

TITANIC

THE SHIP • THE LEGEND

Pack 2





HULL SECTION AND CONNECTORS

PARTS IN THIS ISSUE

- 5A** Starboard bow hull section
- 5B** Short connecting rods for the engine
- 5C** Connecting shaft
- 5D** Valve rods
- 5E** Link sections

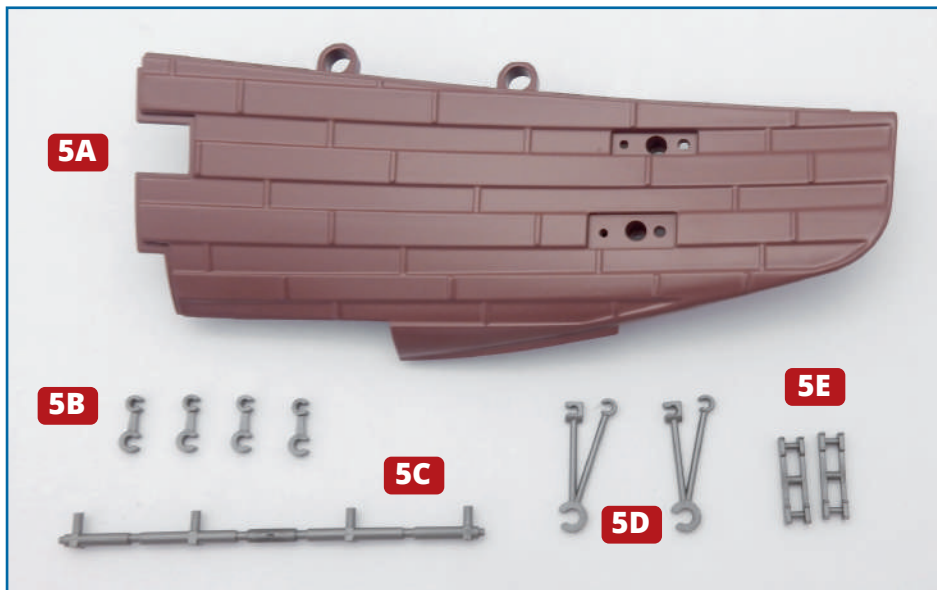

1 Take the four short connecting rods **5B**: note that the connecting grip at one end is larger than the other (left). Also, on the shaft **5C** note that the blocks at the bases of the large pegs are flat on one side (blue arrows, below). With the shaft **5C** in the orientation shown, clip the larger grips of parts **5B** onto the four narrower sections of the shaft **5C** (below right). Do not use any glue.

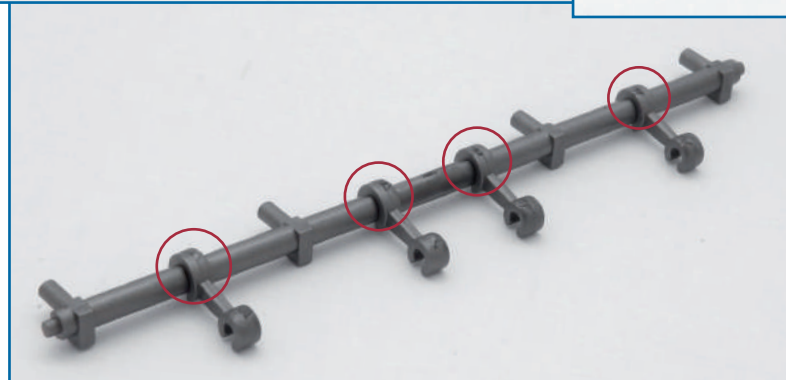
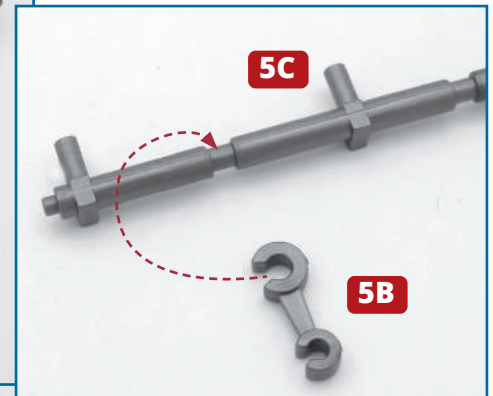
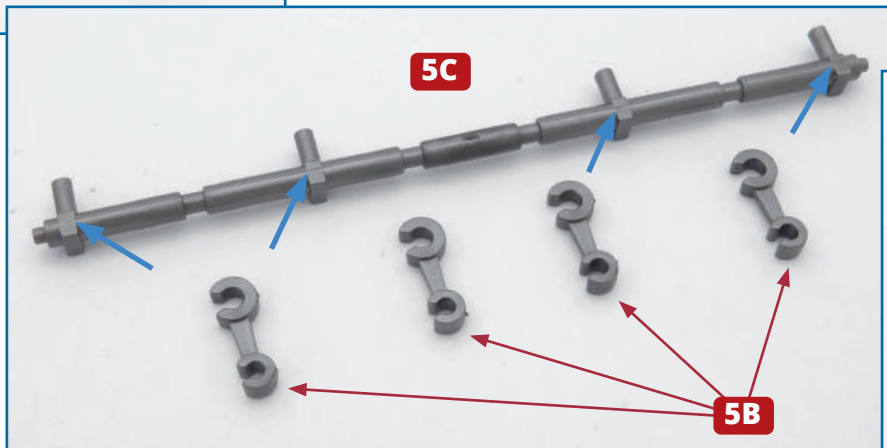

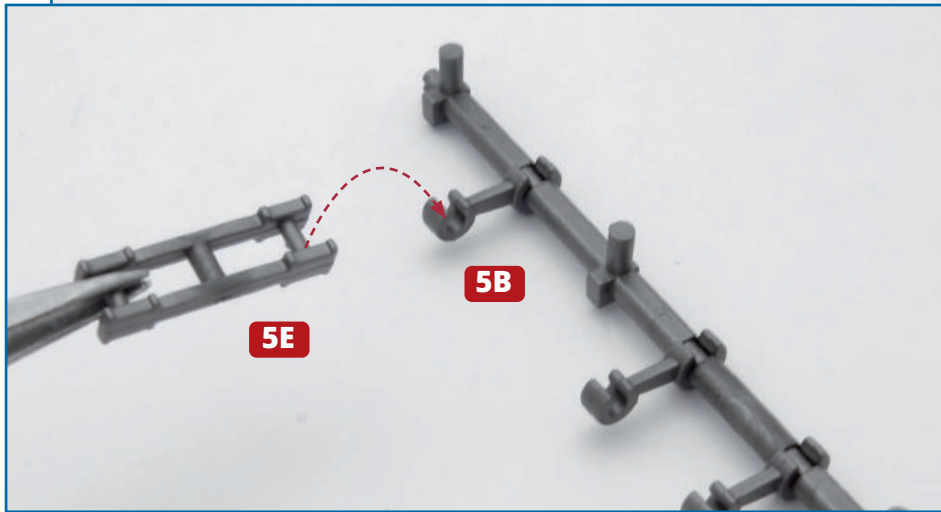
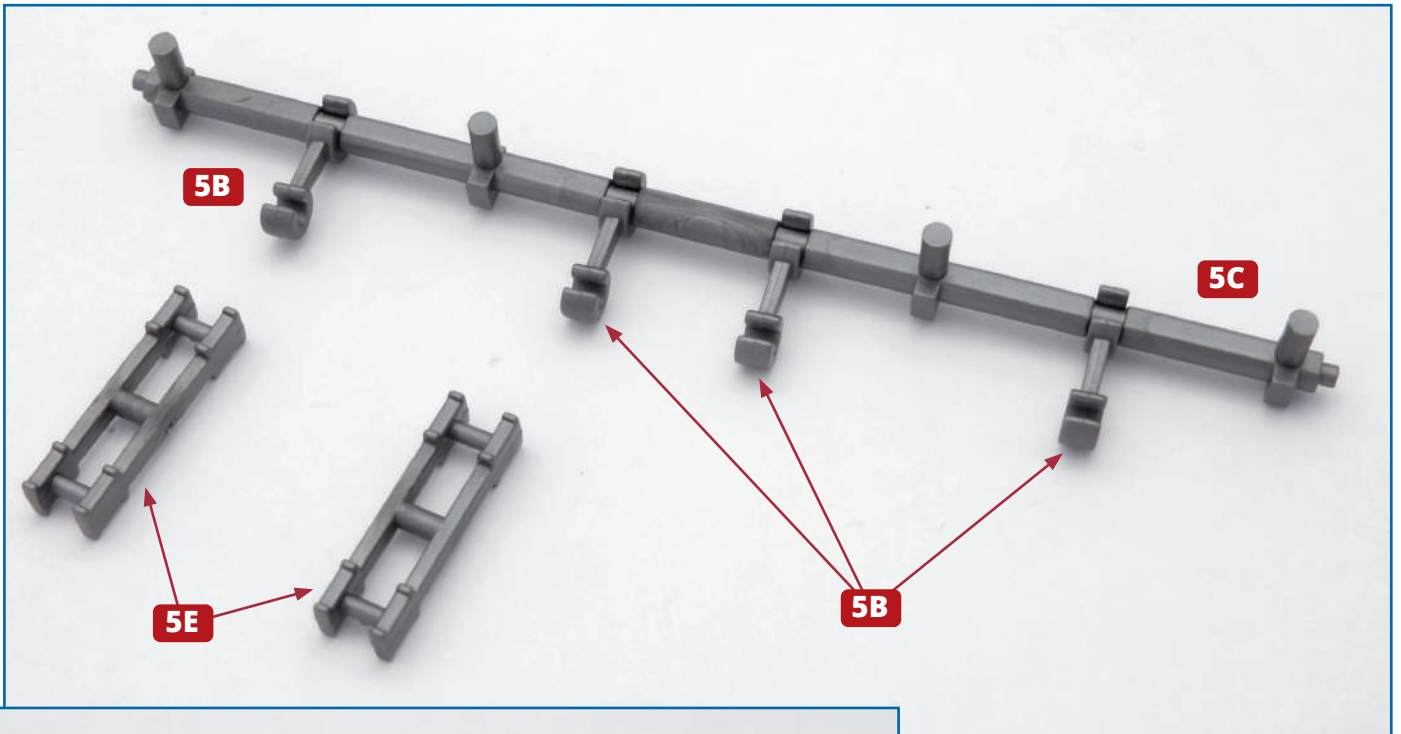

2 Turn the shaft **5C** over, and place it on your work surface with the pegs pointing upwards. Take one of the link sections **5E** and fit the bar at one end into the smaller grip of the connector at the end of the connecting shaft (left). Repeat to fit the second link section **5E** in place (below).

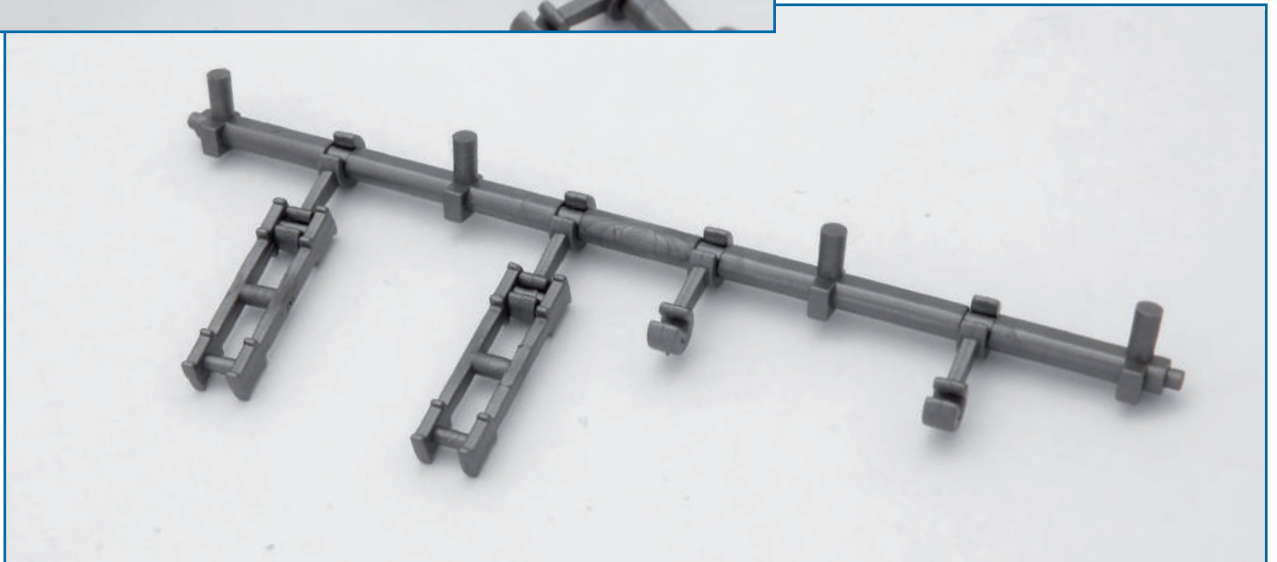

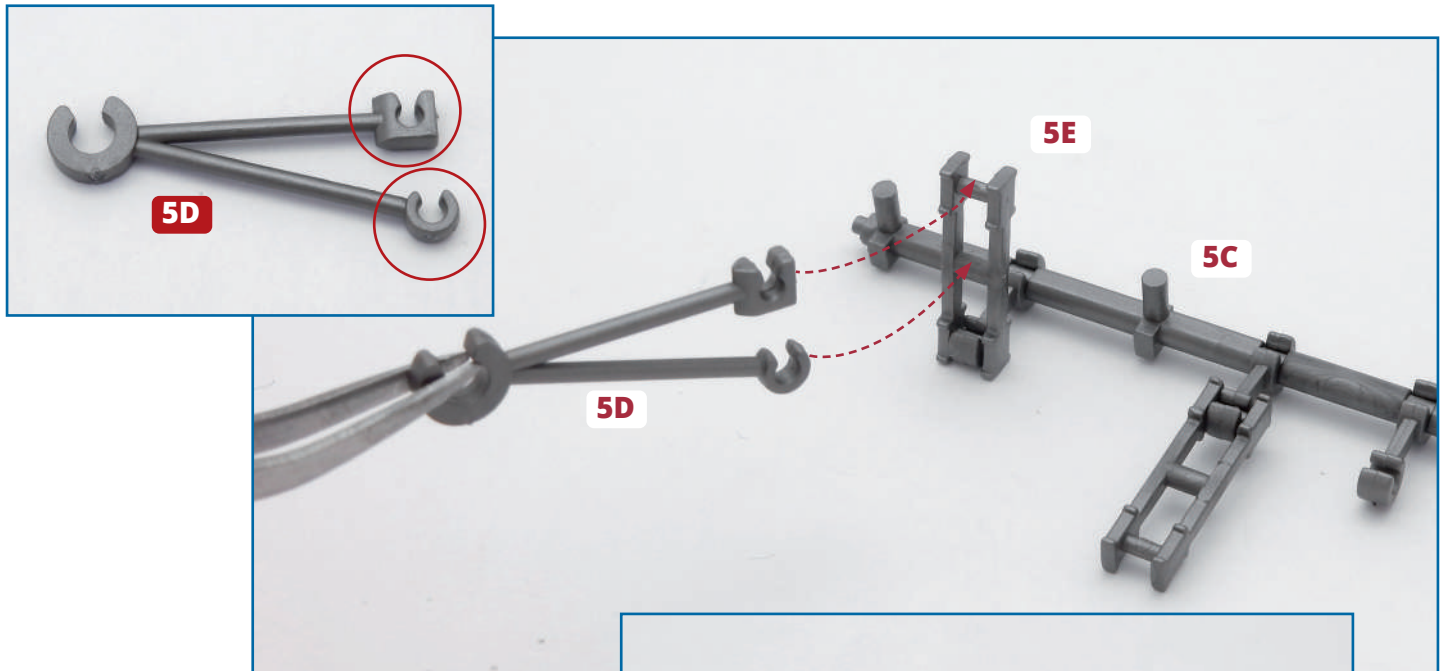

3 Take a valve rod **5D**: note that one of the two grips at the end of the rod is square shaped and the other is rounder (top). Arrange the first link **5E** upright and carefully fit the two grips on to the two free bars on the link **5E** (above right). In this orientation, the square grip is at the top. Repeat to fit the second valve rod **5D** in place (right) on the second link **5E**. Note the orientation of the blocks at the base of the pegs and note that all the openings on the grips face upwards (circled).

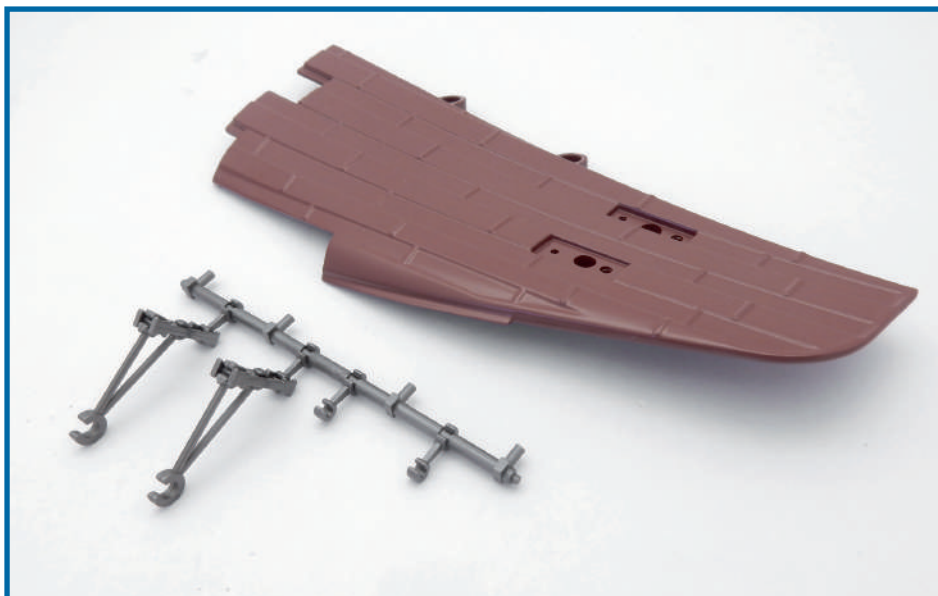
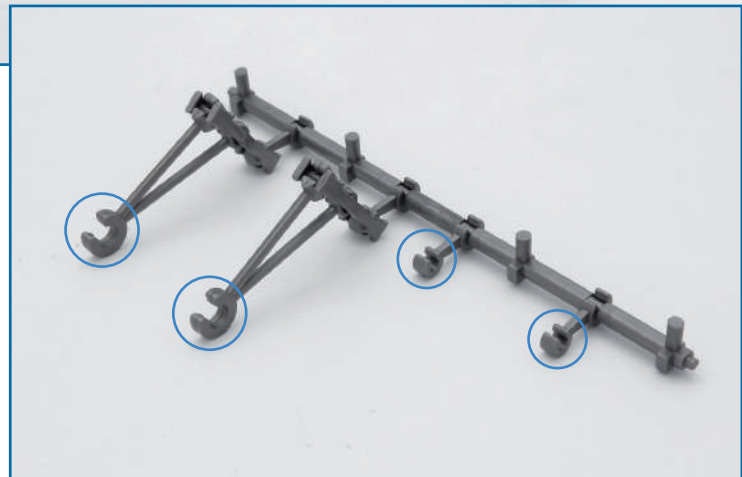

Completed work

Carefully store the hull section and the rod and shaft assembly: in the next issue they will be used to complete the next step of the assembly.

HULL SECTION AND ENGINE PARTS

PARTS IN THIS ISSUE

6A Section of hull, upper bow, starboard

6B Valve rods (x 2)

6C Link sections (x 2)

DM Three PWM screws
(1 spare)

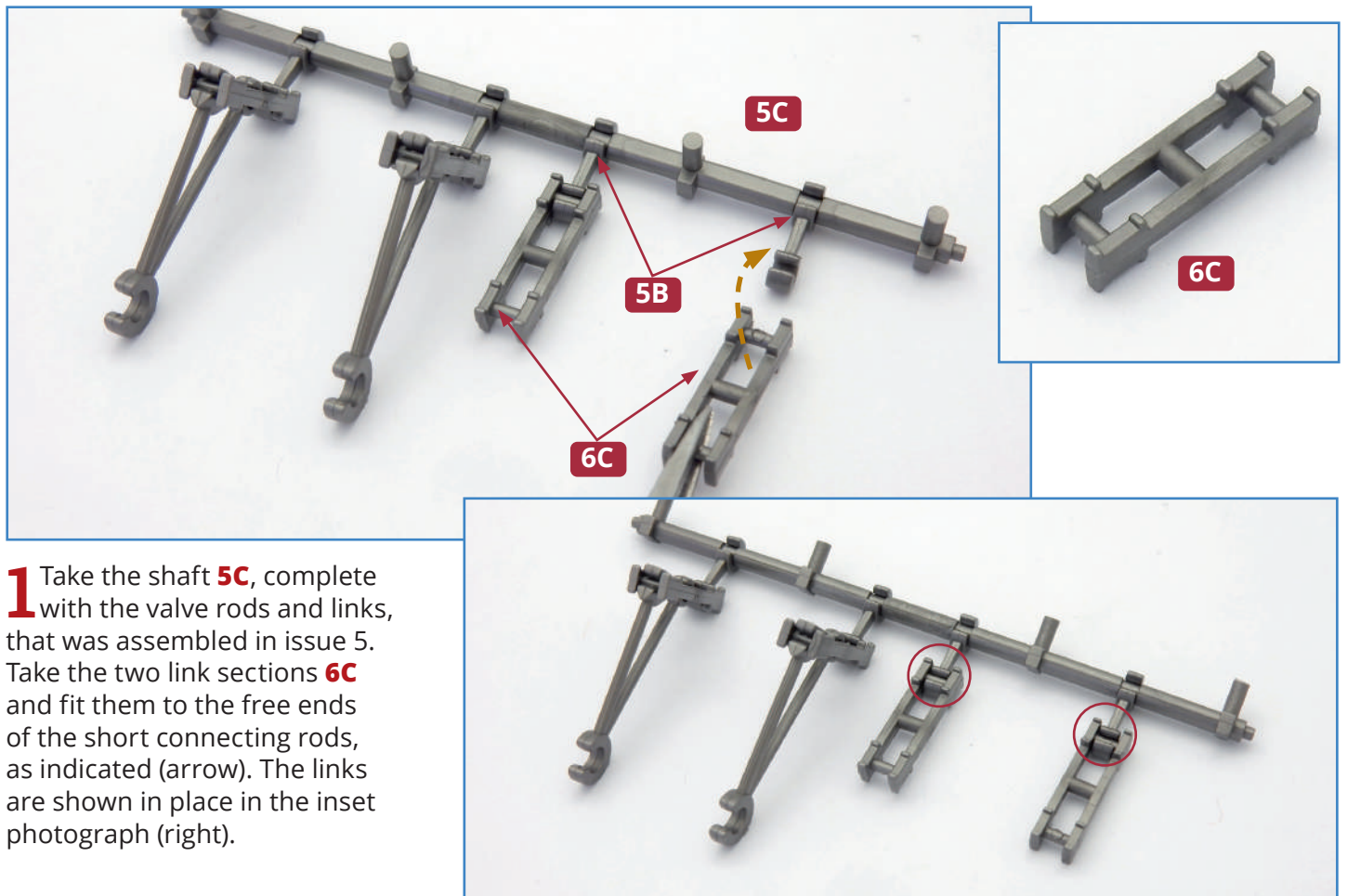
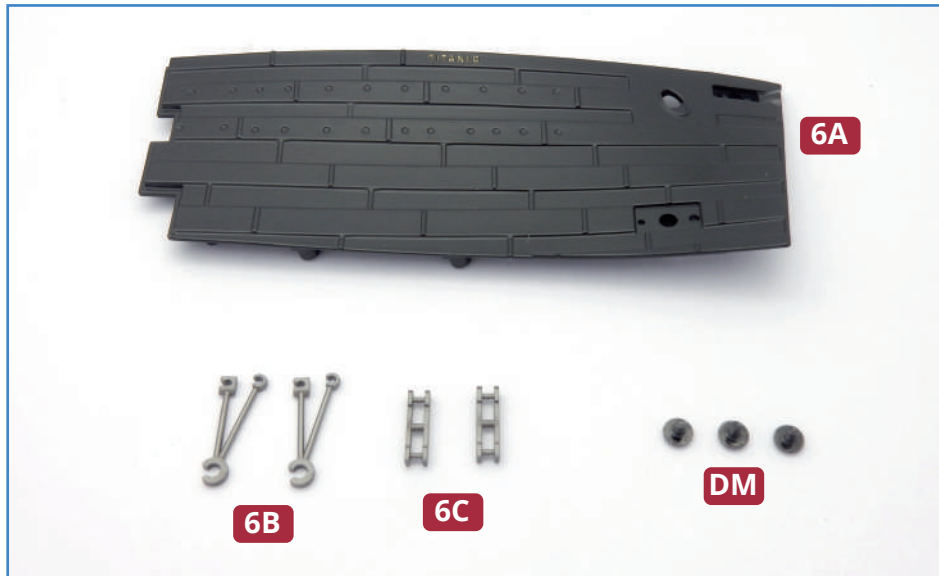

1 Take the shaft **5C**, complete with the valve rods and links, that was assembled in issue 5. Take the two link sections **6C** and fit them to the free ends of the short connecting rods, as indicated (arrow). The links are shown in place in the inset photograph (right).

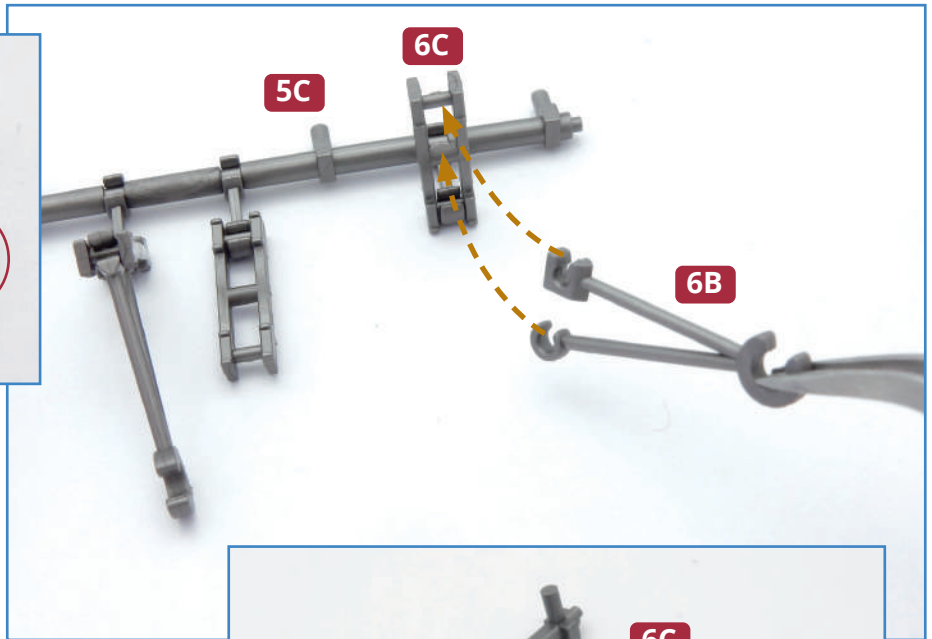
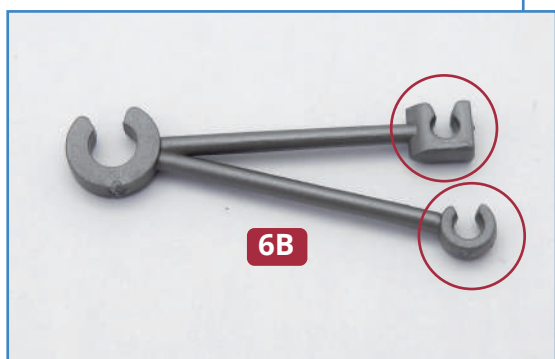

2 Take the first of the two valve rods **6B** and note the square- and round-shaped grips (above). Arrange the end link section **6C** upright, as shown (above right). Take care as you fit the grips: the round grip fits around the central bar in the end link **6C**; the square shaped grip fits around the top bar, as indicated (above right). The inset (right) shows the valve rod fitted in place. Repeat to fit the second valve rod **6B** to the second link **6C**. Check that the openings circled in red (below) all face upwards.



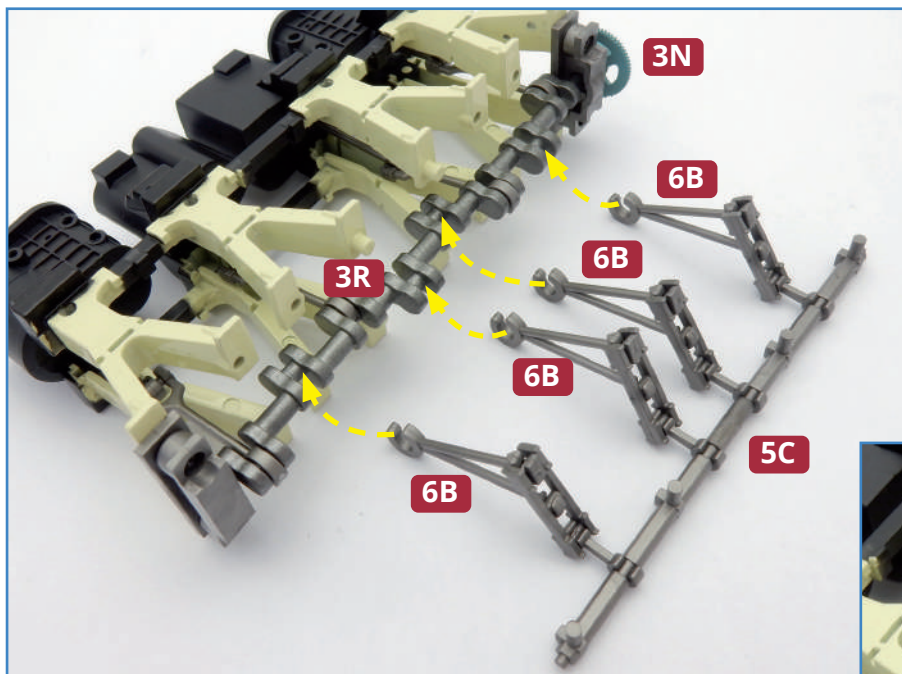

3 Take the engine assembly from issue 3. Position it on your work surface as shown, with the flywheel **3N** at the right-hand end. Place the shaft with connectors on the work surface so that the open grips on the valve rods **6B** are all facing upwards. Fit the grips around the bars on the crankshaft, as indicated (arrows). The inset below shows the valve rods fitted to the crankshaft.

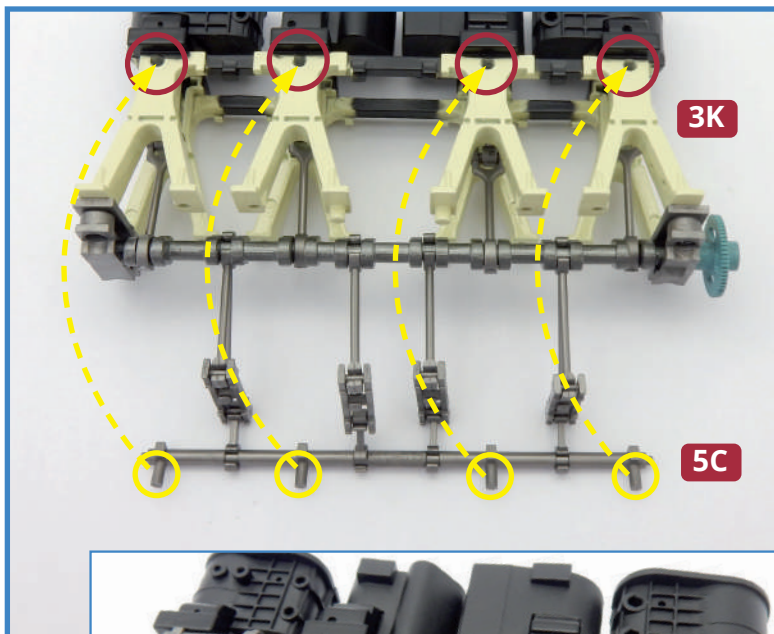
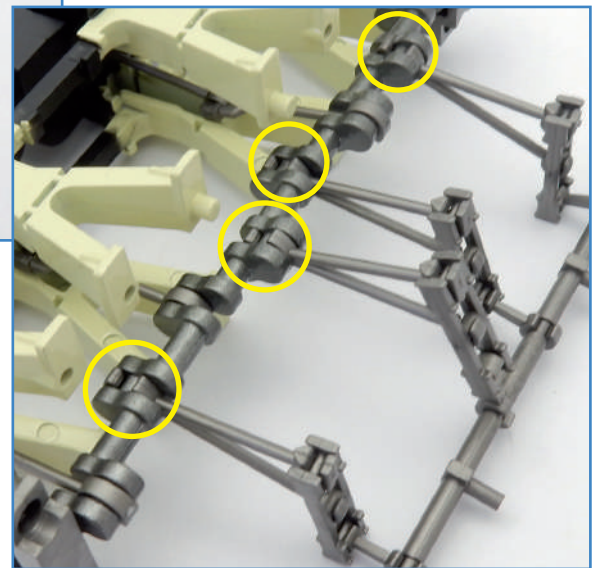

4 Identify the four holes in the port side columns **3K** (circled in red). Lift the shaft as indicated by the arrows so that you can fit the pegs on the shaft **5C** (circled in yellow) into the holes, pushing them firmly in place. The photograph on the left shows the shaft in place. Test the operation of the shafts by following the instructions on the next page. When you have tested it, if necessary apply a little glue to the pegs to hold them securely in place.

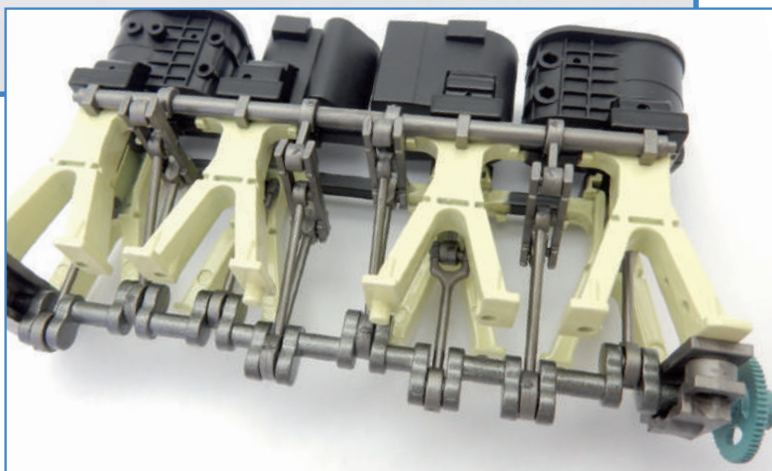

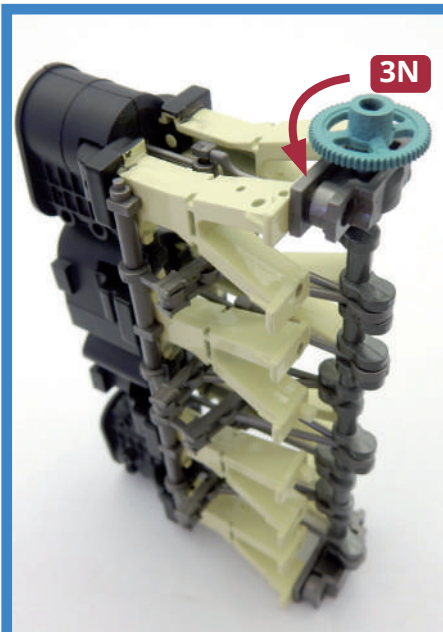

Test the operation of the crankshaft and connected parts: hold the assembly upright, with the flywheel at the top. Carry out a functional test of the crankshaft and connected parts. Turn the flywheel anticlockwise, as indicated, to see the action. **DO NOT** turn the flywheel clockwise.

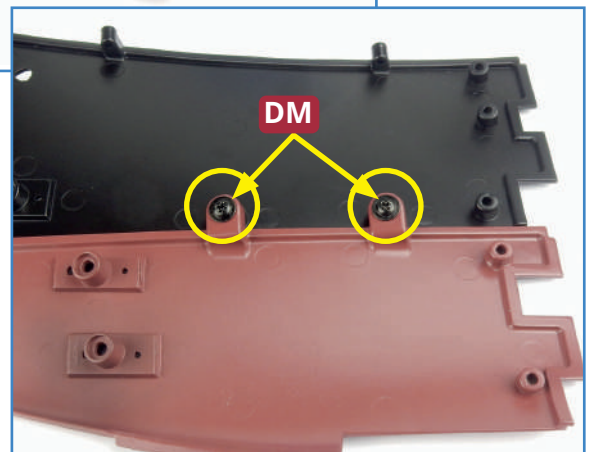
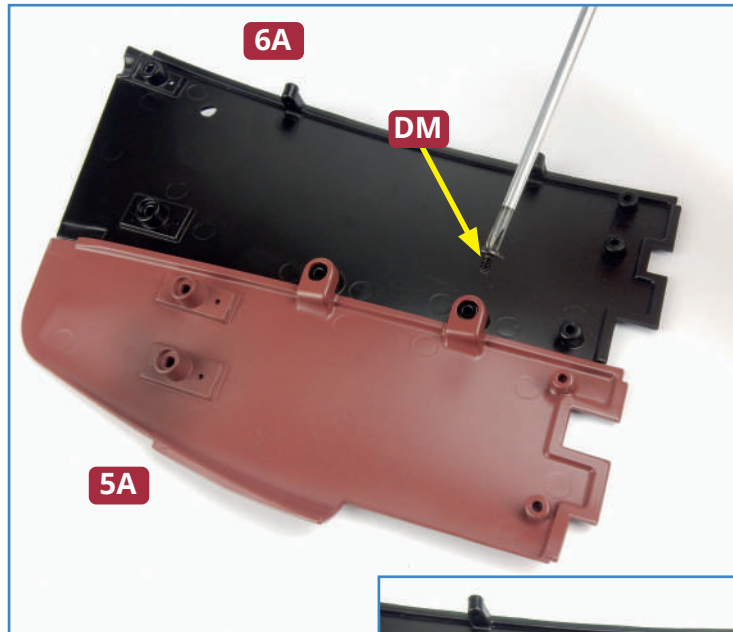

5 Take hull section **5A**, supplied with the previous issue, and the hull section **6A**. Fit the parts together so that the tabs on part **5A** fit over the screw holes in part **6A**. Fix the parts together with two **DM** screws (right).



Completed work

The engine columns, crankshaft and connecting rods have been assembled. Work has started on the starboard side of the hull.

THE BASE OF THE ENGINE

PARTS IN THIS ISSUE

- 7A** Catwalk
- 7B** Base for the engine
- 7C** Hull joining plate
- AP** Seven PB screws (1 spare)
- BP** Four PB screws (1 spare)
- EM** Five PM screws (1 spare)
- FM** Five PB screws (1 spare)

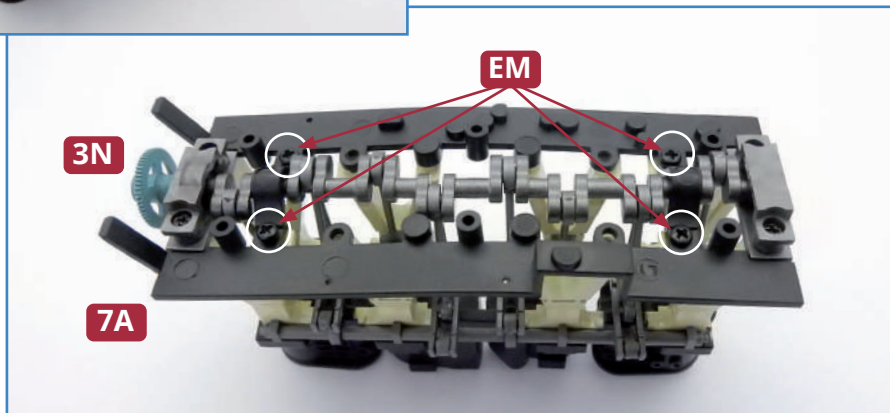
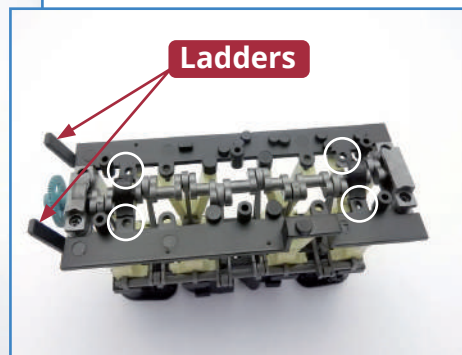
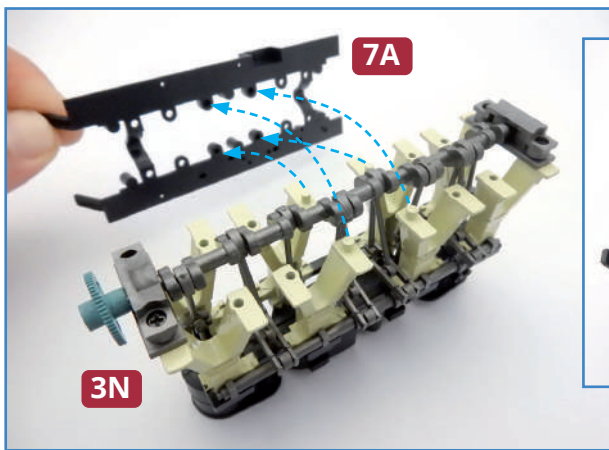
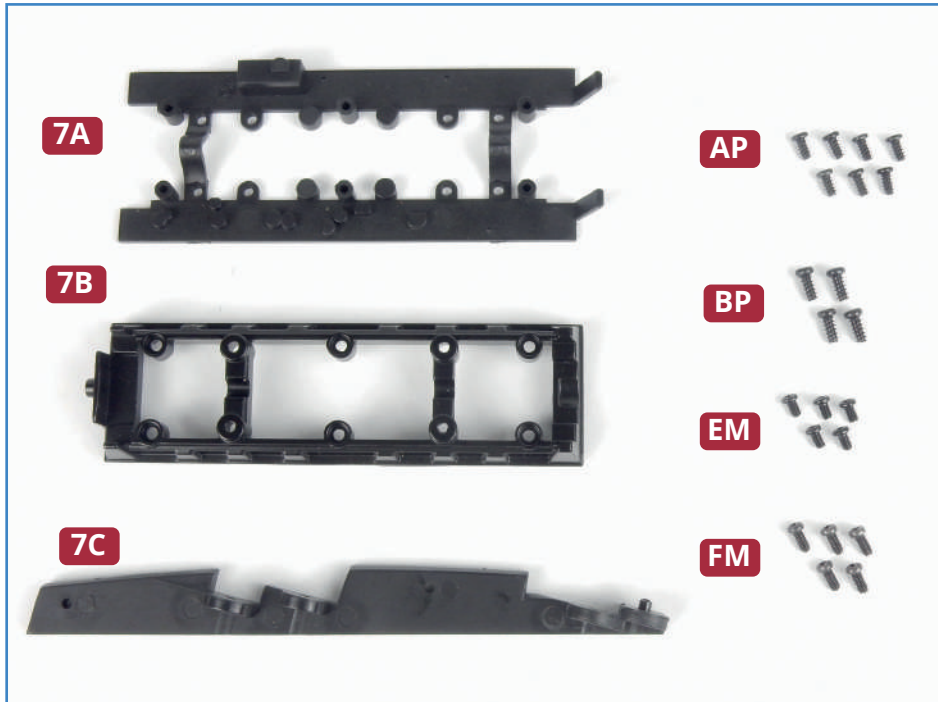

1 Place the engine on your work surface as shown (far left). Note the position of the flywheel **3N**. Position the catwalk **7A** so that the two ladders are at the same end as the flywheel **3N**. Small pegs on the base of the engine fit into sockets in the underside of the catwalk (blue arrows). When you are happy with the fit, use four **EM** screws (circled in white) to fix the catwalk **7A** in place. Make sure that the screws are fully tightened to hold the catwalk flat.

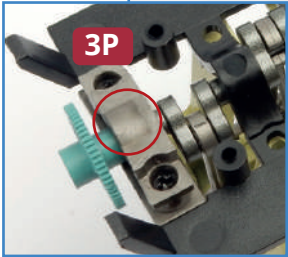
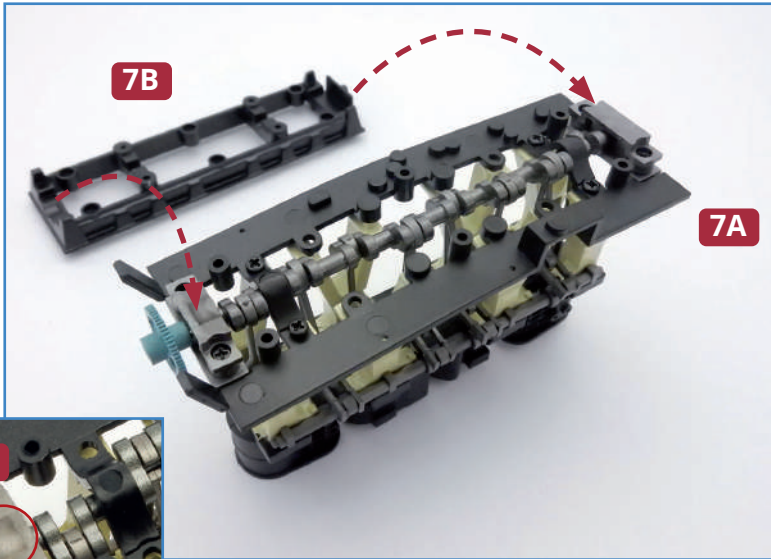

2 Fit the base **7B** over the catwalk **7A**. The ends of the base fit against the stop plates fitted in issue 3, as indicated. There is a small hump on stop plate **3P**, next to the flywheel – if it is in the wrong position, remove the screws and turn it around to the correct position (shown in the inset image, circled) then fix back in place. The base is fixed in place with four **FM** screws, fitted into the screw holes at the ends of the struts (circled in yellow, below). Then fit six **AP** screws into the deep screw sockets (circled in white, below left). We suggest that you fit all the screws loosely to start with, and then go round again to tighten them.

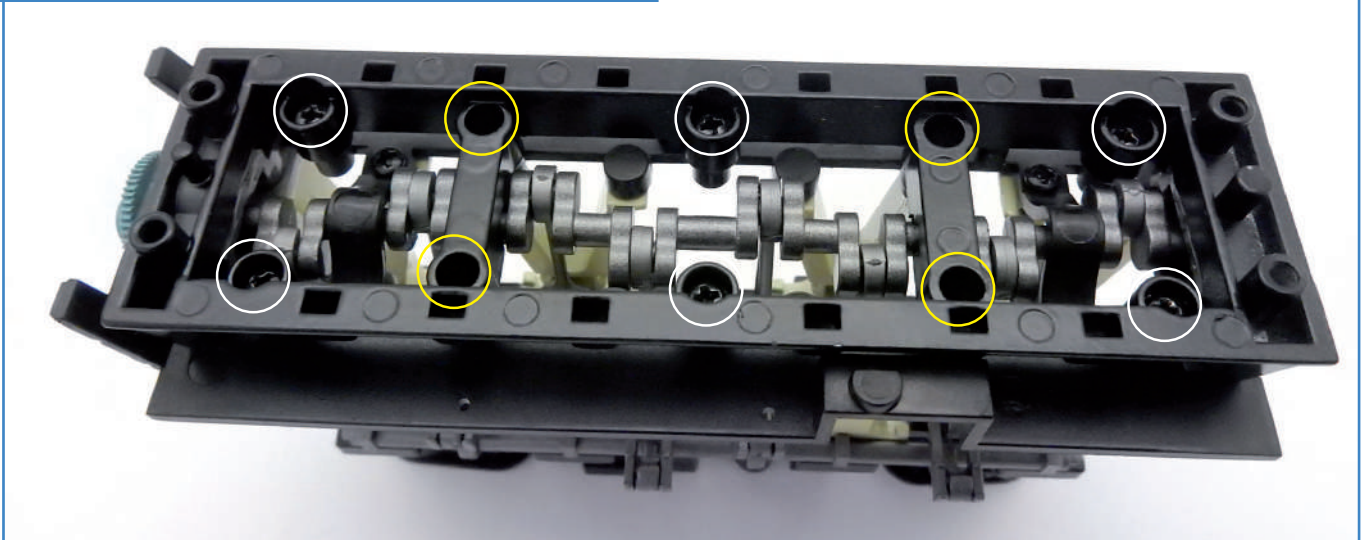
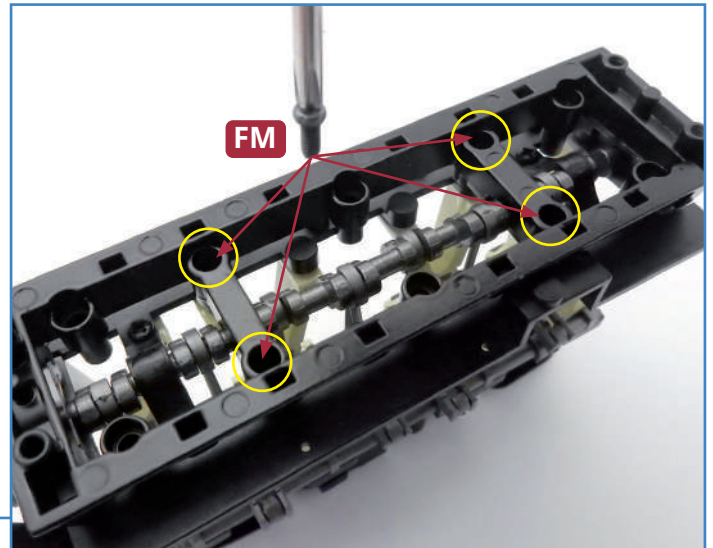
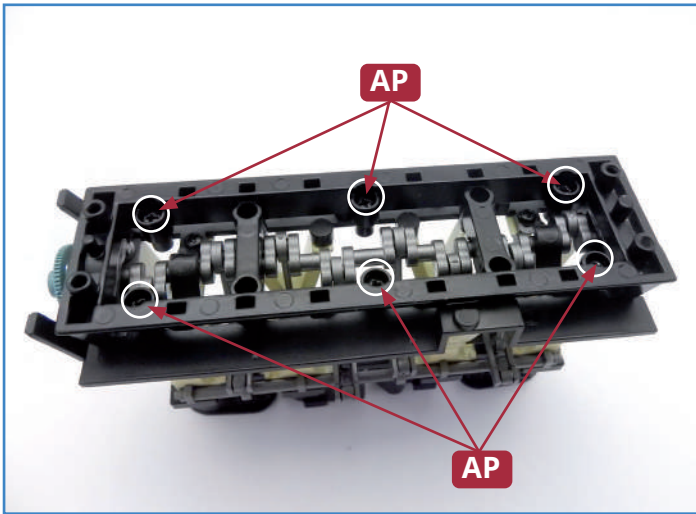

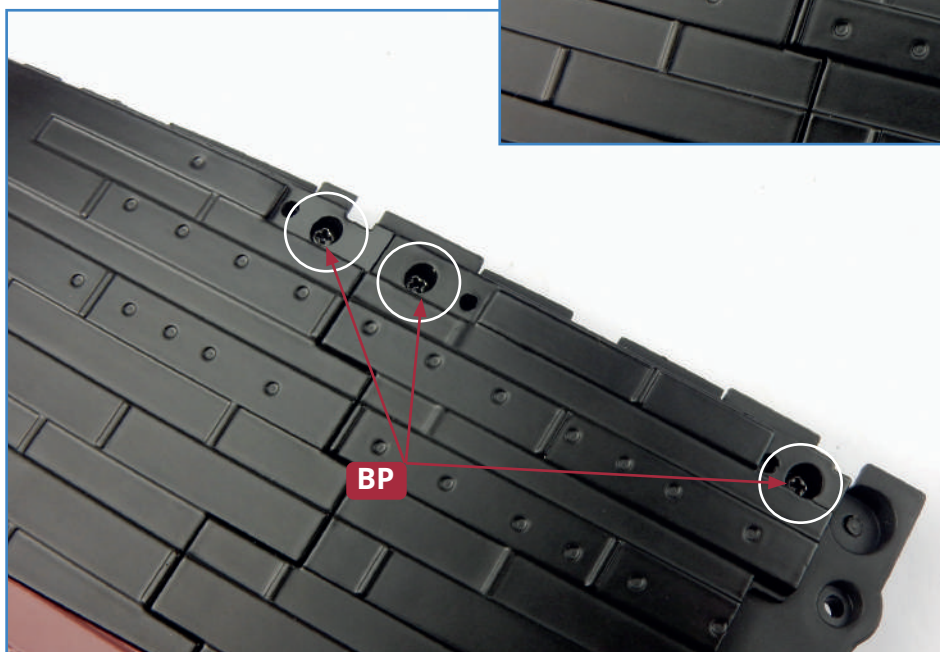
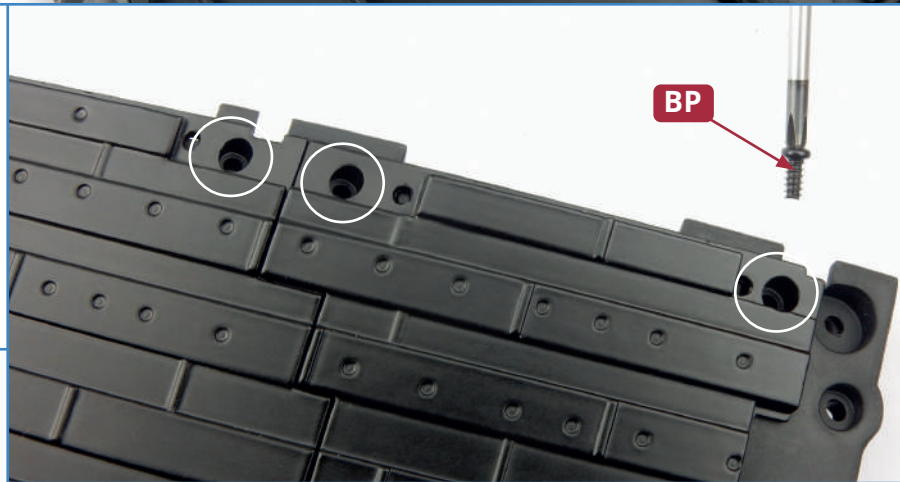
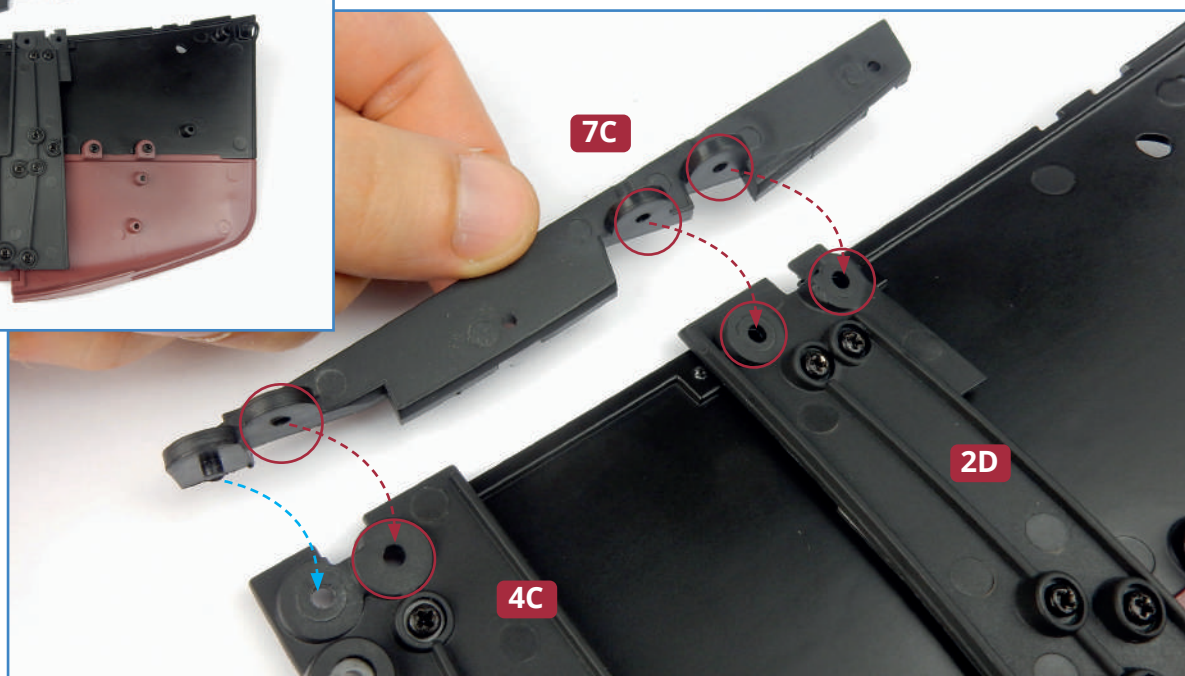

3 Take the port side of the hull assembly from issue 4 and remove the name plate **2C**. Check the fit of the support strut **7C**. Three screw holes in tabs in the support strut **7C** align with screw sockets in the top of parts **4C** and **2D** (red circles and arrows). A peg at the end of part **7C** fits into a hole in part **4C** (blue arrow). Turn the assembly over and identify the three screw sockets (circled in white, above). Fix part **7C** in place with three **BP** screws.

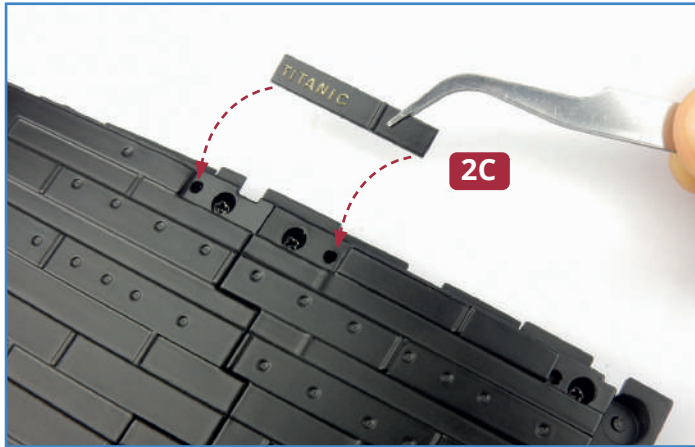

4 Now take the name plate **2C**, removed in step 3. Position it on the top of the hull assembly as indicated: two pegs on part **2C** fit into the sockets in the hull. Use a little superglue to hold it in place if necessary.

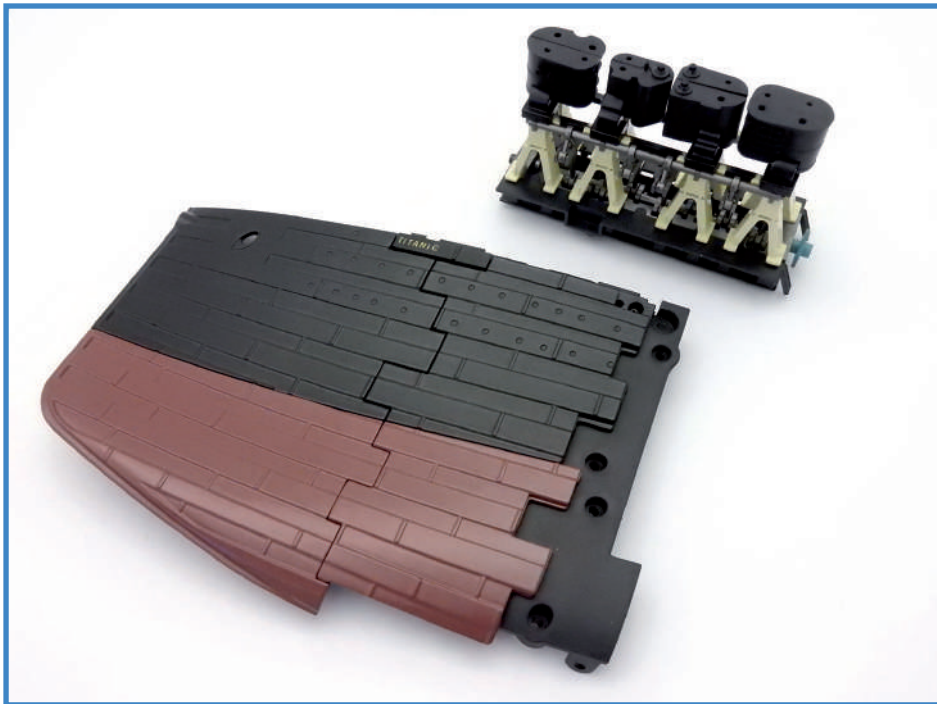

Completed work

The base has been fitted to the engine; the name plate and a joining plate have been fitted to the port side of the hull.

DETAILS ON THE FORECASTLE

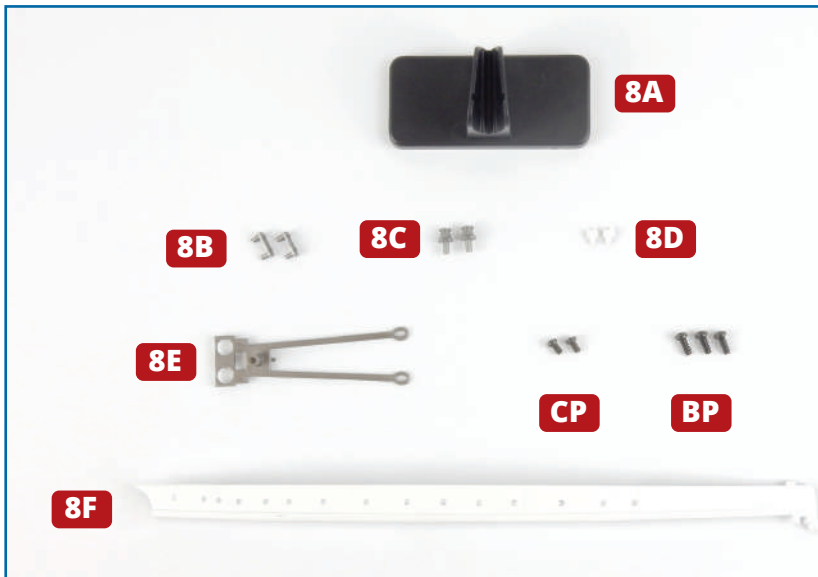

PARTS IN THIS ISSUE

8A Bow support

8B Cleats (x 2)

8C Winches (x 2)

8D Valves for winches (x 2)

8E Anchor chain guide

8F Port top strip of forecastle hull

CP Two PM screws (1 spare)

BP Three PM screws (1 spare)

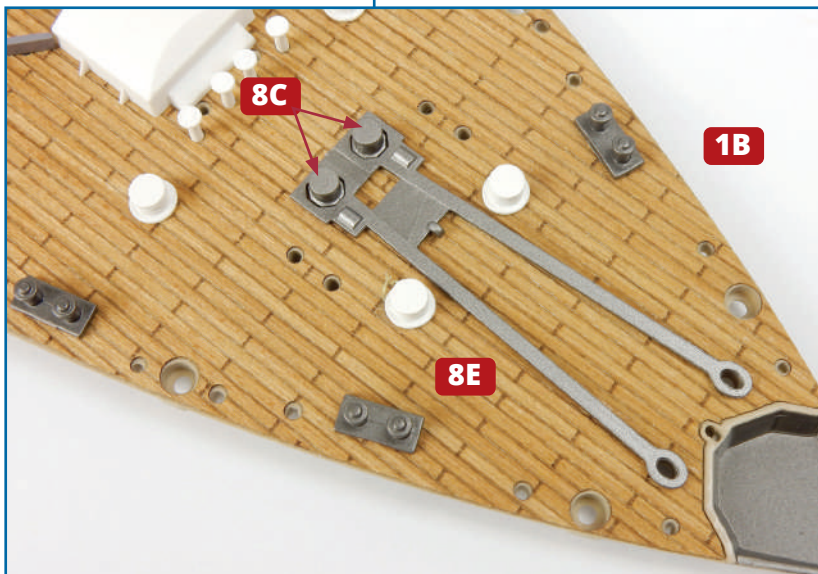
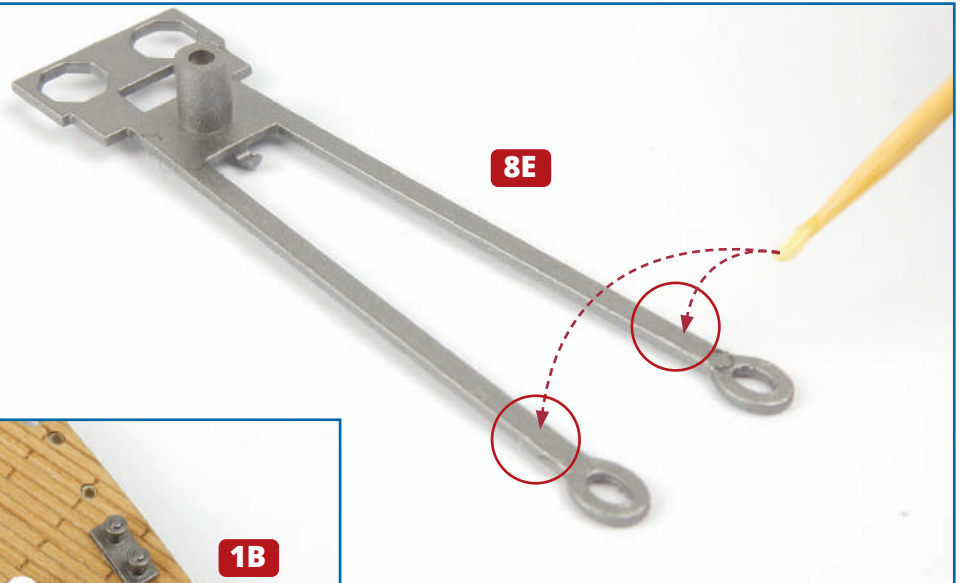
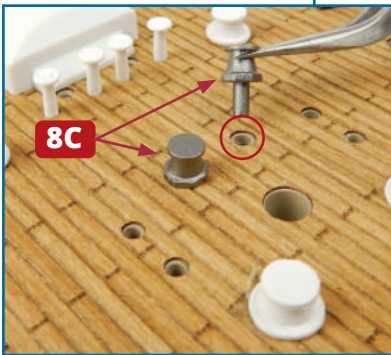

1 Take the two winches **8C** and fit them in the holes in the forecastle deck **1B** (top left). Take the anchor chain guide **8E** and check how it fits over the winches **8C** (left). You may need to turn the winches so the octagonal bases align with the shaped holes in part **8E**. Remove part **8E** and turn it upside down so that you can apply a little glue near the ends of the guides, as indicated above. Then fix part **8E** in place.

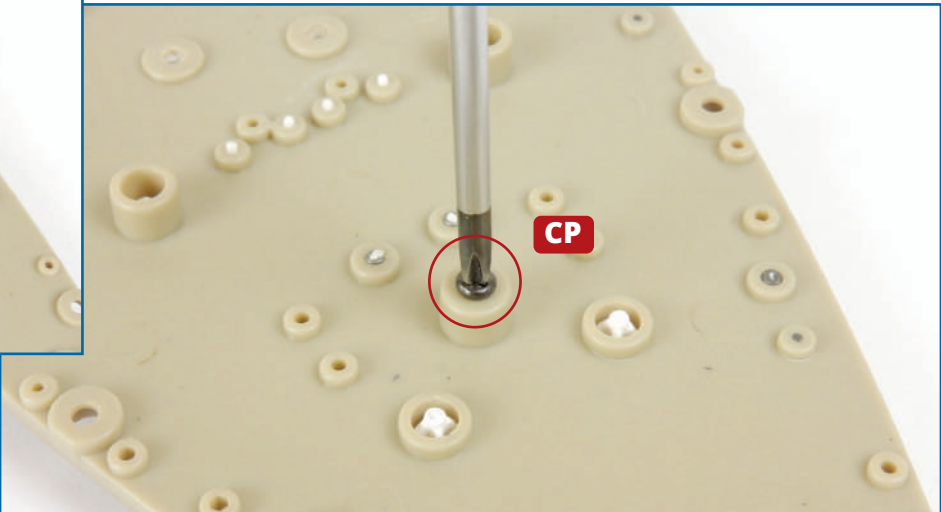
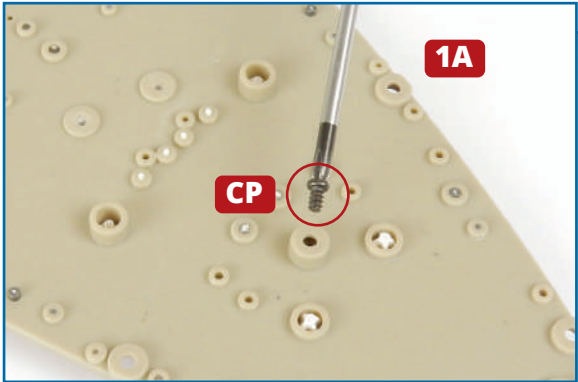

2 Carefully turn the deck over and identify the screw hole on deck support panel **1A** where the anchor chain guide **8E** is fitted. Fix part **8E** in place with a **CP** screw.

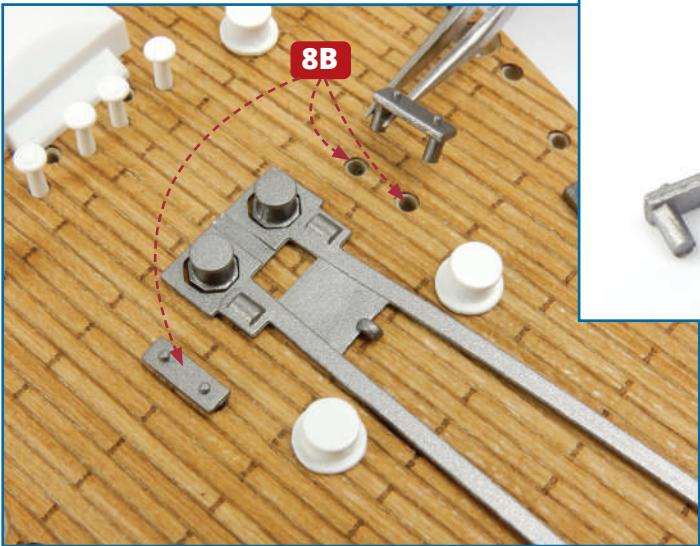

3 Take the two cleats **8B** (left) and fit them into the holes on either side of the anchor chain guides, as indicated (far left).

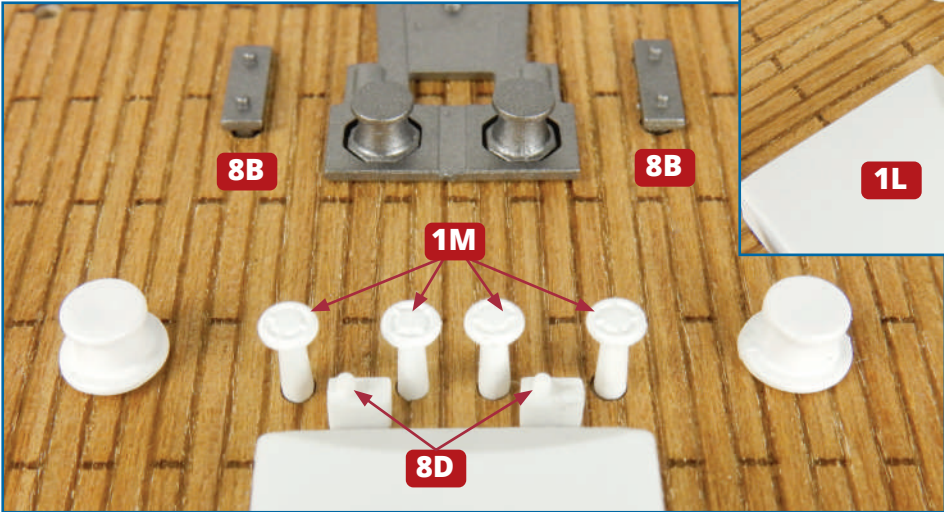
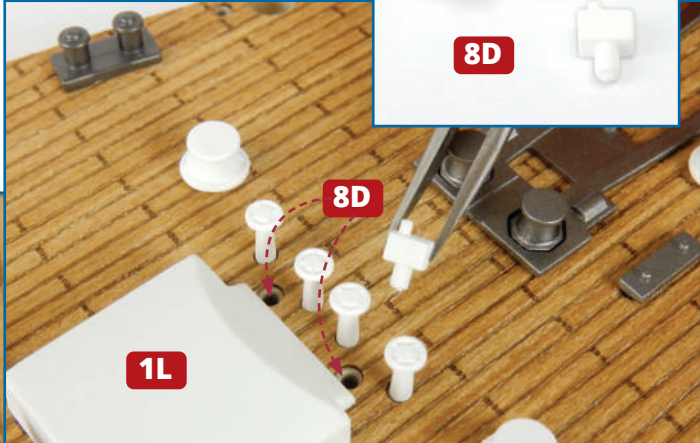
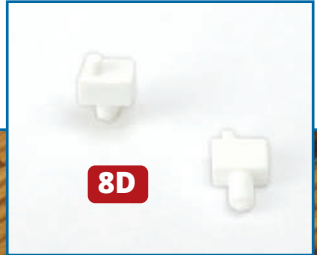

4 The two valves **8D** fit into holes near the loading hatch **1L** (above). Make sure you fit them the right way round, as shown on the left. You may find this easier if you temporarily remove some of the valves **1M** first.

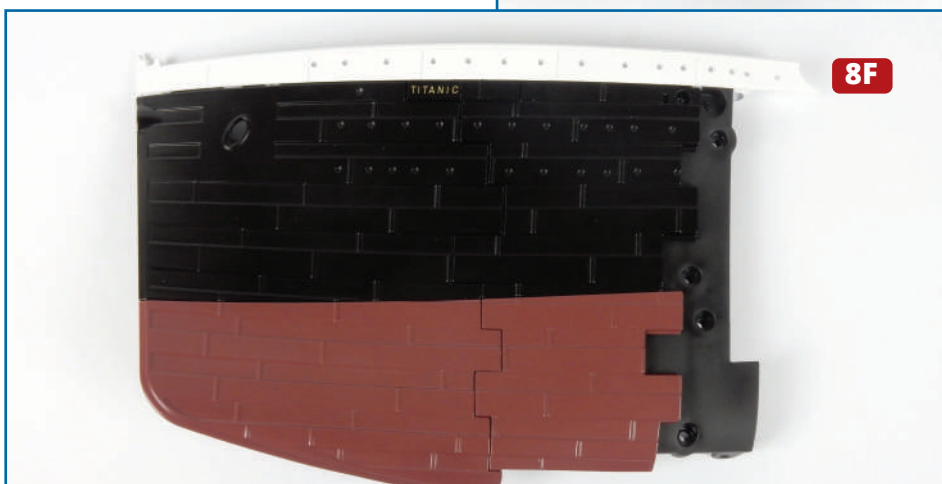
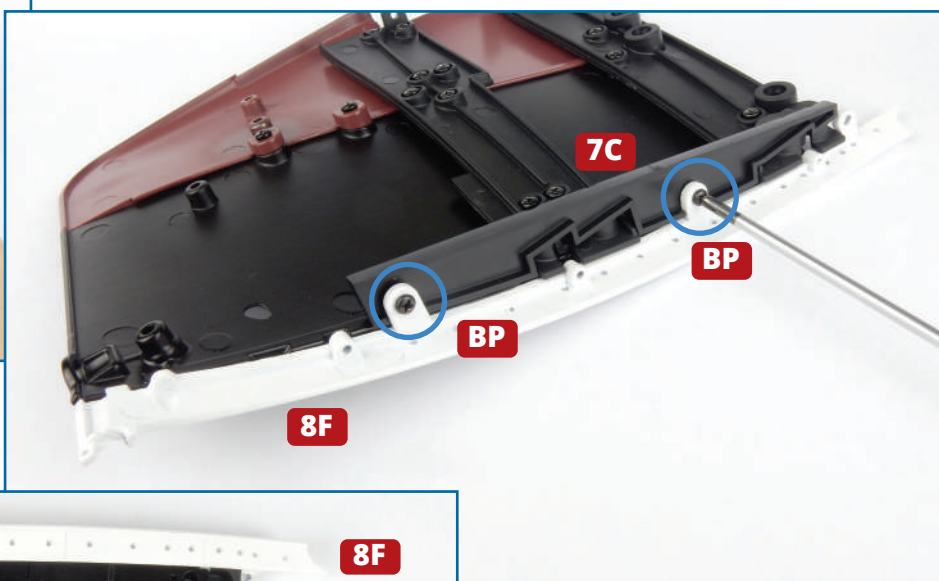
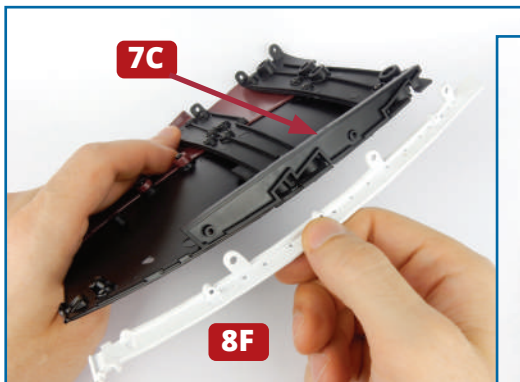

5 Take the port hull assembly from the previous issue. Fit the top strip of the forecastle hull **8F** along the top of the assembly so that the screw holes in the tabs in part **8F** align with the screw holes in the support **7C**. Fix in place with two **BP** screws (above, circled in blue).

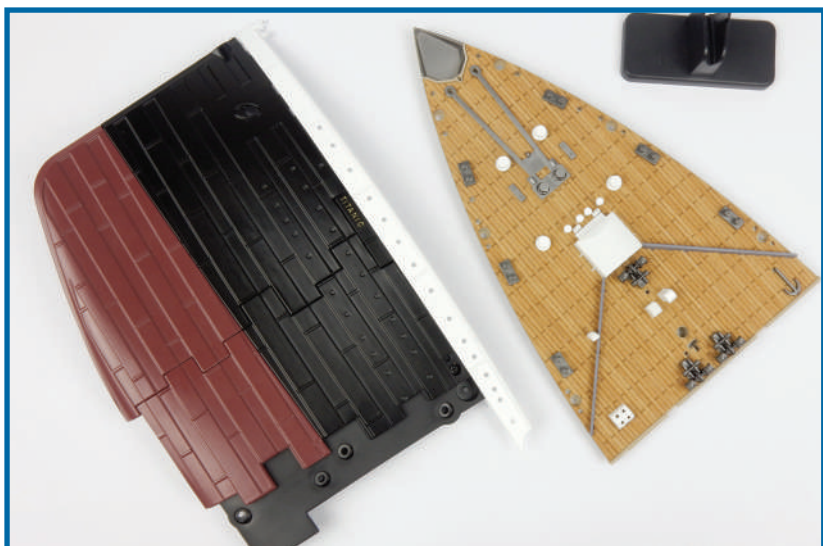

Completed work

Further details have been added to the forecastle and the top strip of the forecastle hull has been fitted along the port side of the hull. The hull bow support **8A** will be used in a future issue.