

TITANIC

THE SHIP • THE LEGEND

Pack 5



STARBOARD HULL SECTION

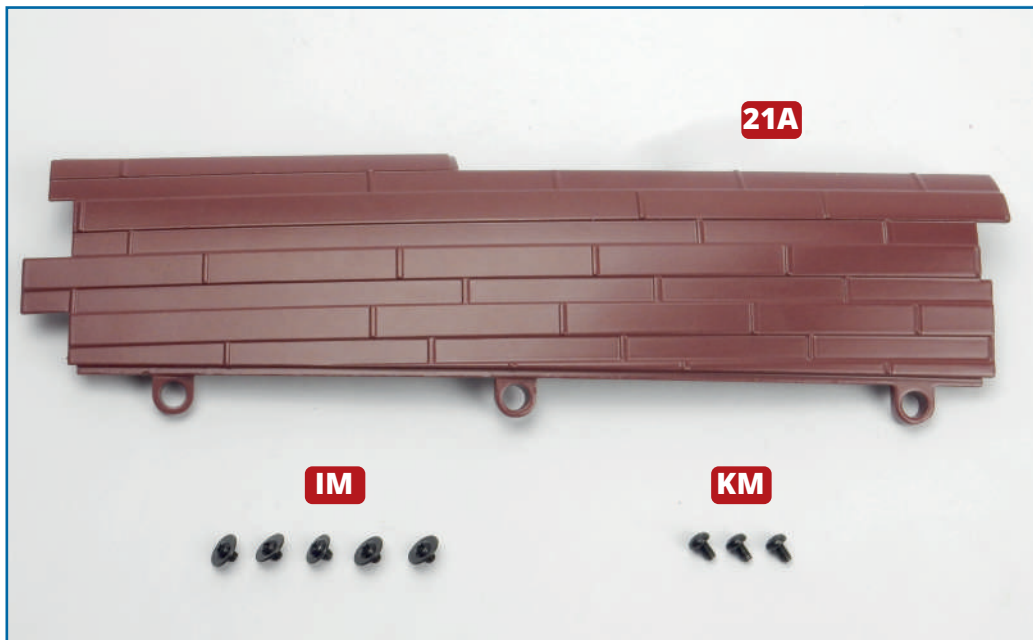

PARTS IN THIS ISSUE

21A Starboard hull section

IM Five 2.6 x 3mm PWM screws (1 spare)

KM Three 2.6 x 3mm PM hex screws (1 spare)

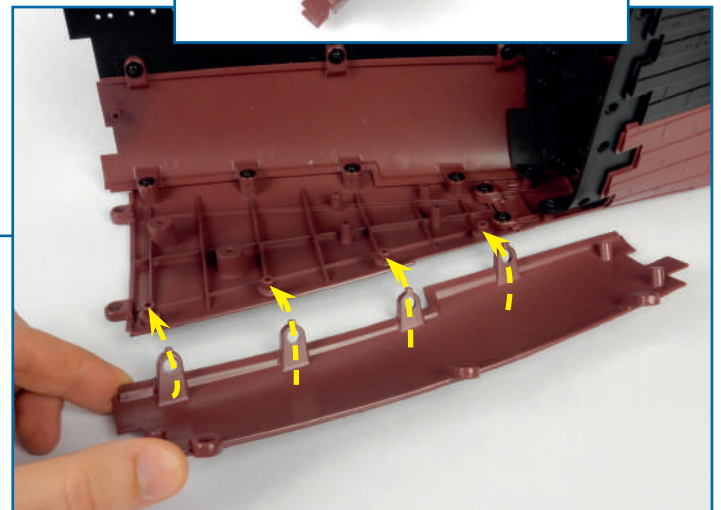
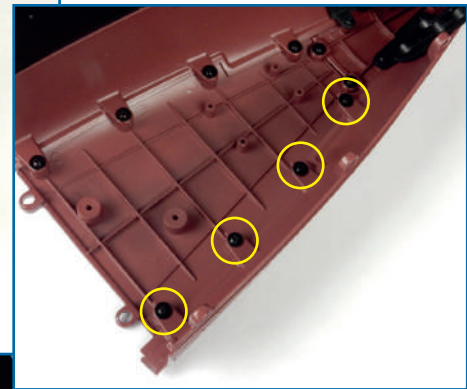
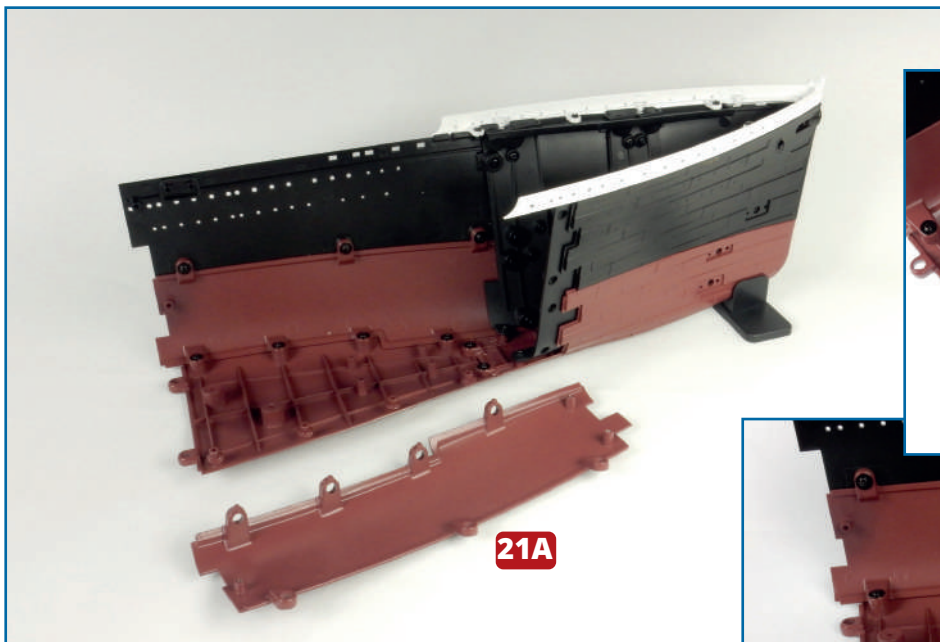

1 Take the hull assembly from issue 18 and the hull section **21A**. Fit section **21A** along the top edge of the keel section **13A** so that the screw holes are aligned, as indicated (yellow arrows, right). Fix the two sections together with four **IM** screws (yellow circles, above right).



2 The forward edge of **21A** is aligned with the joining panel **9I**. Fix the parts together with two **KM** screws, using the Allen key supplied with issue 15.

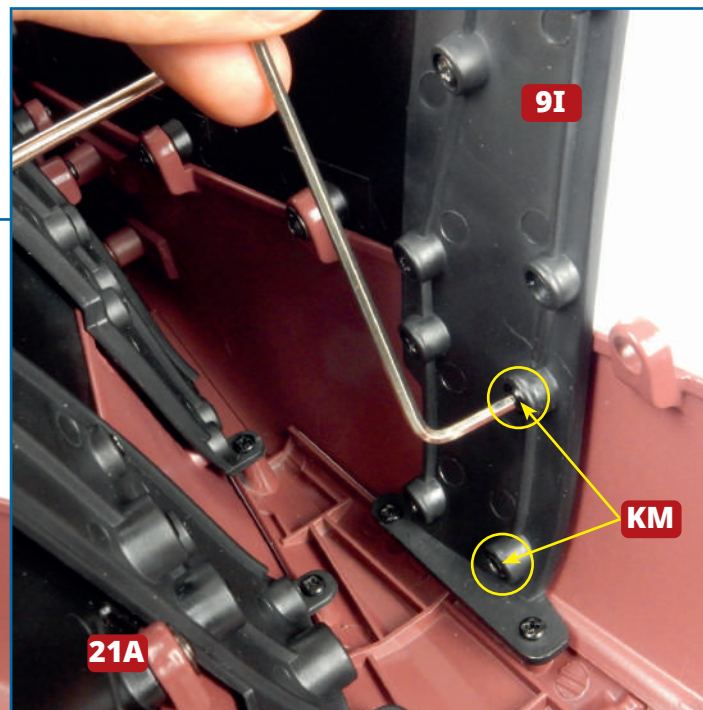
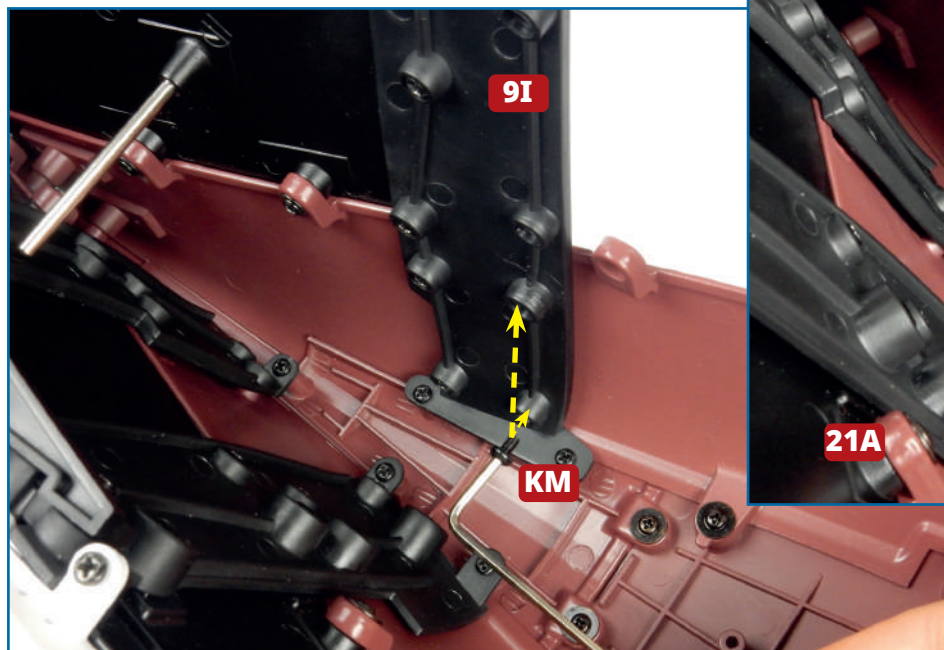

Completed work

Another section has been fitted to the starboard side of the hull.

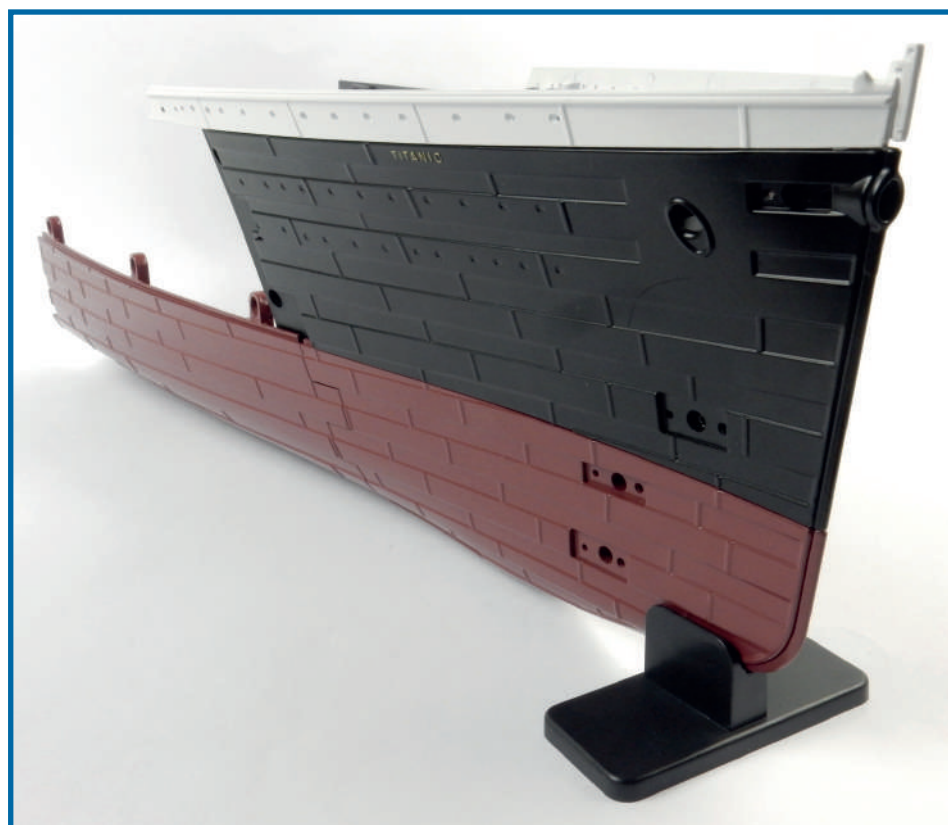

WINDOWS FOR THE SUPERSTRUCTURE

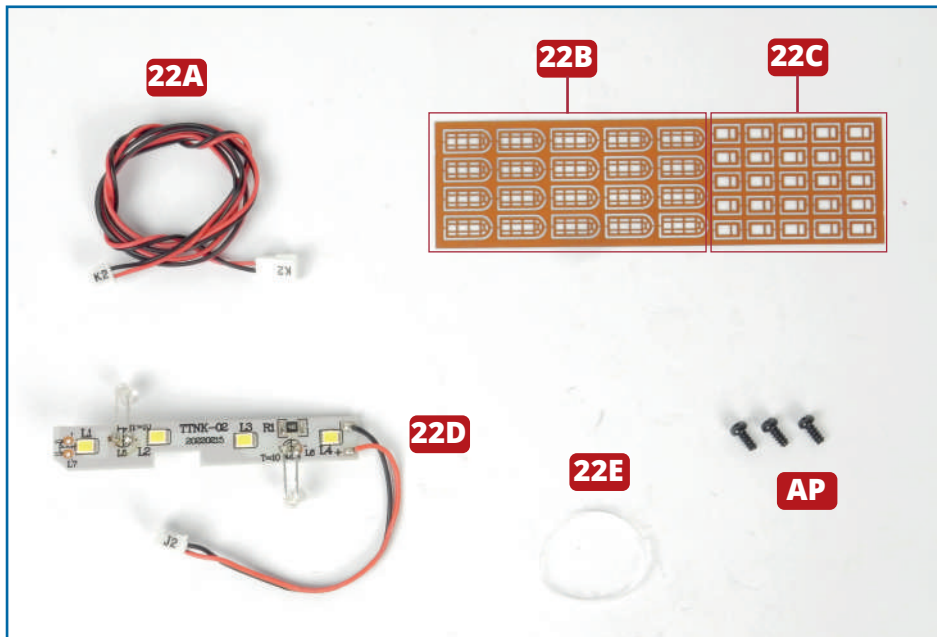

PARTS IN THIS ISSUE

- 22A** Extension cable K2 for the second funnel
- 22B** Arched windows (x 20)
- 22C** Rectangular windows (x 25)
- 22D** LED strip J2
- 22E** Plastic band
- AP** Three 2.3 x 5mm PB screws (1 spare)

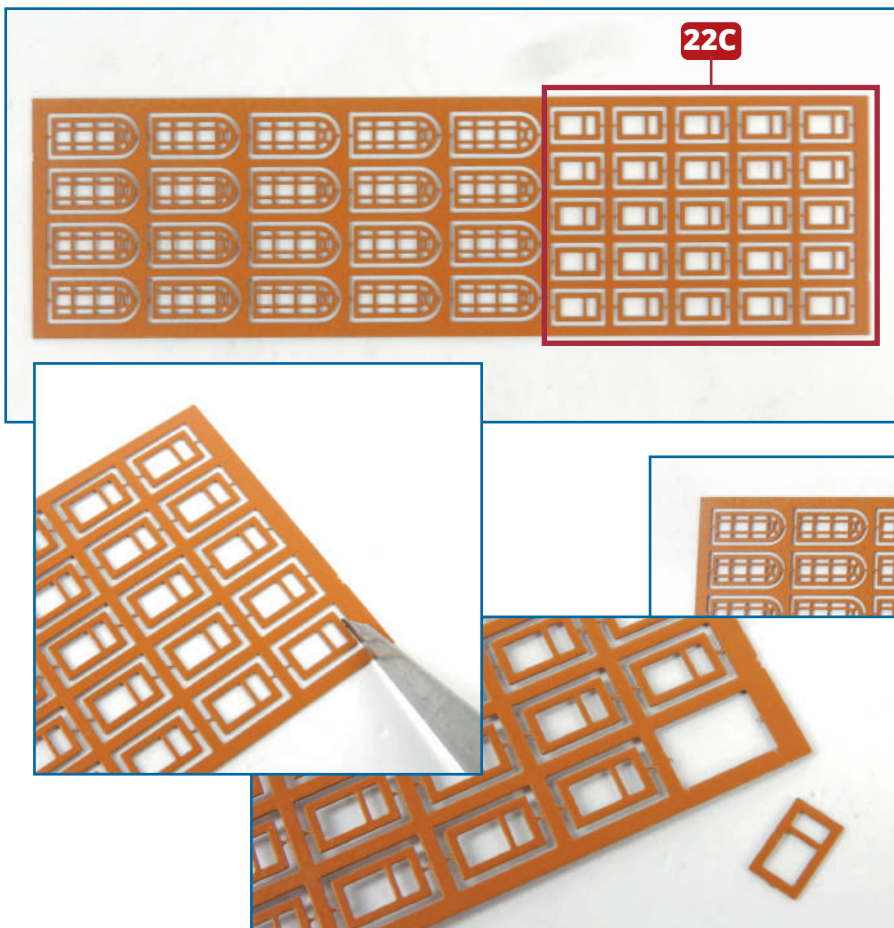

1 Take the photo-etched plate with the windows and remove all the windows from the frame **22C** using a sharp craft knife. When using a craft knife, always take great care and cut on a suitable surface, such as a cutting mat. Use a fine file or sandpaper to remove any small burrs where the windows were attached.

NOTE: The windows are small and delicate. Work on a clear, clean surface and handle the parts carefully.

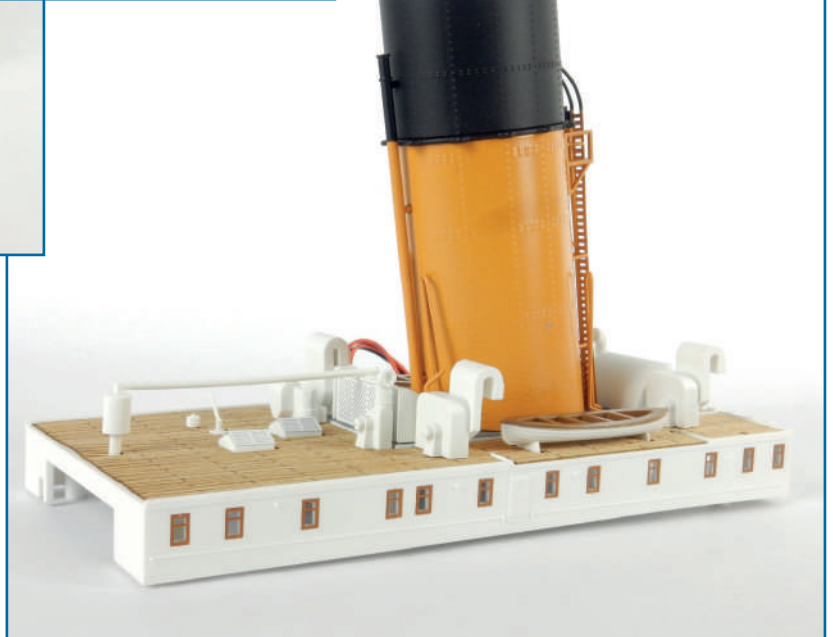
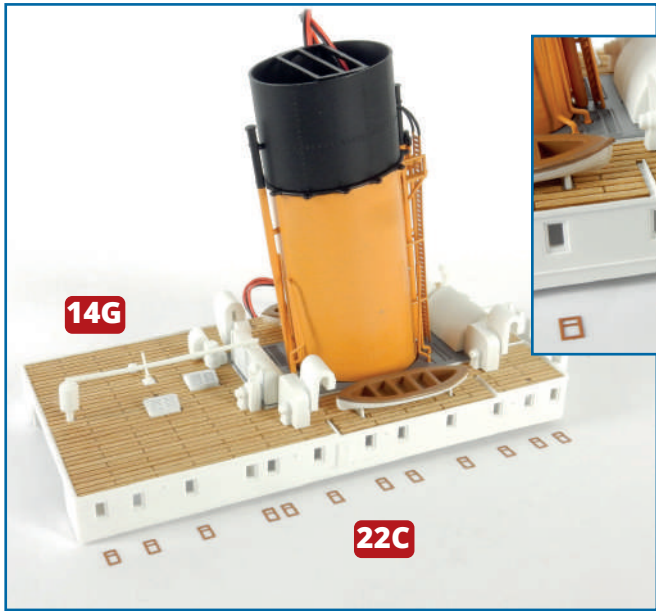

2 The windows **22C** have to be fitted to the superstructure **14G**. Start on the starboard side and align 12 of the windows with the 12 openings. One at a time, apply a little superglue to the recessed rim around each opening and stick each window in place. You may find this easier if you prop up part **14G** so that the starboard side is horizontal. Note the orientation of the windows, with the glazing bar nearer the top.

3 Allow the glue to dry and check that all the starboard windows are secure before continuing. In the same way, work down the port side, fitting 13 windows **22C**. Again, check that all the windows are securely fixed.

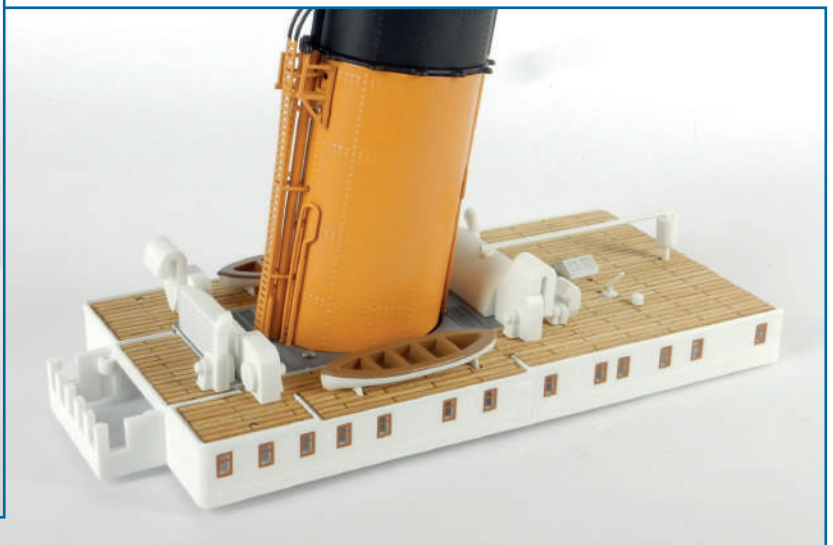
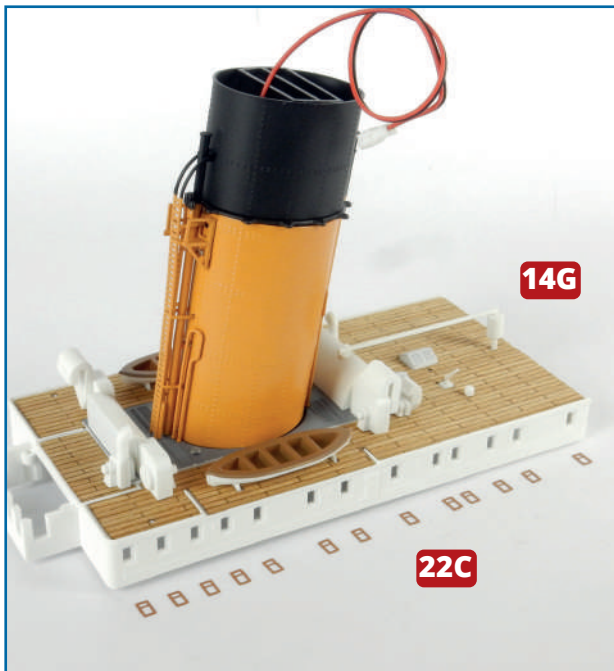

4 Cut sixteen of the arched windows **22B** from the frame and remove any burrs. Align 11 of them with the openings on the starboard side of the superstructure **16E**, around the stairwell and gym. With the superstructure propped up on its side, use a tiny bit of superglue, applied to the rim of the window openings, to fix them in place as shown.

NOTE: You may find it easier to complete these steps if you remove the stairwell dome and skylight and the pipe **19H**. Replace them when you have completed the work.

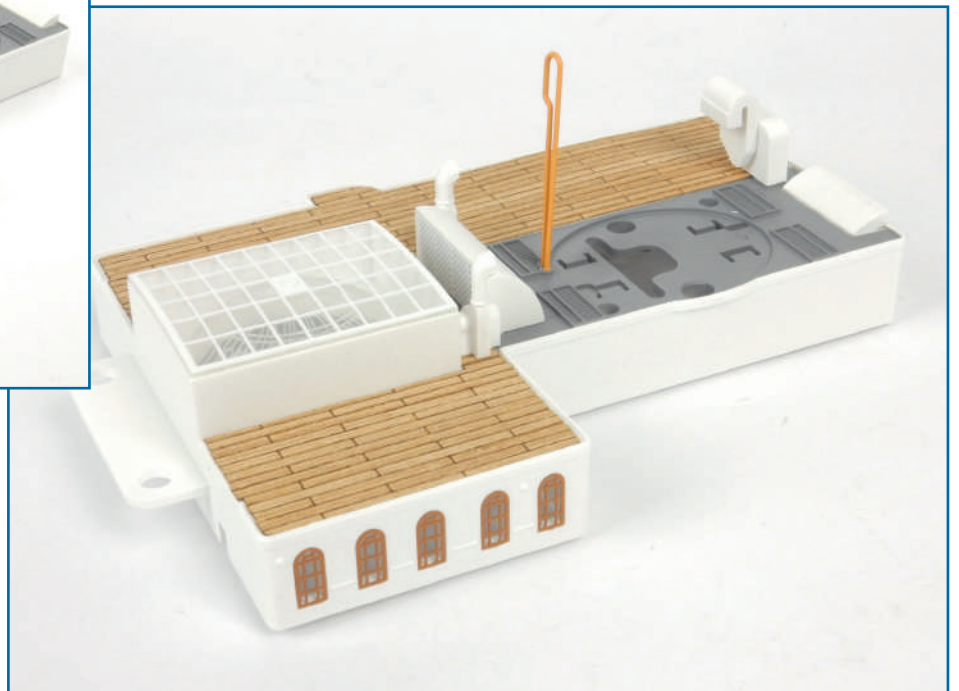
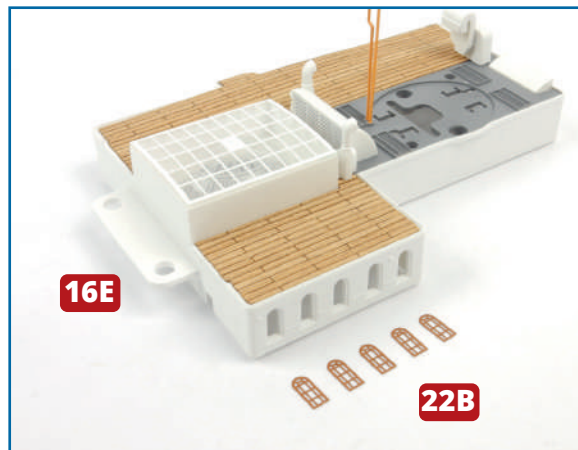
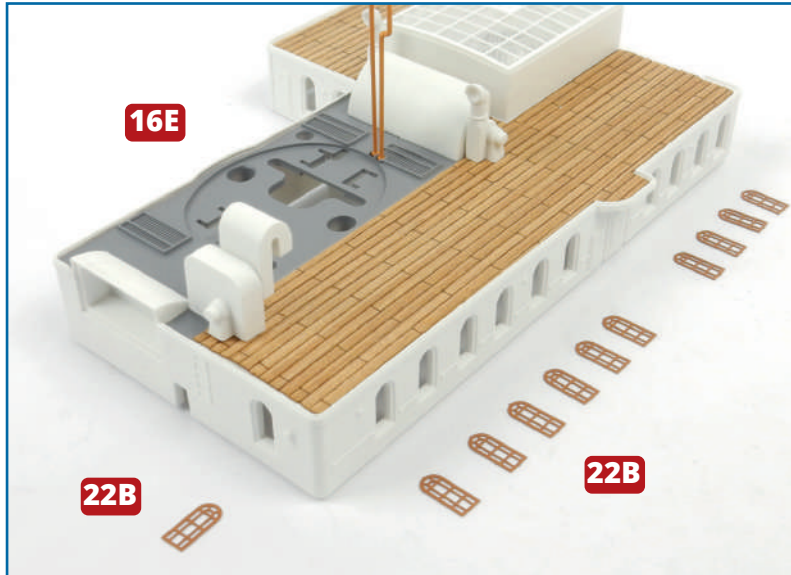
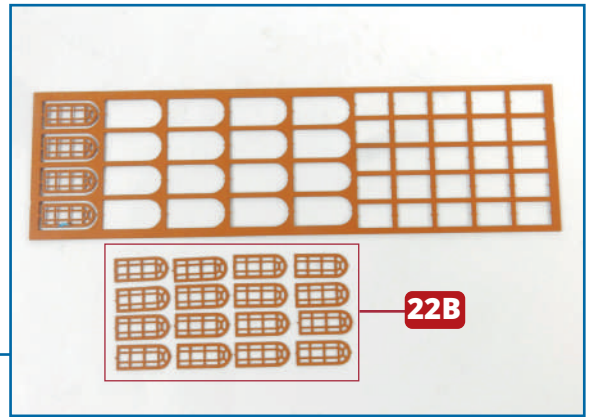

5 Allow the glue to dry and check that all the starboard windows are secure before continuing. The remaining five windows **22B** are fixed in place on the port side of the superstructure **16E**, along the side of the stairwell. Check they are securely fixed.



6 As described in issue 20, use the tester to check that the LED circuit board J2 (**22D**) is working (below). Unplug the LED circuit board and fit it to the underside of the superstructure **16E**: fit the LEDs into the holes (circled in red) then fit one side of the board under two of the tabs (circled in blue). Check that you have the LED circuit board the right way round, so that the ends fit inside the raised ribs on the underside of the superstructure.

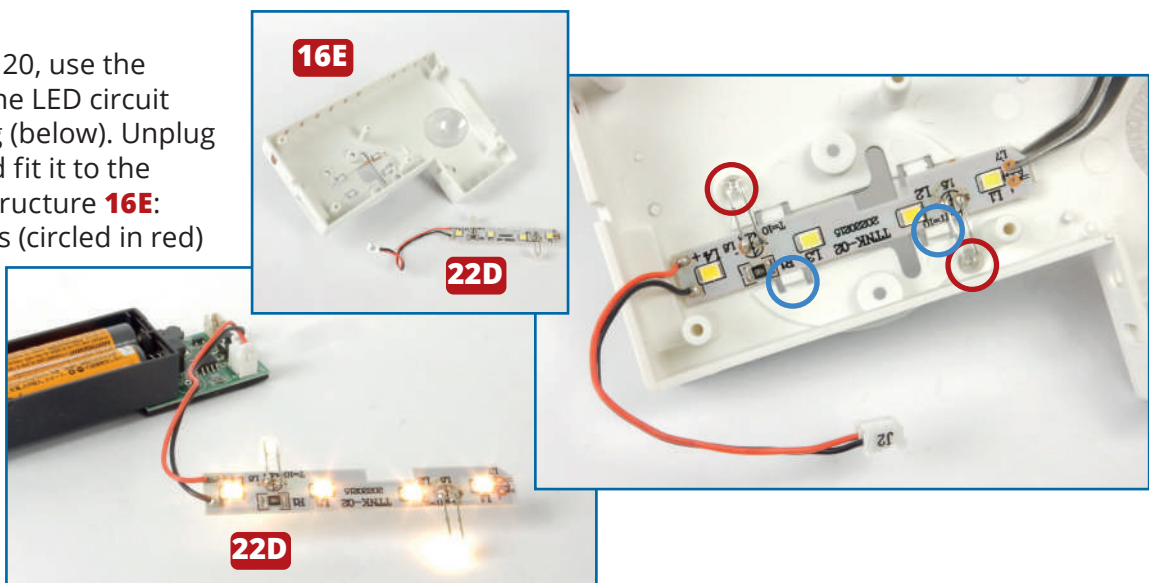

7 Turn the assembly over and use the head of a flat screwdriver to gently ease the circuit board over the other two tabs (circled in yellow) so that the circuit board is held in place.

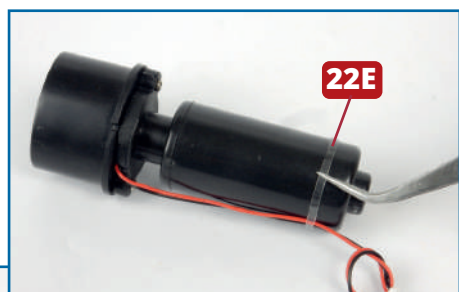
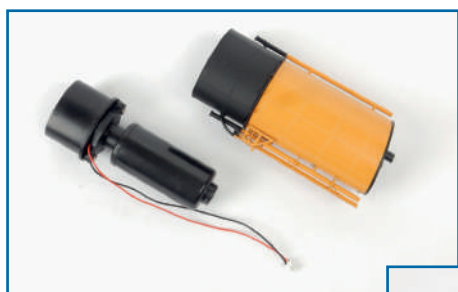
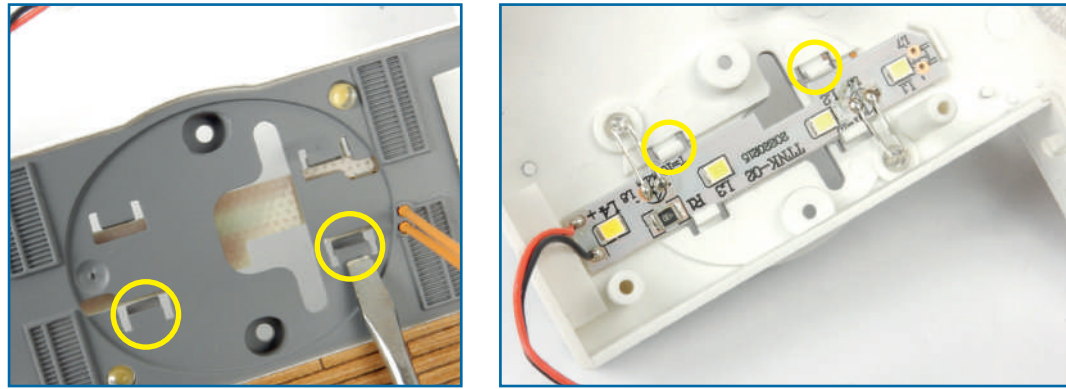

8 Take the tank assembly from issue 19 and the plastic band **22E**. Fit the band **22E** around the tank **17C** as shown left, so that the cable for the smoke generator cable is held in place. Take the cable extension K2 (**22A**) and

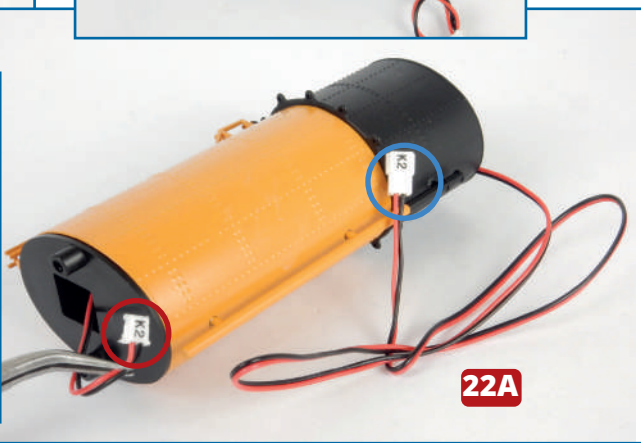
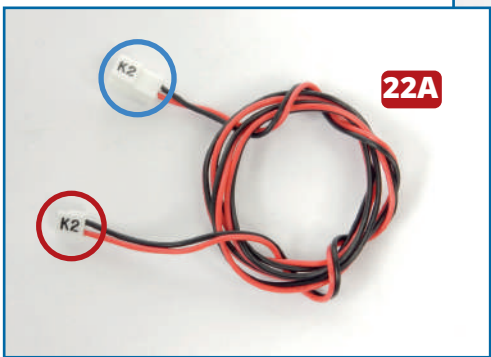

the funnel from issue 19. Thread the extension through the funnel so that the smaller connector (plug, circled in red) is at the base of the funnel and the larger connector socket (circled in blue) comes out of the top of the funnel.

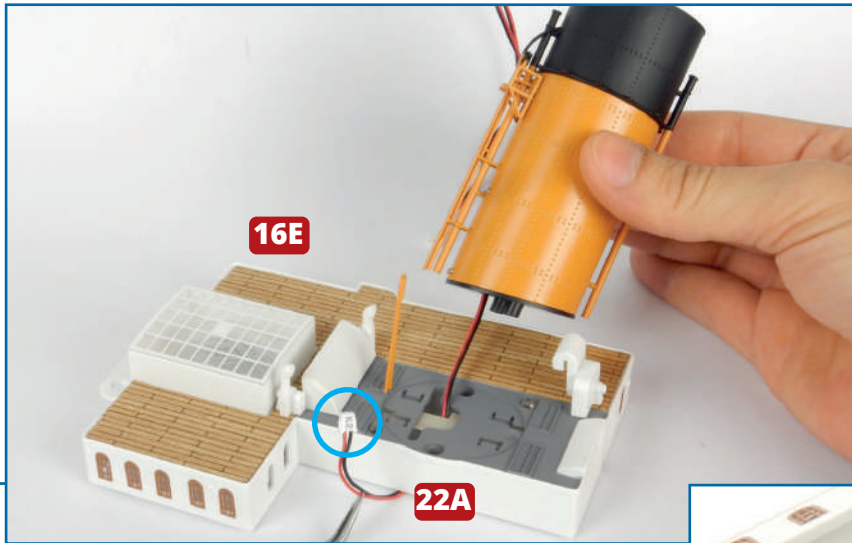

9 Thread the plug of the extension **22A** (circled in blue) through the larger hole in the superstructure for the stairwell, to the starboard side of the LED circuit board J2 (**22D**). Fit the funnel on the superstructure and fix it in place (below left) with two **AP** screws (below).

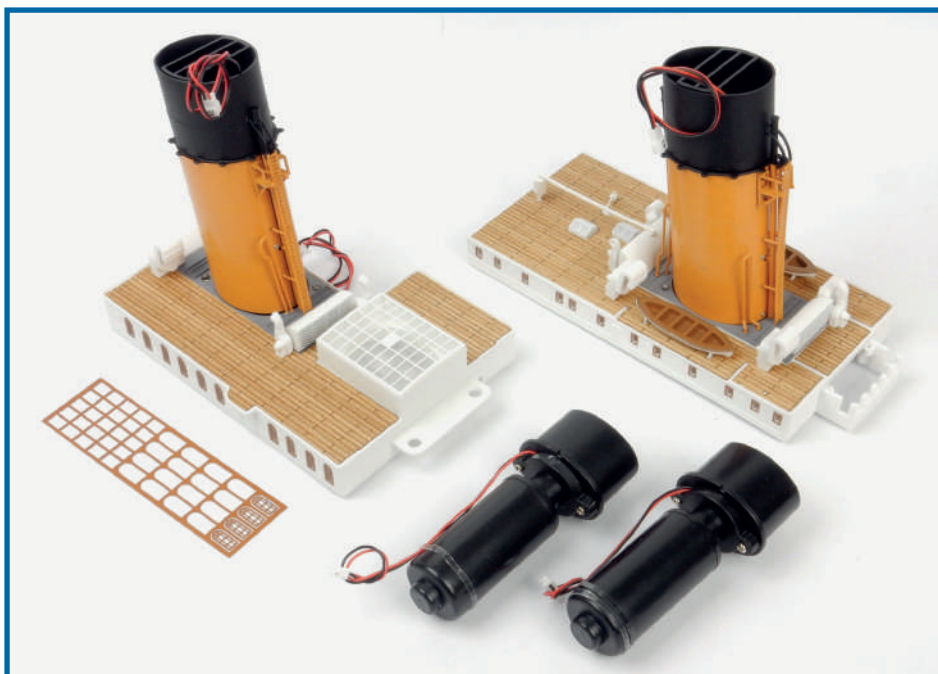
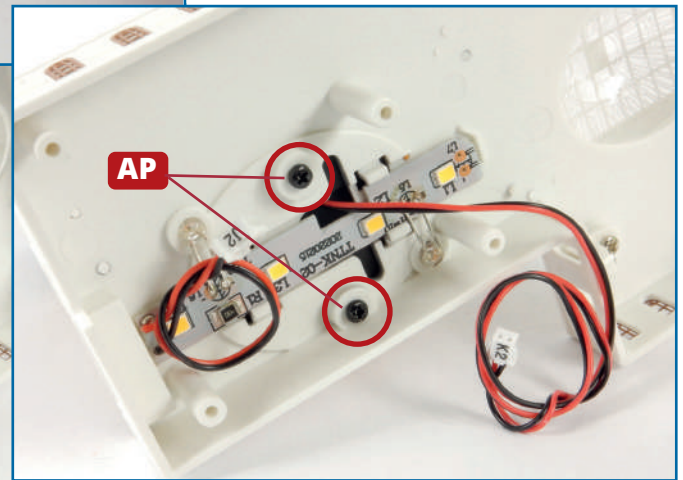
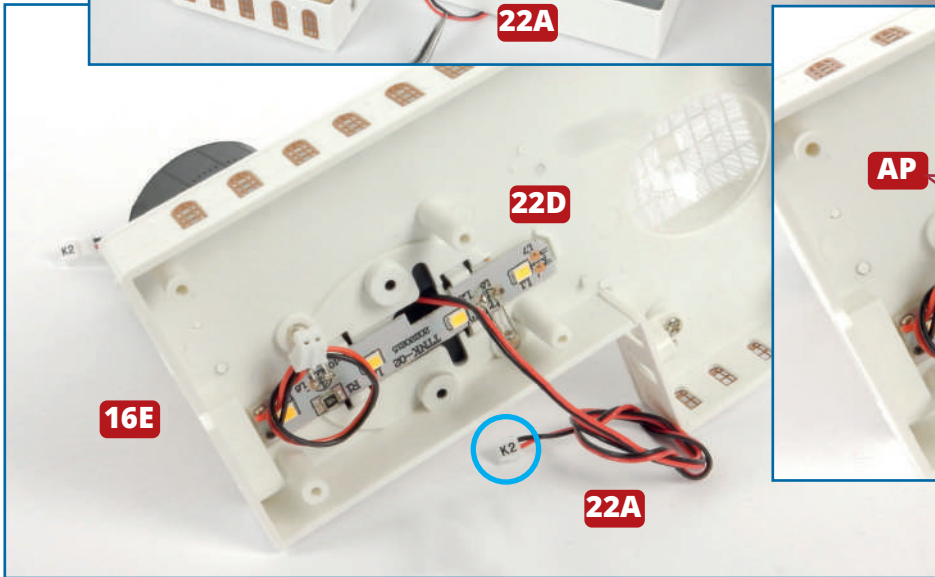

Completed work

Windows have been fitted to two superstructure sections. The second LED circuit board and the second funnel, with extension cable, have been fixed in place. Loosely knot the cables so they do not slip through the funnels. Store all the parts carefully. You do not need to insert the tanks in the funnels at this stage. The four windows on the frame **22B** will be used in a future issue.



FITTING THE ANCHOR WINCH

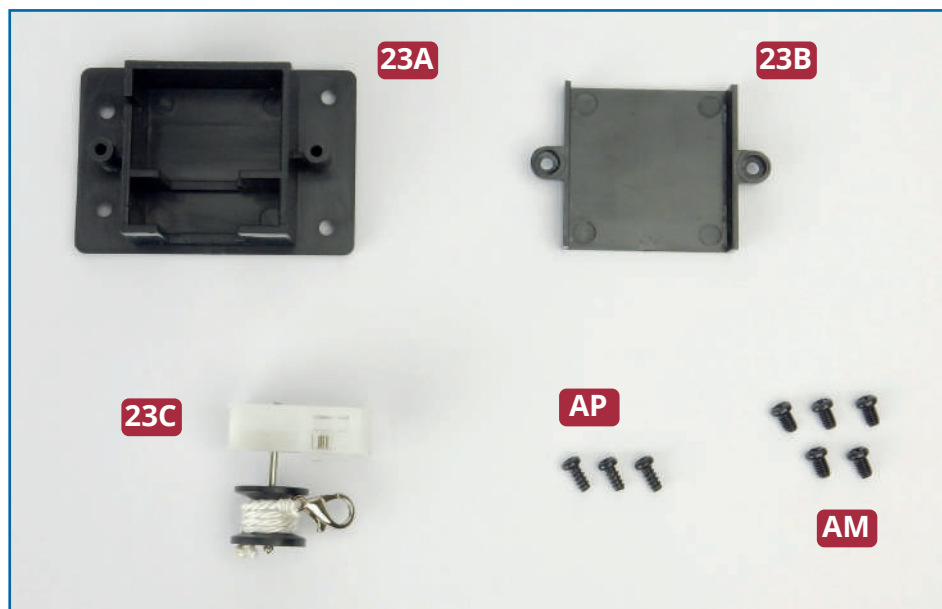

PARTS IN THIS ISSUE

23A Base for winch housing

23B Cover for winch housing

23C Anchor winch

AP Three 2.3 x 5mm
PB screws (1 spare)

AM Five 2.6 x 4mm
PM screws (1 spare)

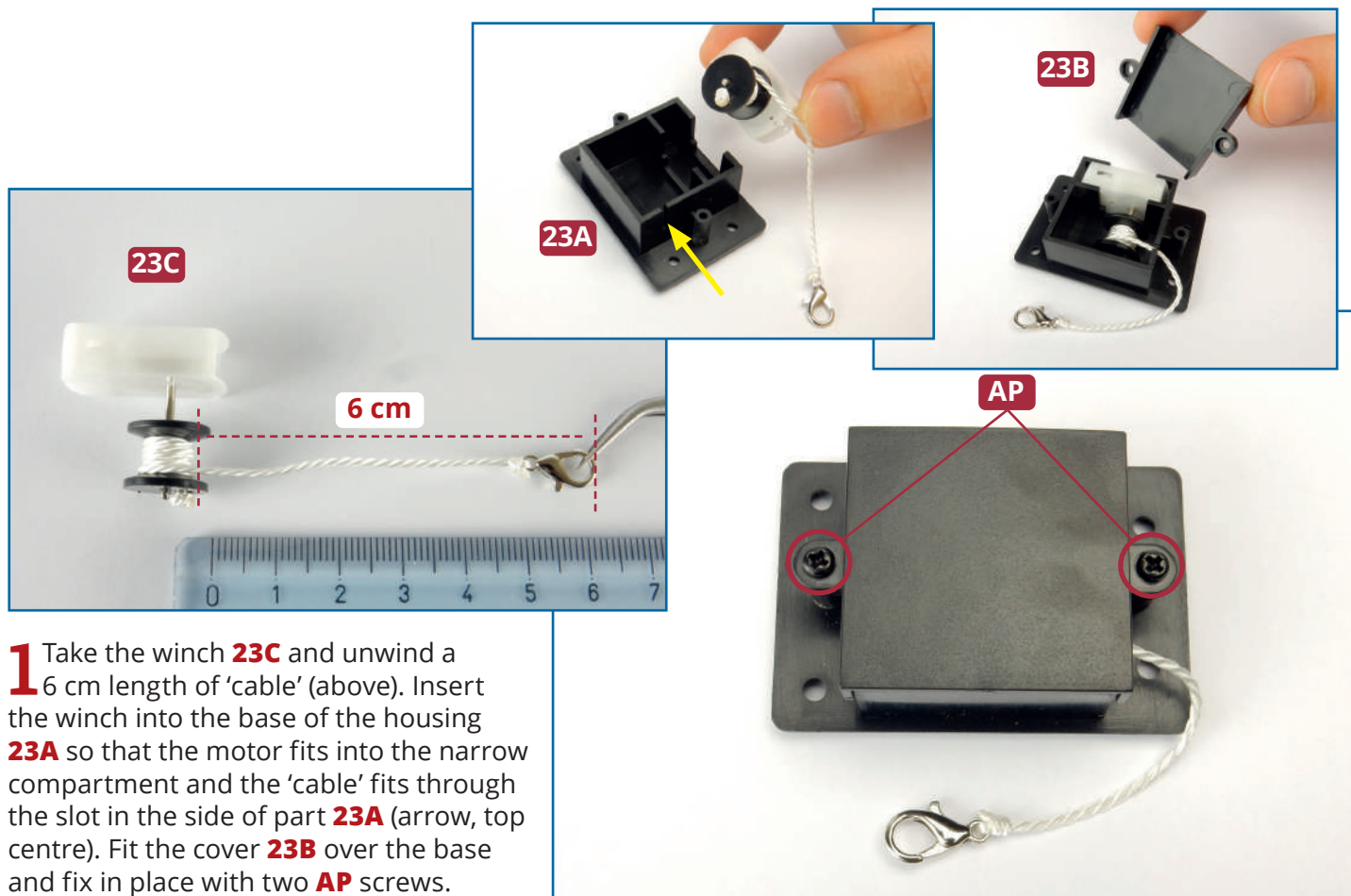

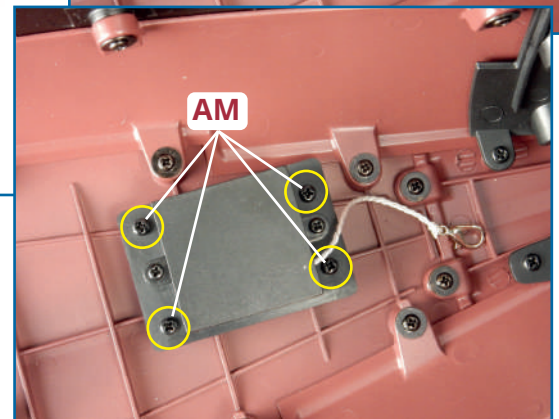
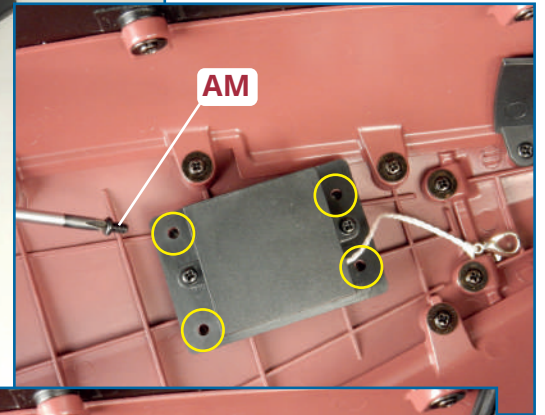
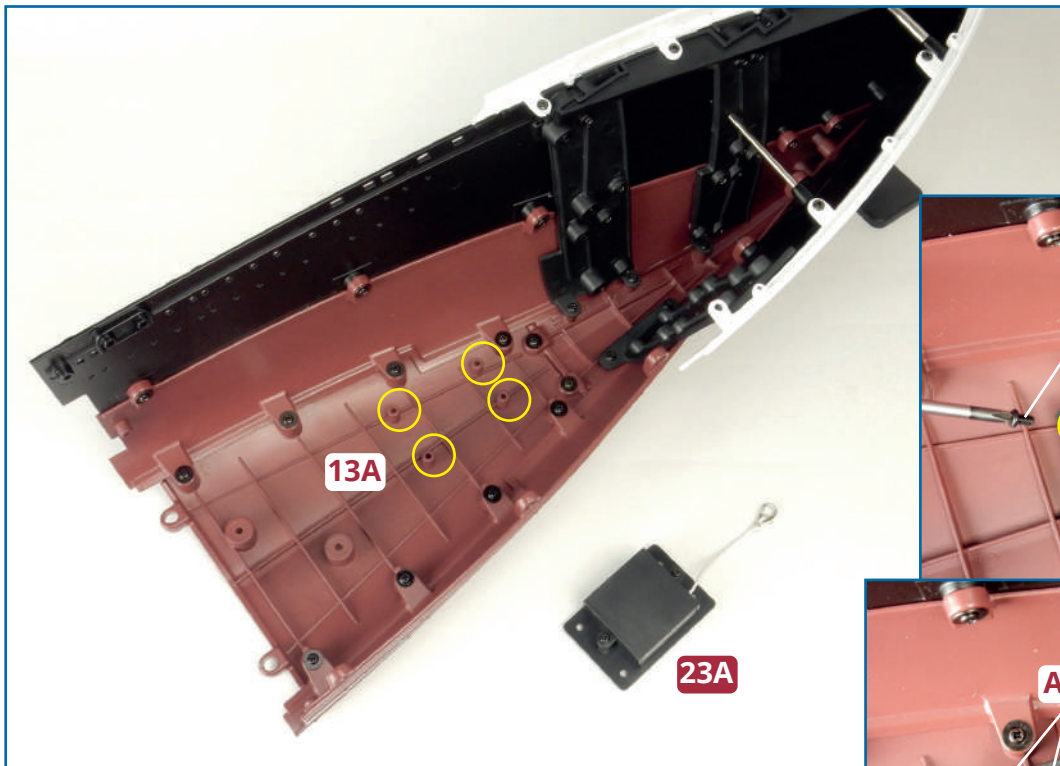

2 Take the hull assembly from issue 21. Identify the four raised screw sockets on part **13A** where the winch housing is fitted (yellow circles). Fit the winch housing in the hull so that the screw holes are aligned (yellow circles, top right). Fix the winch base in place with four **AM** screws (yellow circles, right).

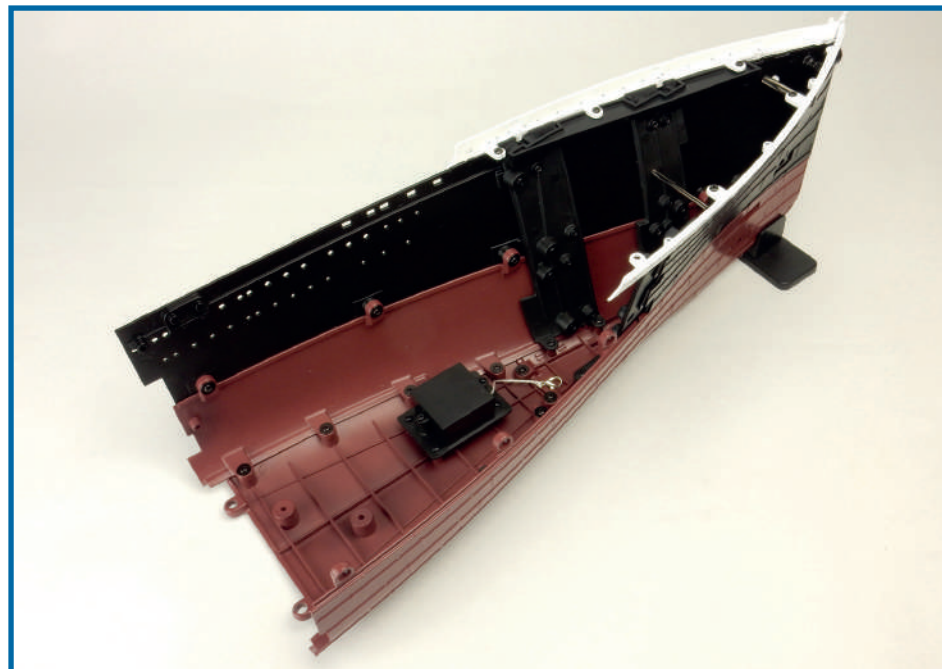

Completed work

The anchor winch has been fitted into the base of the hull.



ANCHOR FOR THE PORT SIDE

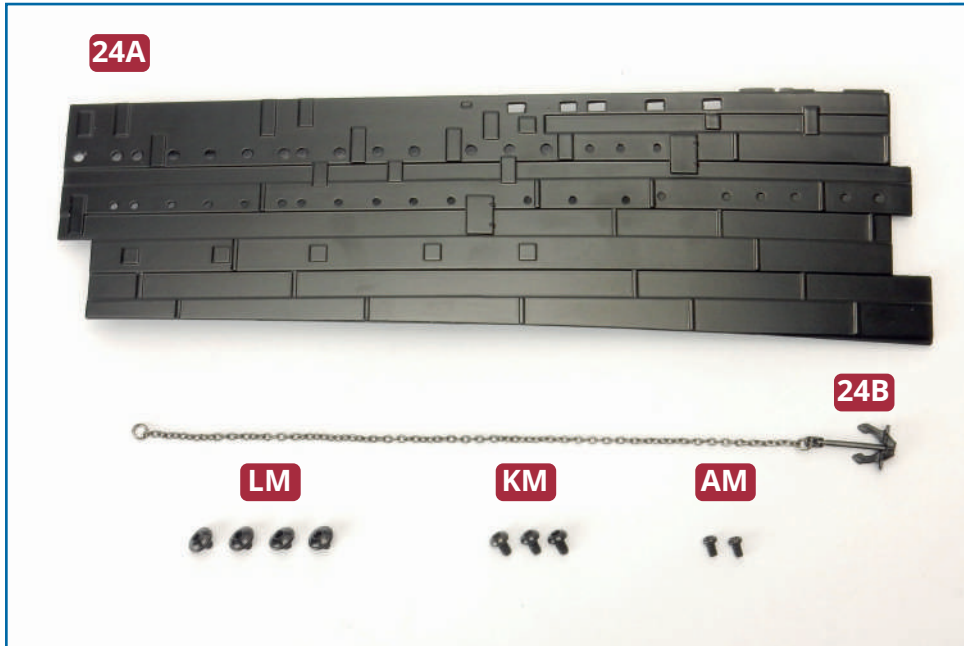

PARTS IN THIS ISSUE

24A Starboard section of the hull

24B Port anchor

LM Four 2.6 x 3mm PWM hex head screws (1 spare)

KM Three 2.6 x 3mm PM hex screws (1 spare)

AM Two 1.6 x 4mm PM screws (1 spare)

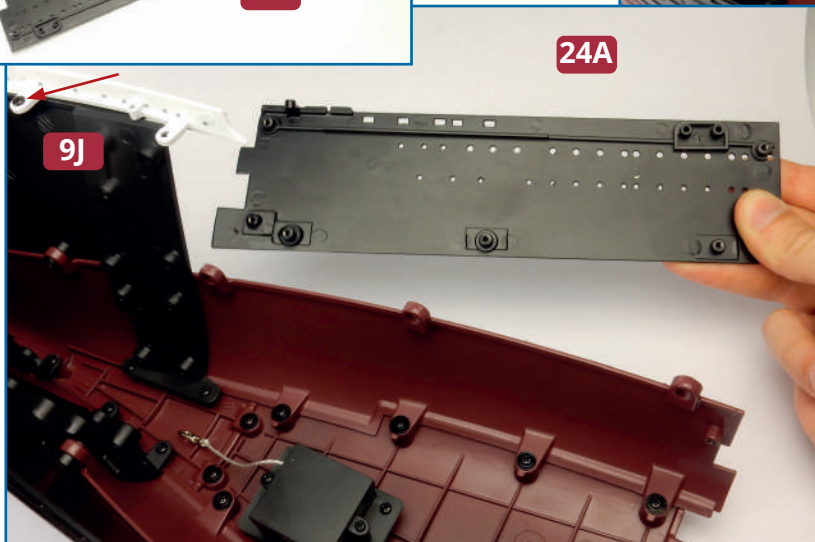
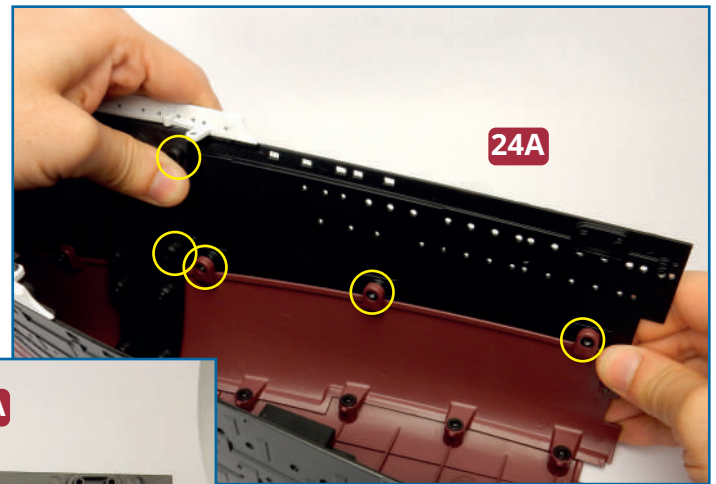
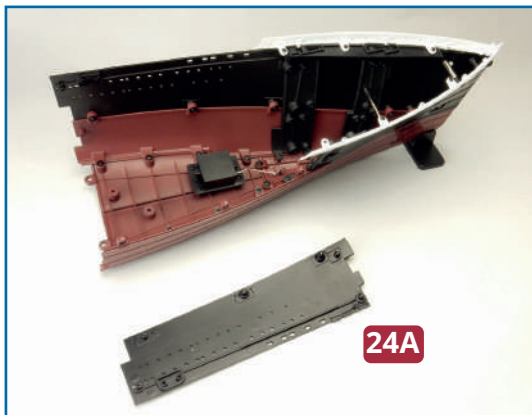

1 Take the hull assembly from the previous issue and check how hull section **24A** fits on the starboard side (left). You may find it helpful to loosen the screw holding the strip **9J** in place (red arrow). Tighten it again after fitting part **24A**. The raised screw sockets and screw holes should all be aligned (yellow circles, above).

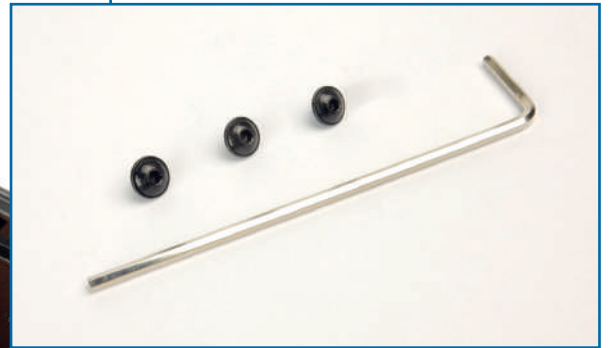
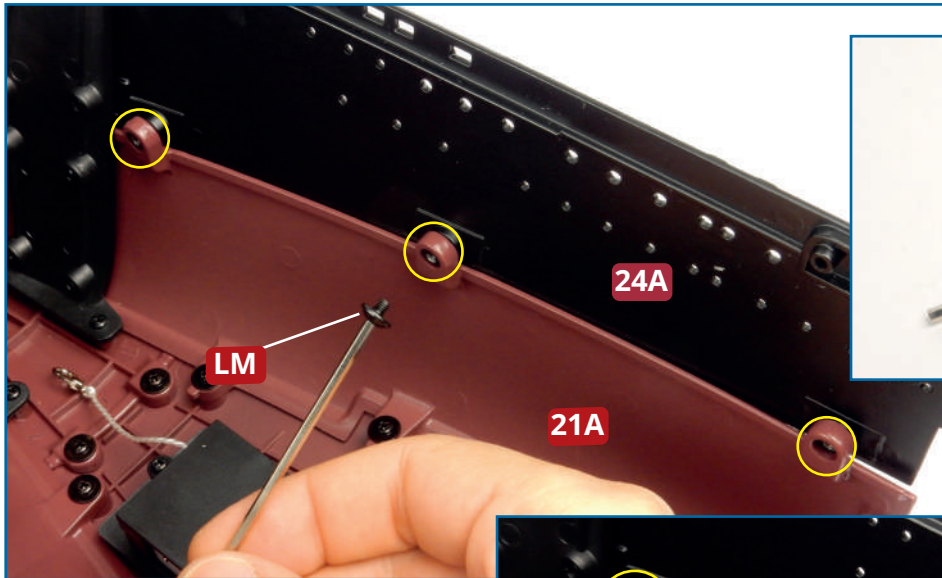

2 Fix hull section **24A** to hull section **21A** with three **LM** screws. Tighten them using the Allen key supplied with issue 15. You may find it helpful to lay the hull on its starboard side, on a surface protected by a soft cloth.

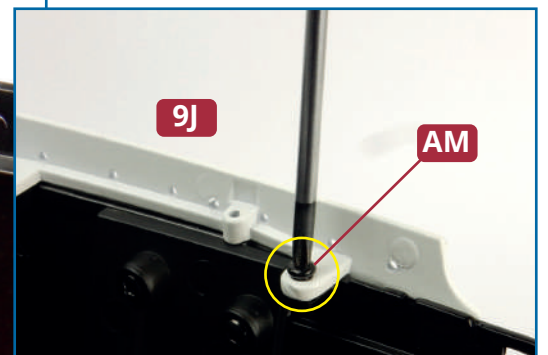
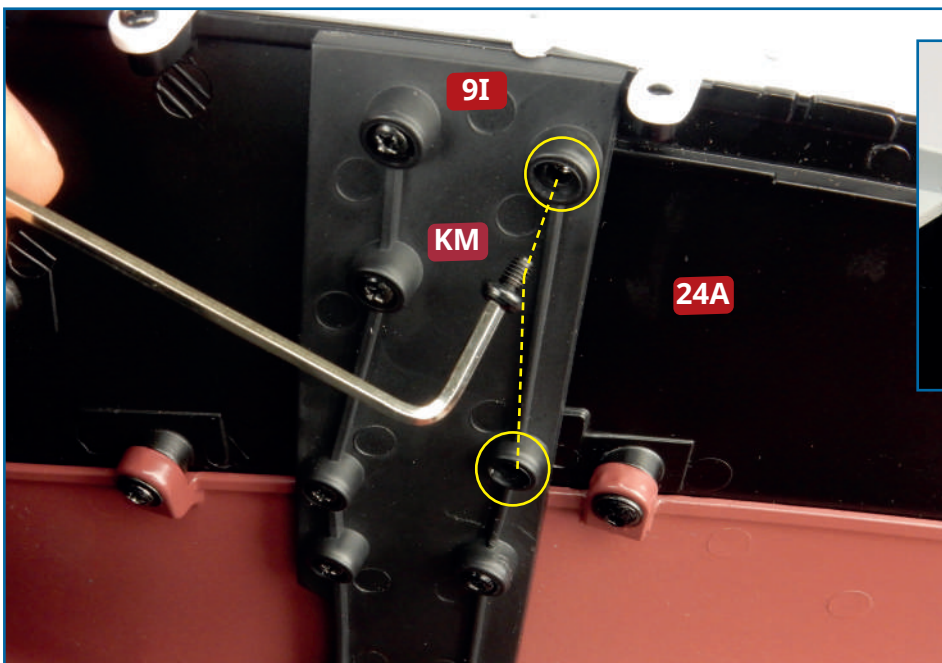
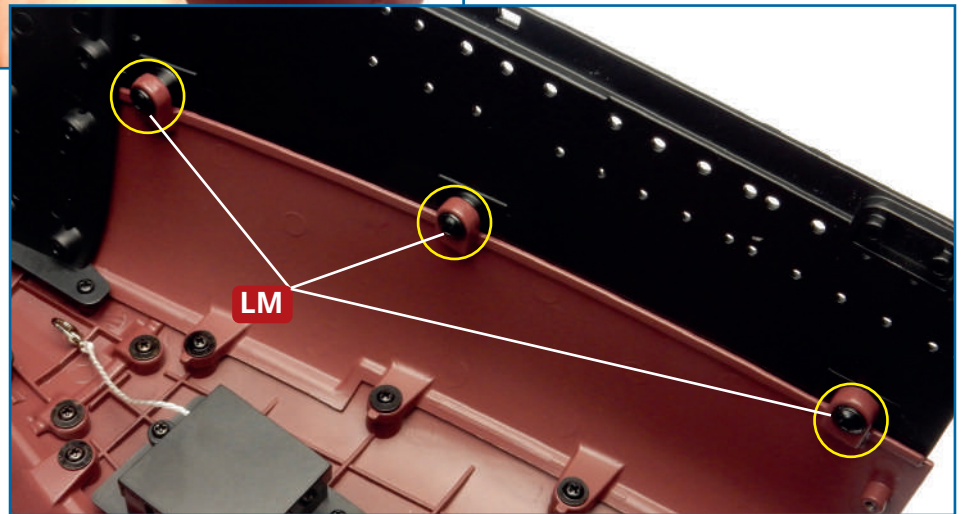

3 Fix hull section **24A** to connector **9I** with two **KM** screws (left, circled in yellow). Again, this is easier if the hull is on its side. Fix the starboard forecastle bulwark strip **9J** to part **24A** with an **AM** screw (above).

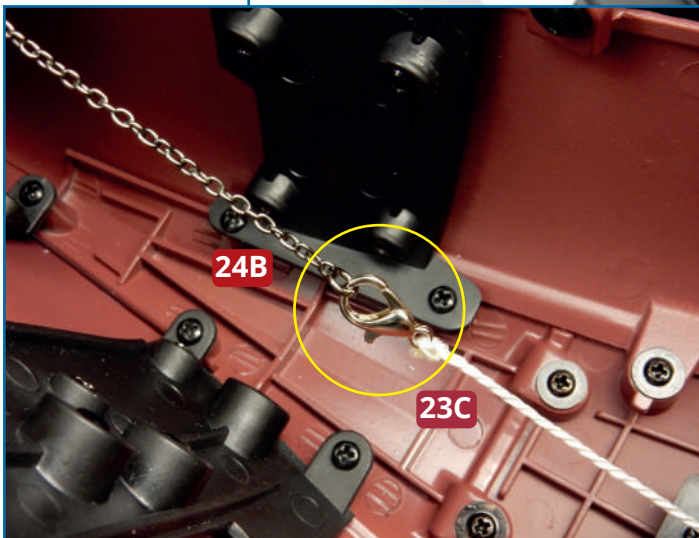
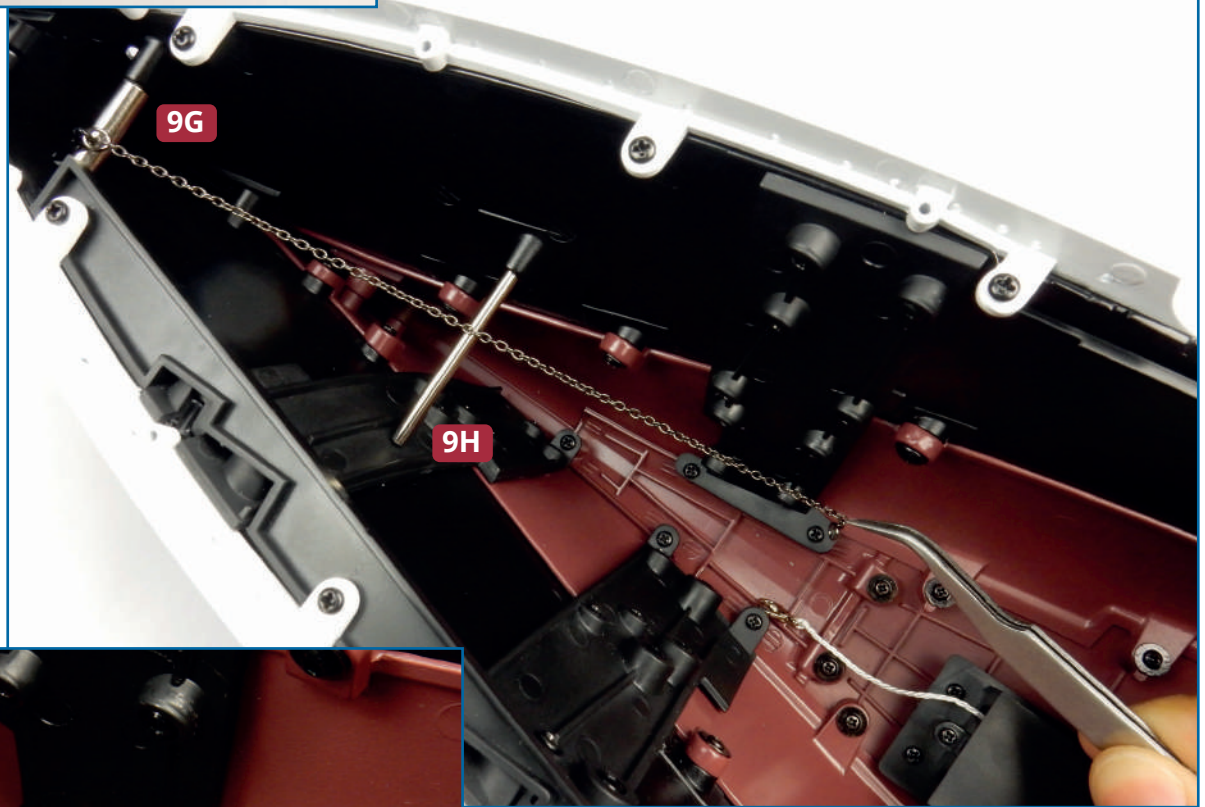
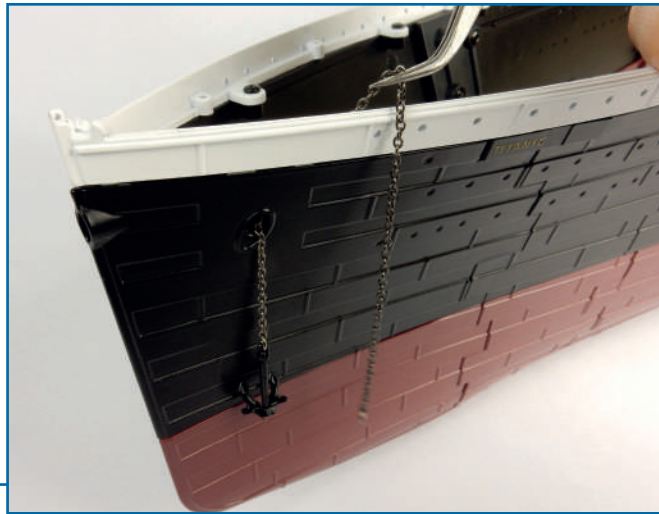
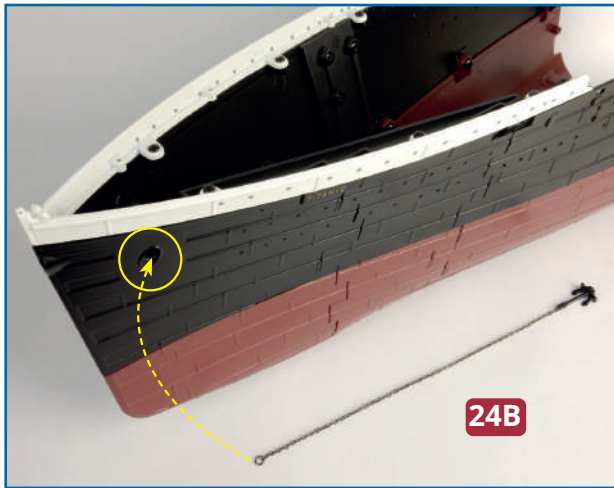

4 Take the anchor **24B** and thread the end of the chain through the hawse hole on the port bow. Using tweezers, draw the chain over the two spacers **9G** and **9H** (above), then fit the catch on the end of the winch 'cable' **23C** to the ring on the end of the anchor chain **24B**.

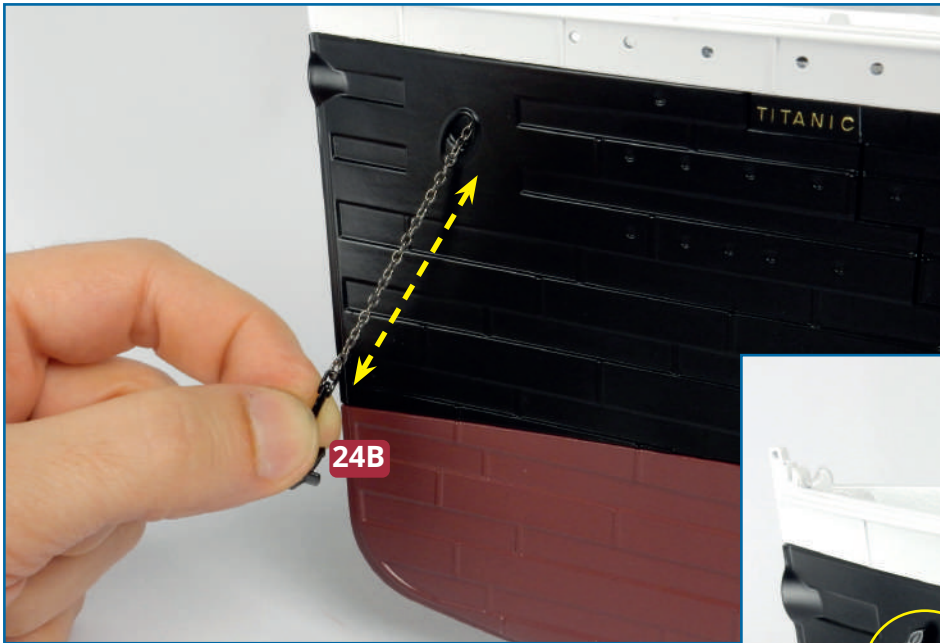

5 Take hold of the anchor **24B** and pull it down gently. When you let go, the winch will pull the anchor back up to the hawse hole (right).

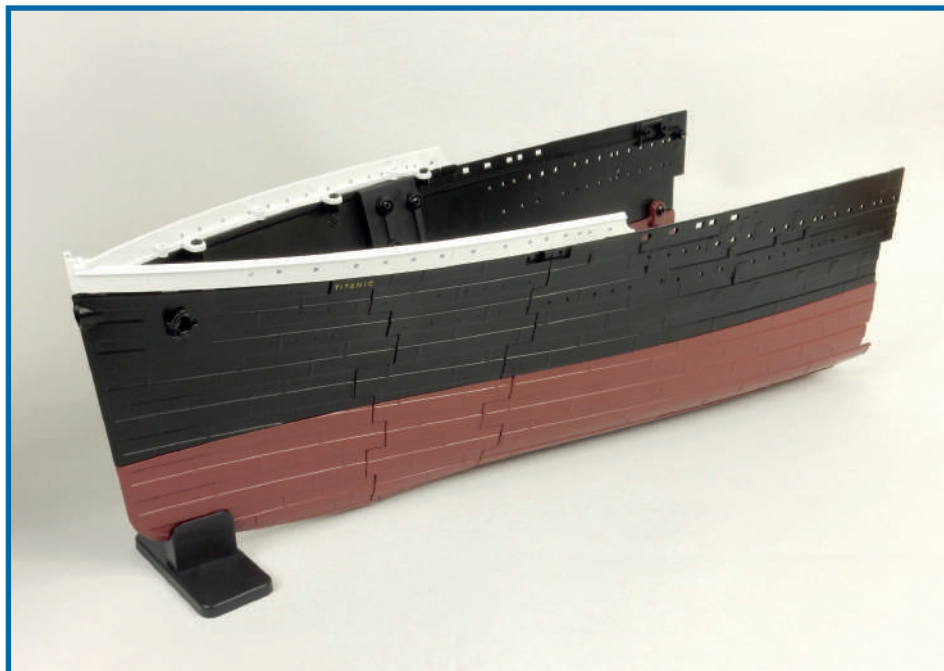

Completed work

Another section has been added to the hull and the port anchor has been fitted.



WELL DECK FORWARD BULKHEAD

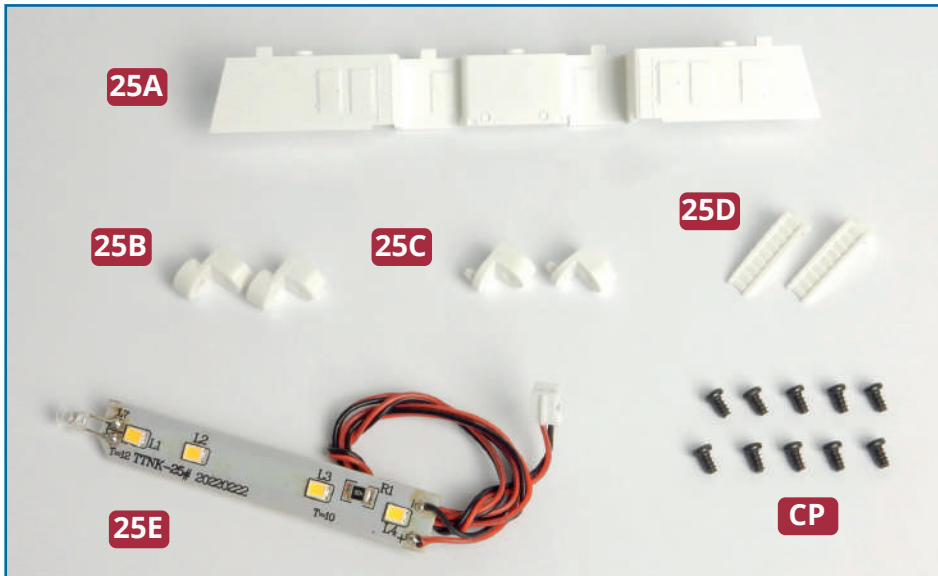

PARTS IN THIS ISSUE

- 25A** Well deck forward bulkhead (front wall)

- 25B** Connectors A (x 2)

- 25C** Connectors B (x 2)

- 25D** Deck ladders (x 2)

- 25E** LED strip P

- CP** Ten 2.3 x 4mm PB screws (1 spare)

TIP: Cover your work surface with a protective layer to ensure you do not damage the features on the decks (see steps 2 to 5).

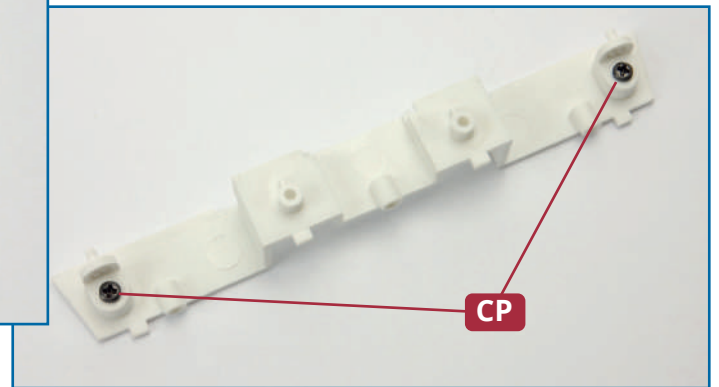
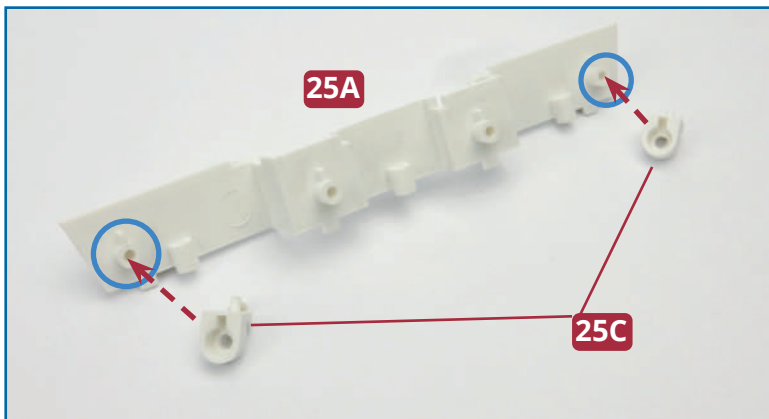

1 Take the well deck bulkhead **25A** and fit two connectors **25C** (marked B) over the raised screw sockets at the ends of the bulkhead (circled in blue). Note that there are tabs beside the screw sockets to ensure that the connectors are fitted the right way up. Fix them in place with two **CP** screws (above

right). Similarly, fit the two connectors **25B** (marked A) over the raised screw sockets near the centre of the bulkhead (red circles, below left) and fix them with two more **CP** screws (below).

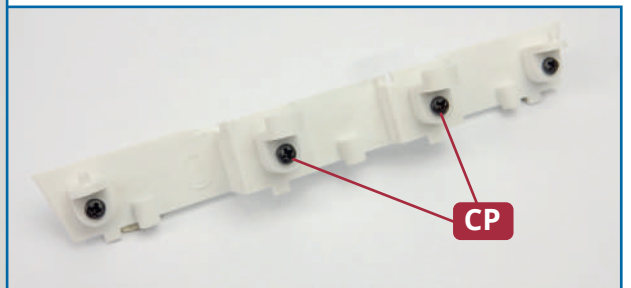
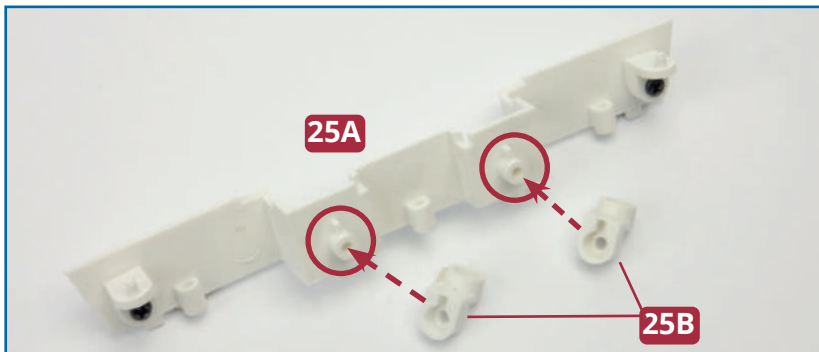

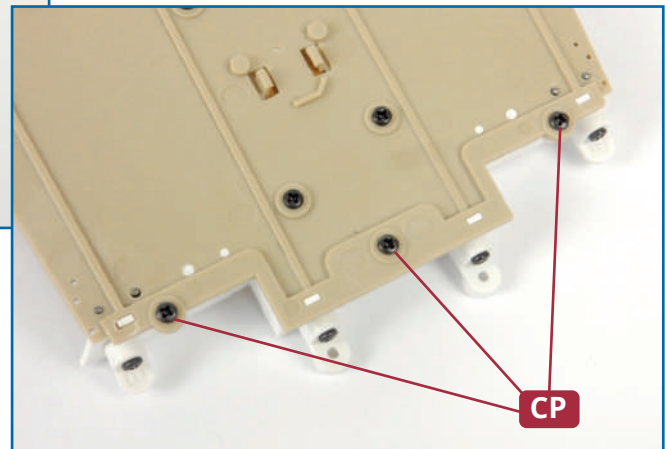
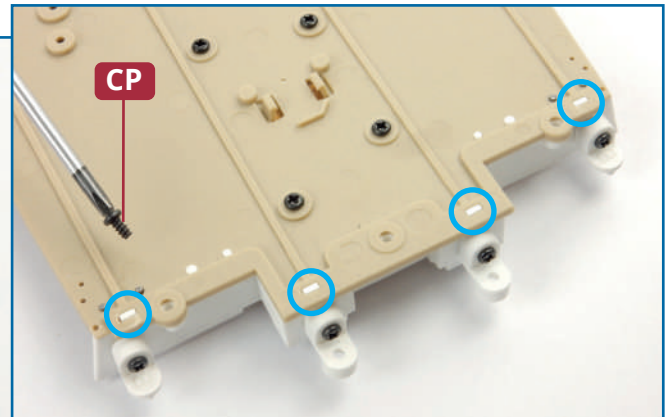
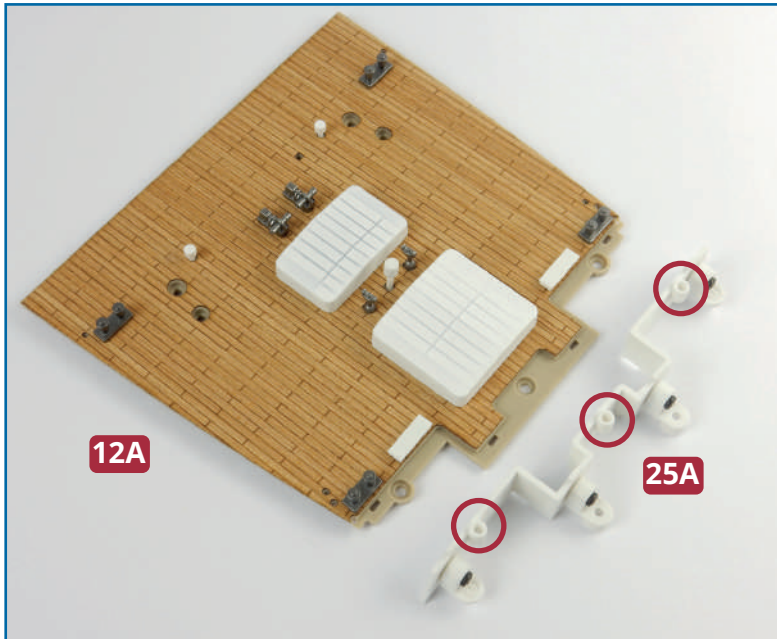

2 Take the forward well deck assembly from issue 21 and the bulkhead **25A**. Identify the three fixing points for the deck (circled in red, above). Turn the deck **12A** over and position it on the bulkhead so that the screw holes are aligned. At the same time, small tabs on the wall have to be fitted into slots in the deck (circled in blue, top right). Fix the wall in place with three **CP** screws (right).

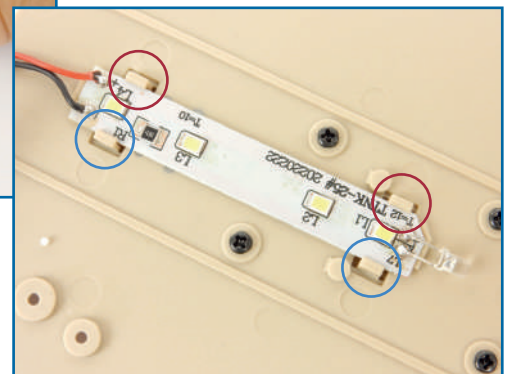
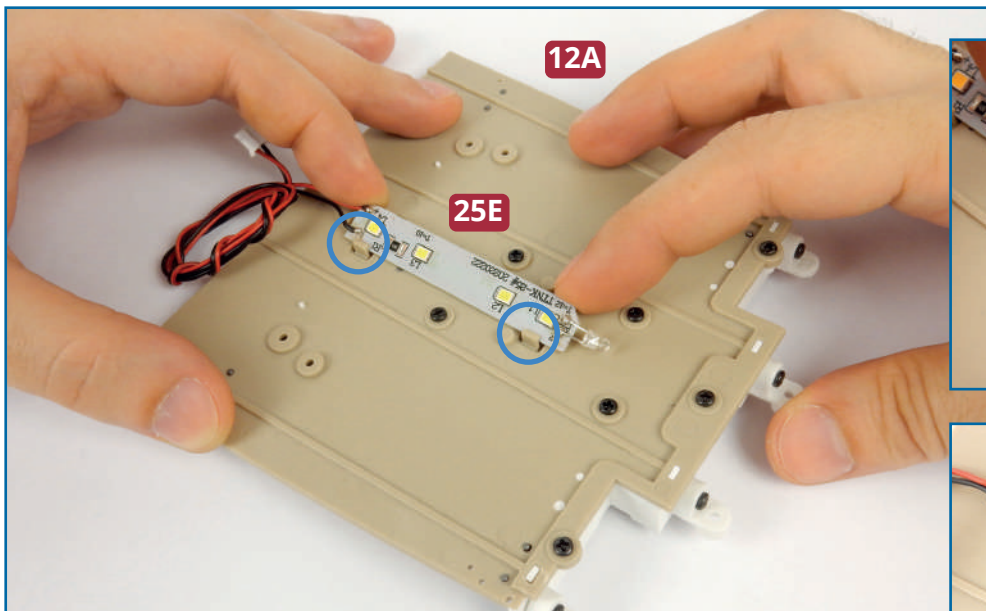

3 Fit the LED strip P **25E** under the two tabs on the underside of the deck **12A** (circled in blue). Use the head of a flat screwdriver to gently ease up the other two tabs (circled in red, top right), to hold the LED strip **25E** in place (right).

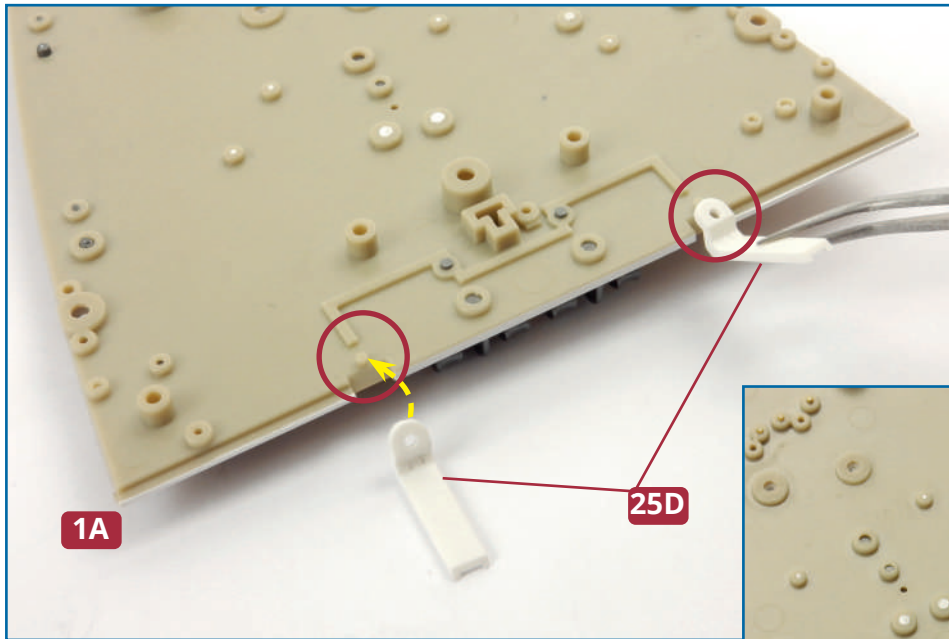

4 Take the forecastle deck assembly from issue 21. Turn the deck **1A** over and fix the two deck ladders **25D** at the points indicated by the red circles. Pegs on the underside of the deck fit into holes in the tabs on the ladders.

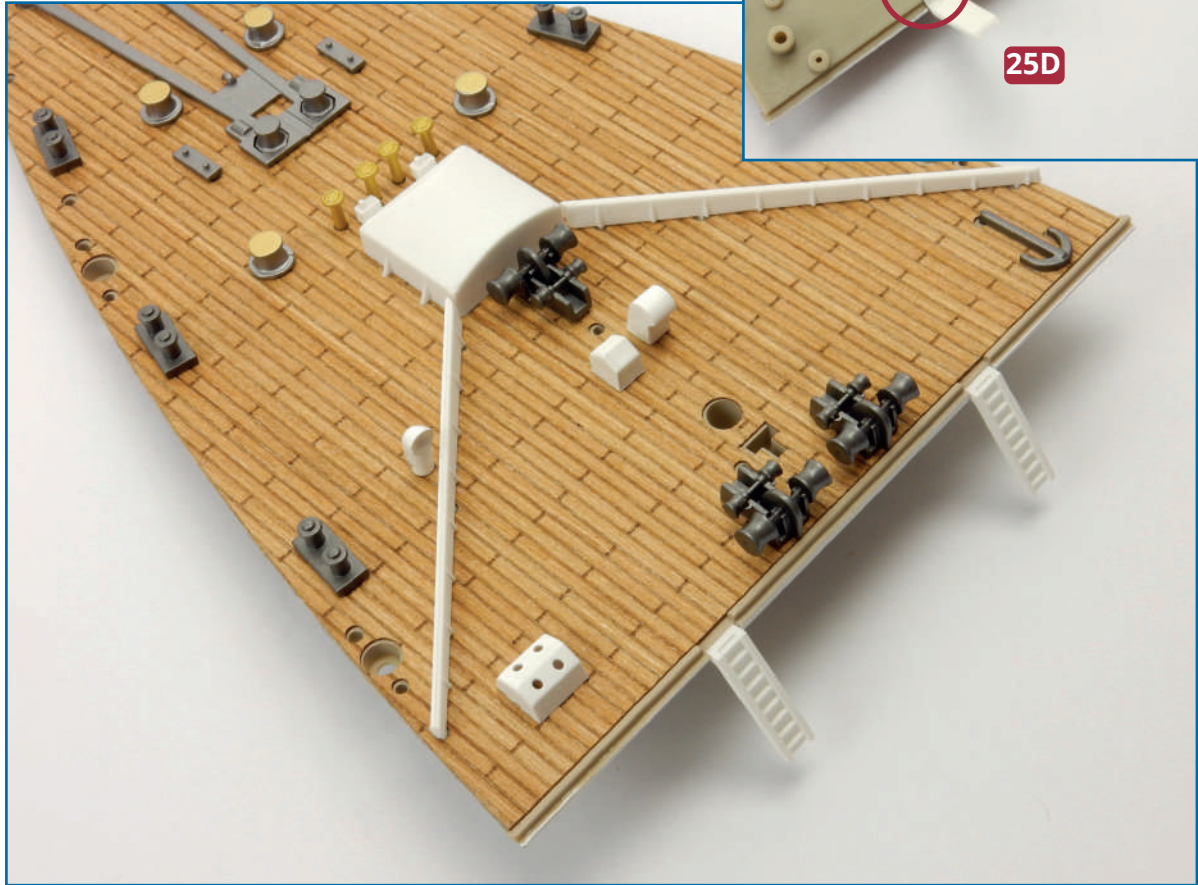
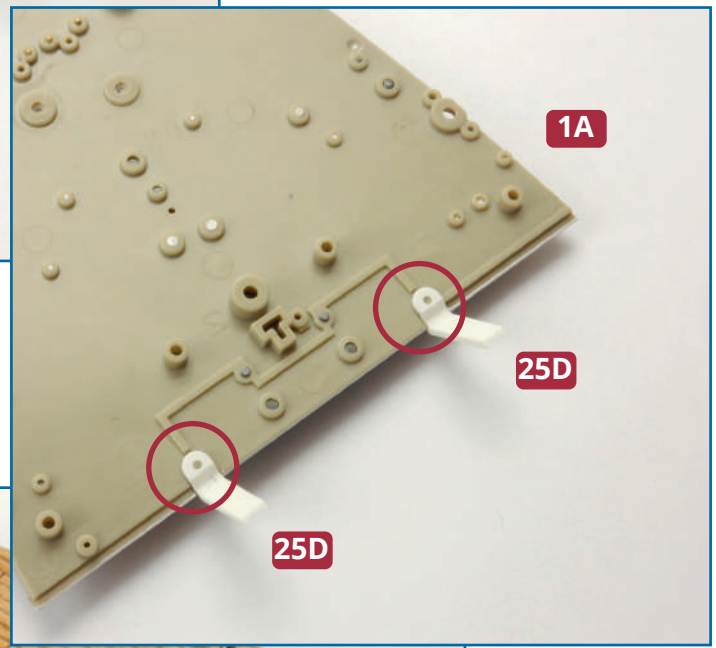

★ STEP-BY-STEP INSTRUCTIONS ★

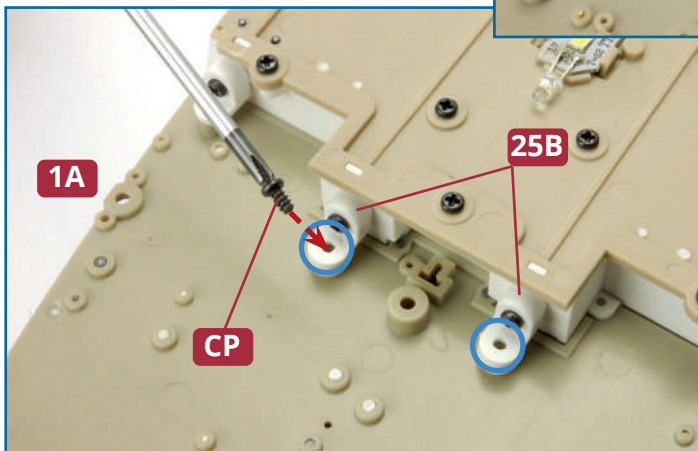
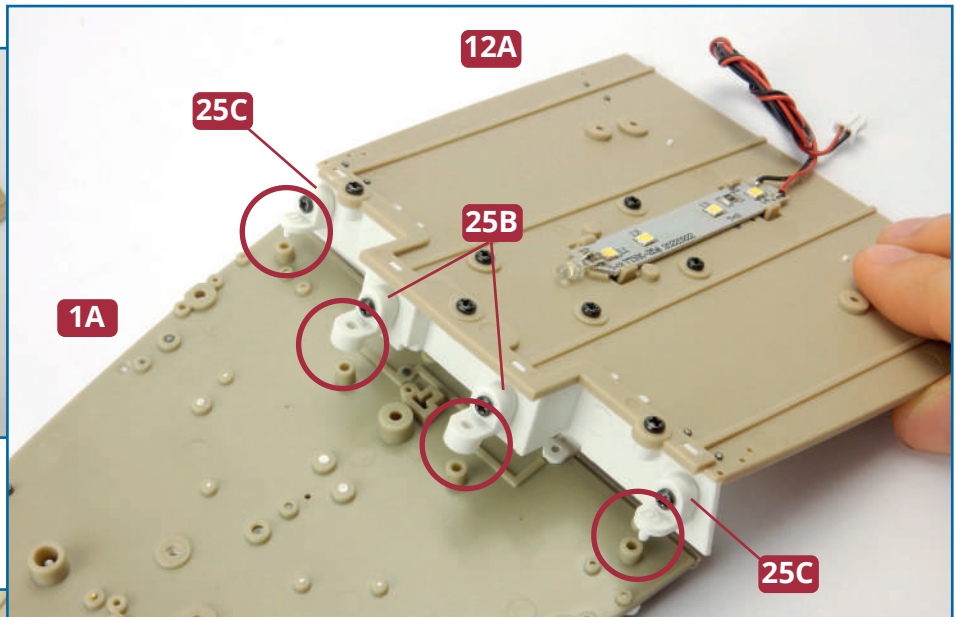
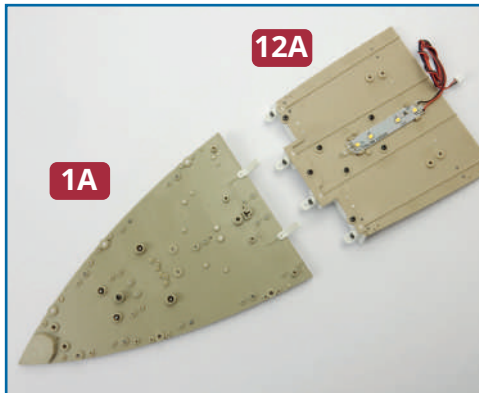

5 Place the forecastle deck **1A** upside down on your work surface. Take the well deck **12A** and position it so that the connectors **25B** and **25C** on the wall match the fixing points on the underside of the forecastle deck. Pegs on connectors **25C** fit into sockets on deck **1A**; the sockets on connectors **25B** fit over raised screw sockets on deck **1A**. Fix the connectors **25B** to deck **1A** with two **CP** screws (circled in blue, left).

Completed work

The first two deck sections have been joined together, with a bulkhead and deck ladders connecting them.

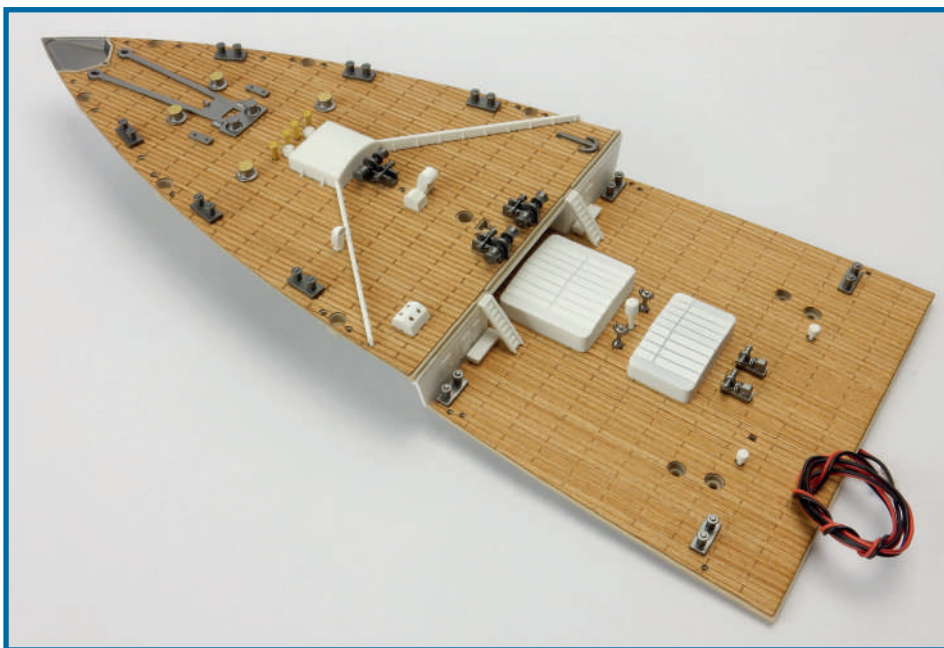



THE DECK OF THE ENGINE ROOM

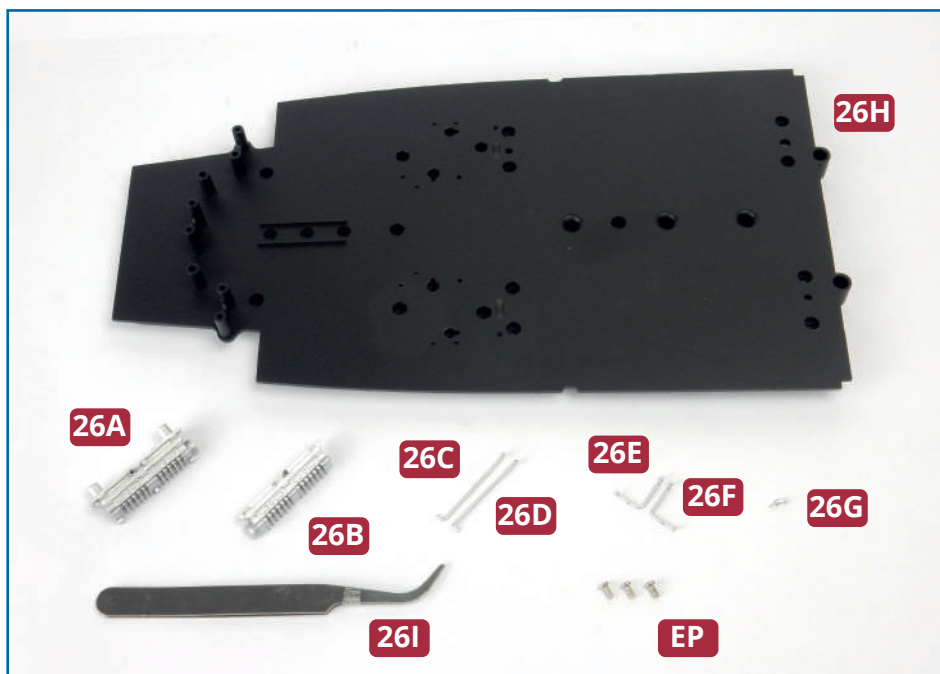

PARTS IN THIS ISSUE

- 26A** Thrust block (A)
- 26B** Thrust block (B)
- 26C** Pipe for port side
- 26D** Pipe for starboard side
- 26E** Short pipe for port side
- 26F** Short pipe for the starboard side
- 26G** Elbow pipe
- 26H** Deck for engine room
- 26I** Tweezers
- EP** Three 2 x 4mm PB screws (1 spare)

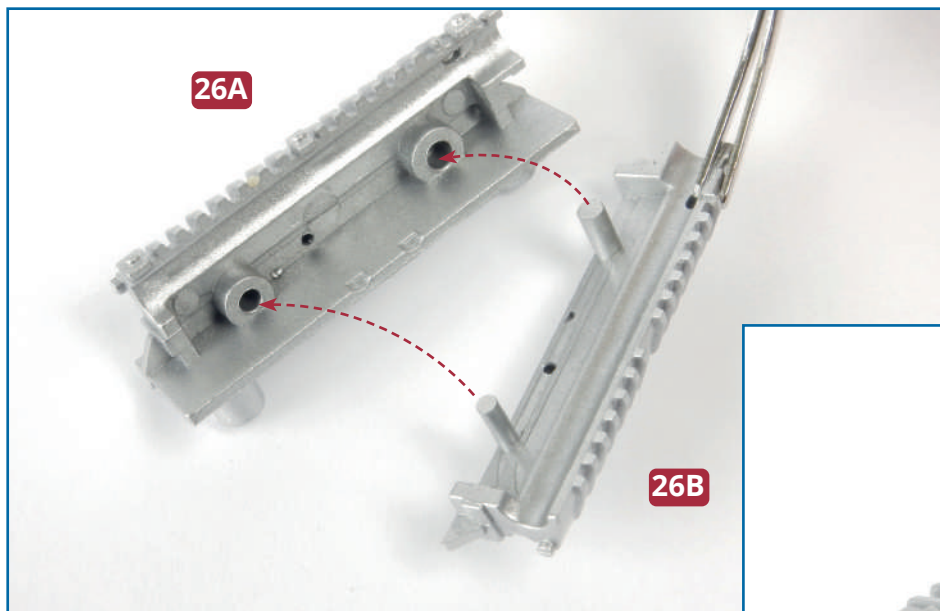

1 Take the two parts of the thrust block, **26A** and **26B**. Fit them together: pegs in part **26B** fit into holes in part **26A**, as indicated. This is a push fit connection.



2 Take the four lengths of pipe and arrange them as shown, so that the port sections **26C** and **26E** and the starboard sections **26D** and **26F** can be connected. Fit the pegs on parts **26E** and **26F** into the sockets in the ends of parts **26C** and **26D**. When you are happy with the fit (see also the following step) fix the pegs in place using a very small amount of superglue.

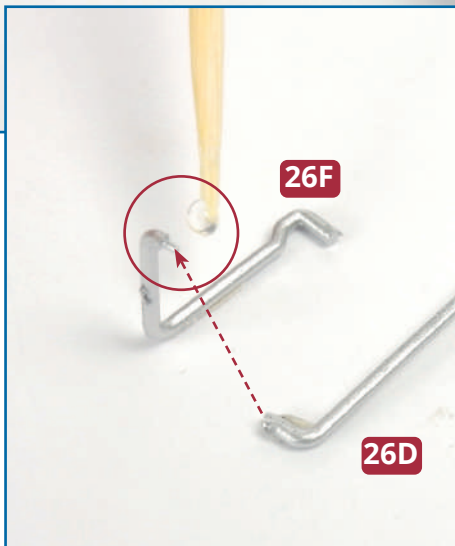
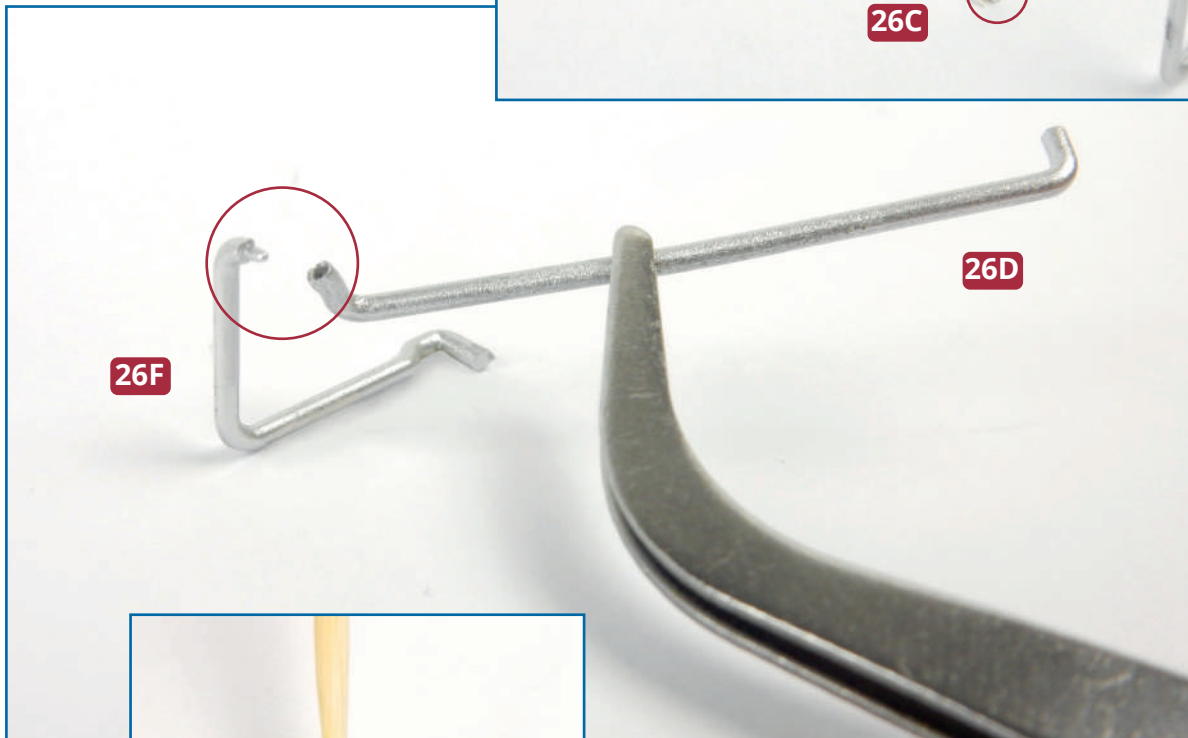
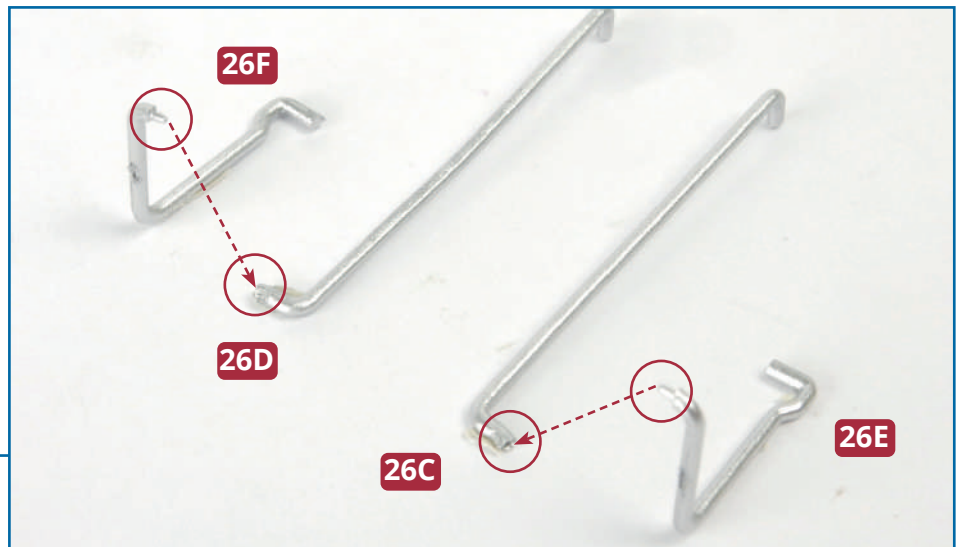

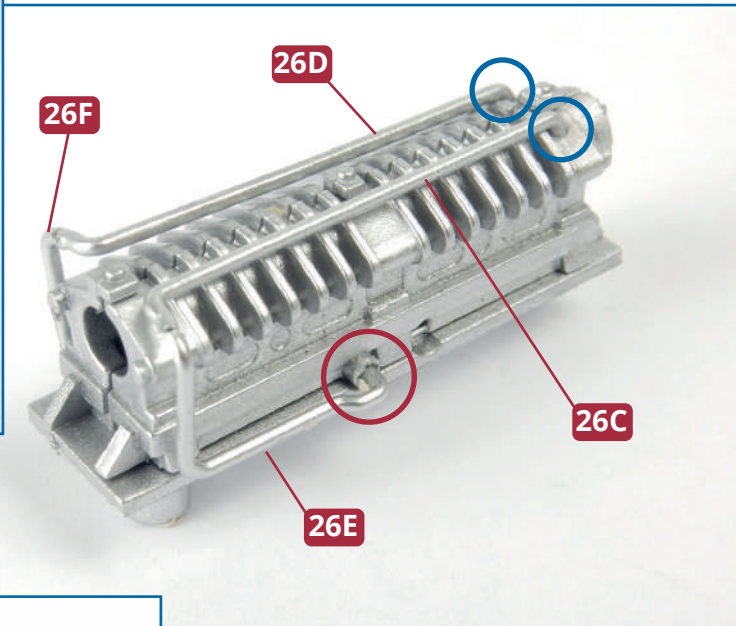
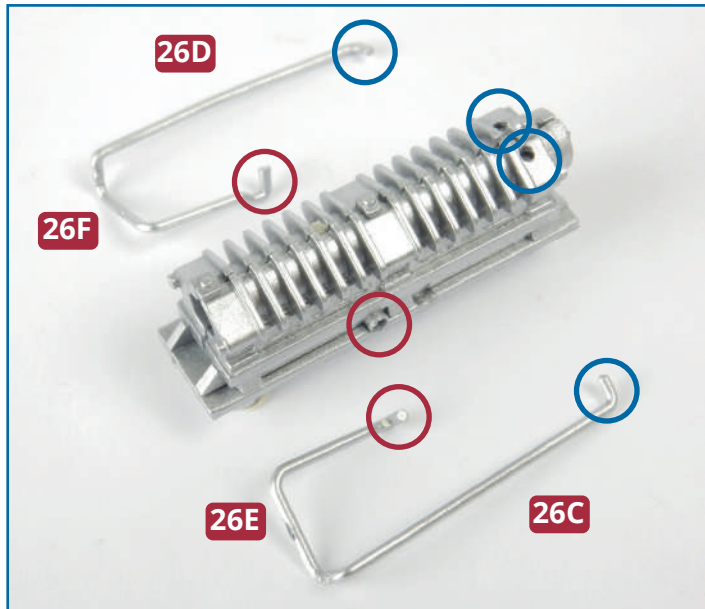

3 The pipe assemblies have to be fitted to the thrust block. Note the orientation of the block: in this view (top left), the front of the block is on the left. The ends of the pipes **26E** and **26C** are fitted to the port side of the thrust block (red and blue circles). The port pipe assembly is fitted in the same way on the other side of the thrust block (above). Fit the flat tab on the elbow pipe **26G** into the hole in the side of the thrust block (circled in yellow, left). If necessary, fix the parts in place with a very small drop of superglue.

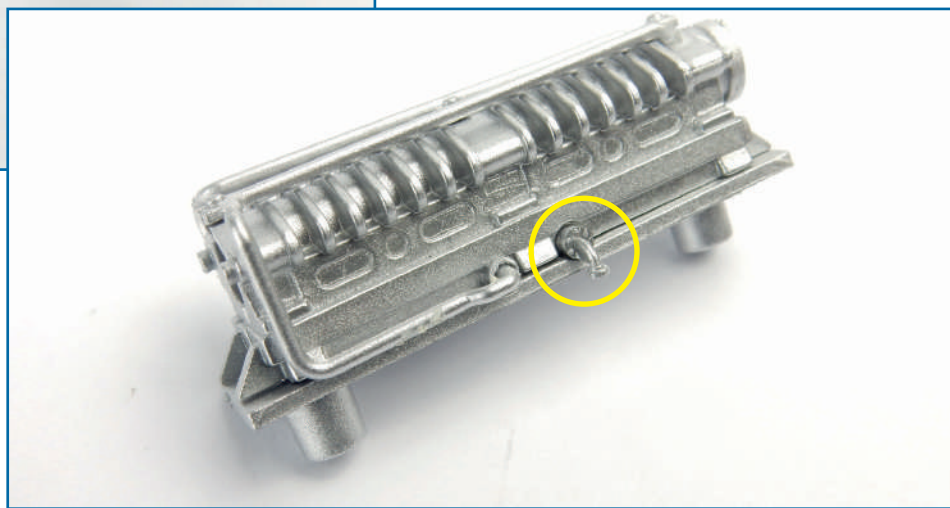

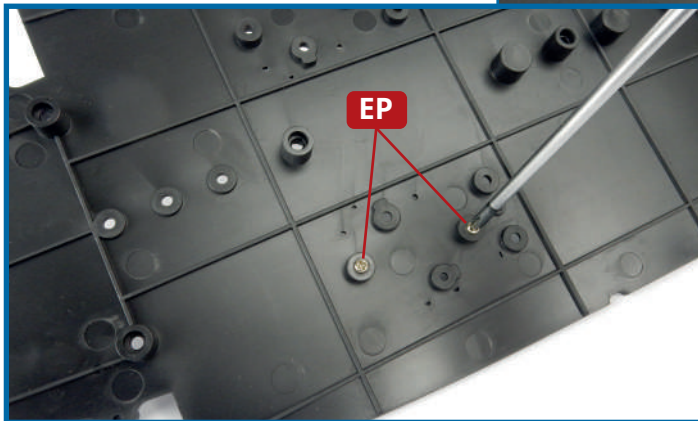
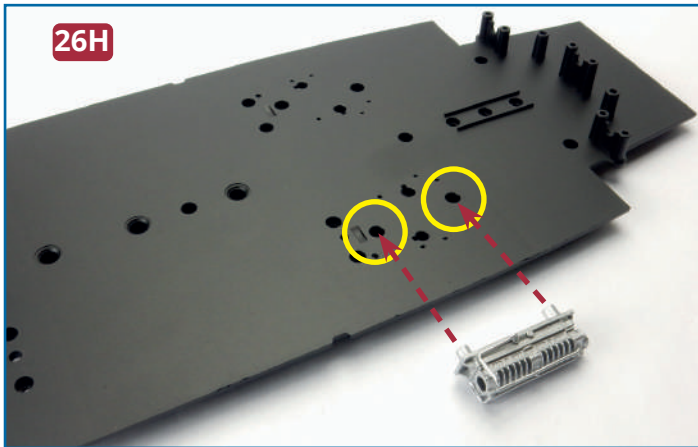

4 Take the deck of the engine room **26H** and place it on your work surface in the orientation shown. Fit the raised screw sockets on the underside of the thrust block in the corresponding holes in the deck, as indicated. Turn the deck over and fix the thrust block in place with two **EP** screws.

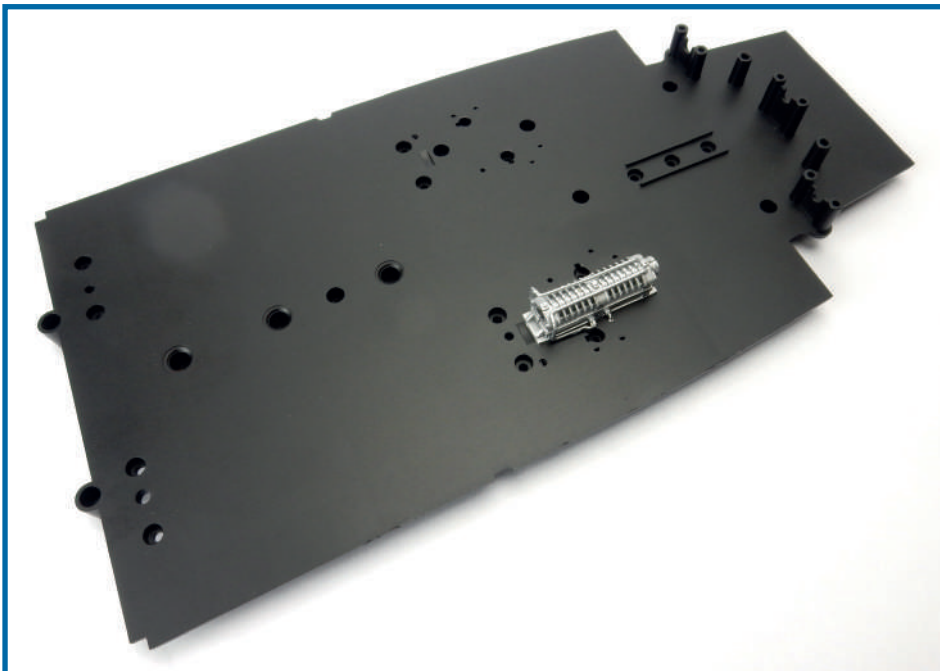

Completed work

A thrust block has been assembled and fitted to the deck of the engine room.