

TITANIC

THE SHIP • THE LEGEND

Pack 8



FURTHER DETAILS FOR THE ENGINES

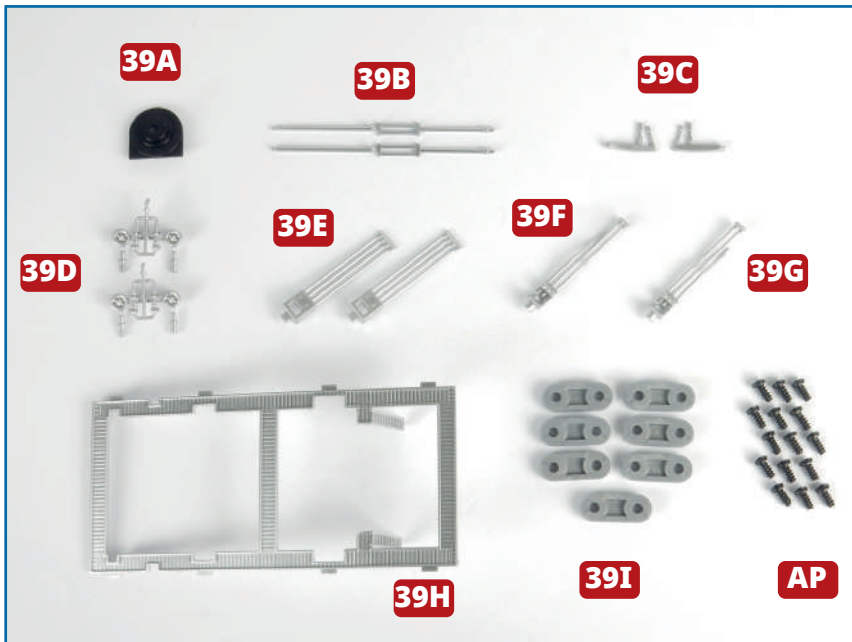

PARTS IN THIS ISSUE

- 39A** Shaft plate
- 39B** Steam pipe A (x 2)
- 39C** Pump detail (x 2)
- 39D** Control handwheels (x 2)
- 39E** Steam pipes B (x 2)
- 39F** Steam pipe C (port side)
- 39G** Steam pipe C (starboard side)
- 39H** Central walkway
- 39I** Grips (x 7)
- AP** Fifteen 2.3 x 5mm PB screws (1 spare)

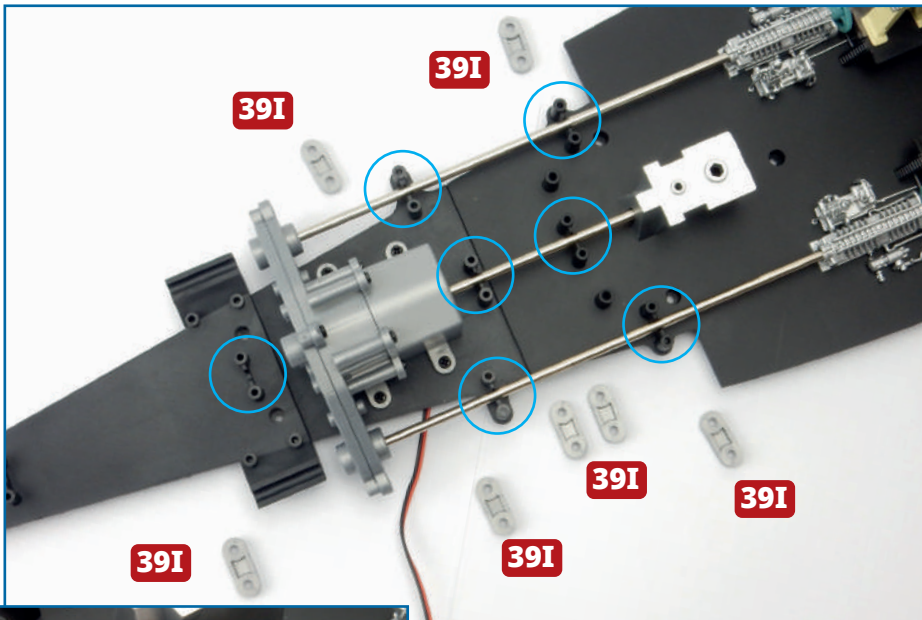

1 Take the assembly from issue 38 and the seven grips **39I**. Fit the grips over the seven pairs of raised screw sockets (circled, left). Position the grips with the flat side face down so that the raised screw sockets fit in the recesses (below left). Fix in place using two **AP** screws for each grip.

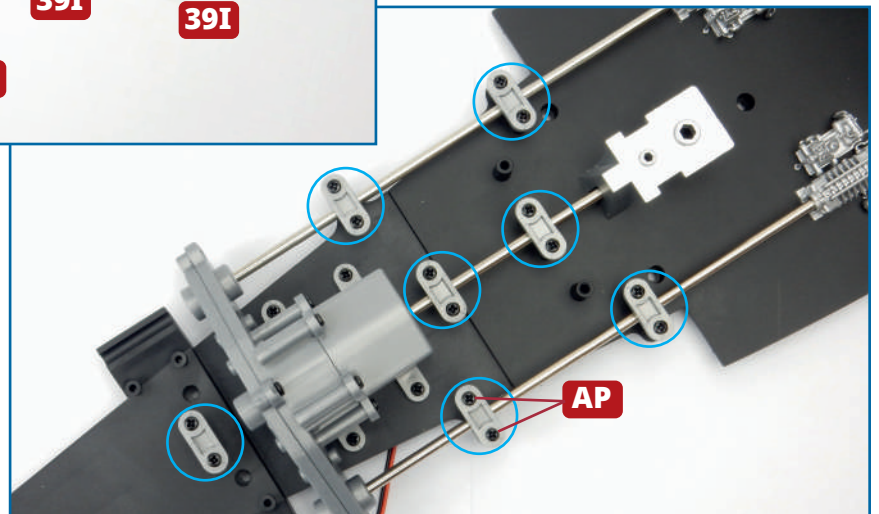
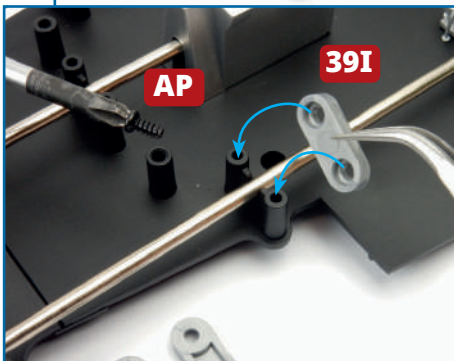



2 Take the turbine and condenser assembly from issue 36 (below). Position it on the base **36E** as shown right, do not use any glue. Align the ends of the steam pipes **36B** and **36G** with the pipes **31A** (port) and **33A** (starboard) running along the inside of each engine (circled in white). If necessary, use a little glue to hold the pipes in place.

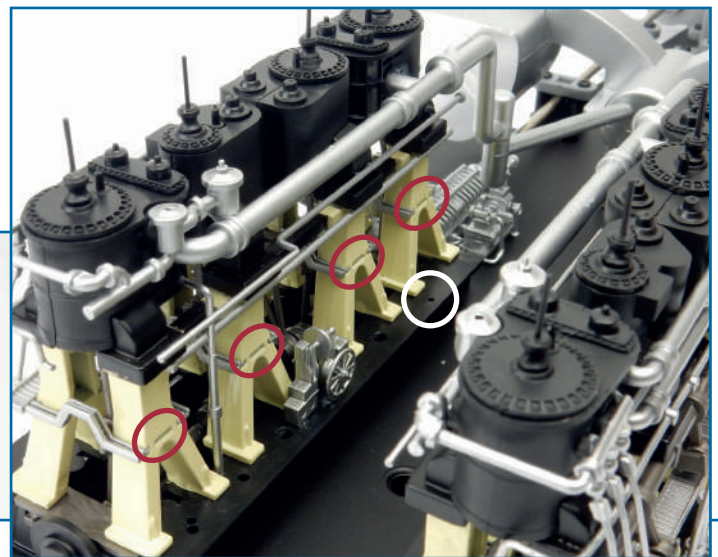
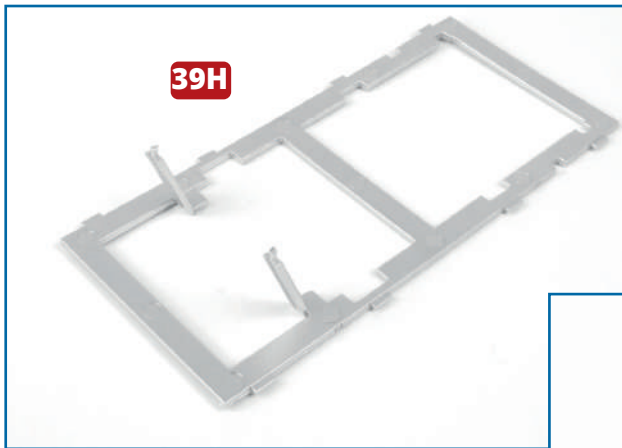
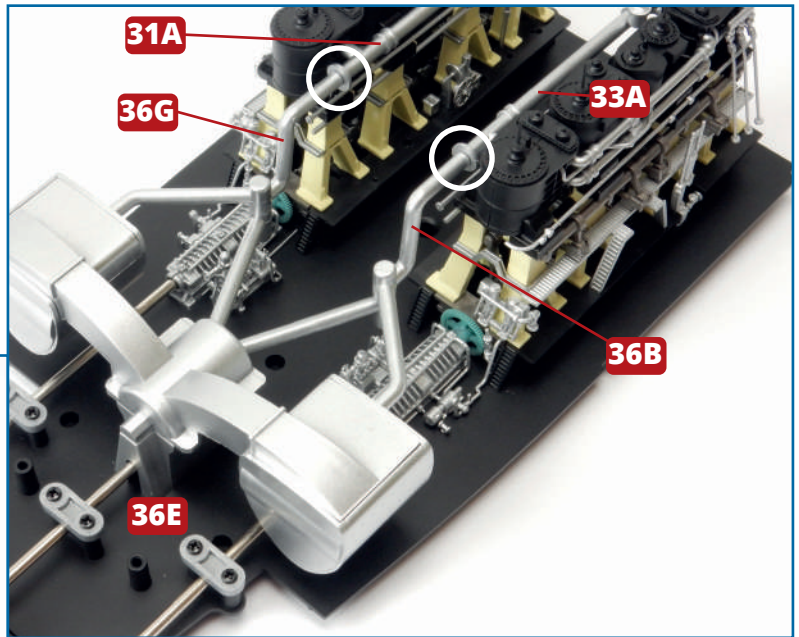
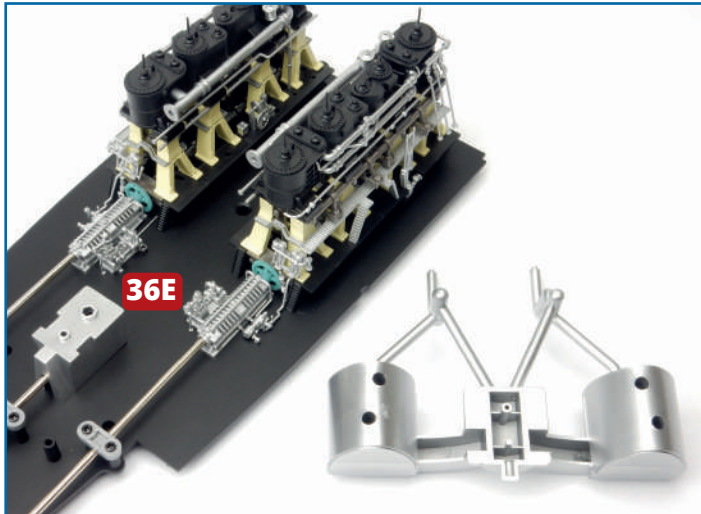

3 Check how the central walkway **39H** fits between the two engines. Tabs on the outer edges of the walkway fit into slots in the engines (circled in red on the starboard engine, above right). A peg on the bottom of the ladder fits into a hole in the base of the engine (circled in white). No glue is needed.

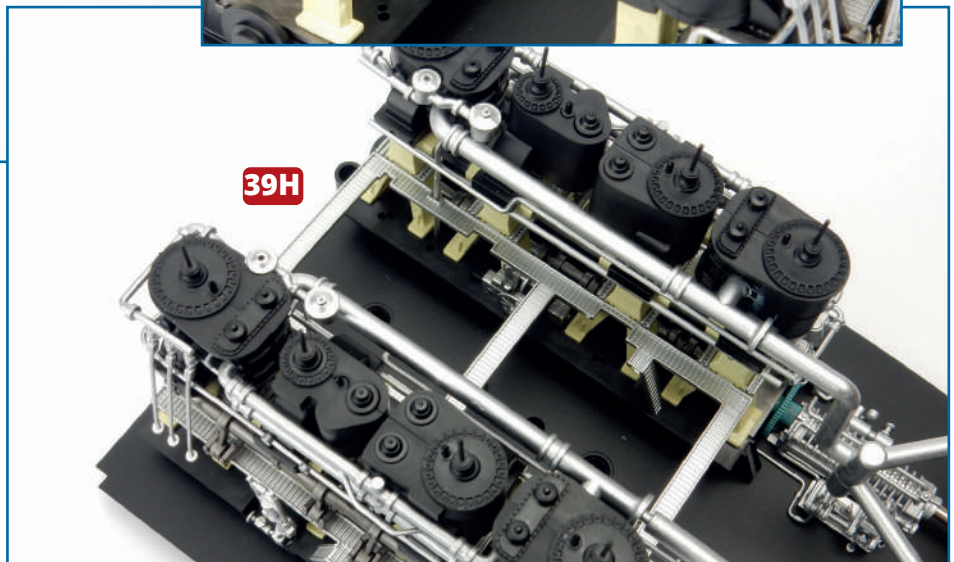

STARBOARD PARTS

PORT PARTS

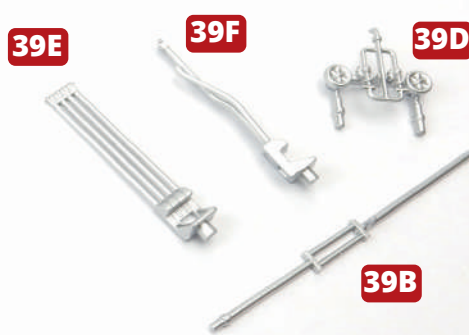

4 Take the pairs of parts **39B**, **39D**, **39E** and the port and starboard pipes **39F** and **39G** (above). The photo on the right shows the fixing points for each part on the port engine. Check the fit of each part in turn and use a fine round file to enlarge the holes if necessary. Apply a little superglue to each of the pegs to hold the parts in place (below right).

Repeat to fix the pipes in place on the starboard engine (below).

PORT ENGINE

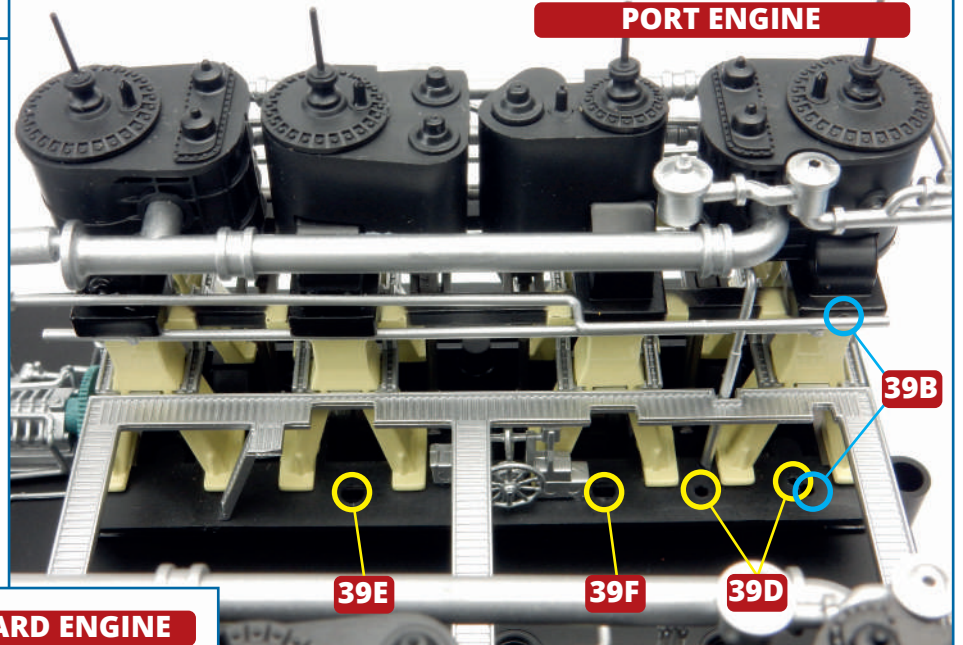

STARBOARD ENGINE

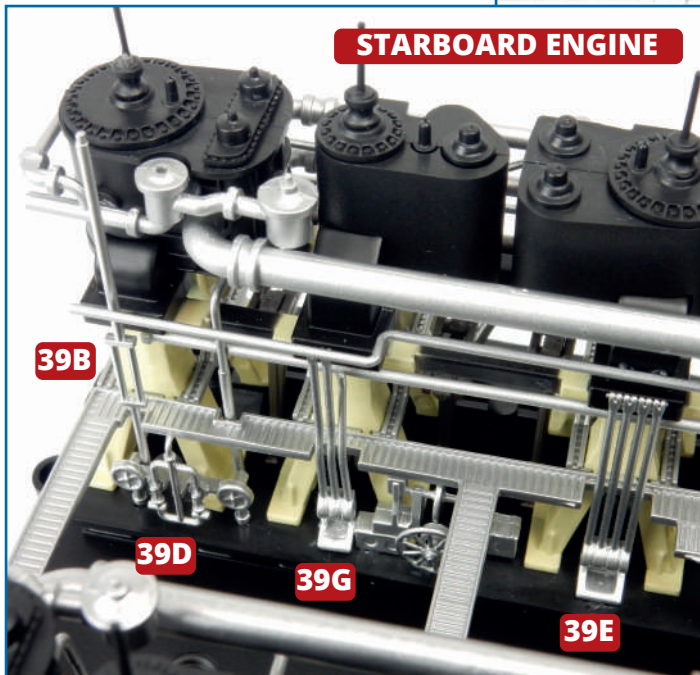

PORT ENGINE

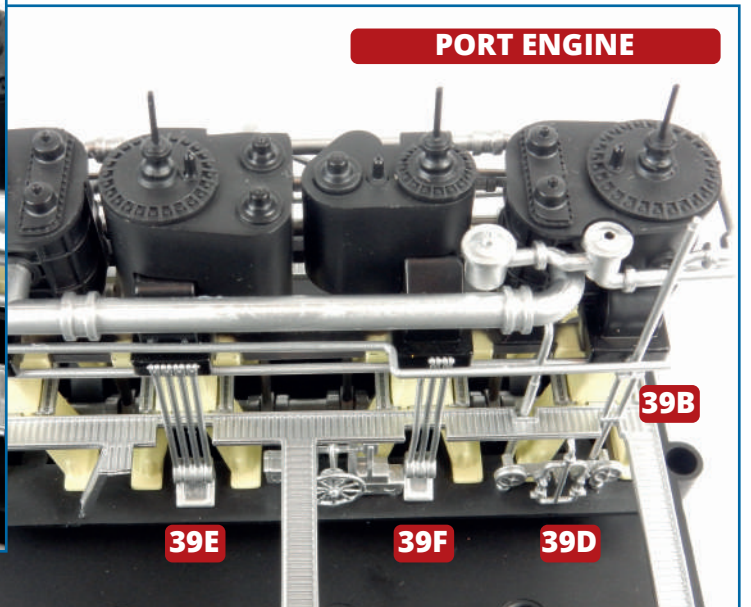

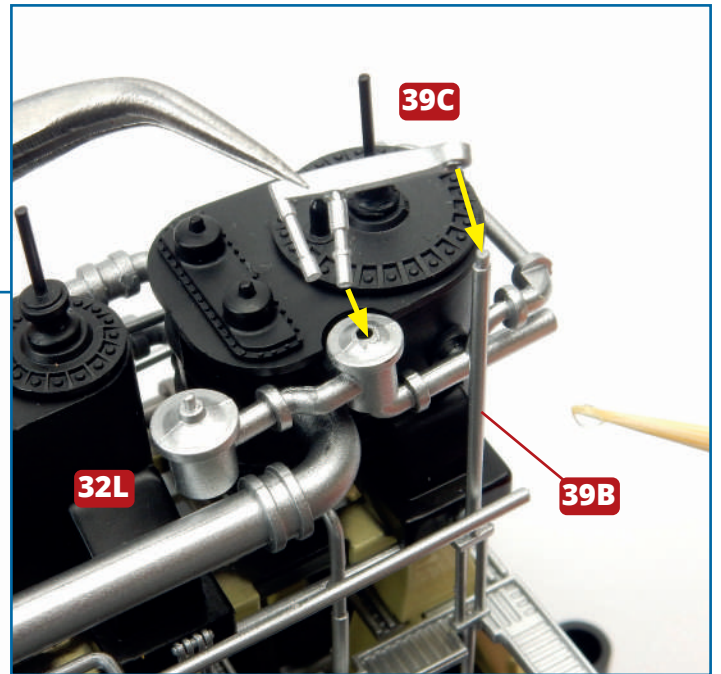
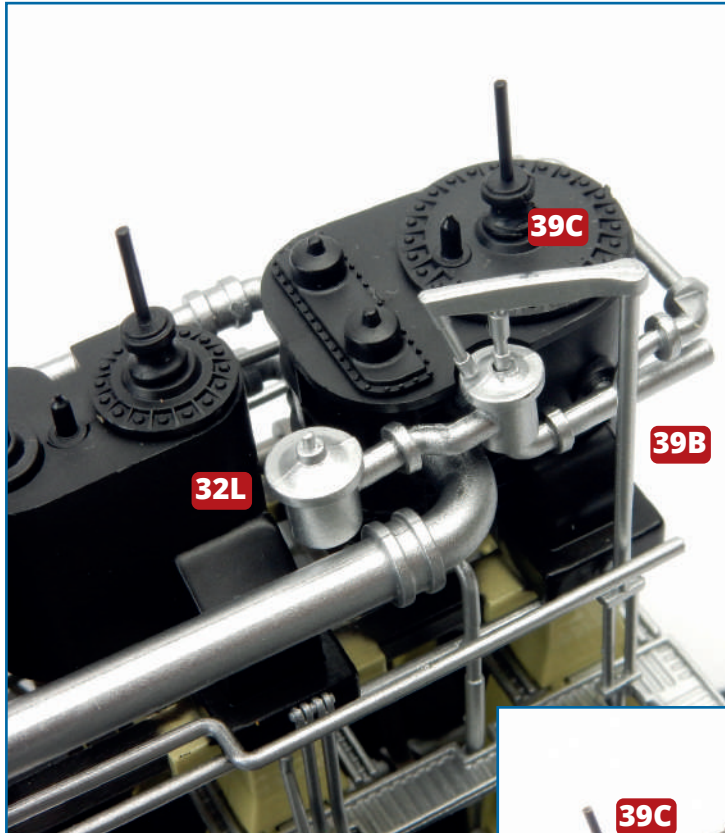

5 The pump details **39C** fit in the tops of the vapour separators **32L** (port engine) and **33K** (starboard engine), with the ends of parts **39C** on the upper ends of the pipes **39B**. Glue in place.

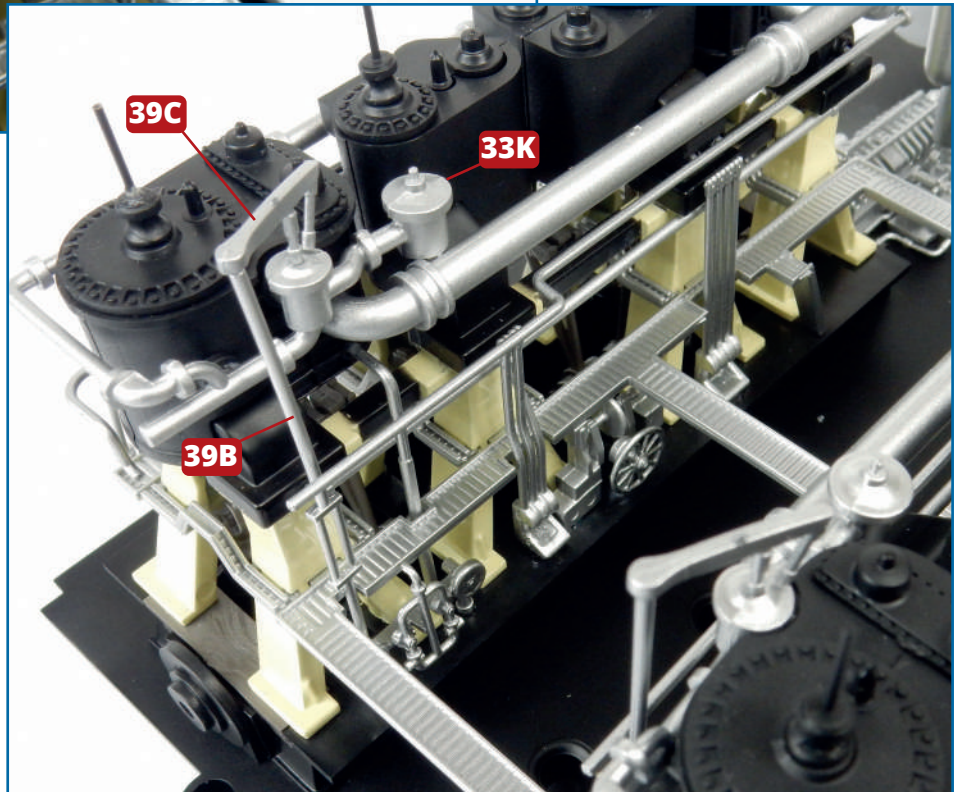

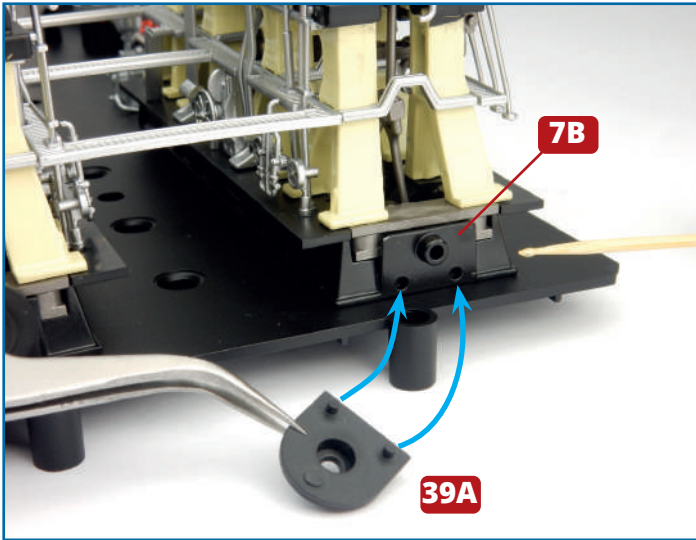

6 The shaft plate **39A** fits on the front of the port engine; two pegs on part **39A** fit into holes in the base of the engine **7B**. Fix it in place with a little superglue if necessary.

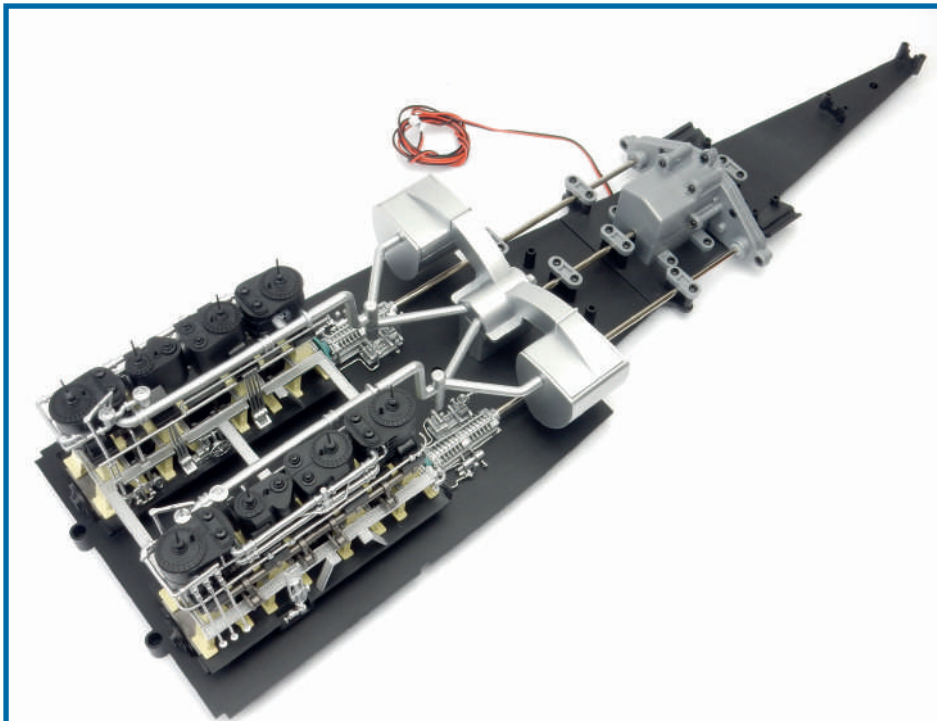
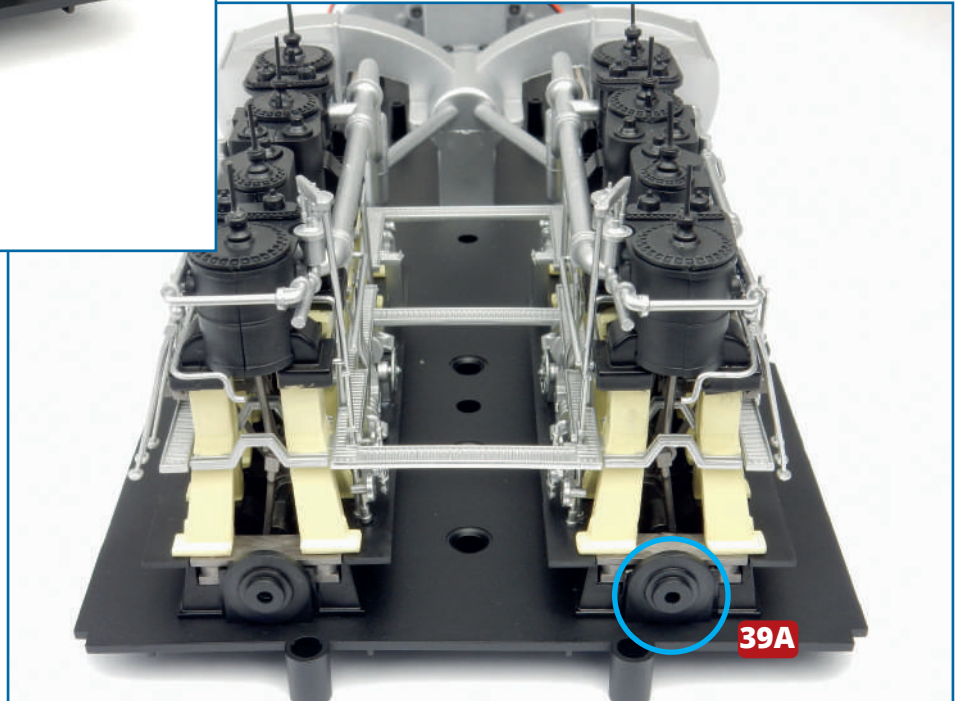

Completed work

Further details have been fitted to the engines and drive shafts have been fixed in place.



SHAFTS AND PROPELLERS

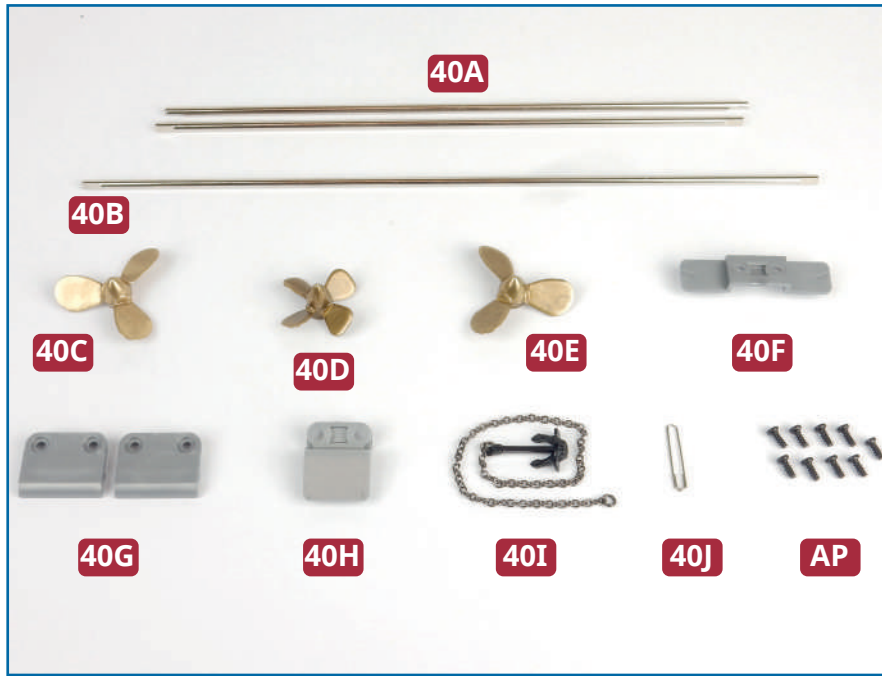

Parts in this issue

- 40A** Side shafts (x 2)
- 40B** Central propeller shaft
- 40C** Port propeller
- 40D** Central propeller
- 40E** Starboard propeller
- 40F** Central plate
- 40G** Side plates (x 2)
- 40H** Stern plate
- 40I** Starboard anchor
- 40J** Clip
- AP** Nine 2.3 x 5mm PB screws (1 spare)



1 Take the two side shafts **40A**, the central shaft **40B** and the three propellers **40C**, **40D** and **40E**. Take care to identify the two side propellers correctly: the angle of tilt of the blades on the starboard propeller is the same as the angle of the blades on the central propeller; the port propeller has the blade tilted in the opposite direction. Fit the ends of the shafts into the propellers. At this stage you do not have to use glue as the assembly will be fixed at a later stage.

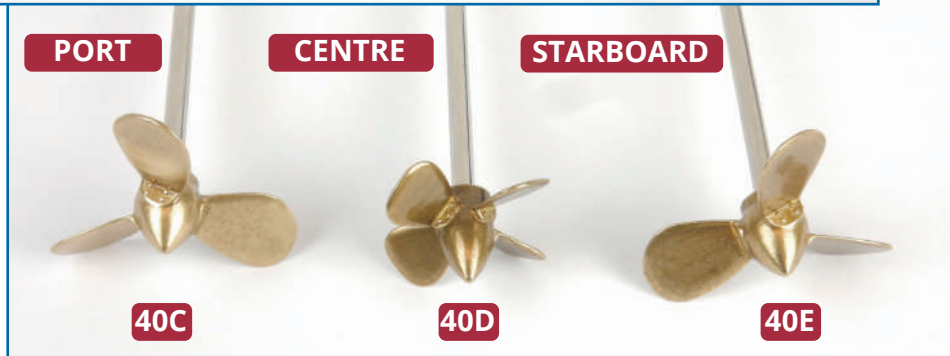

★ STEP-BY-STEP INSTRUCTIONS ★

2 Take the assembly from the previous issue and fit the port and starboard propeller shafts into the sockets on the outer corners of the gearbox **35B** (circled in red). Fit the end of the central shaft under the grip **39I** and into the central hole in the gearbox (circled in blue, below left). Do not use any glue. The shafts and cogs in the gearbox must be able to rotate.

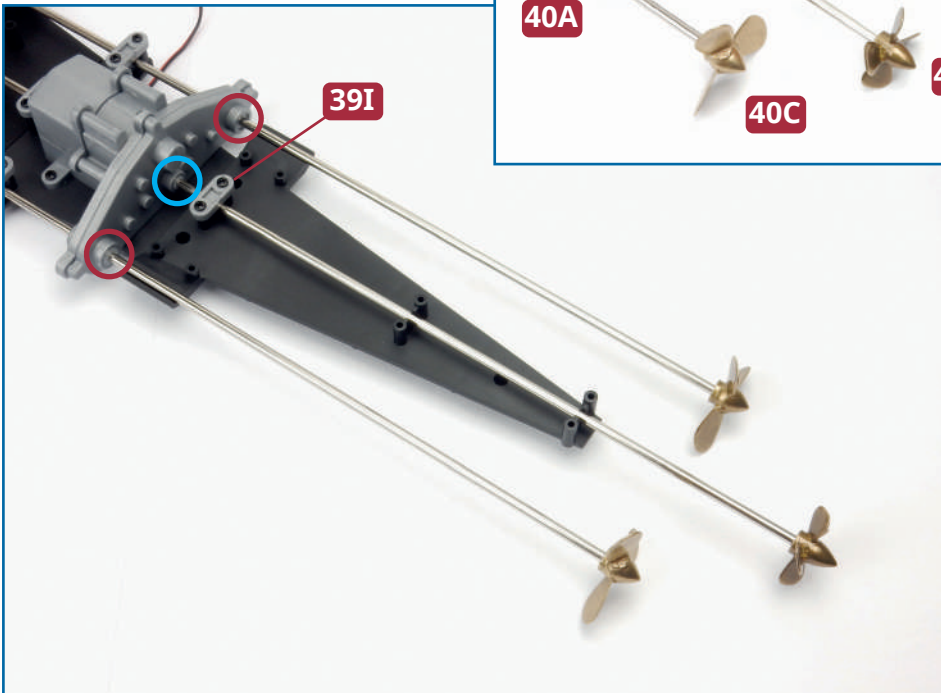
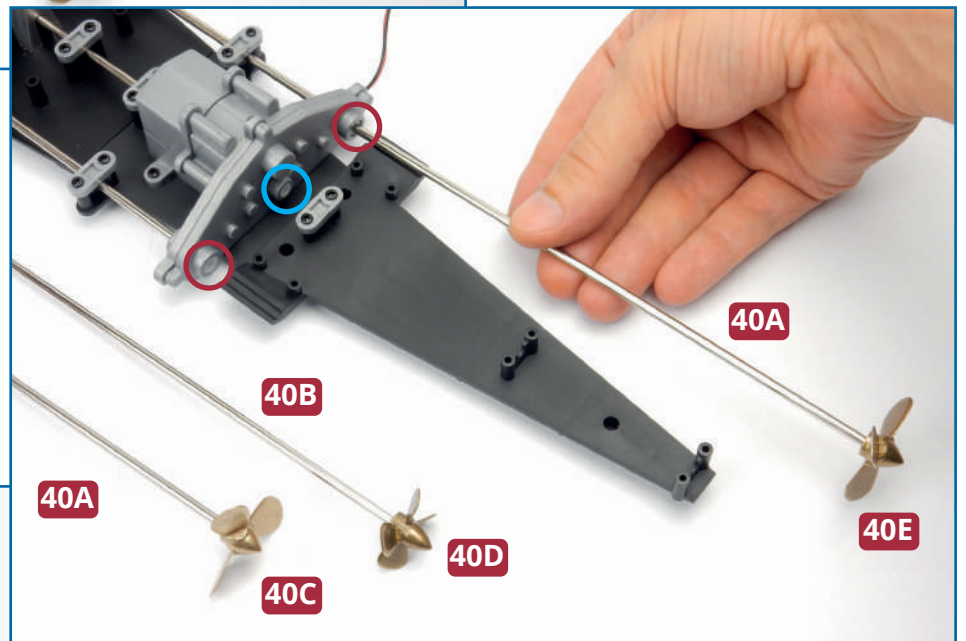
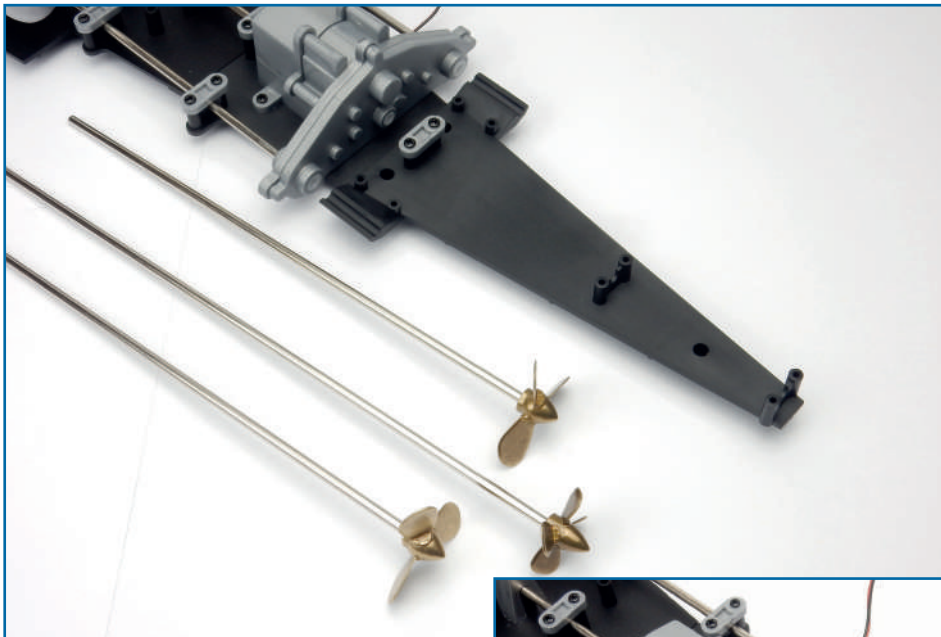



3 Take the plates **40F**, **40G** (x2) and **40H**. Fit the stern plate **40H** over the two raised screw sockets at the stern of the deck (noting the orientation, below). Fix in place using two **AP** screws. Then position and secure the central plate **40F**, again using two **AP** screws (bottom). Finally, fix the side plates **40G** in place with two more pairs of **AP** screws.

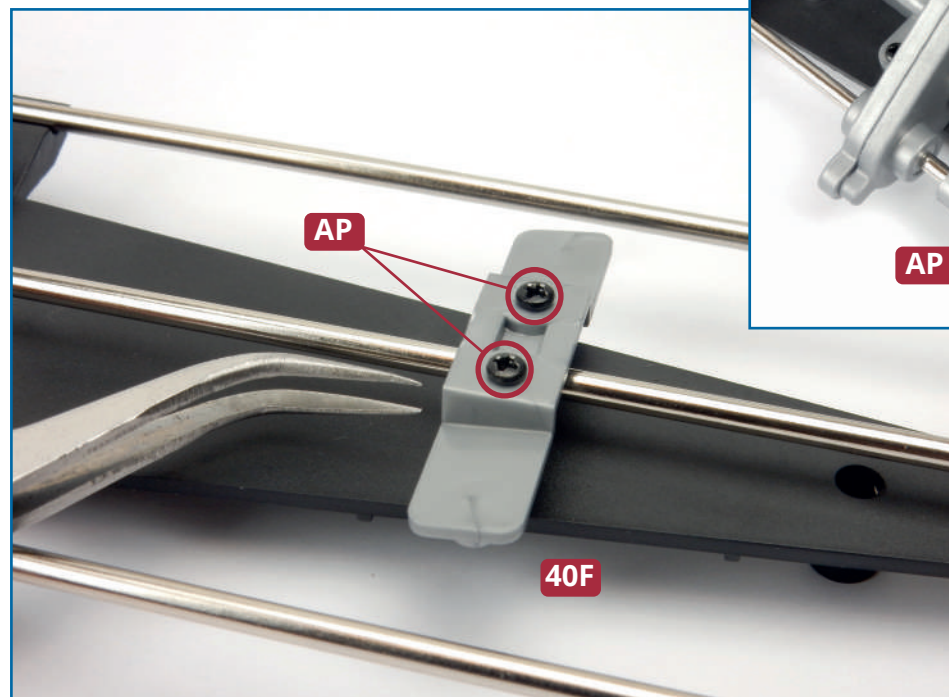
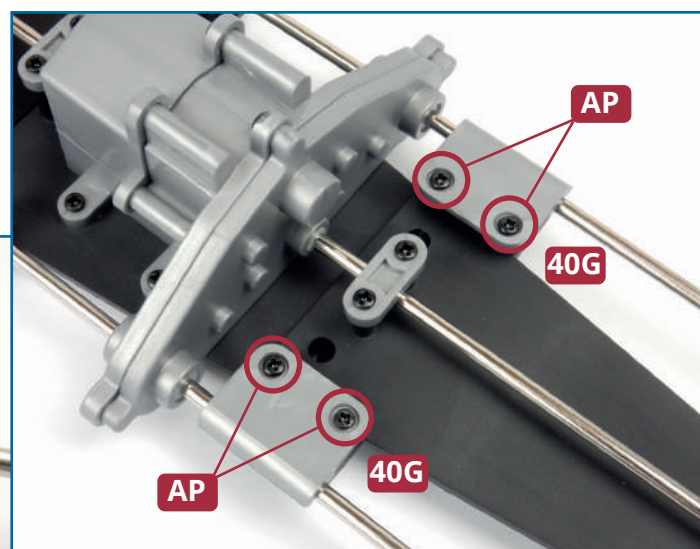
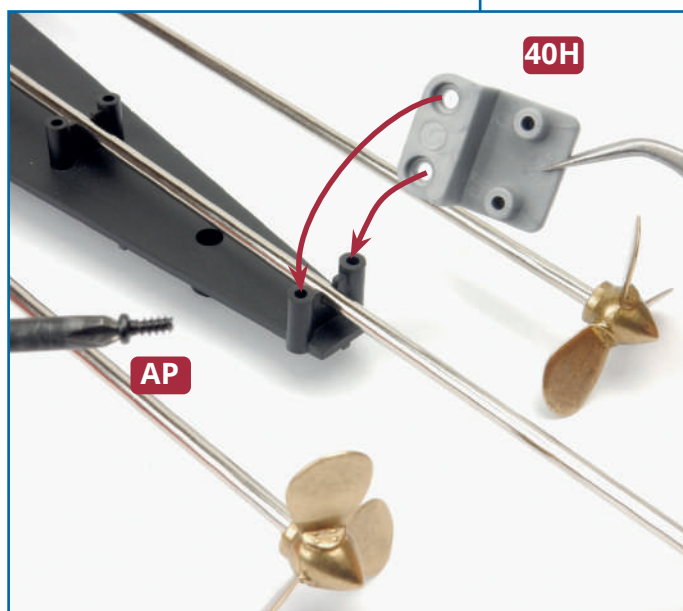
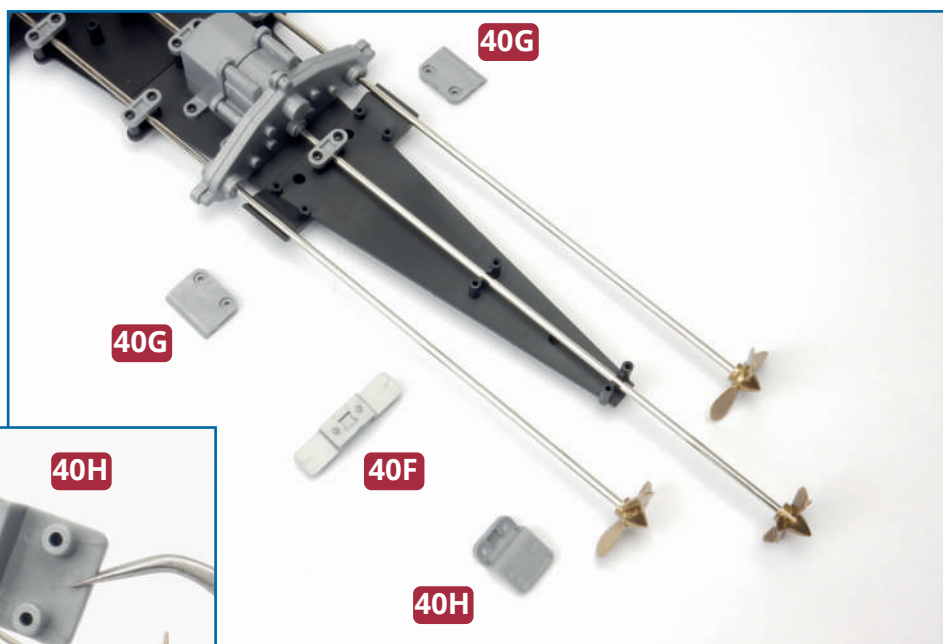

★ STEP-BY-STEP INSTRUCTIONS ★

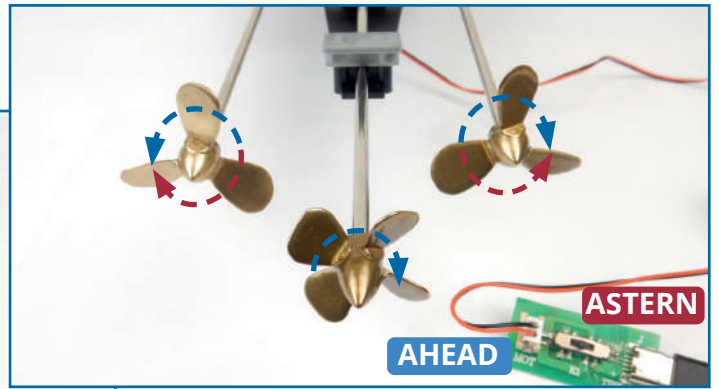
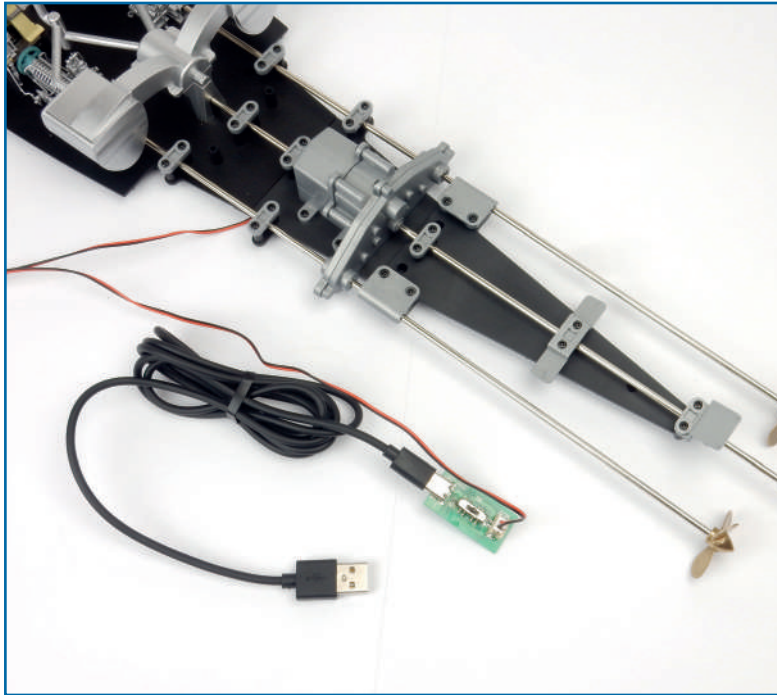

4 You can now carry out another test, following the instructions in issue 38. When the switch is in the “Ahead” position, all three propellers rotate: the port one rotates anticlockwise; the starboard and the central propellers rotate clockwise, and are faster. In the “Astern” position the port propeller rotates clockwise and the starboard propeller rotates anticlockwise. The central propeller does not rotate in the Astern position.

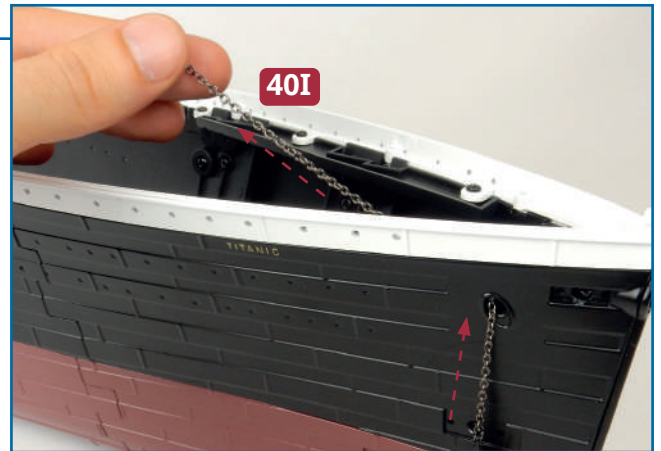
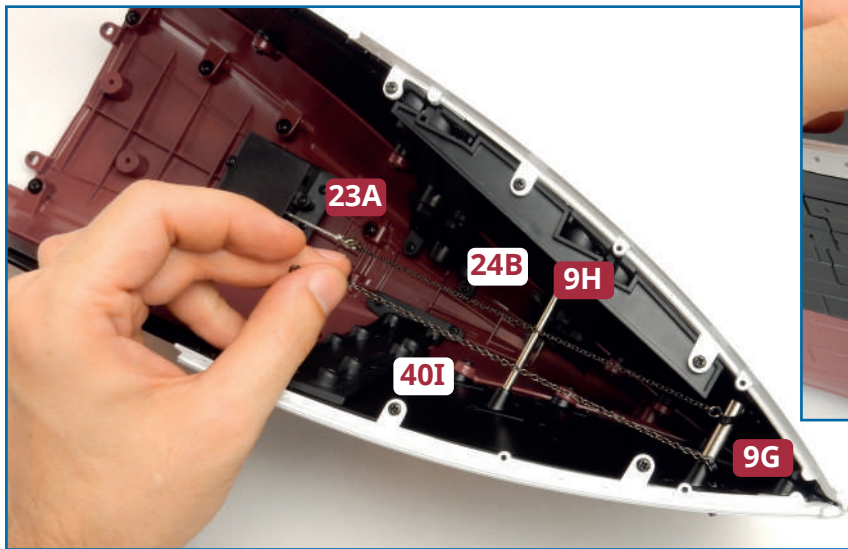

5 Take the bow assembly from issue 24. Thread the chain of the anchor **40I** through the hawse hole on the starboard bow. With both anchors pulled up into the hawse holes, check the length of the chain **40I** against the other anchor chain **24B**. If they are the same length you can fit both onto the catch on the end of the winch ‘rope’ **23C**. If they are different lengths, you will need to use the clip **40J** (see following step).

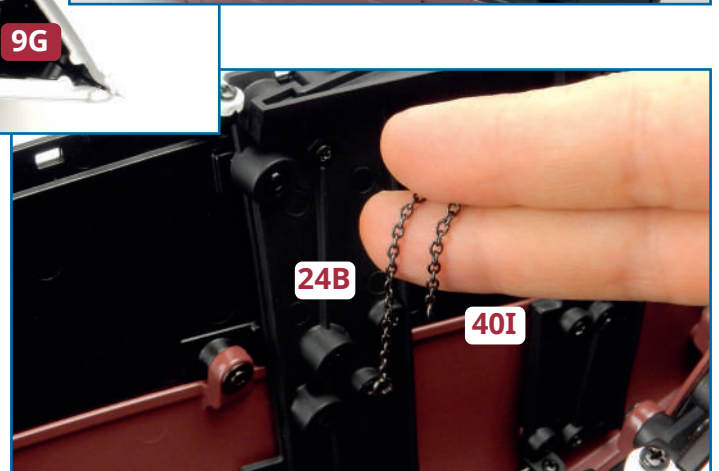

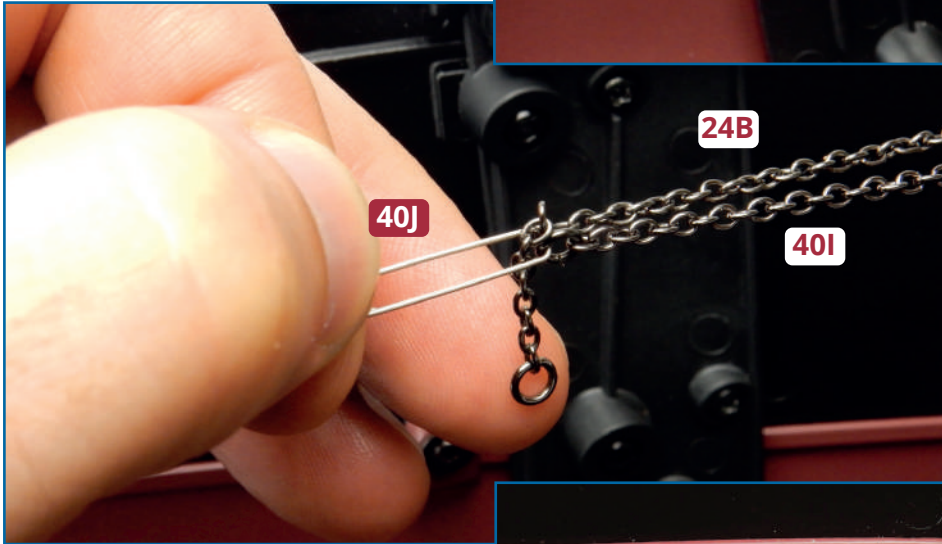
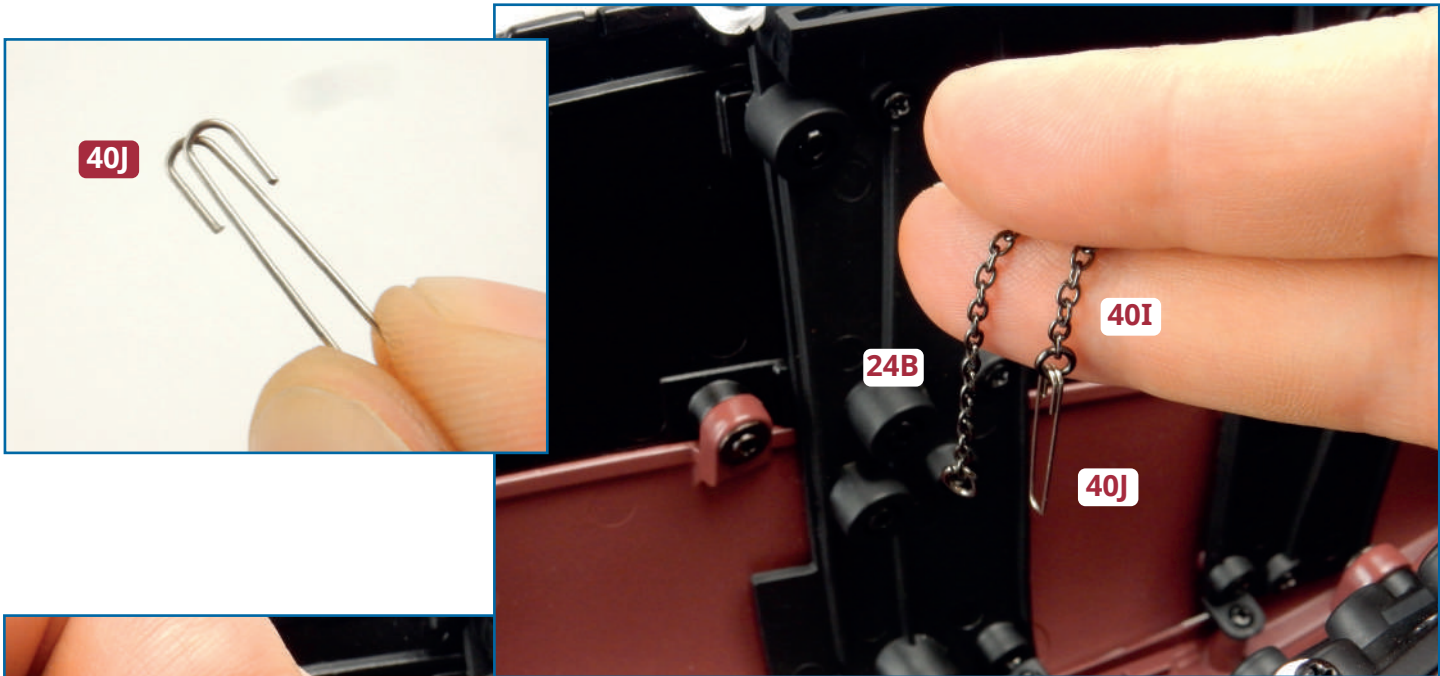

6 If the anchor chains are different lengths, open the clip **40J** and fit it onto the end of the shorter chain. Then, fit the clip through the link in the longer chain that is level with the ring on the end of the shorter chain. With both chains effectively the same length, fit the clip onto the catch on the end of the winch rope **23A**.

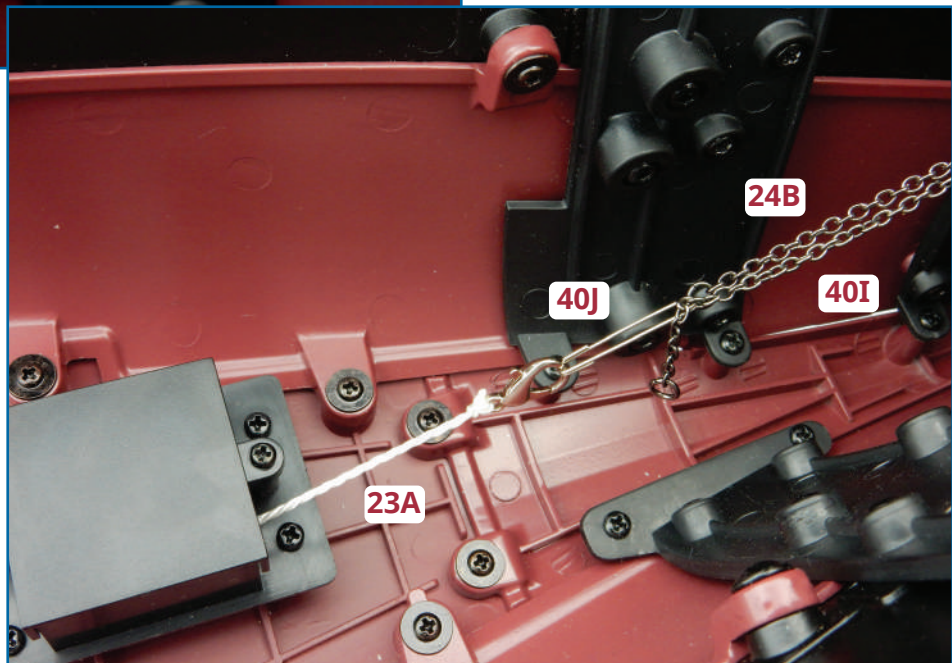

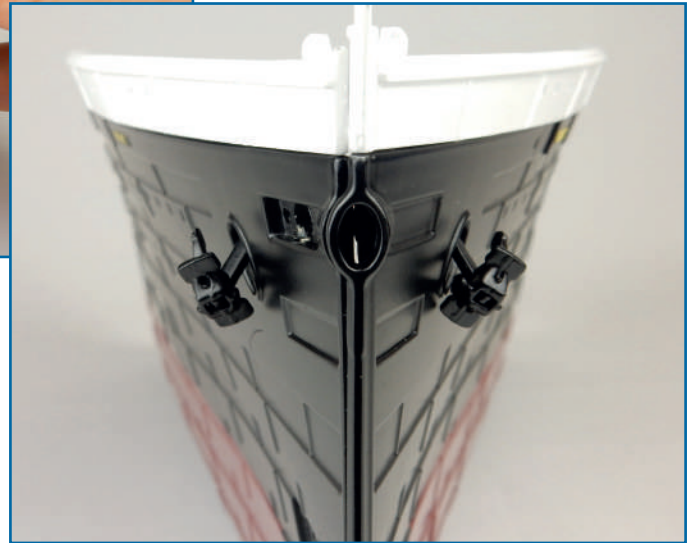
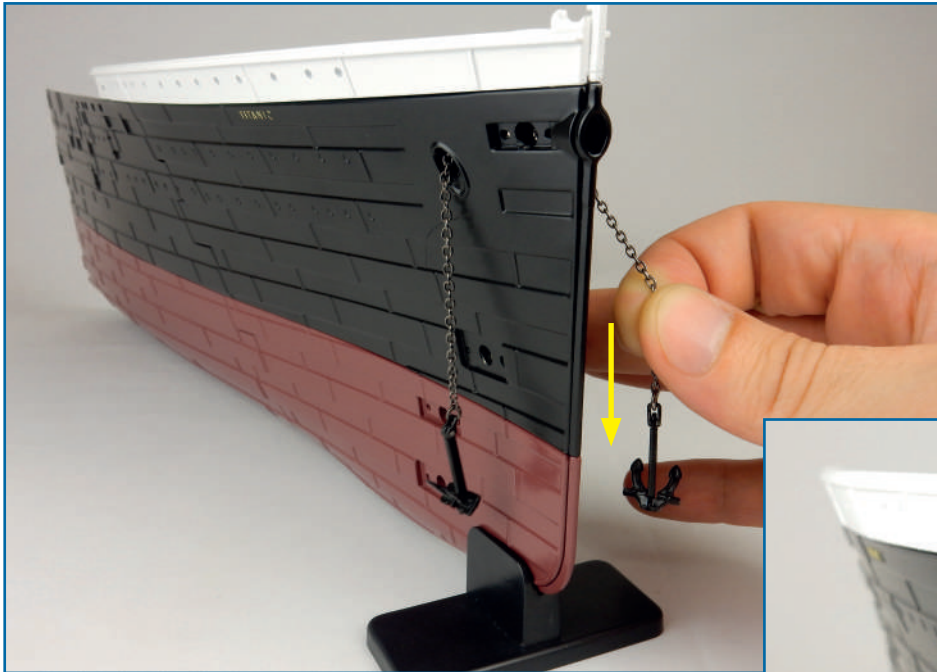

7 Now check the operation of the anchors by pulling them down. When the winch is fully rewound, the two anchors should be at the same level. If one anchor is lower than the other, you will have to adjust the length by fitting the clip **40J** through different links in the chains **40I** and **24B**.

Completed work

Shafts and propellers have been fitted to the engine. Also, the second anchor has been added to the bow of the model.

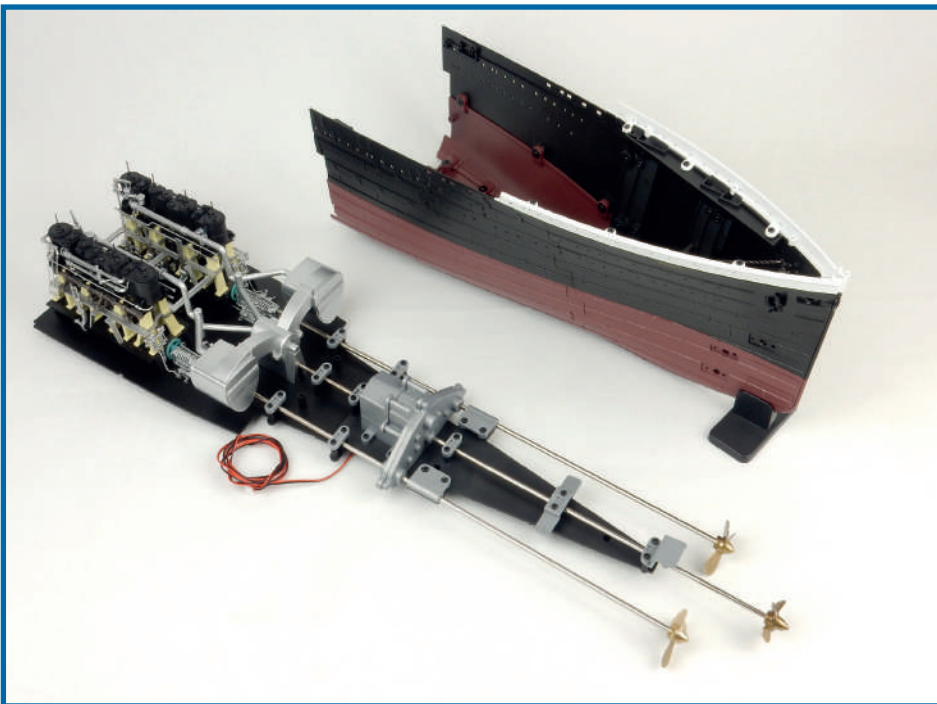



FORWARD BOAT DECK AND BRIDGE

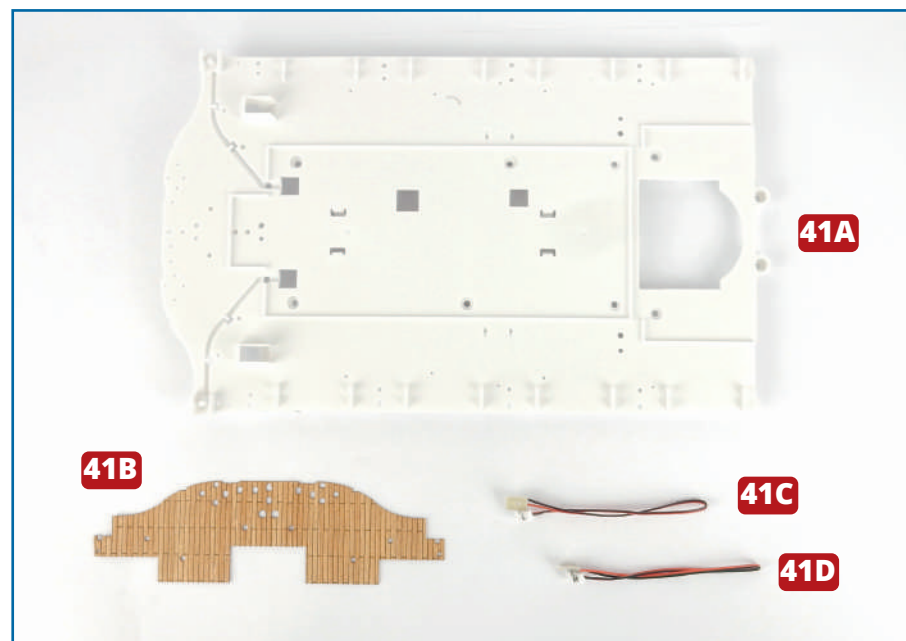

PARTS IN THIS ISSUE

41A Forward boat deck and bridge

41B Decking for bridge

41C LED light (marked L)

41D LED light (marked M)

NOTE: The decking is very delicate and must be handled carefully (see also the tip given in step 4).

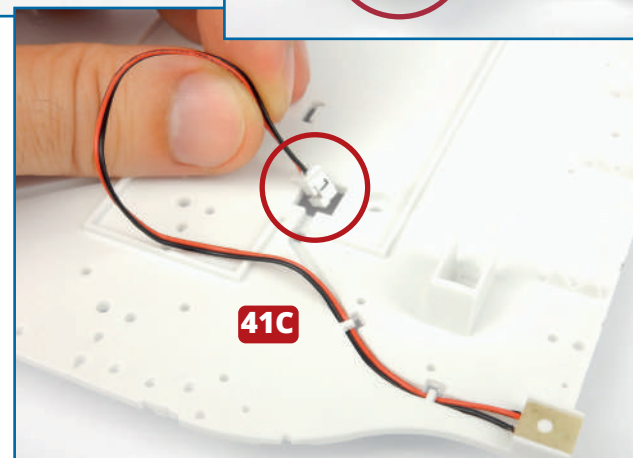
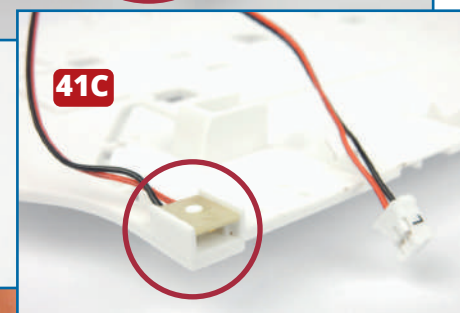
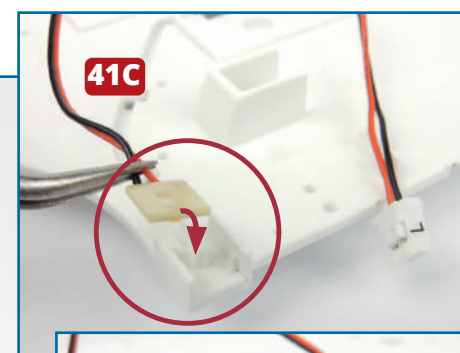
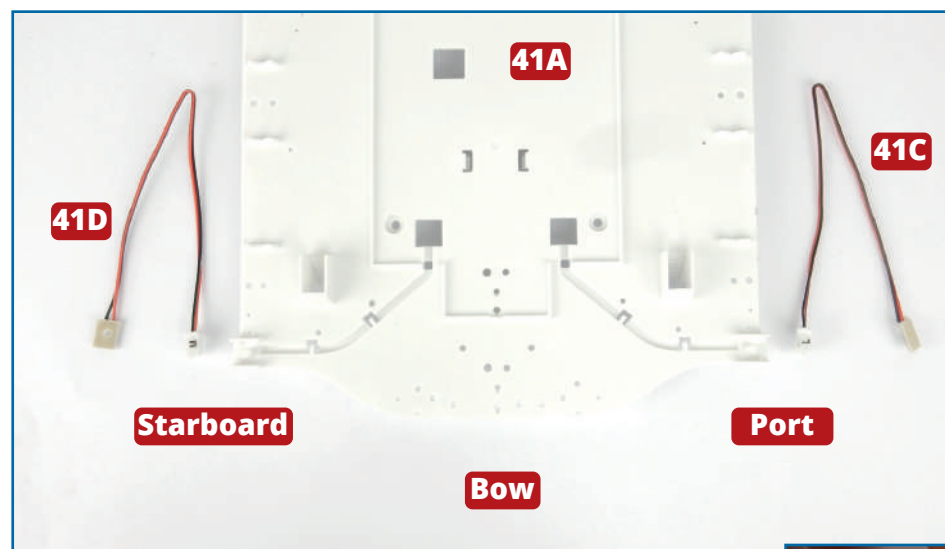

1 Take the boat deck **41A** and the two LED cables **41C** and **41D**. Note the marking **L** and **M** on the sides of the connectors at the end of each cable. Fit the LED on the end of the cable **41C** (L) on the peg in the rectangular box on the port side of the deck **41A**, with the plain side facing upwards (right, top and centre). Run the cables down into the channel and fit them in place so that they are held under the cable clips – you may find it helpful to use a wooden cocktail stick. Thread the connector through the hole at the end of the channel (right).

★ STEP-BY-STEP INSTRUCTIONS ★

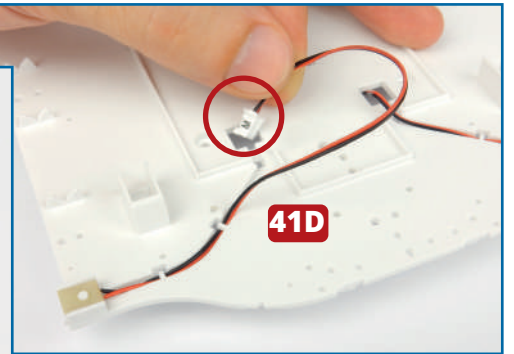
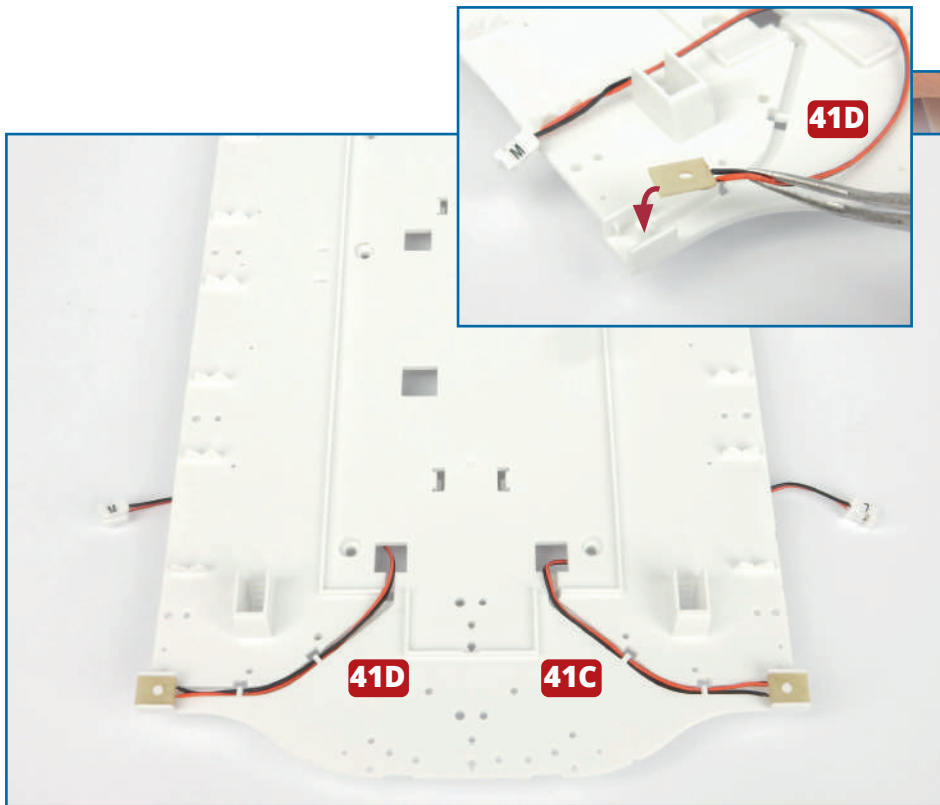

2 Repeat the operation to fit the LED cable **41D** (marked M) on the starboard side of the deck: fit the plate with the LED in the rectangular box and run the cable through the channel so it is anchored beneath the clips. Thread the connector through the hole at the end of the channel.

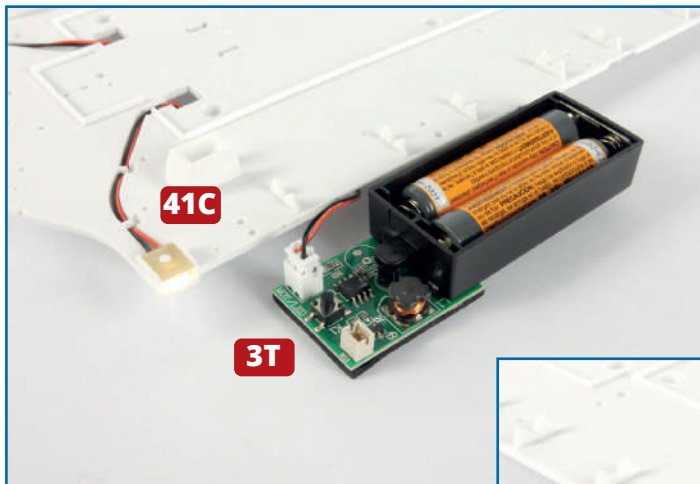

3 Check that both the LED plates are fitted inside the recesses. They will be held in place by a part that will be supplied with the next issue. The cable at the LED end must run straight down into the channel so that it will not prevent the decking from lying flat (see step 4, overleaf).

Use the tester **3T**, supplied with issue 3, to test the LEDs: in turn, fit each of the plugs **L** and **M** into the largest socket in the tester.

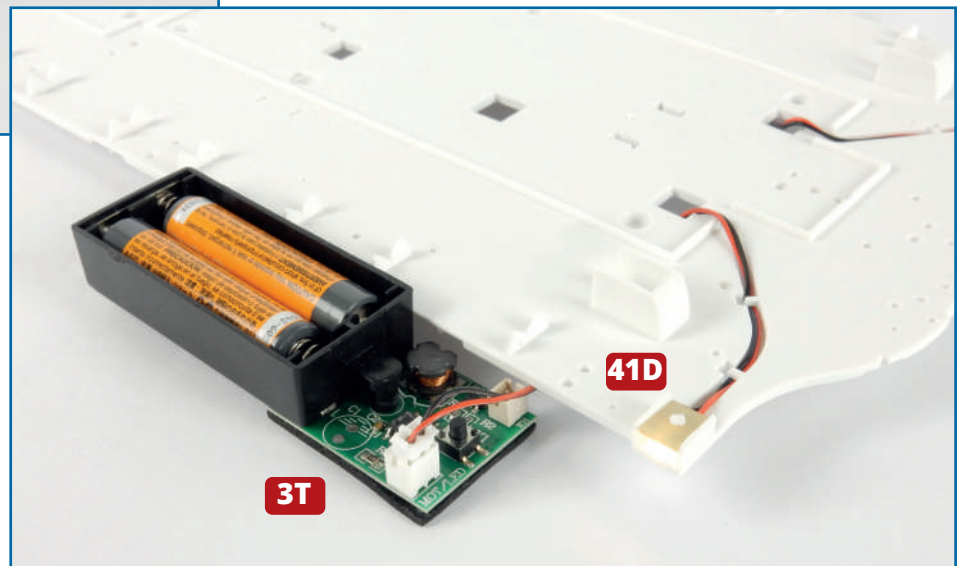

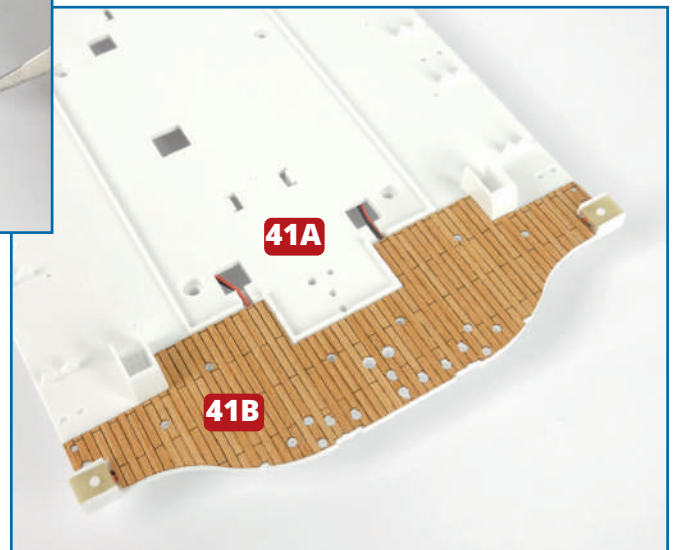
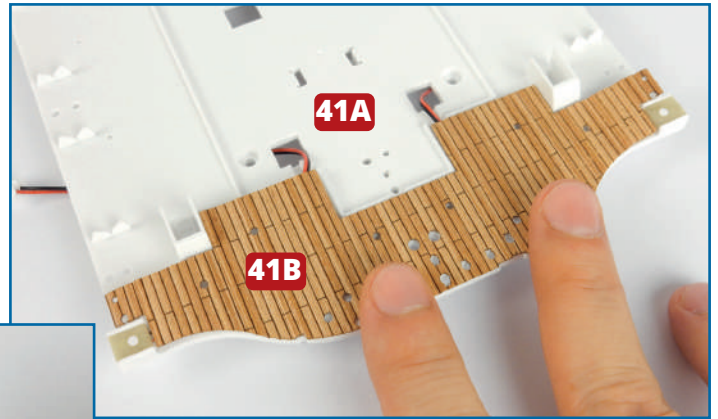

4 Take the decking **41B** and check how it fits on the forward end of the deck **41A** (the bridge, top right). When you are happy with the position, remove the paper backing and fix the decking in place so that all the holes are aligned. Smooth it down with a soft cloth.

TIP: The decking is very delicate, and may get damaged during transit. Check the box carefully for any pieces that have separated from the backing and stick them in place on part **41A**.

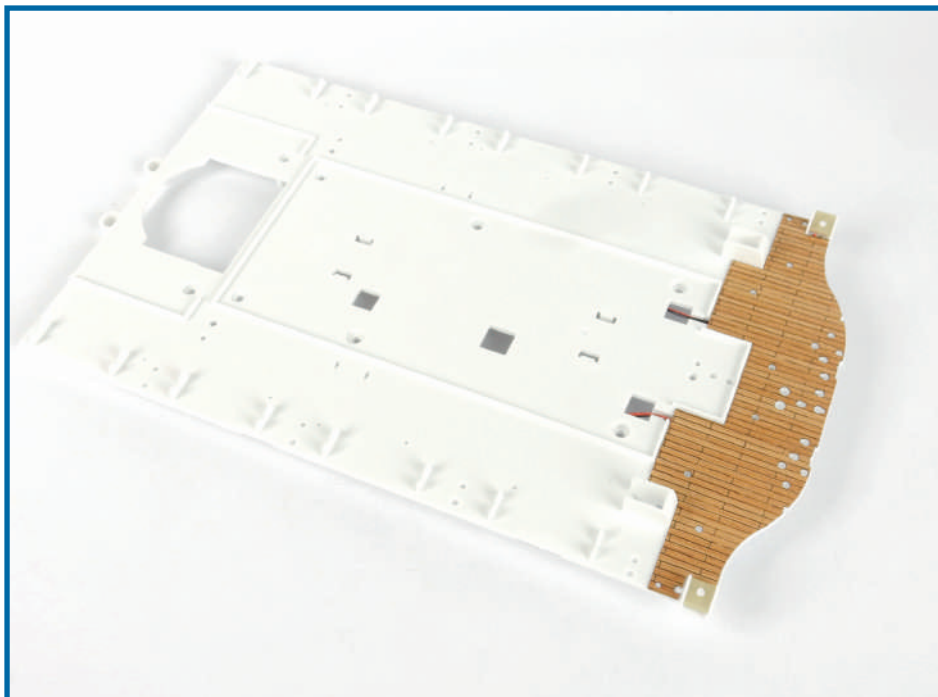

Completed work

The port and starboard navigation LED lights have been fitted and a section of decking has been applied to the bridge on the boat deck.

DETAILS FOR THE BRIDGE

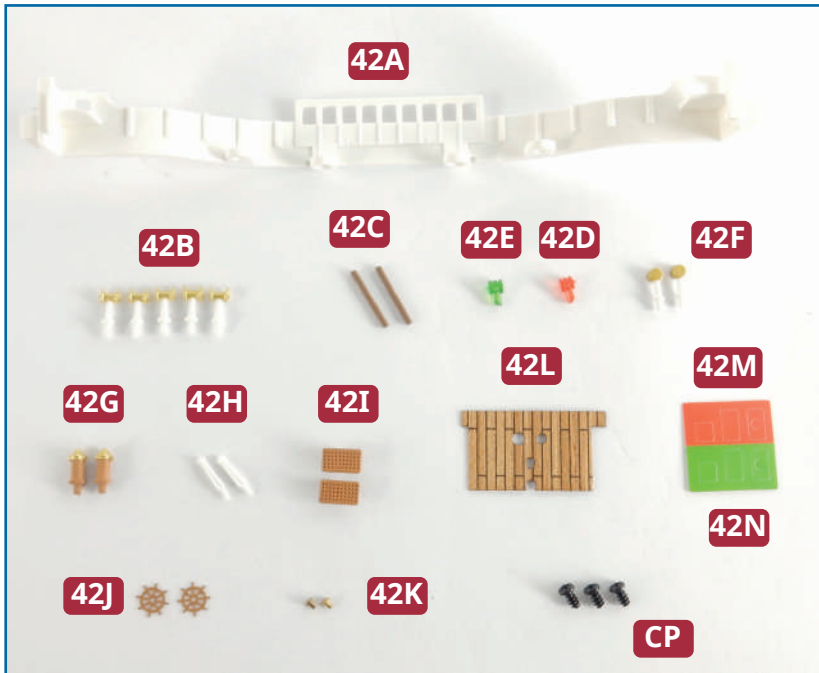

Parts in this issue

- 42A** Forward bulkhead of the bridge
- 42B** Telegraph (x 5)
- 42C** Pillar (x 2)
- 42D** Port navigation light
- 42E** Starboard navigation light
- 42F** Steering column (x 2)
- 42G** Binnacle (x 2)
- 42H** Pelorus (x 2)
- 42I** Platform (x 2)
- 42J** Steering wheel (x 2)
- 42K** Wheel hub (x 2)
- 42L** Wheel house decking
- 42M** Red sticker sheet
- 42N** Green sticker sheet
- CP** Three 3 x 4mm PB screws (1 spare)

NOTE: Take great care when opening the packages, as some parts are very small and the decking is delicate.

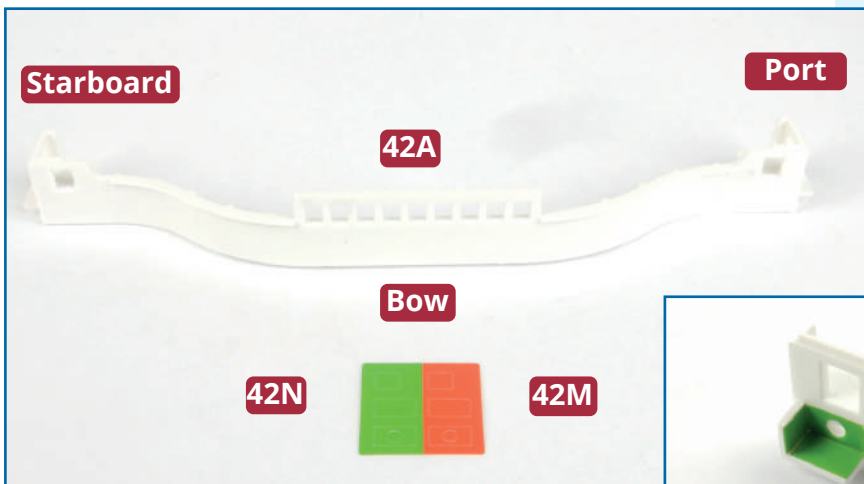

1 Take the front wall of the bridge **42A** and the red and green stickers, **42M** and **42N**. The stickers fit in the shaped areas at each end of part **42A**: the green stickers are fitted on the starboard side (above centre right) and the red stickers are fitted on the port side (below right). Peel off the stickers one at a time, placing each one as shown. Do not cover the hole for the navigation lights. Smooth the stickers down with a cotton bud.

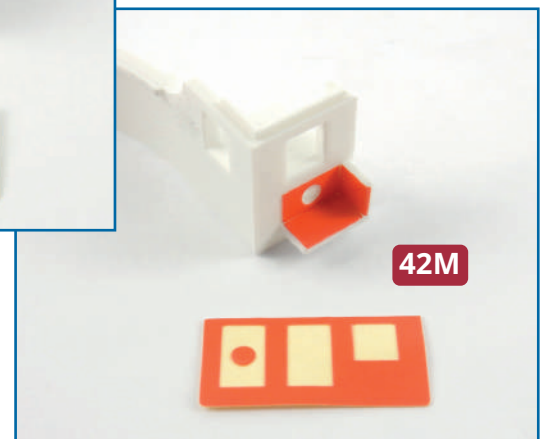
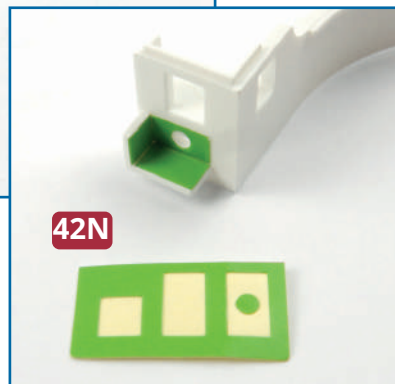



2 Take the boat deck assembly from the previous issue. The forward bulkhead of the bridge **42A** fits at the forward end of the deck: it is a little tricky to fit. With the deck upside down (right), the holes in the two outer tabs fit over the studs on the underside of the deck (green arrows); the tabs with screw holes align with the screw sockets (red arrows). At the same time, you will have to gently bend the wall of the bridge so that you can fit the structures at each end of it over the plates with the LED lights that were fitted in the previous issue. When correctly fitted the front wall will be vertical and the LED plates will be enclosed. Fix the front wall in place with two **CP** screws.

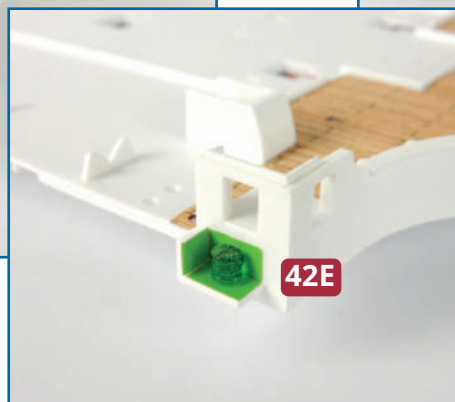
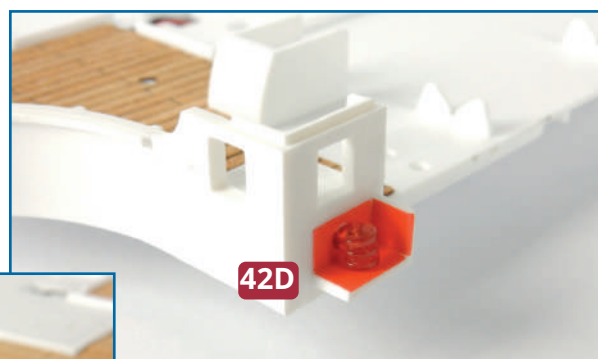
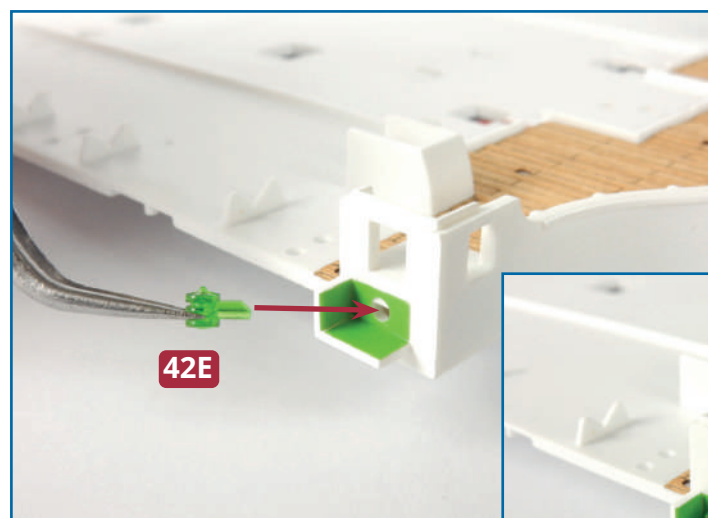
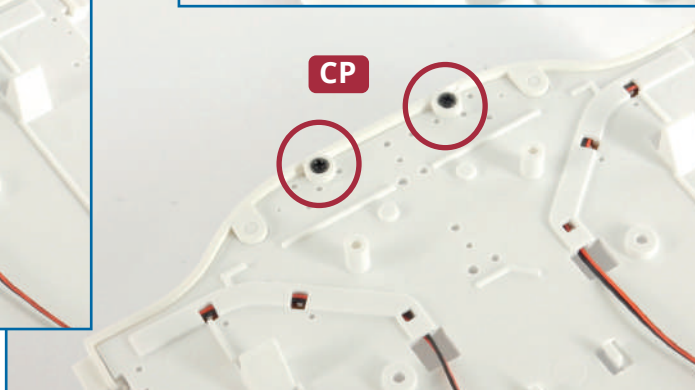
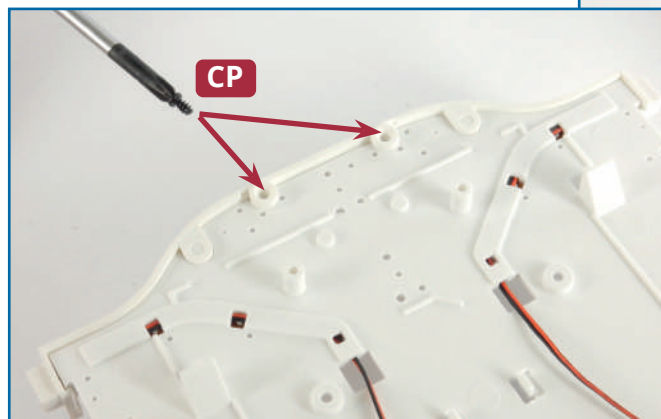
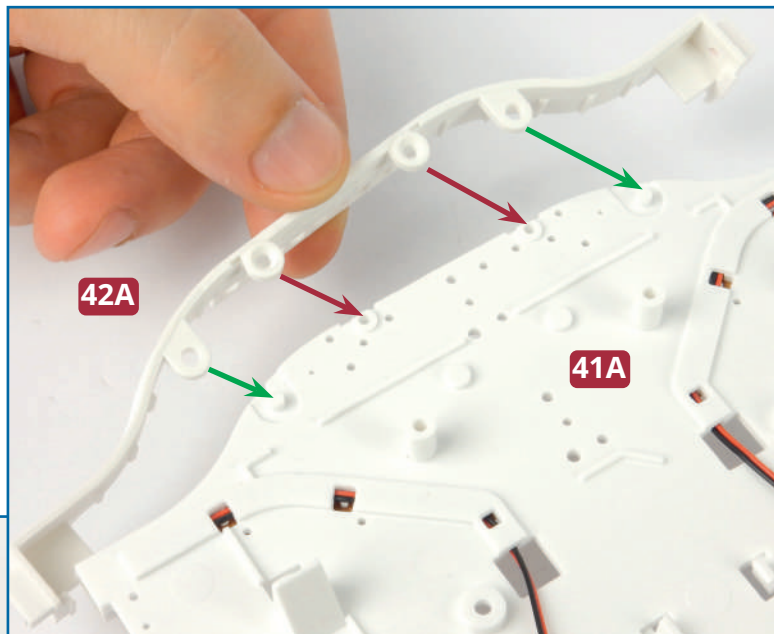

3 Turn the deck right side up and take the two navigation lights **42D** and **42E**. Fit them into the D-shaped holes on each side of the bridge, with the green light on the starboard side and the red light on the port side. Push the lights firmly in place.

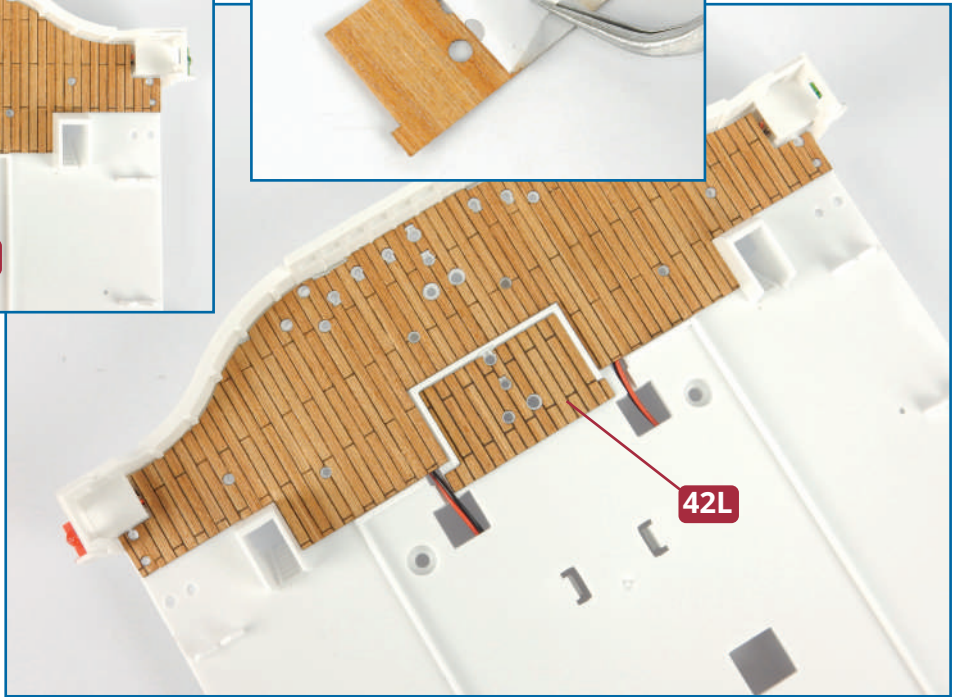

4 Check the fit of the wheel house decking **42L** in the rectangular recess in the deck **41A**. Remove the paper backing and stick the decking in place so that all the holes are aligned. Smooth down with a soft cloth.

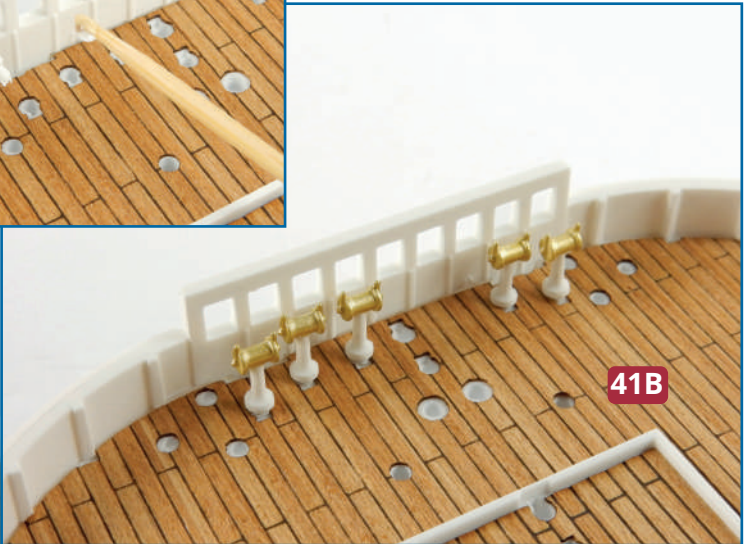

5 Identify the holes where the five telegraphs **42B** are fitted in the deck (circled). Note that there is a rectangular peg beneath the rim at the base of each telegraph that fits into the shaped hole in **41B**. Fit the telegraphs in place, using a little glue to fix them if necessary.

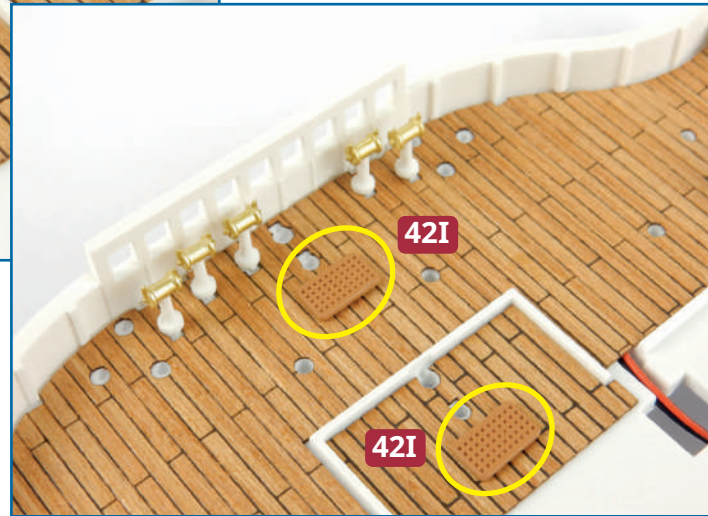
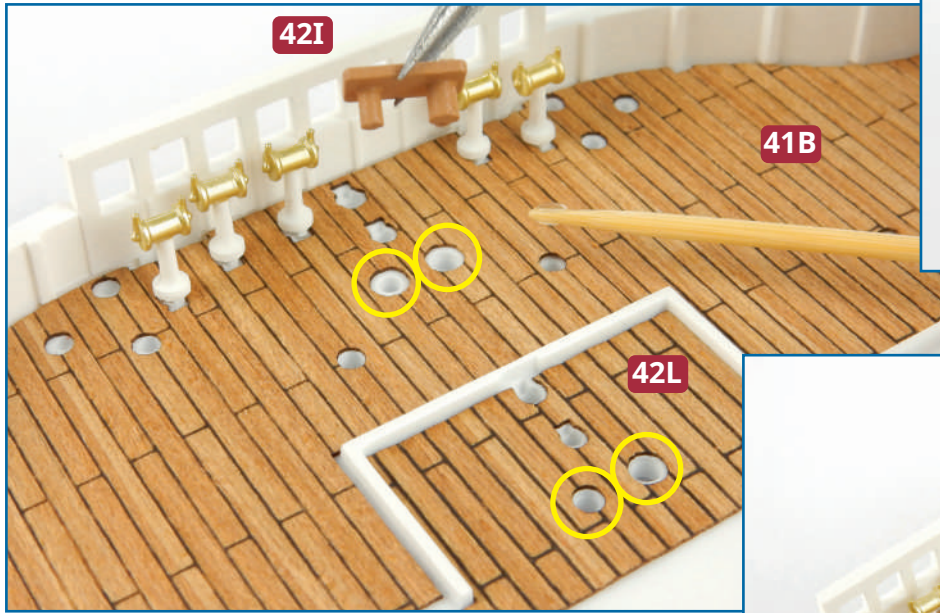

6 Take the two platforms **42I** and check how they fit in the pairs of holes in the decking **41B** and in the wheel house decking **42L** (circled). One peg on each platform is larger than the other, and has to be fitted into the appropriate hole. Fix in place with a little glue if necessary.

7 The two binnacles **42G** fit in the central holes at the front of the bridge and wheel house (circled). Again, there are rectangular pegs beneath the rims at the base of each binnacle that fit into the shaped holes. Use a little glue to hold the binnacles in place if necessary.

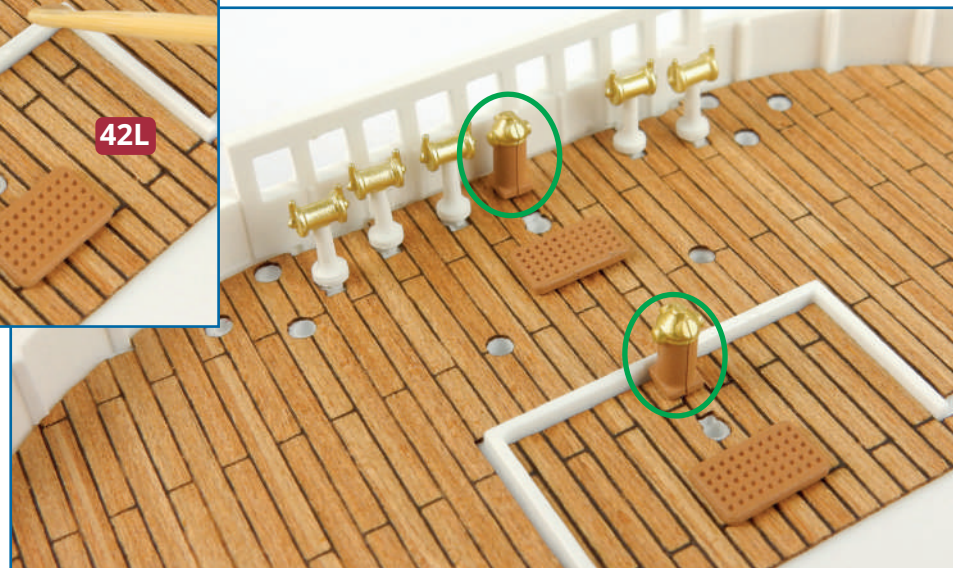
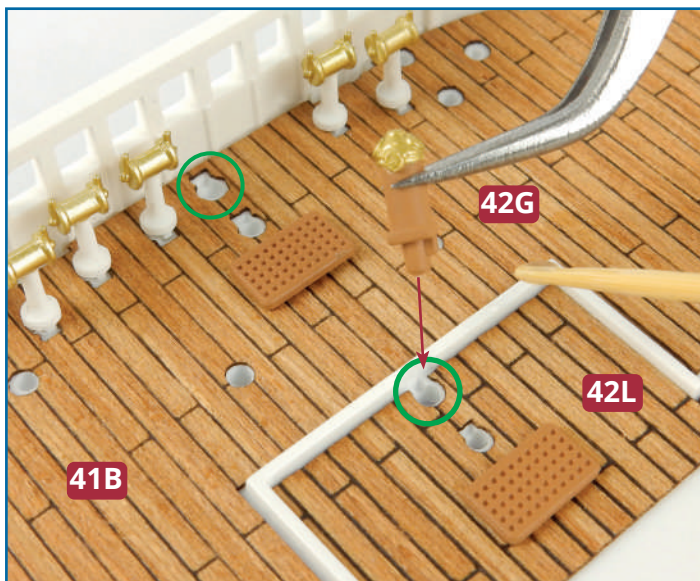

★ STEP-BY-STEP INSTRUCTIONS ★

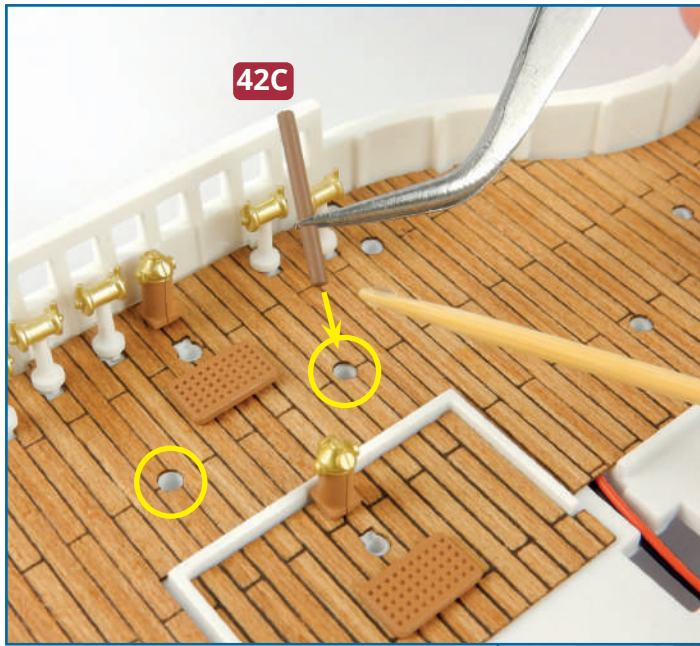

8 Next fit the two pillars **42C** into the holes in front of the wheel house (circled, left and below). Each pelorus **42H** fits into a hole on the far left and on the far right of the bridge (below left and bottom). Glue the parts in place if necessary.

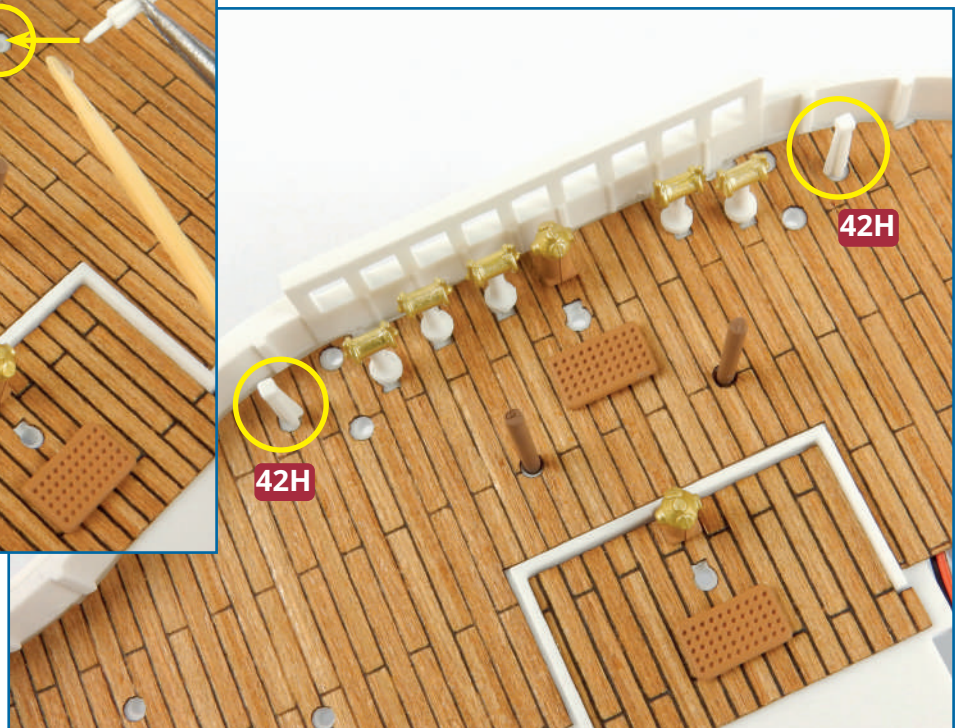
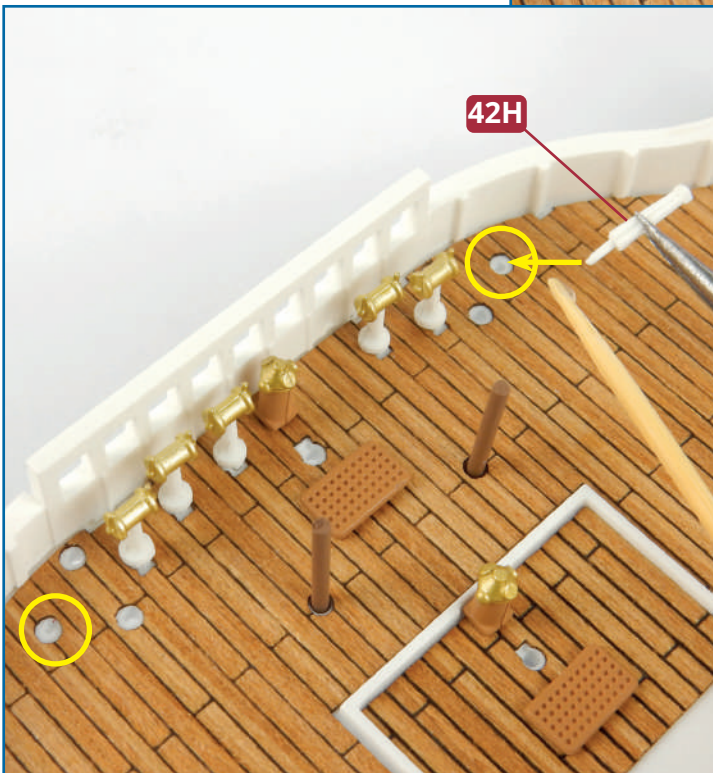
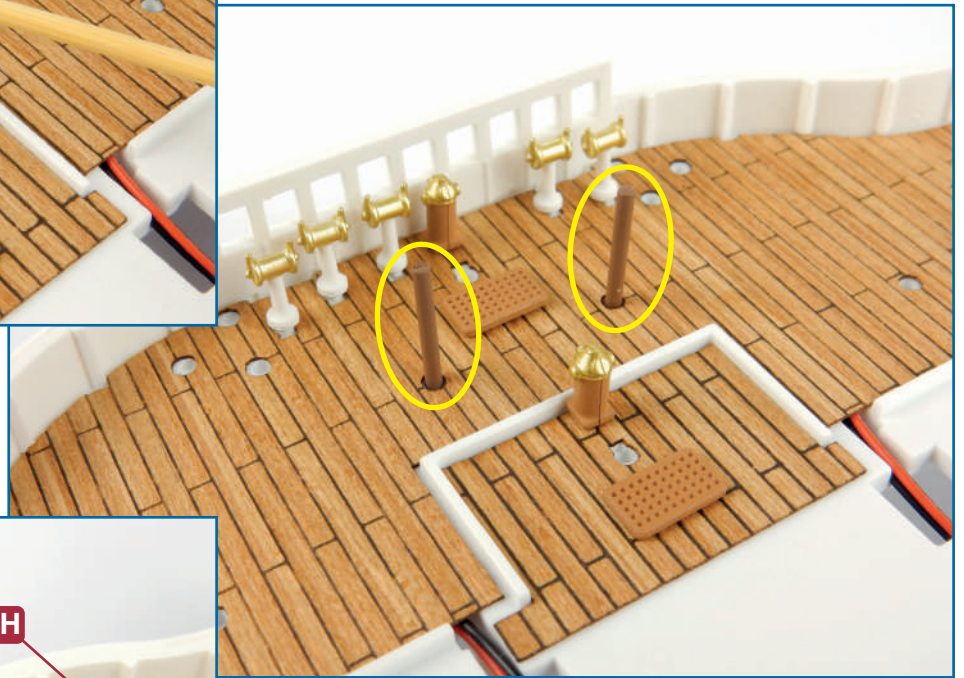

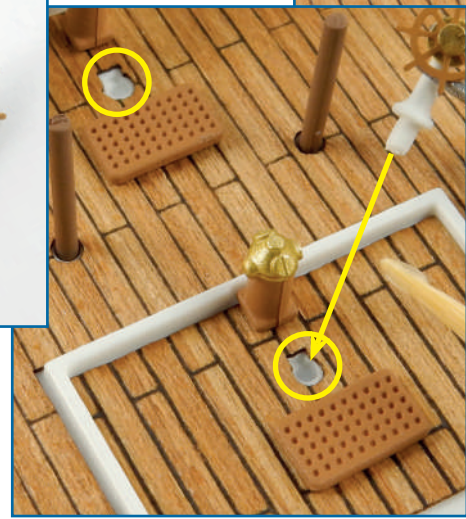
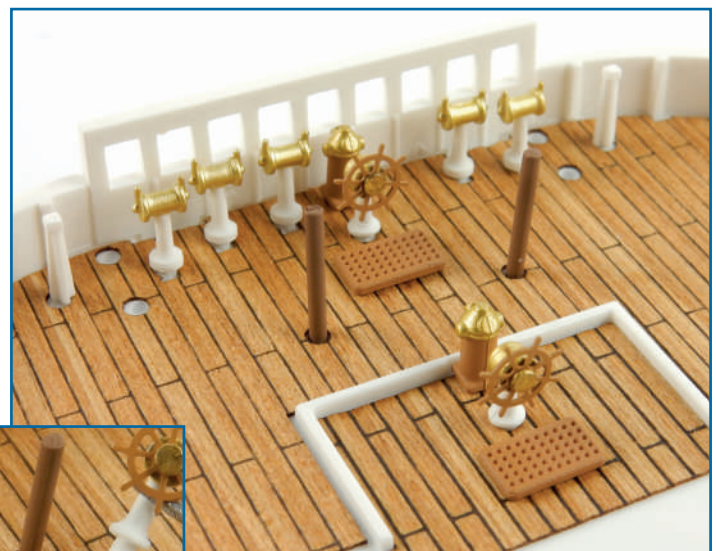
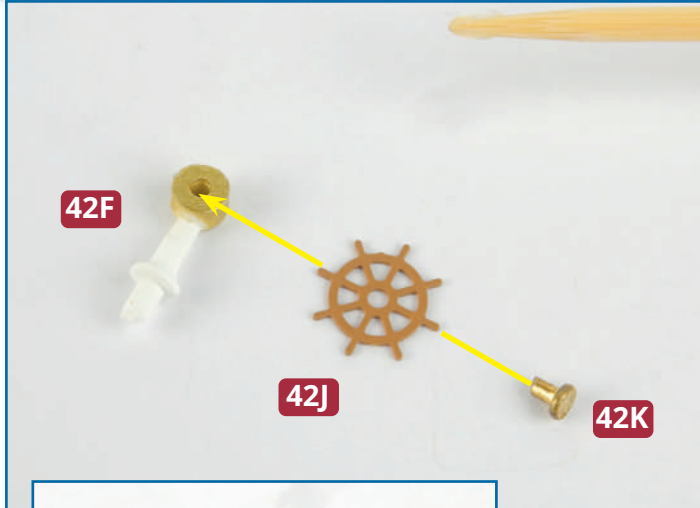
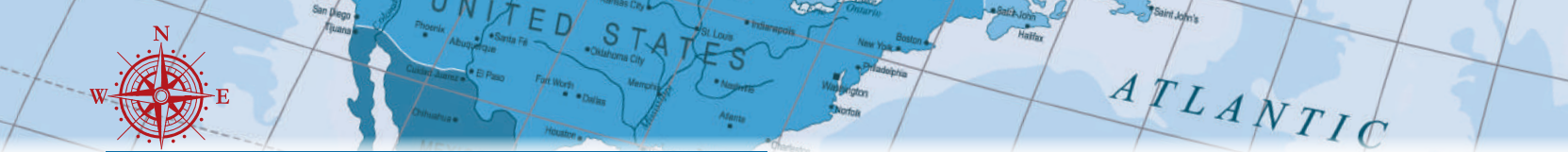

9 Fit each hub **42K** into the centre of a wheel **42J**, then apply a little superglue to the pin of each hub and fix in place on a steering wheel column **42F**. The steering columns fit into shaped holes in front of the platforms (circled, near left). Fix in place with a little glue if necessary. The photo above shows the bridge with all the details in place.

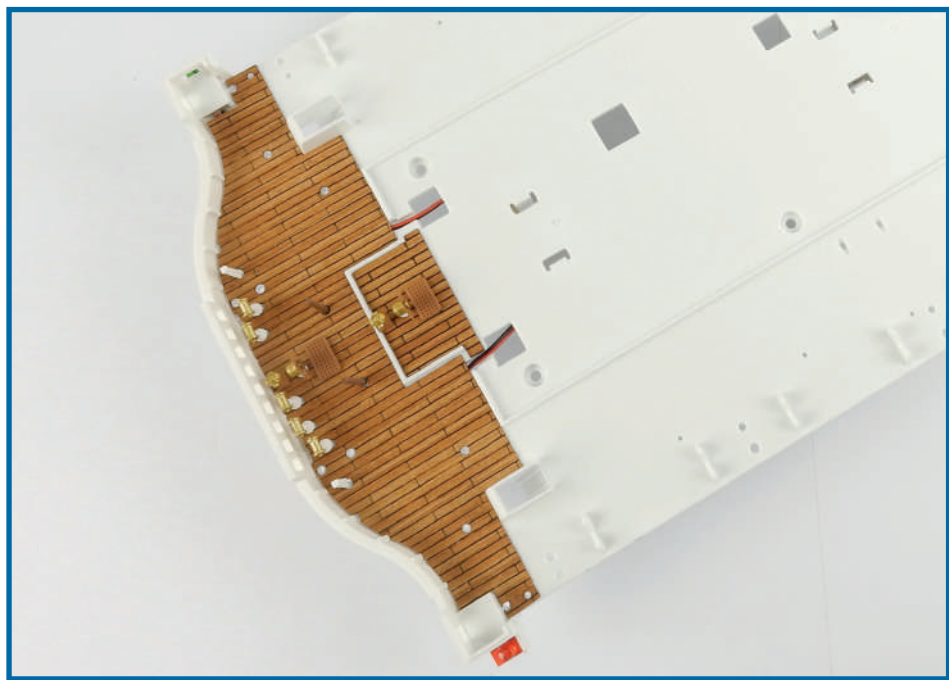

Completed work

Navigational instruments have been fitted in the bridge and the wheel house.

BRIDGE BULKHEADS

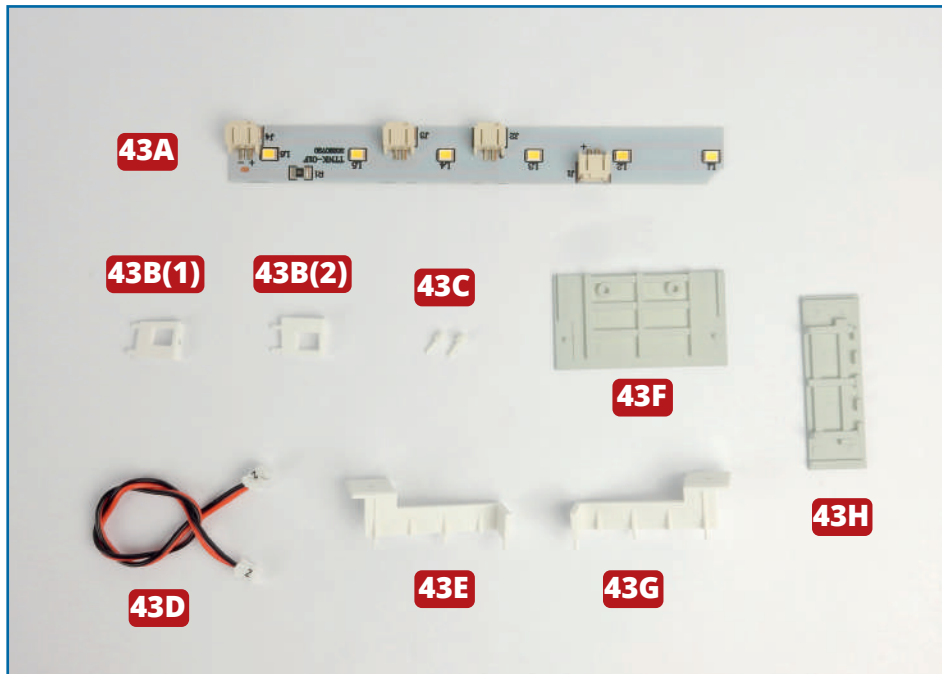

PARTS IN THIS ISSUE

- 43A** LED Strip
- 43B(1)** Bulkhead A (port)
- 43B(2)** Bulkhead B (starboard)
- 43C** Lamp (x 2)
- 43D** LED cable (marked Z)
- 43E** Port bridge bulkhead
- 43F** Panel 1
- 43G** Starboard bridge bulkhead
- 43H** Panel 2

1 Take the forward section of the boat deck assembly from the previous issue and the two bulkheads **43E** and **43G**. Check the fit of the pegs on the base of the bulkheads in the holes in the deck **41A** (circled). When you are happy with the fit, apply a little glue to each of the pegs and to the roof of the structure at the end of the bulkhead (blue arrow, below) and fix in place.

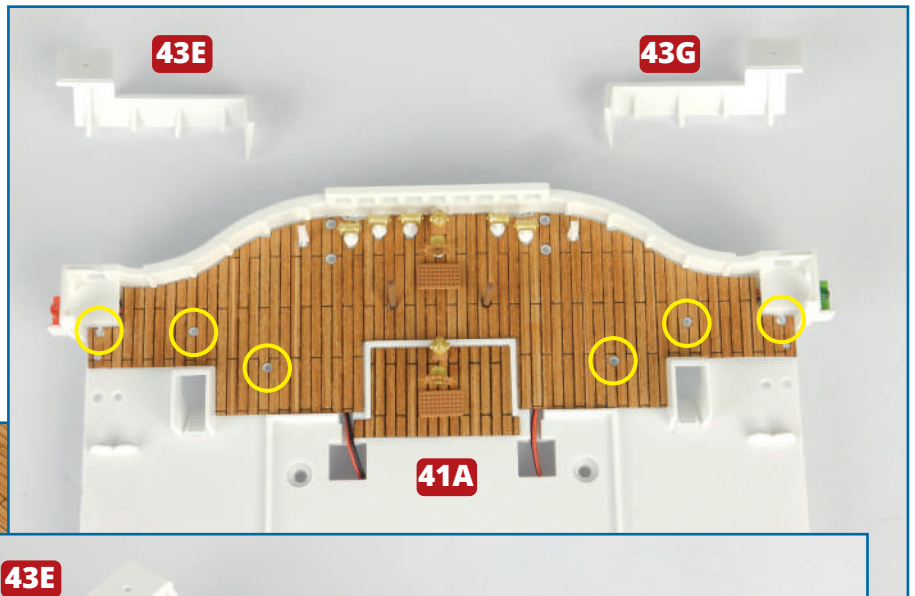
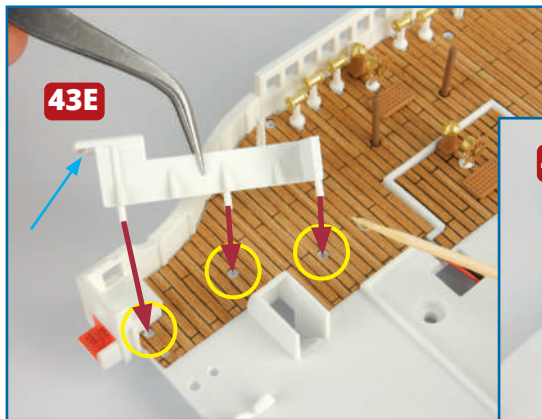

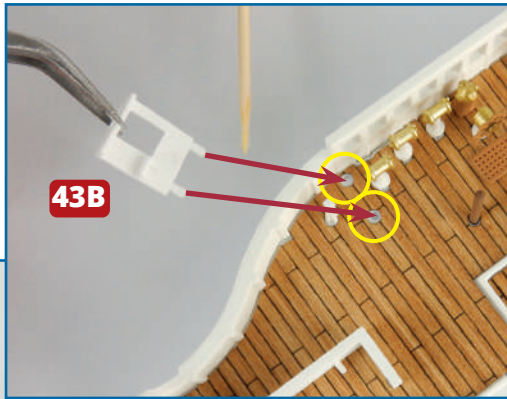

2 Now take the two short bulkheads **43B(1)** and **43B(2)**. Check the fit of the pegs on the base of the bulkheads in the pairs of holes on the bridge: note the position of the shelf and window on each of the bulkheads. When you are happy with the fit, glue the pegs in place.

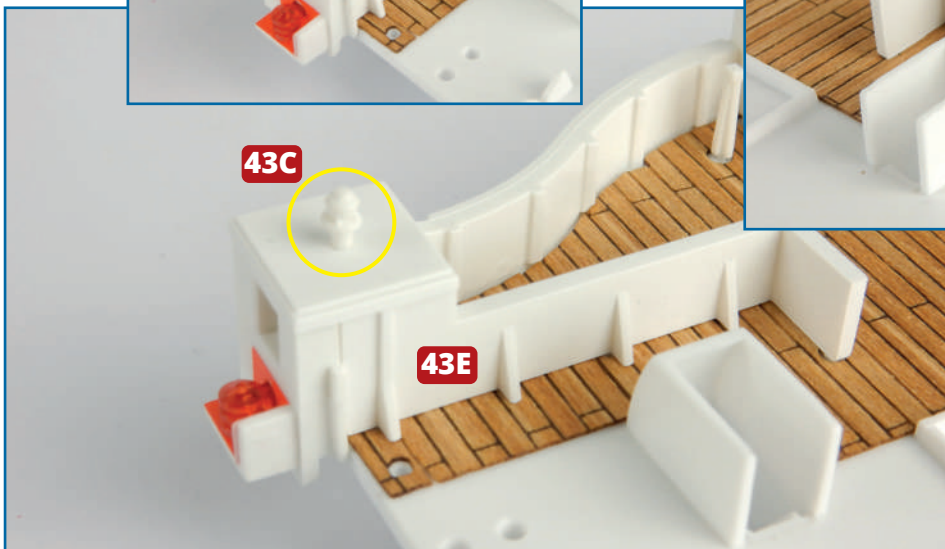
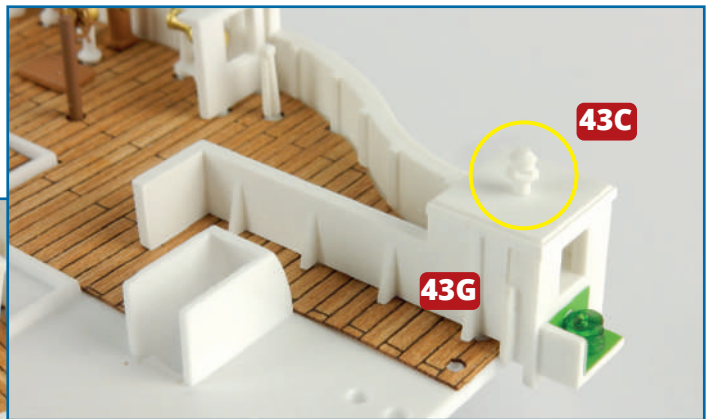
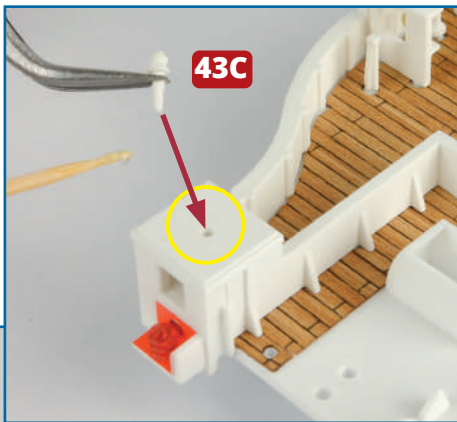
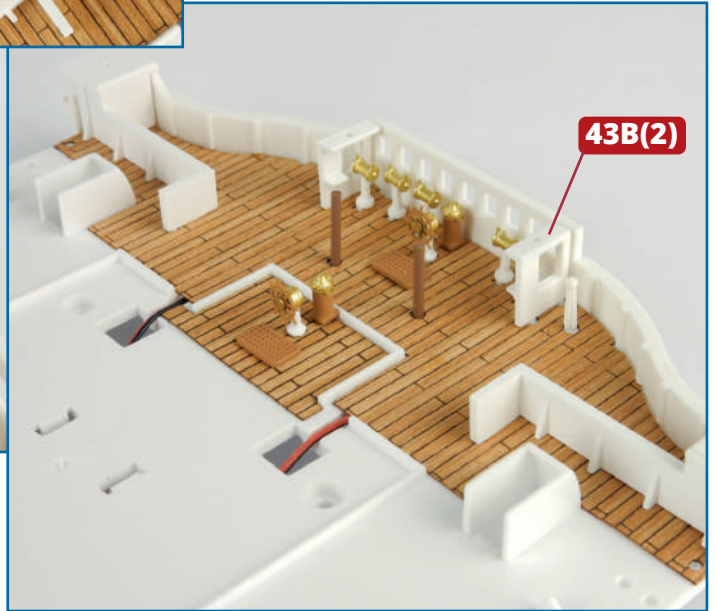

3 The lamps **43C** fit on the roof of the structures on each side of the bridge (on the ends of bulkheads **43E** and **43G**). Glue in place.

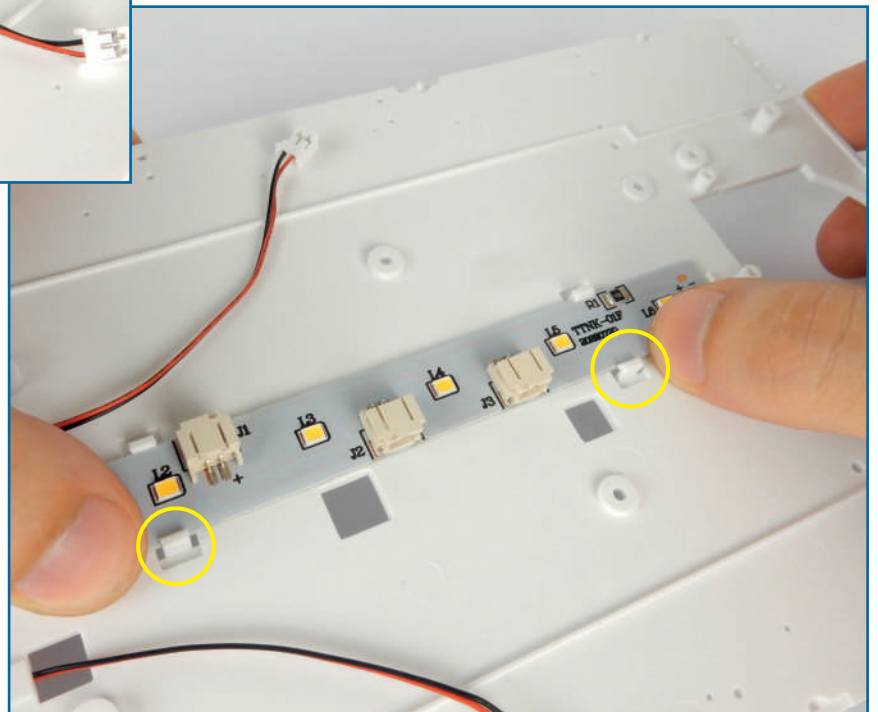
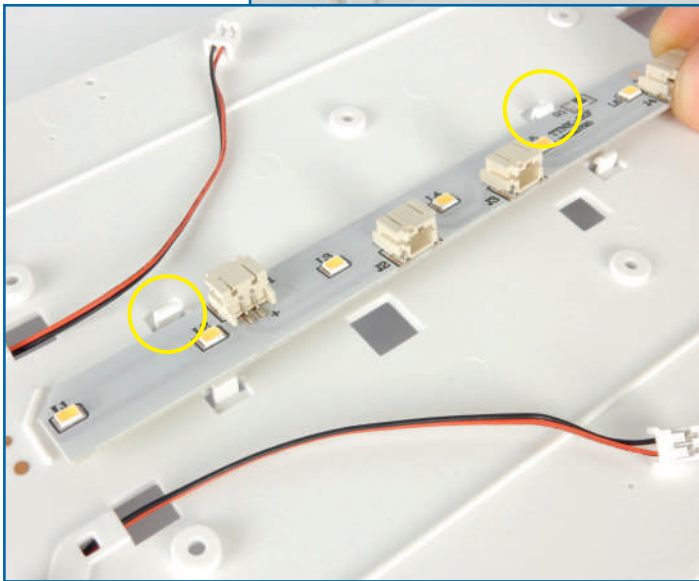
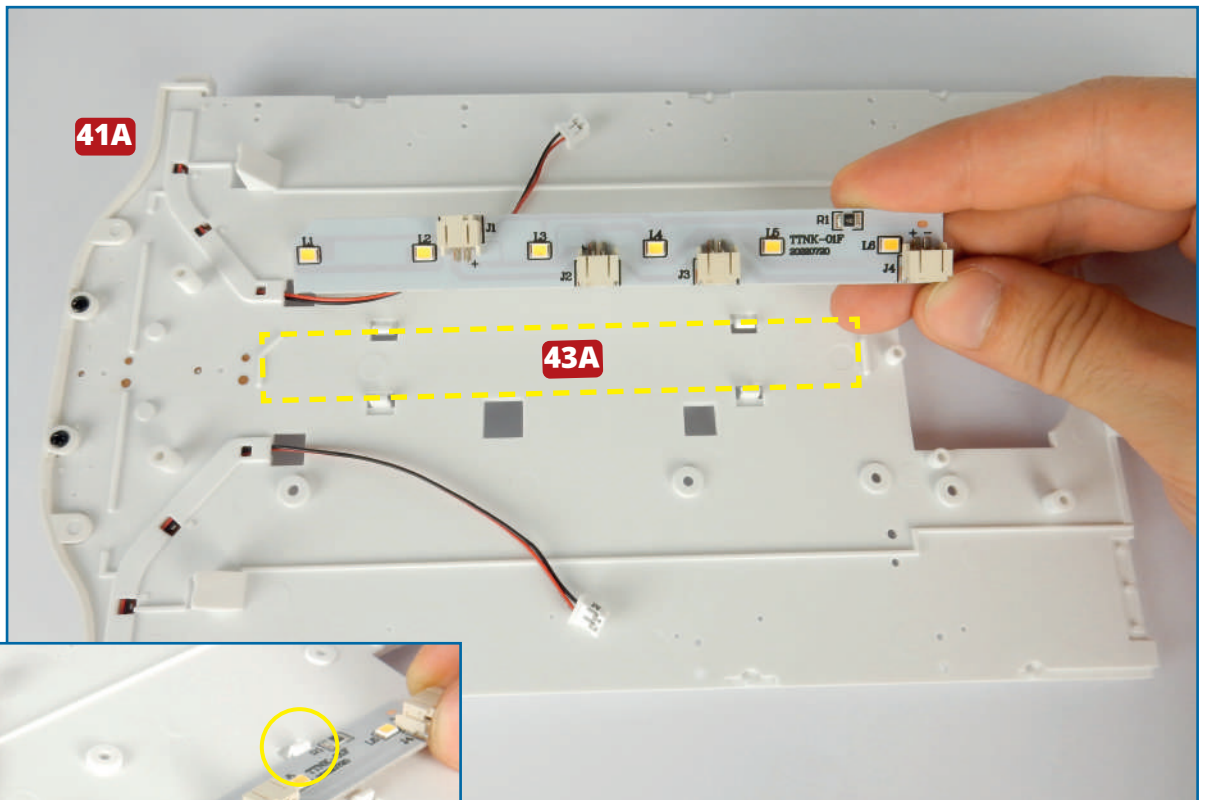

4 Carefully turn the boat deck over and identify the position for the LED strip **43A** on the underside of the deck **41A**. Fit one long edge of the strip **43A** under two of the clips, then fit the other side of the strip **43A** under the other two clips.

NOTE: You may need to apply pressure, so place the deck on your work surface with the bridge hanging over the edge of the surface to avoid damaging any of the assembly.

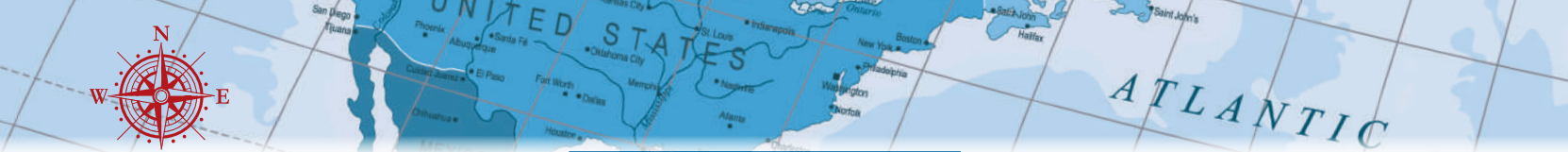

5 Fit the connectors on the ends of the navigation light cables into sockets in the strip **43A**. The connector marked **L** goes into the socket marked **J1** and the connector marked **M** goes into the socket marked **J2**.

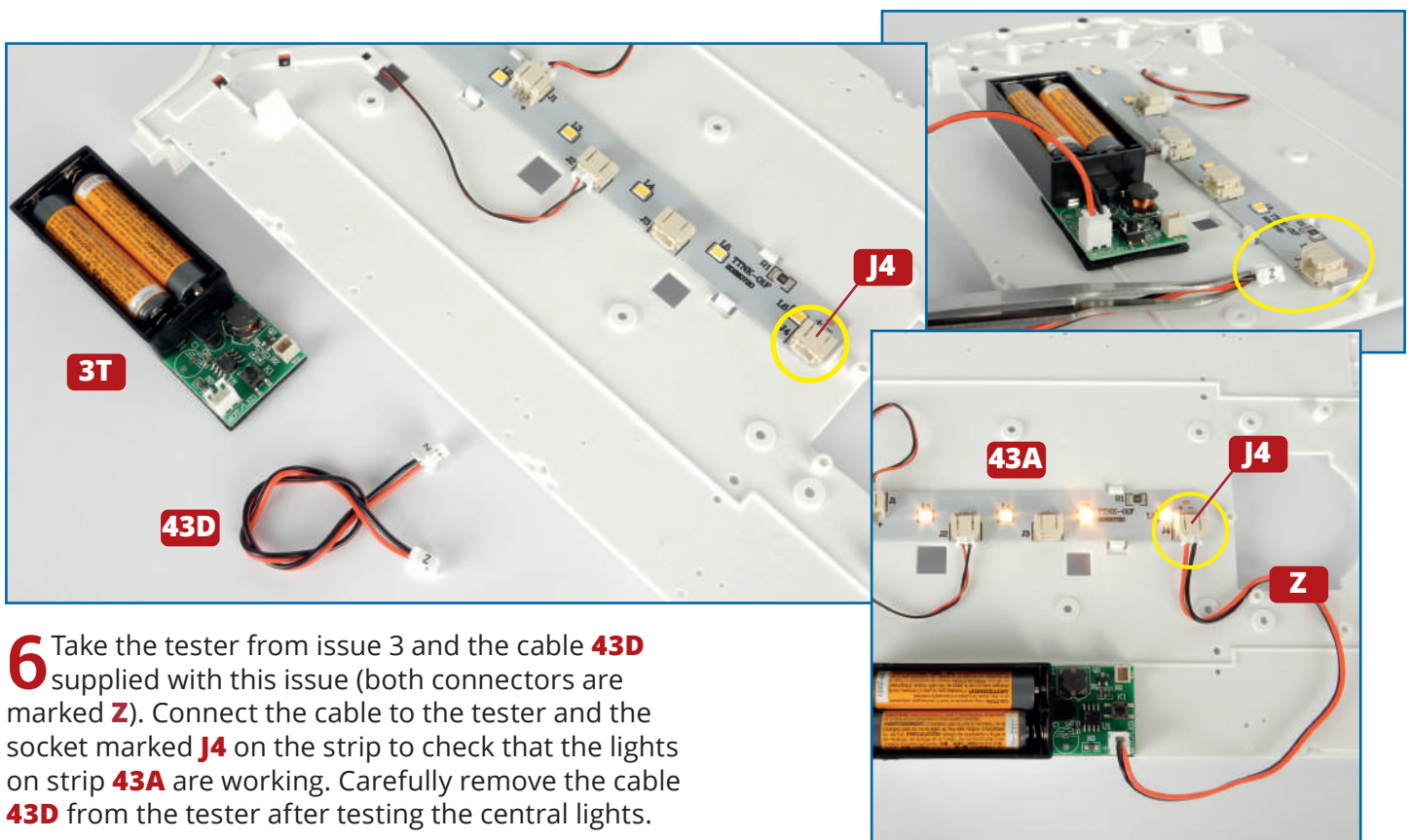
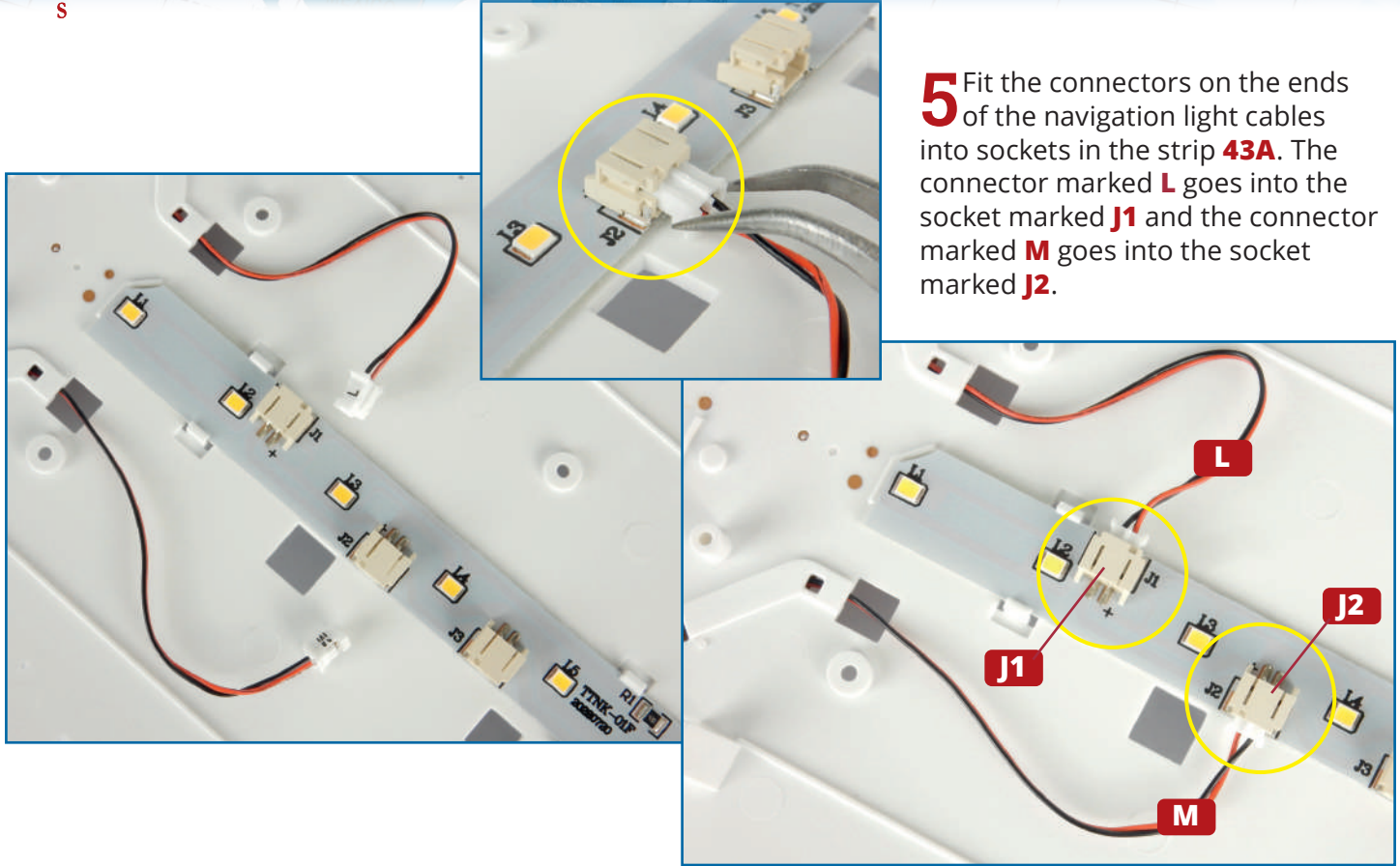

6 Take the tester from issue 3 and the cable **43D** supplied with this issue (both connectors are marked **Z**). Connect the cable to the tester and the socket marked **J4** on the strip to check that the lights on strip **43A** are working. Carefully remove the cable **43D** from the tester after testing the central lights.

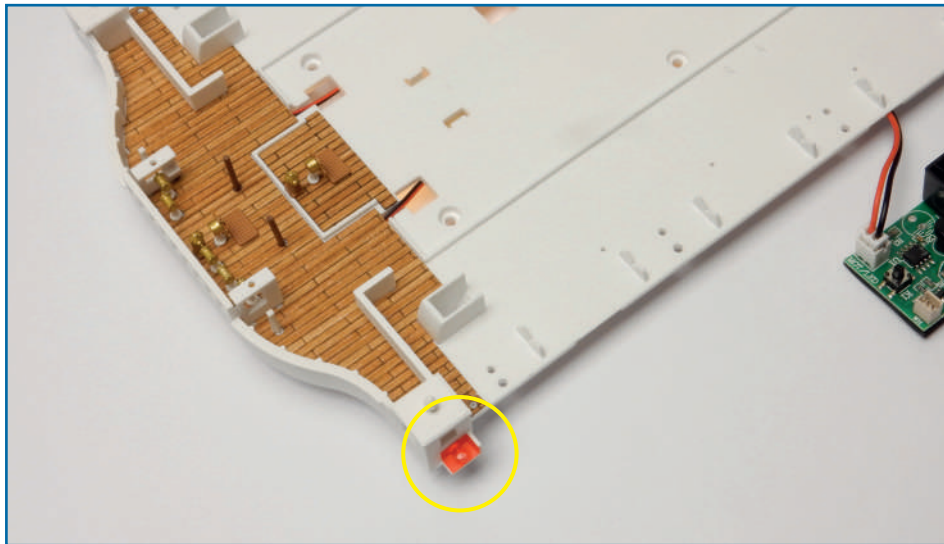

7 Test each of the navigation lights in turn by plugging first the connector marked **L** and then the connector marked **M** into the tester. Handle the connectors with care – it may help to use a pair of fine pliers to remove them. Disconnect the tester and remove the batteries after testing.

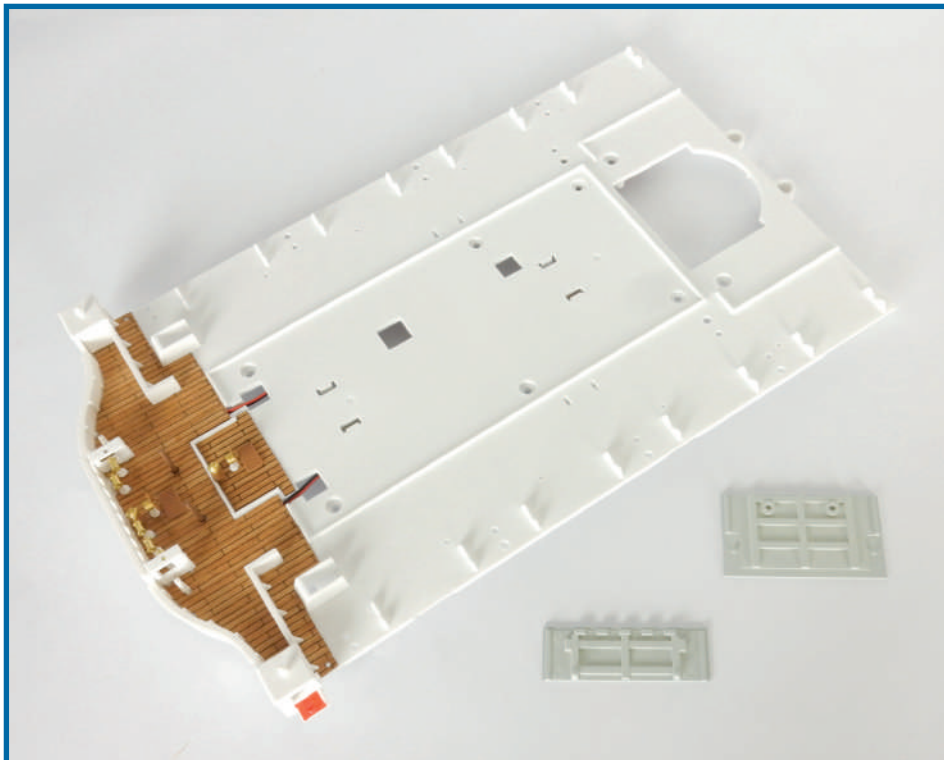
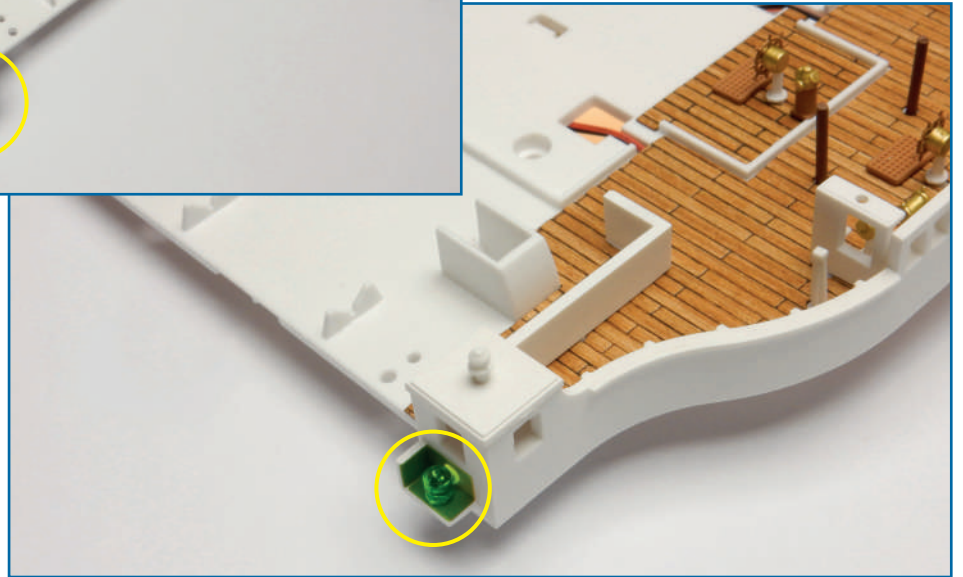

Completed work

More work has been completed on the bridge and boat deck, with a lighting strip on the underside of the deck. Store the panels **43F** and **43H** carefully until needed.



CENTRAL SECTION OF THE BOAT DECK

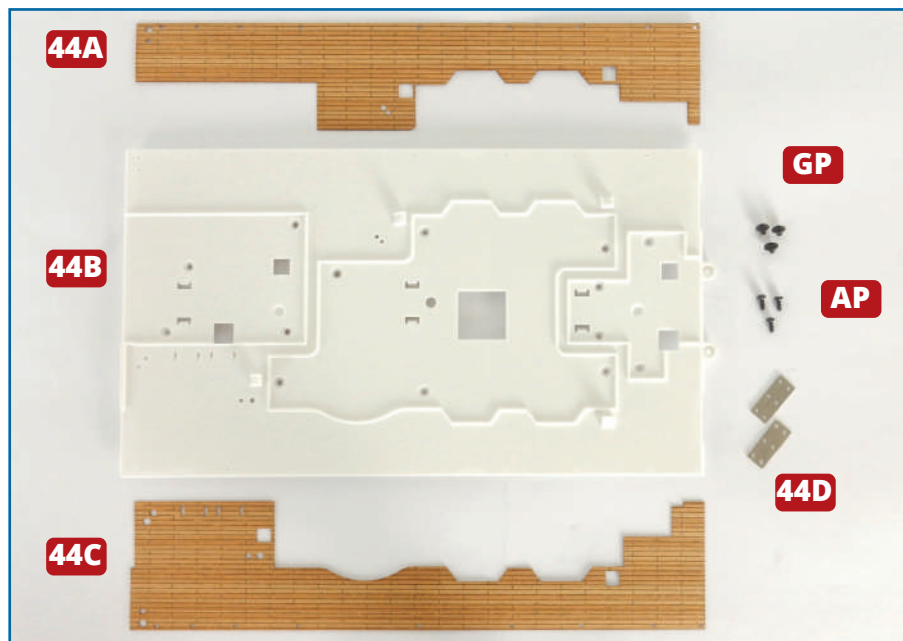

PARTS IN THIS ISSUE

44A Decking for starboard side

44B Central section of boat deck

44C Decking for port side

44D Connecting plates (x 2)

GP Three 3 x 3mm PWB screws (1 spare)

AP Three 3 x 5mm PB screws (1 spare)

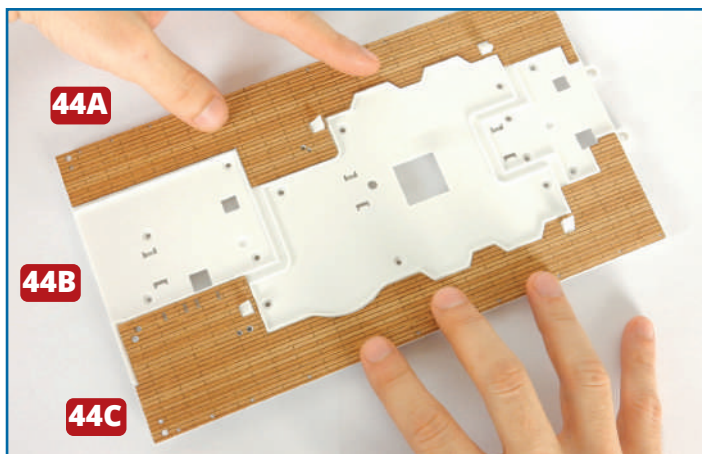

1 Take the central section of the boat deck **44B** and the decking **44A** and **44C**. Check the fit and then, working on one side at a time, remove the backing paper and stick the decking in place, ensuring that all the holes are aligned.

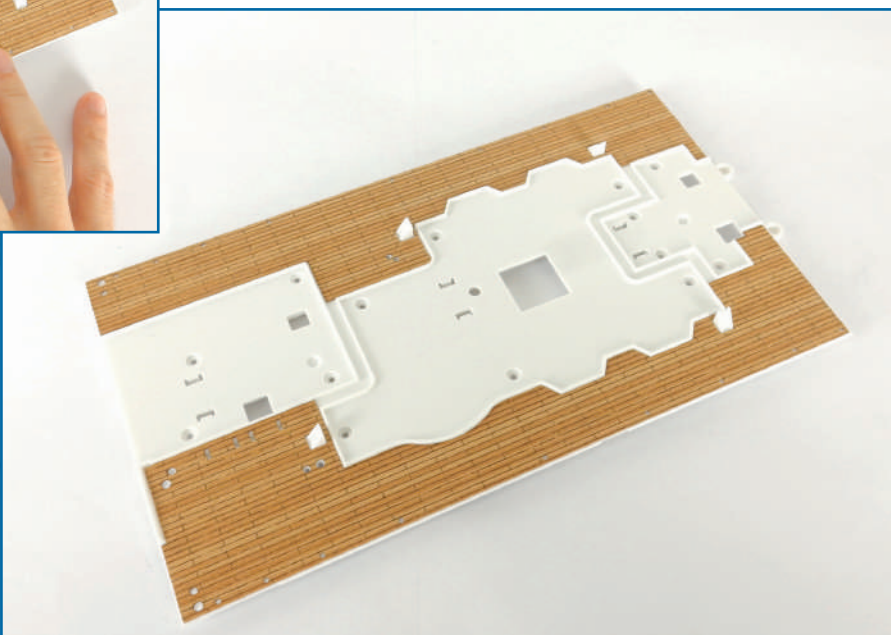
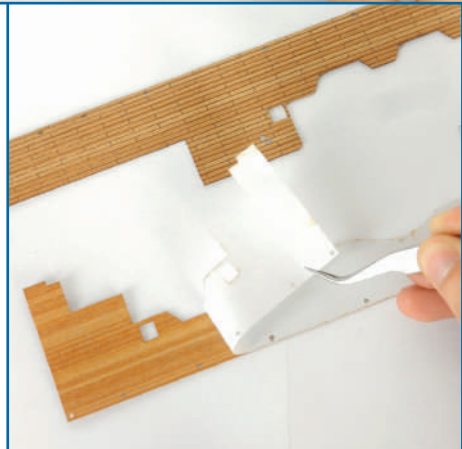

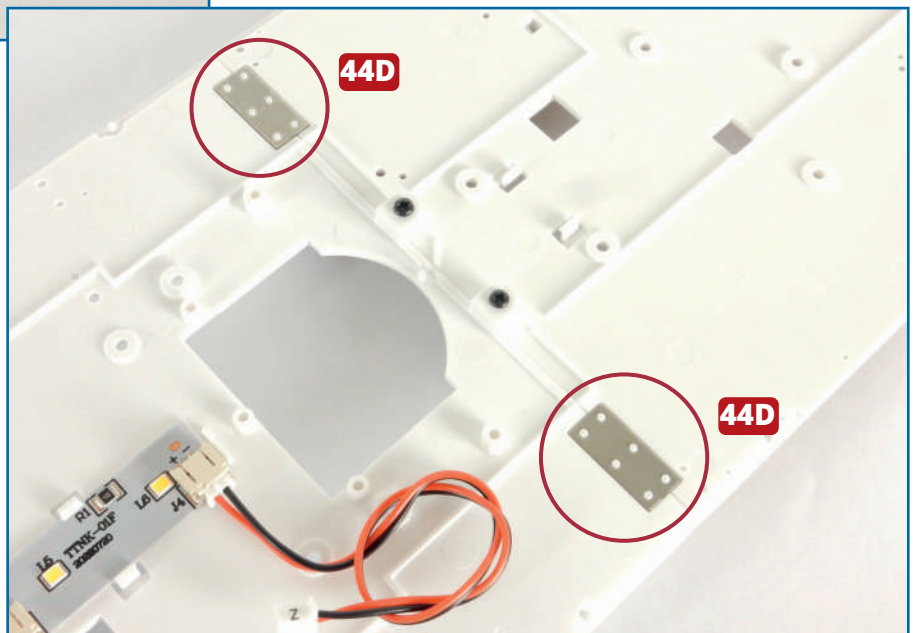
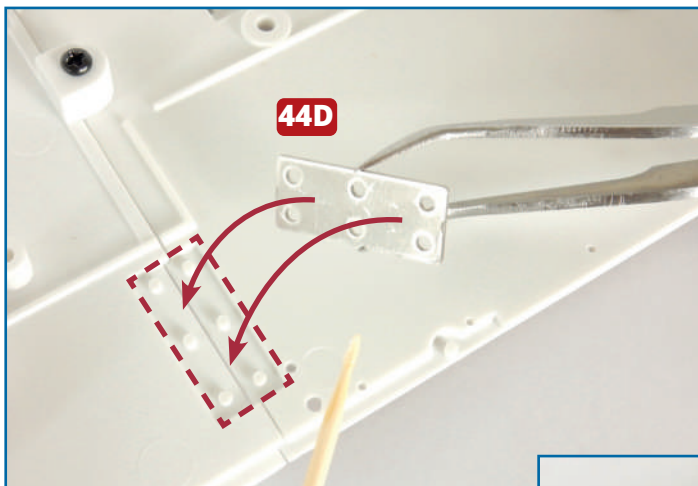
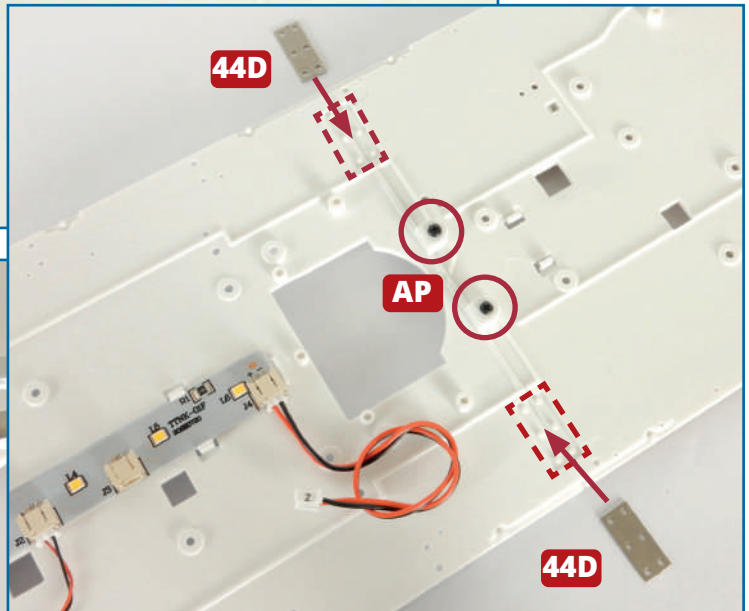
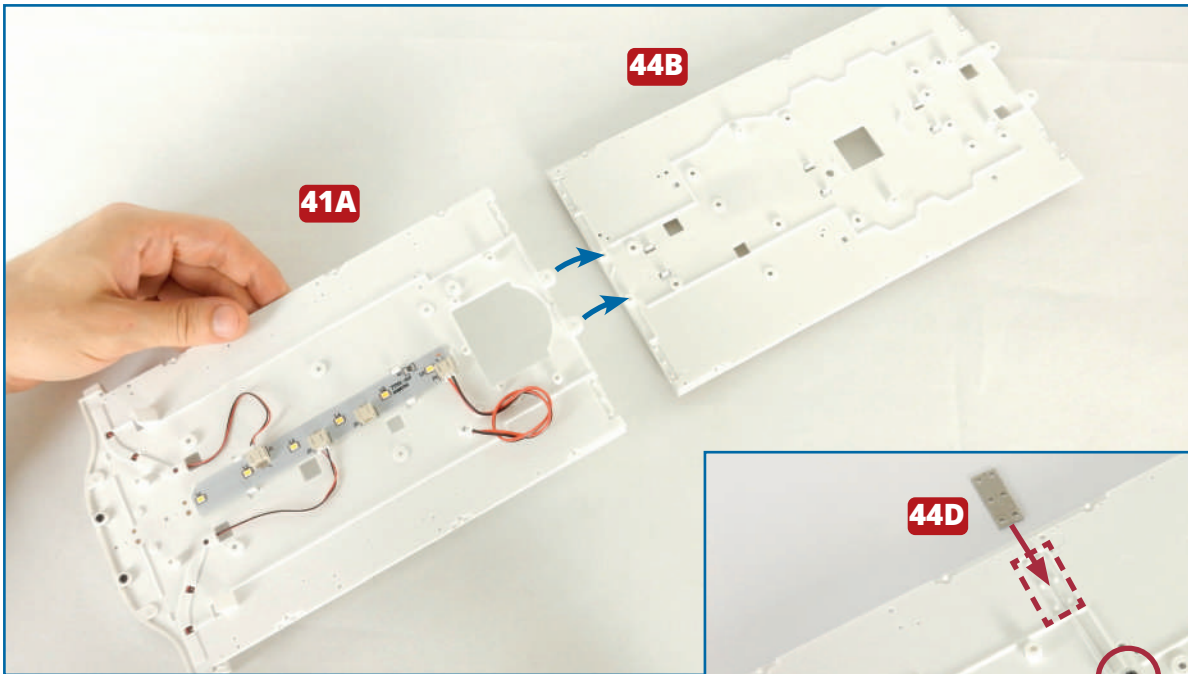

2 Take the forward section of the boat deck from the previous issue. Taking care not to damage any of the parts that have been assembled, turn the deck sections upside down. Fit the tabs with screw holes on the aft end of deck section **41A** over the raised screw sockets on the forward end of deck section **44B** (blue arrows, top). Fix in place with two **AP** screws (circled, above right). To strengthen the assembly, take the two connecting plates **44D** and glue them in place in the recesses across the joint (above and right).

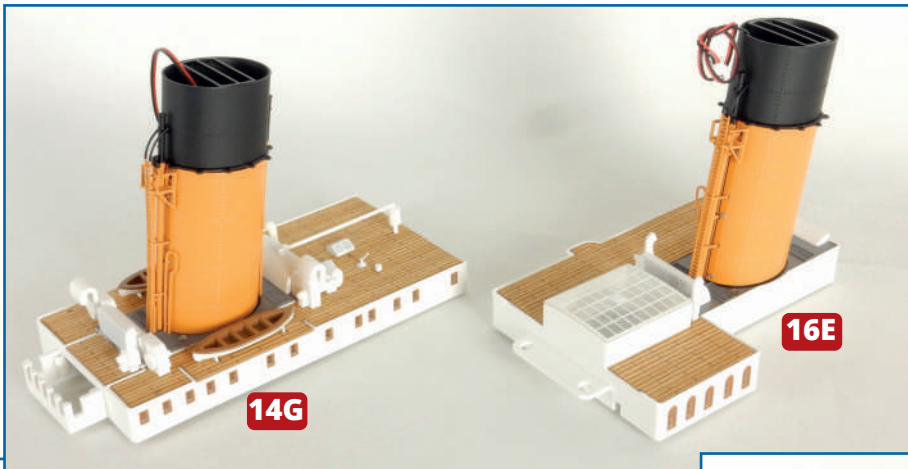

3 Take the two superstructure sections from issue 22. Join the officers' quarters **14G** to the stairwell superstructure **16E** using two **GP** screws, as shown below. You will have to turn the parts on their sides to fix them together, so take care not to damage the assembly.

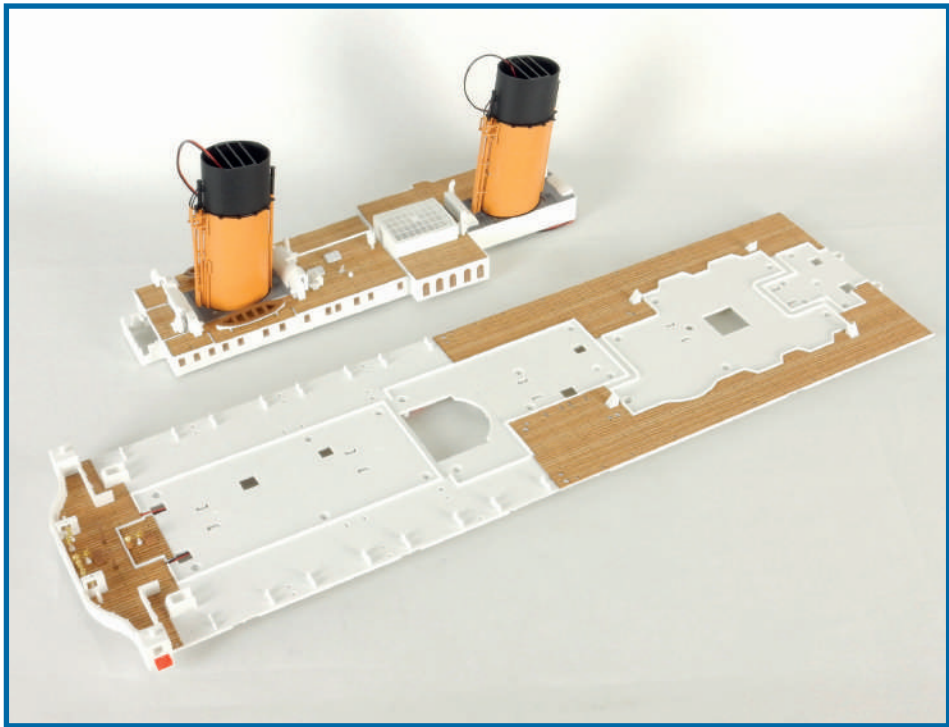
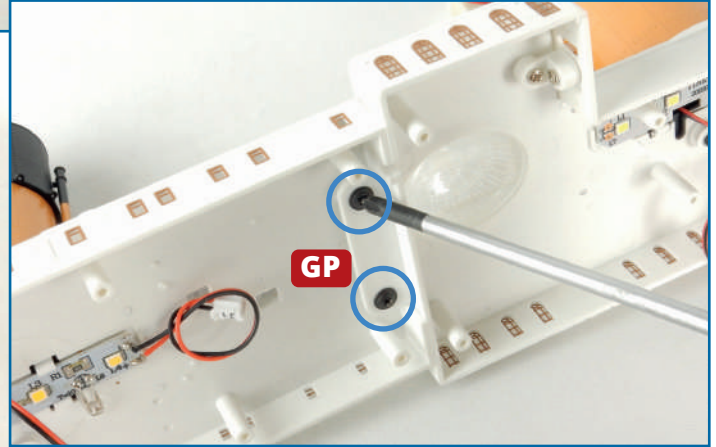
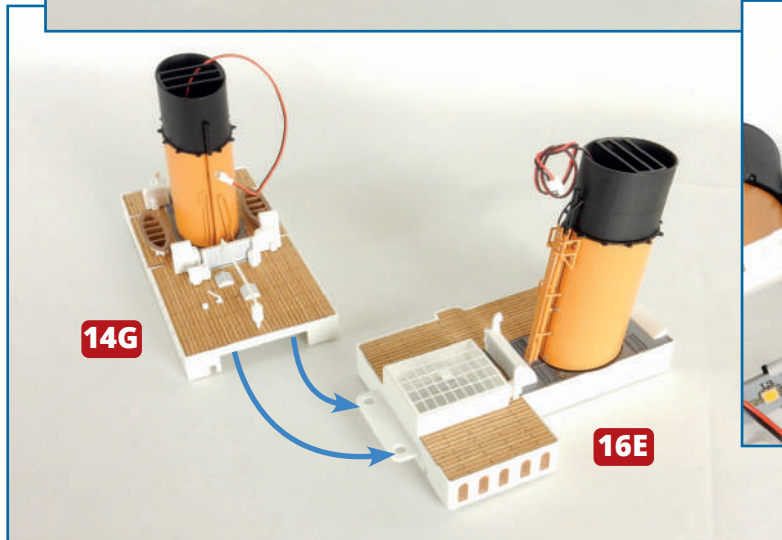

Completed work
The forward section of the boat deck has been fixed to the central section and two sections of the superstructure have been joined together.