



Pack 06

BUILD INSTRUCTIONS

**STAGE 41: THE REAR LEFT WHEEL -
'64 KNOCK-OFF**

**STAGE 42: THE REAR RIGHT WHEEL -
'64 KNOCK-OFF**

**STAGE 43: FITTING THE REAR LEFT
FENDER WELL**

**STAGE 44: FITTING THE REAR RIGHT
FENDER WELL**

**STAGE 45: ASSEMBLING THE BATTERY
AND COOLANT RESERVOIR**

**STAGE 46: PREPARING THE FRONT
REINFORCEMENT FRAME AND WATER HOSE**

**STAGE 47: FITTING THE FAN COVER
AND RADIATOR**

STAGE 48: MOUNTING THE ENGINE

STAGE 49: INSTALLING THE FUEL TANK

General Motors Trademarks used under license by Premium & Collectibles Trading Co. Ltd on behalf of Agora Models.

**AGORA
MODELS®**

Advice from the experts

Spare screws are included with each part. Occasionally, you may be instructed to keep spare or unused screws for a later stage. Keep these spares in a safe place and label them correctly.

Please make sure you don't mix up the screws. They look quite similar, but the threads do vary slightly. Using the wrong screws may damage the parts.

When securing parts together using multiple screws, fit each screw loosely to ensure all the parts are correctly aligned before gently tightening them firmly, but not overtight, in the order in which you placed them.

The screwdriver can be magnetized by stroking it with a magnet (fridge magnet, etc.) enabling it to hold the screws and make assembly easier.

If a screw is tight going into a metal part, do not force it as you may shear the head off. Remove it and put a tiny smear of Vaseline, soap or light oil on the thread. That will lubricate it and make it easier to drive home.

During the course of this build, you will receive many pieces that you will assemble immediately – following the instructions in the corresponding stage – and other pieces that you should store safely to one side, for use in future assembly stages.

Left and Right! When building your Corvette, the left- or right-hand side refers to that side as if you are sitting in the car.



WARNING: Some parts are assembled using magnets. These magnets can cause serious injury if they are swallowed. Keep away from children. If you suspect a magnet has been swallowed, seek medical help straight away.

Stage 41: The Rear Left Wheel – ‘64 Knock-Off

In this pack you will receive the rear set of ‘64 knock offs. The instructions for fitting them are provided, but you may prefer to keep the original set. The choice is yours! In this first stage you’ll assemble the rear left wheel.



STAGE 41 PARTS LIST

Name
Tyre
Kelsey Hayes wheel front
Inner wheel rim
Three-bar knock-off
Two-bar knock-off
Washer
CM screws x2
HM screws x3
RM screws x3

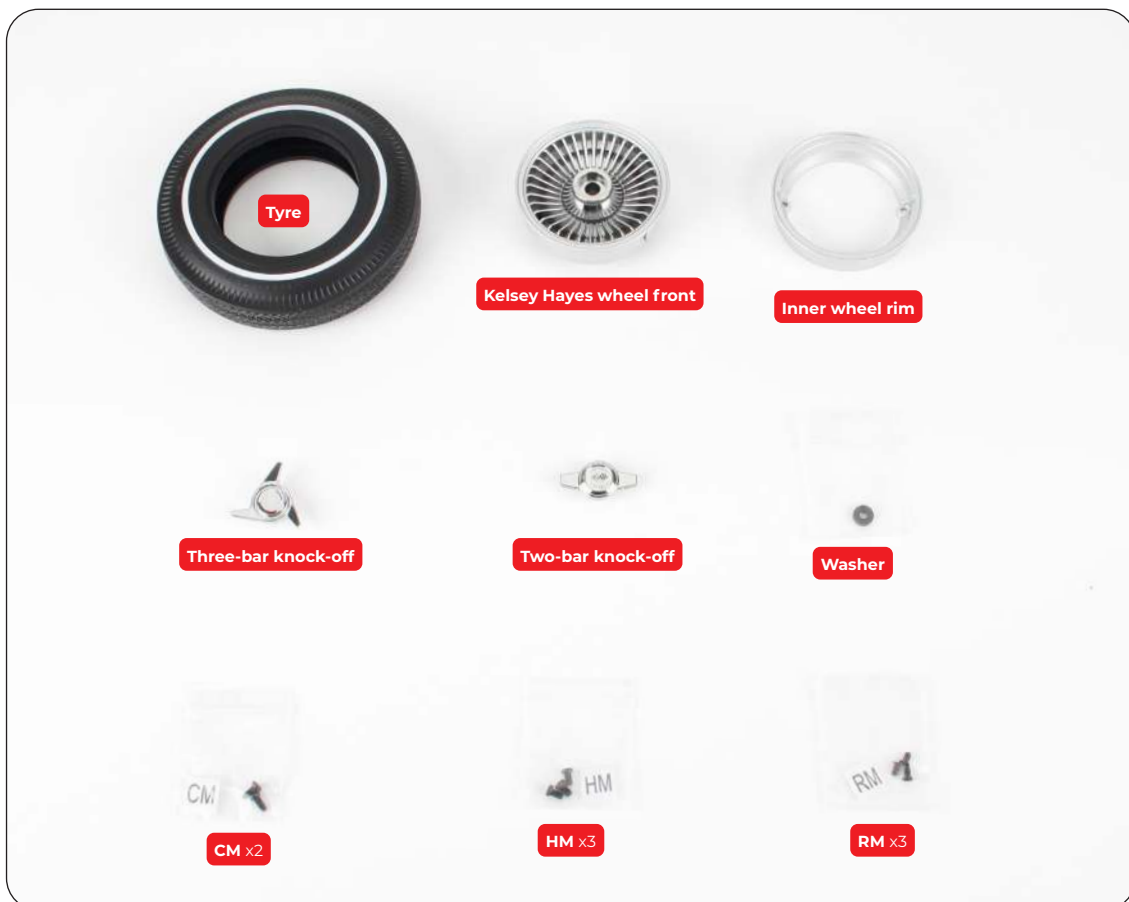

Stage 4: The Rear Left Wheel – '64 Knock-Off



Fit the wheel front onto the tyre.



Press until the wheel front is flush inside the tyre.

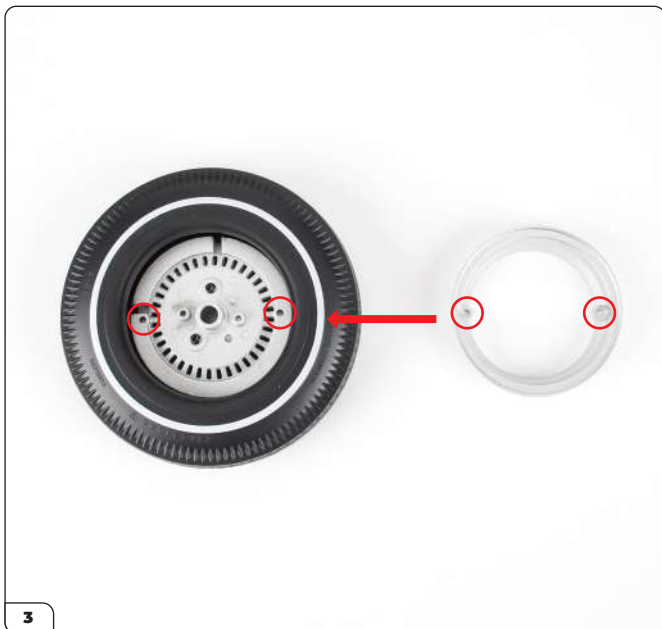

Flip the tyre over and fit the inner wheel rim by aligning the screw holes.

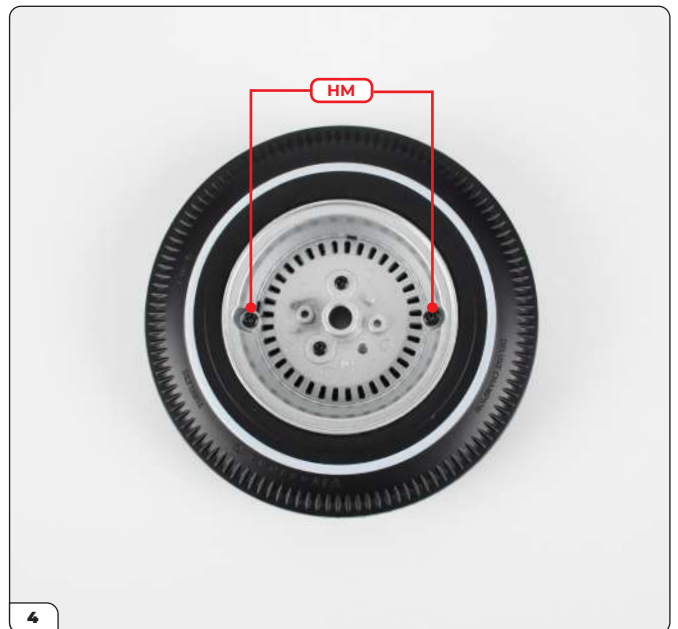

Secure the wheel rim using 2x HM screws.

Stage 41: The Rear Left Wheel – '64 Knock-Off

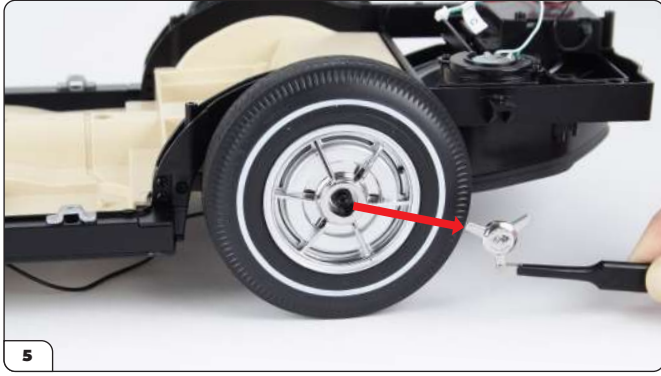

To fit the new wheel, start by removing the three-bar spinner from the original rear left wheel.



Unscrew the CM screw holding the wheel in place as shown.



Remove the wheel then store away the screw, washer and three-bar spinner. Place the wheel on the work surface as shown.



Unscrew the two RM screws holding the drum in place as shown.



Remove the brake drum as shown, then store away the screws.



Align the brake drum with the newly assembled wheel using the mounting pin and hole as a guide.

Stage 41: The Rear Left Wheel – '64 Knock-Off

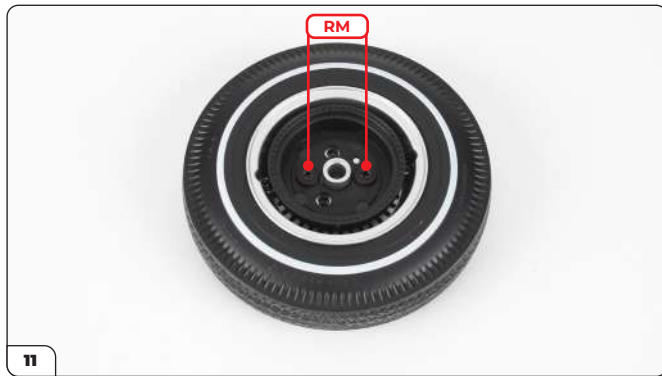

Fit the brake drum and fix using 2x RM screws.

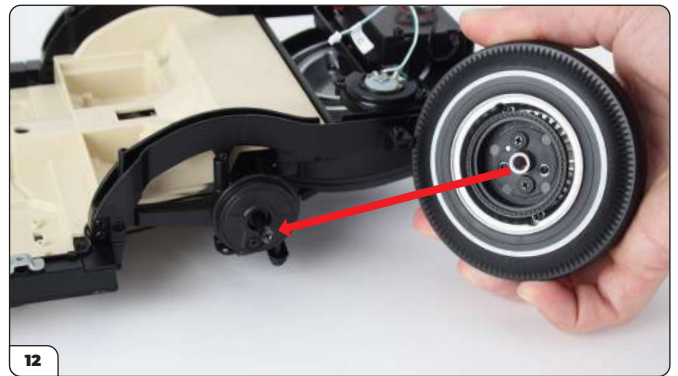

Fit the wheel onto the hub.

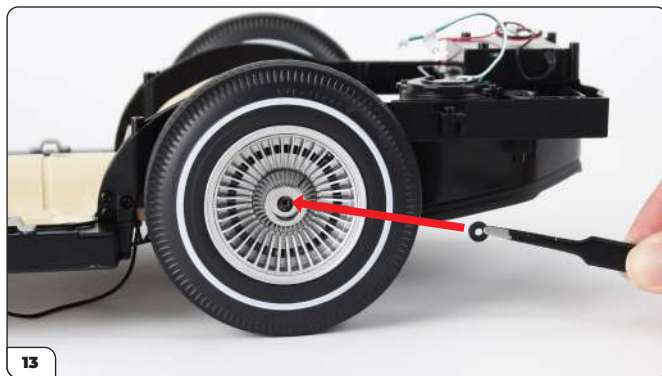

Place the washer over the screw column.

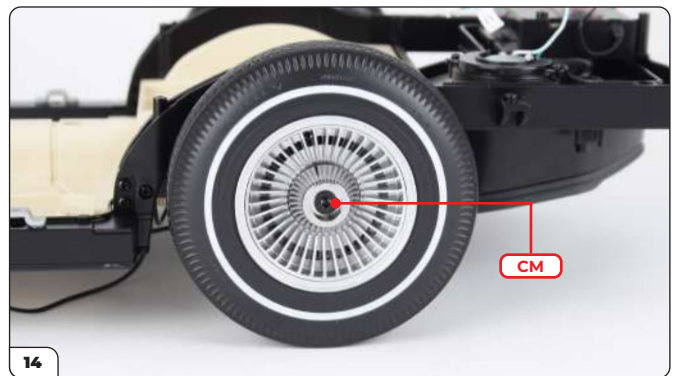

Secure the wheel using a CM screw.



From the two knock-offs, take the one matching those used in stages 33 and 34 for the front wheels.



Press the chosen knock-off in place as shown. This is a magnetic fit.

Stage 41: The Rear Left Wheel – '64 Knock-Off

STAGE COMPLETE



Stage 42: The Rear Right Wheel – '64 Knock-Off

In the next stage, you'll repeat the same process to fit the rear right '64 knock-off wheel.



STAGE 42 PARTS LIST

Name
Tyre
Kelsey Hayes wheel front
Inner wheel rim
Three-bar knock-off
Two-bar knock-off
Washer
CM screws x2
HM screws x3
RM screws x3

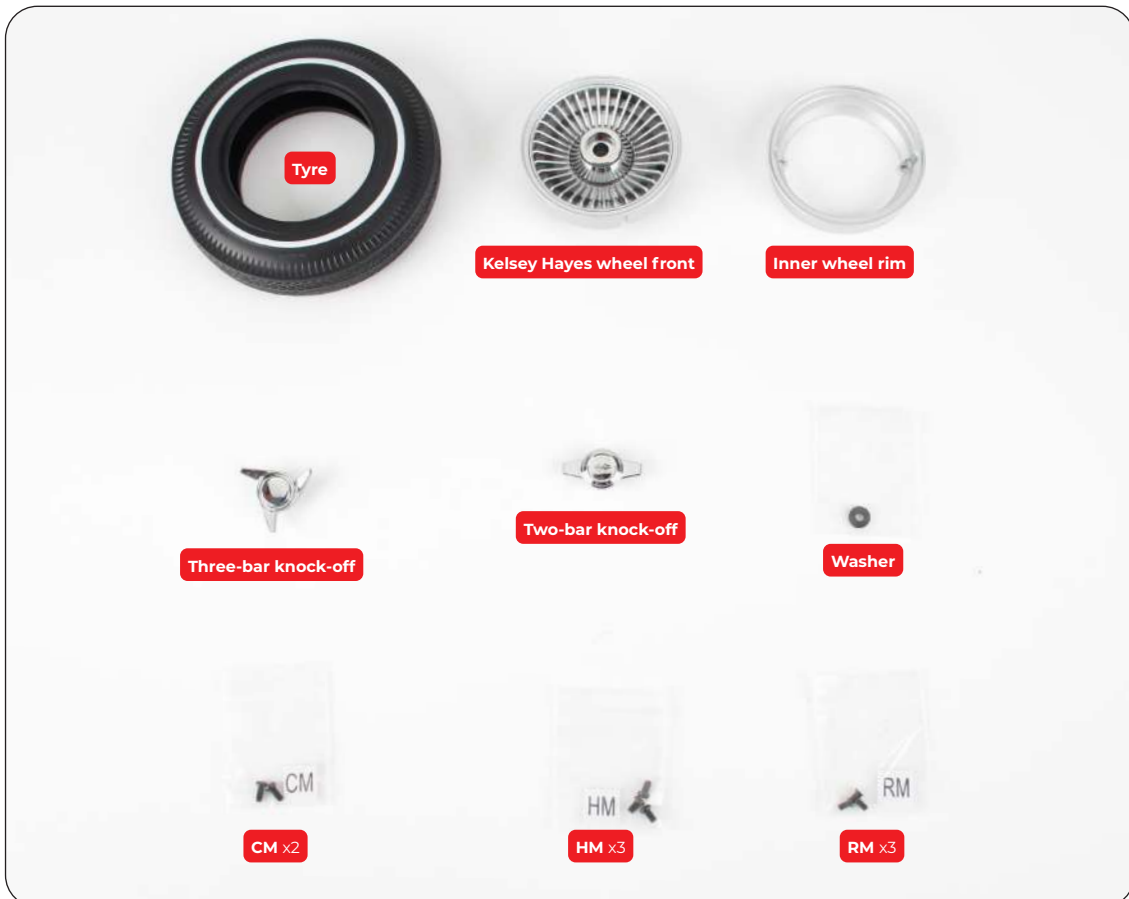

Stage 42: The Rear Right Wheel – '64 Knock-Off



Fit the wheel front onto the tyre.



Press until the wheel front is flush inside the tyre.

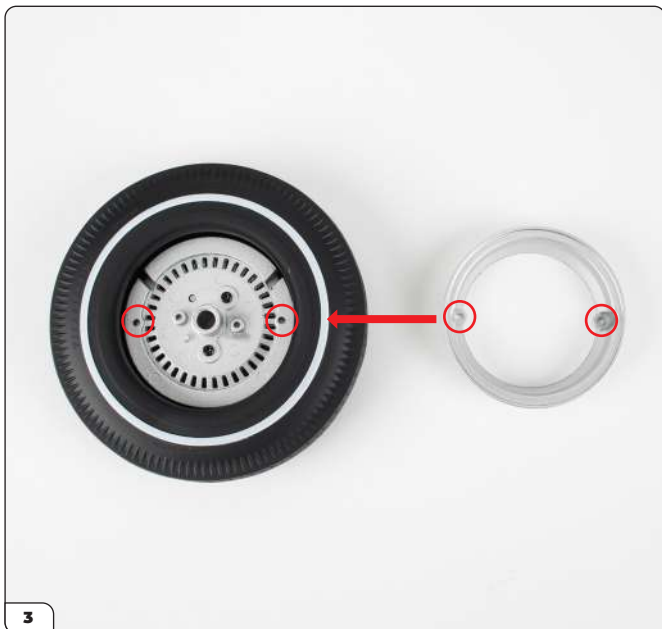

Flip the tyre over and fit the inner wheel rim by aligning the screw holes.

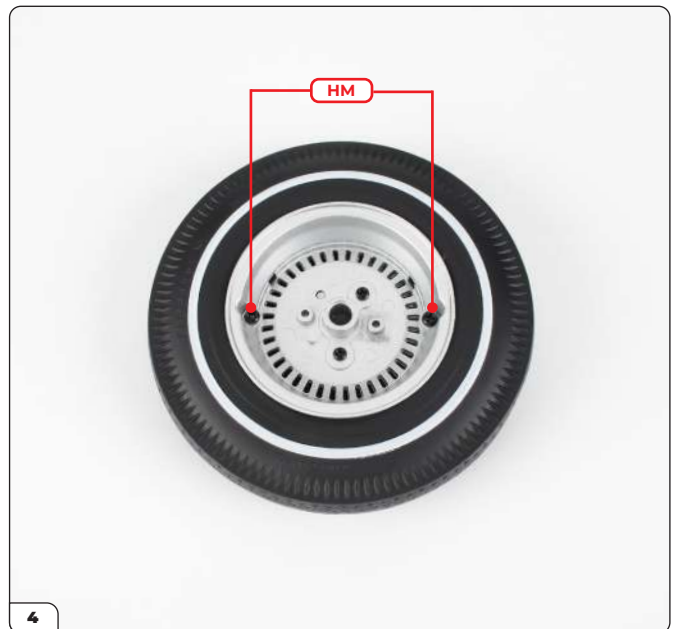

Secure the wheel rim using 2x HM screws.

Stage 42: The Rear Right Wheel – '64 Knock-Off

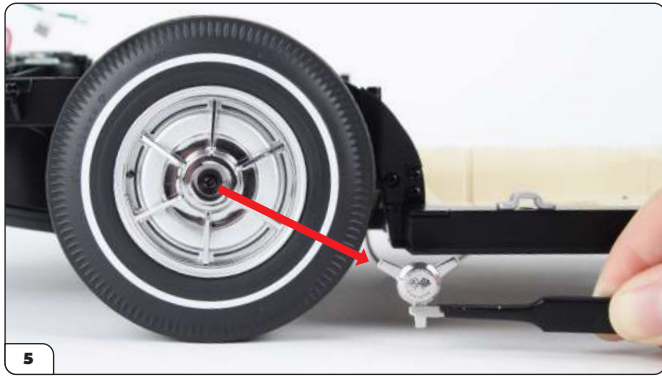

To fit the new wheel, start by removing the three-bar spinner from the original rear right wheel.



Unscrew the CM screw holding the wheel in place as shown.



Remove the wheel then store away the screw, washer and three-bar spinner. Place the wheel on the work surface as shown.



Unscrew the two RM screws holding the drum in place as shown.



Remove the brake drum, then store away the screws.



Align the brake drum with the newly assembled wheel using the mounting pin and hole as a guide.

Stage 42: The Rear Right Wheel – '64 Knock-Off

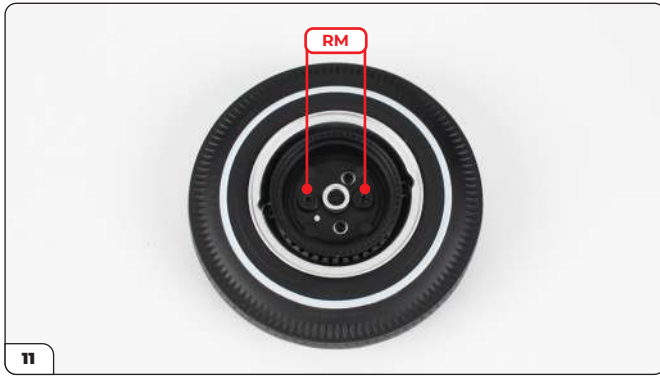

Fit the brake drum and fix using 2x RM screws.

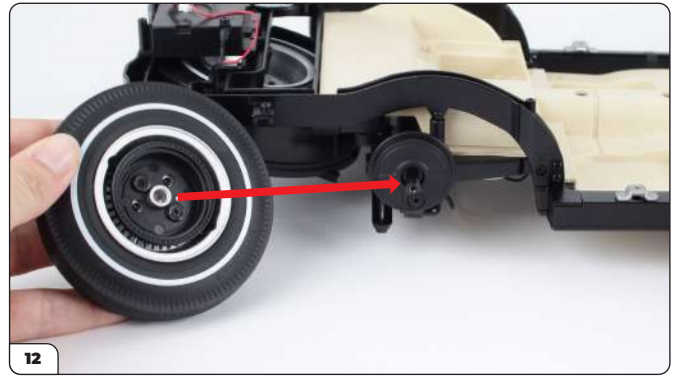

Fit the wheel onto the hub (arrow).

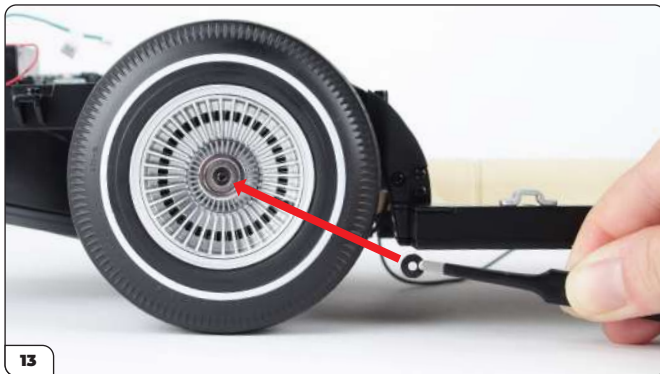

Place the washer over the screw column (arrow).

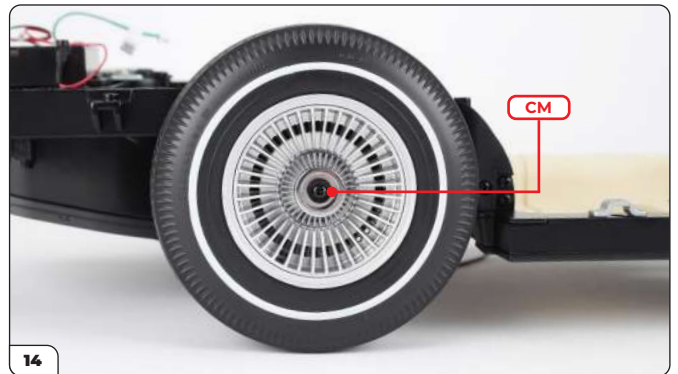

Secure the wheel using a CM screw.



Take the knock-off matching those used for the other wheels and press it in place as shown.

Stage 42: The Rear Right Wheel – '64 Knock-Off

STAGE COMPLETE



Stage 43: Fitting the Rear Left Fender Well

Next you'll fit the rear inner fenders to the chassis, starting with the left.



STAGE 43 PARTS LIST

Name
Rear left inner fender
DM screws x3



Stage 43: Fitting the Rear Left Fender Well

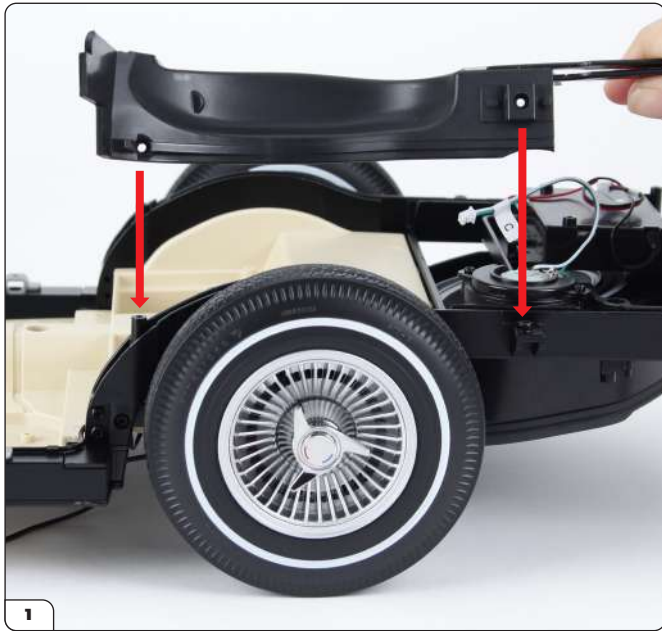

Locate the fixing posts for the rear left inner fender on the chassis as shown (arrows).

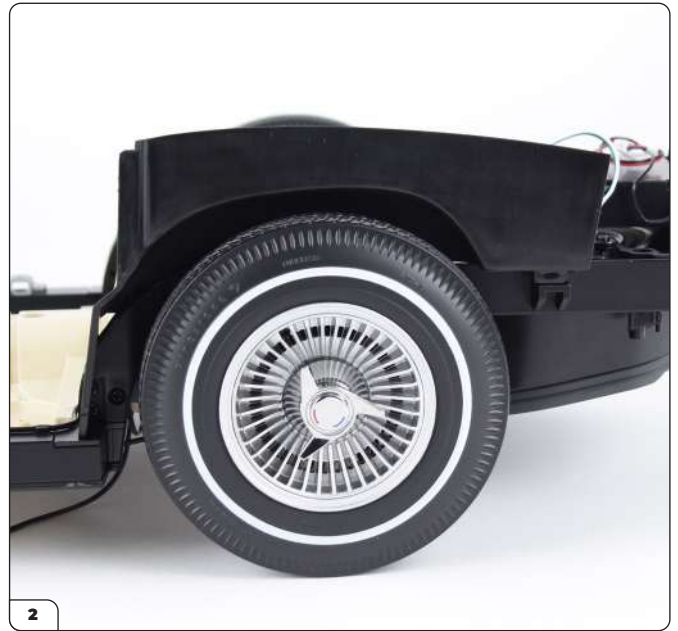

Fit the fender in place as shown.



Fix the fender using 2x DM screws.

Stage 43: Fitting the Rear Left Fender Well

STAGE COMPLETE

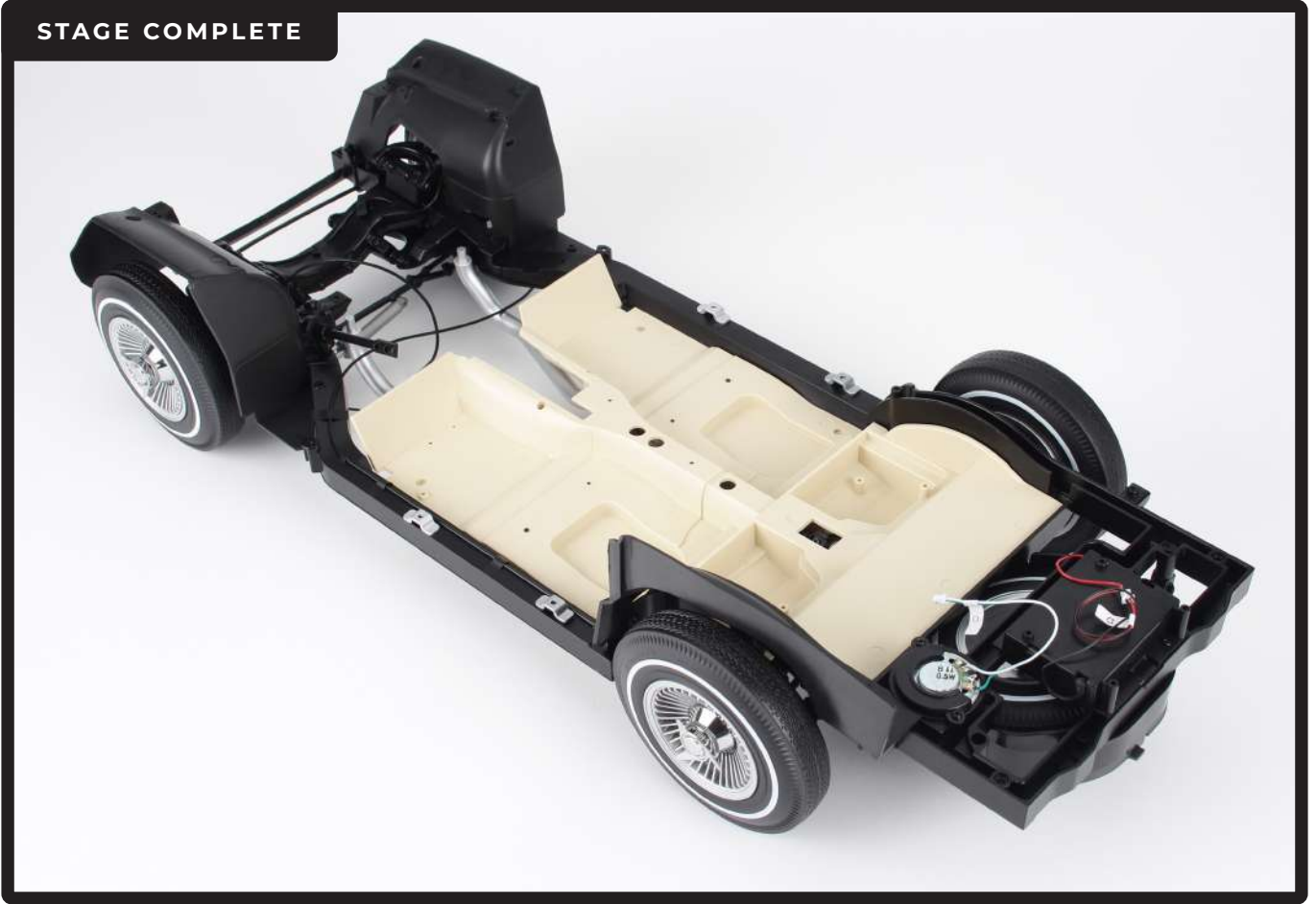

Stage 44: Fitting the Rear Right Fender Well

Now you'll fit the rear right inner fender onto the chassis.



STAGE 44 PARTS LIST

Name
Rear right inner fender
DM screws x3



Stage 44: Fitting the Rear Right Fender Well

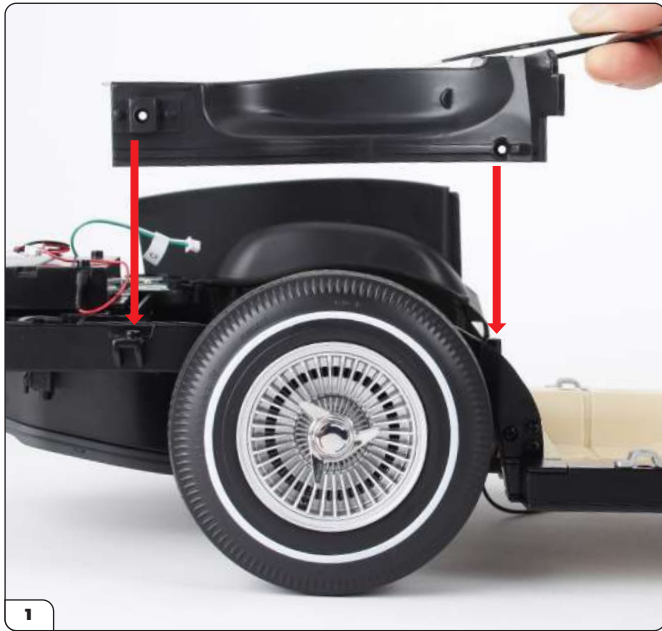

Locate the fixing posts for the rear right inner fender on the chassis as shown (arrows).

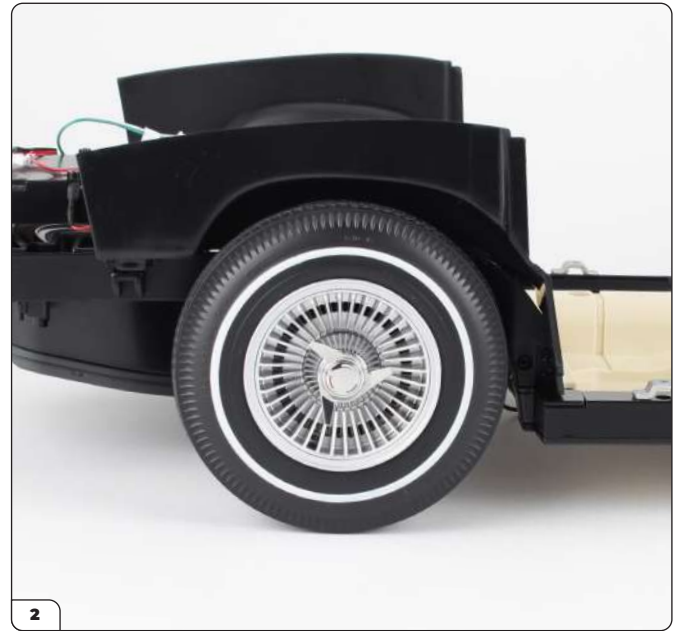

Fit the fender in place.



Fix the fender using 2x DM screws.

Stage 44: Fitting the Rear Right Fender Well

STAGE COMPLETE



Stage 45: Assembling the Battery and Coolant Reservoir

In this stage you'll assemble the battery and coolant reservoir ready to install them later in the pack.



STAGE 45 PARTS LIST

Name	Name
Battery	Wing nut x2
Battery tray	Bushing
Coolant reservoir (L)	Cable (30 mm)
Coolant reservoir (R)	Cable (80 mm)
Bracket	Cable (85 mm)
Breather cap	Cable (102 mm)
Clamp connector	Vent plug x8
Terminal (with post)	FP screw x3
Terminal	KP screw x2
Connector	

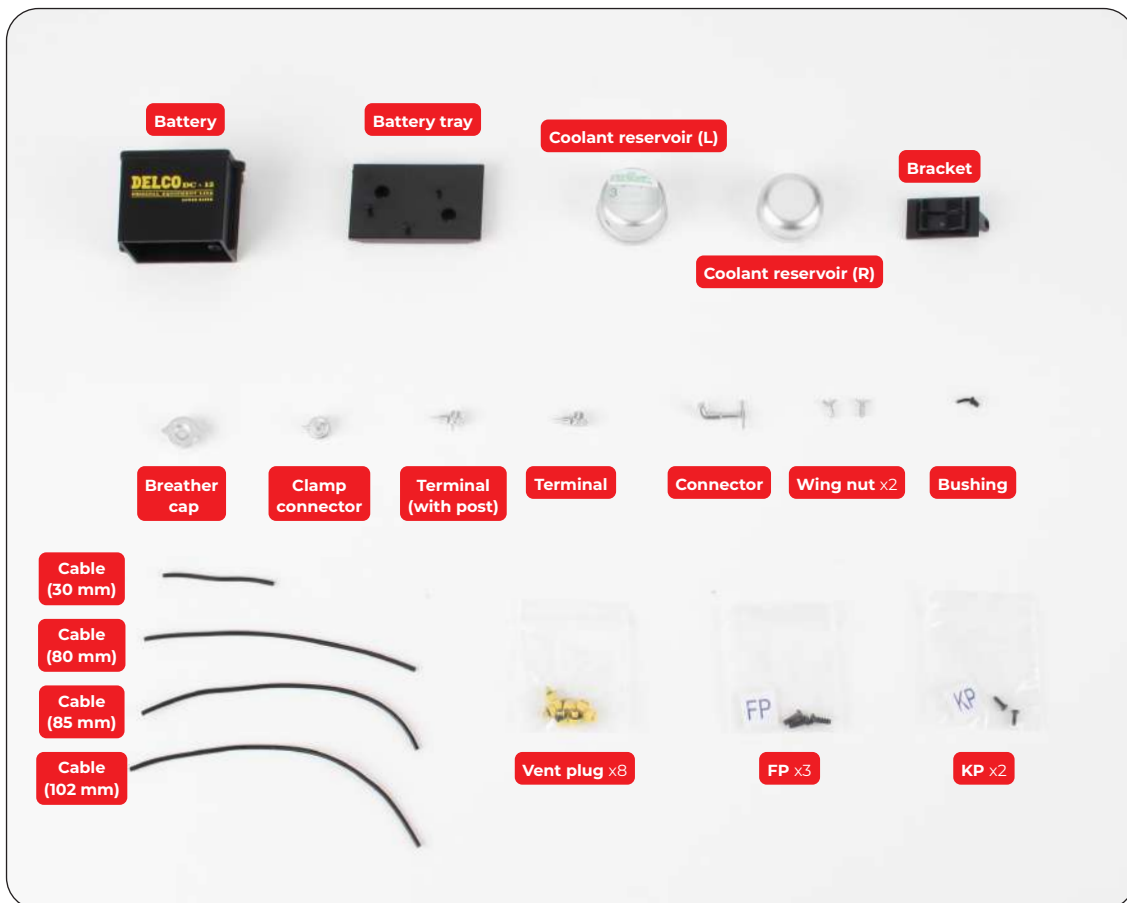

Stage 45: Assembling the Battery and Coolant Reservoir

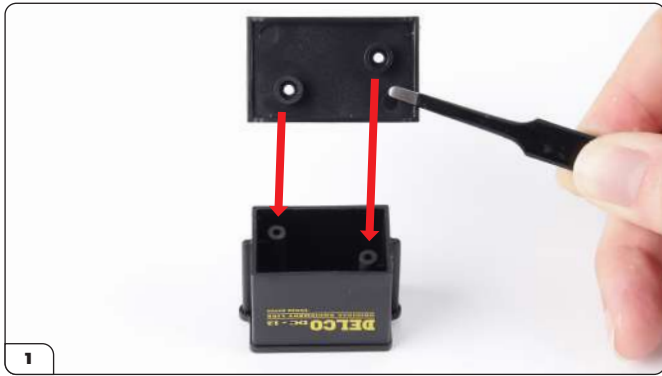

Fit the battery tray onto the battery by pushing the screw holes onto the posts.

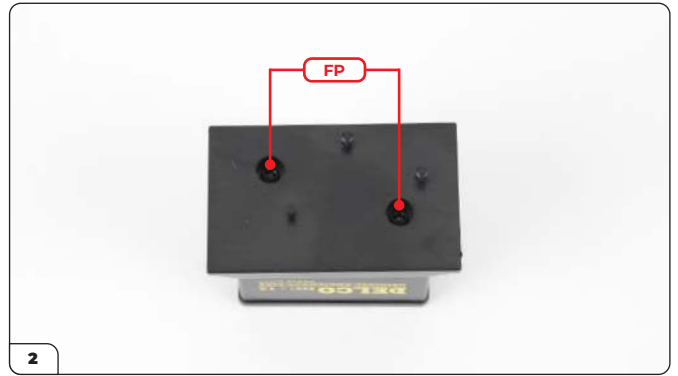

Secure the tray using 2x FP screws.



Turn the battery upright as shown to fit the vent plugs. Also note the '+' and '-' symbols printed next to the pins.



Fit one of the vent plugs into a hole at the top of the battery.



Continue to fit the vent plugs into the remaining five holes.



All six vent plugs have been fitted.

Stage 45: Assembling the Battery and Coolant Reservoir



Press one of the wing nuts into the hole at the end of the row of plugs. Take care when fitting not to damage the thin 'wings' of the part (inset).



Fit the other wing nut into the hole at the opposite end.



One of the terminals has a post on top. This fits onto the negative ('-') pin in the next step.

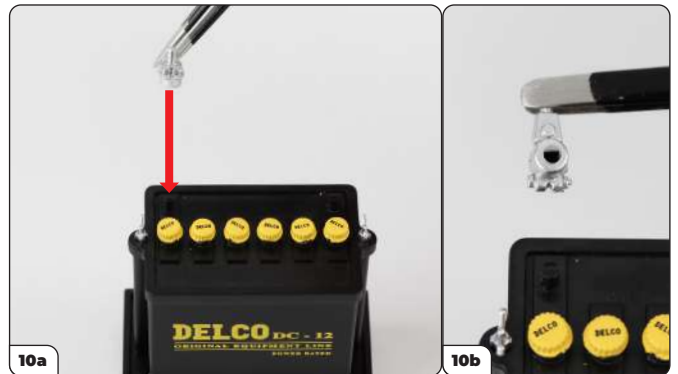

Fit the terminal with a post onto the pin marked with a '-' (10a). The hole and pin are shaped to ensure correct orientation (10b).



Fit the other terminal onto the pin marked with a '+'



The battery has been assembled. Set it aside until it is needed.

Stage 45: Assembling the Battery and Coolant Reservoir



Place the left and right halves of the coolant reservoir on your work surface and locate the mounting tab and corresponding recess (13a). Press the halves together using these as a guide (13b).



Fit the clamp connector, which has a shaped pin (circled) into the shaped hole of the reservoir (arrow).

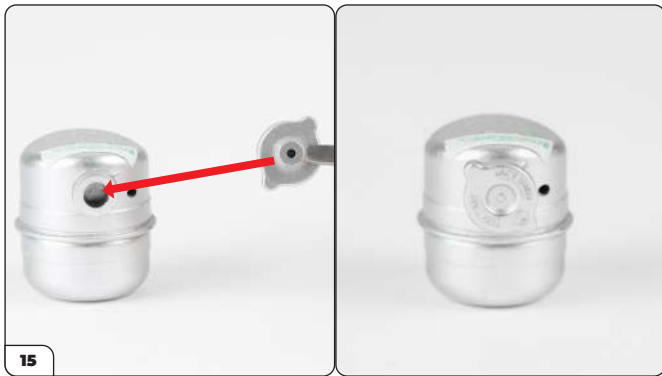

Fit the breather cap into the clamp connector.



Turn the reservoir as shown then fit the connector into the hole, using the shaped pin as a guide.

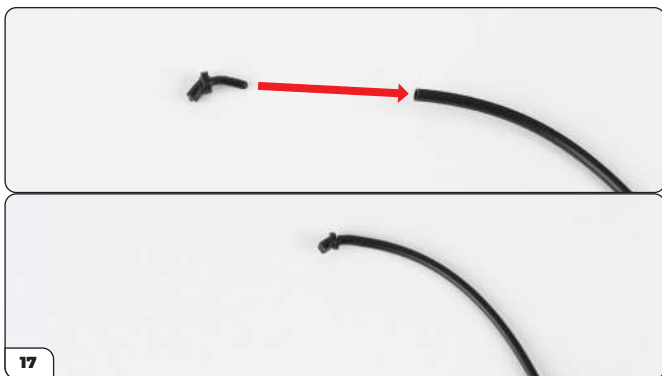

Push the thinner pin of the bushing into the end of the longest cable (102 mm).

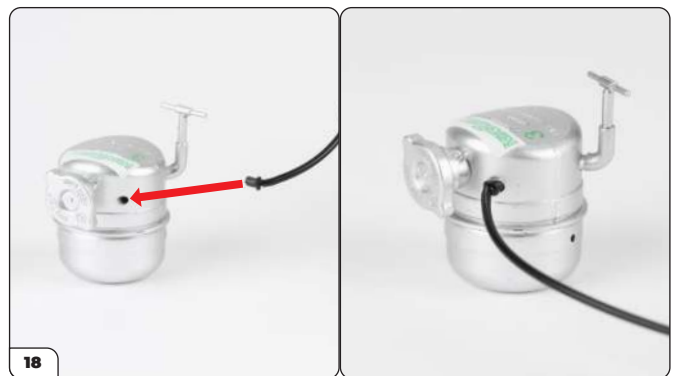

Push the thicker pin of the bushing into the hole of the reservoir.

Stage 45: Assembling the Battery and Coolant Reservoir



Fit the shortest cable (30 mm) onto the pin of the clamp connector (arrow).

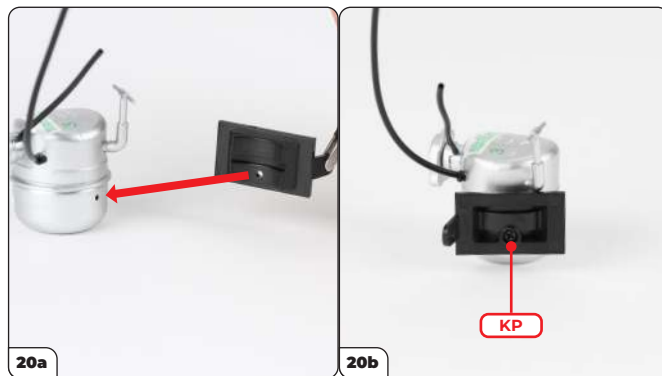

Position the bracket onto the reservoir using the holes as a guide (20a) then secure using a KP screw (20b).

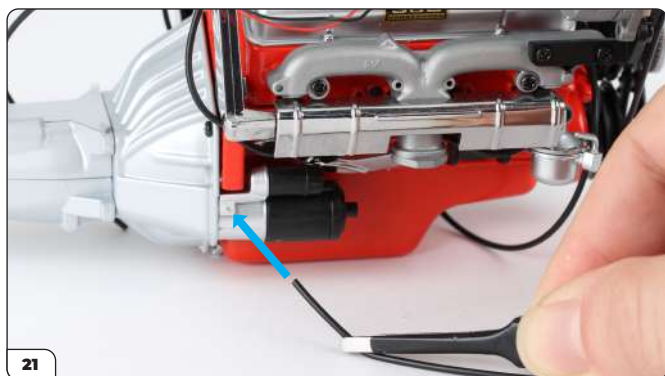

Retrieve the engine assembly (stage 14) and fit the 80 mm long cable onto the pin of the starter motor.

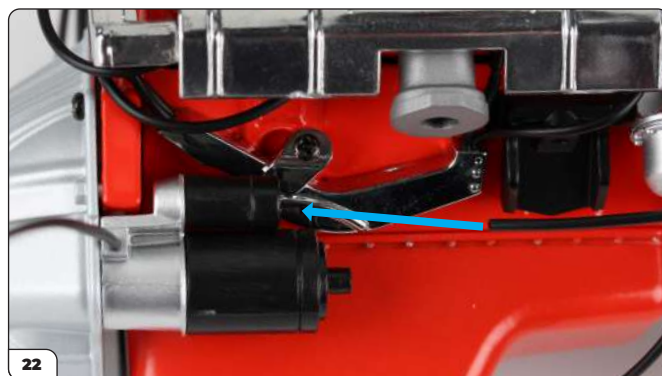

Fit the 85 mm long cable onto the pin of the starter coil.



This is how the 80 mm and 85 mm cables should be fitted.

Stage 45: Assembling the Battery and Coolant Reservoir

STAGE COMPLETE



Stage 46: Preparing the Front Reinforcement Frame and Water Hose

In this stage you'll prepare the front reinforcement frame by fitting its bracket and horns, then fit the water hose onto the engine.



STAGE 46 PARTS LIST

Name
Front reinforcement frame
Water hose
Front reinforcement bracket
Horn (L)
Horn (R)
AP screw x3
EP screw x2

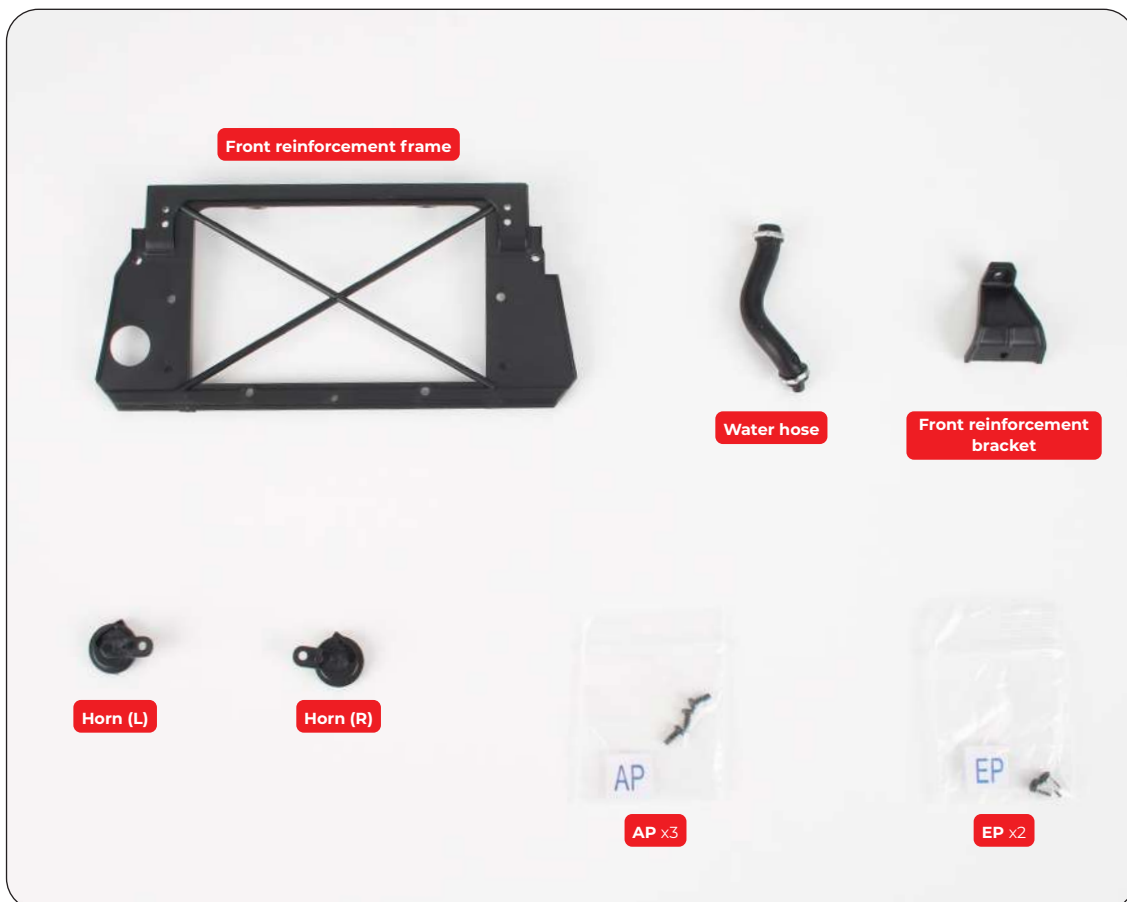

Stage 46: Preparing the Front Reinforcement Frame and Water Hose



Align the front reinforcement frame and its bracket as shown then fit the bracket in place (arrow).



Secure the bracket with an EP screw.

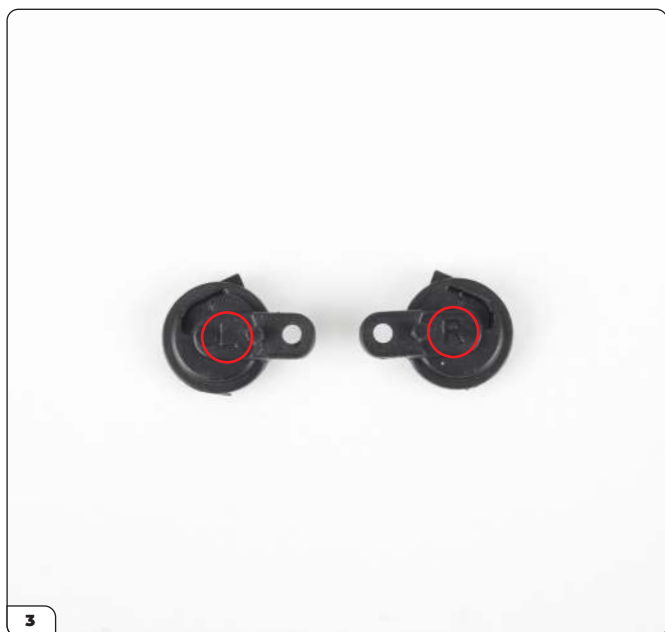

Take the left and right horns which are marked 'L' and 'R' to differentiate them (circled).

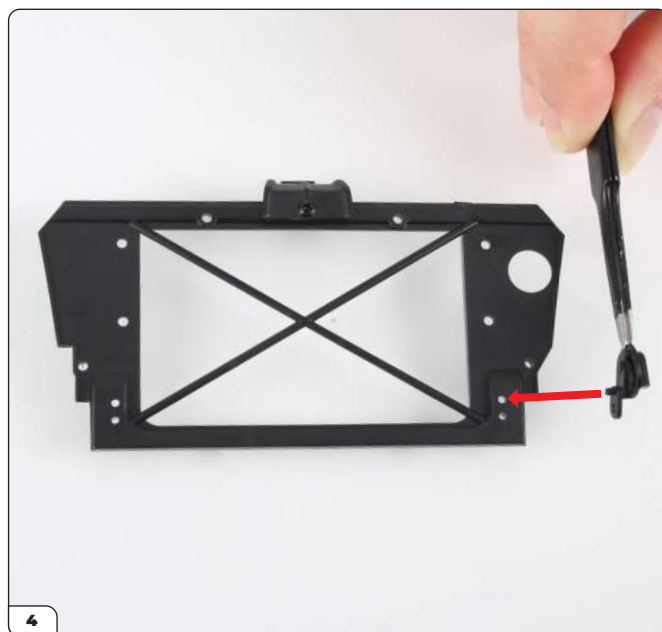

Fit the left horn (L) by locating its pin into the frame socket as indicated.

Stage 46: Preparing the Front Reinforcement Frame and Water Hose



Fit the right horn (R) onto the other side of the reinforcement in the same way.



Secure the horns using 2x AP screws.

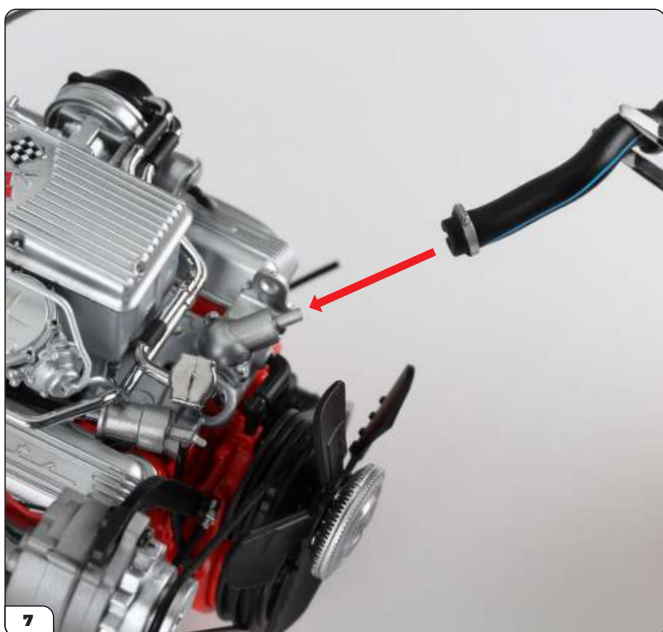

Retrieve the engine assembly and fit the water hose onto the shaped pin.

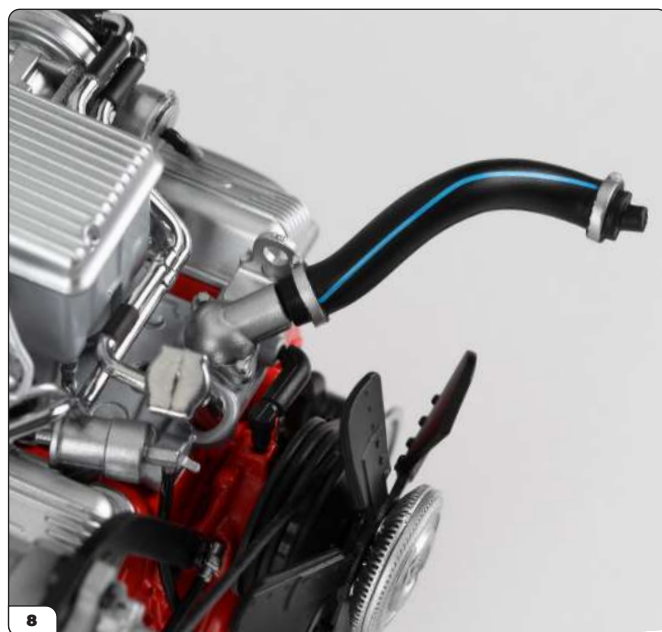

The fitting may be loose, but do not glue the hose for now.

Stage 46: Preparing the Front Reinforcement Frame and Water Hose

STAGE COMPLETE

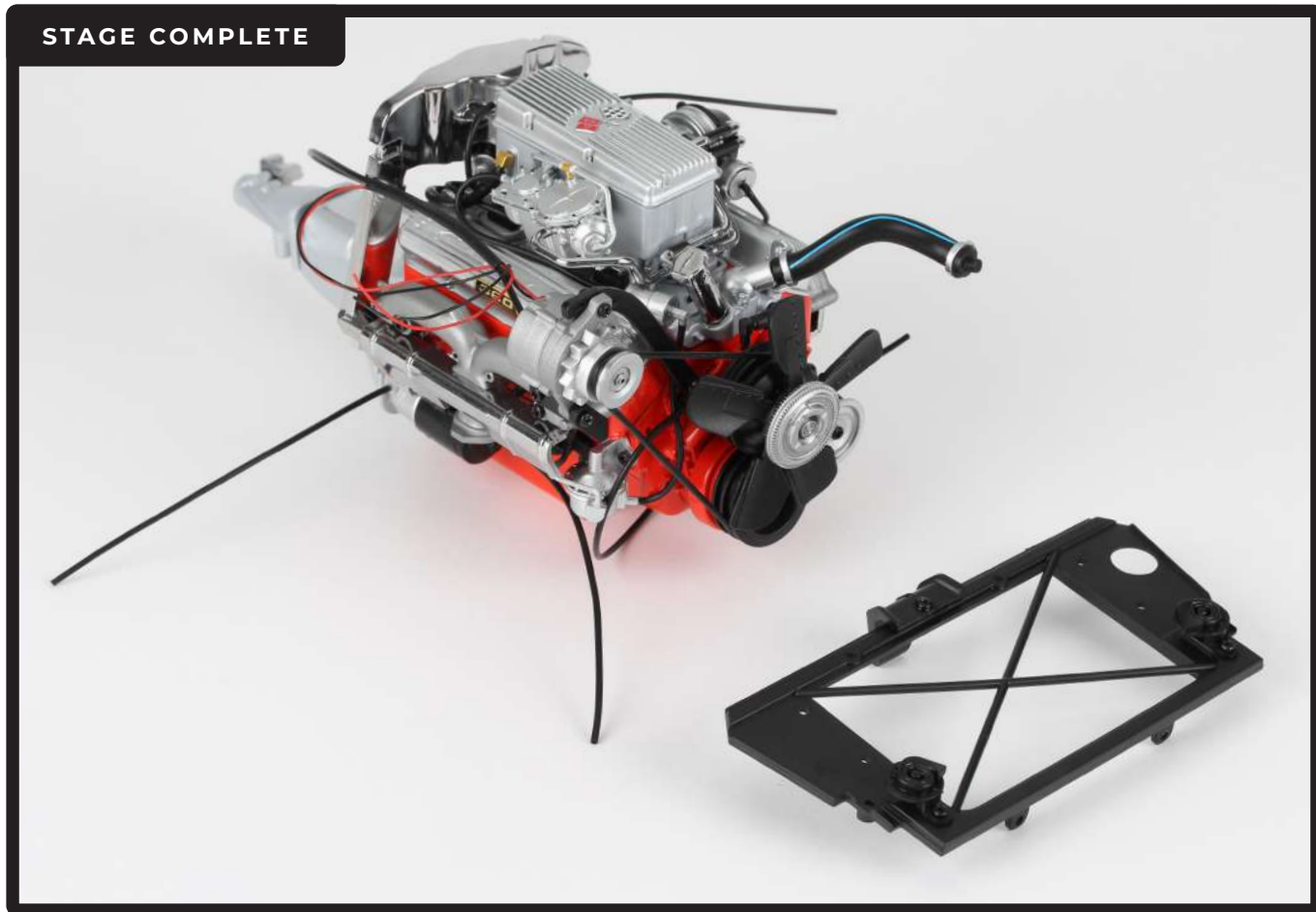

Stage 47: Fitting the Fan Cover and Radiator

After assembling the fan cover and radiator, you'll fit it to the chassis ready for the engine to be mounted in the next stage. You'll also install the battery and coolant reservoir onto the front right fender.



STAGE 47 PARTS LIST

Name	Name
Fan cover	Cable (62 mm)
Radiator front	Cable (57 mm)
Radiator rear	Water pipe connector
Water inlet pipe	EP screw x14
Water hose connector	FP screw x4
Cable (127 mm)	IP screw x3



Stage 47: Fitting the Fan Cover, Radiator and Water Pipes

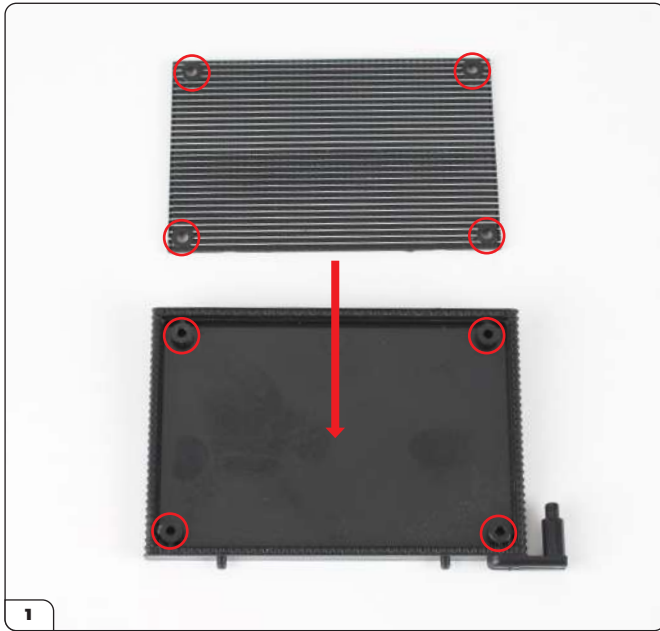

1 Fit the radiator rear into the front by positioning the screw sockets onto the screw posts (circled).

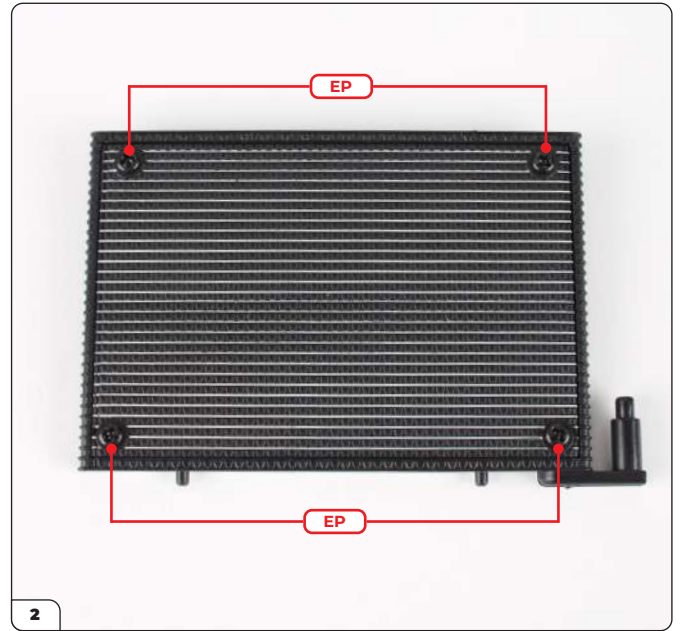

2 Fix using 4x EP screws.

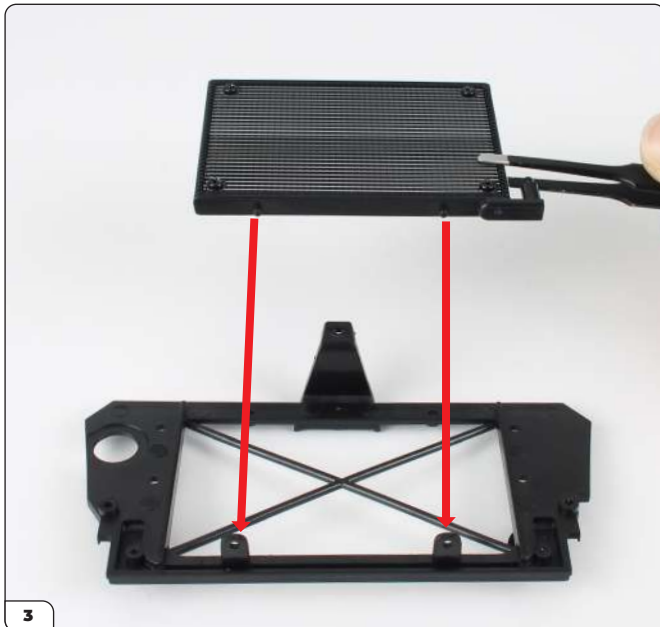

3 Fit the radiator into the front reinforcement frame (stage 46) by pushing the pins into the sockets.

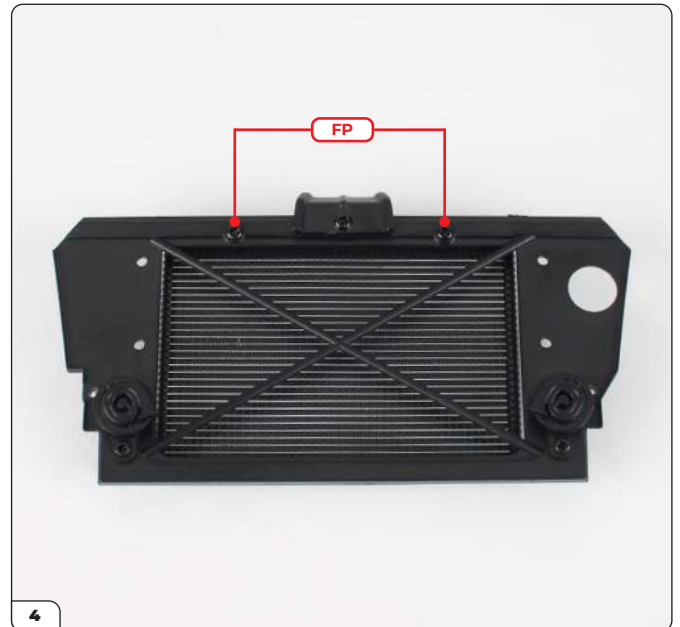

4 Turn the assembly over and secure the radiator using 2x FP screws.

Stage 47: Fitting the Fan Cover, Radiator and Water Pipes



Place the fan cover and frame as shown then locate the connection points: four holes along the edges (circled) and one screw socket that fits to the bracket (arrow).



Fit the cover onto the frame.



Secure the bracket to the cover using an FP screw.



Secure the frame to the cover using 4x EP screws.

Stage 47: Fitting the Fan Cover, Radiator and Water Pipes



Fit the water pipe connector to the fan cover as shown. Check the connector is oriented outwards (inset).

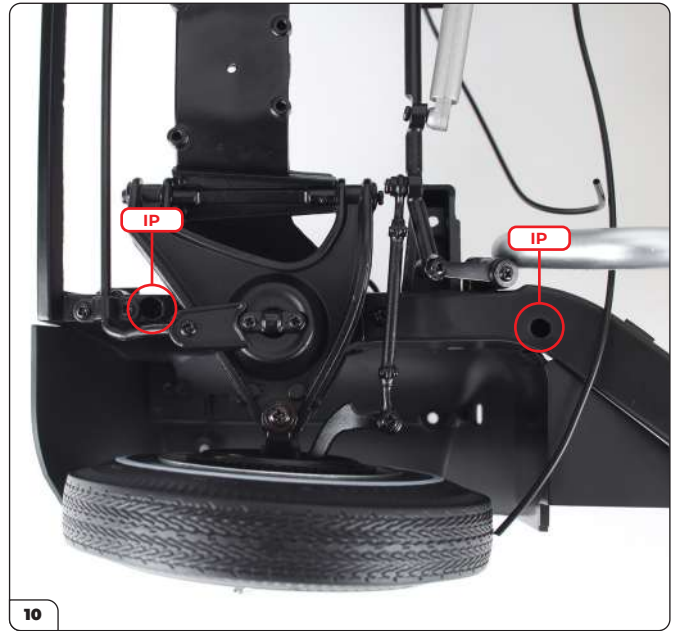

Retrieve the main assembly and carefully place it upside down. Remove the two IP screws holding the front right fender.



Once the screws have been removed, carefully lift the assembly away from the front right fender. Set the fender aside until it is needed later.

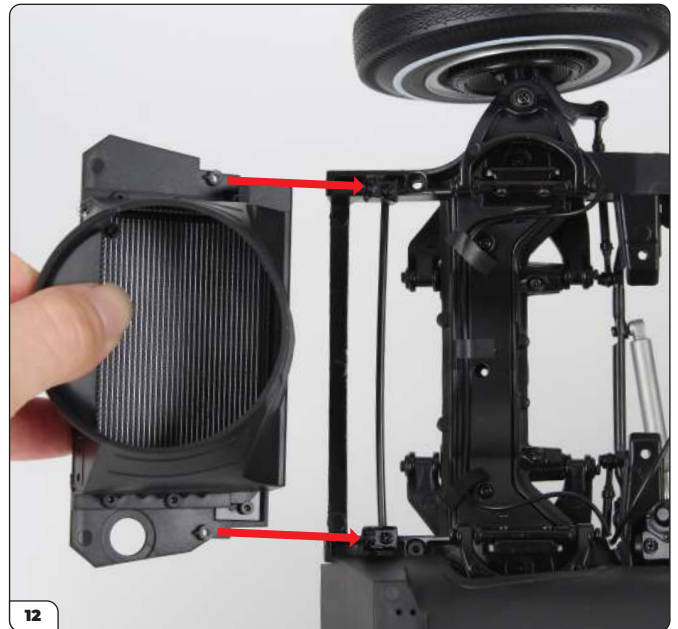

Align the reinforcement frame with the chassis as shown. The two shaped screw posts fit over the brackets on the chassis.

Stage 47: Fitting the Fan Cover, Radiator and Water Pipes



13 The frame should fit like this once in place, with the screw posts connected to the brackets (inset).

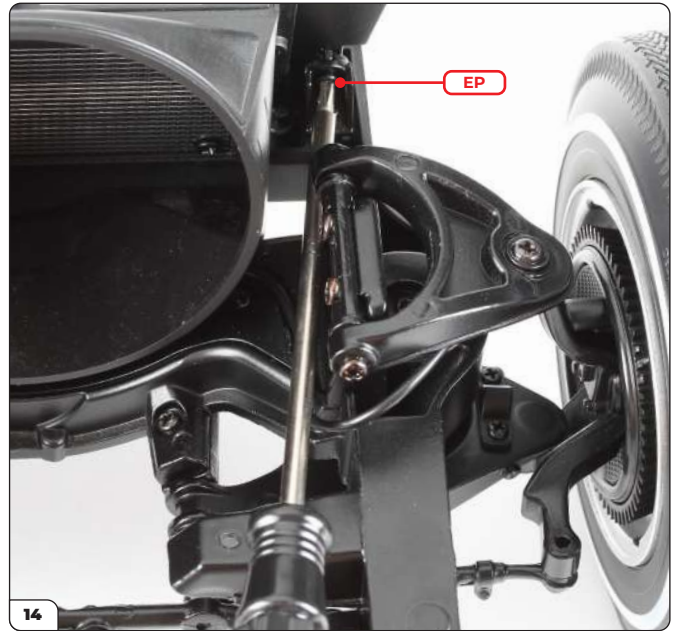

14 Using a long screwdriver, fix the right-hand side by driving an EP screw through the bracket.



15 Fix the left-hand side in the same way with another EP screw.



16 Take the front right fender and locate the slot indicated by the arrow.

Stage 47: Fitting the Fan Cover, Radiator and Water Pipes

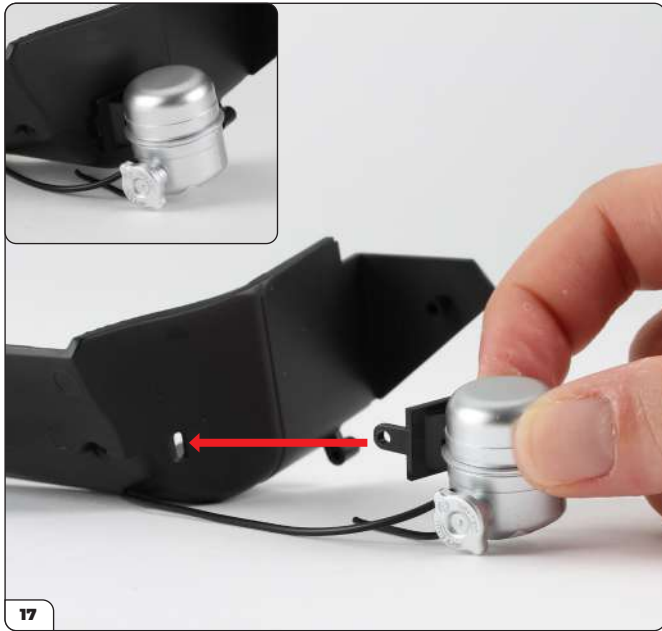

Fit the coolant reservoir (stage 45) to the fender by pushing its bracket through the slot.



Secure the reservoir using an EP screw.

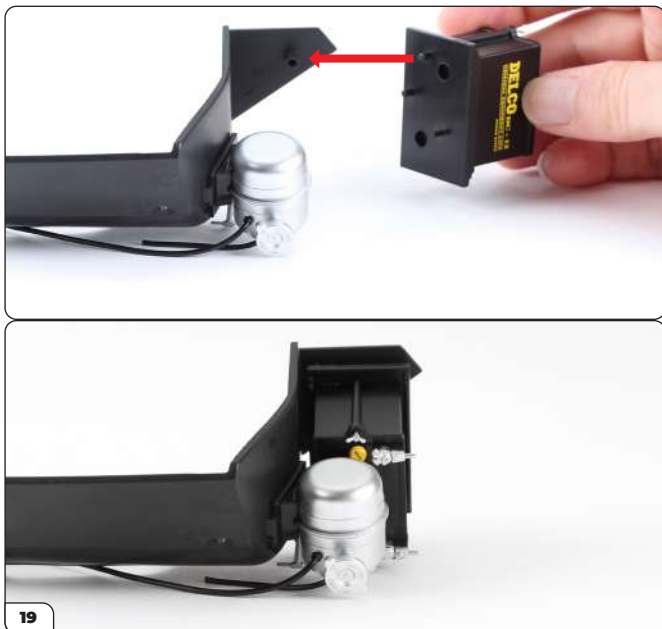

Fit the large pin of the battery tray into the hole of the fender (arrow).

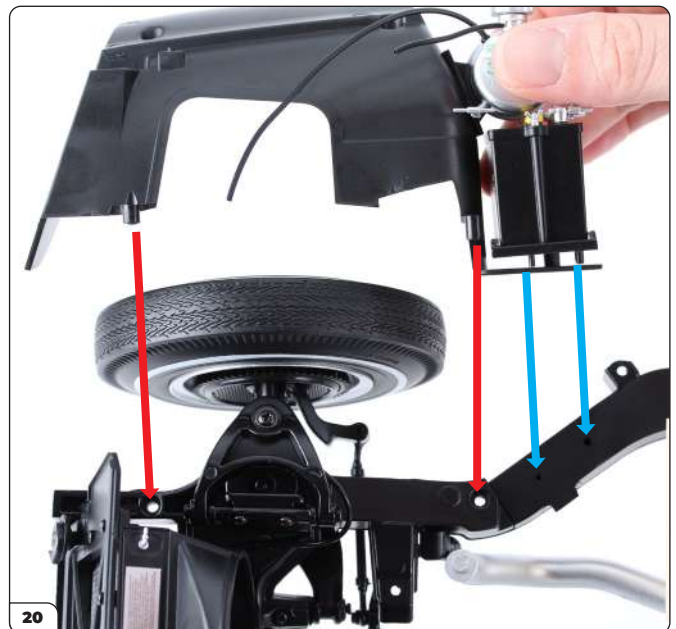

Fit the fender back in place on the chassis by pressing the screw posts into the sockets (red arrows). At the same time, fit the battery tray to the chassis by locating two pins into the holes on the frame (blue arrows).

Stage 47: Fitting the Fan Cover, Radiator and Water Pipes



The right fender and battery should look like this once in place.

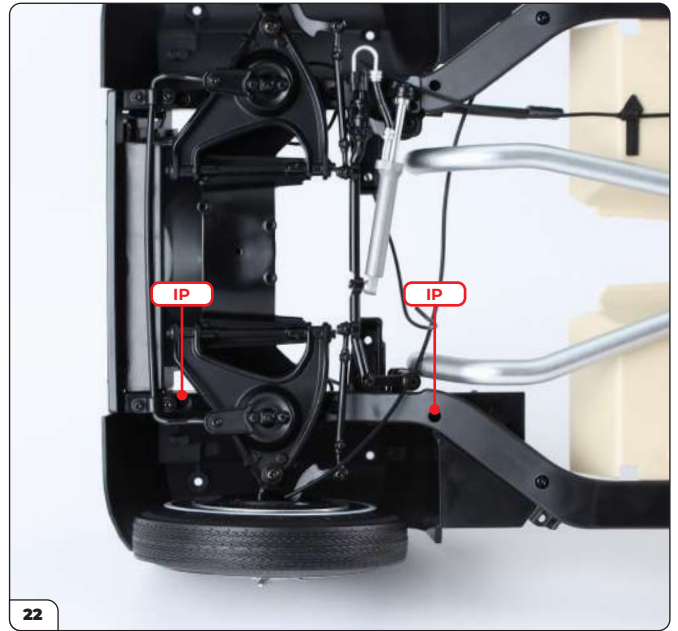

Secure the right fender using 2x IP screws.

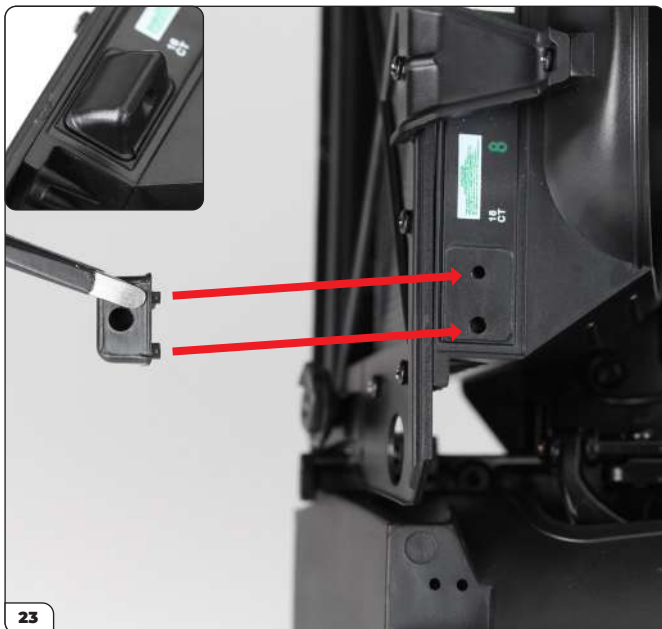

Fit the water hose connector to the fan cover (arrows). The pins and holes are different sizes to ensure the orientation is correct (inset).



Retrieve the engine assembly and identify the three pins on the steering pump cap. Note the arrow colours for the following steps.

Stage 47: Fitting the Fan Cover, Radiator and Water Pipes

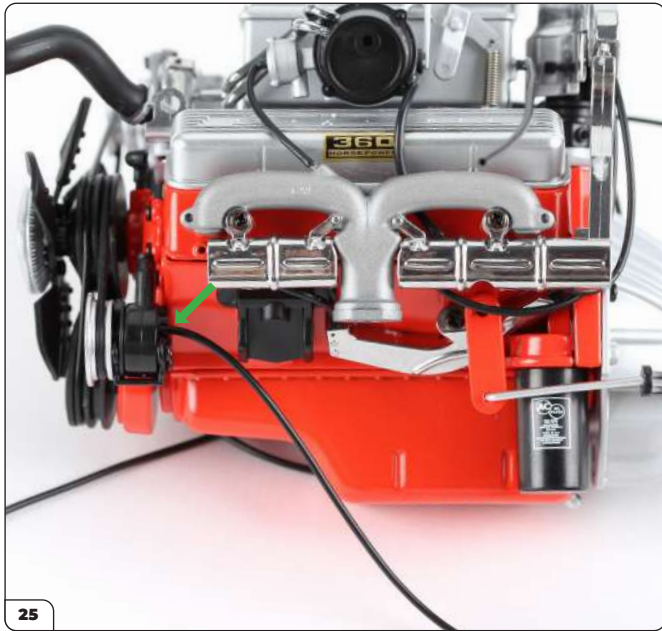

Fit the 62 mm cable onto the middle pin (green arrow).

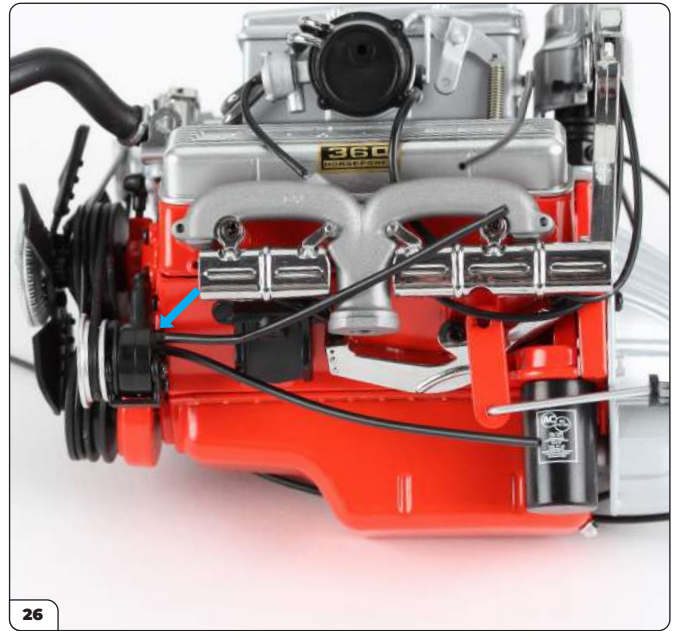

Fit the 57 mm cable onto the upper pin (blue arrow).

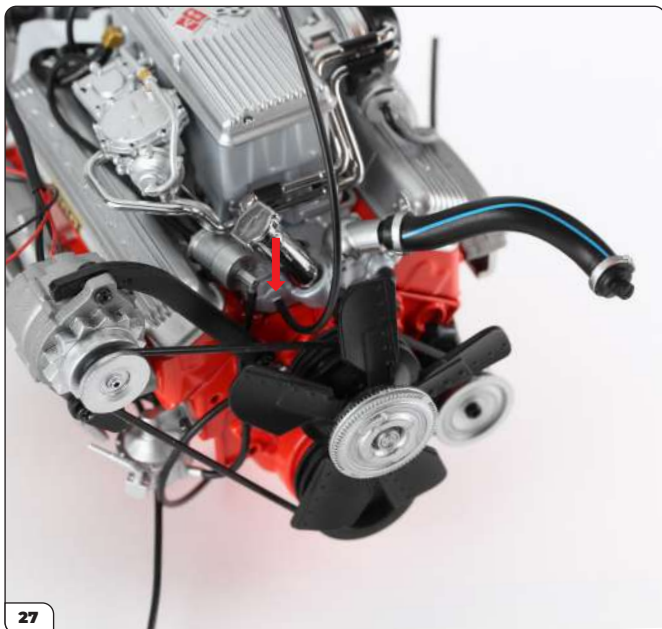

Fit the 127 mm cable onto the pin located behind the fan.

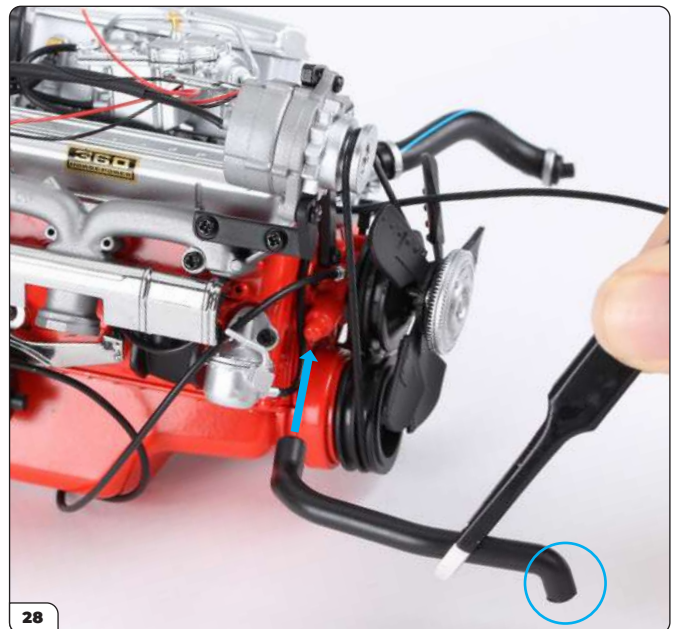

Press the water inlet pipe into position as shown (arrow). Orient the pipe so the curved end points downwards (circled).

Stage 47: Fitting the Fan Cover, Radiator and Water Pipes

STAGE COMPLETE

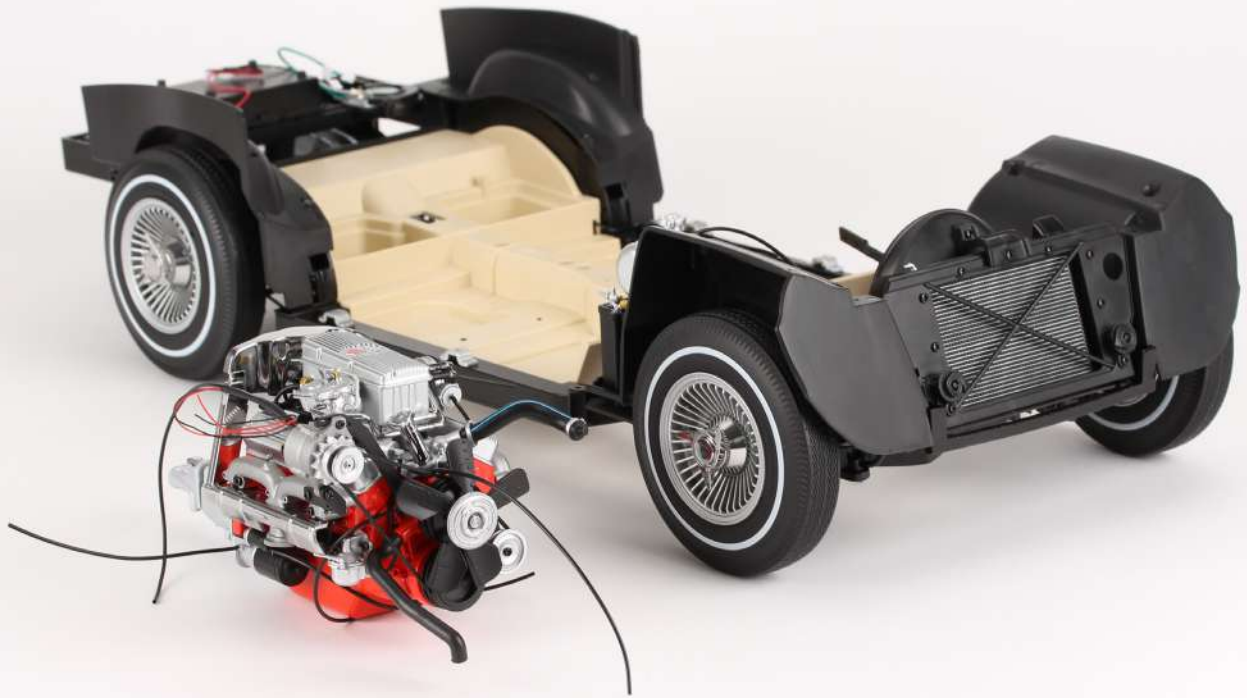

Stage 48: Mounting the Engine

In this stage, you'll fit the lower part of the 35-gallon fuel tank, then mount the engine onto the chassis and connect the exhaust and intake manifold pipes.



STAGE 48 PARTS LIST

Name	Name
35-gallon tank (lower)	Double-sided adhesive sticker x6
Intake manifold pipe (upper)	AM screw x5
Intake manifold pipe (lower)	CM screw x3
Gearbox bracket	EP screw x2
Intake manifold pipe fixing	FP screw x5



Stage 48: Mounting the Engine

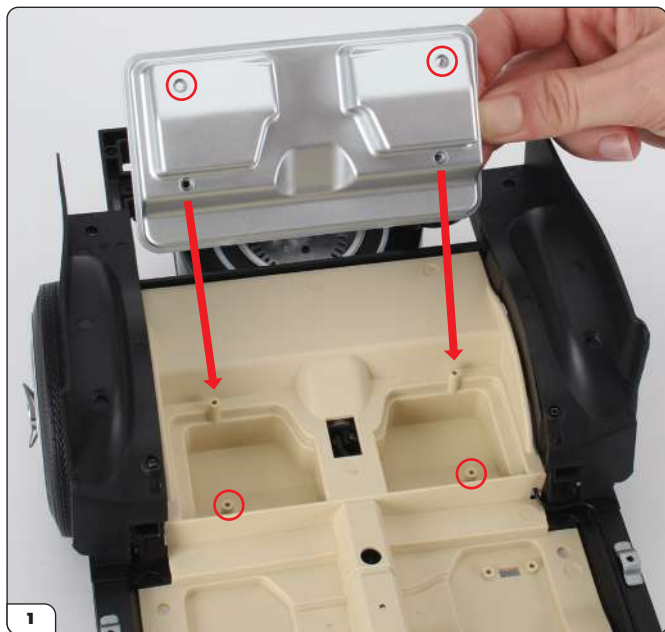

Fit the tank to the cockpit, aligning the screw sockets over the posts as shown.

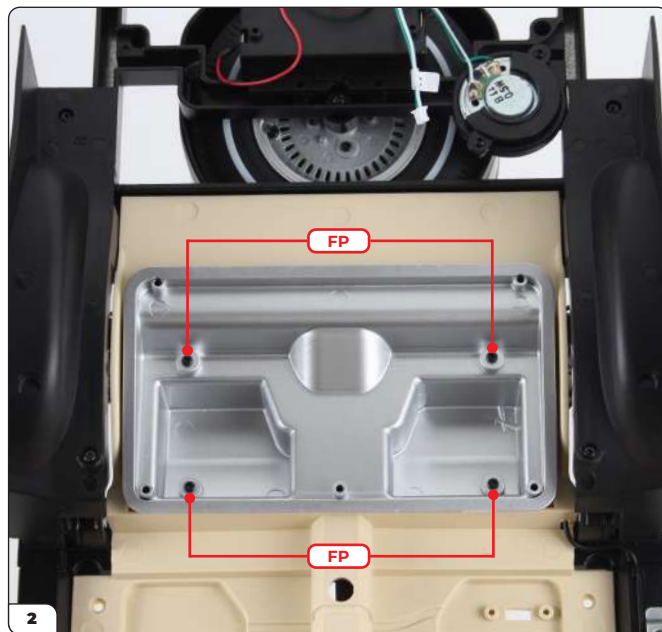

Secure using 4x FP screws.

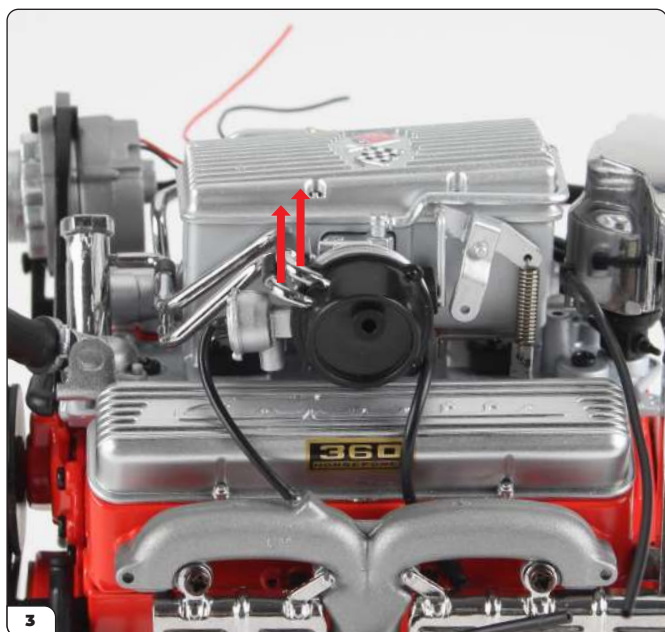

Place the engine assembly on the work surface then carefully remove the two silver pipes from the diffuser cone.



Remove the diffuser cone from the assembly as shown.

Stage 48: Mounting the Engine



5
Position the diffuser cone onto the end of the lower intake manifold pipe as shown.

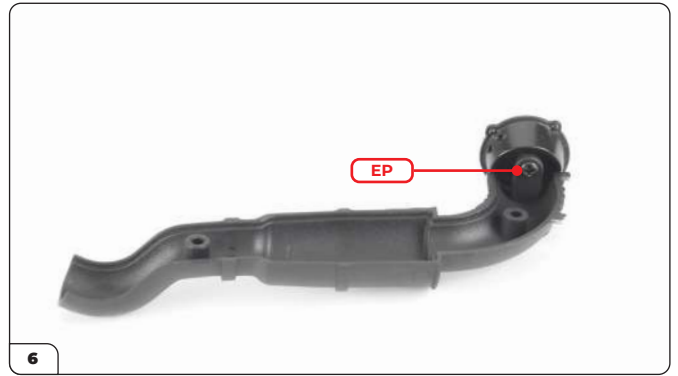

6
Use an EP screw to secure the cone. Don't overtighten the screw as the pipe may need adjusting later.



7
Fit the upper intake manifold pipe to the lower pipe, locating the pins in the sockets.



8
Press the two halves together firmly. Set the intake manifold pipe aside until it is needed in a later step.



9
Peel one of the double-sided adhesive stickers from its backing.

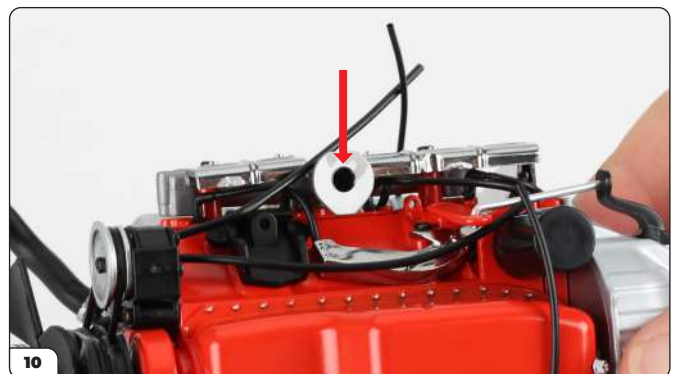

10
Press the sticker onto the left exhaust manifold as shown.

Stage 48: Mounting the Engine



Peel another sticker and press it onto the right exhaust manifold in the same way (arrow).

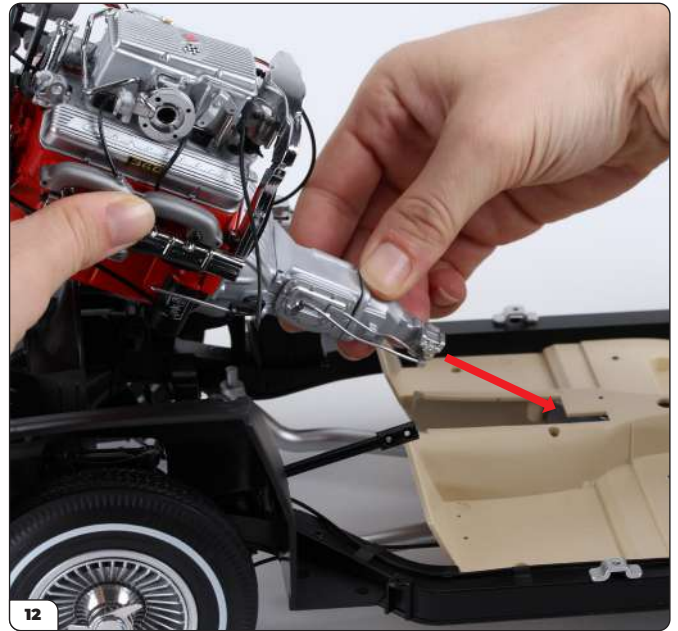

Place the chassis on the work surface, then guide the end of the gearbox into the opening in the cockpit floor. Fit the gearbox onto the transmission shaft.



Lower the front of the engine and carefully fit the fan inside the cover as shown.



Turn the assembly over then pull firmly on the red drive pulley (blue arrow) until all parts of the black pulley are visible and clear of the chassis (red arrows).

Stage 48: Mounting the Engine

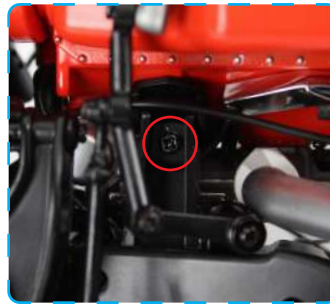
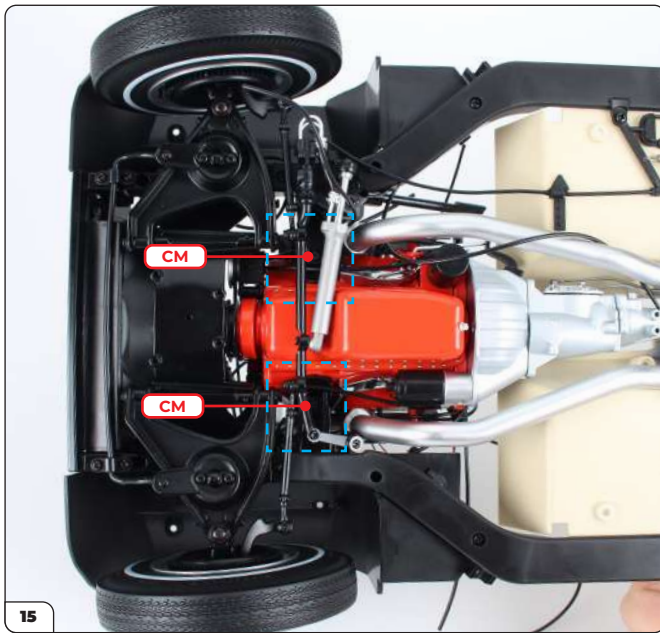

Drive 2x CM screws through the engine brackets to hold the engine in place. The inset images show a closer view of the screws (circled).



Lift the exhaust pipe away then peel the backing paper from the adhesive sticker on the manifold using tweezers (16a). Firmly press the pin of the pipe into the hole of the manifold (16b).



Repeat for the manifold on the other side, peeling the sticker (17a) then pressing the pipe firmly in place (17b).

Stage 48: Mounting the Engine

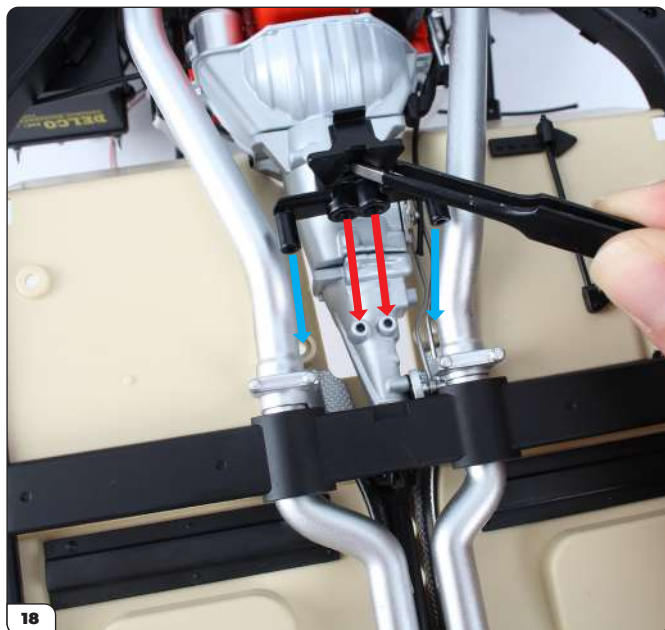

Align the gearbox bracket with the posts on the gearbox (red arrows) and screw sockets in the cockpit floor (blue arrows) as shown.



Press down on the gearbox while fitting the bracket in place.

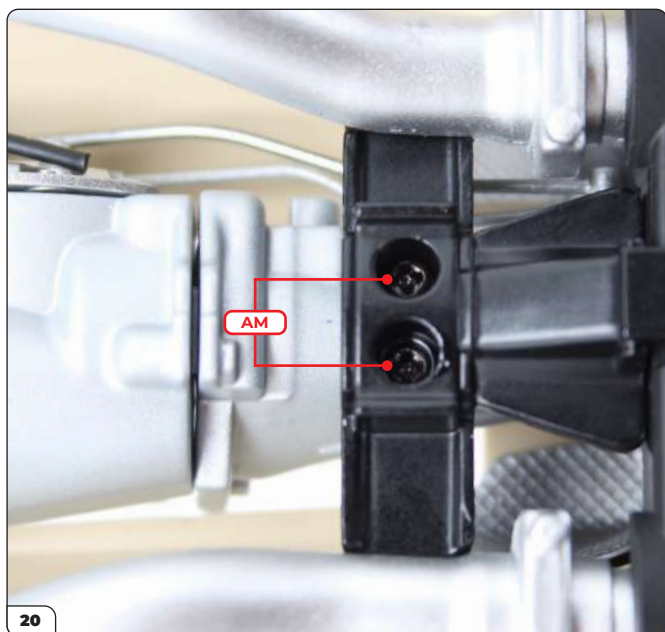

Secure the bracket to the gearbox with 2x AM screws.

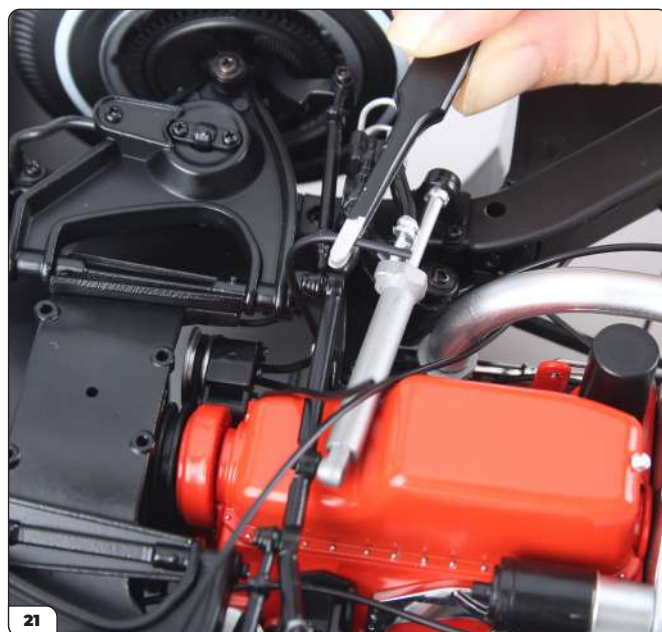

Locate the loose end of the 57 mm cable fitted to the steering pump cap in stage 47.

Stage 48: Mounting the Engine



Fit the cable to the inner pin on the central steering bar.



Locate the loose end of the 62 mm cable fitted to the steering pump cap in stage 47.



Fit it to the outer pin on the central steering bar.

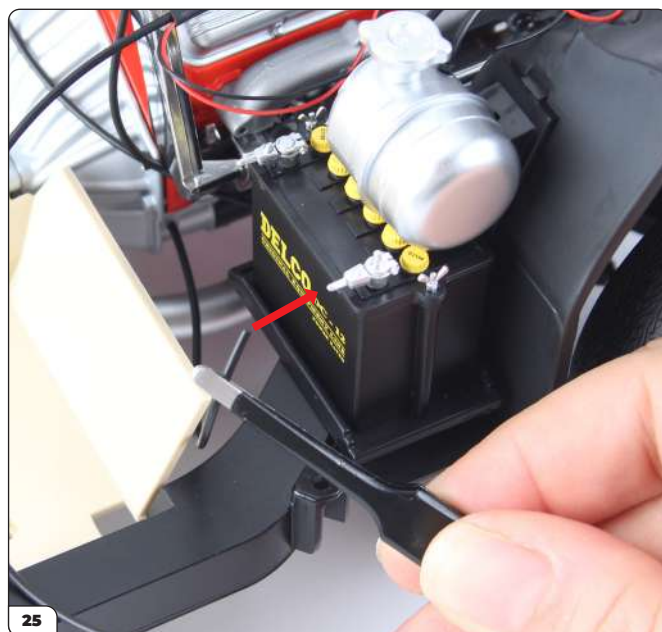

Fit the loose end of the 80 mm cable fitted to the starter motor in stage 45 to the outer terminal of the battery as shown.

Stage 48: Mounting the Engine

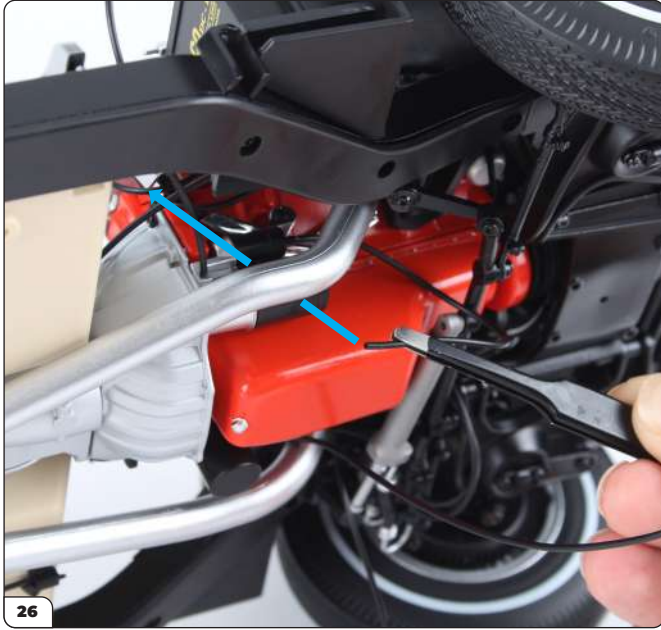

Locate the loose end of the 85 mm cable fitted to the starter motor and guide it up through the chassis, between the exhaust pipe and the engine (arrow).

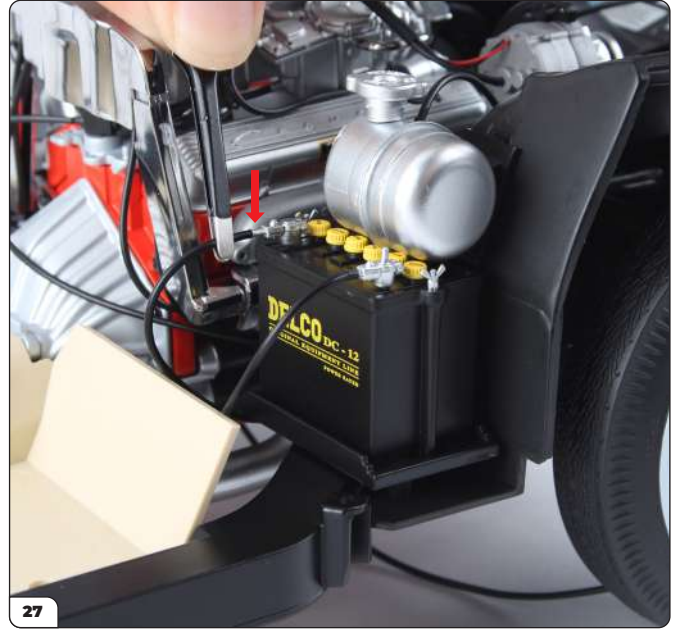

Fit the end of the 85 mm cable to the inner terminal (arrow).

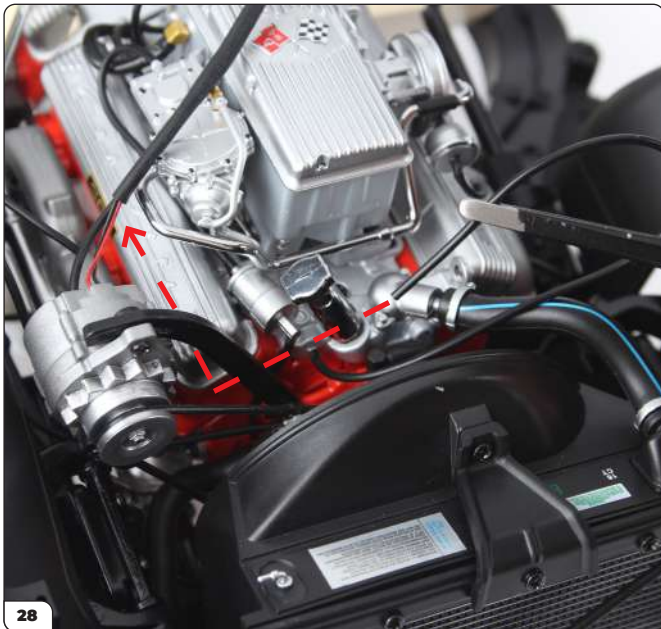

Guide the loose end of the 127 mm cable fitted in stage 47 under the alternator bracket.

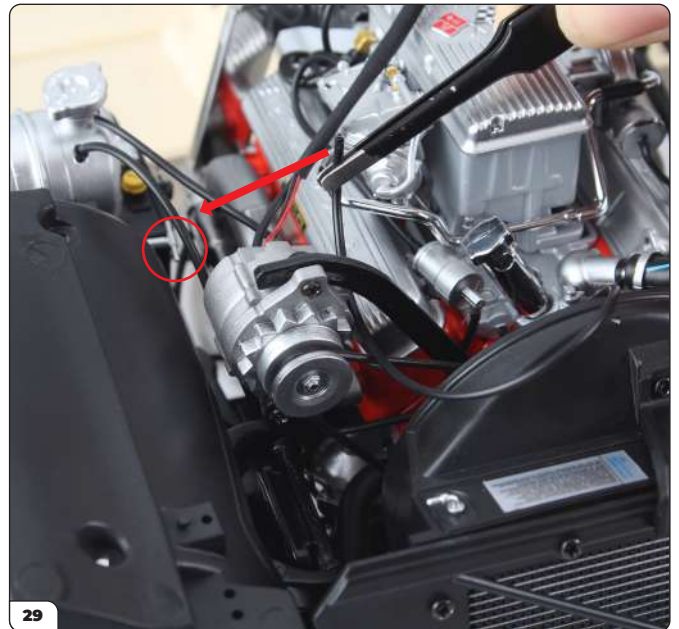

Check the length needed to fit the cable onto the coolant reservoir connector (circled) and trim any excess.

Stage 48: Mounting the Engine

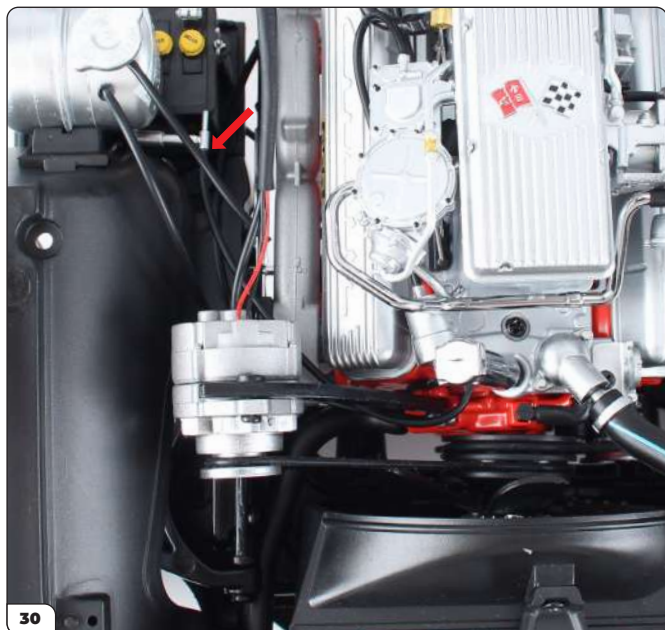

Fit the cable onto the connector.

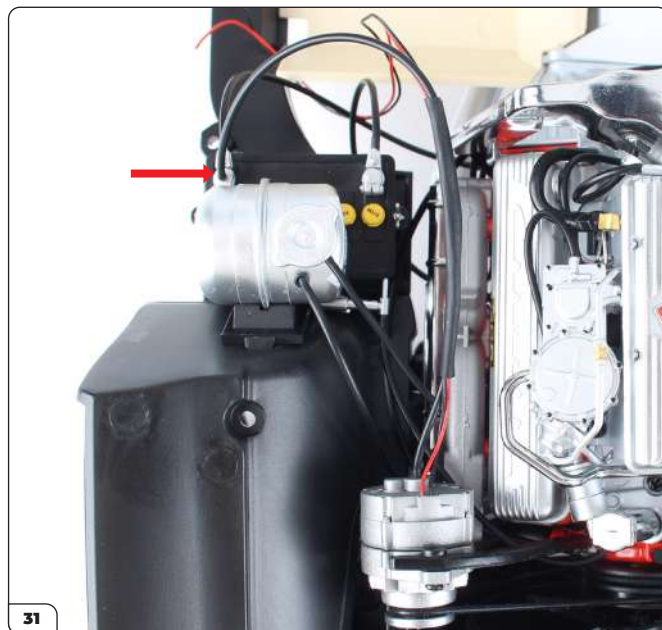

Trim the excess length from the alternator cable then plug it onto the top post of the outer terminal.



Press the water inlet pipe onto the post on the reinforcement frame (arrow) until it connects (inset, circled).



Plug the loose end of the coolant reservoir cable into the water pipe connector on the fan cover (arrow).

Stage 48: Mounting the Engine



Fit the end of the water hose into its connector. Use a drop of glue if the hose is fitting loosely on the engine.

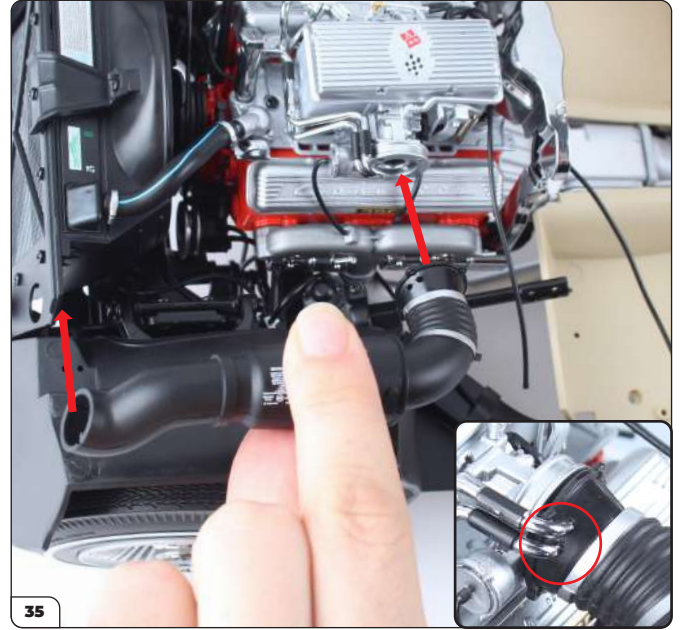

Fit both ends of the intake manifold pipe in place (arrows) and reconnect the silver pipes with the diffuser cone (inset, circled).

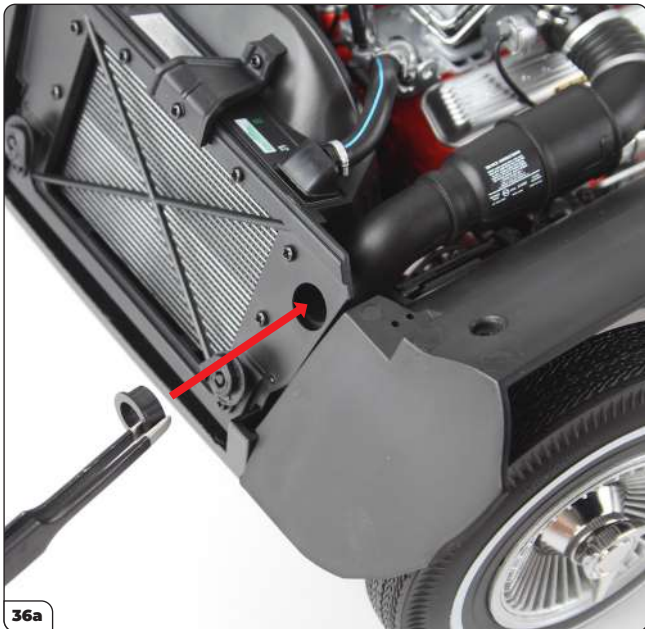

Adjust the manifold pipe so that the open end aligns with the hole in the reinforcement frame, then plug the intake manifold fixing through to hold it in place (36a). Press firmly until the fixing is flush (36b).

Stage 48: Mounting the Engine

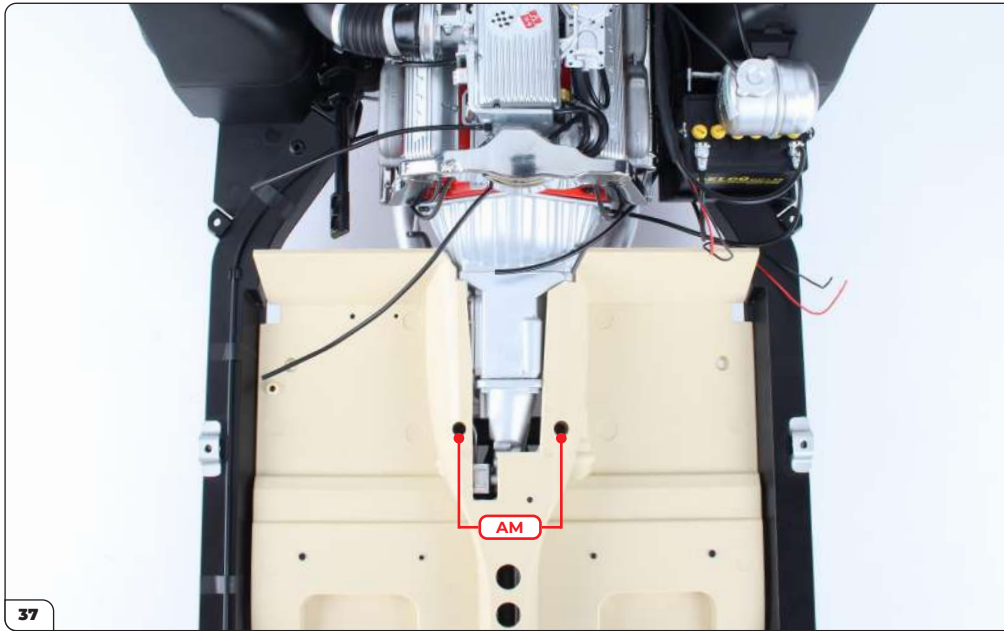

Use 2x AM screws to fix the gearbox bracket to the cockpit floor.

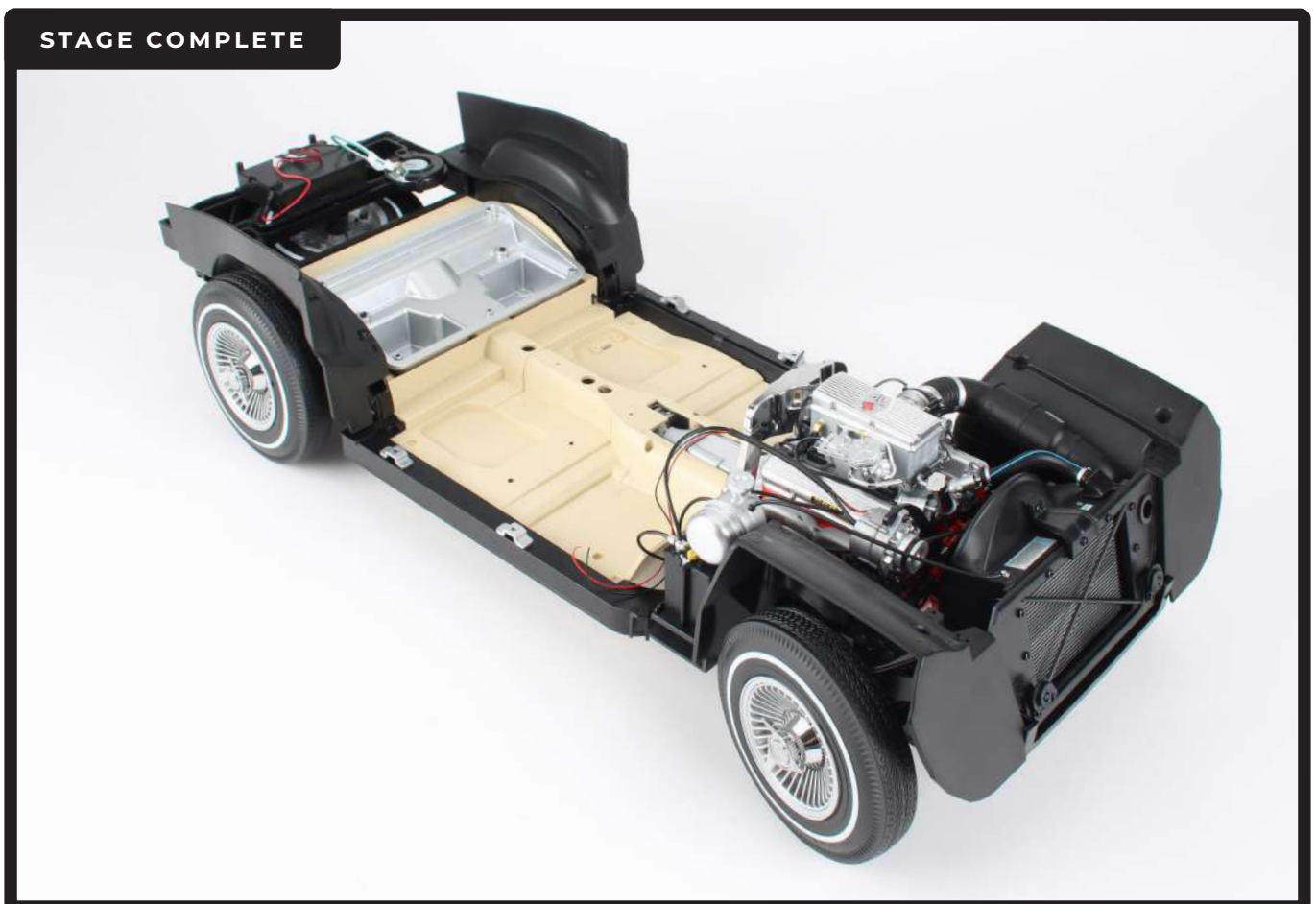

Stage 49: Installing the Fuel Tank

With the lower half of the 35-gallon fuel tank installed in the previous stage, you'll finish by fitting the top section of the tank in place.



STAGE 49 PARTS LIST

Name
35-gallon tank (upper)
Fuel hose
Fuel hose bracket
AM screw x3
IP screw x2



35-gallon tank (upper)



Fuel hose



Fuel hose bracket



AM x3



IP x2

Stage 49: Installing the Fuel Tank



1a



1b

Fit fuel hose to the fuel tank by feeding the tab on the end of the hose through the opening in the tank (1a). Fix using an IP screw (1b).



2

Fit the bracket onto the fuel hose as shown. Note the fitting is shaped to match the curve of the hose.



3

Lower the upper tank over the lower tank, aligning the screw sockets over the corresponding points.

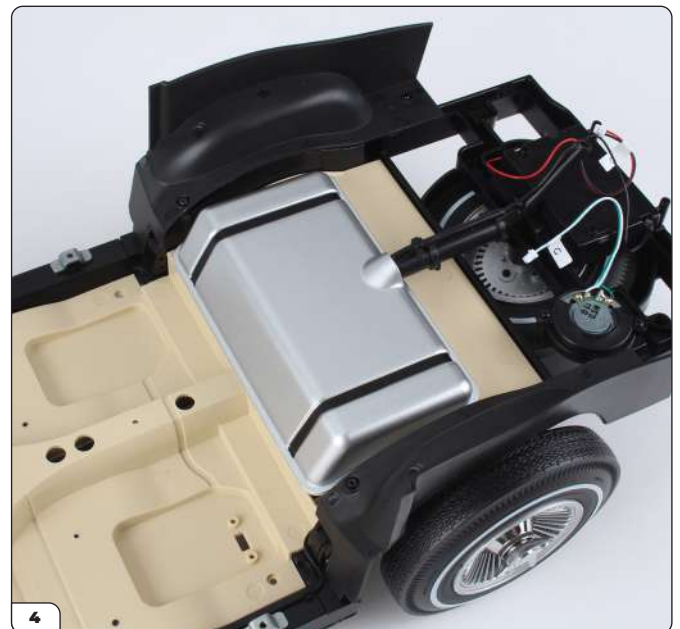

4

Press firmly until the two halves of the tank fit flush.

Stage 49: Installing the Fuel Tank

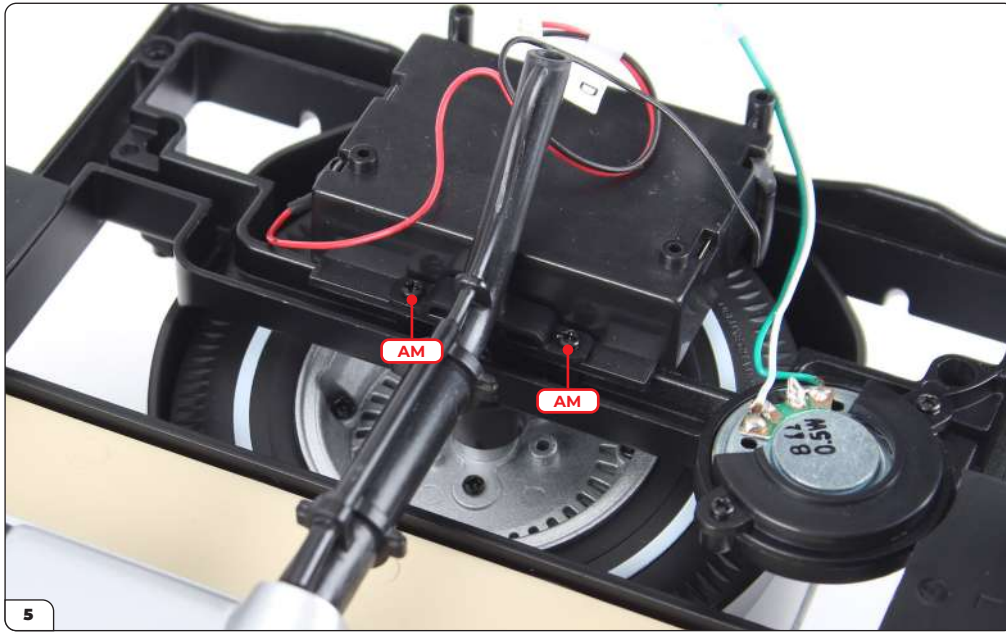

Fix the fuel hose bracket to the battery compartment with 2x AM screws.

STAGE COMPLETE

