

# TITANIC

THE SHIP • THE LEGEND

**Pack 15**







# FIRST SECTION OF THE BRIDGE DECK

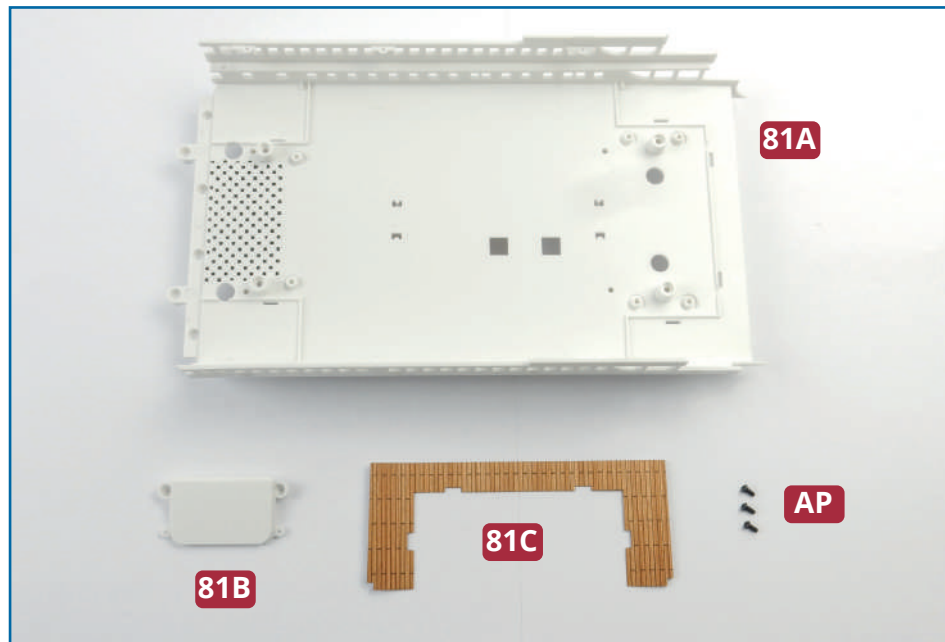

## PARTS IN THIS ISSUE

**81A** Forward section of the bridge deck

**81B** Closing panel

**81C** Decking

**AP** Three 2.3 x 5mm PB screws (1 spare)

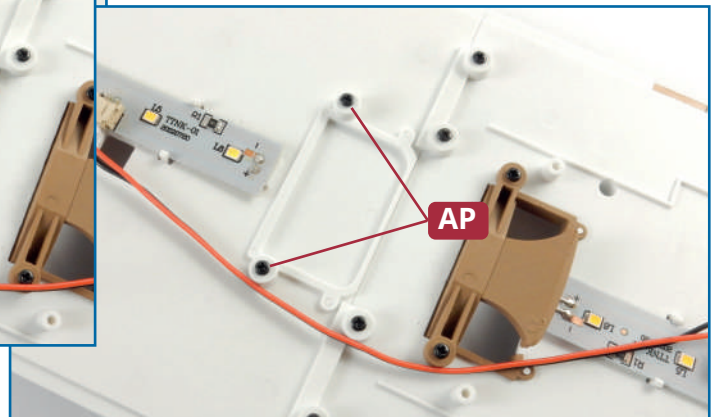
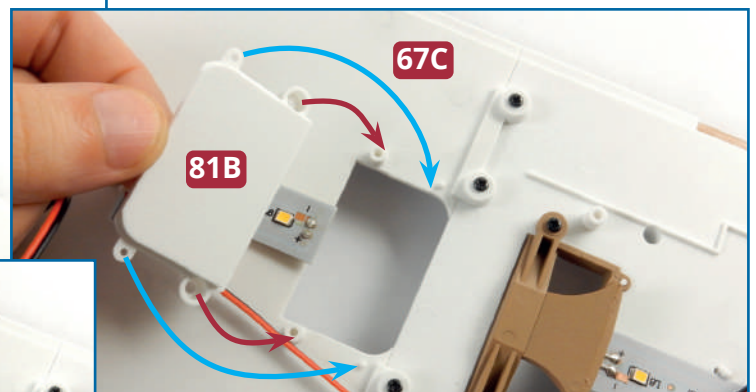
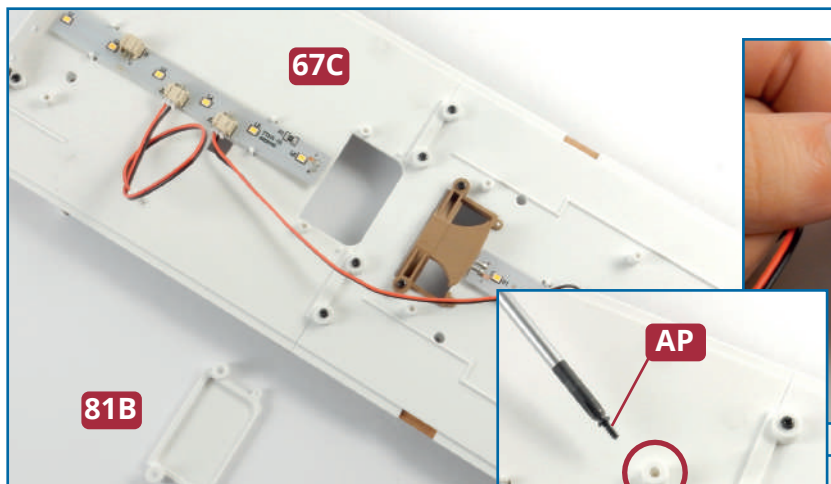

**1** Take the promenade deck from issue 76, turn it upside down and fit the closing panel **81B** into section **67C** of the deck. Pegs on the underside of the deck fit into small holes in part **81B** (blue arrows, top right) and screw holes align (red arrows). Fix the panel in place with two **AP** screws (right and far right).

## ★ STEP-BY-STEP INSTRUCTIONS ★

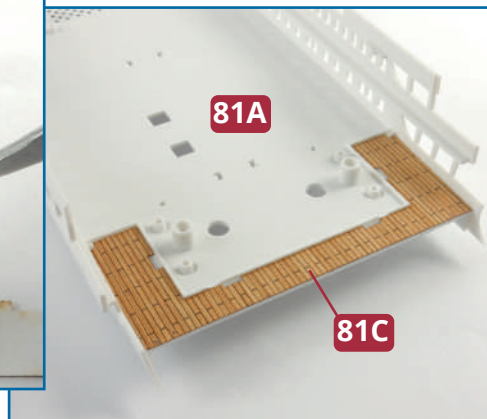
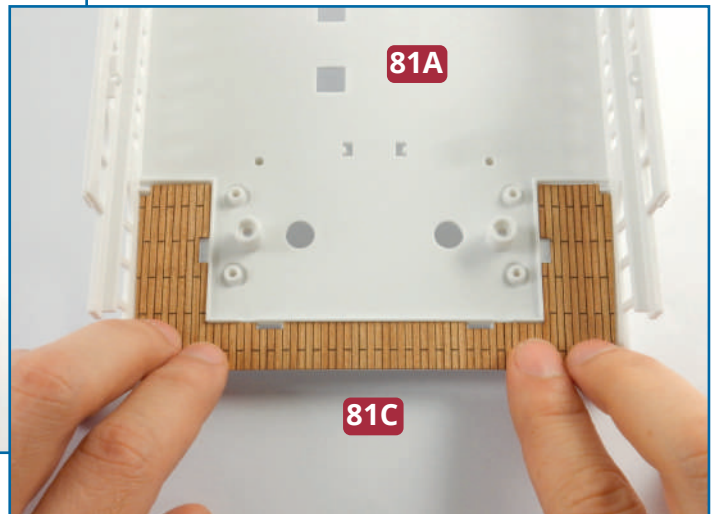
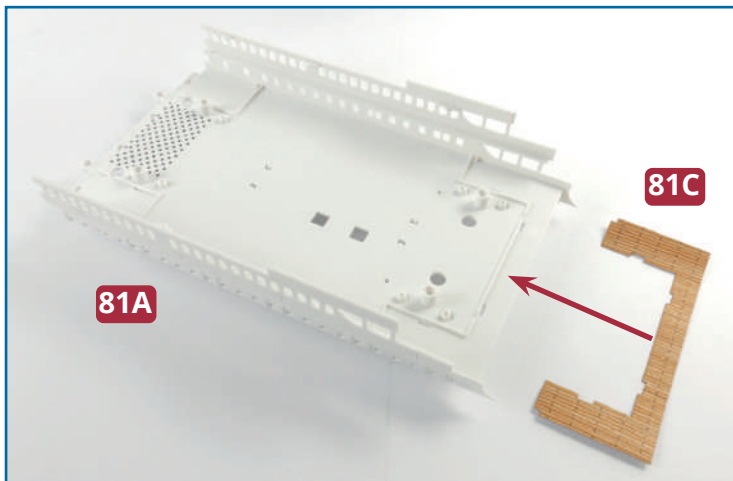

**2** Take the forward section of the promenade deck **81A** and the decking **81C**. Check how the decking fits to the deck. Remove the protective backing and fix the decking in place, smoothing it down with a soft cloth.

### Completed work

A panel has been fitted to the promenade deck and decking has been fitted to the forward end of the bridge deck.

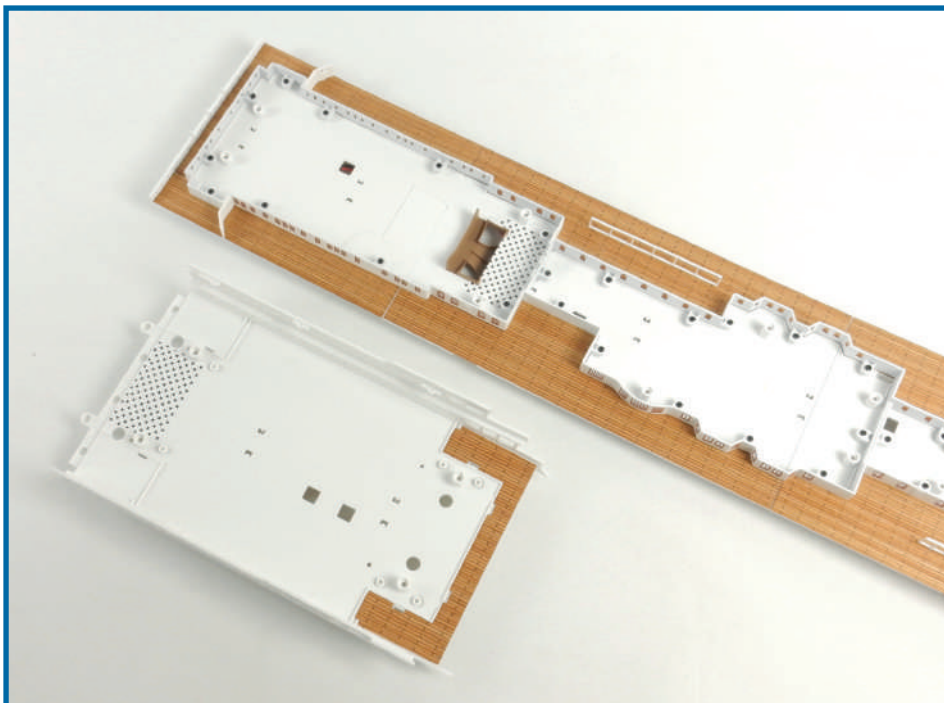





# SECOND SECTION OF THE BRIDGE DECK

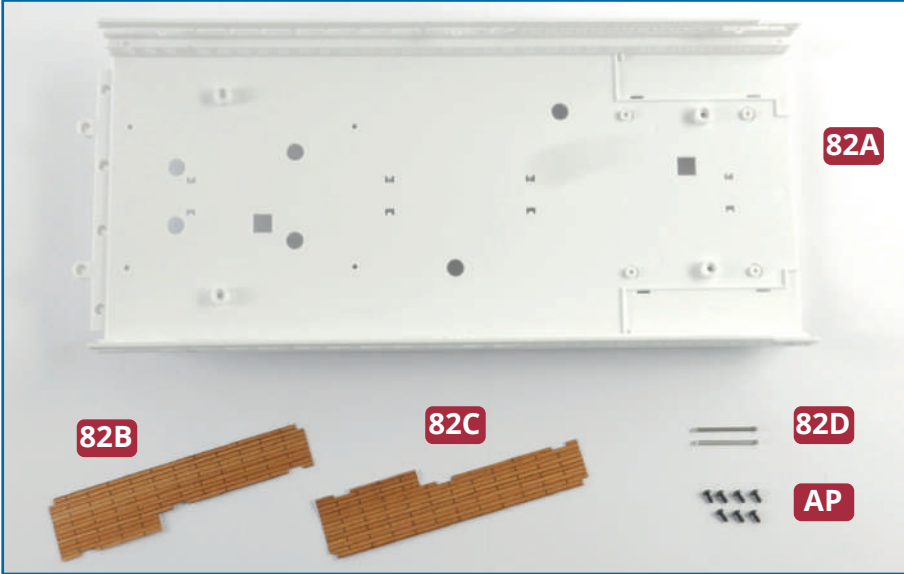

## PARTS IN THIS ISSUE

- 82A** Second section of the bridge deck
- 82B** Starboard decking
- 82C** Port decking
- 82D** Joining pieces (x 2)
- AP** Seven 2.3 x 5mm PB screws (1 spare)

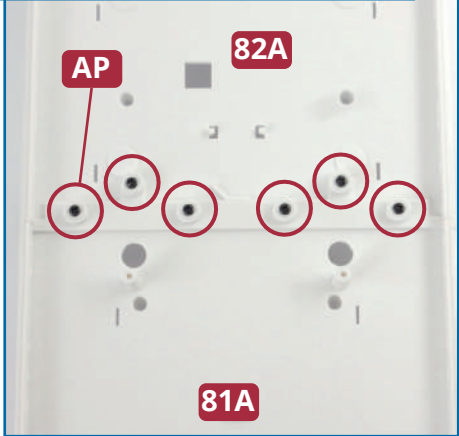
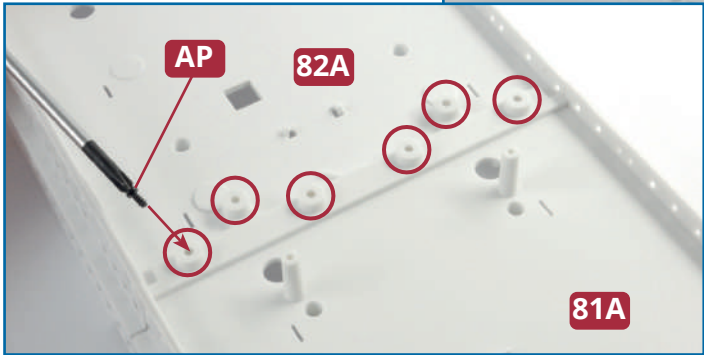
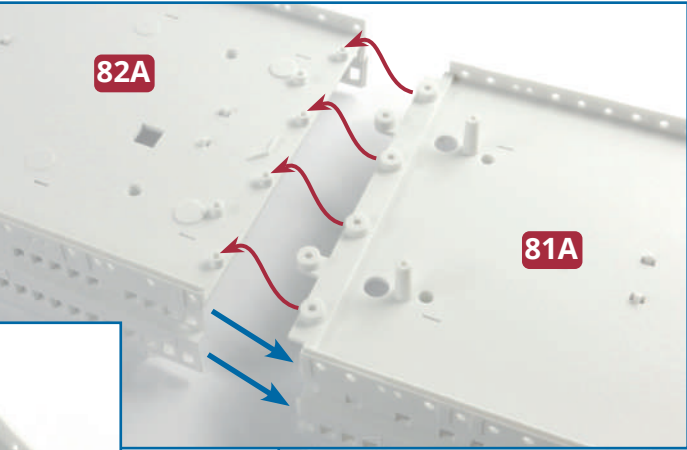

**1** Take the two bridge deck sections **81A** and **82A** and turn them upside down. Identify the fixing points (circled, above) and join the sections so that the screw holes in the tabs on part **81A** fit over the raised screw sockets on part **82A**. Lips on the vertical edges beside the windows and portholes overlap (blue arrows). Fix in place using six **AP** screws.

# ★ STEP-BY-STEP INSTRUCTIONS ★

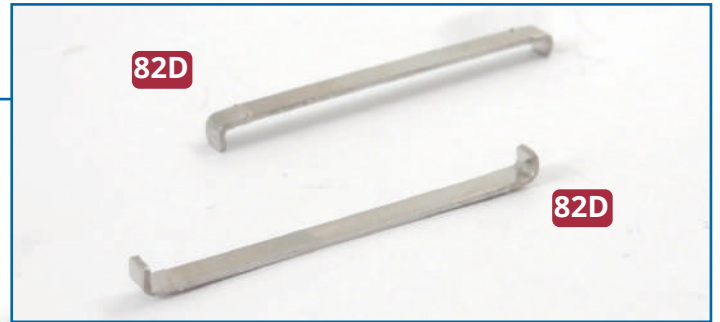
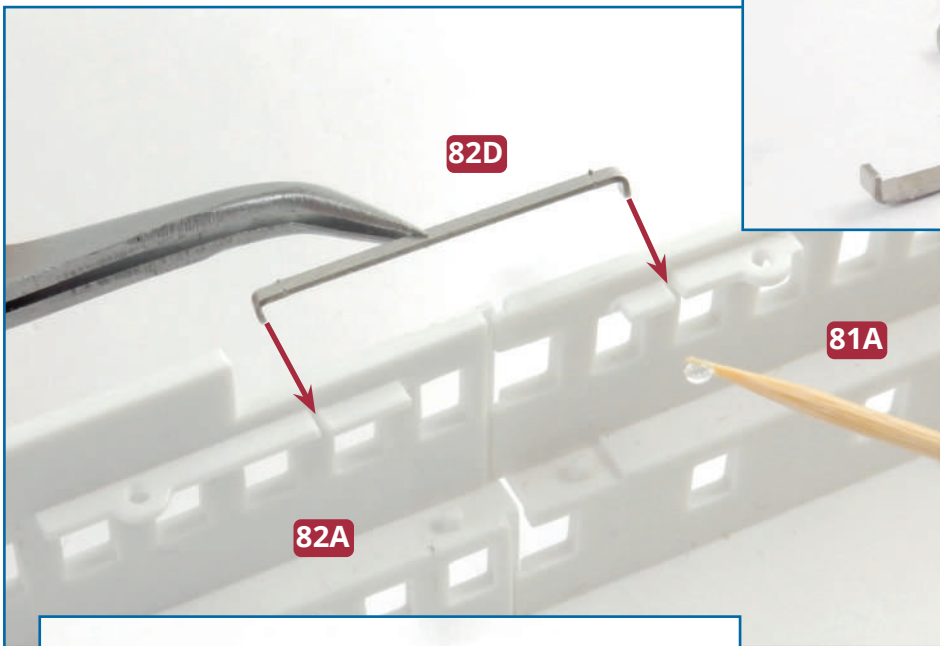

**2** Identify the fixing points for the joining pieces **82D**: the tabs on the ends of the parts fit into slots on the inside of the superstructure (arrows, left). Check that the assembly is completely flat, then glue the tabs in place as shown.

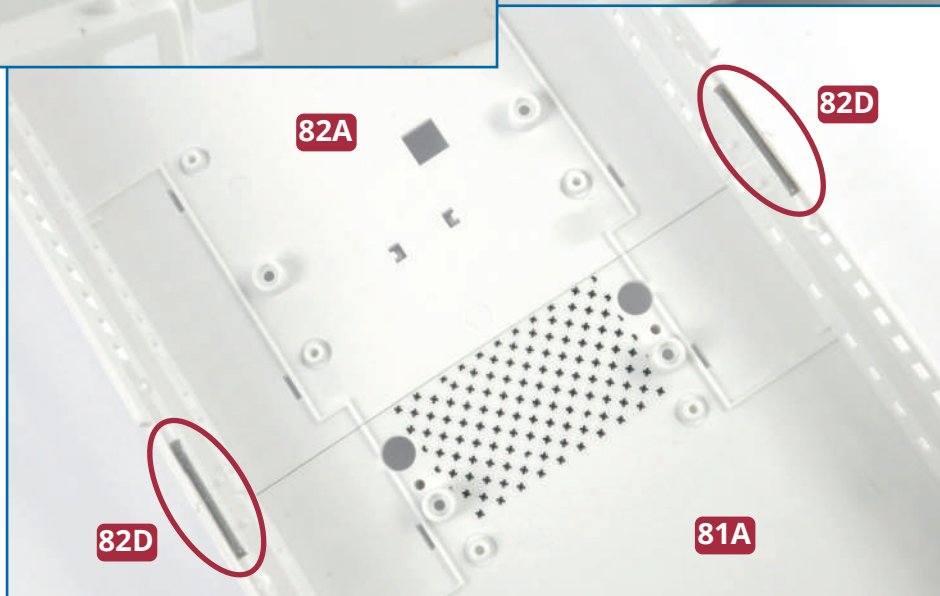
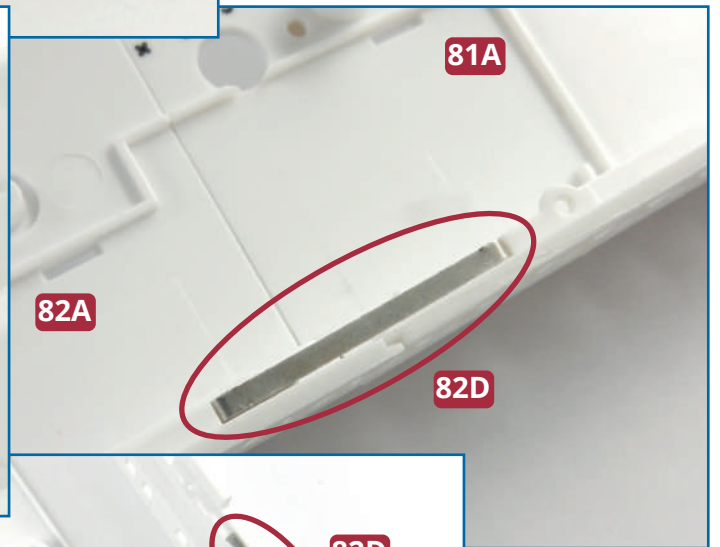
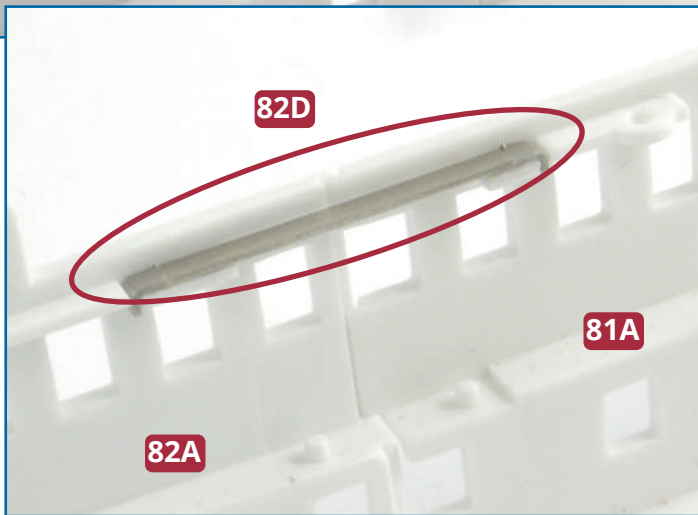



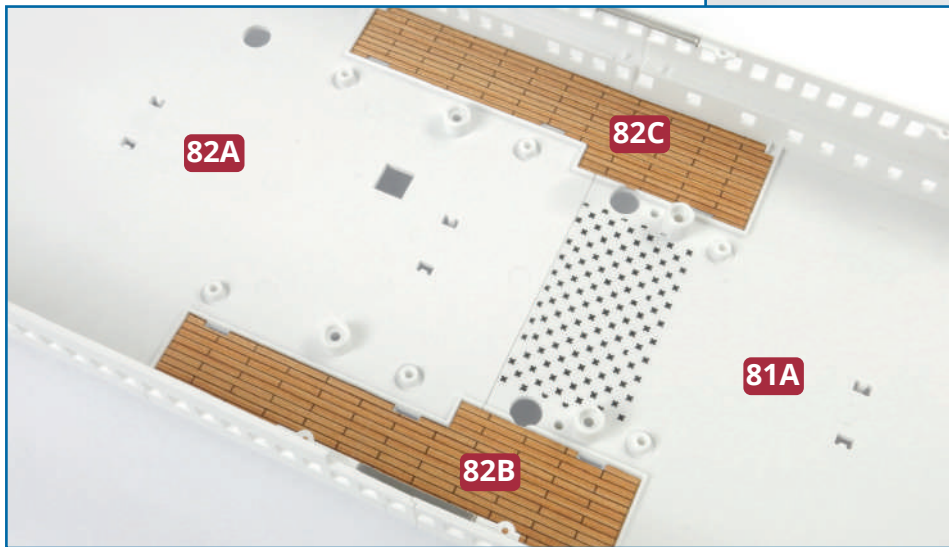
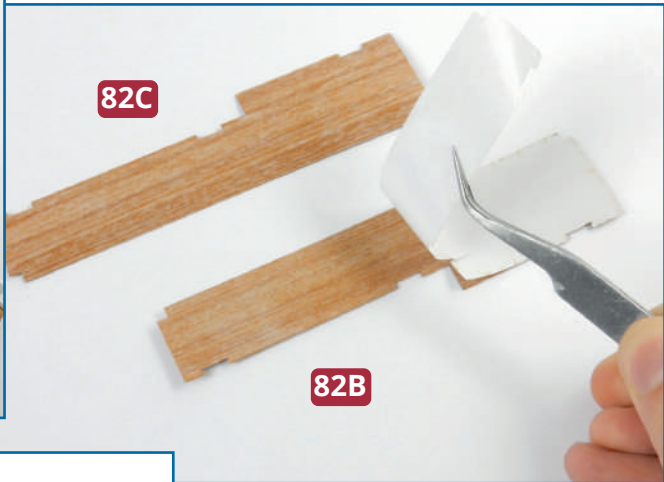
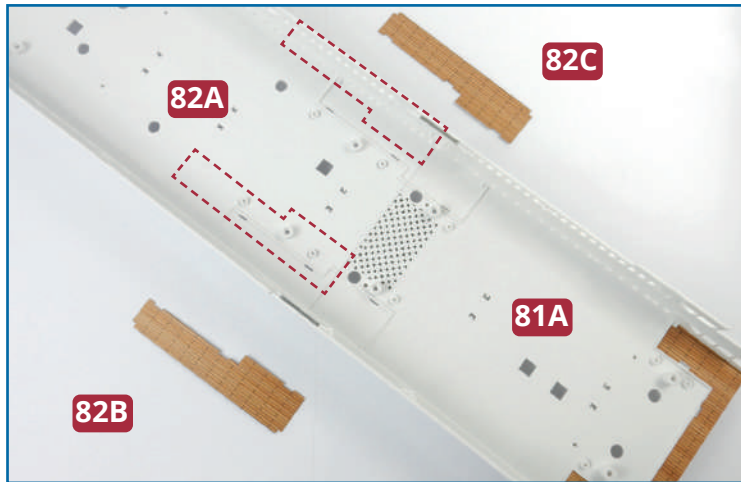

**3** Check the fit of the starboard and port decking **82B** and **82C** across the join between the sections of decking **81A** and **82A**. Remove the protective backing and fix the decking in place, smoothing it down with a soft cloth.

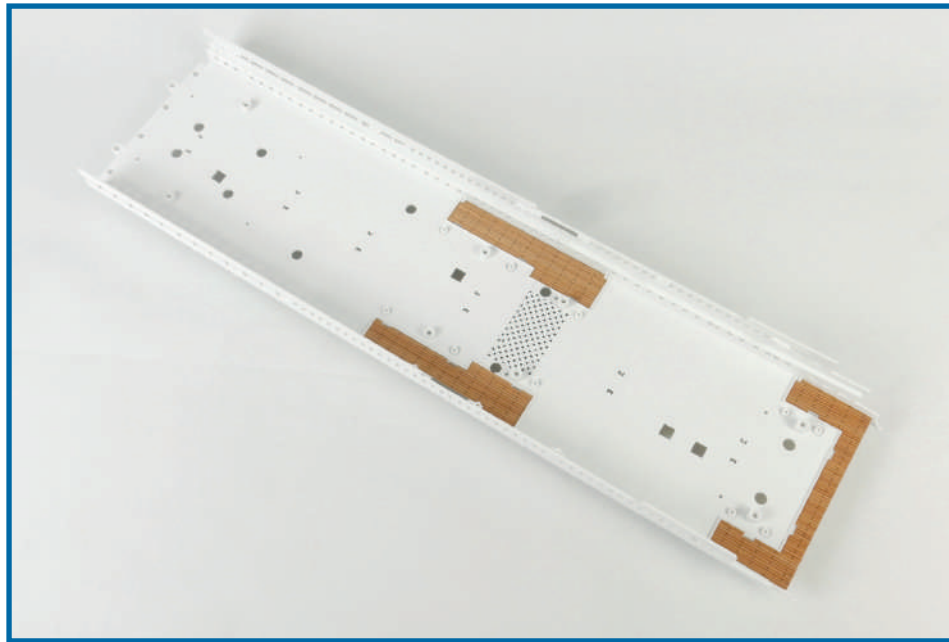

**Completed work**  
Two sections of the bridge deck have been joined together and panels of decking have been fixed in place.

# DETAILS FOR THE BRIDGE DECK

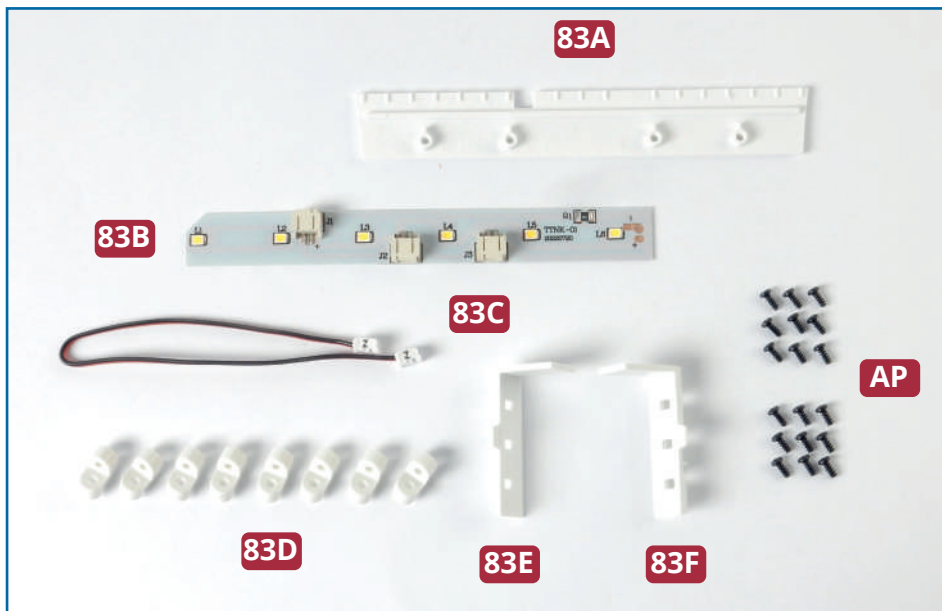

## PARTS IN THIS ISSUE

- 83A** Parapet
- 83B** LED strip
- 83C** LED cable
- 83D** Connectors (x 8)
- 83E** Starboard bulkhead
- 83F** Port bulkhead
- AP** Eighteen 2.3 x 5mm PB screws (1 spare)

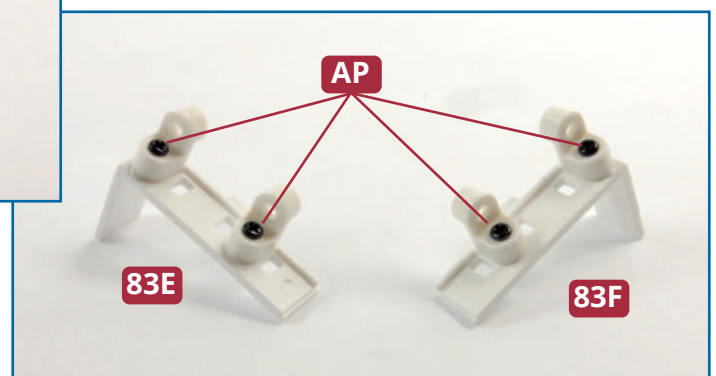
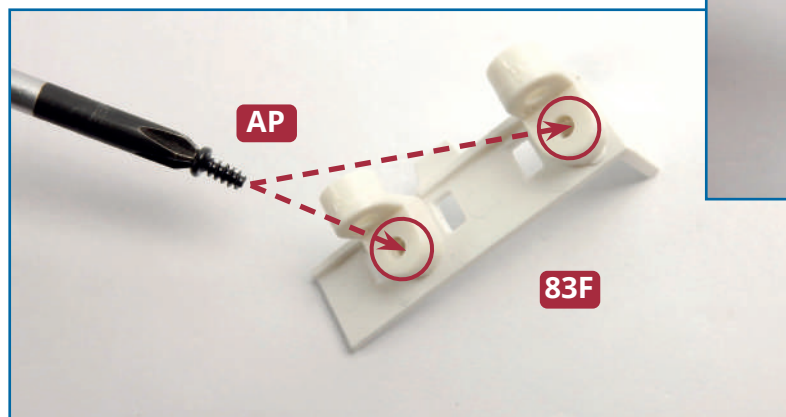
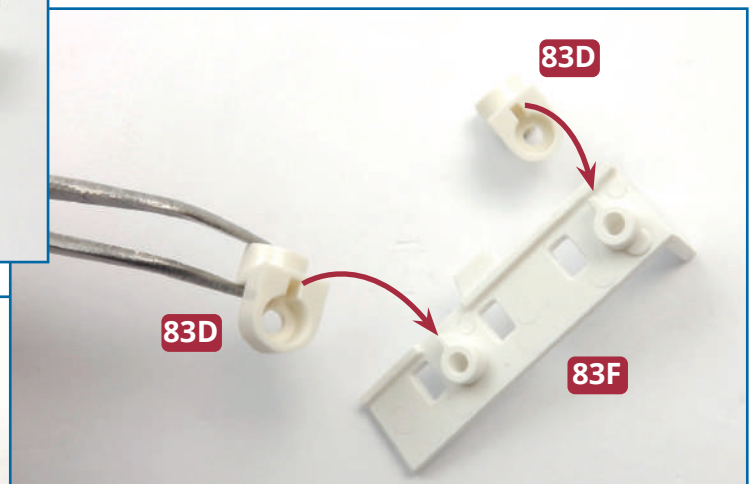
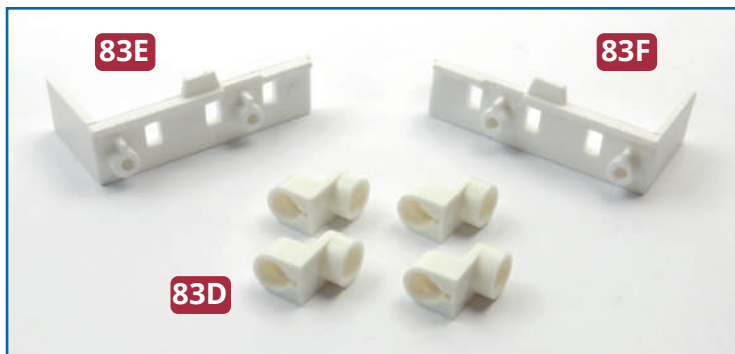

**1** Take the two bulkheads **83E** and **83F**. Fit two connectors **83D** to each bulkhead with **AP** screws, as shown. Note that there is a tab on the raised screw socket that fits into a slot in the connector to help you fit them correctly (arrows, above right).



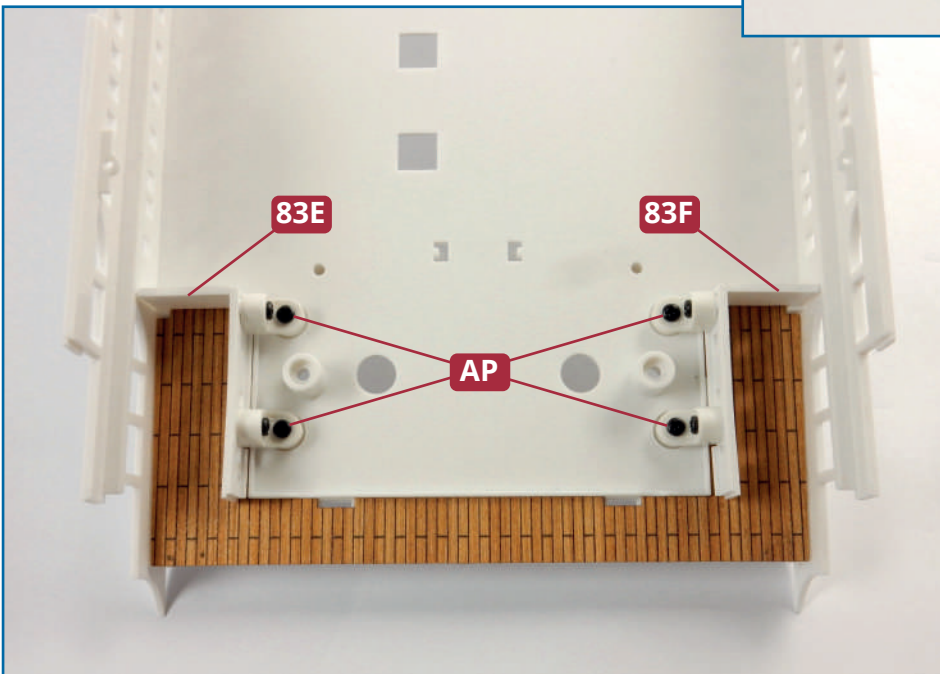
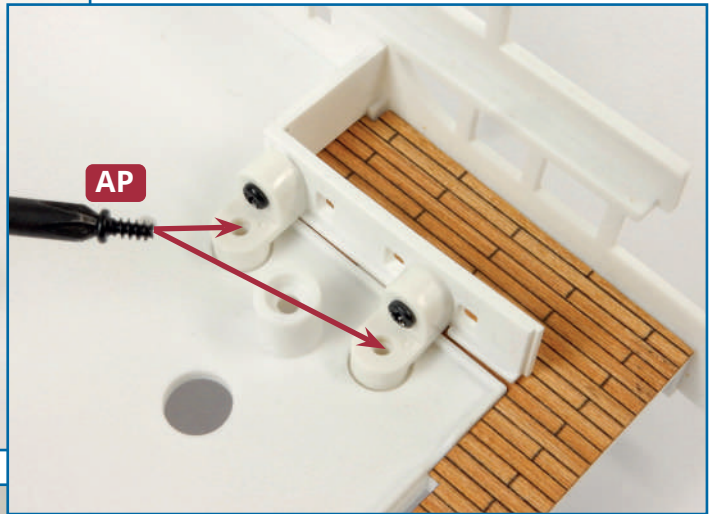
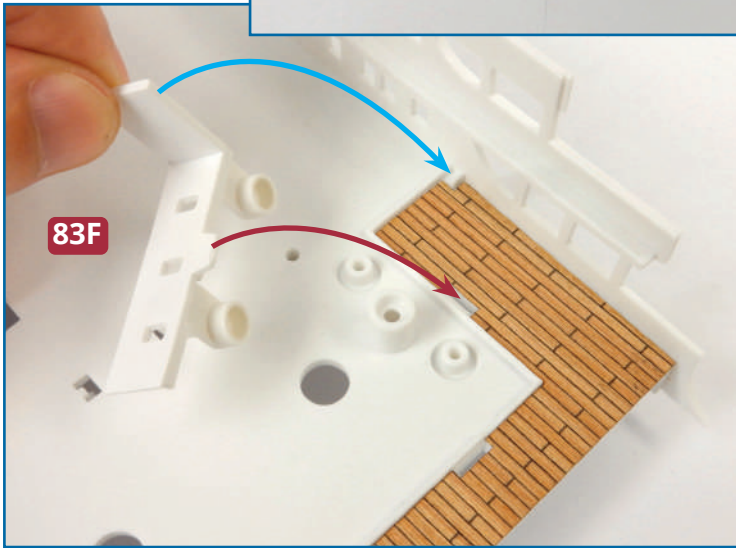
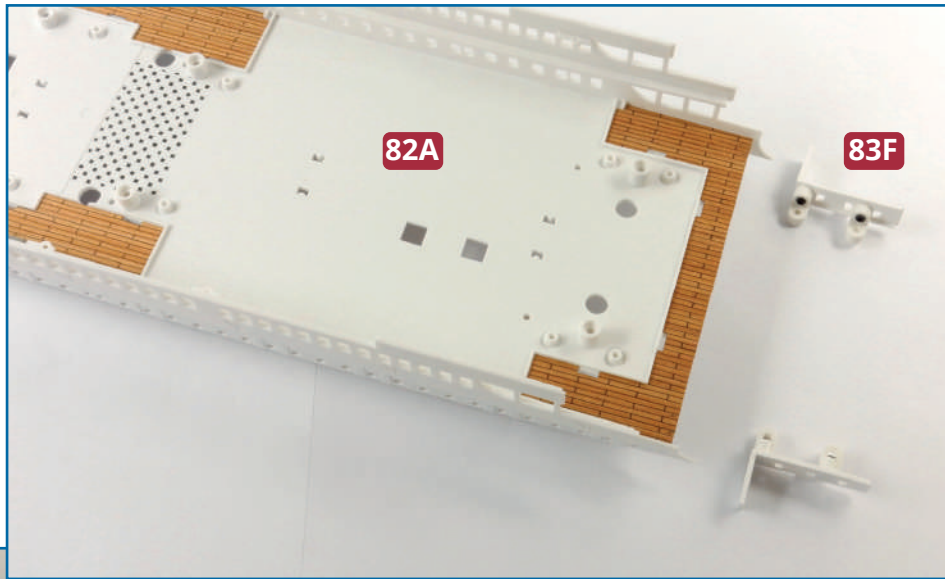

**2** Take the bridge deck assembly from the previous issue. Fit the port bulkhead **83F** to the port side of section **82A** of the bridge deck, and the starboard bulkhead **83E** to the starboard side. The outer end of each of the walls fits into a recess (blue arrow, above left) and a tab on the longer side fits into a recess (red arrow, above left). When you are happy with the fit, fix the connectors **83D** to the deck using **AP** screws (left).



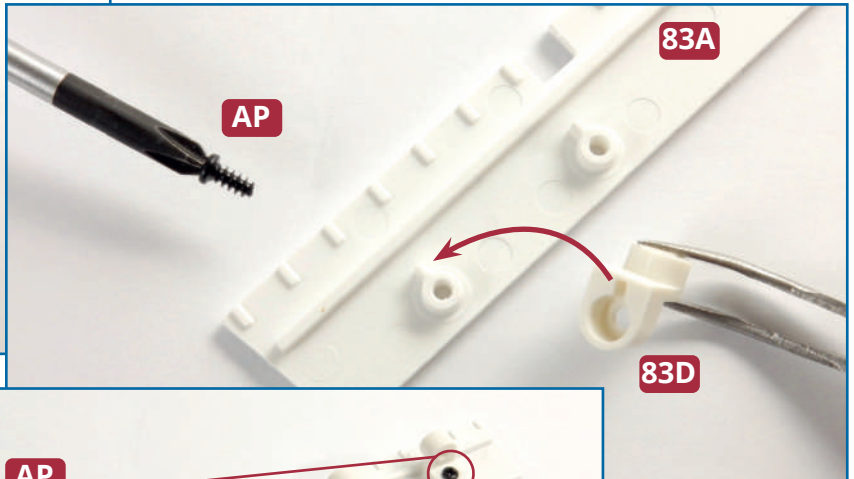
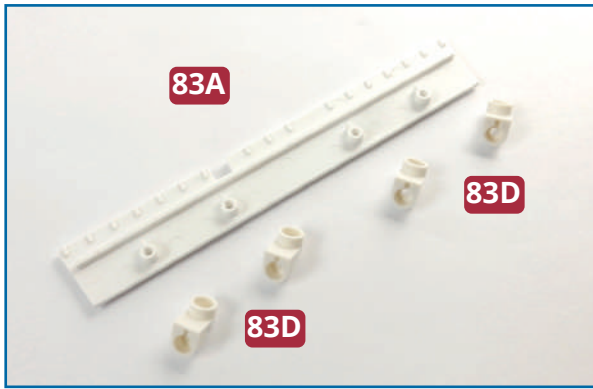

**3** Take the parapel **83A** and fit four connectors **83D**, as shown. There are tabs on the screw sockets on part **83A** to help you fit the connectors the right way round (arrow, above right). Fix the connectors in place with **AP** screws.

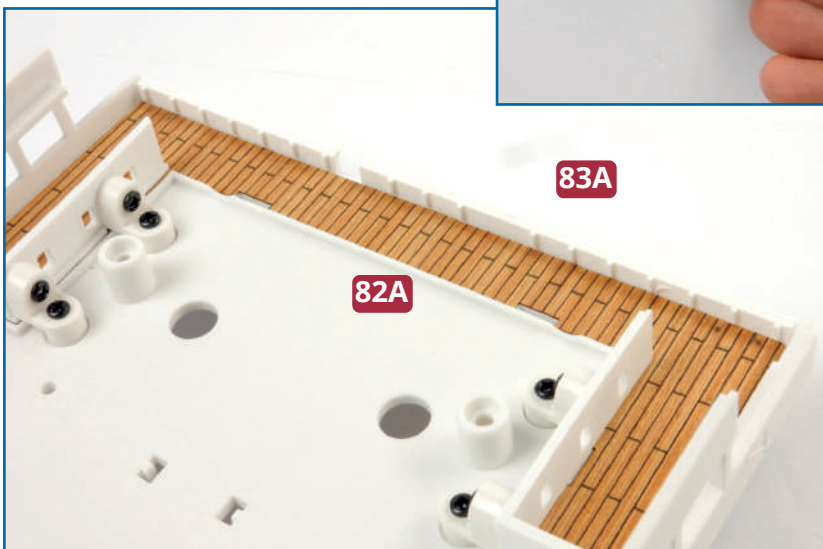
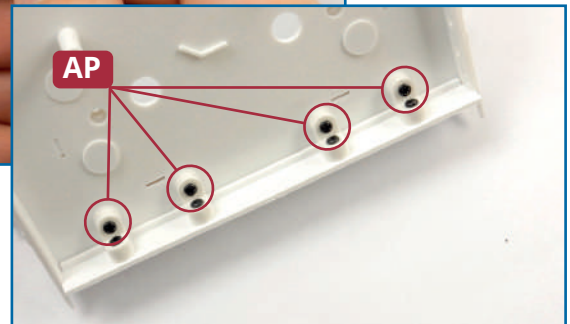
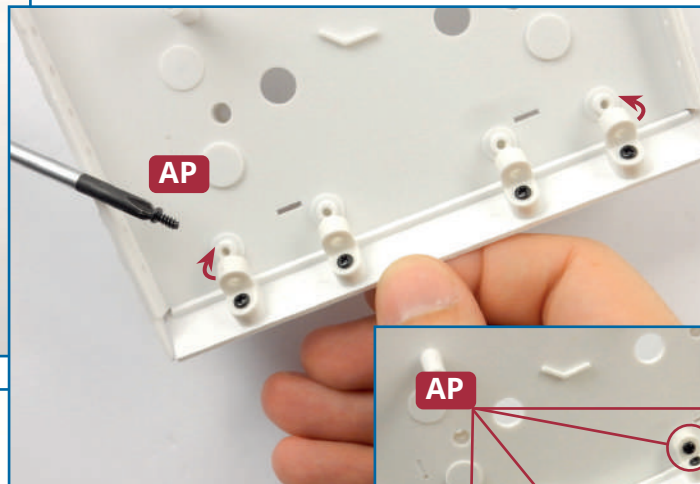
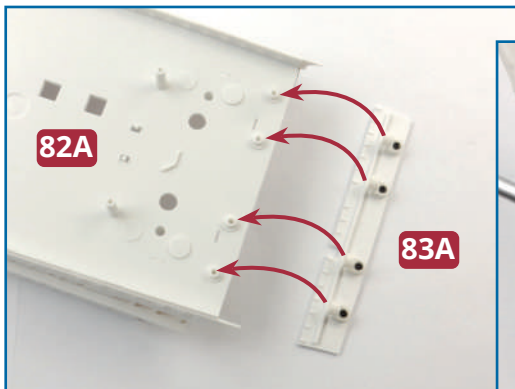
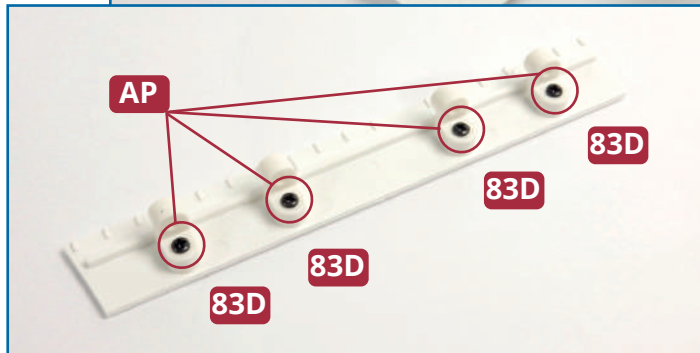

**4** Take the bridge deck and turn it upside down. The parapel **83A** fits along the forward edge of the bridge deck **82A**. The connectors fit over raised screw sockets on the underside of the deck. Fix the parapel in place with **AP** screws as shown.

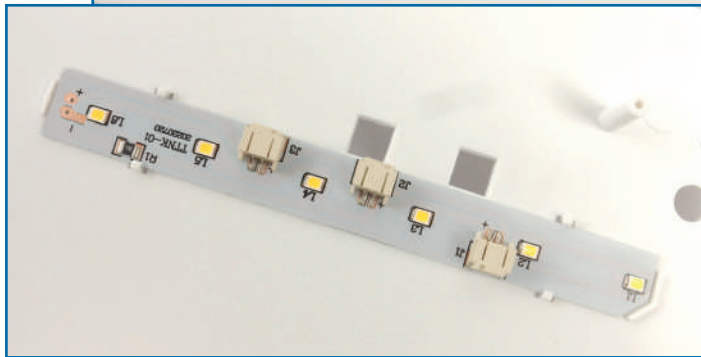
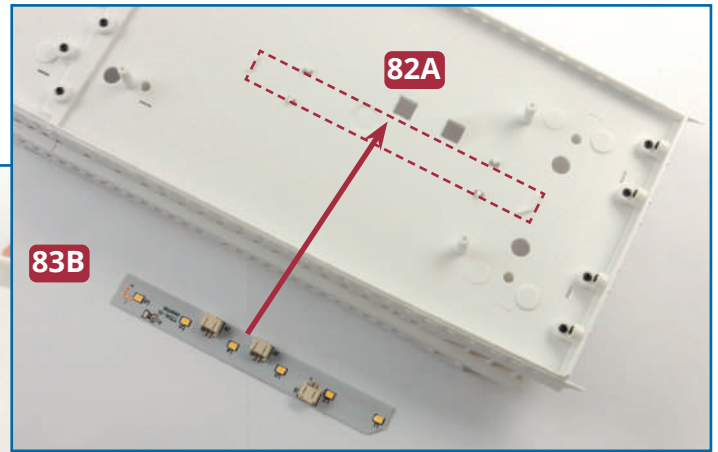
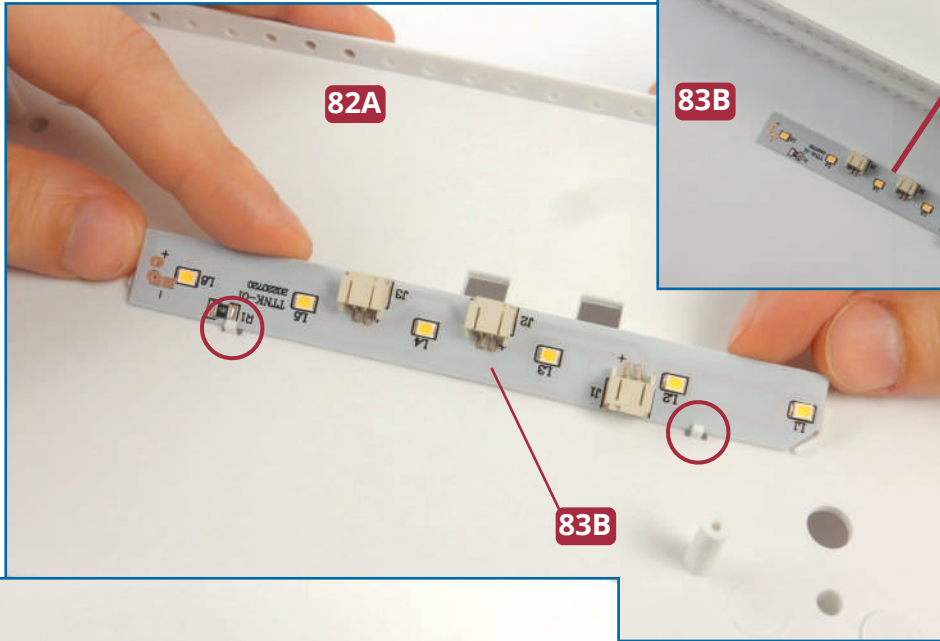

**5** Identify the fixing point for the LED strip **83B** on the underside of section **82A** of the bridge deck. Fix the strip under the clips on one side (circled, above left) and then lever the clips on the other side to fix the LED in place.

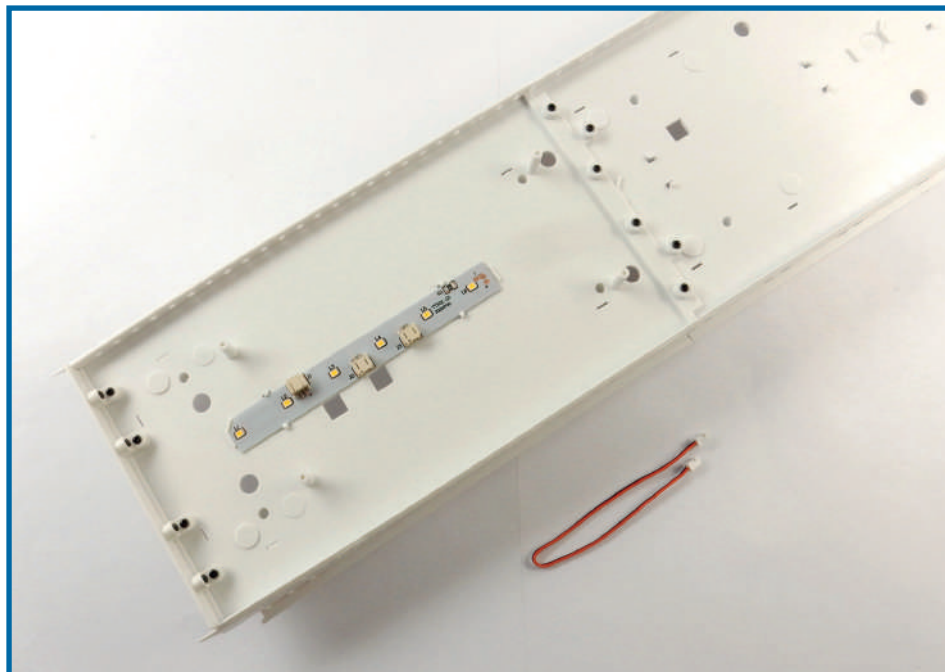

## **Completed work**

Bulkheads and a parapet have been fitted to the bridge deck. An LED strip has been fitted to the underside of the deck. Store the cable safely until it is needed.



# CABIN BULKHEADS AND WINDOWS

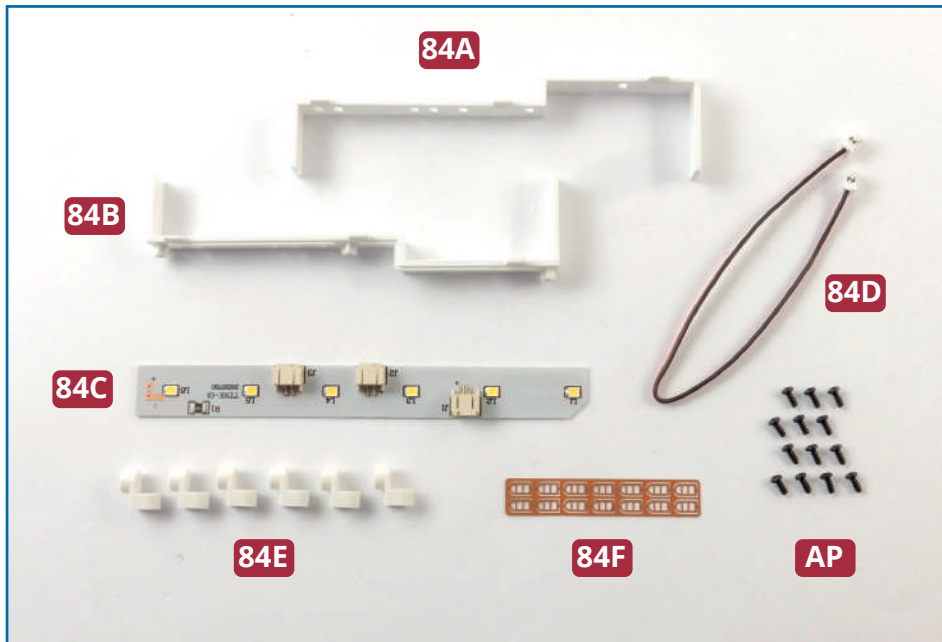

## PARTS IN THIS ISSUE

- 84A** Bulkhead for port cabins
- 84B** Bulkhead for starboard cabins
- 84C** LED strip
- 84D** LED cable
- 84E** Connectors (x 6)
- 84F** Windows (x 14)
- AP** Thirteen 2.3 x 5mm PB screws (1 spare)

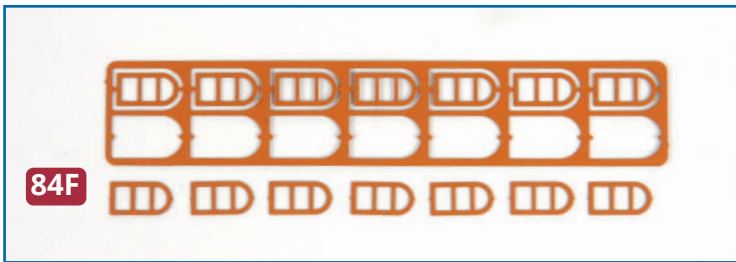

**1** Remove seven windows **84F** from the frame. One at a time, apply a little glue to the rim around the window frames on the outside of the bulkhead for the starboard cabins **84B** and glue the windows in place.

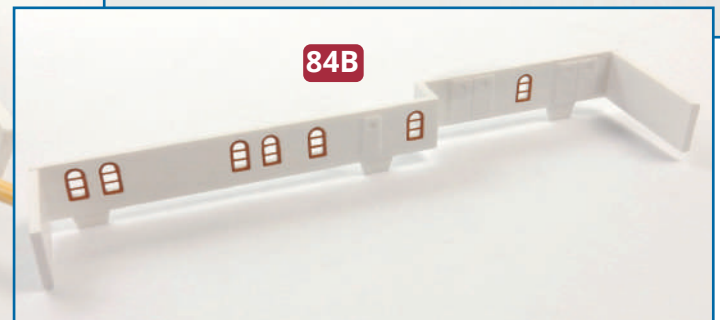
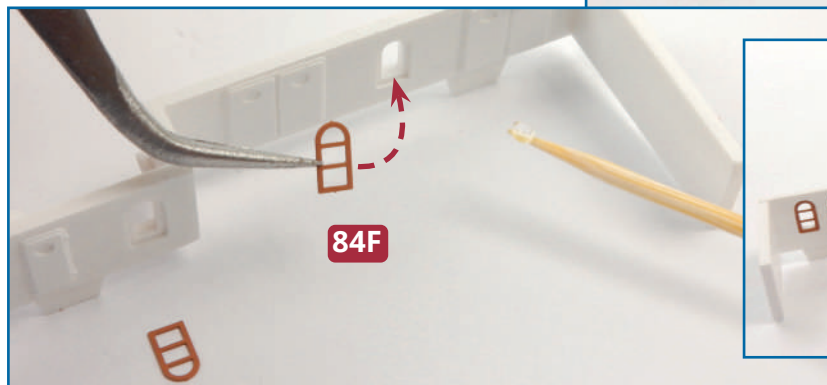
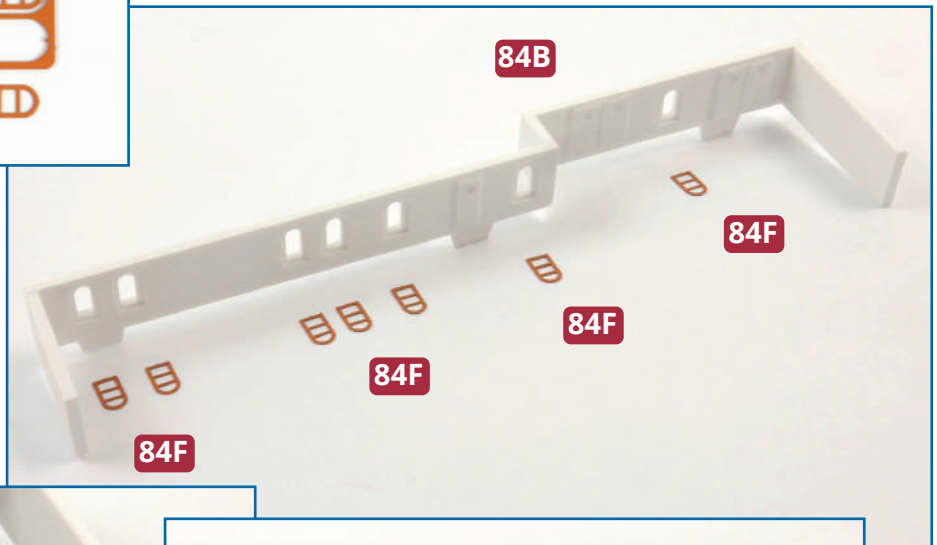

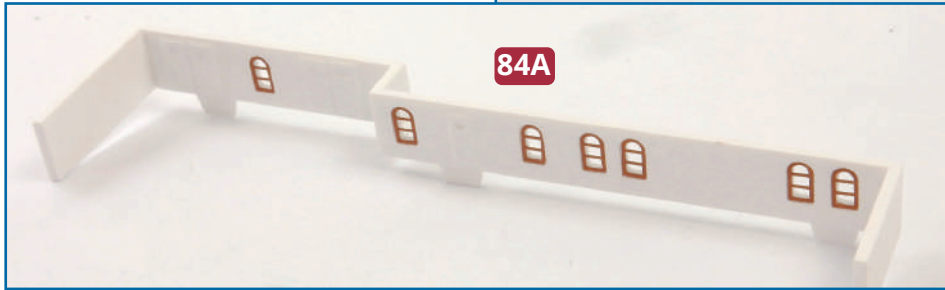
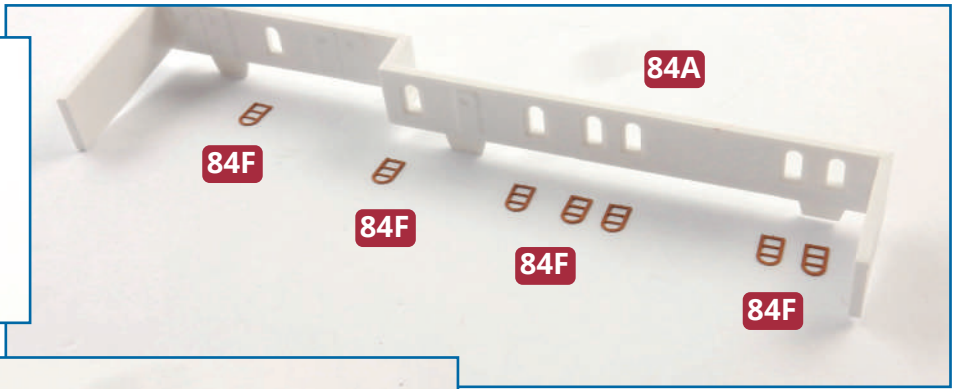
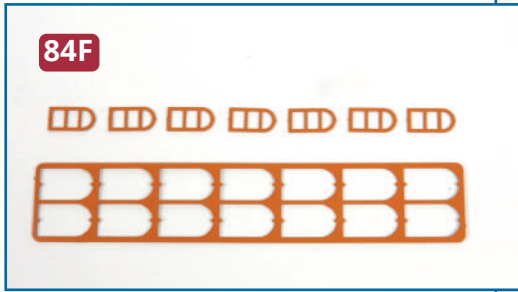

**2** Similarly, remove the remaining seven windows **84F** from the frame and glue them in place on the bulkhead for the port cabins **84A**, as shown.

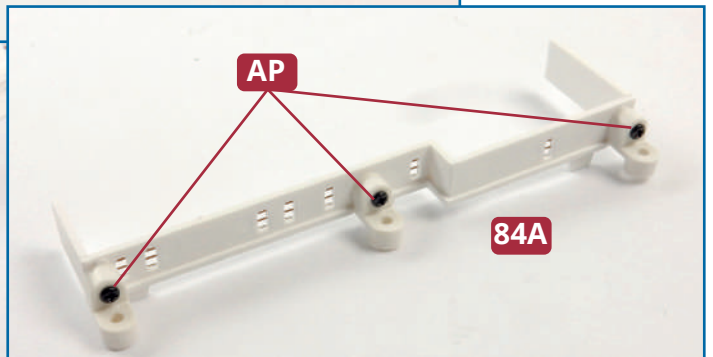
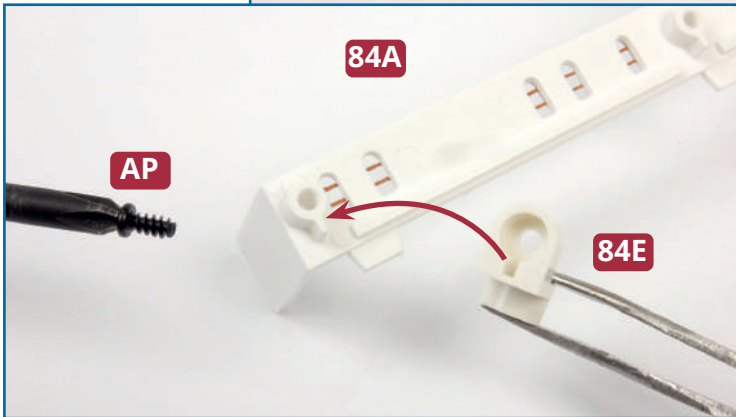
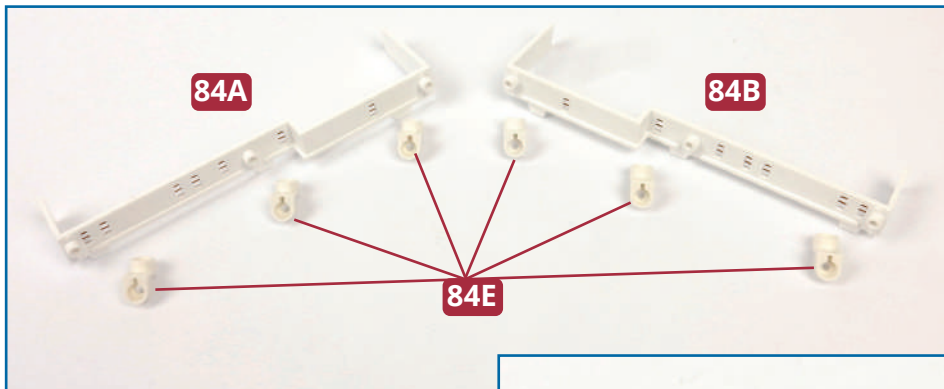

**3** Take the six **84E** connectors and the two bulkheads **84A** and **84B**. Fit the connectors to the bulkheads as shown, and fix in place using six **AP** screws. The raised screw sockets on the bulkheads have a tab to help you fit the connectors correctly (arrow, above).

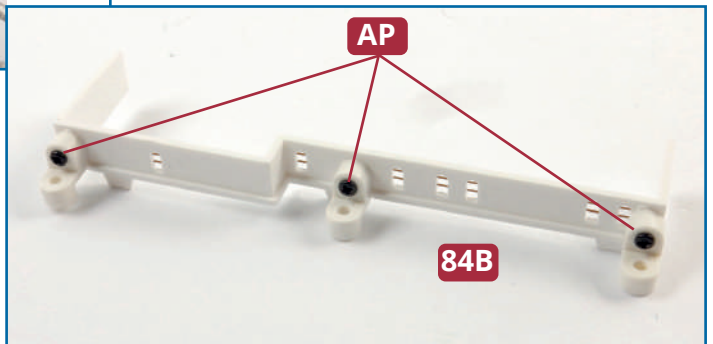



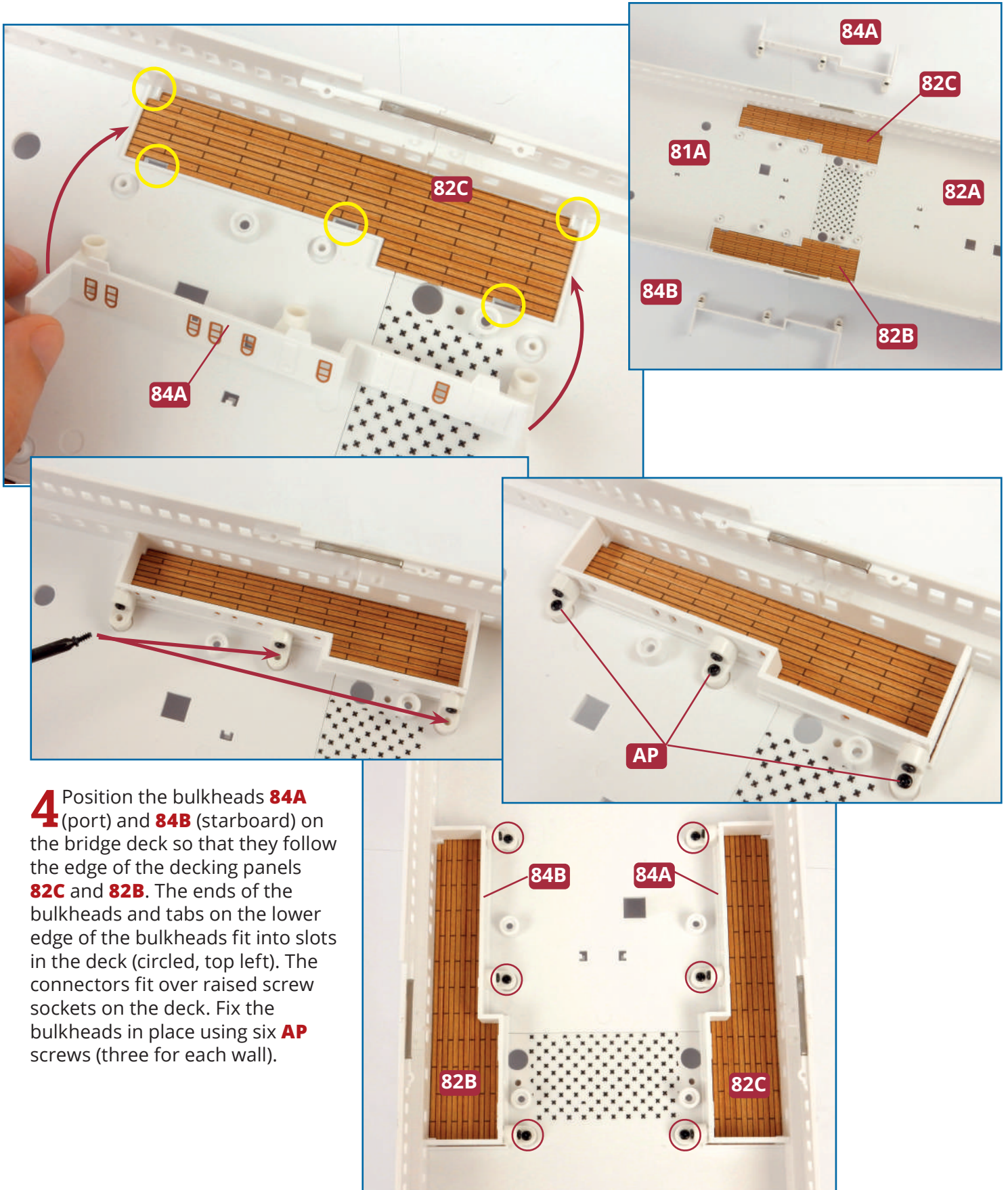

**4** Position the bulkheads **84A** (port) and **84B** (starboard) on the bridge deck so that they follow the edge of the decking panels **82C** and **82B**. The ends of the bulkheads and tabs on the lower edge of the bulkheads fit into slots in the deck (circled, top left). The connectors fit over raised screw sockets on the deck. Fix the bulkheads in place using six **AP** screws (three for each wall).



**5** Turn the bridge deck over and identify the fixing point for the LED strip **84C** on the underside of section **81A** of the deck. Fit the strip in place, fitting one side under the clips (circled, below) and then levering the other clips in place.

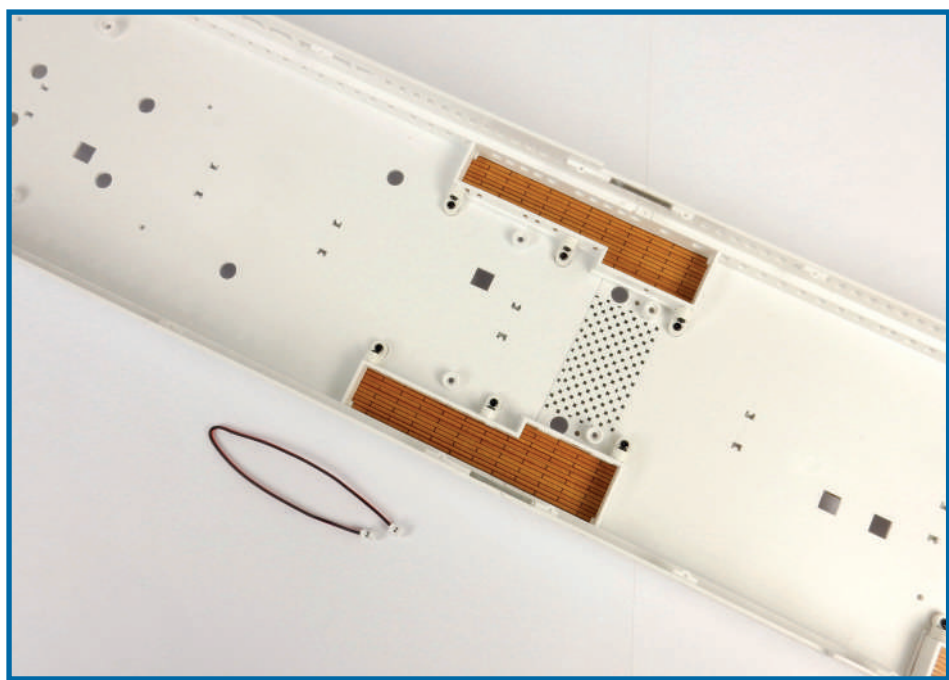
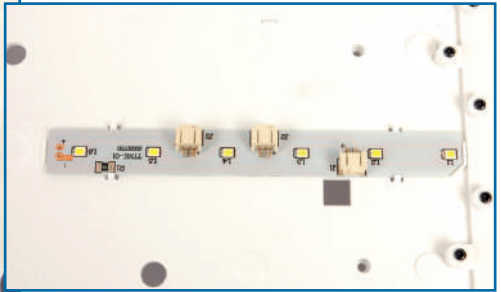
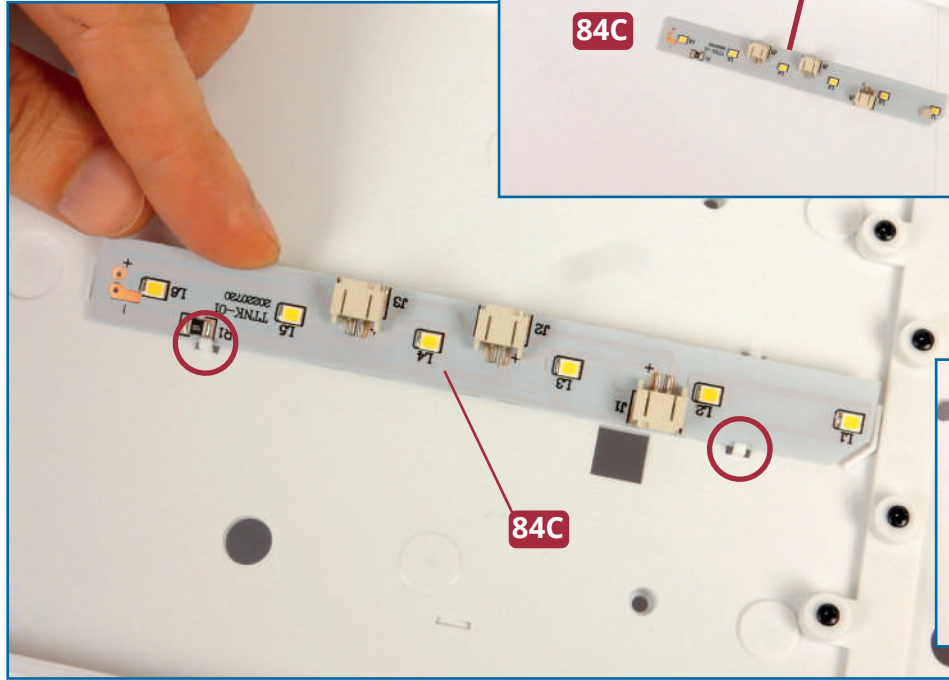
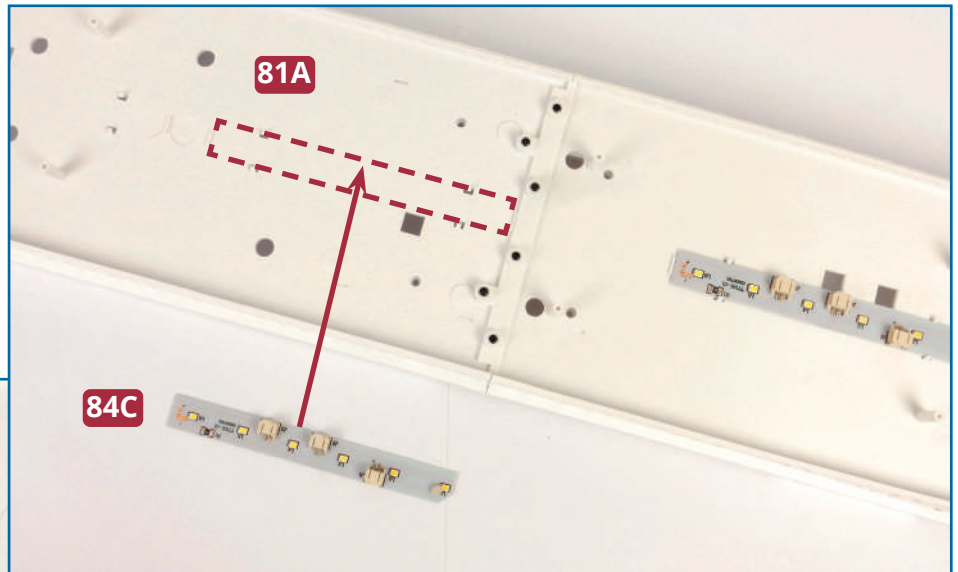

### **Completed work**

The bulkheads for the port and starboard cabins have been fixed in place, and an LED strip has been fitted on the underside of the deck. Store the cable safely until it is needed.



# THE NEXT SECTION OF THE HULL

## PARTS IN THIS ISSUE

**85A** The next section of the hull (port side)

**BM** Three 2 x 4mm KM screws (1 spare)

**LM** Three 2.6 x 3mm PWM hexagonal headed screws (1 spare)

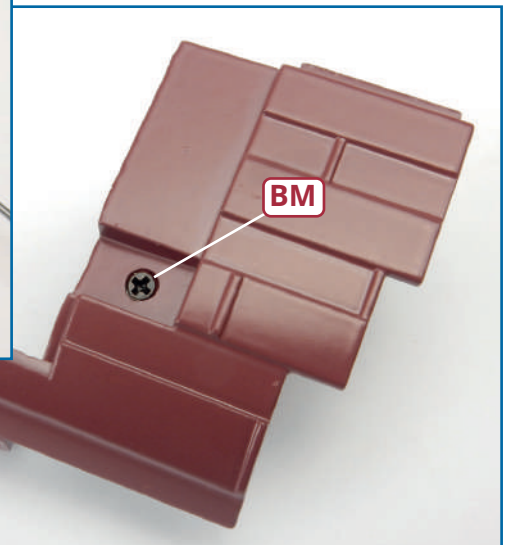
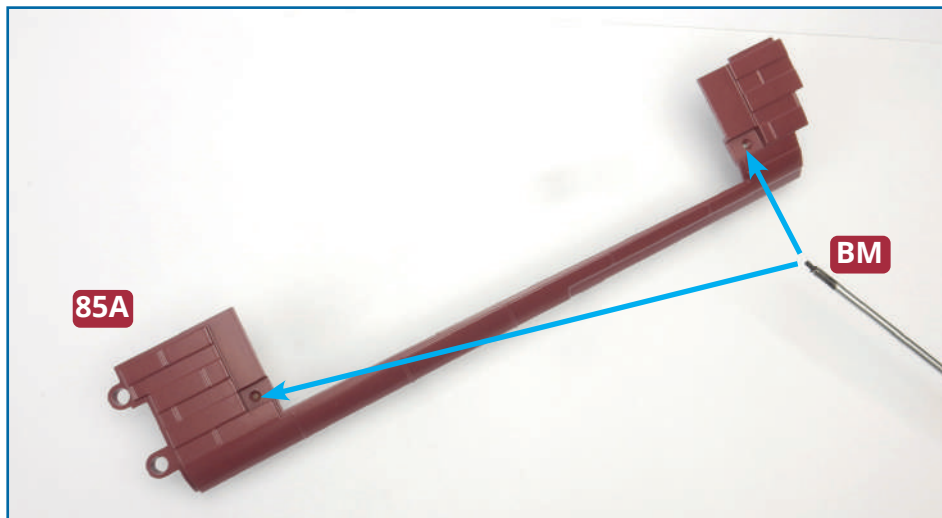
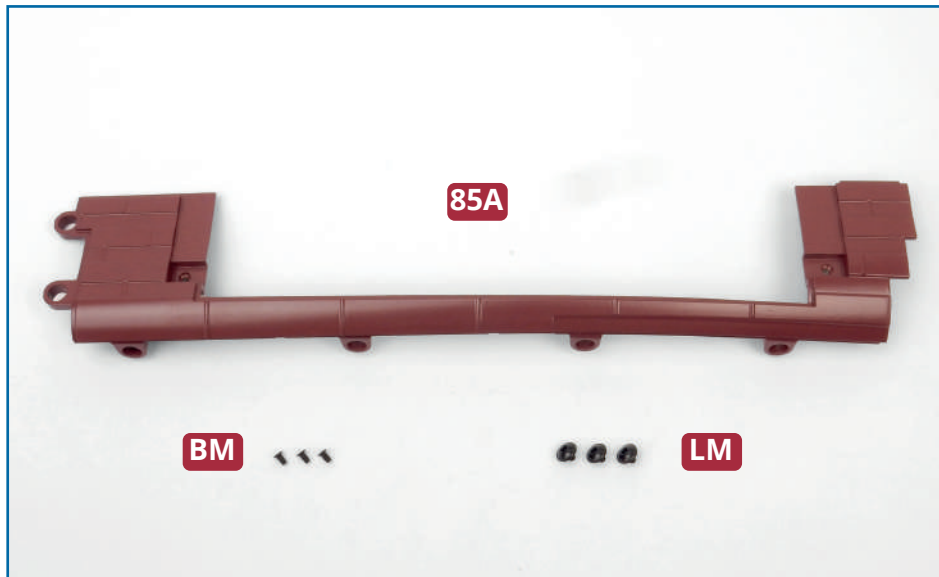

**1** Take the next section of the hull **85A** (marked L12) and fit two **BM** screws in the sockets as indicated. Fully tighten both screws.

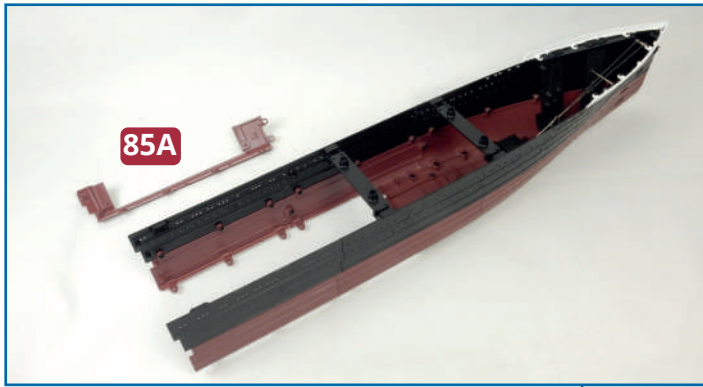

**2** Fit hull section **85A** at the rear end of hull section **77A**, so that the tabs on part **85A** overlap the screw holes on part **77A** as shown (right). Fix section **85A** to section **77A** with two **LM** screws. Use the Allen key supplied with issue 15 to tighten the screws.

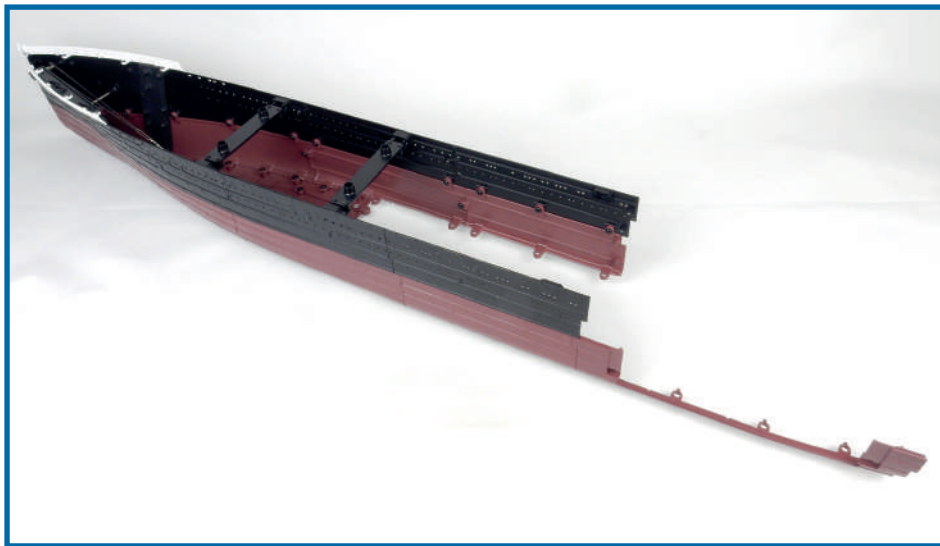
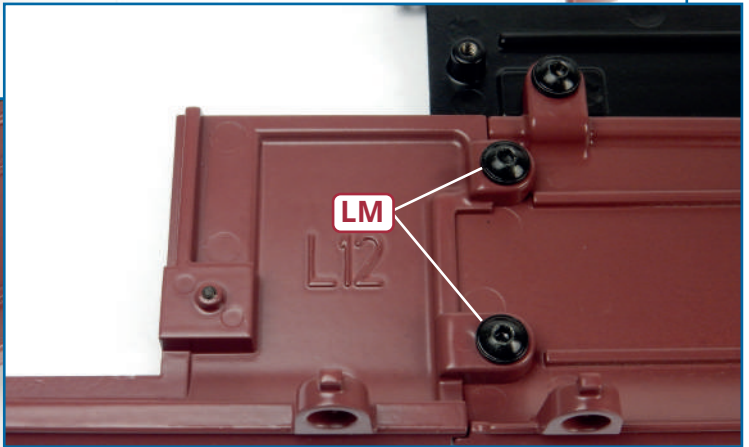
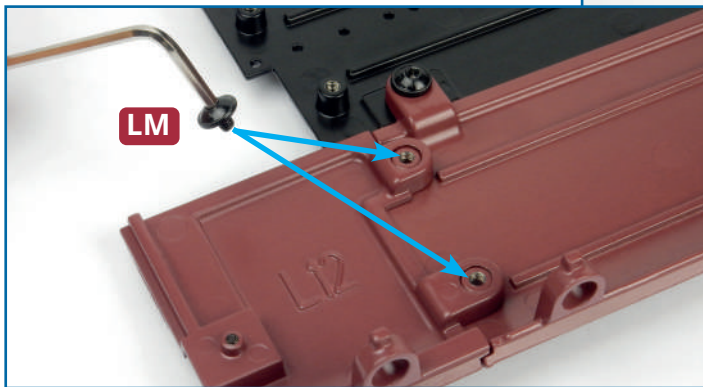
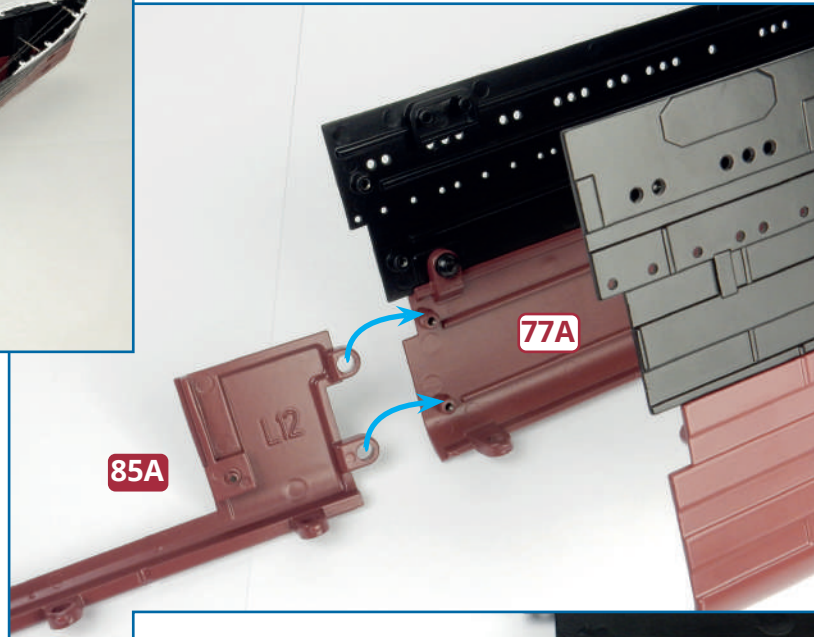

## **Completed work**

The next section of the hull has been fitted. This section has a window in it so that when the model is complete you will be able to see the engine working.



# THE NEXT SECTION OF THE HULL (UPPER PORT SIDE)

## PARTS IN THIS ISSUE

**86A** Hull section (upper port side)

**BM** Three 2 x 4mm KM screws (1 spare)

**LM** Three 2.6 x 3mm PWM hexagonal headed screws (1 spare)

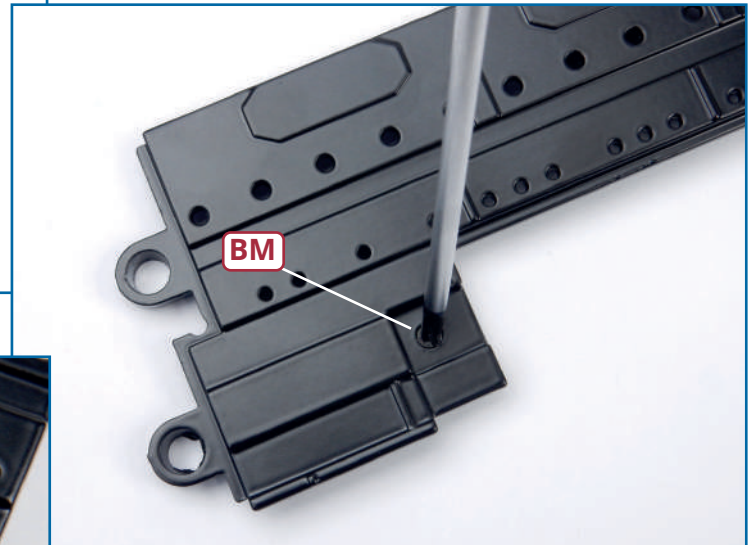
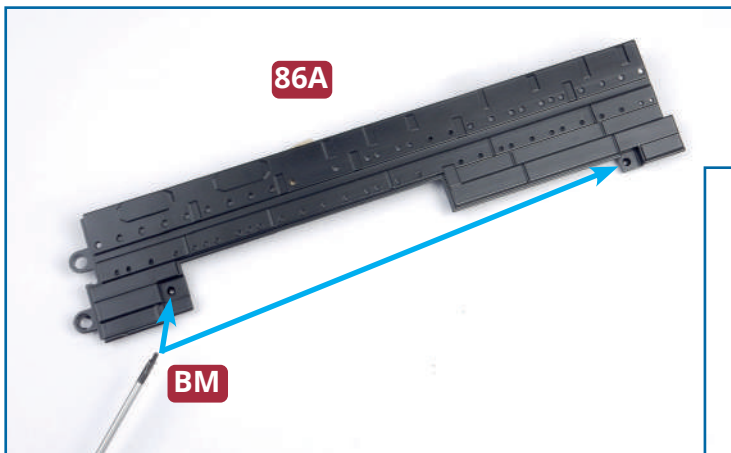
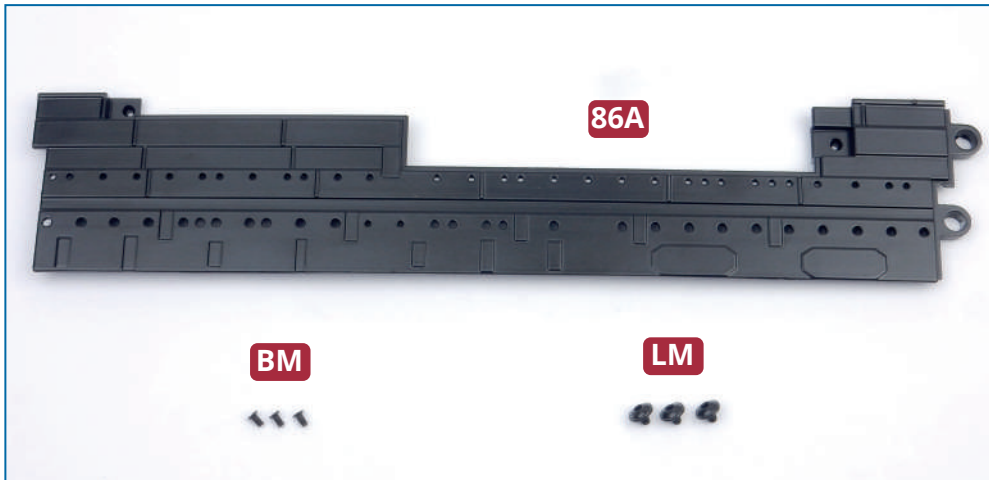

**1** Take the next section of the hull **86A** and fit two **BM** screws in the holes as indicated. Fully tighten both screws.

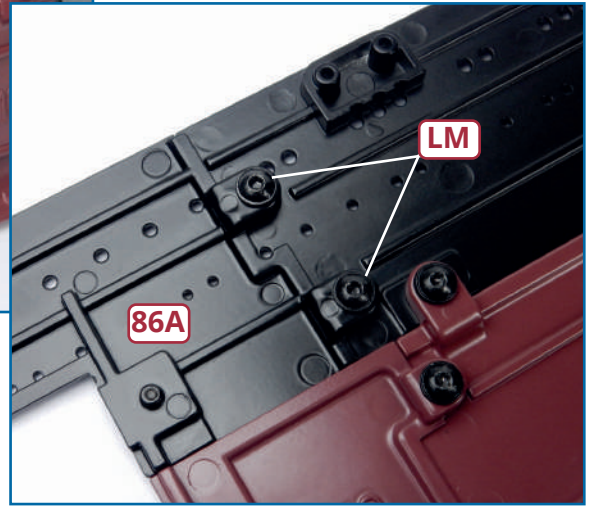
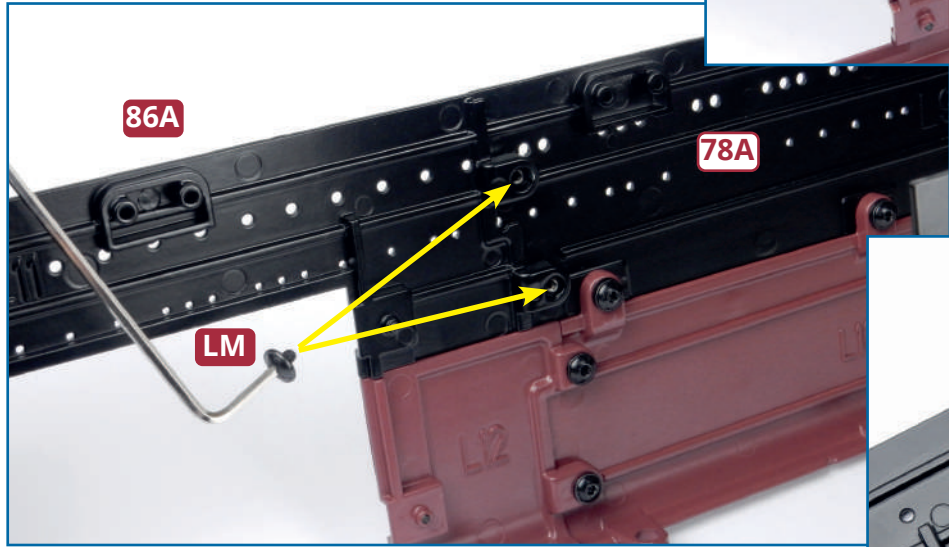
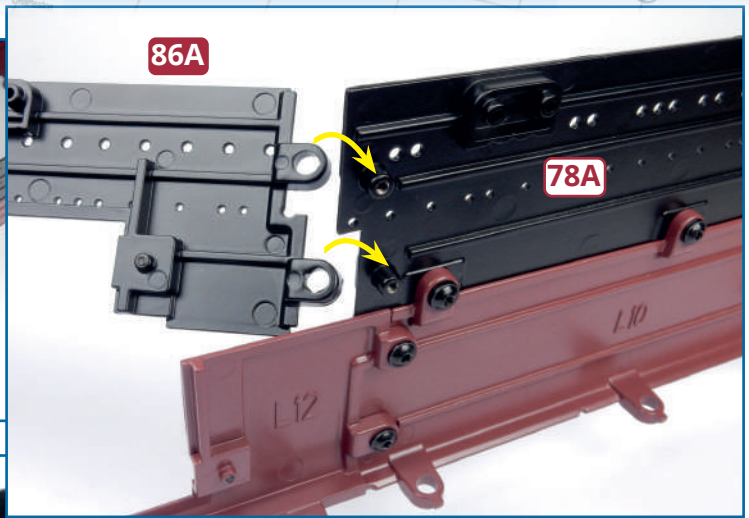

**2** Fit hull section **86A** to the forward section **78A**, so that the tabs on part **86A** overlap the screw holes in part **78A** as shown. Fix hull section **86A** in place with two **LM** screws. Use the Allen key supplied with issue 15 to tighten the screws.

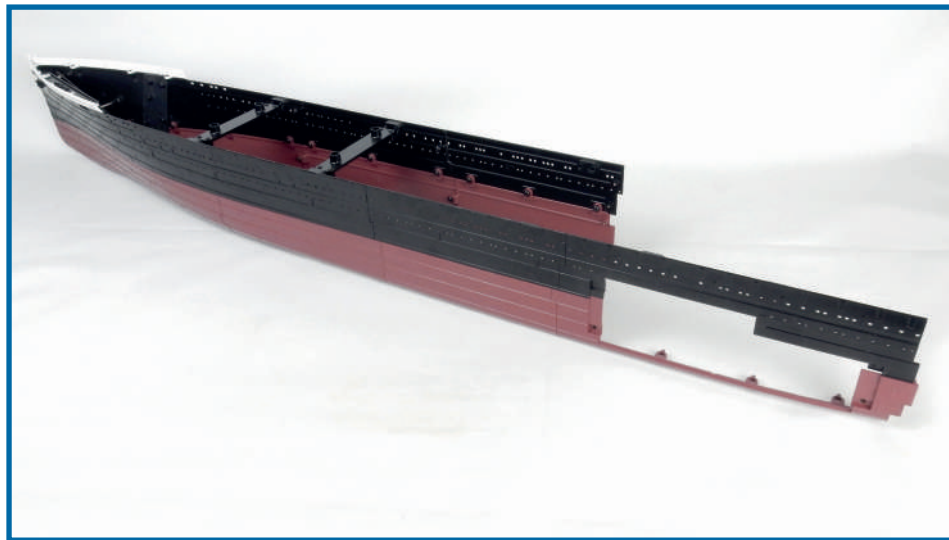

### **Completed work**

The next section of the port side of the hull has been fitted, creating a window that will frame the engine when your model is complete.