

**NO  
TIME  
TO  
DIE** *007™*

**DB5**



# Pack 04

## BUILD INSTRUCTIONS

**STAGE 024: BUILDING THE  
LEFT WHEEL HUB AND FITTING THE  
UPPER LEFT CONTROL ARM**

**STAGE 025: ASSEMBLING THE  
FRONT LEFT SUSPENSION**

**STAGE 026: FITTING THE STEERING ROD**

**STAGE 027VB: BUILD THE SECOND  
WHEEL RIM (EASY-BUILD)**

**STAGE 027: BUILDING THE  
OUTER WHEEL RIM (REGULAR)**

**STAGE 028: BUILDING THE  
INNER WHEEL RIM (REGULAR)**

**STAGE 029: FITTING THE TYRE**

**STAGE 030: MOUNTING THE  
REAR CHASSIS**

NO TIME TO DIE © Danjaq, LLC and Metro-Goldwyn-Mayer Studios Inc. NO TIME TO DIE, *007™* and related James Bond Indicia © 1962-2024 Danjaq, LLC and Metro-Goldwyn-Mayer Studios Inc. NO TIME TO DIE, *007™* and related James Bond Trademarks are trademarks of Danjaq, LLC. All Rights Reserved.



Aston Martin, the Aston Martin Wings logo and the model name "DB5" are trademarks owned, licensed or used by Aston Martin Lagonda Limited. All Rights Reserved.

## Advice from the experts

---

Spare screws are included with each part. Occasionally, you may be instructed to keep spare or unused screws for a later stage. Keep these spares in a safe place and label them correctly.

Please make sure you don't mix up the screws. They look quite similar, but the threads do vary slightly. Using the wrong screws may damage the parts.

When securing parts together using multiple screws, fit each screw loosely to ensure all the parts are correctly aligned before gently tightening them firmly, but not overtight, in the order in which you placed them.

The screwdriver can be magnetized by stroking it with a magnet (fridge magnet, etc.) enabling it to hold the screws and make assembly easier.

If a screw is tight going into a metal part, do not force it as you may shear the head off. Remove it and put a tiny smear of Vaseline, soap or light oil on the thread. That will lubricate it and make it easier to drive home.

During the course of this build, you will receive many pieces that you will assemble immediately – following the instructions in the corresponding stage – and other pieces that you should store safely to one side, for use in future assembly stages.

Left and Right! When building your *No Time To Die* Aston Martin DB5, the left- or right-hand side refers to that side as if you are sitting in the car.



**WARNING:** Some parts are assembled using magnets. These magnets can cause serious injury if they are swallowed. Keep away from children. If you suspect a magnet has been swallowed, seek medical help straight away.

# Stage 024: Building the Left Wheel Hub and Fitting the Upper Left Control Arm

In this stage you'll build the left wheel hub and fit the upper left control arm, following the same process as the right side.



## STAGE 024 PARTS LIST

Name
24-A Left wheel hub
24-B Upper left control arm
24-C Brake disc
24-D Caliper
24-E Upper control arm bracket x2
DS21 screws x3
DS27 screws x5

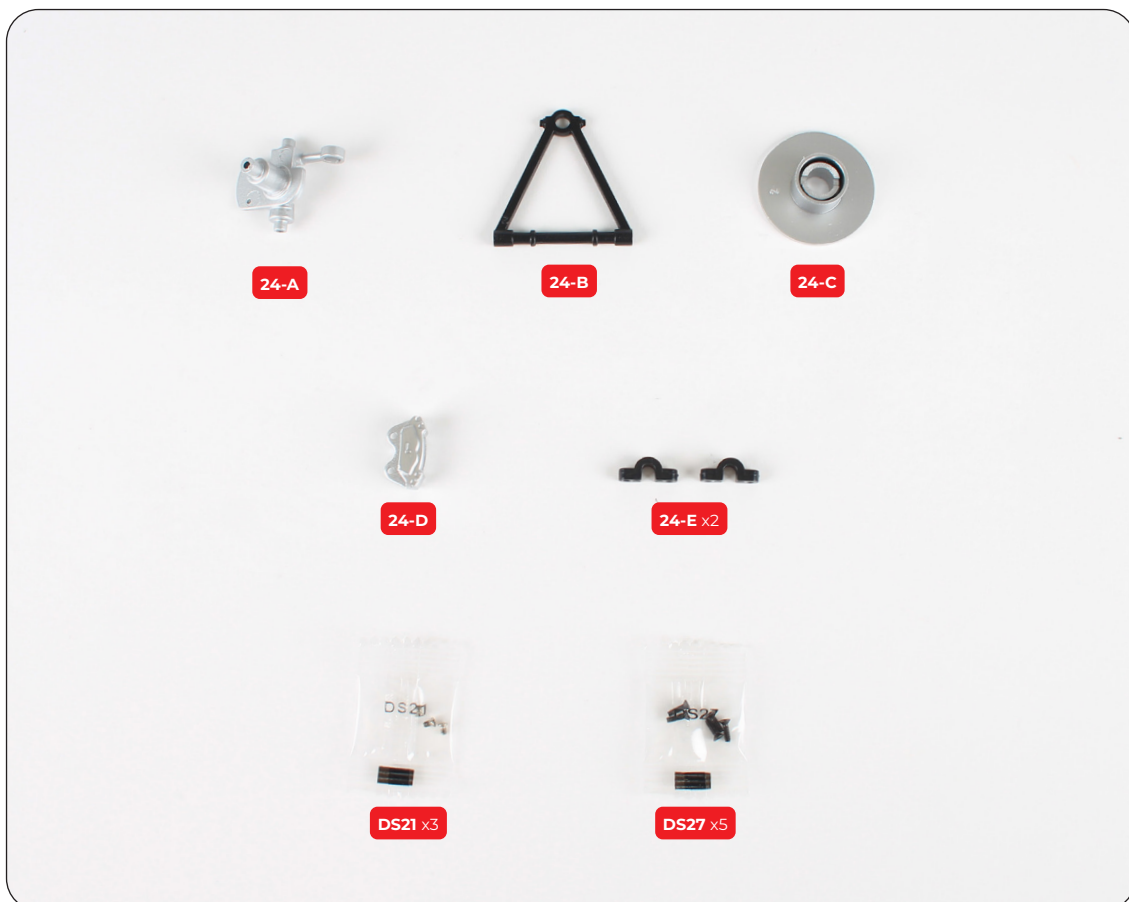

## Stage 024: Building the Left Wheel Hub and Fitting the Upper Left Control Arm

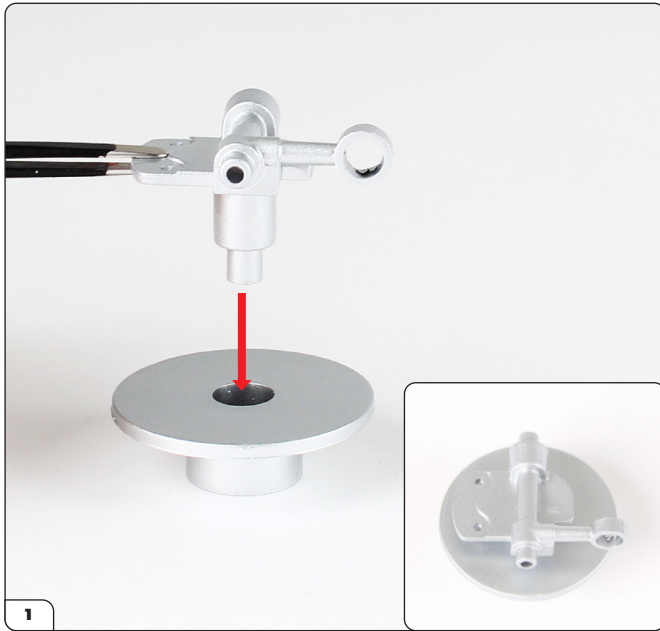

1 Take the brake disc (24-C) and the left wheel hub (24-A) and fit them together as shown.

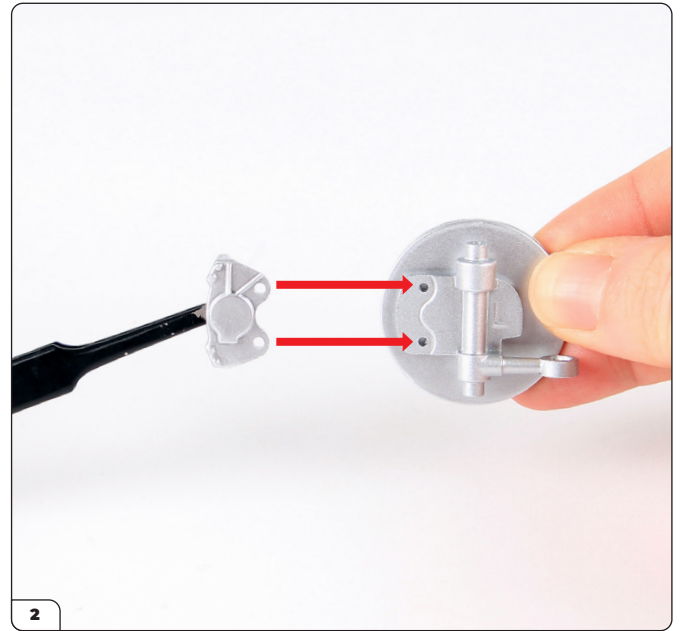

2 Fit the caliper (24-D) onto the assembly.

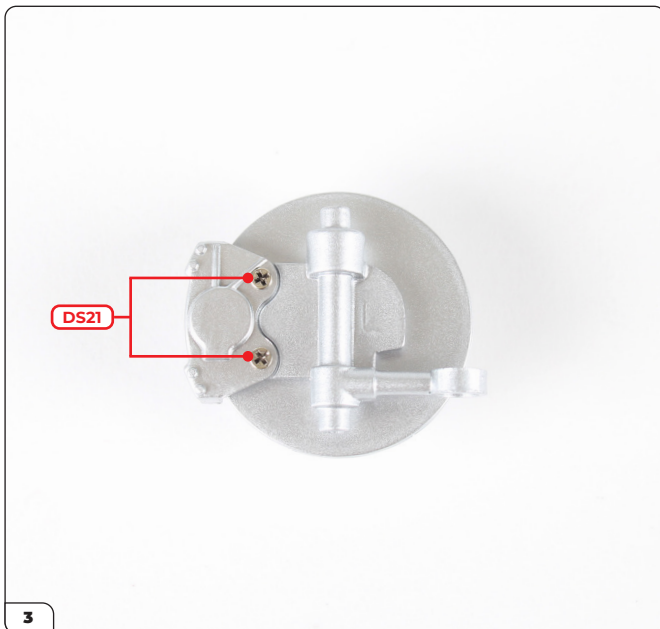

3 Secure with 2x DS21 screws. Do not overtighten the screws.



4 Prepare the brackets (24-E, inset) and 4x DS27 screws. Align the upper left control arm (24-B) with the left side of the front chassis (stage 23). Note the four screw holes for fixing the brackets.

## Stage 024: Building the Left Wheel Hub and Fitting the Upper Left Control Arm

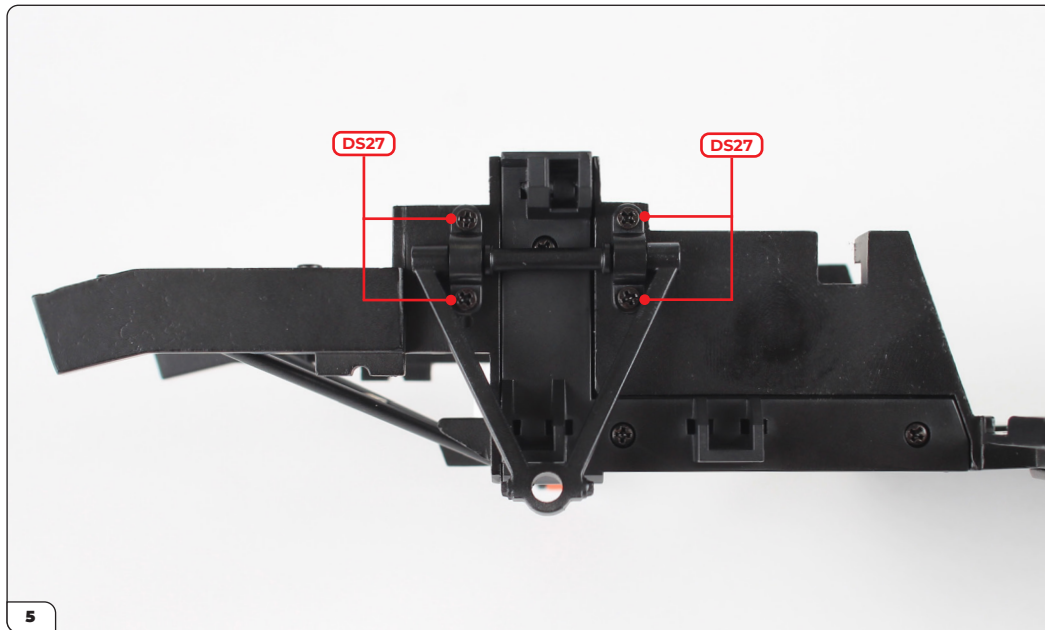

Position the upper control arm between the holes and secure it using the brackets and DS27 screws as shown.

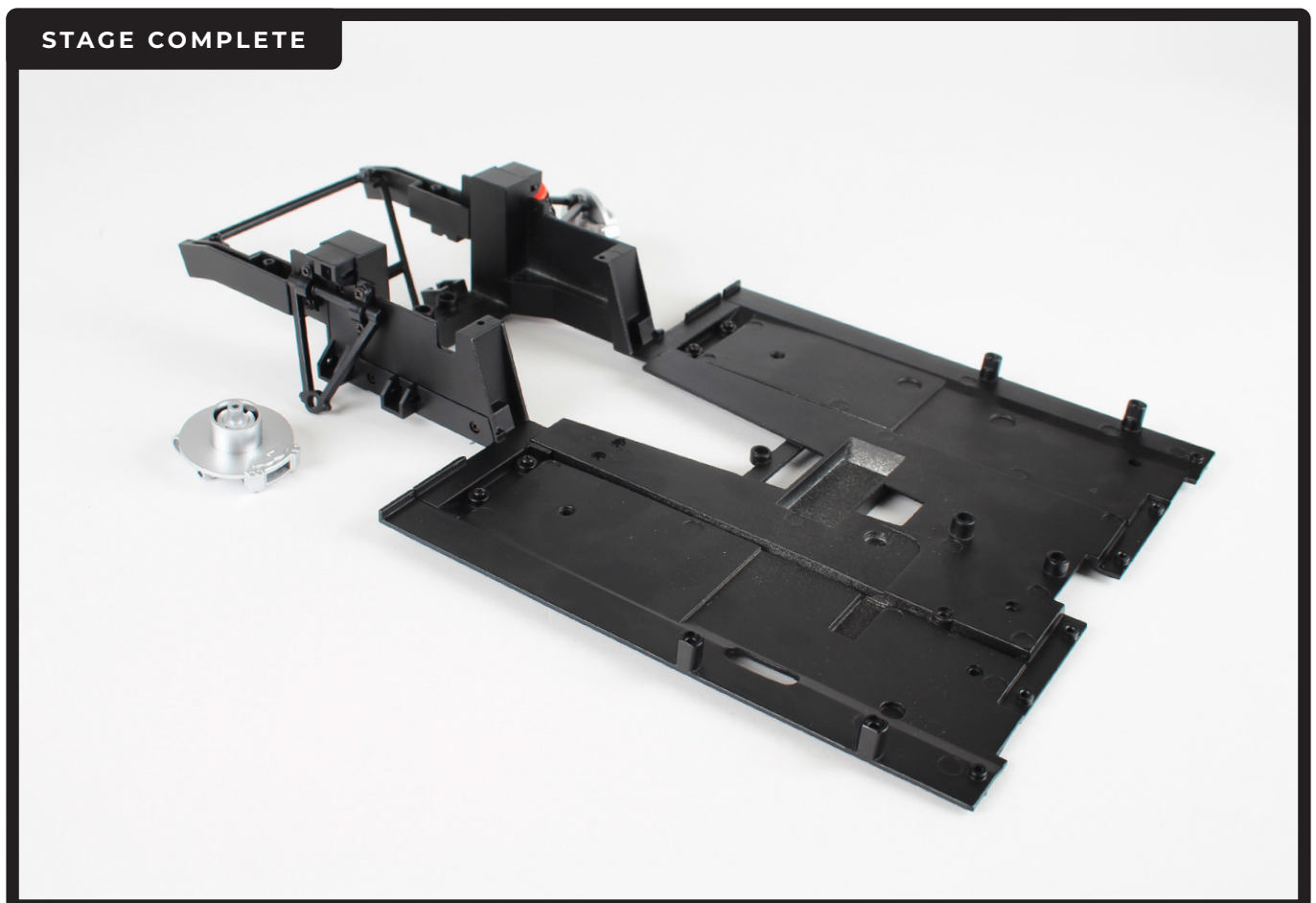

## Stage 025: Assembling the Front Left Suspension

Next you'll assemble the front left suspension by fitting the lower control arm and shock absorber then attaching the wheel hub.



### STAGE 025 PARTS LIST

Name
25-A Lower right control arm
25-B Shock absorber cylinder
25-C Shock absorber spring
25-D Shock absorber rod
25-E Anti-roll bar connection
25-F Pin x4
DS24 screws x3
PS31 screws x2

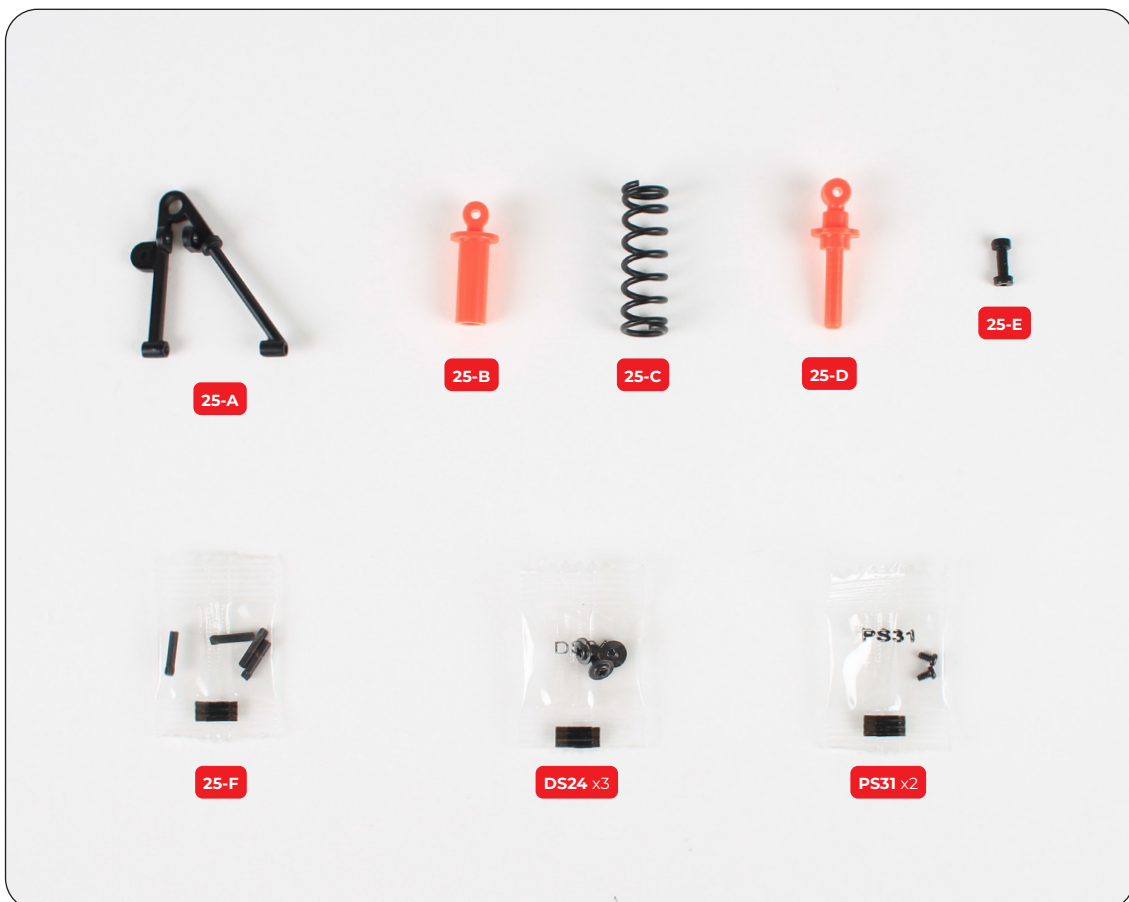

## Stage 025: Assembling the Front Left Suspension



Take the lower left control arm (25-A) and the anti-roll bar connection (25-E). Fit them together as shown using the D-shape to ensure the correct orientation. The connection can be fitted at either end.



Secure from the opposite side using a PS31 screw.

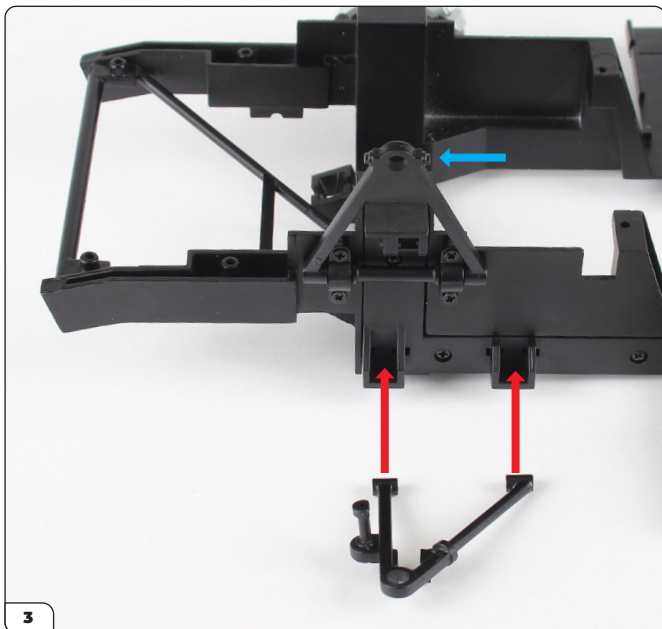

Align the lower control arm with the front chassis' left side. Lift the upper control arm out of the way (blue arrow).

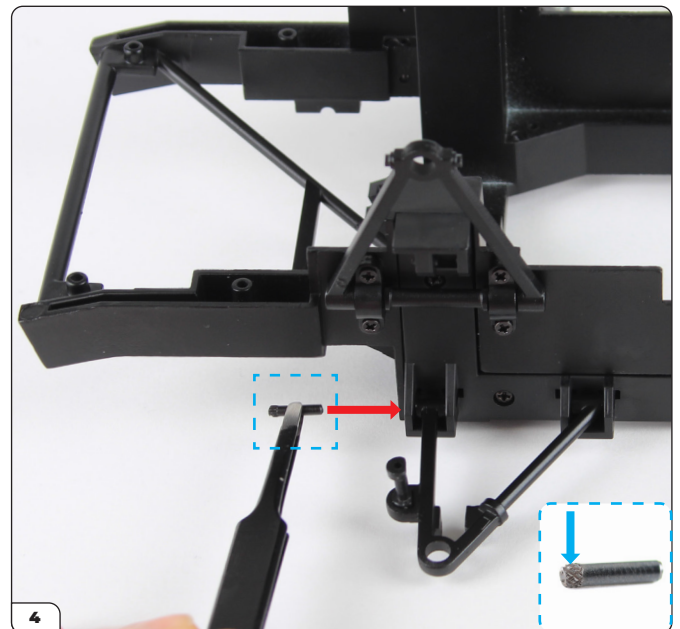

Fit the control arm in place then fit a pin (25-F) through the mount and arm. One end of the pin is splined (inset). Fit the pin's smooth end first.

## Stage 025: Assembling the Front Left Suspension

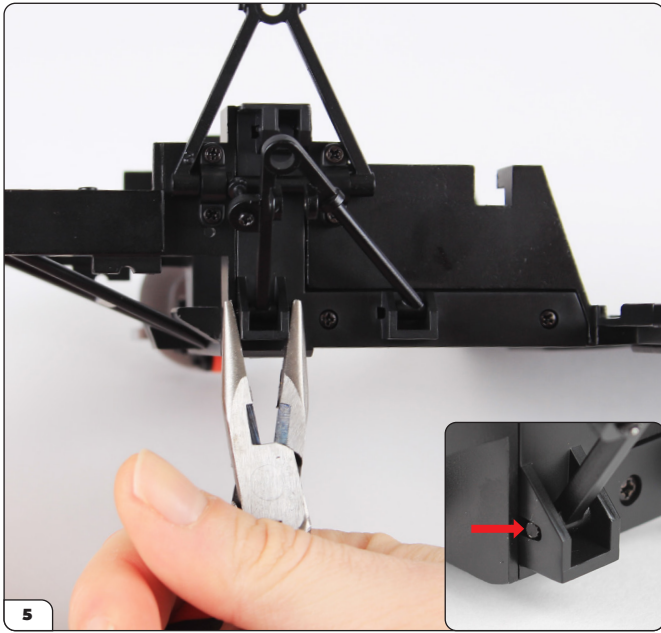

Apply pressure to the splined end of the pin until it fits flush into the mount (inset).



Fit a pin through the other mount in the same way and press it flush (inset).



Push the circular end of the shock absorber rod (25-D) into the lower control arm.

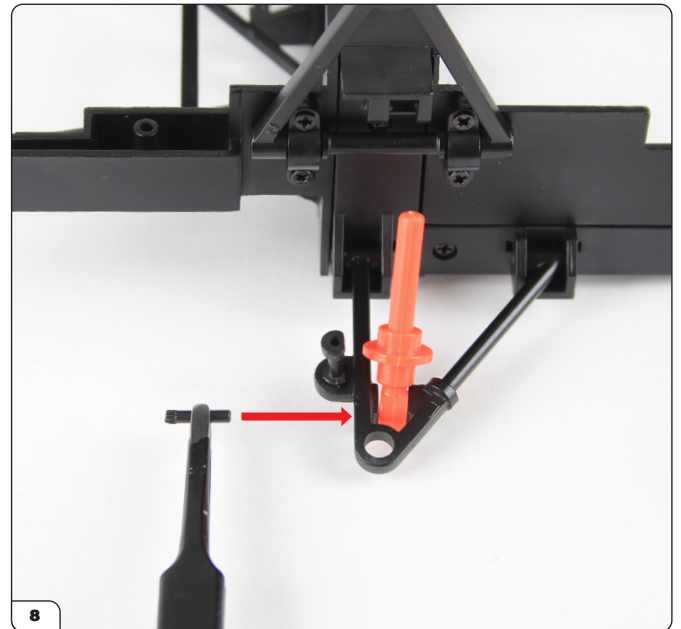

Fit a pin through the arm and rod in the same way as before.



## Stage 025: Assembling the Front Left Suspension

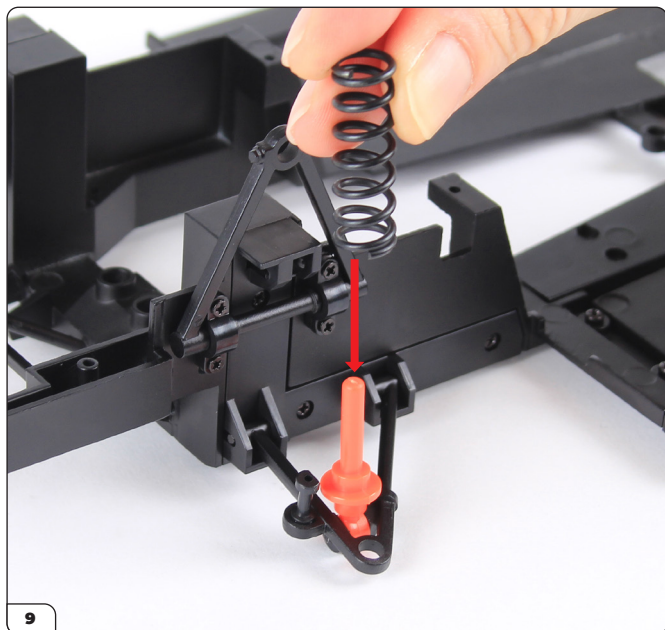

Place the spring (25-C) over the rod.

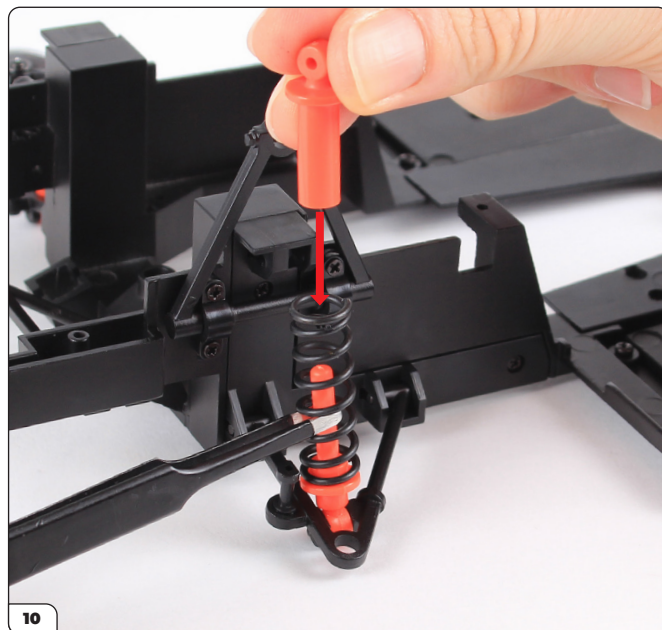

Push the shock absorber cylinder (25-B) through the spring and onto the rod.

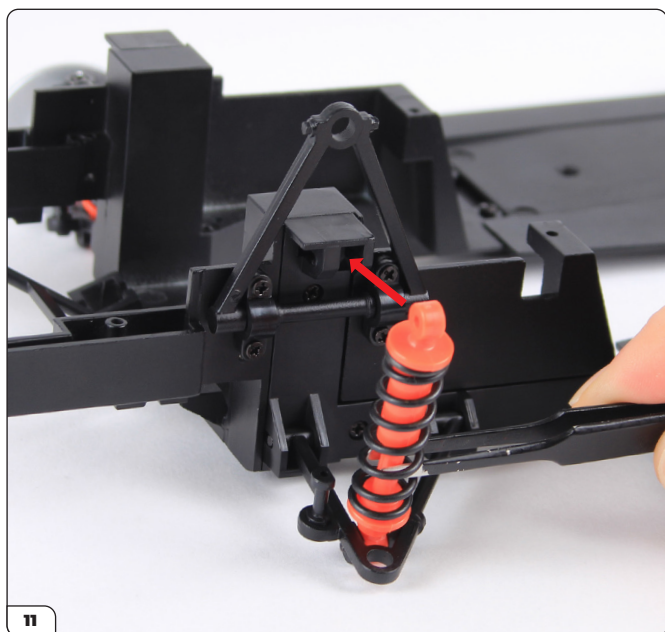

Fit the circular end of the cylinder into the suspension mount.

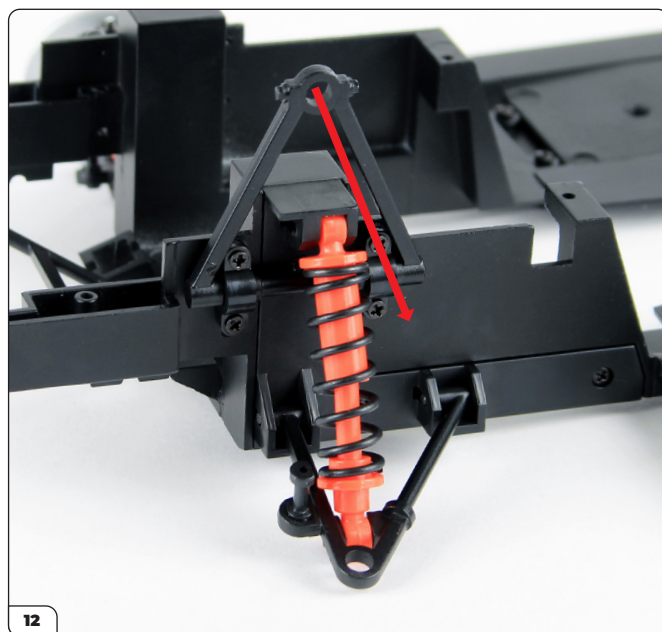

Lower the upper control arm out of the way.

## Stage 025: Assembling the Front Left Suspension

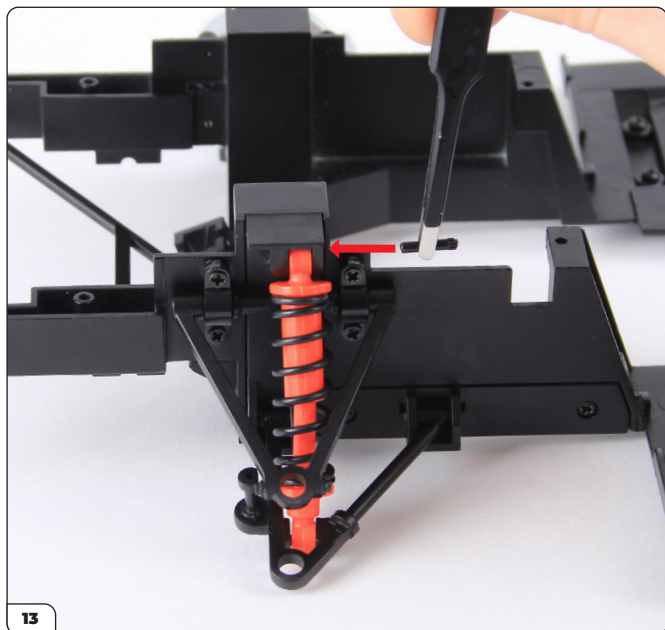

Fit a pin through the mount and cylinder.

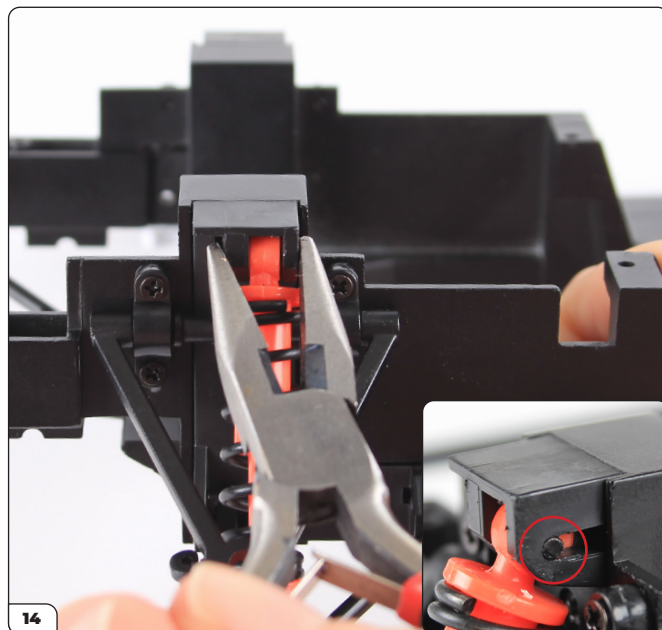

Press the pin fully into the mount in the same way as before.

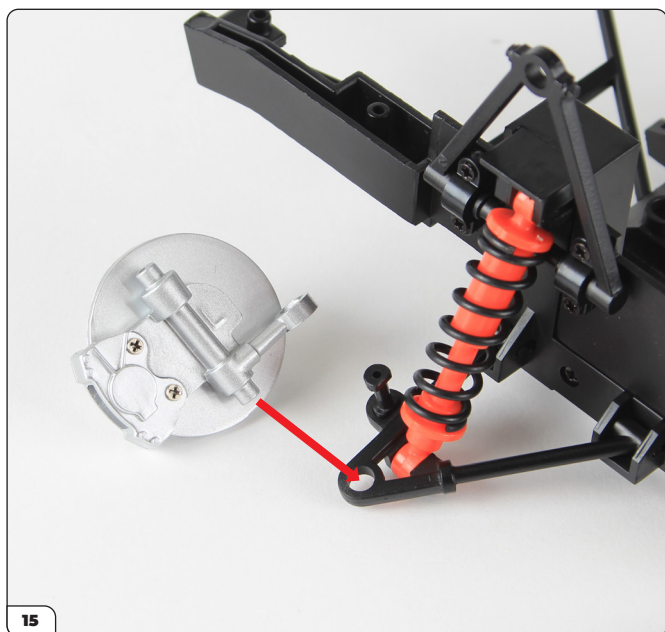

Position the left wheel hub (from stage 024) on the lower control arm.

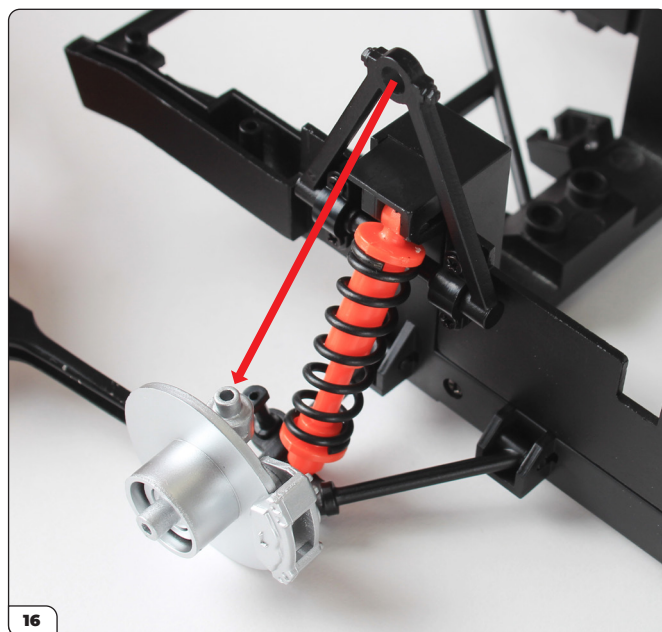

Fit the upper control arm onto the wheel hub.

## Stage 025: Assembling the Front Left Suspension

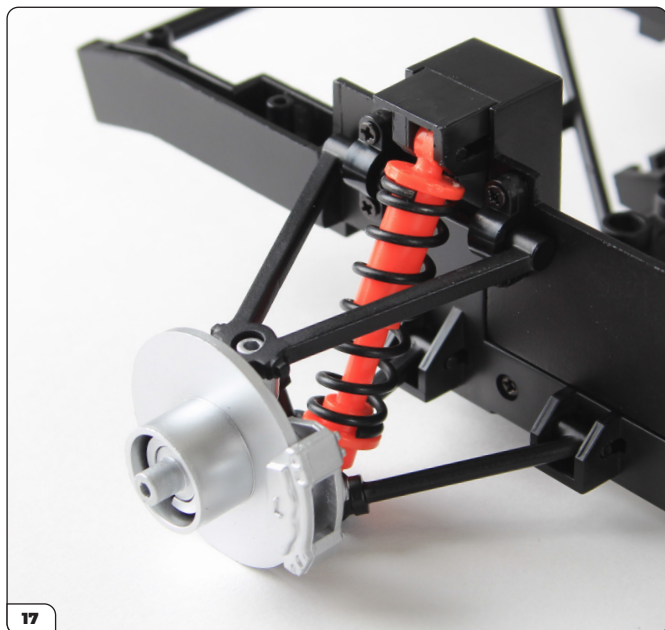

This image shows the control arm fitted on the wheel hub.



Lift up the assembly and secure the lower control arm from underneath with a DS24 screw.

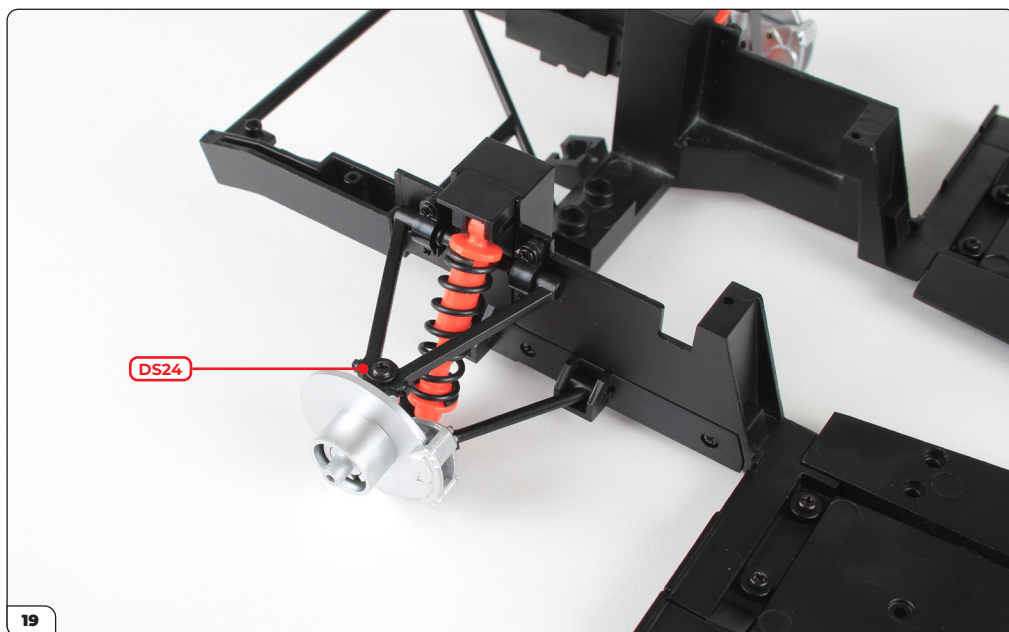

Fix the upper control arm with another DS24 screw.

## Stage 025: Assembling the Front Left Suspension

STAGE COMPLETE

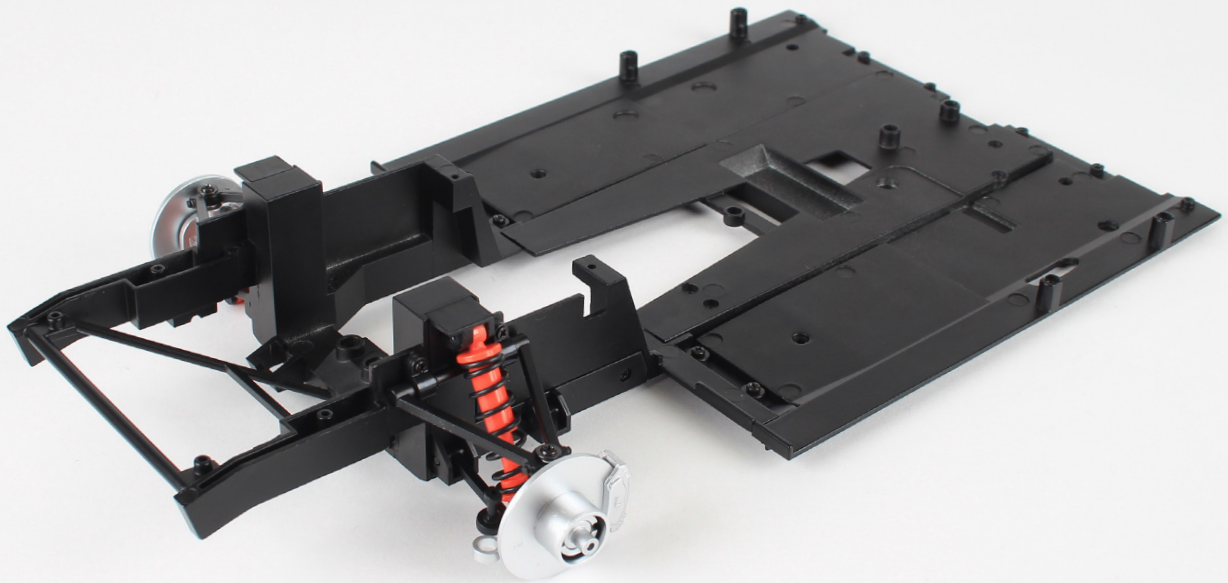

## Stage 026: Fitting the Steering Rod

With the front suspension built, you'll now connect the wheel hubs using the steering rod. You'll also connect the steering column and mount the anti-roll bar.



### STAGE 026 PARTS LIST

Name	Name
26-A Steering rod	26-H Anti-roll bar brackets x2
26-B Anti-roll bar	26-I Pin x2
26-C Steering column	DS03 screws x3
26-D Steering link	DS20 screws x5
26-E Steering gear	DS24 screws x3
26-F Left steering rod holder	PS14 screws x3
26-G Right steering rod holder	



## Stage 026: Fitting the Steering Rod

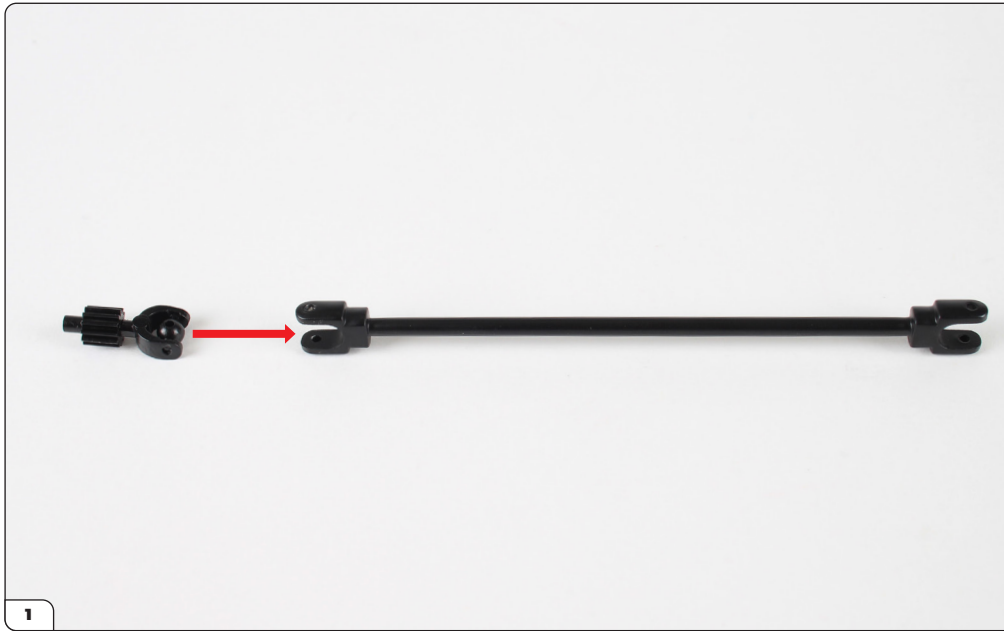

Take the steering gear (26-E) and steering column (26-C). Fit the gear's ball joint into the column.

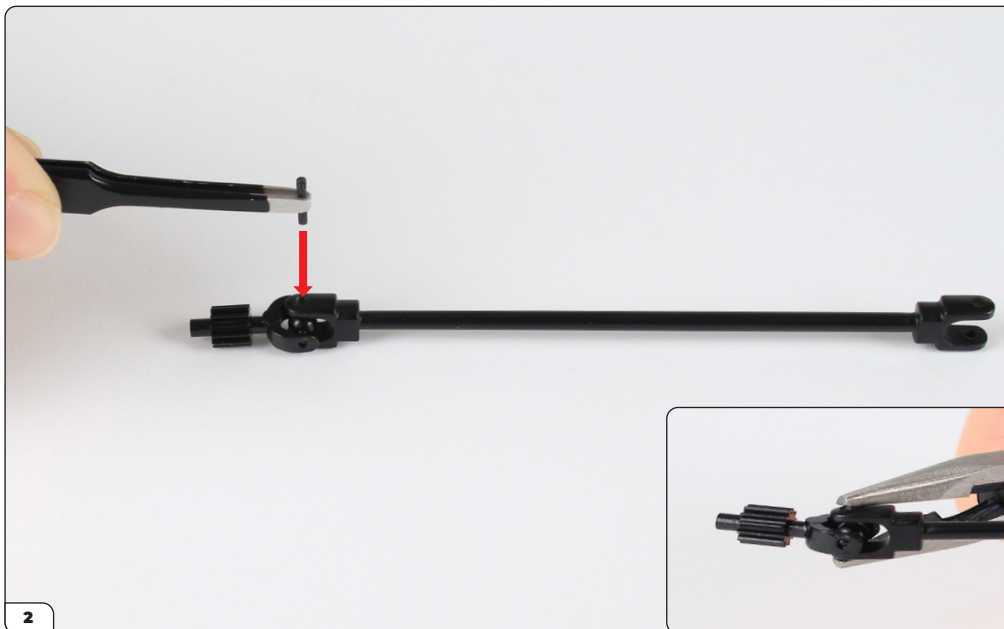

Check the holes are aligned, then fit a pin (26-I) through the column and gear, starting with the pin's smooth end. Press the pin until flush (inset).

## Stage 026: Fitting the Steering Rod

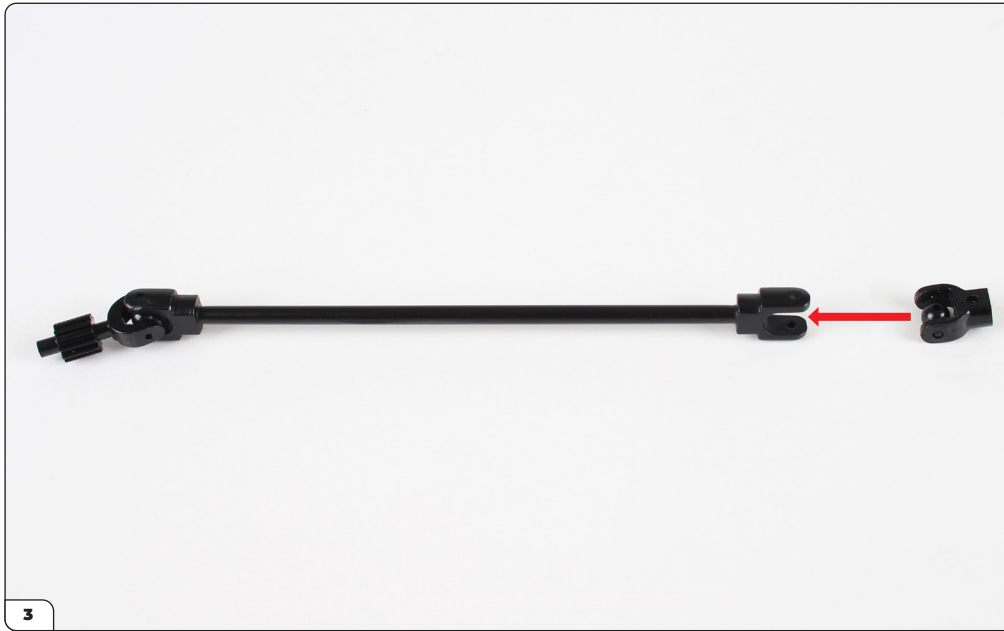

Fit the steering link (26-D) into the column's other end.



Check the alignment then fit a pin (26-I) through the column and link and press through until flush (inset).

## Stage 026: Fitting the Steering Rod

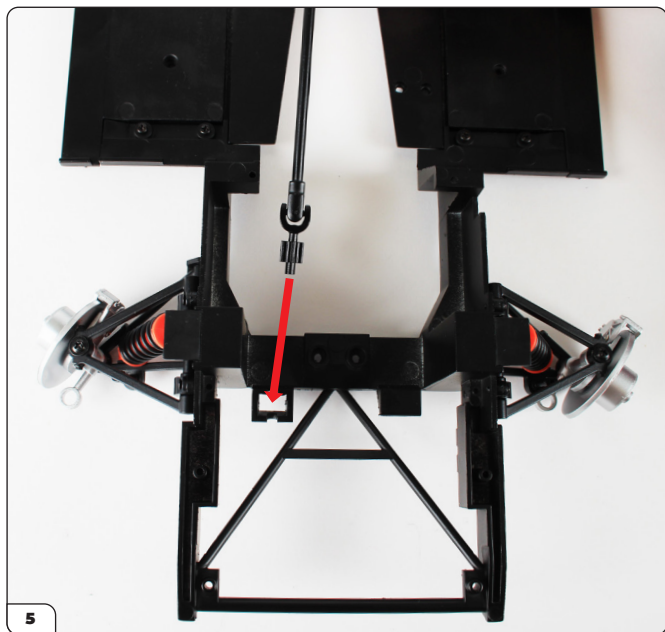

Position the steering gear into the cradle on the chassis assembly.

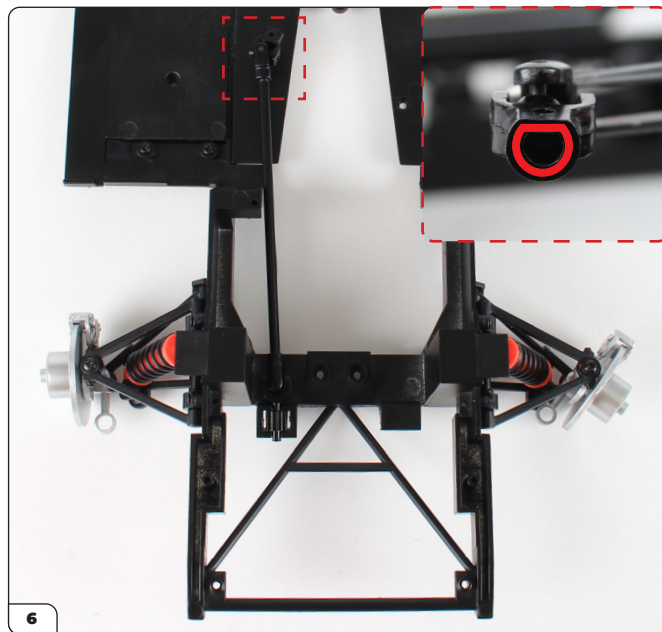

The gear should sit in the cradle as shown. Turn the steering link so that the D-shaped hole has the flat side oriented upwards (inset).

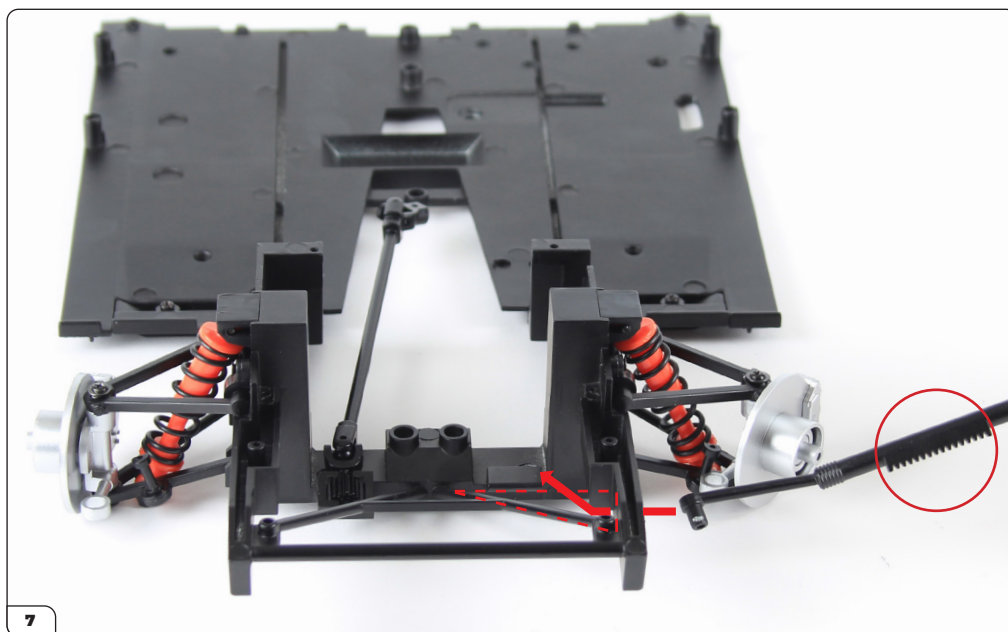

Take the steering rod (26-A) and fit the end with the gear teeth (circled) under the chassis and up through the highlighted triangular opening.



## Stage 026: Fitting the Steering Rod

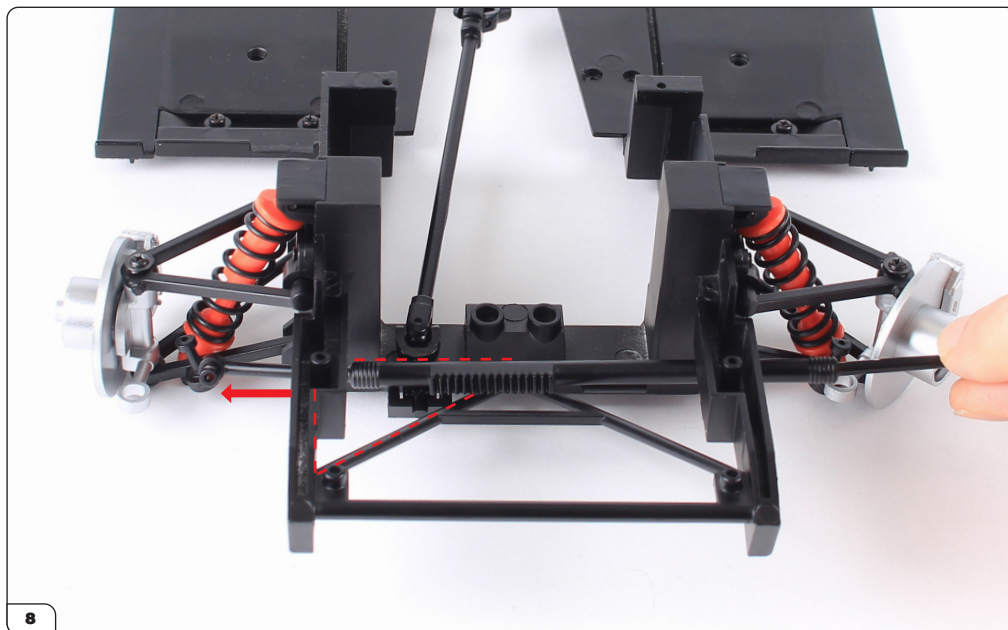

Fit the end of the steering rod through the triangular opening on the other side of the chassis as shown.

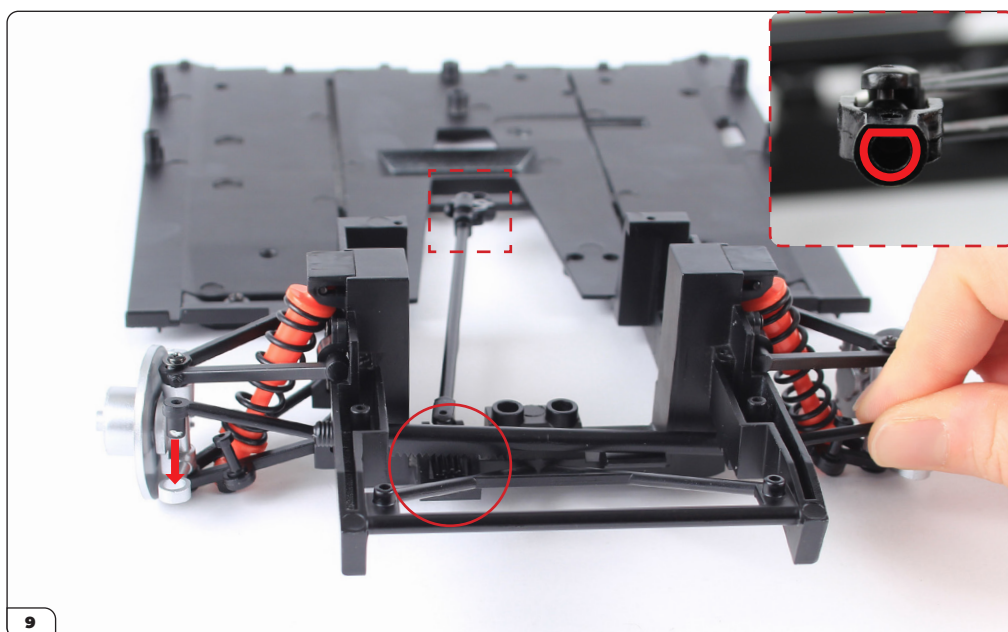

Adjust the parts so that the wheel hubs are pointing straight forward and line up with the rod's columns (arrow). Twist the steering rod to engage the teeth with the steering gear (circled). Remember that the steering gear's D-shaped hole should be oriented as shown in step 6 (inset).

## Stage 026: Fitting the Steering Rod

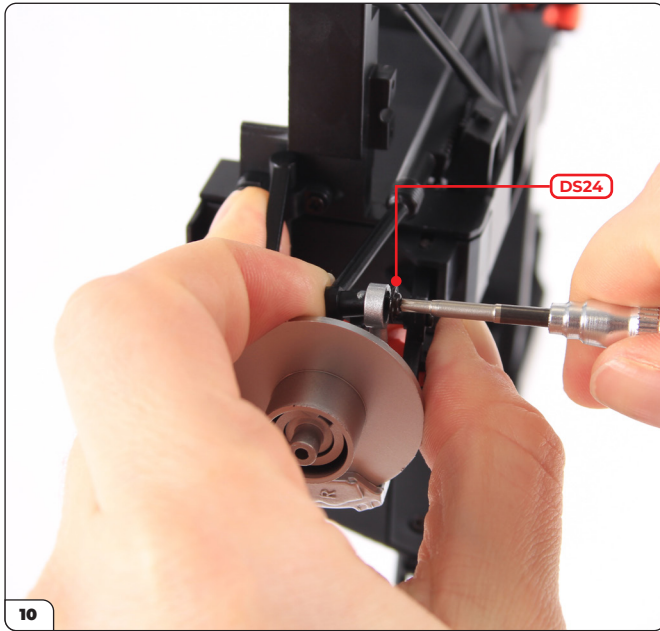

Take a DS24 screw. Squeeze the suspension firmly as shown and drive the screw into the steering rod column to secure it to the right wheel hub.

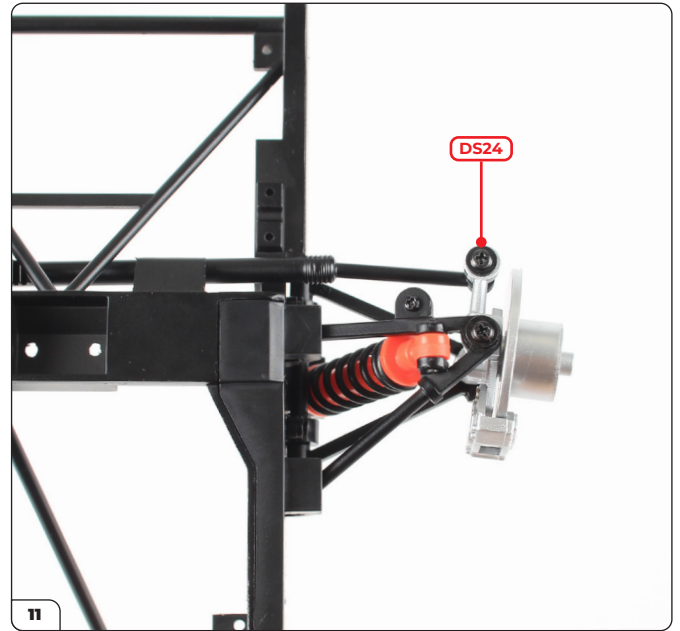

Repeat this process on the other side using a DS24 screw to secure the left wheel hub to the steering rod.

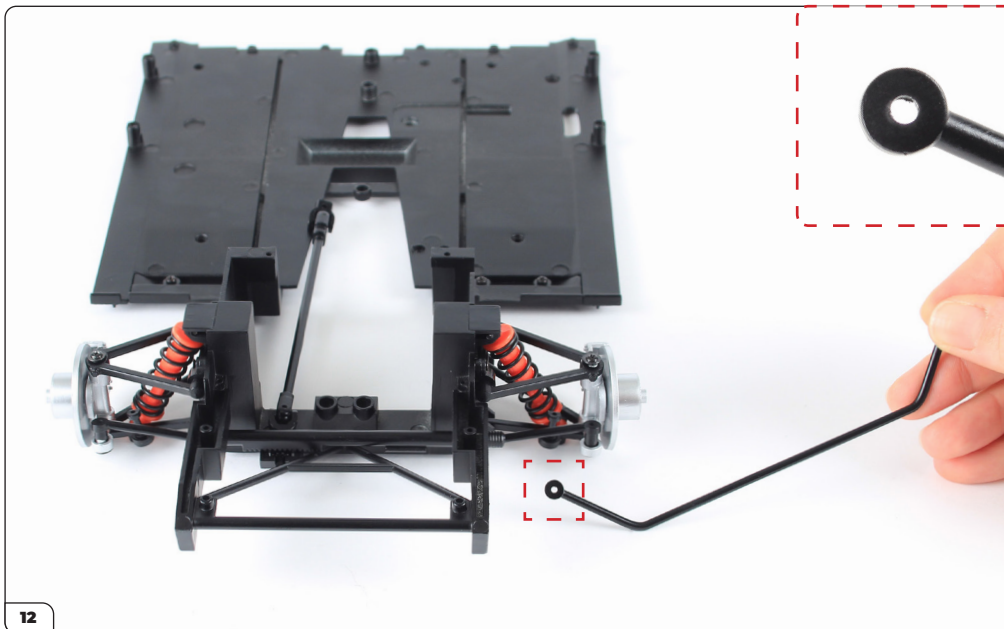

Align the anti-roll bar (26-B) with the assembly, with the flat side facing you as shown (inset). When the bar is fitted the flat side should be facing upwards (see step 16).

## Stage 026: Fitting the Steering Rod

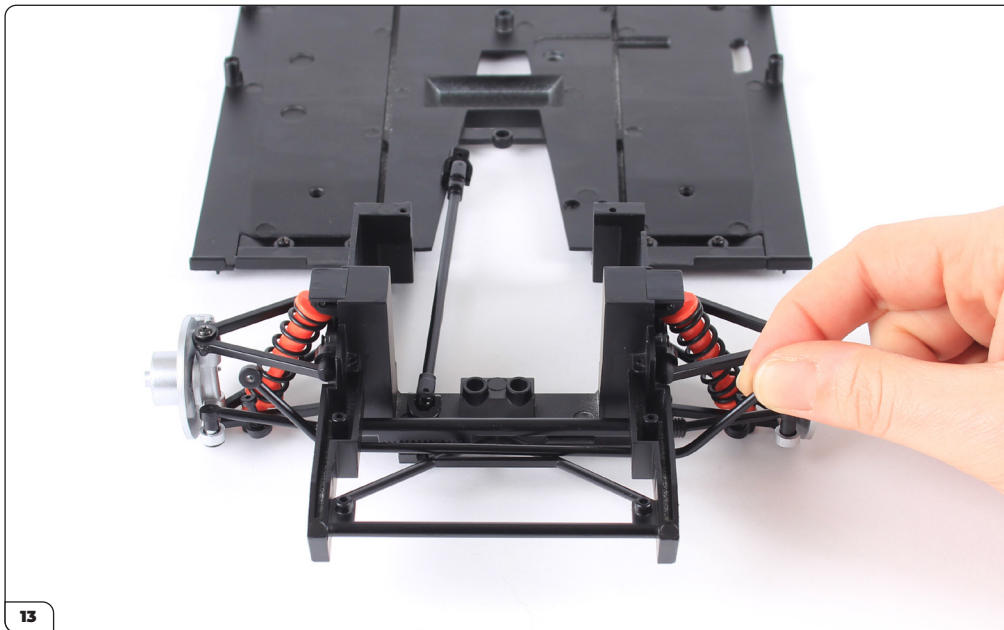

Fit the bar through the same openings as the steering rod.

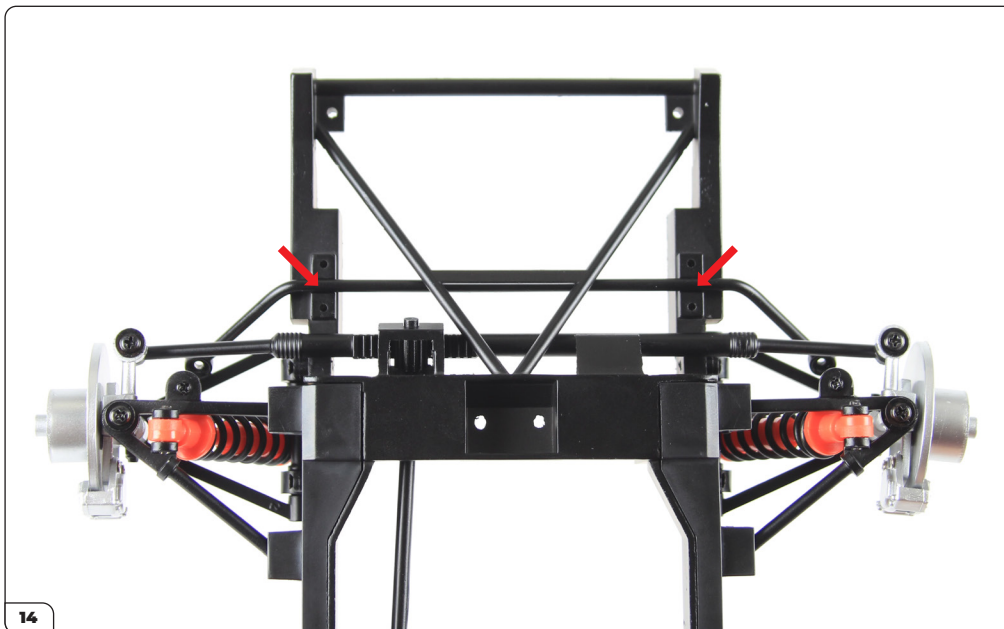

Carefully turn the assembly over and fit the bar into the recesses between the pairs of screw holes.

## Stage 026: Fitting the Steering Rod

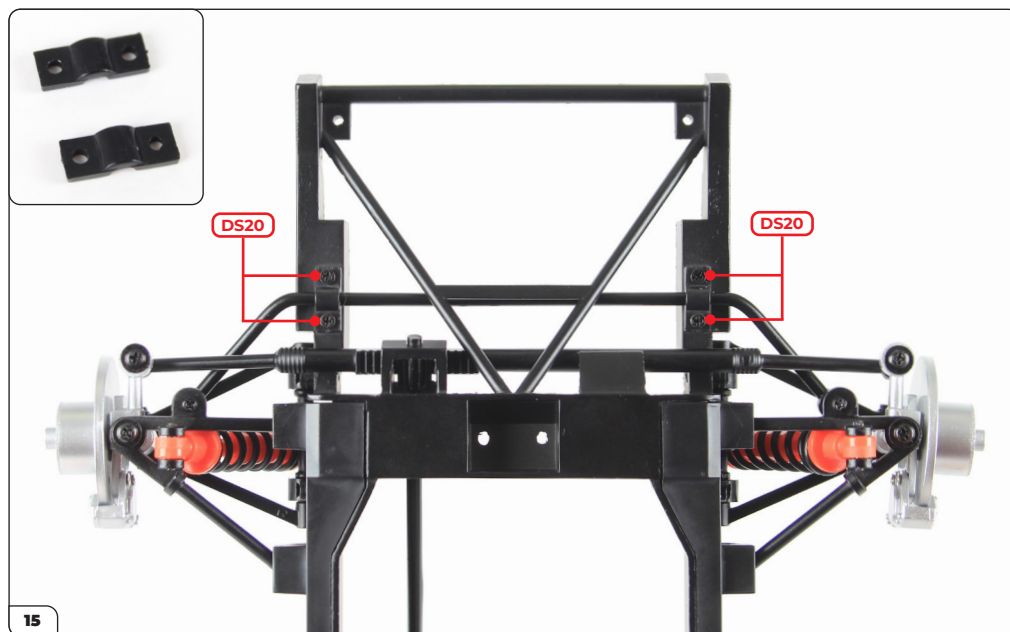

Take the two brackets (26-H, inset) and fit them over the screw holes then secure in place using 4x DS20 screws.

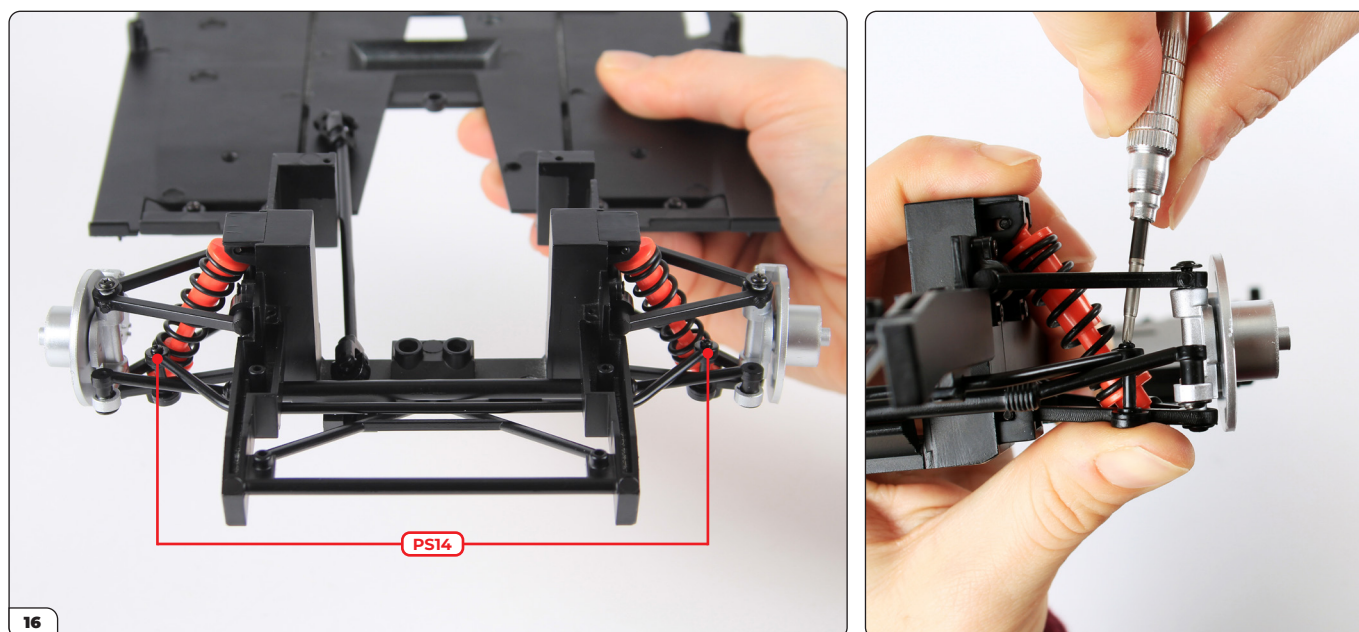

Fit the shaped ends of the bar onto the anti-roll bar connections then secure using 2x PS14 screws. Apply pressure to the lower control arm (right image) and take care when tightening the screws so the connections don't get damaged.

## Stage 026: Fitting the Steering Rod

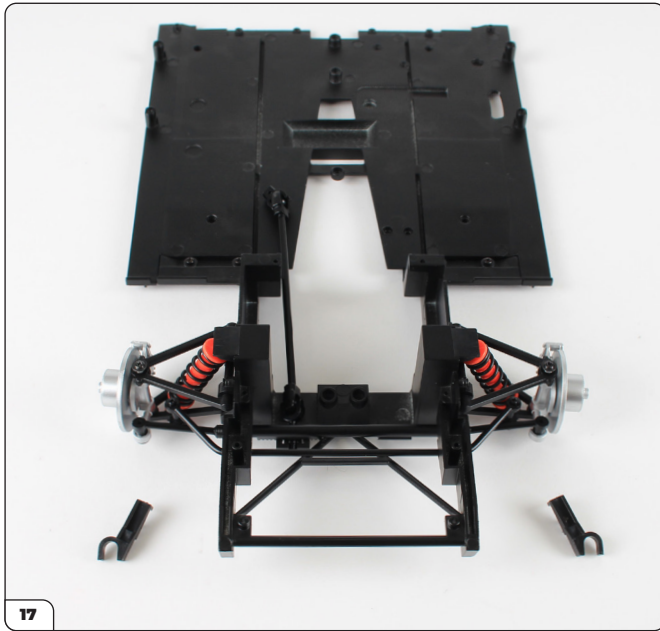

Take the left (26-F) and right (26-G) steering rod holders.

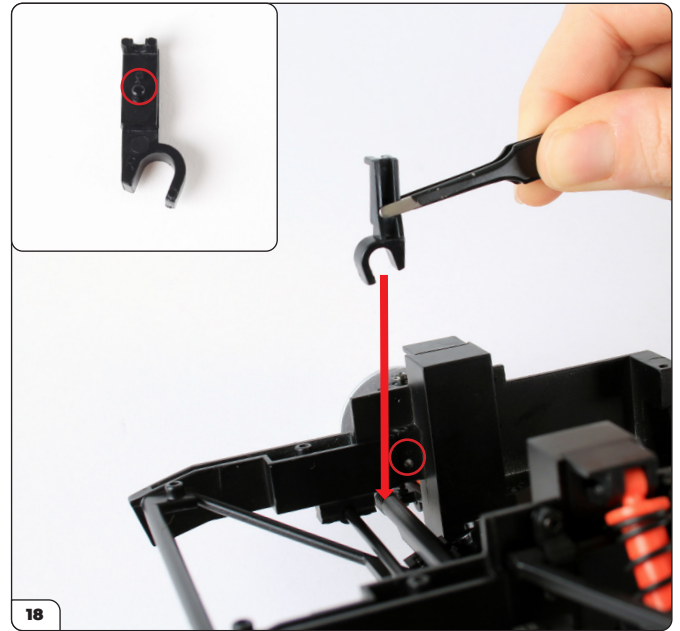

Fit the pins of the right holder into the holes in the chassis (circled). The U-shaped section fits over the steering rod (arrow).

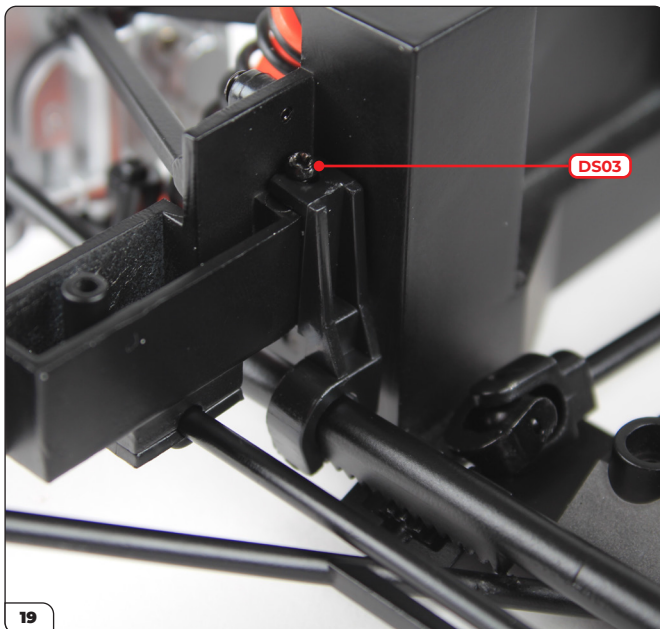

Secure using a DS03 screw.



Fit the left holder in the same way and secure with a DS03 screw.

## Stage 026: Fitting the Steering Rod

STAGE COMPLETE

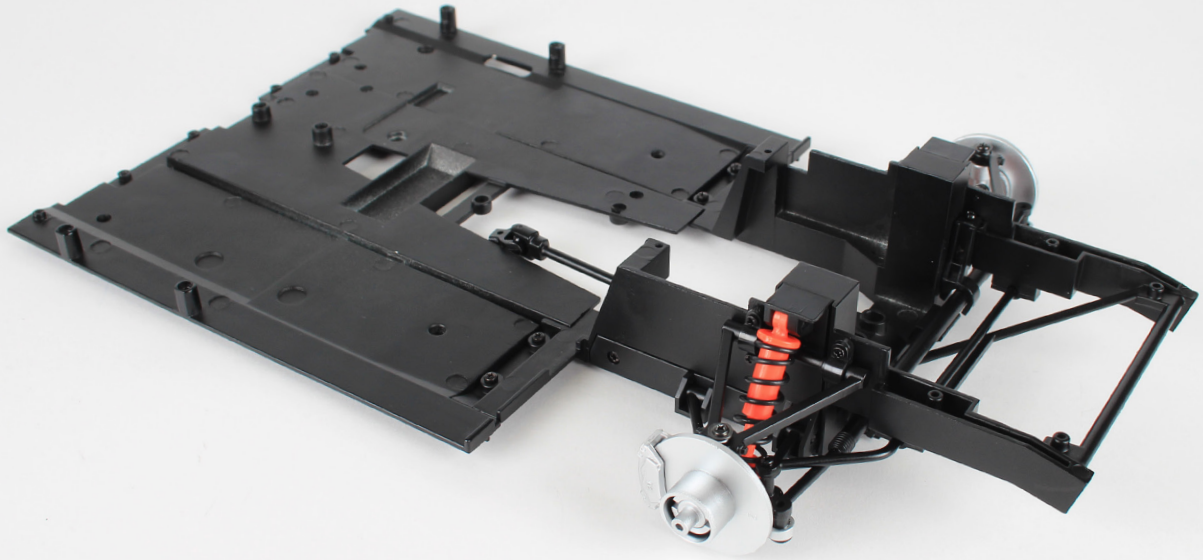

## Stage 027VB: Build the Second Wheel Rim (Easy-Build)

This stage is the easy-build version of the wheel rim. If you choose to use this version, move straight to Stage 029 after completing it.



### STAGE 027VB PARTS LIST

Name
27VB-A Outer spokes
27VB-B Inner wheel rim
27VB-C Outer ring
27VB-D Inner spokes
27VB-E Outer wheel rim
27VB-F Wheel hub back
27VB-G Inner ring
27VB-H Spoke retainer ring
27VB-I Wheel hub front
PS02 screws x9
PS03 screws x4
PS32 screws x4

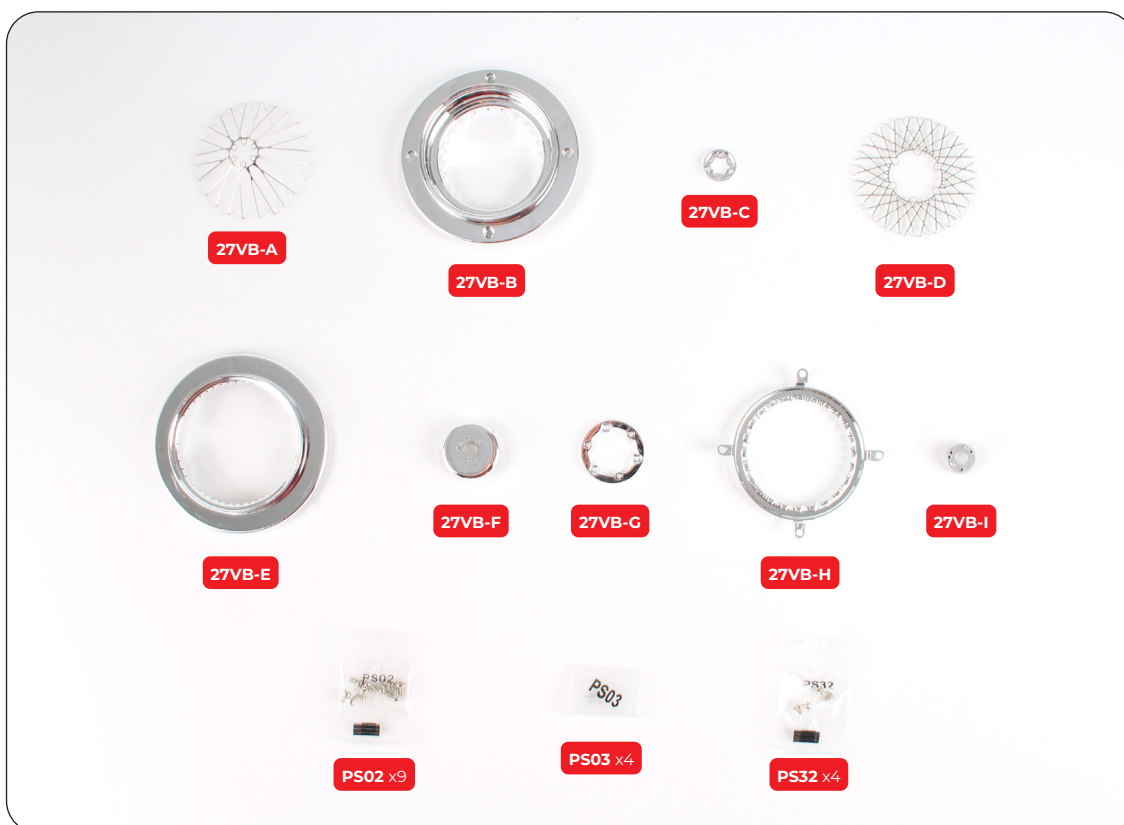

## Stage 027VB: Build the Second Wheel Rim (Easy-Build)



Line up the wheel hub front (27VB-I), outer spokes (27VB-A) and outer ring (27VB-C) as shown, then position the outer ring on top of the spokes.

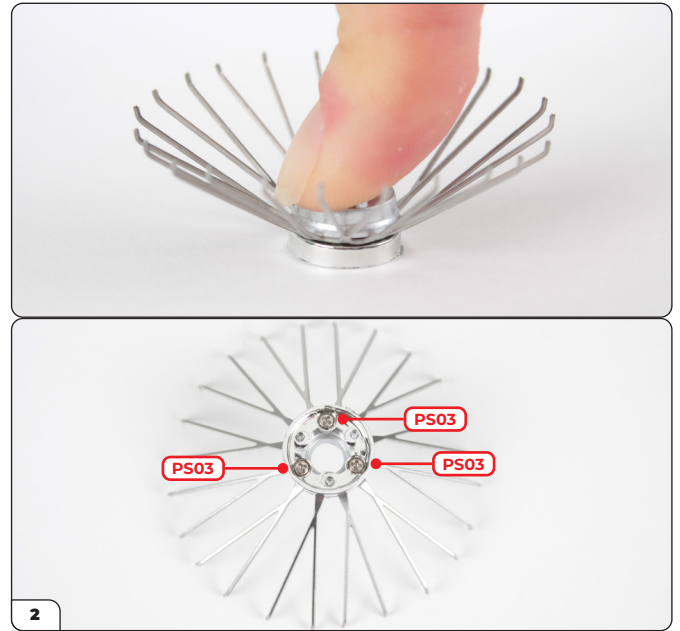

Turn the spokes over and press the pins on the wheel hub front into the smaller holes on the outer ring. Secure using 3x PS03 screws.

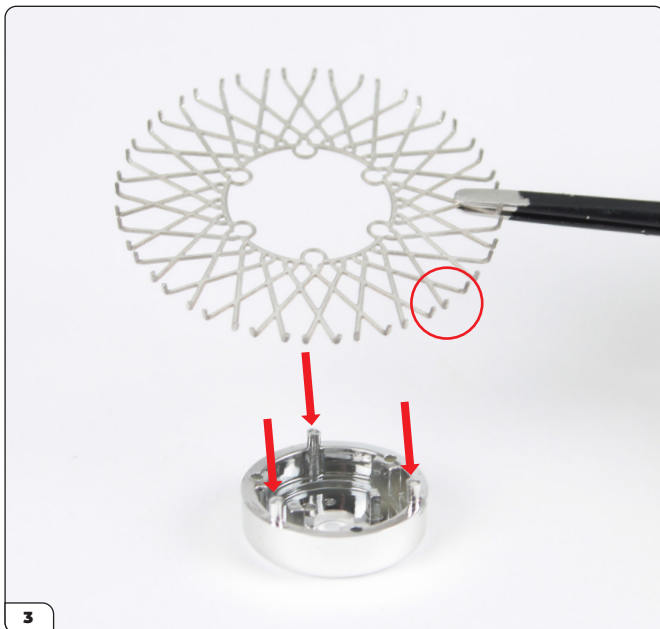

Place the inner spokes (27VB-D) with the ends pointing up (circled) onto the three pins on the wheel hub back (arrows).

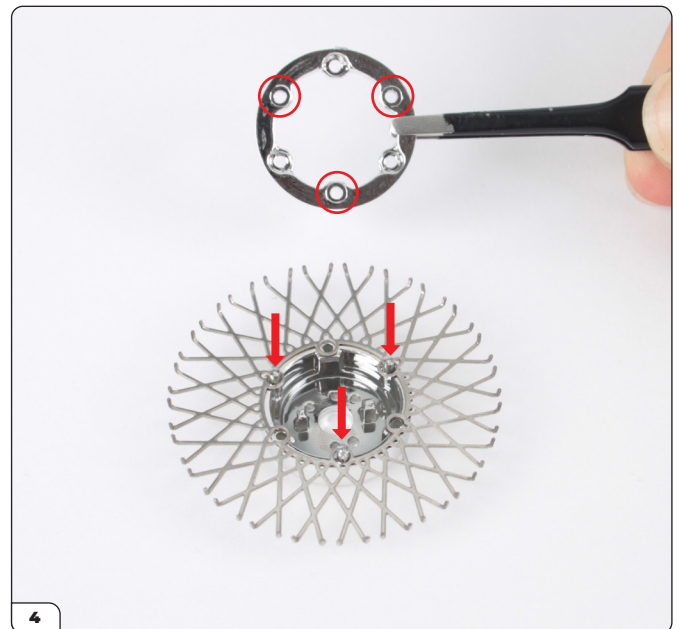

Press the inner ring (27VB-G) on top of the spokes using the three holes without a recess (circled). If any holes are covered with paint, simply poke through using a knife or needle.



## Stage 027VB: Build the Second Wheel Rim (Easy-Build)

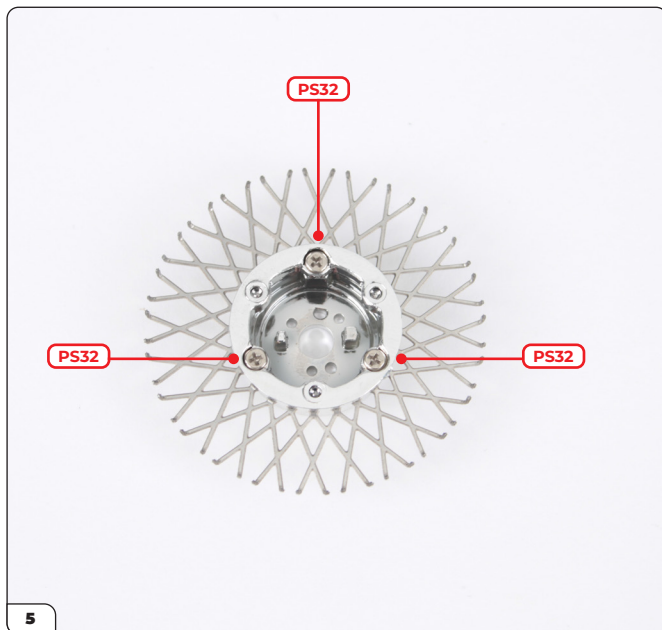

Secure using 3x PS32 screws.

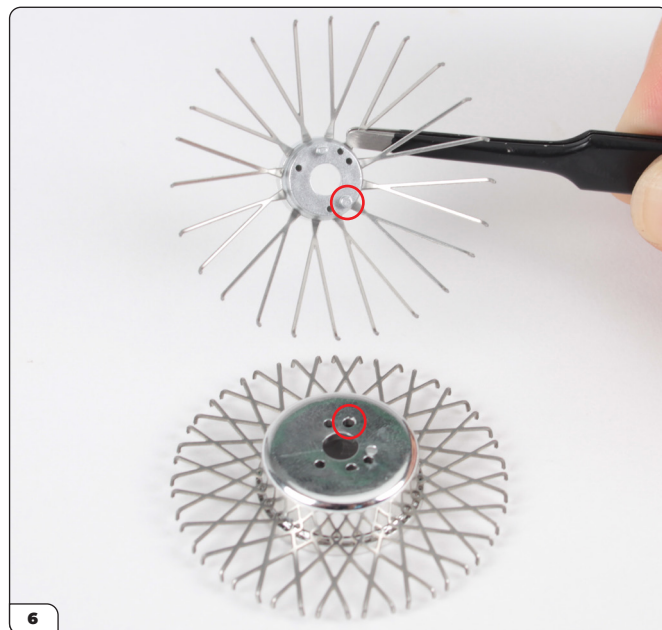

Turn the inner spokes over, then fit the outer spokes on top using the larger pin on the wheel hub front as a guide.



The ends of the outer spokes should sit in the 'V' of the inner spoke ends once in place.

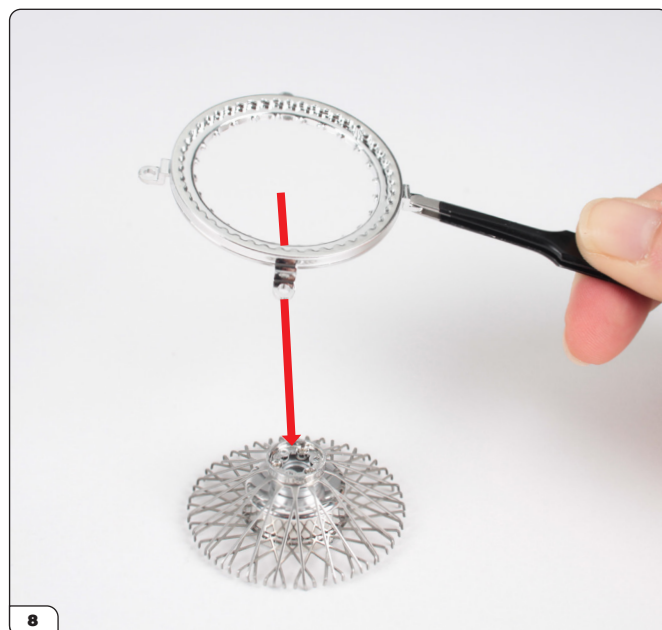

Place the spoke retainer ring (27VB-H) over the assembly in the orientation shown.

## Stage 027VB: Build the Second Wheel Rim (Easy-Build)



Align the retainer ring so that the outer spokes fit into the recesses around the edge (inset). Check all the spokes are in place.

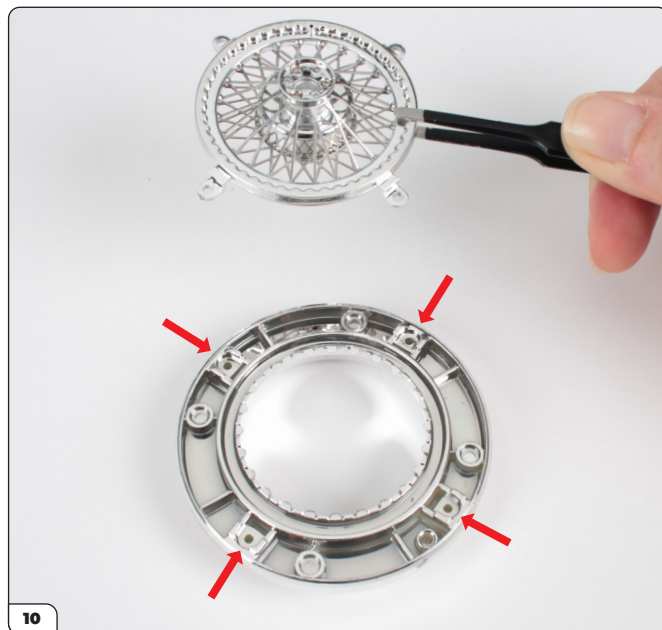

Fit the four tabs on the retainer ring into the recesses on the inner wheel rim (27VB-B).

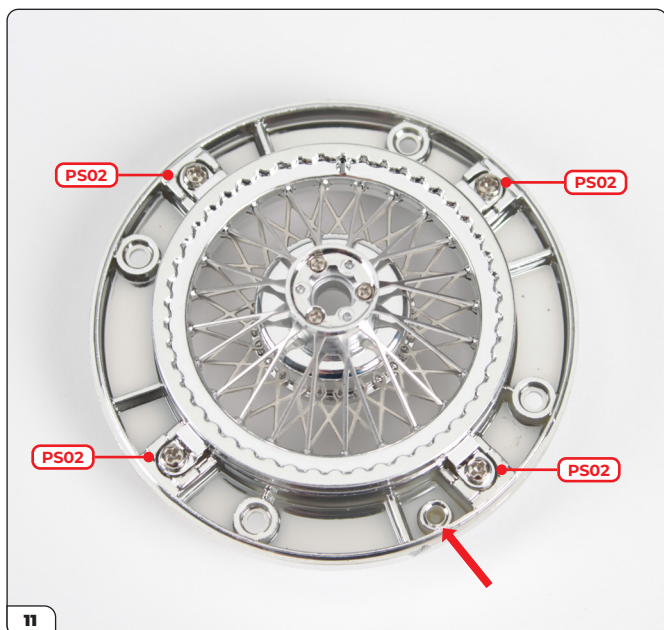

Secure using 4x PS02 screws. Note the indicated hole for the pin in the next step (arrow).

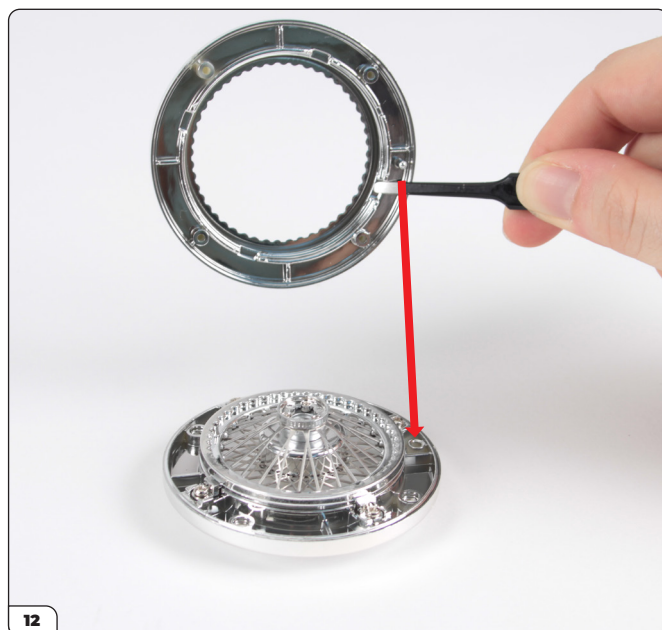

Fit the outer wheel rim (27VB-E) in place using the pin as a guide.

## Stage 027VB: Build the Second Wheel Rim (Easy-Build)

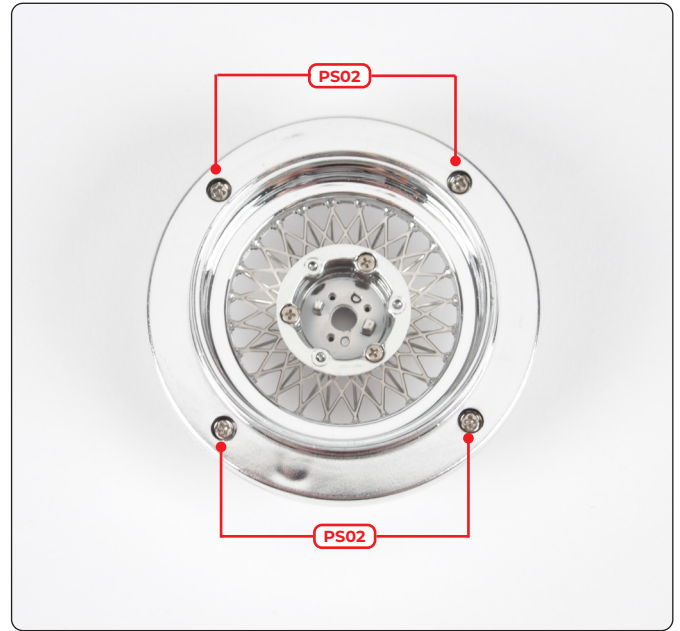

Press firmly around the edges, then turn the assembly over and secure using 4x PS02 screws.



## Stage 027: Building the Outer Wheel Rim (Regular)

Use this stage for building the regular versions of the wheel rims for the DB5. Go to Stage 029 if you are following the easy-build instructions.

Watch our video for extra guidance here: <https://youtu.be/iJAt2nvWEQw>



### STAGE 027 PARTS LIST

Name
27-A Spoke retainer ring
27-B Wheel centre
2-C Outer wheel rim
27-D Spokes x24
27-D Spokes x24
PS01 screws x5



## Stage 027: Building the Outer Wheel Rim (Regular)

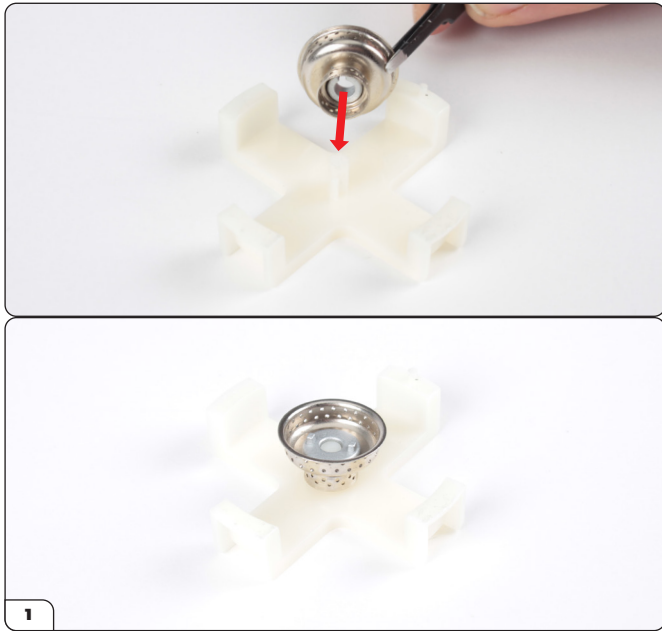

Align the shaped hole in the wheel centre (27-B) with the post on the jig (from stage 002) then fit it in place.

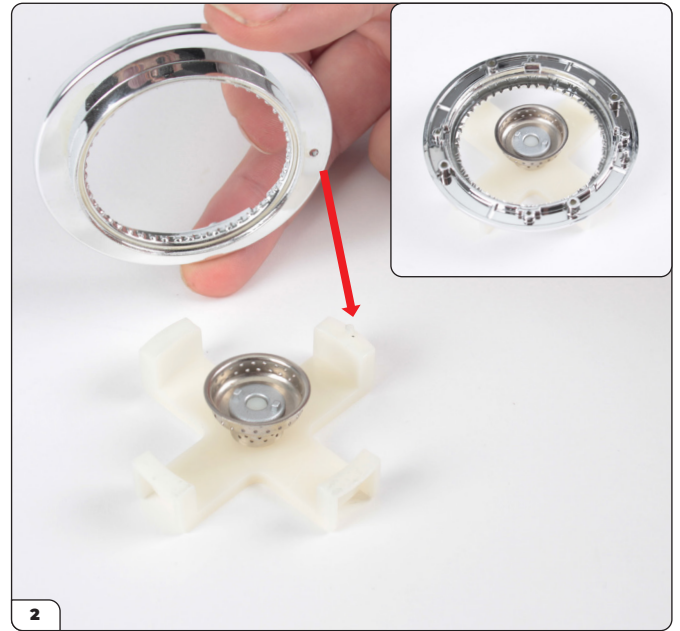

Fit the outer wheel rim (27-C) onto the jig, using the pin as a guide. Press firmly to lock the rim in position.



Open a bag of spokes (27-D) and thread the angled tip through one of the holes of the lower row.

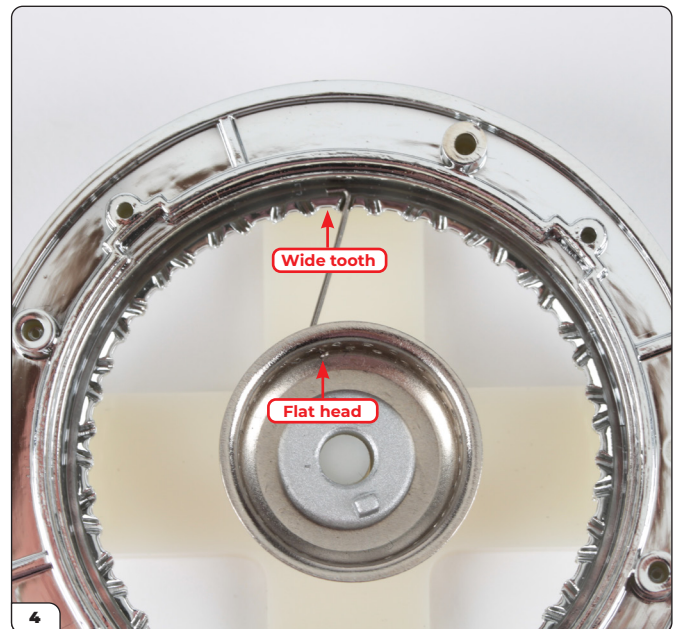

Pull the spoke through until the flat head reaches the hole, then hook the tip around the nearest wide tooth that gives a comfortable fit. The tip must face the wide tooth, as shown.

## Stage 027: Building the Outer Wheel Rim (Regular)

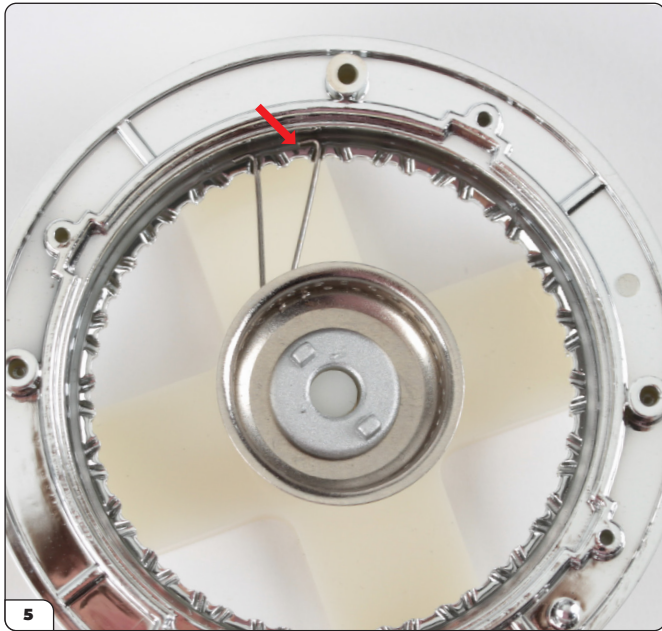

Thread another spoke through the next lower row hole and hook the tip around the next wide tooth (arrow). As you fit the remaining spokes, you can gently adjust the tension by twisting the wheel centre with your flat of your thumb.



Continue until all 24 spokes are in position.

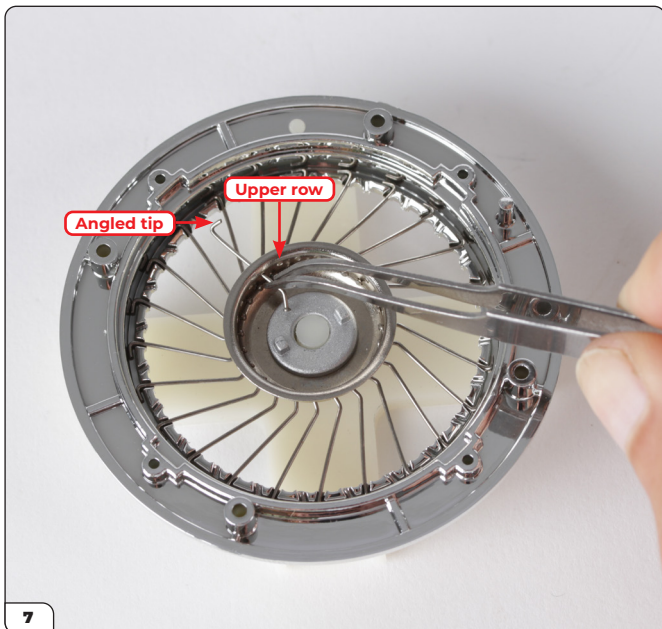

Open the remaining bag of spokes (27-D) and thread the angled tip through one of the holes in the upper row.

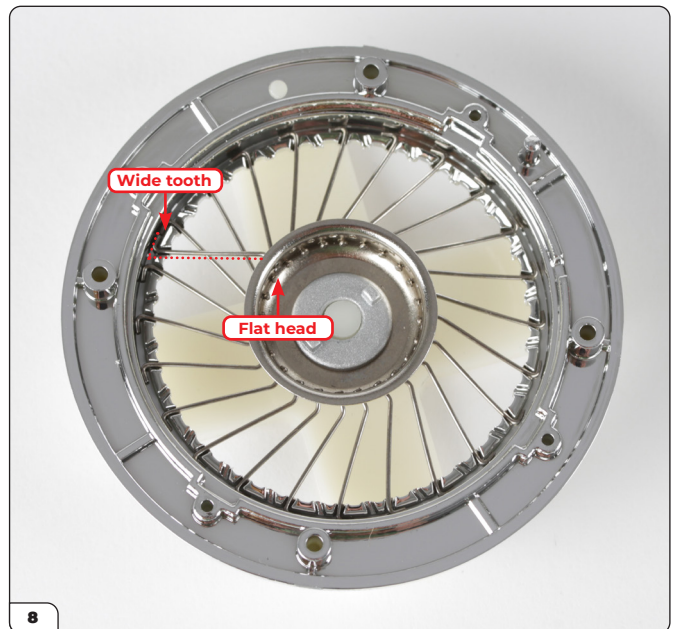

Pull the spoke through until the flat head reaches the hole, then hook the tip around the nearest wide tooth that gives a comfortable fit, facing the tip of the lower row spoke. While threading, some of the other spokes may be knocked out of position. You can wait until both rows have been threaded before correcting any tips.

## Stage 027: Building the Outer Wheel Rim (Regular)



Thread another spoke through the next upper row hole and hook the tip around the next wide tooth (arrow). Note the spokes create a diamond shape, highlighted in the image.

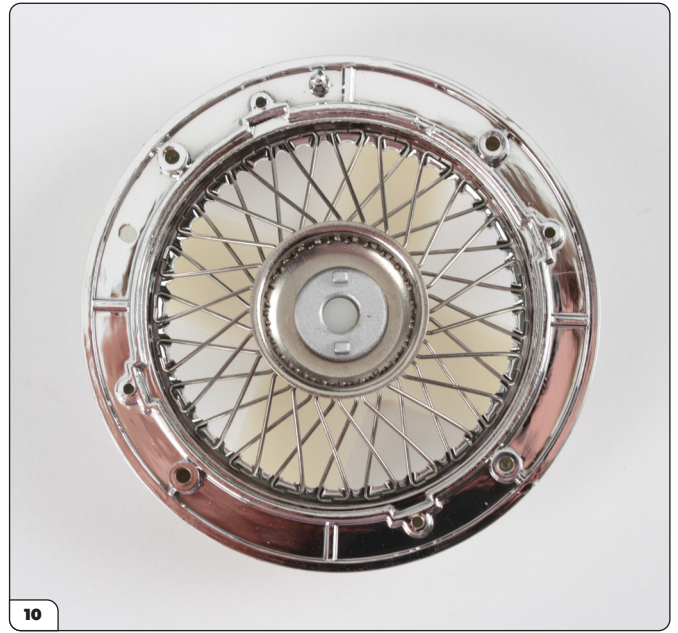

Continue in sequence until all spokes have been fitted, then carefully check each wide tooth to ensure the spokes are in the correct position.

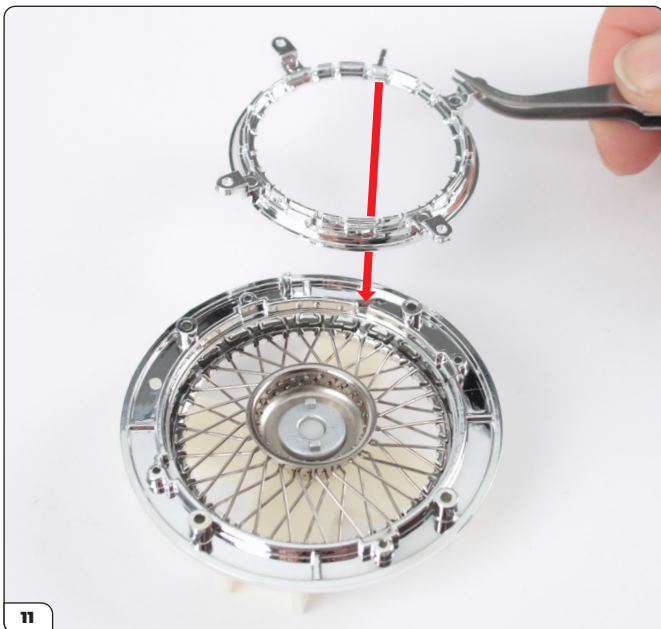

Fit the spoke retainer ring (27-A), using the protruding tab as a guide.

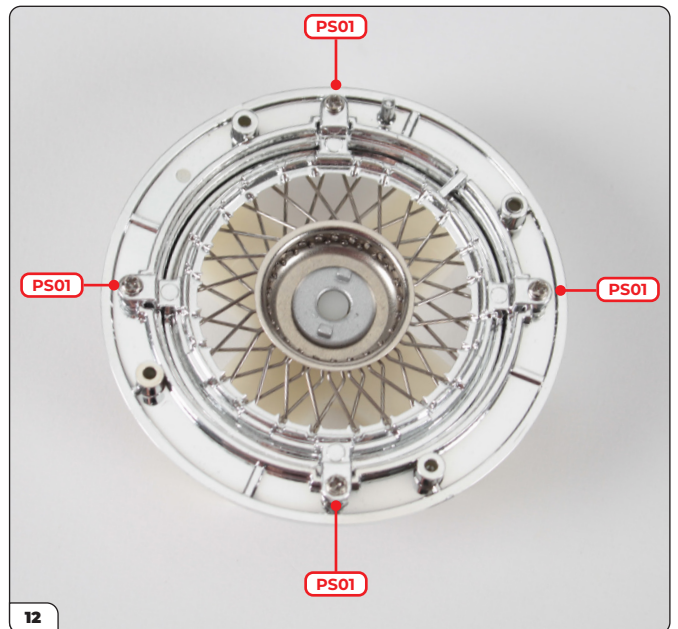

Check the spokes are in place, then secure the ring using 4x PS01 screws. To continue building, go to Stage 028.

## Stage 027: Building the Outer Wheel Rim (Regular)

STAGE COMPLETE





## Stage 028: Building the Inner Wheel Rim (Regular)

You'll continue to assemble the wheel by building the inner rim and its spokes then fitting it to the outer rim.



### STAGE 028 PARTS LIST

Name
28-A Inner wheel rim
28-B Spacer ring
28-C Spokes type A x12
28-D Spokes type B x12
PS02 screws x5

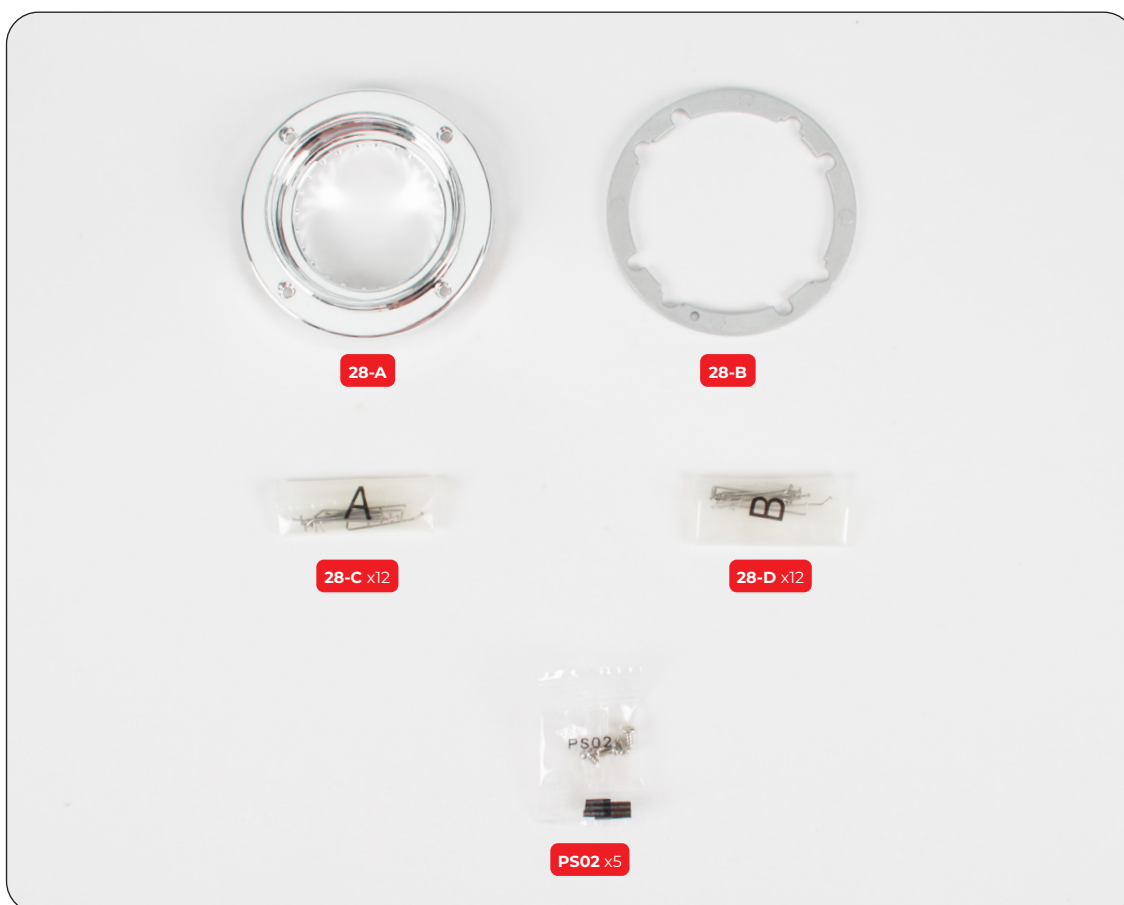

## Stage 028: Building the Inner Wheel Rim (Regular)

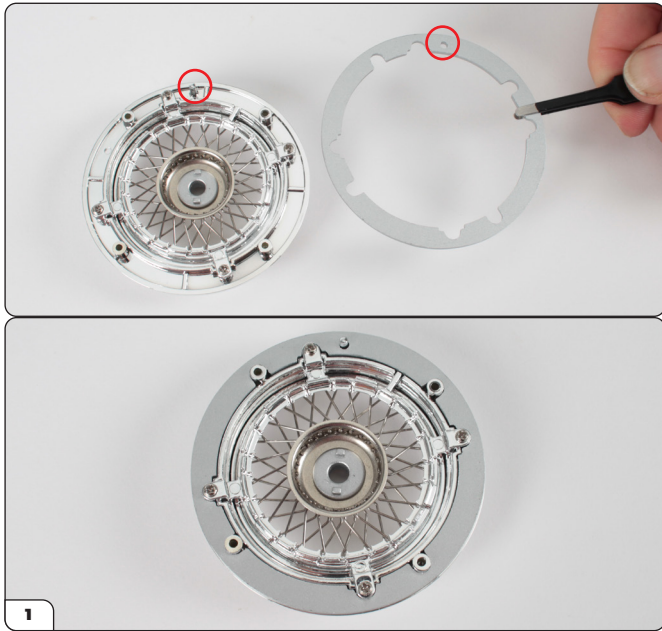

Align the spacer ring (28-B) with the outer wheel rim assembly (Stage 027) using the hole and pin (circled) as a guide. Fit the ring in place.

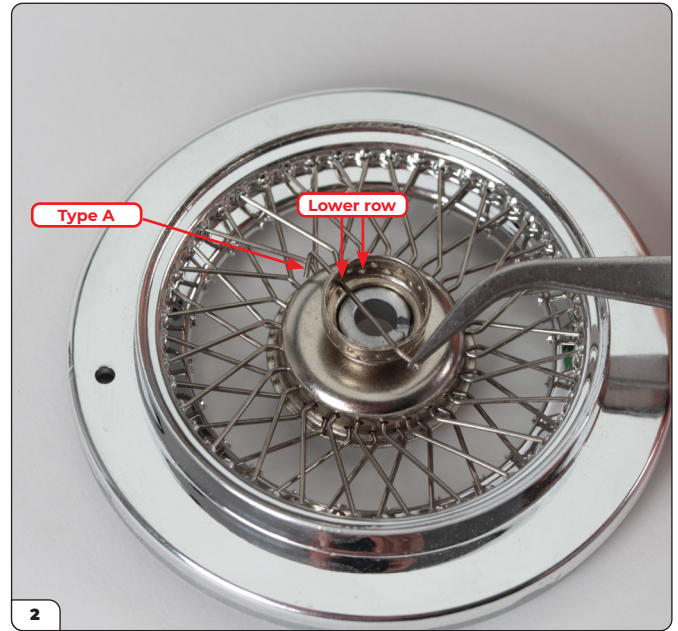

Turn the assembly over and push the tip of a type A spoke (28-C) through one of the holes in the lower row.



Pull the spoke through and guide the tip into the diamond shape to the left and out through to the opposite side.

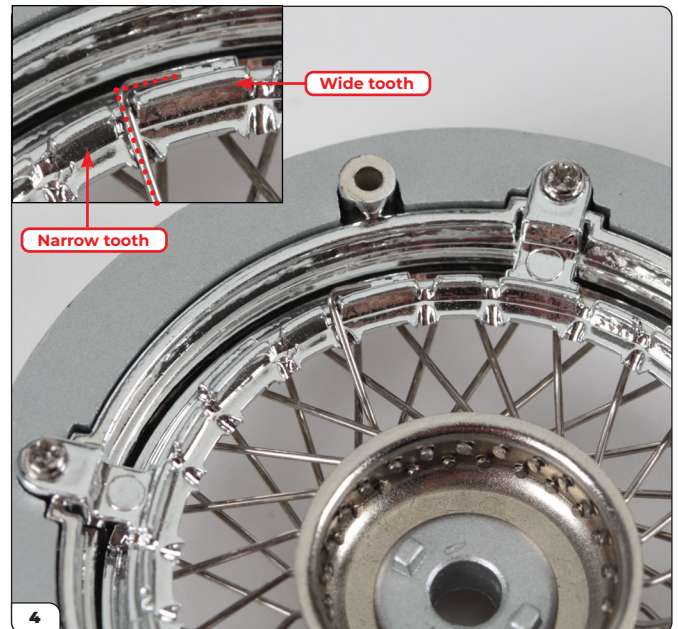

Turn the assembly over and fit the tip of the spoke. **It should hook around a wide tooth as shown.** If it aligns with a narrow tooth, thread the spoke through the next diamond along. This is very important. **Please ensure the spoke is fitted around a wide tooth.**

## Stage 028: Building the Inner Wheel Rim (Regular)



Once you are happy with the fit of the first spoke, thread another type A into the next lower hole and through the diamond two-along from the first, as highlighted in the image. At this stage, the tips can be left loose on the opposite side.



Continue to thread type A spokes around the lower row, pushing the tip through alternating diamonds as indicated. Continue to leave the ends loose for now, they do not need fitting onto the wide teeth yet.



Now take a type B spoke (28-D) and thread it through a hole of the upper row. Cross it over the lower row spoke to its left (circled) and guide the tip to the empty diamond without a spoke through it (highlighted).



Press the tip through the diamond with your forefinger while pushing the spoke into position with your thumb as shown.

## Stage 028: Building the Inner Wheel Rim (Regular)

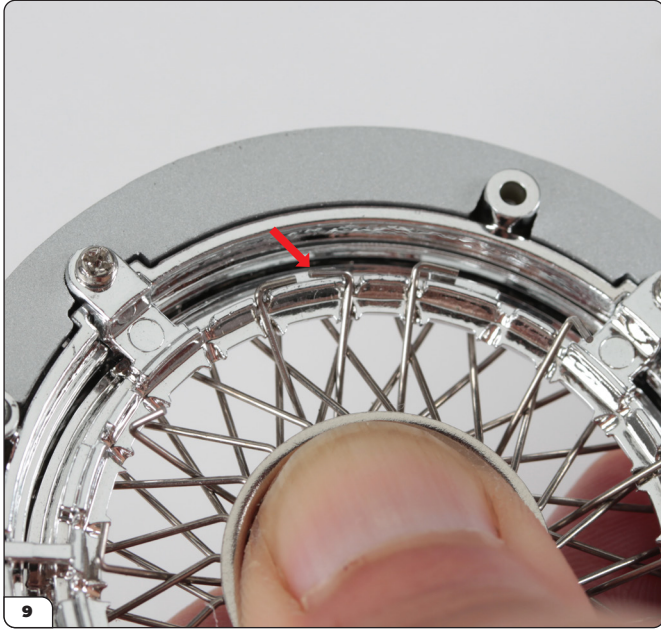

9 Turn the assembly over and check the tip fits over a wide tooth to face one of the lower row spokes.



10 Turn back over and thread another type B spoke into the next upper hole along, crossing it over the type A to its left and into the next empty diamond to the left.

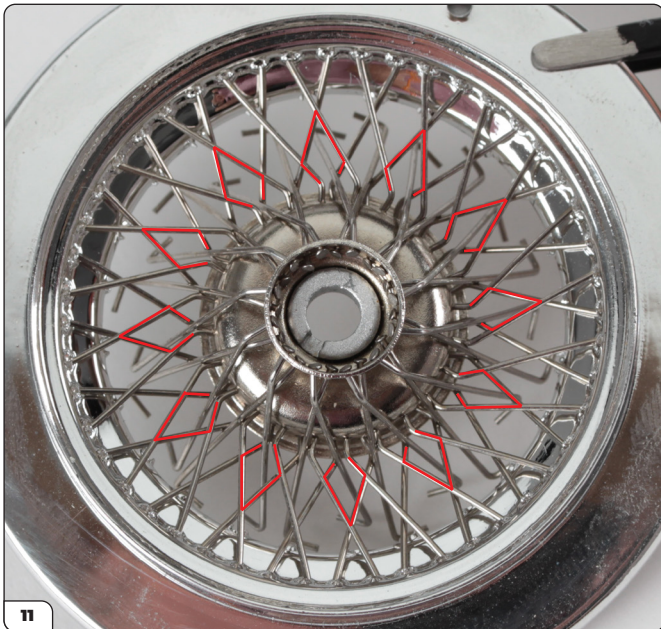

11 Continue to thread type B spokes through, crossing over the type A and through the next empty diamond in the same way.



12 Once you are happy all the spokes are fitted correctly, they can be fitted to the wide teeth. Start by pushing a piece of tissue paper into the wheel centre to hold the spokes in place.

## Stage 028: Building the Inner Wheel Rim (Regular)

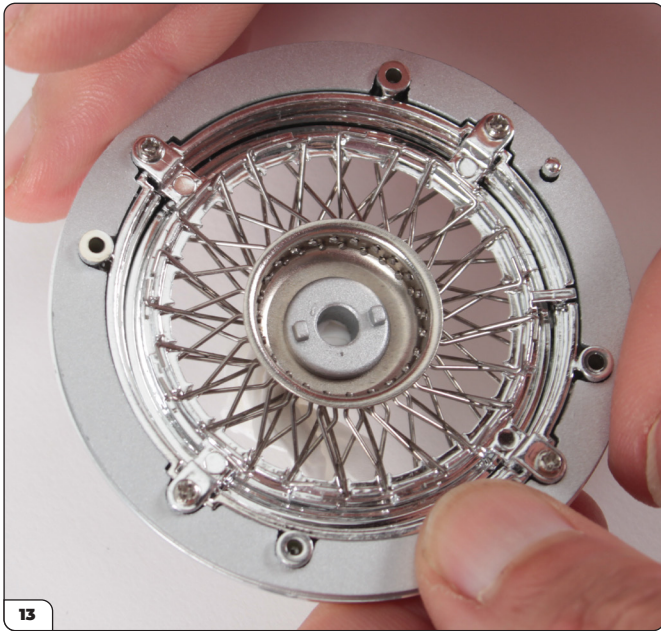

Keeping the tissue in place to hold the spokes, turn the assembly over. The tips of the spokes should now fall naturally towards the teeth.

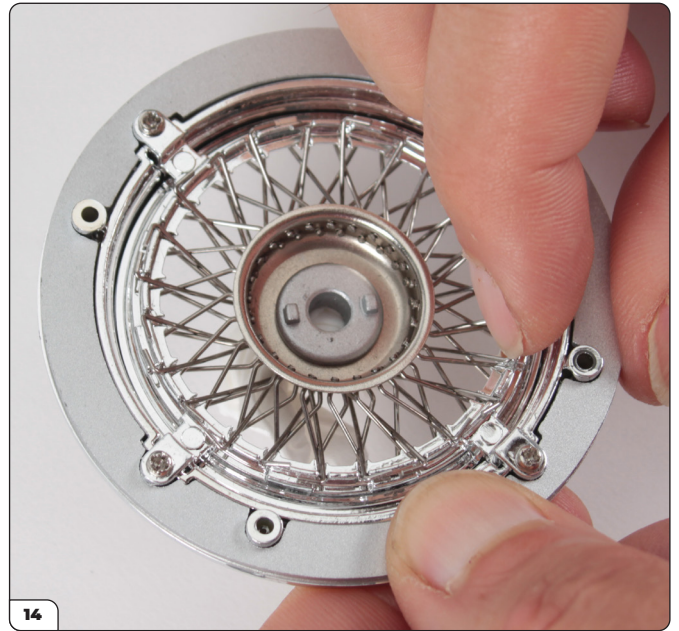

Gently brush the spokes with your finger to hook them over the wide teeth around the edge. The tension can be adjusted by gently pushing the soft part of your thumb into the centre and carefully twisting.

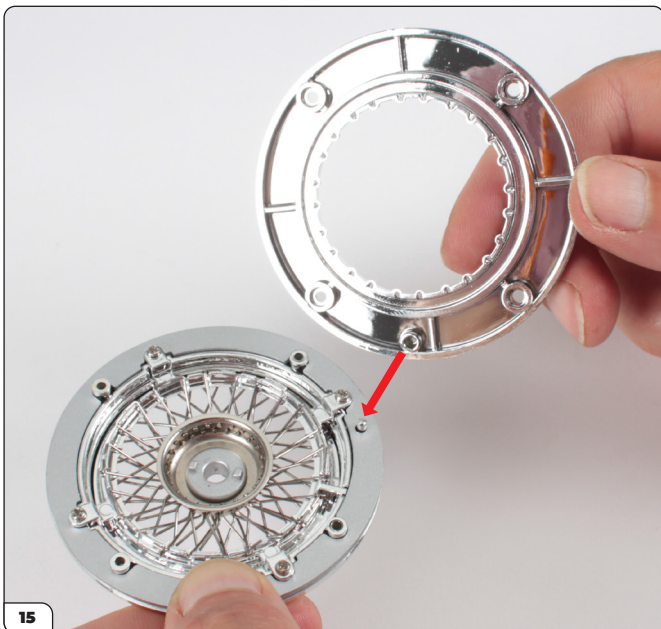

Align the inner wheel rim (28-A) with the assembly using the hole and pin as a guide.

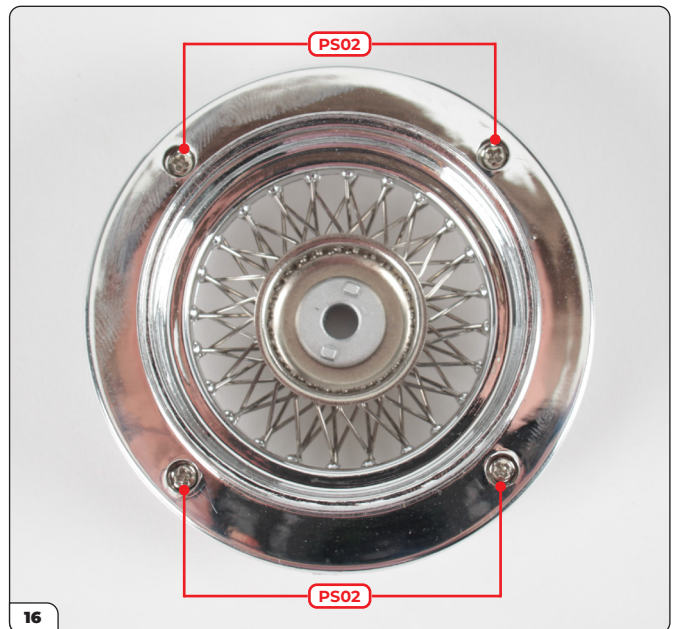

Press the inner rim in place, making sure the spokes stay in position, then secure using 4x PS02 screws.

## Stage 028: Building the Inner Wheel Rim (Regular)

STAGE COMPLETE



## Stage 029: Fitting the Tyre

With the wheel rim built you can now fit the tyre around it.



### STAGE 029 PARTS LIST

Name
29-A Tyre
29-B Hub cap



## Stage 029: Fitting the Tyre



Carefully place the tyre (29-A) in a bowl of hot water to soften it. Take care not to splash hot water when placing the tyre in the bowl.



After 1–2 minutes, remove the tyre from the water using tweezers to avoid burning your fingers. Dry with a cloth.



Fit your wheel rim (from stage 027VB or stage 027) into the tyre while it is still flexible. Press the rim into the tyre, then work your way around pulling the tyre over the rim.



Fit the hub cap (29-B) onto the wheel centre. The magnet will hold it in place.



## Stage 029: Fitting the Tyre

---

STAGE COMPLETE



## Stage 030: Mounting the Rear Chassis

For the last stage of this pack, you'll mount the rear chassis onto the main assembly.



### STAGE 030 PARTS LIST

Name
30-A Rear chassis
DS02 screws x7



## Stage 030: Mounting the Rear Chassis

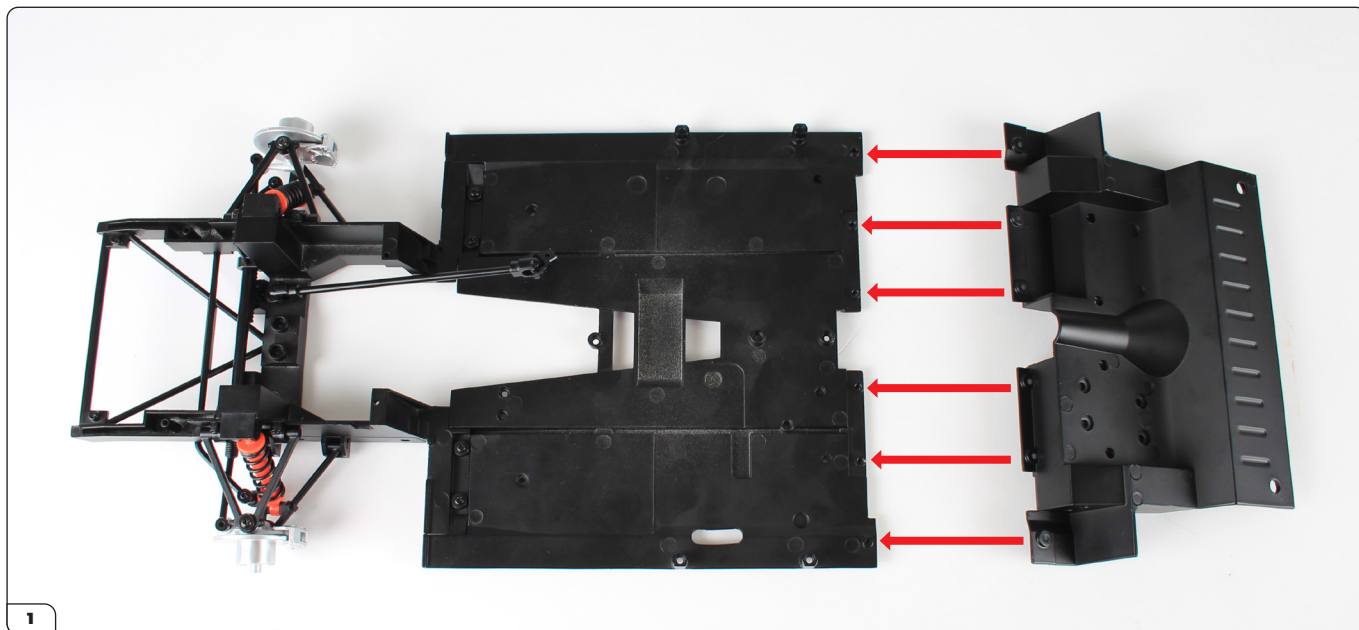

Align the rear chassis (30-A) with the main assembly.

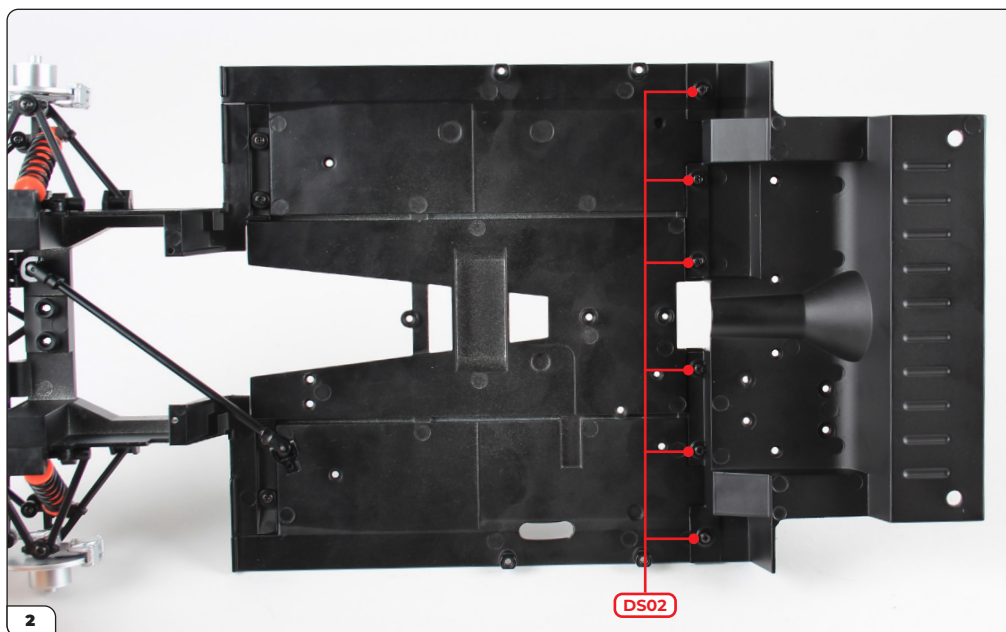

Fit the rear chassis then secure using 6x DS02 screws.

## Stage 030: Mounting the Rear Chassis

STAGE COMPLETE

