

TITANIC

THE SHIP • THE LEGEND

Pack 16





THE NEXT SECTION OF THE HULL



PARTS IN THIS ISSUE

87A Hull section, lower starboard side

LM Three 2.6 x 3mm PWM hexagonal headed screws (1 spare)

1 Take the hull assembly from the previous issue and check the fit of part **87A** at the aft end of part **79A**. The screw tabs on the end of part **87A** fit over the raised sockets on part **79A** (red arrows below and yellow circles below right).

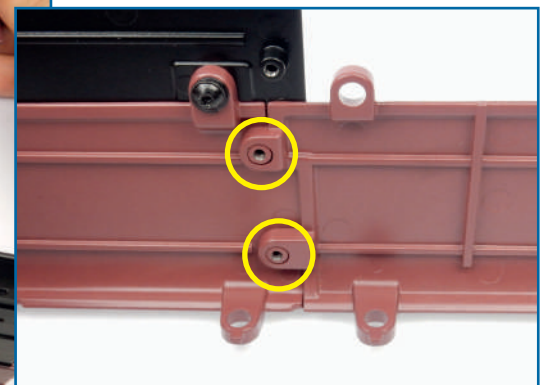
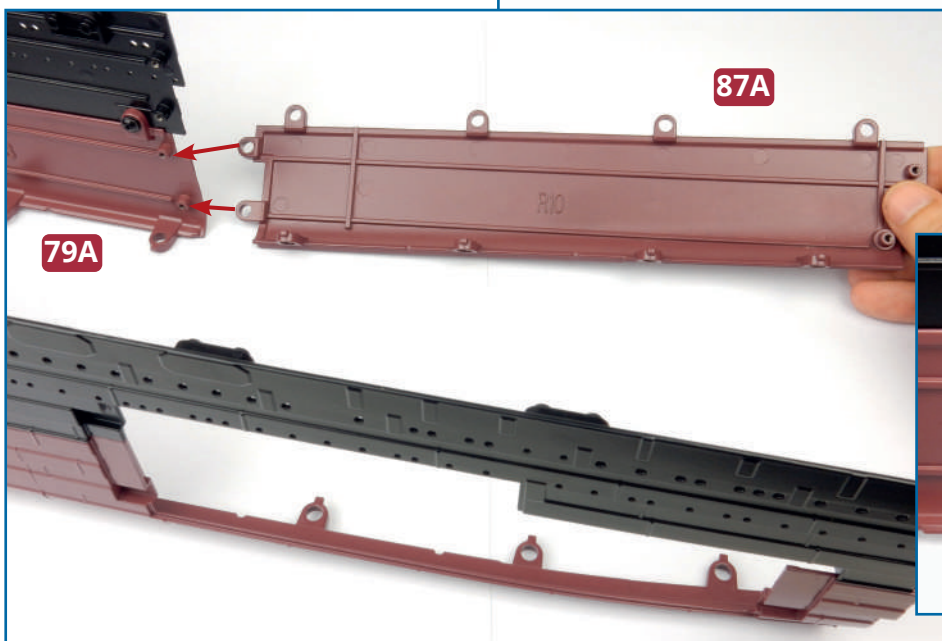

2 On the outside of the hull, check that the forward end of part **87A** is correctly aligned with part **79A** (right). Fix the hull sections together using two **LM** screws. You will need to use the Allen key supplied with issue 15.

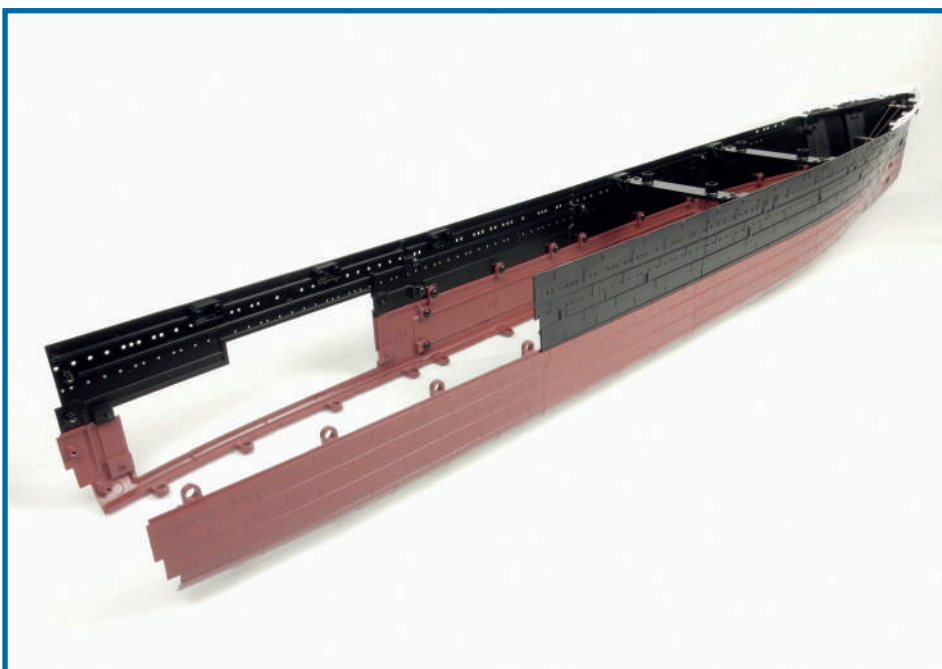
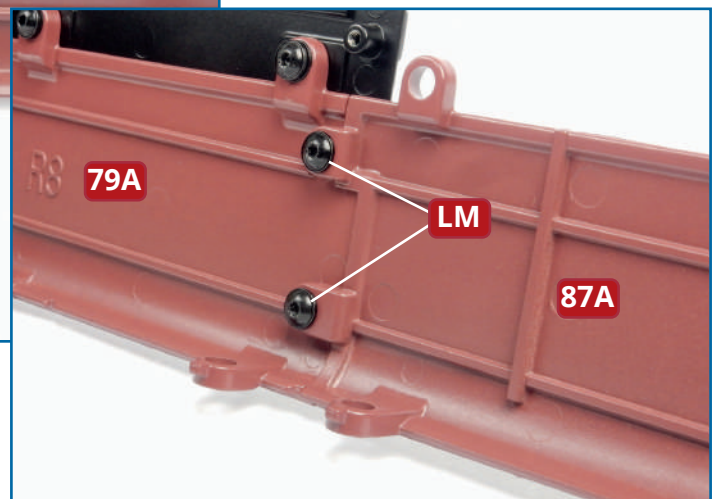
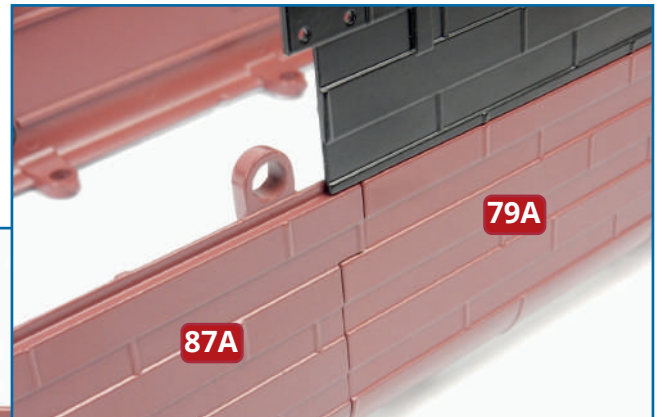
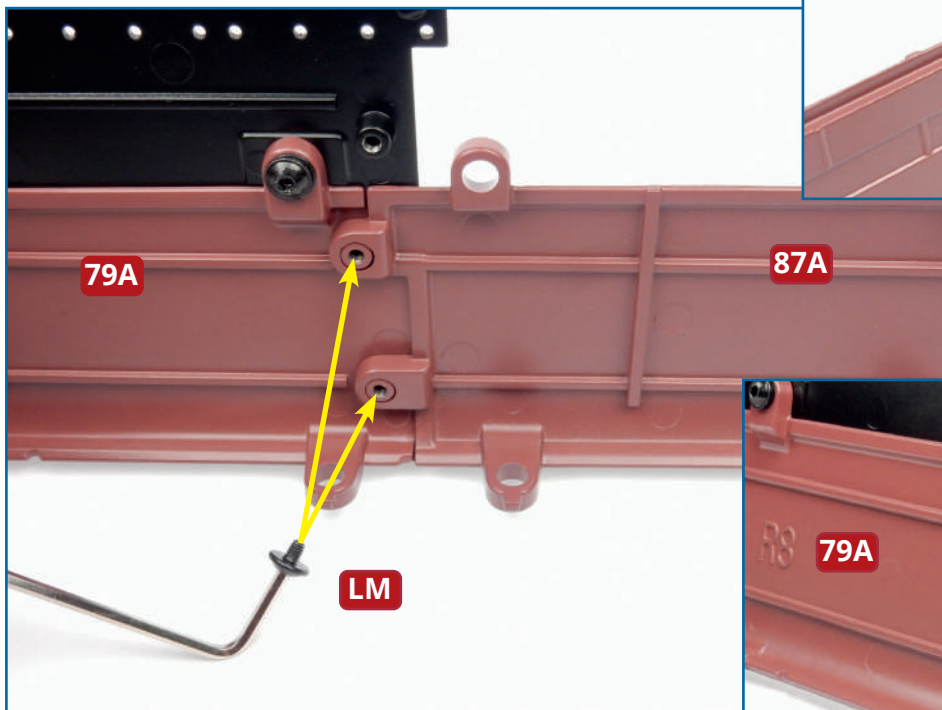

Completed work

The next lower starboard hull section has been fitted to your model.



NEXT UPPER STARBOARD HULL SECTION



PARTS IN THIS ISSUE

88A Upper starboard hull section

LM Seven 2.6 x 3mm PWM hexagonal headed screws (1 spare)

1 Take the hull assembly from the previous issue and check the fit of the upper hull part **88A** to the aft of part **80A** and along the top of part **87A**. Tabs on the forward end of part **88A** fit over raised screw sockets on part **80A** (red arrows; see also the photo below right). Tabs on part **87A** fit over raised screw sockets on part **88A**, as indicated (blue arrows).

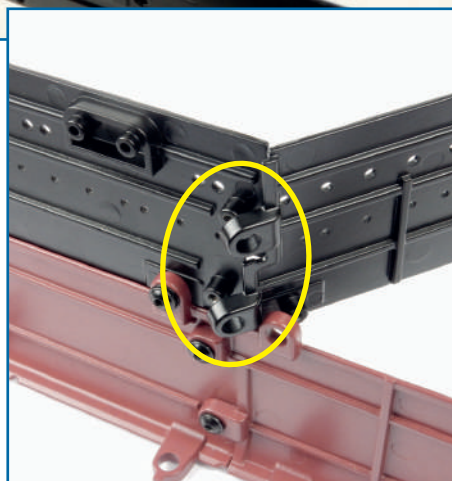
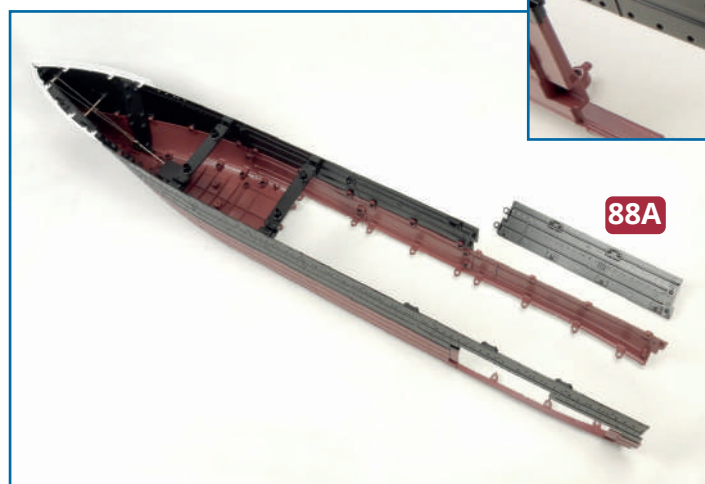
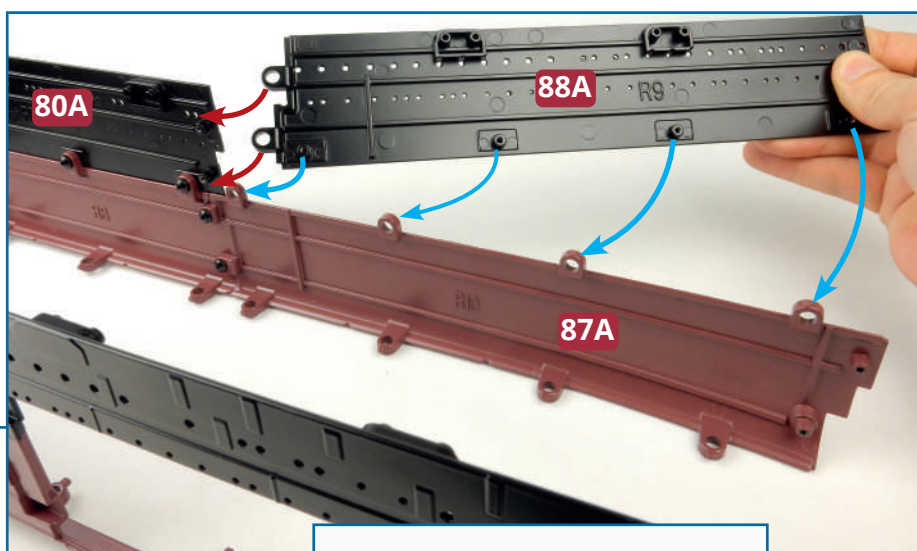

★ STEP-BY-STEP INSTRUCTIONS ★

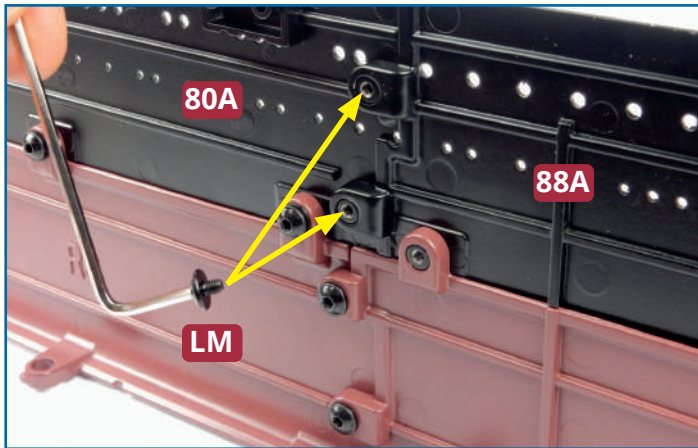

2 Fix the forward end of part **88A** in place with two **LM** screws. You will need to use the Allen key supplied with issue 15 to tighten the screws.

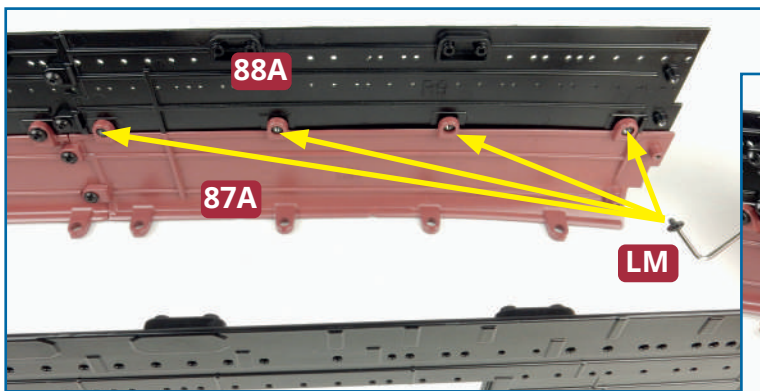
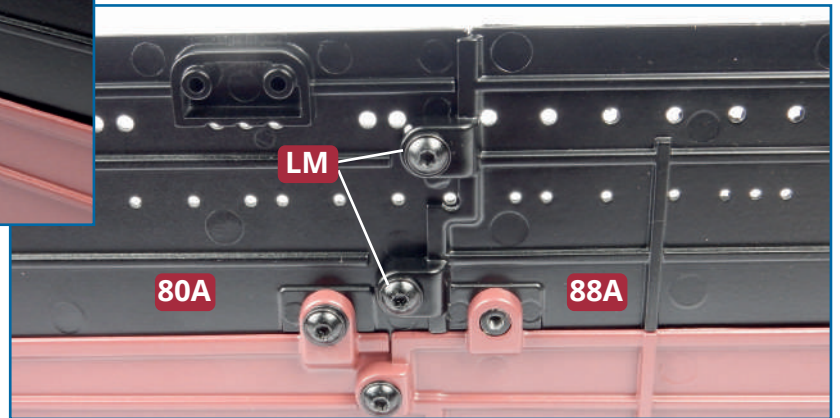

3 Similarly, fit the lower edge of part **88A** in place with four **LM** screws, tightening them with the Allen key.

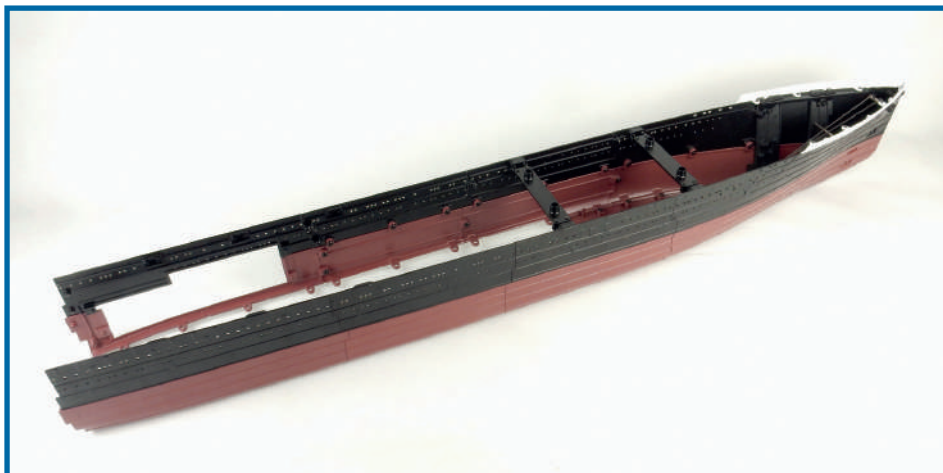
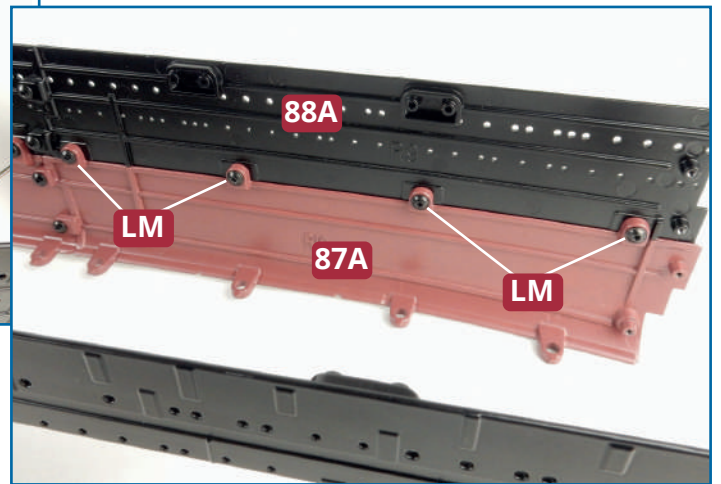

Completed work

The starboard side of the hull is now the same length as the port side.



THIRD SECTION OF THE BRIDGE DECK

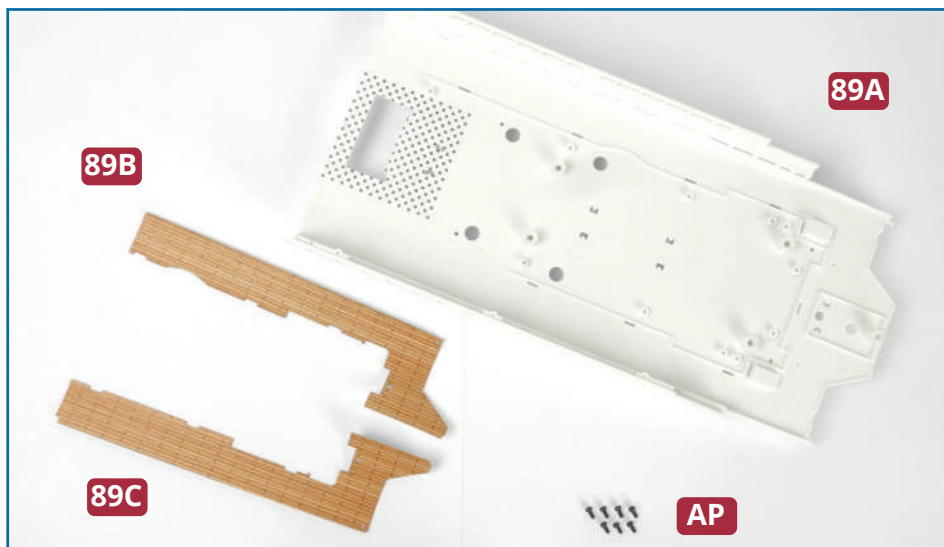

PARTS IN THIS ISSUE

89A Third section of the bridge deck

89B Decking (starboard side)

89C Decking (port side)

AP Seven 2.3 x 5mm PB screws (1 spare)

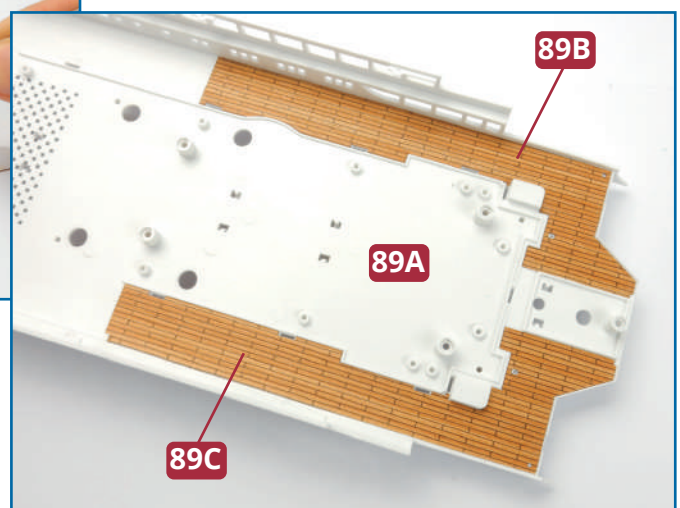
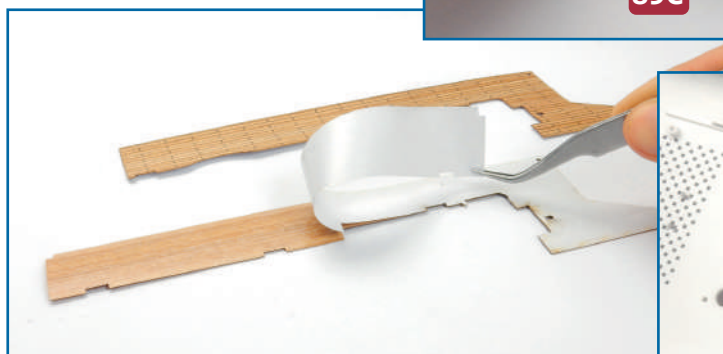
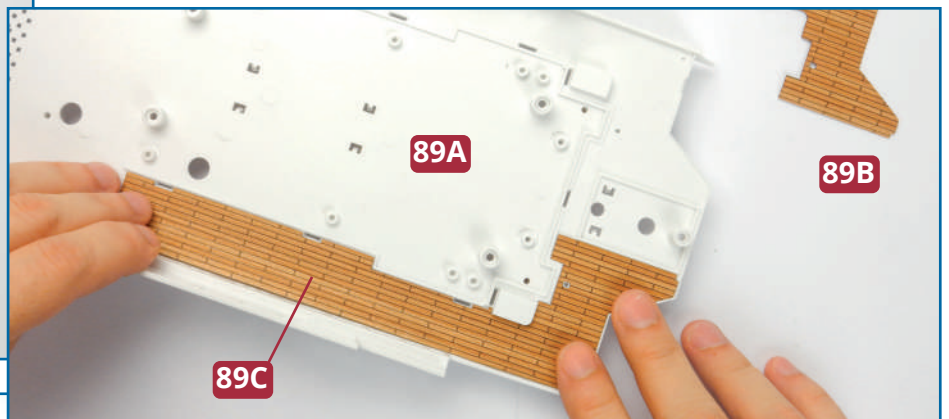
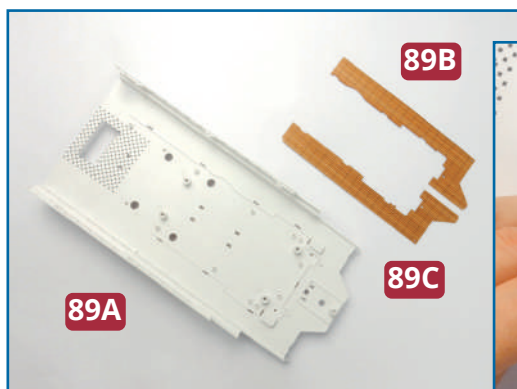

1 Take the two decking panels **89B** (starboard) and **89C** (port). Check how they fit on the bridge deck **89A** then, one at a time, remove the protective backing and fix the decking in place, smoothing it out with a soft cloth.

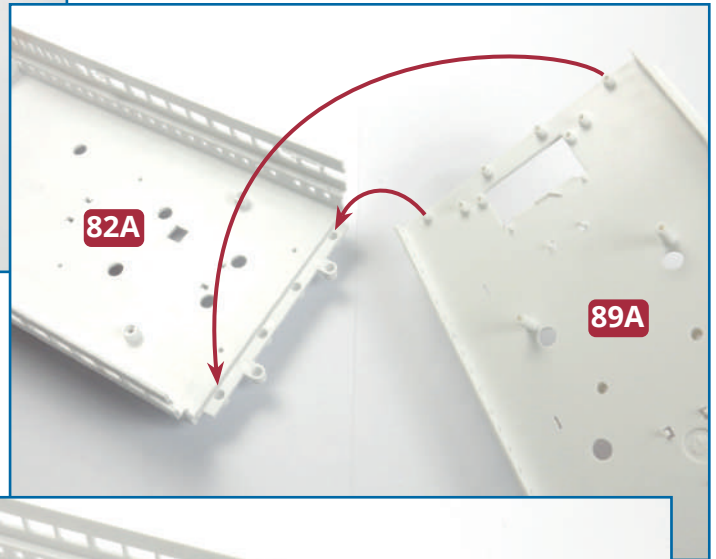
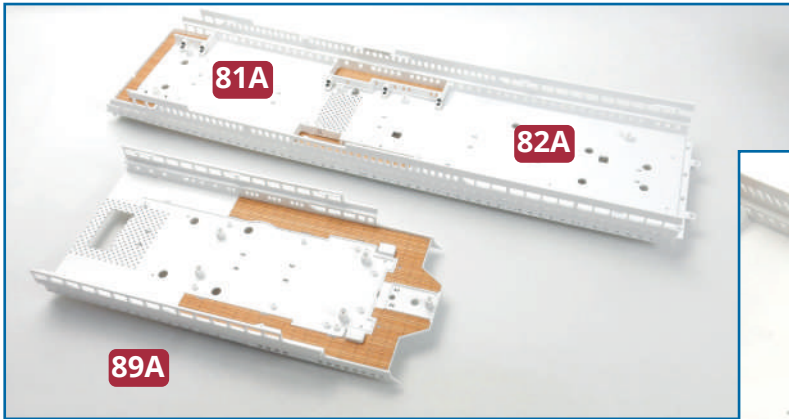

2 Take the bridge deck assembly from issue 84 and check how deck section **89A** fits against section **82A** so that the screw holes are aligned. Fix the deck sections together with six **AP** screws (circled below), which are fitted from the underside of the deck.

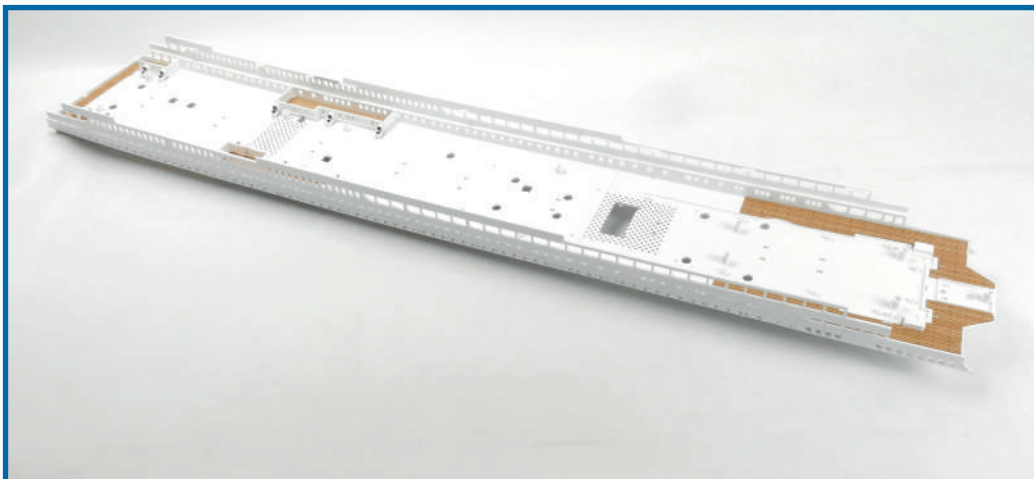
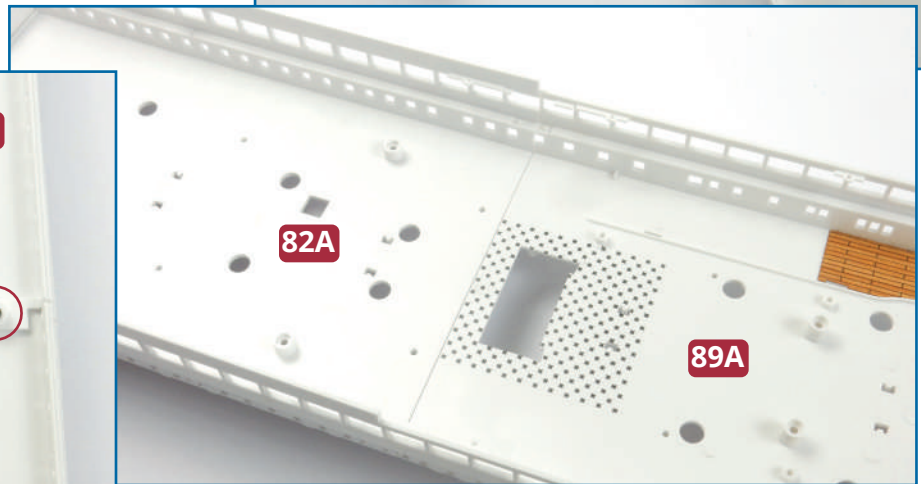
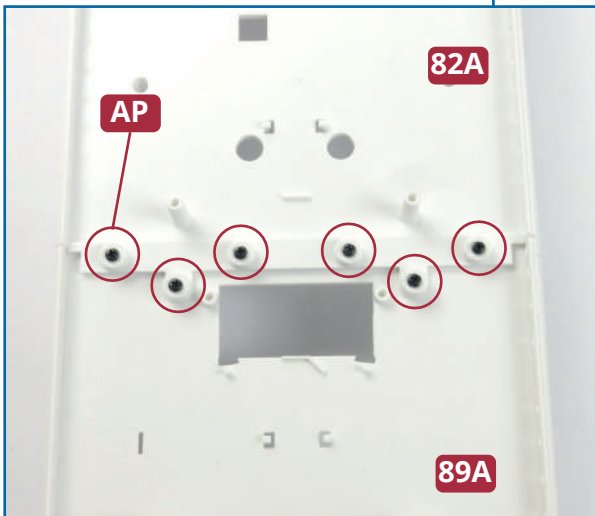

Completed work

The bridge deck is complete, with all the major parts fitted.



DETAILS FOR THE BRIDGE DECK



PARTS IN THIS ISSUE

- 90A** Restaurant bulkhead (starboard side)

- 90B** LED strip

- 90C** LED cable

- 90D** Stern staircase

- 90E** Decking

- 90F** Windows A (x 3, large rectangles)

- 90G** Windows B (x 6, small rectangles)

- 90H** Windows C (x 4, arched)

- 90I** Decking (small panel)

- 90J** Connectors (x 4)

- 90K** Joining pieces (x 2)

- AP** Eleven 2.3 x 5mm PB screws (1 spare)

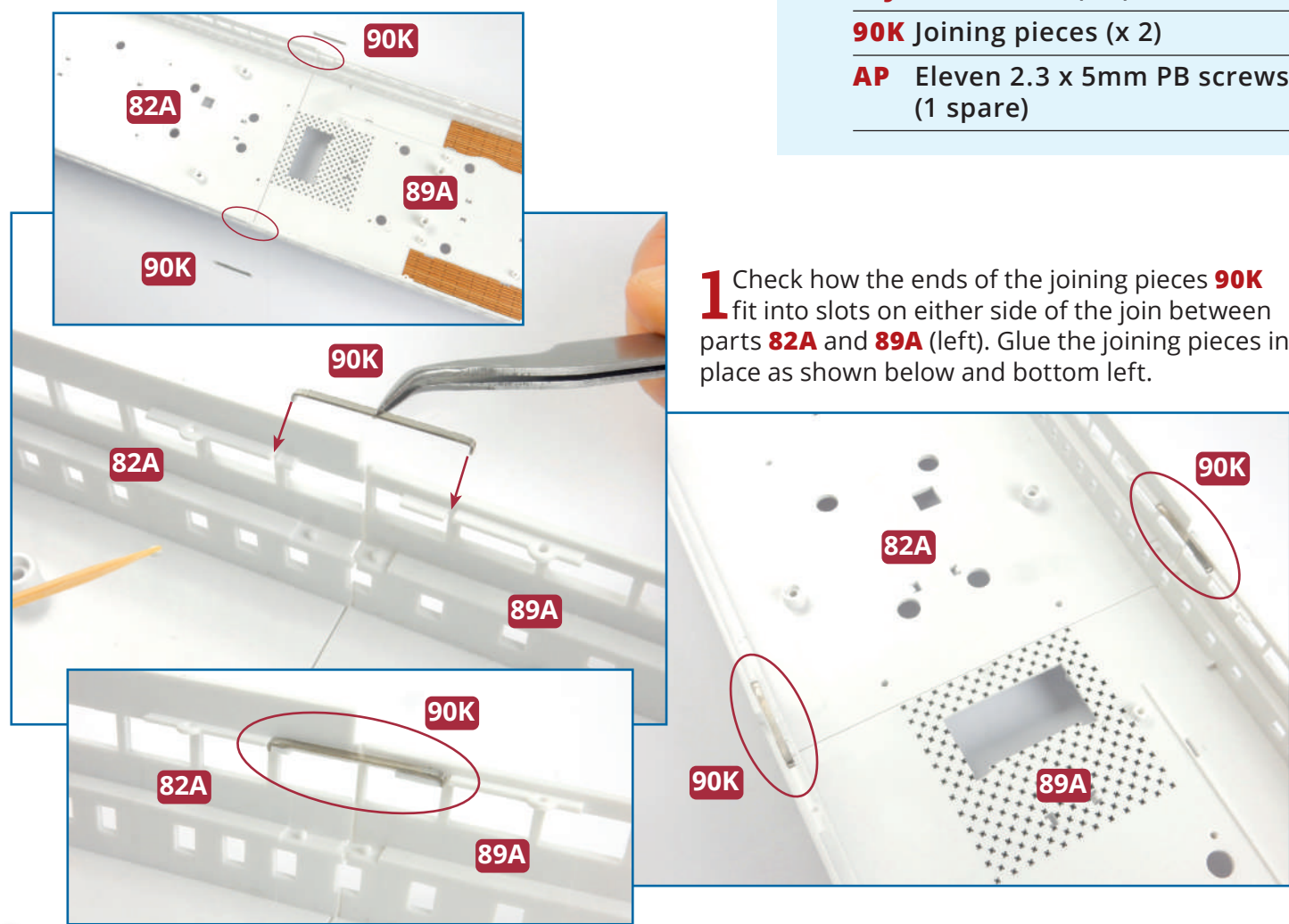

★ STEP-BY-STEP INSTRUCTIONS ★

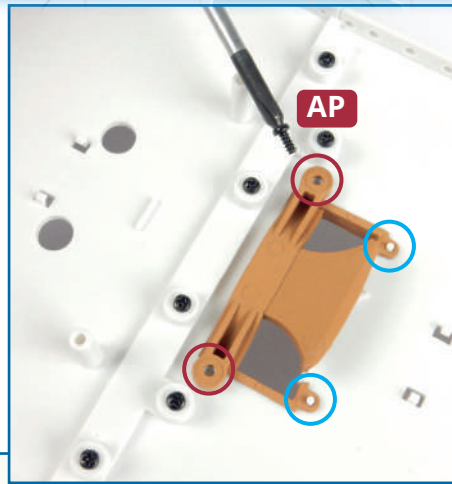
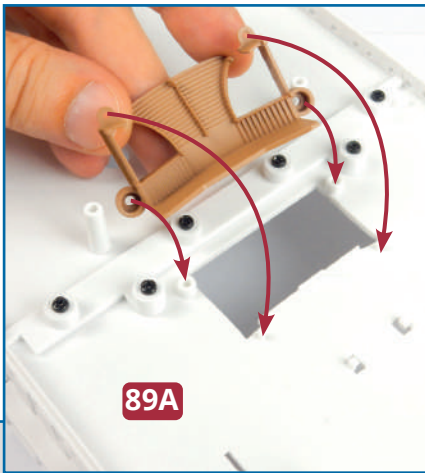

2 Turn the bridge deck assembly upside down, taking care not to damage any parts, and check how the staircase **90D** fits so that the screw holes align. Pegs on the underside of part **89A** fit into holes in tabs on part **90D** (circled in blue). Fix in place with two **AP** screws using the screw holes circled in red.

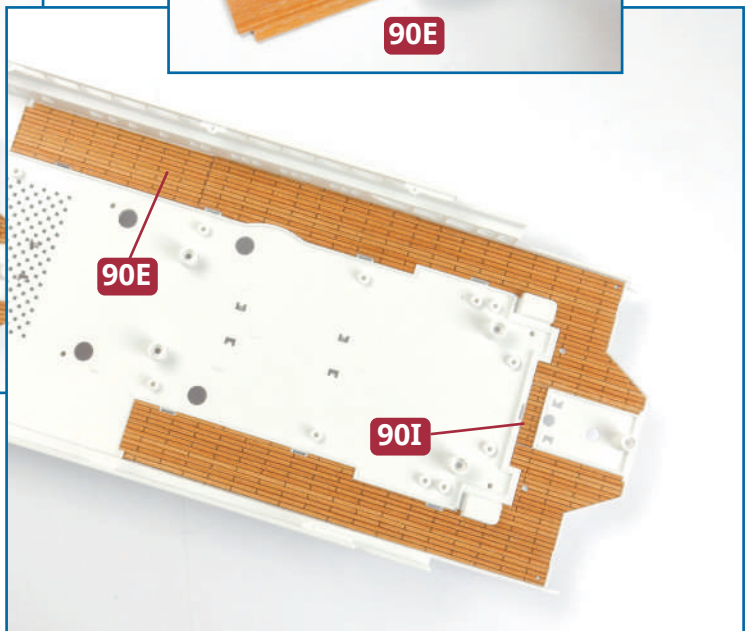
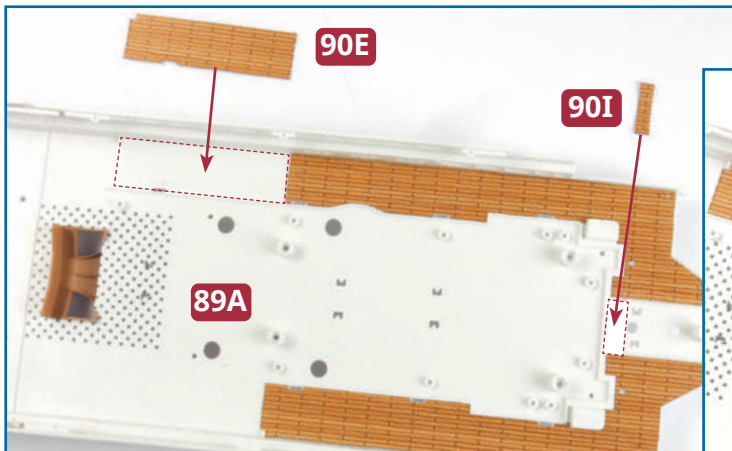
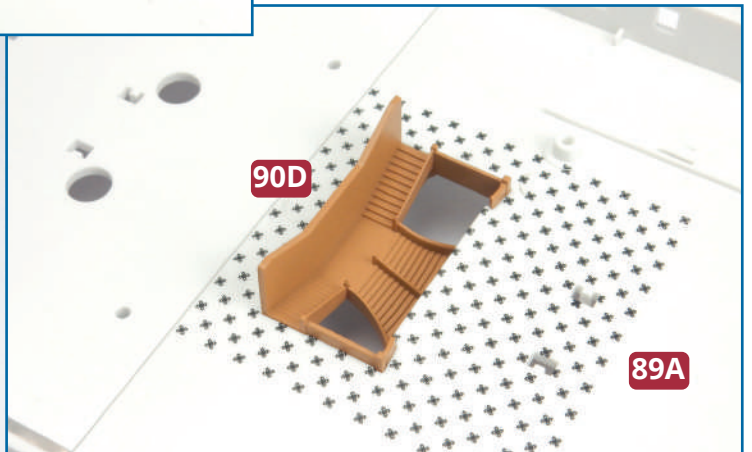
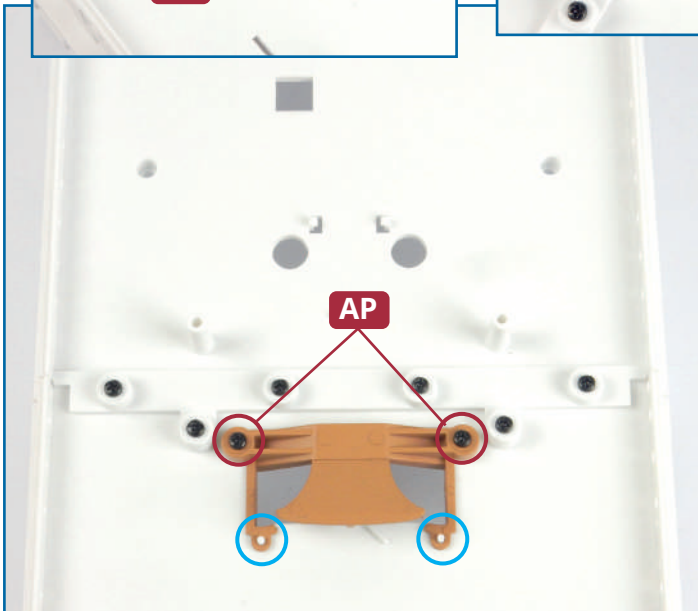

3 Take the two panels of decking **90E** and **90I**. Check how the decking fits on the deck assembly then, one at a time, remove the protective backing and fix the decking in place, smoothing it down with a soft cloth.

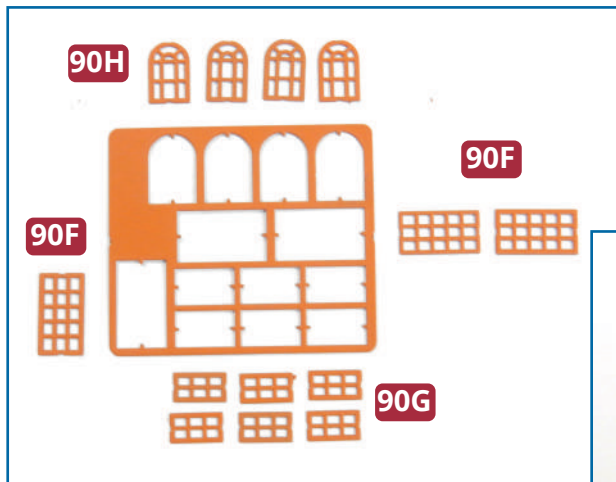

4 Remove the windows **90F** (x 3), **90G** (x 6) and **90H** (x 4) from the frame. Glue them in place on the outside of the bulkhead **90A** as shown: windows **90G** are for the second class smoking room, windows **90F** for the restaurant, and windows **90H** for the cloakroom and corridor.

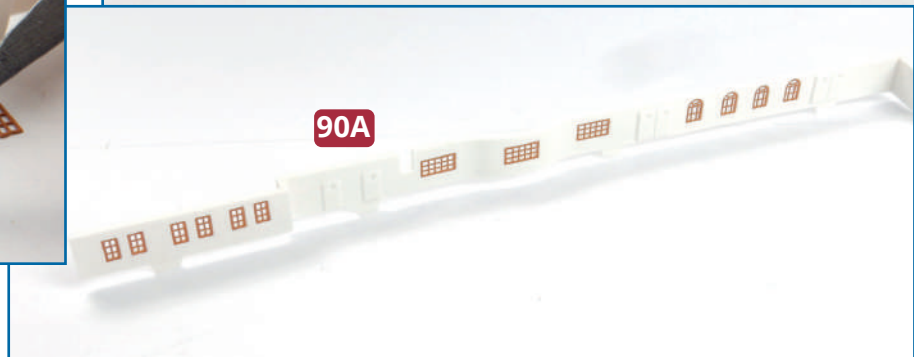
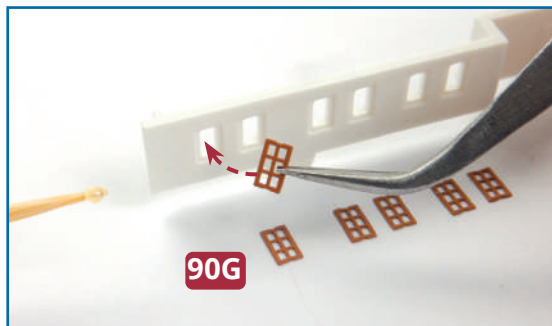
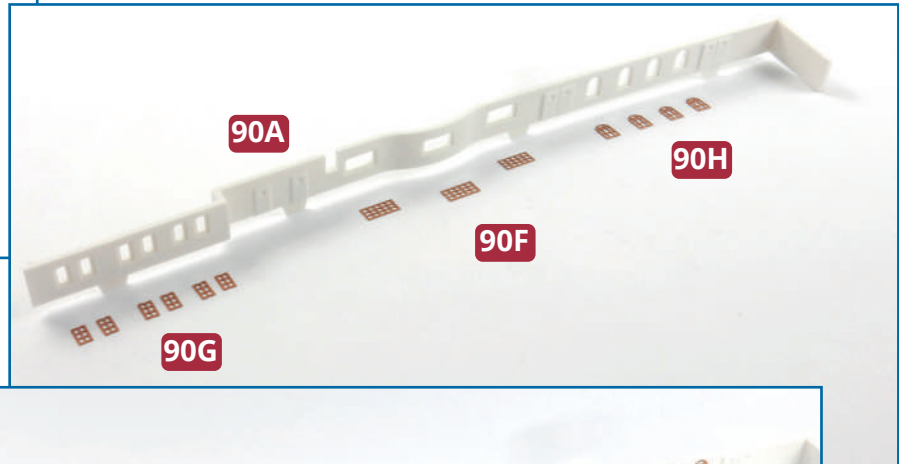

5 Take the four connectors **90J** and the bulkhead **90A**. Fix the connectors to the inside of the bulkhead as shown, using four **AP** screws.

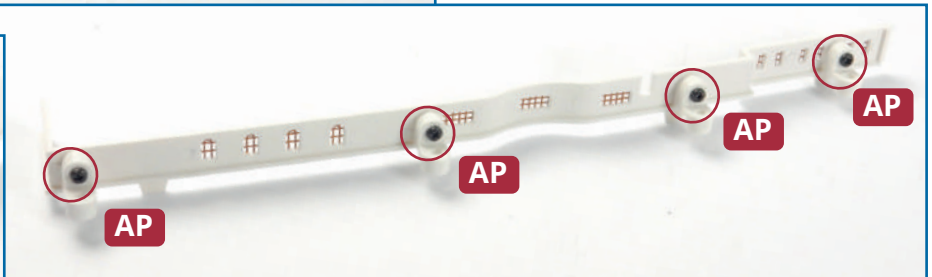
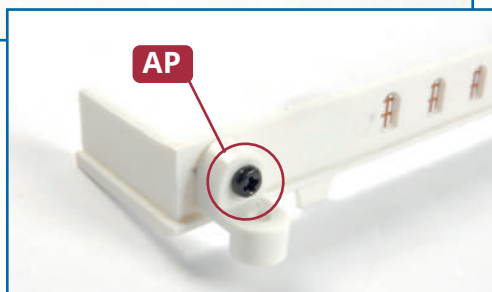
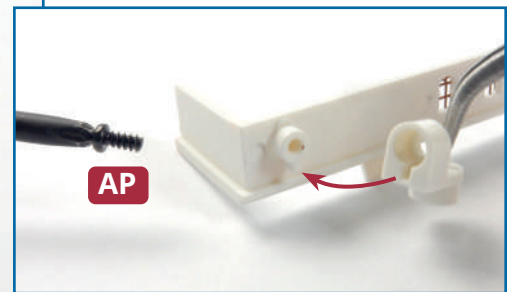
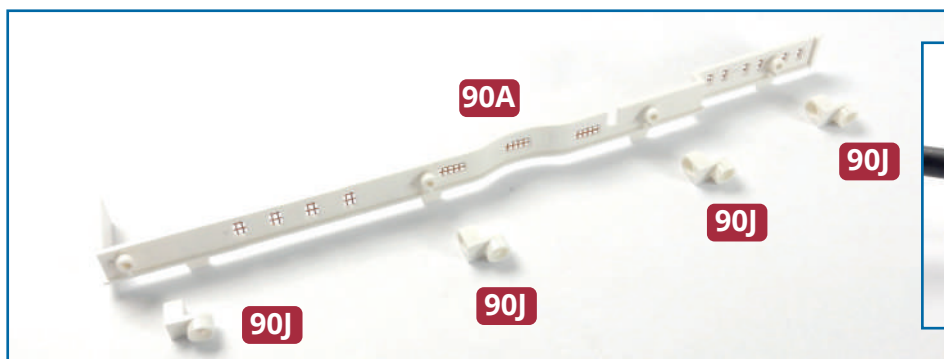

★ STEP-BY-STEP INSTRUCTIONS ★

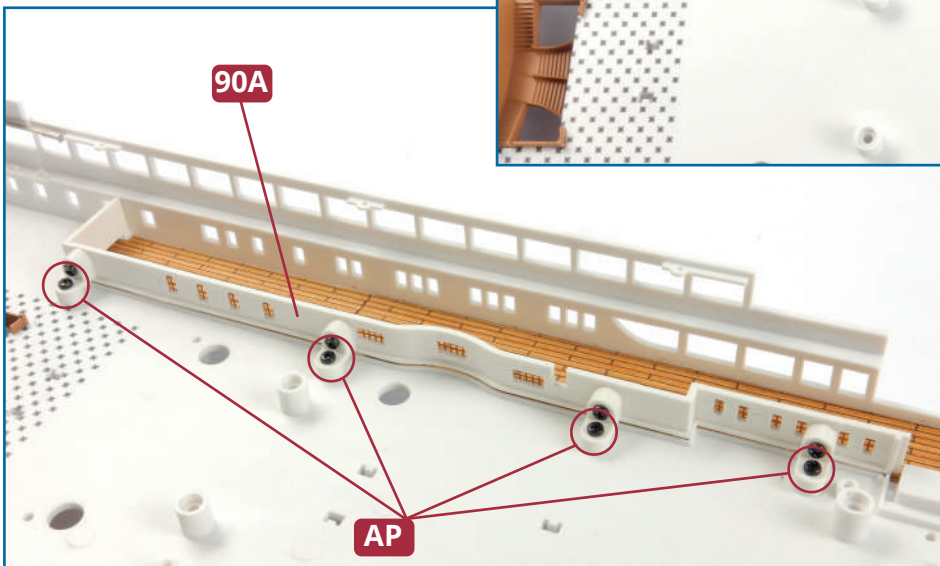
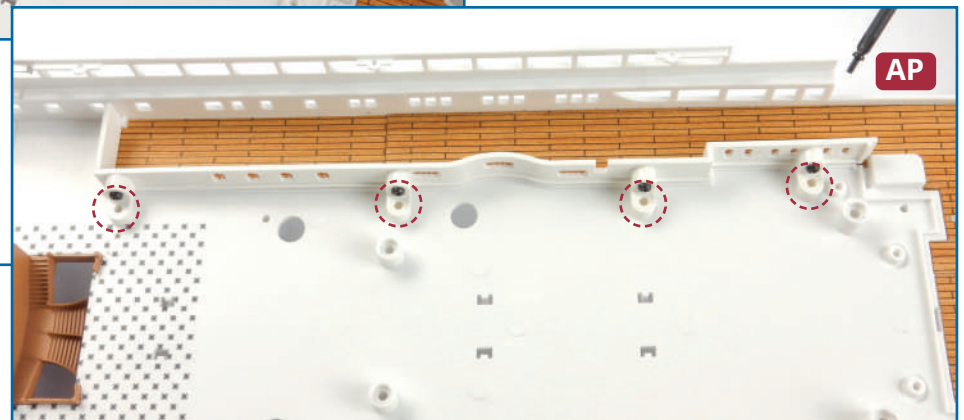
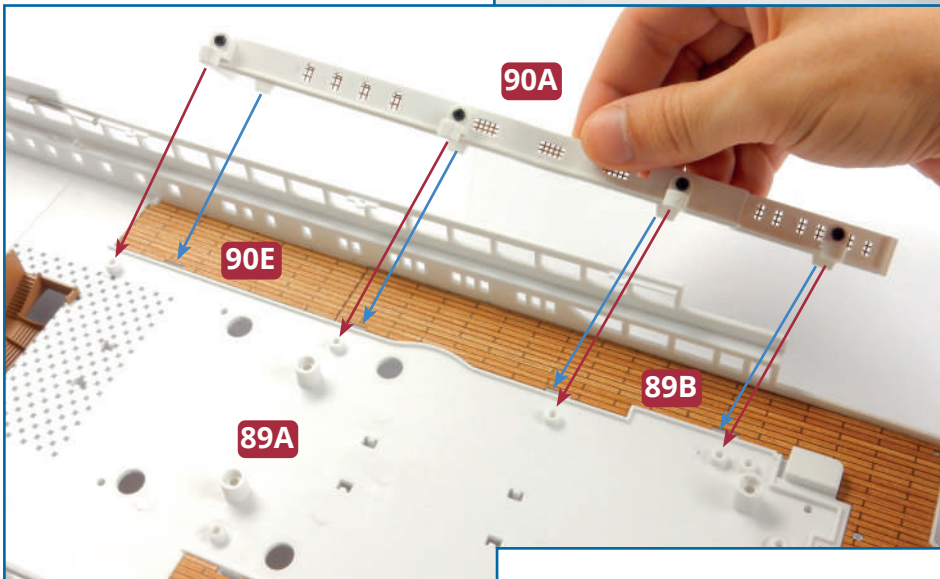
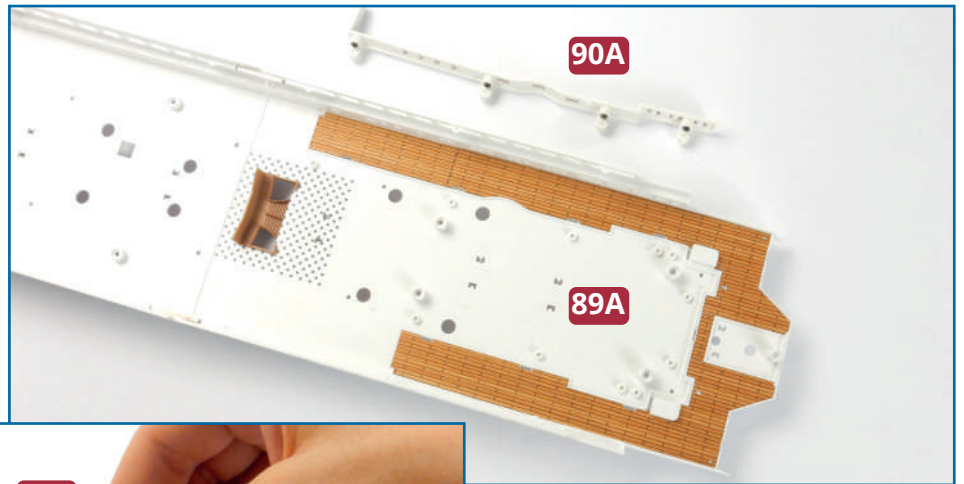

6 Check how the bulkhead **90A** fits on section **89A** of the bridge deck, alongside deck sections **89B** and **90E**. The connectors **90J** fit over raised screw sockets on the deck (red arrows), and tabs on the lower edge of the bulkhead fit into slots in the deck (blue arrows). Fix in place with four **AP** screws.



7 Carefully turn the bridge deck over and identify the fixing point for the LED strip **90B** on the underside of deck section **82A**. Insert one side of the LED strip under the clips (circled in red, below) and then clip the other side in place beneath the clips circled in blue.

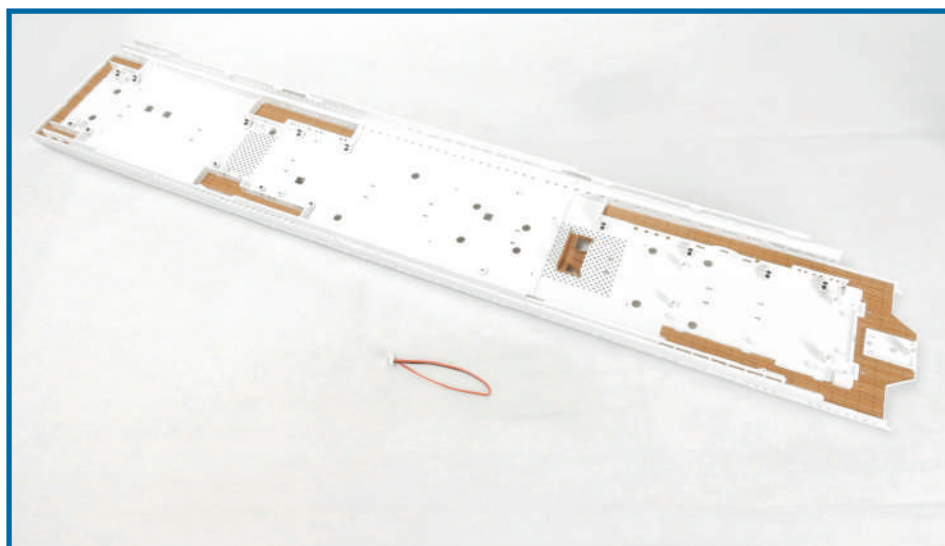
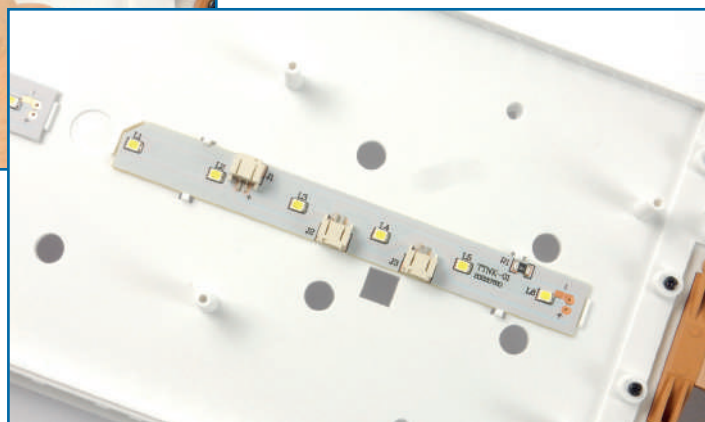
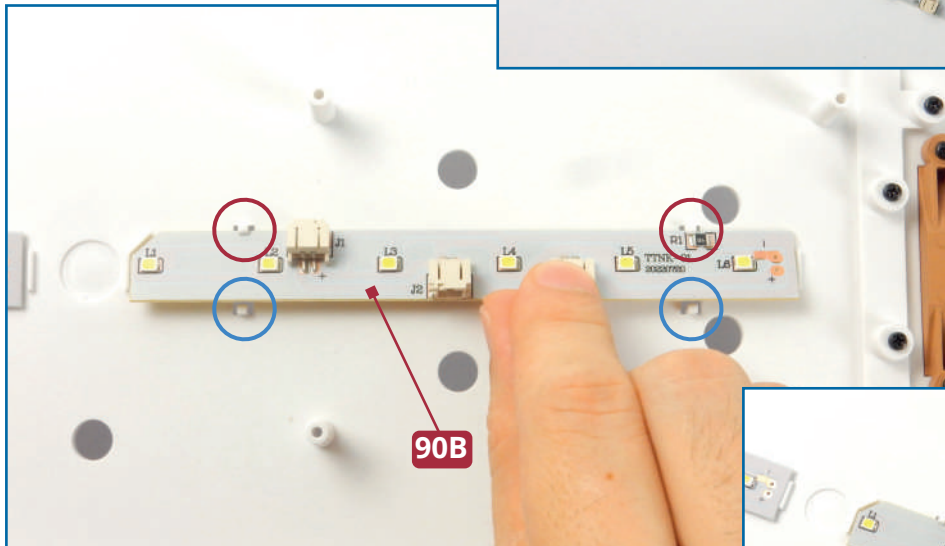
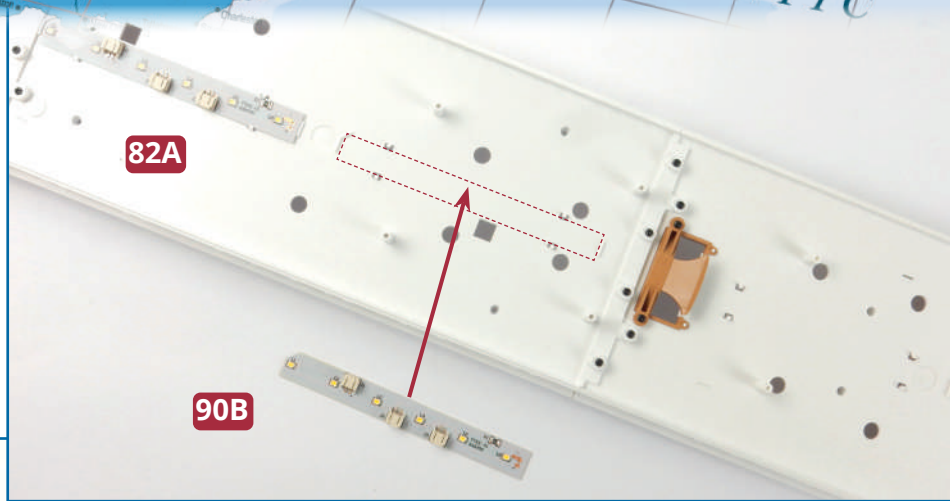

Completed work

The starboard wall of the restaurant has been fitted to the bridge deck. Store the LED cable **90C** until it is needed.

BULKHEADS FOR THE BRIDGE DECK

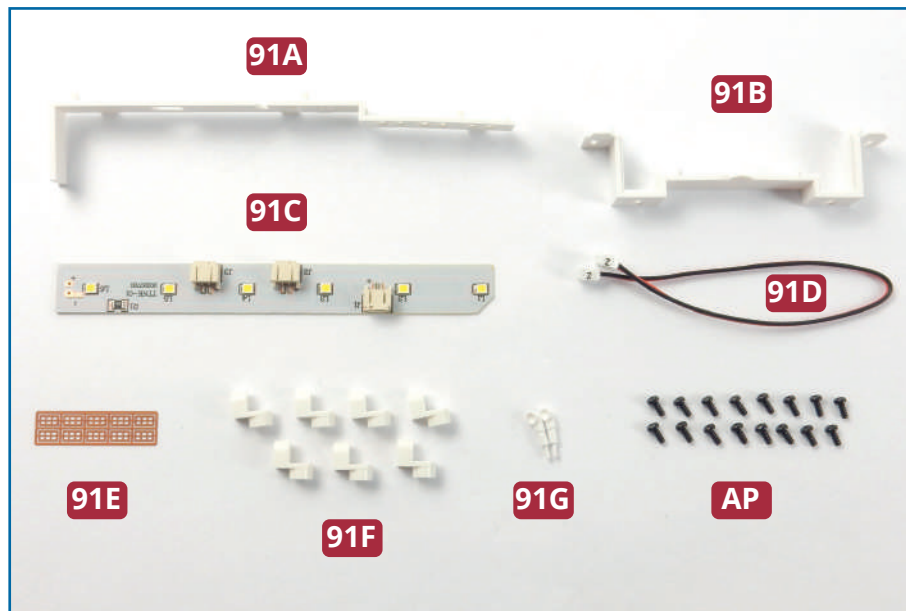

PARTS IN THIS ISSUE

- 91A** Bulkhead for the port side of the restaurant

- 91B** Bulkhead for the aft of the second-class smoking room

- 91C** LED strip

- 91D** LED cable

- 91E** Windows (x 10)

- 91F** Connectors (x 7)

- 91G** Ventilators (x 2)

- AP** Sixteen 2.3 x 4mm PB screws (1 spare)

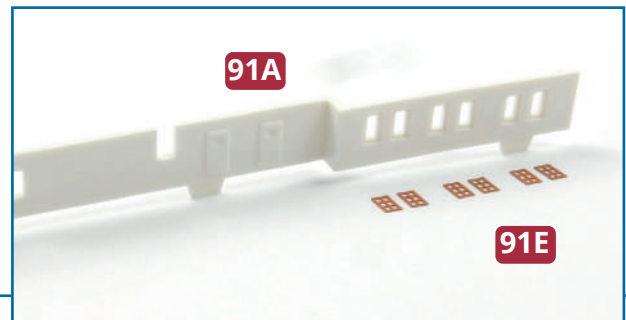
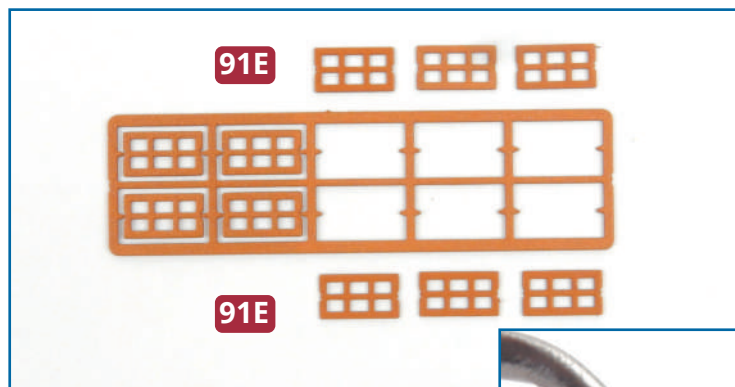

1 Remove six of the windows **91E** from the frame. Check the fit on the outside of the bulkhead **91A**, as shown: this part of the bulkhead is the port side of the second-class smoking room. Glue the windows in place.

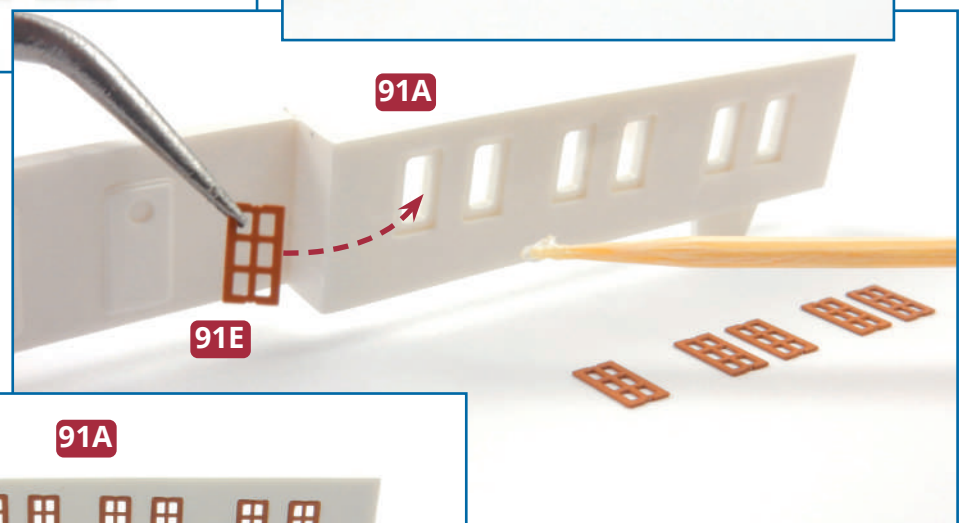

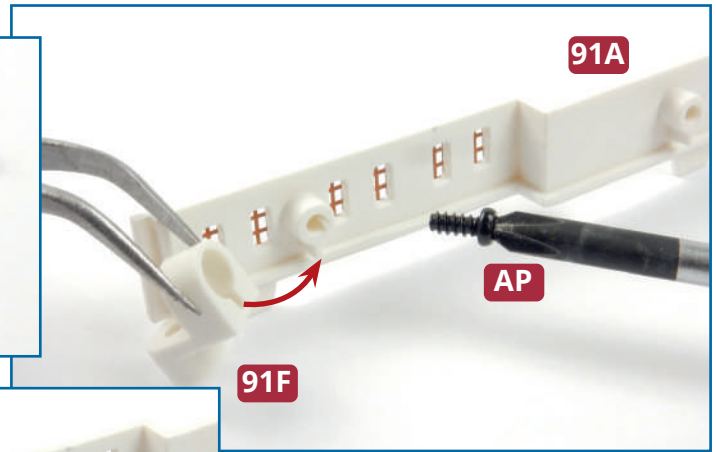
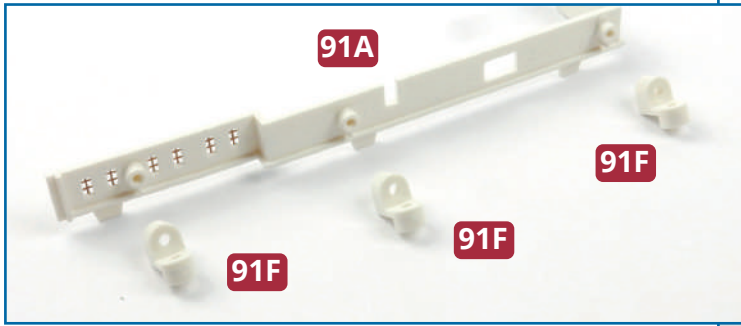

2 Take three connectors **91F** and check how they fit on the inside of part **91A**. Fix each connector in place with an **AP** screw.

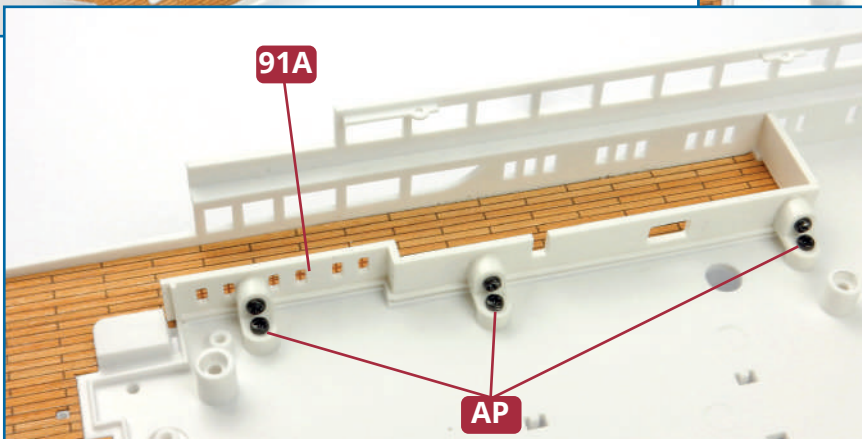
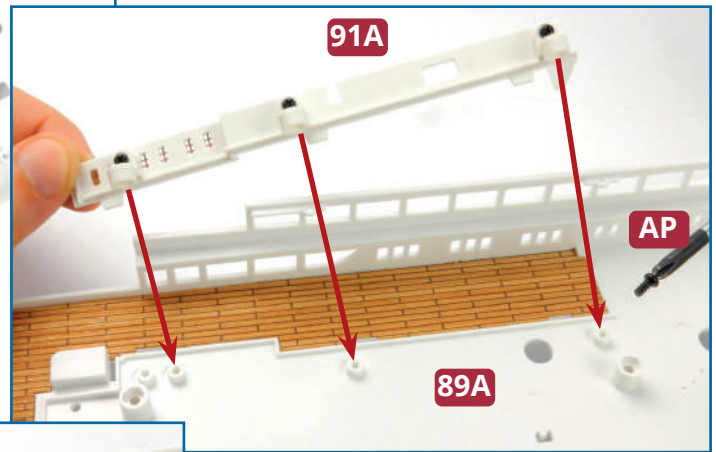
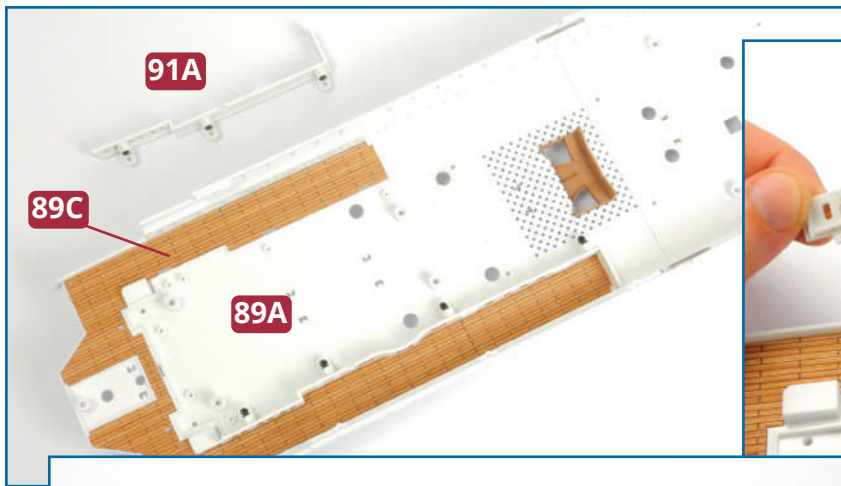
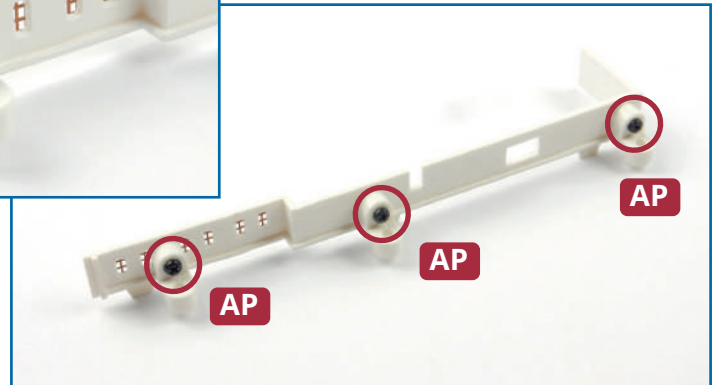
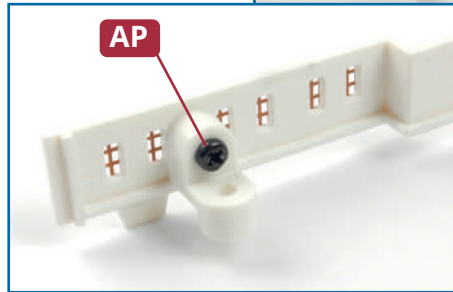

3 Check the fit of bulkhead **91A** on section **89A** of the bridge deck, alongside decking panel **89C**. Tabs on the lower edge of part **91A** fit into recesses between the decking and the raised edge on the deck, and the connectors align with the screw sockets on the deck. Fix in place with three **AP** screws.

★ STEP-BY-STEP INSTRUCTIONS ★

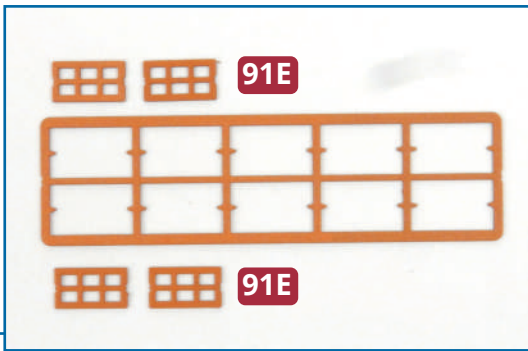

4 Remove the remaining four windows **91E** from the frame. Check the fit on the outside of part **91B** then apply a little glue to the recess around the window openings and carefully glue the windows in place.

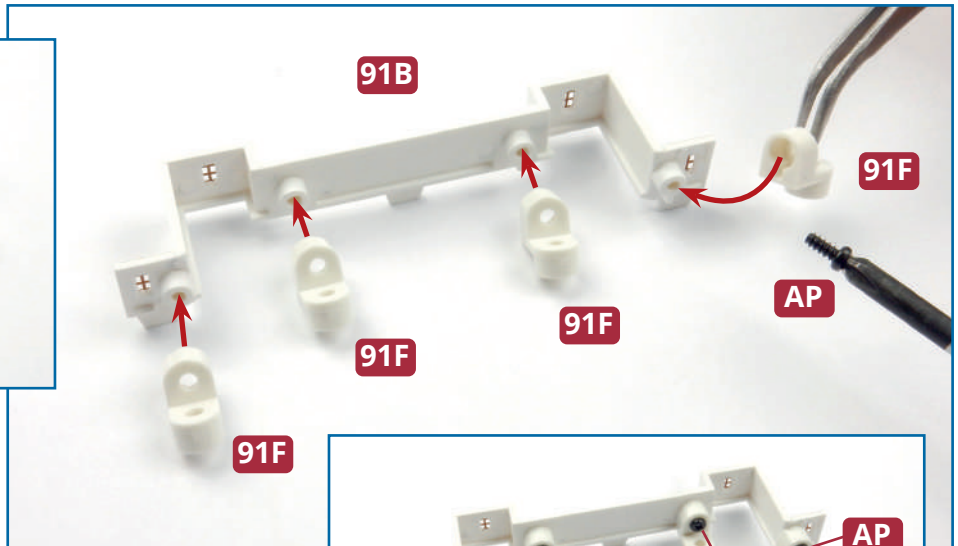
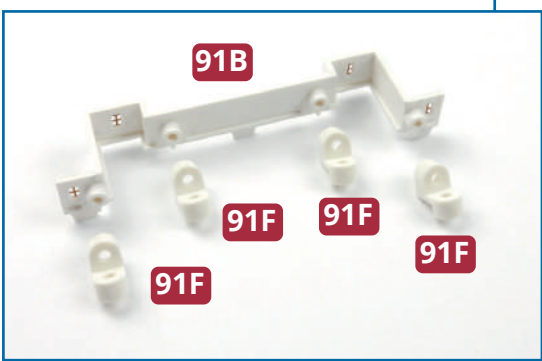
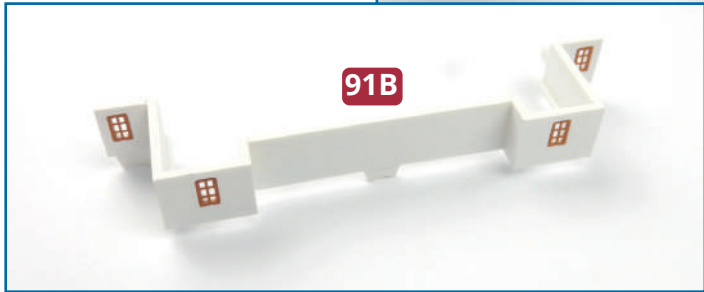
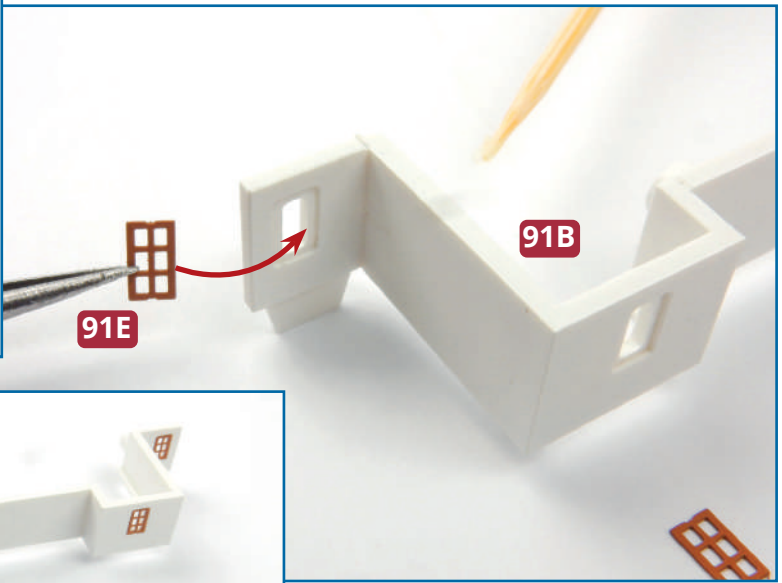
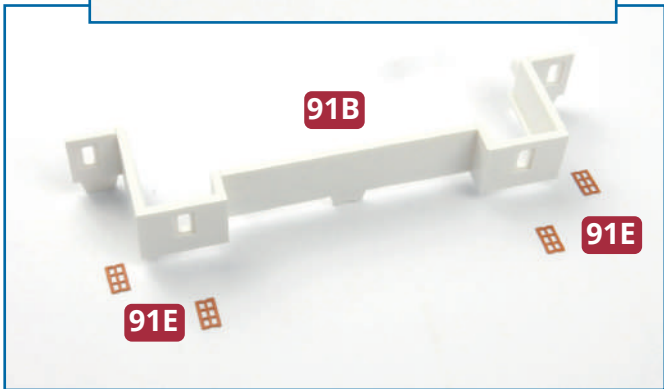

5 Take the remaining four connectors and check the fit on the inside of part **91B**. Fix each connector in place with an **AP** screw.

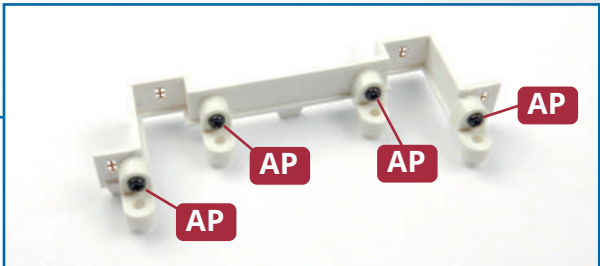

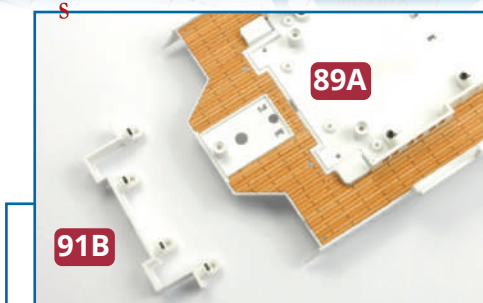

6 Check the fit of bulkhead **91B** on section **89A** of the bridge deck. Tabs on the lower edge of part **91B** fit into recesses between the decking and the raised edge on the deck, and the connectors align with screw sockets on the deck. Fix in place with three **AP** screws. This forms the aft bulkhead of the second-class smoking room.

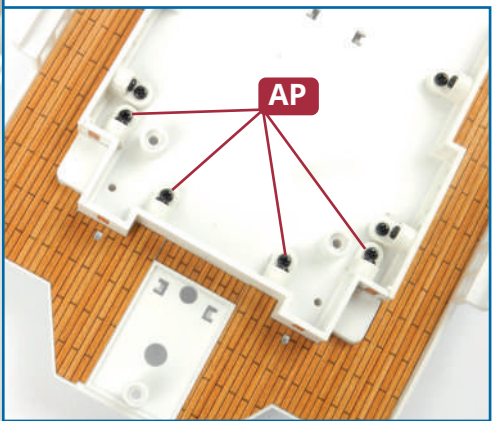
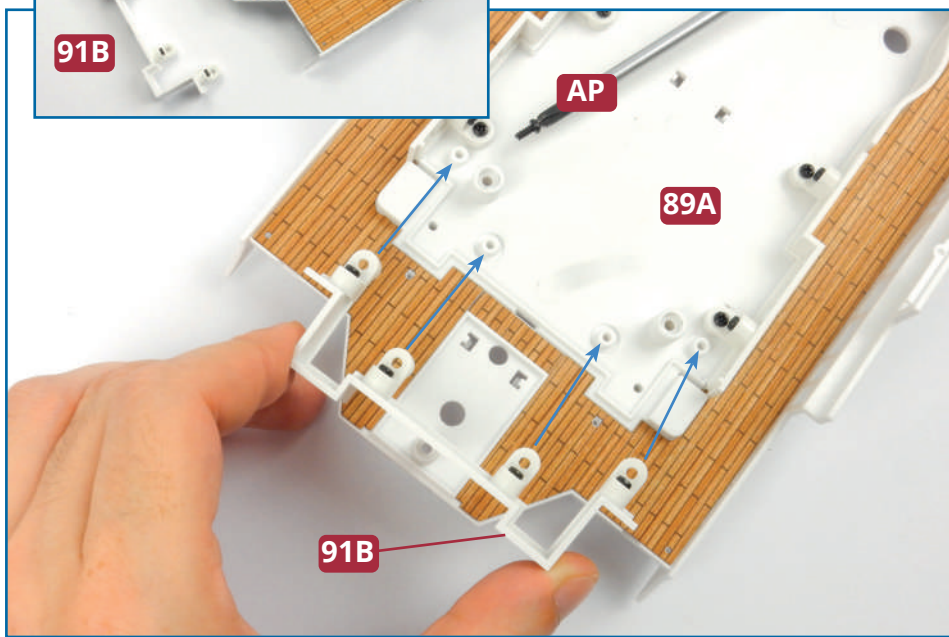

7 Identify the fixing points for the two ventilators **91G** aft of the smoking-room wall. Apply a little glue to the peg on each ventilator and glue in place.

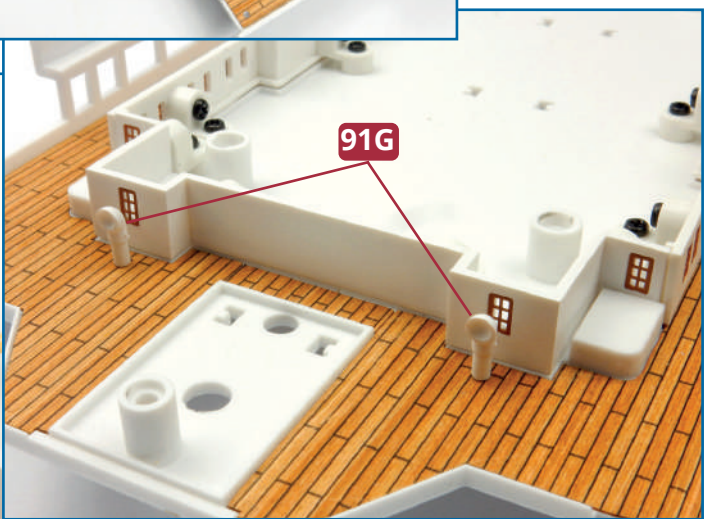
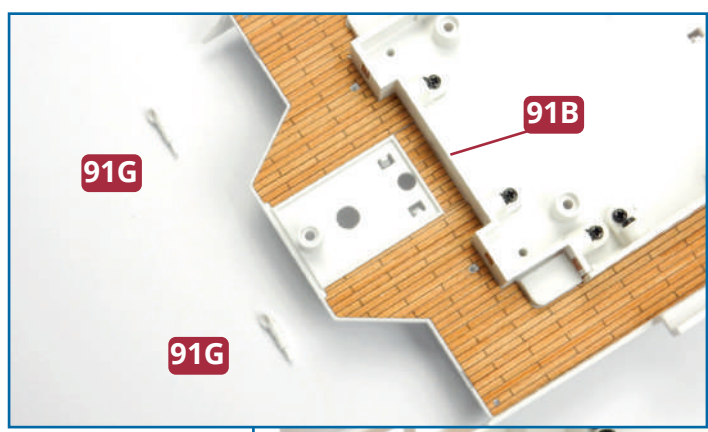

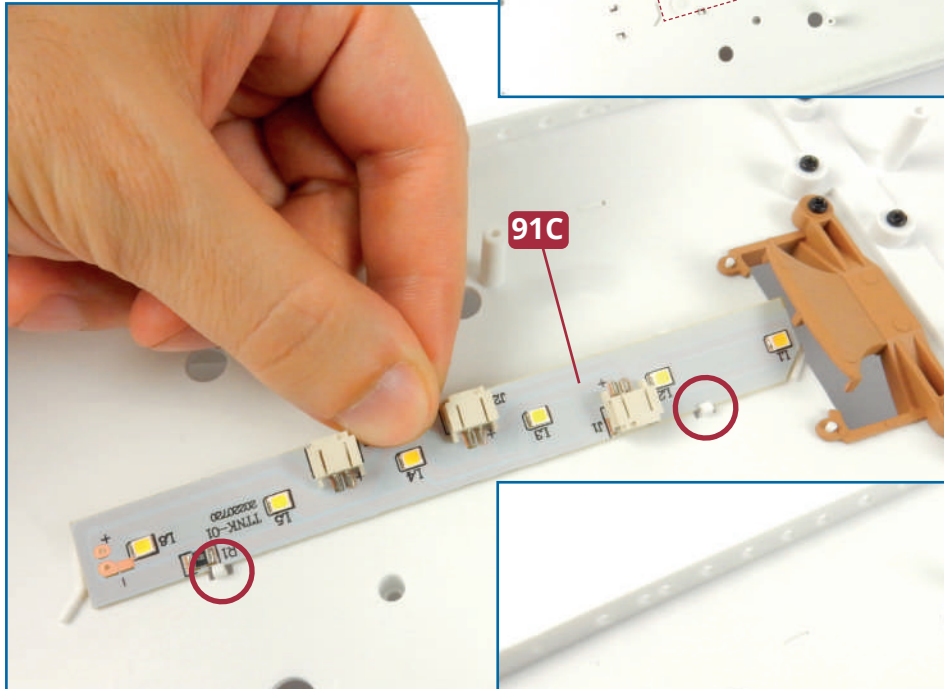
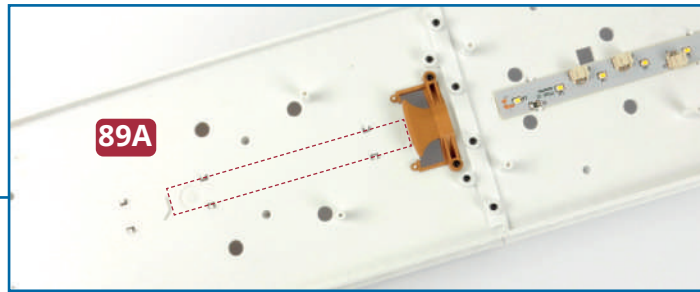

8 Carefully turn the bridge deck over and identify the position for the LED strip **91C** on the underside of deck section **89A**. Fit the strip in place by inserting one long edge beneath the tabs (circled in red) and then clipping the other side in place.

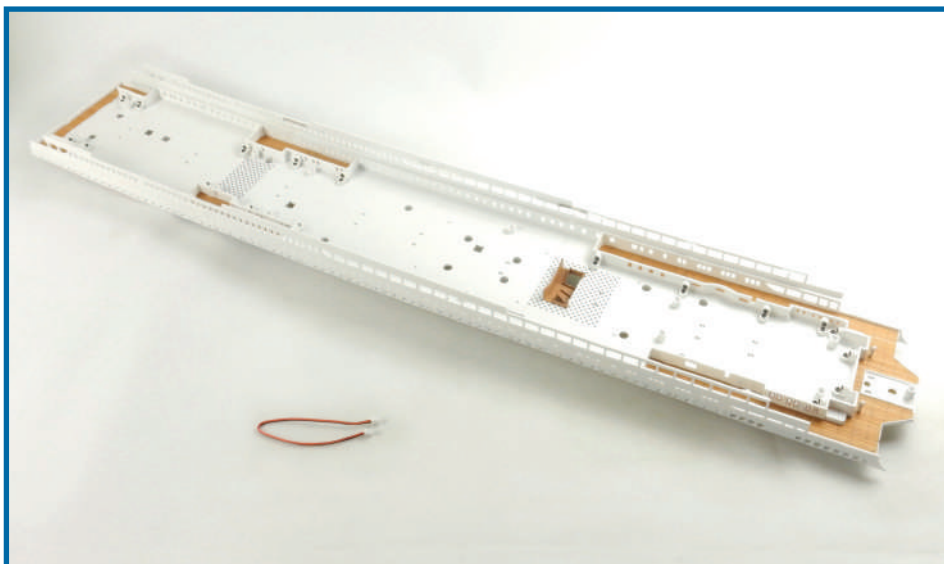
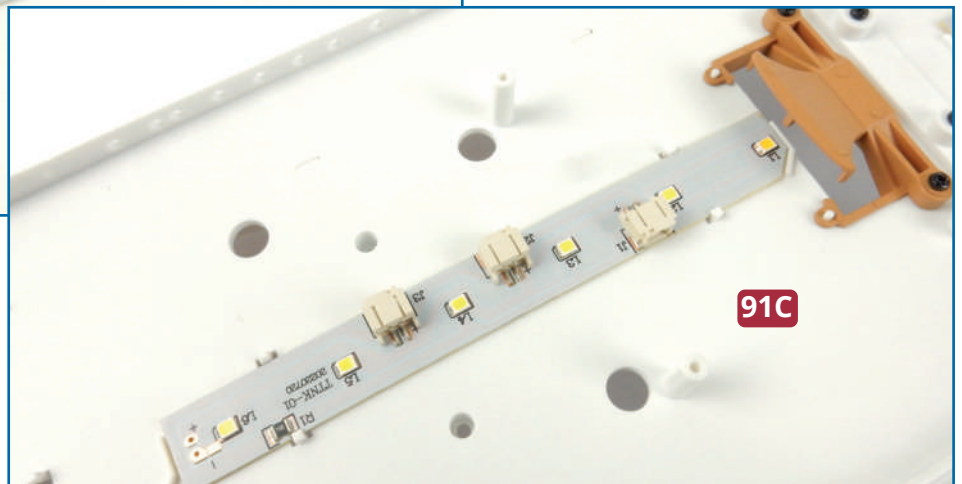

Completed work

Bulkheads have been fitted to the bridge deck, along with an LED strip. Store the cable **91D** carefully until it is needed.



BULKHEAD FOR THE SHELTER DECK

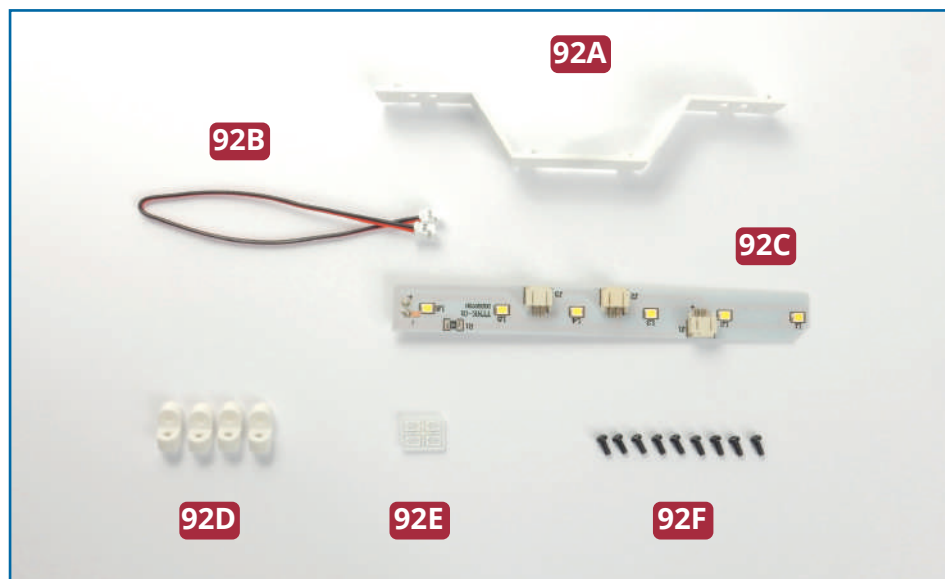

PARTS IN THIS ISSUE

- 92A** Bulkhead
- 92B** LED cable
- 92C** LED strip
- 92D** Connectors (x 4)
- 92E** Grilles (x 4)
- AP** Nine 2.3 x 4mm PB screws (1 spare)

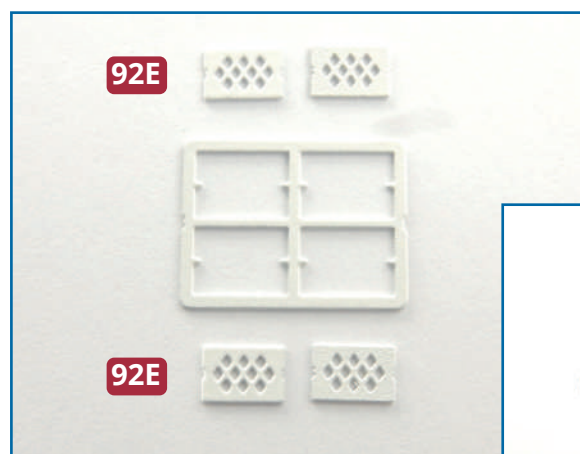

1 Remove the four grilles from the frame **92E**. Check the fit on the outside of part **92A** and glue them in place as shown, below.

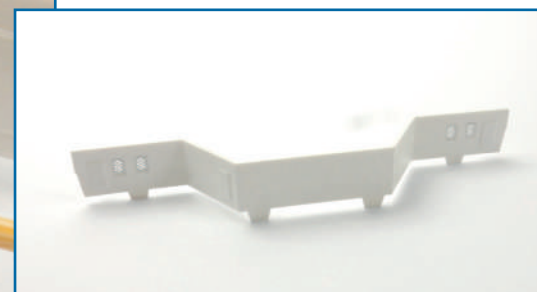
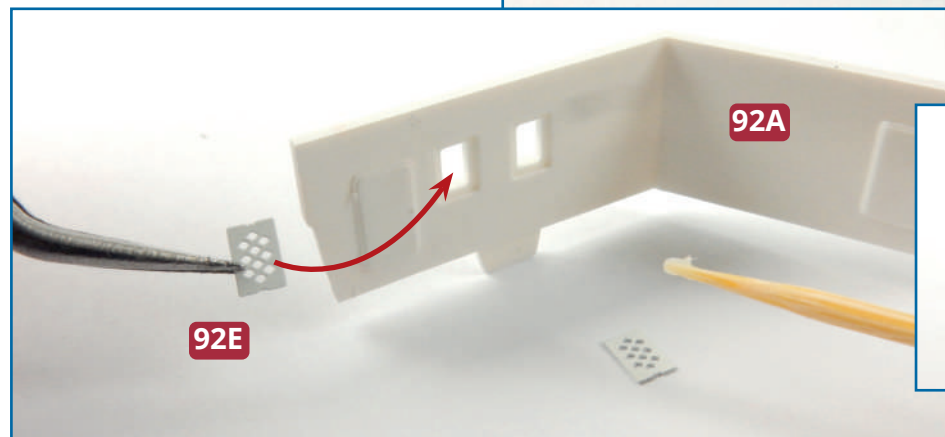
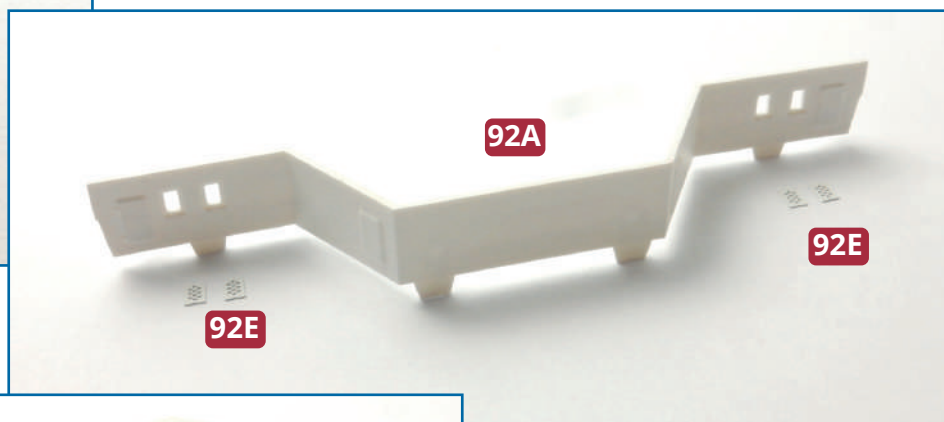

★ STEP-BY-STEP INSTRUCTIONS ★

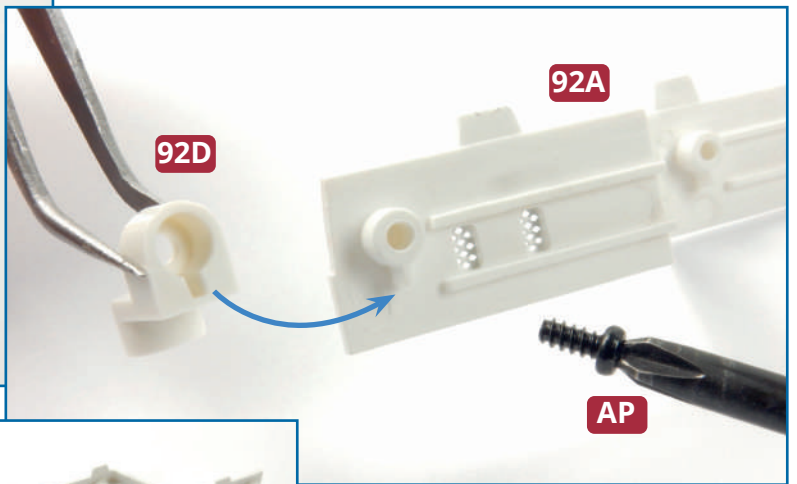
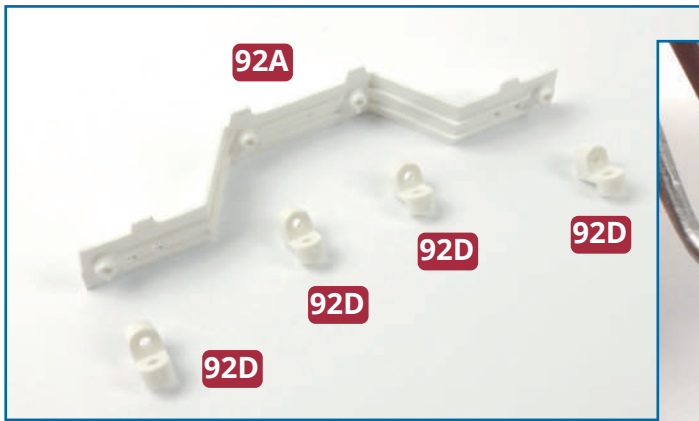

2 Check how the four connectors **92D** fit on the inside of part **92A**. Fix each of the connectors in place with an **AP** screw.

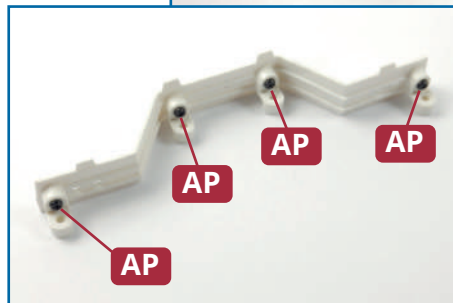

3 Fit the upper edge of part **92A** to the underside of section **89A** of the bridge deck, at the aft end. The connectors **92D** fit over the raised screw sockets. Fix each connector in place with an **AP** screw. The photo at the bottom right shows part **92A** in place, with the deck side up.

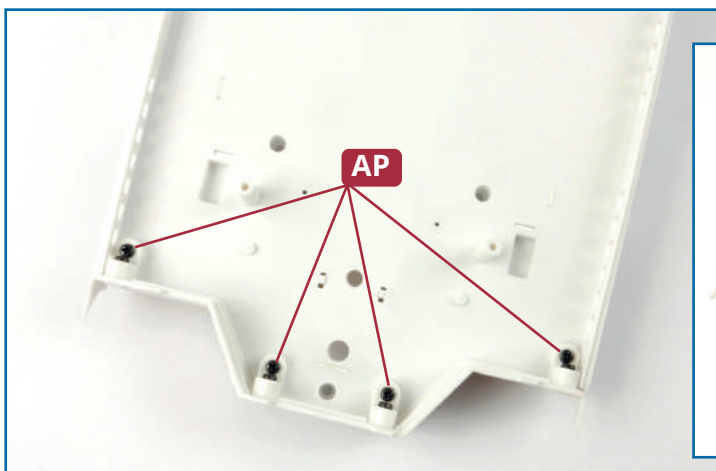
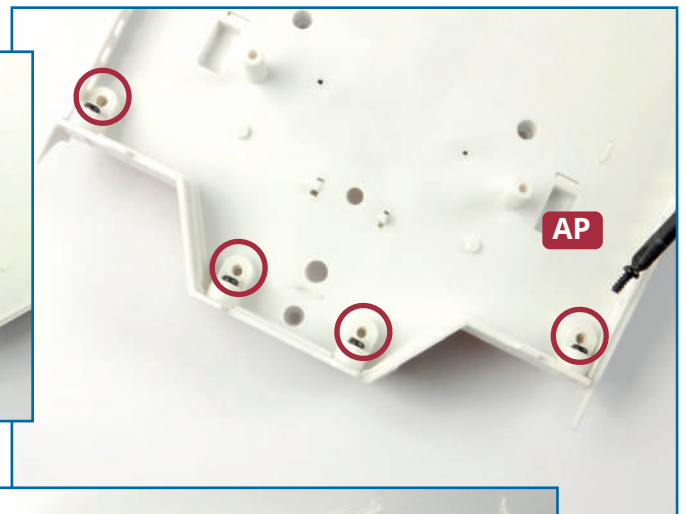
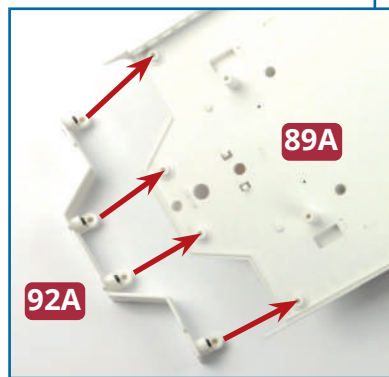



4 With the deck upside down, identify the position for the LED strip **92C** on the underside of deck section **89A**. Fit one side of the strip under the tabs, then clip the other side in place.

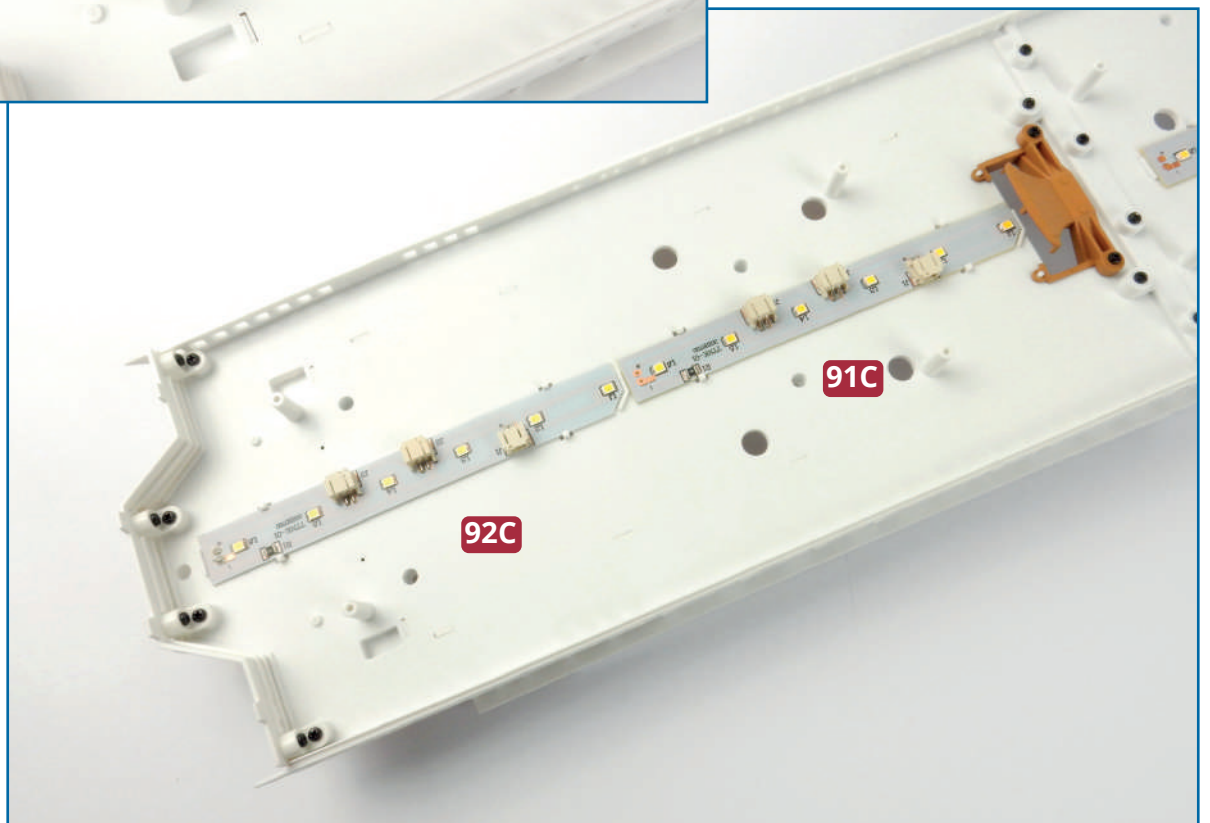
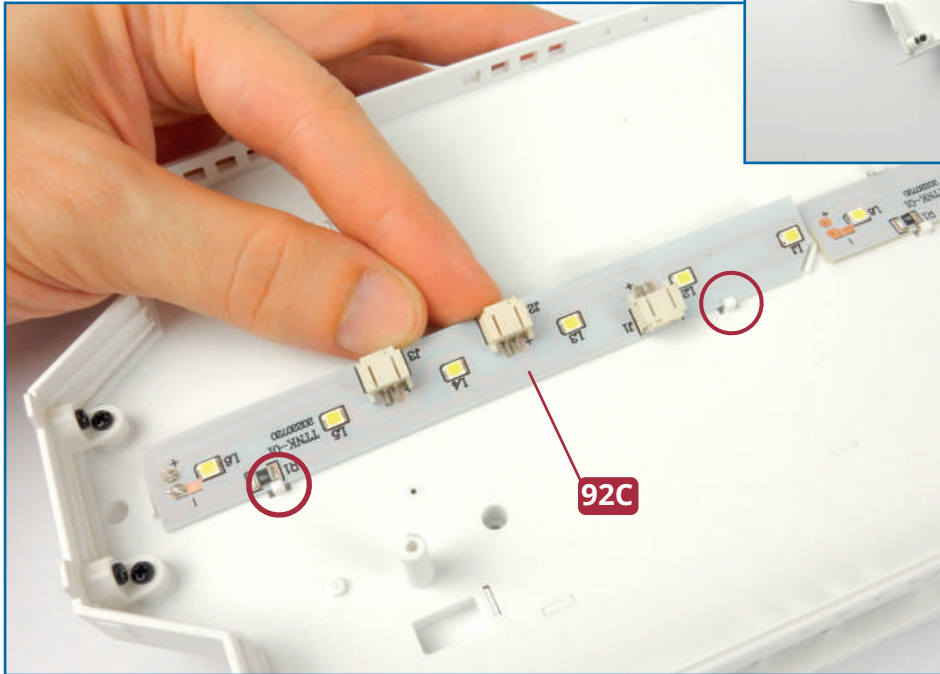
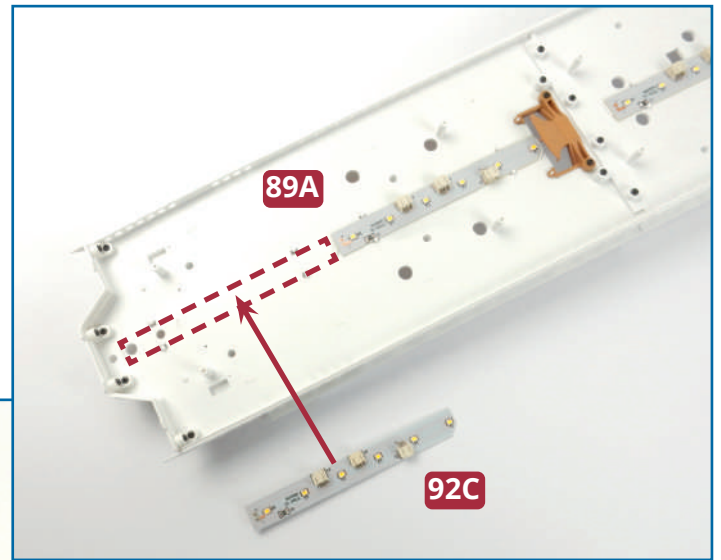

5 All five LED strips have been fixed to the underside of the bridge deck. Now you need to connect and test them. Take the LED cables **83C**, **84D**, **90C**, **91D** and **92B** from previous issues. They are identical, and all connections are labelled Z. The photo below shows how to connect the cables to the LED strips, fitting the sockets on the cables into the labelled ports on the LED strips. When the cables are in place, connect cable **92B** to the tester **3T** and check that the LEDs light up. Disconnect the tester, remove the batteries and store carefully.

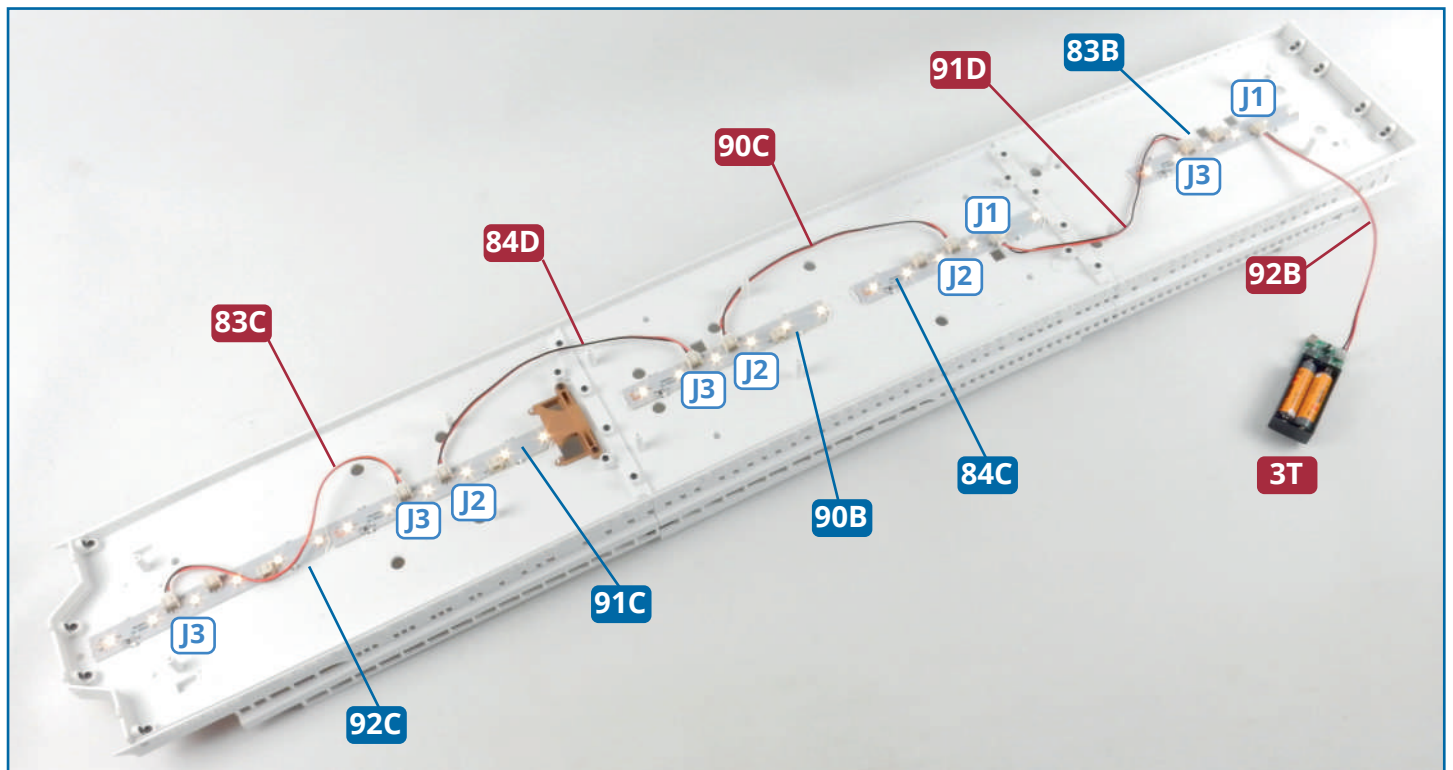
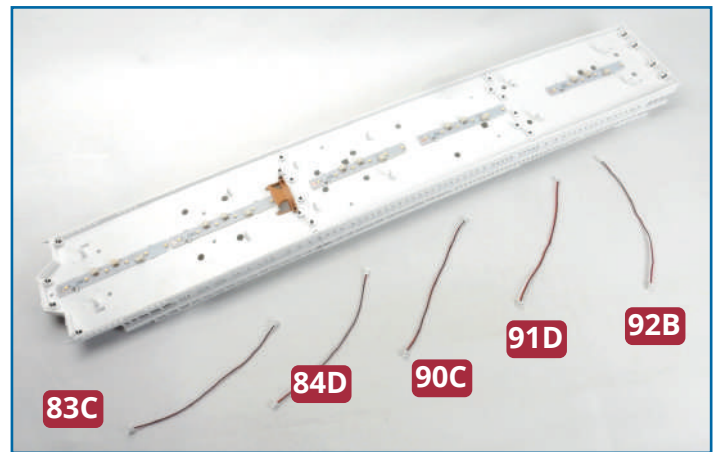

Completed work

A bulkhead for the shelter deck has been fitted to the aft end of the bridge deck. The LED strips on the underside of the bridge deck have been tested.

