

MITSUBISHI A6MZERO FIGHTER



Pack 01 | Build Instructions

Your 1:18 model of the Japanese Zero is reproduced in the most exquisite detail, with electronics allowing you to recreate aeronautical operations such as take-off and landing, turning, firing and night combat. Lights, machine-gun and propeller sounds bring your legendary fighter plane to life.

In your first model pack, you will assemble:

STAGE 01: THE PROPELLER

STAGE 02: ENGINE, LOWER ENGINE COWLING & CYLINDERS

STAGE 03: ENGINE, UPPER ENGINE COWLING & CYLINDERS

STAGE 04: ENGINE CYLINDERS

STAGE 05: ENGINE CYLINDERS & OIL PIPES

Advice from the experts

Spare screws are included with each part. Occasionally, you may be instructed to keep spare or unused screws for a later stage.

Keep these spares in a safe place and label them correctly.

Please make sure you don't mix up the screws. They look quite similar, but the threads do vary slightly. Using the wrong screws may damage the parts.

When securing parts together using multiple screws, fit each screw loosely to ensure all the parts are correctly aligned before gently tightening them firmly, but not overtight, in the order in which you placed them.

The screwdriver can be magnetised by stroking it with a magnet (fridge magnet, etc.) enabling it to hold the screws and make assembly easier.

If a screw is tight going into a metal part, do not force it as you may shear the head off. Remove it and put a tiny smear of Vaseline, soap or light oil on the thread. That will lubricate it and make it easier to drive home.

During the course of this build, you will receive many pieces that you will assemble immediately – following the instructions in the corresponding stage – and other pieces that you should store safely to one side, for use in future assembly stages.

Not suitable for children under the age of 14. This product is not a toy and is not designed for use in play. Keep the parts out of the reach of small children. Some parts may have sharp edges. Please handle them with care.

Stage 01: Assembling the Propeller

In the first stage of building your Zero fighter plane, you will assemble the propeller.

Stage 01 Assembly

The Propeller



STAGE 01 PARTS

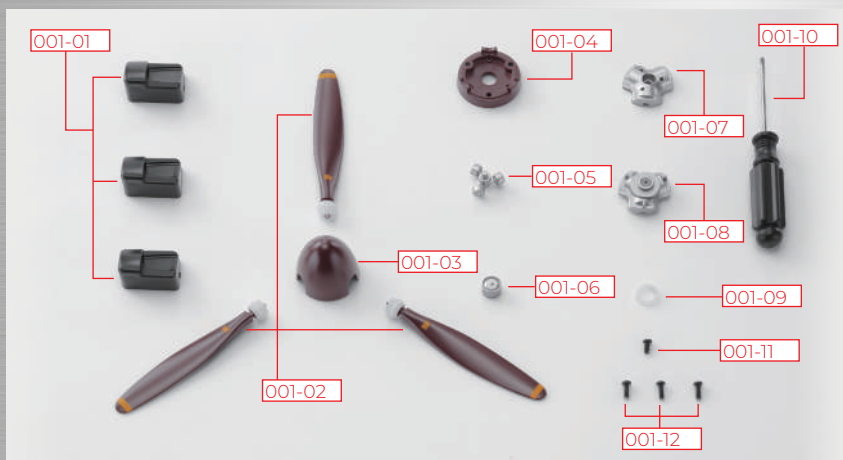

You will also need: superglue, tweezers.

PARTS LIST

	PART	No.	MATERIAL
<input type="checkbox"/>	001-01	3	ABS resin
<input type="checkbox"/>	001-02	3	Die-cast
<input type="checkbox"/>	001-03	1	Die-cast
<input type="checkbox"/>	001-04	1	Die-cast
<input type="checkbox"/>	001-05	1	ABS resin
<input type="checkbox"/>	001-06	1	ABS resin
<input type="checkbox"/>	001-07	1	ABS resin
<input type="checkbox"/>	001-08	1	ABS resin
<input type="checkbox"/>	001-09	1	POM
<input type="checkbox"/>	001-10	1	Steel / ABS resin
<input type="checkbox"/>	001-11	1	Steel
<input type="checkbox"/>	001-12	3	Steel

STEP 1 Attaching the gear

← : Glue
 - - - : Don't glue

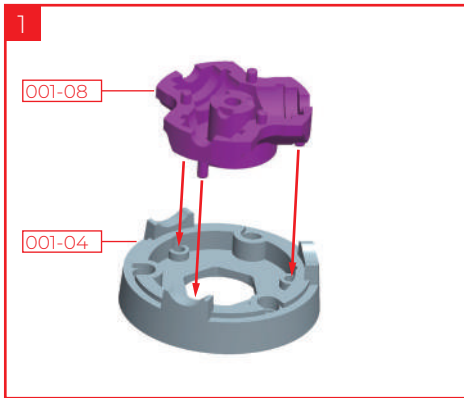

Apply a small drop of superglue to the three pins on 001-08 and insert them into the small holes in 001-04.

TIP
 Insert the convex part in the centre of 001-08 firmly into the hole in the centre of 001-04. Study the picture below carefully.

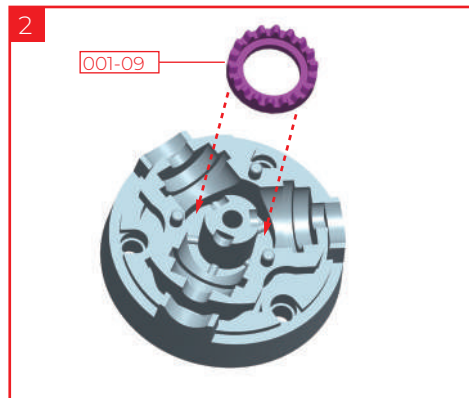

Fit 001-09 into the parts already assembled in picture 1. Insert 001-09 ensuring that the teeth are facing up. Do not glue.

STEP 2 Assembling the blades

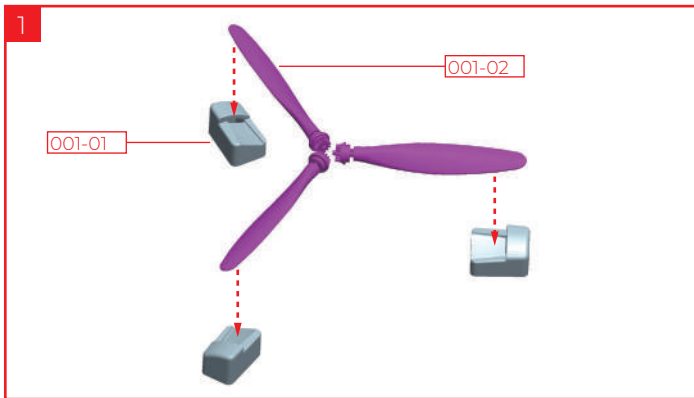

Insert 001-02 into 001-01. 001-01 is a jig to prevent the angles of the three blades from shifting. Do not glue it as it will no longer be needed after assembly.

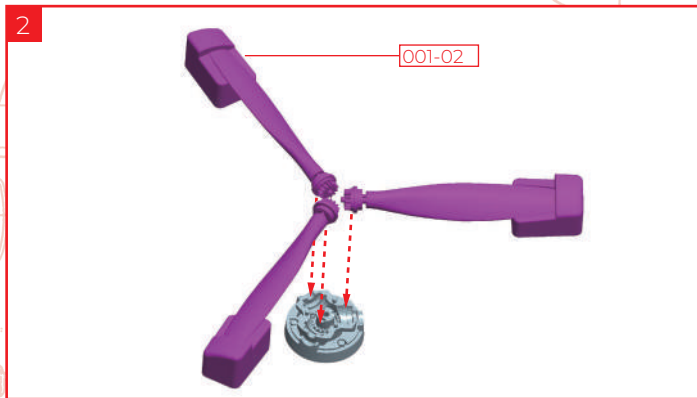

Fit 001-02 into the parts assembled in picture 1. Do not glue.

STEP 3 Fixing the blades

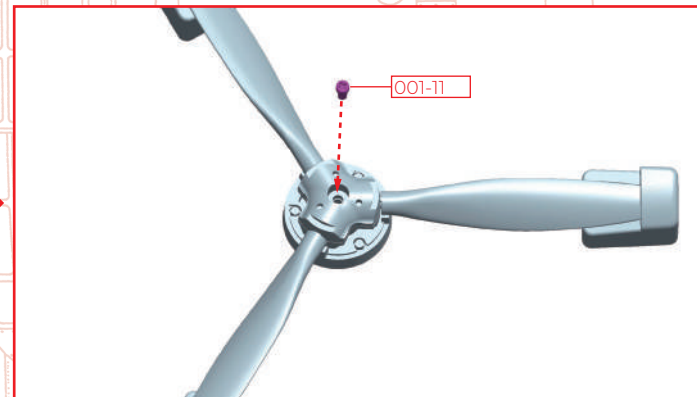
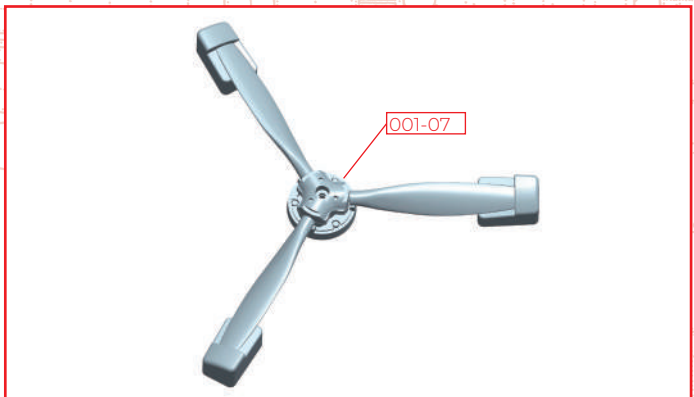

Place 001-07 on the parts assembled in STEP 2 and fix it with a 001-11 screw.

STEP 4

Installing central parts to the blades

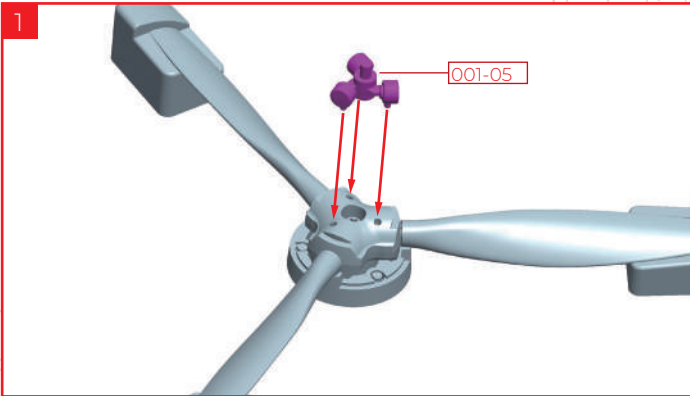

Apply a small amount of superglue to the three pins of 001-05 and insert them into the holes of 001-07.

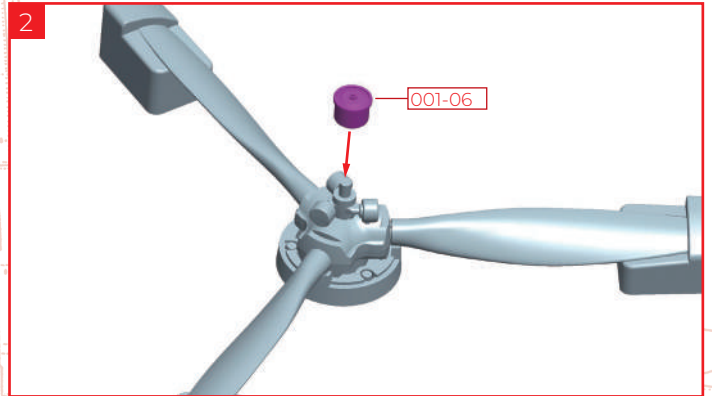

Apply a small amount of superglue to the center pin of 001-05 before pushing 001-06 in place on top.

STEP 5

Installing the spinner

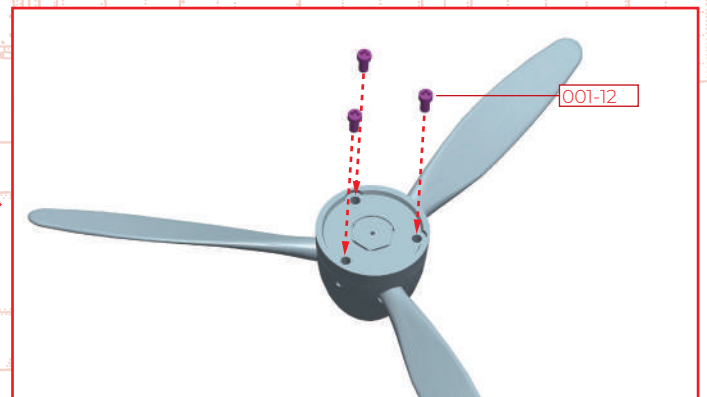
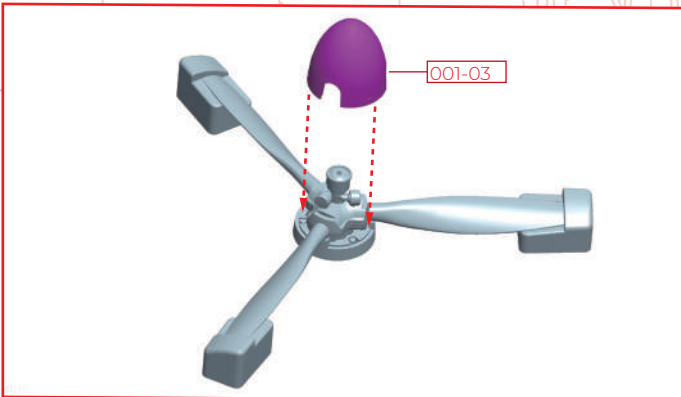

Cover the parts assembled in STEP 4 with the spinner 001-03, carefully turn it over and fix it with 3 x 001-12 screws. Do not glue.

TIP

The angle of the blades can be operated by hand. Check that the three blades are moving together.

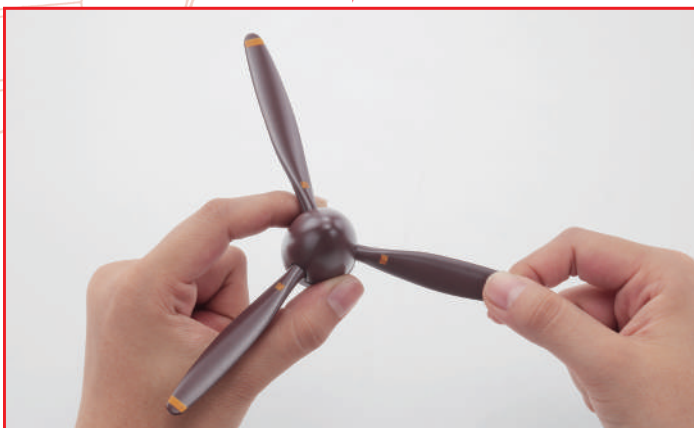

STAGE COMPLETE



Stage 02: Building the Engine (Part 1)

In this stage you will start building the Sakae 21 14-cylinder radial engine of your Zero Fighter Type 52.

Stage 02 Assembly

The Engine



STAGE 02 PARTS

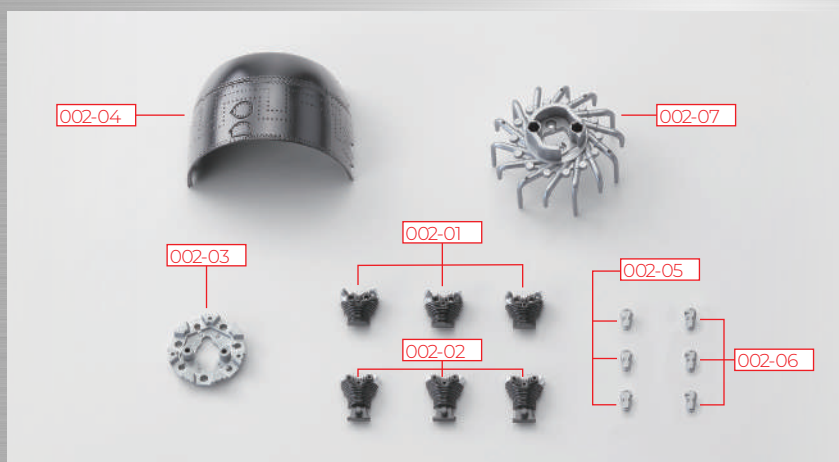

You will also need: superglue, tweezers.

* 002-04 and 002-07 will not be used in this stage. Keep them in a safe place

PARTS LIST

	PART	No.	MATERIAL
<input type="checkbox"/>	002-01	3	Die-cast
<input type="checkbox"/>	002-02	3	Die-cast
<input type="checkbox"/>	002-03	1	Die-cast
<input type="checkbox"/>	002-04	1	Die-cast
<input type="checkbox"/>	002-05	3	ABS resin
<input type="checkbox"/>	002-06	3	ABS resin
<input type="checkbox"/>	002-07	1	ABS resin

STEP 1

Assembling the cylinders

← : Glue
- - - : Don't Glue

1

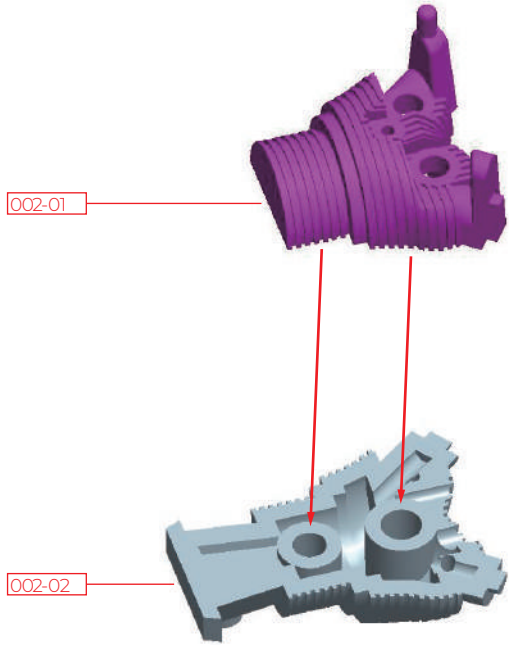

Apply a small amount of superglue to the two pins on part 002-01 and insert them into the holes on part 002-02 to join them. Make 3 of these.

NOTE

Parts 002-01 & 002-02 are marked with the letter D.

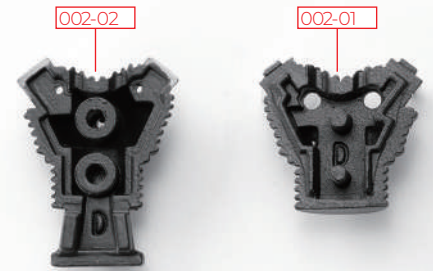

2

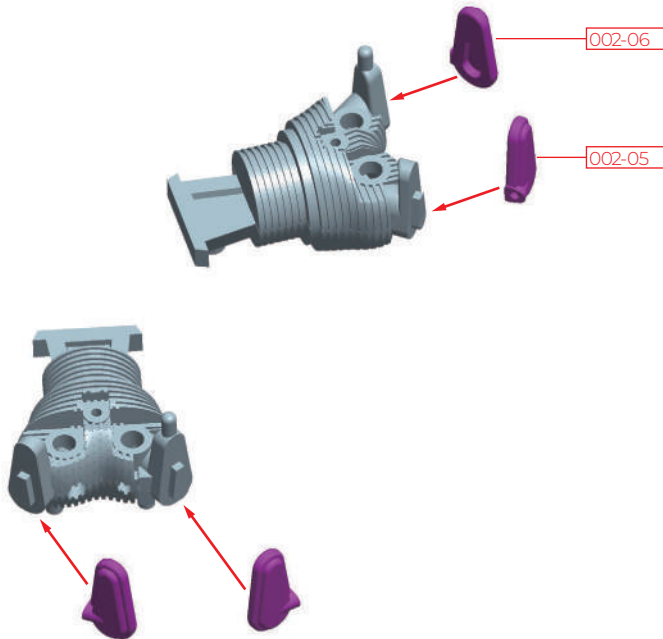

Glue rocker boxes 002-05 & 002-06 to the cylinder assembly in 1. Make three of these.

NOTE

Parts 002-05 & 002-06 are similar, so be careful not to make a mistake. Make sure that the holes on the sides face outward.

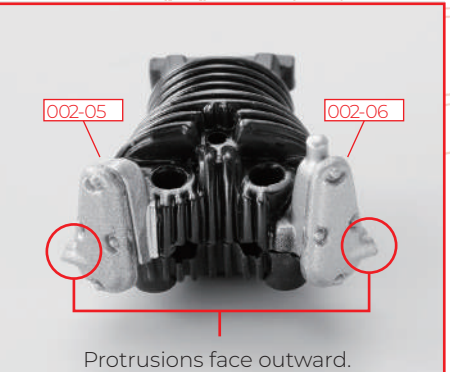

Protrusions face outward.

STEP 2

Fitting the cylinders to the crankcase

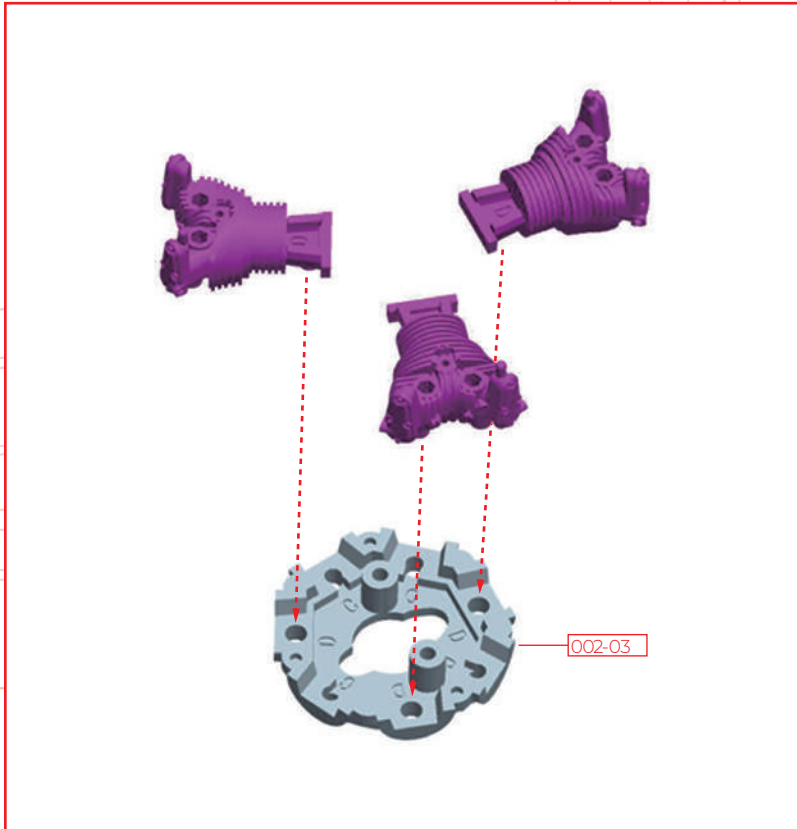

Fit the three assemblies made in STEP 1 to the crankcase – part 002-03 – by aligning the projections with the holes marked D and pushing the pieces together. Do not glue.

NOTE

This shows how your assembly should look.

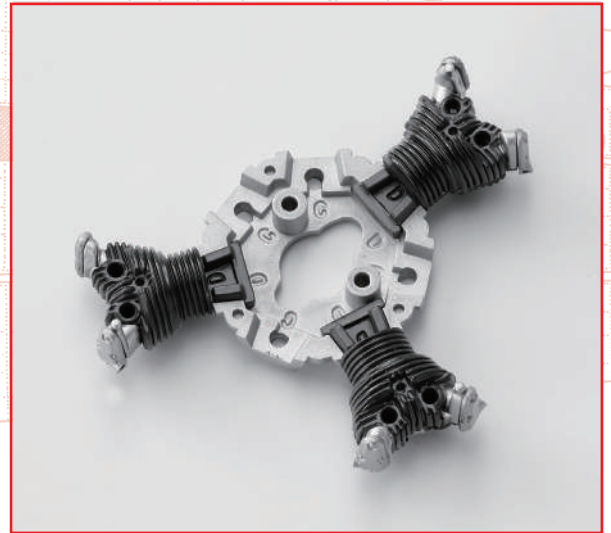

NOTE

Study part 002-03 carefully. The holes are marked C and D. Ensure the assemblies are located in the correct holes - position D.



STAGE COMPLETE



Stage 03: Building the Engine (Part 2)

Stage 03 Assembly
 The Engine / Engine Cowling

You will continue to build the engine cylinders and add the upper cowling.



STAGE 03 PARTS

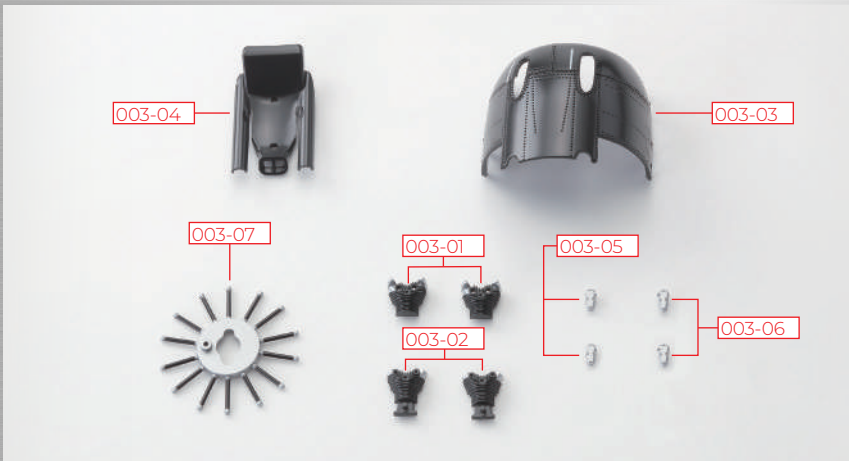

You will also need: superglue, tweezers, screwdriver.
 * Part 003-02 will not be used in this stage. Keep it in a safe place..

PARTS LIST

	PART	No.	MATERIAL
<input type="checkbox"/>	003-01	2	Die-cast
<input type="checkbox"/>	003-02	2	Die-cast
<input type="checkbox"/>	003-03	1	Die-cast
<input type="checkbox"/>	003-04	1	ABS resin
<input type="checkbox"/>	003-05	2	ABS resin
<input type="checkbox"/>	003-06	2	ABS resin
<input type="checkbox"/>	003-07	1	ABS resin

STEP 1

Assembling the cylinders

← : Glue
 - - - : Don't Glue

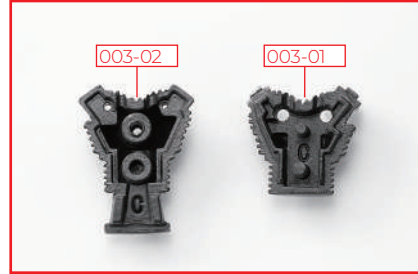
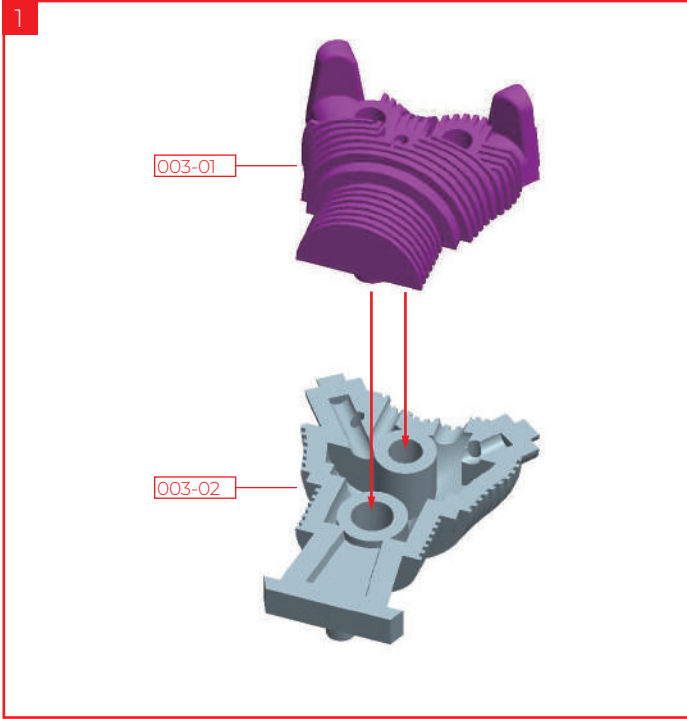

NOTE
 Parts 003-01 and 003-02 are marked with a C.

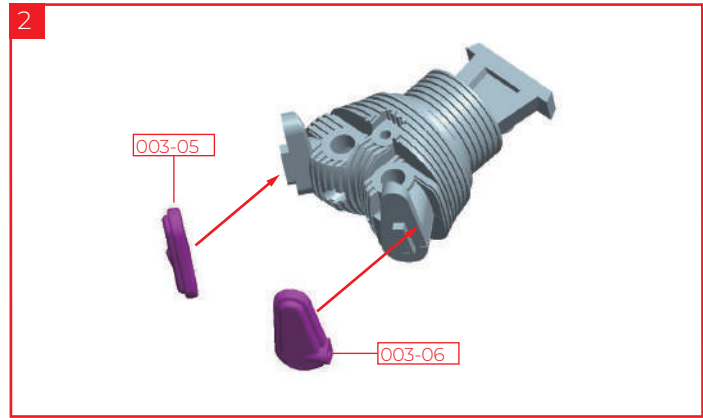

Apply a small amount of superglue to the two pins on 003-01 and insert them into the holes of 003-02 to join them. Make two of these.

Glue 003-05 & 003-06 to the cylinder assembled in 1. Make two of these. Please note that 003-05 & 003-06 are different shapes.

STEP 2

Fitting the cylinders to the crankcase

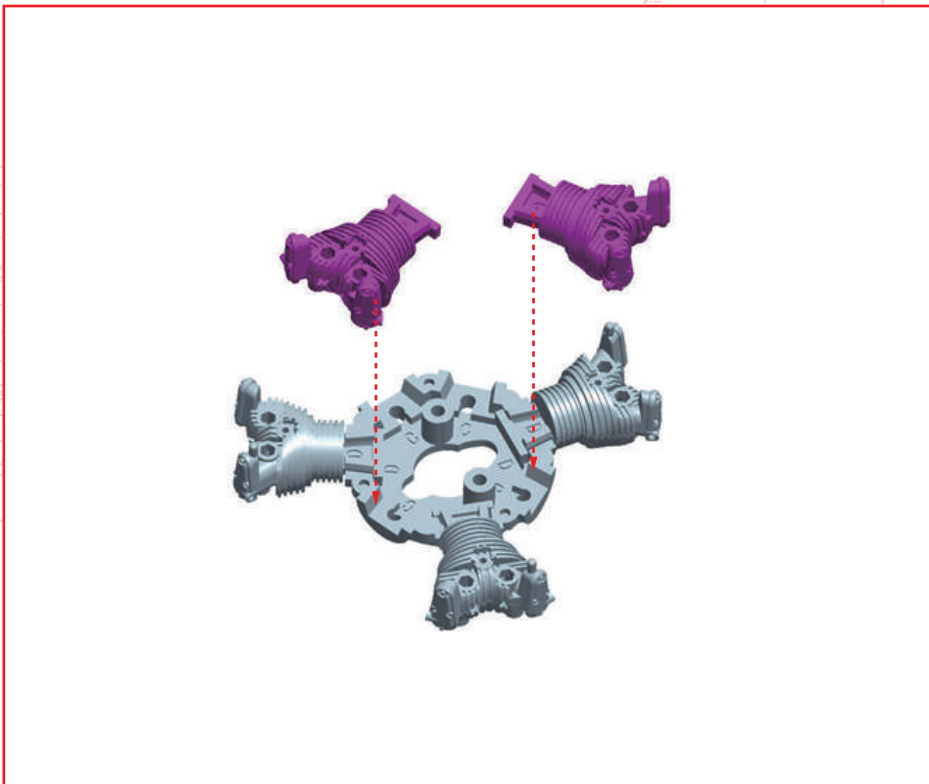

Insert the protrusions on the cylinder assemblies from Step 1 into the holes marked C on the crankcase assembled from Stage 02. Do not glue.



STEP 3

Assembling the engine cowl

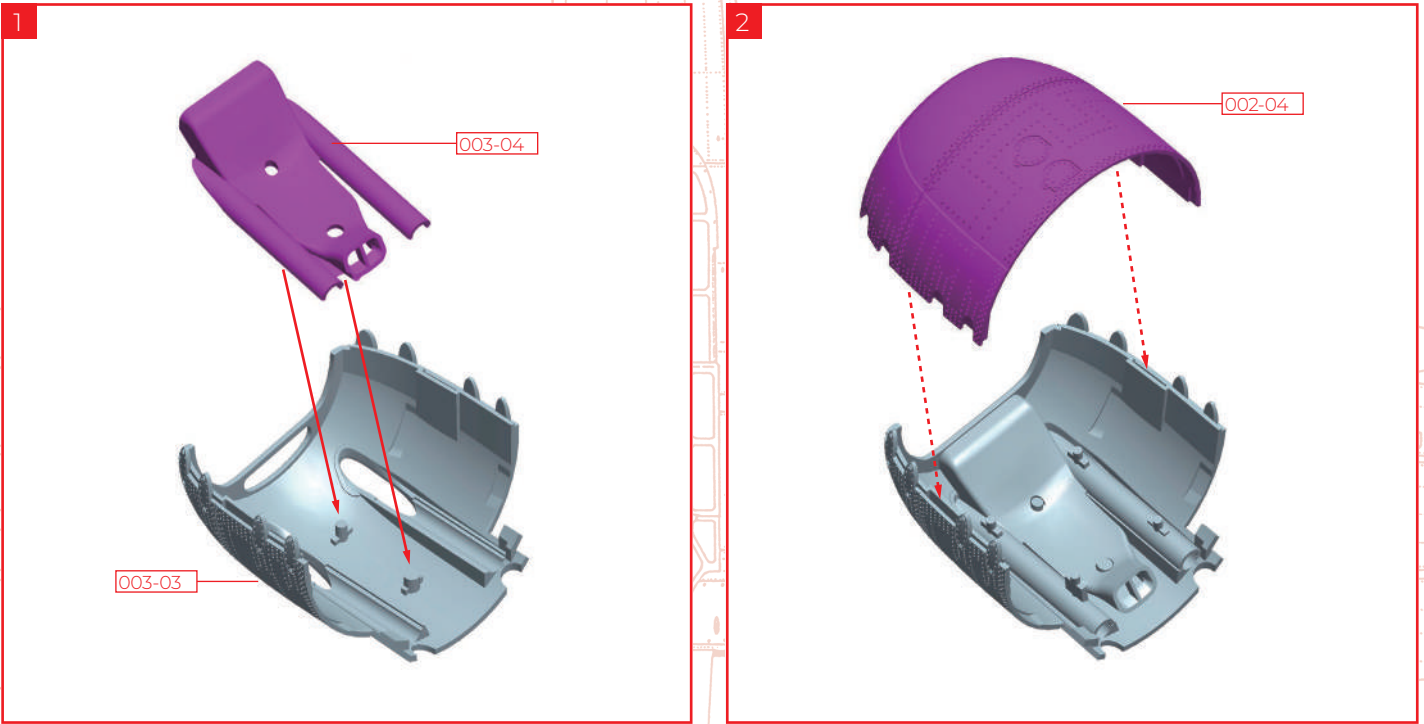

Apply a small amount of superglue to the two pins on 003-03 and attach to 003-04.

Fit the upper part of the engine cowling assembled in 1 to part 002-04. Do not glue as this is secured with a magnet.

STAGE COMPLETE



Stage 04: Building the Engine (Part 3)

In this stage you will continue to build the engine.

Stage 04 Assembly

The Engine



STAGE 04 PARTS

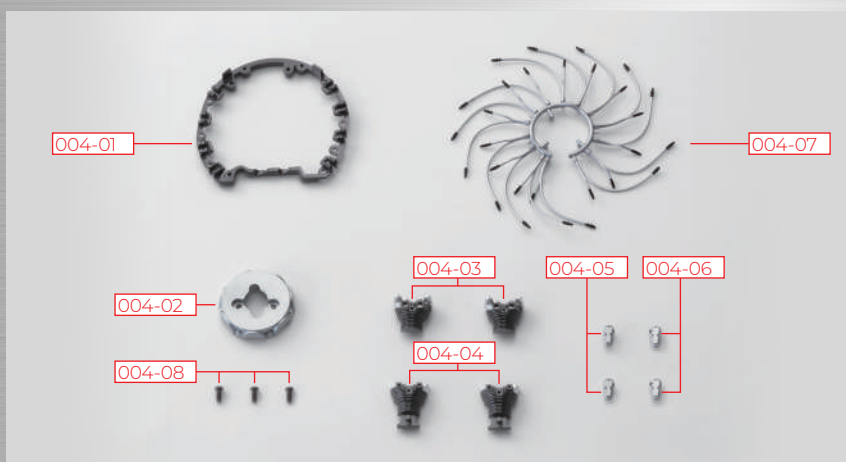

You will also need: superglue, tweezers, screwdriver
Parts 004-01 and 004-07 will not be used in this stage. Keep them in a safe place.

PARTS LIST

	PART	No.	MATERIAL
<input type="checkbox"/>	004-01	1	Die-cast
<input type="checkbox"/>	004-02	1	Die-cast
<input type="checkbox"/>	004-03	2	Die-cast
<input type="checkbox"/>	004-04	2	Die-cast
<input type="checkbox"/>	004-05	2	ABS resin
<input type="checkbox"/>	004-06	2	ABS resin
<input type="checkbox"/>	004-07	1	PVC / ABS resin
<input type="checkbox"/>	004-08	3	Steel

STEP 1

Assembling the cylinders

← : Glue
 - - - : Don't Glue

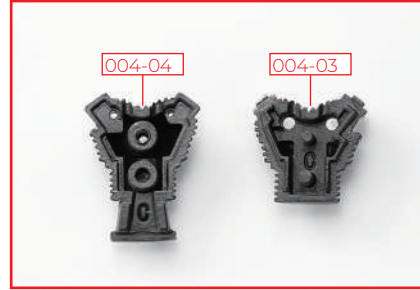
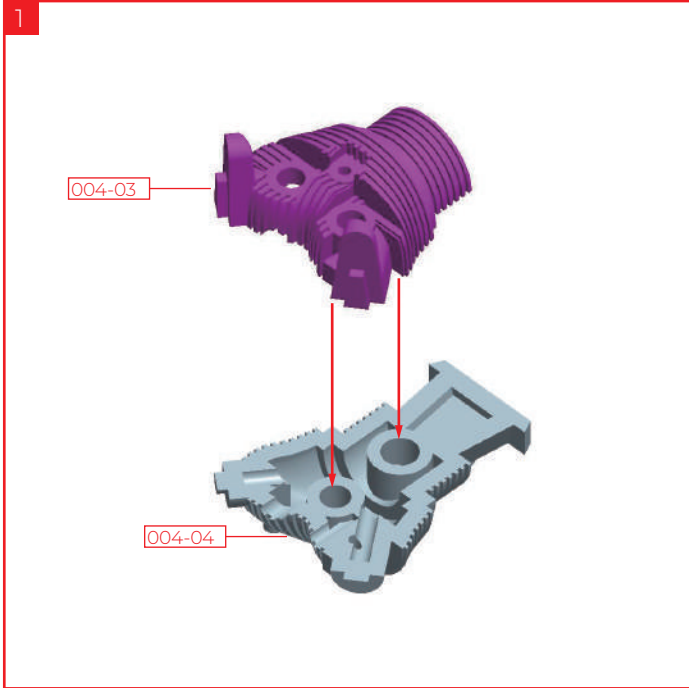

NOTE
 Parts 004-03 & 004-04 are marked with a C.

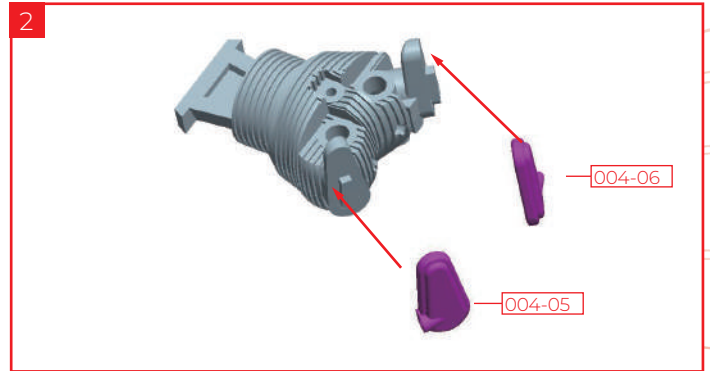

Apply a small amount of superglue to the two pins on part 004-03 and insert them into the holes on part 004-04 to join them. Make two of these.

Glue rocker box parts 004-05 & 004-06 to the cylinders assembled in 1. Please note that 004-05 & 004-06 are different shapes. Ensure the holes face outward. Make two of these.

STEP 2

Completing the crankcase

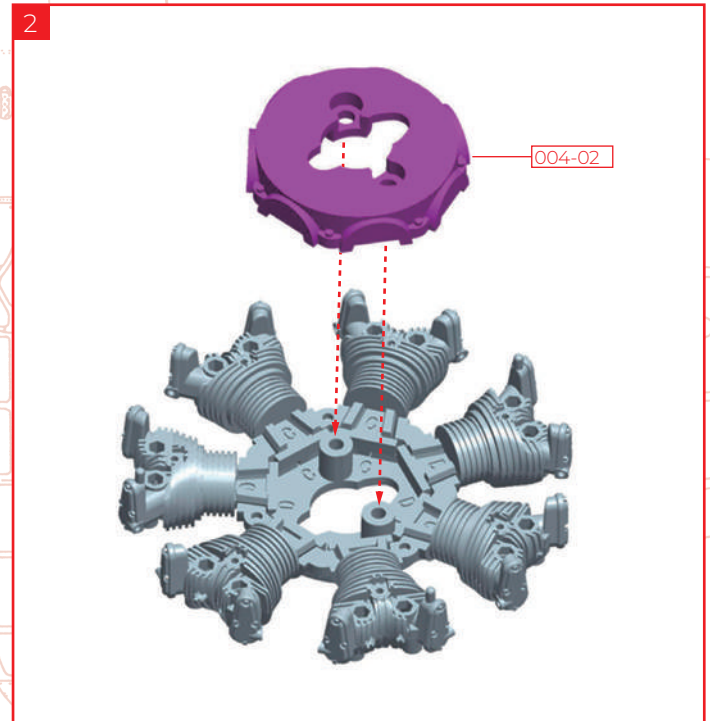
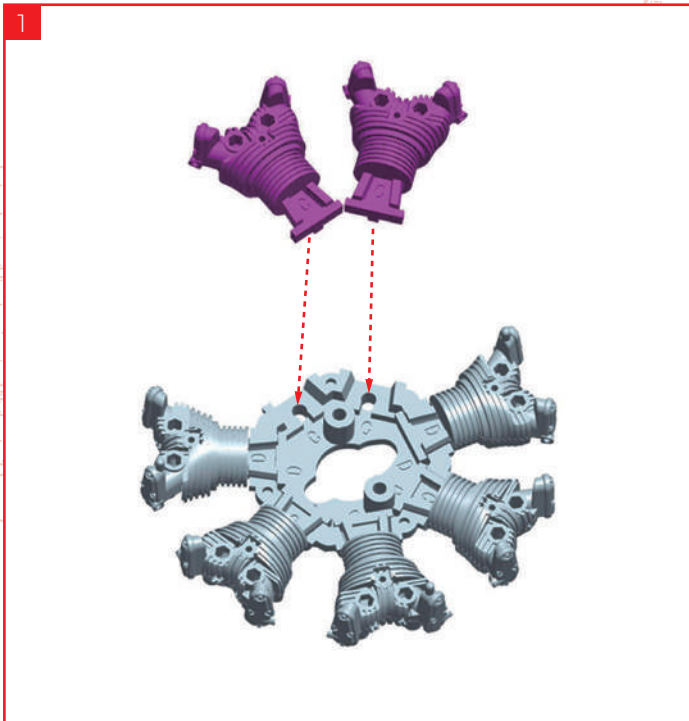

Insert the protrusions on the cylinders from STEP 1 into the holes marked C on the crankcase assembled in Stage 03. Do not glue.

Cover the parts assembled in 1 with part 004-02.

3

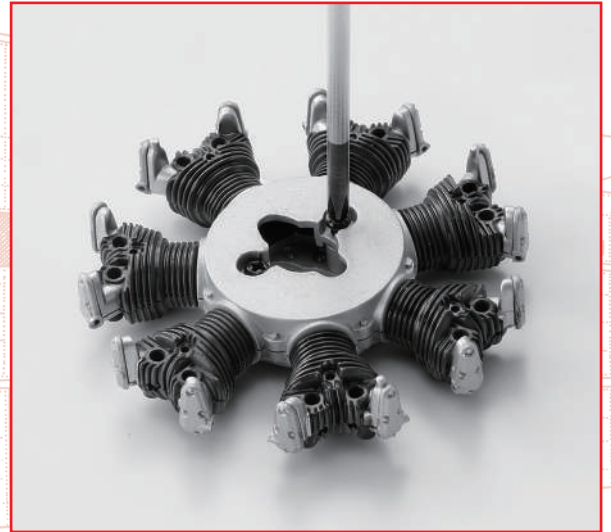
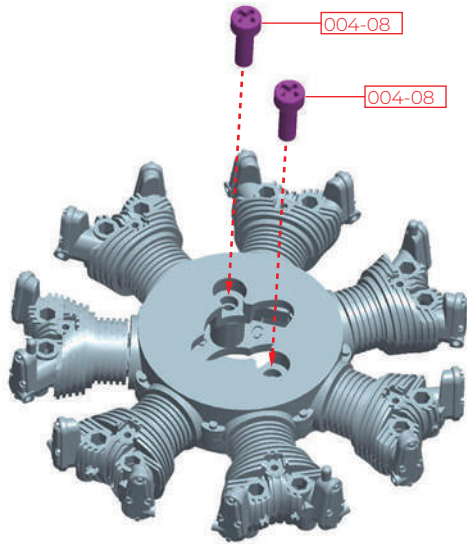

Fix the cover in place with 2 x 004-08 screws. This is a temporary fastening, so don't overtighten it.

STAGE COMPLETE



Stage 05: Building the Engine (Part 4)

You will continue to build the engine.

Stage 05 Assembly

The Engine



STAGE 05 PARTS

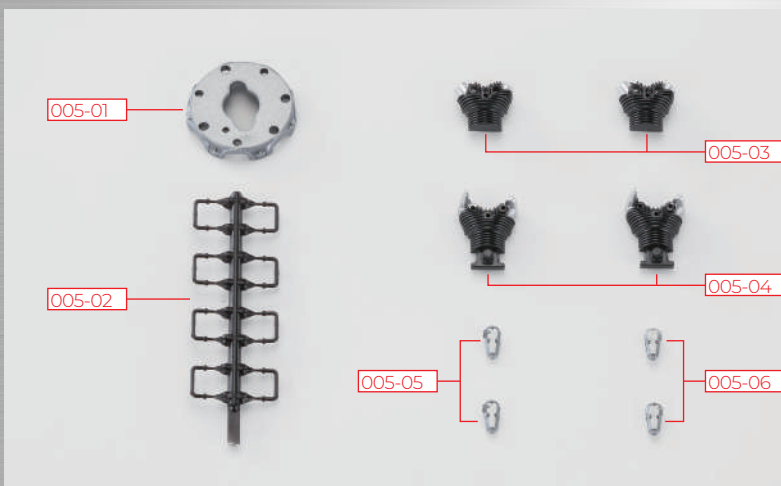

You will also need: superglue, tweezers

PARTS LIST

	PART	No.	MATERIAL
<input type="checkbox"/>	005-01	1	Die-cast
<input type="checkbox"/>	005-02	8	ABS resin
<input type="checkbox"/>	005-03	2	Die-cast
<input type="checkbox"/>	005-04	2	Die-cast
<input type="checkbox"/>	005-05	2	ABS resin
<input type="checkbox"/>	005-06	2	ABS resin

STEP 1

Assembling the cylinders

← : Glue
 - - - : Don't Glue

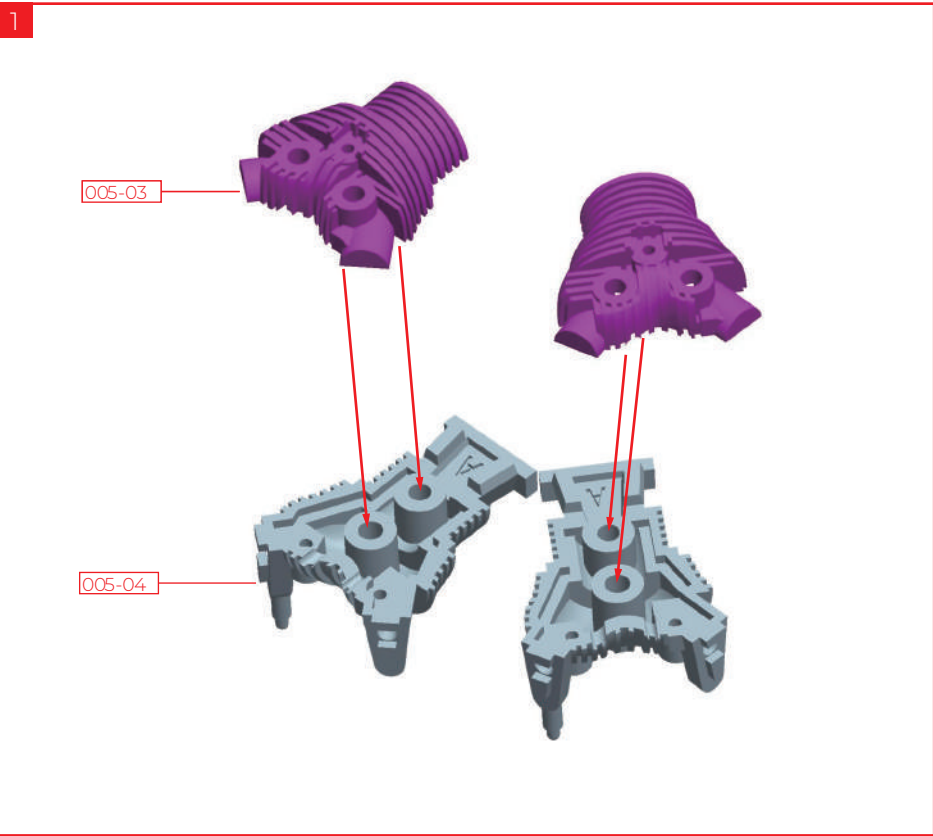

Apply a small amount of superglue to the two pins on part 005-03 and insert them into the holes on part 005-04 to join them. Make two of these.

NOTE
 Parts 005-03 & 005-04 are marked with the letter A.

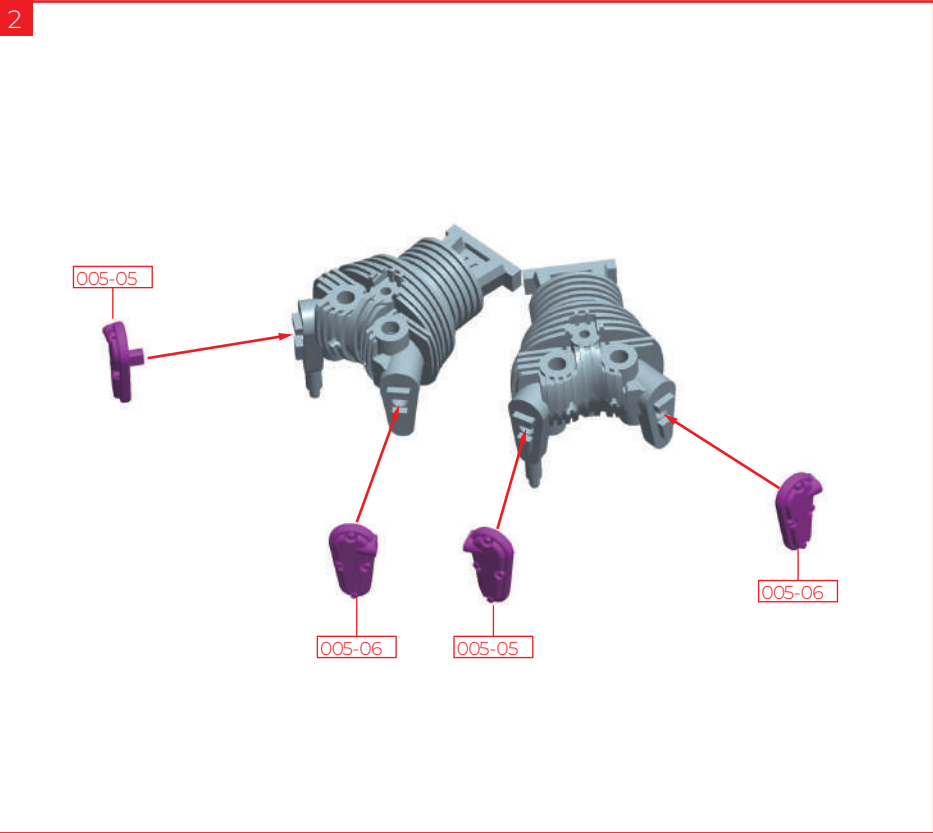
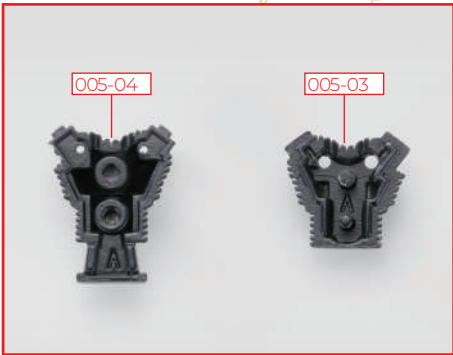

Glue parts 005-05 & 005-06 to the cylinders assembled in 1. Make two of these. Note that parts 005-05 & 005-06 are similar in shape.

POINT
 Parts 005-05 & 005-06 are similar, so take care not to make a mistake. Glue so that the holes on the sides face outward.

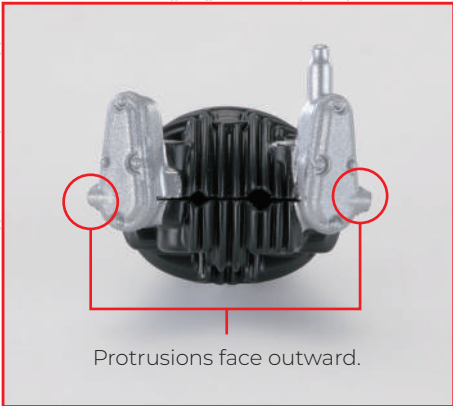

STEP 2

Fitting the cylinders to the crankcase



Fit the two assemblies from STEP 1 into the holes marked A on part 005-01. Do not glue.

NOTE

Part 005-01 has holes marked A and B. Be careful to place into the positions marked A.

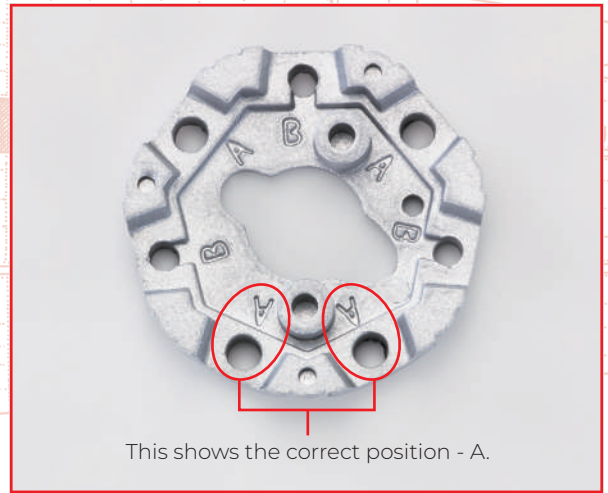

STEP 3

Attaching the oil pipes to the cylinders

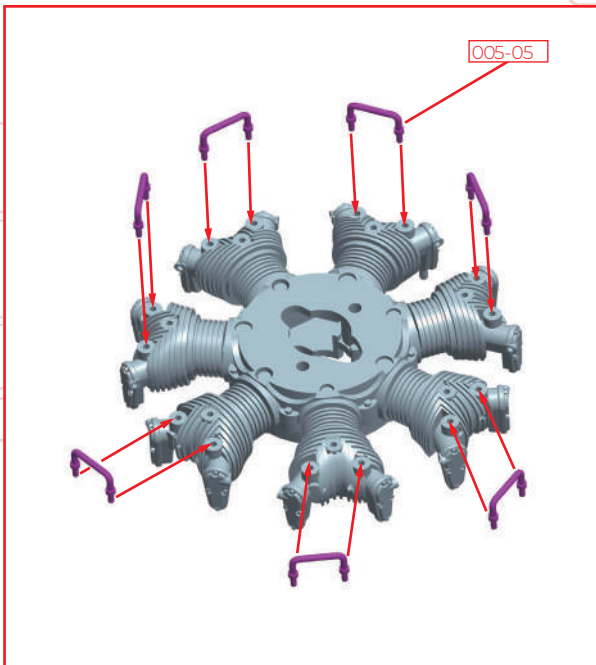

With the assembly from Stage 04 facing downwards, glue the oil pipes 005-02 to each of the seven cylinders.

STAGE COMPLETE

