

Pack 1

LaFerrari

1:8 SCALE

THE ULTIMATE HYPERCAR
ULTIMATE PERFORMANCE
ULTIMATE STYLE

AGORA
MODELS®



STAGE 01 FRONT NOSE AND BADGE

The parts supplied with this first stage are the upper panel of the nose, the badge of the Maranello company (with the famous black prancing horse on a yellow background) that is mounted on it, and the rear plate. This is an exact reproduction of the one affixed to the car when it was presented to the public at the Geneva Motor Show in 2013. Keep the

plate in a safe place, as it will be used when you assemble the car towards the end of your build. A first glance at the upper nose panel will allow you to appreciate the sleek lines of the LaFerrari bodywork, carefully tested in the wind tunnel to obtain its extraordinary aerodynamic qualities.

Parts provided are highlighted in blue/grey and numbered to match the list on the next page.



PARTS LIST

NO.	PART	QUANTITY	MATERIAL
1	Front nose (upper panel)	1	Metal
2	Ferrari badge	1	ABS
3	Rear plate	1	ABS

Note: your first pack includes all the screws you will need during the course of the build, plus spares. Keep them safe, and prepare them as detailed in the Parts List as you begin each stage.



CURVED MODELING TWEEZERS

Tweezers make it easier to hold and position the smaller parts that you will use while assembling the model.

STEP 1

Using tweezers, place the badge (1) in the correct position, with the pin on the back inserted into the matching hole in the upper nose panel (2). Pressing it firmly in place will ensure a secure fixing, but if you prefer you can add a very small drop of superglue.



Ferrari badge

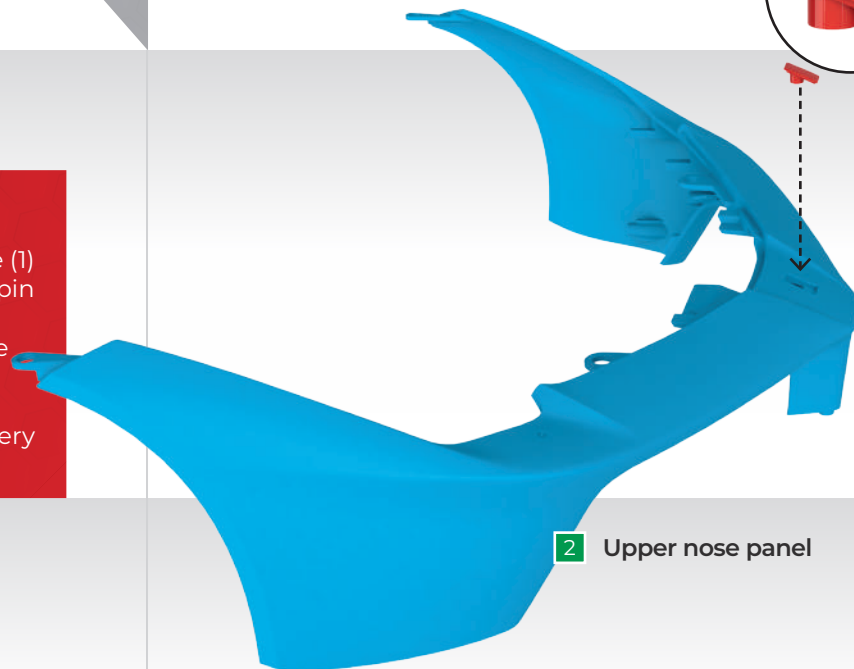

Upper nose panel



STAGE COMPLETE

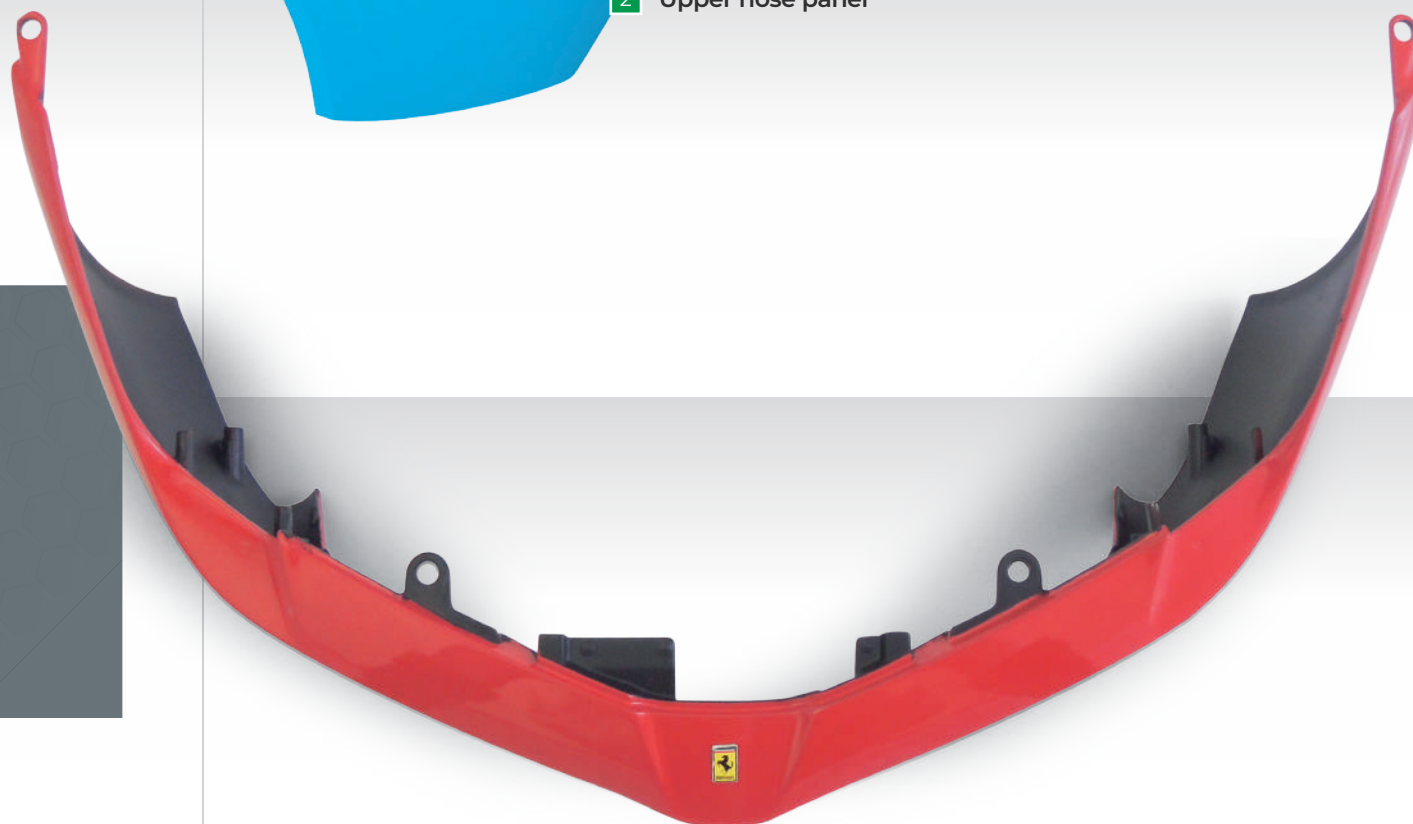

STAGE 02 THE DRIVER'S SEAT

YOUR EXCLUSIVE REPLICA
OF THE MASTERPIECE FROM THE
HOUSE OF MARANELLO WILL BE
ENHANCED BY THIS MINIATURE
DRIVER'S SEAT, PERFECTLY
REPRODUCED IN EVERY DETAIL

PARTS LIST

NO.	NAME	QUANTITY	MATERIAL
1	Headrest	1	ABS + PVC
2	Front upholstery	1	ABS + PVC
3	Screws type B	3	Metal
4	Backrest	1	ABS
5	Base	1	ABS

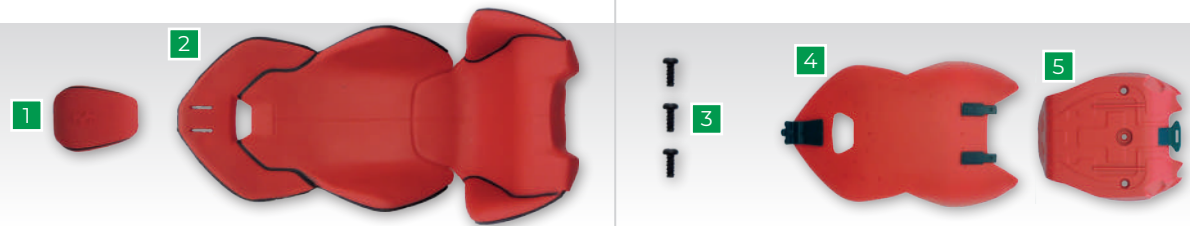

STEP 1

Fit the seat base (5) onto the front upholstery (2). Then insert two type B screws (3) making sure they are aligned with their mounting holes. Tighten them securely using a small crosshead screwdriver.

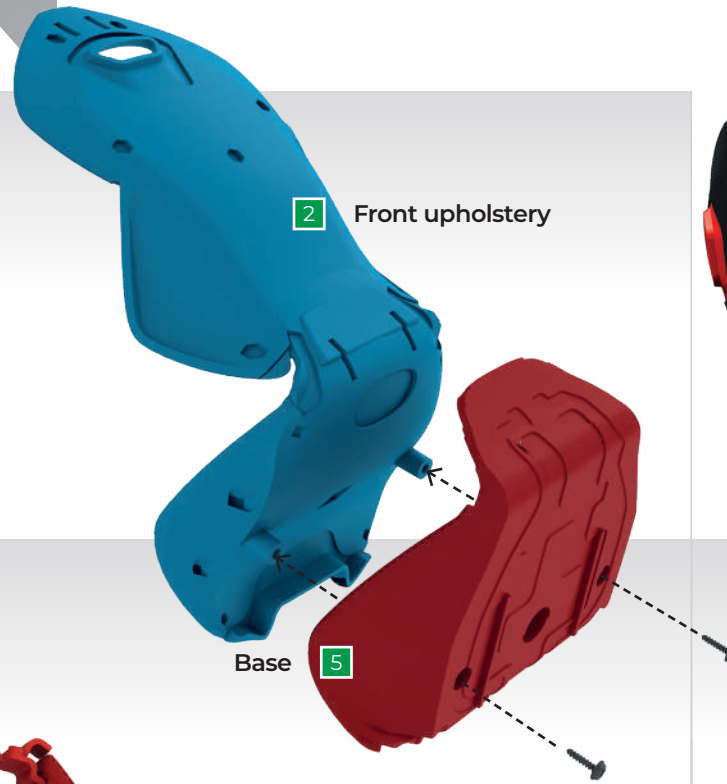

STEP 2

Fit the backrest (4) onto the front upholstery (2), interlocking it with the matching recess. It is a secure press-fit, but if you prefer you can add a little superglue.

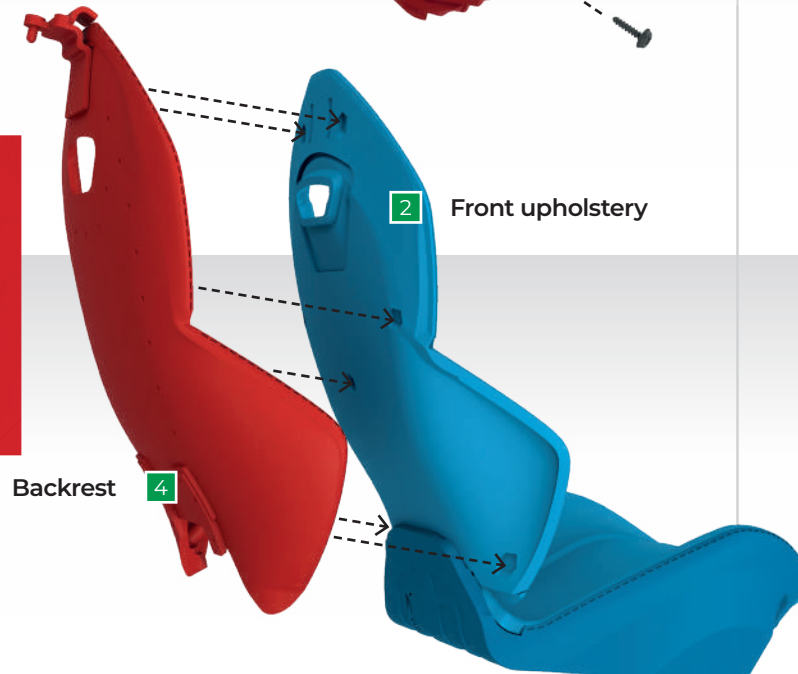

STEP 3

Fit the headrest (1) on top of the front upholstery (2). As with the backrest, the parts are a secure press fit, but if you prefer, you can use a little superglue.



STAGE COMPLETE

This completes the construction of the driver's seat. Store it carefully, ready to fit to your 1:8-scale LaFerrari.



STAGE 03 FRONT SPLITTER & AILERON

THE AILERON AND THE FRONT SPLITTER COMPLETE THE 'DELTA' STRUCTURE AT THE FRONT OF LAFERRARI, A DESIGN THAT WAS DERIVED FROM THE EXPERIENCE GAINED BY THE HOUSE IN FORMULA ONE





PARTS LIST

NO.	NAME	QUANTITY	MATERIAL
1	Rear tyre	1	Rubber
2	Aileron	1	Metal
3	Front splitter	1	PVC
4	Screws type A	6	Metal

STEP 1

Fit the lug on the aileron (2) into the pillar on the upper panel of the nose, provided with stage 1. The components interlock to keep them aligned. Use a type A screw (4) to secure them together.

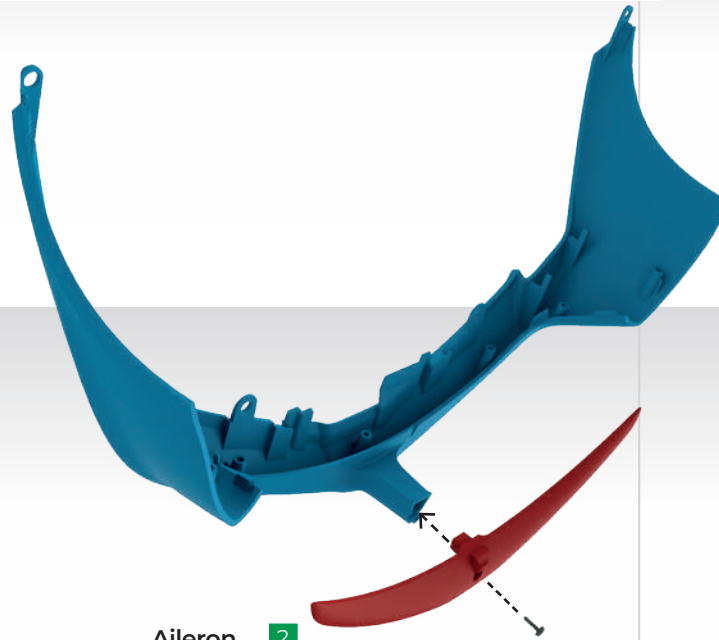

Aileron **2**



STEP 2

Align the splitter (3) with the nose assembly from Step 1. Use four type A screws (4) to join the two pieces at the points shown. Make sure you align them correctly in the screw holes and do not overtighten them.

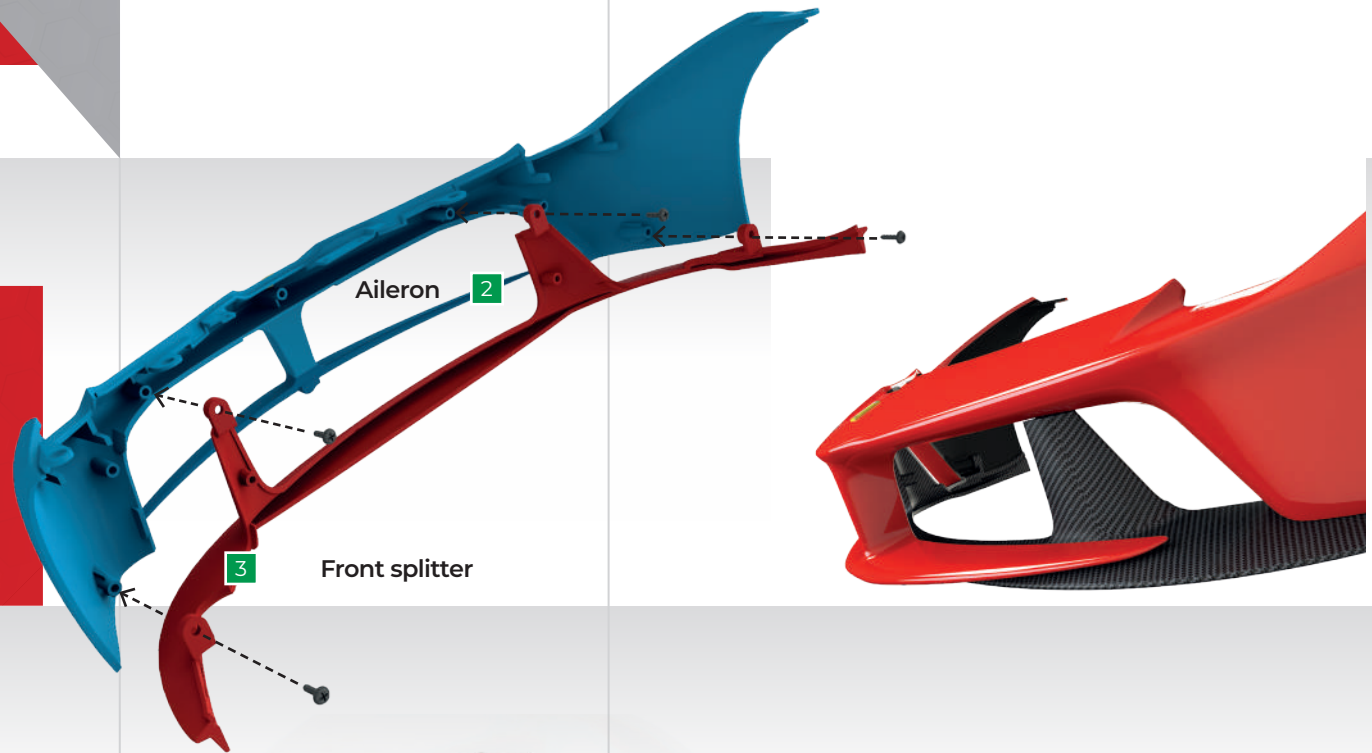

STAGE COMPLETE

The nose of your LaFerrari has gained two fundamental components: the splitter and the aileron. Store the assembly carefully, together with the screwdriver and rear tyre. The latter will be used in the next stage of construction.



STAGE 04 THE REAR LEFT WHEEL RIM

THE FIVE-SPOKE ALLOY WHEELS ARE FINE EXAMPLES OF ELEGANCE AND ROBUSTNESS. USING THESE DETAILED INSTRUCTIONS YOU CAN START TO ASSEMBLE THE LEFT REAR WHEEL OF YOUR 1:8-SCALE LAFERRARI

PARTS LIST

NO.	NAME	QUANTITY	MATERIAL
1	Rear hub cap	1	ABS
2	Rear left wheel rim	1	Metal

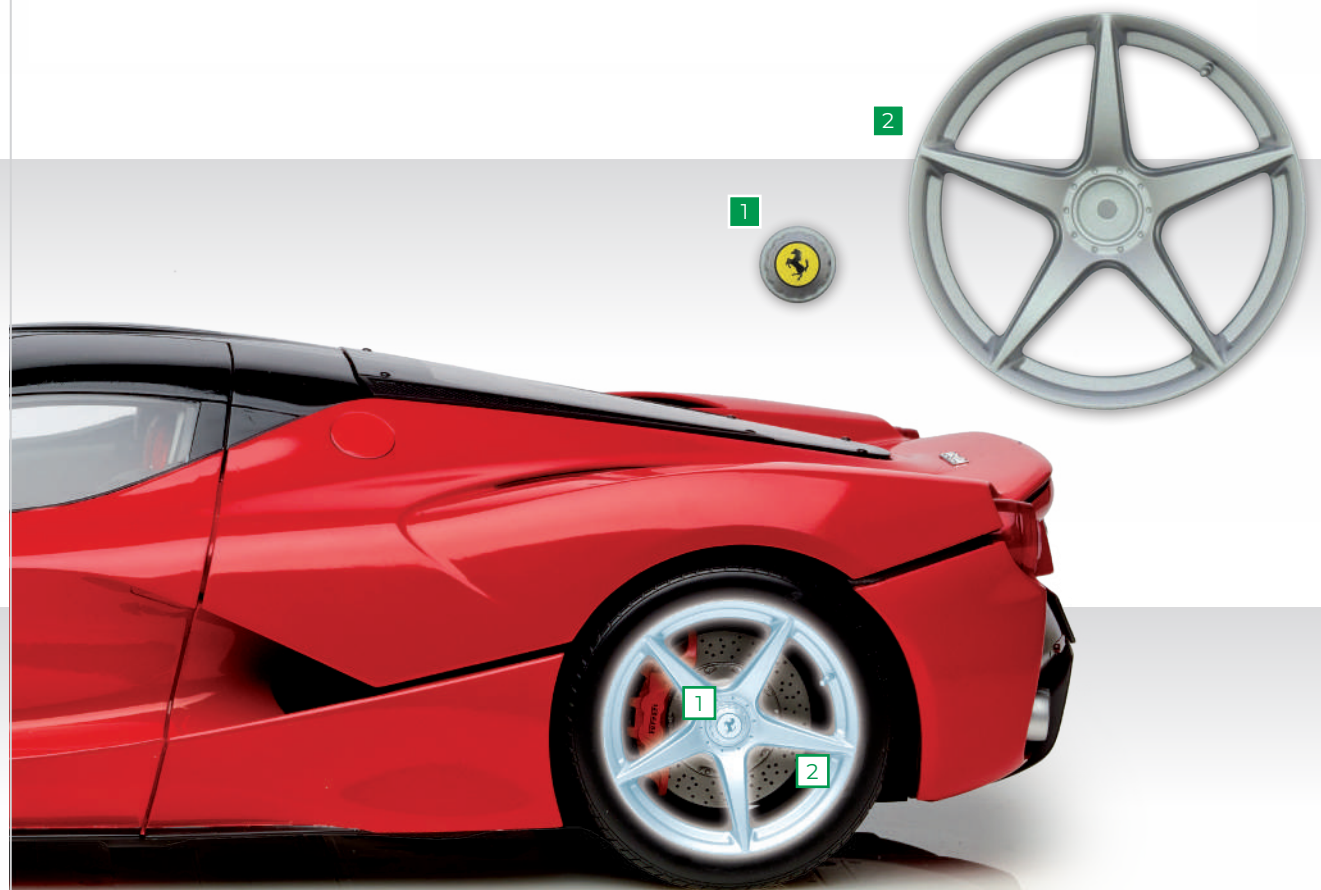

STEP 1

Take the tyre provided with stage 3 and fit it over the insert that ensures the tyre looks evenly inflated all round. If the rubber is too stiff to allow this, place the tyre in hot water for about a minute.

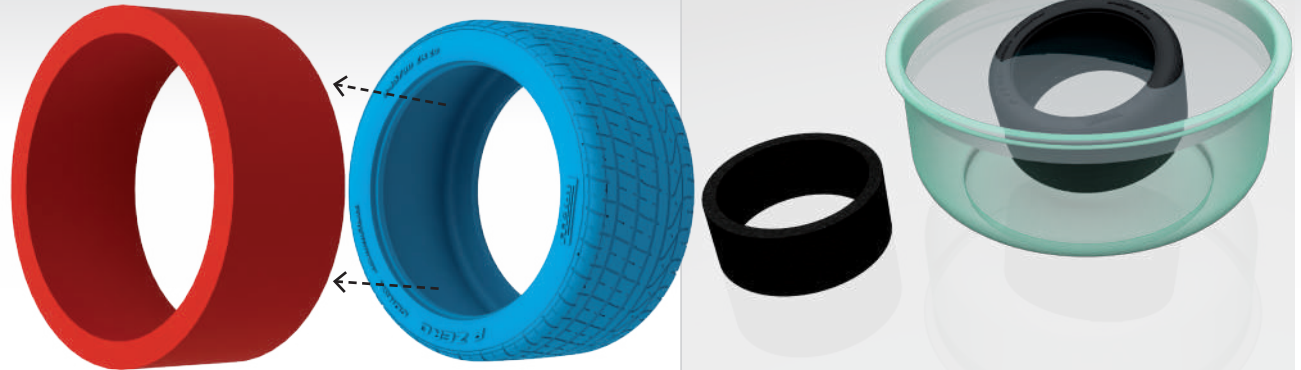

STEP 2

Before continuing, make sure that the insert has filled the tyre evenly. If it was necessary to soak the tyre in hot water, make sure it has dried fully before fitting it onto the wheel.

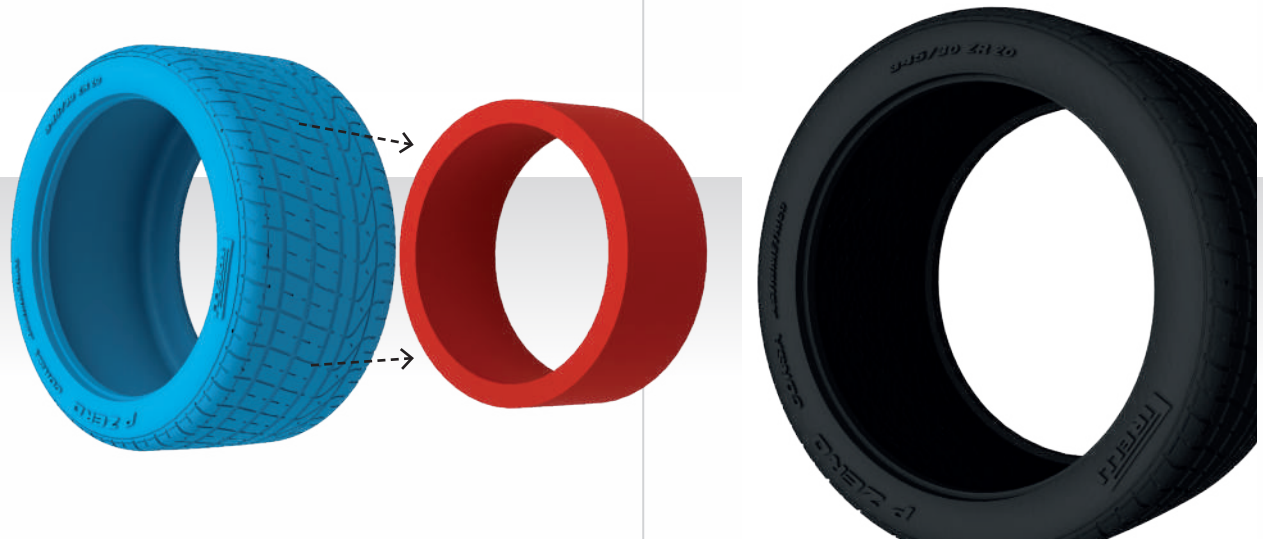

STEP 3

All that remains is to fit the tyre onto the rim of the wheel. It's important to make sure that the beads around the edge of the tyre slot into the outer channels in the rim, and that they are evenly bedded all round. Note the position of the S-shaped tread on the wheel (red arrow).

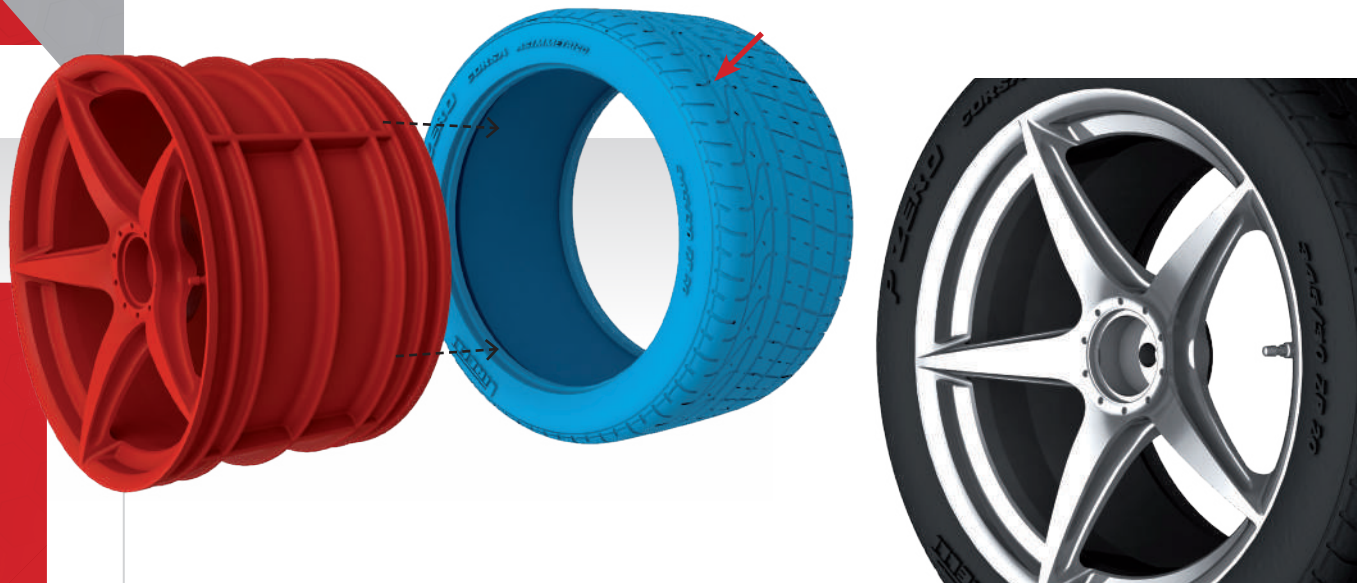

STAGE COMPLETE

This is what the rear left wheel will look like after assembly. Keep it safe, together with the Prancing Horse hubcap, which will be used in one of the later stages of the assembly.



STAGE 05 THE BONNET

THE BONNET, WHICH
COVERS THE COMPARTMENT
FOR THE RADIATOR AND A
SMALL TRUNK, IS SHAPED TO
FOLLOW THE DELTA
CONFIGURATION OF THE
LAFERRARI NOSE



PARTS LIST

NO.	NAME	QUANTITY	MATERIAL
1	Bonnet	1	Metal
2	Left bonnet hinge	1	Metal
3	Right bonnet hinge	1	Metal
4	Screw type C	3	Metal



CROSSHEAD SCREWDRIVER

This familiar tool will be used for many stages of assembling your 1:8-scale LaFerrari. But all screwdrivers are not the same! Make sure the tip fits the small screws properly. We recommend choosing a robust, good quality precision screwdriver, as poorly made tools will make it hard to drive the screws and may even damage their heads. It is also important to have a sturdy, comfortable handle, and we recommend choosing a screwdriver equipped with non-slip grips.

STEP 1

Fit the two hinges onto the bonnet, pressing the holes onto the matching locating pins. Fix them in place using two type C screws (4). It will be necessary to apply a fair amount of force, so be careful to keep the screwdriver in alignment.

Right bonnet hinge **3**

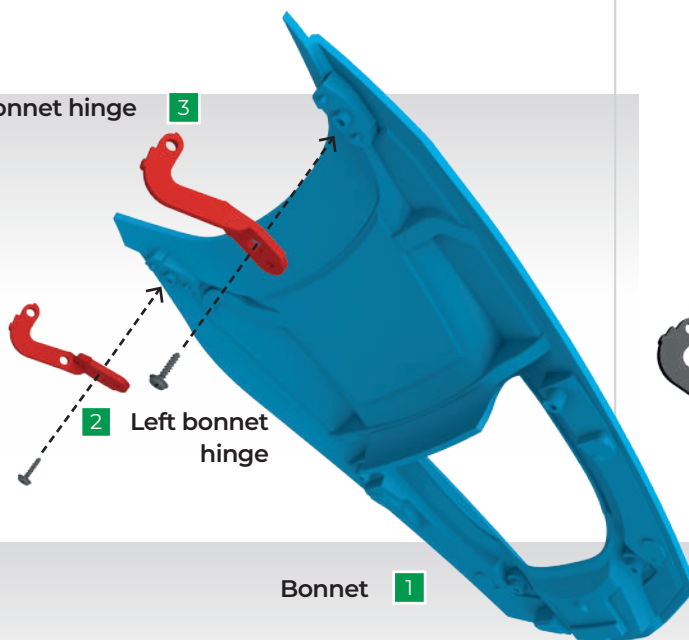

2 Left bonnet hinge

Bonnet **1**



STAGE COMPLETE

The bonnet of your model now has the two hinges that will be used to join it to the rest of the bodywork. Store it carefully, ready for a later stage of the build.



STAGE 06 INTERNAL DETAILS OF THE BONNET

AFTER YOU FIT THE NEW COMPONENTS PROVIDED TO THE BONNET OF YOUR 1:8-SCALE LAFERRARI, YOU WILL BE ABLE TO APPRECIATE THE EXTREME ATTENTION TO DETAIL OF YOUR REPLICA



PARTS LIST

NO.	NAME	QUANTITY	MATERIAL
1	Bonnet airfoil (part 2)	1	ABS
2	Bonnet vent frame (part 1)	1	ABS
3	Screw type D	5	Metal

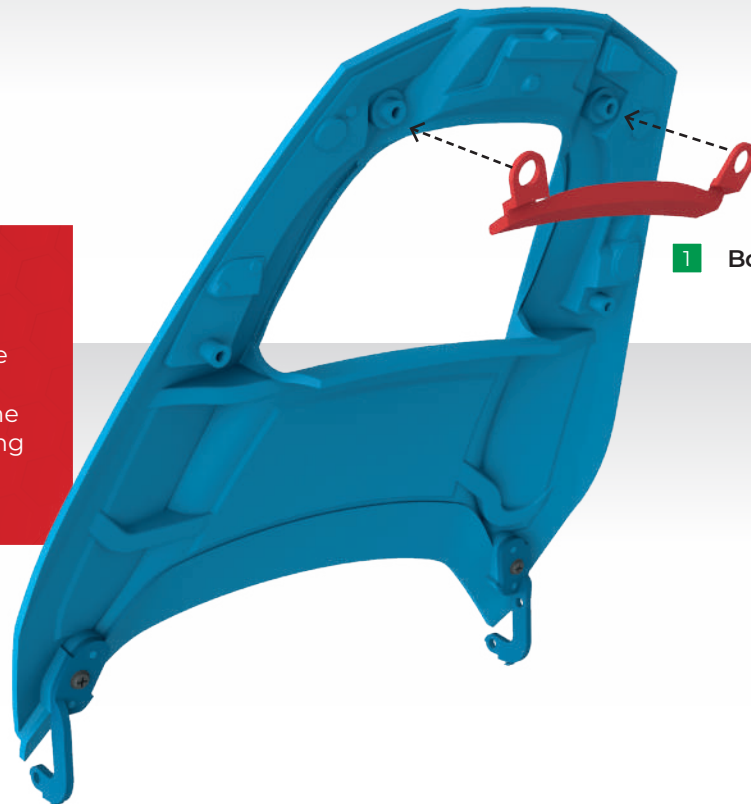
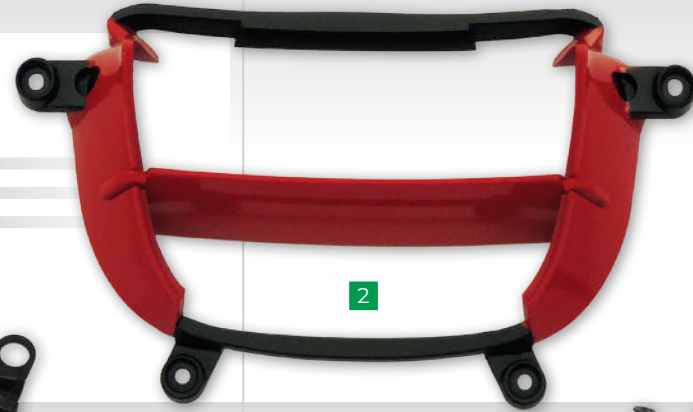

STEP 1

Install the bonnet airfoil (1) in the vent by fitting its two holes over the two locating posts so that the airfoil fits up through the opening in the bonnet.

STEP 2

Align part 2 with the opening in the bonnet, fitting its four holes over the matching locating posts, then fix it in place by using four type D screws (3).

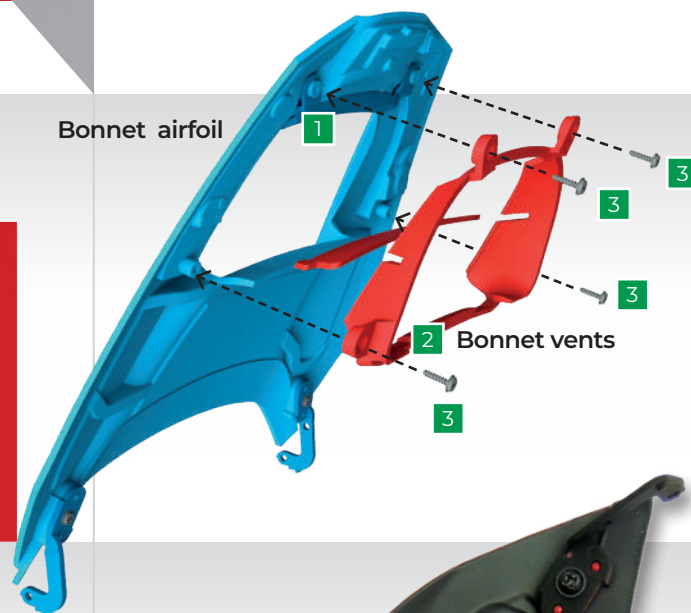

STAGE COMPLETE

This is what the inside of the hood looks like at the end of this stage. Check that your model looks like this, then store the assembly and screwdriver carefully.



STAGE 07 THE ENGINE'S AIRBOX

WITH THE NEW PARTS PROVIDED, YOU CAN START BUILDING THE SPECIAL HYBRID POWER UNIT THAT REPRESENTS ONE OF THE KEY FEATURES OF THIS TWO-SEATER FROM THE PRANCING HORSE



PARTS LIST

NO.	NAME	QUANTITY	MATERIAL
1	Air-box	1	ABS
2	Ferrari logo	2	Photo-etched metal

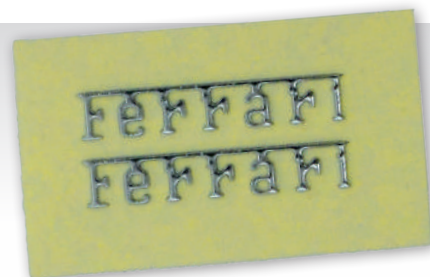

STEP 1

Carefully remove the two silver logos from their backing paper, one by one, and apply them to the engine's airbox. The illustrations show you where they should be placed: make sure both are perfectly positioned, then press them firmly onto the surface.

STAGE COMPLETE

The airbox of the engine of your 1:8-scale LaFerrari, showing the position of the two logos of the House of Maranello. Put your finished assembly away in a safe place, until you are ready to employ these components at a later stage of construction.

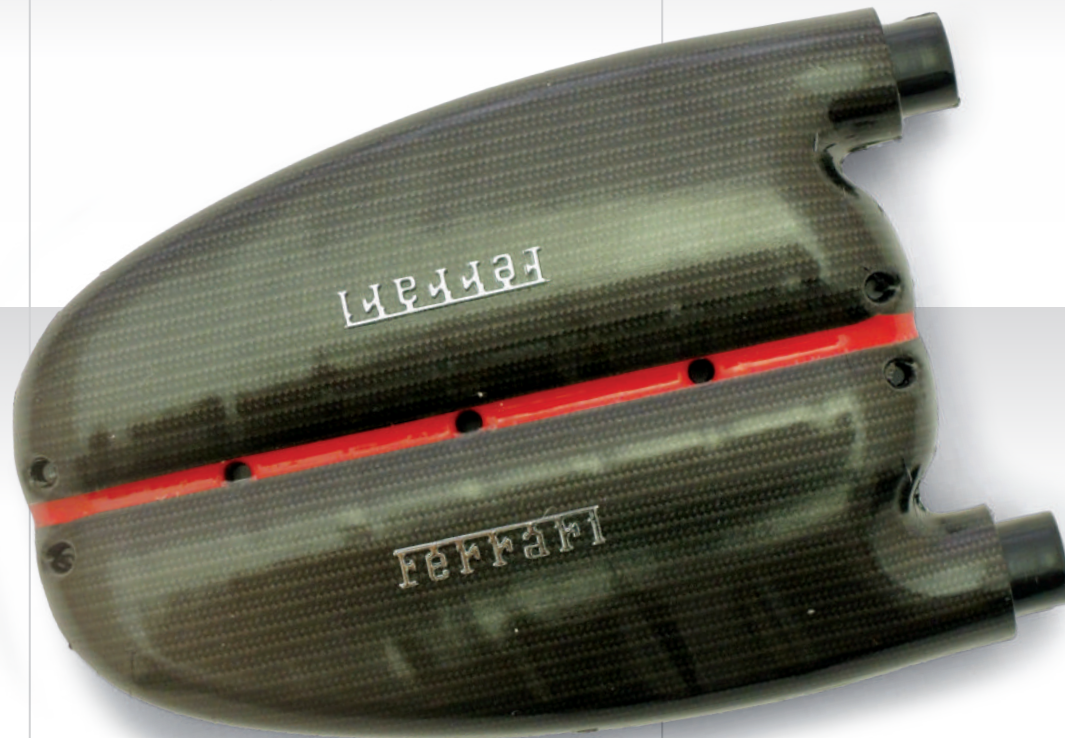
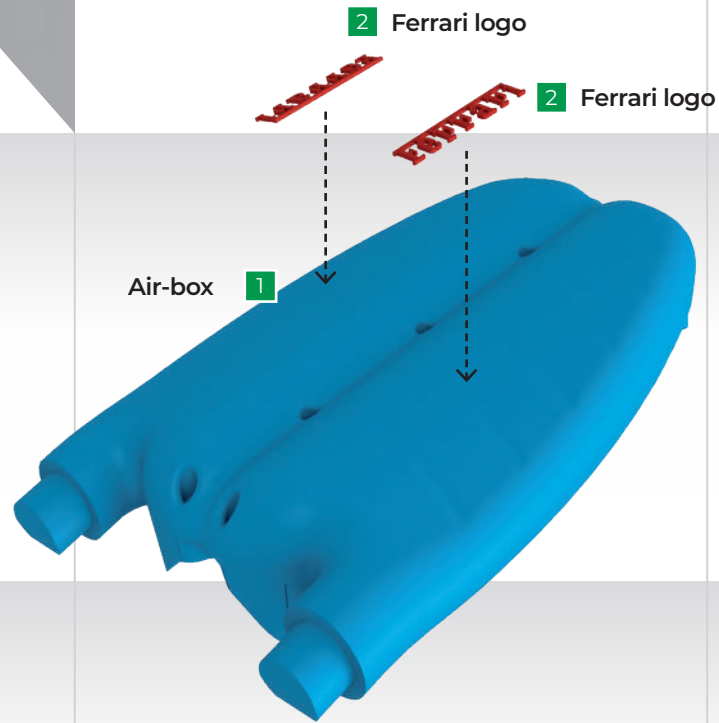

STAGE 08 THE LEFT-HAND HEAD COVER

THE LAFERRARI ENGINE IS A DESIGN IN THE TRADITION OF THE HOUSE OF MARANELLO - A V12. THIS MEANS THAT IT HAS TWO CYLINDER BANKS, EACH OF WHICH HAS ITS OWN HEAD COVER. USING THE PARTS PROVIDED, YOU WILL BEGIN TO ASSEMBLE THE COVER FITTED ON THE LEFT

PARTS LIST

NO.	NAME	QUANTITY	MATERIAL
1	Left-hand head cover	1	ABS
2	Plug caps	13	ABS
3	Head-cover gasket	2	EVA Foam





STEP 1

Fit one of the head-cover gaskets (3) over the two posts on the underside of the head cover (1), noting which way round it goes.

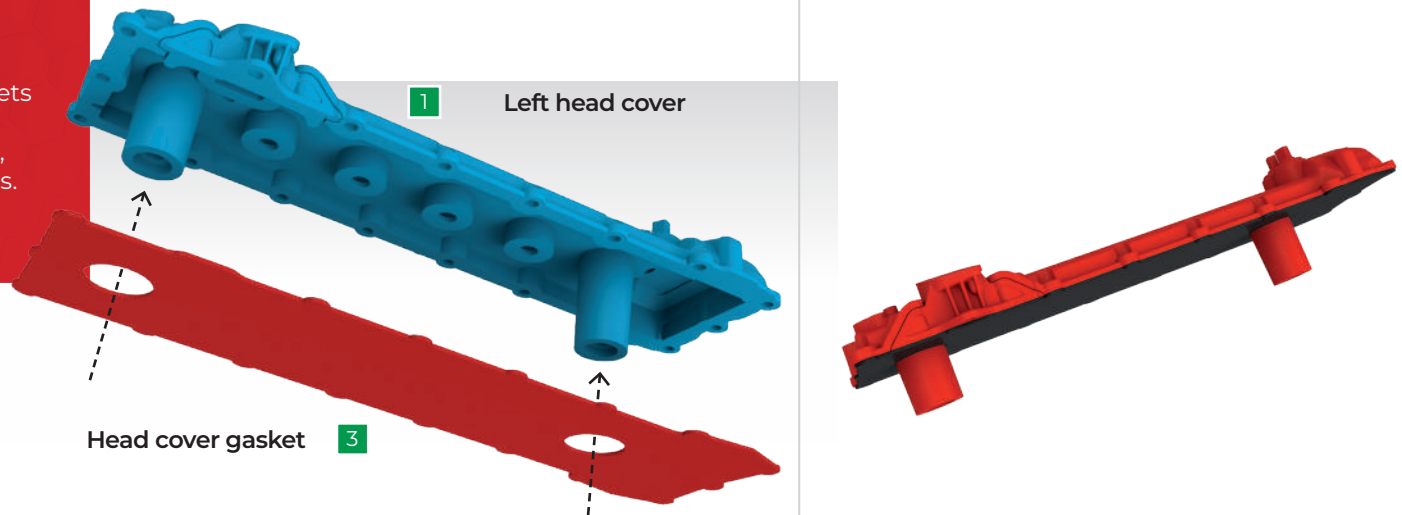

STEP 2

Press four plug caps into the holes in the head cover shown on the right. Note the notches beside the holes, which mean that the caps have to be at the correct angle before they can be fully pushed in. The caps will stay in place if they are dry-fitted, but, for extra security, you can add a drop of superglue.

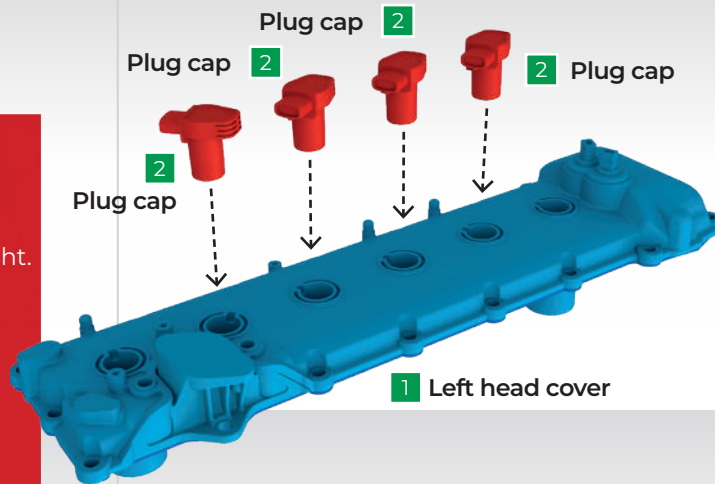

STAGE COMPLETE

The left-hand head cover is now fitted with its gasket and four of its six plug caps. Put the assembly away carefully, together with the unused parts. They will be needed for the next stage.

