

1 9 6 5

SHELBY COBRA

427 SEMI-COMPETITION

1:8 SCALE



Pack 09 | Build Instructions

In the 1960s, Carroll Shelby's Cobras dominated racetracks worldwide, first winning races coast to coast across North America, then in 1965, winning the World Manufacturer's GT Championship, achieving the ultimate goal of defeating Ferrari. The Semi-Competitions were modified from full competition models just enough to make them street legal. Only 29 models were produced, making them one of the most sought-after American sports cars by collectors.

Your 1:8 model replicates the original 1965 Semi-Competition Cobra in intricate detail. From the detail on the dashboard dials to the writing on the wheels, every piece is precisely reproduced.

In your ninth model pack, you will assemble:

**STAGE 65: DRIVER SEAT-BELT HARNESS,
HOOKS & FRONT LATERAL CAGE RIGHT BAR**

**STAGE 66: OIL VAPOUR CANISTER, PIPES,
CAP, & AIR INTAKE PIPE**

**STAGE 67: STEERING SYSTEM SHAFT, CAM
GEAR BRACKET & COVER**

STAGE 68: STEERING ROD & COLUMN

**STAGE 69: TRUNK, EMBLEM
& LICENSE PLATE LIGHT**

**STAGE 70: TRUNK HINGES, BRACKET,
& REAR LICENSE PLATE**

STAGE 71: LEFT DOOR, TRIM & RIVETS

STAGE 72: LEFT DOOR HINGE AND LOCK

STAGE 73: RIGHT DOOR, TRIM & RIVETS

Stage 65: Driver Seat-Belt Harness, Hooks & Front Lateral Cage Right Bar

In this first stage of pack 09 you will add some details to the roll bar from stage 03.

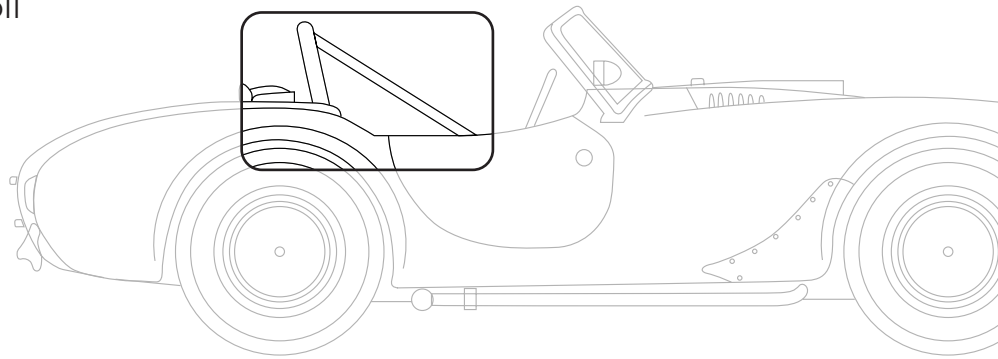

STAGE 65 PARTS LIST

Name	Quantity
Driver Seat Harness Rear Bracket	1
Driver Seat Harness Front Bracket (left)	1
Driver Seat Harness Front Bracket (right)	1
Harness Hooks	2
Front Lateral Cage Right Bar	1
Screws Type OP10	3

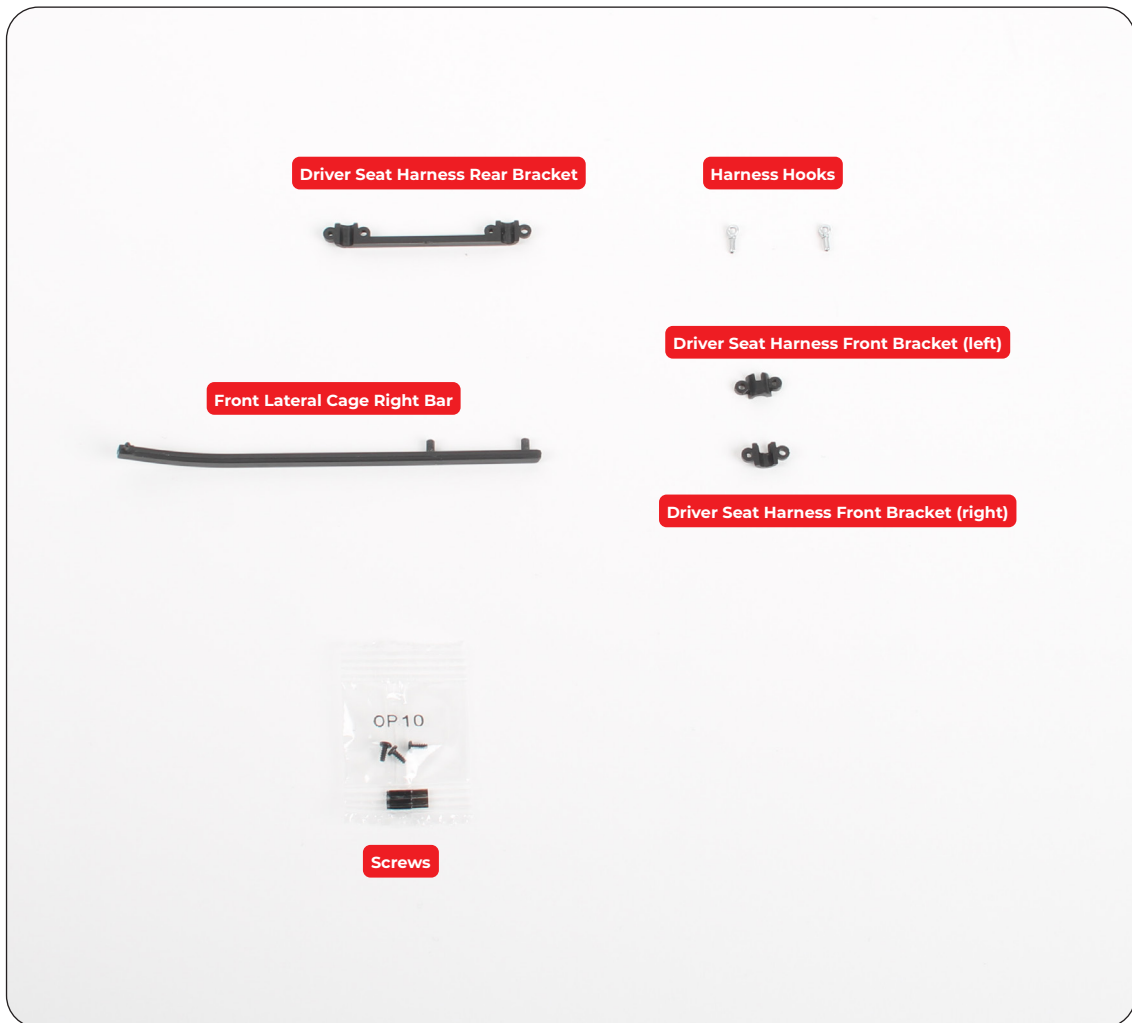

Stage 65: Driver Seat-Belt Harness, Hooks & Front Lateral Cage Right Bar

STEP 1

ATTACH THE SEAT HARNESS REAR BRACKET TO THE ROLL BAR FROM STAGE 03

Hold the Roll Bar with the front facing you (the raised screw hole at the top faces the rear). Align the Harness Rear Bracket with the notches on the roll bar, anchoring it from the rear. Rest in this position.

Take the Left Seat-Harness Front Bracket and place it in the notches on the front of the roll bar (picture 2). Secure with an OP10 screw. Repeat on the opposite side with the Right Seat-Harness Front Bracket.

Note: the notch on the Left Seat-Harness Front Bracket is bigger than the notch on the Right Seat-Harness Front Bracket.

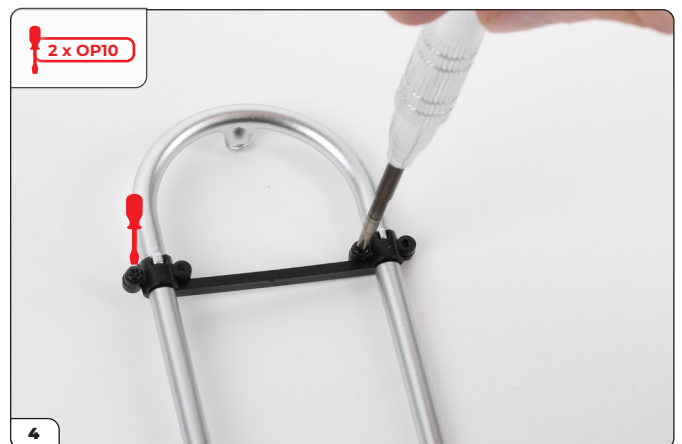

Stage 65: Driver Seat-Belt Harness, Hooks & Front Lateral Cage Right Bar

STEP 2

ATTACH THE HARNESS HOOKS AND SEAT BELTS FROM STAGE 54

Align the two Harness Hooks with the outer holes on the Seat Harness Brackets. Push into place ensuring the hole is in the vertical position.

Take the Seat Belts from Stage 54 and hook them onto the Harness Hooks. Check you have them the correct way round (see Stage Complete image to check the position of the hooks at the ends of the seat belts).

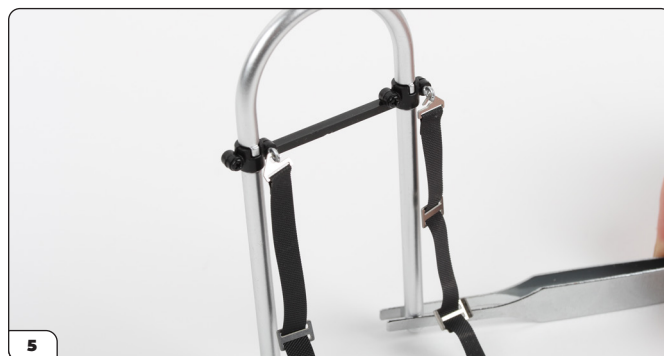
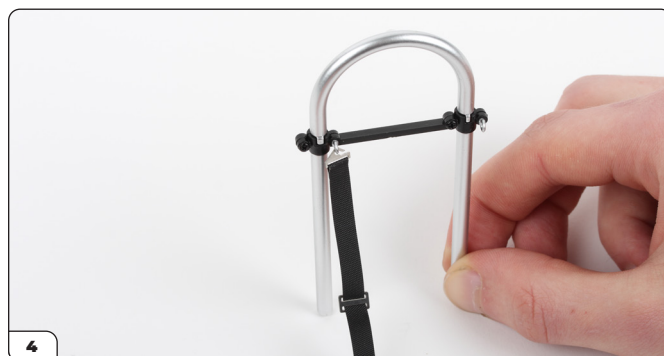
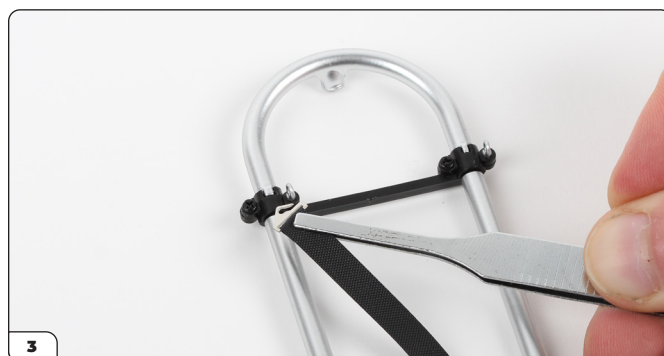

Stage 65: Driver Seat-Belt Harness, Hooks & Front Lateral Cage Right Bar

STEP 3

ATTACH THE FRONT LATERAL CAGE RIGHT BAR TO THE FIREWALL

Align the pegs on the Front Lateral Cage Right Bar with the holes on the Firewall from Stage 64.

Push into place.

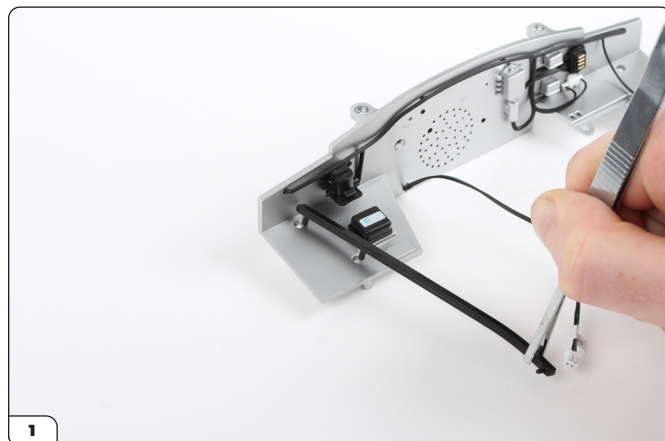

Stage 65 complete!

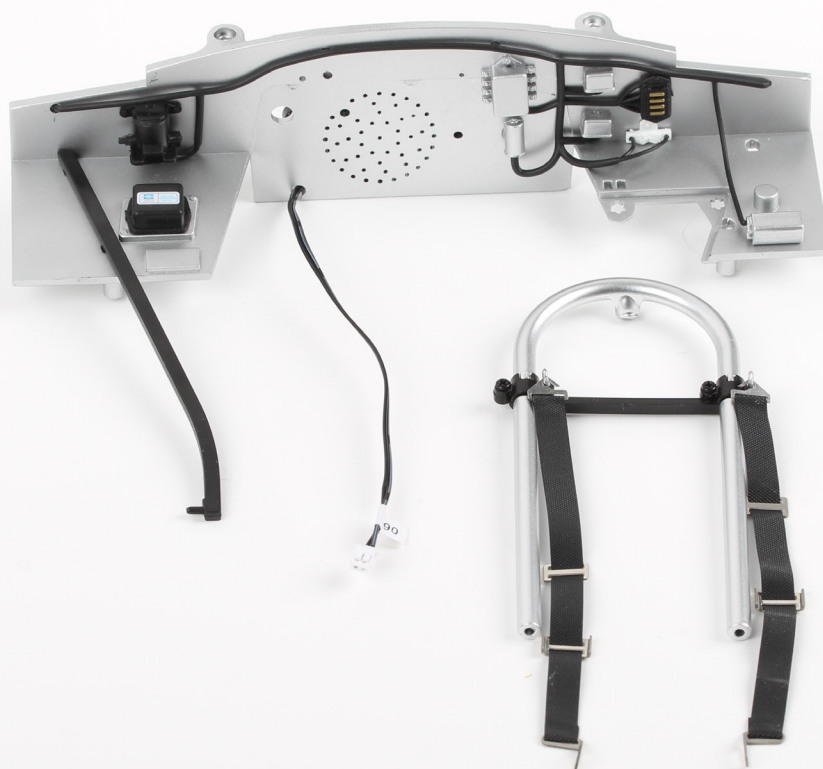

Stage 66: Oil Vapour Canister, Pipes, Cap, & Air Intake Pipe

In stage 66, you will assemble the oil vapour canister and attach it to the firewall.

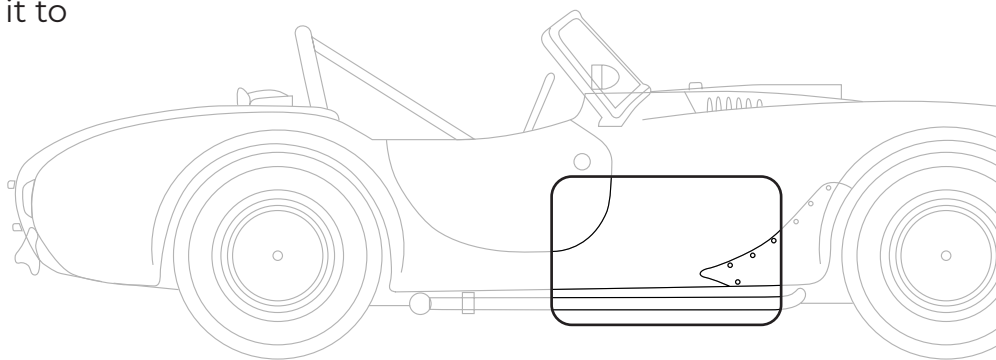

STAGE 66 PARTS LIST

Name	Quantity
Oil Vapour Canister	1
Oil Vapour Canister Pipe 1	1
Oil Vapour Canister Pipe 2	1
Oil Vapour Canister Cap	1
Air Intake Pipe	1
Screws Type OP07	2

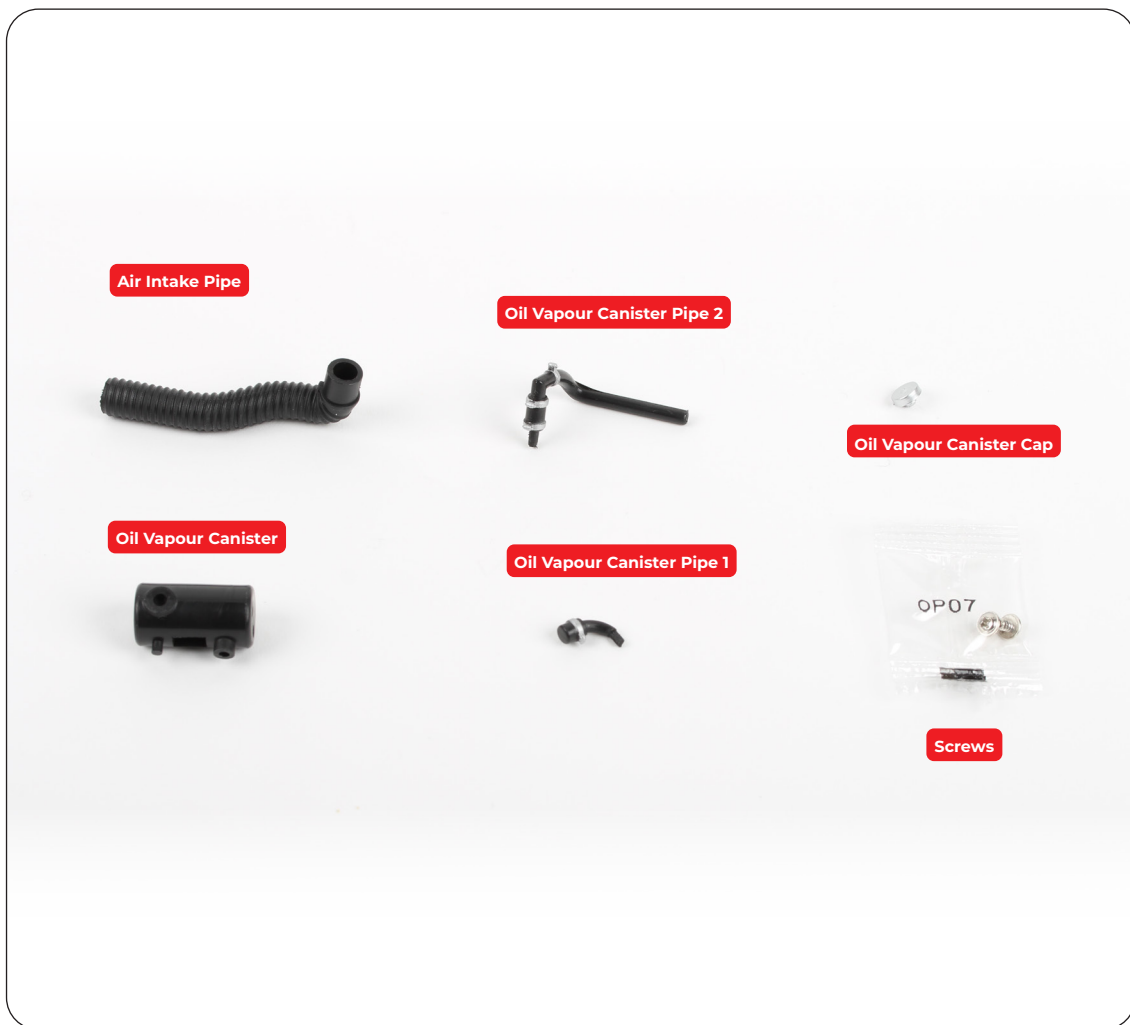

Stage 66: Oil Vapour Canister, Pipes, Cap, & Air Intake Pipe

STEP 1

ASSEMBLE THE OIL VAPOUR CANISTER AND ATTACH IT TO THE FIREWALL

Take the Oil Vapour Canister and find the end closest to the raised screw hole (arrow). Align the Oil Vapour Canister Pipe 1 with the small round hole on the end of the Canister and push into place. There is only one way to fit this pipe.

Then take Canister Pipe 2 and push the thin tip into the hole next to Pipe 1. Again, there is only one way to fit.



Stage 66: Oil Vapour Canister, Pipes, Cap, & Air Intake Pipe

CONTINUED...

Press the Canister Cap into the flat round hole on the side of the Canister.

To Fit the Oil Vapour Canister to the firewall, align the raised screw hole and the lug on the Canister with the two holes on the Firewall. Fit into place and secure from the reverse side using a TYPE OP07 screw.



ADVICE FROM THE EXPERTS

If the Oil Vapour Canister doesn't sit in the holes properly, remove the speaker, then clear out the hole with the tip of a pointed craft knife.

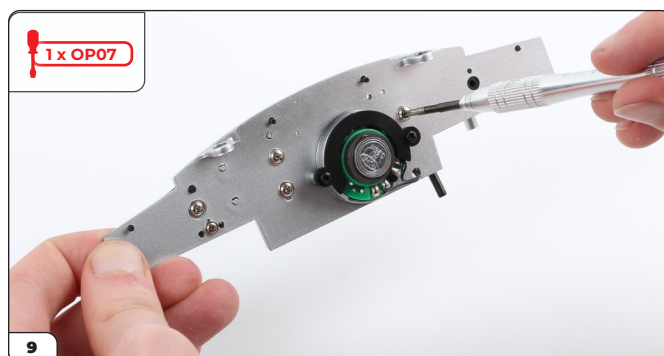
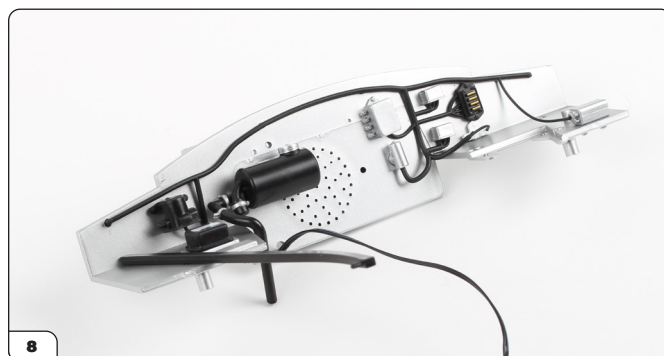
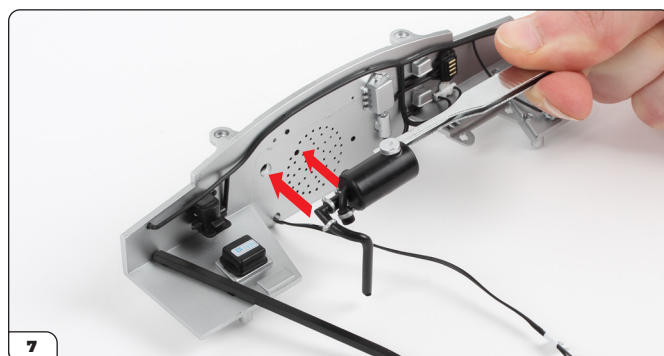

Stage 66: Oil Vapour Canister, Pipes, Cap, & Air Intake Pipe

STEP 2

ATTACH THE AIR INTAKE PIPE TO THE FIREWALL

Push the bent end of the Air Intake Pipe over the lug on the Firewall. Press firmly to fit.



Stage 66 complete!

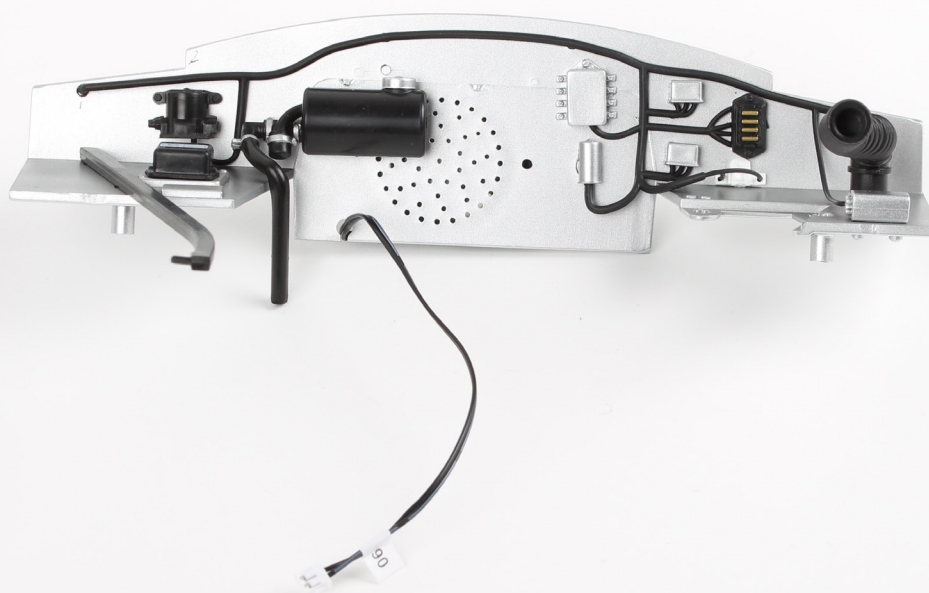

Stage 67: Steering System Shaft, Cam Gear Bracket & Cover

In stage 67 you will start to fit components for the steering system.

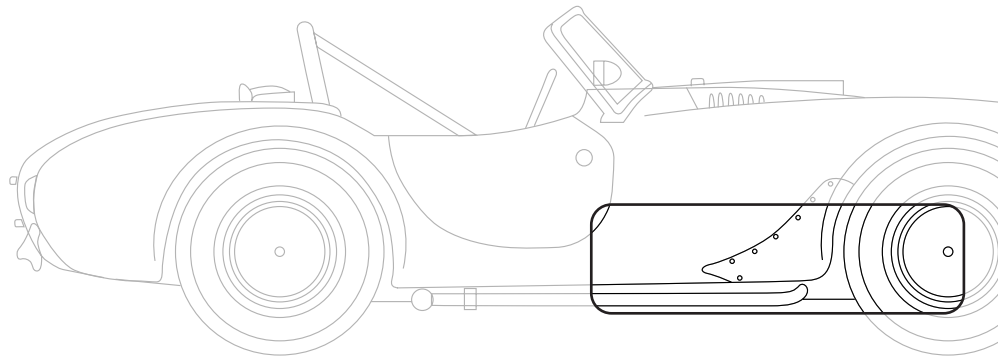

STAGE 67 PARTS LIST

Name	Quantity
Steering System Shaft	1
Cam Gear Cover	1
Cam Gear Bracket	1
Screws Type OD05	3
Screws Type OD06	3



Stage 67: Steering System Shaft And Cam Gear Bracket & Cover

STEP 1

ATTACH THE CAM GEAR BRACKET

Align the Cam Gear Bracket with the two holes on the Front Suspension Support. Fix into place with 2 x OD05 screws.



ADVICE FROM THE EXPERTS

Screw the Cam Gear Cover onto the Cam Gear Bracket (STEP 3) and then remove it. This will pre-thread the holes and make assembly much easier.

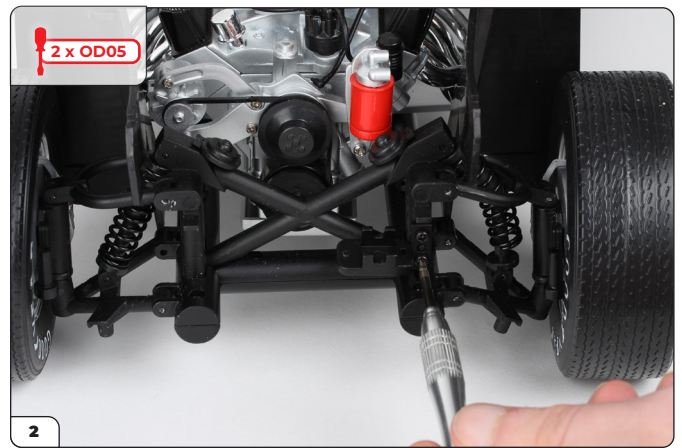

STEP 2

FIT THE STEERING SYSTEM SHAFT

Insert the ribbed end of the Steering System Shaft through the middle of the Exhaust Manifold Pipes. Thread it downwards, through towards the front of the chassis until the ribbed end sits within the notches of the Cam Gear Bracket.

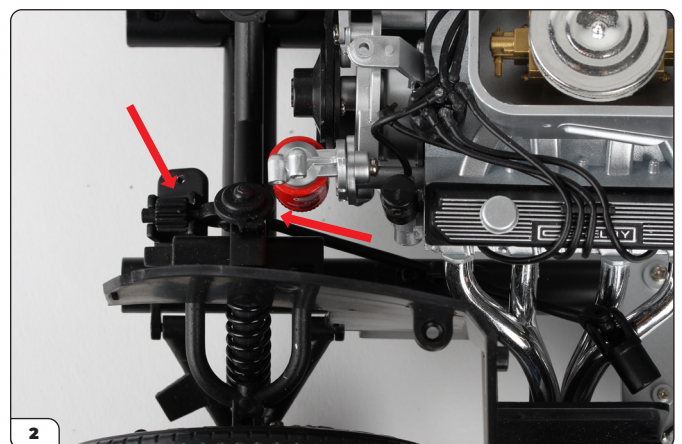
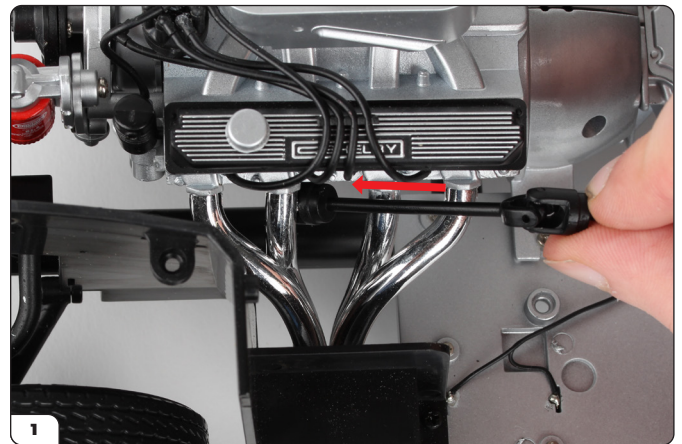

Stage 67: Steering System Shaft And Cam Gear Bracket & Cover

STEP 3

ATTACH THE CAM GEAR COVER

Place the Cam Gear Cover on top of the bracket and fix in place with 2 x OD06 screws.

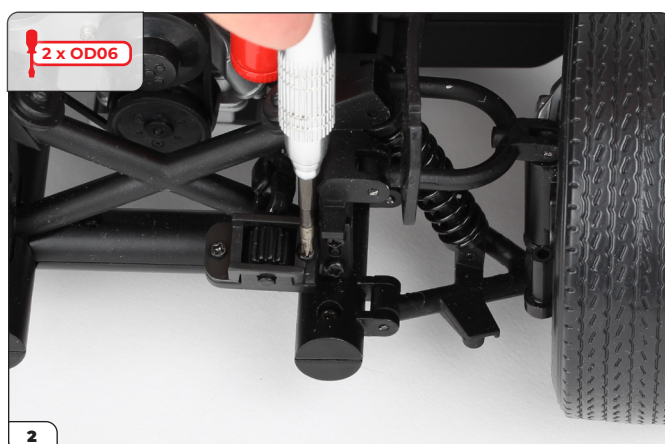
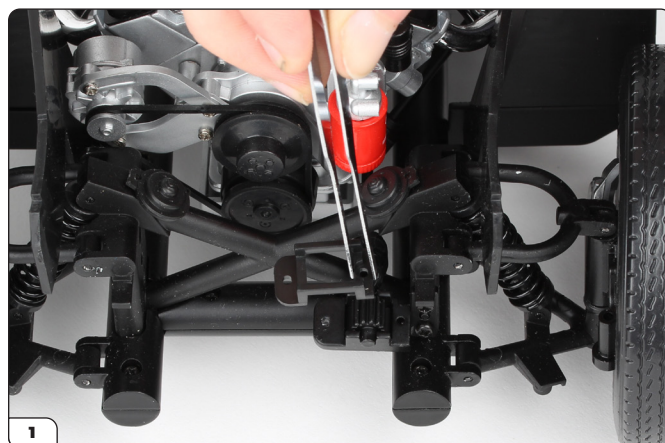

Stage 67 complete!

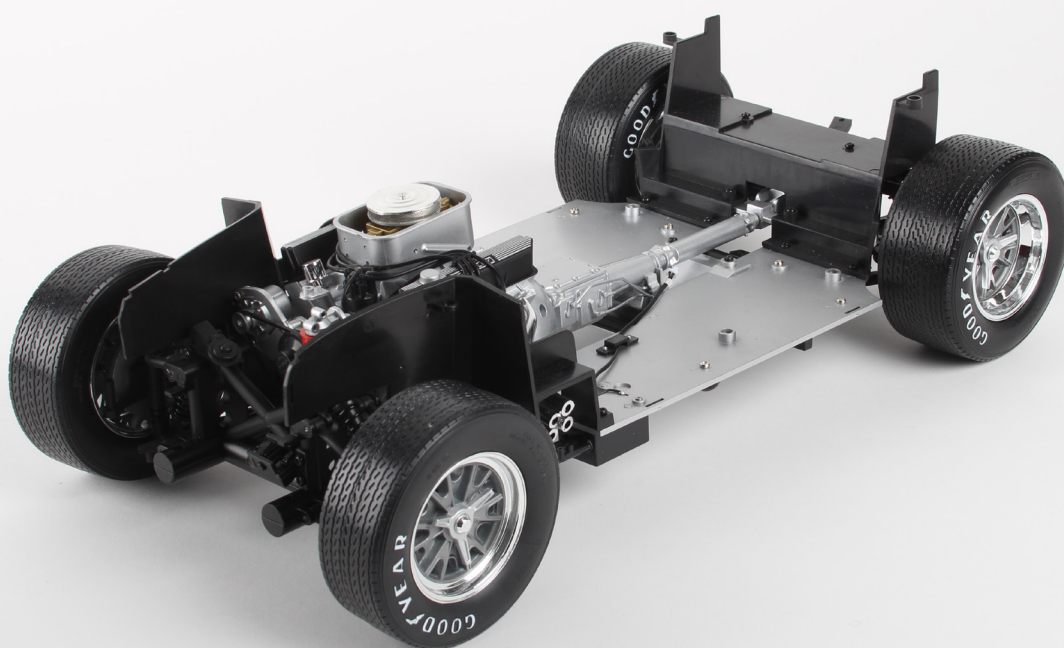

Stage 68: Steering Rod & Column

In stage 68, you will build components for the steering system.

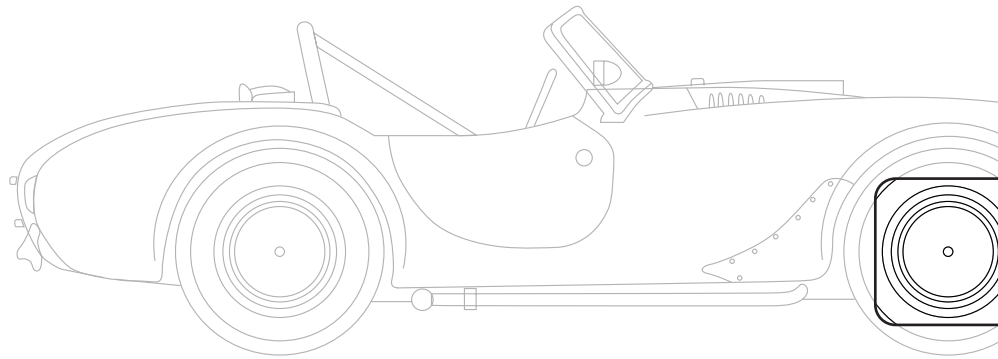

STAGE 68 PARTS LIST

Name	Quantity
Steering Rod	1
Steering Column	1
Springs	2
Screws Type OD07	3

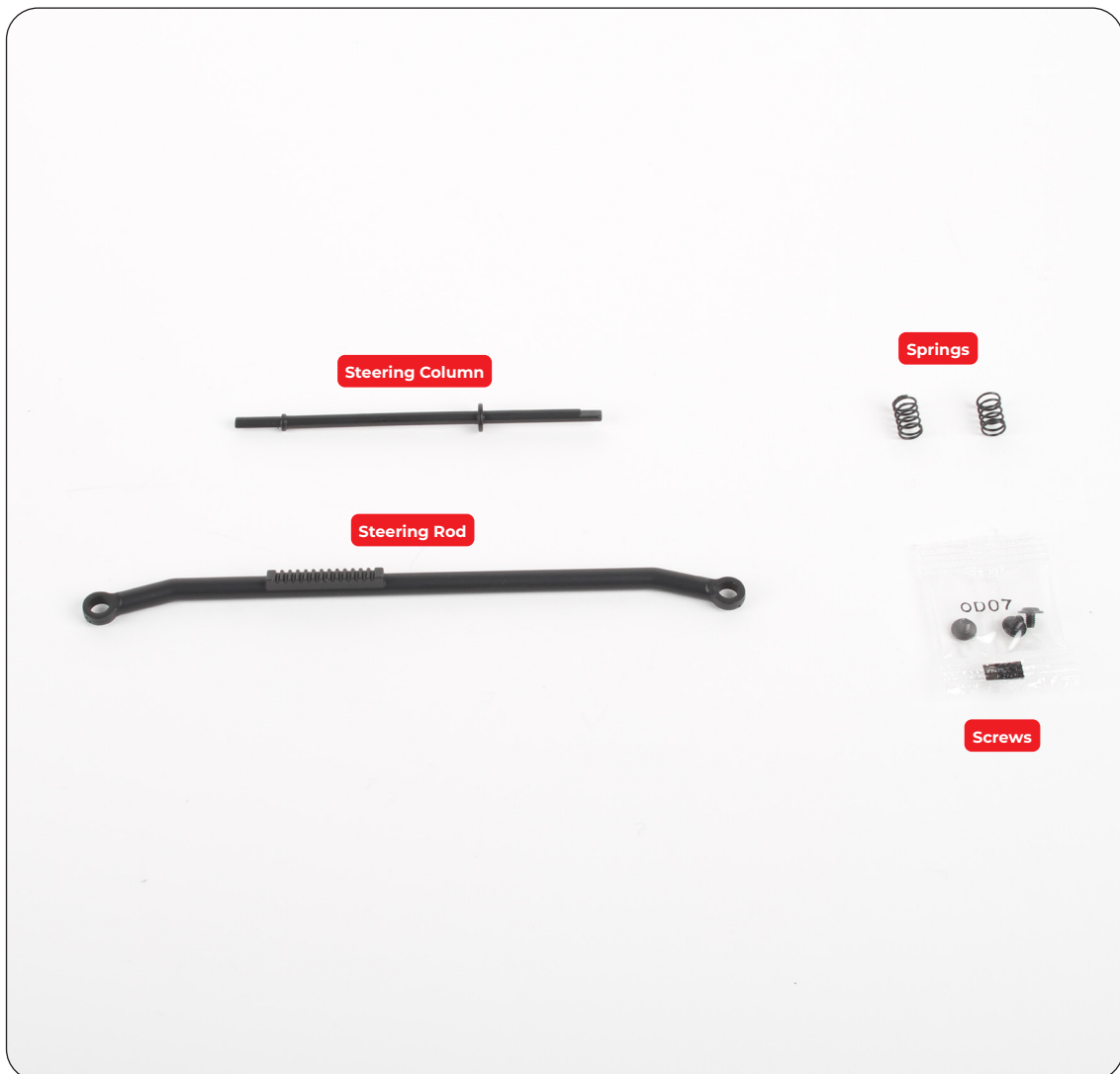

Stage 68: Steering Rod & Column

STEP 1

ATTACH THE STEERING WHEEL AND STEERING COLUMN TO THE DASHBOARD

Thread the notched end of the Steering Column through the cylindrical channel on the Dashboard. Push the Steering Wheel from Stage 03 onto the protruding end of the Steering Column. This may be easier if you tap gently with a hammer. Be careful not to damage the emblem or your work surface! Protect the emblem with a piece of wood. Do not hammer or push on the spokes or rim of the steering wheel as you will break it!

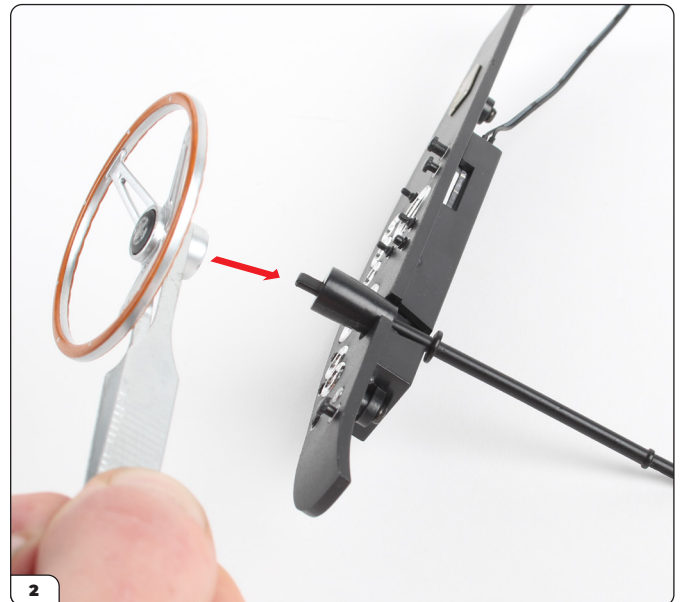

Stage 68: Steering Rod & Column

STEP 2

ATTACH THE SPRINGS AND STEERING ROD TO THE FRONT WHEELS

Place a Spring on each of the two Front Wheel Hubs (pictures 1 & 2). Align the holes at both ends of the Steering Rod over the Springs and push into place. Secure in position using 2 x OD07 screws.



ADVICE FROM THE EXPERTS

A drop of oil will help lubricate the threads and make it easier to tighten the OD07 screws.

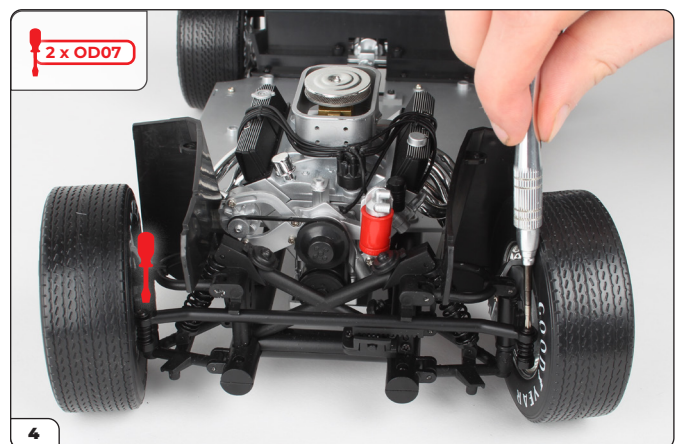
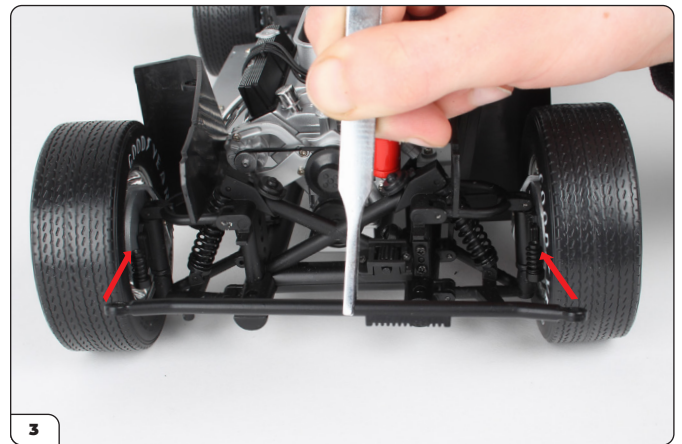
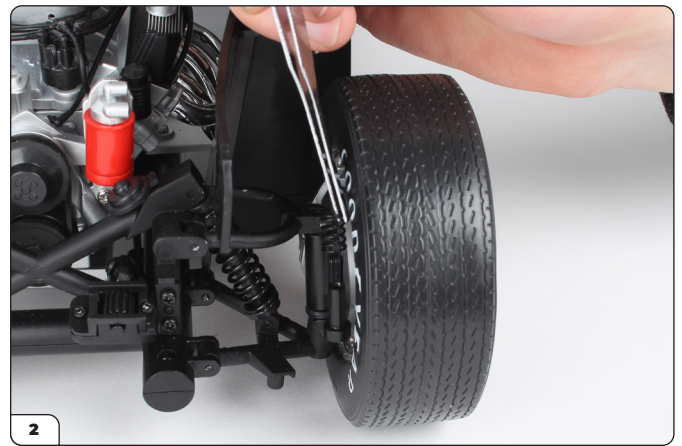
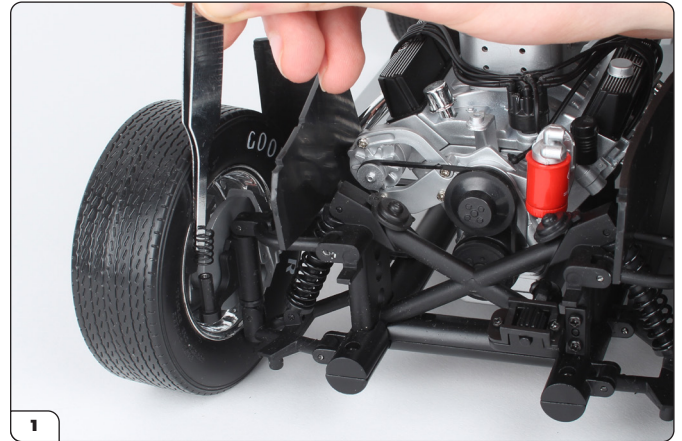

Stage 68: Steering Rod & Column

Stage 68 complete!

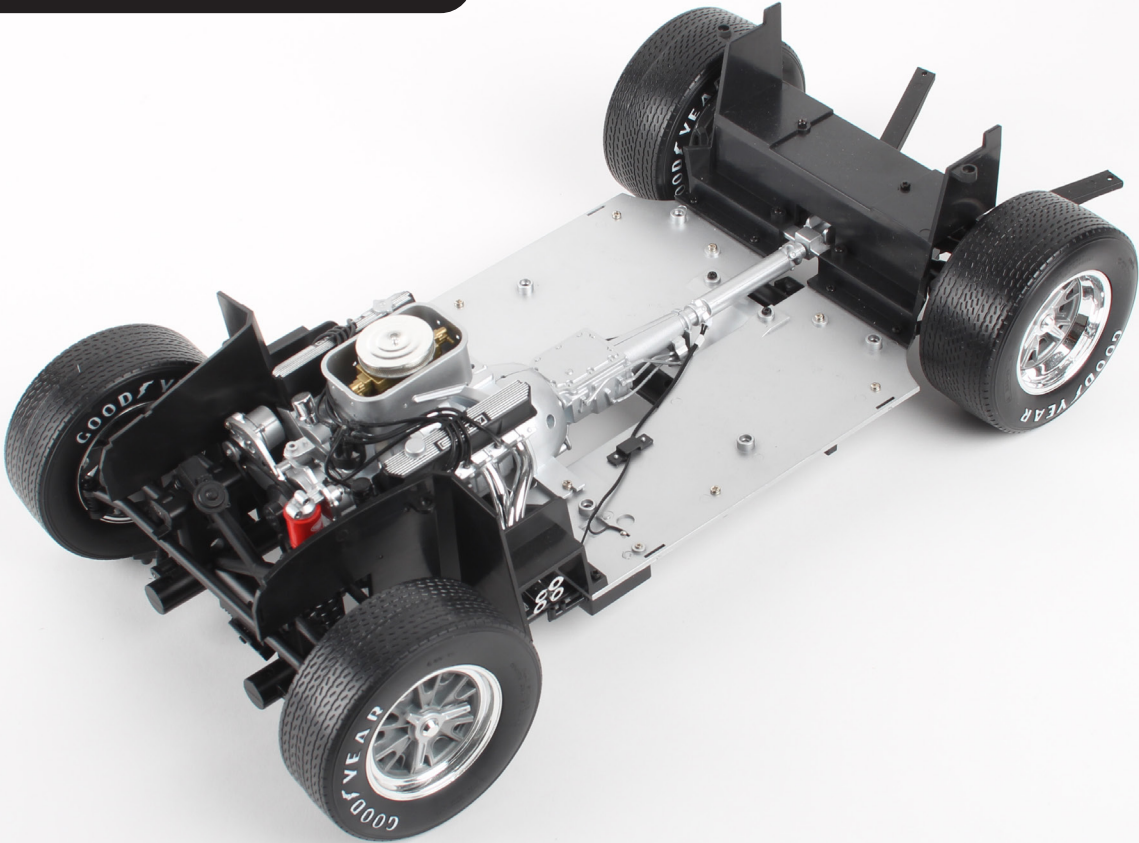

Stage 69: Trunk, Emblem & License Plate Light

In stage 69, you will assemble components for the trunk.

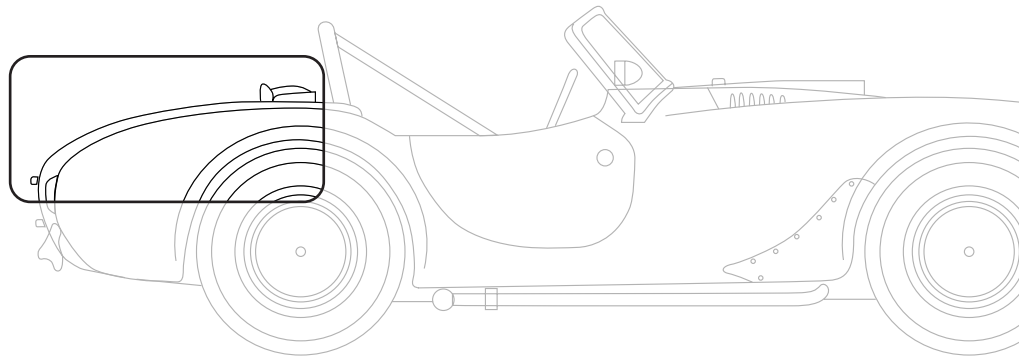

STAGE 69 PARTS LIST

Name	Quantity
Trunk	1
Trunk Emblem	1
License Plate Light	1
Trunk Latch	1
Screws Type OP10	2



Stage 69: Trunk, Emblem & License Plate Light

STEP 1

FIX THE EMBLEM, LICENSE PLATE LIGHT & LATCH TO THE TRUNK

Align the Emblem with the hole on the Trunk and press into place. Secure from the reverse using a TYPE OP10 screw. Take care to protect the paintwork on the trunk by resting on a soft cloth.

Push the License Plate Light into the upper pair of holes (picture 3), and then push the Latch into the lower pair of holes. (picture 4).

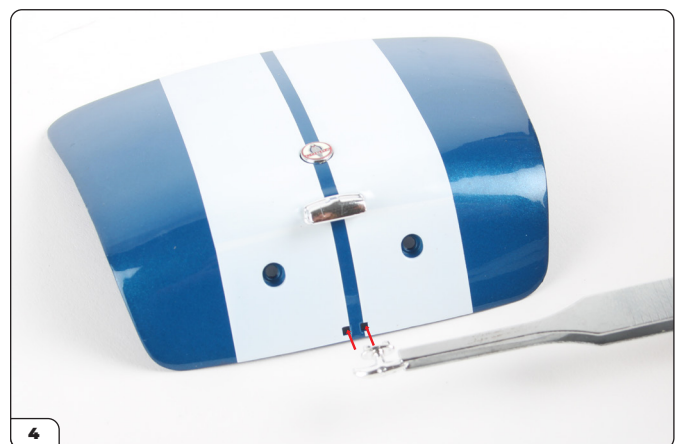

Stage 69: Trunk, Emblem & License Plate Light

Stage 69 complete!



Stage 70: Trunk Hinges, Bracket, & Rear License Plate

You'll continue with more trunk details, adding the hinges and license plate.

Did you know you can choose your own personalized license plate? Go to agoramodels.com for details.

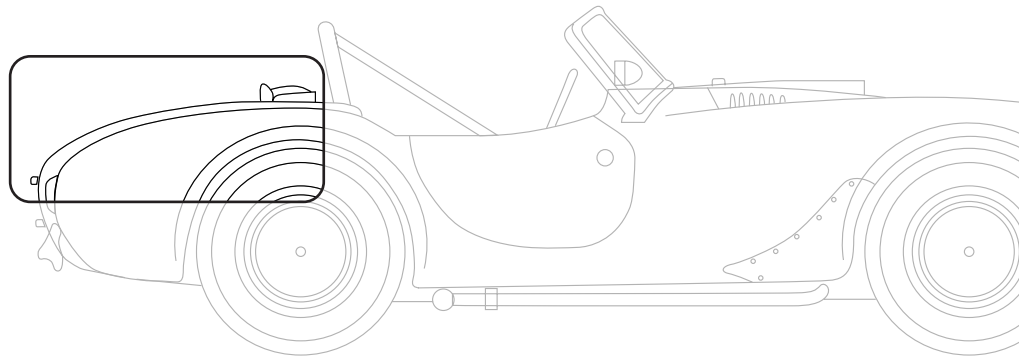

STAGE 70 PARTS LIST

Name	Quantity
Left Trunk Hinge	1
Right Trunk Hinge	1
Rear License Plate	1
Trunk Hinge Bracket	1
Screws Type OP08	3
Screws Type OD05	3



Stage 70: Trunk Hinges, Bracket, & Rear License Plate

STEP 1

ATTACH THE HINGES AND LICENSE PLATE TO THE TRUNK

Check you have protected the paintwork on the trunk before proceeding!

Align the screw hole on the Left Trunk Hinge with the corresponding hole on the Trunk. Secure in place with a TYPE OD05 screw. Repeat on the opposite side with the Right Trunk Hinge.

Position the License Plate over the two trunk holes and secure in place from the reverse side using 2 x OP08 screws.

Note: Keep the Trunk Hinge Bracket in a safe place until needed at a later stage.



Stage 70: Trunk Hinges, Bracket, & Rear License Plate

Stage 70 complete!



Stage 71: Left Door, Trim & Rivets

In stage 71, you will start to assemble the left door.

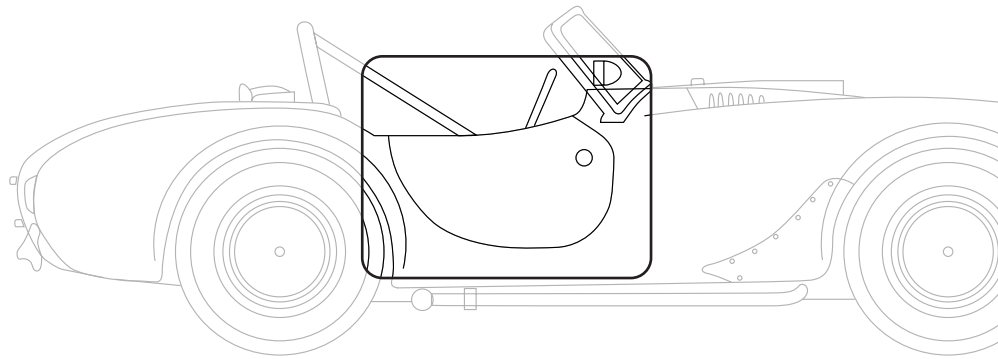

STAGE 71 PARTS LIST

Name	Quantity
Left Door	1
Left Door Trim	1
Door Top Rivets	4
Screws Type OD08	3



Stage 71: Left Door, Trim & Rivets

STEP 1

ATTACH THE DOOR TRIM AND RIVETS

Fit the Left Door Trim Inside the Left Door and fix in place using 2 x OD08 screws.

Remove the Door Top Rivets from the sprues and push into the three holes along the top of the Left door.



Stage 71: Left Door, Trim & Rivets

Stage 71 complete!



Stage 72: Left Door Hinge And Lock

You will now continue to assemble components for the left door. The spring in this stage is very small, be careful not to lose it!

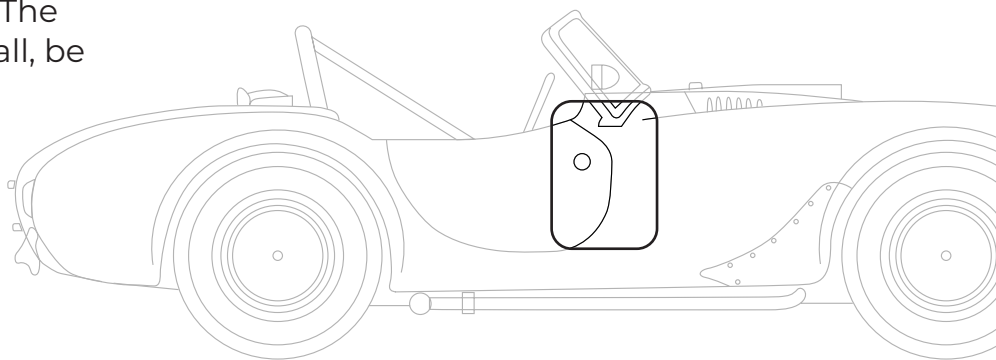

STAGE 72 PARTS LIST

Name	Quantity
Door Hinge	1
Door Hinge Cover	1
Door Lock Mechanism	1
Lock Handle	1
Spring	1
Screws Type OP02	3
Screws Type OP15	2

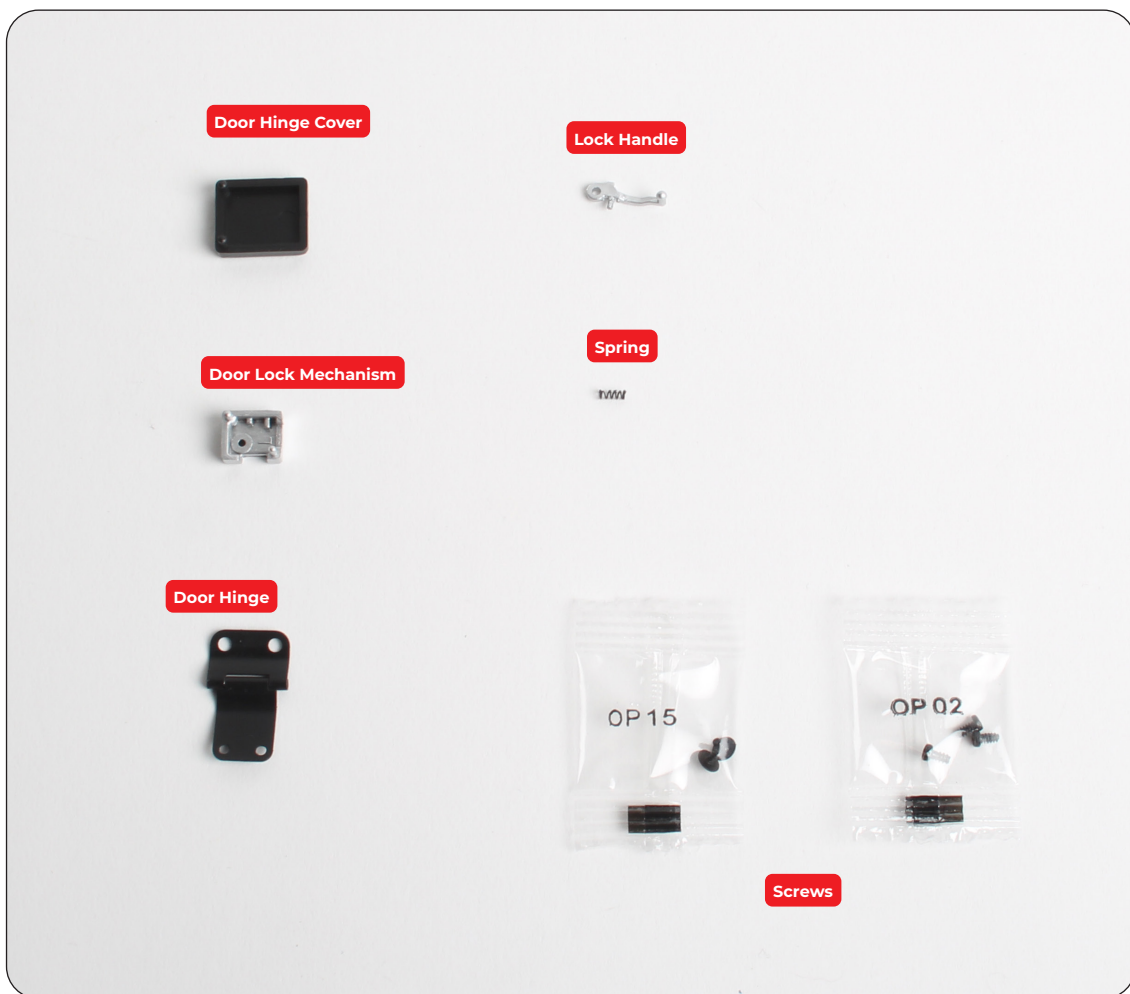

Stage 72: Left Door Hinge And Lock

STEP 1

ASSEMBLE THE LOCK

Position the Spring over the peg on the Lock Handle. Lower this assembly into the Door Lock Mechanism and secure the parts together using a TYPE OP15 screw.

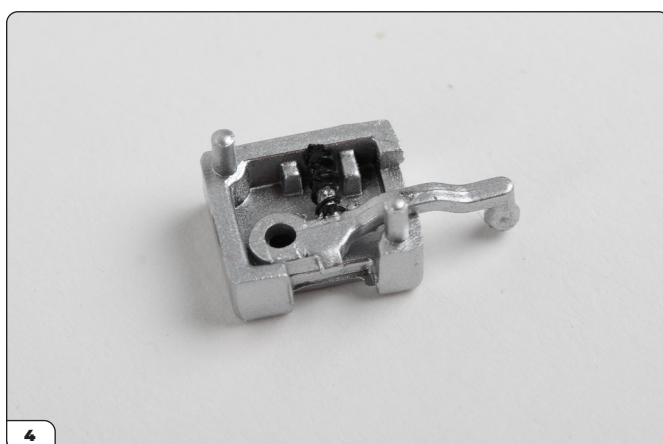
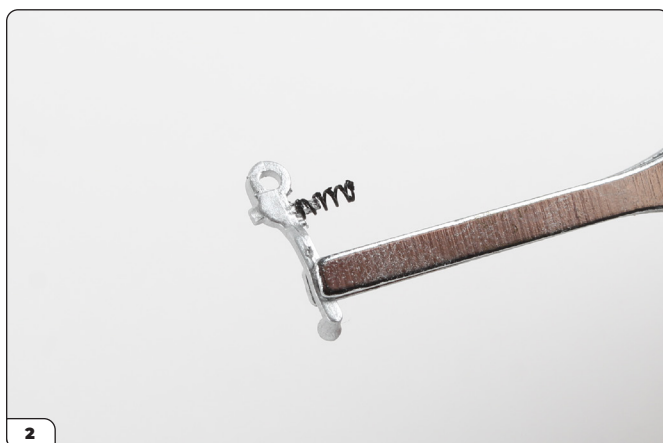
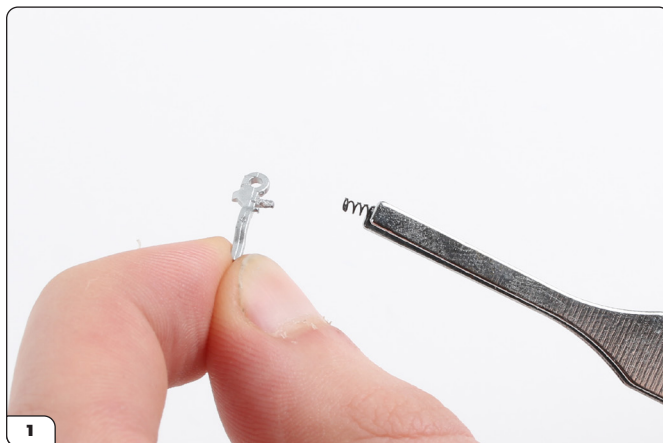

Stage 72: Left Door Hinge And Lock

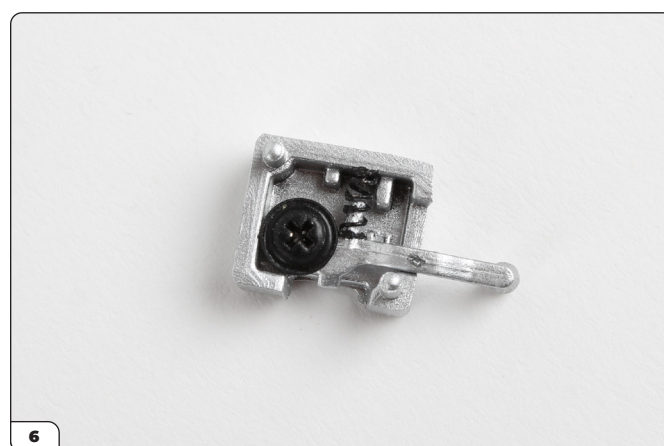

STEP 2

FIT THE HINGE TO THE DOOR

Check you have the Door Hinge in the correct orientation before fixing it to the door using 2 x OP02 screws.



Stage 72: Left Door Hinge And Lock

CONTINUED...

Lower the Door Hinge Cover over the Hinge, pressing the tiny lugs into the corresponding holes, and push/snap into place..



STEP 3

FIT THE LOCK TO THE DOOR

Push the lugs on the door lock assembly into their corresponding holes on the door until they are firmly in place. Gently test the movement of the handle.



Stage 72: Left Door Hinge And Lock

Stage 72 complete!



Stage 73: Right Door, Trim & Rivets

In stage 73, you will start to assemble the right door.

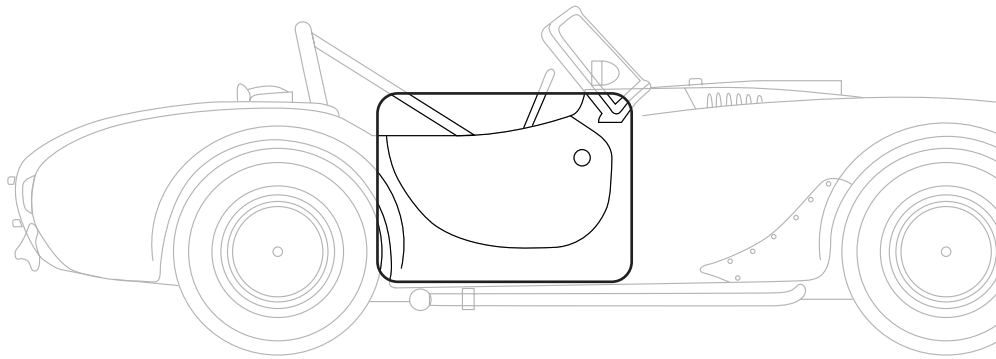

STAGE 73 PARTS LIST

Name	Quantity
Right Door	1
Right Door Trim	1
Door Top Rivets	4
Screws Type OD08	3

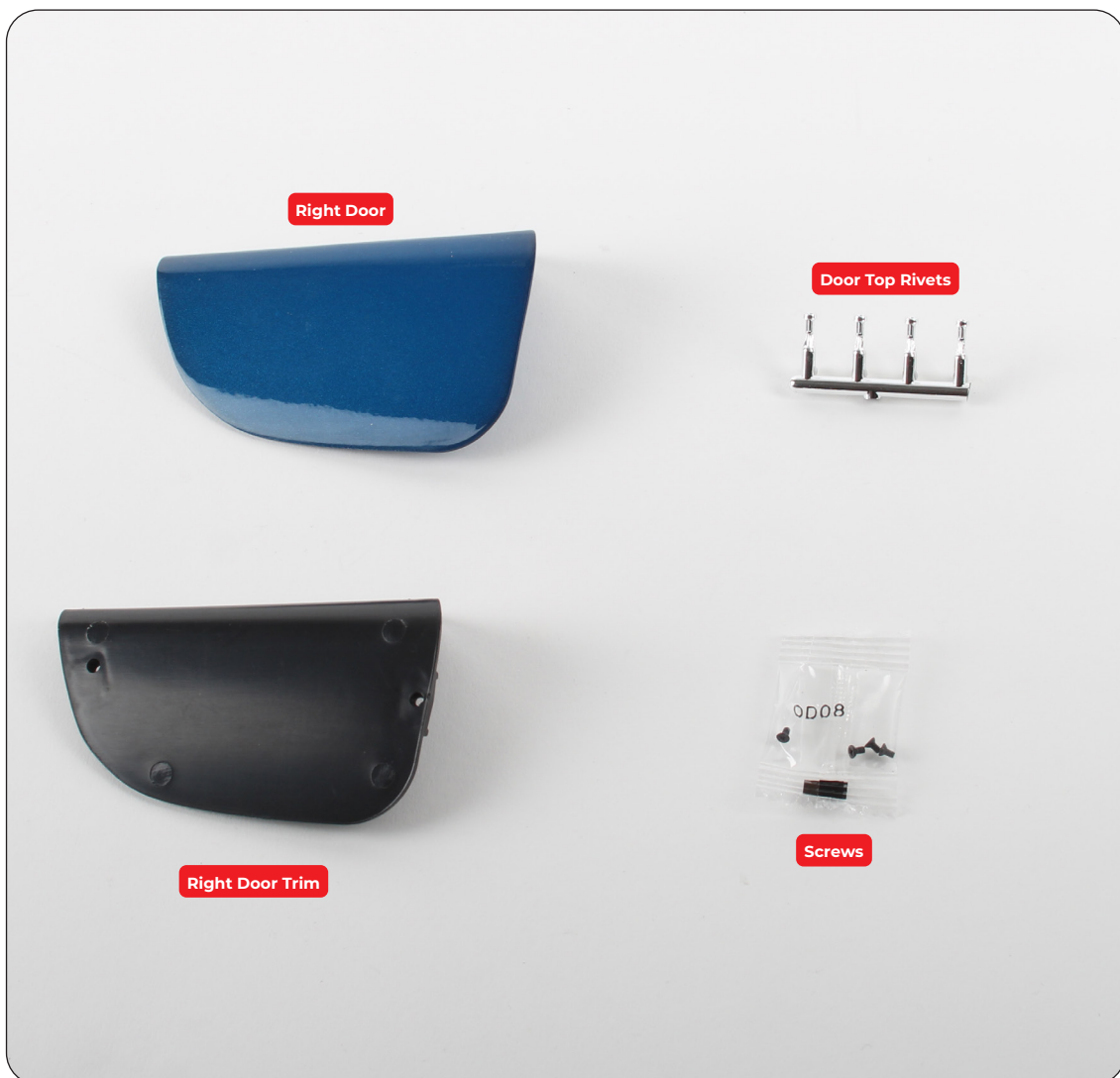

Stage 73: Right Door, Trim & Rivets

STEP 1

ATTACH THE TRIM AND RIVETS TO THE DOOR

Repeat the same process as for the Left Door:

Align the Right Door Trim with the inside of the Right Door and secure the parts together using 2 x OD08 screws

Cut the Door Top Rivets from their sprues and push them into the three holes along the top edge of the Right Door.



Stage 73: Right Door, Trim & Rivets

Stage 73 complete!

