

1967

SHELBY GT500

**SUPER
SNAKE**

1:8 SCALE



Pack 10 | Build Instructions

Your Shelby GT500 Super Snake is a finely detailed model replicating every aspect of the original car. From the paint color to the smallest interior details, every piece is precisely reproduced.

In your tenth model pack, you will assemble:

**STAGE 74: DISTRIBUTOR, SPARK PLUG
WIRE AND OIL PAN**

**STAGE 75: SIDE PANEL AND FRONT
RIGHT SHOCK ABSORBER**

**STAGE 76: ENGINE CENTRAL PANEL,
PUMP AND BRAKE FLUID RESERVOIR**

**STAGE 77: FRONT LEFT PANEL,
SPEAKER AND SUSPENSION**

**STAGE 78: BATTERY, STRUT BAR,
OIL FILTER AND PIPES**

**STAGE 79: WASHER FLUID RESERVOIR,
ELECTRONIC CIRCUIT AND WIRING**

STAGE 80: LEFT FRONT FENDER

STAGE 81: CHASSIS FRONT PANEL

STAGE 82: RIGHT FRONT FENDER

AGORA
MODELS

Stage 74: Distributor, Spark Plug Wire and Oil Pan

You will begin Pack 10 by assembling the ignition coil, attaching the distributor and then connecting up the spark wires.

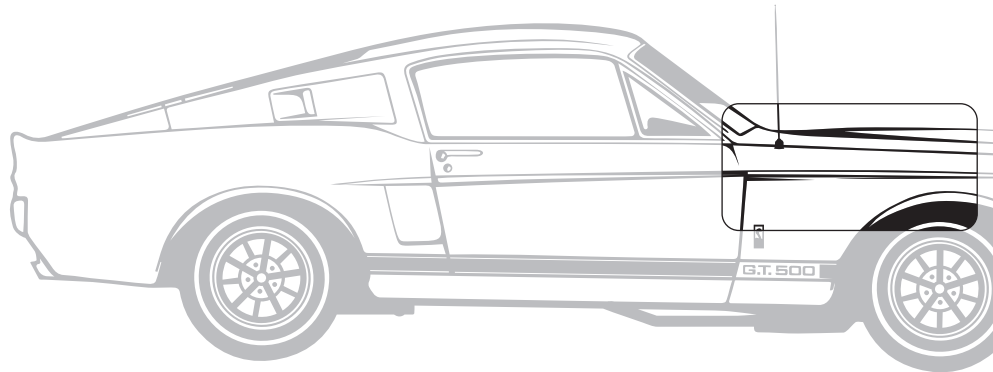

STAGE 74 PARTS LIST

Name	Quantity
Distributor	1
Spark Plug Wire	1
Spark Wire Connectors	1
Ignition Coil Top	1
Ignition Coil Bottom	1
Ignition Coil Connector	1
Breather Pipe Connector	1
Oil Pan	1
Screws TYPE MP01	3 [inc. 1 spare]
Screws TYPE MD06	2 [inc. 1 spare]



Stage 74: Distributor, Spark Plug Wire and Oil Pan

STEP 1

ASSEMBLE THE IGNITION COIL

Place the Ignition Coil Connector inside the Ignition Coil Bottom as shown. Ensure the free end on the connector points in the opposite direction to the two lugs. Hold the connector in place while you place the top on the ignition coil. Push the lugs on the ignition coil assembly onto the corresponding holes on the engine as shown. Push together until the parts click together. Push the Breather Pipe Connector into the tiny hole on the right Rocker Cover. This is a 'D' fixing to ensure the correct positioning.



ADVICE FROM THE EXPERTS

If the Breather Pipe Connector is difficult to insert, clear out any excess chrome plating from the hole with the tip of a sharp knife, and ensure that there are no burrs or flash on the D-shaped peg.

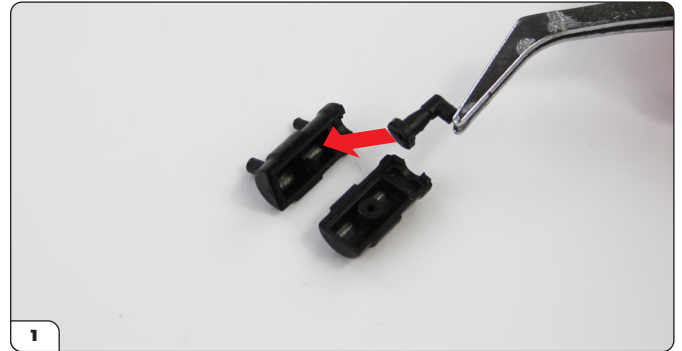

STEP 2

ATTACH THE DISTRIBUTOR

Align the Distributor with the engine assembly as shown. Fix the Distributor in place by pushing it into the corresponding hole. There is only one correct position for this part, determined by a 'D' shape.

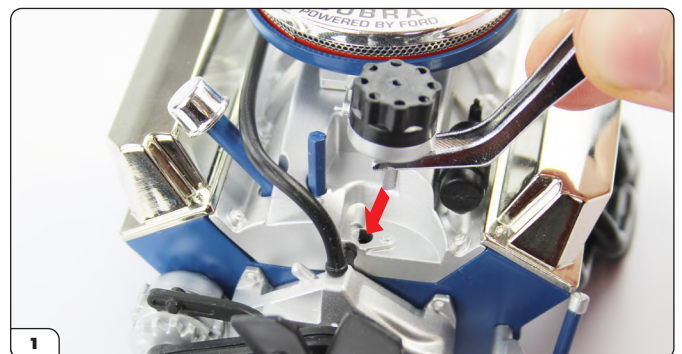

Stage 74: Distributor, Spark Plug Wire and Oil Pan

STEP 3

INSTALL THE SPARK PLUG WIRE IN THE CORRECT SEQUENCE

Cut the Spark Plug Wire into the ten lengths as shown below. Starting at position **8**, take the wire measuring 10.5 cm (4 1/8") – and push a Spark Wire Connector into one end. Attach the Connector to the Distributor in position **8**; push the free end through the furthest hole on the engine block. Repeat with the remaining three lengths of wire as illustrated in the firing sequence diagram and the pictures on the following pages. The spark wire connectors have a D-shaped peg to ensure they are correctly orientated.



ADVICE FROM THE EXPERTS

You may find it easier to glue the Spark Wire Connectors to the Spark Plug Wire with a tiny drop of superglue before attaching them to the distributor.

KEY

Position 4 : 10.5 cm (4 1/8")	Position 8 : 10.5 cm (4 1/8")
Position 3 : 10.5 cm (4 1/8")	Position 7 : 11.0 cm (4 5/16")
Position 2 : 9.0 cm (3 9/16")	Position 6 : 8.5 cm (3 3/8")
Position 1 : 9.0 cm (3 9/16")	Position 5 : 8.5 cm (3 3/8")

Plus: 3.5 cm (1 3/8")

Plus: 5.5 cm (1 3/8")

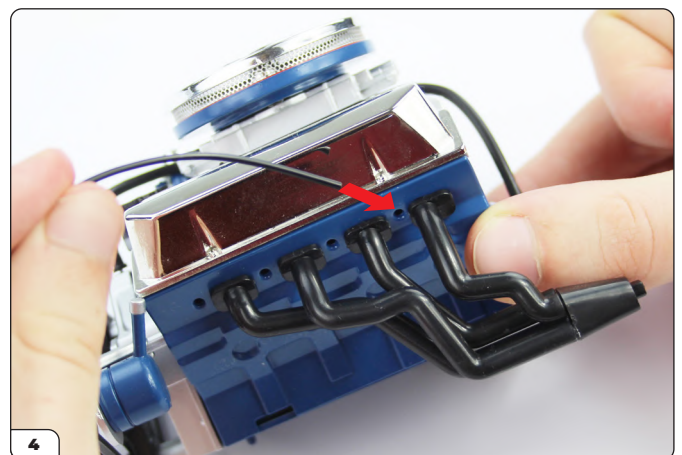
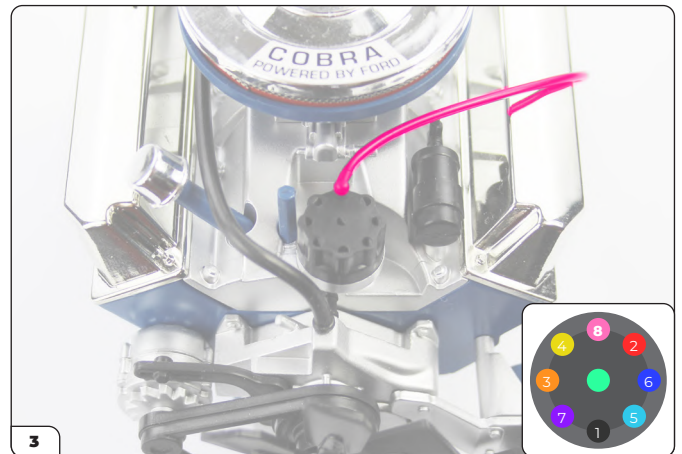
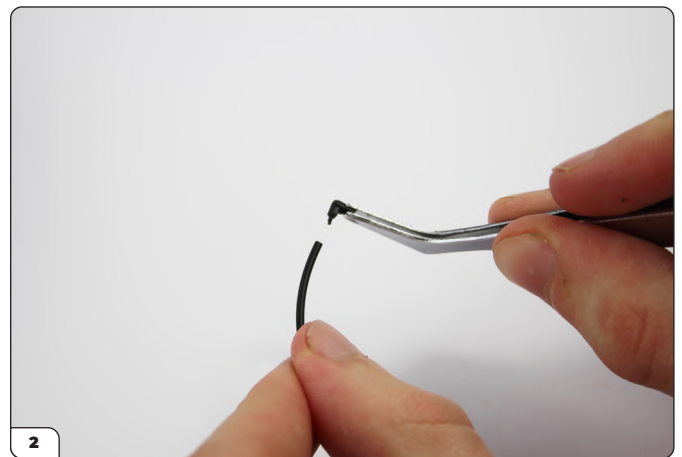
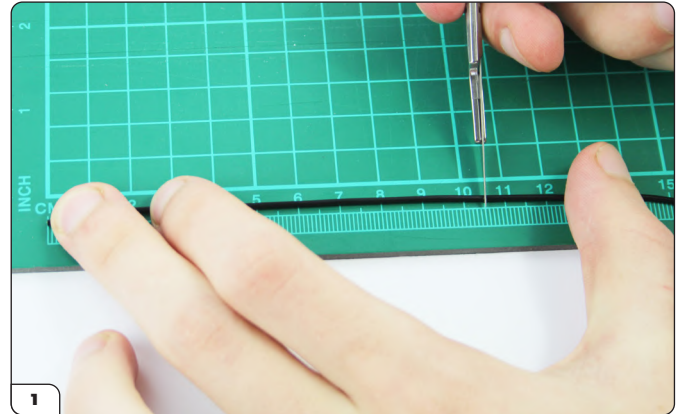
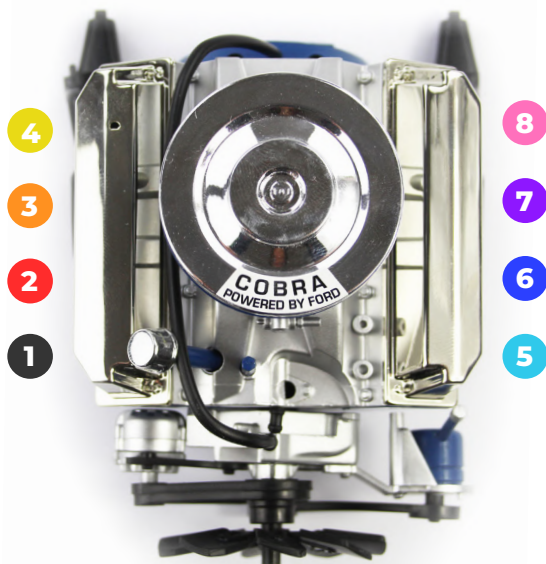

Stage 74: Distributor, Spark Plug Wire and Oil Pan

STEP 4

THE FOLLOWING PICTURES SHOW THE SPARK WIRES BEING CONNECTED IN THE ORDER 7, 6, 5.

In picture 8, the 3.5cm (1 3/8") piece of wire is attached to a connector before being fixed to the distributor as shown. Push the free end on to the ignition coil.

KEY

- | | |
|------------------------------|-------------------------------|
| Position 4: 10.5 cm (4 1/8") | Position 8: 10.5 cm (4 1/8") |
| Position 3: 10.5 cm (4 1/8") | Position 7: 11.0 cm (4 5/16") |
| Position 2: 9.0 cm (3 9/16") | Position 6: 8.5 cm (3 3/8") |
| Position 1: 9.0 cm (3 9/16") | Position 5: 8.5 cm (3 3/8") |

- Plus: 3.5 cm (1 3/8")
 Plus: 5.5 cm (1 3/8")

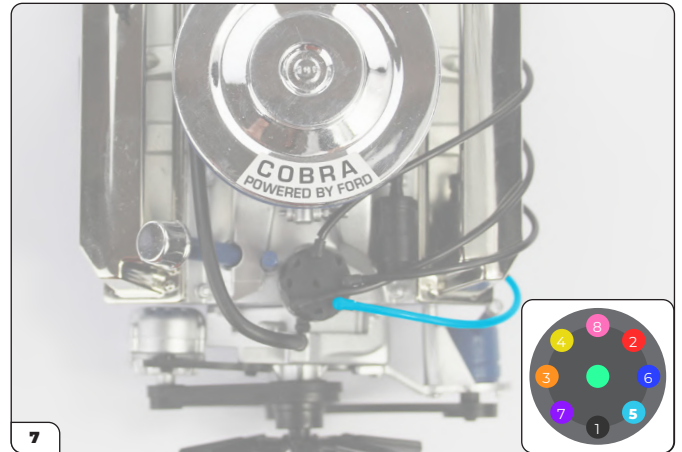
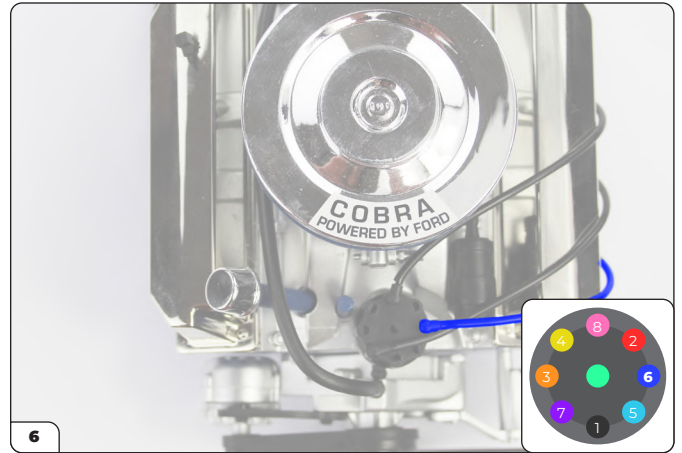

Stage 74: Distributor, Spark Plug Wire and Oil Pan

STEP 5

THE FOLLOWING PICTURES SHOW THE SPARK WIRES BEING CONNECTED FROM 4, 3, 2, 1.

In picture 13, the 5.5 cm (2 3/16") piece of wire is attached to the Breather Pipe Connector in the rocker cover at one free end and to the carburetor, just below the cylinder head cover, at the other.

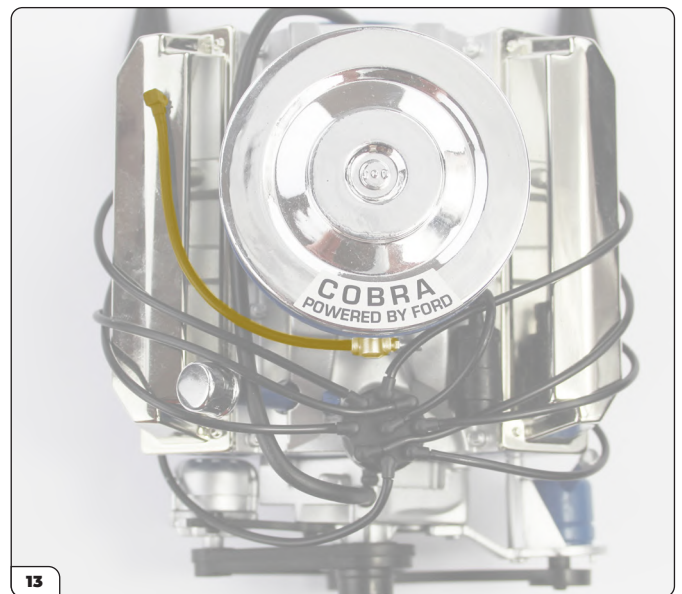
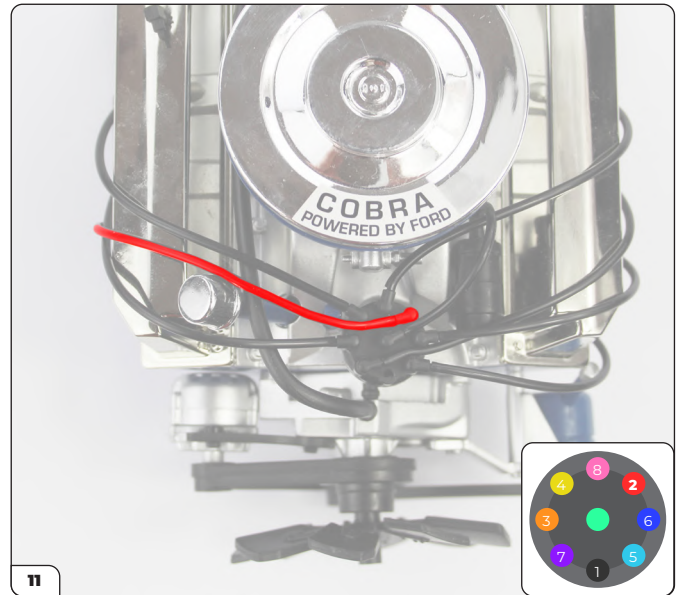
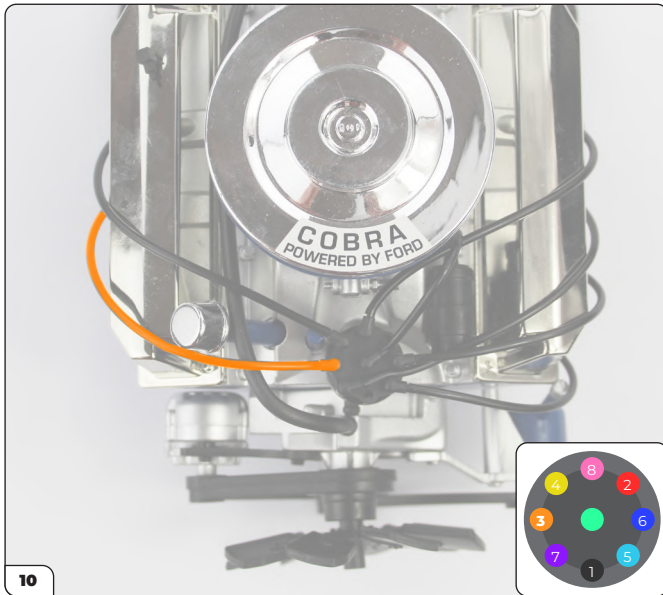
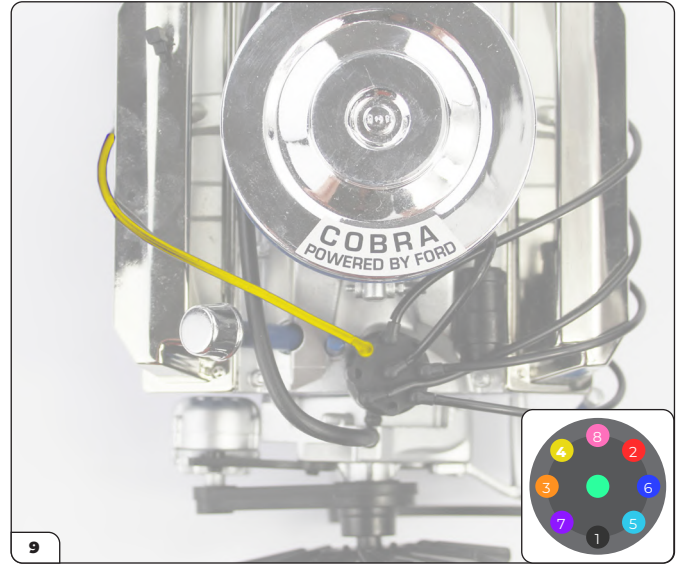

Stage 74: Distributor, Spark Plug Wire and Oil Pan

STEP 6

ATTACH THE OIL PAN

Align the lug and screw hole on the Oil Pan with the underside of the engine. Secure the two parts together using a TYPE MD06 screw.



STEP 7

MOUNT THE ENGINE ONTO THE CHASSIS

Lower the engine onto the chassis in the position shown, tucking the gearbox (leading edge of the engine) under to allow the two blue gearbox sections to interlock and the screw holes to align. Check that the exhaust manifolds fit into the exhaust pipes underneath. **Make sure the wires aren't trapped under the engine** before fixing it to the chassis using 2 x TYPE MP01 screws.

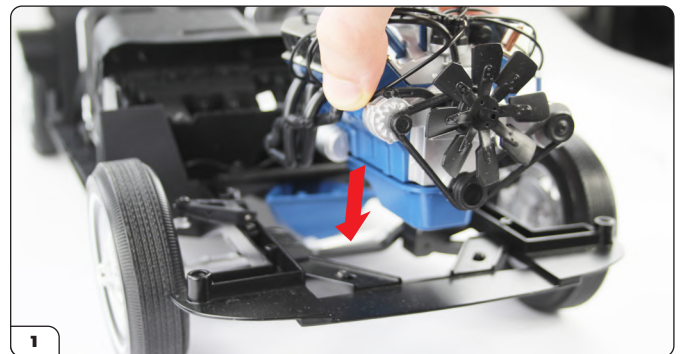

! ADVICE FROM THE EXPERTS

In stage 79 you will be connecting up some of the wiring. As you work your way through the stages, keep checking that you can see the numbered wires and that none have become trapped at any stages of the build. You have assembled wires 1-4 so far.

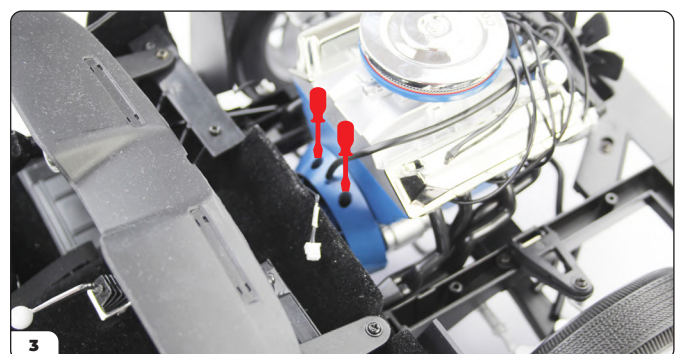
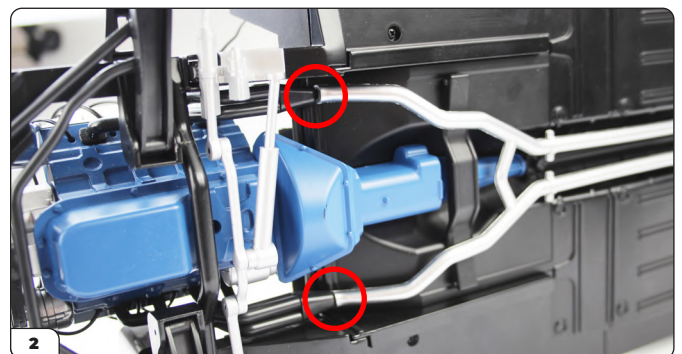

Stage 74: Distributor, Spark Plug Wire and Oil Pan

Stage 74 complete!

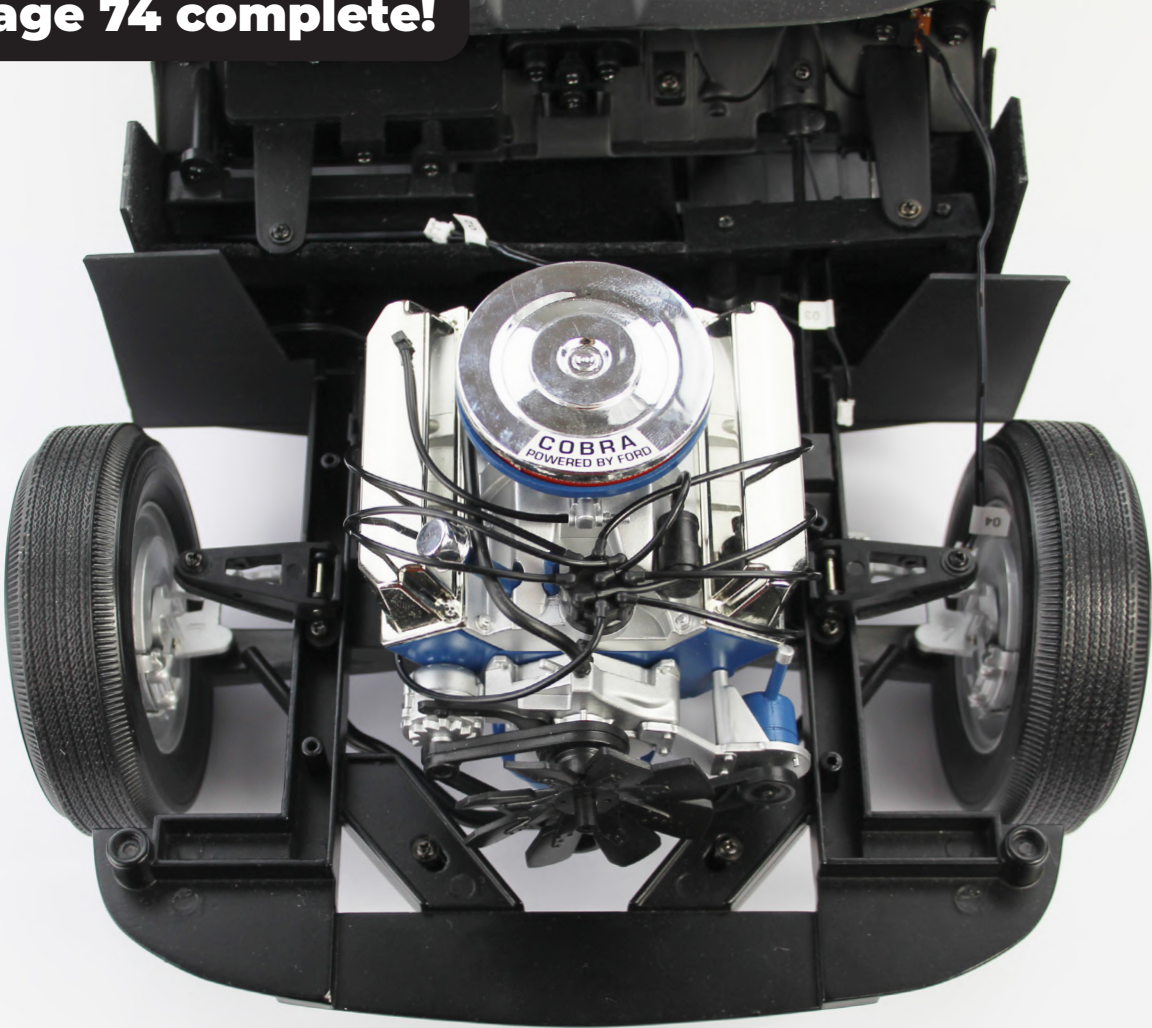

Stage 75: Side Panel And Front Right Shock Absorber

You will continue to build the engine compartment.

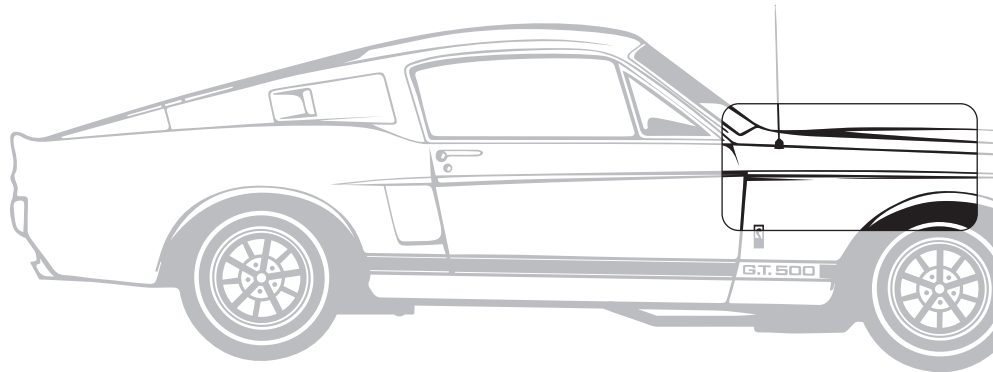

STAGE 75 PARTS LIST

Name	Quantity
Shock Absorber Piston	1
Piston Pin	1
Shock Absorber Cylinder	1
Front Right Side Panel	1
Shock Absorber Spring	1
Screws TYPE MD06	3 [inc 1 spare]
Screws TYPE MP01	4 [inc 1 spare]
Screws TYPE MD02	7 [inc 1 spare]

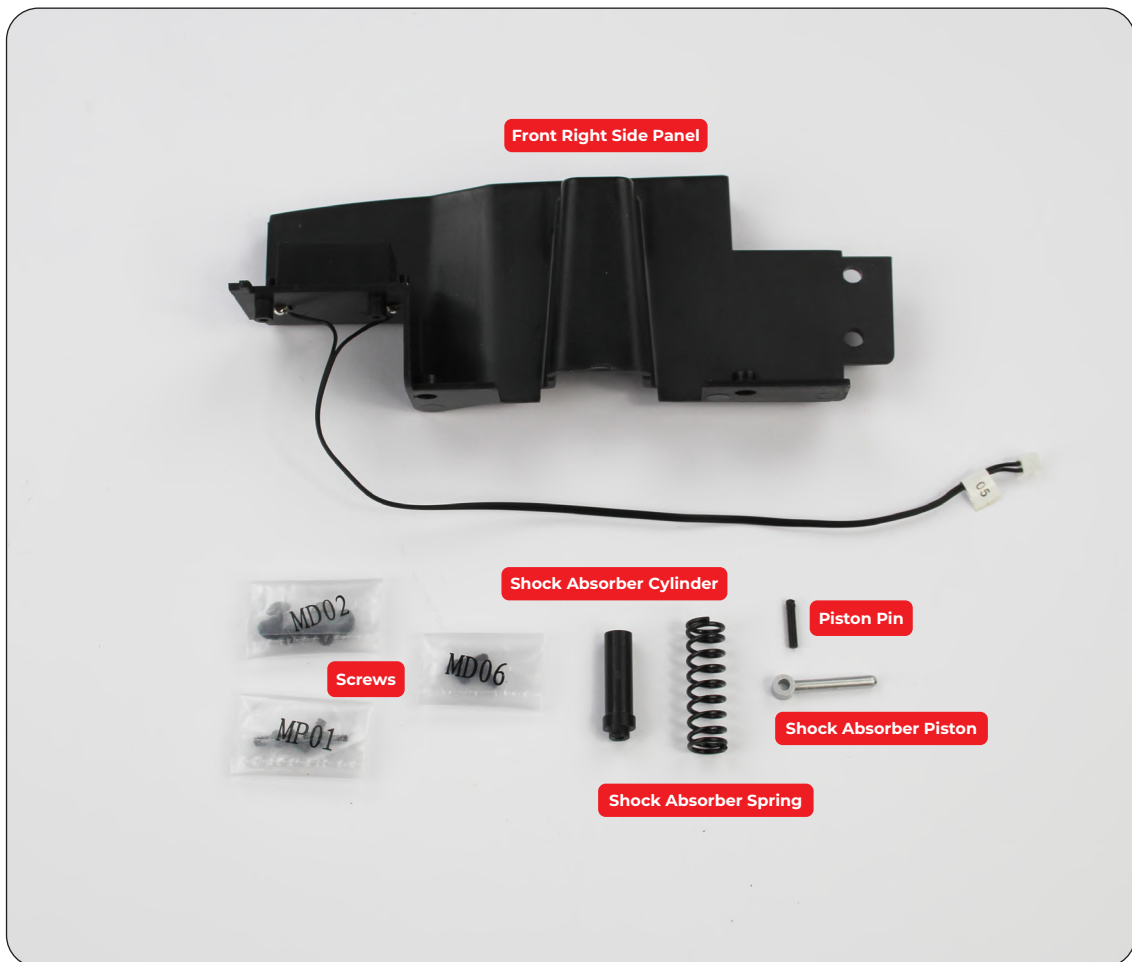

Stage 75: Side Panel And Front Right Shock Absorber

STEP 1

ADD THE SHOCK ABSORBER PISTON

Place the Shock Absorber Piston in the front right wheel suspension arm. Then insert the Piston Pin through both holes in the suspension arm to hold the piston in place. Squeeze the pin into place using pliers to ensure it reaches all the way through the suspension arm.

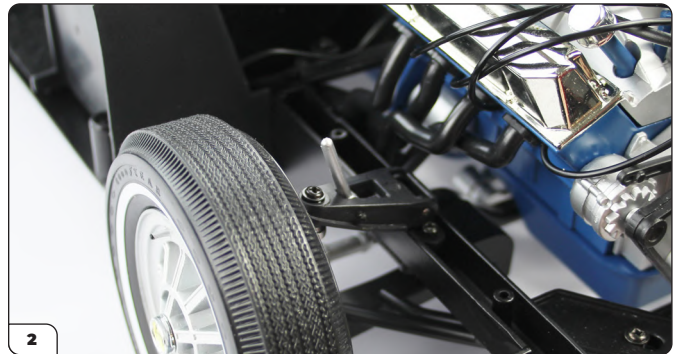
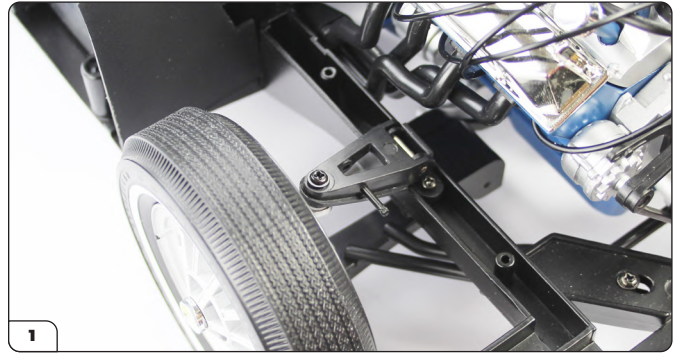

STEP 2

FIT THE SHOCK ABSORBERS

Fit the Shock Absorber Cylinder to the Front Right Side Panel as shown. There is only one way to fit these parts, determined by their shape. Secure in place from underneath using a TYPE MP01 screw.

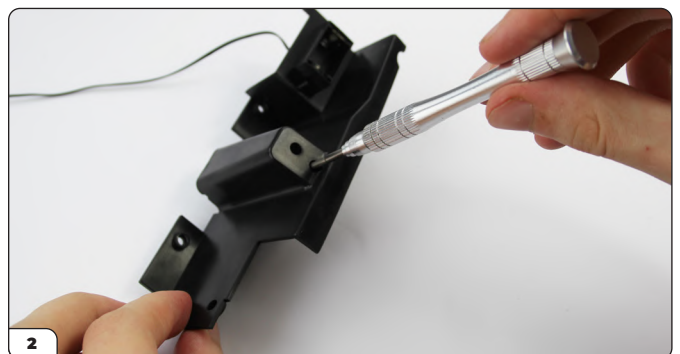

Stage 75: Side Panel And Front Right Shock Absorber

STEP 3

ATTACH THE RADIATOR

Align the screw holes on the radiator assembly and the Front Right Side Panel as shown. Be careful not to trap the wires under the radiator bracket. Secure the parts together using 2 x TYPE MP01 screws. Slide the Spring over the Shock Absorber Cylinder on the Side Panel.

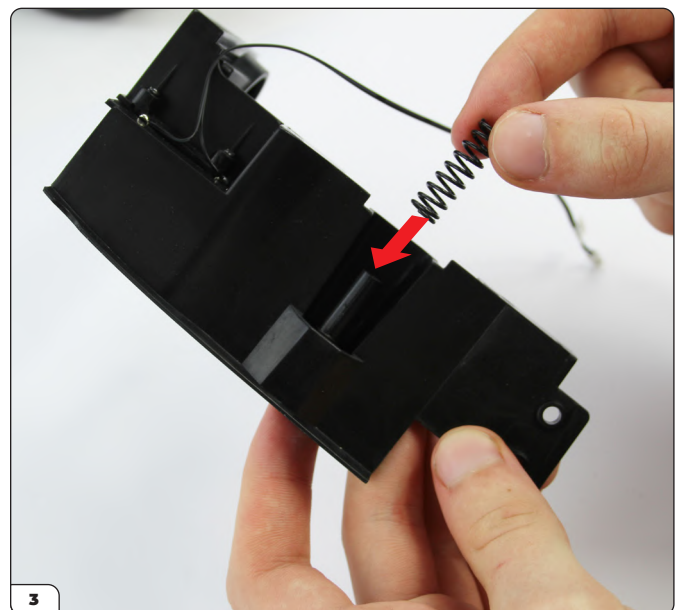
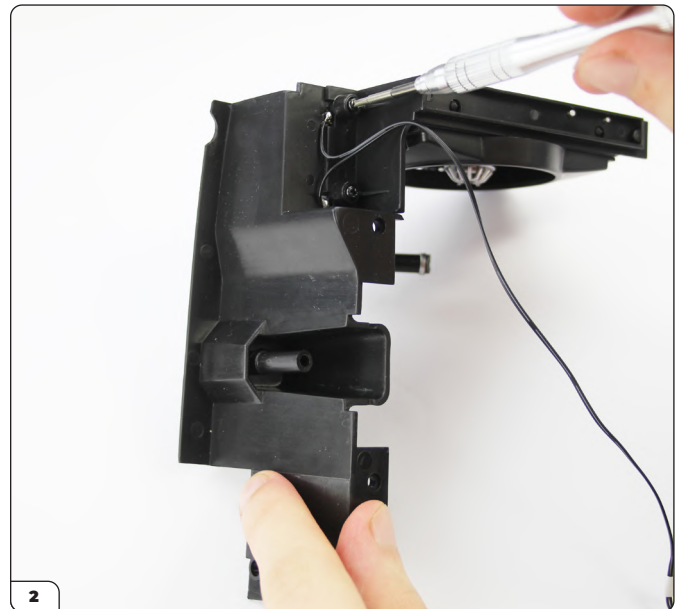

Stage 75: Side Panel And Front Right Shock Absorber

STEP 3

CONTINUED...

Before continuing, check that the four small dimples in the fan hub are at 3, 6, 9 & 12 o'clock.

Hold the Spring in place as you lower the side panel/ Radiator assembly over the Shock Absorber Piston onto the chassis. Check that the peg on the fan fits into the fan bracket on the radiator. You may need to lift the engine to get it to locate easily. Also check that the end of the radiator hose fits over the the peg on the engine front housing. Fix in place using 2 x MD06 screws.



ADVICE FROM THE EXPERTS

Hold the spring in place with a piece of masking tape.

This step might be easier if you remove the radiator hose from the top of the radiator. It's easily pushed back on after the radiator is screwed in place.

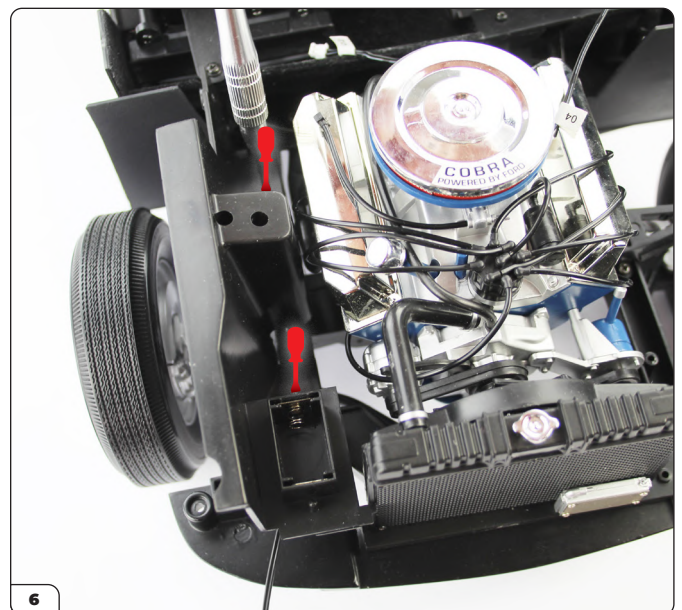
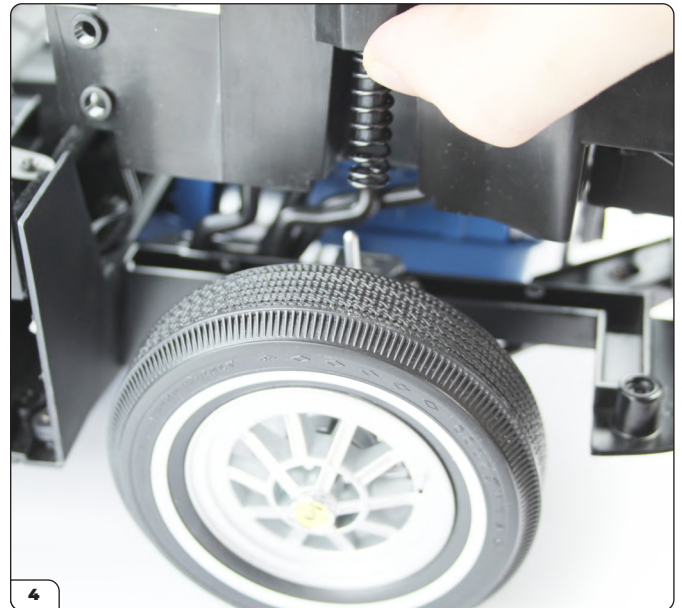

Stage 75: Side Panel And Front Right Shock Absorber

Stage 75 complete!

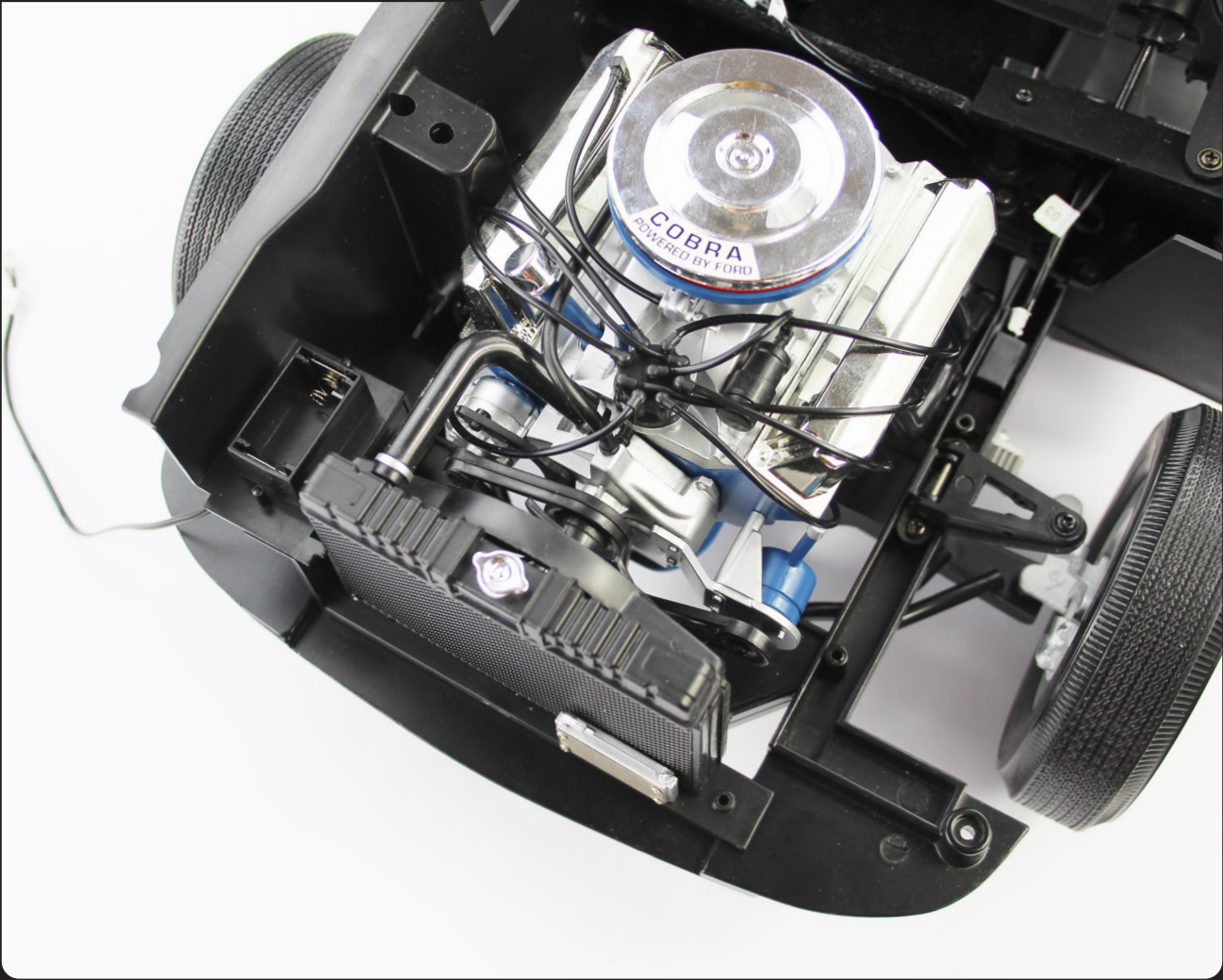

Stage 76: Engine Central Panel, Pump And Brake Fluid Reservoir

You will continue to assemble the engine compartment.

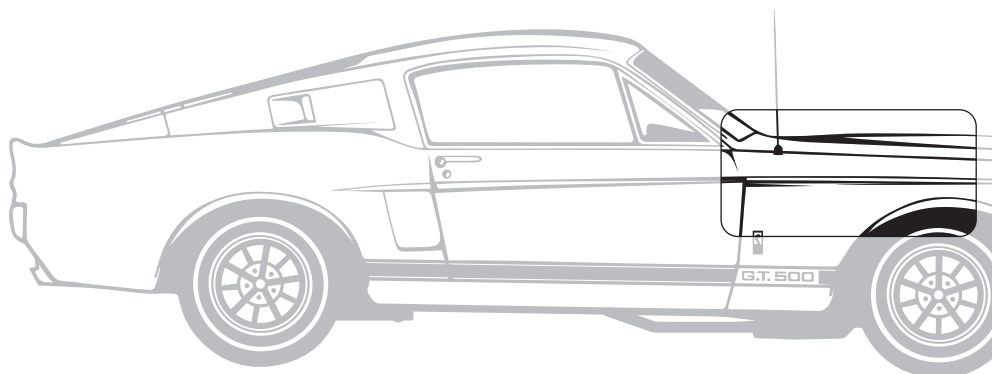

STAGE 76 PARTS LIST

Name	Quantity
Brake Fluid Reservoir	1
Brake Fluid Reservoir Support	1
Engine Partition	1
Screws TYPE MP01	2 [including 1 spare]
Screws TYPE MP03	3 [including 1 spare]

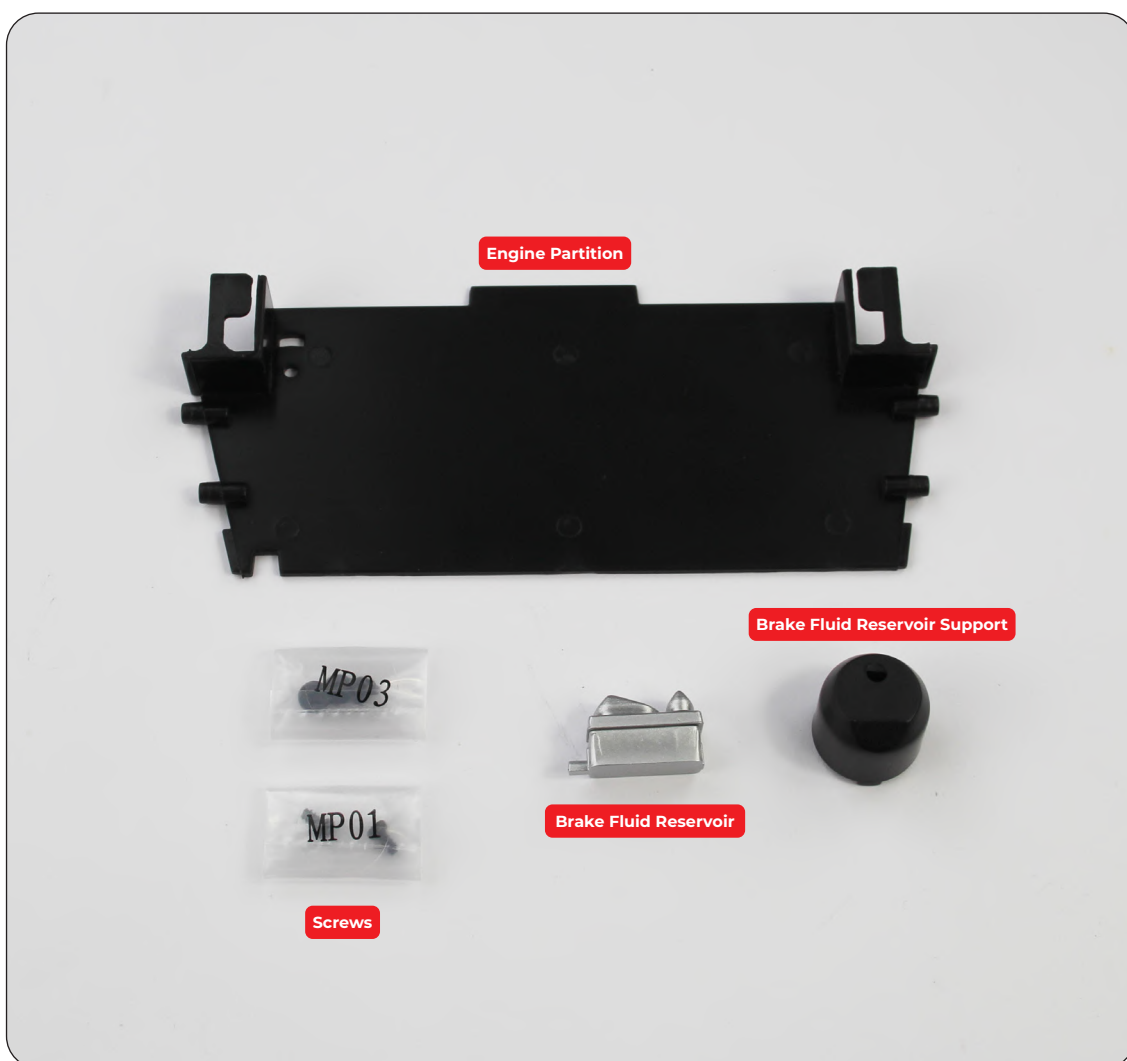

Stage 76: Engine Central Panel, Pump And Brake Fluid Reservoir

STEP 1

ATTACH THE BRAKE FLUID RESERVOIR TO THE SUPPORT

Align the Brake Fluid Reservoir with the Support as shown. There is only one way to fit these pieces together. Press together firmly for a perfect fit.



STEP 2

ATTACH THE BRAKE FLUID RESERVOIR TO THE ENGINE PARTITION

Align the tenon on the Reservoir Support with the hole in the Engine Partition as shown. Fix the parts together from the reverse side using a TYPE MP01 screw.

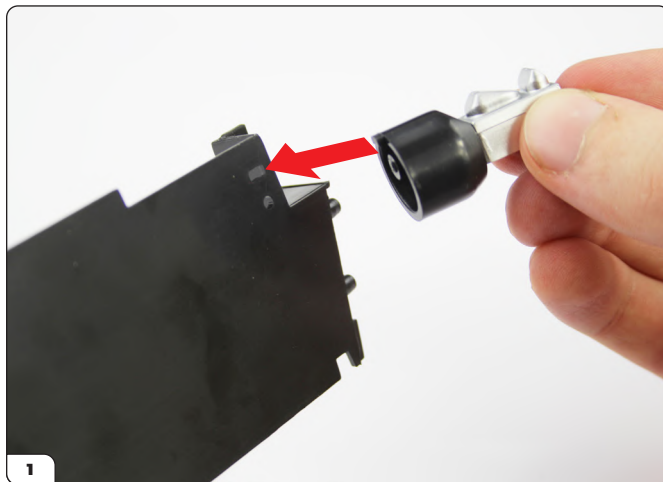

Stage 76: Engine Central Panel, Pump And Brake Fluid Reservoir

STEP 3

ATTACH THE ENGINE PARTITION TO THE CHASSIS

Carefully lift all the wiring to the sides before lowering the Engine Partition onto the chassis. Fix in place using 2 x TYPE MP03 screws.

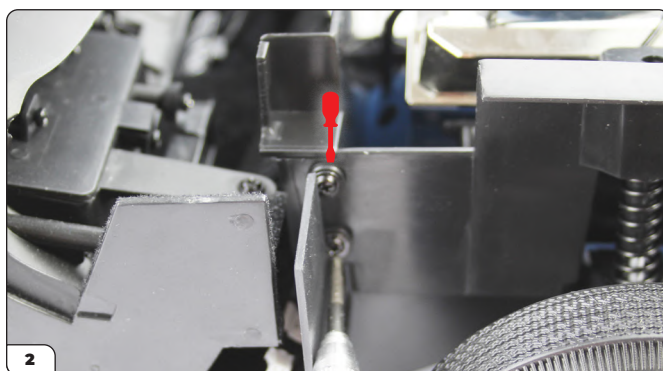
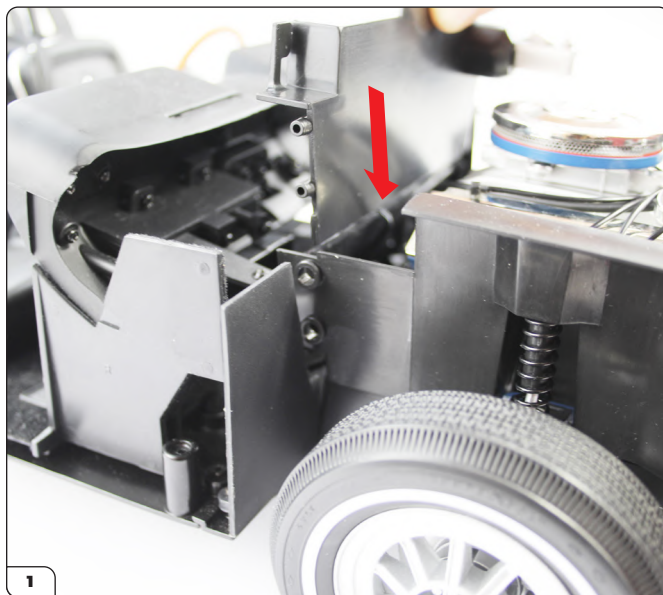

Stage 76 complete!

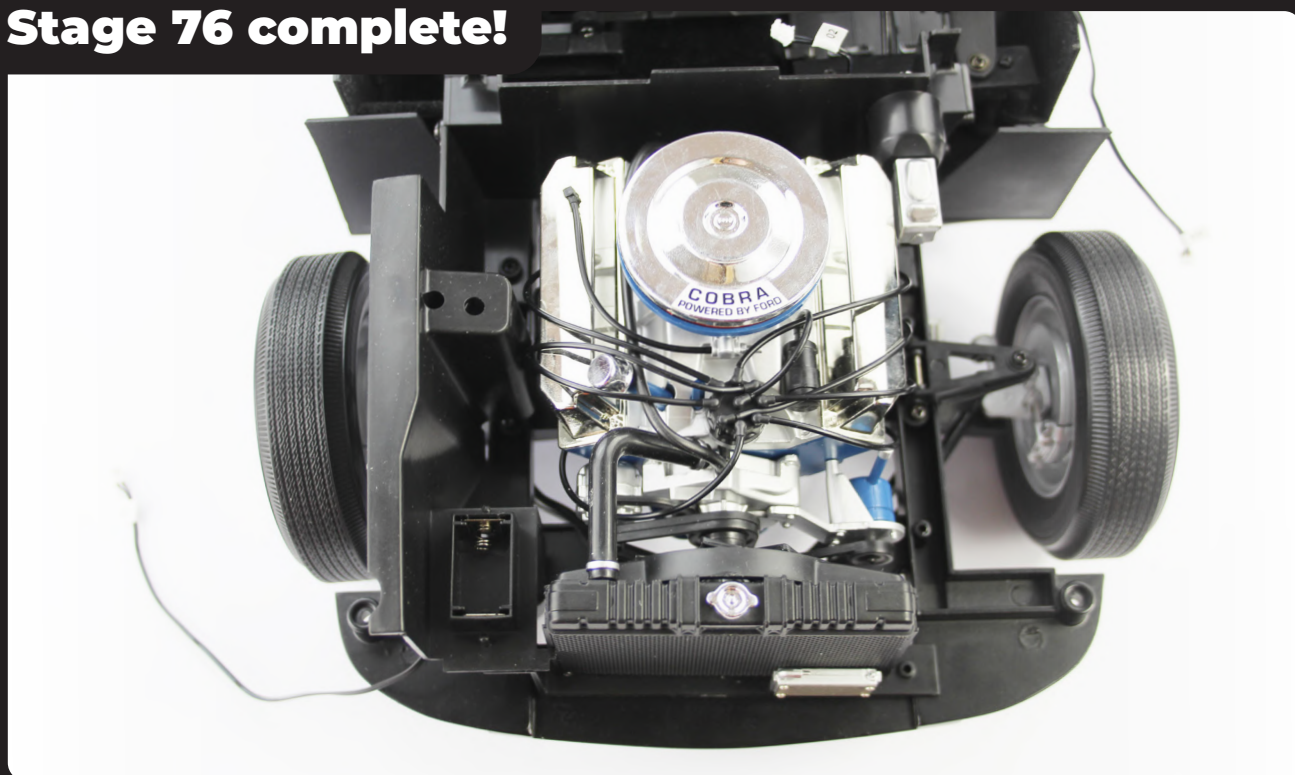

Stage 77: Front Left Panel, Speaker And Suspension

You will continue to assemble the engine compartment.

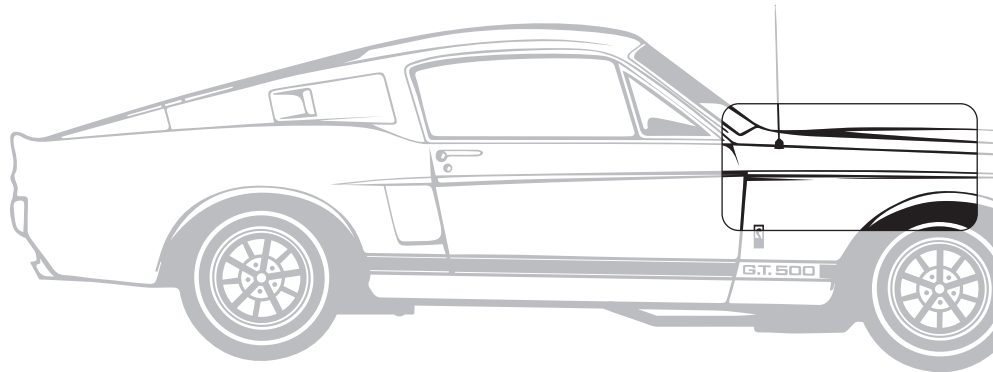

STAGE 77 PARTS LIST

Name	Quantity
Shock Absorber Cylinder	1
Left Front Panel	1
Speaker	1
Speaker Support	1
Piston	1
Piston Pin	1
Shock Absorber Spring	1
Screws TYPE MP03	3 [including 1 spare]
Screws TYPE MD06	3 [including 1 spare]
Screws TYPE MP01	5 [including 1 spare]

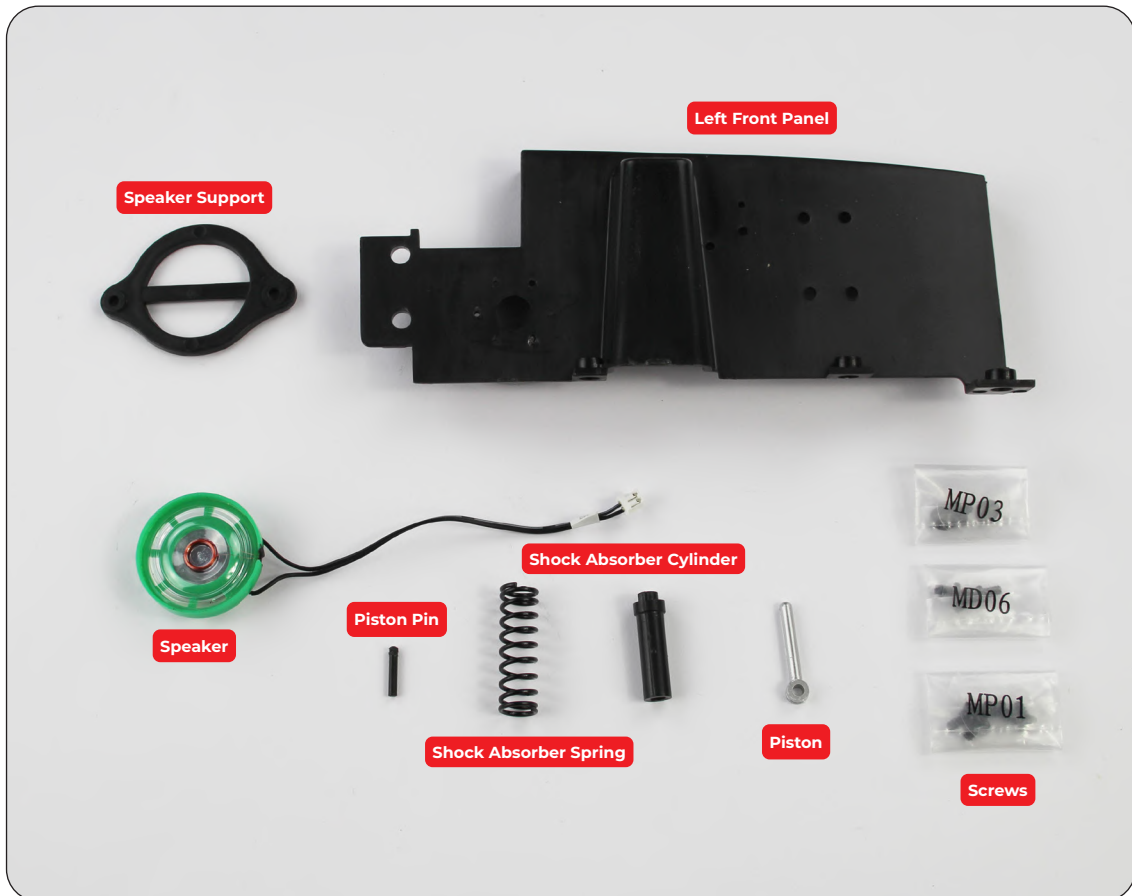

Stage 77: Front Left Panel, Speaker And Suspension

STEP 1

ATTACH THE PISTON

Place the Piston in the left front wheel suspension arm, just as you did for the right front wheel suspension. Insert the Piston Pin through the holes in the suspension arm, just as far as the ridges on the end of the pin. Squeeze into place with pliers, checking that the leading end goes all the way through to the other side of the suspension arm.

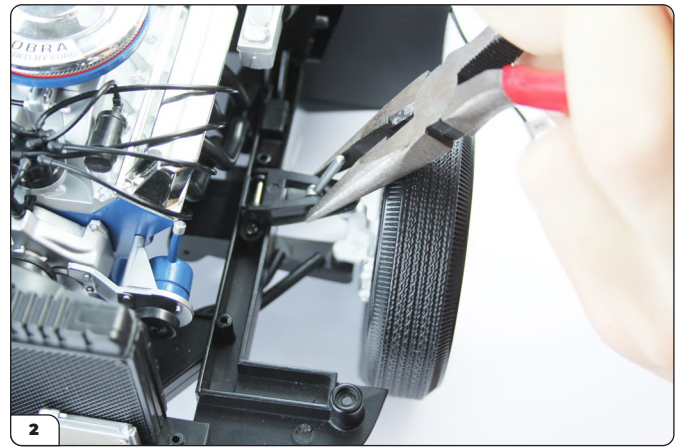
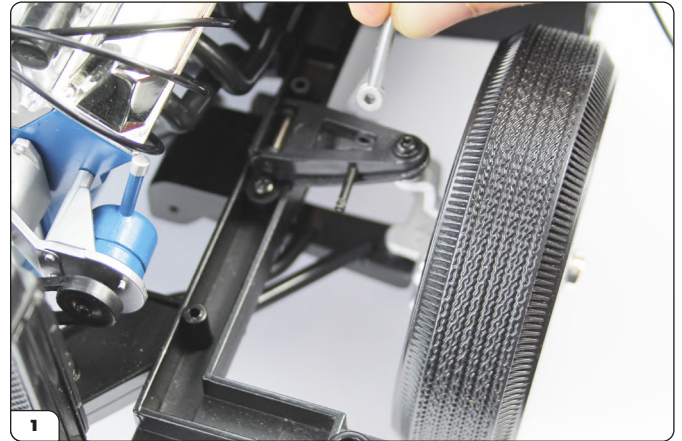

STEP 2

ASSEMBLE THE LEFT FRONT PANEL

Fit the Shock Absorber Cylinder to the Left Front Panel. This can only be fitted in one position. Secure on the reverse side with a TYPE MP01 screw.

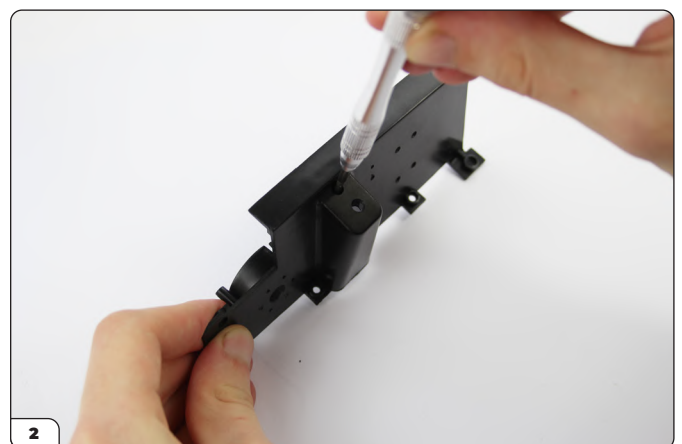

Stage 77: Front Left Panel, Speaker And Suspension

STEP 3

ATTACH THE SPEAKER

Orient the speaker as shown and place it in position on the front panel. Note: the two speaker cables must pass either side of the tab (picture 2). Then align the screw holes on the Speaker Support with the screw holes on the front panel. Secure in place using 2 x TYPE MP01 screws.

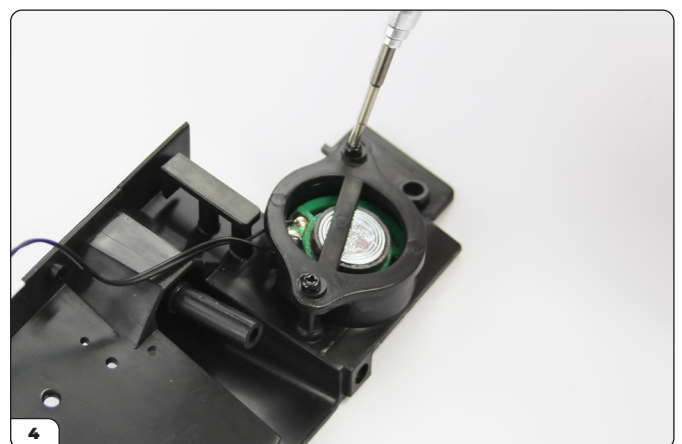
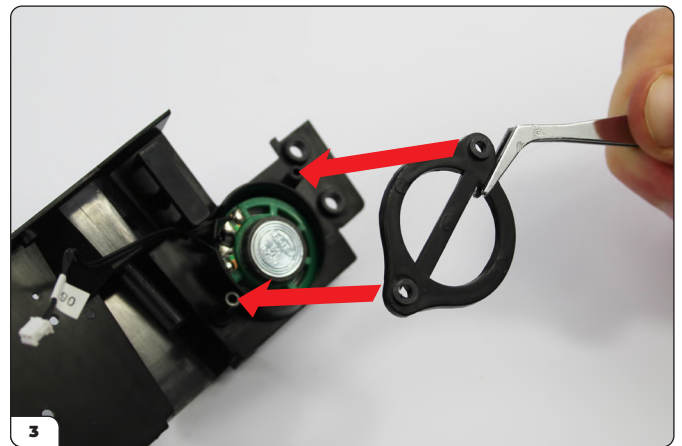
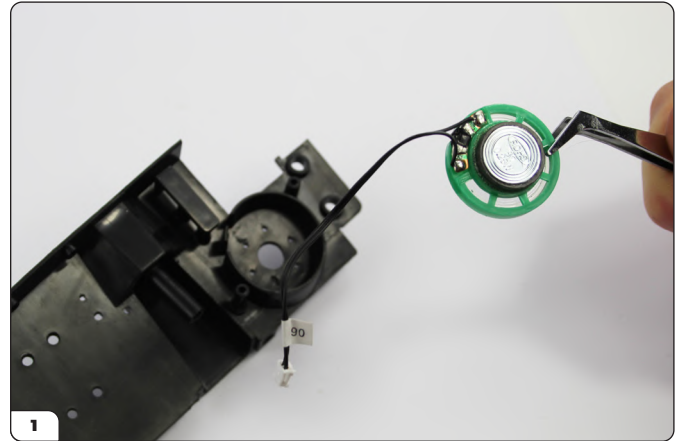

Stage 77: Front Left Panel, Speaker And Suspension

STEP 4

ATTACH THE LEFT FRONT SIDE PANEL

Position the Shock Absorber Spring on top of the Shock Absorber Cylinder fitted in Step 2. Then, holding the panel and the spring, fit the parts onto the left side of the chassis. The Piston must fit into the shock absorber cylinder under the spring. Check that the interlocking assembly points on the side panel are correctly fitted to the central panel. Secure the side panel to the chassis using 1 x TYPE MP01 screw and 2 x MD06 screws.



ADVICE FROM THE EXPERTS

Hold the spring in place with some masking tape.

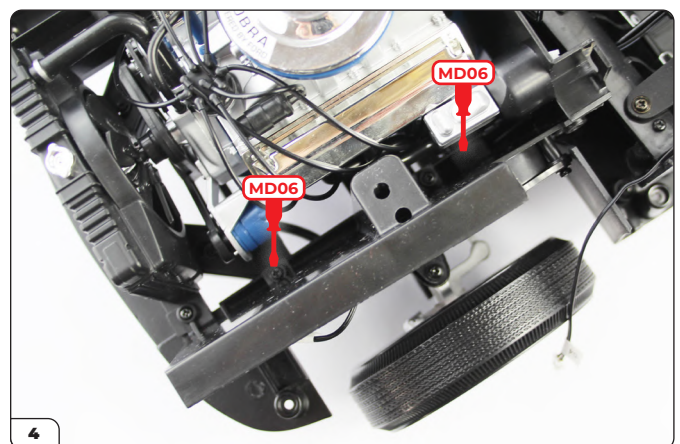
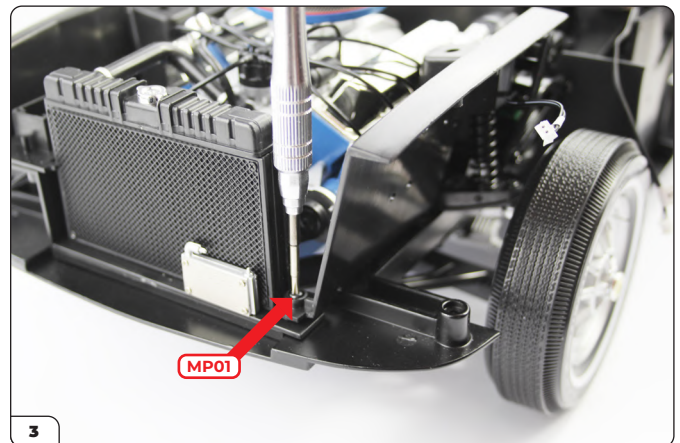
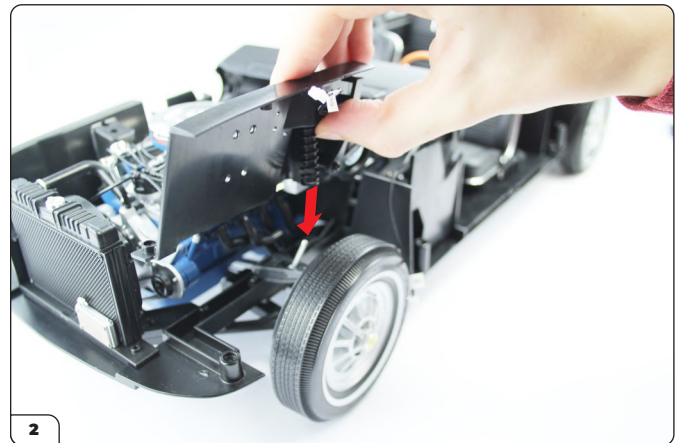
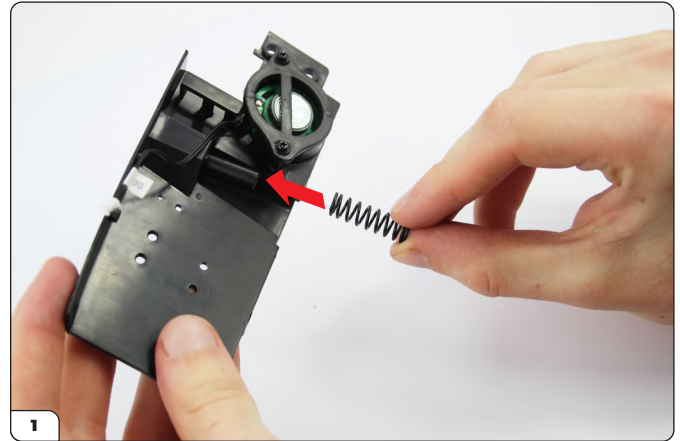

Stage 77: Front Left Panel, Speaker And Suspension

STEP 5

ATTACH THE SIDE PANEL TO THE ENGINE PARTITION PANEL

Finally, fix the side panel to the Engine Partition Panel using 2 x TYPE MPO3 screws.

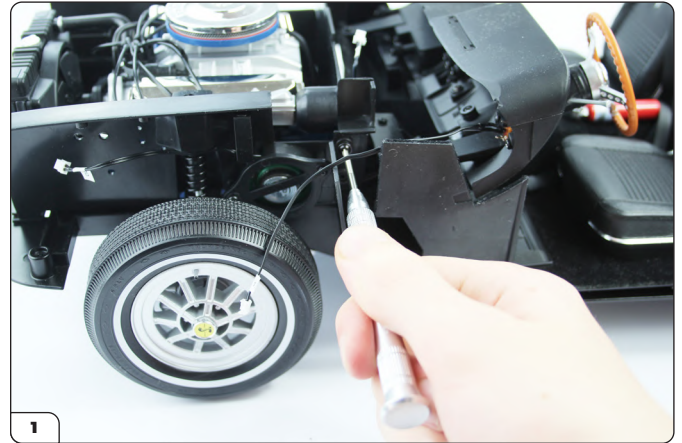

Stage 77 complete!

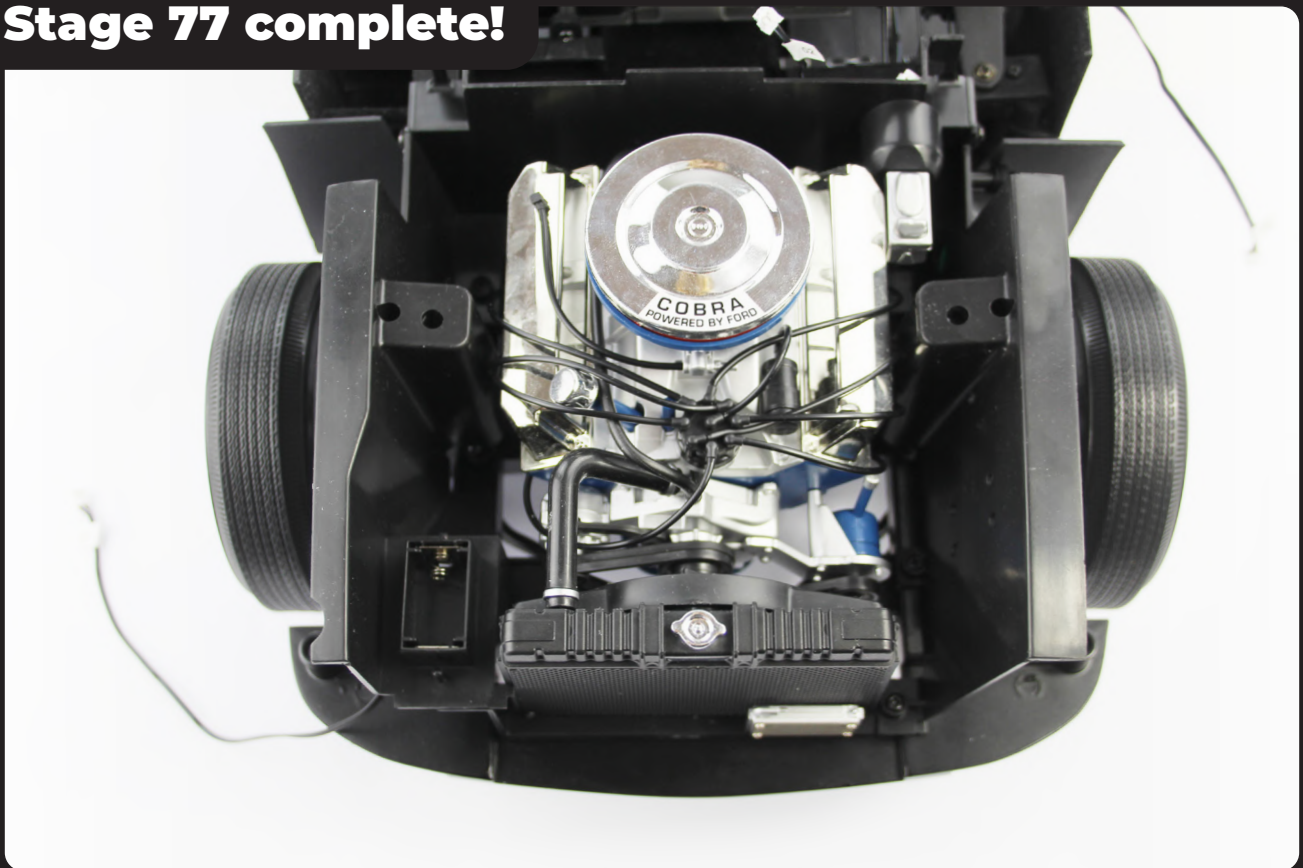

Stage 78: Battery, Strut Bar, Oil Filter and Pipes

You will add the strut bar, battery, oil filter and pipes to the engine section.

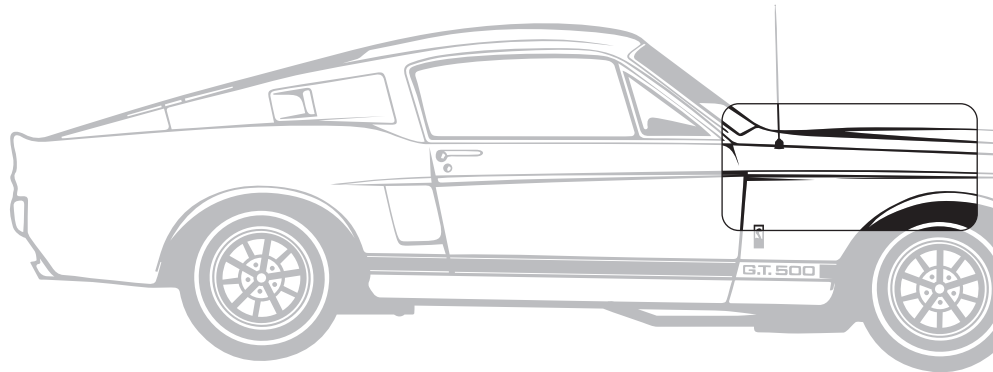

STAGE 78 PARTS LIST

Name	Quantity
Strut Bar	1
Battery	1
Battery Handle	1
Oil Filter	1
Oil Filter Cap	1
Oil Filter Connector 1	1
Oil Filter Connector 2	1
Oil Cooler Pipe ($\varnothing = 2$ mm)	1
Oil Pipe ($\varnothing = 1$ mm)	1
Screws TYPE MP05	3 [including 1 spare]



Stage 78: Battery, Strut Bar, Oil Filter and Pipes

STEP 1

FIT THE BATTERY

First, fit the battery handle by aligning the fixings on the handle with the holes on the Battery. There is only one way to fit the handle. Try rotating 180 degrees if the fit doesn't feel easy first time. Push the parts together until the handle snaps into place. Secure in place with 2 x TYPE MPO5 screws. Then position the battery in the engine compartment as shown.

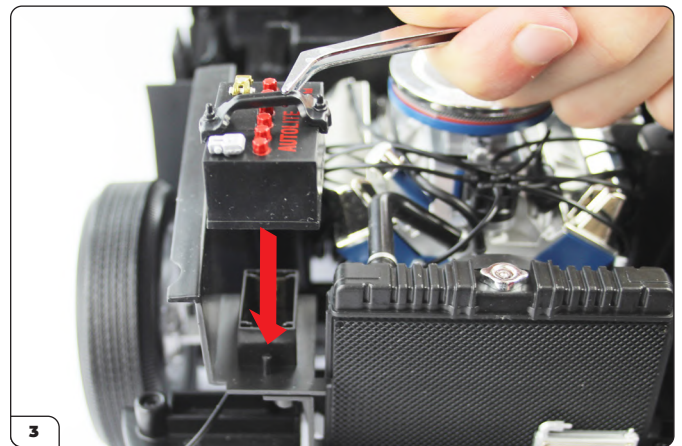
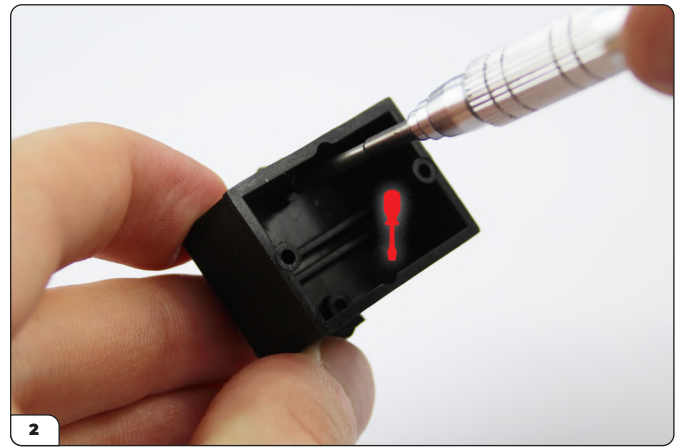
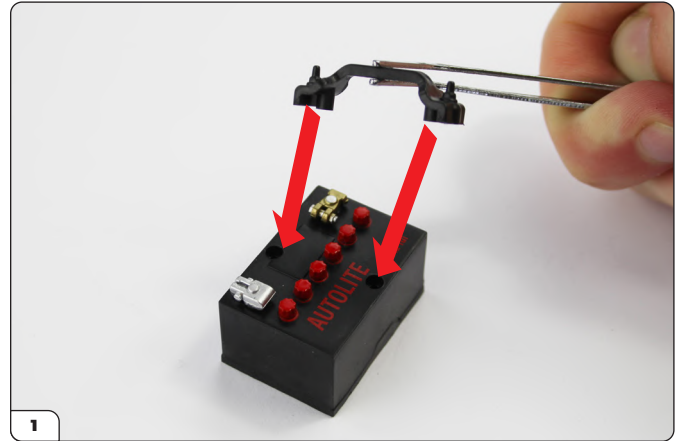

STEP 2

ATTACH THE STRUT BAR

Align the lugs on the ends of the Strut Bar with the holes on the side panels and press firmly into position.

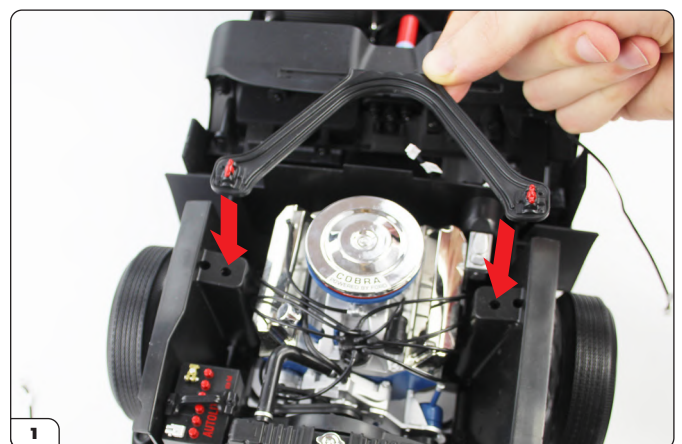

Stage 78: Battery, Strut Bar, Oil Filter and Pipes

STEP 3

ASSEMBLE THE OIL FILTER

Push the Oil Filter Cap firmly on to the end of the Oil Filter. Then, push the thin end of Connector 1 into the opposite end, followed by Connector 2, in the orientation shown. Finish by pushing one end of the oil pipe onto Connector 2.



ADVICE FROM THE EXPERTS

You can scrape the paint off the pegs if the connectors are difficult to insert. You can also fix them with a tiny drop of superglue for extra security.

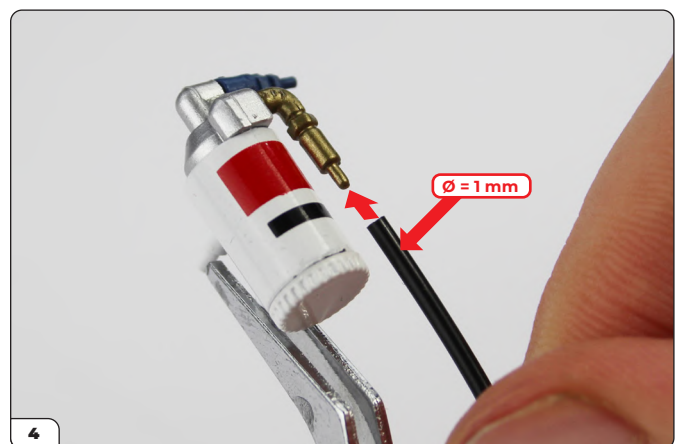
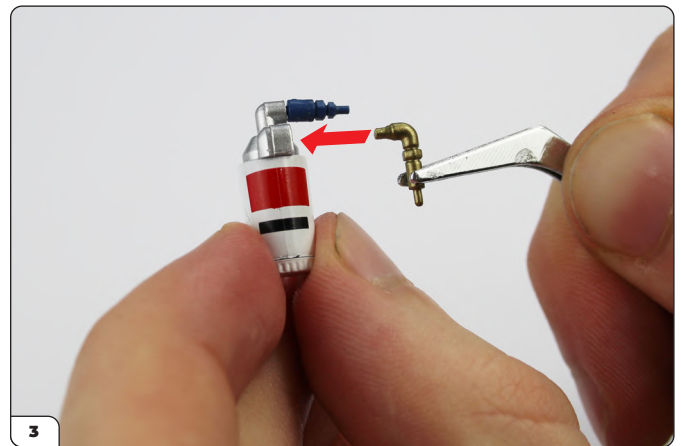
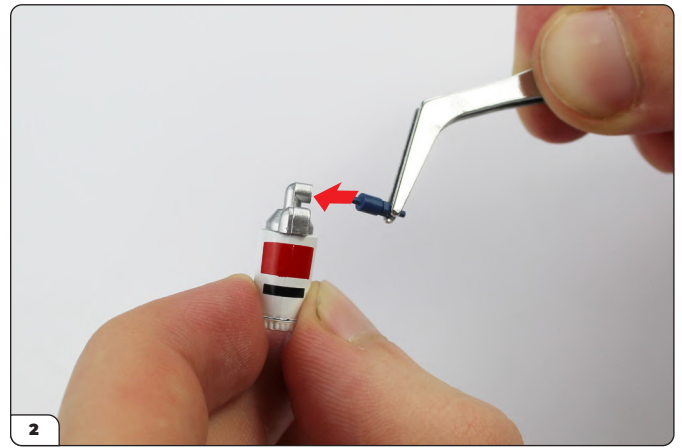
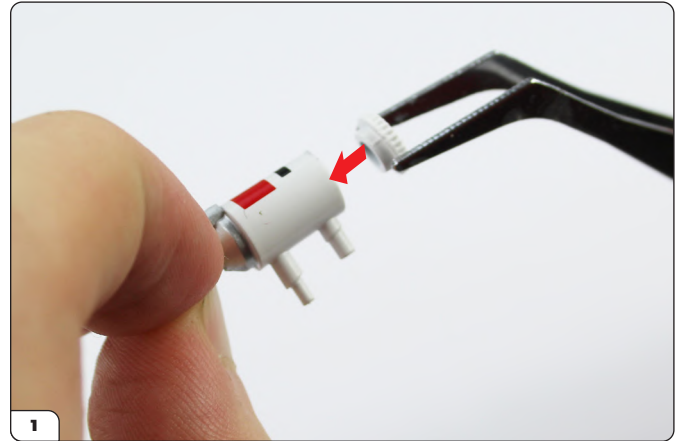

Stage 78: Battery, Strut Bar, Oil Filter and Pipes

STEP 4

INSTALL THE OIL PUMP AND PIPES

Start by cutting a length of Oil Cooler Pipe measuring 16.5 cm. Push one end of this pipe onto the oil cooler, then push the other end through the furthest hole on the side panel as shown. Pull the pipe through the hole, but keep plenty of slack. Take the remaining length of Oil Cooler Pipe pipe (about 9.5 cm) and push one end onto Oil Filter Connector 1. Install the Oil Filter in the engine compartment by pushing the two lugs into the side panel as shown. Carefully grab the free end of the Oil Pipe using tweezers and push it onto the lug on the engine front as shown. Finish by pushing the remaining free end of the Oil Cooler Pipe onto the Oil Cooler.

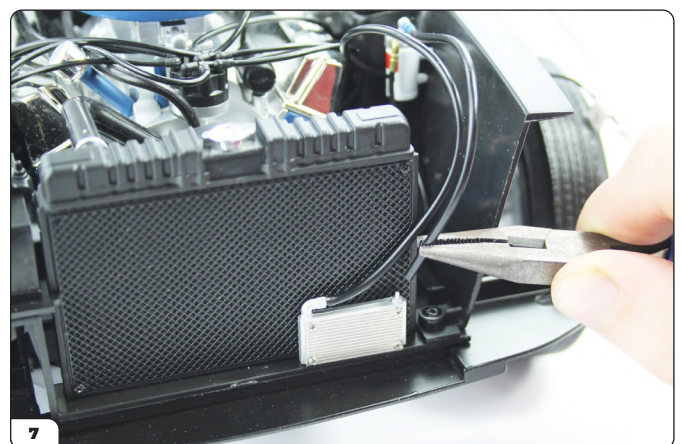
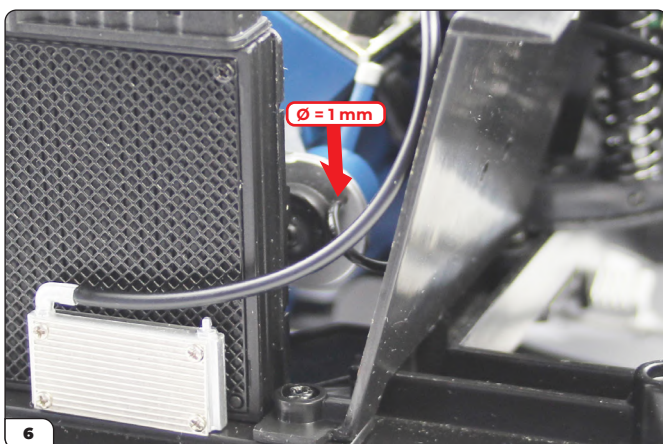
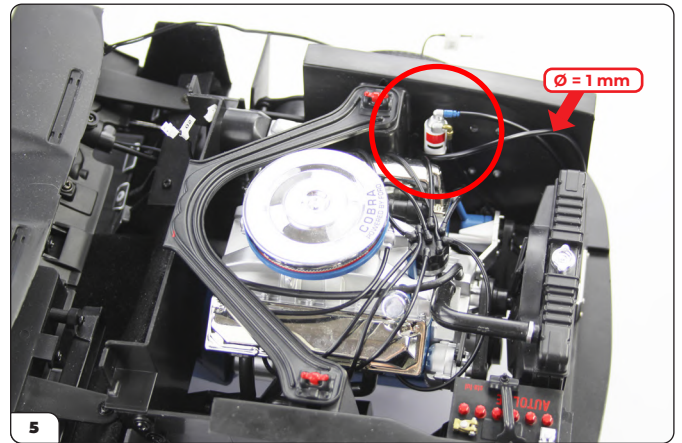
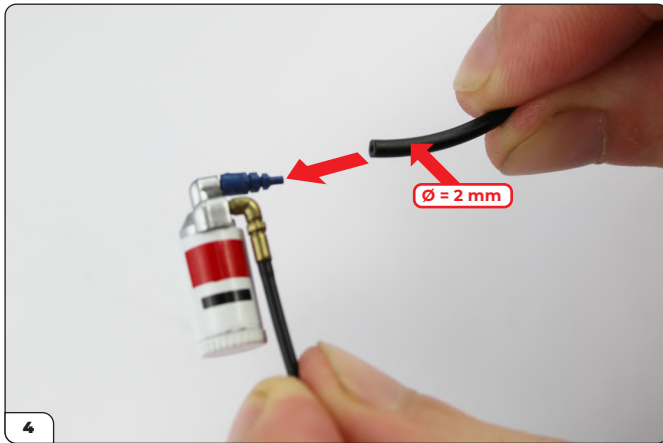
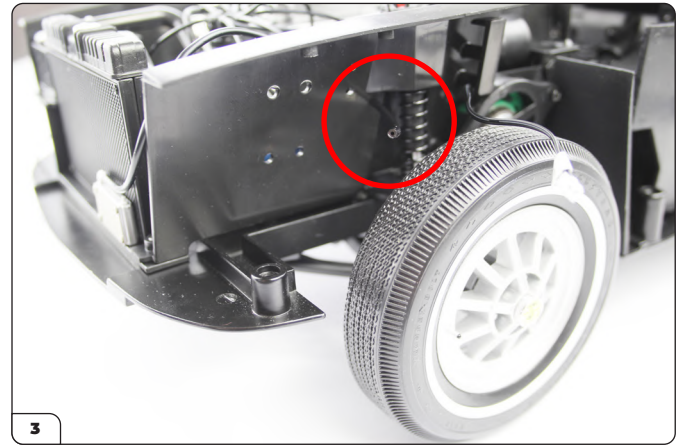
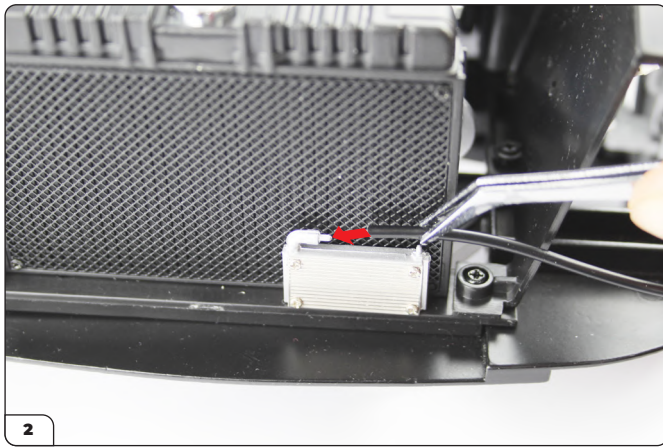
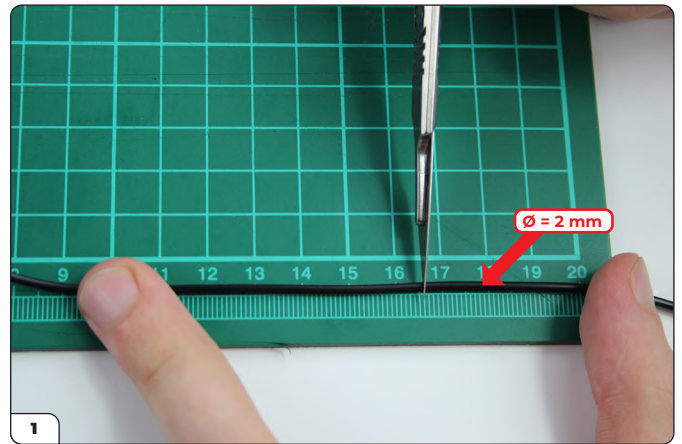

Stage 78: Battery, Strut Bar, Oil Filter and Pipes

Stage 78 complete!

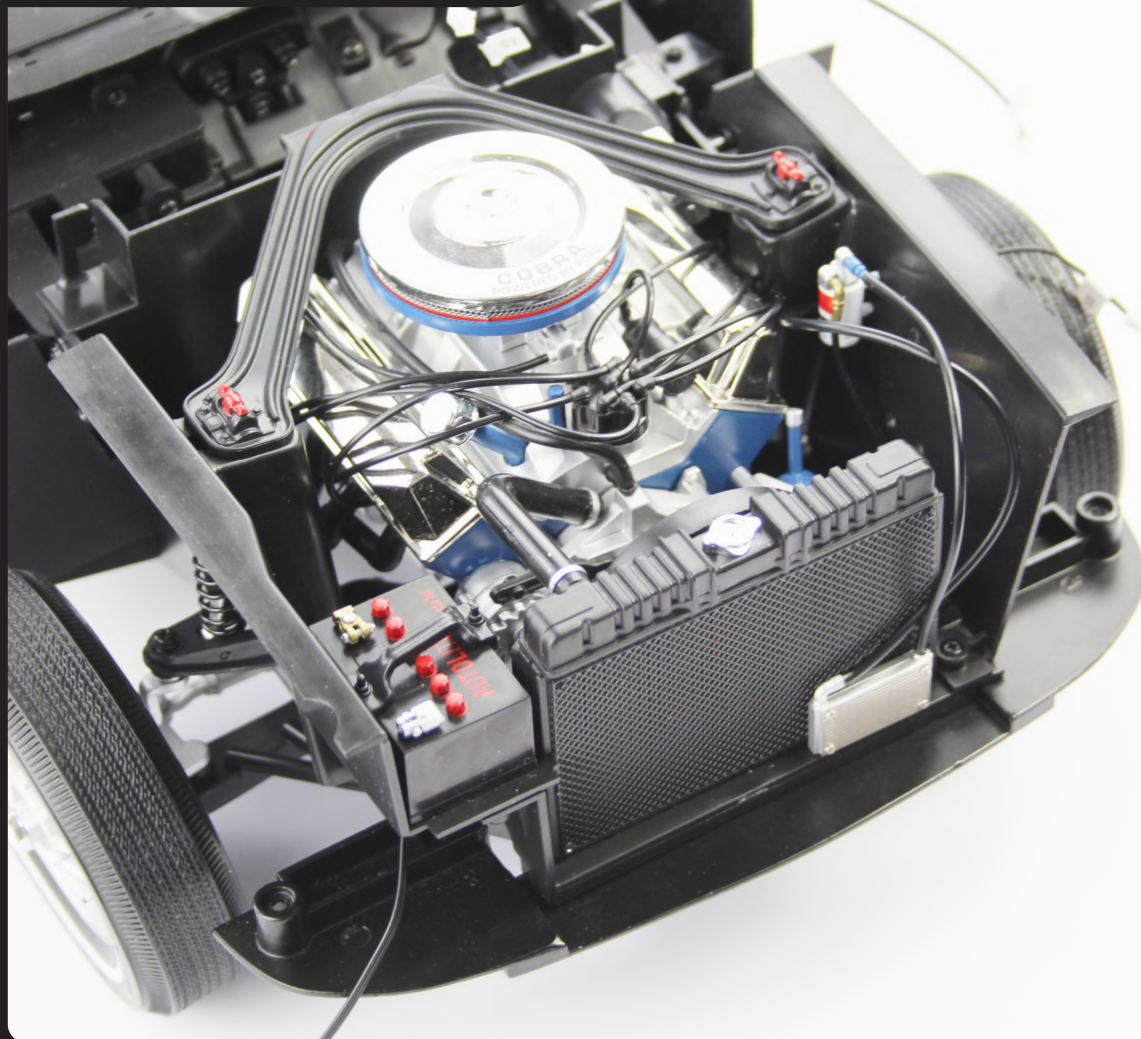

Stage 79: Washer Fluid Reservoir, Circuit Board And Wiring

In this stage you will install the windscreen washer-fluid reservoir and connect some cables to the circuit board.

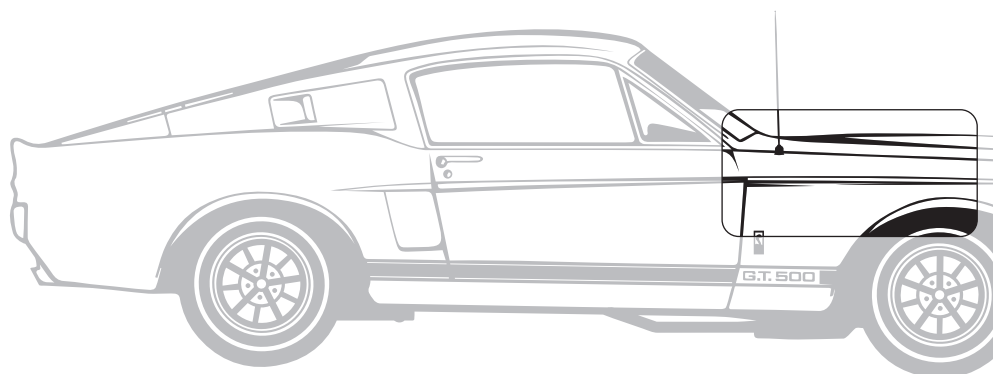

STAGE 79 PARTS LIST

Name	Quantity
Circuit Board	1
Windscreen Washer Fluid Reservoir	1
Cable No. 1	1
Cable No. 2	1
Cable No. 3	1
Cable No. 4	1
Cable No. 5	1
Cable No. 7	1
Cable No. 8	1
Cable No. 9	1
Cable No. 10	1
Screws TYPE MP08	1

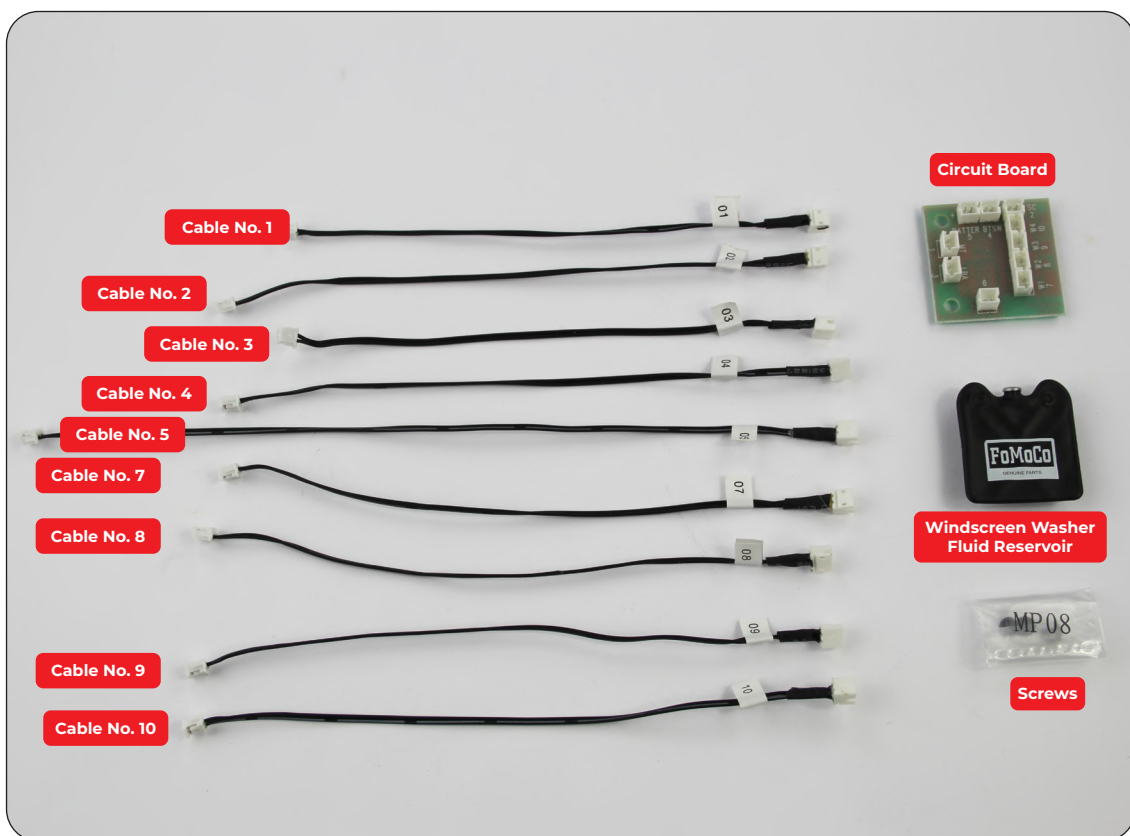

Stage 79: Washer Fluid Reservoir, Circuit Board And Wiring

STEP 1

ATTACH THE WINDSCREEN WASHER FLUID RESERVOIR

Align the washer fluid reservoir with the holes on the left side panel as shown. Press the parts together for a perfect fit.

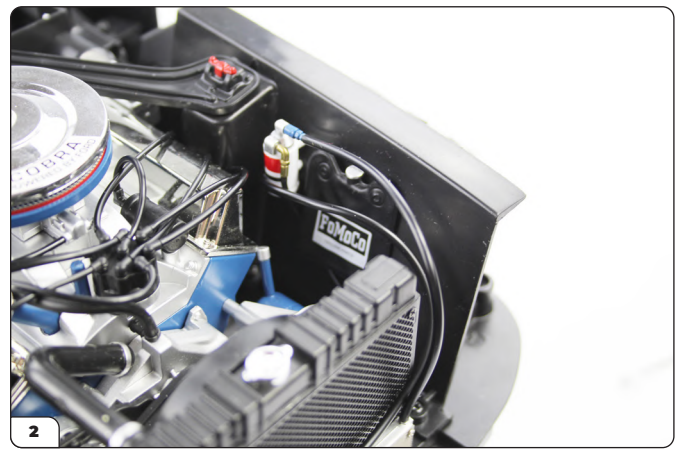
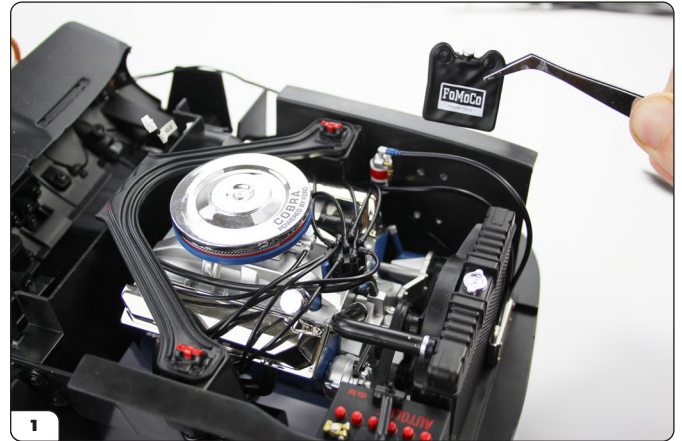

STEP 2

CONNECT THE WIRES TO THE CIRCUIT BOARD

Note that each connector on the circuit board has a number that corresponds with the numbers on the cables. Also note that each cable has two connectors: a male (on the left) and a female (on the right, closest to the number). Take cable No. 1 and insert the male connector into the corresponding connector (numbered '1') on the circuit board. Press firmly to snap the connector into place. Then connect cables No. 2, 3, 4 and 5 to their respective connectors. Continue to connect cables 7 – 10 in the same way.

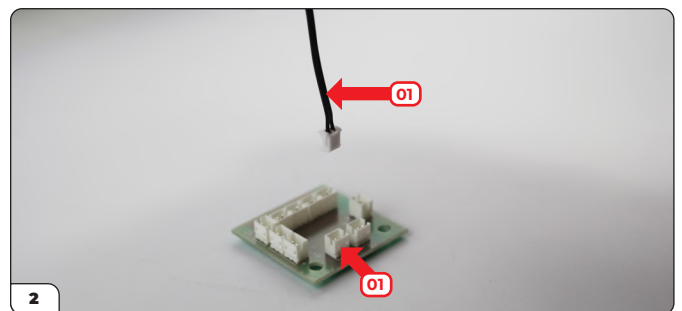

Stage 79: Washer Fluid Reservoir, Circuit Board And Wiring

STEP 3

ATTACH THE CIRCUIT BOARD TO THE CHASSIS

Take the circuit board to the engine and locate the cable in the engine compartment labelled No. 6. Connect this to the circuit board. Next, rest the car on its side and position the circuit board as shown in the picture. The holes on the circuit board fit over the tenons on the left panel (indicated in picture 2). Secure the parts together using 2 x MP08 screws. This will require a long screwdriver. Finally, route the cables on the side of the chassis as shown.

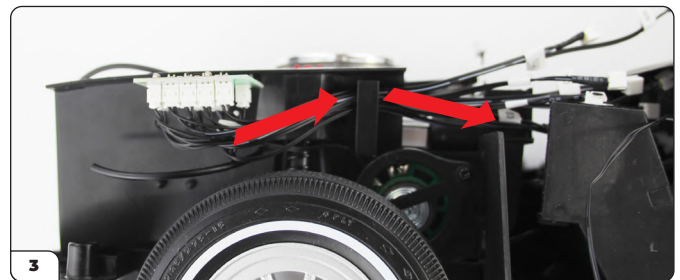
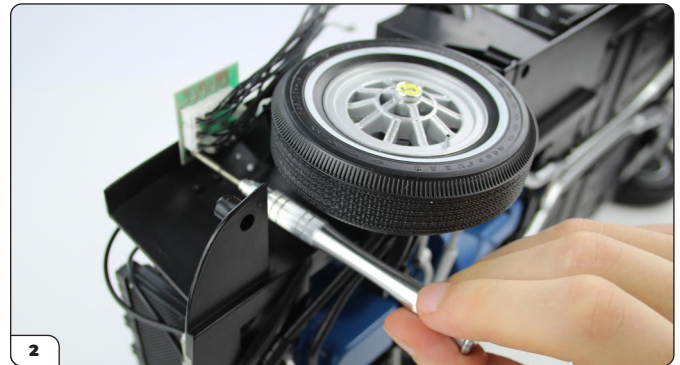
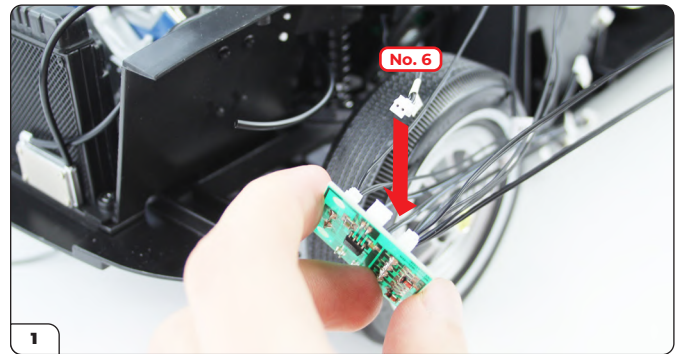

STEP 4

CONNECT CABLES 1 - 5

Connect the free end of cables No. 1, 2, 3, 4 & 5 to the corresponding cables already installed in the car. Finish by grouping the cables you have just connected and route them on the side panel as shown. Leave the remaining unconnected cables free, ready to connect at a later stage.

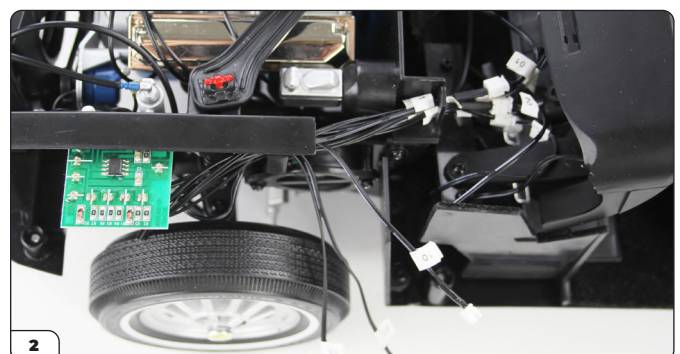
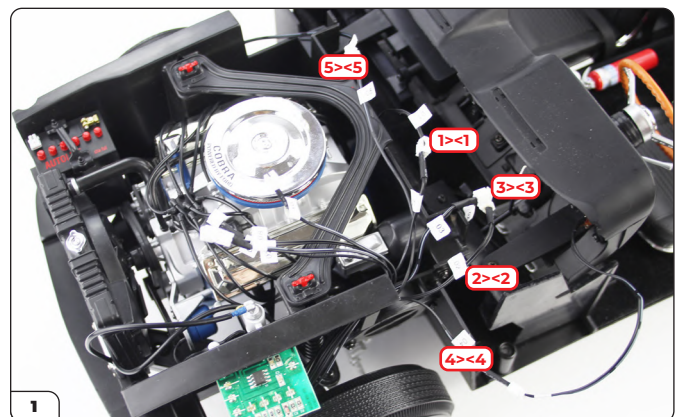

Stage 79: Washer Fluid Reservoir, Circuit Board And Wiring

Stage 79 complete!

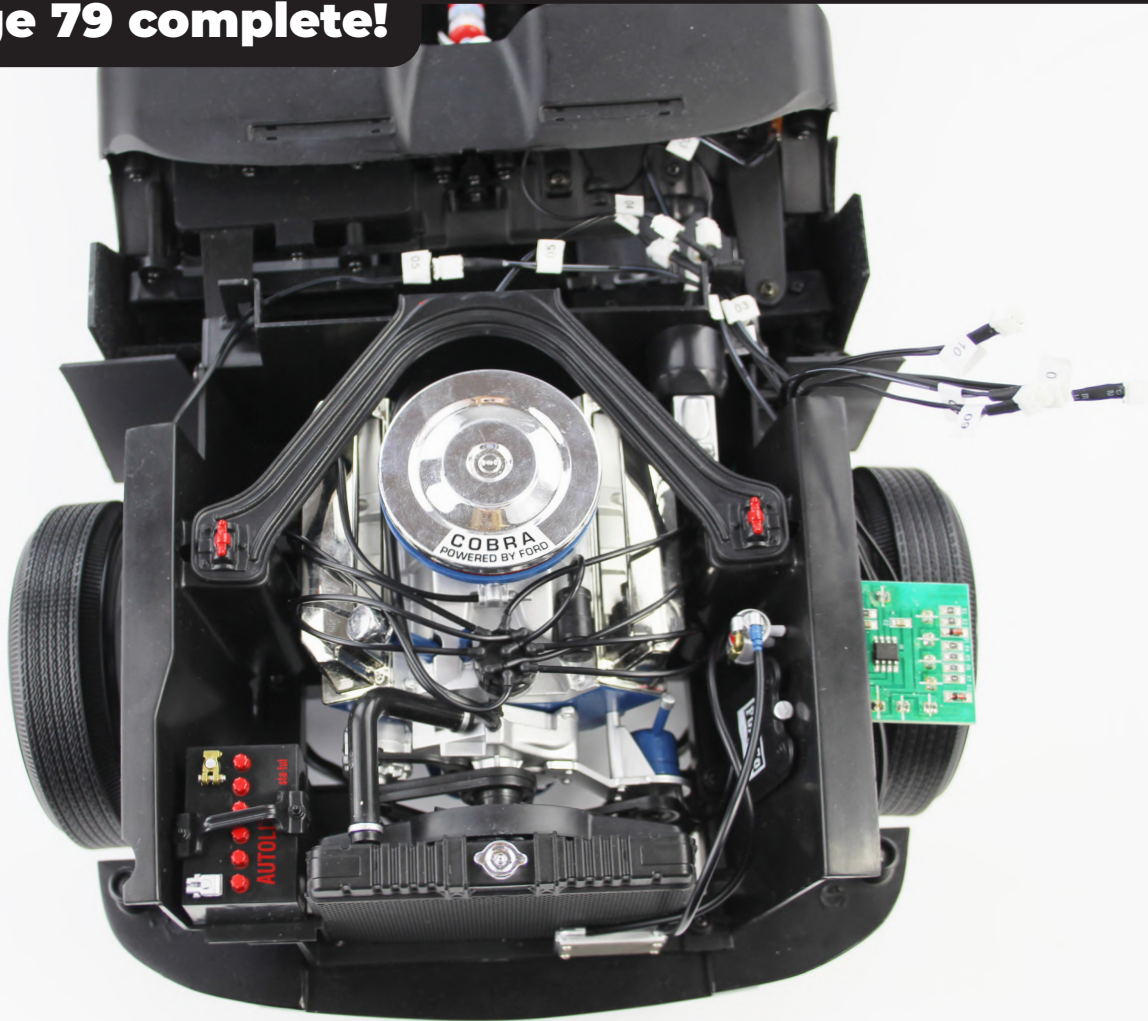

Stage 80: Left Front Fender

Your Super Snake will continue to take shape as you assemble the left and right front fenders.

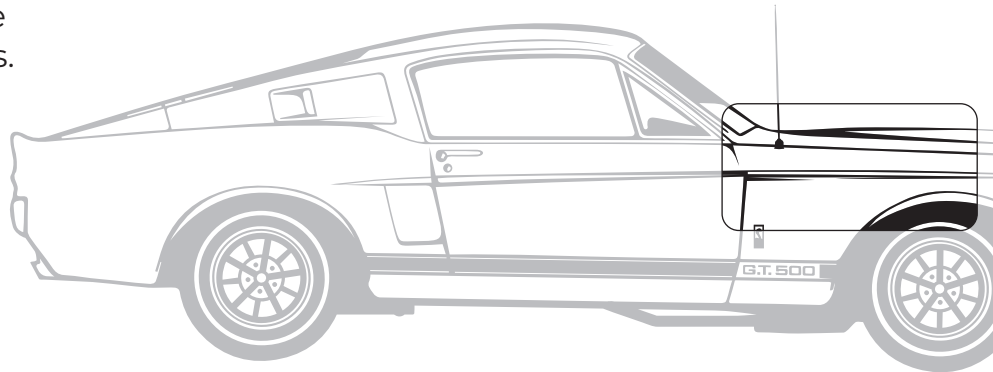

STAGE 80 PARTS LIST

Name	Quantity
Left Front Fender	1



Stage 80: Left Front Fender

STEP 1

LEFT FRONT FENDER

This part will be fixed to the Chassis Front Panel in stage 81, so unpack your stage 80 part and jump straight to stage 81.



Stage 80 complete!



Stage 81: Chassis Front Panel

In stage 81 you will assemble the chassis front panel before attaching the front fenders.

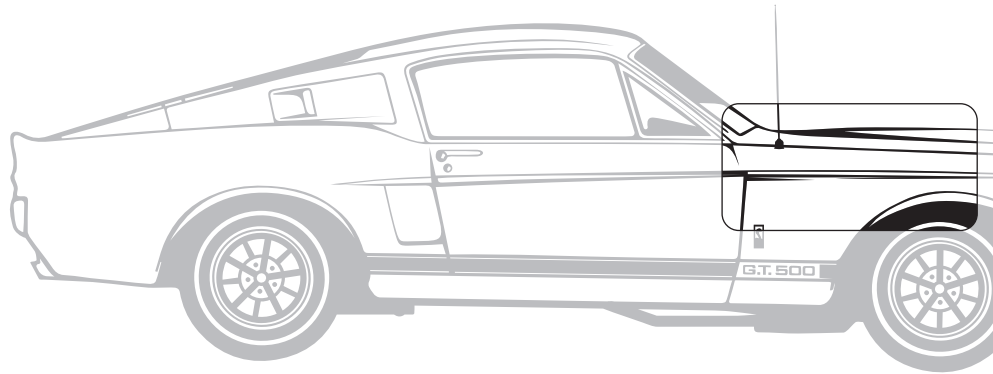

STAGE 81 PARTS LIST

Name	Quantity
Chassis Front Panel	1
Left Hood Support	1
Right Hood Support	1
Screws TYPE MP09	3
Screws TYPE MD06	3



Stage 81: Chassis Front Panel

STEP 1

ASSEMBLE THE CHASSIS FRONT PANEL

Align the Left Hood Support with the Chassis Front Panel as shown. These parts can only be assembled in one position. Secure from the underside with a TYPE MP09 screw. Fit the Right Hood Support at the other end of the Chassis Front panel in the same way, securing the parts with another MP09 screw.

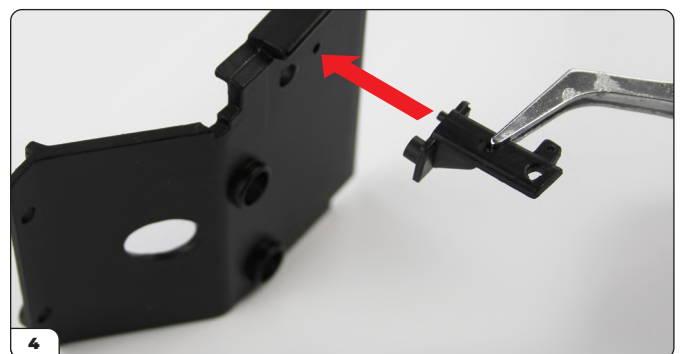
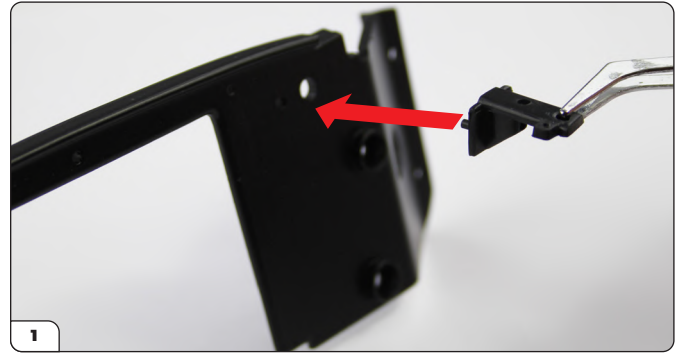

Stage 81: Chassis Front Panel

STEP 2

ATTACH THE LEFT FRONT FENDER

Take the Left Front Fender from stage 80. Align the screw holes on the Chassis Front panel with the screw holes on the end of the Left front Fender. Secure the parts together with 2 x TYPE MD06 screws.

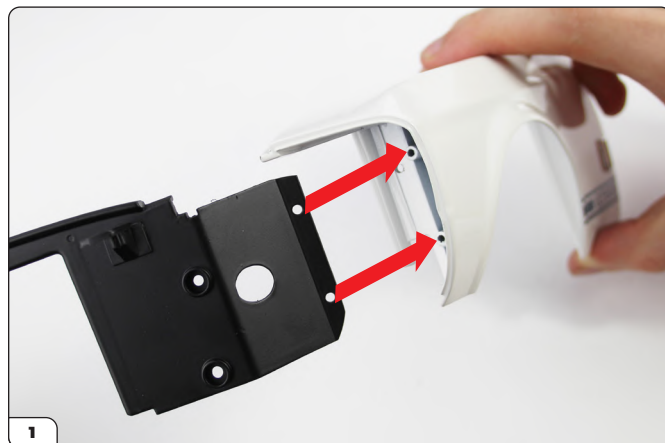

Stage 81 complete!



Stage 82: Right Front Fender

Your Super Snake will continue to take shape as you attach the right front fender.

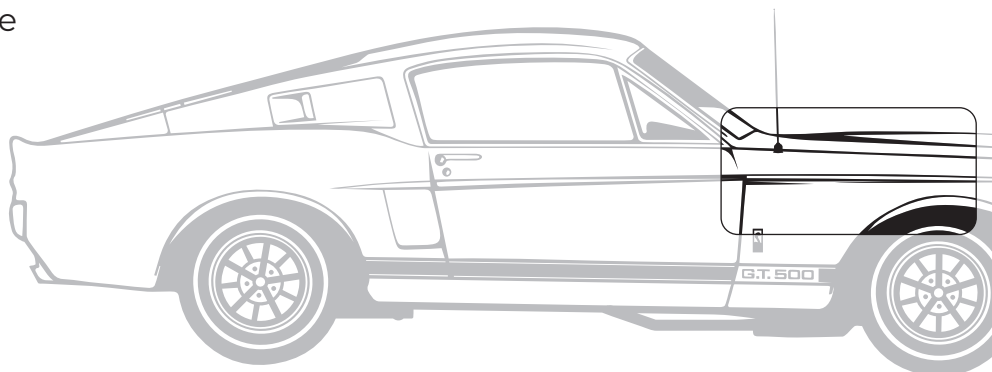

STAGE 82 PARTS LIST

Name	Quantity
Right Front fender	1
Screws TYPE MD06	3 [including 1 spare]



Stage 82: Right Front Fender

STEP 1

ATTACH THE RIGHT FRONT FENDER TO THE FRONT CHASSIS PANEL

Take the Chassis Front panel assembly from the previous stage and attach the Right Front Fender on the opposite side. First, align the screw holes on the Front Chassis Panel with the screw holes on the Right Front Fender. Then secure the parts together using 2 x TYPE MD06 screws.

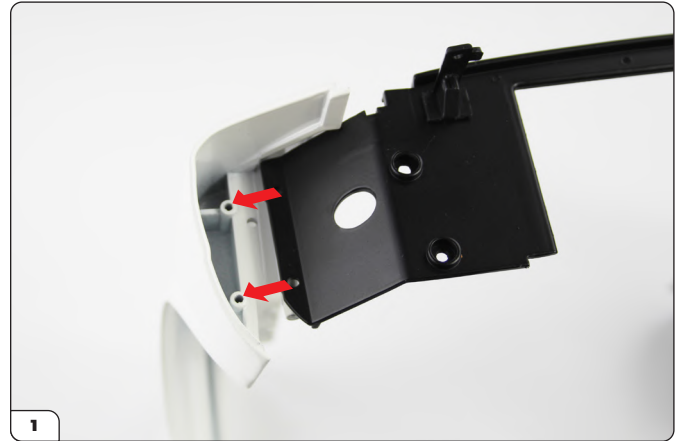

Stage 82 complete!

