

# OPTIMUS PRIME

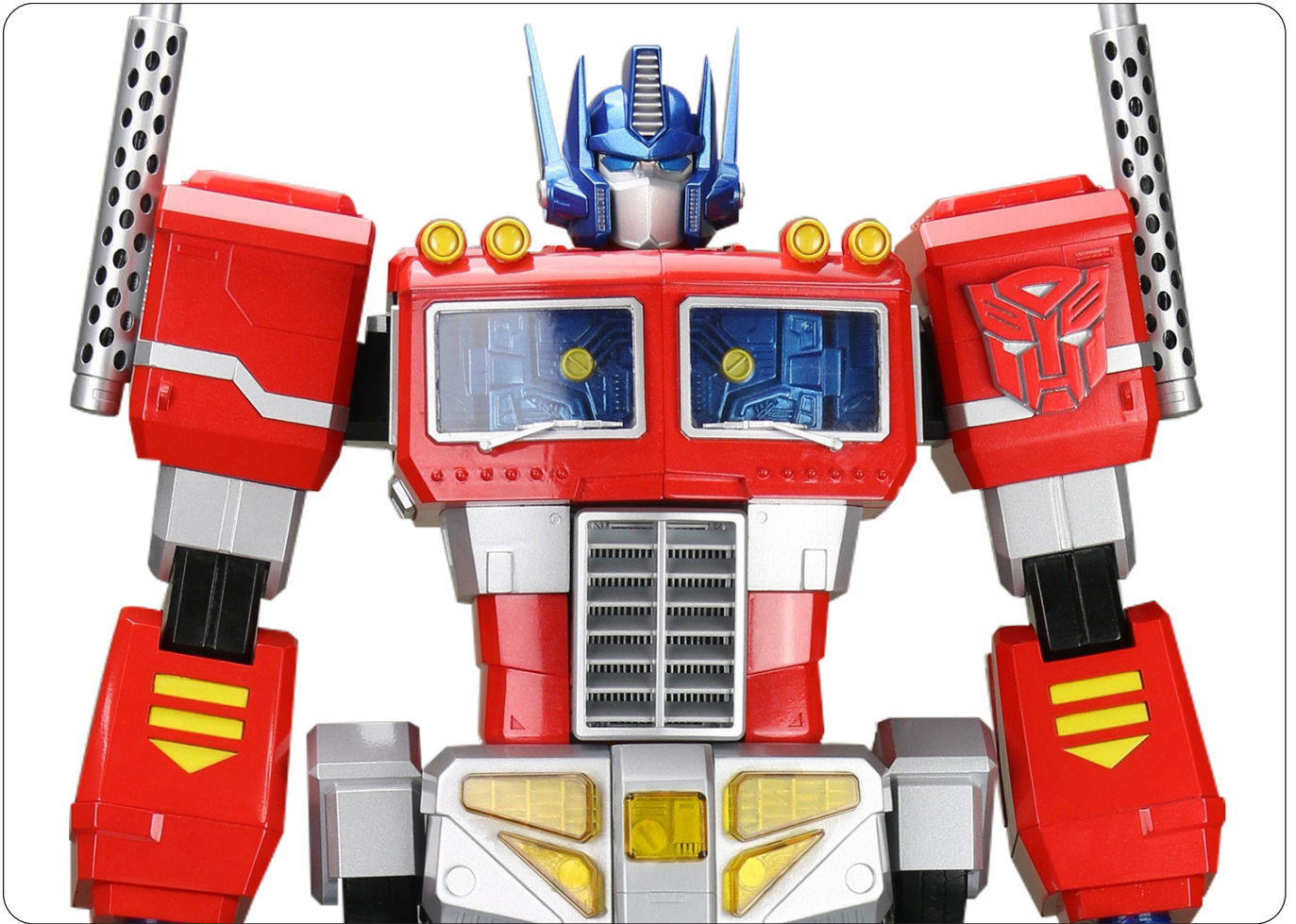

## Pack 02

BUILD INSTRUCTIONS

ASSEMBLING THE LEFT SHOULDER & ARM

**AGORA**  
MODELS®

# Advice from the experts

---

 **Please keep ALL unused screws as they may be required in a later stage.**

Please make sure you don't mix up the screws. They look quite similar, but the threads do vary slightly. Using the wrong screws may damage the parts.

When securing parts together using multiple screws, fit each screw loosely to ensure all the parts are correctly aligned before gently tightening them firmly, but not overtight, in the order in which you placed them.

The screwdriver can be magnetized by stroking it with a magnet (fridge magnet, etc.) enabling it to hold the screws and make assembly easier.

If a screw is tight going into a metal part, do not force it as you may shear the head off. Remove it and put a tiny smear of Vaseline, soap or light oil on the thread. That will lubricate it and make it easier to drive home.

Some parts will require a little glue for assembly. Please apply glue sparingly and use a cocktail stick so that you don't use too much nor apply the glue too heavily. We recommend superglue gel or Extra Thin Liquid modeling glue. Where possible, parts should be test-fitted in place before gluing.



Look out for the glue symbol and apply glue to the red area indicated in the picture.

During the course of this build, you will receive many pieces that you will assemble immediately – following the instructions in the corresponding stage – and other pieces that you should store in the tray supplied, for use in future assembly stages.

Always protect the paint finish on components by placing a cutting mat, sheet of white paper or soft cloth on your work surface.

Left and Right! When building your Optimus Prime, the left or right hand side refers to each side as viewed by Optimus Prime. Optimus Prime's left arm is on the viewer's right.



**WARNING:** Some parts are assembled using magnets. These magnets can cause serious injury if they are swallowed. Keep away from children. If you suspect a magnet has been swallowed, seek medical help straight away.

# Pack 2: Assembling the Left Shoulder & Arm

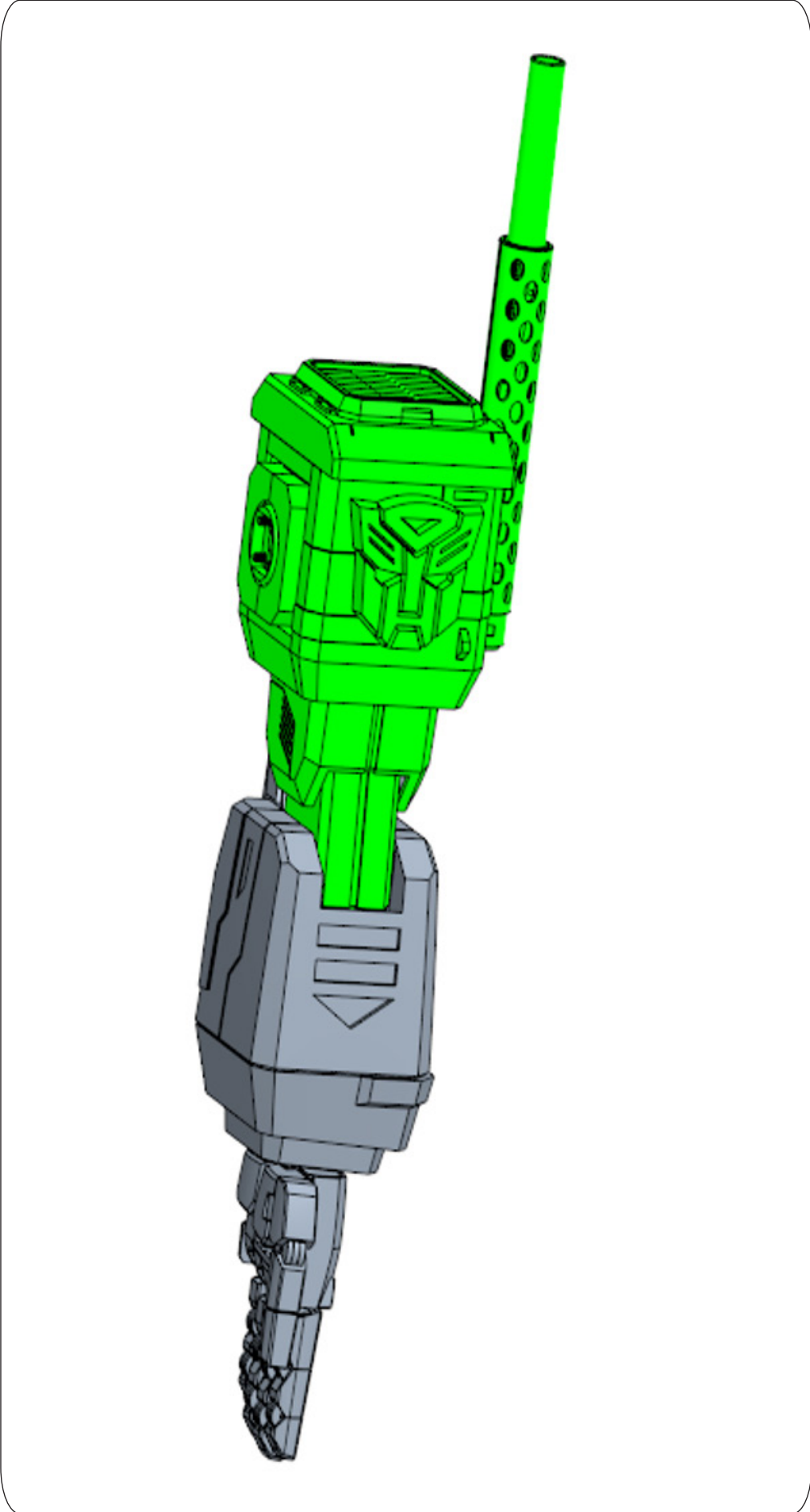

# Pack 2 Parts

TRAY 1:

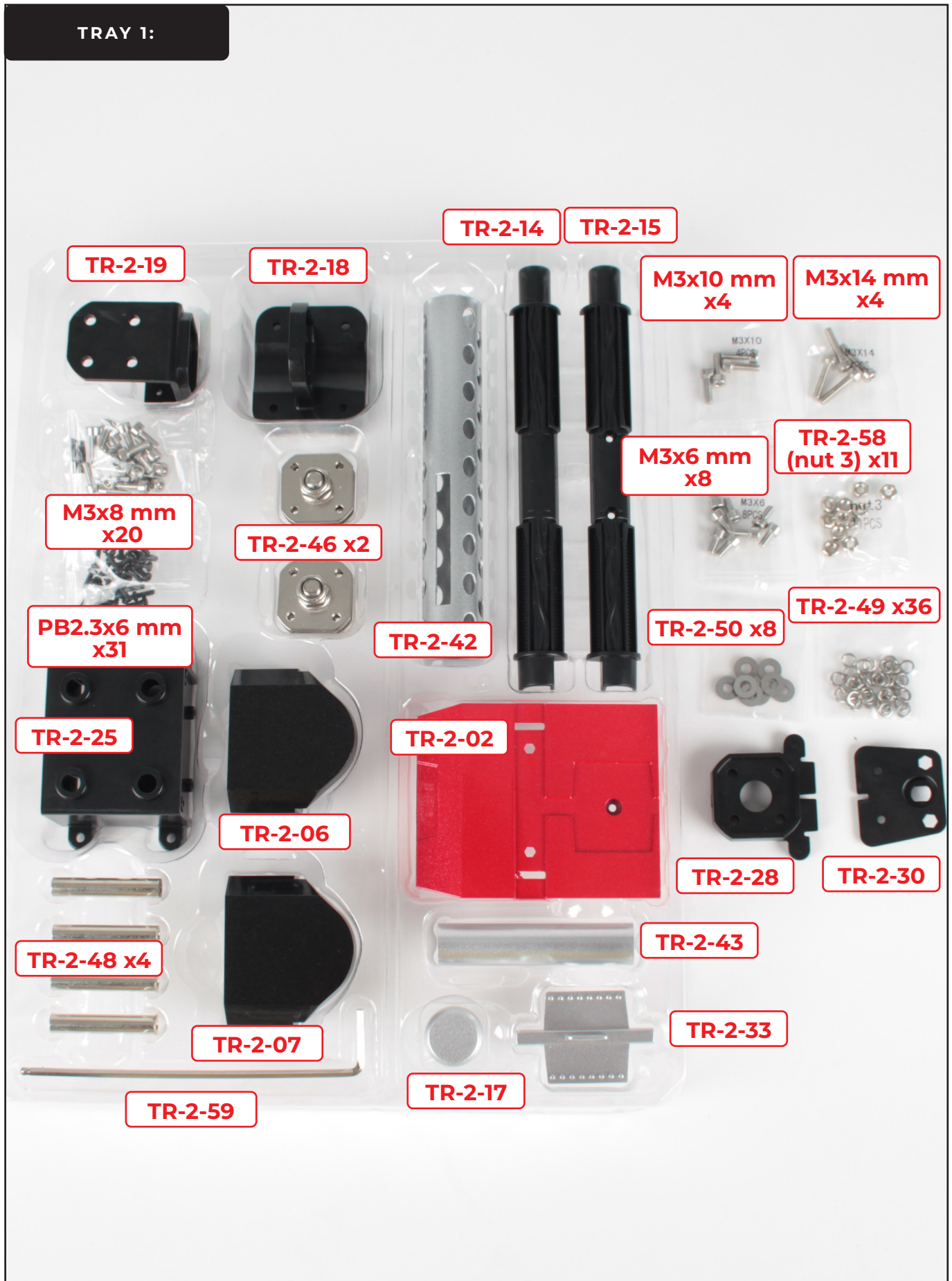

# Pack 2 Parts

TRAY 2:

TR-2-03



TR-2-34

TR-2-32



TR-2-21



TR-2-20



TR-2-22



TR-2-41



TR-2-44



TR-2-47 x2

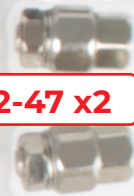

TR-2-29



TR-2-16



TR-2-23



TR-2-45 x3



TR-2-26/27



TR-2-10



TR-2-11



# Pack 2 Parts

TRAY 3

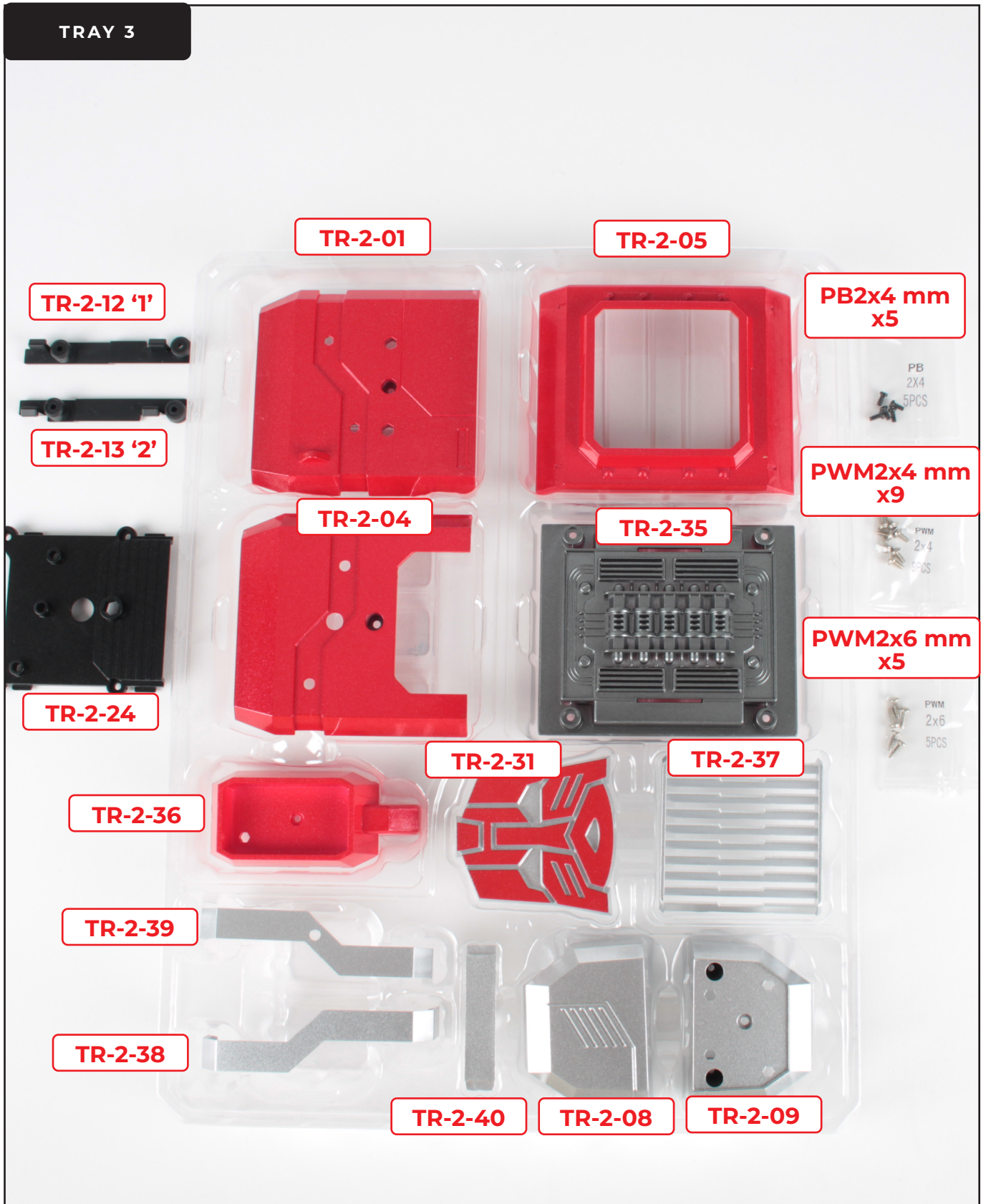

# Assembling the Left Shoulder & Arm

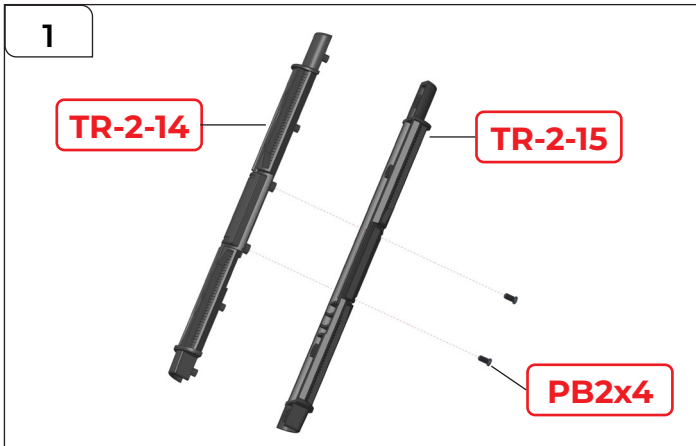

## STEP 1

Align TR-2-14 and TR-2-15 as shown and secure them together using 2x PB2x4 mm screws.

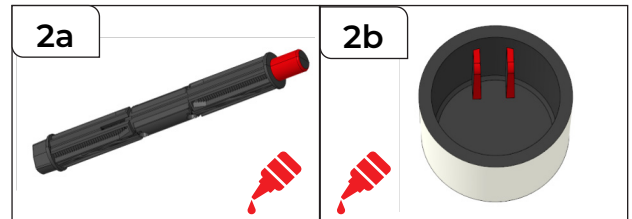

## STEP 2

Glue the assembly from step 1 as shown in 2a, then fix TR-2-43 over the glued end as shown.

Glue TR-2-17 as shown in 2b, then fix it to the opposite end of the assembly, taking care to align the glued fixing points.

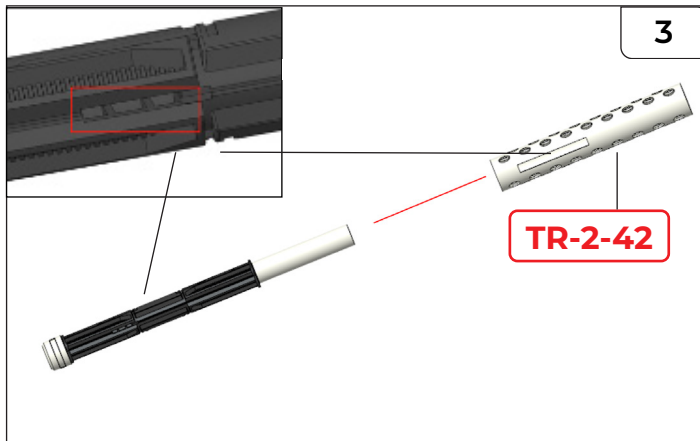

## STEP 3

Push TR-2-42 onto the assembly from step 2, paying attention to the detail highlighted in the inset image. Check that the slot in TR-2-42 is oriented over the corresponding slot in the assembly.

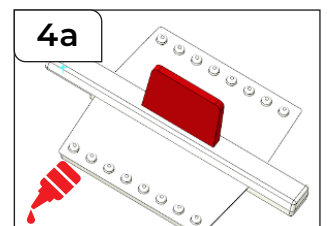

## STEP 4

Apply a little glue to TR-2-33 as shown in 4a and fix to the assembly from step 3. Study the inset image (bottom, right) to check that part TR-2-33 is in the correct orientation. There is a step at one end.

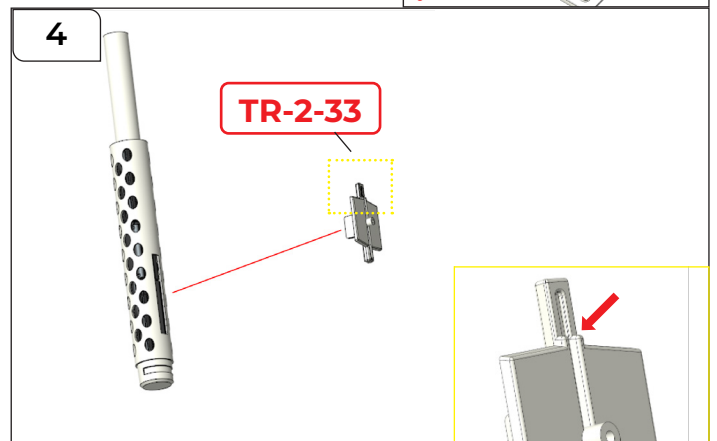

# Assembling the Left Shoulder & Arm

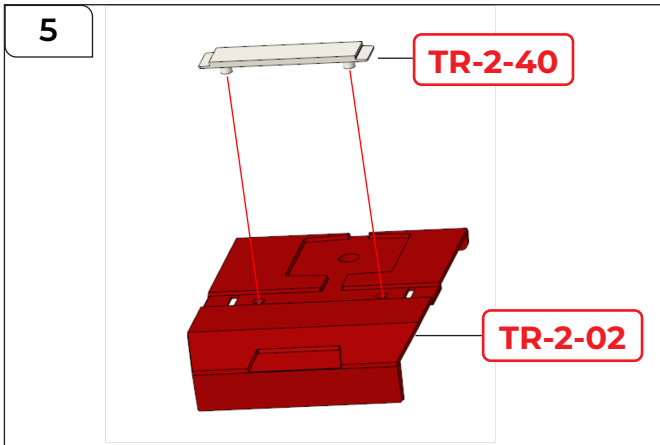

## STEP 5

First attach TR-2-40 to TR-2-02, Fix TR-2-02 to the assembly from step 4 using 1x PB2.3x6 mm screw.

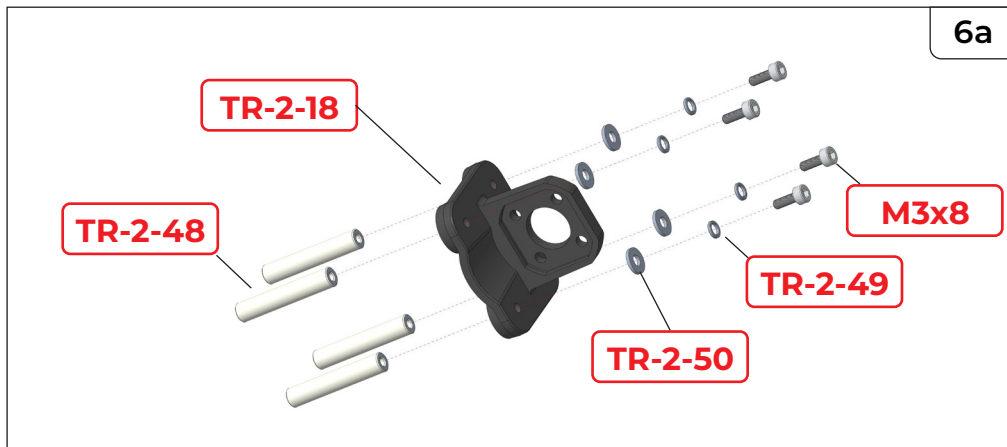
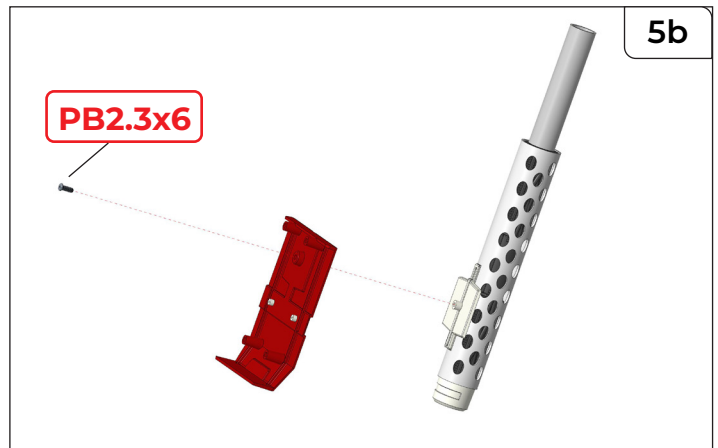

## STEP 6

Thread TR-2-49 and TR-2-50 onto a M3x8 mm screw before inserting the assembled screw through a corner screw hole in TR-2-18. Then attach TR-2-48. Repeat with the other 3 sets, driving them through the remaining 3 screw holes.

Fasten each screw quite tight.

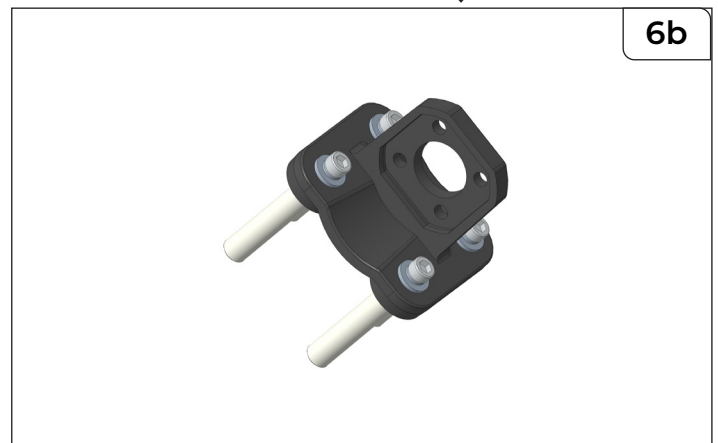



# Assembling the Left Shoulder & Arm

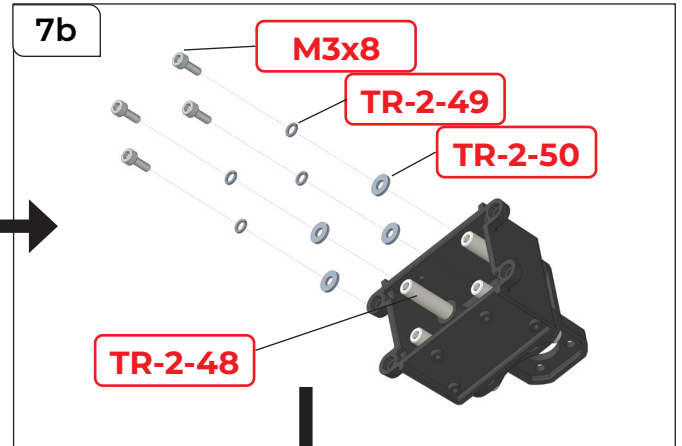
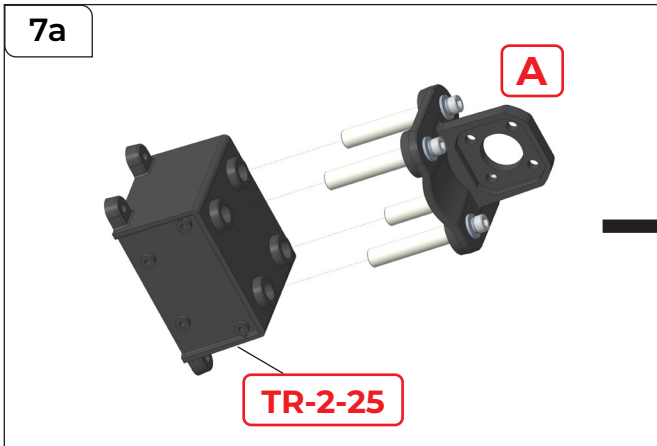

## STEP 7

Push assembly A into TR-2-25 as shown.

Thread washers TR-2-49 and then TR-2-50 onto a M3x8 mm screw. Make 4 sets and then screw them into TR-2-48 as shown.

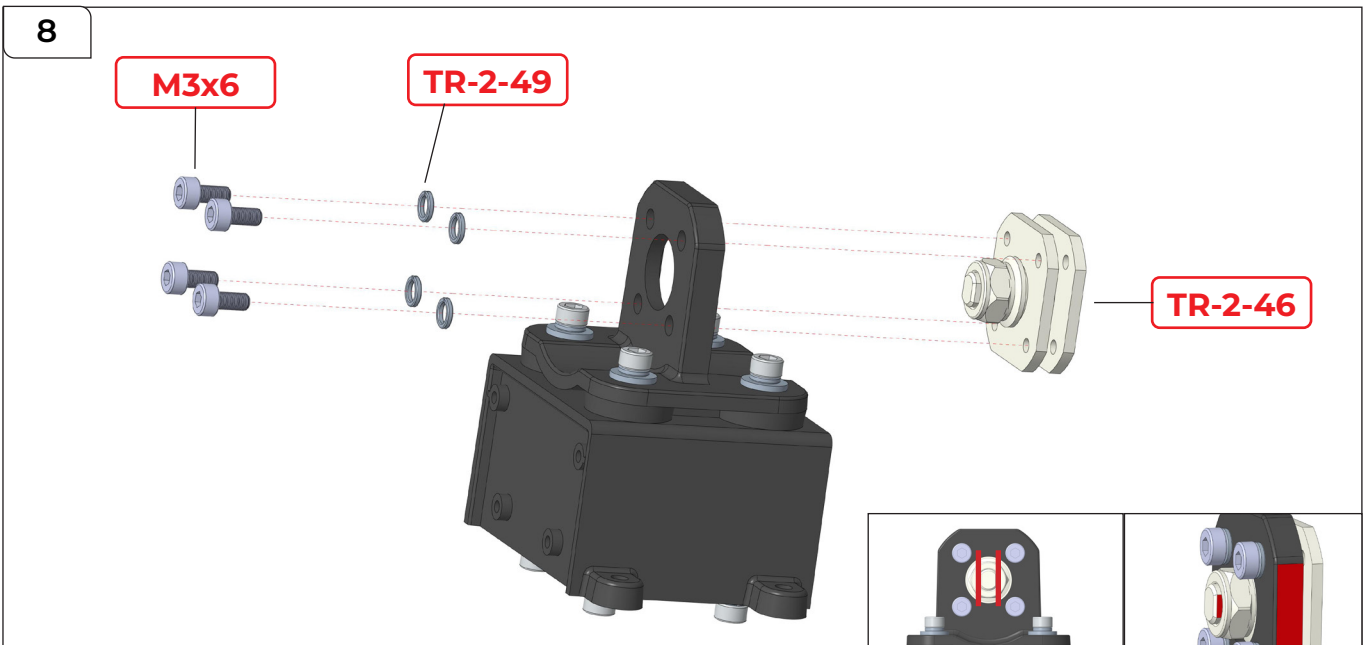
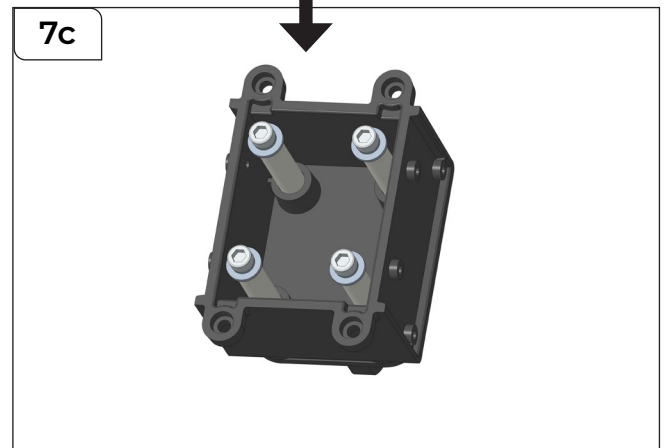

## STEP 8

Push TR-2-46 through the hole in TR-2-18, paying close attention to the orientation. The top and bottom edges are rounded, the left and right edges are flat (see 8a-d on the next page). Thread TR-2-49 onto a M3x6 mm screw and make 4 sets, using them to secure TR-2-46 in place as shown.

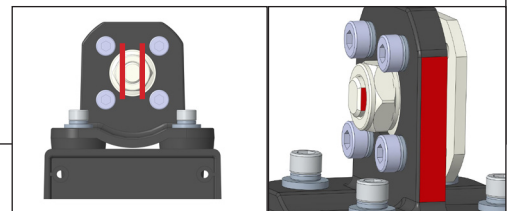

# Assembling the Left Shoulder & Arm

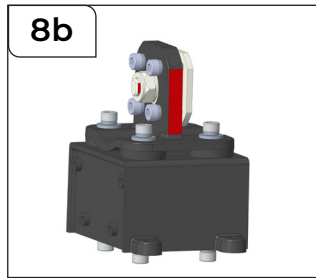
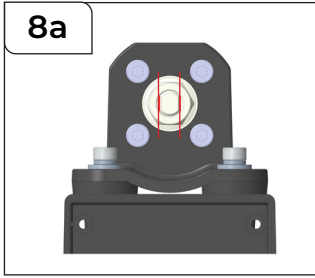

## STEP 8 CONT...

IMPORTANT! Check that the red sides are flat.

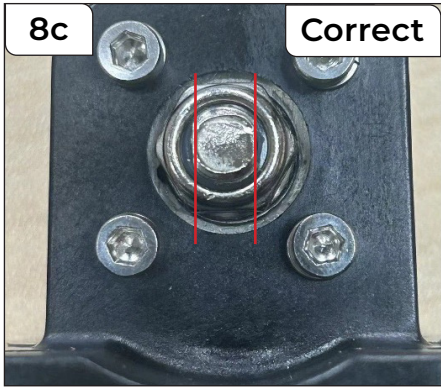

Correct

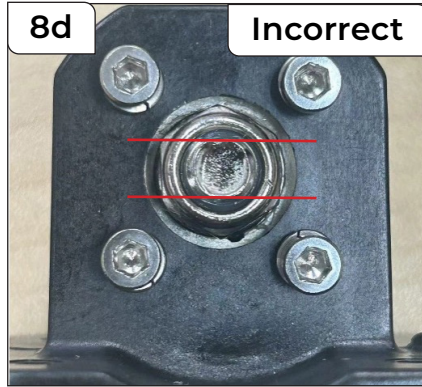

8d

Incorrect

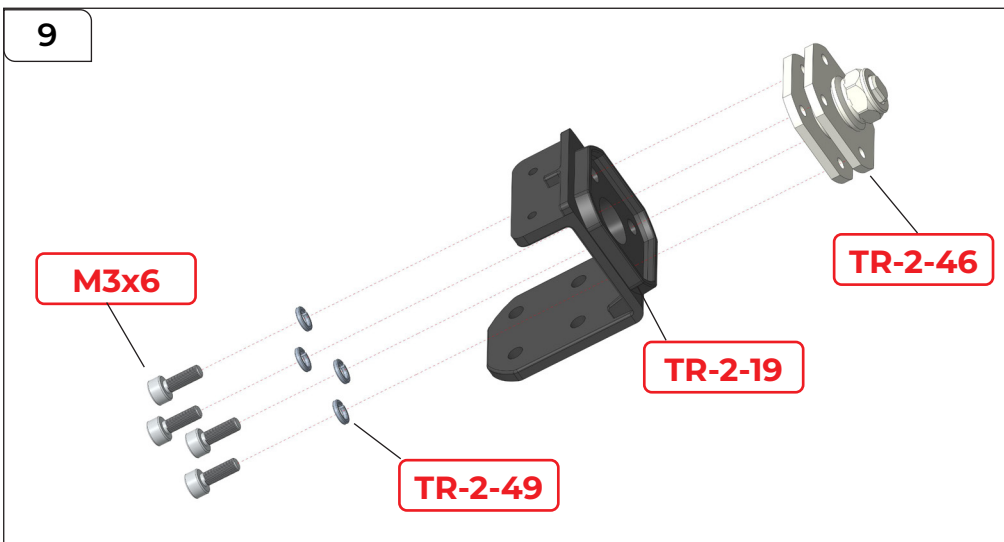

## STEP 9

Place a washer **TR-2-49** onto a **M3x6 mm** screw before pushing it through **TR-2-19** to attach it to **TR-2-46**. Repeat three more times, pushing the screw assemblies through the remaining three screw holes. There is no particular direction for parts at this stage.

## STEP 10

Align assembly A, **TR-2-28** and assembly B as shown. Push the parts together.

Thread washers **TR-2-49** onto screws **M3x14 mm** and make 4 sets. Fix the parts together as shown, pushing each screw assembly through the four screw holes on each part.

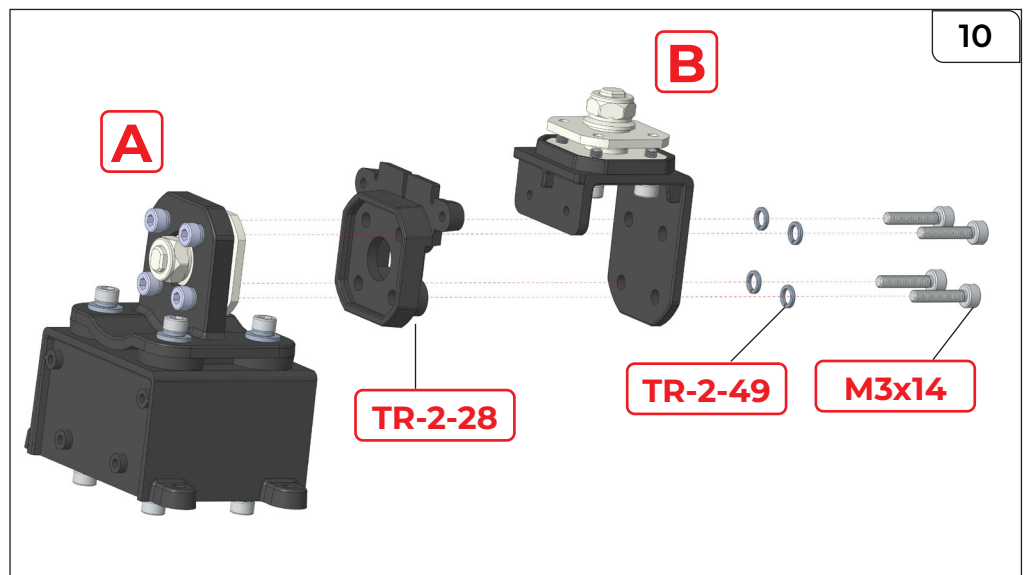

10

# Assembling the Left Shoulder & Arm

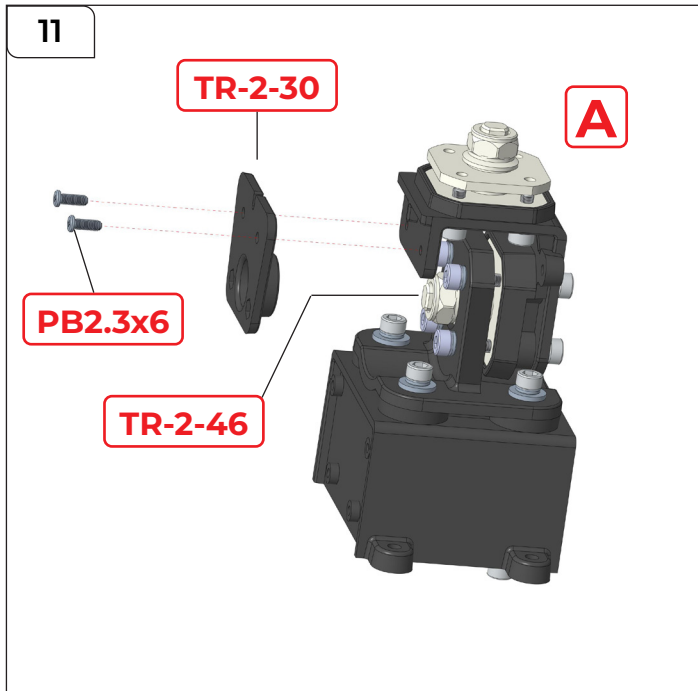

## STEP 11

Align **TR-2-30** with assembly **A** as shown, then fix it in place using **2x PB2.3x6 mm** screws. Pay close attention to the shape of the hole in part **TR-2-30**, checking that it fits the fixing point on **TR-2-46** (shown completed in 11b below).

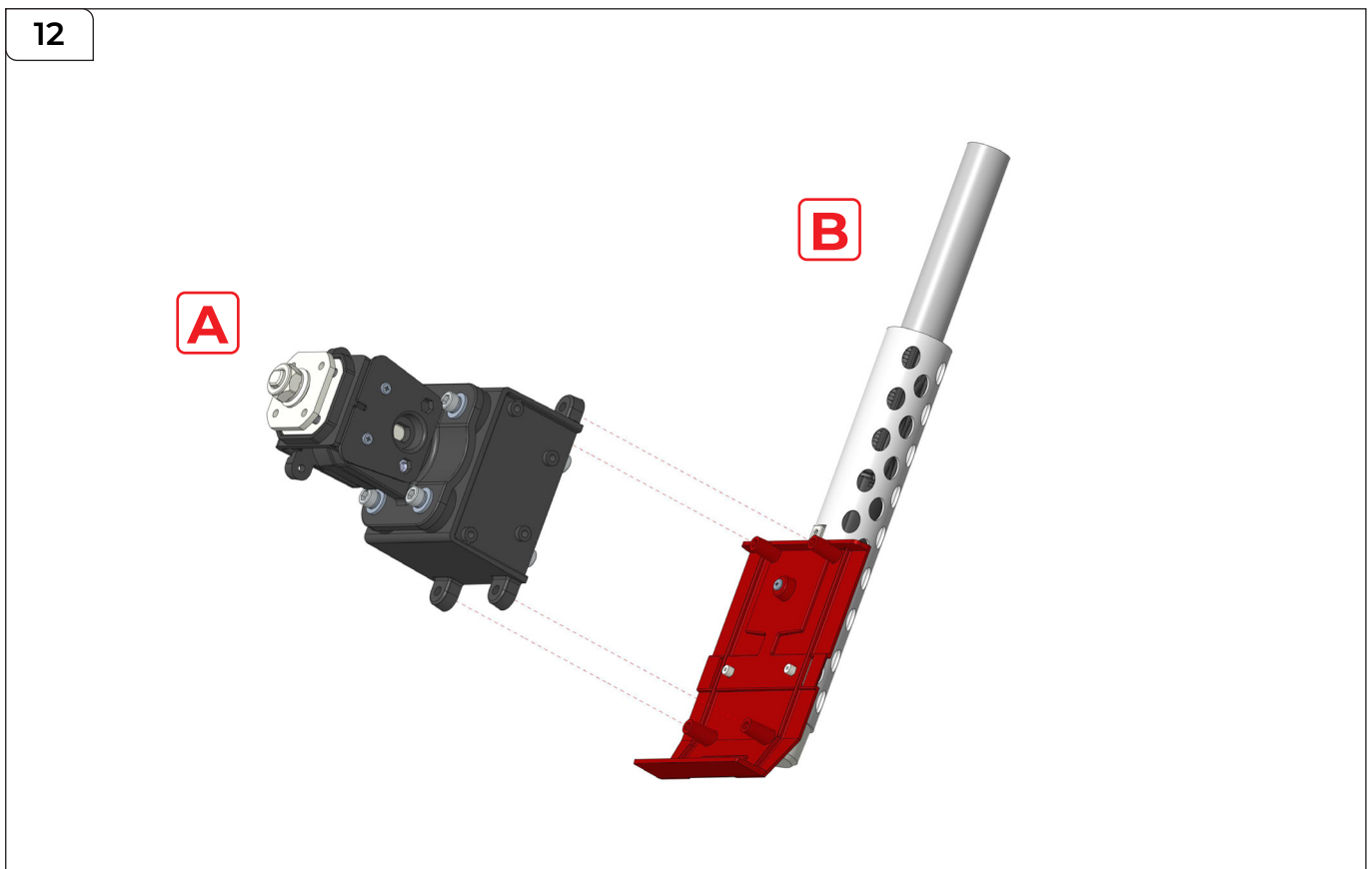
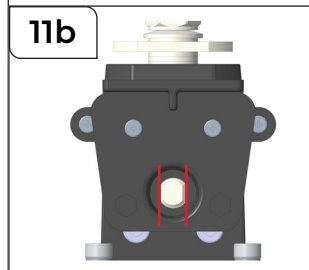

## STEP 12

Attach assembly **A** to assembly **B** as shown.

# Assembling the Left Shoulder & Arm

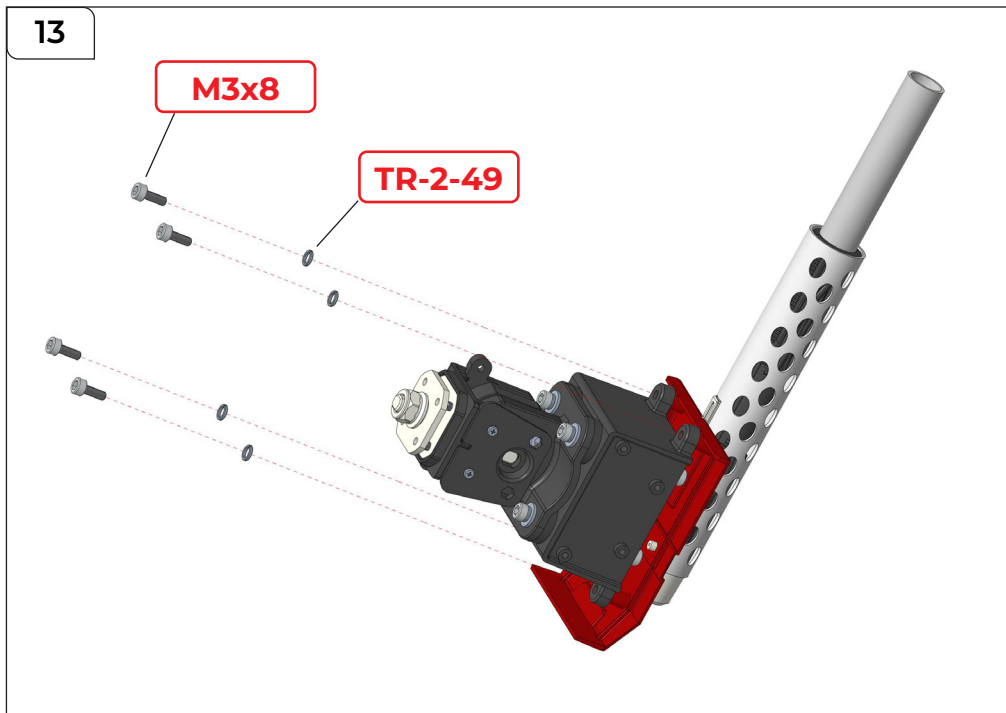

## STEP 13

Secure A to B using 4x washers TR-2-49 and 4x screws M3x8 mm as shown.

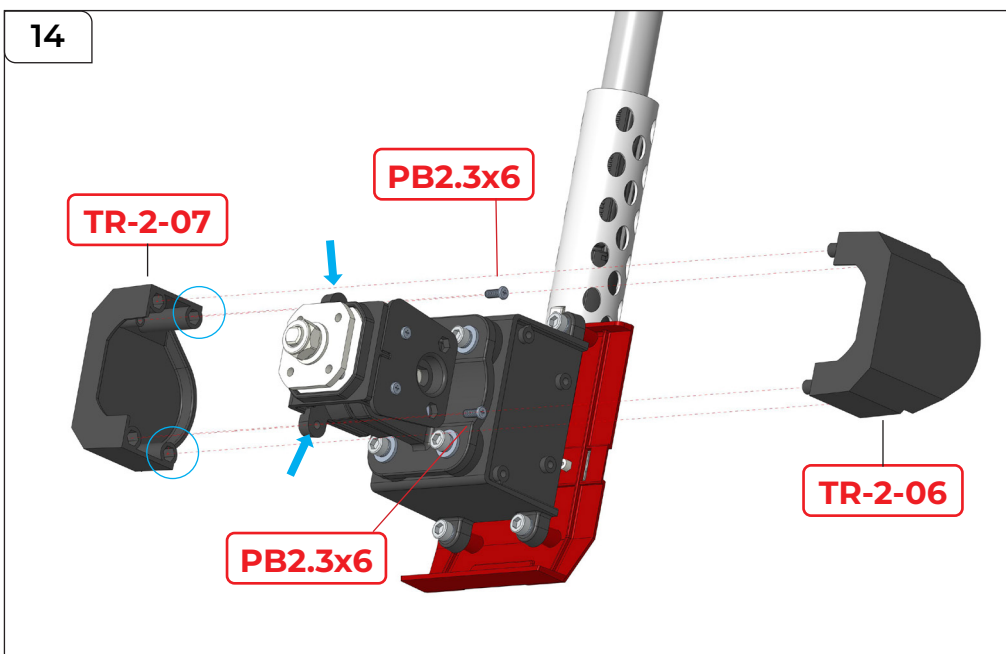

## STEP 14

Attach TR-2-07 to assembly A by driving 2x PB2.3x6 mm screws through the tabs (blue arrows) and into the screw posts on TR-2-07 (blue circles). Push the lugs on TR-2-06 into TR-2-07 to secure parts together.

# Assembling the Left Shoulder & Arm

15

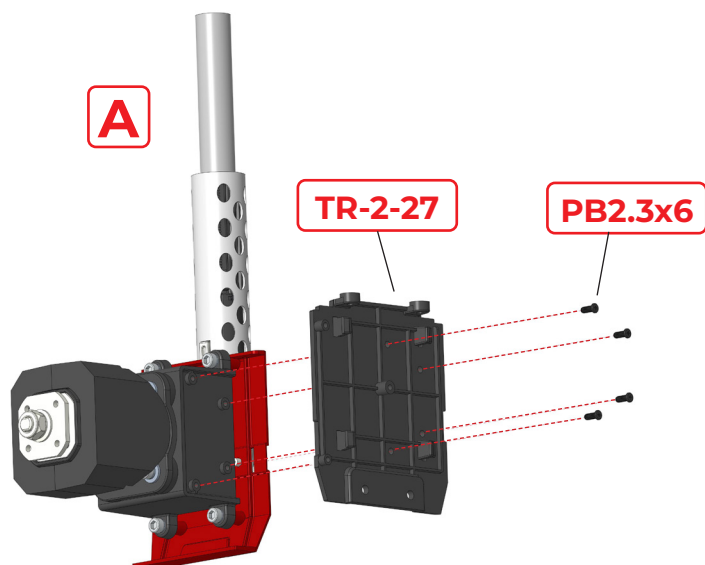

## STEP 15

Secure TR-2-27 to A using 4x PB2.3x6 mm screws.

16

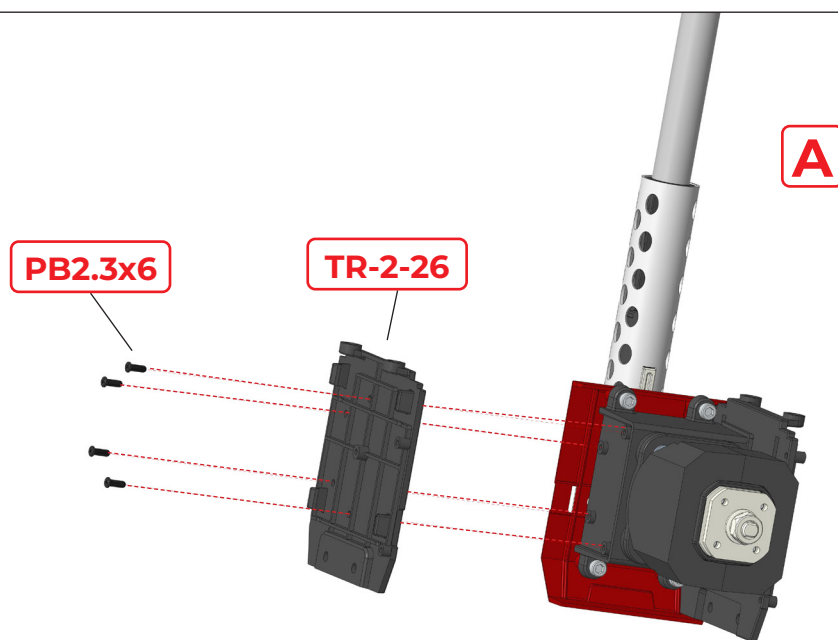

## STEP 16

Secure TR-2-26 to A using 4x PB2.3x6 mm screws.

## Assembling the Left Shoulder & Arm

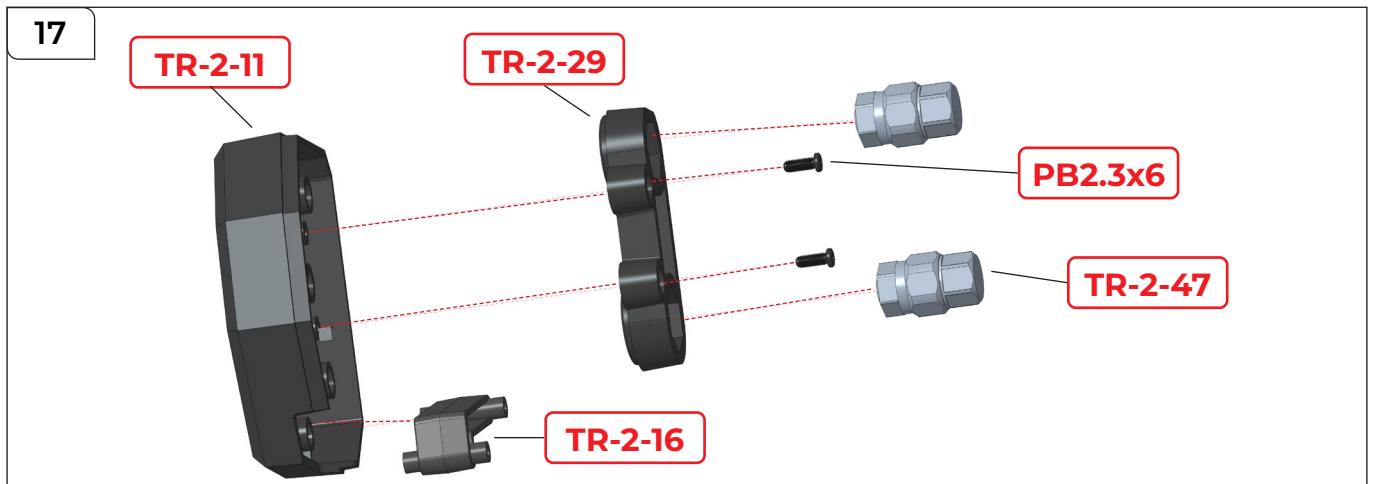

### STEP 17

Attach **TR-2-29** to **TR-2-11** and secure them with **2x PB2.3x6 mm screws**.

Attach **TR-2-47** to **TR-2-29**

Attach **TR-2-16** to **TR-2-11**. **Do not glue** as this is a moving part.

This is now referred to assembly as **A**.

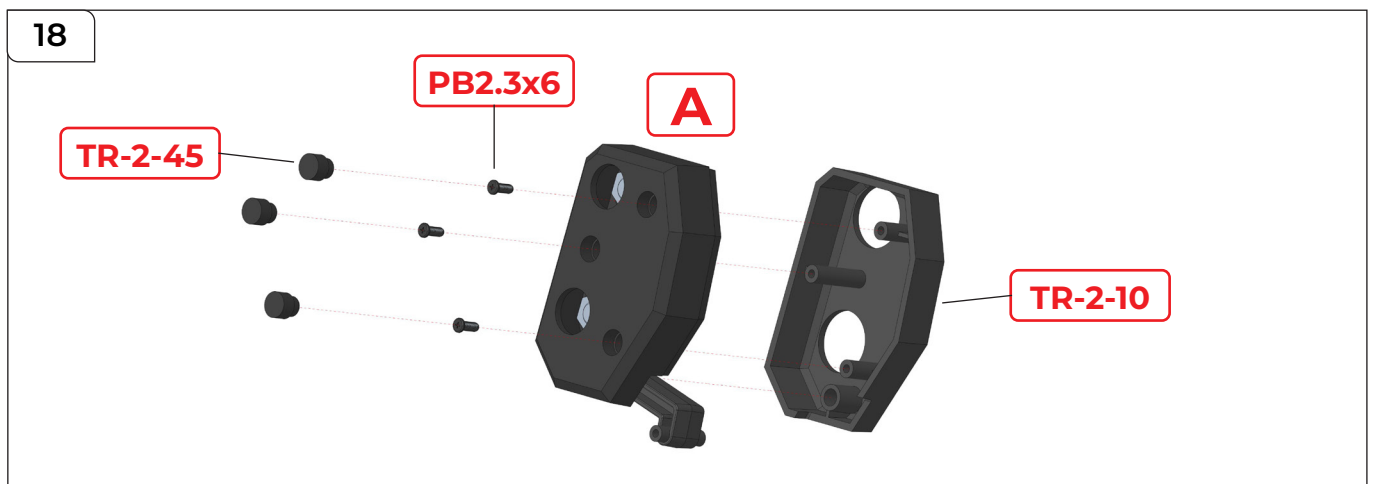

### STEP 18

Attach **TR-2-10** to assembly **A** and secure everything together using **3x PB2.3x6 mm screws**.

Then place **3x TR-2-45 caps** over the screws.

# Assembling the Left Shoulder & Arm

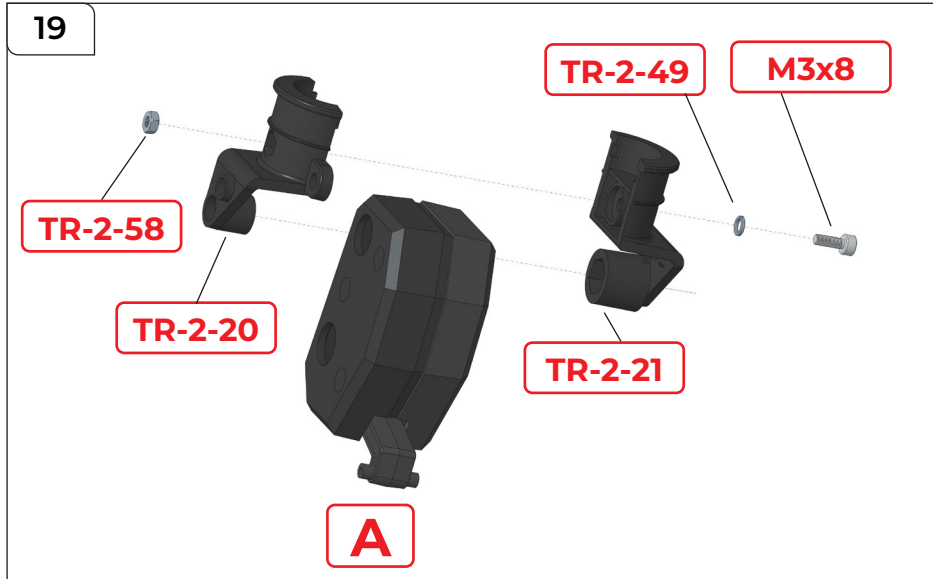

## STEP 19

Attach TR-2-20 and TR-2-21 to A. Thread washer TR-2-49 onto screw M3x8 mm and feed through the assembly, securing from the opposite side using a nut TR-2-58.

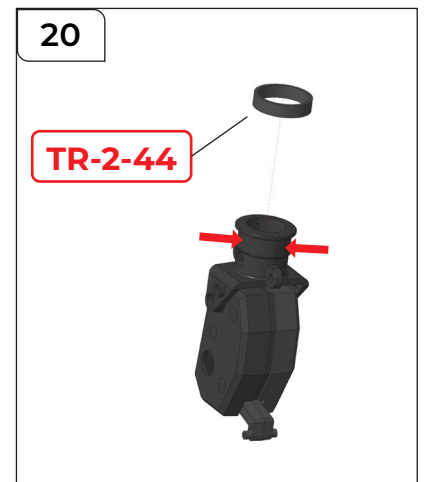

## STEP 20

Place TR-2-44 around the outside rim of the assembly.

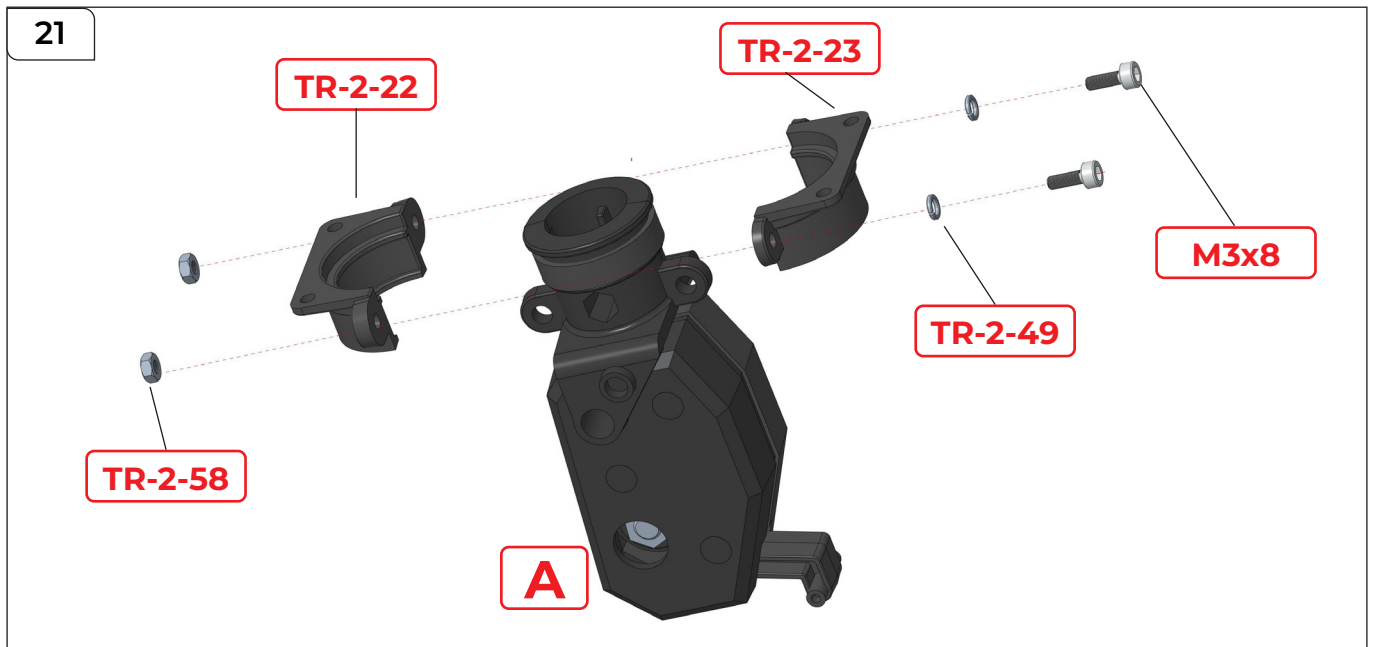

## STEP 21

Attach TR-2-22 and TR-2-23 to A as shown.

Thread washer TR-2-49 onto a M3x8 mm screw and make 2 sets. Push each screw with washer through the assembly as shown, securing them in place using 2x nuts TR-2-58.

# Assembling the Left Shoulder & Arm

22

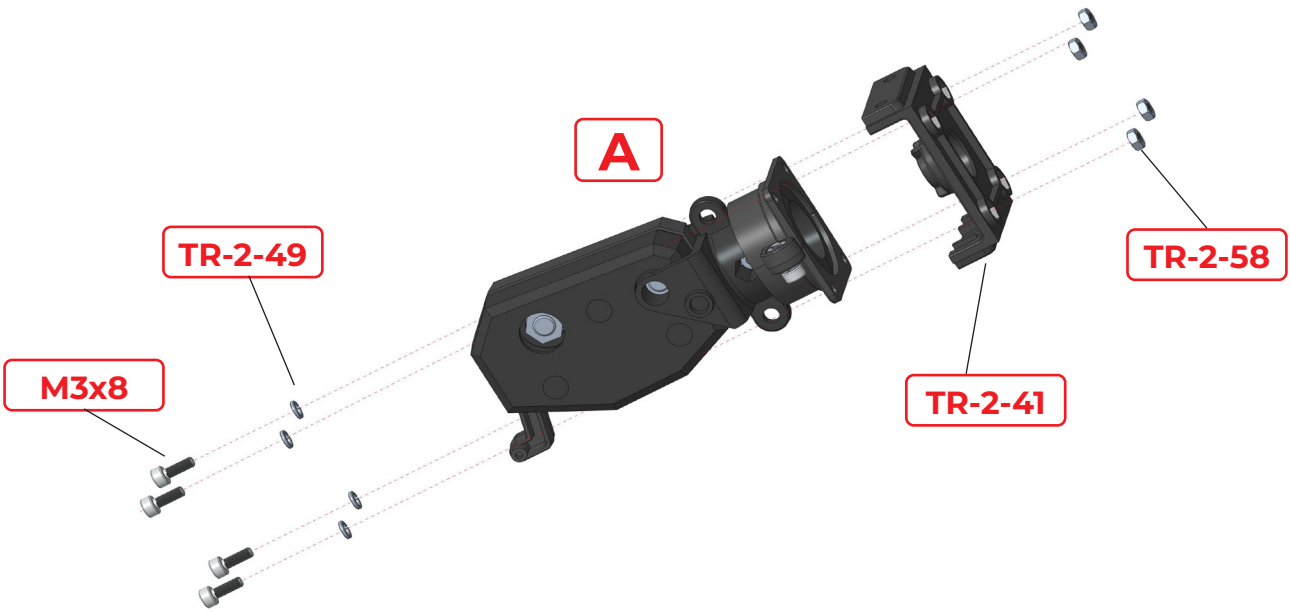

## STEP 22

Attach **TR-2-41** to **A** as shown.  
Thread washers **TR-2-49** onto **4x M3x8 mm screws** and push them through the assembly as shown, securing them in place from the opposite side using **nuts TR-2-58**.

23a

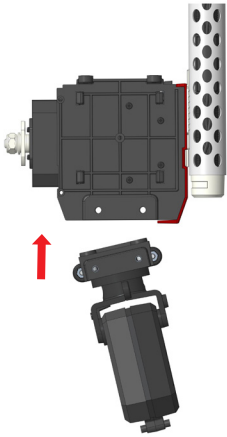

23b

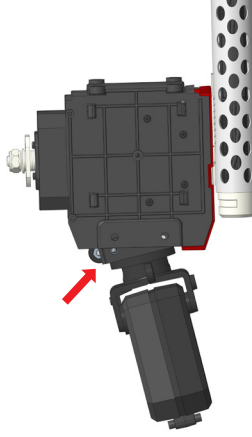

23c

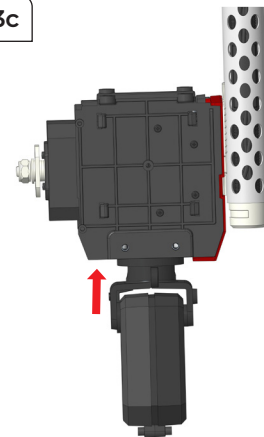

## STEP 23

Attach the assembly from step 22 to the assembly from step 16. Push into position, lining up the screw holes. Start with one screw hole, get it into position, then follow with the second screw hole, as demonstrated by the sequence above.



# Assembling the Left Shoulder & Arm

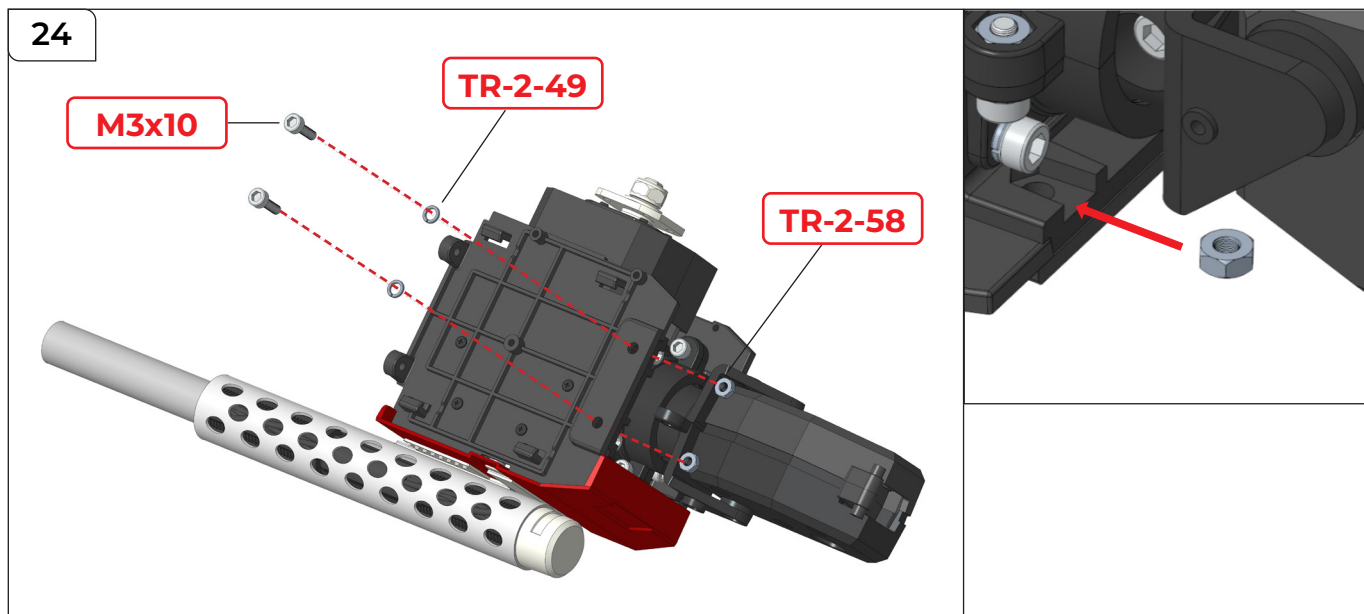

## STEP 24

Start by placing **TR-2-58** into each notch (shown above right), then place **washers TR-2-49** onto **2x M3x10 mm screws** before driving them into **TR-2-58** as shown.

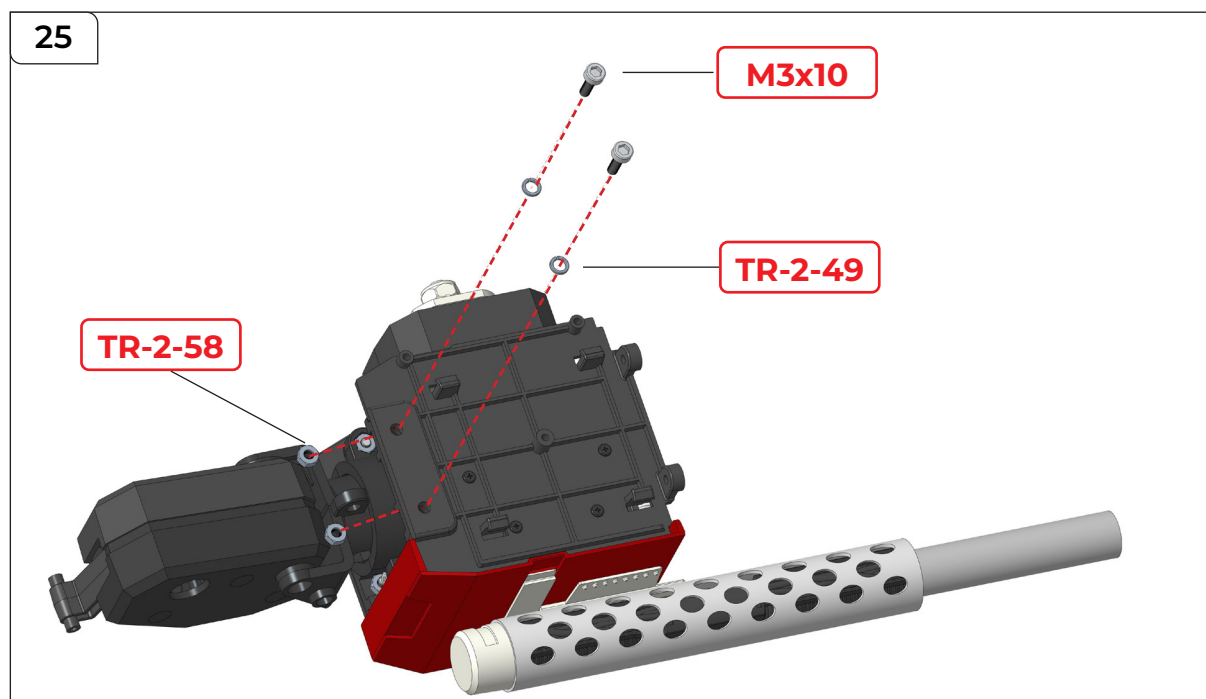

## STEP 25

Turn the assembly over and repeat step 24 on the opposite side.

# Assembling the Left Shoulder & Arm

26

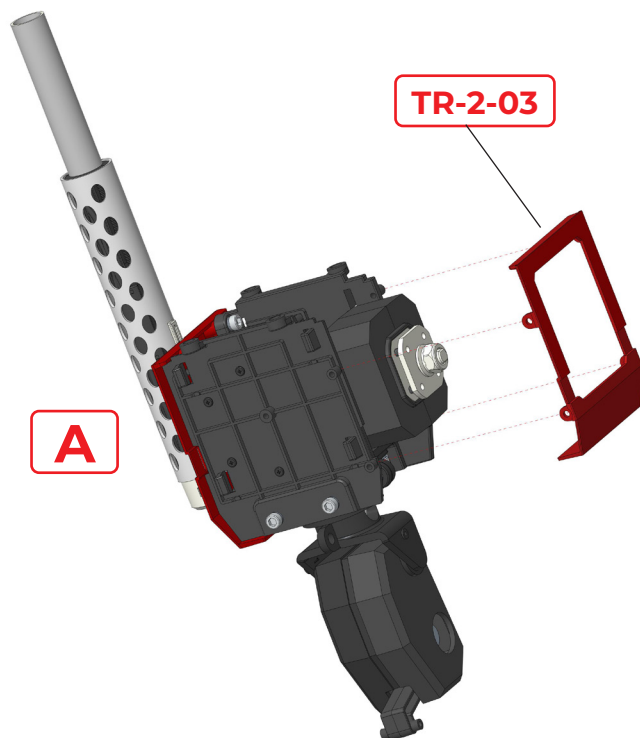

**STEP 26**

Position TR-2-03 onto A.

**STEP 27**

Secure the parts together using  
4x PB2.3x6 mm screws.

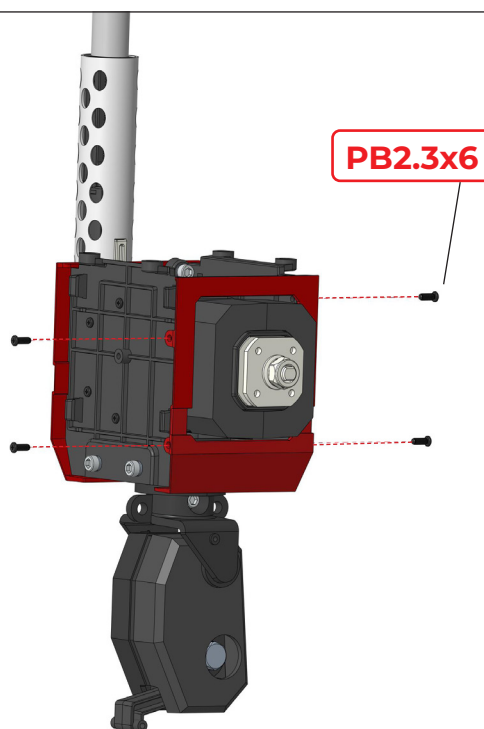

27

# Assembling the Left Shoulder & Arm

28

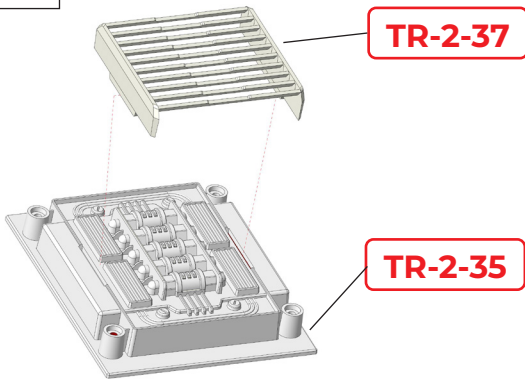

## STEP 28

Attach TR-2-37 to TR-2-35.

## STEP 29

Place TR-2-05 on top of TR-2-35 and secure it in place using 4x PWM2x6 mm screws.

Note: check the orientation of the blind window - shown in 29a - before completing the assembly. The louvres are horizontal and slope down and forwards from the back to the front.

TR-2-05

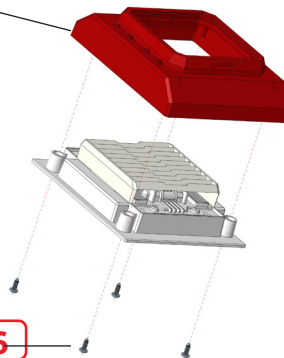

29

Back of model

29a

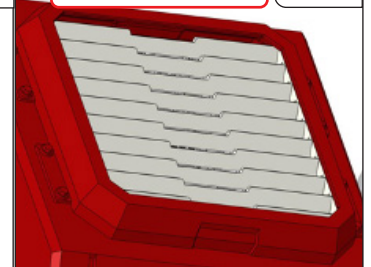

Front of model

30

PB2.3x6

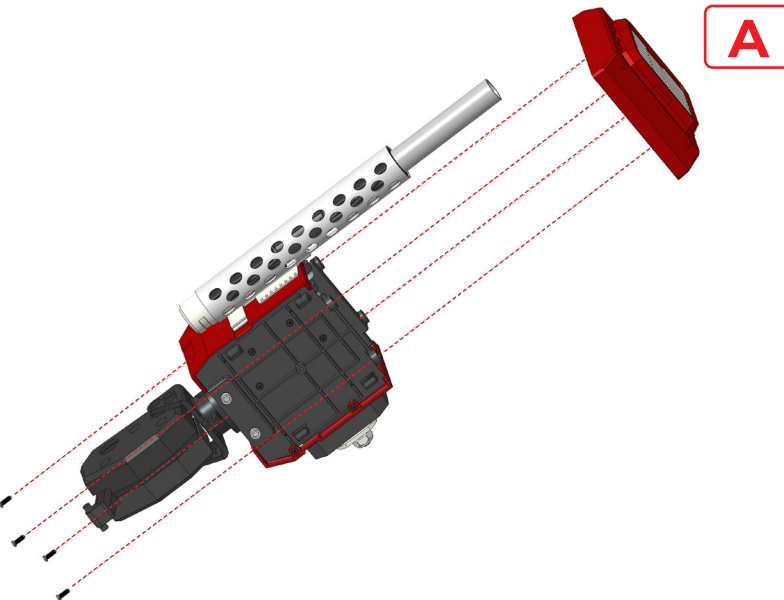

A

## STEP 30

Place assembly A onto the shoulder assembly from step 27, securing it in place using 4x PB2.3x6 mm screws.

# Assembling the Left Shoulder & Arm

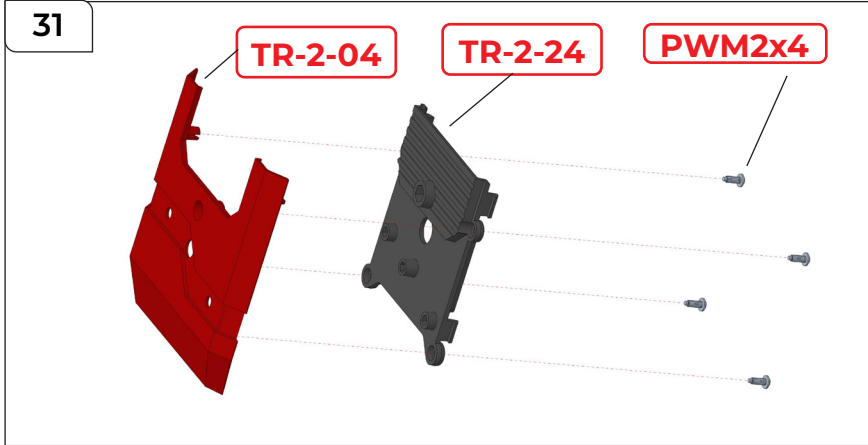

## STEP 31

Place TR-2-24 onto TR-2-04 and secure them together using 4x PWM2x4 mm screws as shown.

## STEP 32

Place the assembly from step 31 onto the shoulder assembly from step 30, sliding it into position in the direction of the arrow.

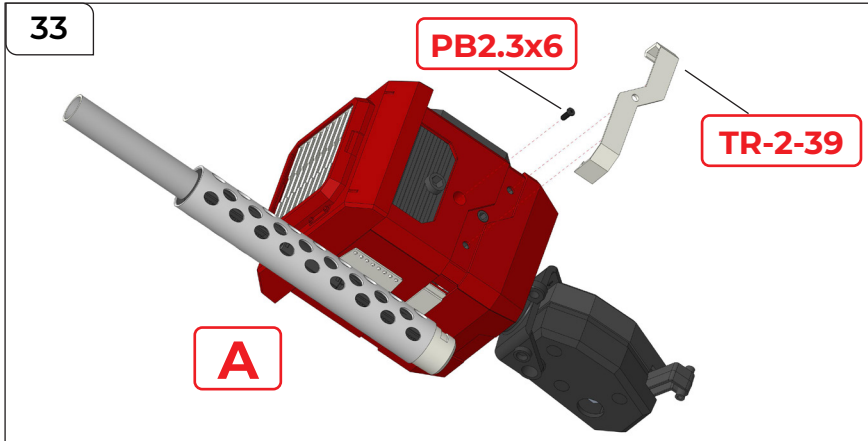
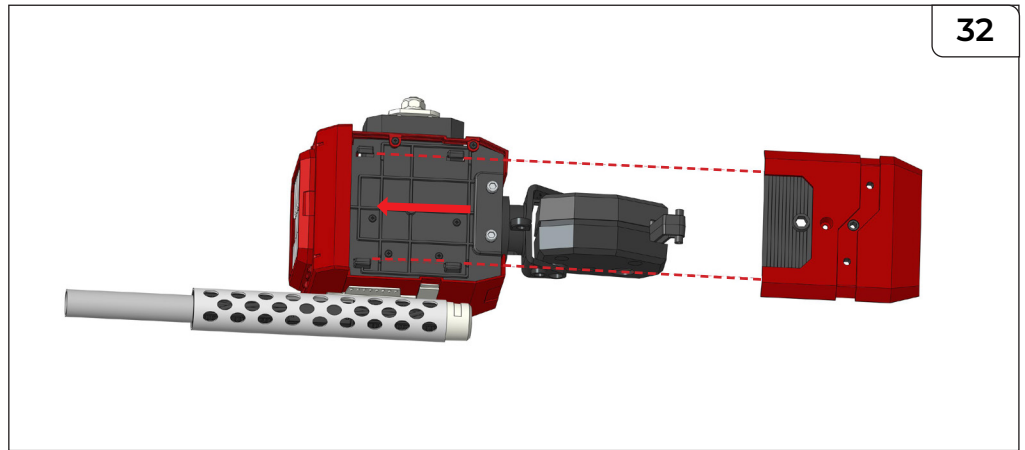

## STEP 33

Secure the parts from step 32 in position using a PB2.3x6 mm screw, then push TR-2-39 into A until it clicks into position.

## STEP 34

Place TR-2-34 onto TR-2-36 and secure them using a PB2x4 mm screw.

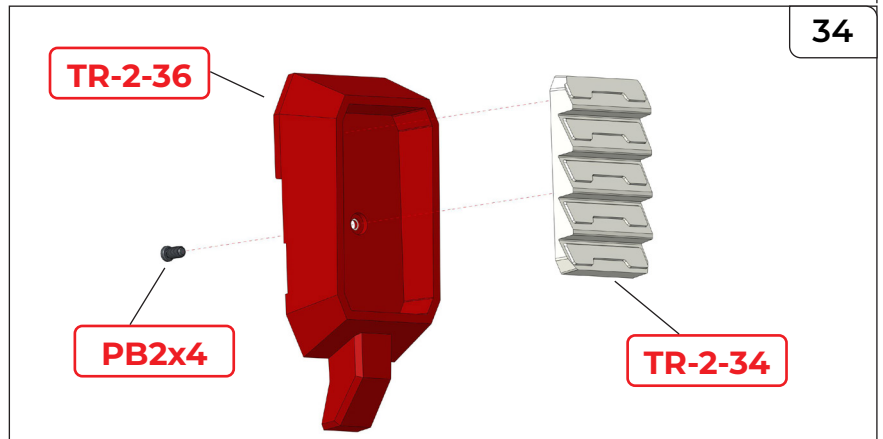

# Assembling the Left Shoulder & Arm

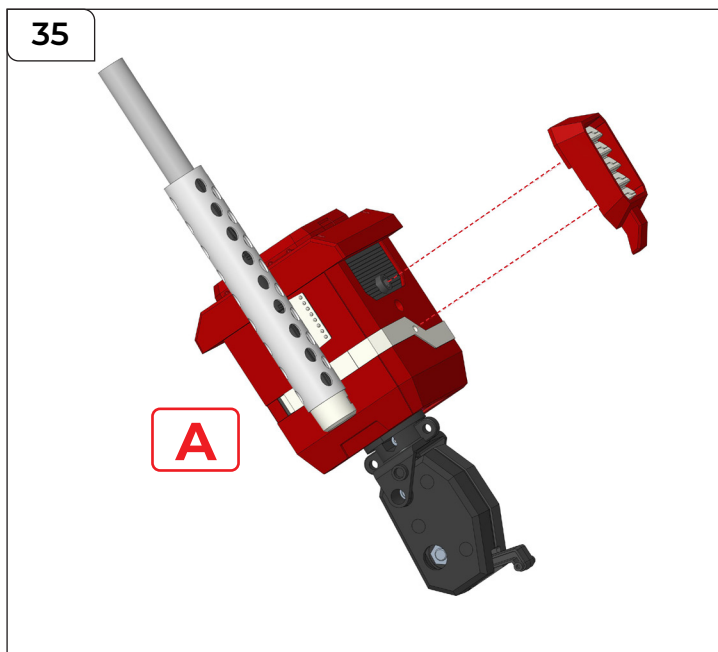

## STEP 35

Attach the assembly from step 34 to A as shown.

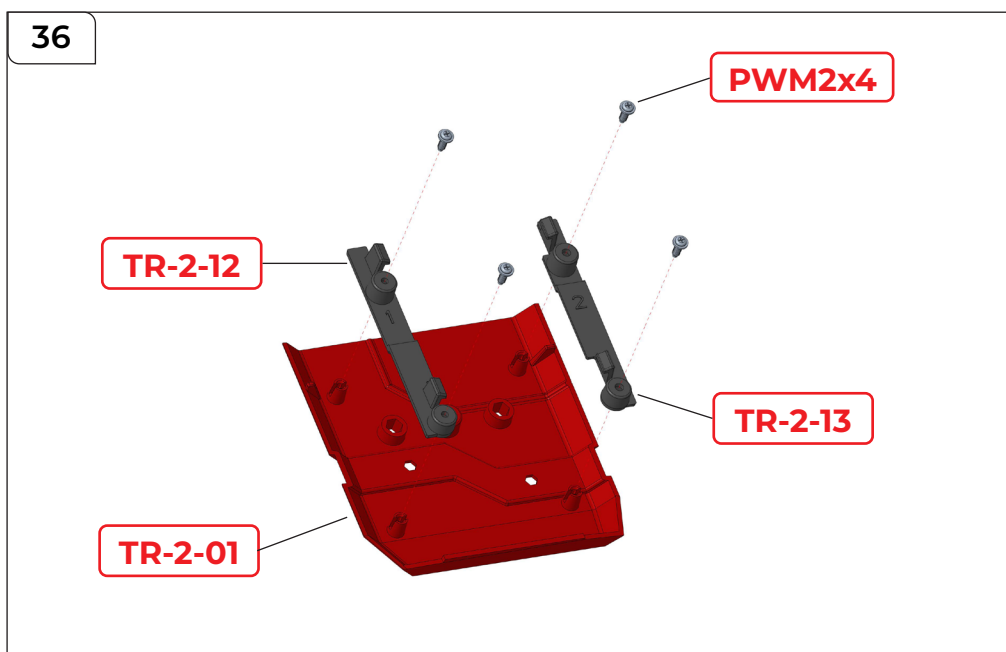

## STEP 36

Place TR-2-12 and TR-2-13 on TR-2-01 as shown, securing them with 4x PWM2x4 mm screws.

# Assembling the Left Shoulder & Arm

37

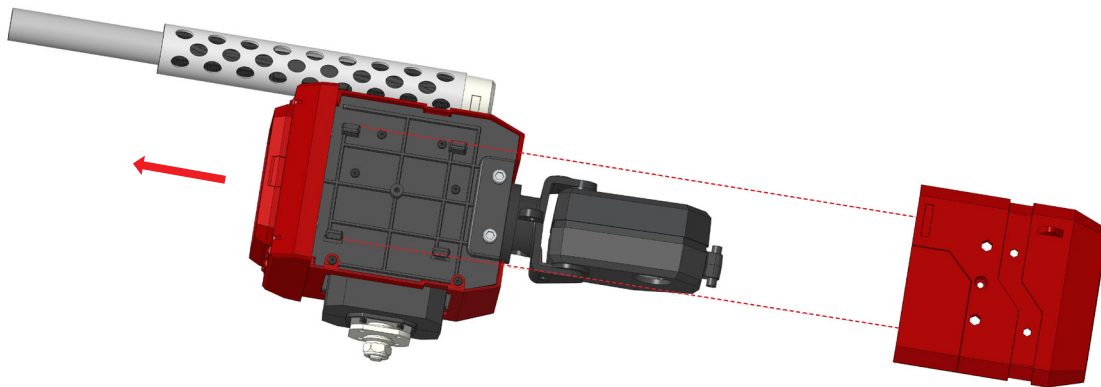

## STEP 37

Place the assembly from step 36 onto the shoulder, sliding it into position in the direction of the arrow.

38

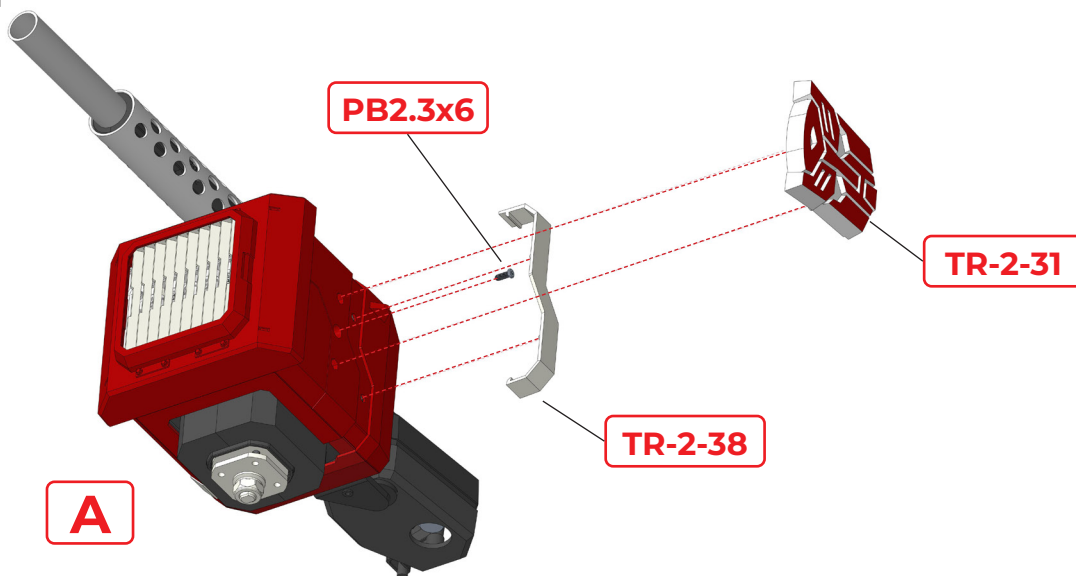

## STEP 38

Secure the parts from step 37 in place using a **PB2.3x6 mm screw**.  
Push **TR-2-38** into A as shown until it clicks into place.  
Fix **TR-2-31** to A.

# Assembling the Left Shoulder & Arm

39

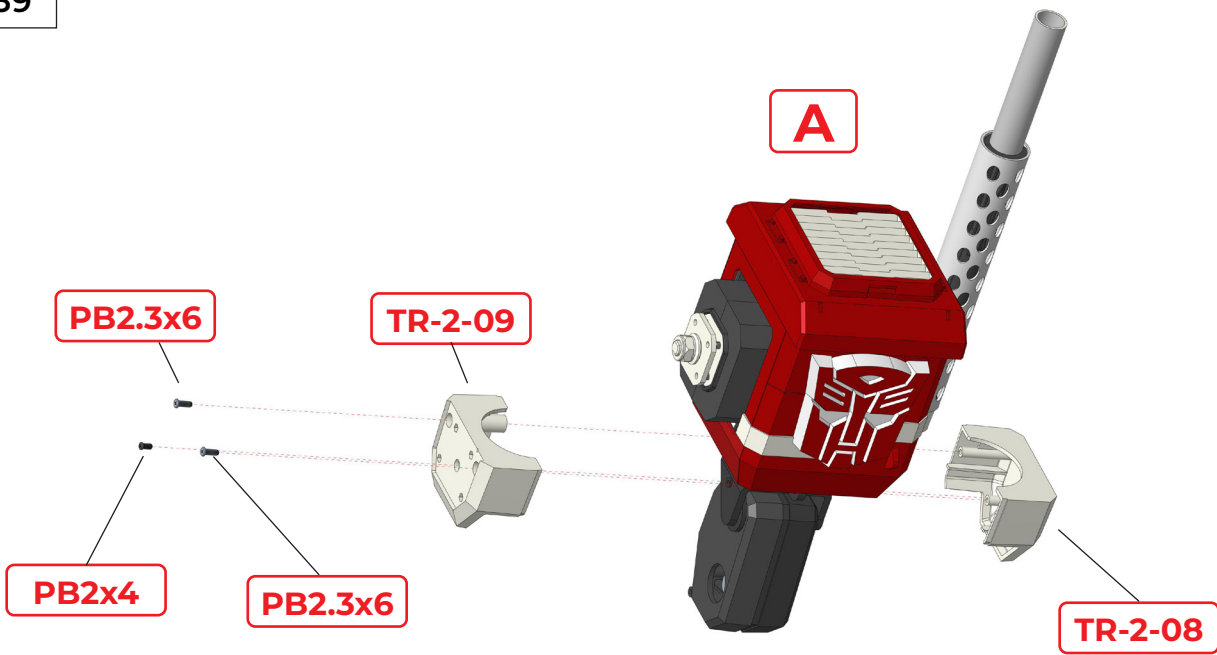

## STEP 39

Position **TR-2-08** and **TR-2-09** either side of **A** as shown. Secure them together using **2x PB2.3x6 mm screws** in the outer holes, and **1x PB2x4 mm screw** in the central hole.

40

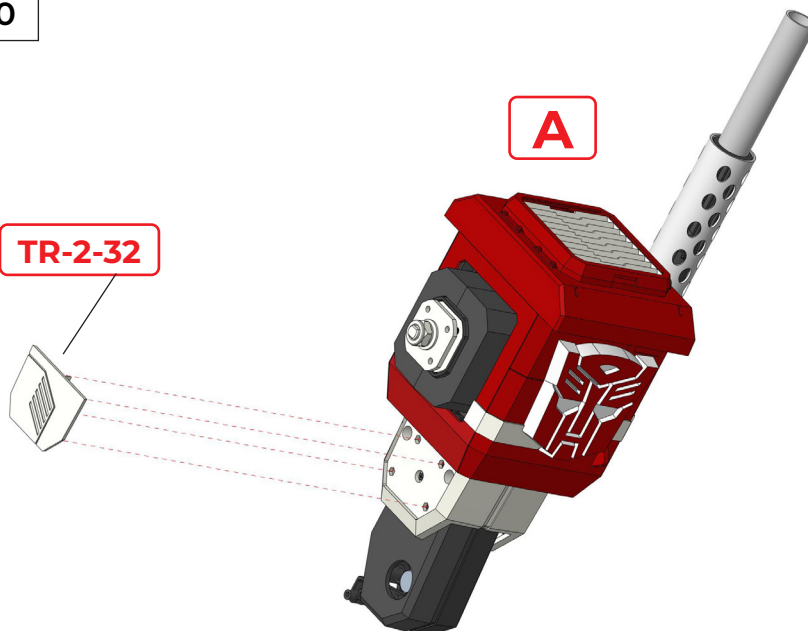

## STEP 40

Fix **TR-2-32** to **A** as shown.

# Assembling the Left Shoulder & Arm

PACK 2 COMPLETE

