



# FDNY<sup>®</sup>

## FIRE TRUCK TOWER LADDER 9



# Pack 08

## BUILD INSTRUCTIONS

**STAGE 50: COMPONENTS FOR THE ROOF,  
STARTING ASSEMBLY OF THE PLATFORM, &  
INSTALLING A CROWBAR**

**STAGE 51: FIXING THE HOSE REEL AND  
STORAGE COMPARTMENT TO THE ROOF**

**STAGE 52: ASSEMBLING THE PLATFORM**

**STAGE 53: STORAGE BOX COVER AND BLACK  
COVER**

**STAGE 54: LEFT-HAND SIDE WHEEL  
ARCH COVER**

**STAGE 55: COMPONENTS FOR THE ROOF AND  
TWO MORE TOOLS**

**STAGE 56: STAGE 56: ROOF COMPONENTS  
AND ANOTHER TWO TOOLS**

**STAGE 57: RIGHT-HAND SIDE WHEEL ARCH  
COVER & CUPBOARD COVER**

**AGORA**  
MODELS

## Advice from the experts

---

 **Please keep ALL unused screws as they will be required in a later stage.**

Please make sure you don't mix up the screws. They look quite similar, but the threads do vary slightly. Using the wrong screws may damage the parts.

When securing parts together using multiple screws, fit each screw loosely to ensure all the parts are correctly aligned before gently tightening them firmly, but not overtight, in the order in which you placed them.

The screwdriver can be magnetized by stroking it with a magnet (fridge magnet, etc.) enabling it to hold the screws and make assembly easier.

If a screw is tight going into a metal part, do not force it as you may shear the head off. Remove it and put a tiny smear of Vaseline, soap or light oil on the thread. That will lubricate it and make it easier to drive home.

During the course of this build, you will receive many pieces that you will assemble immediately – following the instructions in the corresponding stage – and other pieces that you should store safely to one side, for use in future assembly stages.

Left and Right! When building your fire truck, the left or right hand side refers to each side as you are sitting in the cab.



**WARNING:** Some parts are assembled using magnets. These magnets can cause serious injury if they are swallowed. Keep away from children. If you suspect a magnet has been swallowed, seek medical help straight away.

# Stage 50: Components for the Roof, Starting Assembly of the Platform, & Installing a Halligan Bar

In Pack 8, you will add components to the main body roof, collect various tools, and start to assemble the platform. In the final stage, the fire-fighters seats will be installed into the cab.



## STAGE 50 PARTS LIST

Name	Name
Warning bar	Ladder pipe part b
Platform brackets x2	Piston outer sections x2
Piston poles x2	Light lenses x4
Tarp box	Piston ends x2
Halligan bar	Type B screws x4
Platform base	Type E screw x1
Ladder pipe part a	



Note: in early versions of the build instructions, the tarp and tarp box may have been referred to as the blanket and blanket box. This has now been corrected.

## Stage 50: Components for the Roof, Starting Assembly of the Platform, & Installing a Halligan Bar

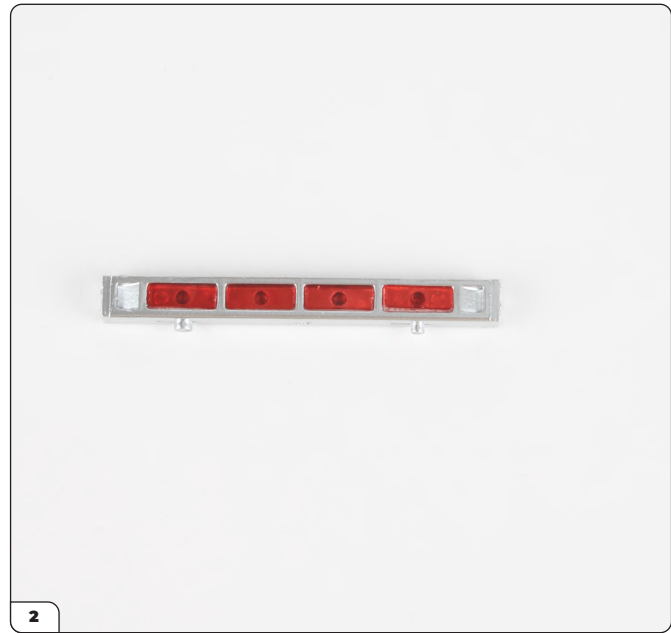
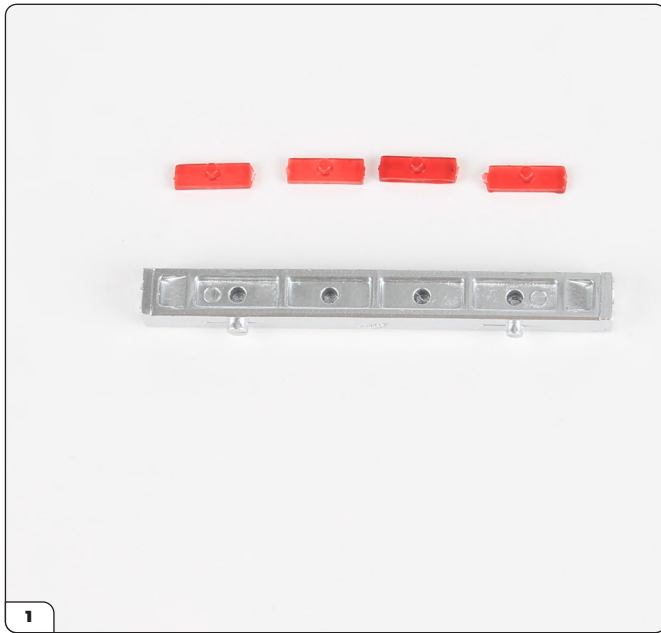

**FIXING COMPONENTS TO THE FIRE TRUCK MAIN BODY**  
Take the warning bar and prepare the four light lenses. Note that each lens has a tiny lug on the underside that will fit into the corresponding hole on the bar. Apply a drop of glue into the hole in the bar before pushing each lens into place.

Fix all four lenses onto the warning bar.



Push the warning bar into the two small holes at the rear of the fire truck main body so that the lenses face outwards.

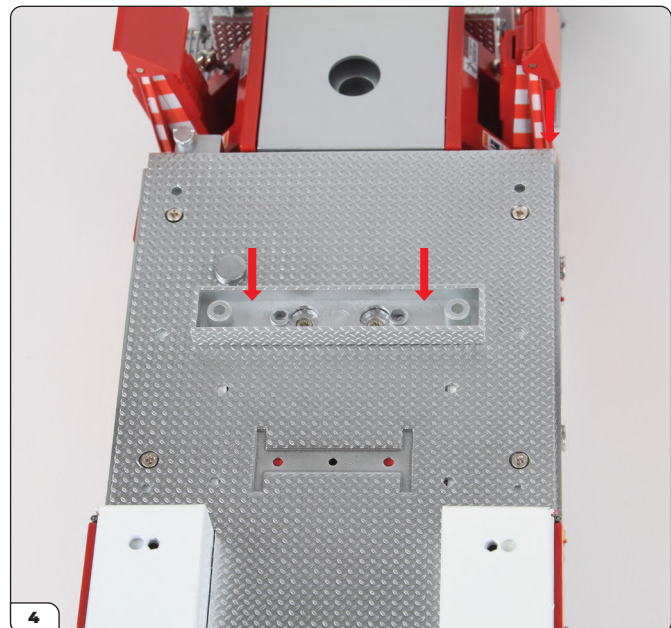

Next, take the tarp box and push the two lugs on its flat surface into the front part of the main body as shown.

# Stage 50: Components for the Roof, Starting Assembly of the Platform, & Installing a Halligan Bar

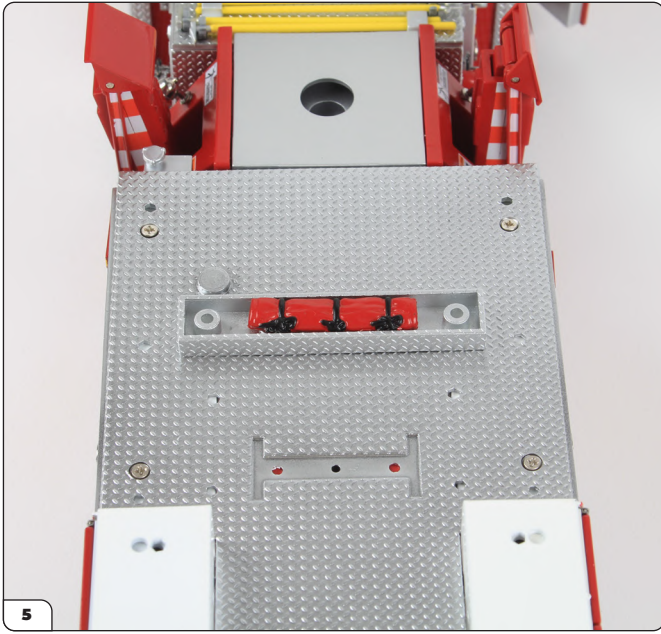

Push the tarp supplied with pack 7, stage 49, into the tarp box.



### ASSEMBLING THE PLATFORM

To begin assembly of the platform, align the ladder pipe parts a & b as shown.

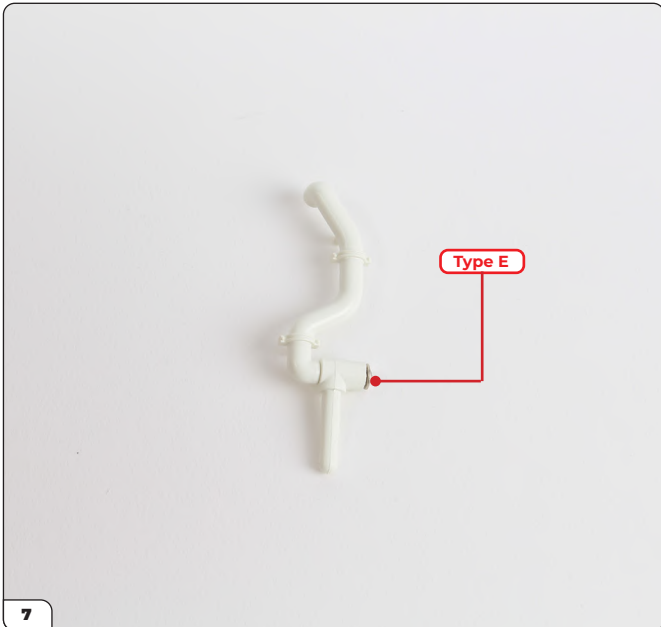

Push them together and secure using the Type E Screw.



Now take the platform base and push the ladder pipe assembly into the two central holes, in the orientation shown.

# Stage 50: Components for the Roof, Starting Assembly of the Platform, & Installing a Halligan Bar

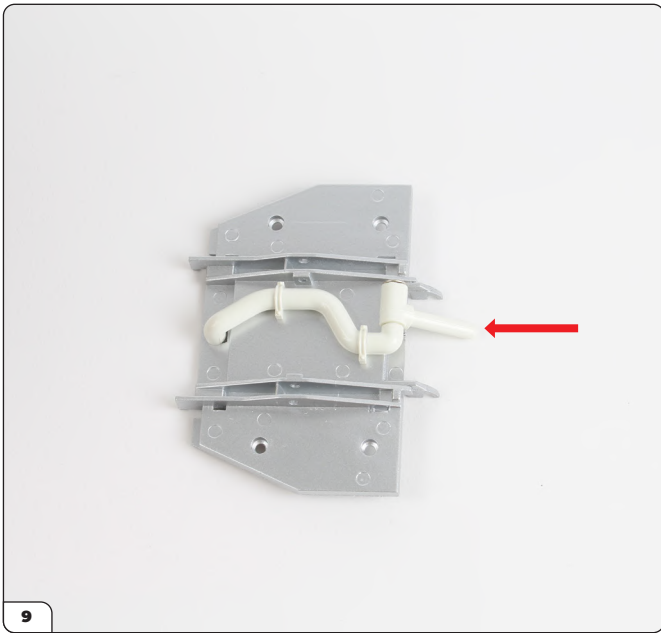

Note that the 'T'-shaped pipe projects between the two platform hinges (arrow).

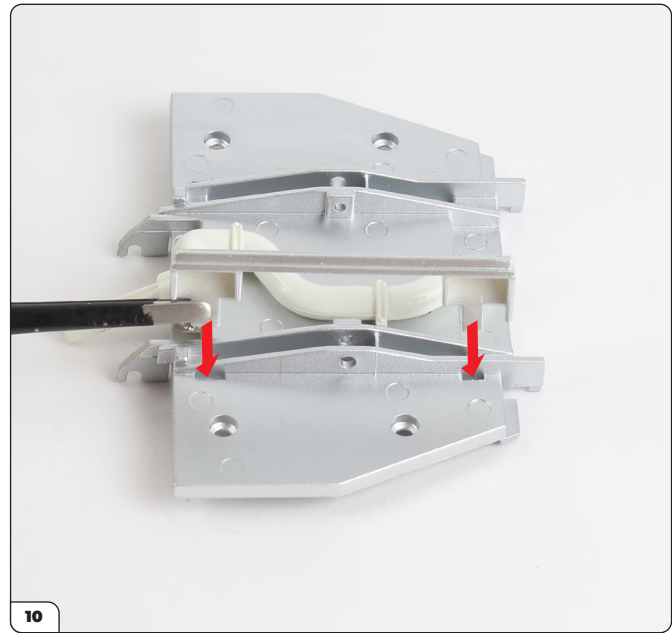

Take one of the platform brackets and line it up with the channel on the platform base so that the flat faces are flush.

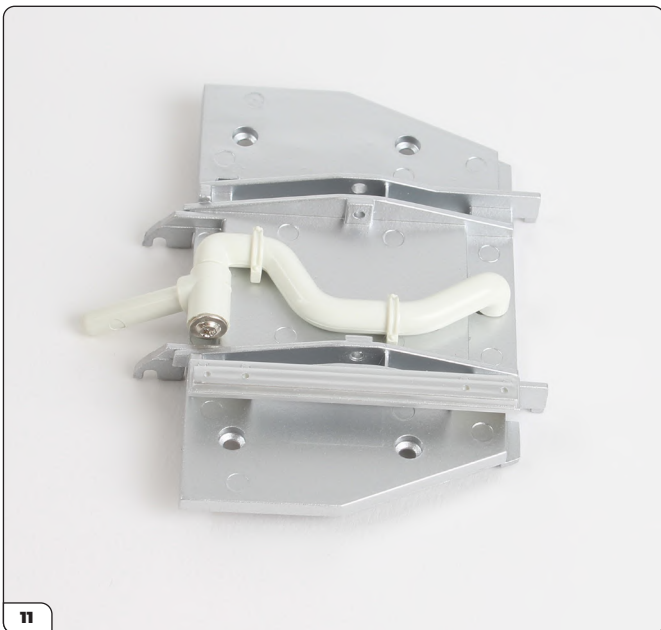

Push the tabs on the bracket into the slots on the base.

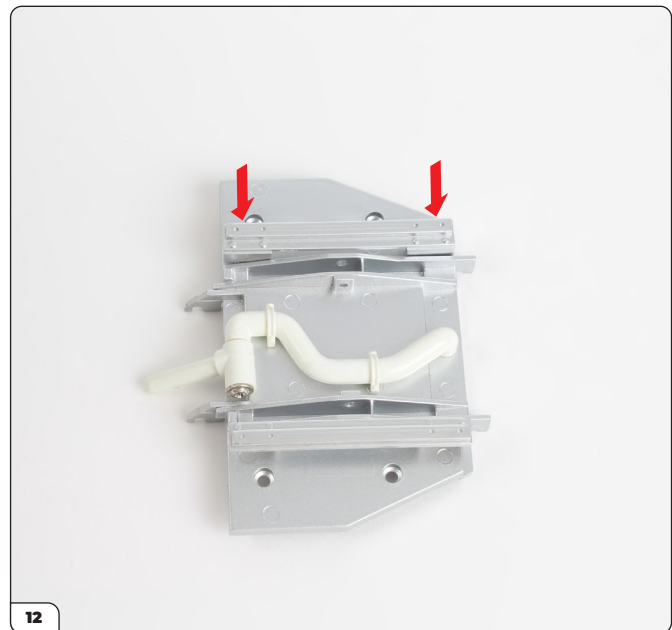

Repeat steps 10 and 11 to fit the second bracket to the platform base.

## Stage 50: Components for the Roof, Starting Assembly of the Platform, & Installing a Halligan Bar



Prepare to assemble the pistons by aligning the piston pole, piston outer section, and piston end. Push the piston into the outer section as far as it will go, and the piston end onto the opposite end.



Assemble the second piston the same way, then put them both to one side.

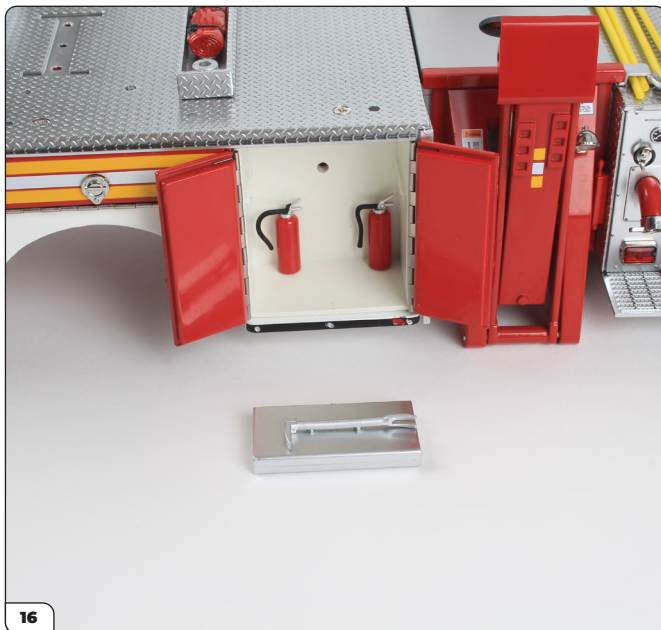

### INSTALLING THE HALLIGAN BAR

Open the storage compartment next to the right-hand outrigger and carefully slide out the shelf. Push the halligan bar into the shelf as shown.



Slide the shelf back onto the brackets inside the compartment.

# Stage 50: Components for the Roof, Starting Assembly of the Platform, & Installing a Halligan Bar

STAGE COMPLETE





# Stage 51: Fixing the Electrical Cable Reel and Storage Compartment to the Roof

In this next stage, you'll assemble the electrical cable reel and a storage compartment with opening lid, which are then fixed to the roof of the main body.



## STAGE 51 PARTS LIST

Name
Cable
Reel retraction
Bracket
Door Lock
Reel ends x2
Fairlead rollers

Name
Handle
Storage compartment base
Storage compartment lid
Storage compartment inner
Type B screws x1

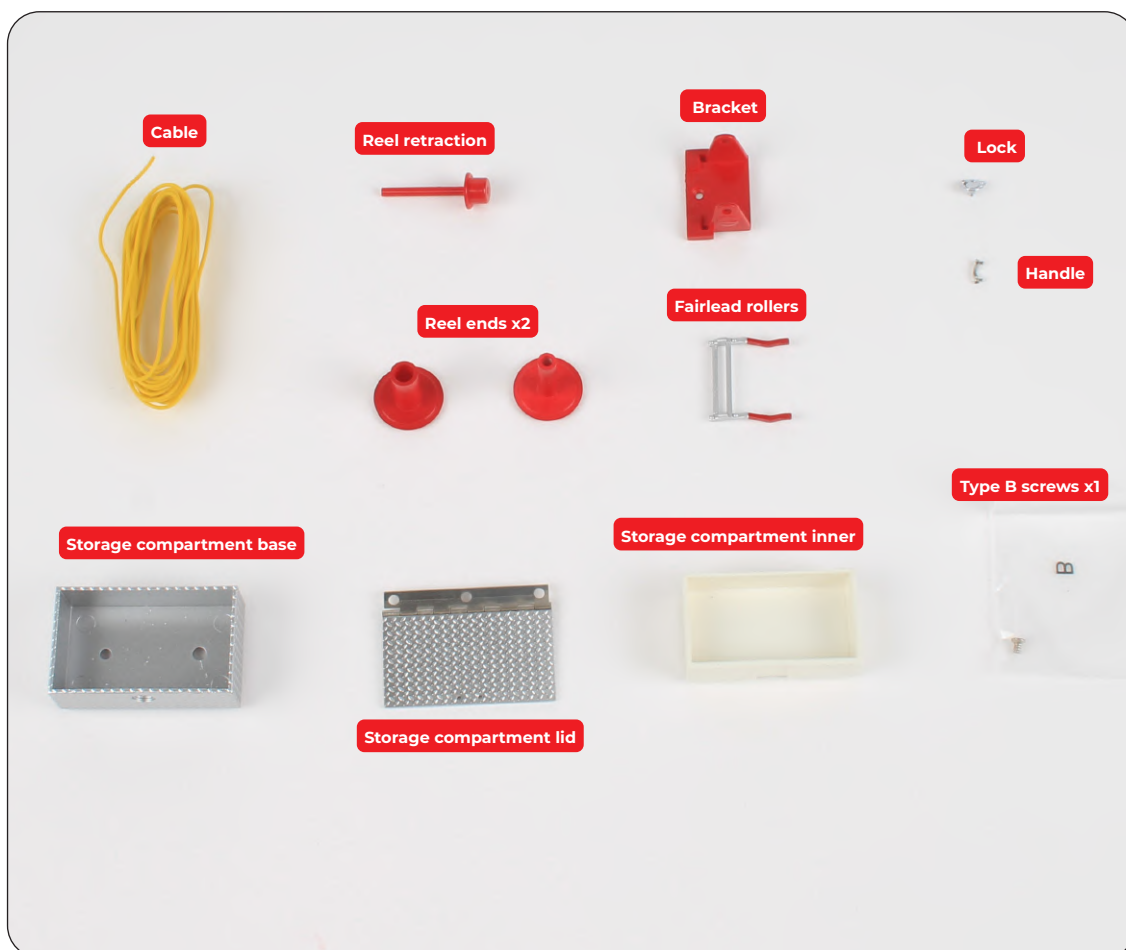

## Stage 51: Fixing the Electrical Cable Reel and Storage Compartment to the Roof



### ASSEMBLING THE CABLE REEL

Take both the reel ends and slide the narrower cylinder into the wider cylinder.



Push the parts firmly together.



To coil the cable around the reel, start by wrapping one end tightly around the cylinder. You may wish to secure this end with a little glue. Continue to wind the length of cable neatly around the cylinder.



Apply a little glue to the free end, then tuck it into the side of the reel.

## Stage 51: Fixing the Electrical Cable Reel and Storage Compartment to the Roof



Check your neatly wound cable is not going to unravel before resting it on the bracket.

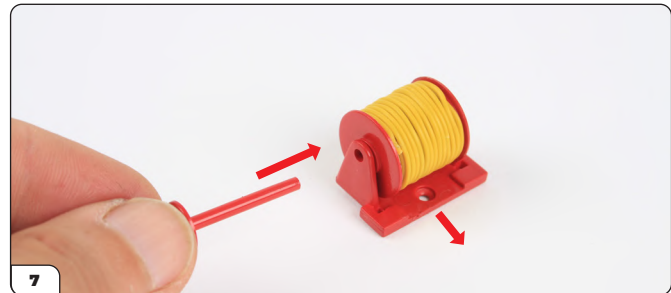

Secure the reel to the bracket by pushing the reel retraction through the bracket, cylinders, and out through the other side of the bracket. Check you have the reel in the correct orientation, with the screw hole facing you, the retraction is fed through from the left-hand side.

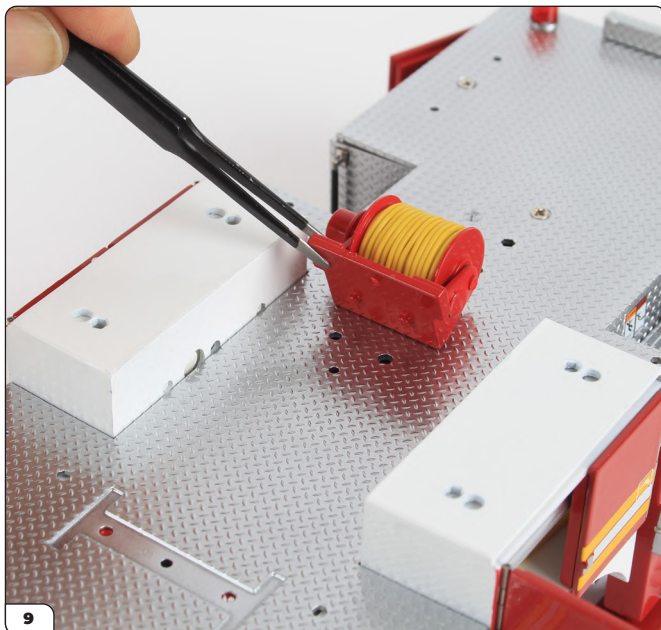

Place the cable reel on the roof of the main body, pushing the lugs into the holes between the two storage compartments, and aligning the screw holes.

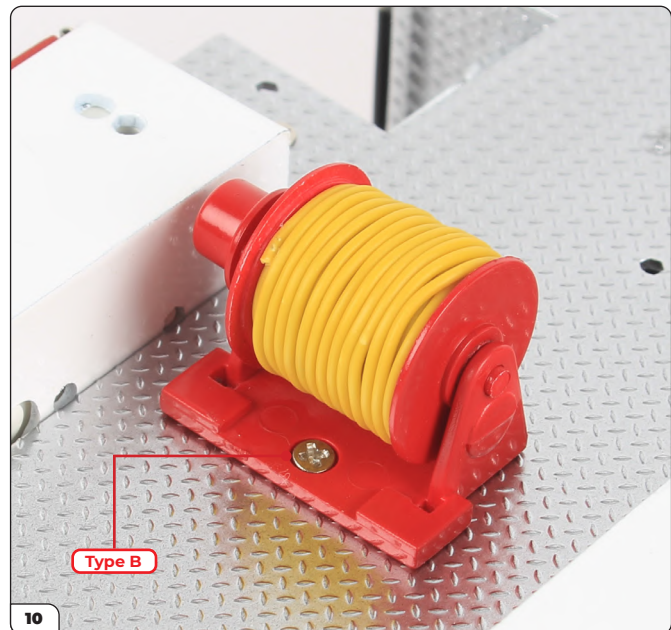

Secure the cable reel in place using a Type B screw.

## Stage 51: Fixing the Electrical Cable Reel and Storage Compartment to the Roof

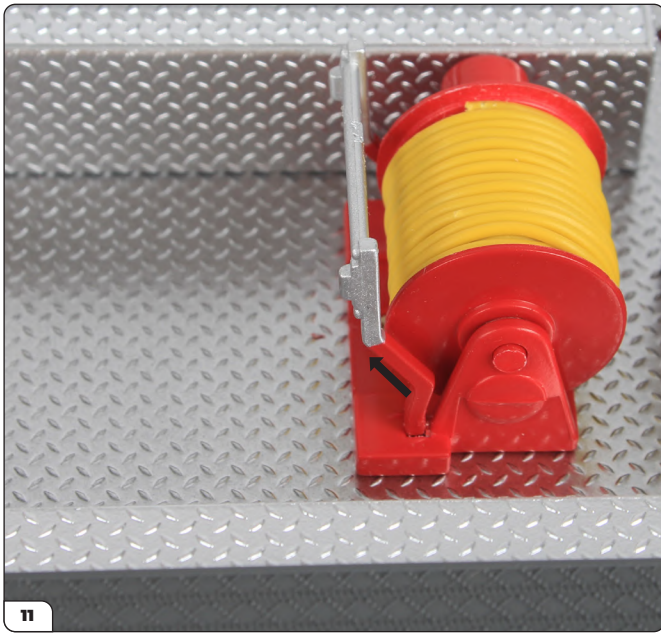

Check you have the correct orientation (arrow) before apply a little glue to the ends of the Fairlead rollers and pushing them into the bracket.

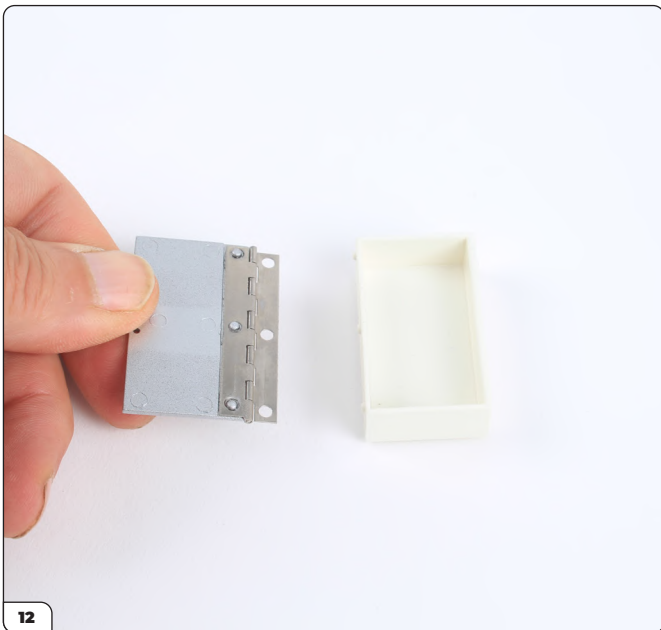

### ASSEMBLING THE STORAGE COMPARTMENT

Apply a little glue to the hinge of the storage compartment lid and align it with lugs along the side of the storage compartment inner.



Press firmly to fix, with the lid in the closed position.

## Stage 51: Fixing the Electrical Cable Reel and Storage Compartment to the Roof

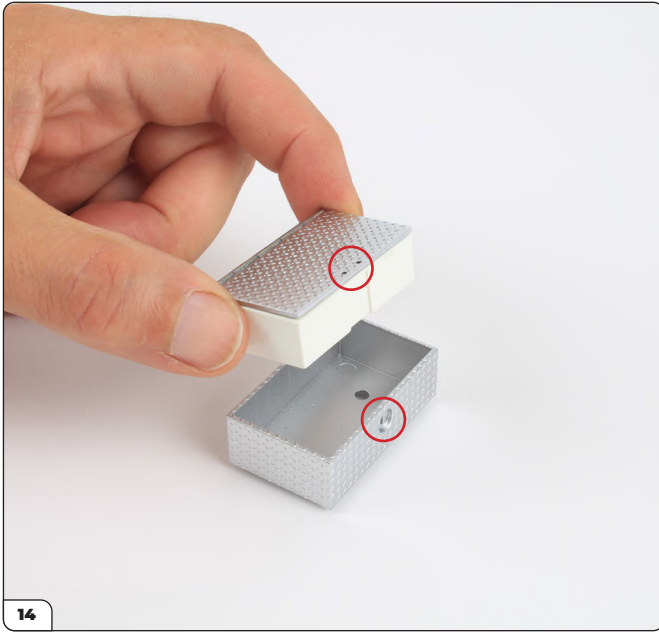

Push the lid/inner compartment assembly into the compartment base, checking that the holes for the handle and door lock are along the same edge (circled).

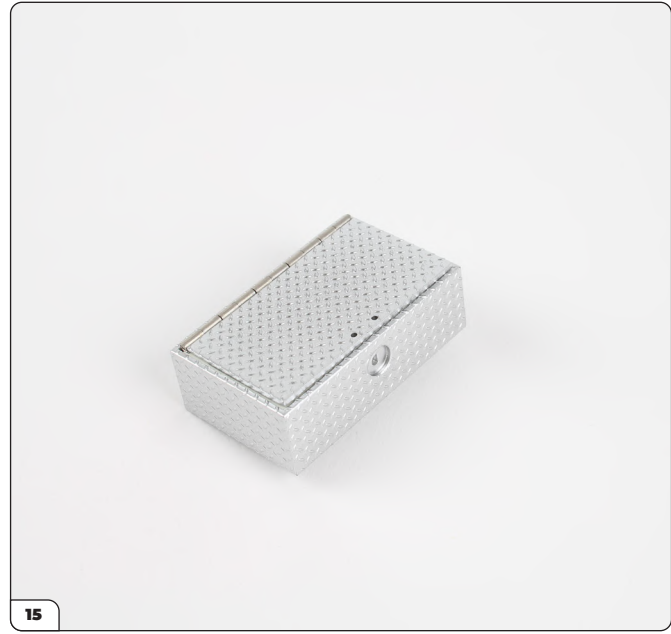

Push firmly to fit.



Apply a little glue to the lock before fixing it to the front of the storage compartment.



Apply a little glue to the handle before fixing it to the lid.

## Stage 51: Fixing the Electrical Cable Reel and Storage Compartment to the Roof

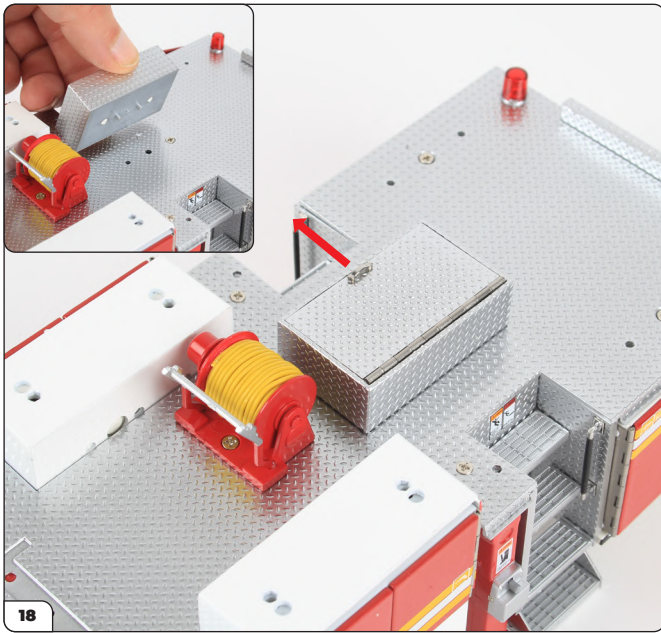

Fit the storage compartment to the main body roof, just behind the cable reel, with handle and lock facing the right-hand side of the fire truck (arrow).

**STAGE COMPLETE**



## Stage 52: Assembling the Platform

In this next stage, the platform continues to take shape.



### STAGE 52 PARTS LIST

Name
Platform ladder
Nozzle
Nozzle swivel base
Platform control box
Platform floor
Cable run
Type A screws x6

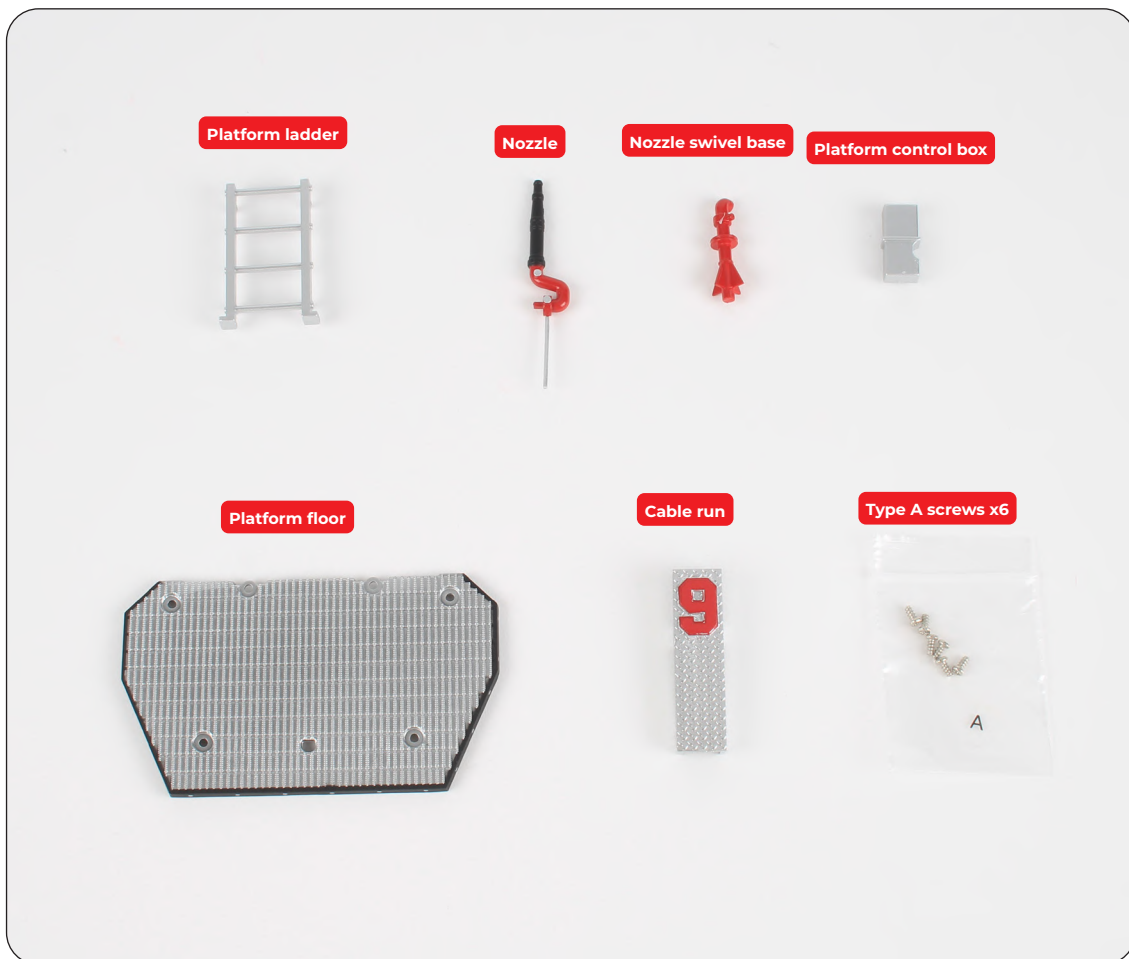

## Stage 52: Assembling the Platform

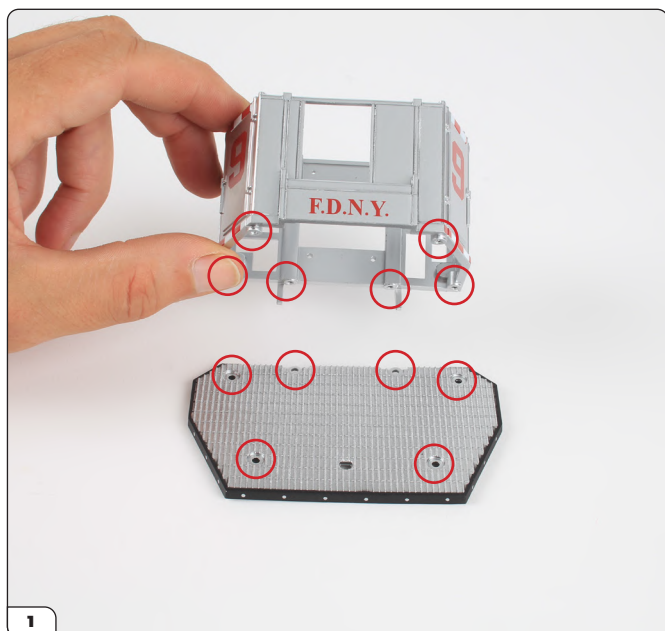

### ASSEMBLING THE PLATFORM

Take the platform sides that you assembled in Pack 1, Stage 6, and prepare to attach them to the platform floor. Align the six screw holes indicated above (circled).

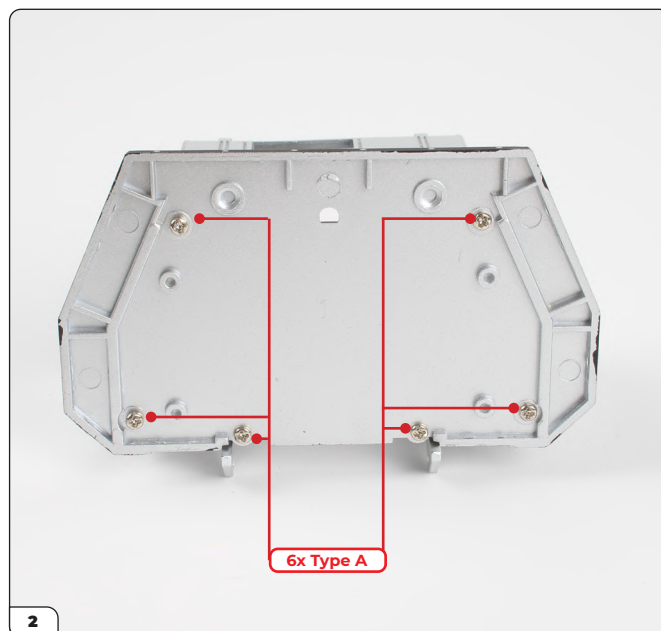

Secure the two sections together from the underside using 6x Type A screws.

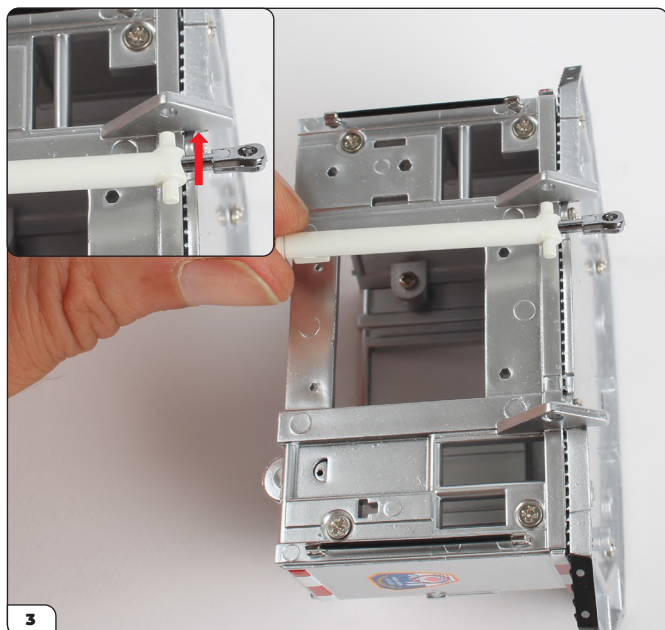

Take one of the piston assemblies from stage 50 and align the 'T' shaped lug at the end with the triangular fixing point on the platform (circled). Push the lug into the hole.



Repeat with the remaining piston assembly to fix it to the opposite triangular fixing point (circled).



## Stage 52: Assembling the Platform

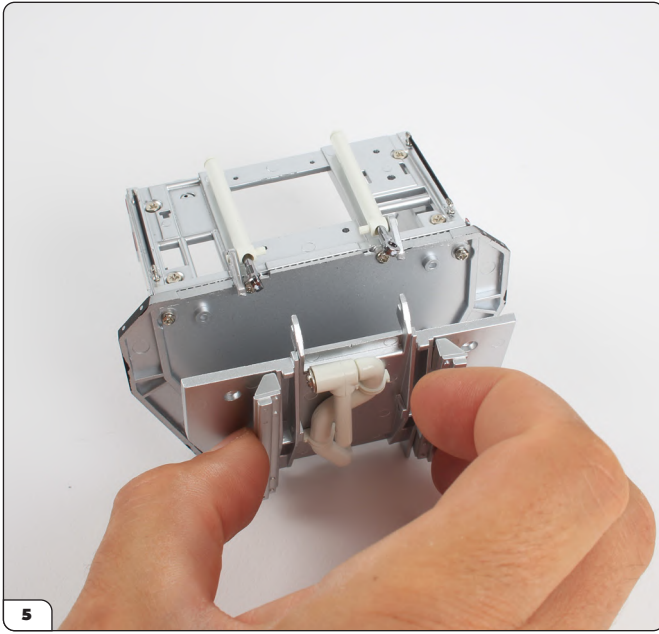

5 With the two pistons resting in position, take the platform base and place it over the platform floor.

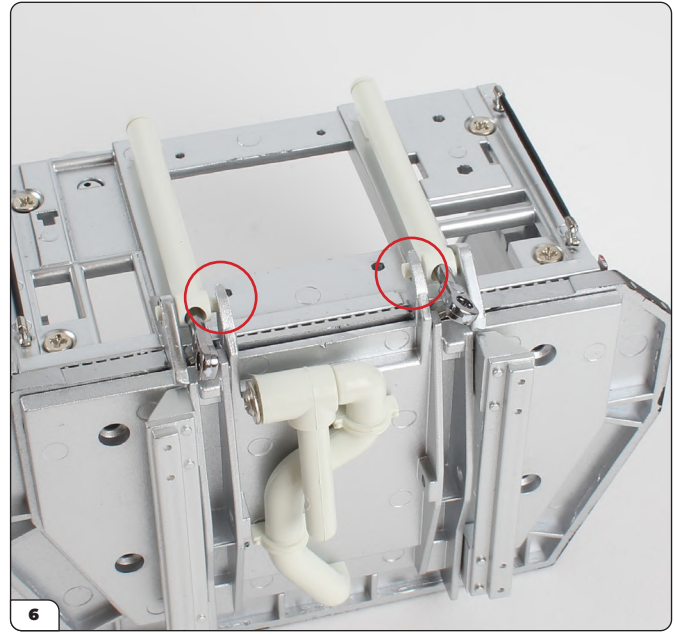

6 The projecting hooks on the base should wrap around the 'T'-shaped lugs on the pistons (circled).

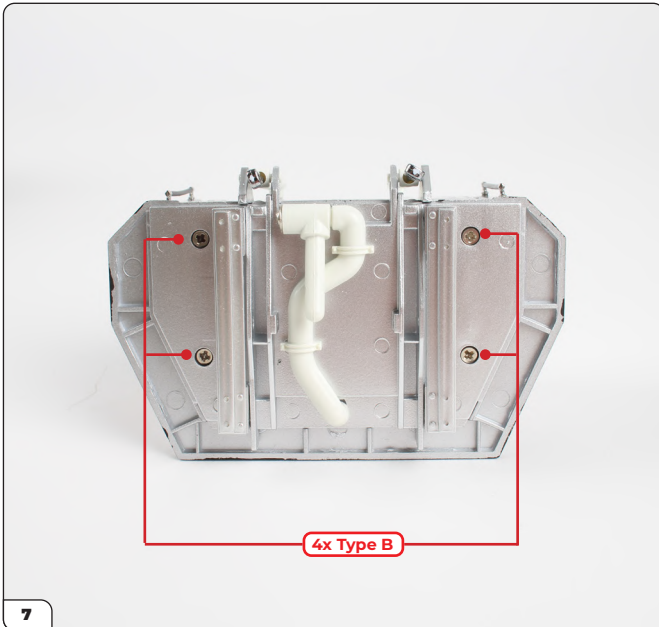

7 Secure the base to the floor using 4x Type B screws.

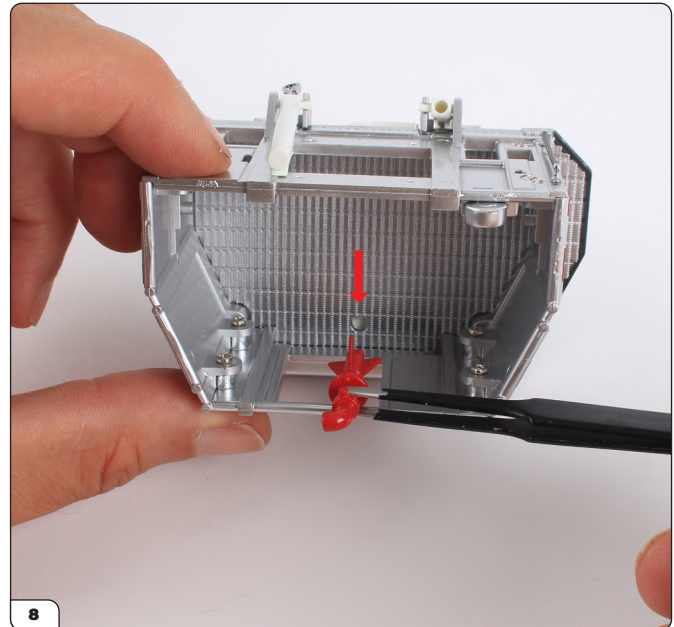

8 Turn the platform over so you are looking into the inside and locate the hole along the front edge (arrow). Align the pin on the end of the nozzle swivel base with the hole in the floor.

## Stage 52: Assembling the Platform



Push the base into place. This is how it should look from outside the platform.

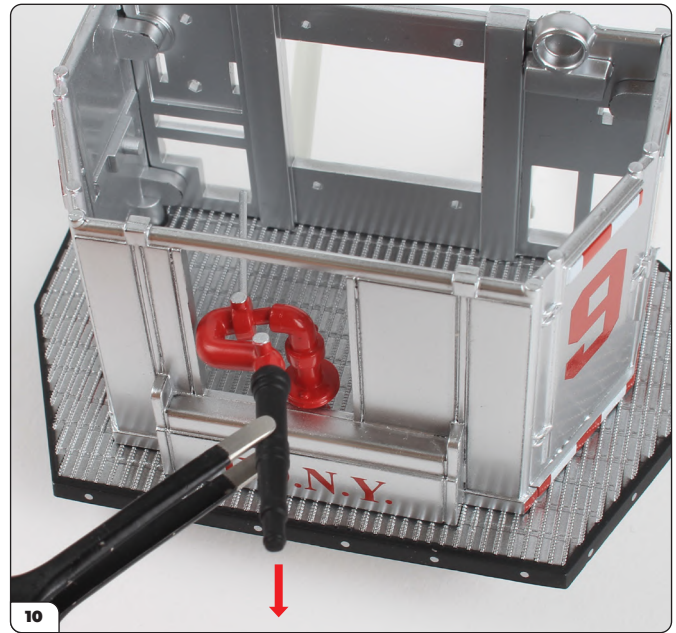

Now take the nozzle and push its projecting lug into the end of the nozzle swivel base. The nozzle should point outside the platform (arrow).

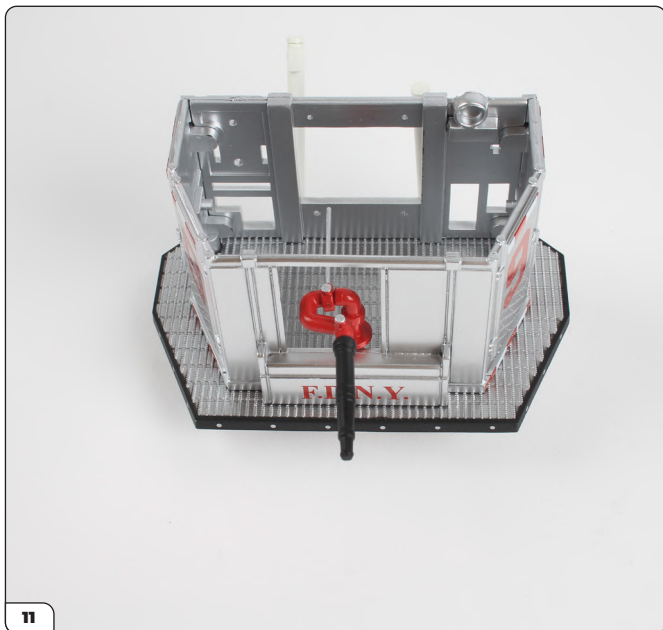

The nozzle swivel base and nozzle correctly installed on the platform.

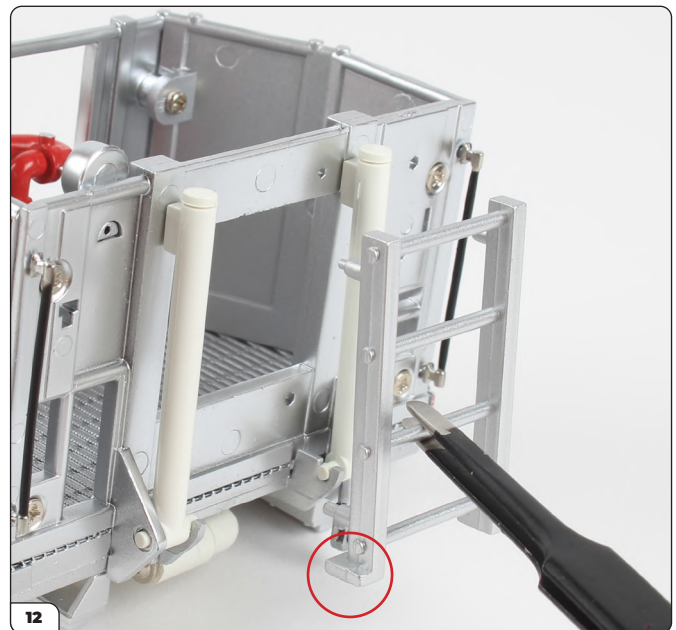

Push the ladder into place in between the two pistons on the back of the platform. The 'L' shaped ends of the ladder are at the bottom (circled).

## Stage 52: Assembling the Platform

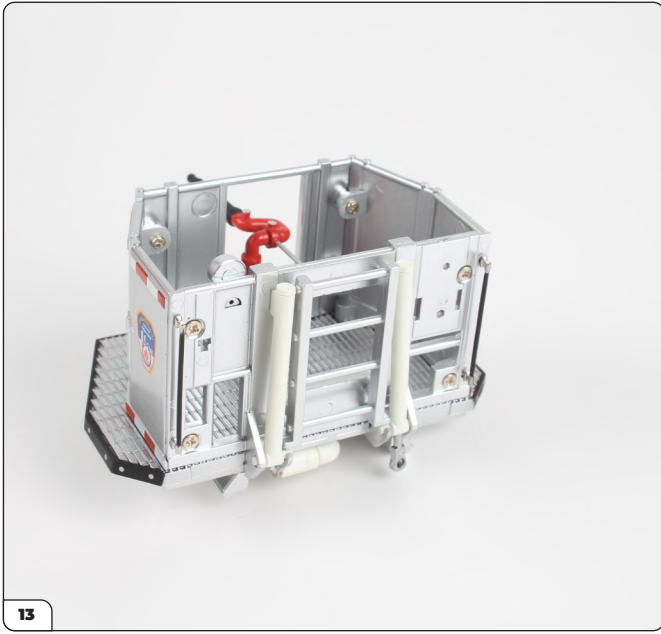

The ladder is now correctly installed.

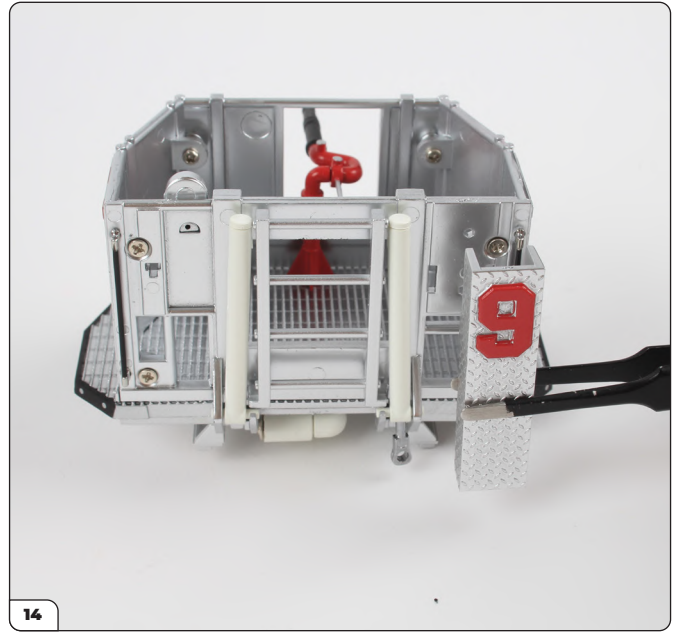

Take the cable run part and align it on the right-hand side on the rear of the platform.



Push the part firmly onto the platform.

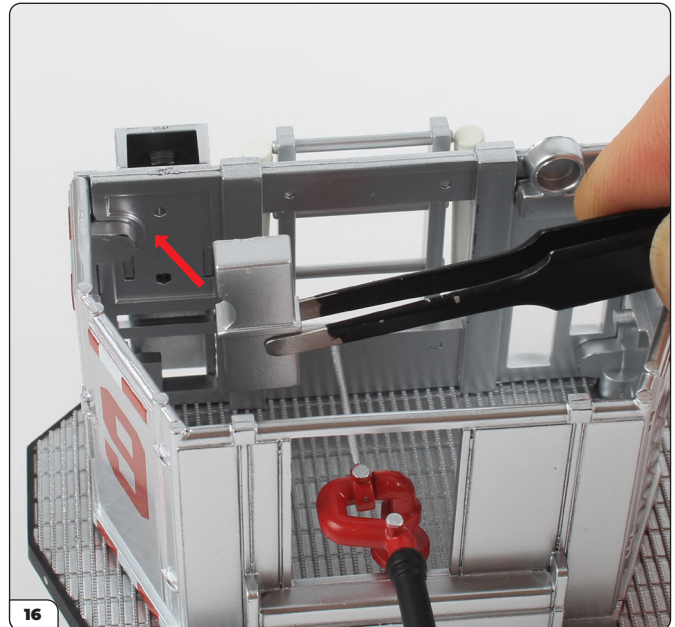

The platform control box attaches to the inside of the platform. Push firmly to fix into place.

## Stage 52: Assembling the Platform

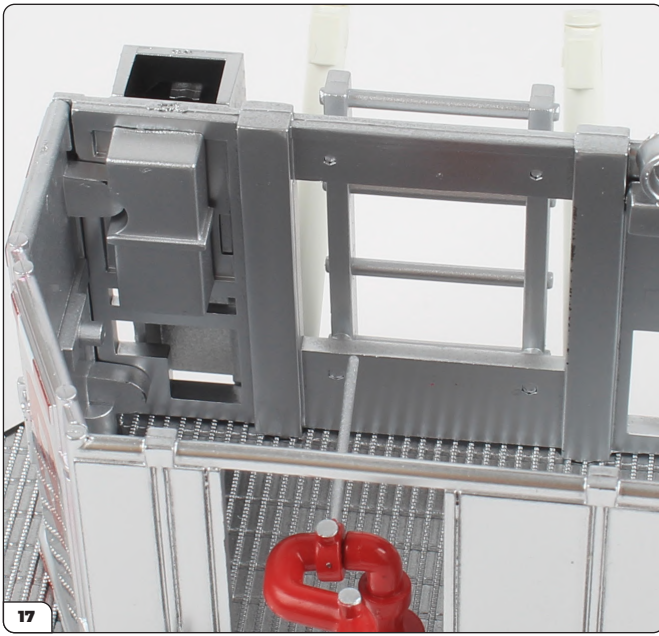

The control box has now been correctly installed.

**STAGE COMPLETE**



# Stage 53: Storage Box Cover and Raised Walkway

In this pack you will receive a number of ladders. Keep them to one side, ready to store in the ladder bays at a later stage. You'll now add another cover section around one of the storage compartments.



## STAGE 53 PARTS LIST

Name
Ladder
Storage compartment cover
Walkway

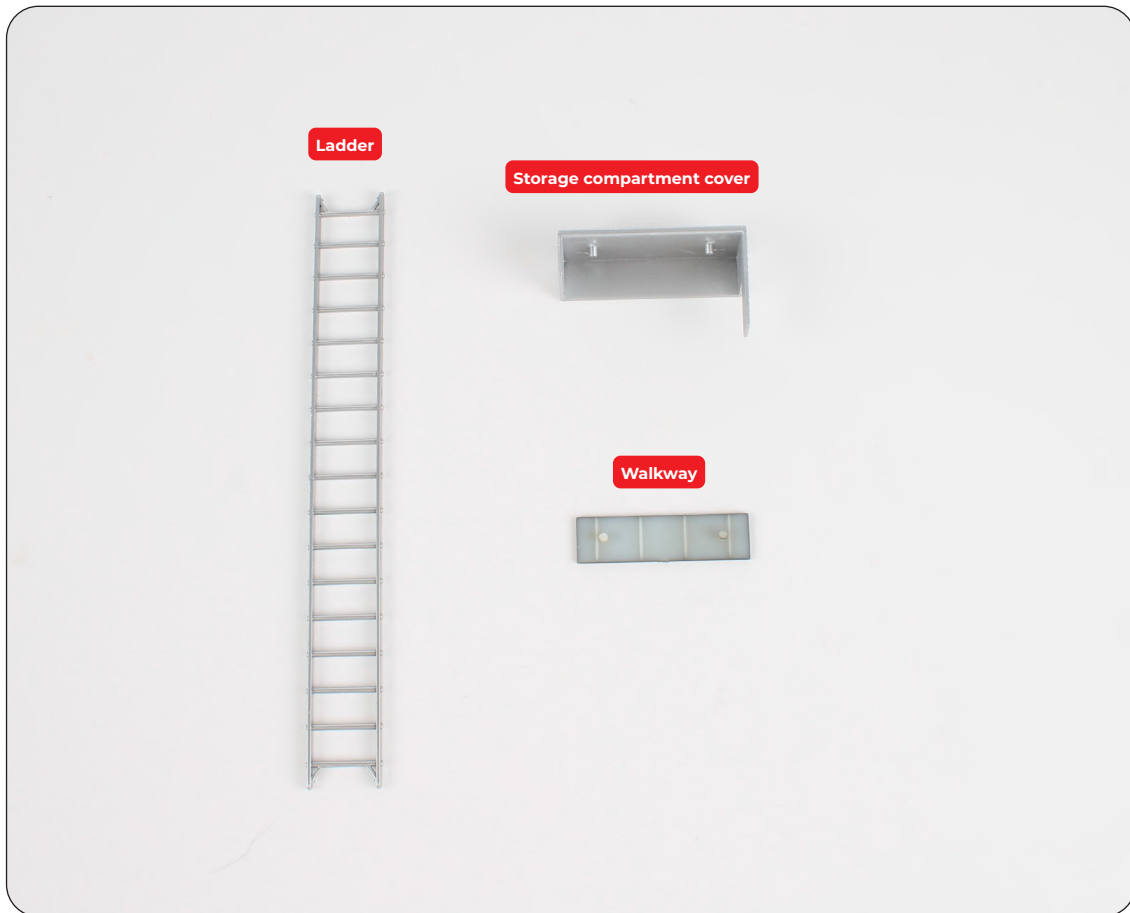

## Stage 53: Storage Box Cover and Raised Walkway



### FIXING THE COVER SECTION

The next two parts fit over the storage compartment on the left-hand side. Locate the lugs and the corresponding fixing holes.

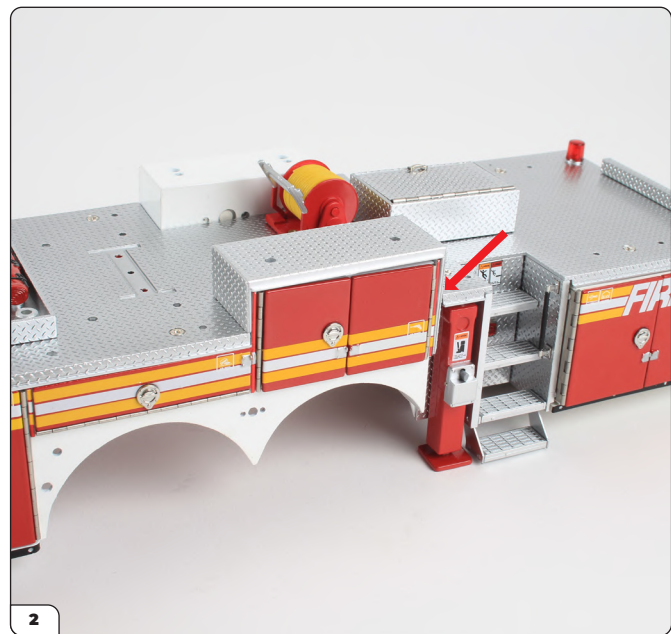

Press firmly to fit, tucking the side section in between the compartment and the jack (arrow).

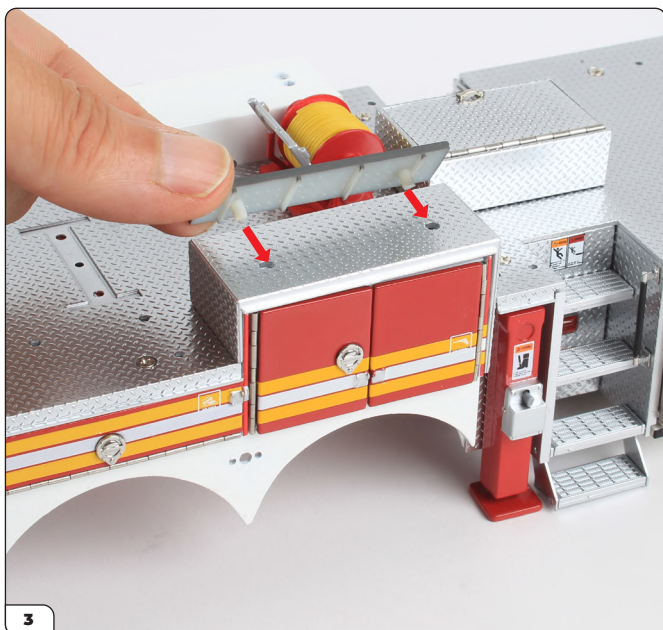

Fit the raised walkway in the same way, on top of the cover you have just fitted.



The two extra sections have now been fitted over the compartment.

# Stage 53: Storage Box Cover and Raised Walkway

STAGE COMPLETE



## Stage 54: Left-hand Side Wheel Arch Cover

In this next stage, you'll assemble and attach the wheel arch cover for the rear wheels on the left-hand side of the fire truck.



### STAGE 54 PARTS LIST

Name
Ladder
Wheel arch cover
Side marker
Electrical socket
Work light
Emergency light lens
Emergency light frame

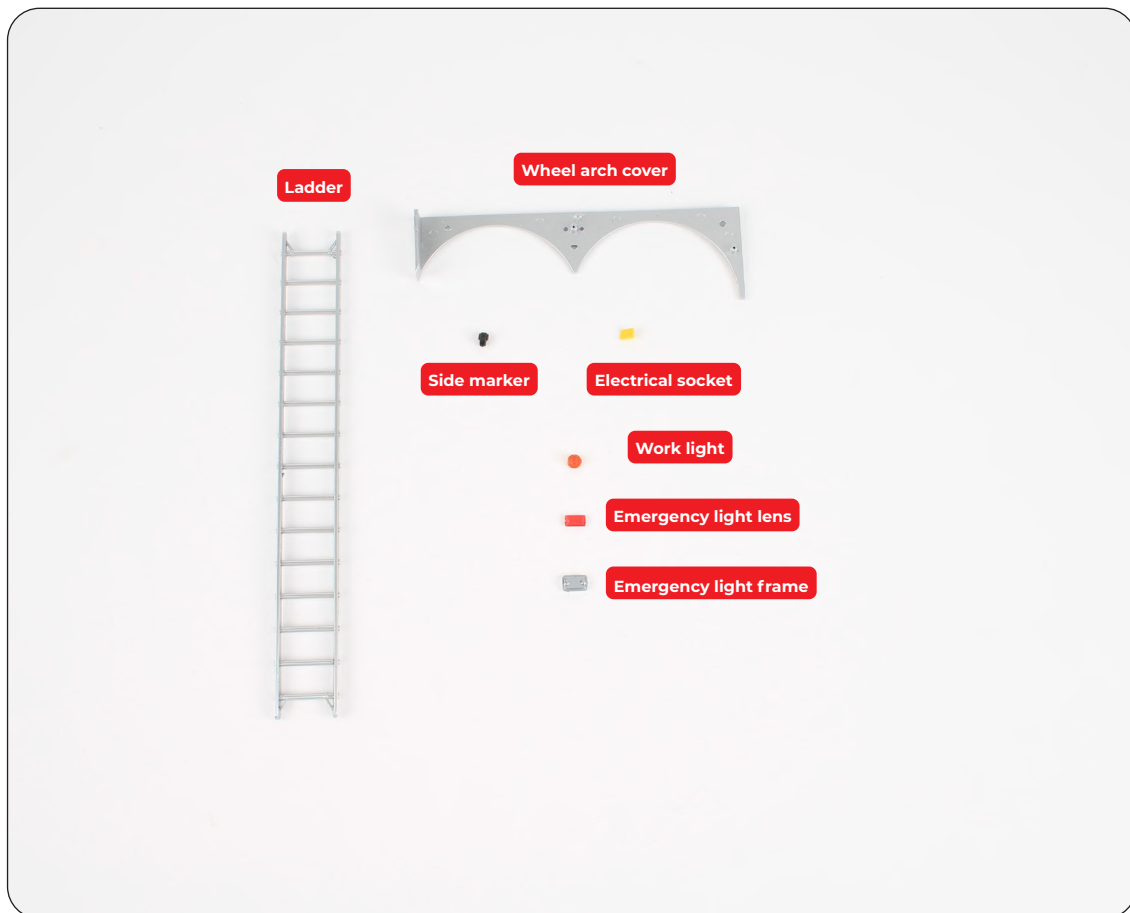



## Stage 54: Left-hand Side Wheel Arch Cover

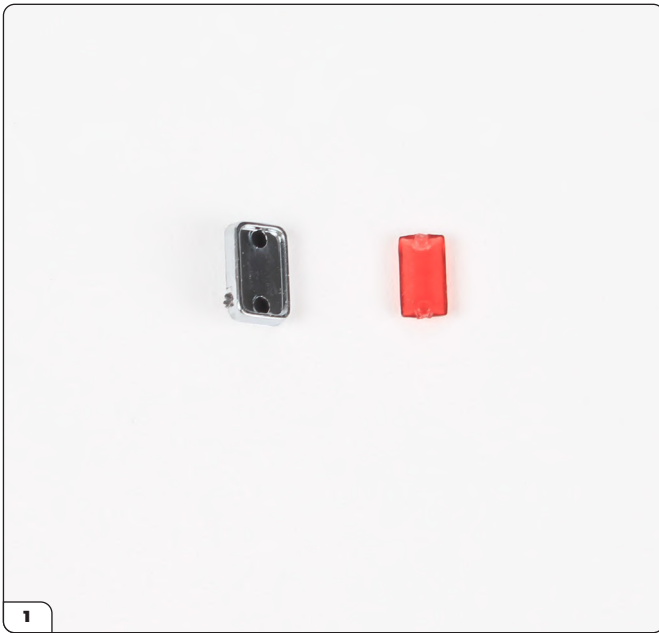

### ASSEMBLING THE WHEEL ARCH COVER

First, assemble the emergency light. Take the light frame and rectangular lens. Apply a little glue to the frame before pushing the lens into place in the frame.



This is how your emergency light should look.



Align the assembled light with the centre of the wheel arch cover and prepare to fit the work light.



Apply a little glue before fixing the light and the lens to the cover.

## Stage 54: Left-hand Side Wheel Arch Cover

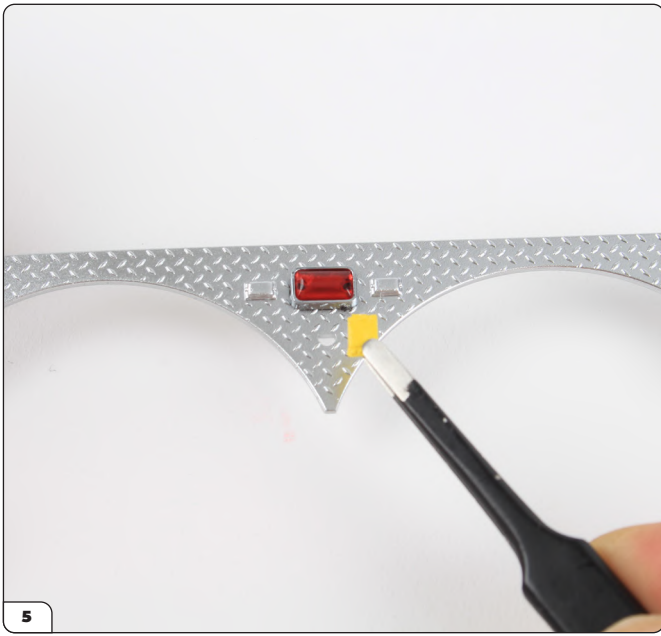

Prepare the electrical socket, aligning it with the hole just below the emergency light.

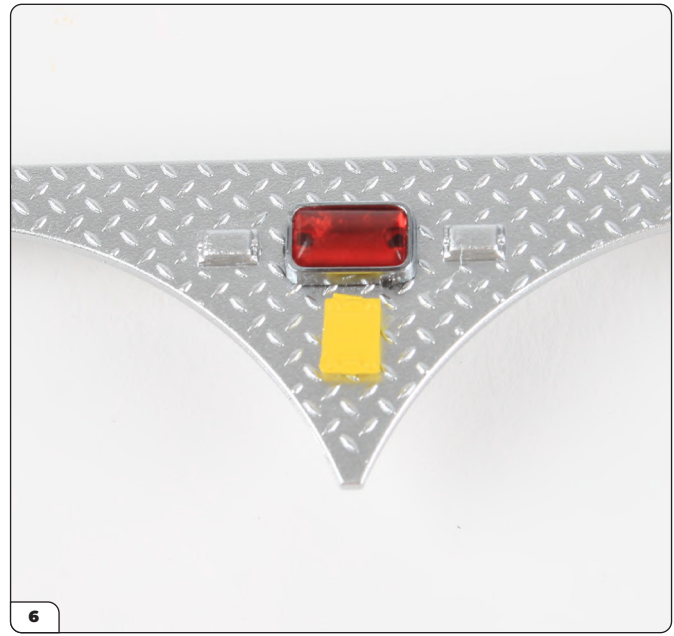

Apply glue then fix into place.



Prepare the side marker, aligning it with the hole on the right-hand side of the wheel arch cover.

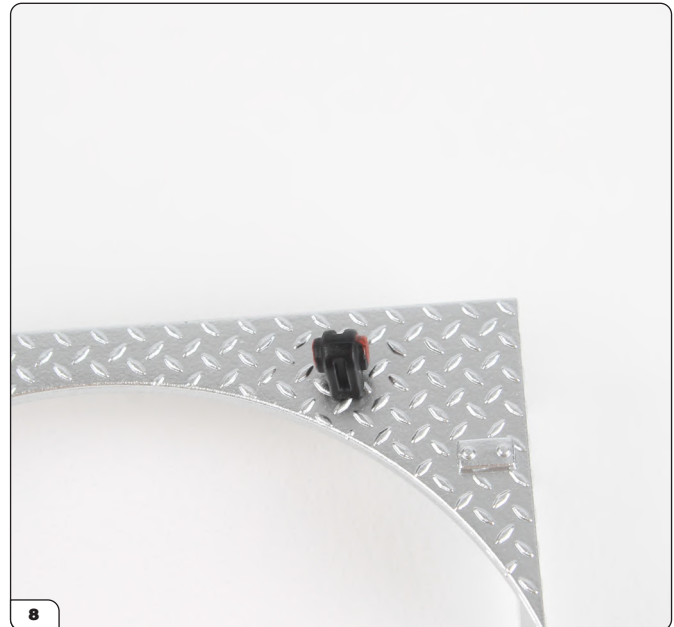

Apply glue, then fix into place.

## Stage 54: Left-hand Side Wheel Arch Cover



The wheel arch cover is fitted into place on the main body, over the wheel arches. Check that you are fitting it to the right-hand side so the side section slots in between the jack and the compartment (arrow)



Push firmly to fit.

**STAGE COMPLETE**



# Stage 55: Components for the Roof and Two More Tools

In stage 55, you'll add more components to the roof and place two more tools in their cupboards.



## STAGE 55 PARTS LIST

Name	Name
Boom cradle	Sand bottle
Large accessory storage	Water coolers x2
Hydrant wrench	Hydraulic ram jack
Water cooler storage	Ladder
Accessory	Type B screws x1



# Stage 55: Components for the Roof and Two More Tools

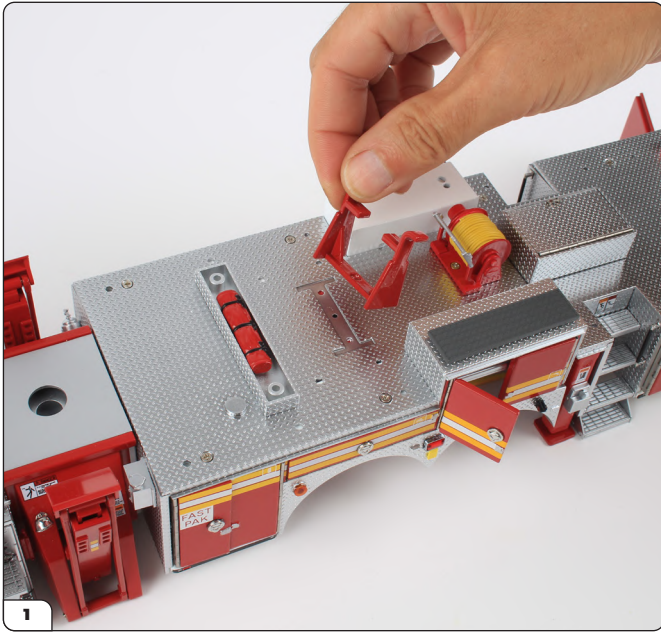

**1**  
**COMPONENTS FOR THE ROOF**  
Align the boom cradle with the H-shaped recess in the roof.

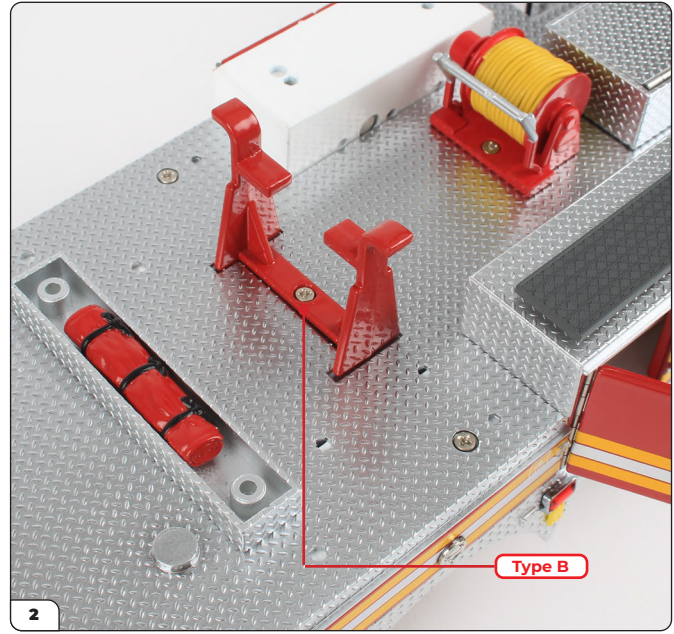

**2**  
Fix into place using the Type B screw.



**3**  
Take the large accessory box and the accessory.



**4**  
Push the accessory into the box.

## Stage 55: Components for the Roof and Two More Tools

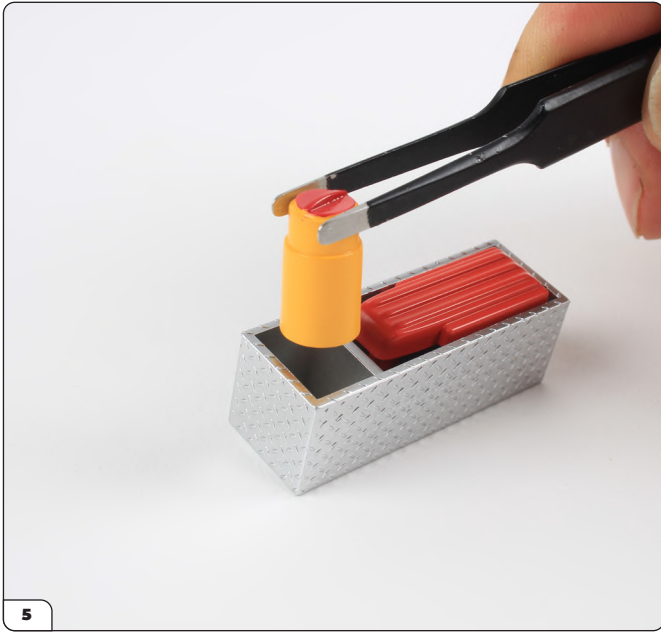

Push one of the water coolers into the smaller section of the accessory storage.

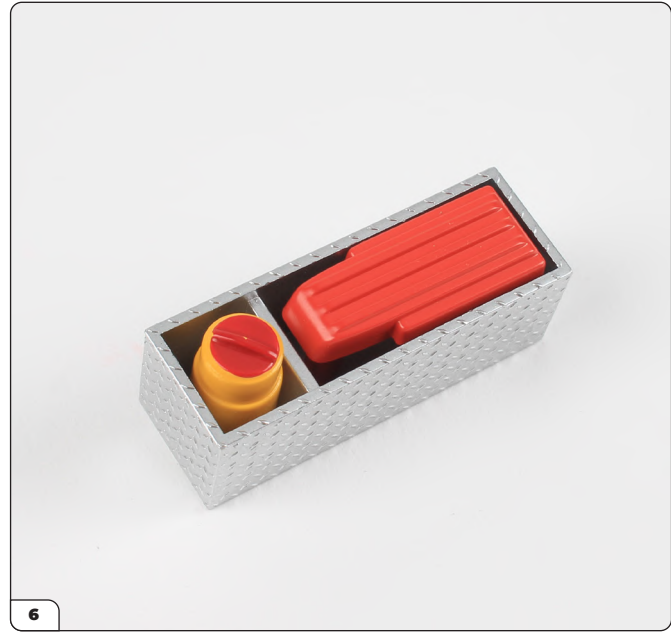

The storage box is now ready to fix to the roof.

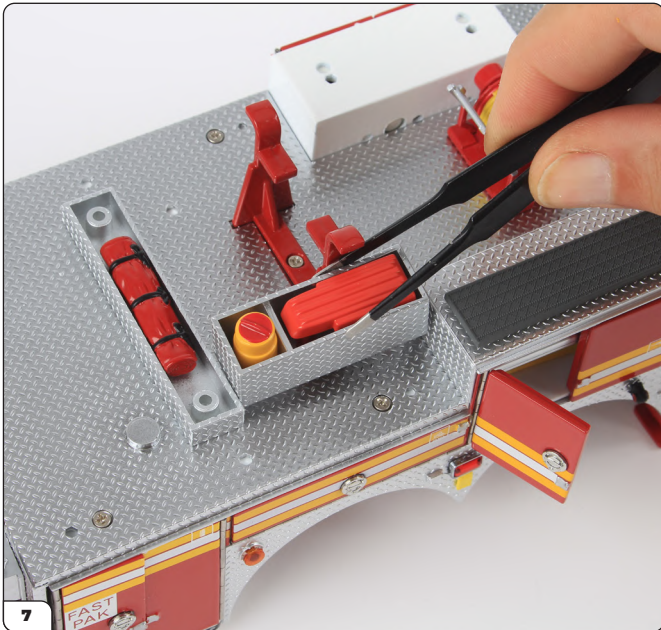

Lower the accessory storage onto the roof, behind the tarp box on the left-hand side.

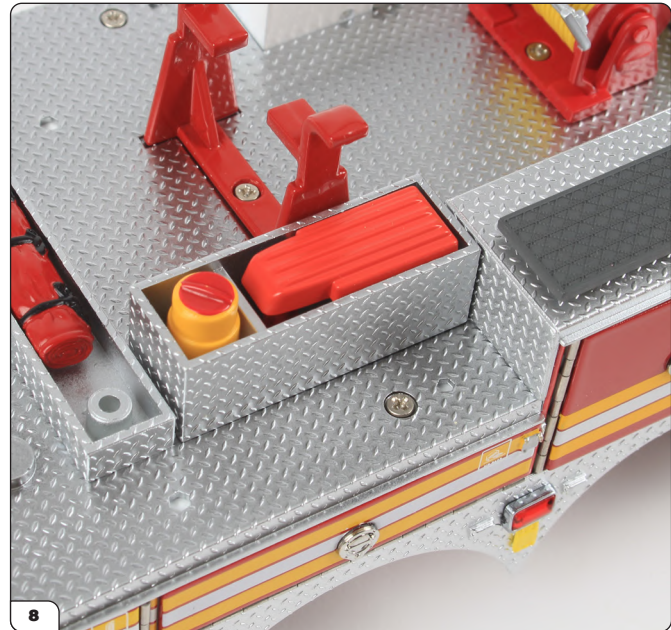

Push firmly to fix the lugs into the holes.

## Stage 55: Components for the Roof and Two More Tools

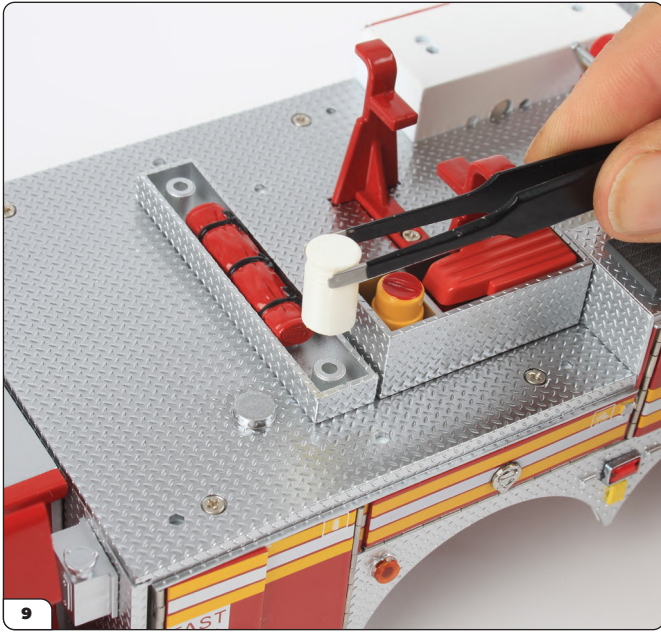

9 Lower the sand bottle into the tarp box.



10 Push firmly onto the raised post to fix.

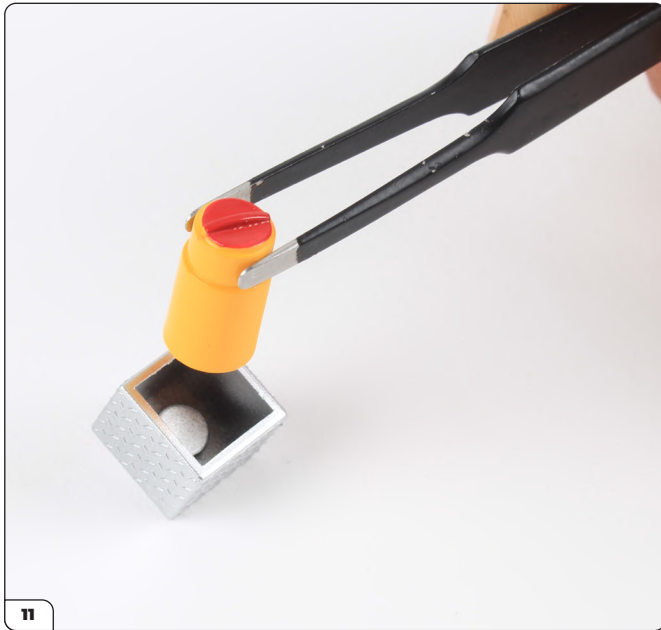

11 Take another water cooler and the water cooler storage.

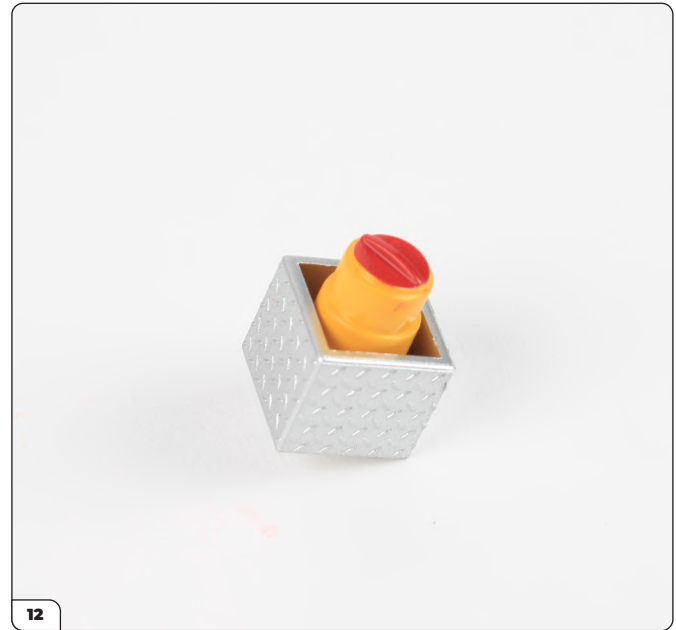

12 Push the water cooler onto the fixing post in the storage. Keep to one side to fix in a later stage.

## Stage 55: Components for the Roof and Two More Tools

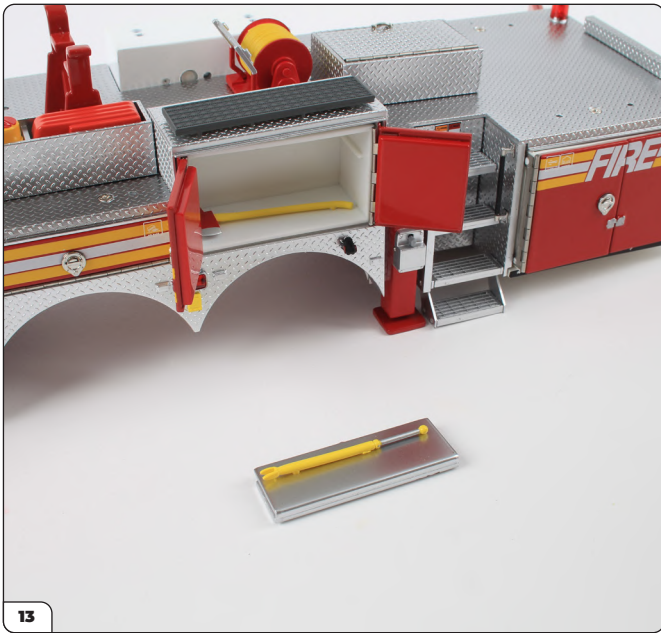

Carefully remove the shelf from the storage compartment over the wheel arch on the left-hand side. Push the fork-ended tool onto the shelf as shown.



Slide the shelf back over the brackets inside the cupboard.



Finally, remove the shelf from the rearmost cupboard on the left-hand side. Fix the hydrant wrench to the shelf.

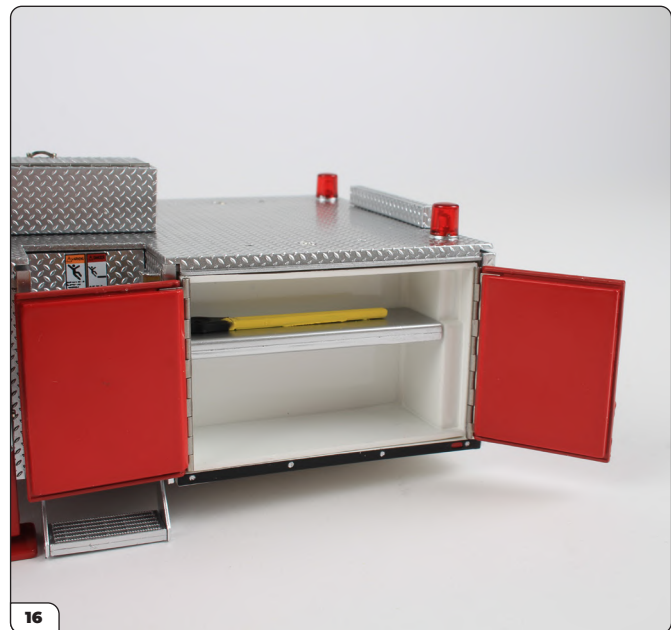

Slide the shelf back over the compartment brackets.



# Stage 55: Components for the Roof and Two More Tools

STAGE COMPLETE



# Stage 56: Roof Components and Another Two Tools

You'll continue to add components to the roof and tools to the cupboards.



## STAGE 56 PARTS LIST

Name
Storage box
Small raised walkway
Medium raised walkway
Hydrant wrench
Large raised walkway
Compartment handle
Halligan bar

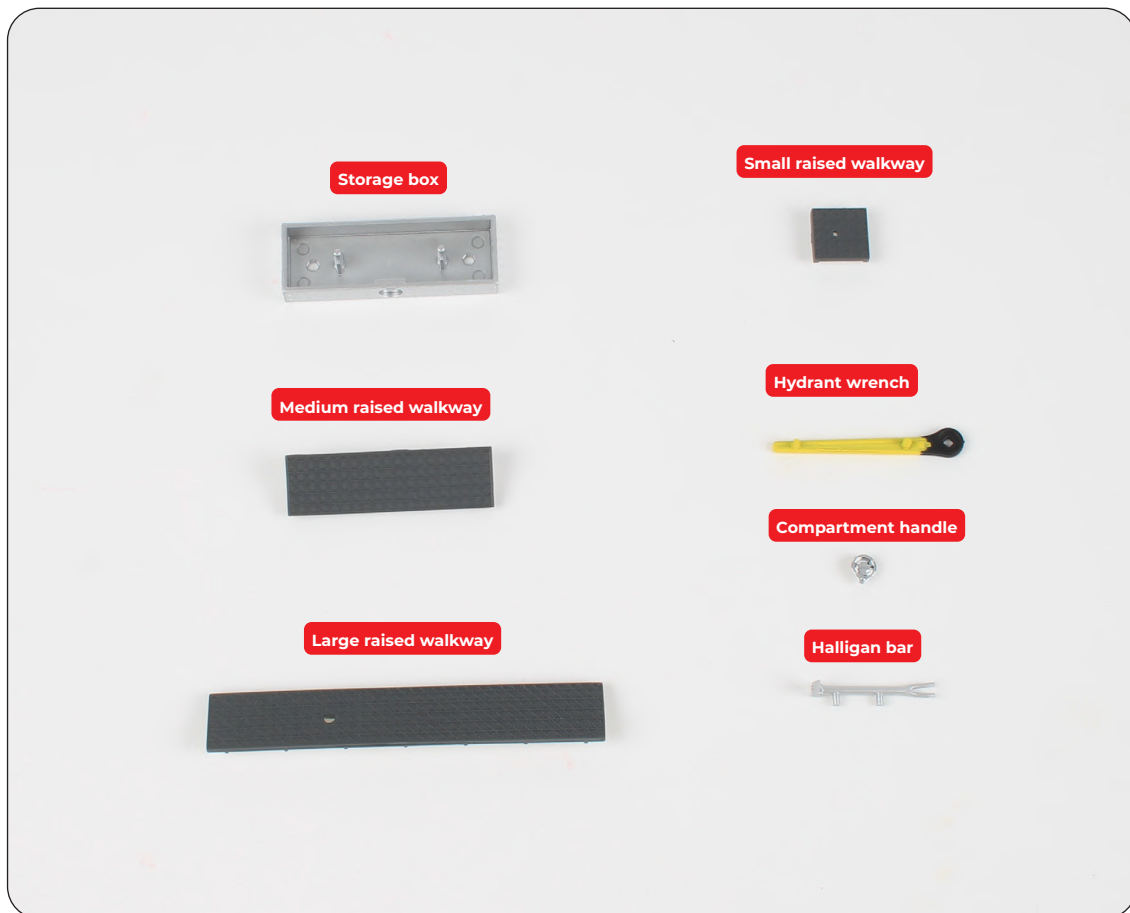

## Stage 56: Roof Components and Another Two Tools

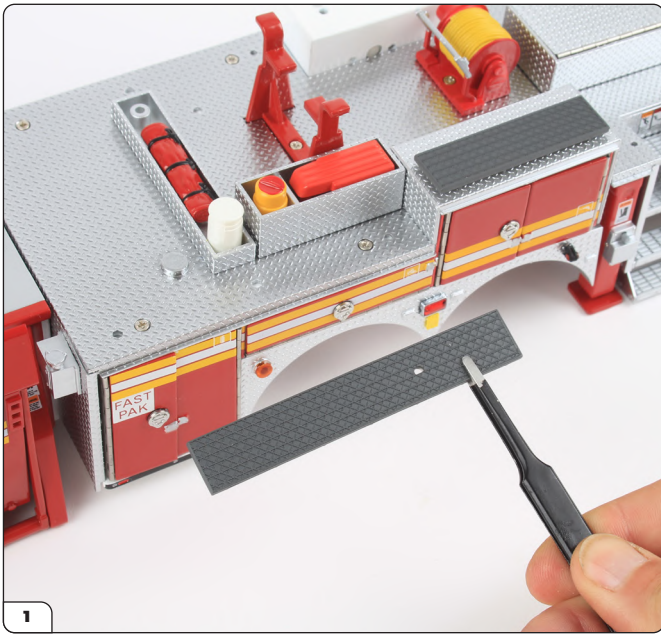

### FIXING THE ROOF COMPONENTS

Take the large raised walkway and push it into position on the roof, over the frontmost cupboard and wheel arch on the left-hand side.



Press firmly to fix.

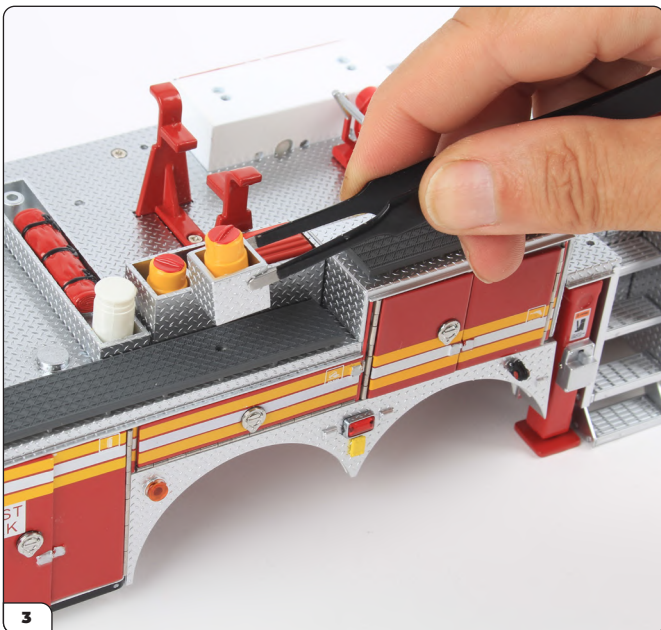

Align the water cooler in its storage box from the previous stage with the hole at the end of the walkway just installed.



Press firmly to fix.

## Stage 56: Roof Components and Another Two Tools



5 Position the small raised walkway on the roof above the jack.



6 Press firmly to fix.



7 Locate the front edge of the storage box and prepare to fix the handle in place. This is a 'D'-shaped fixing. The handle points sideways.



8 Apply a little glue before fixing into place.

## Stage 56: Roof Components and Another Two Tools



Align the storage box with the holes in the roof above the rearmost storage compartment on the left-hand side.



Push firmly to fix.



Lower the medium raised walkway over the storage box you have just fitted.



Press firmly to fix.

## Stage 56: Roof Components and Another Two Tools



Moving to the right-hand side of the fire truck, remove the shelf from the rear compartment and press the hydrant wrench onto the shelf.



Slide the shelf back into the compartment.

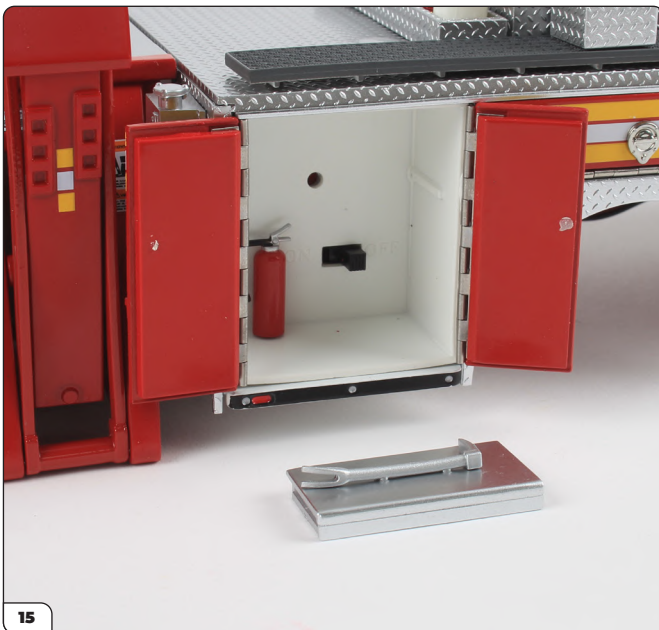

Remove the shelf from the compartment next to the outrigger. Press the halligan bar onto the shelf and slide the shelf back into the cupboard.

## Stage 56: Roof Components and Another Two Tools

STAGE COMPLETE



# Stage 57: Right-hand Side Wheel Arch Cover & Compartment Cover

Next, you'll assemble and attach the wheel arch cover over the rear wheels on the right-hand side, and add a compartment cover.



## STAGE 57 PARTS LIST

Name
Ladder
Emergency light frame
Emergency light lens
Work light
Storage compartment cover
Raised walkway
Wheel arch cover
Side marker
Electrical socket

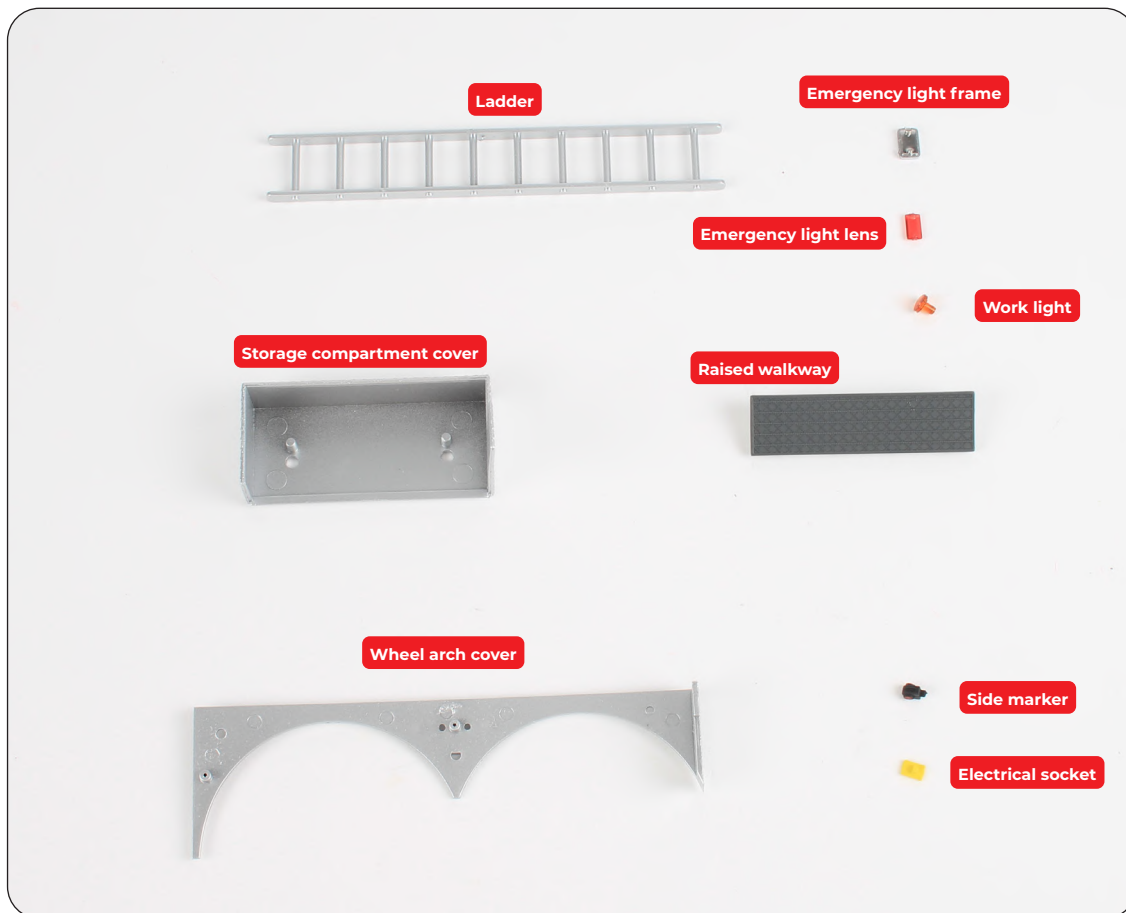



## Stage 57: Right-hand Side Wheel Arch Cover & Compartment Cover



### ASSEMBLING THE WHEEL ARCH COVER

First, assemble the emergency light. Take the emergency light frame and lens. Apply a little glue to the frame before pushing the lens into place in the frame.



This is how your emergency light should look.



Align the assembled light with the centre of the wheel arch cover and prepare to fit the work light.



Apply a little glue before fixing the light and the lens to the cover.

## Stage 57: Right-hand Side Wheel Arch Cover & Compartment Cover

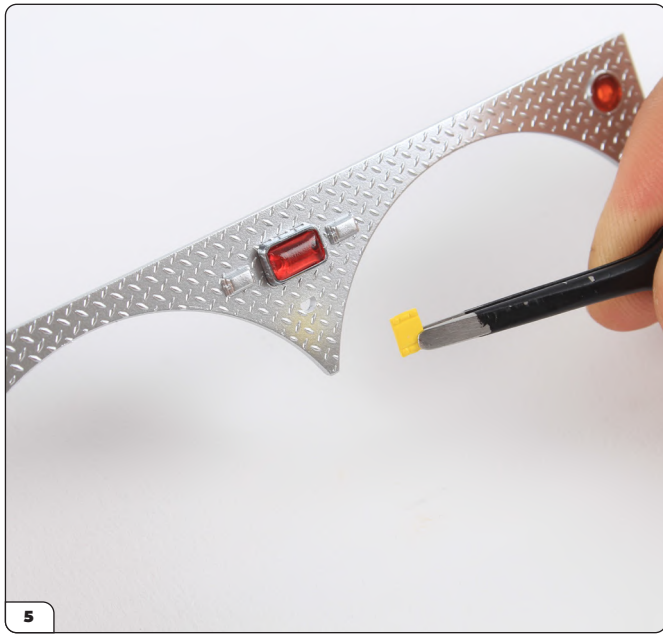

Prepare the reflector, aligning it with the hole just below the rectangular light.



Apply glue then fix into place.



Prepare the side marker, aligning it with the hole on the left-hand side of the wheel arch cover.



Apply glue, then fix into place.

## Stage 57: Right-hand Side Wheel Arch Cover & Compartment Cover



The wheel arch cover is fitted into place on the main body, over the wheel arches. Check that you are fitting it to the right-hand side so the side section slots in between the jack and the compartment (arrow).

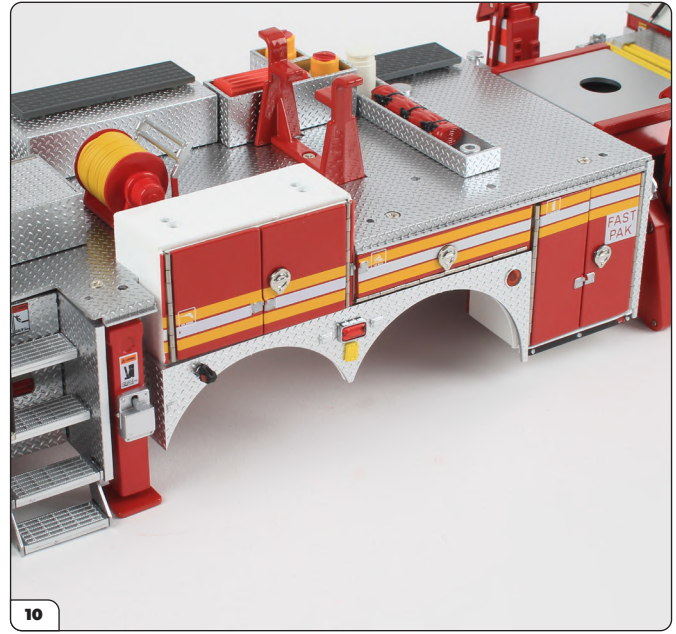

Push firmly to fit.



Lower the storage compartment cover onto the compartment above the wheel arches.

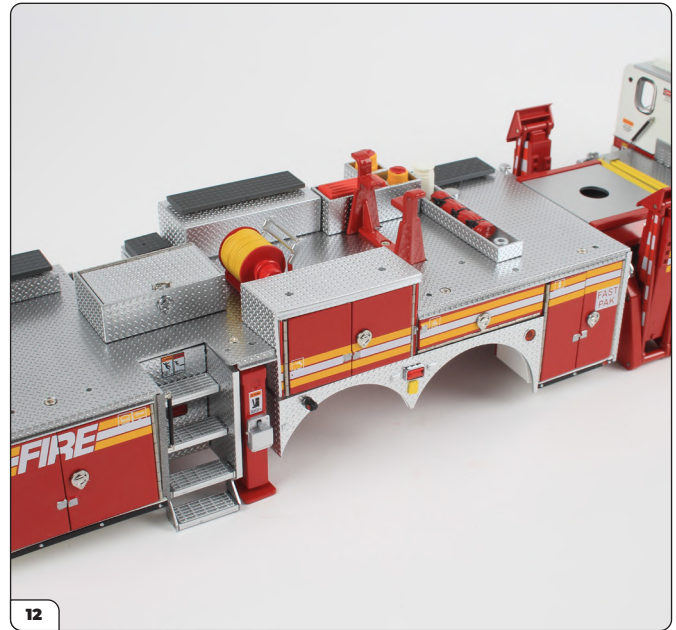

Push firmly to fit.

## Stage 57: Right-hand Side Wheel Arch Cover & Compartment Cover

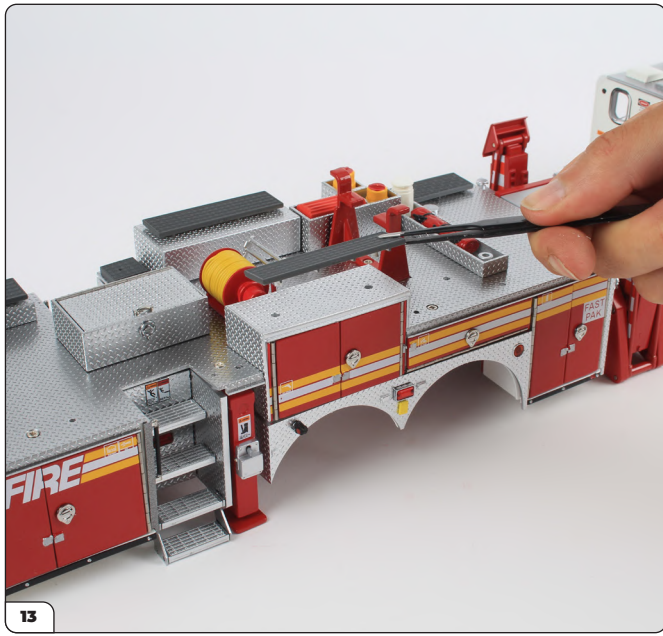

Finally, place the raised walkway on top of the storage compartment cover you have just fitted.



Press firmly to fit.

STAGE COMPLETE

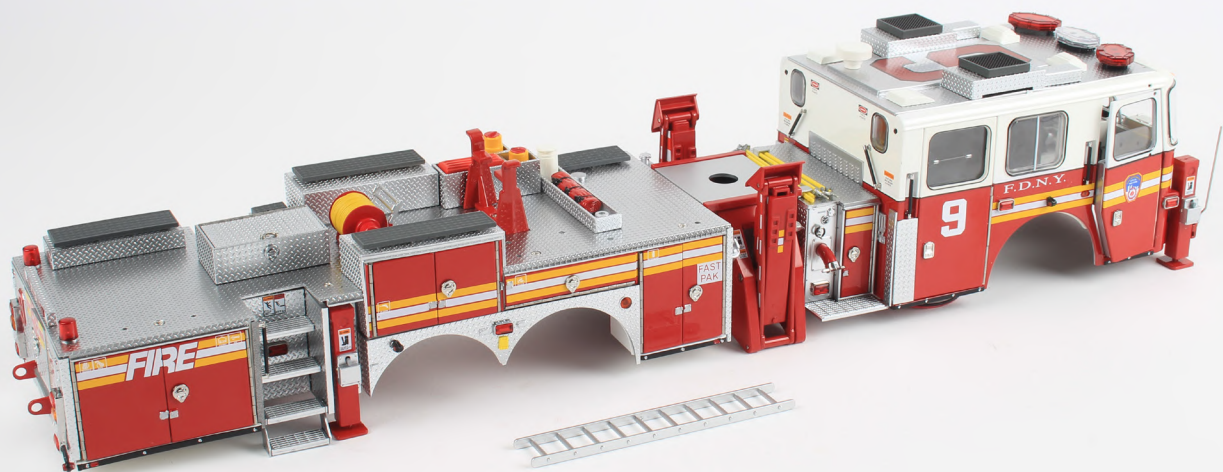

## Installing the Seats into the Cab:

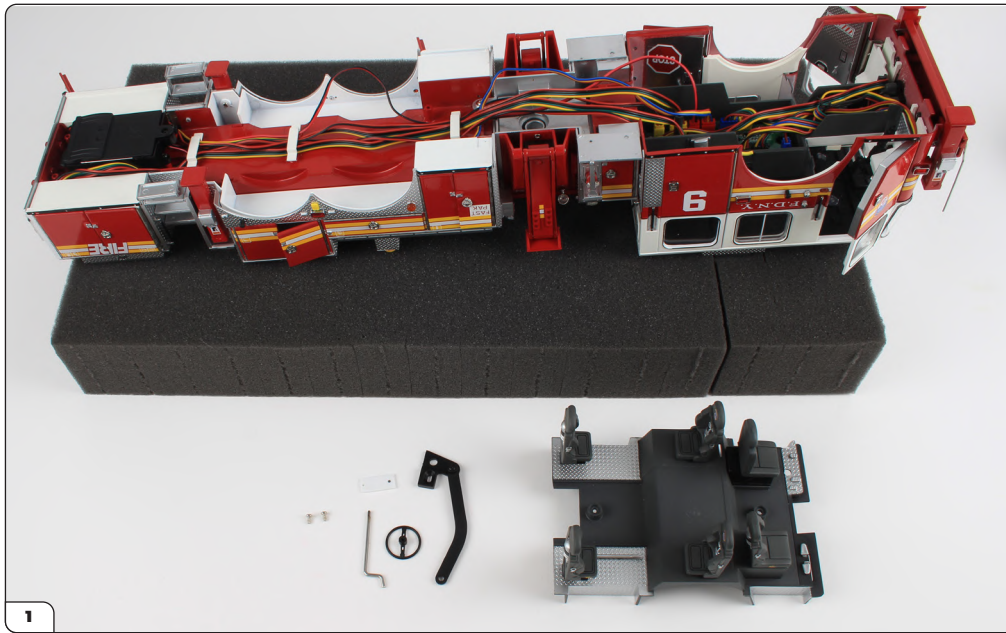

You can now fit the fire fighter's seat assembly into the cab, and install the steering equipment. Start by resting the firetruck upside down over some protective foam or other protective support. Prepare the seat assembly, and the steering strut/bracket, steering wheel, column, and securing tab from Pack 2, Stage 15, plus 2x type H screws.

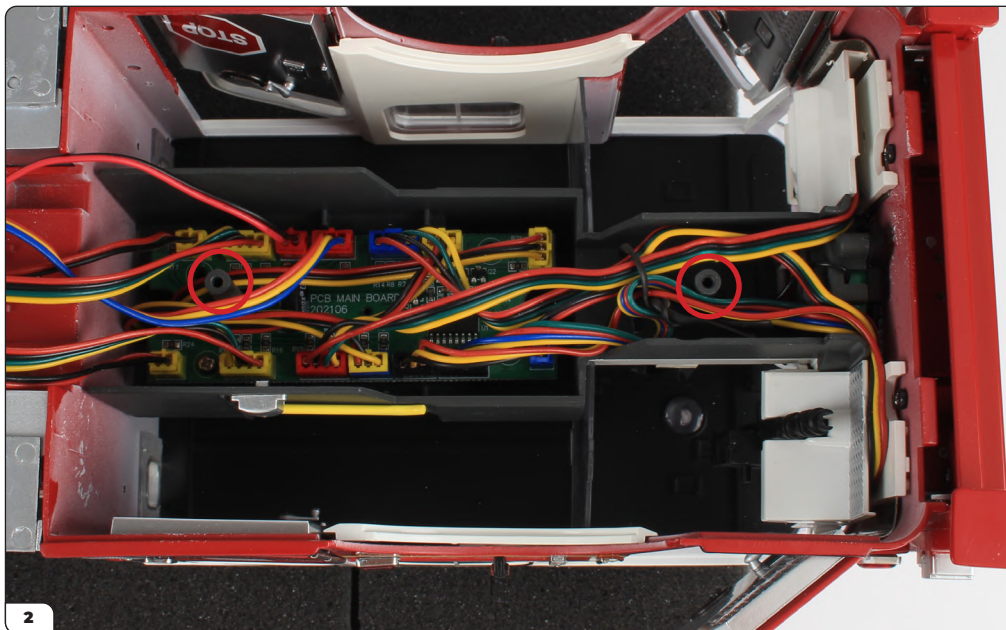

Start by ensuring that none of the cables are running over the screw posts (circled).

## Installing the Seats into the Cab:

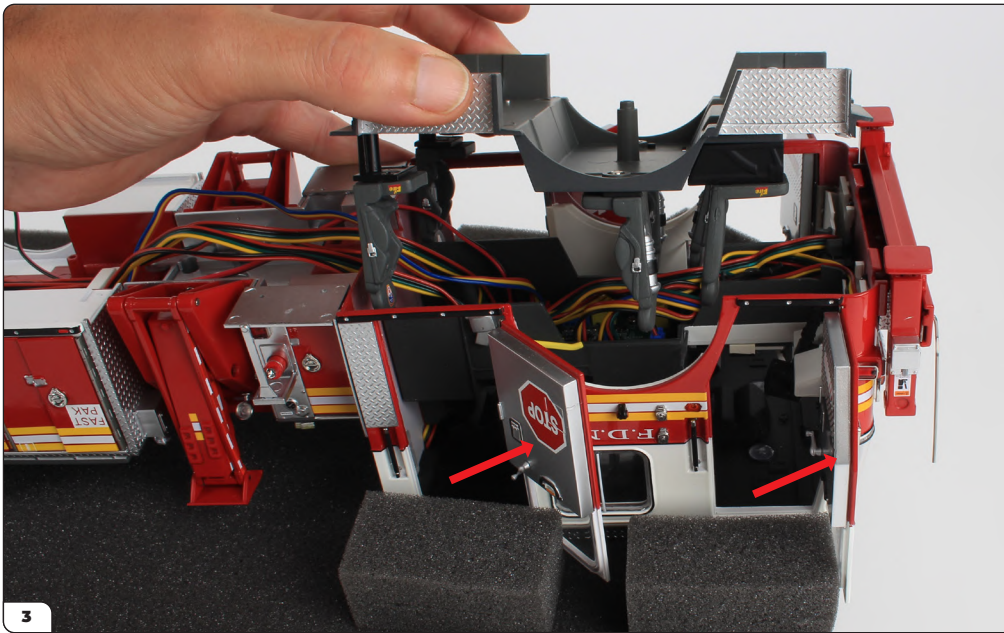

Prop all four cab doors open. Turn the seat assembly upside down and lower it into position so that the screw holes line up with the screw hole posts. Also pay attention to the tabs on the cab divider glass - these fit into the slots in the roof.

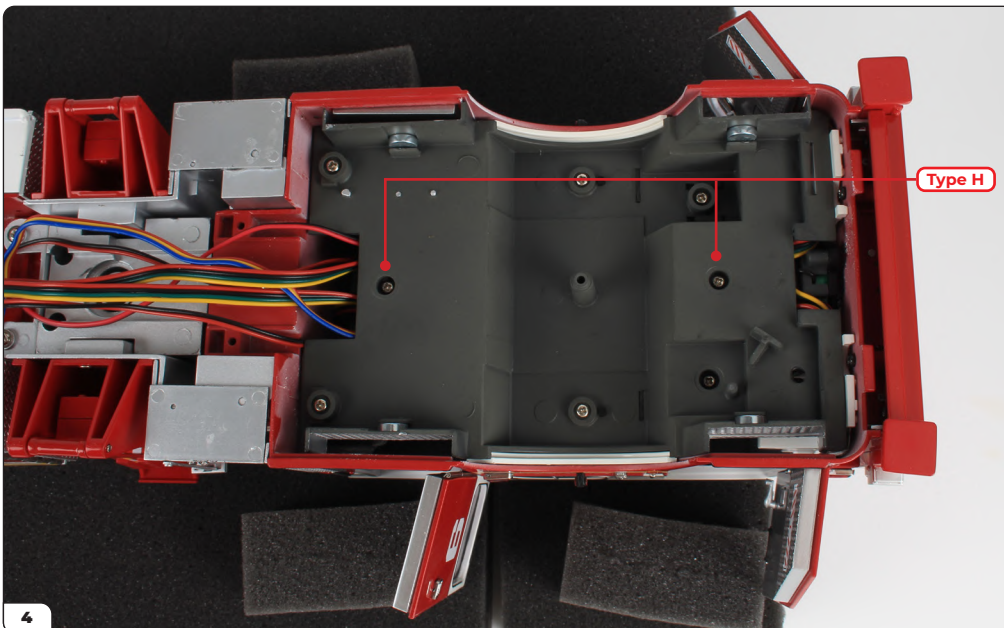

Once in position, secure the seats in place using 2x type H screws.

## Installing the Seats into the Cab:

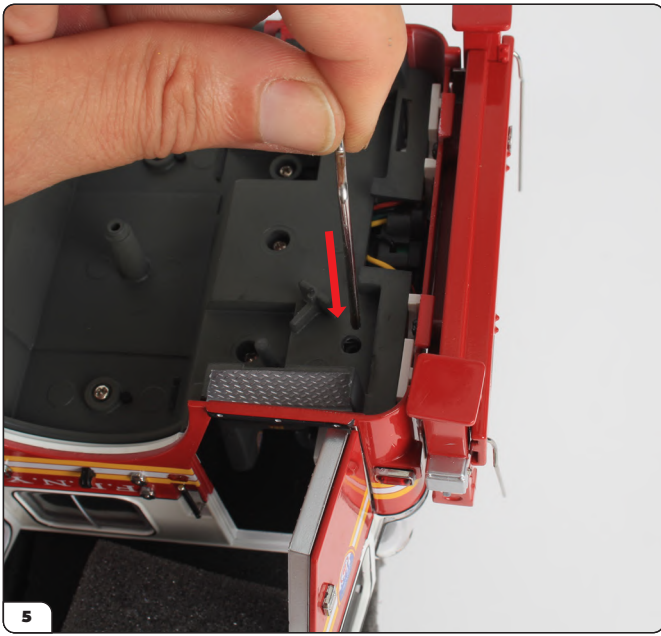

5 Lower the straight end of the steering strut through the seat assembly at the point shown, until you can see it projecting into the cab (picture 10).

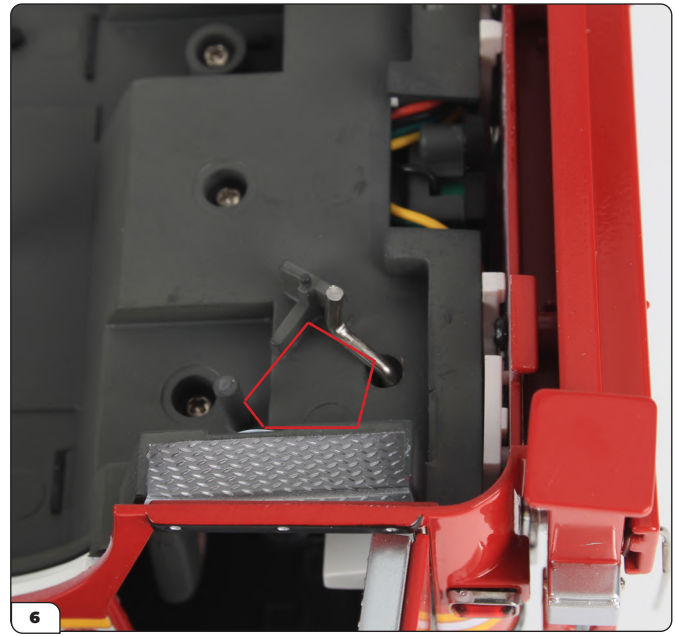

6 Feed the steering column through the hole in the seats and into the cab. The 'L'-shaped end must rest within the section outlined in red.



7 Check that the steering column is projecting into the cab (circled).

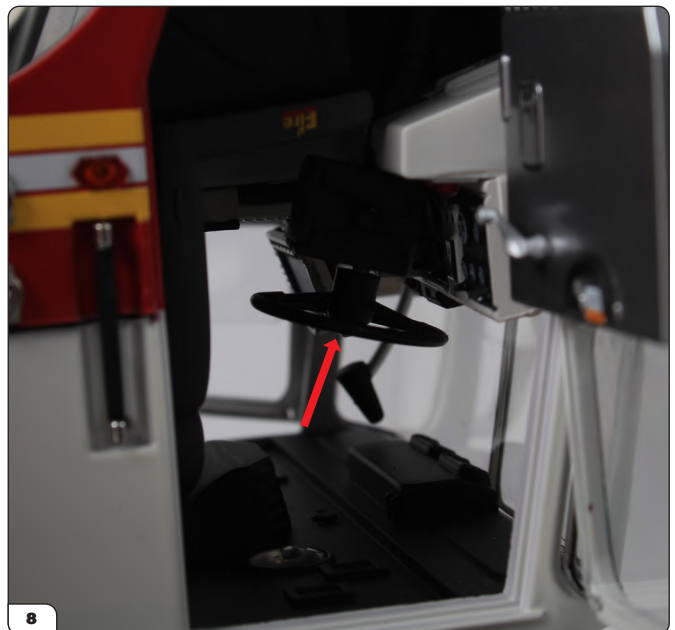

8 Fit the steering wheel onto the end of the steering column by pushing it firmly.

## Installing the Seats into the Cab:

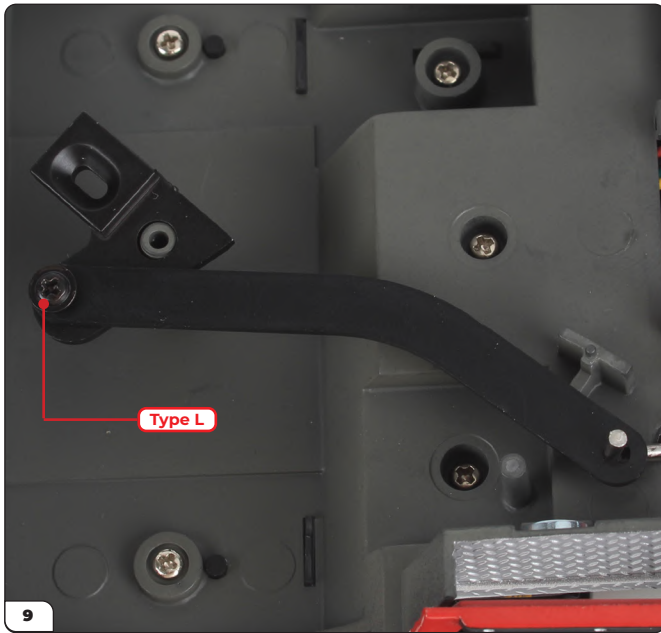

Back on the outside of the cab, first check the steering strut is fitted to the steering bracket in the orientation shown. The strut sits on top of the bracket. The bracket has the flat side facing the cab. Use a type L screw.

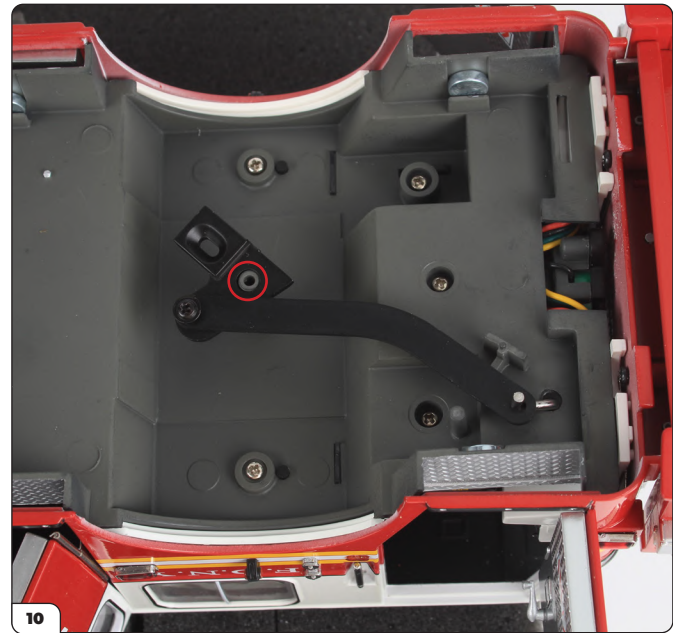

Fit the steering strut onto the end of the steering column. The bracket fits onto the projecting post circled in the photo above.



Fix the strut into place by pushing the securing tab over the two pins.

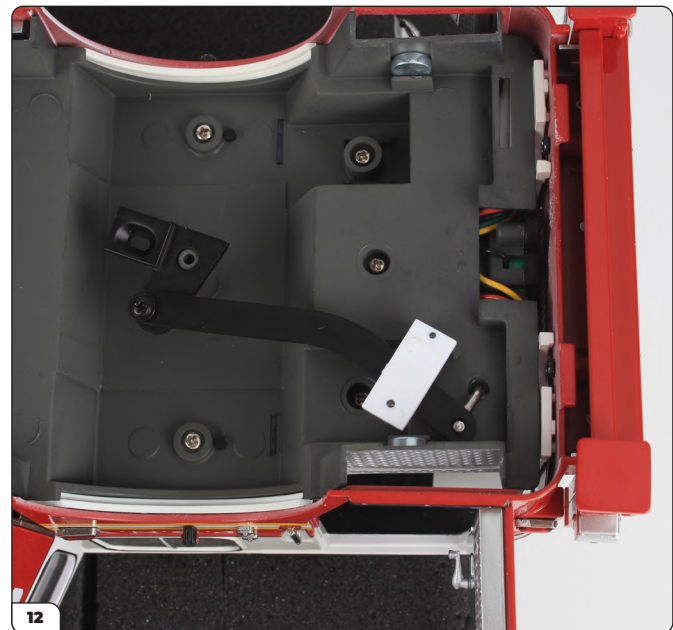

This is how the steering strut should now look.



## Installing the Seats into the Cab:

STAGE COMPLETE



STAGE COMPLETE

