

# BISMARCK

## THE LEGENDARY BATTLESHIP



### Pack 04 | Build Instructions

Your 1:200 scale model of the legendary battleship Bismarck is packed with intricate details which precisely replicate every aspect of this state-of-the-art warship. Each piece has been created using premium quality materials to bring maximum enjoyment during your complete build.

In your fourth model pack, you will assemble:

**STAGE 33: MOTOR FOR THE FORWARD  
RADAR EQUIPMENT**

**STAGE 34: RADAR CONTROL CENTRE**

**STAGE 35: A KEEL SECTION AND  
A DISPLAY STAND**

**STAGE 36: MOTOR FOR THE FORETOP  
RADAR INSTALLATION**

**STAGE 37: THE FORETOP RADAR  
AND A PORT HULL SECTION**

**STAGE 38: THE FORETOP RADAR  
AND A STARBOARD HULL SECTION**

**STAGE 39: THE NEXT HULL SECTION**

**STAGE 40: FIRE CONTROL POST DETAILS AND  
SEARCHLIGHT DECK**

**STAGE 41: THE NEXT SECTION OF HULL**

**STAGE 42: THE SIXTH KEEL SECTION**

**STAGE 43: ADMIRAL'S BRIDGE**

**STAGE 44: THE UPPER MAST DECK**

## Advice from the experts

Spare screws are included with each part. Occasionally, you may be instructed to keep spare or unused screws for a later stage.

Keep these spares in a safe place and label them correctly.

Please make sure you don't mix up the screws. They look quite similar, but the threads do vary slightly. Using the wrong screws may damage the parts.

When securing parts together using multiple screws, fit each screw loosely to ensure all the parts are correctly aligned before gently tightening them firmly, but not overtight, in the order in which you placed them.

Your screwdriver can be magnetised by stroking it with a magnet (fridge magnet, etc.) enabling it to hold the screws and make assembly easier.

If a screw is tight going into a metal part, do not force it as you may shear the head off. Remove it and put a tiny smear of Vaseline, soap or light oil on the thread. That will lubricate it and make it easier to drive home.

During the course of this build, you will receive many pieces that you will assemble immediately – following the instructions in the corresponding stage – and other pieces that you should store safely to one side, for use in future assembly stages.



Not suitable for children under the age of 14. This product is not a toy and is not designed for use in play. Keep the parts out of the reach of small children. Some parts may have sharp edges. Please handle them with care.

## STAGE 33

# MOTOR FOR THE FORWARD RADAR EQUIPMENT

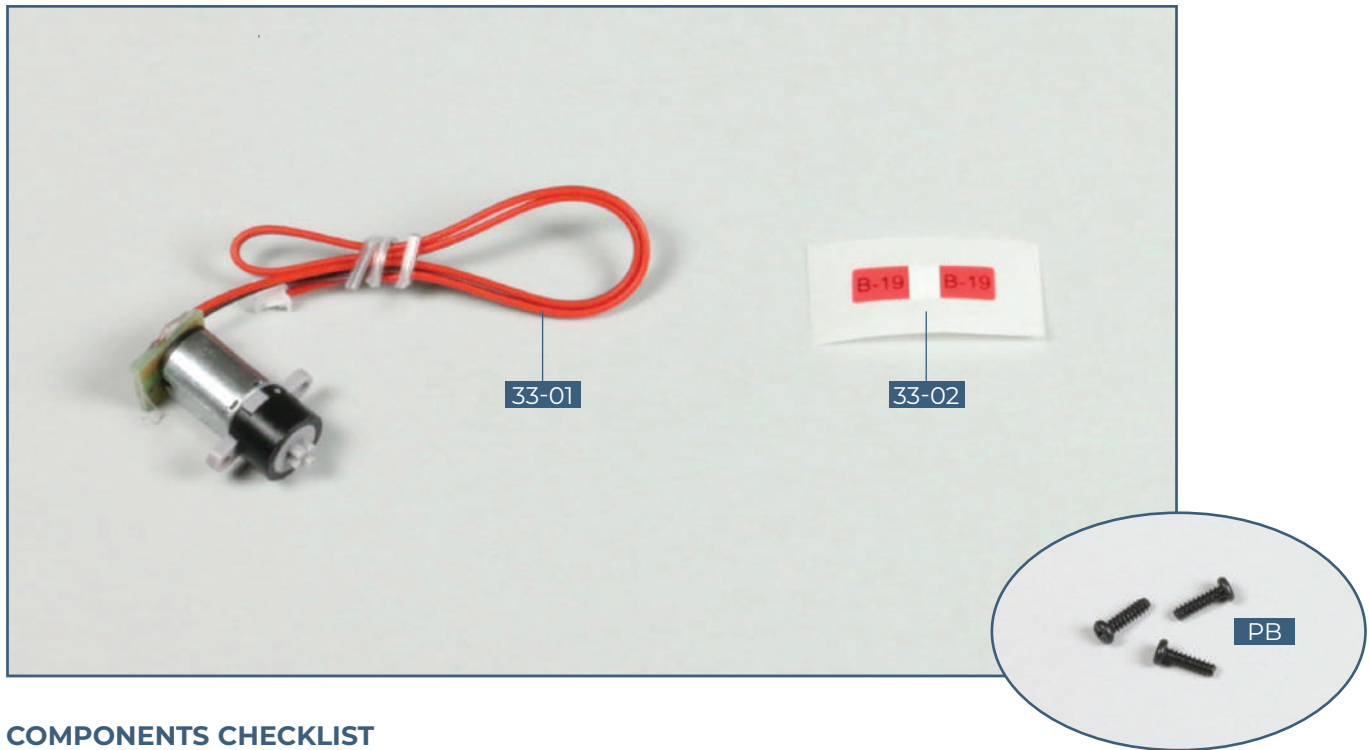

### COMPONENTS CHECKLIST

**33-01:** Motor for the forward radar **PB:** Three 1.7 x 6 mm PB screws

**33-02:** Cable label

## 01. PREPARING THE RADAR MOTOR

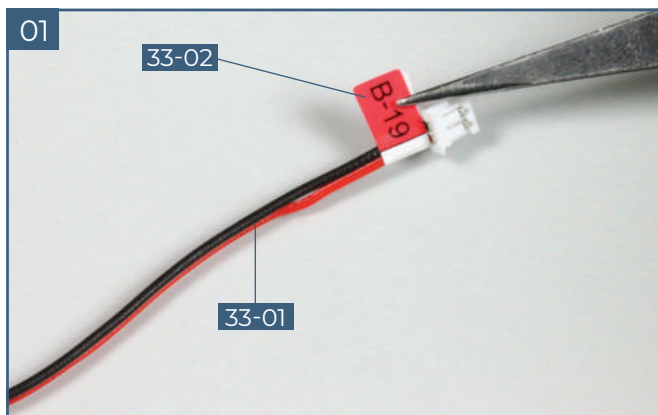

Take the motor with attached cable **33-01**. Remove the cable label **33-02** from the backing and wrap it around the cable, next to the socket, as shown.

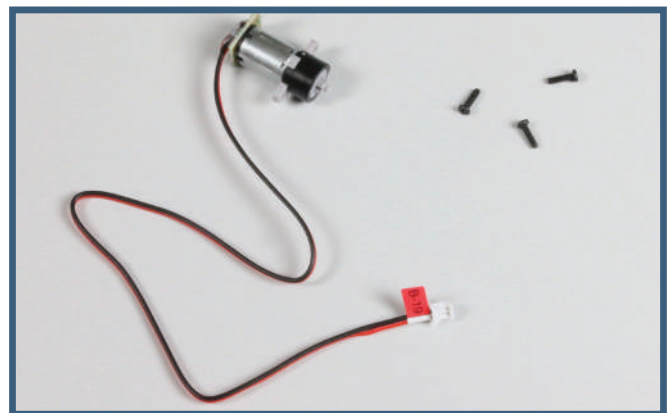

### Completed work

A label has been fitted to the cable on the radar motor. Store the three PB screws carefully until they are needed in stage 34.

# STAGE 34

## RADAR CONTROL CENTRE

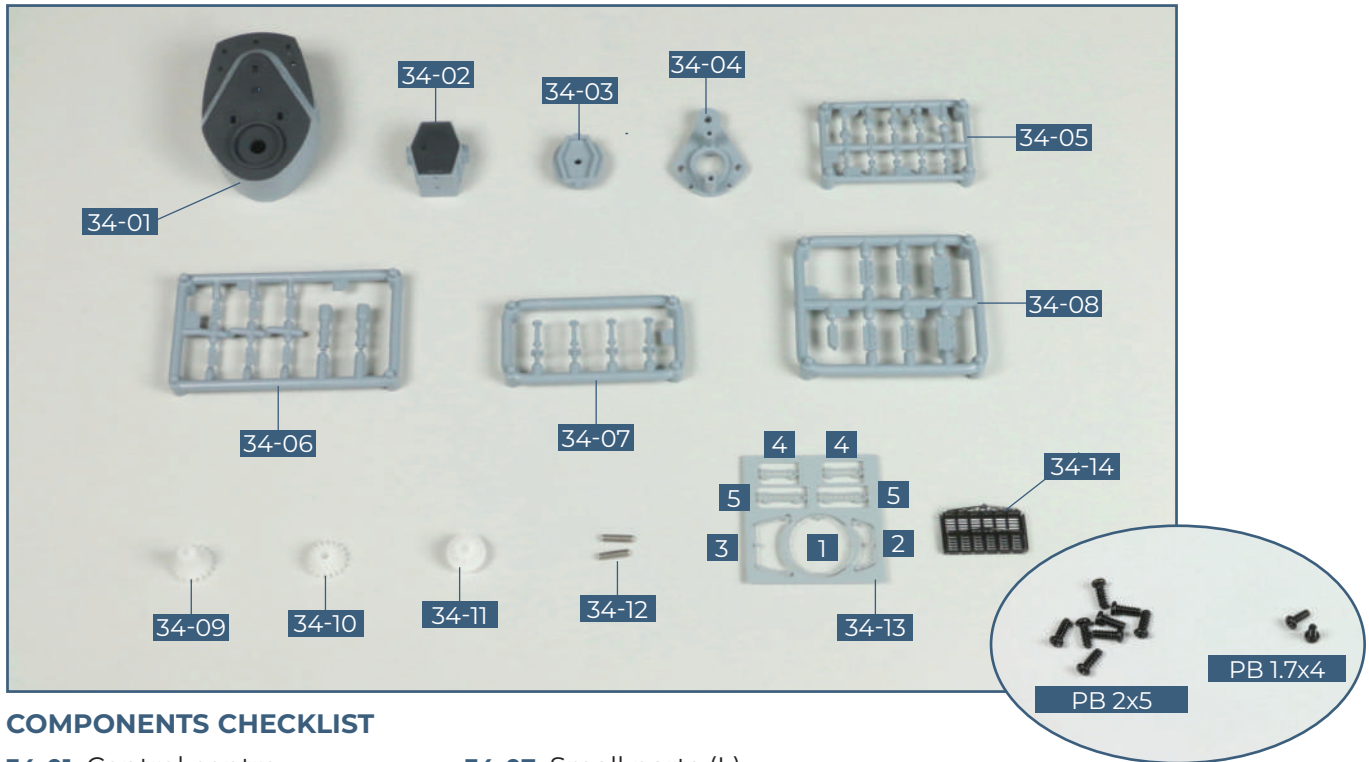

### COMPONENTS CHECKLIST

- |                                   |                                   |                                     |
|-----------------------------------|-----------------------------------|-------------------------------------|
| <b>34-01:</b> Control centre      | <b>34-07:</b> Small parts (L)     | <b>34-13:</b> Small metal parts     |
| <b>34-02:</b> Radar unit          | <b>34-08:</b> Small parts (M1-M3) | <b>34-14:</b> Radar antenna         |
| <b>34-03:</b> Base of radar unit  | <b>34-09:</b> Cog                 | <b>PB:</b> Eight 2 x 5 mm PB screws |
| <b>34-04:</b> Mounting plate      | <b>34-10:</b> Cog                 | <b>PB:</b> Two 1.7 x 4 mm PB screws |
| <b>34-05:</b> Small parts (J1-J5) | <b>34-11:</b> Cog                 |                                     |
| <b>34-06:</b> Small parts (K1-K2) | <b>34-12:</b> Shaft (x2)          |                                     |

## 01. SMALL PARTS FOR THE CONTROL CENTRE AND RADAR



Remove the six lockers **K2** from frame **34-06**. Take the control centre **34-01** and use a little superglue to fix three lockers **K2** on the port side as shown.



Fix the remaining three lockers **K2** on the starboard side of the control centre **34-01**.

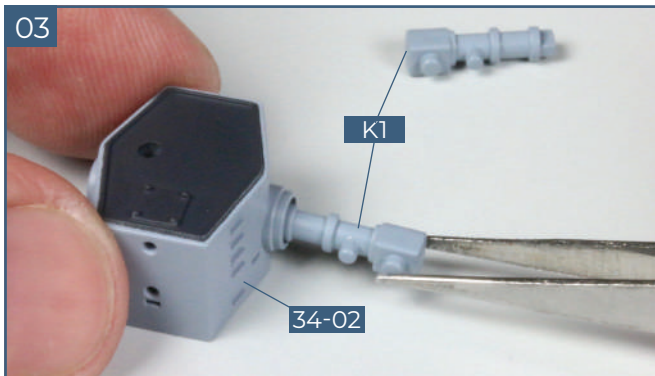

Cut the two radar arms **K1** from the frame **34-06**. Glue the first arm **K1** to the radar unit **34-02**, ensuring that it is pointing in the right direction (see step 4).

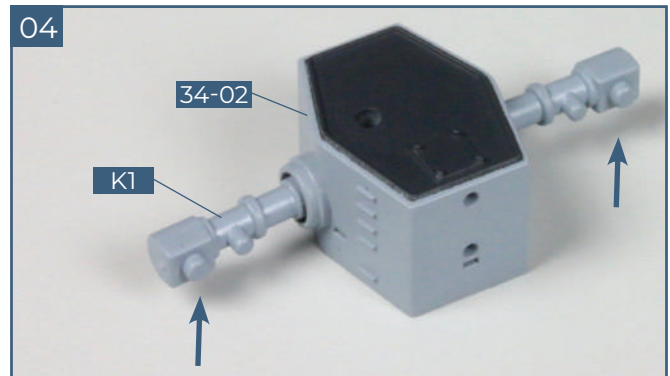

Fit the second radar arm **K1** in place on the other side of the radar unit **34-02**, ensuring it is pointing in the right direction, as indicated by the arrow.

## 02. GEARBOX FOR THE RADAR

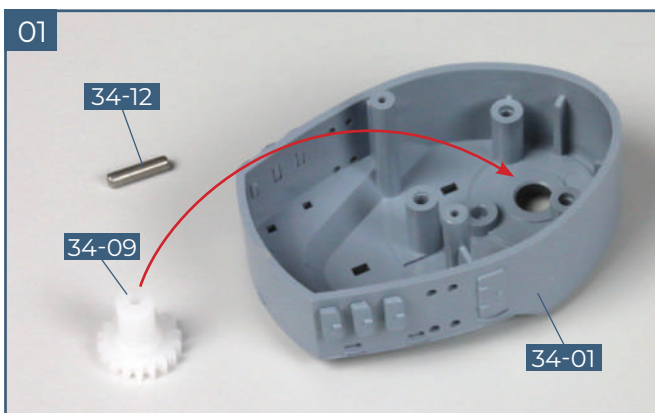

Position the control centre upside down on your work surface. Identify the cog **34-09**. You will also need a shaft **34-12**.

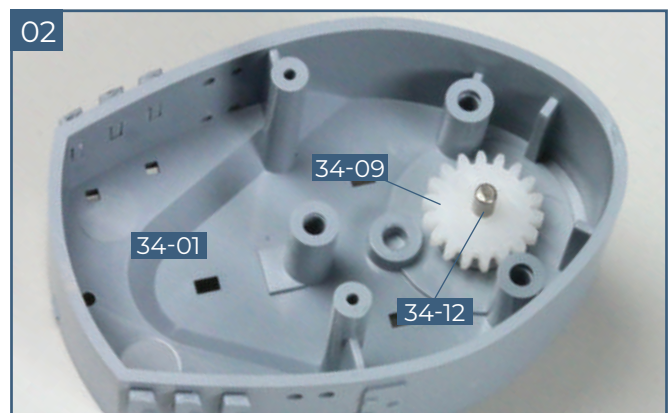

Fit the shaft of cog **34-09** into the larger hole in the control centre **34-01**. Fit the shaft **34-12** into the centre of the cog.

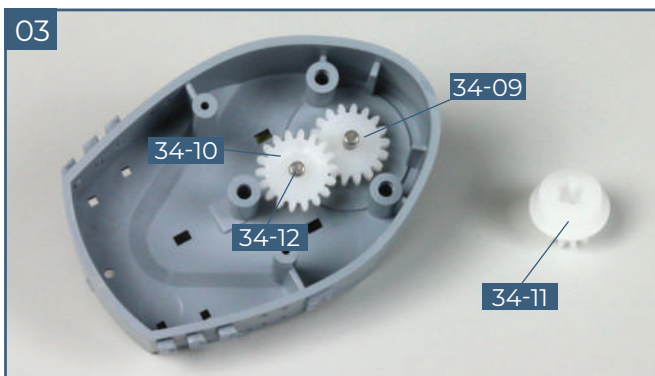

Fit the cog **34-10** and the second shaft **34-12** in the next hole in the control centre. The smaller rim of teeth on cog **34-10** engages with the teeth of **34-09**. Next, you will need cog **34-11**.

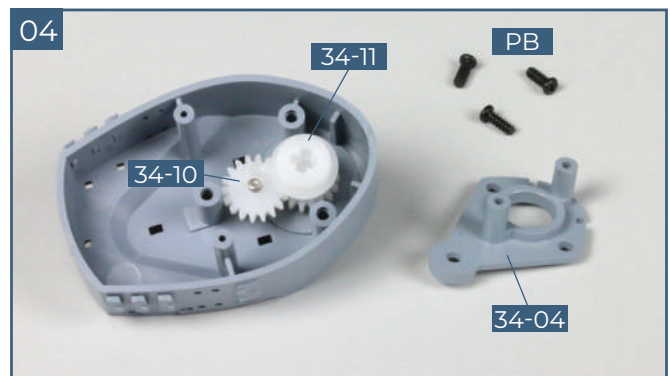

Fit the cog **34-11** on the first shaft **34-12**: its teeth engage with the larger rim of teeth on part **34-10**. Next, you will need the mounting plate **34-04** and three **PB** 2 x 5 mm screws.

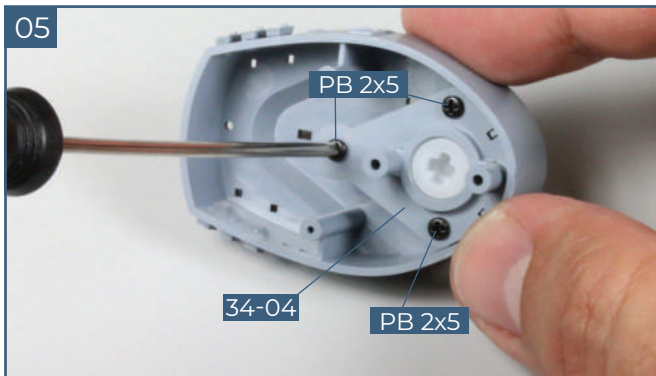

Fit the mounting plate **34-04** onto the bottom of the control centre and fix in place with the three **PB 2 x 5** mm screws. The cogs are held in place by the mounting plate.

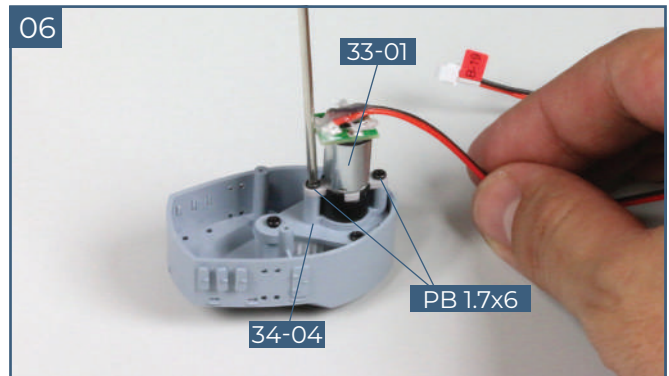

Insert the shaft of the motor **33-01** into the centre of cog **34-11** (not shown) and fix the motor to the mounting plate **34-04** with two **PB 1.7 x 6** mm screws (supplied with stage 33).

### 03. METAL PARTS FOR THE RADAR AND SUPERSTRUCTUREK

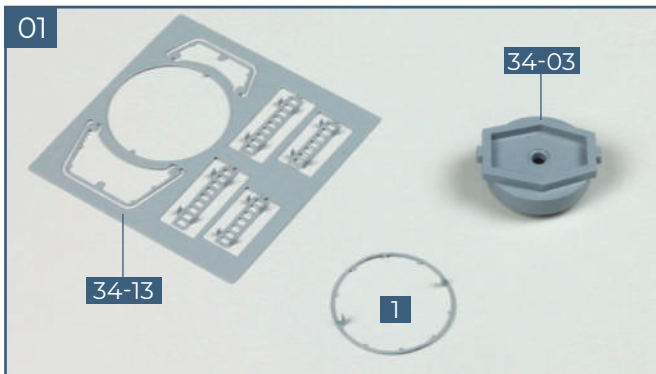

Place the base of the radar **34-03** on your worktop. Remove part **1** from the metal plate **34-13** using tweezers or side cutters.

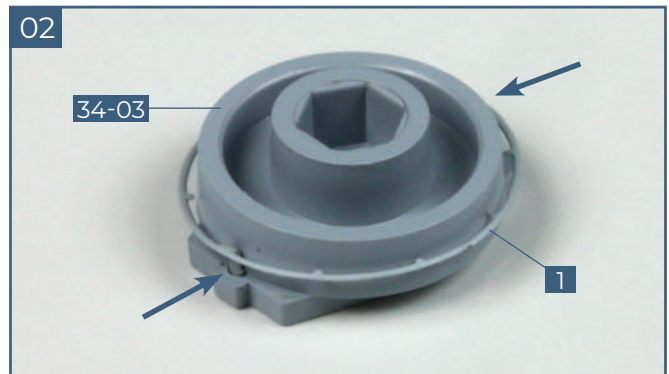

Turn over the base of the radar unit **34-03**. Apply a little superglue to the two pins on the metal part **1** and insert them into the holes in the side of the radar unit, indicated by the arrows.

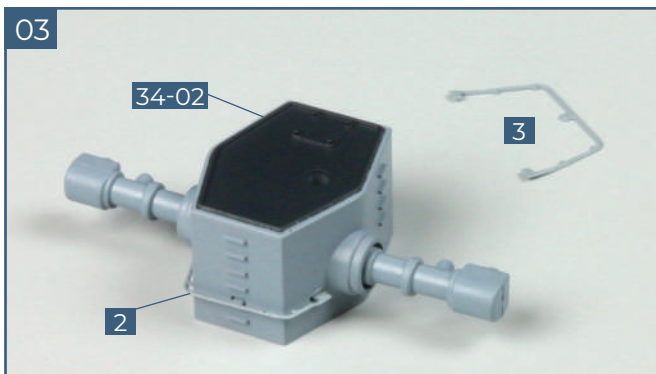

Cut parts **2** and **3** from the metal frame **34-13**. Use a little glue to fix part **2** to the back of the radar unit **34-02**, so that the three pins fit into the holes.

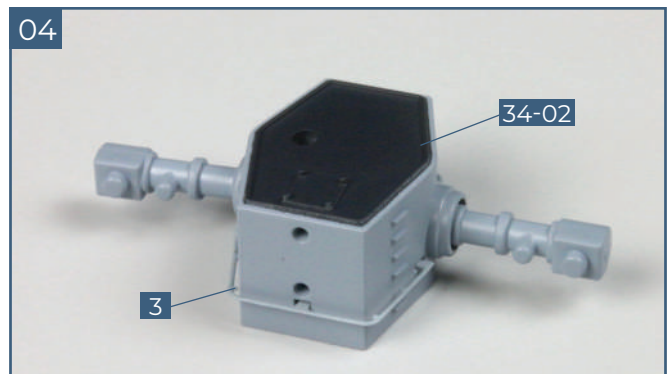

The metal part **3** is glued to the front of the radar unit **34-02**. Again, the three pins fit into holes in the radar unit.

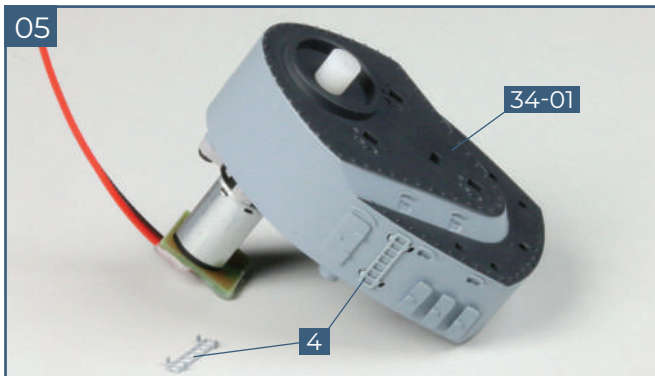

Identify the two ladders **4** and cut them from part **34-13**. Glue the first ladder **4** on the starboard side of the control centre **34-01**.

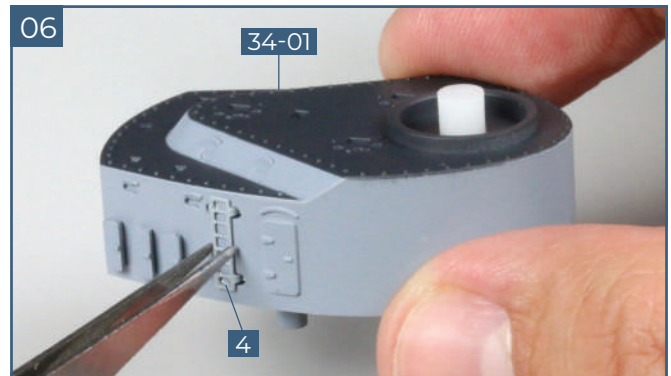

Glue the second ladder **4** in place on the port side of the control centre **34-01**.

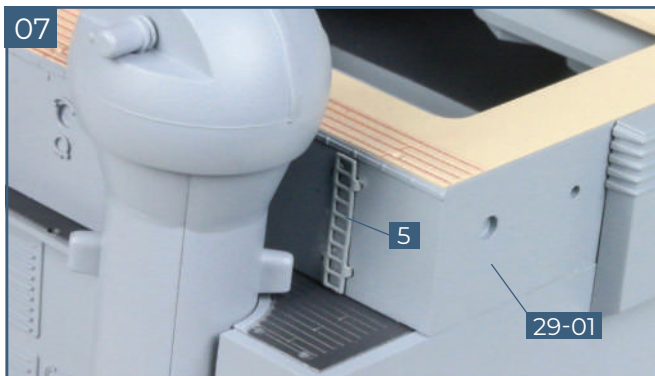

Cut the two ladders **5** from part **34-13**. Glue the first ladder **5** to the back port side of the superstructure (part **29-01**, behind the rangefinder).



Glue the second ladder **5** to the starboard side of the superstructure, behind the rangefinder.

## 04. FURTHER DETAILS FOR THE RADAR AND CONTROL CENTRE

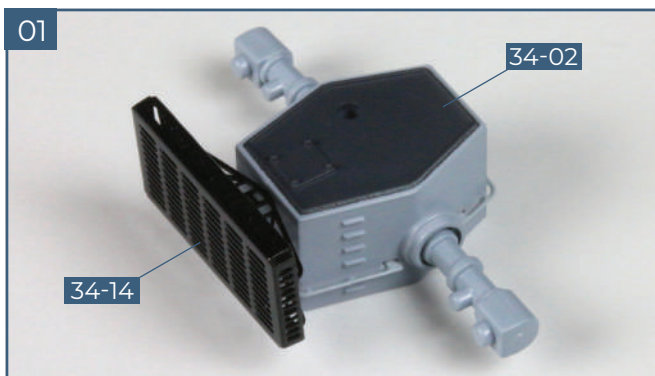

Check the fit of the radar antenna **34-14** on the front of the radar unit **34-02**. It should protrude clearly above the top of **34-02**. Fix in place with a little superglue.

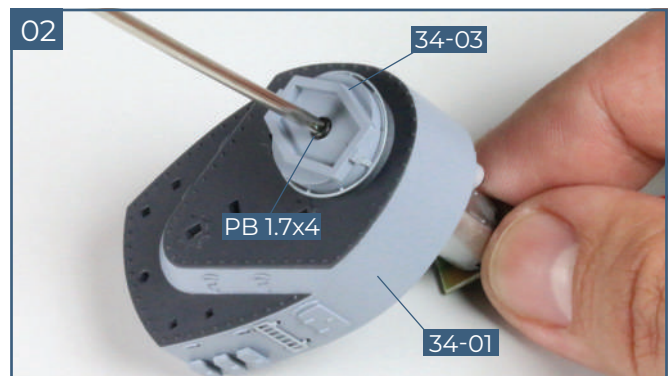

Attach the base of the radar unit **34-03** to the roof of the control centre using a **PB** (1.7 x 4 mm) screw.

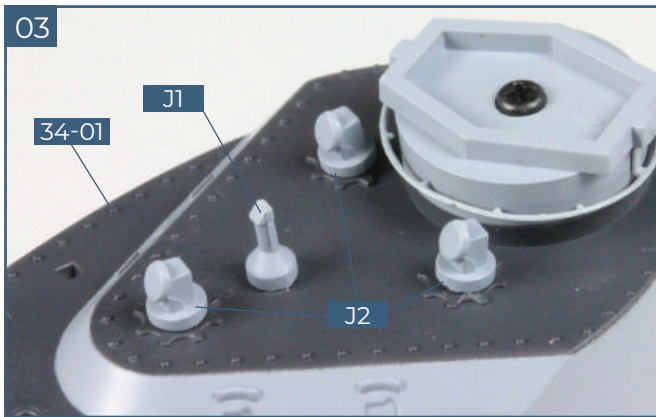

03 Taking care that the parts do not fly off, cut part **J1** and three parts **J2** from the frame **34-05**. Glue them to the top of the control centre **34-01**.

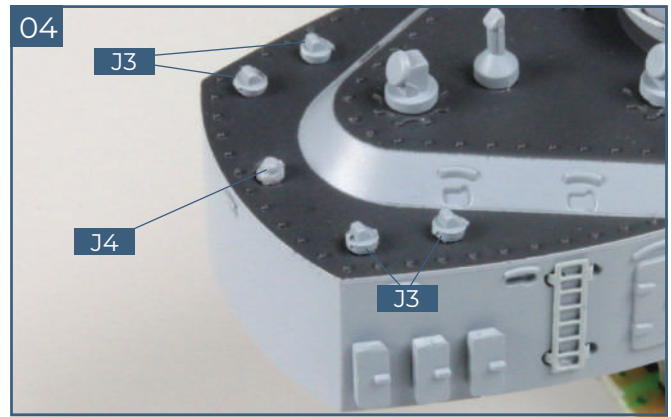

04 Cut four parts **J3** and one part **J4** from the frame. Glue them around the edge of the control centre **34-01** as shown.

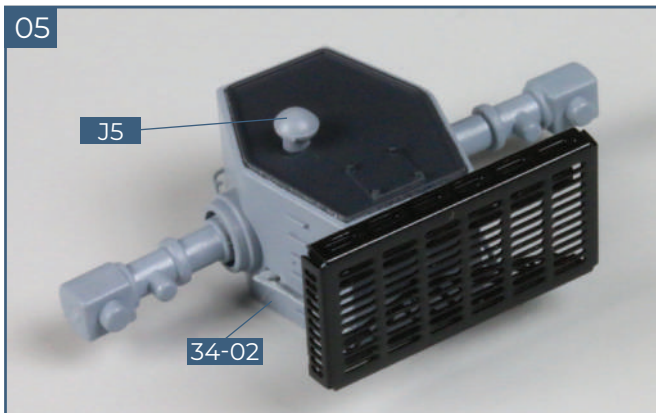

05 Cut part **J5** from the frame and glue it in place on the roof of the radar unit as shown.

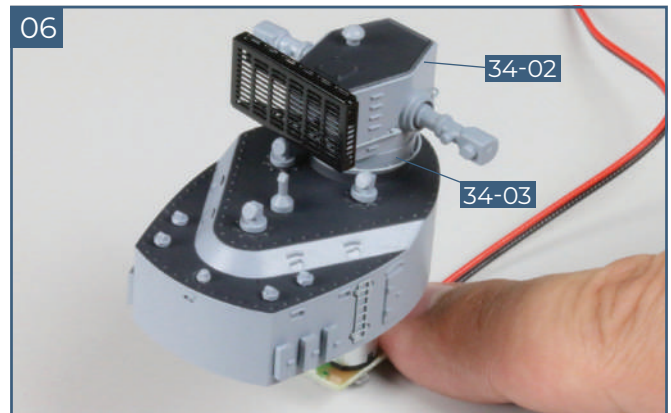

06 Check the fit of the radar unit **34-02** to the base of the radar unit **34-03** and check that the screw fitted earlier (see page 7 step 2) is fully tightened. Glue the radar unit in place.

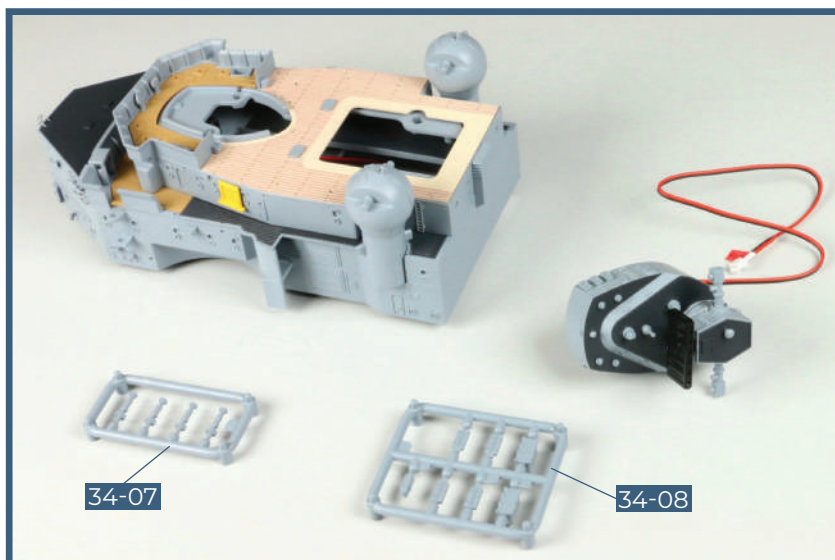

### Completed work

The radar control centre and turntable have been assembled and fitted with accessories. The engine and gearbox for the radar were fitted and two ladders were attached to the front superstructure. Frames **34-07** and **34-08** and two **PB 2 x 5 mm** screws will be used in the next stage.



## STAGE 35

# A KEEL SECTION AND A DISPLAY STAND

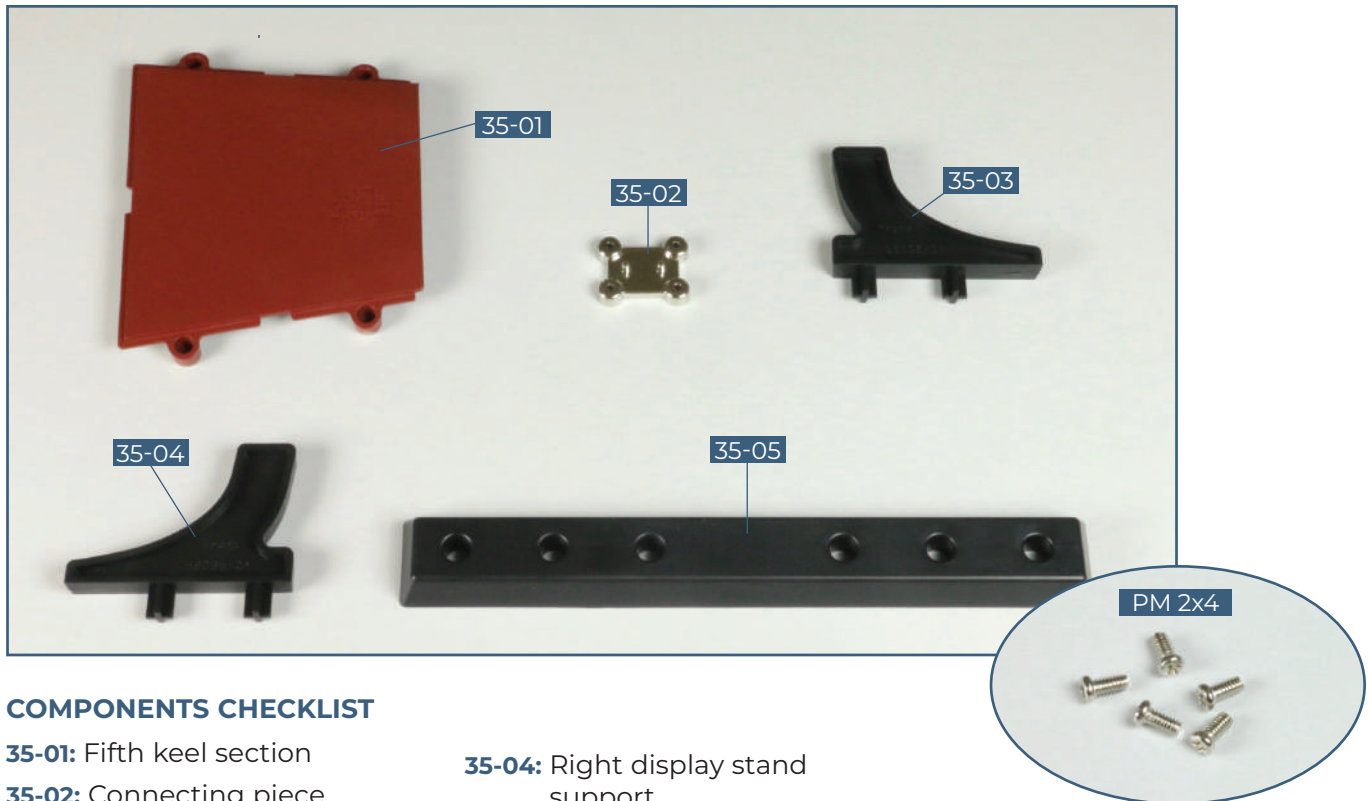

### COMPONENTS CHECKLIST

**35-01:** Fifth keel section

**35-02:** Connecting piece

**35-03:** Left display stand support

**35-04:** Right display stand support

**35-05:** Base of display stand

**PM:** Five 2 x 4 mm PM screws

## 01. DETAILS FOR THE FORWARD SUPERSTRUCTURE

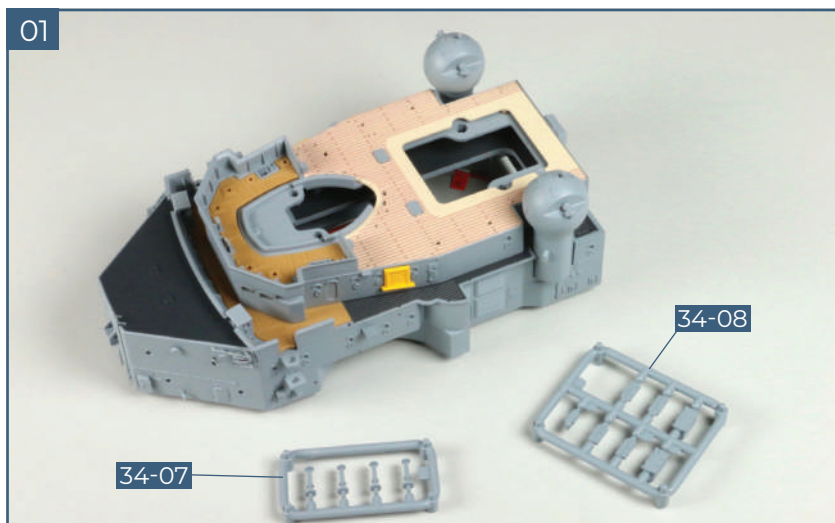

Place the forward superstructure assembly on your worktop. You will need the two plastic frames supplied with the previous stage: frame **34-07** has four identical parts **L**, and frame **34-08** has two parts **M1**, four parts **M2** and one part **M3**.

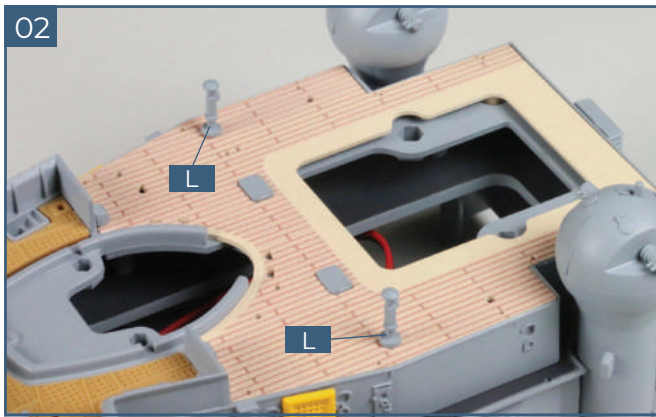

Fit first two parts **L** from the frame **34-07** on each side of the lower mast deck, as shown. Fix in place with a little superglue.

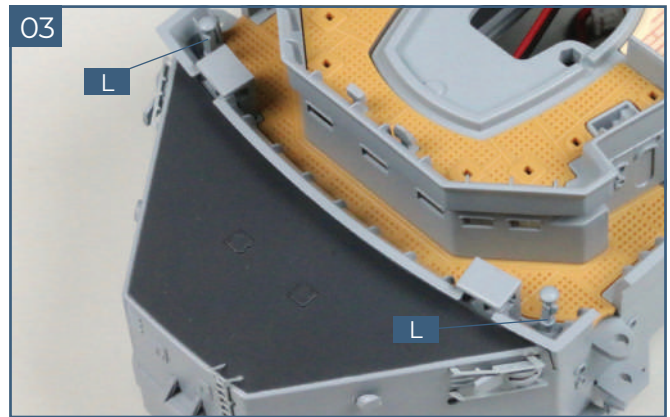

Fit the two remaining parts **L** in the forward corners of the bridge deck and glue in place.

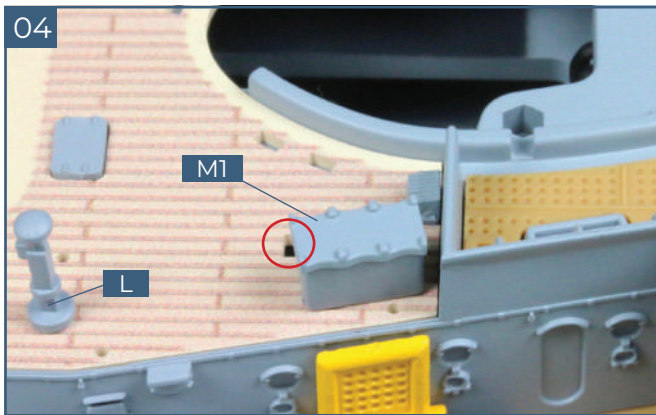

Cut the first storage box **M1** from frame **34-08**. Check the fit on the starboard side of the lower mast deck, near part **L**. Make sure that the box does not cover the hole on the deck (circled). Glue in place.

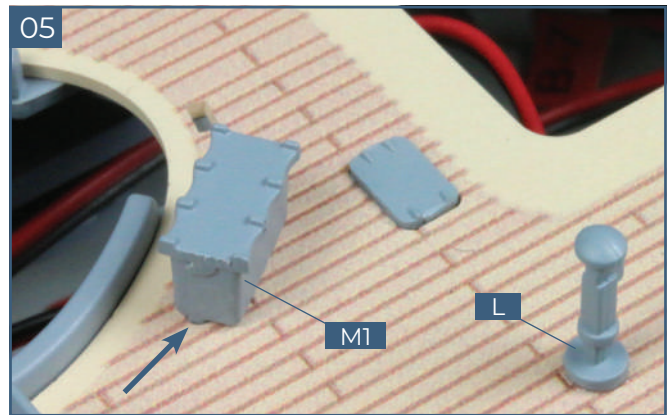

Cut the second storage box **M1** from frame **34-08** and fit it in place on the other side of the lower mast deck, near the oval opening. Make sure you have the box the right way round: in this photo, the pegs on the base are located on the left, as indicated by the arrow.

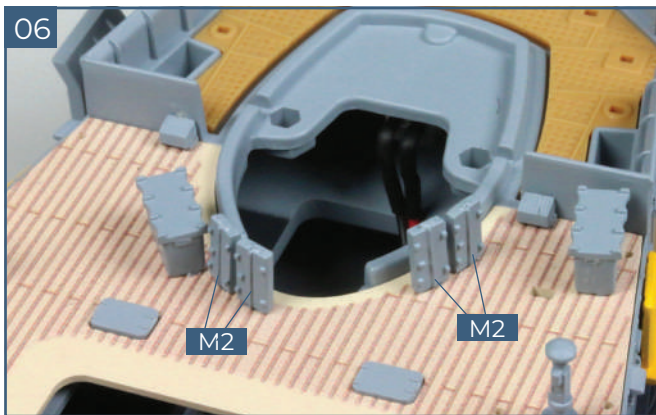

The four storage units **M2** are fitted in pairs behind the large opening. Take care not to remove the locating pegs when cutting from the frame. Make sure that they are vertically aligned and glue in place.

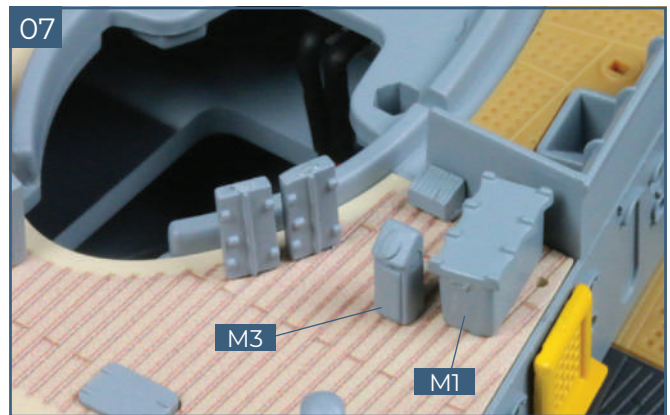

Glue part **M-3** in place next to box **M-1** on the lower mast deck.

## 02. ASSEMBLING THE SUPERSTRUCTURE ELEMENTS

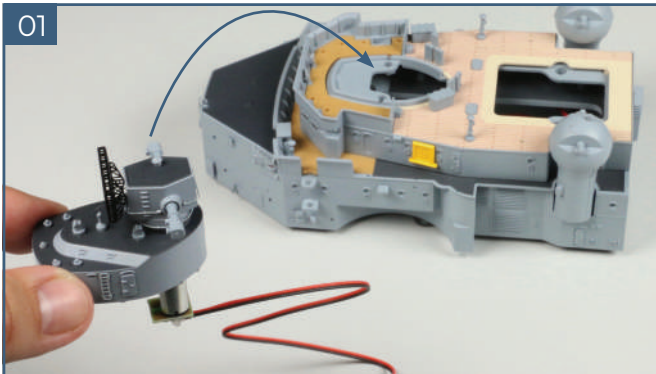

Take the control centre assembly from the previous stage and check the fit in the recess on the lower mast deck as shown.

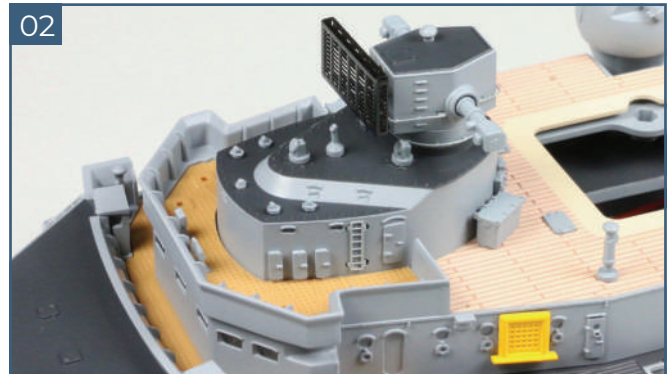

When fitting the control centre, take care not to damage the parts that are already in place. Press down gently on the assembly so that it fits snugly, with no gaps. This is a very tight push-fit.

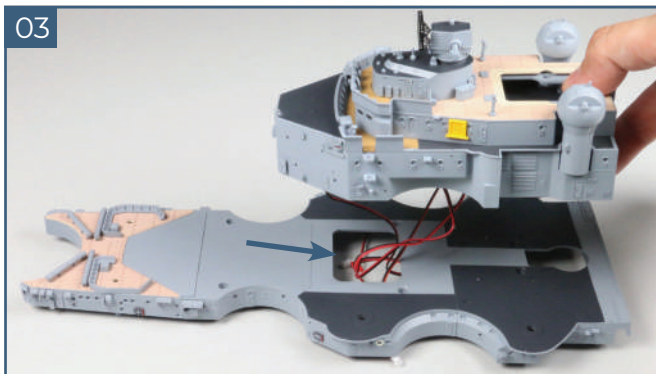

Place the superstructure deck on your worktop. Fit the bridge deck assembly so that all cables run down into the large recess of the superstructure deck, as indicated by the arrow.

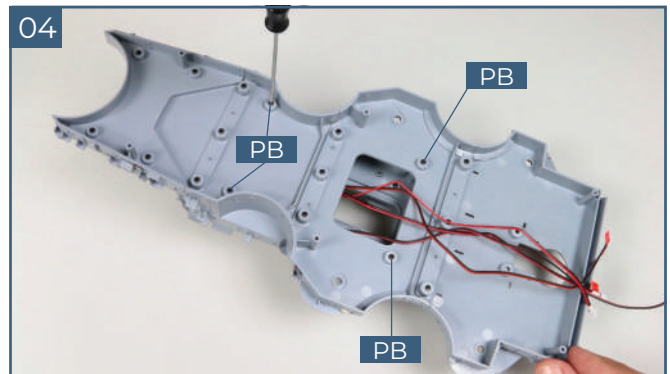

Carefully turn the assembly over, taking care not to damage any parts. Fix the superstructure decks together using four **PB 2 x 5** mm screws (supplied with the previous stage).

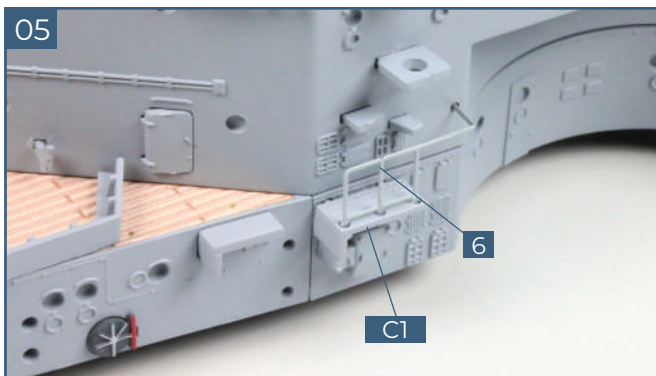

Remove the railing **6** from the metal frame **32-07**. Glue it in place on the port side of the superstructure, to form a railing for platform **C1** (fitted in stage 23).

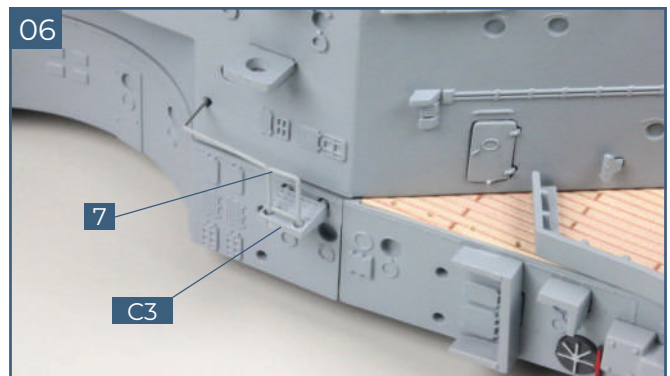

Similarly, glue railing **7** to platform **C3** on the other side of the superstructure deck.

### 03. FITTING THE NEXT KEEL SECTION

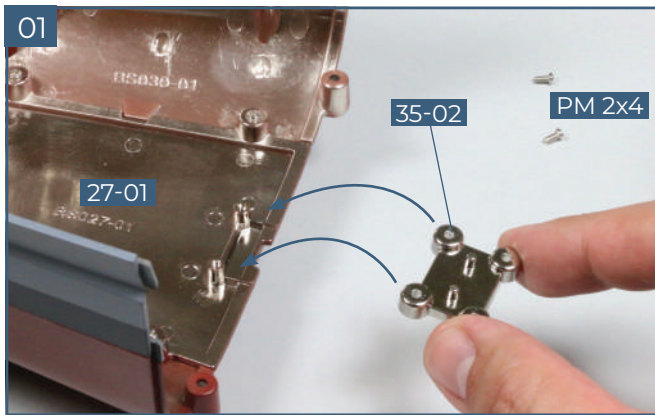

Fit the connecting piece **35-02** over the two raised sockets on the keel section **27-01**, as indicated. Have two **PM 2 x 4** mm screws ready.

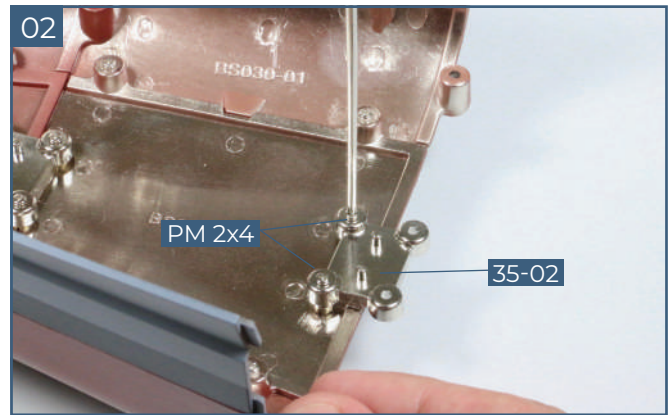

Fix part **35-02** to the keel assembly using two **PM 2 x 4** mm screws as shown.

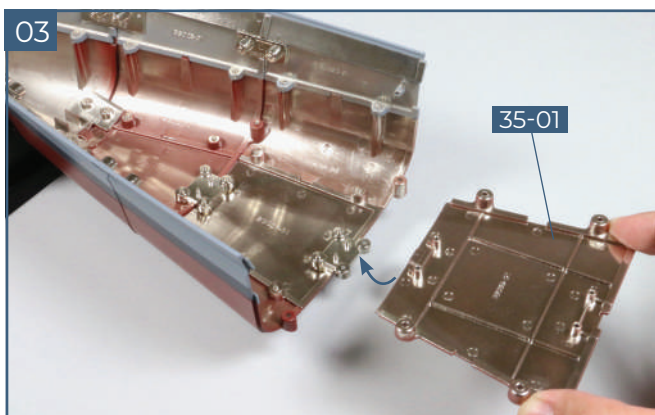

Position the keel section **35-01** so that the raised screw sockets fit into the sockets in the connecting piece **35-02** as shown.

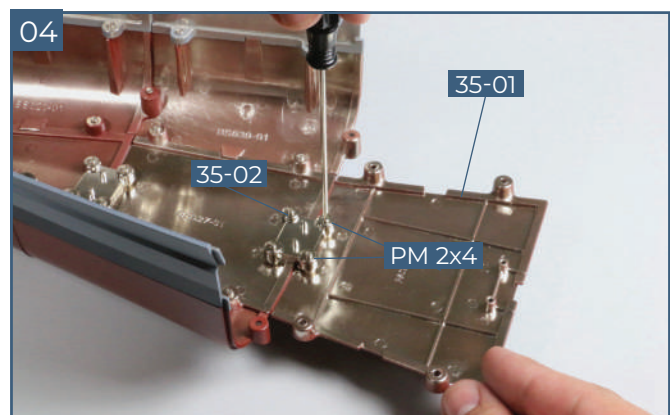

Fix the keel section in place with two **PM 2 x 4** mm screws.

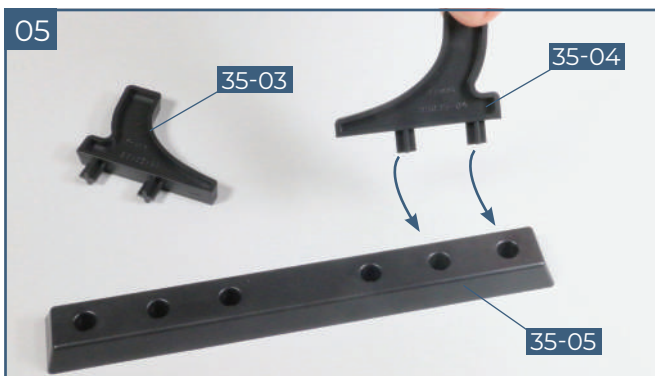

Place the parts of the display stand, **35-05**, **35-03** and **35-04** on your worktop. Fit the pegs on the right support **35-04** into the corresponding holes in the base **35-05**, as shown.

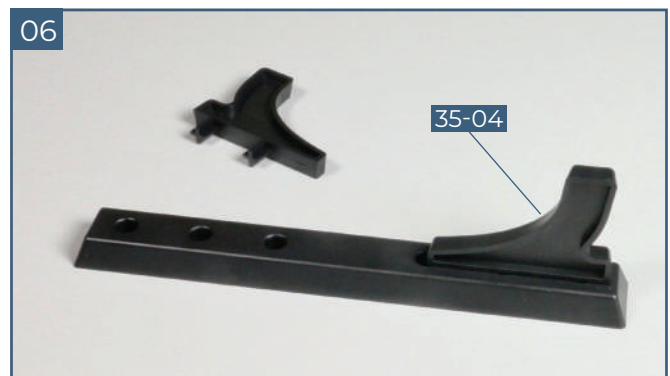

This photo shows the first part of the display stand in place.



Next, fit the pegs on the other bracket **35-03** into the corresponding holes in the base **35-05**, as shown.

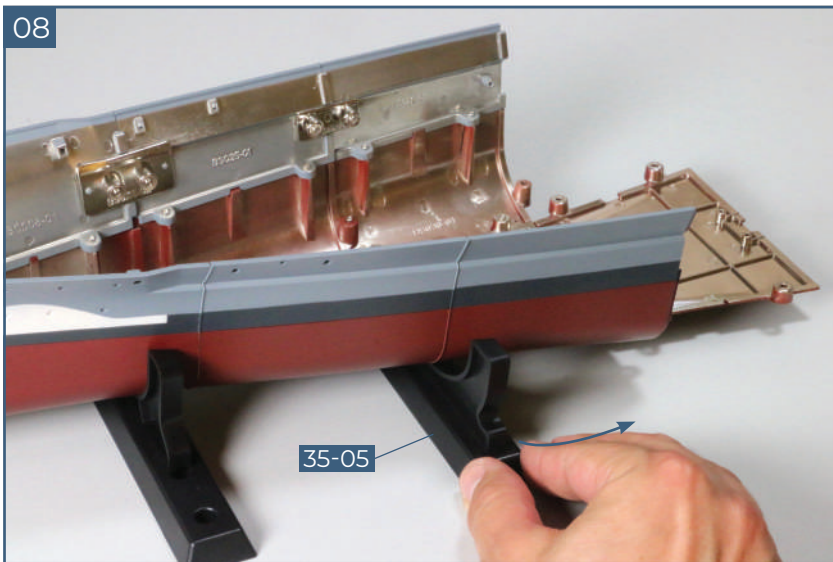

Fit the display stand **35-05** under the hull of your model and push it aft as far as possible.

Note: When positioning the display stand, make sure that the 'front' sides of the two brackets are facing the bow.

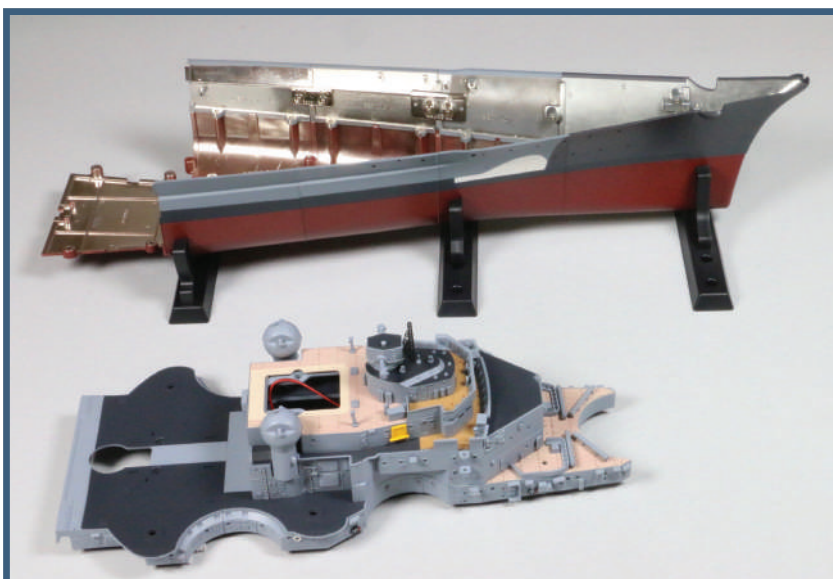

### Completed work

The hull has been extended and now rests safely on three display stands. Three elements of the front superstructure have been fitted together to make a large assembly.

## STAGE 36

# MOTOR FOR THE FORETOP RADAR INSTALLATION

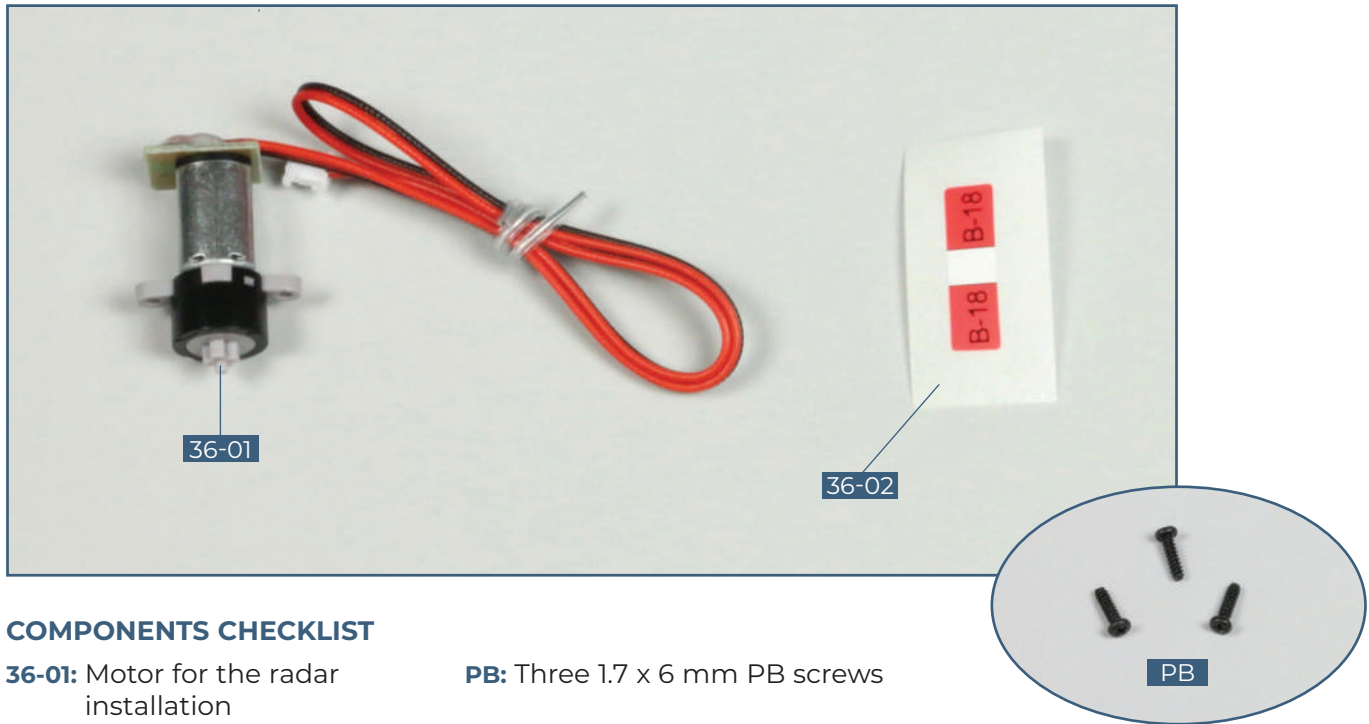

### COMPONENTS CHECKLIST

**36-01:** Motor for the radar installation

**PB:** Three 1.7 x 6 mm PB screws

**36-02:** Cable label

## 01. PREPARING THE RADAR MOTOR

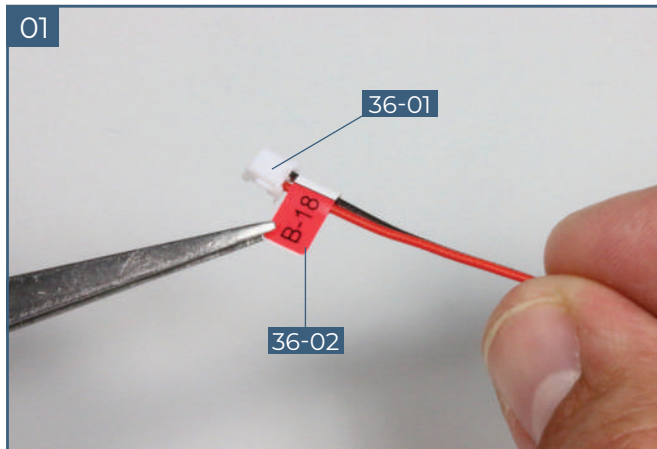

Take the motor with attached cable **36-01**. Remove the cable label **36-02** from the backing and wrap it around the cable, next to the socket, as shown.

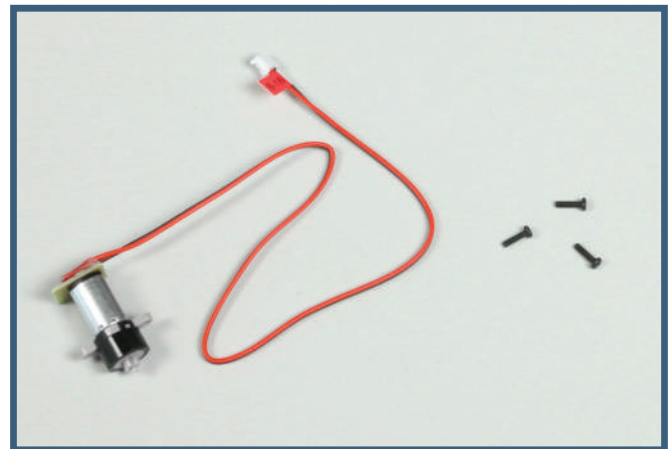

### Completed work

A label has been fitted to the cable on the second radar motor. Store this and the three **PB** screws until they are needed in the next stage.

## STAGE 37

# THE FORETOP RADAR AND A PORT HULL SECTION

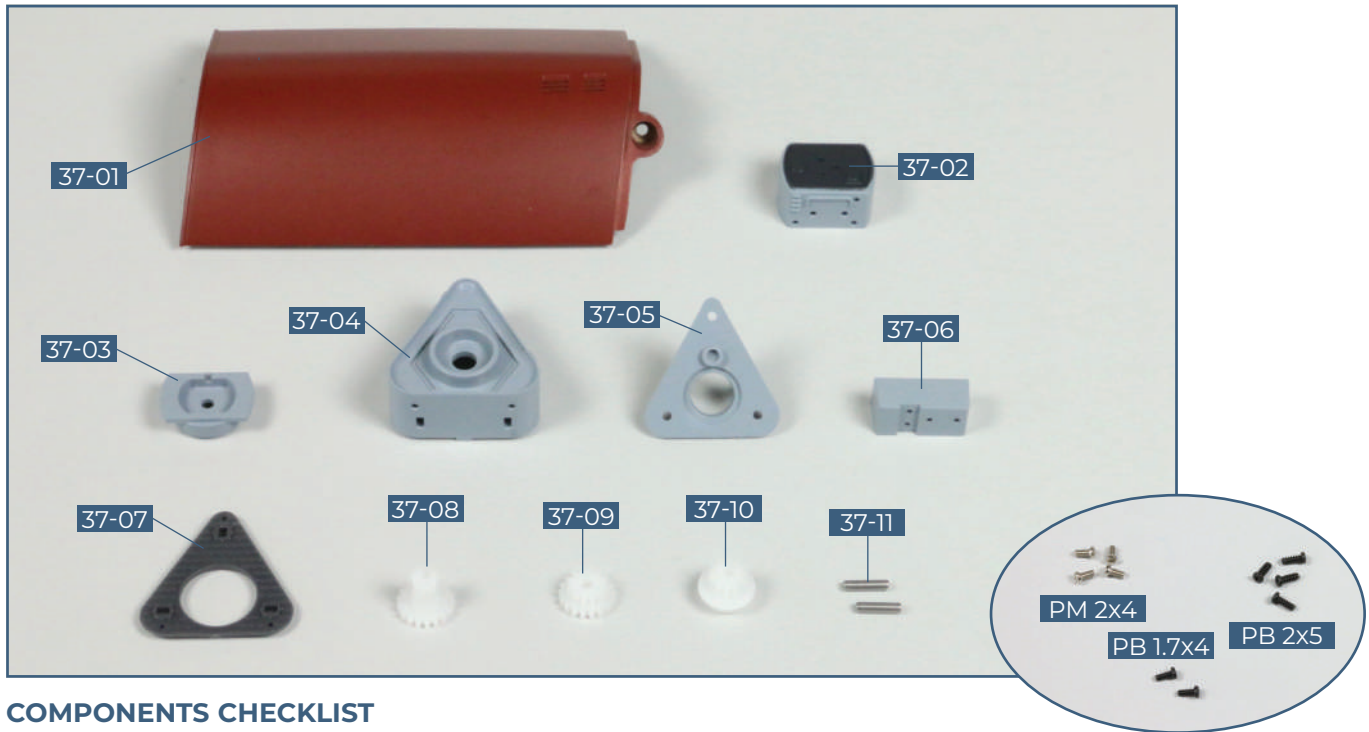

### COMPONENTS CHECKLIST

**37-01:** Lower port hull section

**37-02:** Radar unit

**37-03:** Base of radar unit

**37-04:** Foretop command post

**37-05:** Base plate

**37-06:** Foretop command post attachment

**37-07:** Deck

**37-08:** Cog

**37-09:** Cog

**37-10:** Cog

**37-11:** Two shafts

**PM:** Four 2 x 4 mm PM screws

**PB:** Four 2 x 5 mm PB screws

**PB:** Two 1.7 x 4 mm PB screws

## 01. FITTING THE NEXT HULL SECTION

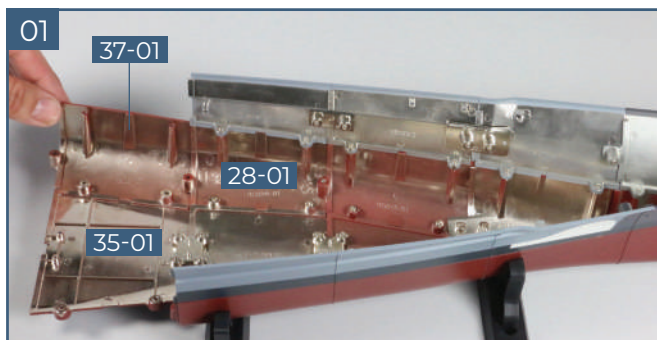

Take the hull assembly from stage 35. Fit the pegs on the lower port hull section **37-01** into the raised sockets in the hull sections **28-01** and **35-01**.

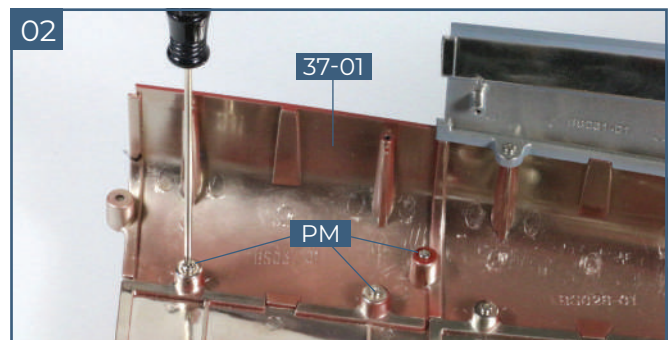

Fix the hull section **37-01** in place with three **PM 2 x 4 mm** screws.

## 02. THE RADAR UNIT

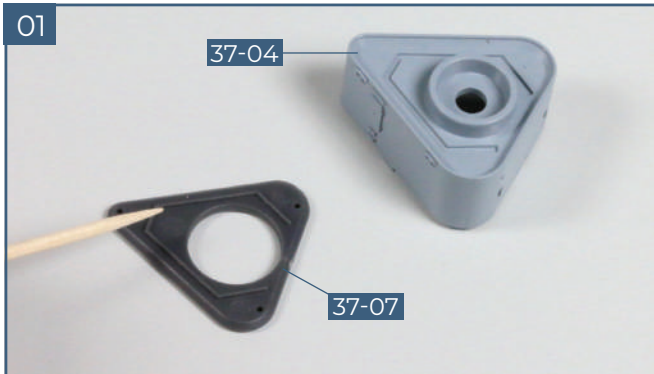

Put the foretop command post attachment **37-04** on your work surface. Take the deck **37-07** and check the fit on the top of part **37-04**. Apply superglue to the underside of the deck **37-07**.

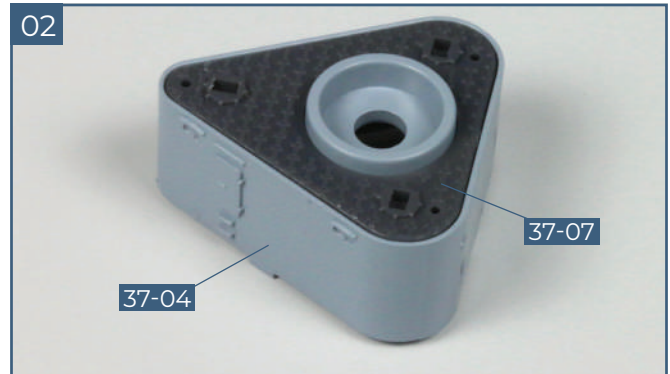

Fix the deck **37-07** in place on the top of part **37-04**.

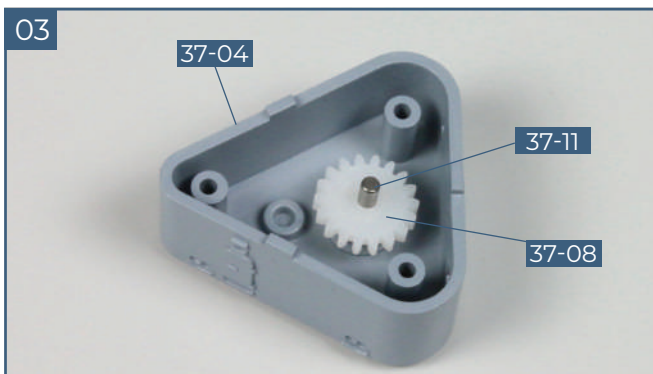

Turn part **37-04** over. Take the cog **37-08** and one of the shafts **37-11**. Fit the shaft into the cog **37-08** then pass the cog through the hole in part **37-04**.

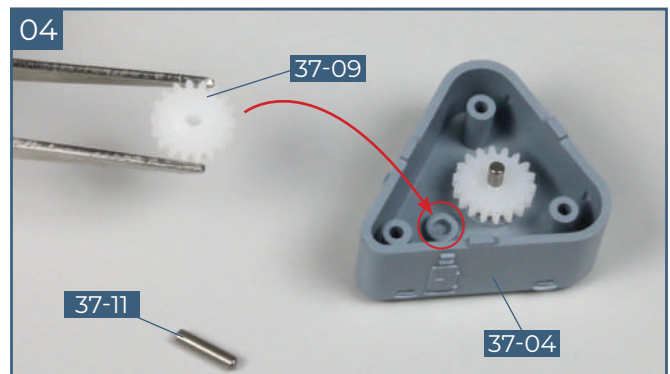

Identify the fixing point (circled) for the next cog **37-09** and shaft **37-11**.

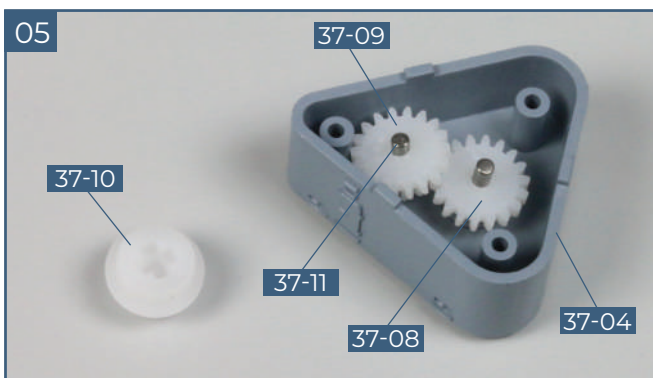

Fit the shaft **37-11** through the cog **37-09** and into the fixing point in part **37-04**. When correctly fitted, the smaller ring of teeth on the cog **37-09** will engage with the teeth on the outer edge of cog **37-08**.



Fit cog **37-10** on the first shaft **37-11** so that its teeth engage with the outer ring of teeth on cog **37-09**.



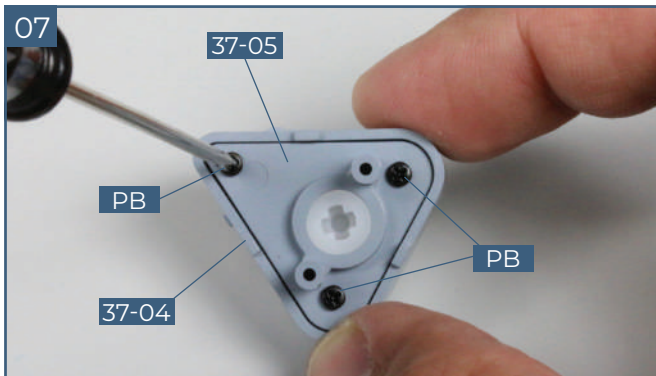

Take the base plate **37-05** and fit it over the cogs. Fix in place with three **PB 2 x 5 mm** screws so that the cogs are held in place.

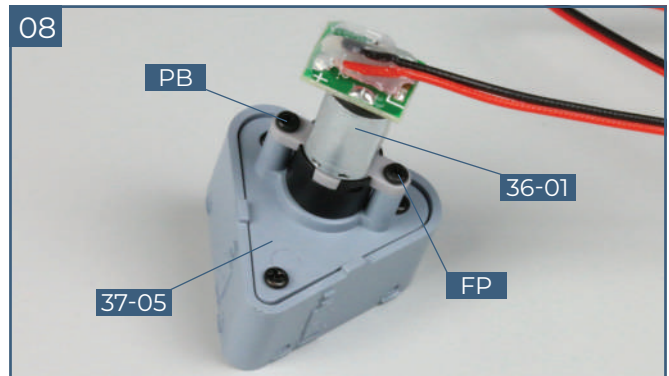

Take the motor from the previous stage. Fit the shaft of the motor into the recess in cog **37-10**, so that the tabs on the motor fit over the raised screw sockets. Fix the motor in place with two **PB 1.7 x 6 mm** screws (supplied with stage 36).

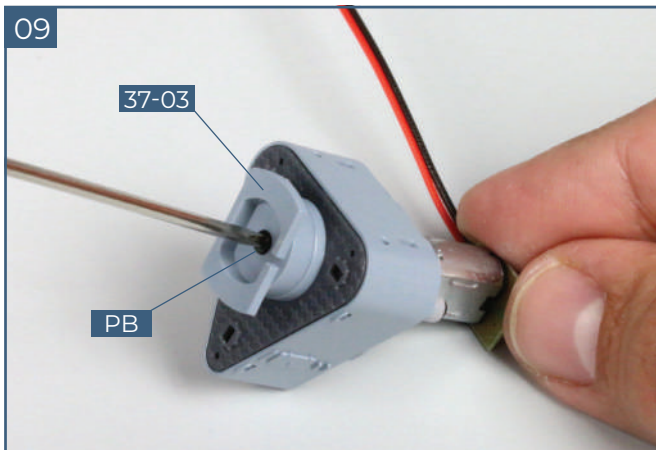

Turn the assembly over and take the base of the radar unit **37-03**. Fit it onto the protruding shaft of cog **37-08** and fix in place with a **PB 1.7 x 4 mm** screw.

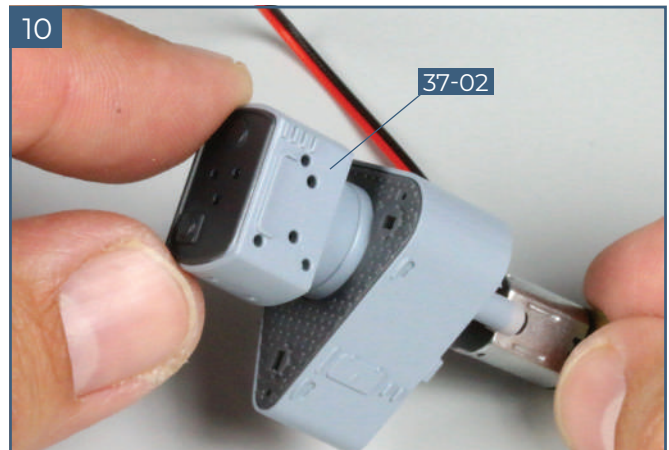

Check the fit of the radar unit **37-02** on the base **37-03**. Apply a little superglue to the contact points and fix in place.

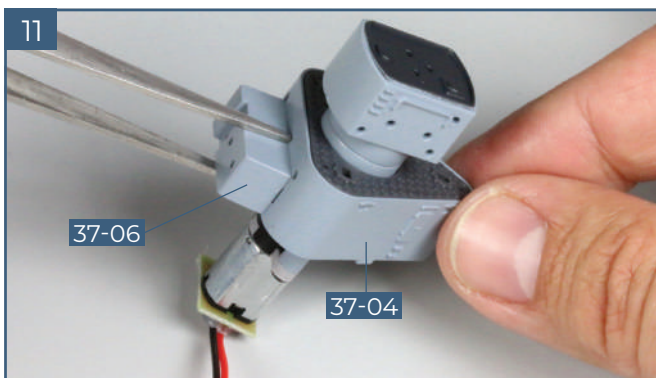

Check the fit of the foretop command post attachment **37-06** on the back of the foretop command post part **37-04**, as shown. Apply a little superglue to the two pins on part **37-06** and fix in place.

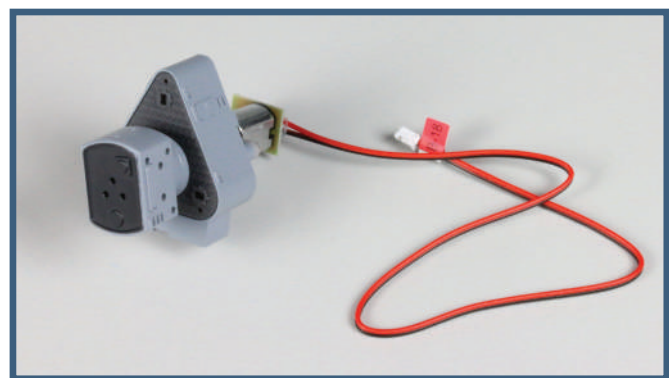

**Completed work**

We have started to assemble the radar unit, and the motor has been fitted.

# STAGE 38

## THE FORETOP RADAR AND A STARBOARD HULL SECTION



### COMPONENTS CHECKLIST

**38-01:** Lower starboard hull section

**38-02:** Foretop command post gallery

**38-03:** Small accessories (1-5)

**38-04:** Deck

**PM:** Four PM 2 x 4 mm screws

## 01. FITTING THE NEXT HULL SECTION

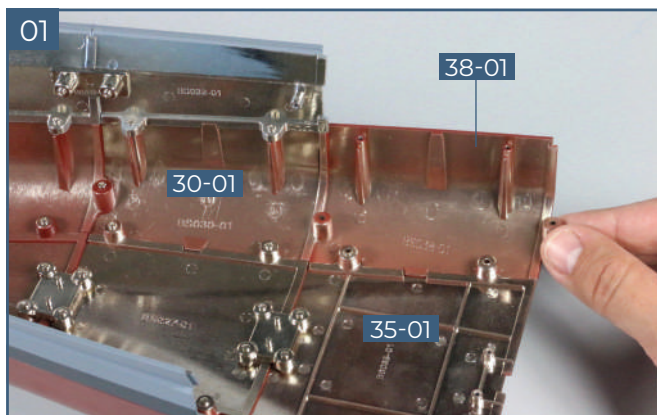

Take the hull assembly from stage 37. Fit the pegs on the lower starboard hull section **38-01** into the raised screw sockets in the hull sections **30-01** and **35-01**.

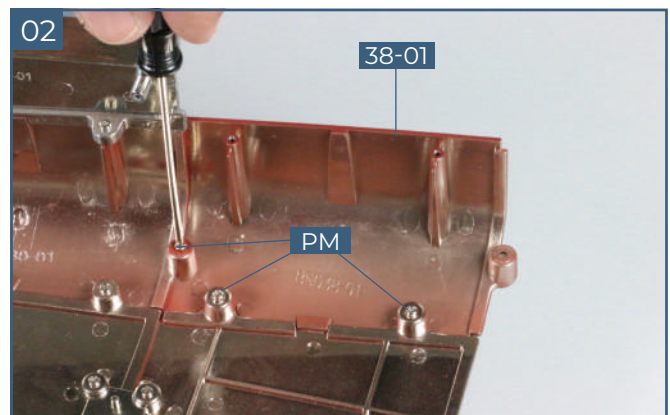

Fix the hull section **38-01** in place with three **PM 2 x 4 mm** screws.

## 02. ACCESSORIES FOR THE FORETOP CONTROL POST

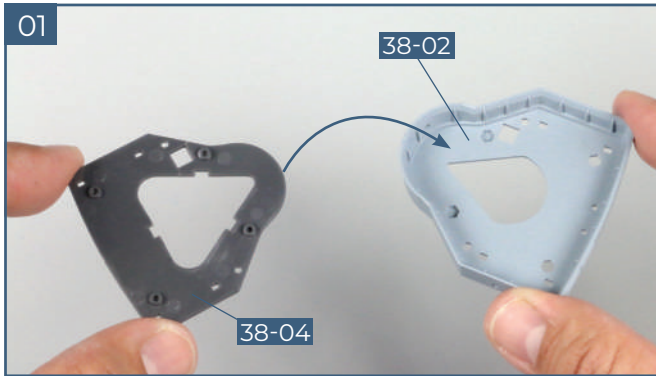

Take the deck **38-04** and fit it into the foretop command post gallery **38-02**, as indicated by the blue arrow shown in the picture above.

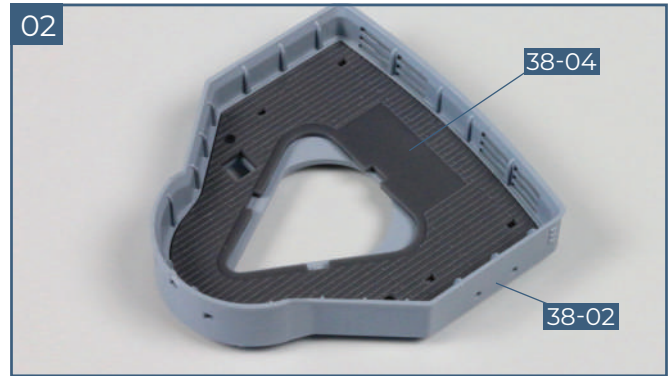

This shows the deck in place. If it is loose, fix in place with a little superglue.

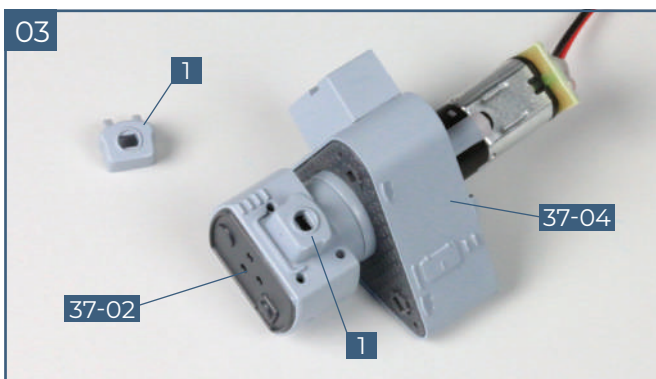

Take the foretop assembly from stage 37. Cut the two sockets, **1**, from the frame **38-03** and smooth any rough edges. Check the fit on the side of the radar unit **37-02**. Apply a little glue to the pegs on the first socket **1** and fix in place.

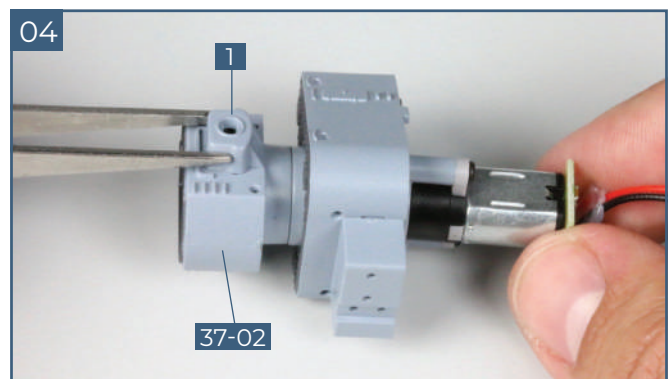

Repeat step 03 to fit the second socket, **1**, on the other side of the radar unit.

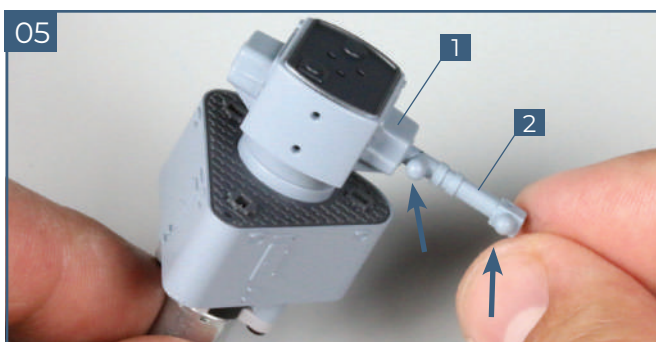

Cut the two rangefinder arms, **2**, from the frame **38-03**. Check the fit of the first arm in one of the sockets, **1**, ensuring you have it pointing in the right direction, as indicated by the arrows. Also, carefully note the orientation of part **37-02**. Fix in place with superglue.

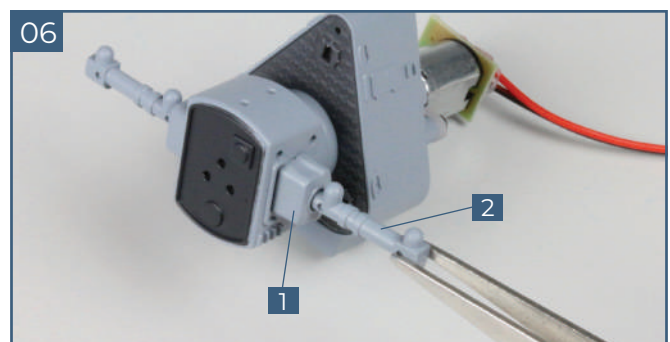

Repeat step 05 to fix the second rangefinder arm, **2**, into the second socket, **1**.

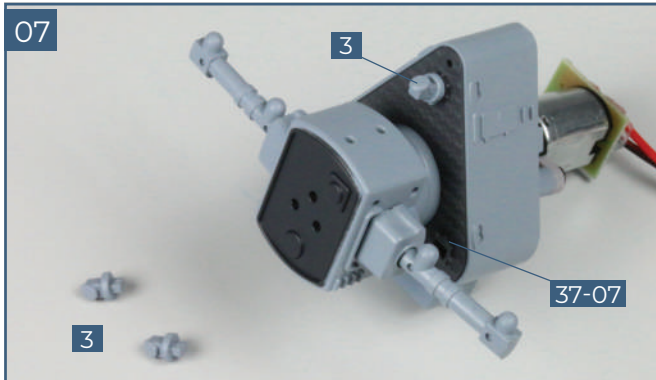

Cut the three parts **3**, from the frame **38-03**. Identify the fixing point for the first part **3**, on the recess on the forward end of the deck **37-07**. Note that the flat side should face forwards. Fix in place with a little superglue.

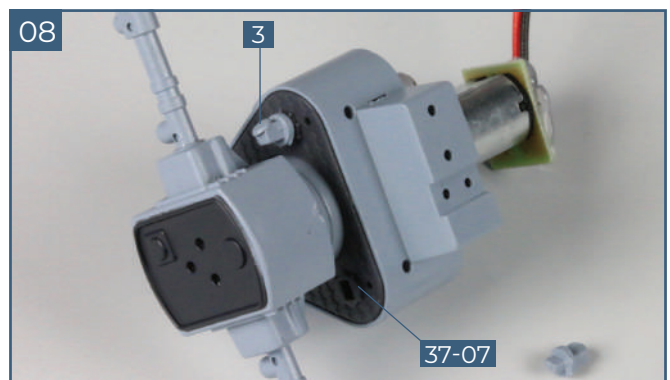

Turn the foretop around so that you can fit the second part **3**, in one of the recesses in the aft corners of the foretop deck **37-07**. Again, make sure you have part **3** facing the right way, in this case it faces outwards. Fix in place with a little superglue.

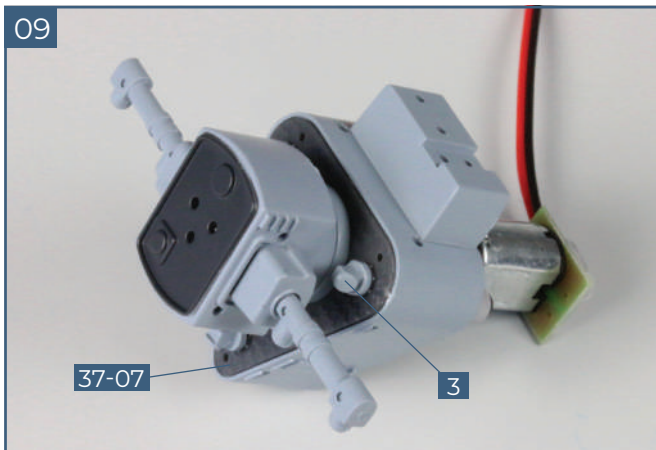

Fix the third part **3** in place in the other corner of the foretop deck, again, with the flat side facing outwards.

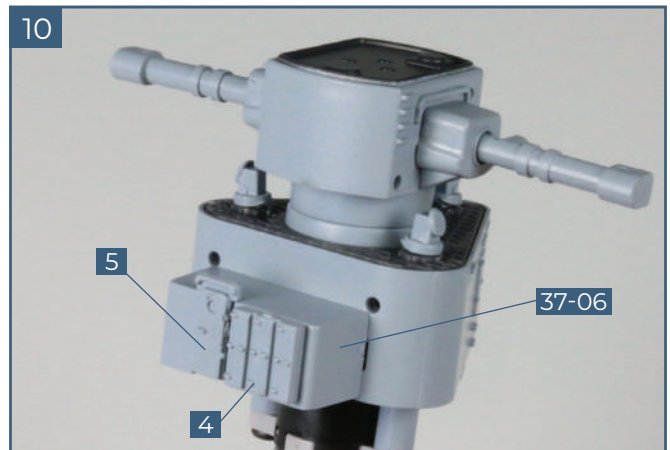

Cut the door, **5**, and the set of three lockers, **4**, from the frame **38-03**. Test the fit on the foretop, noting the orientation, and fix in place with a little superglue.

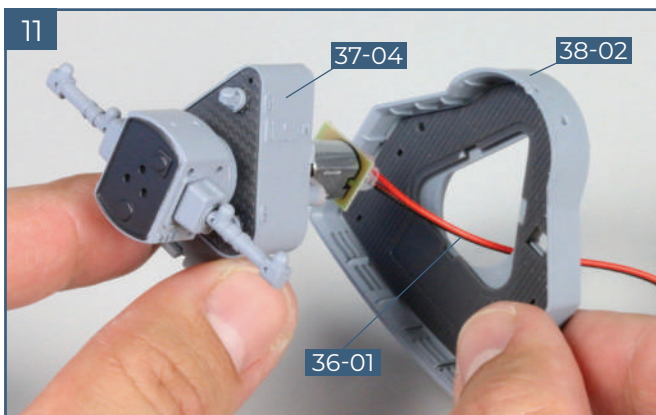

Thread the motor cable **36-01** through the centre of the foretop command post gallery **38-02**. Check that the triangular shapes of the foretop are aligned. Apply a little superglue around the base of part **37-04** and fix in place.

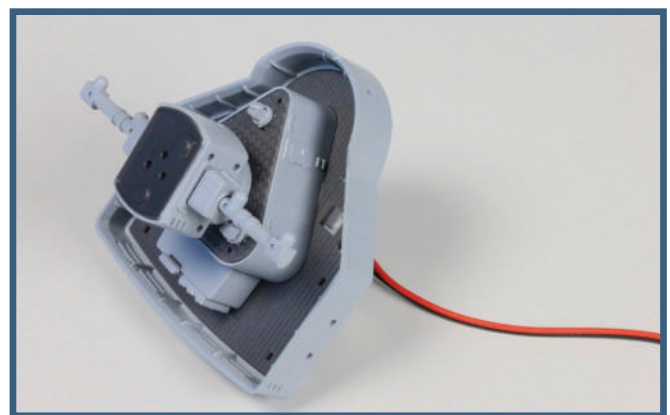

### Completed work

Accessories and a gallery have been fitted to the foretop command post.

## STAGE 39 THE NEXT HULL SECTION



### COMPONENTS CHECKLIST

**39-01:** Upper port hull section

**PM:** Five 2 x 4 mm PM screws

**39-02:** Connecting piece

## 01. FITTING THE NEXT HULL SECTION

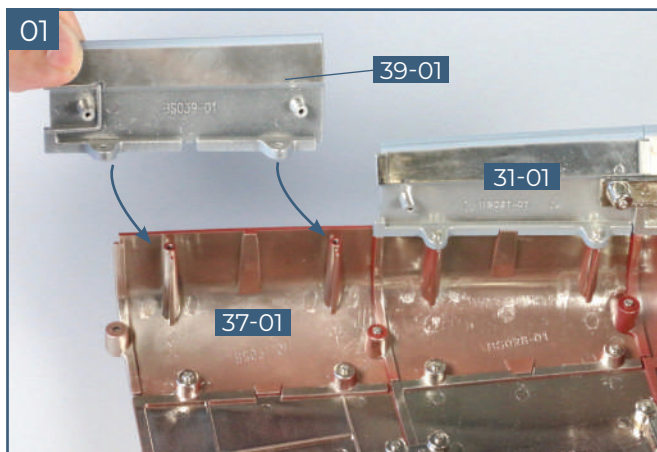

Take the hull assembly from stage 38. Align the holes in the tabs on the upper port hull section **39-01** with the screw sockets in the hull section **37-01**. You may find it helpful to temporarily loosen the adjoining part **31-01**.

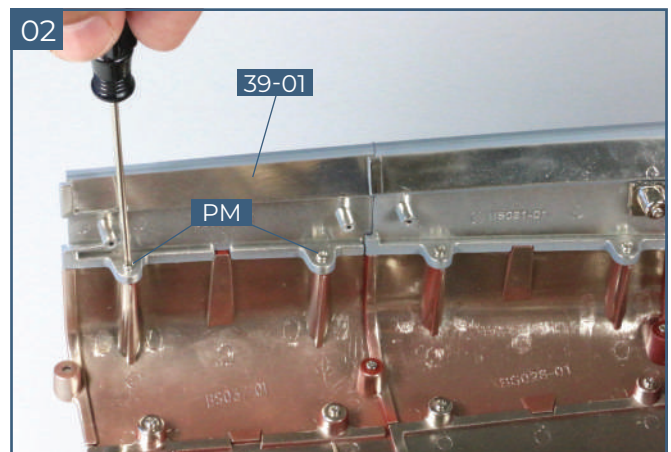

Fix the hull section **39-01** in place with two **PM** 2 x 4 mm screws.

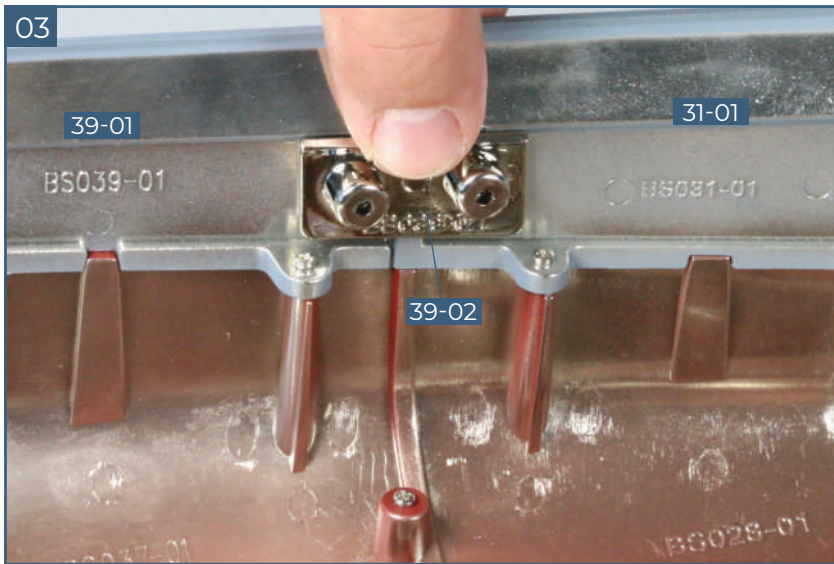

Fit the connecting piece **39-02** over the raised screw sockets on either side of the join between parts **39-01** and **31-01**.

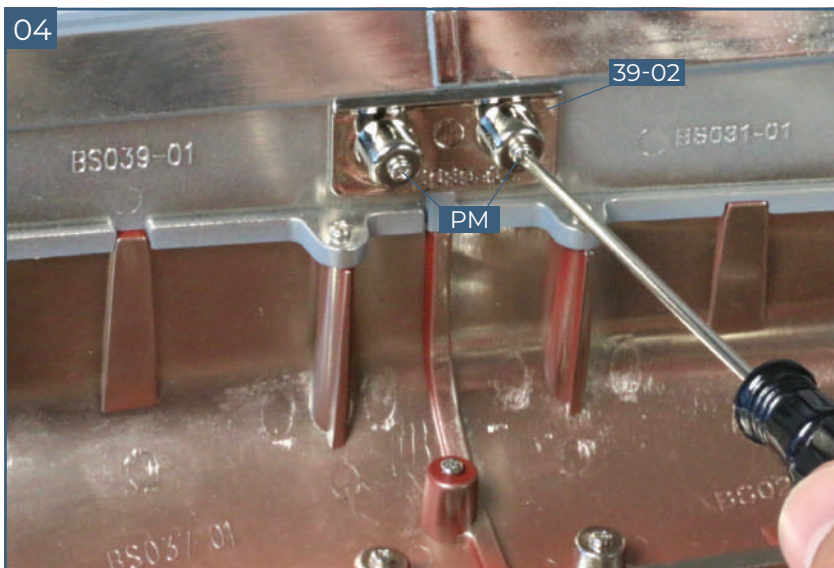

Fix the connecting piece **39-02** in place with two **PM** 2 x 4 mm screws.

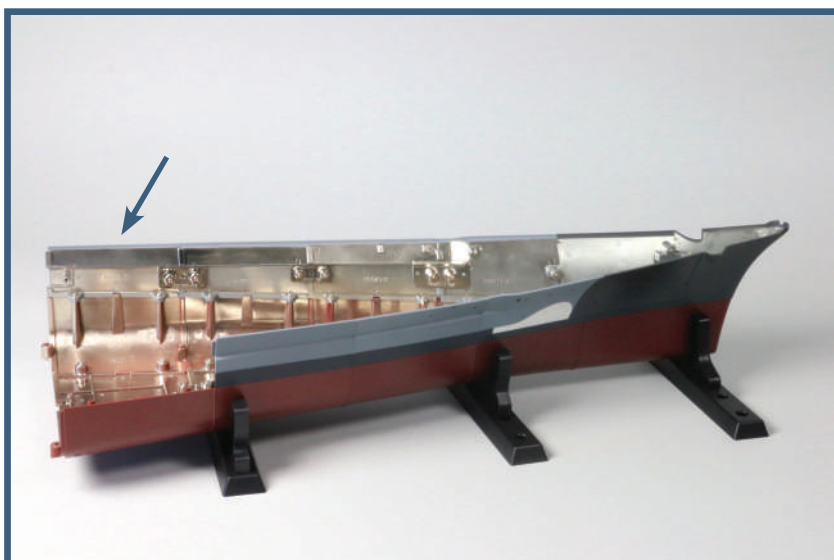

**Completed work**

Another panel has now been added to the hull section.

## STAGE 40

# FIRE CONTROL POST DETAILS AND SEARCHLIGHT DECK

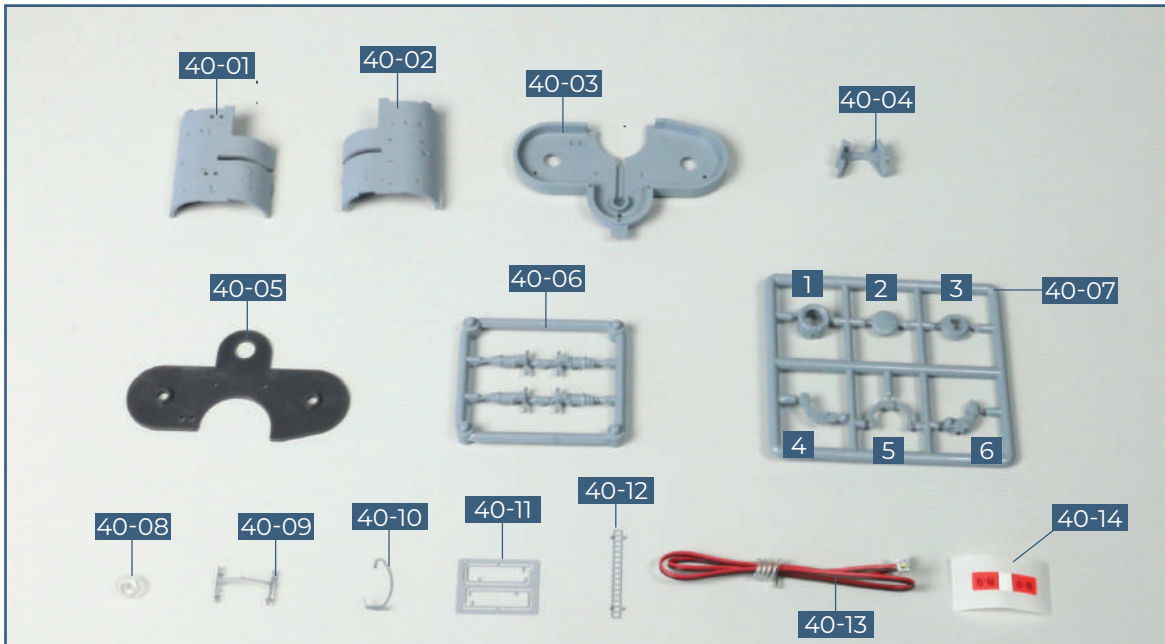

### COMPONENTS CHECKLIST

**40-01:** Upper superstructure, left half

**40-02:** Upper superstructure, right half

**40-03:** Searchlight platform

**40-04:** Locker structure

**40-05:** Decking

**40-06:** Four ZAG artillery guidance devices

**40-07:** Searchlight parts (1-6)

**40-08:** Searchlight glass

**40-09:** Ladder support

**40-10:** Cooling coil

**40-11:** Rangefinder rails

**40-12:** Ladder

**40-13:** Searchlight cable

**40-14:** Cable label

## 01. ATTACHING THE CABLE LABEL

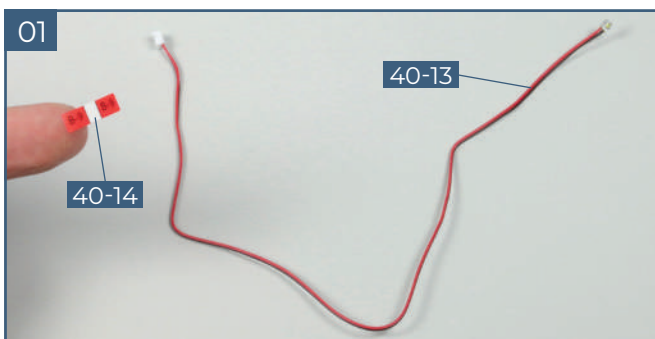

Place the searchlight cable **40-13** on your worktop. Peel the cable label **40-14** from the backing as shown.

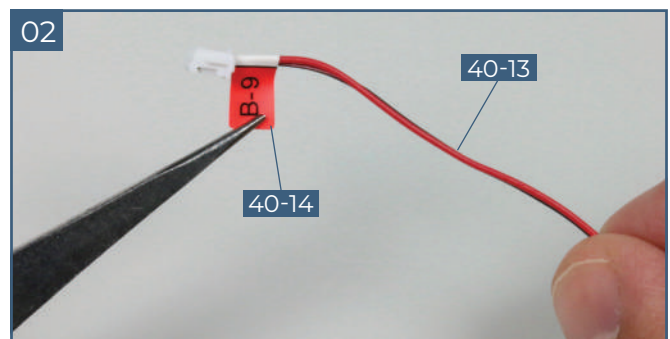

Wrap the label **40-14** around the cable **40-13** near the connector as shown.

## 02. ASSEMBLING THE FIRST SEARCHLIGHT

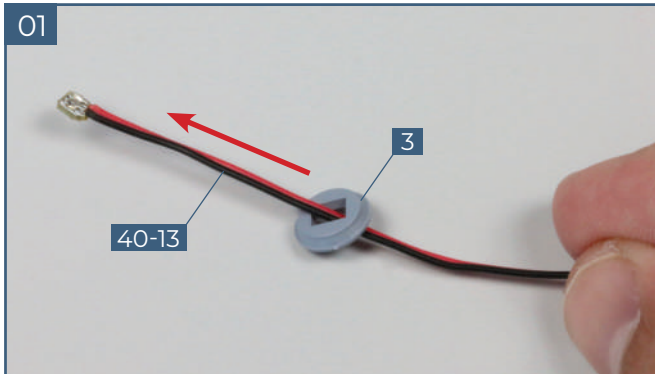

Carefully cut the base of the searchlight **3** from frame **40-07**. Pass the LED on the end of cable **40-13** through part **3**. Make sure that you have the base of **3** the right way round.

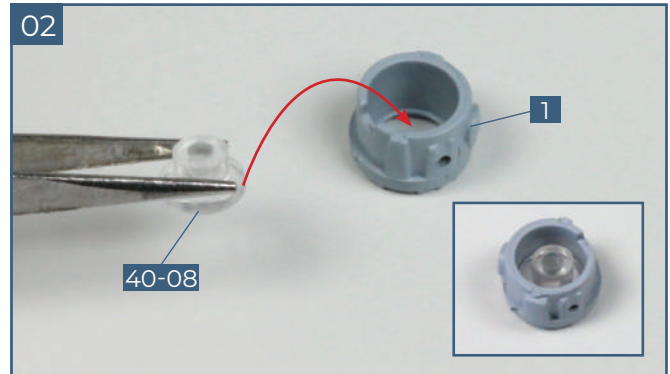

Cut the searchlight body **1** from frame **40-07**. Take the searchlight glass **40-08** and fit it into part **1**. The inset shows the two pieces assembled.

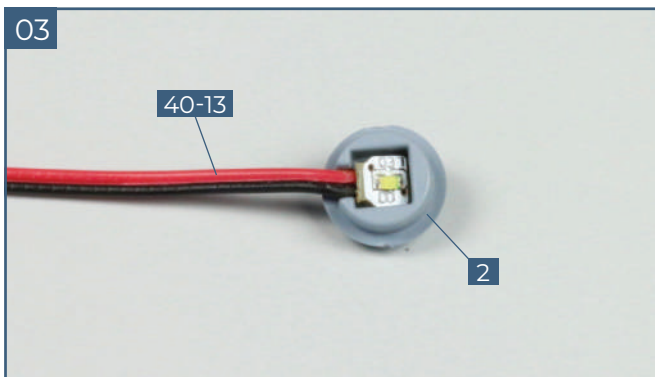

Cut the searchlight backplate **2** from the frame **40-07**. Insert the LED end of the searchlight cable **40-13** into the searchlight backplate **2**, so that the cable fits into the recess on the side. Ensure that the LED is facing outwards, as shown.

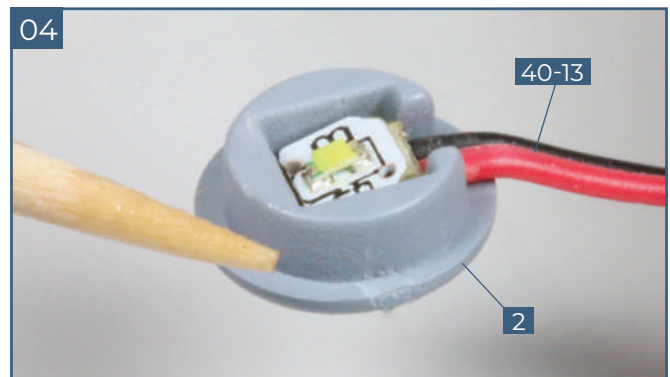

Apply a tiny amount of superglue around the outside of the searchlight backplate **2**.

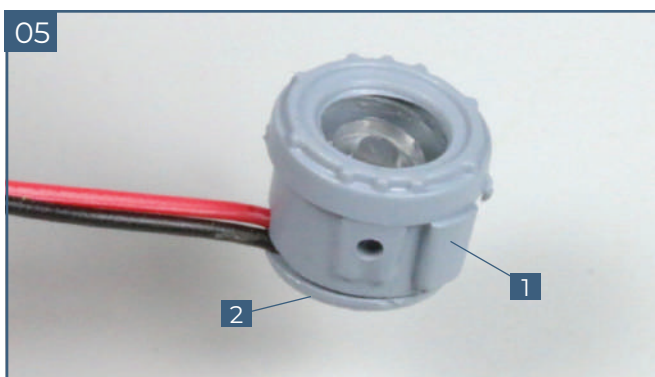

Stick the assembly from step 02 in place on the searchlight backplate **2**. Note that there is a notch in part **1** that fits over the wire.

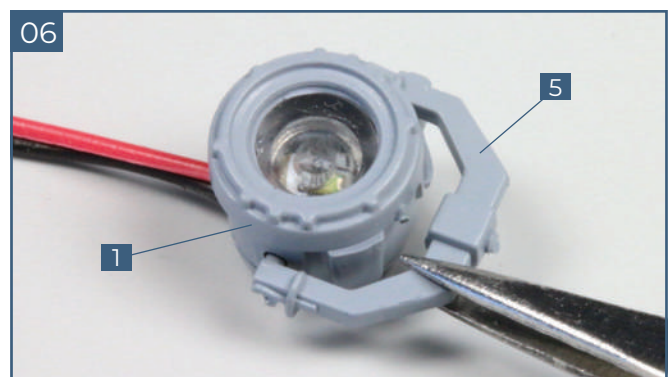

Cut the searchlight support **5** from the frame **40-07**. Fit the two pegs of part **5** in the holes on the opposite sides of the headlight body **1**, as shown.



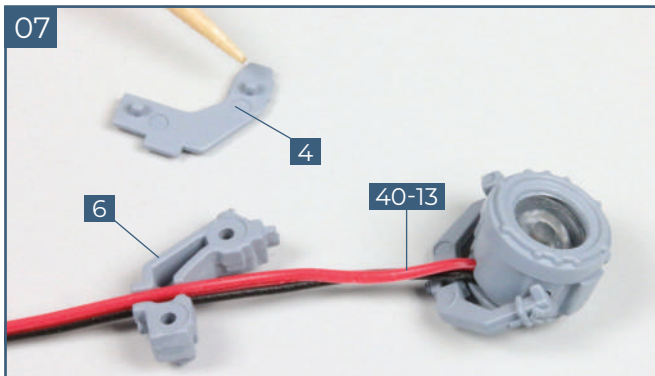

07 Cut the headlight arm **6** from the frame **40-07**. Fit the searchlight cable **40-13** into the recess in part **6**. Make sure you have part **6** the right way round, as shown. Cut the second part of the headlight arm **4** from the frame **40-07**.

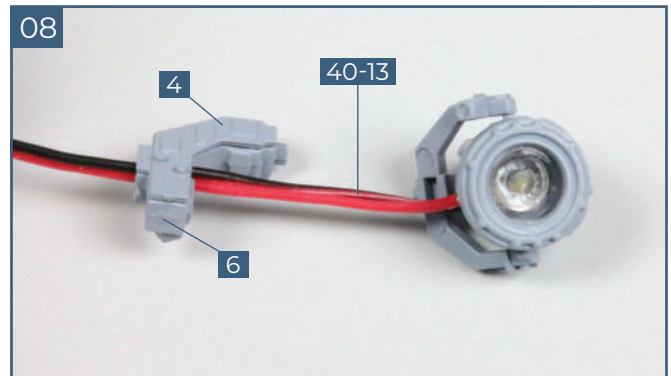

08 Apply a little superglue to the pegs on part **4** and stick them in place in the holes on part **6** so that the cable is enclosed. Take care not to get adhesive on the cable.

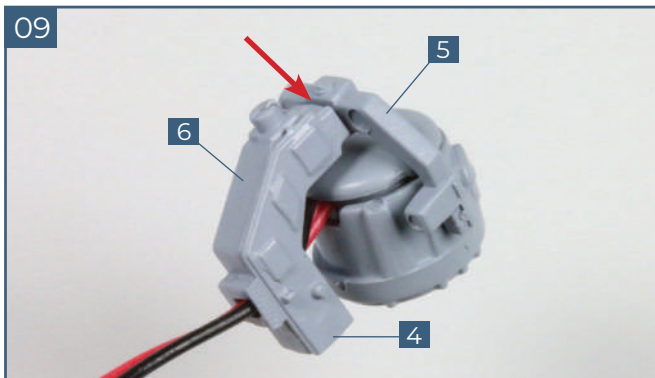

09 Apply a little superglue to the peg on the end of the arm assembly **4/6**. Fit the peg into the recess on the searchlight support **5** (indicated by the arrow).

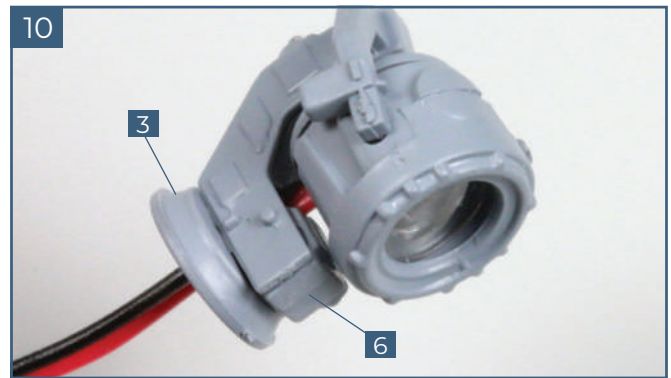

10 Check the fit of the searchlight base **3** against the underside of the headlight body **6**. Apply a little superglue to the edge of the square base of part **6** and stick part **3** in place.

### 03. ASSEMBLING THE SEARCHLIGHT PLATFORM

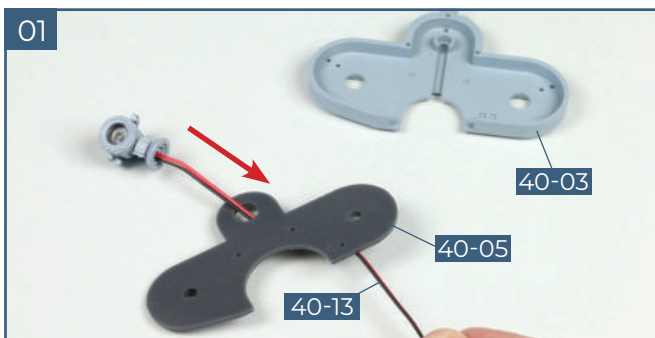

01 Take the searchlight platform **40-03** and decking **40-05**. Pass the light cable **40-13** through the opening in the flat, top side of the deck covering **40-05** in the direction as indicated by the arrow.

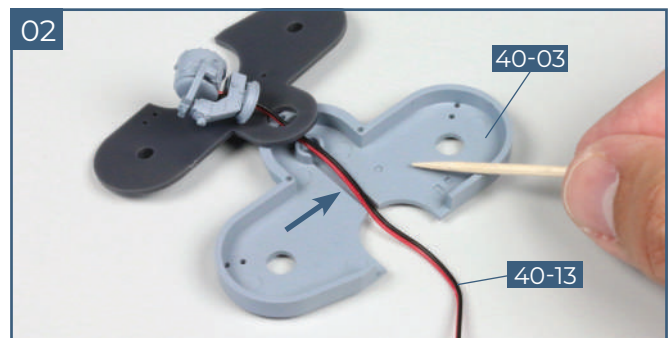

02 Run the cable **40-13** along the channel in the searchlight platform **40-03** (arrow). Apply a thin layer of superglue to the surface of the platform. Take care not to get any glue on the cable.

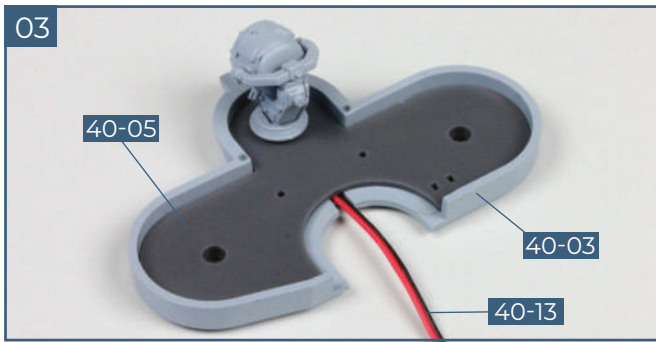

Stick the decking **40-05** in place on the searchlight platform **40-03**. Apply a little glue to the base of the searchlight and gently pull the cable **40-13** through the channel in the platform so that the searchlight sits on the deck covering, facing forward, as shown.

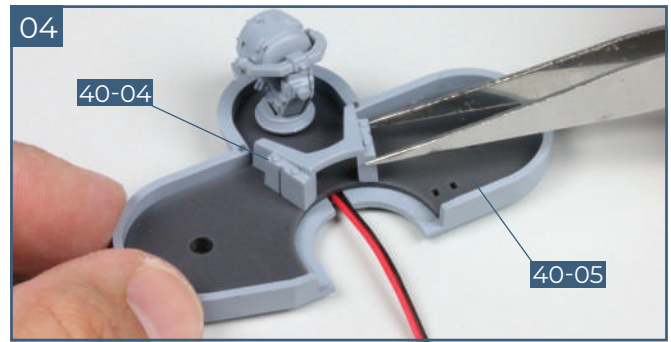

Hold the searchlight in place until the glue is firmly set. Apply a little superglue to the two pegs on the bottom of locker structure **40-04** and fix it in place with the pegs in the holes in the decking **40-05**.

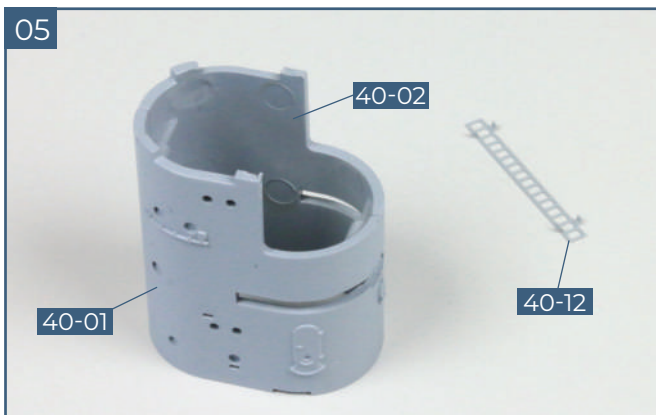

Take the two parts of the upper superstructure **40-01** and **40-02** and check the fit. Apply a little superglue to the pegs on part **40-02** and fix it on to part **40-01**. Take the ladder **40-12** and check the fit on the upper superstructure.

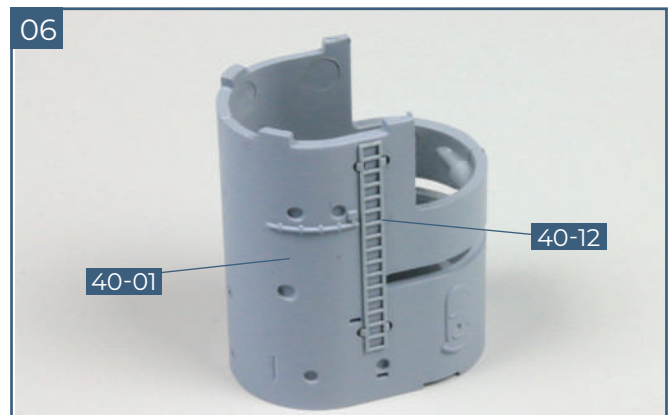

Apply tiny drops of superglue to the four pegs (two at each end) of ladder **40-12** and fix it in place with the pegs in the holes on part **40-01**, as shown.

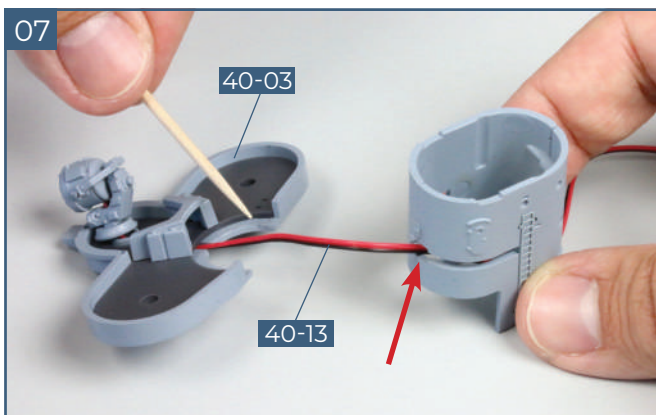

Pass the connector on the end of cable **40-13** through the opening in the upper superstructure assembly (arrow). Apply a very small amount of superglue to the semicircular edge of the searchlight platform **40-03**.



Fix the searchlight platform in place on the front of the upper superstructure.

## 04. DETAILS FOR THE FORETOP FIRE CONTROL POST

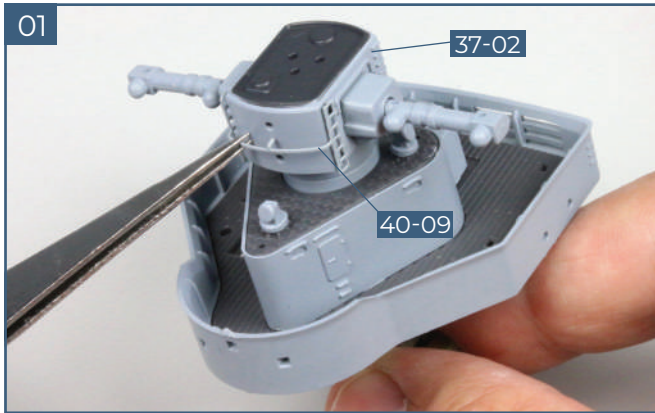

Take the radar assembly unit **37-02** (assembled in stage 38). After checking the fit, glue the ladder support **40-09** to the radar unit on the foretop fire control post.

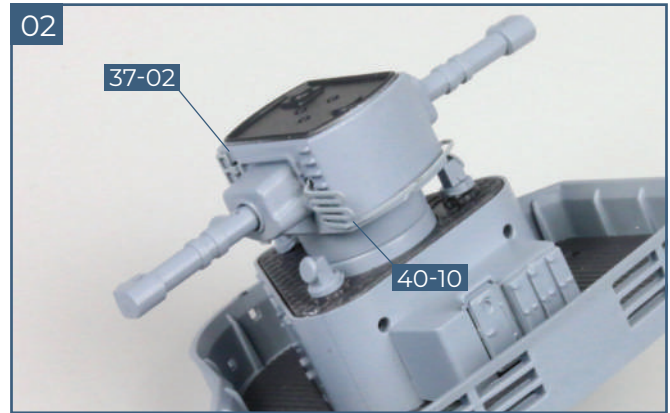

After checking the fit, glue the cooling coil **40-10** in place behind the port rangefinder arm, as shown.

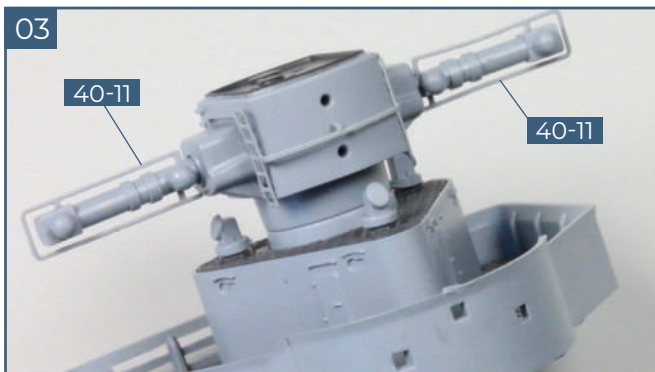

Cut the two sets of rails, **40-11** from their frame. Check how the pins on the rails fit into corresponding holes in the rangefinder arms. Use a little superglue to fix the rails in place.

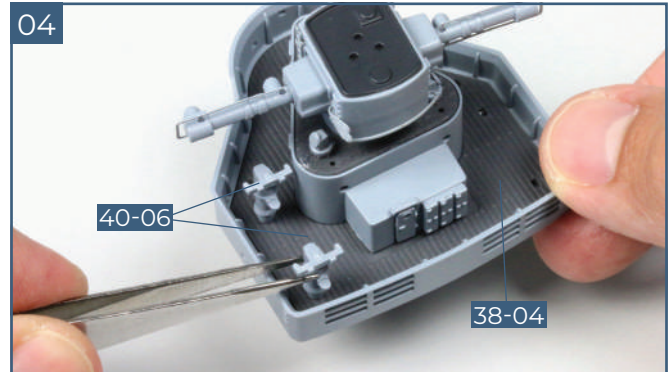

Remove two of the ZAG artillery guidance devices **40-06** from the frame, taking care not to cut off the locating pegs at their base. Check the fit on the port side of the decking **38-04**, making sure they are facing in the right direction. Glue in place.

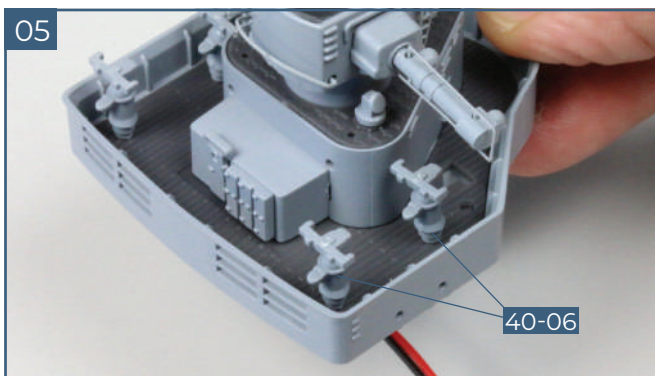

Repeat the previous step to fix two ZAG artillery guidance devices **40-06** on the starboard side of the foretop fire control post.

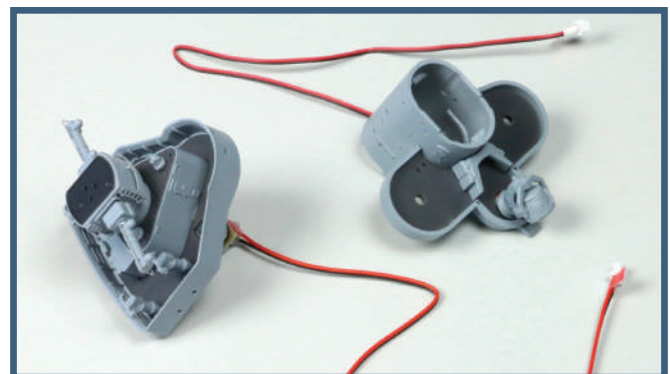

### Completed work

The searchlight has been assembled and fitted to the upper superstructure and the foretop fire control post has been fitted with extra details.

## STAGE 41 THE NEXT SECTION OF HULL



### COMPONENTS CHECKLIST

**41-01:** Starboard upper hull section

**41-02:** Connector

**PM:** Five 2 x 4 mm PM screws

## 01. FITTING THE HULL SECTION

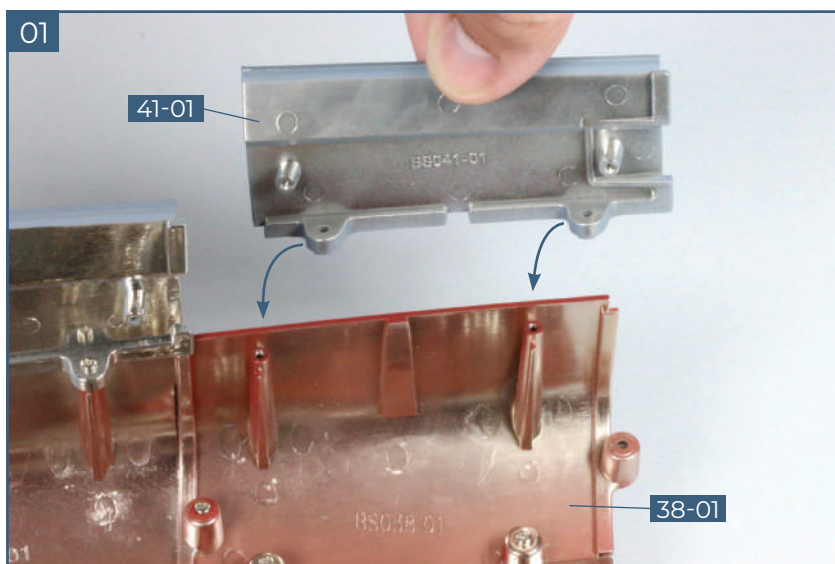

Put the hull structure on your worktop. Take the starboard upper hull section **41-01** and fit it against the starboard lower hull section **38-01** so that the screw holes are aligned, as shown.

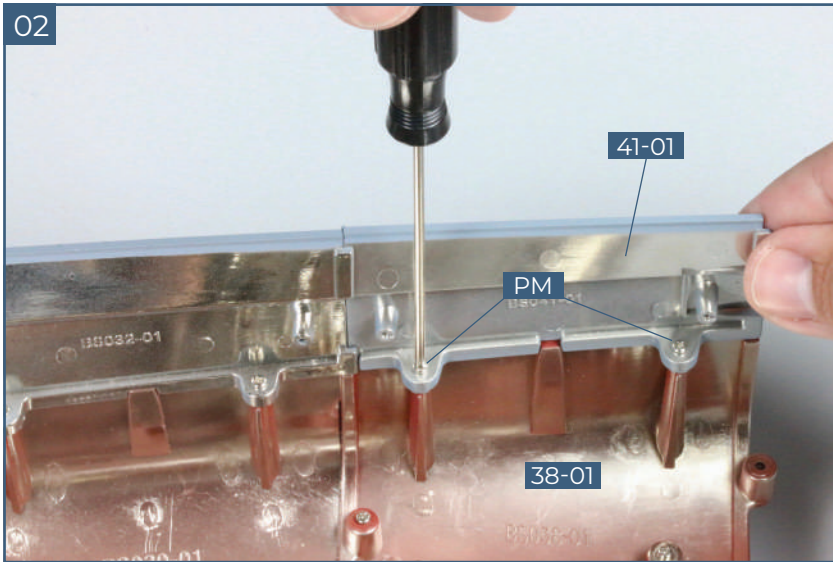

Use two **PM** screws to fix section **41-01** to section **38-01**, as shown.

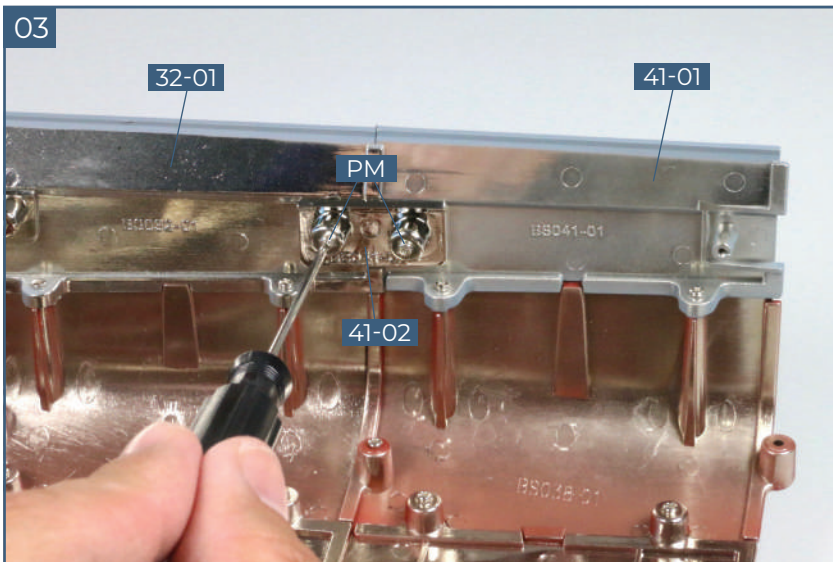

Fit the screw holes on the connector **41-02** over the screw sockets on parts **32-01** and **41-01**. Fix in place with two **PM** 2 x 4 mm screws.

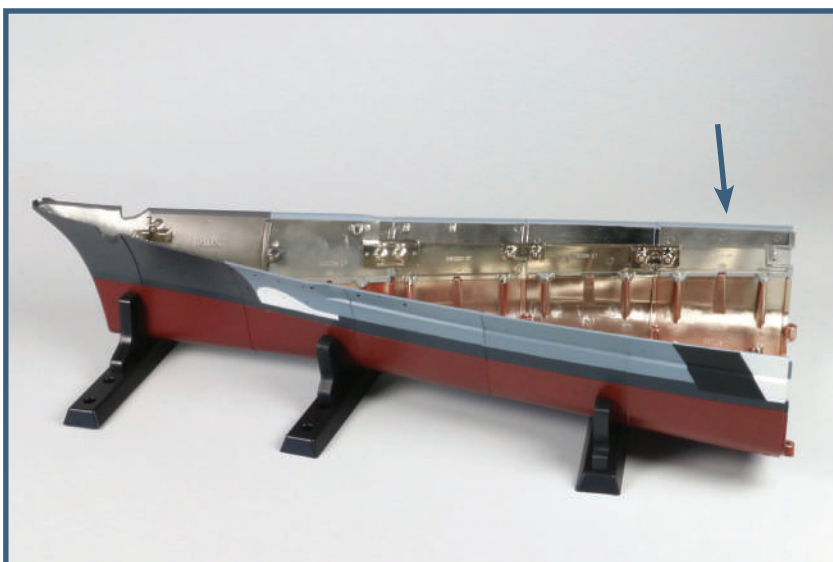

**Completed work**

Another section of the hull has now been fitted to your model.

## STAGE 42

# THE SIXTH KEEL SECTION

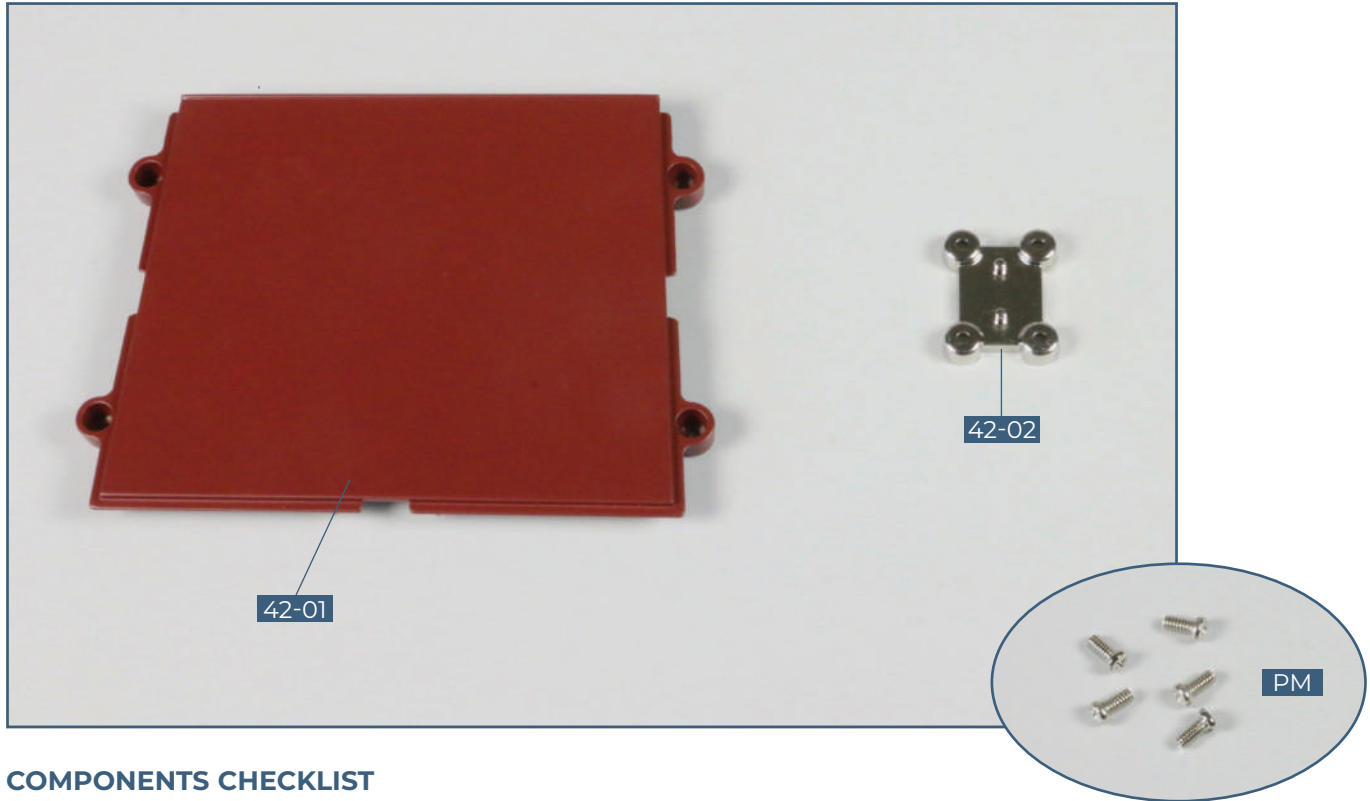

### COMPONENTS CHECKLIST

**42-01:** Sixth keel section

**PM:** Five 2 x 4 mm PM screws

**42-02:** Connector

## 01. FITTING THE KEEL SECTION

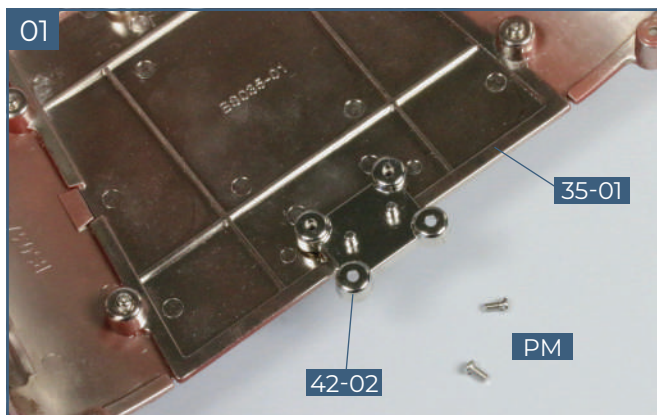

Put the hull structure on your worktop. Fit the sockets on the connector **42-02** over the two raised screw sockets on the keel section **35-01**. Have two **PM** screws ready.

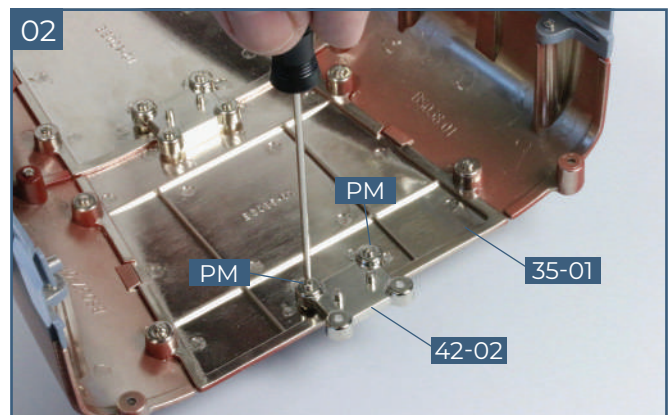

Use two **PM** screws to fix the connector **42-02** to section **35-01**, as shown.

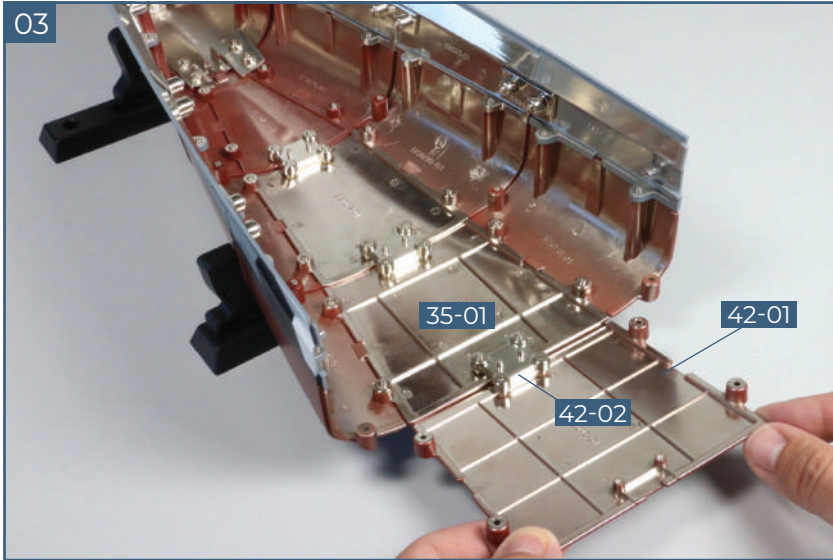

Bring the edge of the keel section **42-01** up beneath the connector **42-02** so that the raised screw sockets on part **42-01** fit into the sockets on part **42-02**.

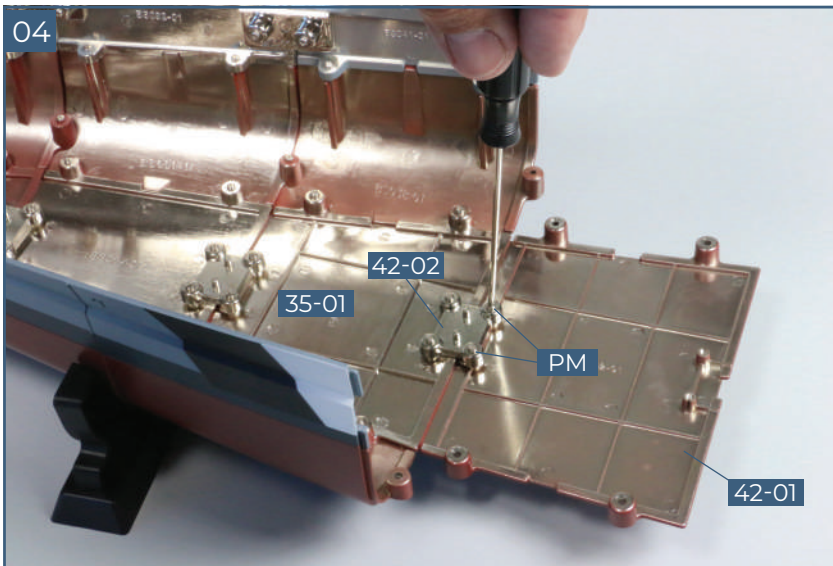

Use two **PM** screws to fix connector **42-02** to keel section section **42-01**, as shown.

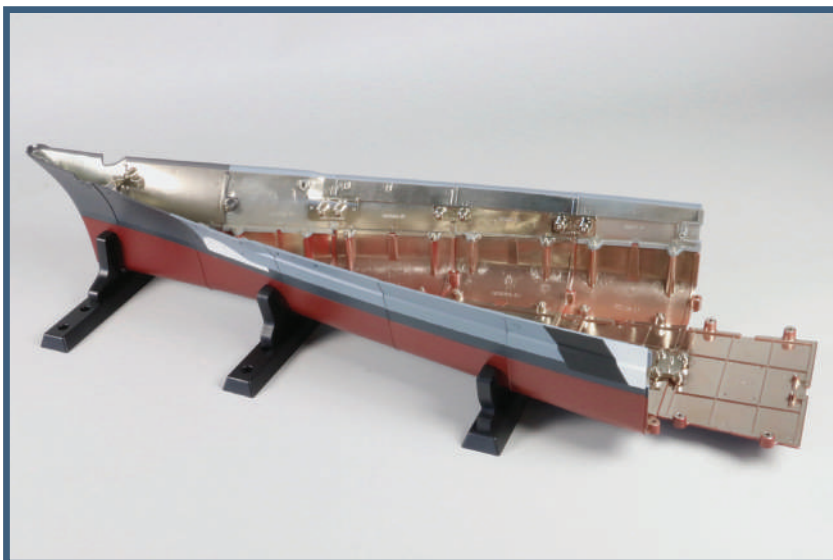

**Completed work**

Another keel section has now been added to the hull. Store the assembly carefully to avoid damage to the connection.

# STAGE 43

## ADMIRAL'S BRIDGE

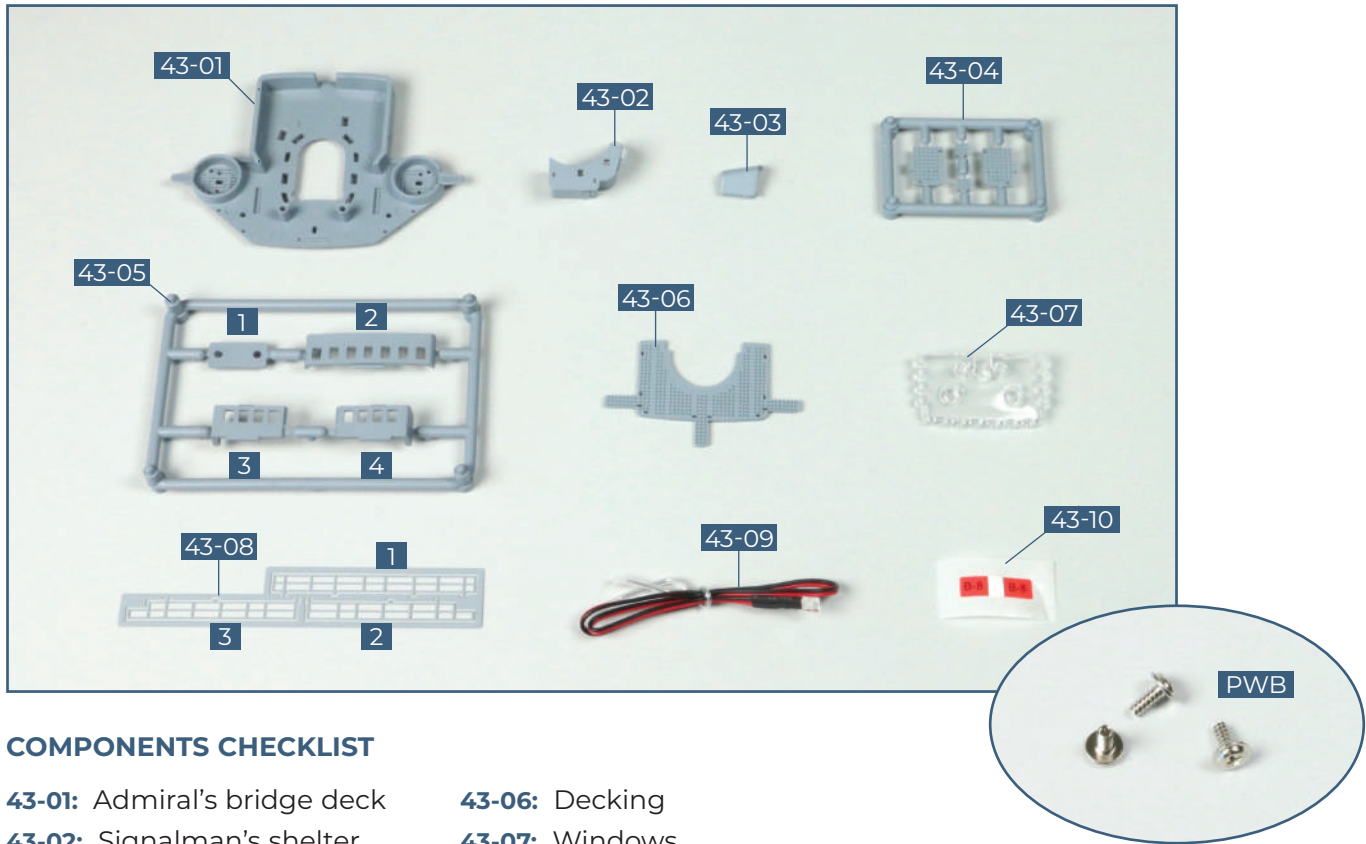

### COMPONENTS CHECKLIST

- |                                      |                           |
|--------------------------------------|---------------------------|
| <b>43-01:</b> Admiral's bridge deck  | <b>43-06:</b> Decking     |
| <b>43-02:</b> Signalman's shelter    | <b>43-07:</b> Windows     |
| <b>43-03:</b> Shelter                | <b>43-08:</b> Railings    |
| <b>43-04:</b> Gratings               | <b>43-09:</b> Light cable |
| <b>43-05:</b> Admiral's bridge walls | <b>43-10:</b> Cable label |

**PWB:** Three 1.7 x 4 mm PWB screws

## 01. ASSEMBLING AND FITTING THE GRATINGS

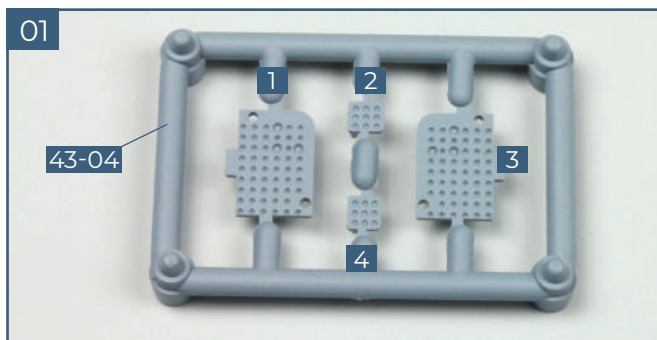

Cut the gratings **1** and **2** from the frame **43-04**.  
Remove any rough edges.

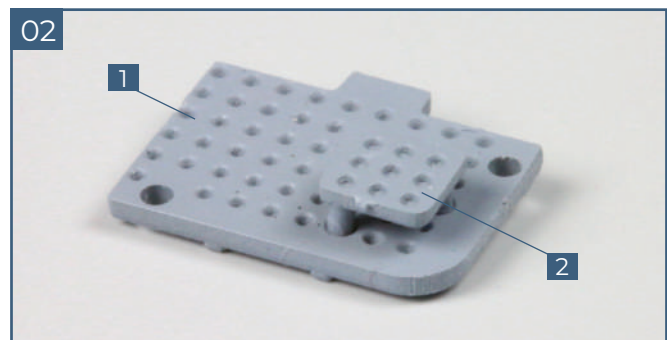

Check the fit of the three pegs on the underside of part **2** in the recesses in part **1**, as shown. Apply a tiny drop of superglue to the pegs and fix in place.



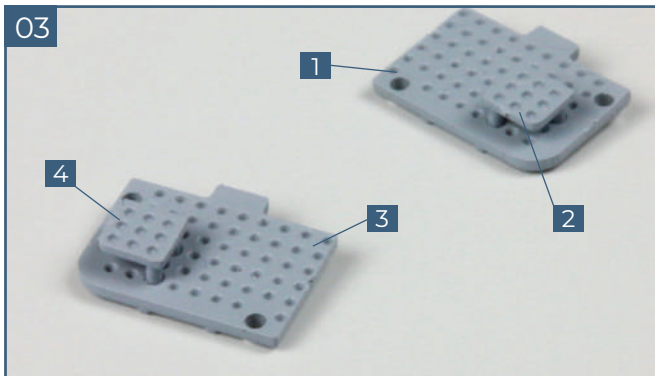

Repeat the previous two steps to cut parts **3** and **4** from the frame and fix together. Note the orientation of the parts.

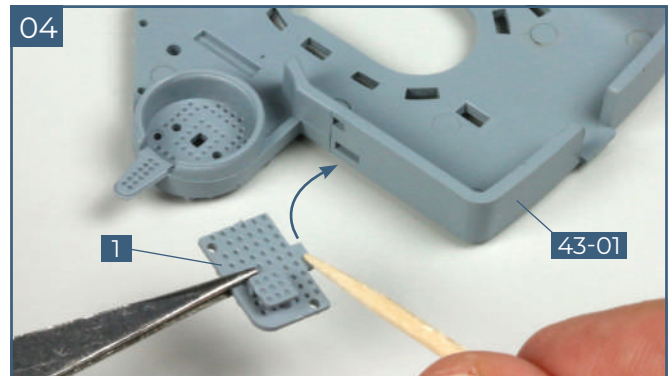

Take the admiral's bridge deck **43-01** and identify the fixing point for the grating assembly **1** and **2** on the port side. Apply a tiny drop of superglue to the tab on part **1** and fix in place as indicated by the arrow.



Identify the fixing point for the grating assembly **3** and **4** on the starboard side of the admiral's bridge deck.

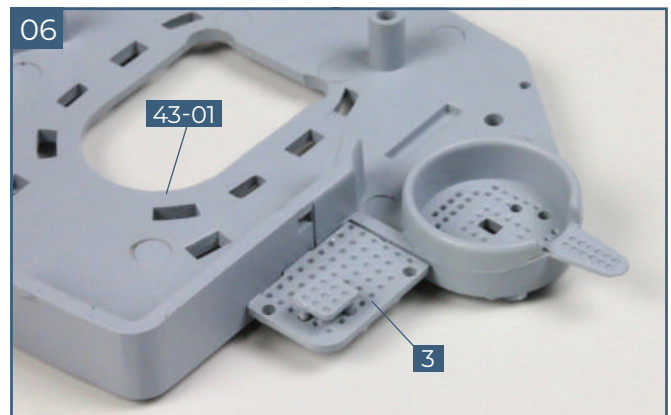

Apply a little superglue to the tab on part **3** and fix in place as shown.

## 02. ATTACHING THE CABLE LABEL

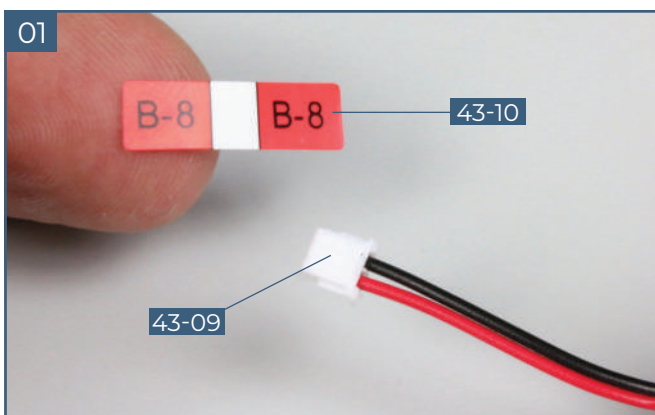

Take the connector end of the cable **43-09**. Remove the backing from the cable label **43-10**.

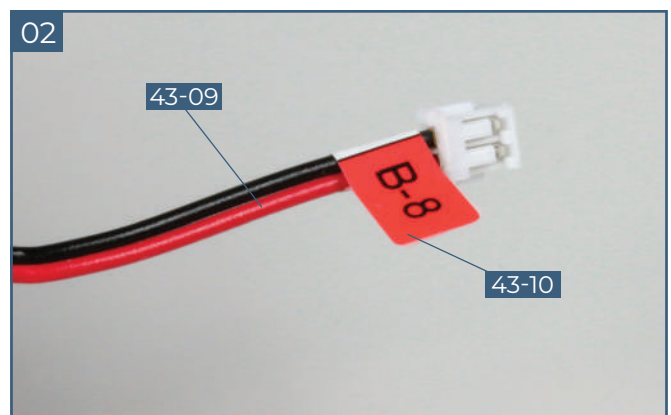

Wrap the cable label **43-10** around the cable **43-09** as shown.

## 03. LIGHTING FOR THE ADMIRAL'S BRIDGE

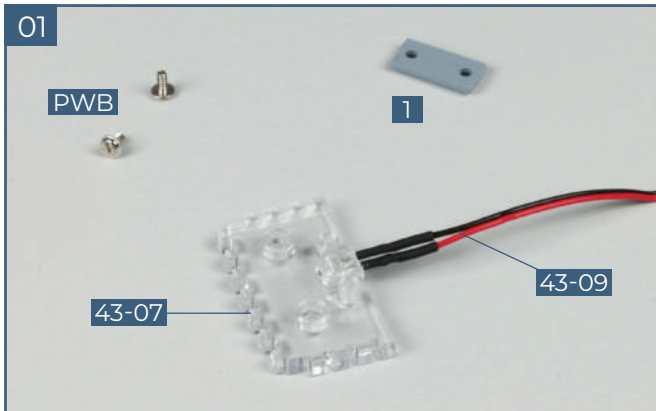

Take the windows of the admiral's bridge **43-07** and fit the LED on the end of cable **43-09** into the recess. Cut part **1** from frame **43-05**. Have two **PWB** screws ready.

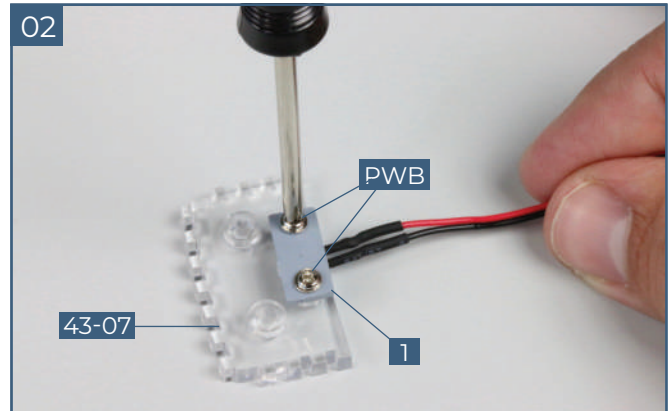

Fit part **1** over the recess in part **43-07** to hold the LED in place. Fix in place with two **PWB** screws.

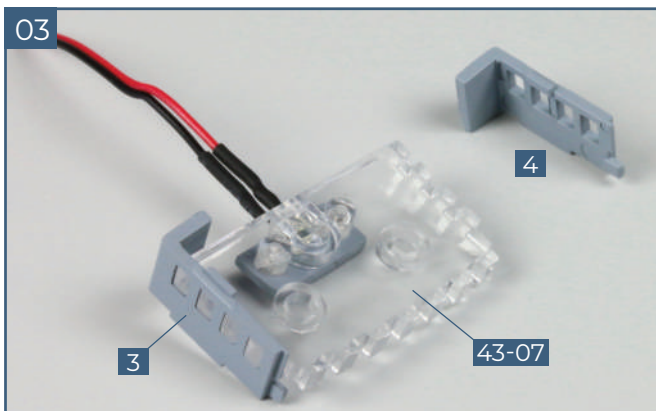

Turn the windows **43-07** over so that part **1** is facing downwards. Cut walls **3** and **4** of the admiral's bridge from frame **43-05** and check the fit, as shown.

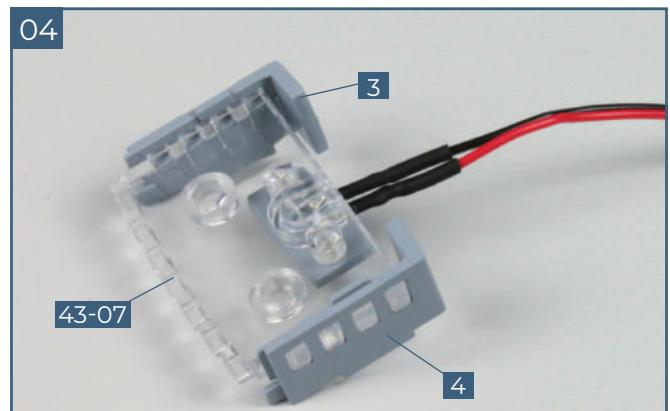

Walls **3** and **4** have corners that fit around the sides of the windows **43-07**.

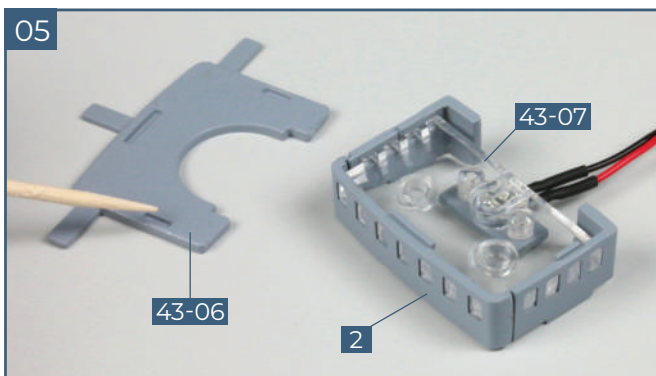

Cut the remaining wall **2** from the frame **43-05** and push-fit it across the windows **43-07** and onto the walls **3** and **4**. Take the deck **43-06** and check the fit on top of the bridge walls.

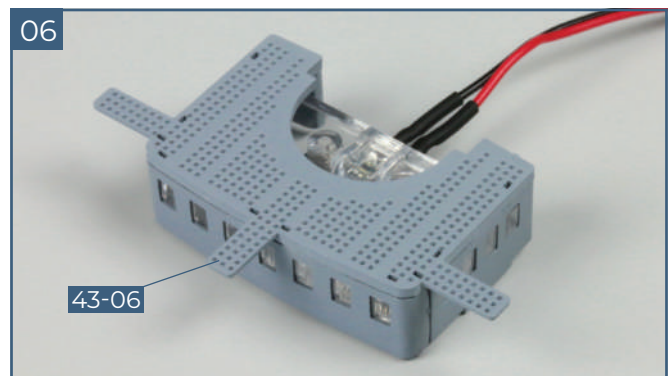

Fix part **43-06** on top of the walls of the admiral's bridge, holding them in place.

## 04: ASSEMBLING THE ADMIRAL'S BRIDGE

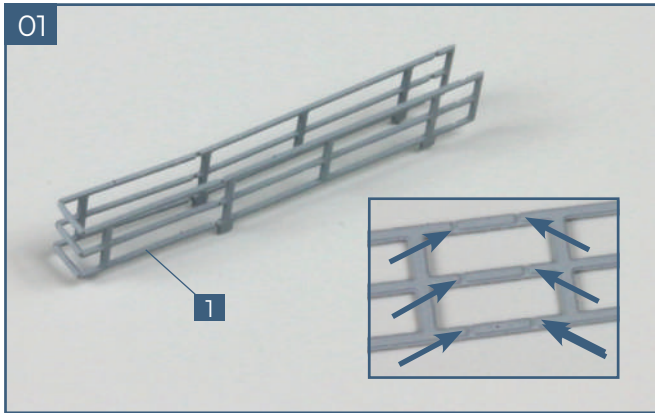

Cut the railing **1** from frame **43-08**. Identify the indents on either side of the centre point of the railings (see detail image). Make two right angle bends at these points.

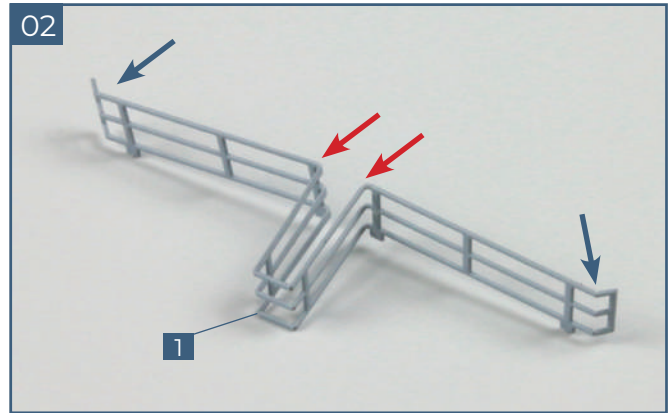

Identify the next two bend points (red arrows) and bend the railings outwards at right angles. Check the fit of the railings on the deck (see step 3) and make the final bends to part **1** at each end.

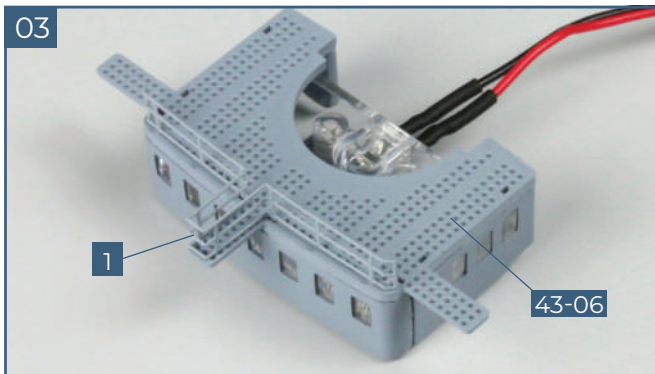

The railings fit along the front of the decking **43-06**. Apply a little superglue to the bottom of the posts of the railings **1** and fix in place.

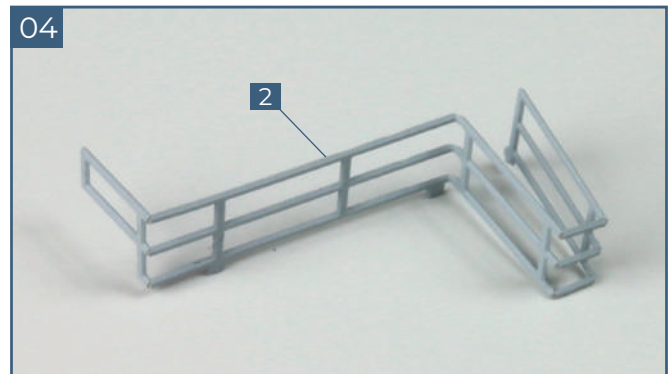

Cut part **2** from frame **43-08** and bend it at the indents, as shown, so that it fits along the starboard side of the decking.

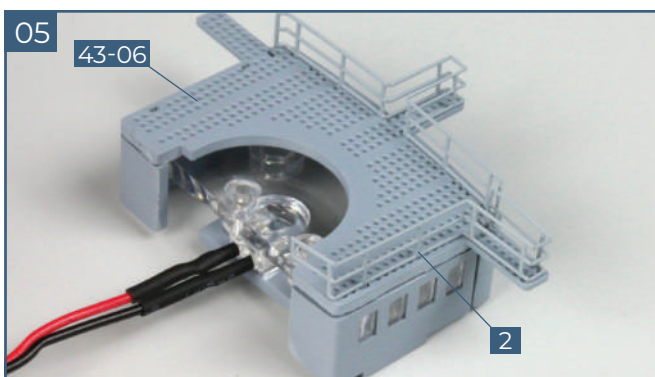

Use a tiny bit of superglue, applied to the bottom of the posts, to fix the section of railing **2** in place on the decking **43-06**.

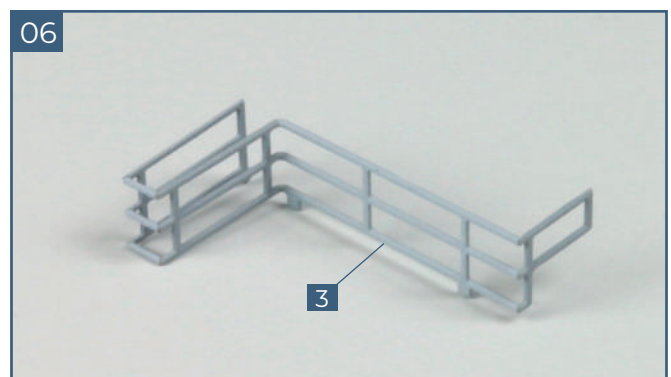

Take the last section of railing **3** from frame **43-08** and bend it as shown, at the indents, to fit along the port side of the decking.

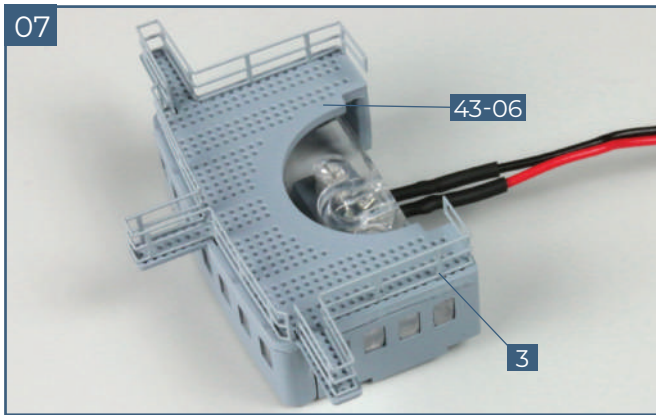

Glue the last section of railing **3** in place along the port side of the decking **43-06**.

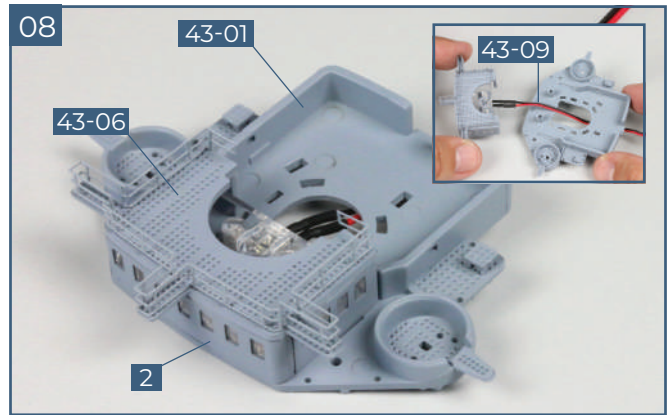

Feed the connector cable **43-09** through **43-01** (inset). Apply a little superglue to the tabs on the base of **43-06** and fix into the recesses in deck **43-01** so that wall **2** aligns with the front of the deck **43-01**.

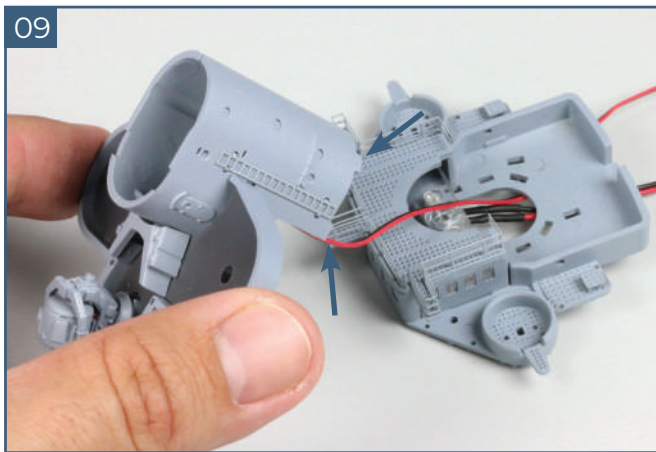

Take the searchlight assembly from Stage 40 and feed the cable through the hole in the admiral's bridge deck **43-01**. Identify the tabs on the base of the superstructure assembly (arrows), which fit into slots in the deck. Apply a little superglue to the tabs and fix in place.

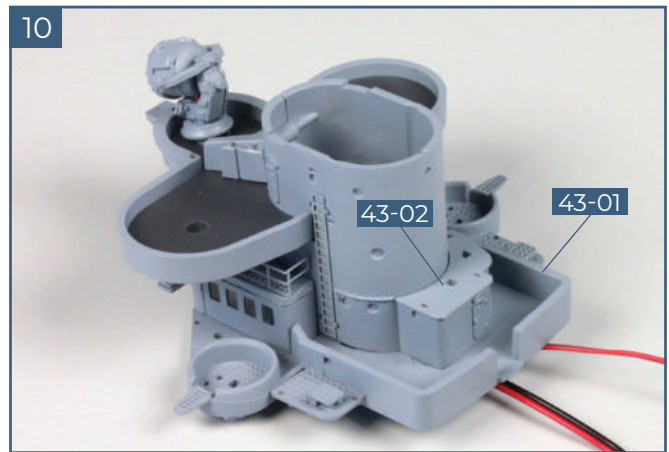

Tabs on the base of the signalman's shelter **43-02** fit into slots at the aft of the admiral's bridge deck **43-01**. Apply a little superglue to the tabs and fix in place.

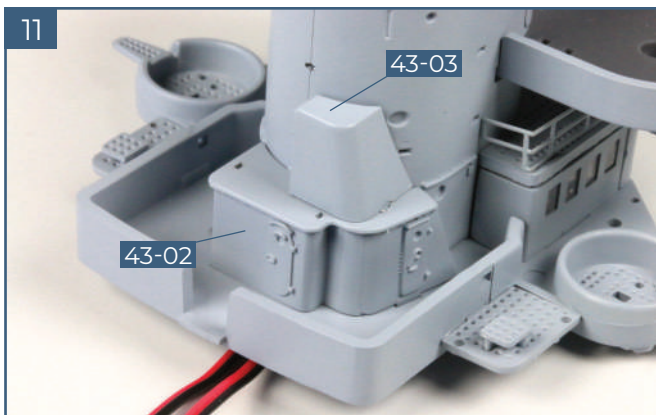

Glue the shelter **43-03** in place on top of the shelter **43-02** as shown.

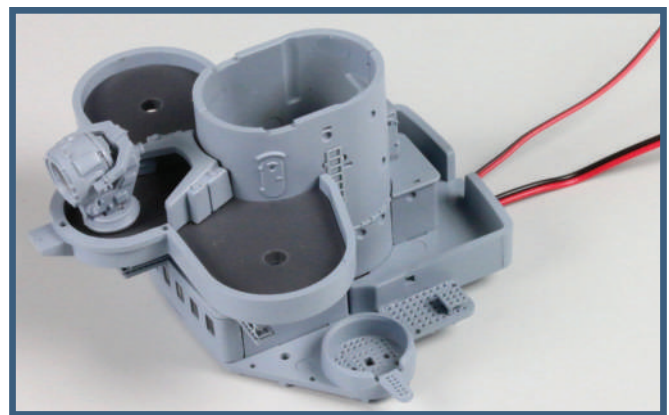

**Completed work**

The admiral's bridge, with lighting, is now assembled.

# STAGE 44

## THE UPPER MAST DECK

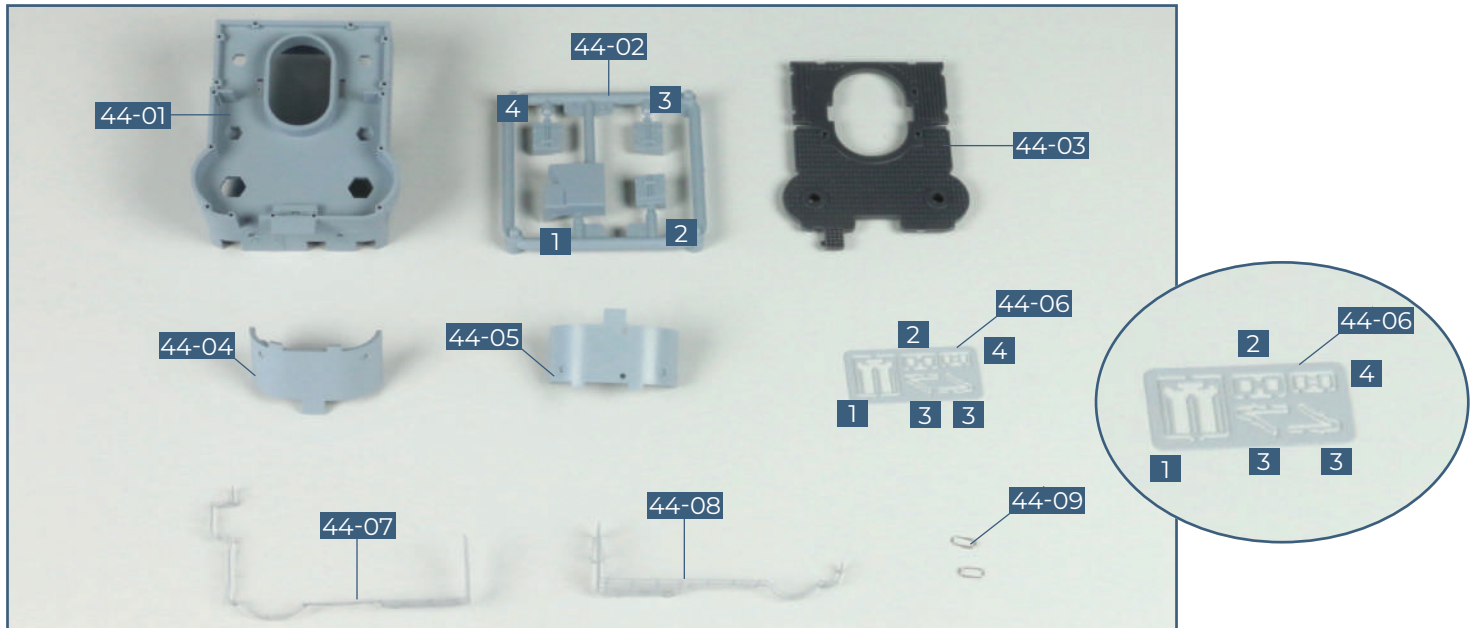

### COMPONENTS CHECKLIST

- |   |  |                                 |
|---|--|---------------------------------|
| <b>44-01:</b> Upper mast deck                     | <b>44-04:</b> Lower section of the conning tower (port)      | <b>44-06:</b> Ammunition hoist  |
| <b>44-02:</b> Accessories for the upper mast deck | <b>44-05:</b> Lower section of the conning tower (starboard) | <b>44-07:</b> Port railing      |
| <b>44-03:</b> Decking                             |  | <b>44-08:</b> Starboard railing |
|   |  | <b>44-09:</b> Two anchor rings  |

## 01. UPPER MAST DECK, CONNING TOWER AND AMMUNITION HOIST

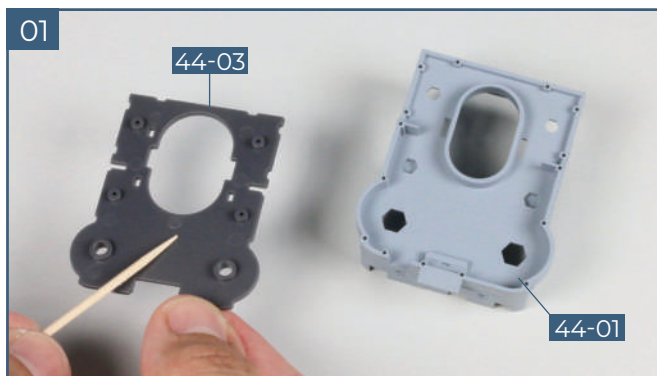

Place the upper mast deck **44-01** on your work surface. Take the decking **44-03** and apply a little superglue to the main contact points on the underside.

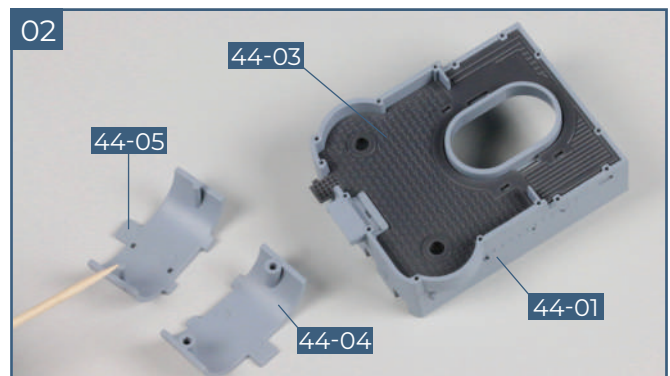

Glue the decking **44-03** in place on the surface of the upper mast deck **44-01**. Take the two sections of the conning tower, **44-04** and **44-05**, check the fit and apply a little superglue to the pegs at the fixing points on part **44-05**.

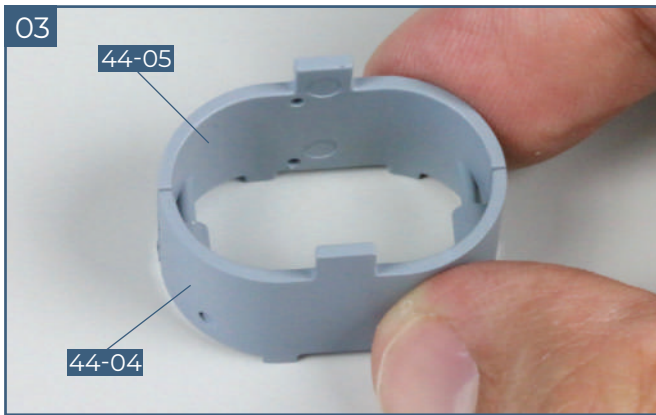

Glue the two sections of the conning tower together so that the pegs on part **44-05** fit into the sockets on part **44-04**, as shown.

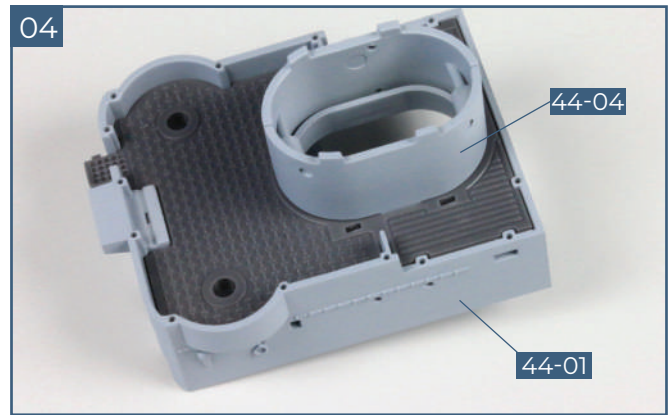

Check the fit of assembly **44-04/44-05** in the opening of the upper mast deck **44-01**, noting the orientation, shown here. Apply a little superglue to the tabs on the lower edge of parts **44-04/44-05** and glue in place.

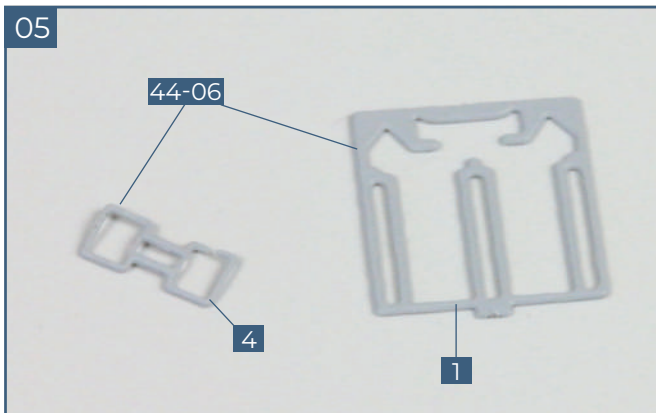

Take frame **44-06**, which will form the ammunition hoist for the 2-cm magazines. Cut parts **1** and **4** from the frame, taking care they do not fly off. Note that parts **2** and **4** are similar, but part **4** is smaller than part **2**.

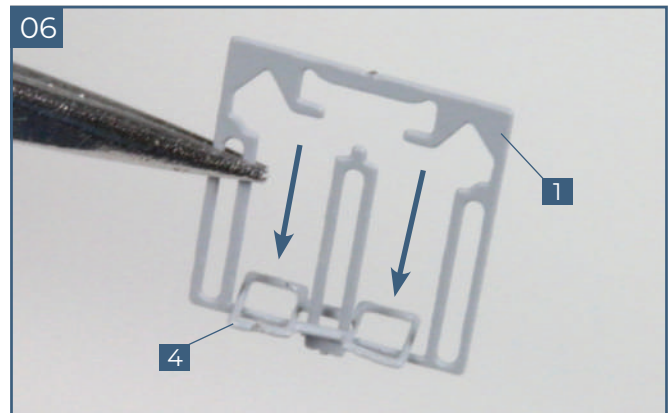

Slot the central upright 'spine' of part **1** through the central opening in part **4** and slide part **4** down as far as it will go. Note that part **4** is slightly tilted, as shown. Fix in place with a tiny drop of superglue.

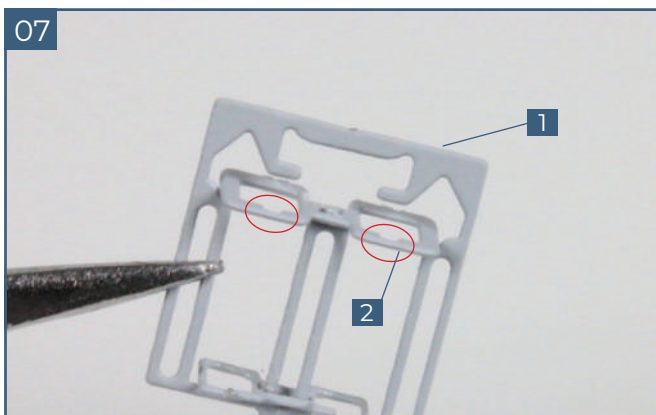

Cut part **2** from the frame and fit it across the top of the central spine of part **1**, positioning the notches (circled) as shown. Again, part **2** is slightly tilted, at the same angle as part **4**, as shown. Fix in place with a tiny drop of superglue.

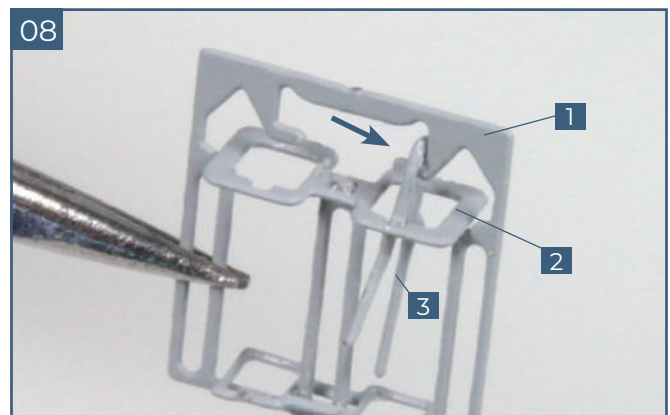

Take the first part **3** and fit the end with a loop through the opening in part **2**. Then fit the loop onto the horizontal peg of part **1**. Apply a drop of glue to hold the loop in place (arrow).

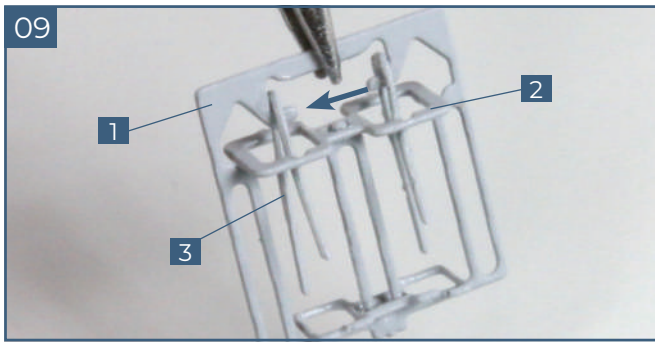

Fit the second part **3** in place through the opening in part **2**, and glue the loop in place on the horizontal peg of part **1** with a little superglue.

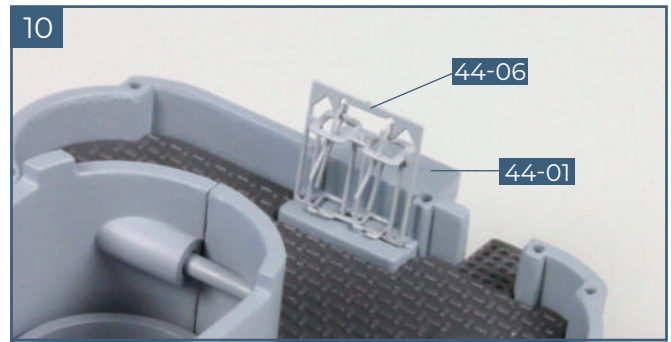

Glue the assembled ammunition hoist **44-06** in place at the front of the upper mast deck **44-01** as shown.

## 02. DETAILS FOR THE UPPER MAST DECK

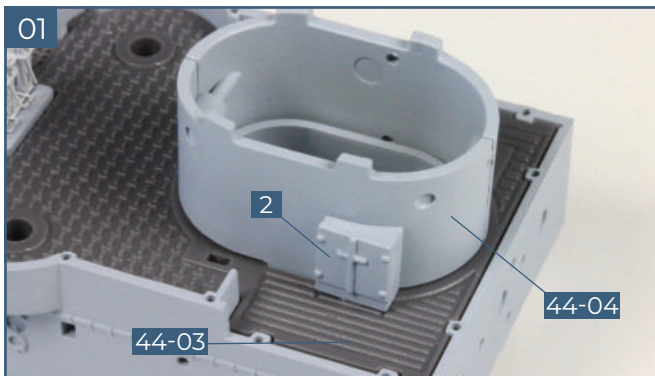

Cut the locker, **2**, from the frame **44-02** and check the fit on the port side of the conning tower **44-04**. A tab at the base of the locker fits into a slot in the decking **44-03**. Apply a little superglue to the peg and fix in place as shown.

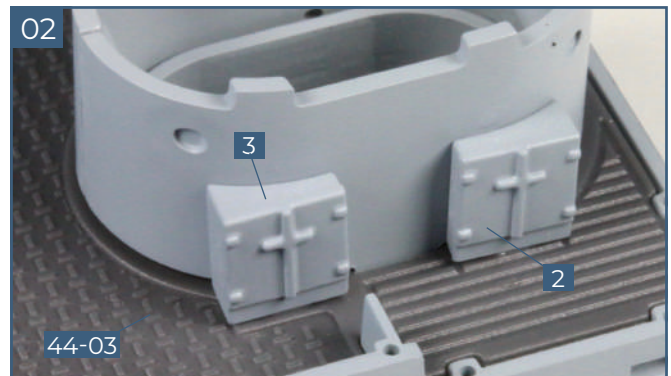

Check the fit of the next locker, **3**, on the port side of the conning tower **44-04** as shown. Glue in place in the same way as described for locker **2**.

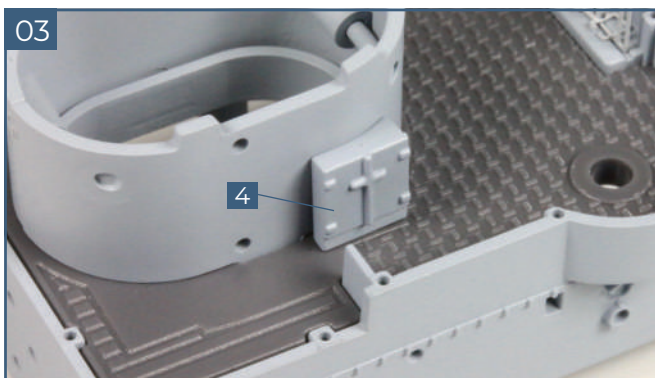

Turn the assembly round and glue locker **4** in place on the starboard side of the conning tower **44-05**, in the same way as described for locker **2**.

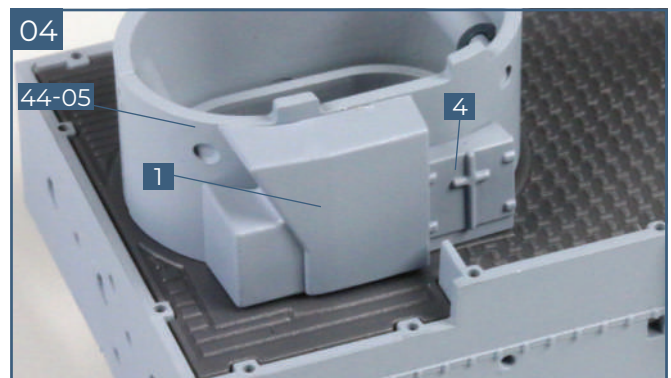

Cut part **1** from frame **44-02** and check the fit on the starboard side of the conning tower. Two pegs on part **1** fit into corresponding holes in part **44-05**. Apply a little superglue to the pegs and fix in place.

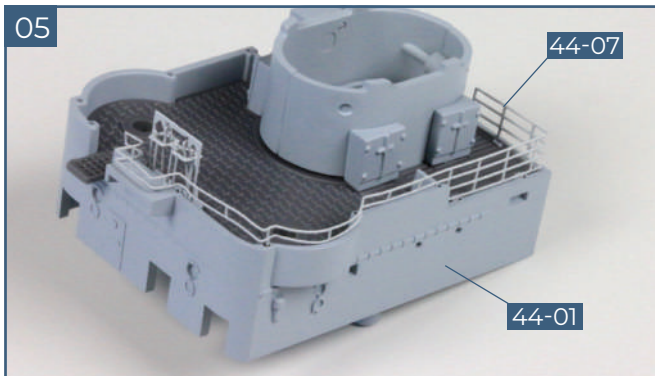

Turn the assembly around again and take the port railing, **44-07**. Check the fit around the front port side of the upper mast deck **44-01** and use a few drops of superglue on the pegs at the bottom to fix it in place.

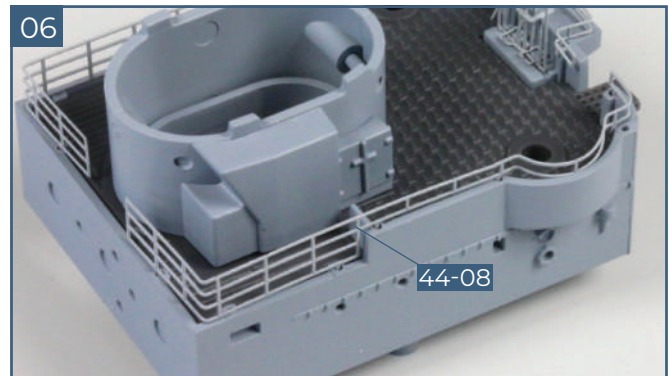

Turn the assembly round and glue the starboard railing **44-08** in place around the starboard side of the upper mast deck **44-01**.

### 03. NEW ANCHOR RINGS

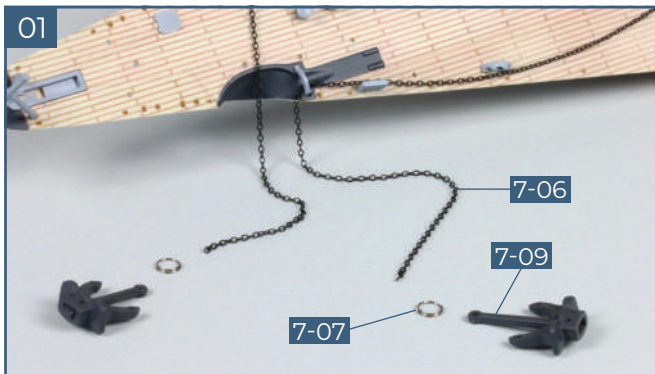

Loosen the anchor rings **7-07** from both anchor chains **7-06** and anchor shafts **7-09** as shown.

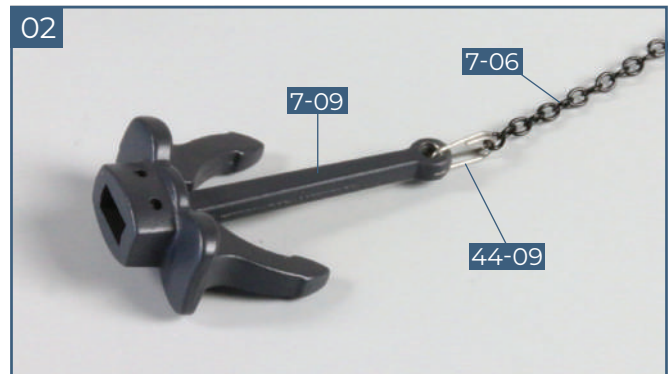

Take one of the two new anchor rings **44-09** and use it to connect an anchor chain **7-06** to an anchor shaft **7-09**.

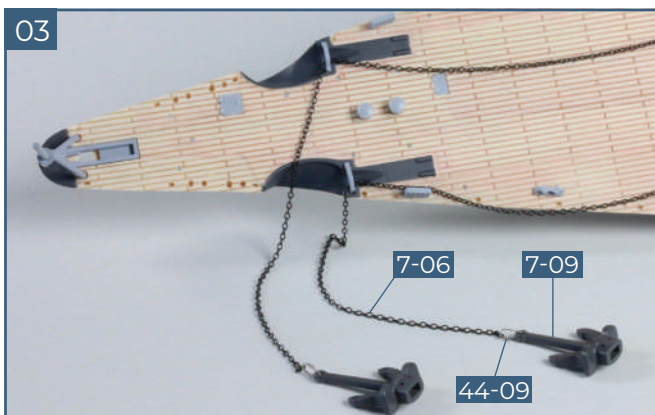

In the same way, use the second anchor ring **44-09** to connect the second anchor chain **7-06** to an anchor shaft **7-09**.

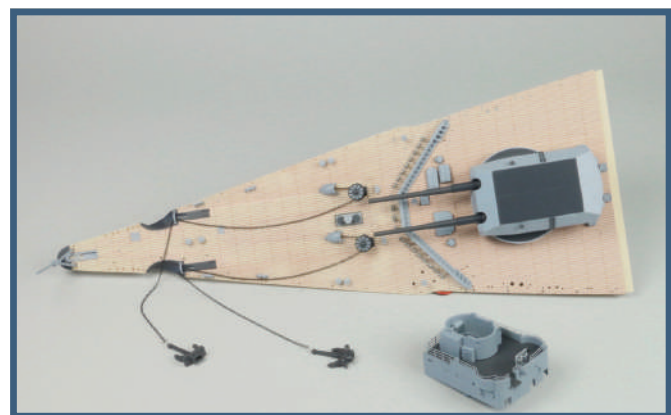

#### Completed work

We have replaced the anchor rings and started the assembly of the upper mast deck.