



Lamborghini MIURA



Pack 08

BUILD INSTRUCTIONS

STAGE 59: ASSEMBLING AND FITTING THE HORNS

STAGE 60: ATTACHING THE REINFORCEMENT CROSSBAR

STAGE 61: ASSEMBLING AND FITTING THE FRONT LEFT LOWER WISHBONE ARM

STAGE 62: ASSEMBLING AND FITTING THE FRONT RIGHT LOWER WISHBONE ARM

STAGE 63: FITTING THE FRONT LEFT UPPER WISHBONE ARM AND TORSION BAR

STAGE 64: FITTING THE FRONT RIGHT UPPER WISHBONE ARM AND TORSION BAR

STAGE 65: ASSEMBLING THE WHEEL HUBS AND THE FRONT LEFT BRAKE DISC

STAGE 66: FITTING THE FRONT WHEEL HUBS

The "Automobili Lamborghini" and "Automobili Lamborghini Bull and Shield" trademarks, copyrights, designs and models are used under license from Automobili Lamborghini S.p.A, Italy.

Advice from the experts

Spare screws are included with each part. Occasionally, you may be instructed to keep spare or unused screws for a later stage. Keep these spares in a safe place and label them correctly.

Please make sure you don't mix up the screws. They look quite similar, but the threads do vary slightly. Using the wrong screws may damage the parts.

When securing parts together using multiple screws, fit each screw loosely to ensure all the parts are correctly aligned before gently tightening them firmly, but not overtight, in the order in which you placed them.

The screwdriver can be magnetized by stroking it with a magnet (fridge magnet, etc.) enabling it to hold the screws and make assembly easier.

If a screw is tight going into a metal part, do not force it as you may shear the head off. Remove it and put a tiny smear of Vaseline, soap or light oil on the thread. That will lubricate it and make it easier to drive home.

During the course of this build, you will receive many pieces that you will assemble immediately – following the instructions in the corresponding stage – and other pieces that you should store safely to one side, for use in future assembly stages.

Left and Right! When building your Lamborghini, the left or right hand side refers to each side as you are sitting in the car.



WARNING: Some parts are assembled using magnets. These magnets can cause serious injury if they are swallowed. Keep away from children. If you suspect a magnet has been swallowed, seek medical help straight away.

Stage 59: Assembling and Fitting the Horns

In this stage you'll build the horns for the Lamborghini Miura and fit them into the front frame. The parts supplied with this stage will be used later and can be stored away for now.



STAGE 59 PARTS LIST

Name
Reinforcement crossbar
Windscreen washer reservoir
Horn actuator body
Horn actuator body
Type A screws x3



Stage 59: Assembling and Fitting the Horns

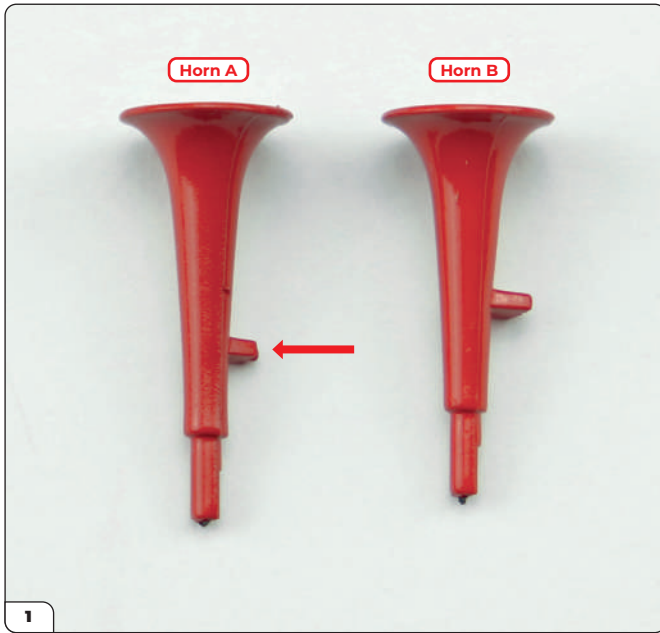

Retrieve the two horns supplied with Stage 58. When placing them on the work surface as shown, you can see they are different: horn (A) has its fitment further towards the end (arrow) and is slightly longer than horn (B).



First take horn (A) and one of the horn rear caps (also supplied with Stage 58). The narrow end of the cap has a hole that fits over the rear pin of the horn. Push it fully over the pin and into place as shown in the bottom image.

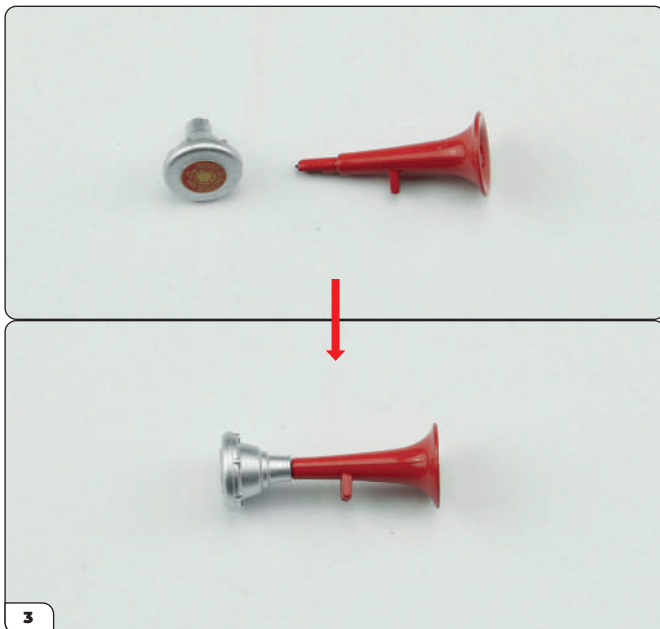

Take the remaining horn rear cap from Stage 58 and push it onto the end of horn (B) in the same manner.

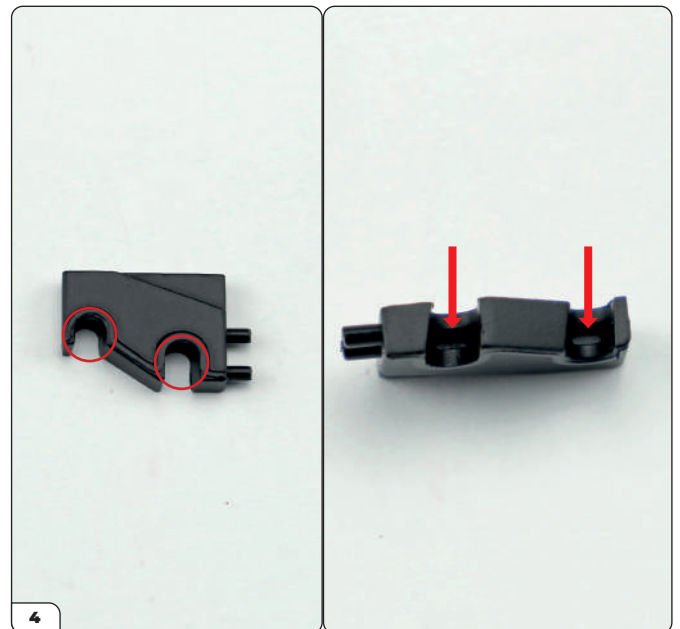

Next take the horn support (Stage 58) which has two recesses designed to accommodate the horns (circled). Inside the recesses are two rectangular holes (arrows) into which the fixing pins of the horns will be fitted.

Stage 59: Assembling and Fitting the Horns



Start by pressing the fixing pin of horn (A) into the recess furthest away from the pins (arrow) in the orientation shown. Apply an equal amount of pressure on the horn from either side of the recess to push it fully into place.



Press horn (B) into the other recess in the same orientation. If necessary, you can secure the horns in place using a small drop of super glue on the fixing pins.

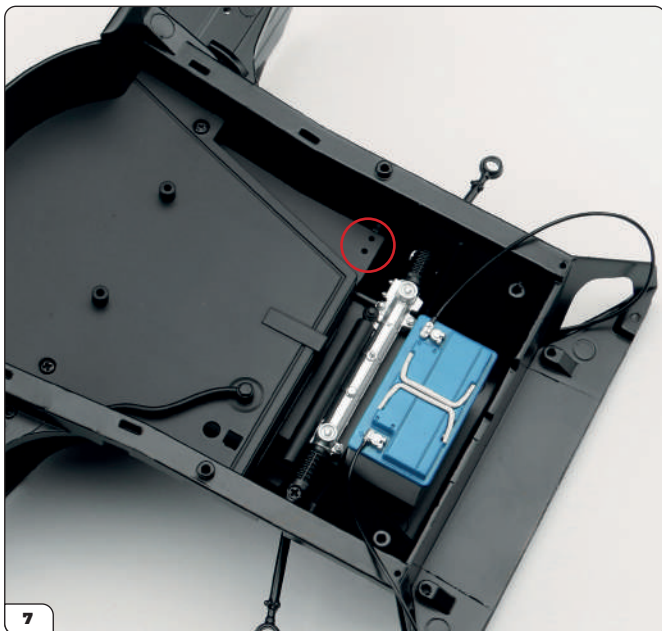

Retrieve the front frame assembly from Stage 58 and lay it on the work surface as shown. There are two holes located on the right side of the frame close to the steering rack (circled).

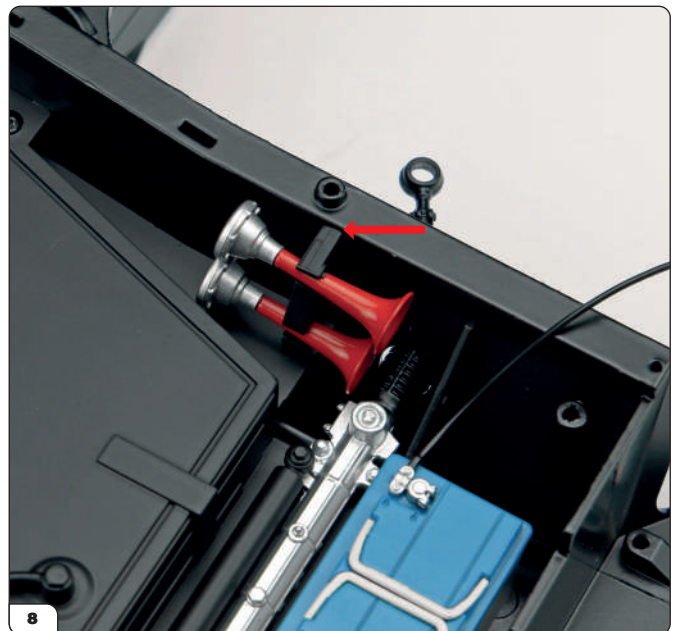

Press the pins of the horn support into the holes indicated in the previous step. The horns should face towards the battery as shown in the image and the top of the support should be just below the side edge of the frame (arrow).

Stage 59: Assembling and Fitting the Horns

STAGE COMPLETE

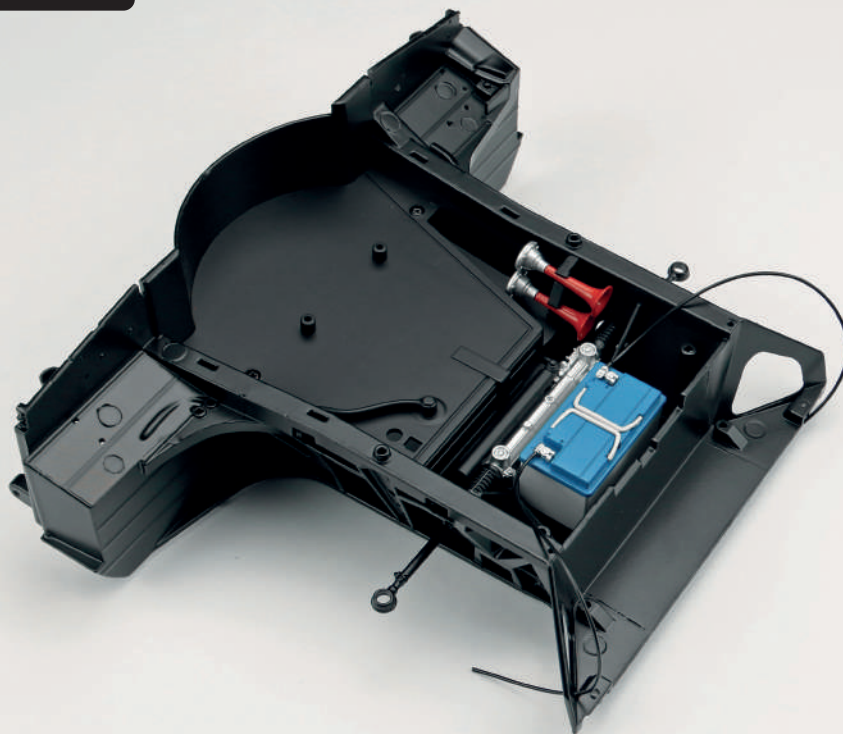

Stage 60: Attaching the Reinforcement Crossbar

Using the parts supplied in Stage 59, you'll attach the horn actuator and windscreen washer reservoir onto the reinforcement crossbar then fit the bar in place on the front frame.



STAGE 60 PARTS LIST

Name
Front shock absorber
Front left lower wishbone arm
Wishbone arm bracket x2
Type A screws x3
Type F screws x2
Type G screws x4
Type P screws x2

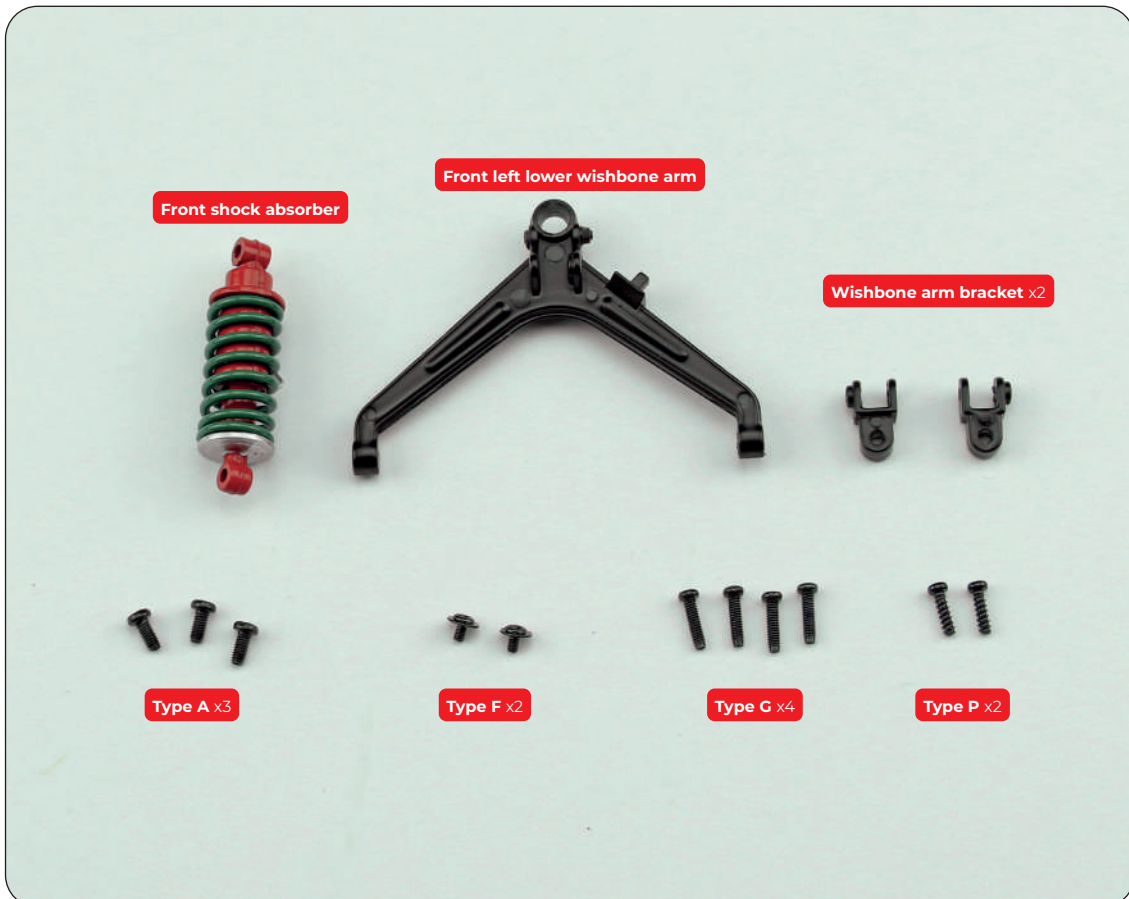

Stage 60: Attaching the Reinforcement Crossbar



Take the horn actuator body and cover supplied with Stage 59. Press the cover into the upper hole of the actuator body.

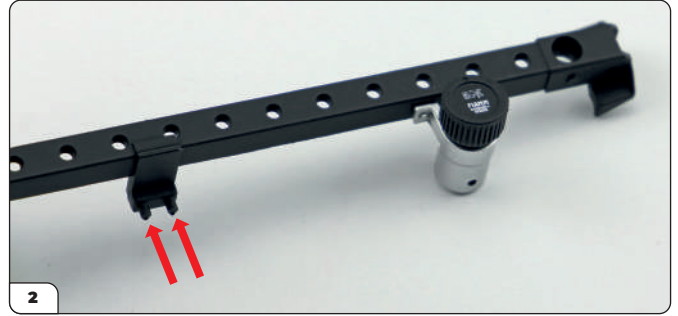
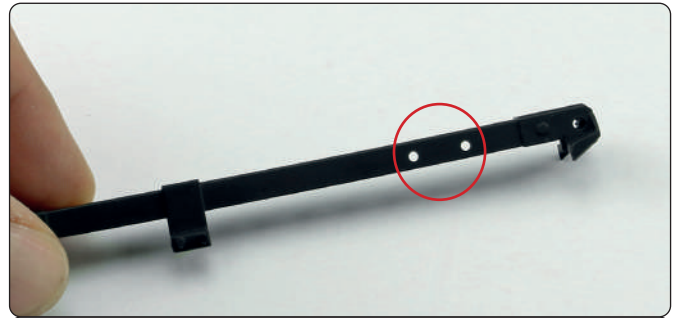

Now take the reinforcement crossbar from Stage 59 and locate the two holes for mounting the actuator (circled). Press the pins of the actuator body into the holes of the crossbar as shown. If the fit is too tight, try removing some of the excess paint from the pins on the actuator body with a file. Note the pins on the crossbar (arrows) for the next step.

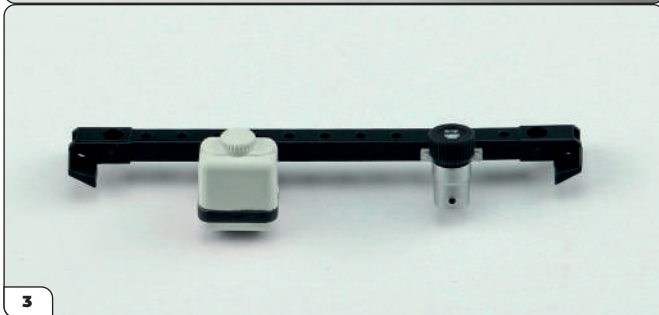

Next take the windscreen washer reservoir from Stage 59 and locate the two small holes on its side (arrows). Press these holes onto the pins of the crossbar highlighted in the previous step. Try removing some of the excess paint from the pins on the crossbar body with a file if the fit is tight.

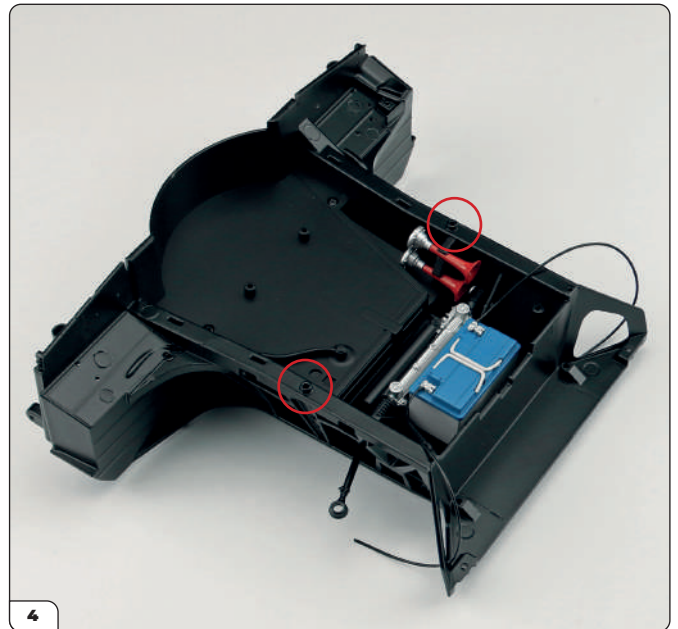

Take the front frame assembly from the previous stage. Locate the two fixing points for the reinforcement crossbar (circled) found on the edges of the frame.

Stage 60: Attaching the Reinforcement Crossbar

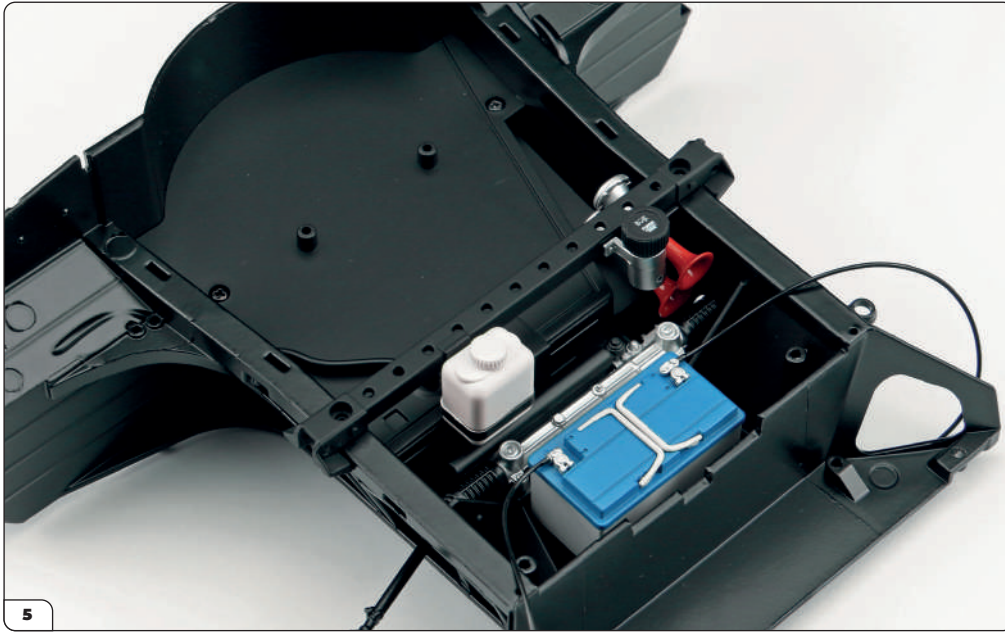

Fit the crossbar in place as shown, with the actuator and reservoir facing towards the battery.

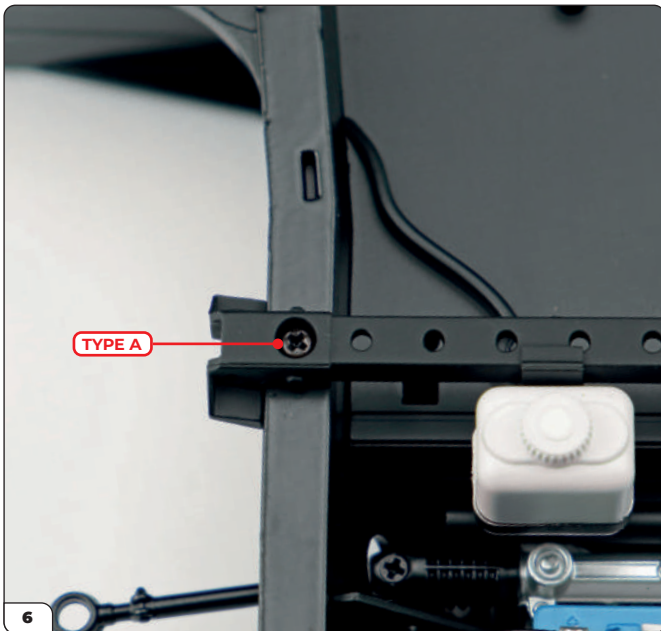

Fix one side of the crossbar to the frame using a Type A screw (supplied with Stage 59).

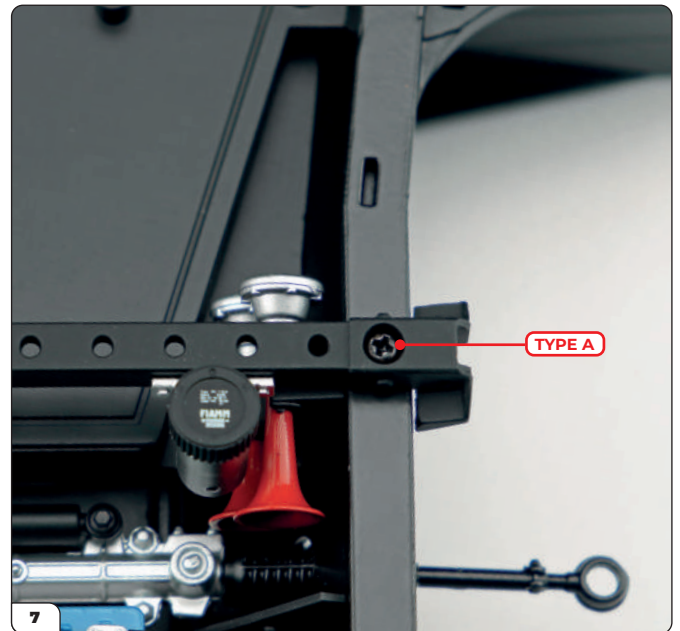

Use another Type A screw (supplied with Stage 59) to secure the opposite end of the crossbar.

Stage 60: Attaching the Reinforcement Crossbar

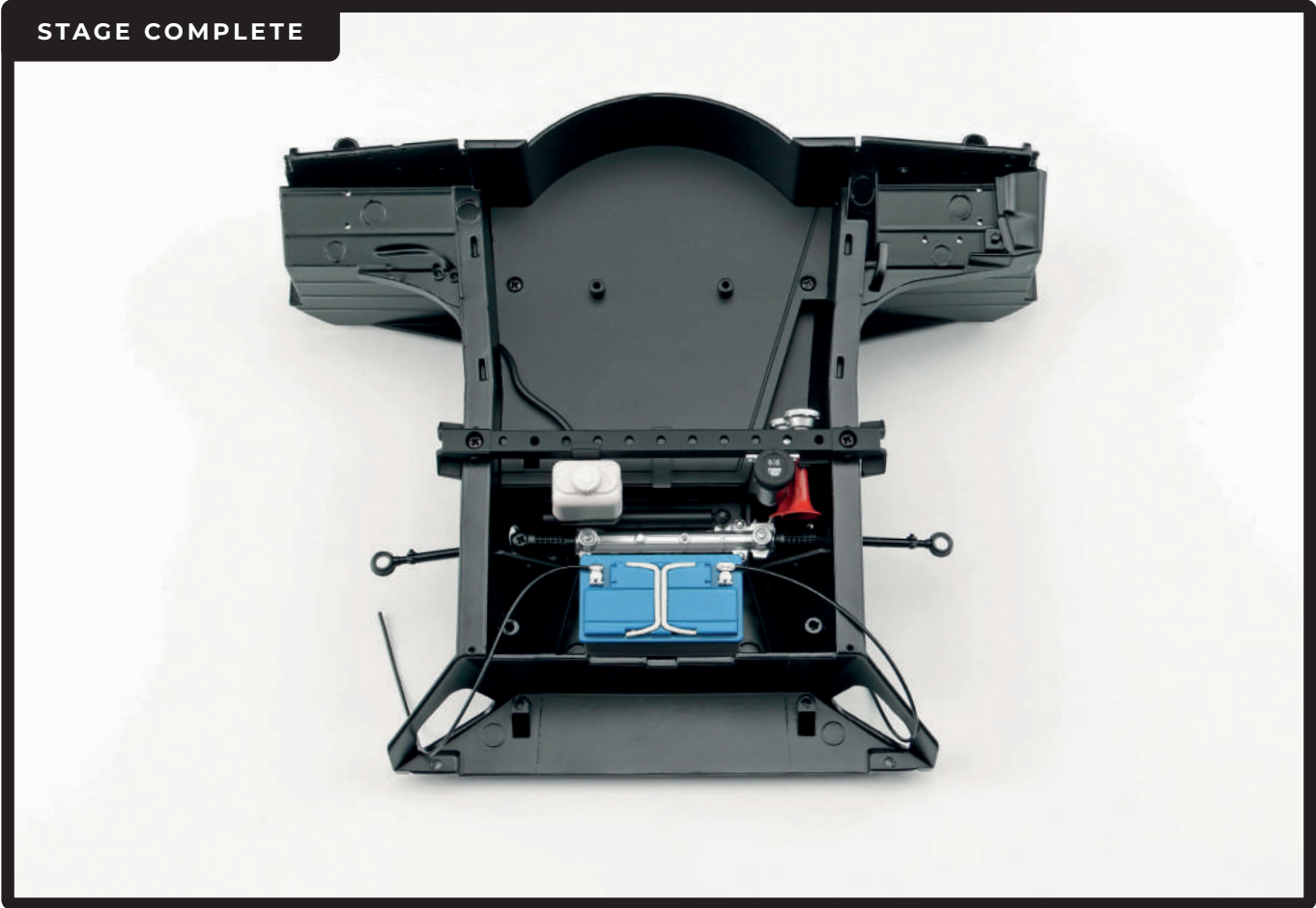

Stage 61: Assembling and Fixing the Front Left Lower Wishbone Arm

For this section you'll use the parts supplied with Stage 60 to assemble and fix the front left wishbone arm to the front frame.



STAGE 61 PARTS LIST

Name
Front right lower wishbone arm
Wishbone arm bracket x2
Front shock absorber
Sandpaper x2
Type A screws x3
Type F screws x2
Type G screws x4
Type P screws x2

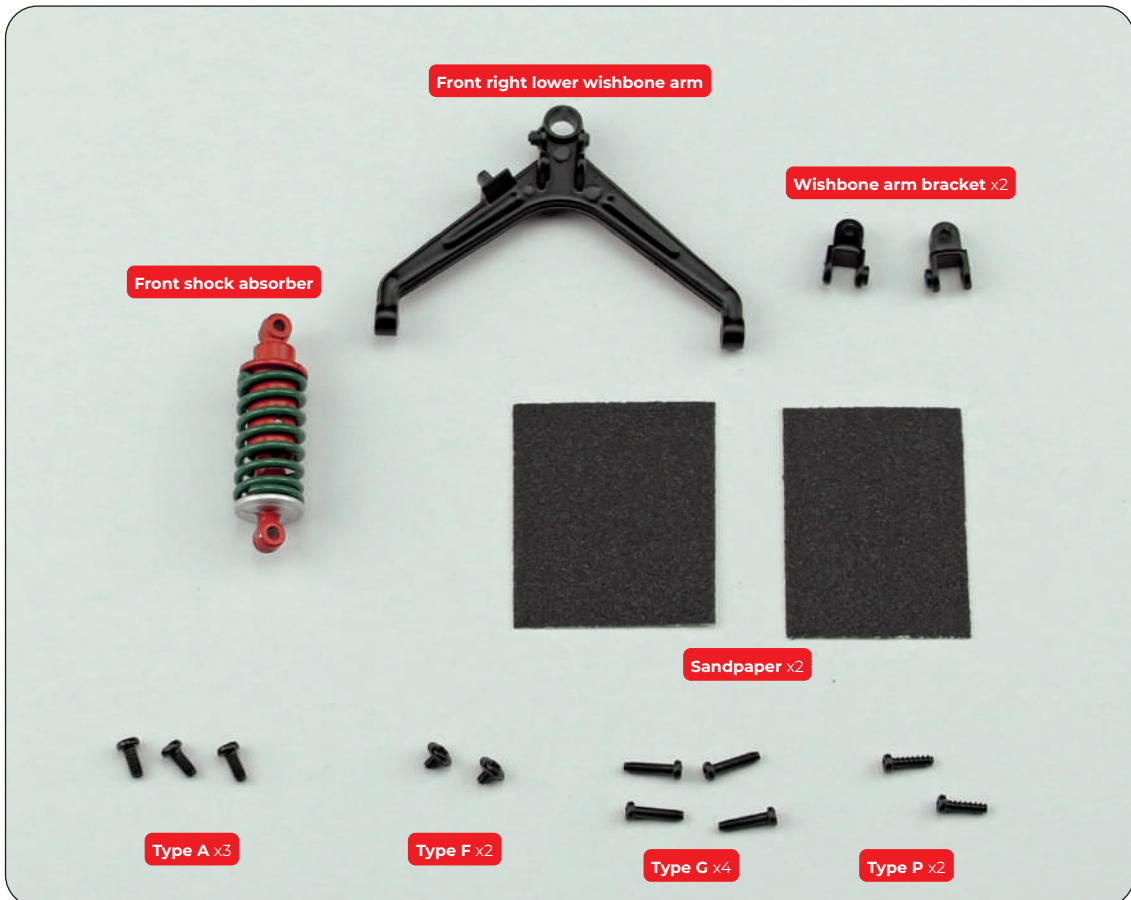

Stage 61: Assembling and Fixing the Front Left Lower Wishbone Arm

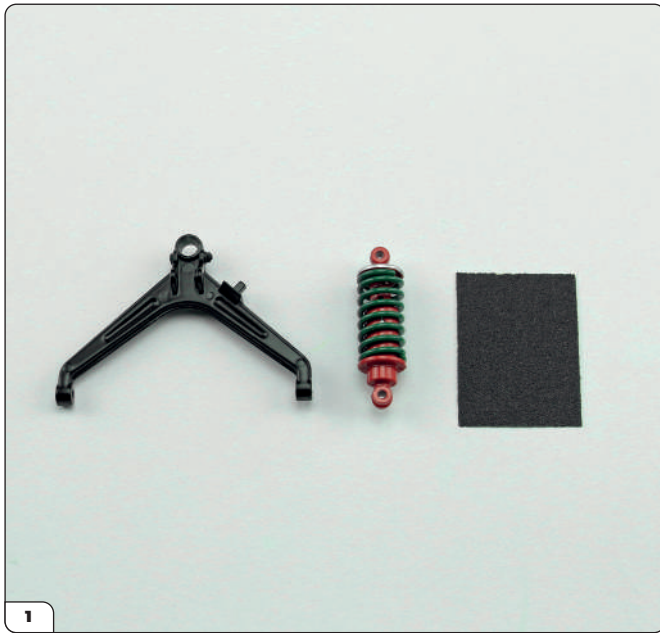

Take the front left lower wishbone arm and front shock absorber supplied with Stage 60, along with one of the pieces of sandpaper supplied in this stage. You can also use a fine flat file in place of the sandpaper for the next steps.

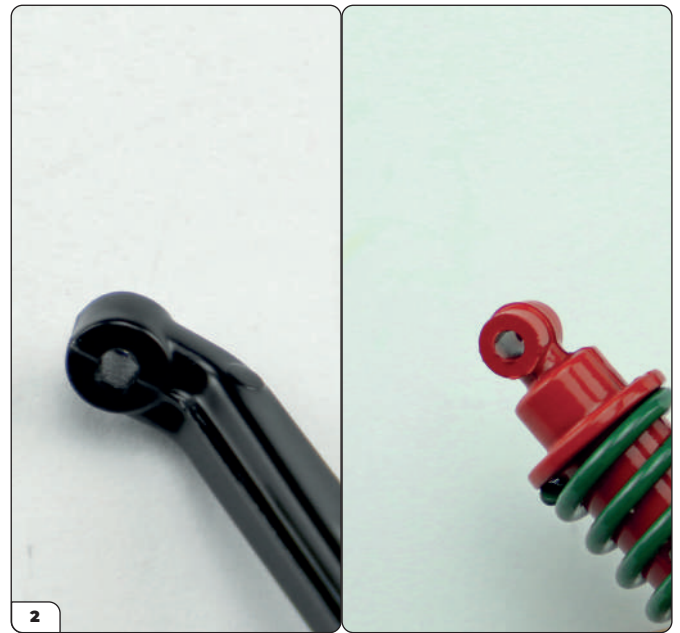

First you will need to test the attachment points for the wishbone arm and shock absorber pictured above. Try fitting the wishbone arm into the supports (steps 6 – 8) and the shock absorber into the wishbone arm (step 9). If it is difficult to insert, follow steps 3 and 4.

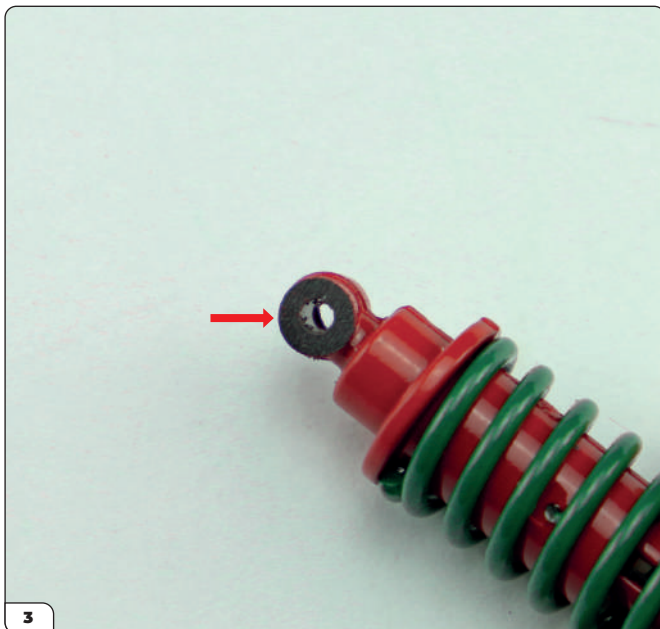

With the help of sandpaper or a fine flat file, remove some of the paint from both sides of the lower shock absorber attachment that lacks the metal-coloured plate. Be careful not to damage the paint on any other part of the piece.



In the same way, remove paint from the two ends of the wishbone arm using the sandpaper or a flat file. If it is still difficult to fit the parts together, continue filing until the fit is snug.

Stage 61: Assembling and Fixing the Front Left Lower Wishbone Arm

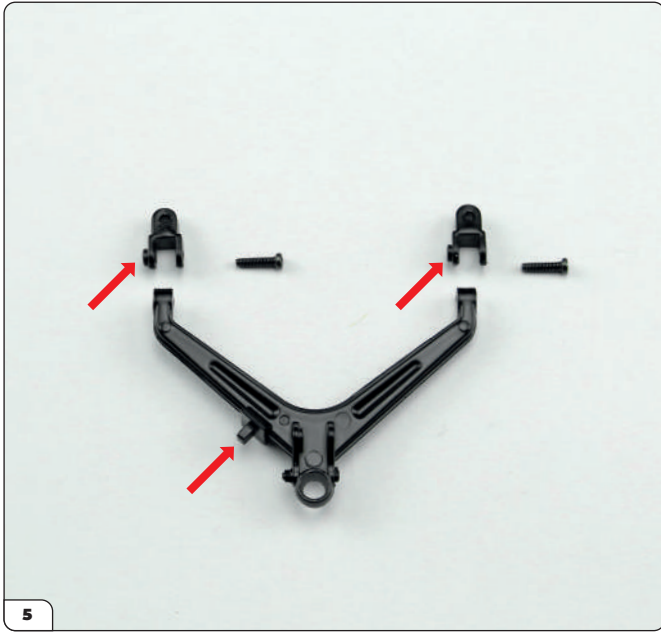

Take the wishbone arm along with the brackets and two of the Type G screws, all supplied with Stage 60. Ensure that the parts are aligned as shown in the image when fitting them together – note the position of the details highlighted by the arrows.

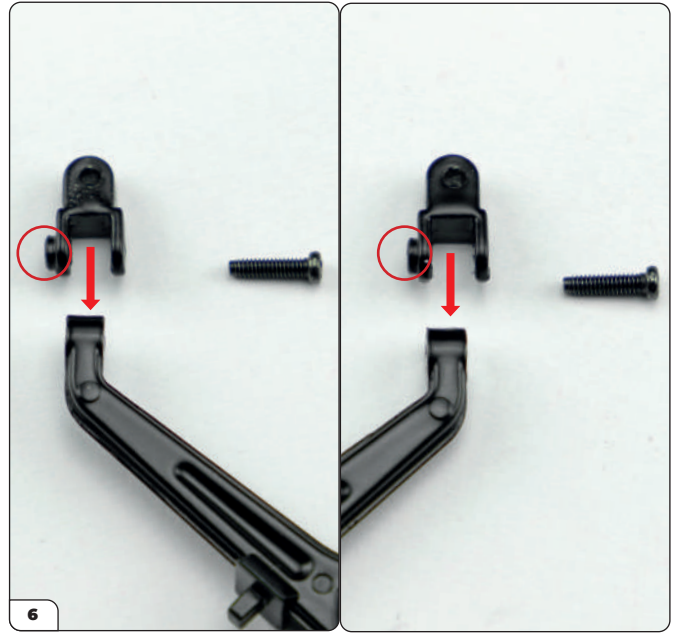

Fit the brackets onto the ends of the wishbone arm so that the protruding sections (circled) are facing the same direction.



Drive a Type G screw through the flat side of a bracket. The bracket should be able to move freely once secure – loosen the screw slightly if it is too tight.

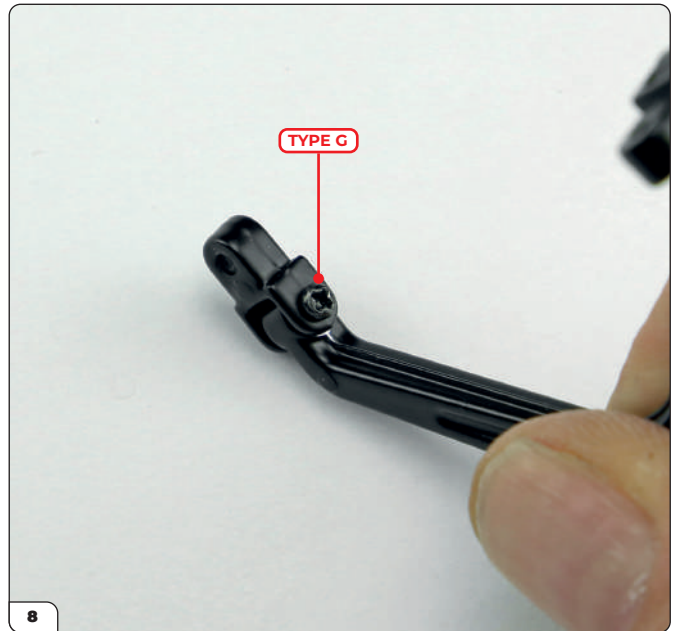

Use a Type G screw to secure the other bracket in the same way.

Stage 61: Assembling and Fixing the Front Left Lower Wishbone Arm



Take the front shock absorber and place the lower attachment point (without the coloured plate) in the appropriate housing located on the upper face of the wishbone arm as shown.

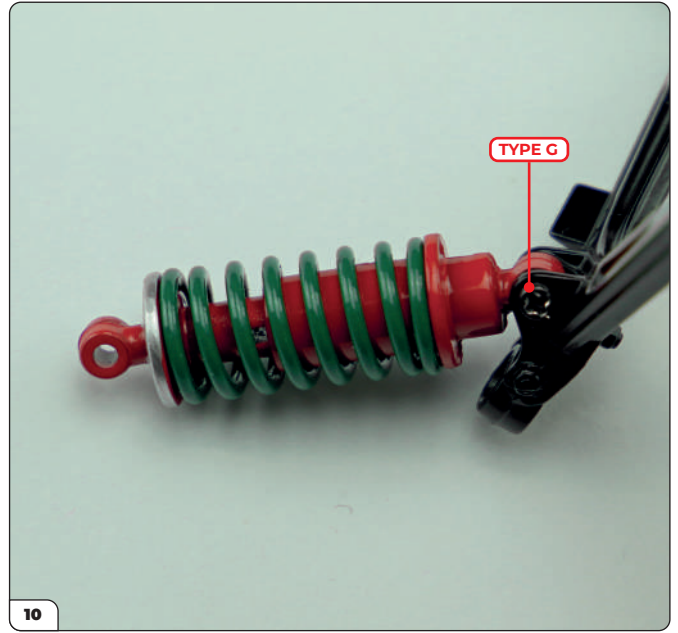

Secure the shock absorber to the wishbone arm using a Type G screw supplied with Stage 60. Drive the screw through from the same side as the screws securing the brackets. Don't tighten the screw too much as the absorber should be able to move freely.

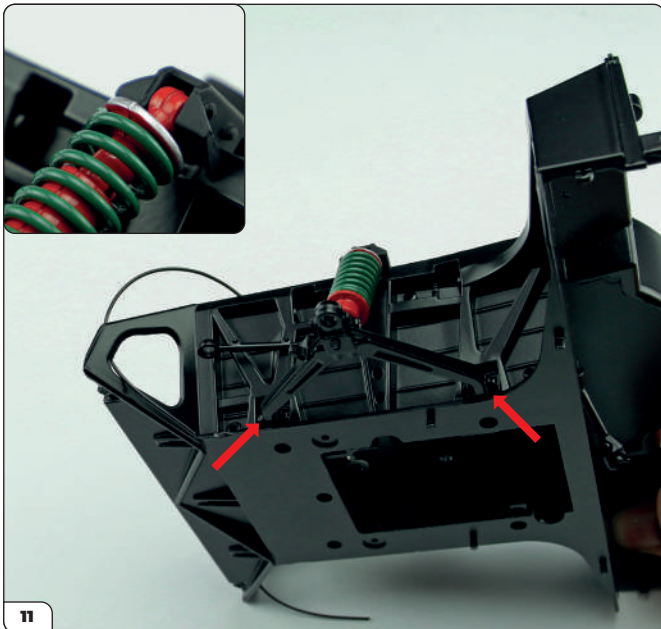

Retrieve the front frame assembly from the previous stage. Insert the wishbone arm brackets into the two square-shaped holes located at the base of the left-hand side of the frame (arrows). The upper attachment point of the shock absorber is inserted into the end of the frame reinforcement crossbar (inset).

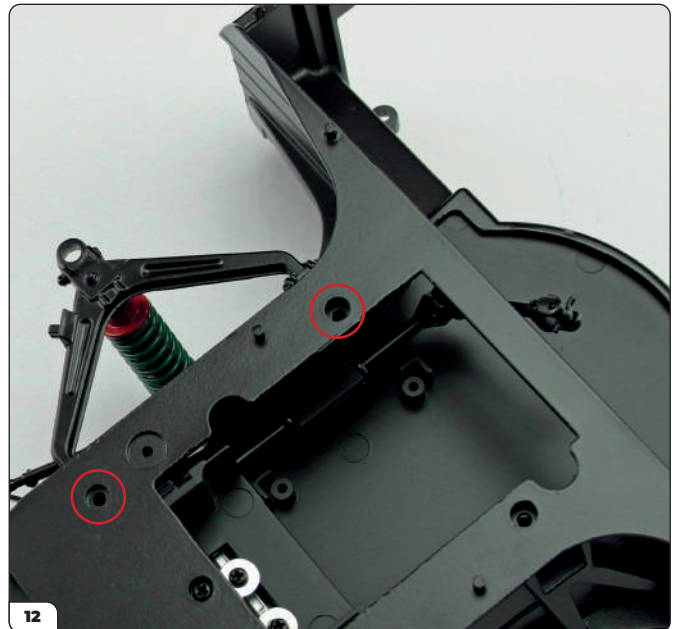

Carefully turn the assembly over while keeping the wishbone arm and shock absorber in place. Locate the two holes (circled) for fastening the wishbone arm brackets. Check the brackets have been inserted far enough in so that the screw holes are visible.

Stage 61: Assembling and Fixing the Front Left Lower Wishbone Arm

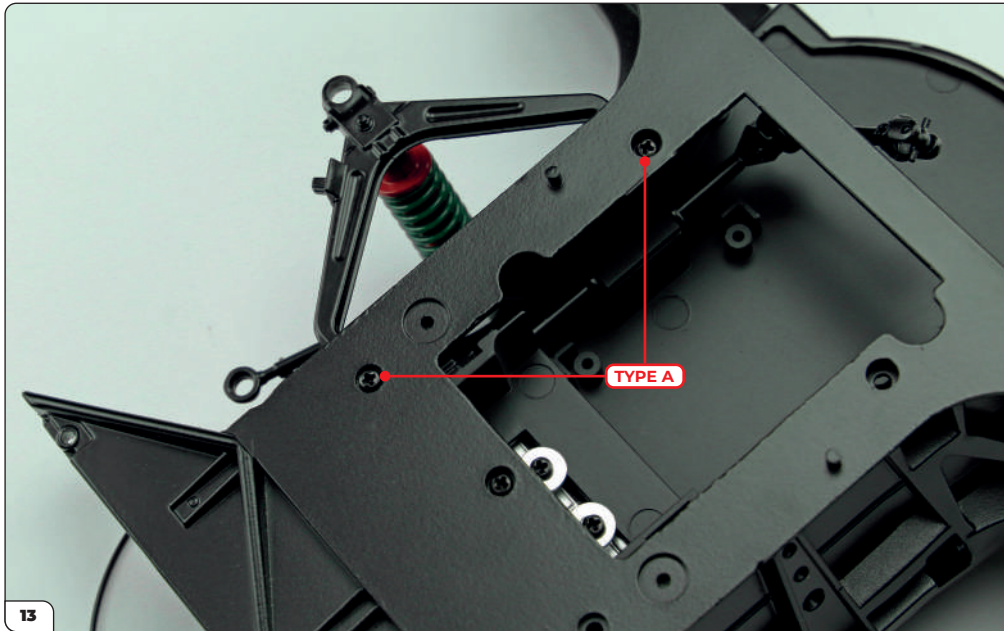

Using 2x Type A screws from Stage 60, secure both wishbone arm brackets to the frame. Once fixed, the two screws should not protrude above the face of the frame.

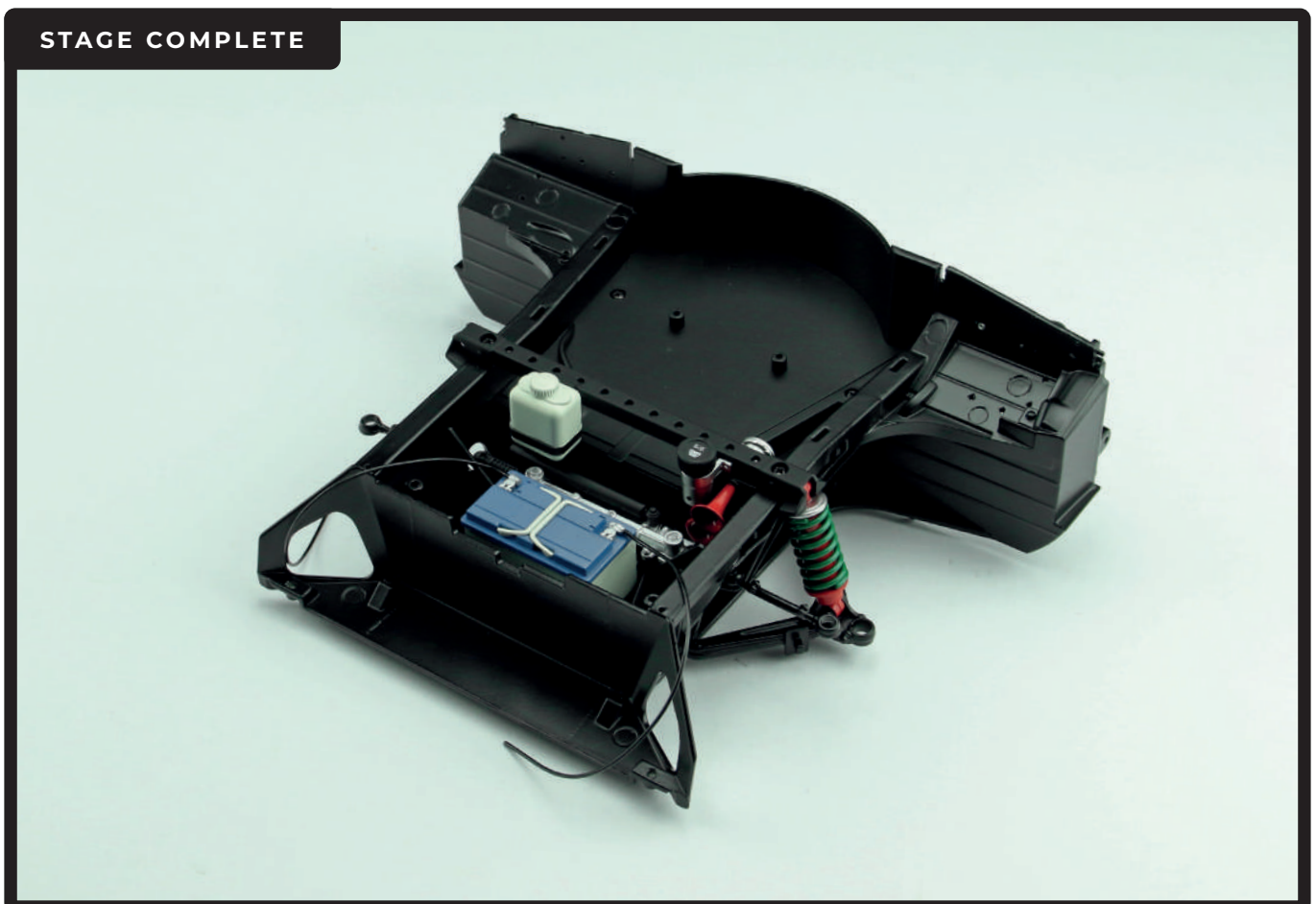

Stage 62: Assembling and Fixing the Front Right Lower Wishbone Arm

In this stage you'll assemble and fix the front right wishbone arm to the front frame using the parts supplied with Stage 61.



STAGE 62 PARTS LIST

Name
Front left upper wishbone arm
Left torsion bar
Support A
Support B
Type D screws x3



Stage 62: Assembling and Fixing the Front Right Lower Wishbone Arm



As you did in the previous stage, start by testing the fit of the brackets and shock absorber with the lower wishbone arm (both supplied with Stage 61).



Remove excess paint from the shock absorber using a flat file or the sandpaper supplied with Stage 61 if necessary.

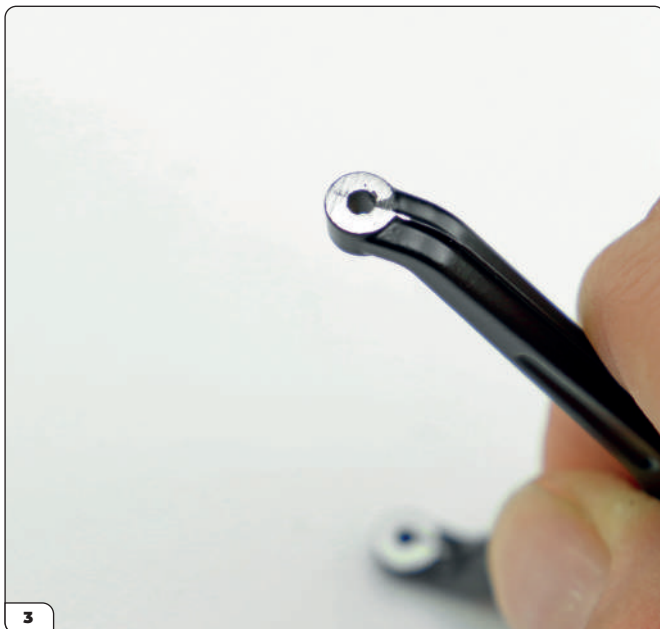

Remove excess paint from the ends of the wishbone arm using a file or the sandpaper supplied if necessary.

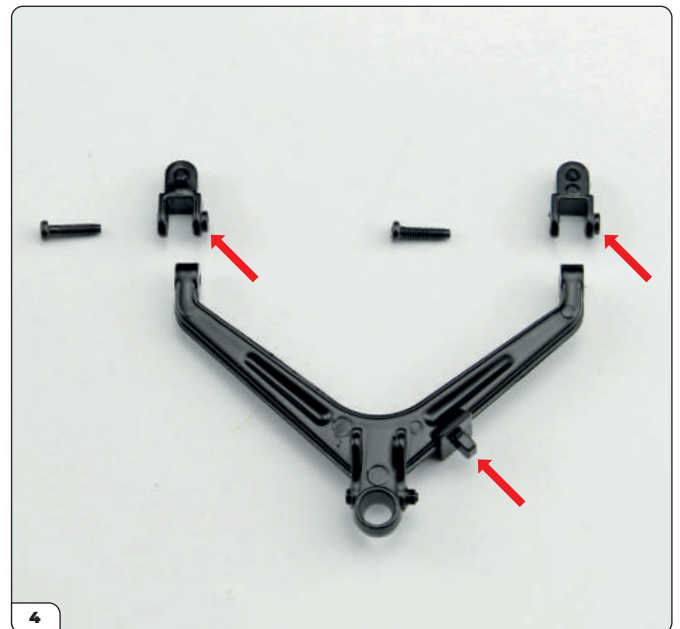

Retrieve the wishbone arm and the brackets and along with two of the Type G screws supplied with Stage 61. Align the parts as shown in the image – note the position of the details highlighted by the arrows.

Stage 62: Assembling and Fixing the Front Right Lower Wishbone Arm

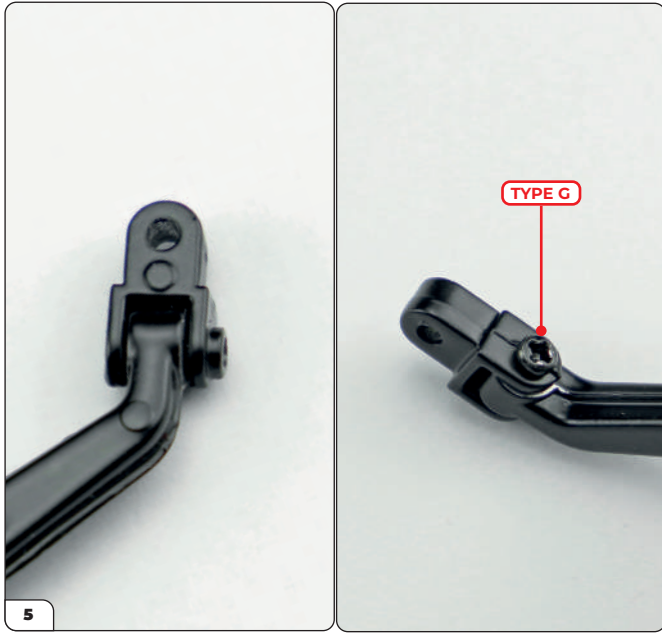

Fit the bracket onto the end of the wishbone arm as shown then secure it using a Type G screw.

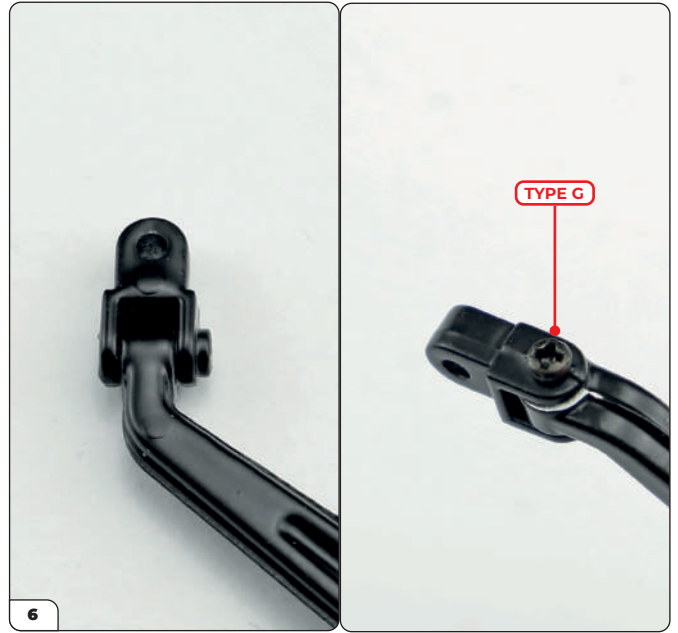

Fit the remaining bracket onto the other end and secure using a Type G screw

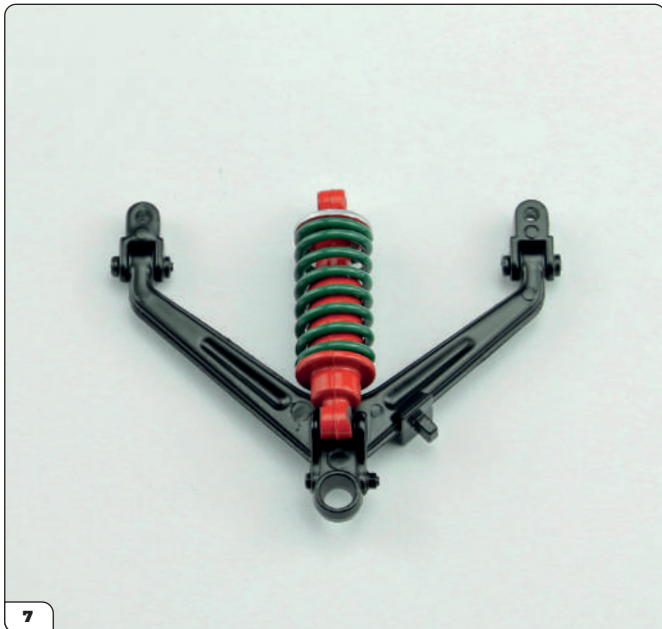

Fit the front shock absorber in the appropriate housing located on the upper face of the wishbone arm as shown.

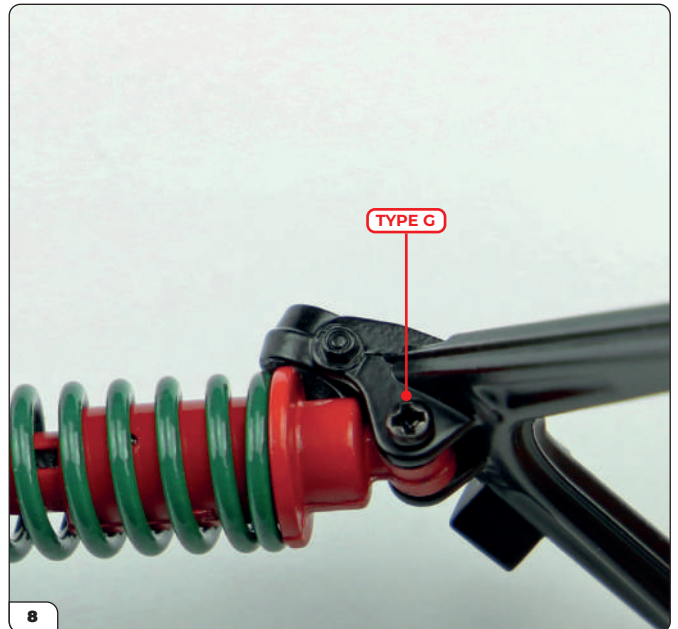

Secure the shock absorber by driving a Type G screw (supplied with Stage 61) through from the same side as the screws securing the brackets.

Stage 62: Assembling and Fixing the Front Right Lower Wishbone Arm

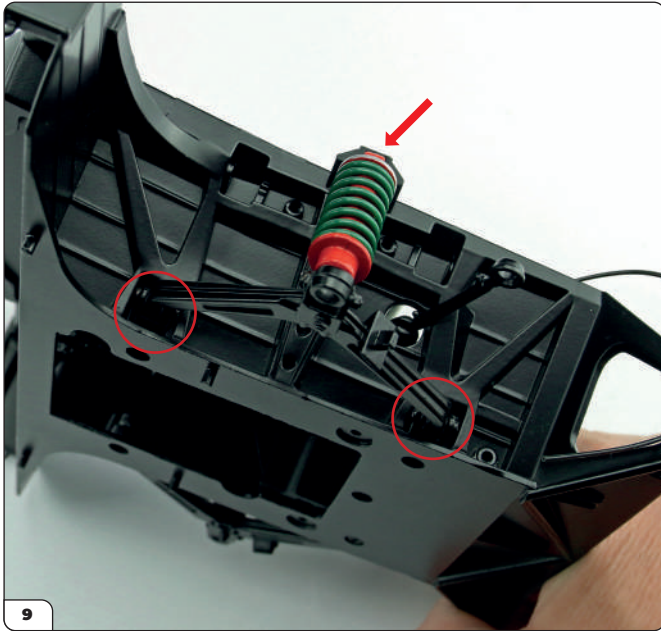

In the same manner as before, fit the wishbone arm brackets into the two square-shaped holes located at the base of the left-hand side of the frame (circled) and insert the upper attachment point of the shock absorber into the end of the frame reinforcement crossbar (arrow) at the same time.

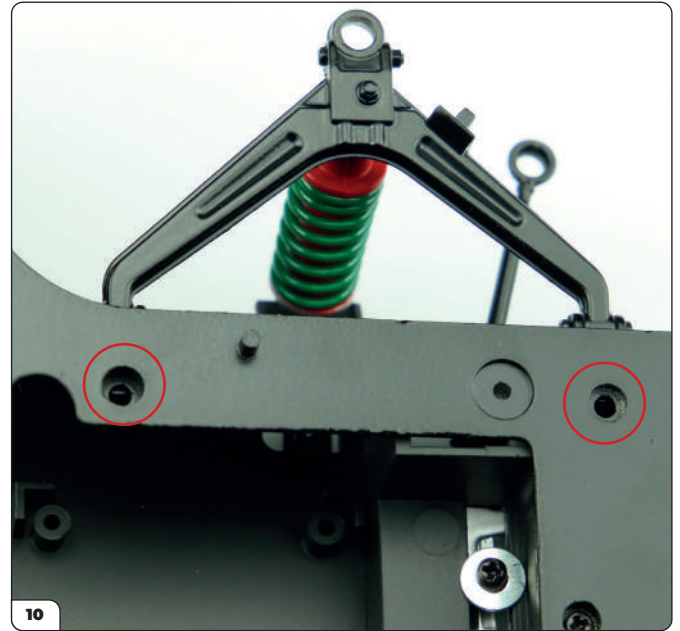

Carefully turn the assembly over while keeping the wishbone arm and shock absorber in place. Locate the two holes (circled) for fastening the wishbone arm brackets and check they have been inserted far enough in so that the screw holes are visible.

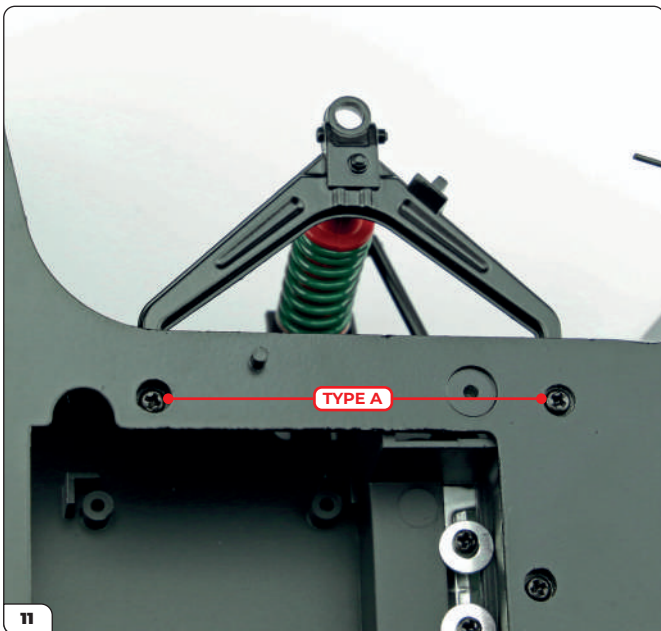

Fix the brackets to the frame using 2x Type A screws (supplied with Stage 61). Ensure the two screws do not protrude above the face of the frame.

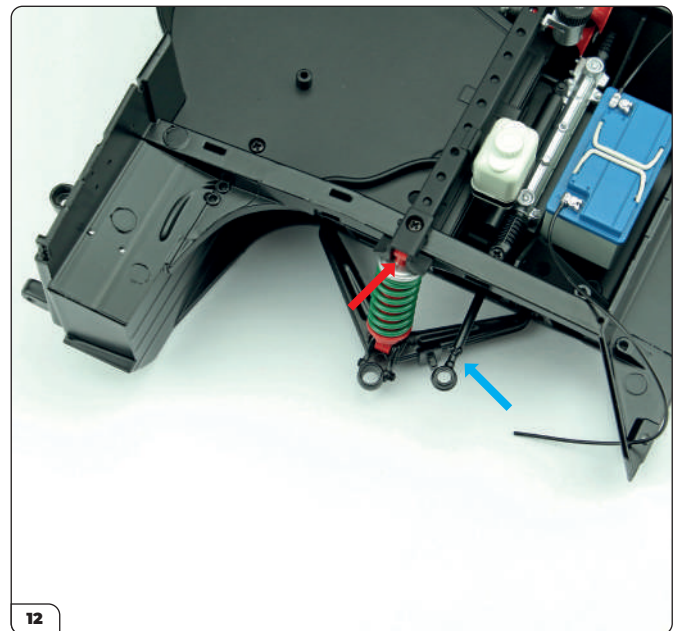

Turn the assembly back over. Check that the shock absorber on both sides of the frame are located in the slots in the crossbar (red arrow) and that the screw holes are aligned. Make sure the steering arm (blue arrow) is not trapped behind either of the shock absorbers.

Stage 62: Assembling and Fixing the Front Right Lower Wishbone Arm

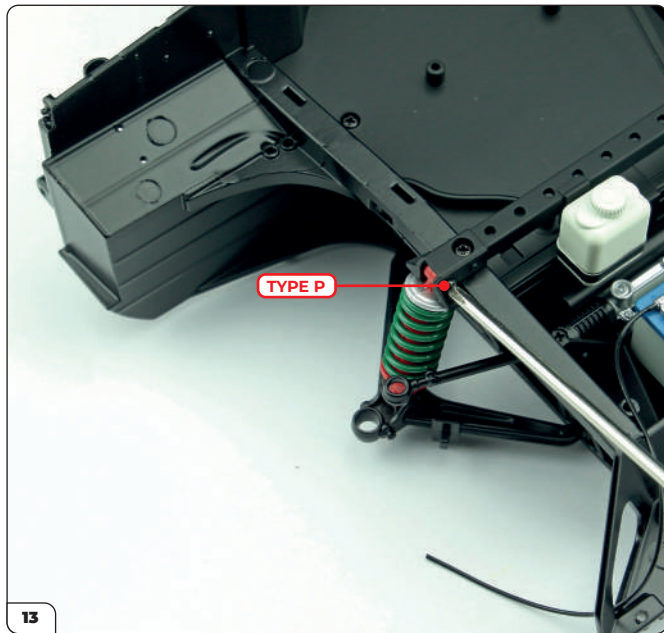

Using a Type P screw (supplied with Stage 60), fix the shock absorber to the crossbar.

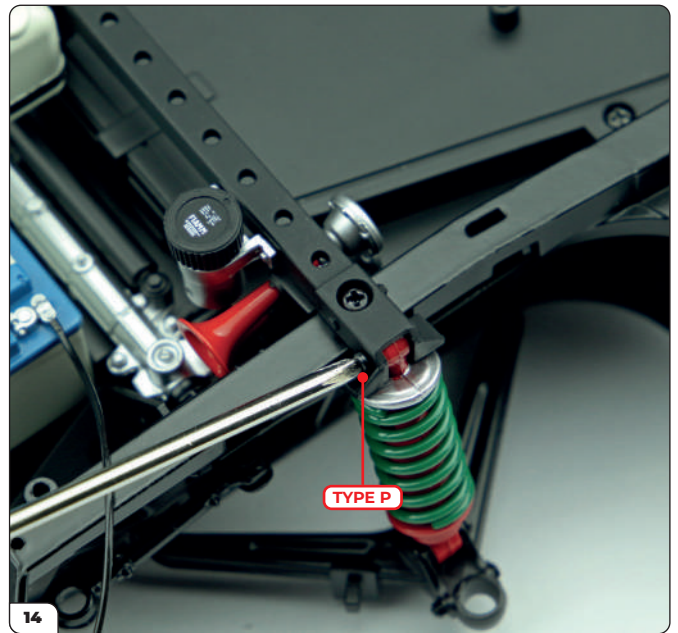

Repeat for the shock absorber on the other side using another Type P screw (supplied with Stage 61) as shown.



Stage 63: Fitting the Front Left Upper Wishbone Arm and Torsion Bar

Now you'll fit the left upper wishbone arm and torsion bar onto the front frame of the Miura. You'll need the parts supplied in the previous stage for this.



STAGE 63 PARTS LIST

Name
Front right upper wishbone arm
Right torsion bar
Type D screws x3
Support B
Support A



Stage 63: Fitting the Front Left Upper Wishbone Arm and Torsion Bar

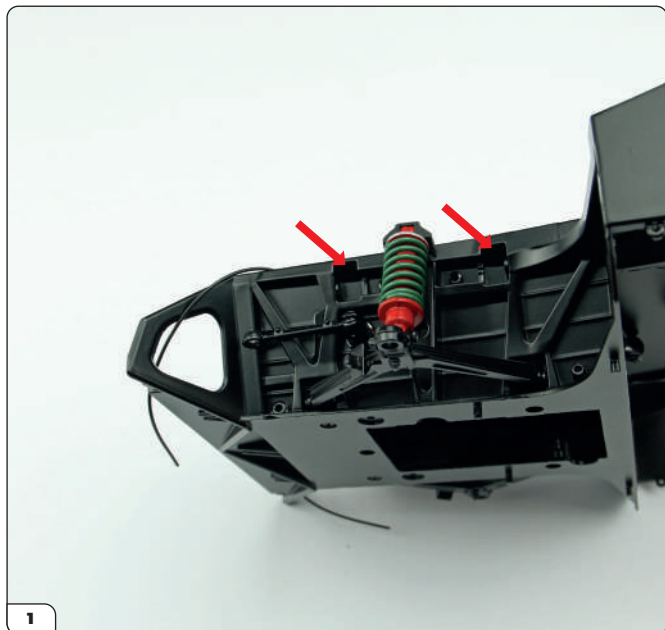

Take the front frame assembly and locate the seats for the ends of the front left upper wishbone arm next to the shock absorber (arrows) on the left side of the frame.

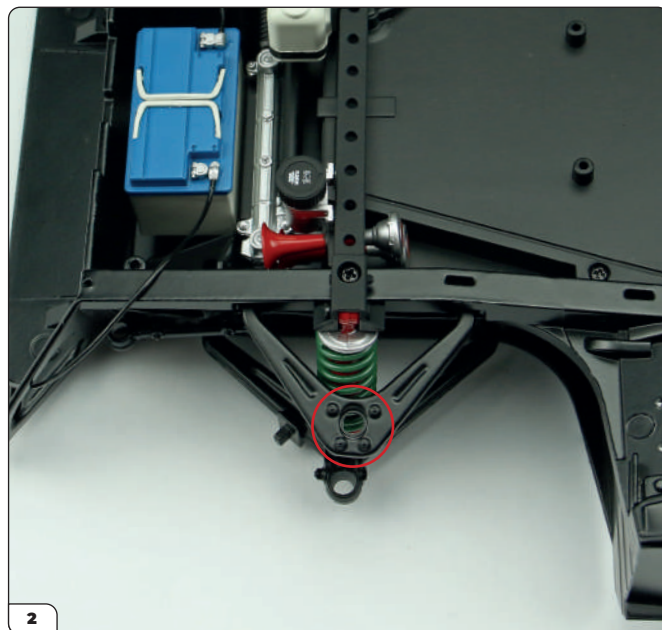

Take the front left upper wishbone arm from Stage 62 and position it in place. Orient it with the detail nuts facing upwards (circled).

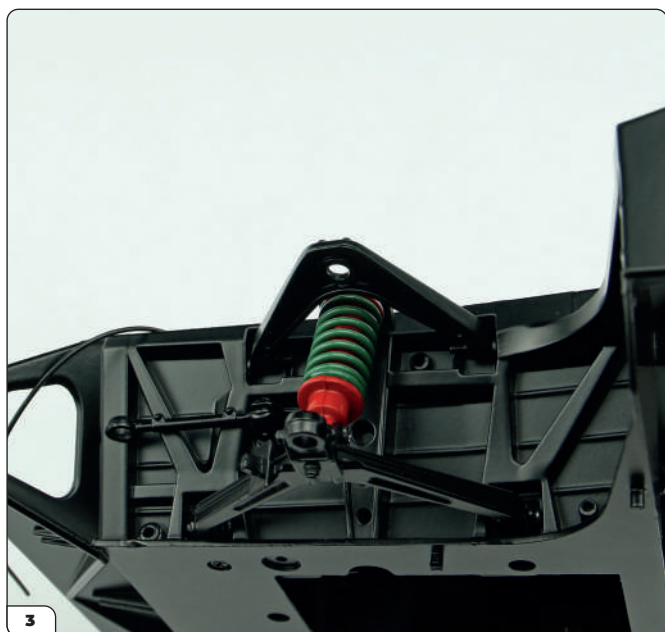

The arm should be in this position once inserted in place.



Take the two supports (supplied with Stage 62) and lay them on the work surface as shown. Identify the narrower support (B) from the wider one (A).

Stage 63: Fitting the Front Left Upper Wishbone Arm and Torsion Bar

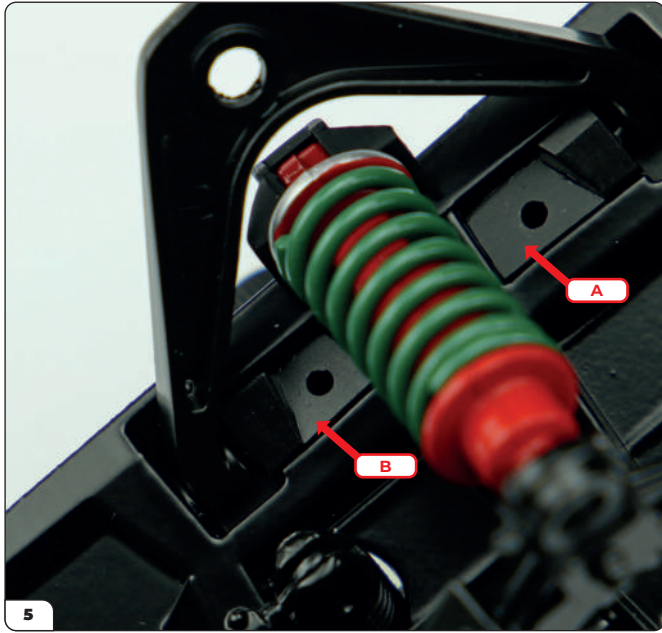

Position support A in the housing to the right of the shock absorber. Then insert support B to the left of the shock absorber as shown. We recommend using a pair of tweezers to push the supports in place.

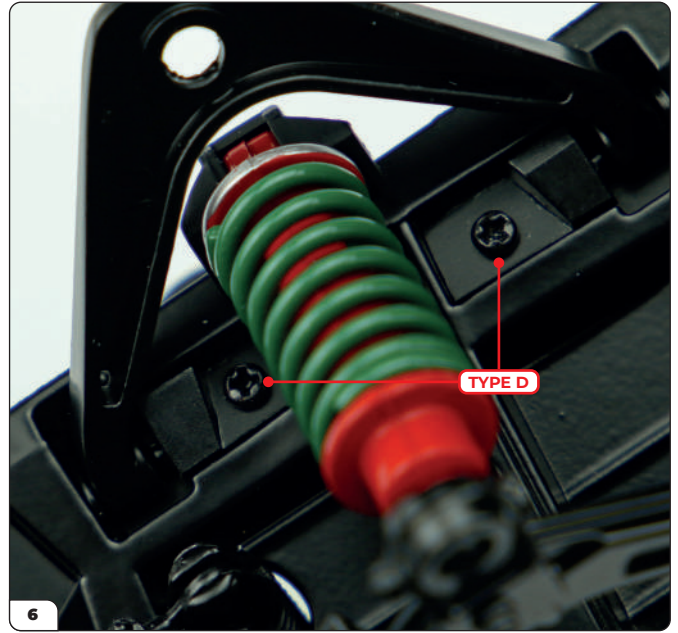

Fix the supports in place using 2x Type D screws.

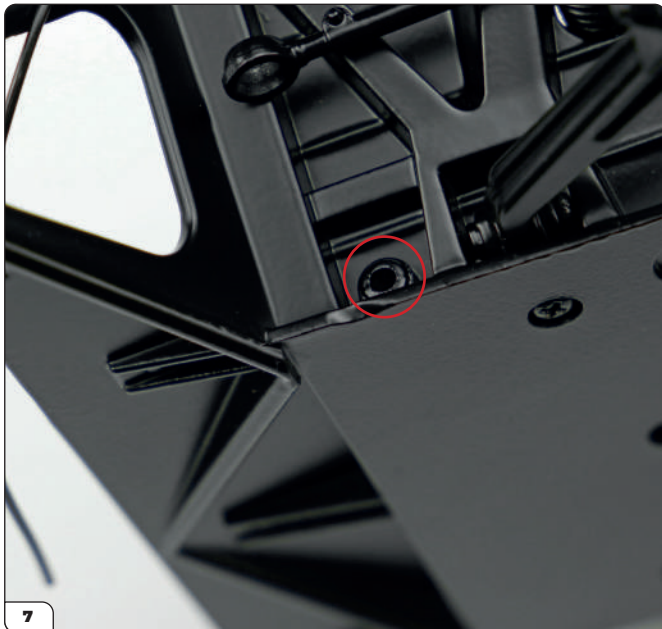

On the lower edge of the frame, to the left of the lower wishbone arm, find the hole (circled) into which the torsion bar will fit.

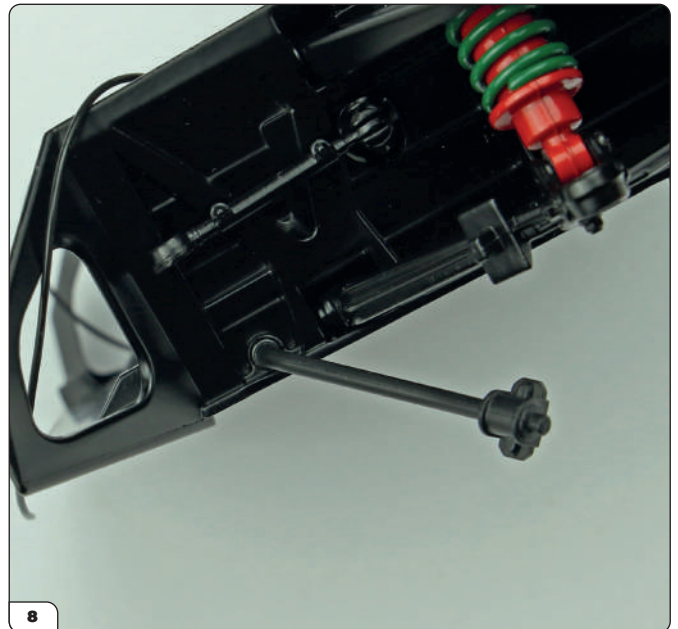

Then take the torsion bar from Stage 62 and insert the pin located on the curved end of the piece into the hole identified in step 7.

Stage 63: Fitting the Front Left Upper Wishbone Arm and Torsion Bar

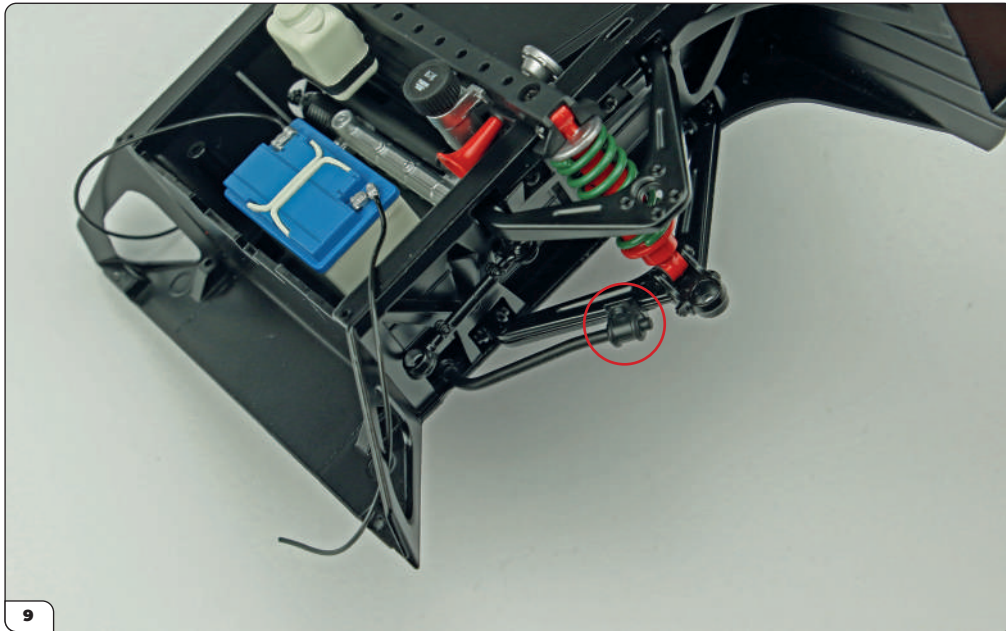

Slightly rotate the torsion bar and fit it onto the pin located on the square section of the front lower wishbone arm (circled).

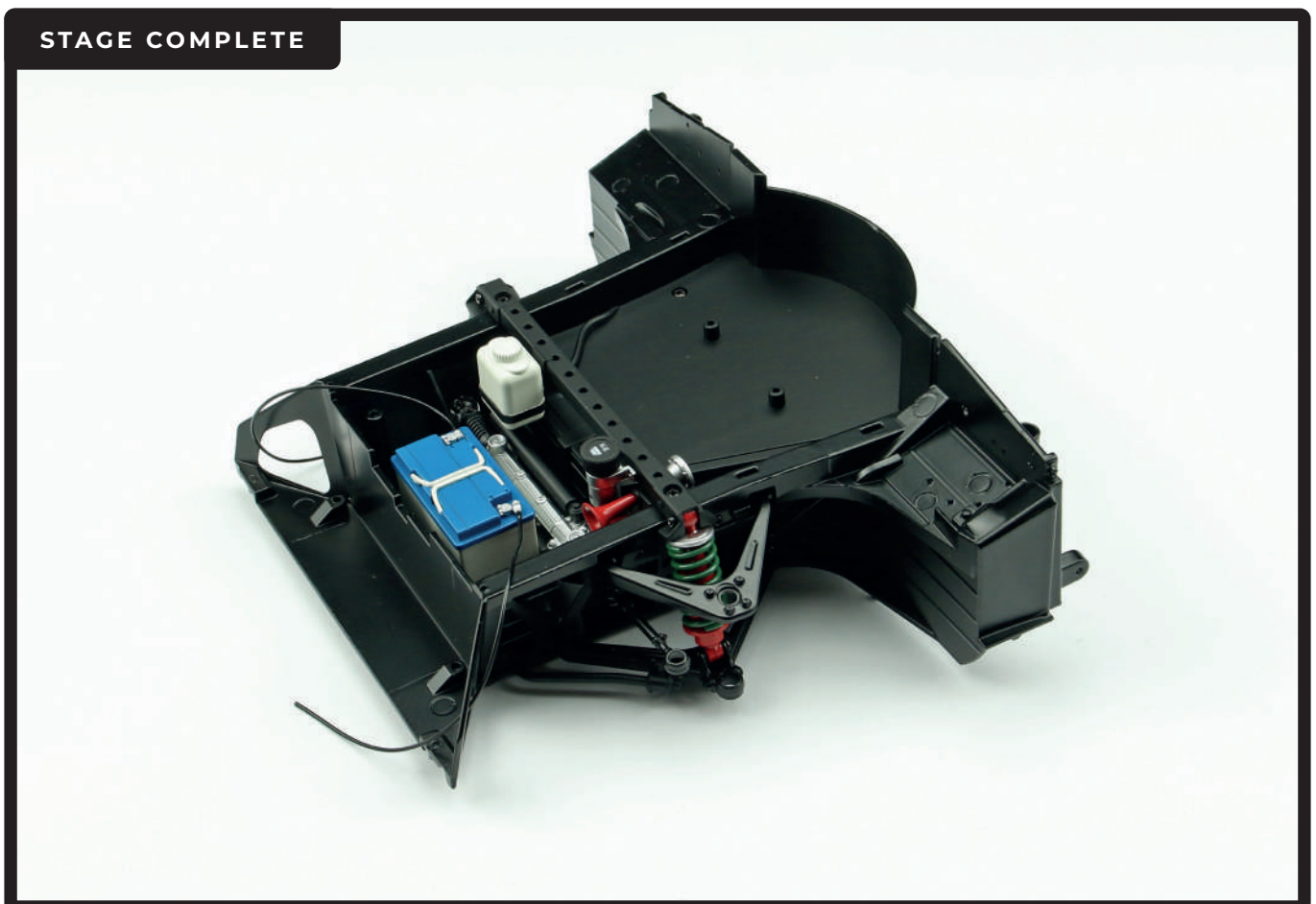

Stage 64: Fitting the Front Right Upper Wishbone Arm and Torsion Bar

Next you'll fit the right upper wishbone arm and torsion bar in the same manner as before using the parts supplied with Stage 63.



STAGE 64 PARTS LIST

Name
Front left brake disc (inner)
Front left brake disc (outer)
Front left brake caliper (inner)
Front left brake caliper (outer)

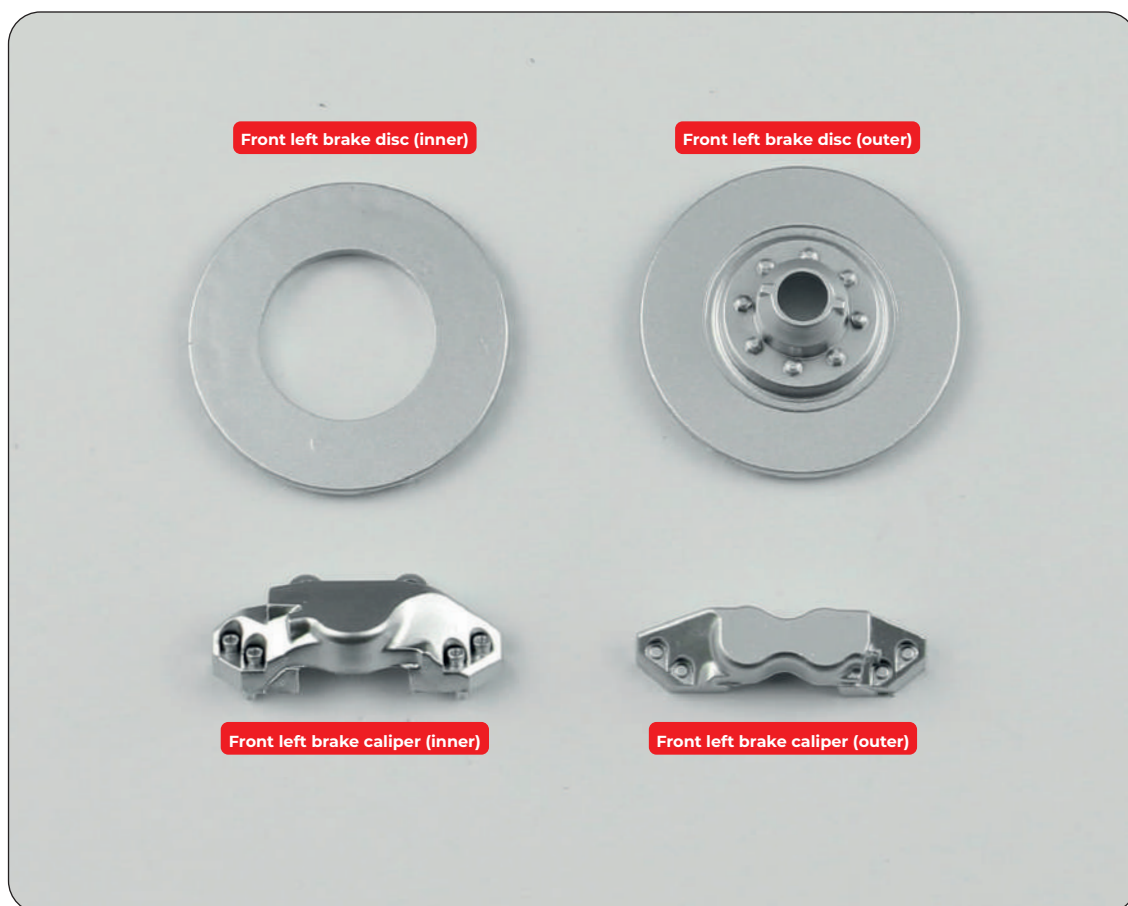

Stage 64: Fitting the Front Right Upper Wishbone Arm and Torsion Bar

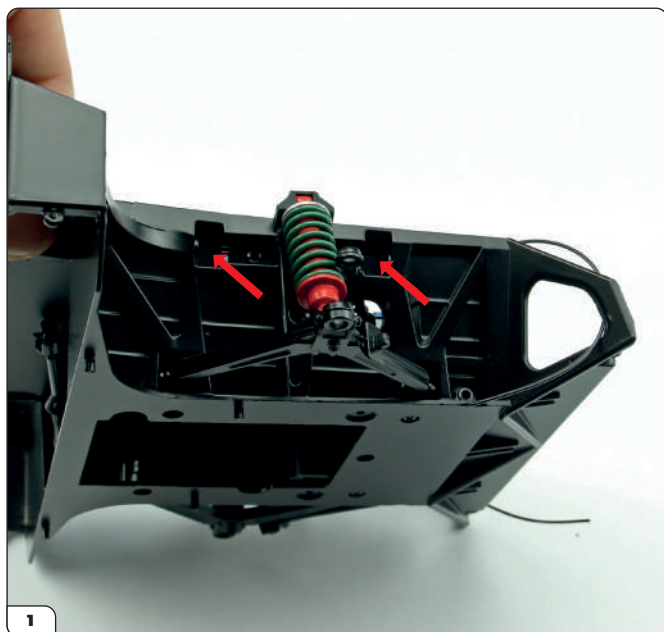

1
Take the front frame assembly and locate the seats for the ends of the front right upper wishbone arm next to the shock absorber (arrows) on the right side of the frame.

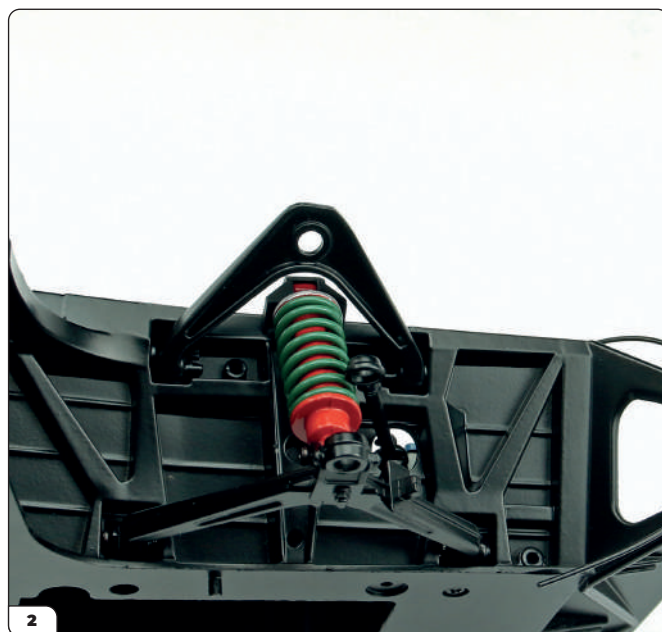

2
Take the front right upper wishbone arm from Stage 63 and position it in place in the same manner as before.

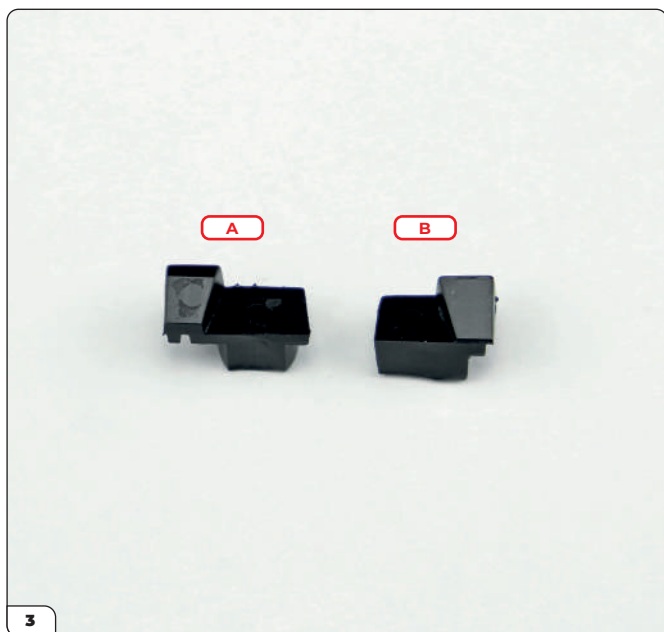

3
Take the two supports (supplied with Stage 63) and lay them on the work surface. Identify the narrower support (B) from the wider one (A).

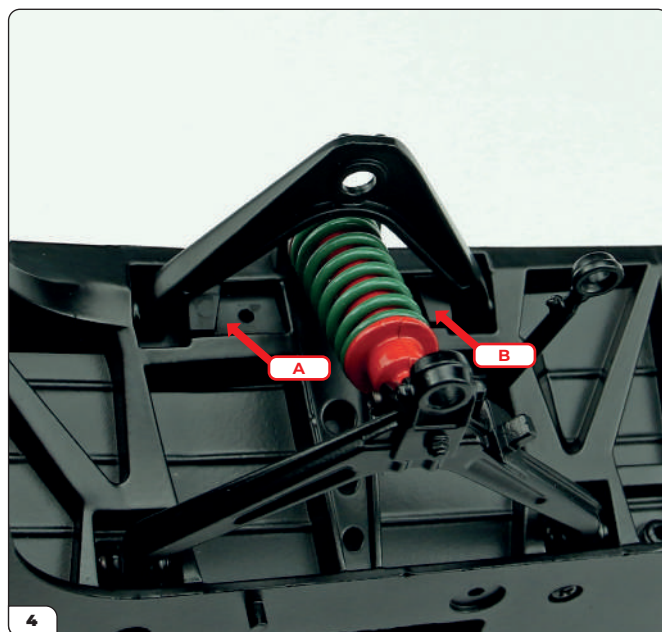

4
Position support A in the housing to the left of the shock absorber. Then insert support B to the right of the shock absorber as shown. We recommend using a pair of tweezers to push the supports in place.

Stage 64: Fitting the Front Right Upper Wishbone Arm and Torsion Bar

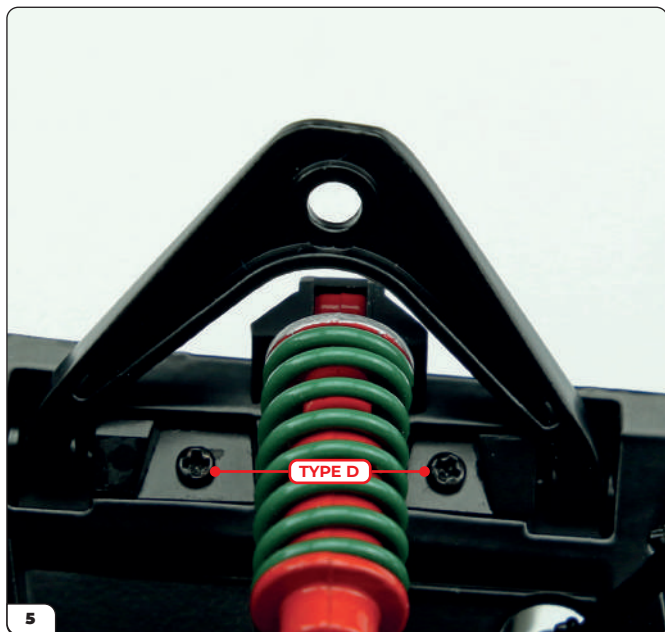

Fix the supports in place using 2x Type D screws.

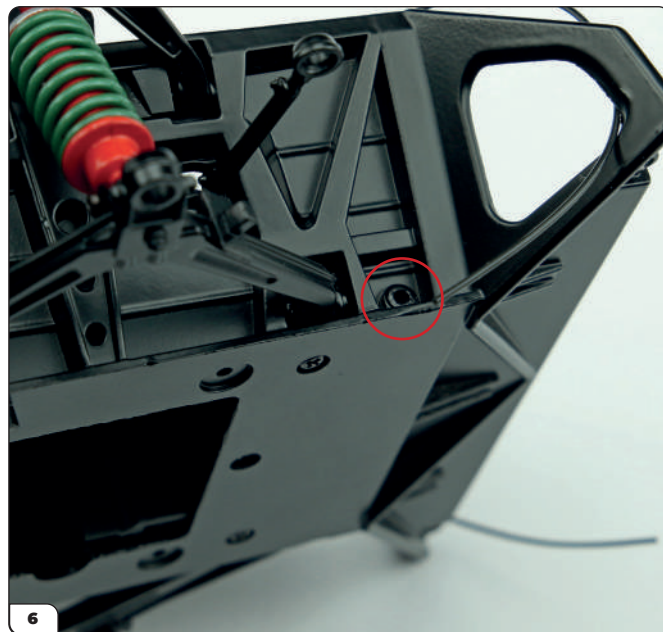

On the lower edge of the frame, to the left of the lower wishbone arm, find the hole (circled) into which the torsion bar will fit.



Then take the torsion bar from Stage 63 and insert the pin located on the curved end of the piece into the hole identified in step 6.

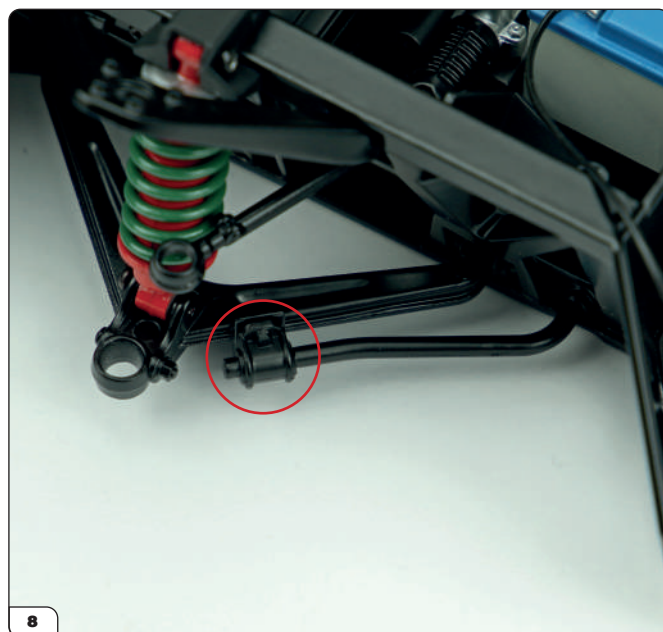

Slightly rotate the torsion bar and fit it onto the pin located on the square section of the front lower wishbone arm (circled).

Stage 64: Fitting the Front Right Upper Wishbone Arm and Torsion Bar

STAGE COMPLETE

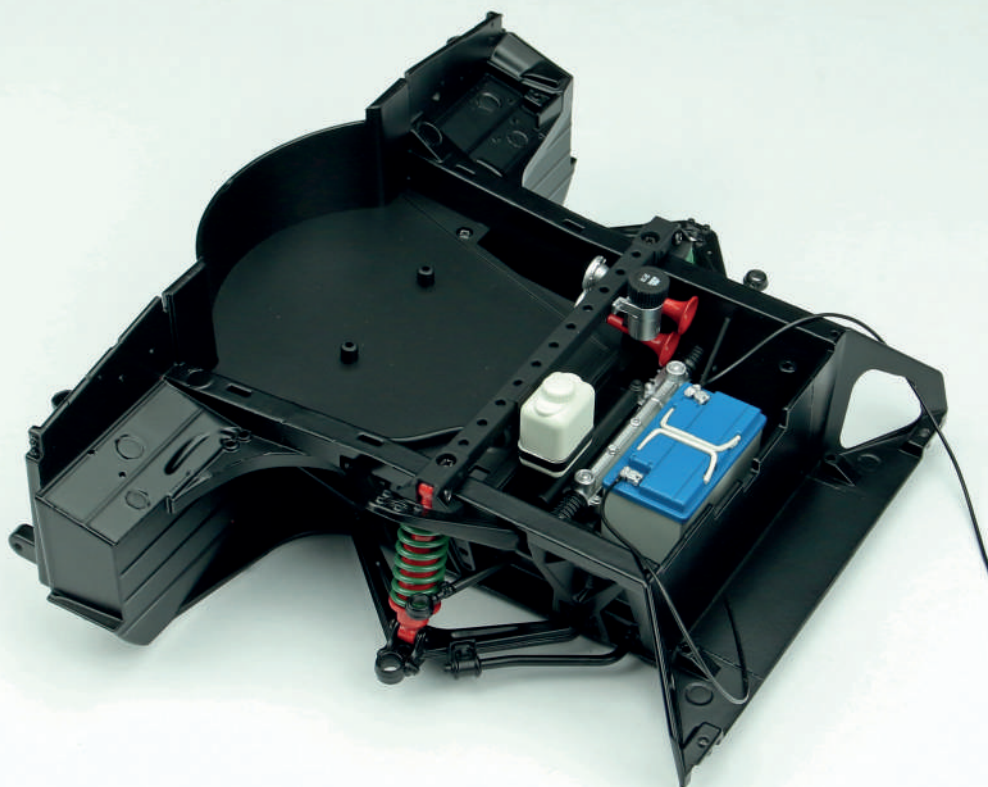

Stage 65: Assembling the Wheel Hubs and the Front Left Brake Disc

In this stage you'll fit the two halves of the front left brake disc together and prepare the front wheels hubs for fitting to the suspension.



STAGE 65 PARTS LIST

Name
Angle drive (right)
Front right wheel hub
Front left wheel hub
Angle drive (left)
Type F screws x5

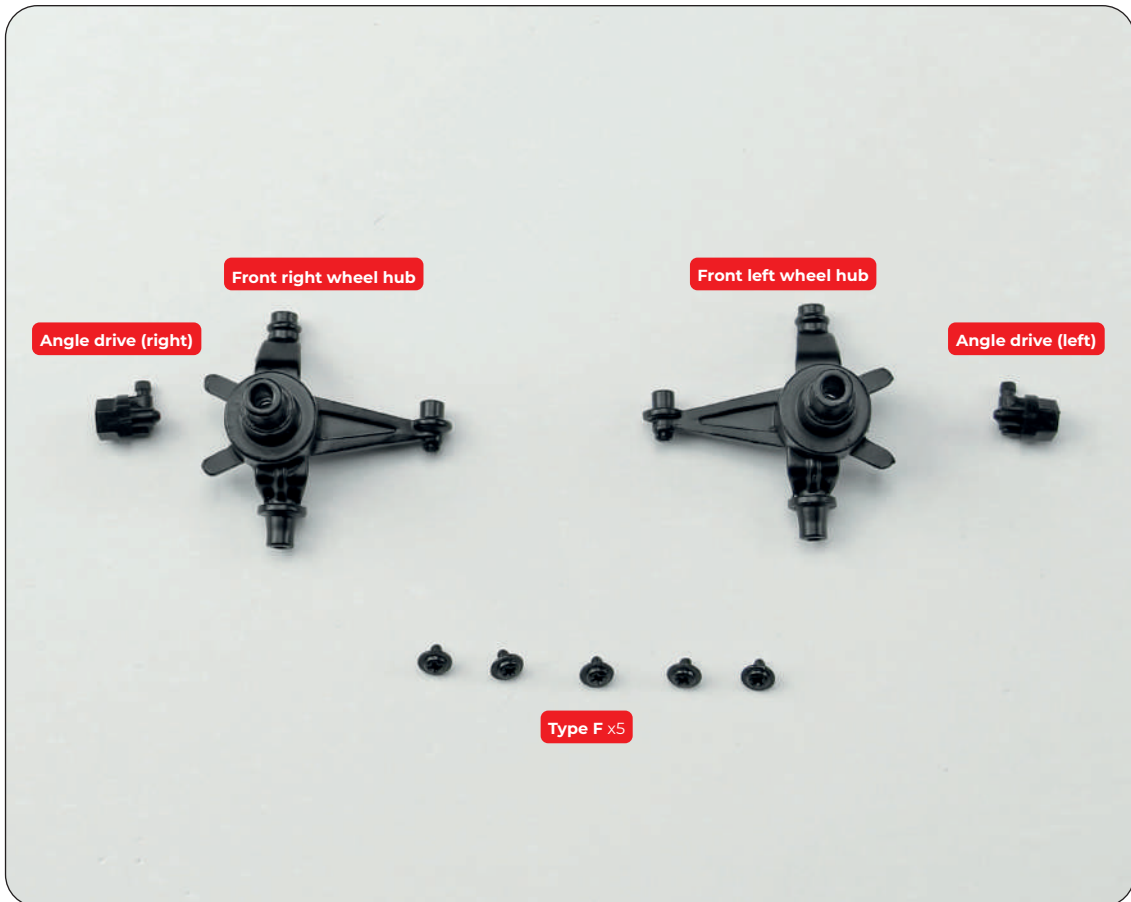

Stage 65: Assembling the Wheel Hubs and the Front Left Brake Disc

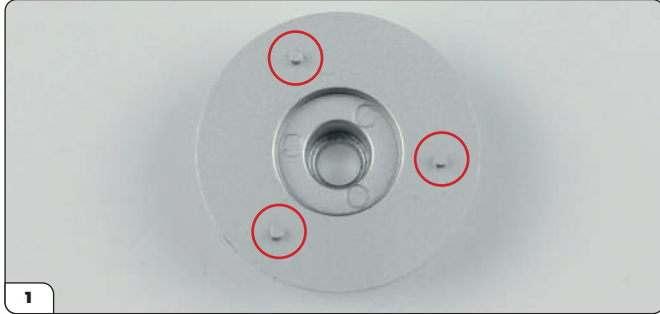
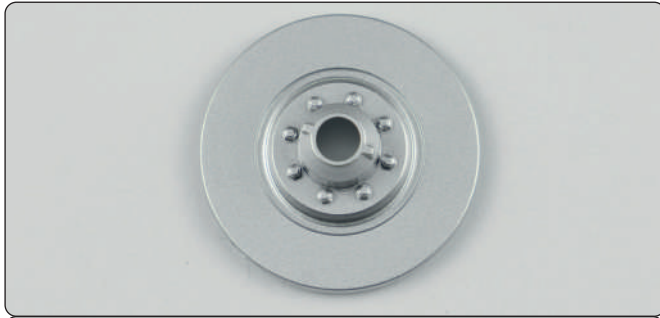

Take the outer half of the front left brake disc supplied with Stage 64 and place it on the work surface. Turning it over, you will see three mounting pins (circled).

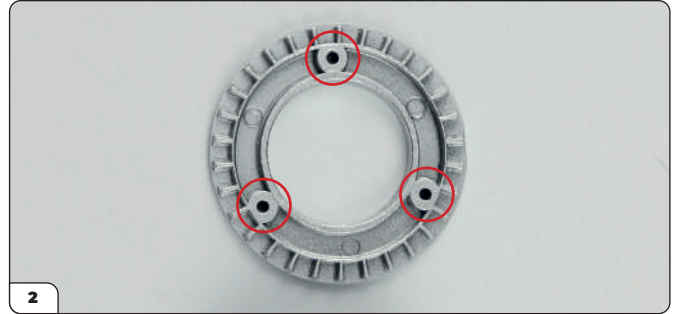

The inner half of the front left brake disc (Stage 64) has a flat surface on one side and three holes on the other side (circled).

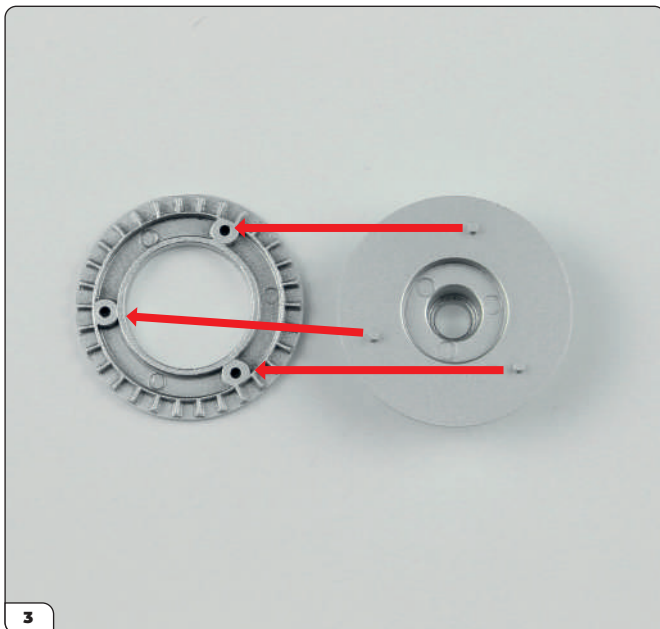

Press the pins into the holes to fit the two halves together.



Check the fit is flush around the sides of the disc.

Stage 65: Assembling the Wheel Hubs and the Front Left Brake Disc



The brake caliper comes in two halves, which will be used in a later stage. Keep them stored away safely for now. You may wish to use the bag marked with the letter L that contains the front left wheel hub after unpacking it in the next step.

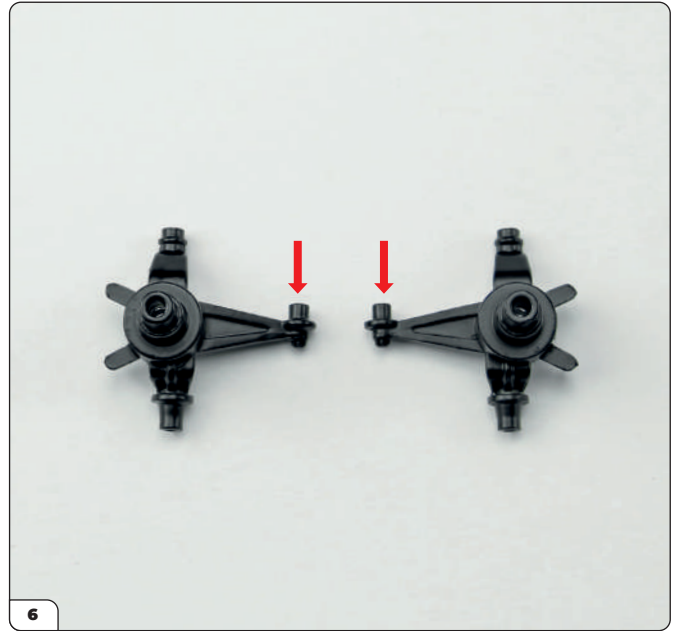

Now take the wheel hub components supplied with this stage. The front right wheel hub components are contained in bags marked with the letter R (right), those of the front left wheel in bags with the letter L (left). Keep in mind that the longer ends of the hubs (arrows) will be joined to the steering arms and therefore must be facing the front of the model.



Take the front left wheel hub with the inside facing you as shown.



Press the left angle drive into the centre of the hub, orienting it in the direction shown in the photo.

Stage 65: Assembling the Wheel Hubs and the Front Left Brake Disc

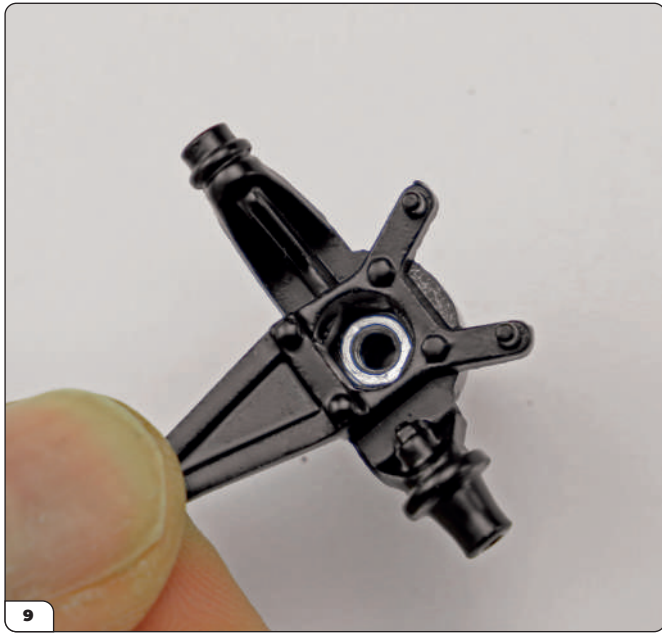

Now take the right wheel hub and face it towards you as shown.



Press the right angle drive into the centre in the orientation shown.

STAGE COMPLETE



Stage 66: Fitting the Front Wheel Hubs

In the final stage of this pack, you'll fit the front wheel hubs to the suspension and connect them to the steering rack. You can store the parts supplied until they are needed in a later stage.



STAGE 66 PARTS LIST

Name
Front right brake disc (outer)
Front right brake disc (inner)
Front right brake caliper (outer)
Front right brake caliper (inner)

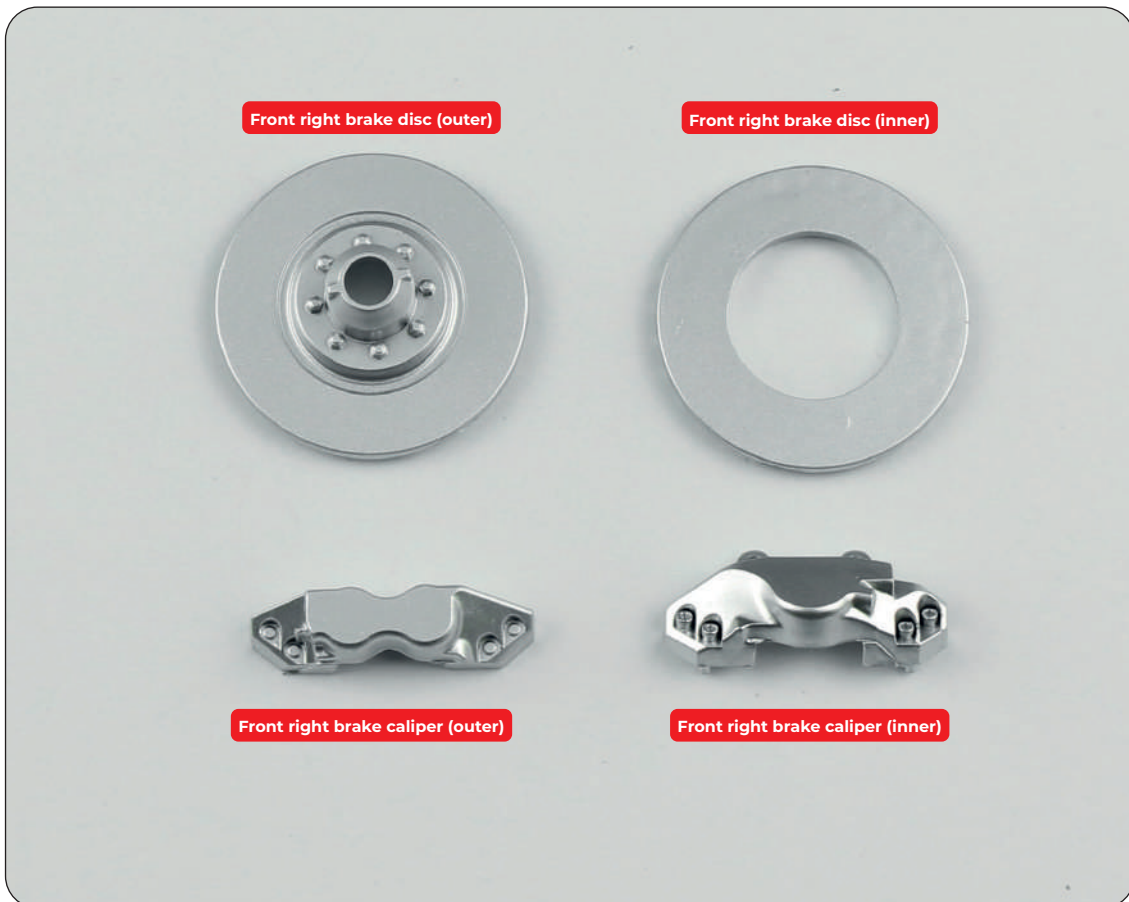

Stage 66: Fitting the Front Wheel Hubs

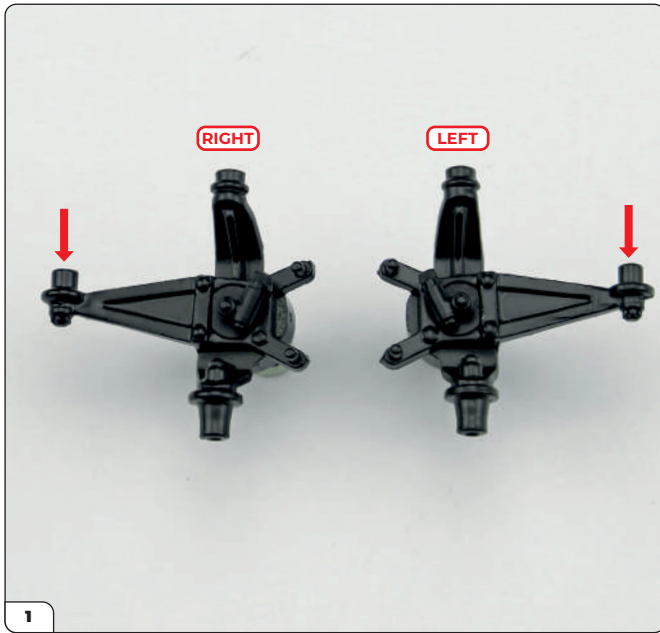

Take the two front wheel hubs from the previous stage. Place them on the work surface as shown and identify the left from the right hub. Note the connection points for the steering rack (arrows) are facing upwards in the photo.



Retrieve the front frame assembly and place it on the work surface with the right-hand side facing you. Align the front right wheel hub with it as shown. Note the column and hole indicated by the arrows.

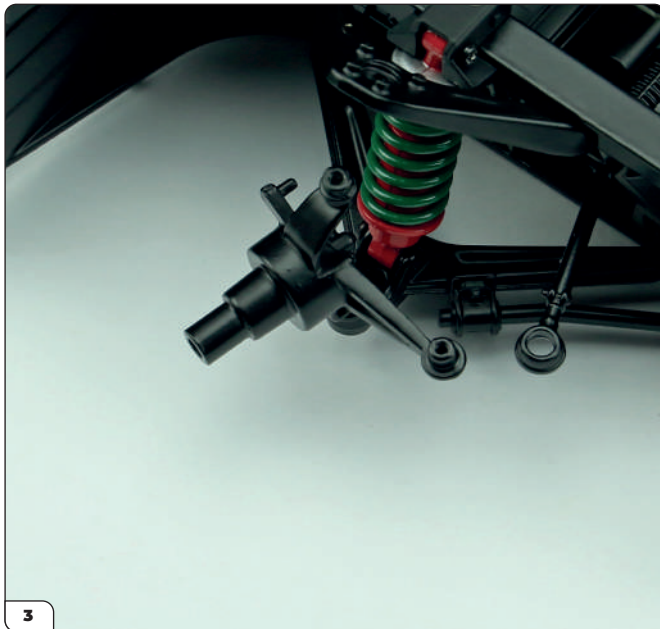

Lift the upper wishbone out of the way and slot the wheel hub into the lower wishbone by inserting the column into the hole (highlighted in the previous step).

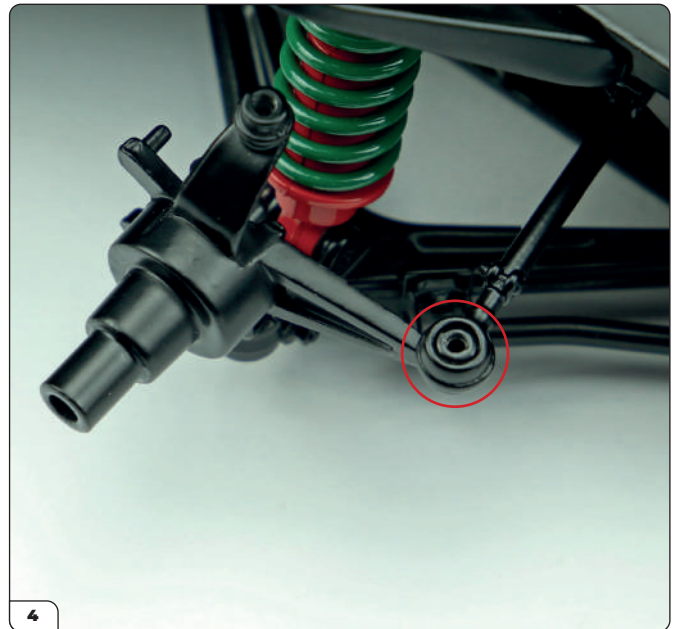

Connect the steering arm to the wheel hub (circled).

Stage 66: Fitting the Front Wheel Hubs

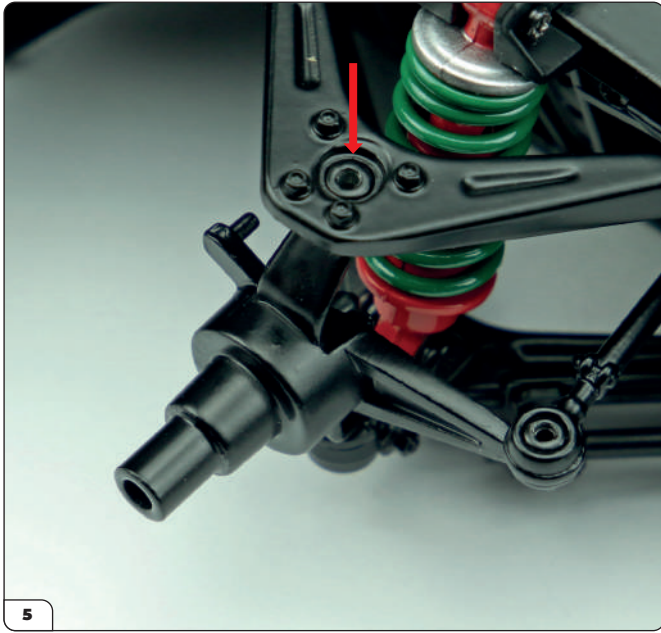

Lower the upper wishbone onto the top of the wheel hub (arrow).

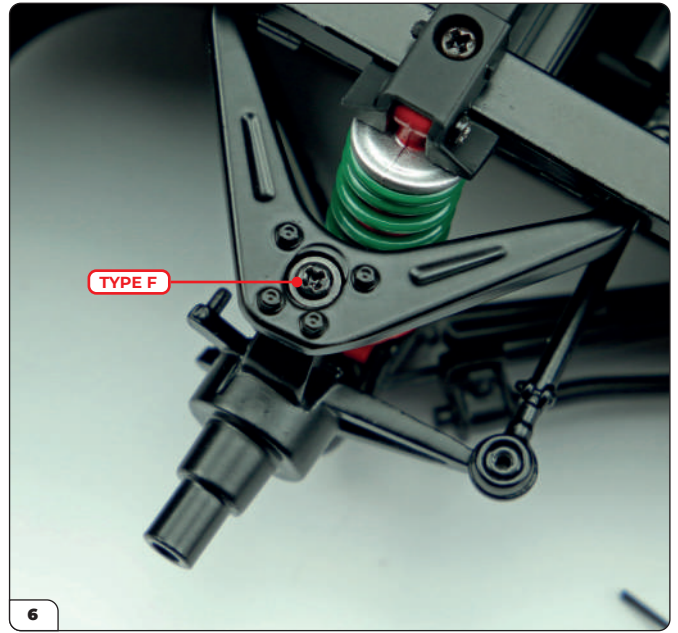

Drive a type F screw (supplied with Stage 65) into the hole at the top of the wheel hub. Don't overtighten the screw as the hub needs to move freely for the steering to function.

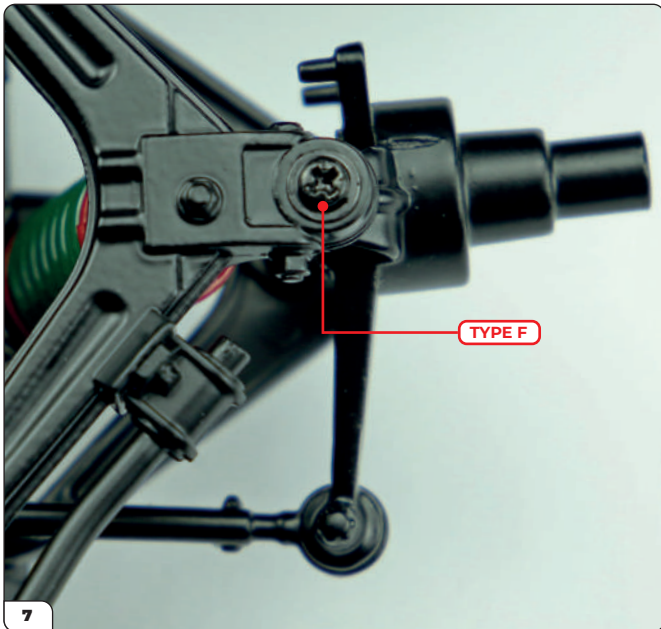

Turn the assembly over and fix the bottom of the wheel hub using a type F screw. Again, don't overtighten the screw.

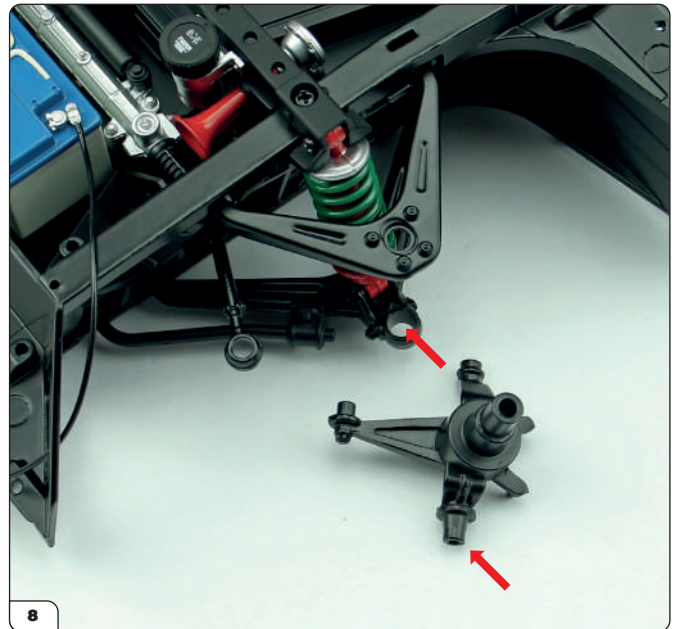

Turn the frame back over and face the left-hand side towards you. Align the front left wheel hub with it as shown. Note the column and hole indicated by the arrows.

Stage 66: Fitting the Front Wheel Hubs

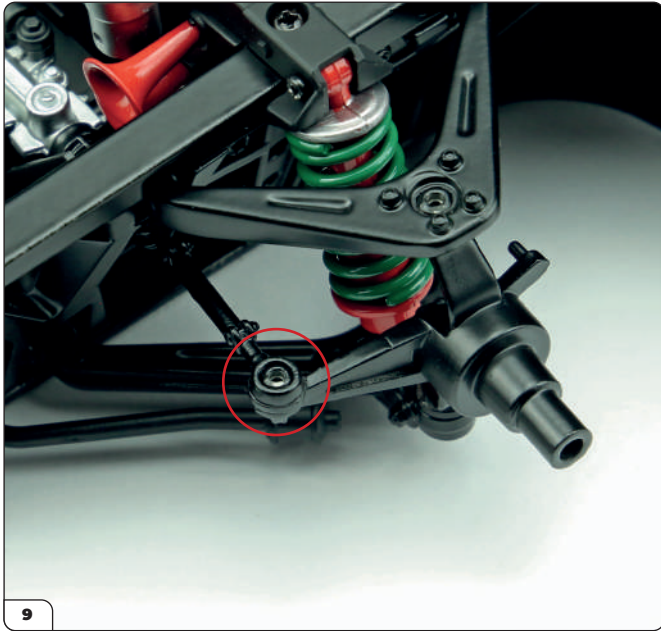

Insert the wheel hub in place in the same manner as you did before, then connect the steering arm to the wheel hub (circled).

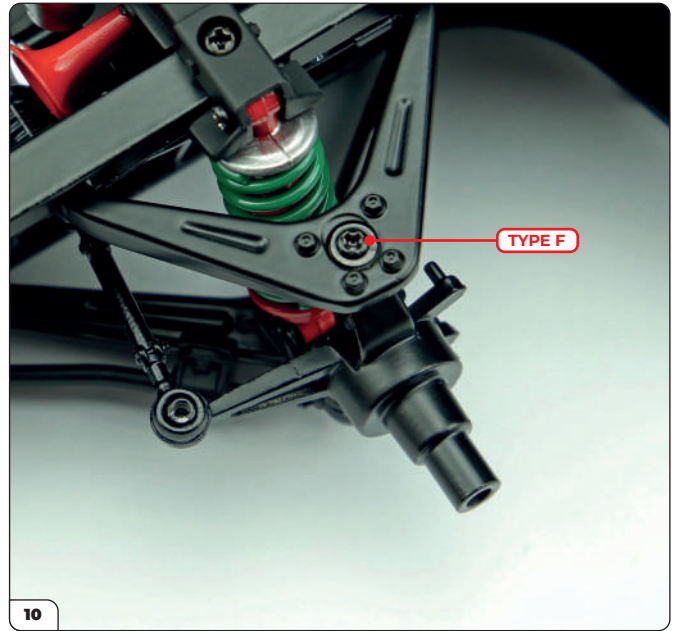

Fix the top of the wheel hub using a type F screw (Stage 65).

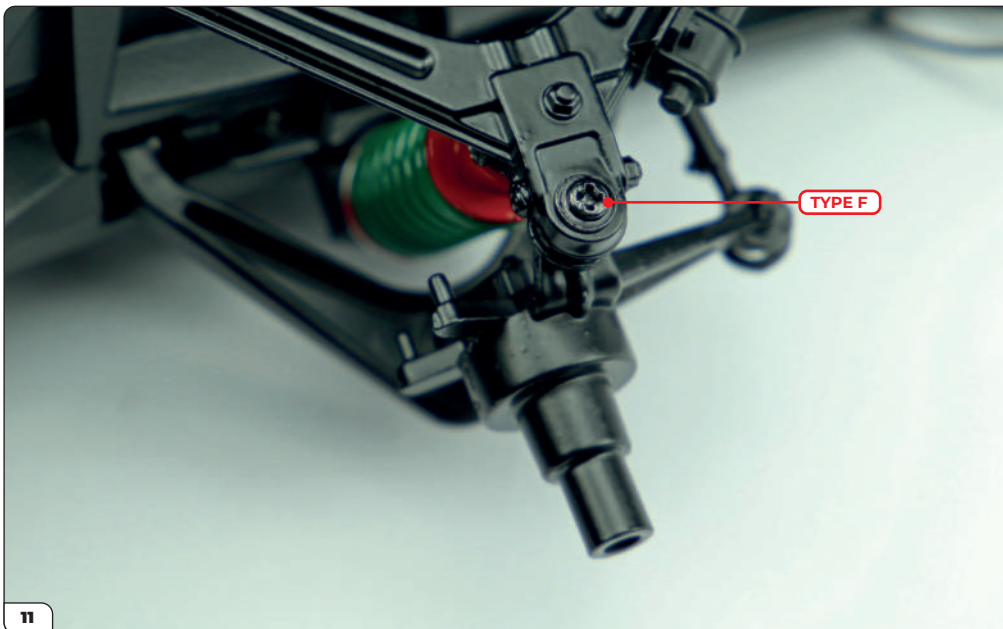

Then turn the assembly over and fix the bottom of the wheel hub using another type F screw (stage 65).

Stage 66: Fitting the Front Wheel Hubs

