



E-TYPE



Pack 08

BUILD INSTRUCTIONS

STAGE 57: REAR RIGHT WHEEL

STAGE 58: COCKPIT FLOOR

STAGE 59: TRANSMISSION TUNNEL

STAGE 60: DRIVER'S CONTROLS

STAGE 61: BRAKE LIGHT SWITCH
AND SEAT CUSHION

STAGE 62: INSTALLING THE SEATS

STAGE 63: DASHBOARD

STAGE 64: DASHBOARD INSTRUMENTS
AND STEERING WHEEL COLUMN

Advice from the experts

Spare screws are included with each part. Occasionally, you may be instructed to keep spare or unused screws for a later stage. Keep these spares in a safe place and label them correctly.

Please make sure you don't mix up the screws. They look quite similar, but the threads do vary slightly. Using the wrong screws may damage the parts.

When securing parts together using multiple screws, fit each screw loosely to ensure all the parts are correctly aligned before gently tightening them firmly, but not overtight, in the order in which you placed them.

The screwdriver can be magnetized by stroking it with a magnet (fridge magnet, etc.) enabling it to hold the screws and make assembly easier.

If a screw is tight going into a metal part, do not force it as you may shear the head off. Remove it and put a tiny smear of Vaseline, soap or light oil on the thread. That will lubricate it and make it easier to drive home.

During the course of this build, you will receive many pieces that you will assemble immediately – following the instructions in the corresponding stage – and other pieces that you should store safely to one side, for use in future assembly stages.

Left and Right! When building your Jaguar, the left or right hand side refers to each side as you are sitting in the car.



WARNING: Some parts are assembled using magnets. These magnets can cause serious injury if they are swallowed. Keep away from children. If you suspect a magnet has been swallowed, seek medical help straight away.

Stage 57: Right Rear Wheel

In this first stage you'll fit the tyre onto the right rear wheel and attach it to the subframe assembly built in Pack 06.



STAGE 57 PARTS LIST

Name
Tyre
Washer
Screws type AM07 x2



Stage 57: Right Rear Wheel

STEP 1



Take the completed wheel from Stage 56. Prepare a hot water bath by filling a small bowl with boiling water. Soak the tyre in the water for 2 minutes.

Note: The tyre shown in pictures 1-4 is the spare tyre from Stage 25, and differs slightly in the tread pattern from the tyre supplied in this Stage. The method for fitting the tyre is the same.



Carefully remove the tyre from the water bath using tongs or tweezers - the tyre will be very hot! Shake off any excess water and dab on kitchen paper or a towel.



Working quickly while the tyre is pliable, push the wheel into the tyre and twist to fit the outer wheel rim under the inner rim of the tyre.

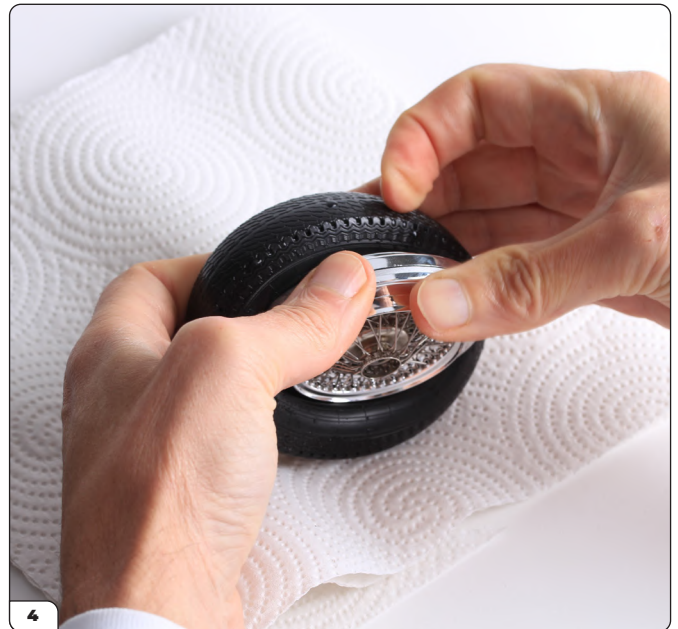

Keep pushing and pulling, working around the tyre, until the side walls fit comfortably over the wheel rim on both sides.

Stage 57: Right Rear Wheel



The tyre has now been fully fitted to the wheel and is now ready to fix to the front subframe assembly from Stage 48.



Prepare the front subframe assembly and right rear wheel.

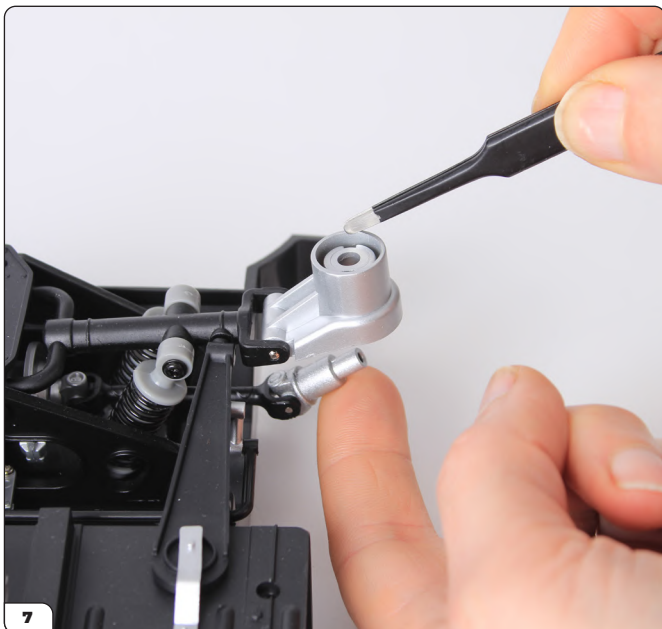

Lift up the right-hand hub carrier and insert the universal joint into the hub carrier (see picture 8).



The universal joint and hub carrier should look like this.

Stage 57: Right Rear Wheel



Holding the wheel as shown, align the two lugs on the wheel centre with the two notches in the right hub carrier. Position the wheel in place, ensuring the lugs fit into the notches.

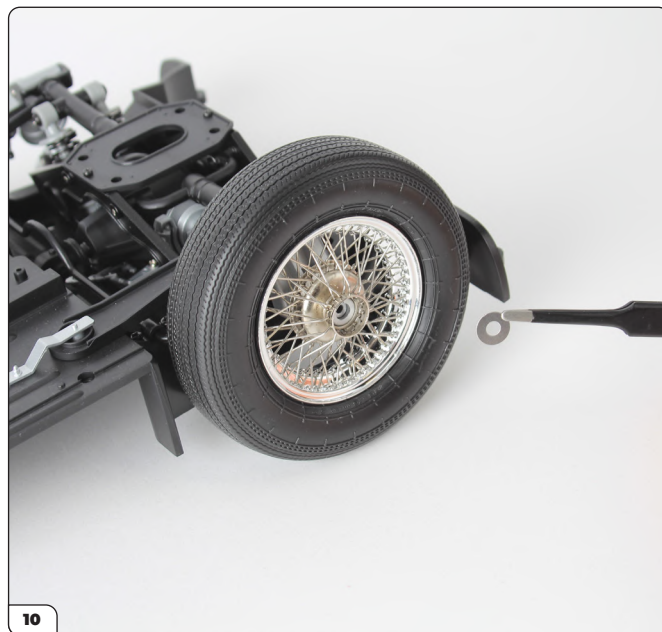

Take the washer and place it into the wheel centre.

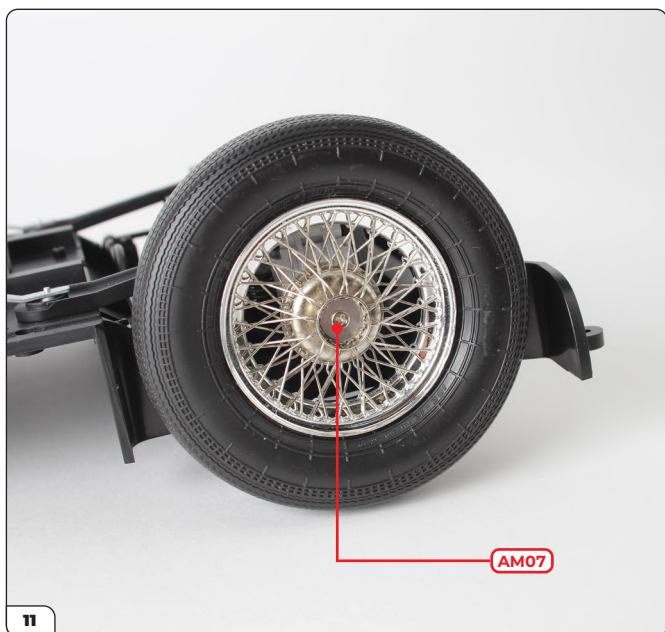

Secure the washer and right wheel in place using a type AM07 screw.

Stage 57: Right Rear Wheel

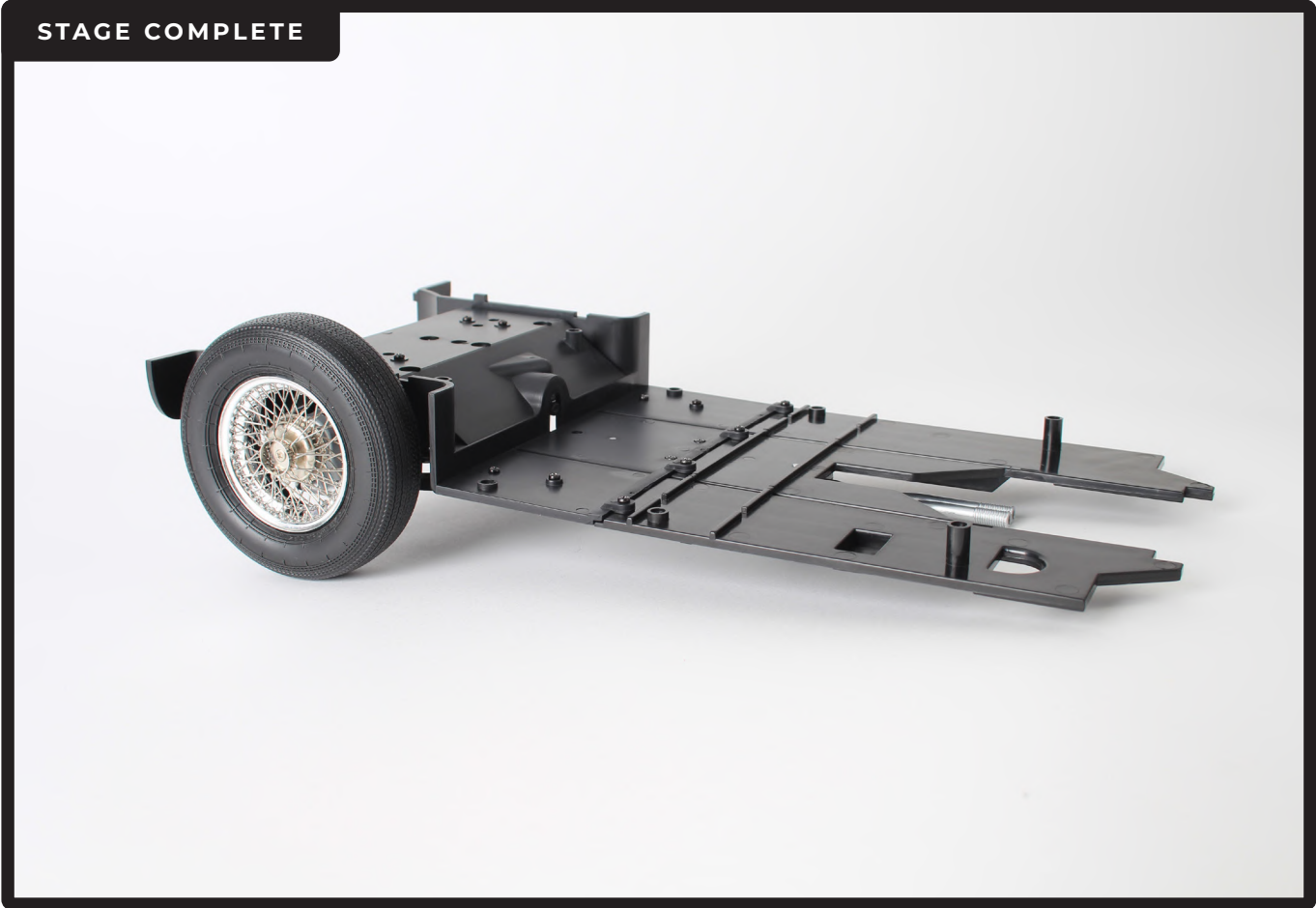

Stage 58: Cockpit Floor

In this next stage you'll start to build the cockpit floor by installing the switch that controls the electrical system.



STAGE 58 PARTS LIST

Name
Cockpit floor
Microswitch

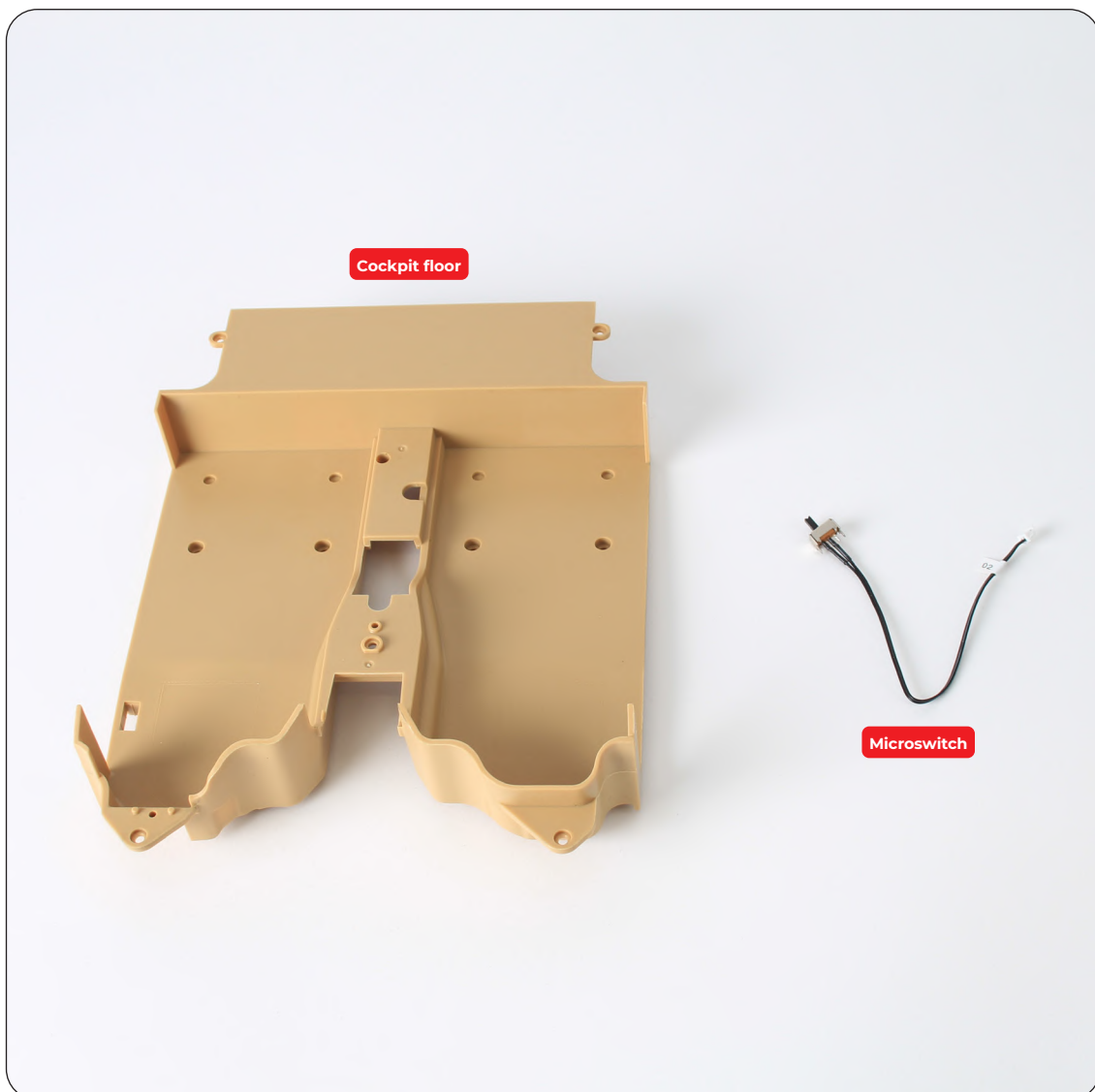

Stage 58: Cockpit Floor

STEP 1

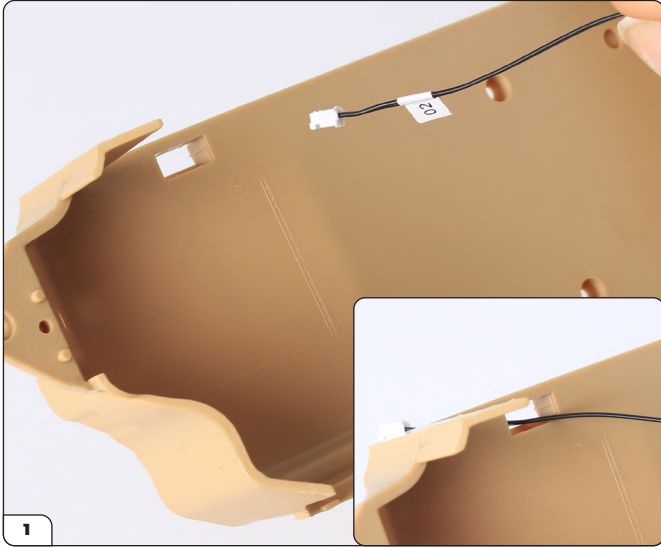

Take the cockpit floor and locate the rectangular hole. Pass the white plug end of the microswitch through the hole (inset).

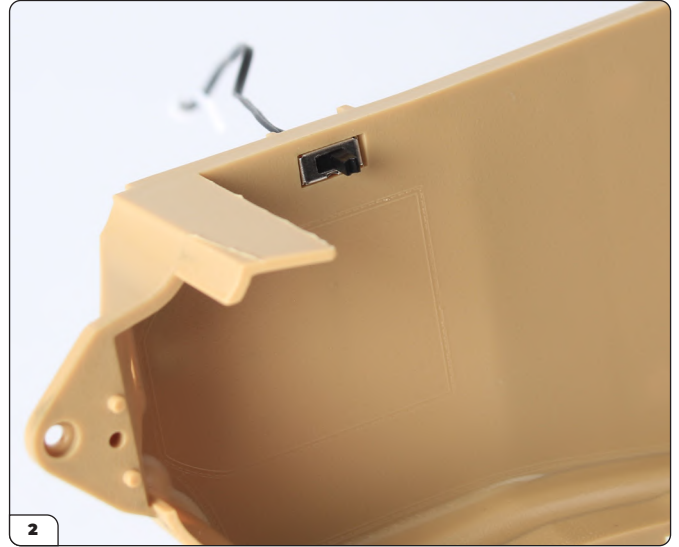

Feed the cable through the opening and press the switch into the rectangular hole until it is flush.

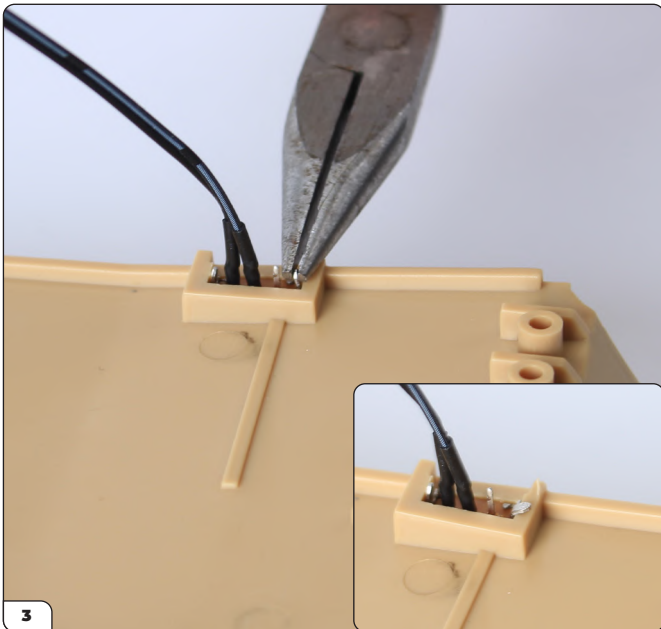

Turn over the cockpit floor. Using a pair of long-nosed pliers, bend one of the protruding tabs over the side of the hole (see inset)

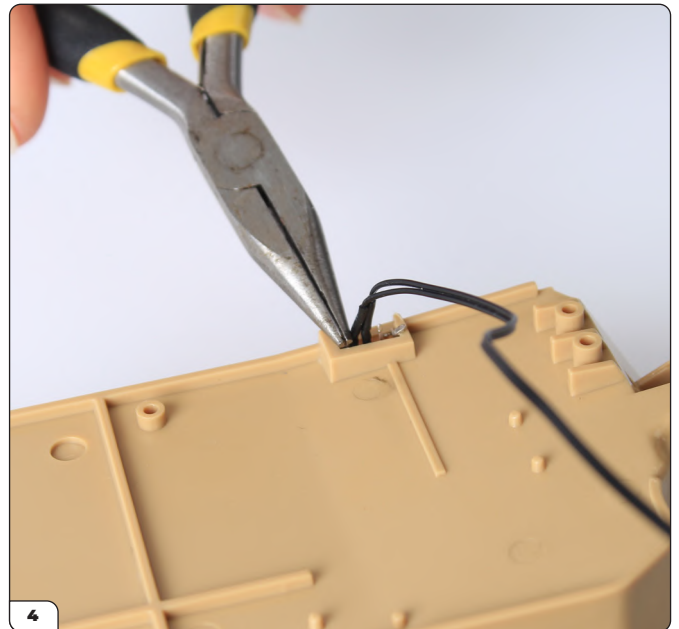

Bend the other tab in the same way to secure the microswitch in place.

Stage 58: Cockpit Floor

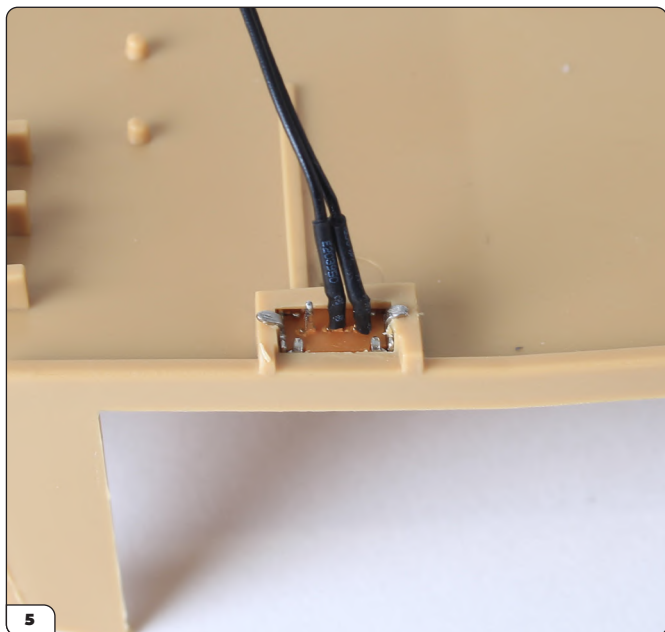

The tabs should now look like this.

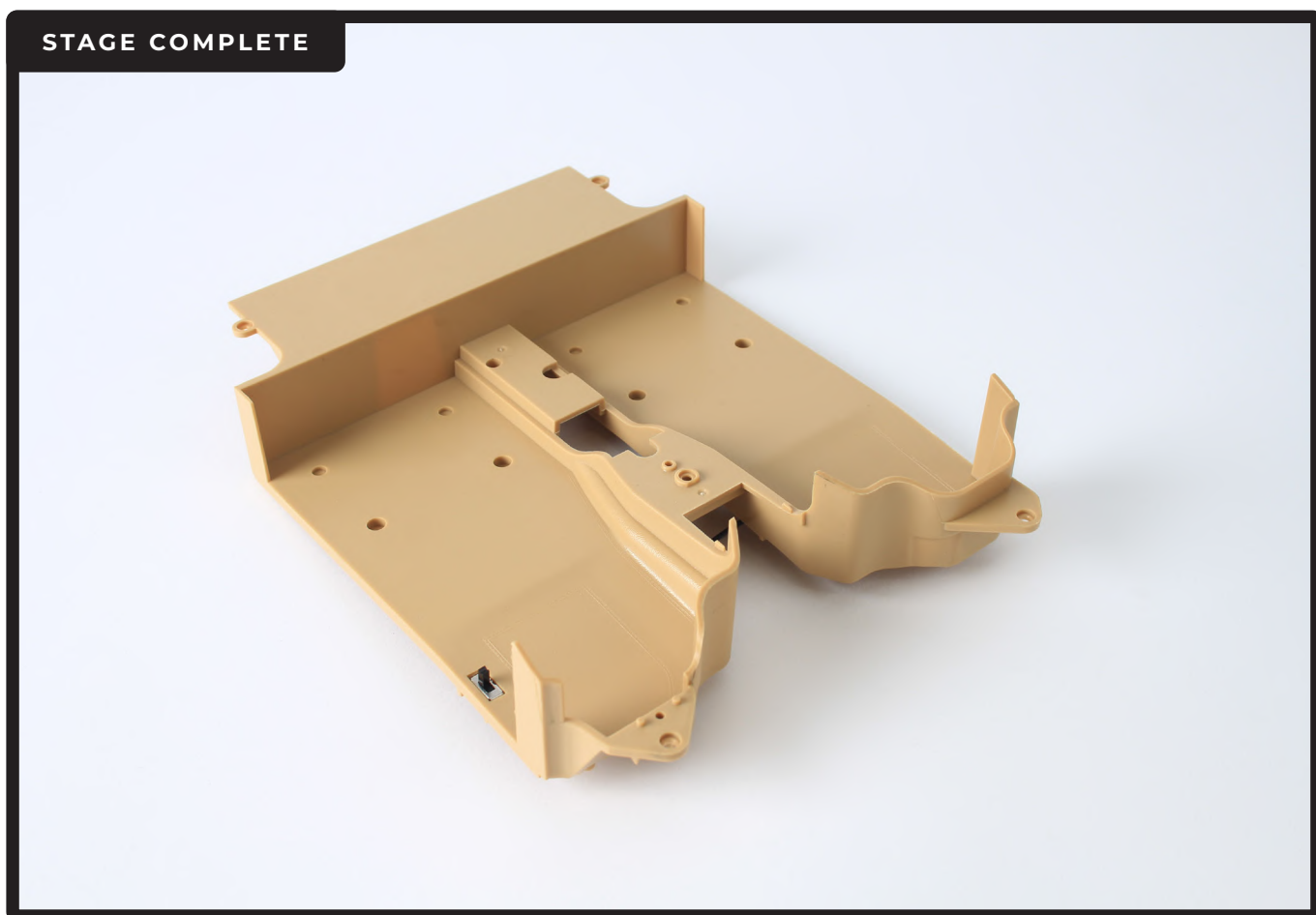

Stage 59: Transmission Tunnel

In this next stage you'll continue to add components to the cockpit by assembling and attaching the speakers and radio to the transmission tunnel.



STAGE 59 PARTS LIST

Name
Transmission tunnel
Speaker mount (left)
Speaker mount (right)
Radio
Speaker grilles (x2)
Speaker bezels (x2)
Radio controls
Screws type AG05 x2

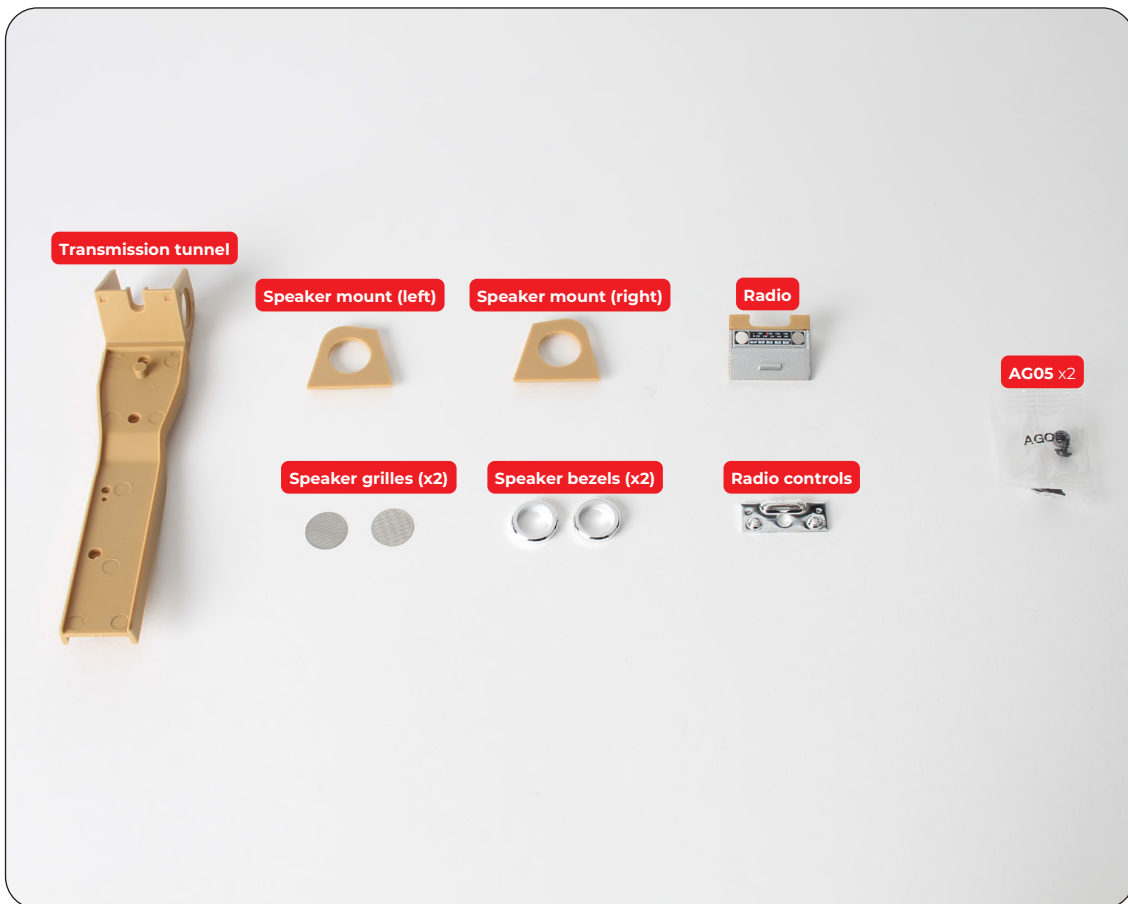

Stage 59: Transmission Tunnel

STEP 1

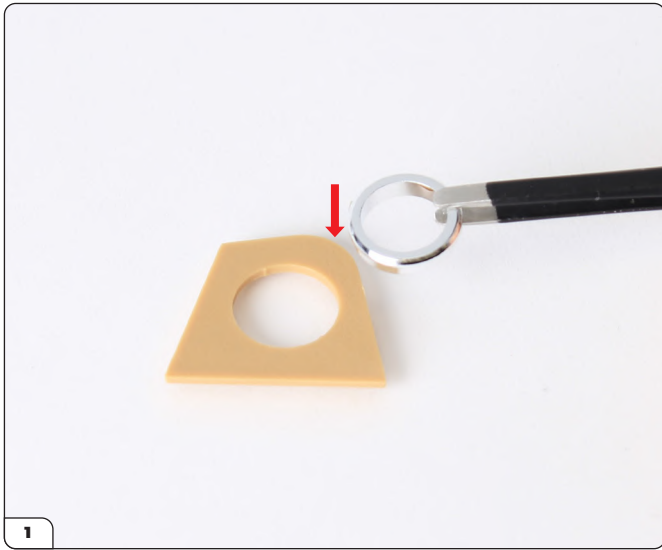

Take the right speaker mount (with the rounded corner in the top right, arrow) and one of the speaker bezels. Align the bezel with the mount as shown.



Press the bezel into the mount, until the lip of the bezel is firmly against the surface.

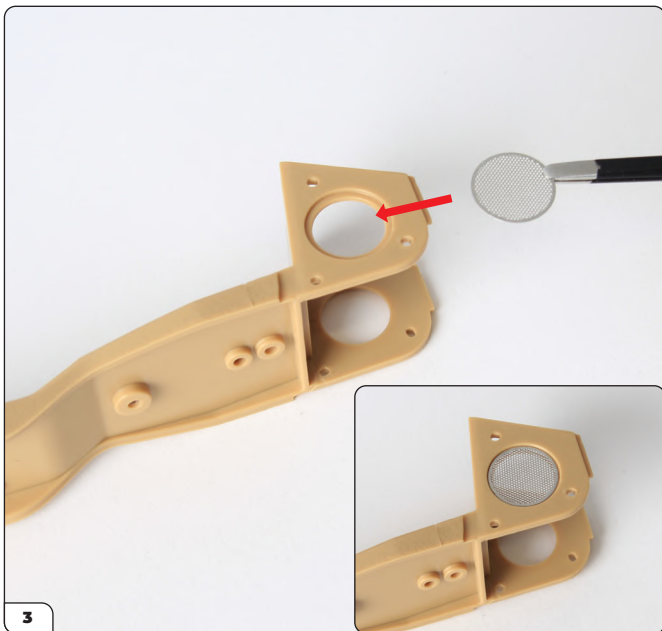

Place the transmission tunnel on its side, as shown. Take one of the speaker grilles and lay it into the recess (see inset).

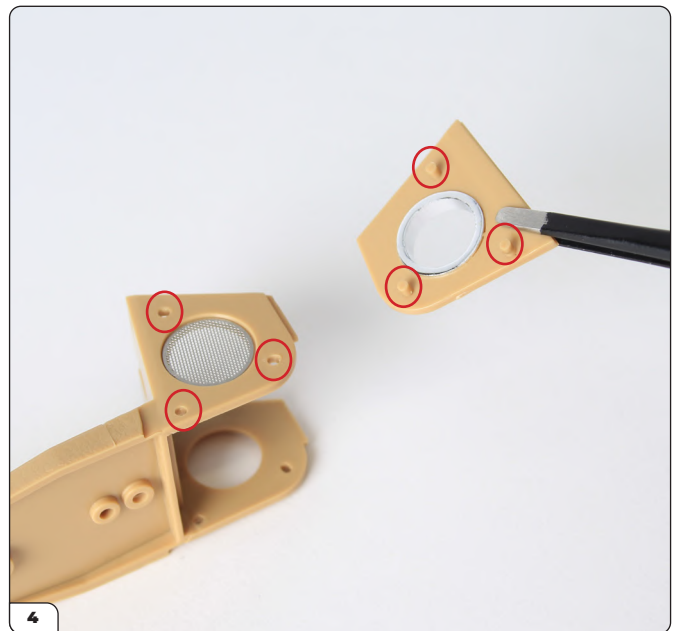

Align the right speaker mount with the transmission tunnel. Note the three pins on the speaker mount (circled) and line them up with the holes on the transmission tunnel (circled).

Stage 59: Transmission Tunnel

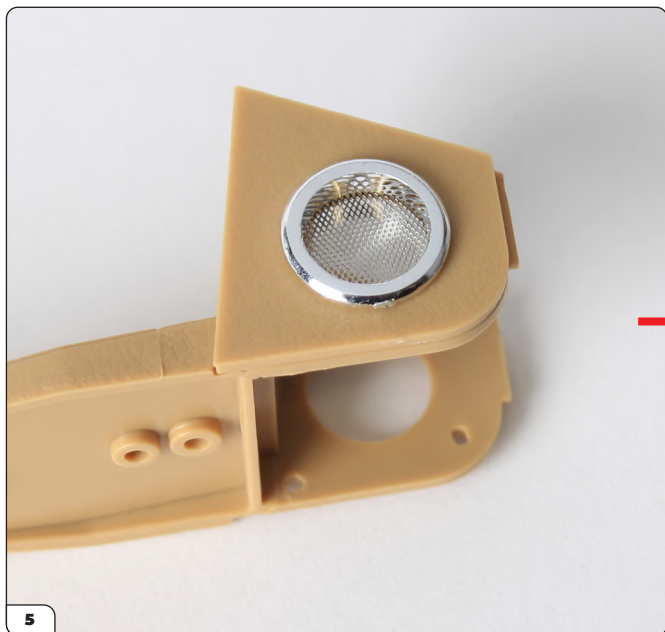

Press the speaker mount into the transmission tunnel so that the bezel covers the grille.

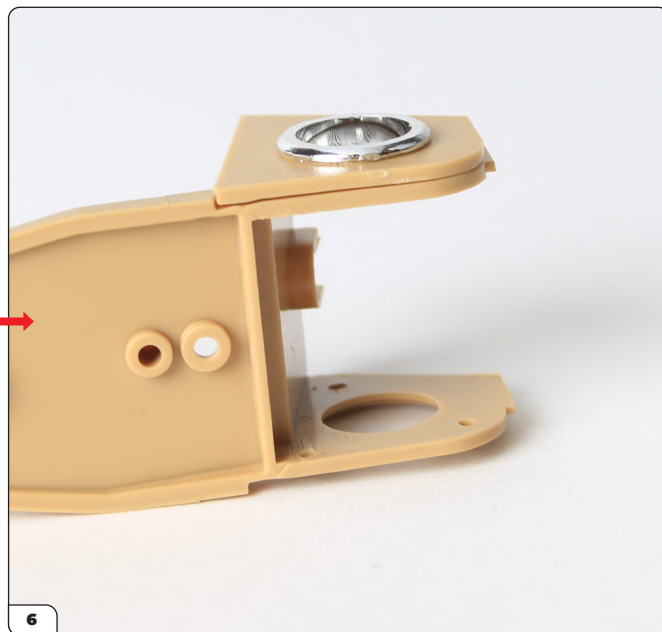

Check that the fit is flush all the way round.



Next take the left speaker mount and the remaining bezel.



Press the bezel into the speaker mount as you did before.

Stage 59: Transmission Tunnel

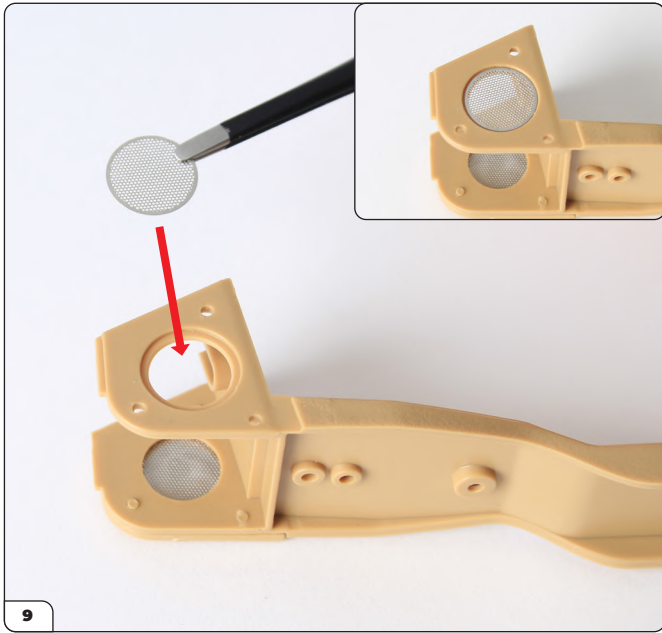

Turn the transmission tunnel over onto its other side. Lay the remaining speaker grille in place (inset).



Take the left speaker mount and align its pegs with the holes on the transmission tunnel, in the same way as before.



Press the speaker mount firmly in place, checking it is flush with the transmission tunnel.

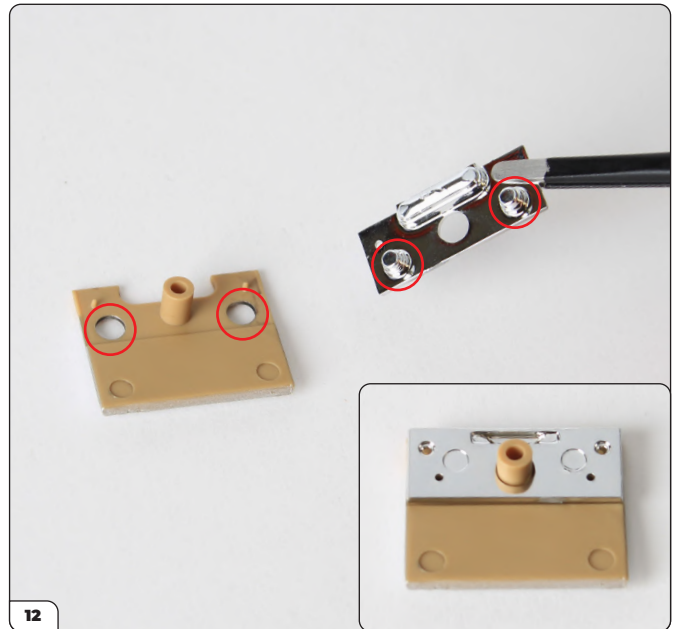

Next take the radio and lay it flat so the lug is facing up as shown. Take the radio controls and fit the knobs and display into the corresponding holes (circled). The inset shows how the back of the radio should look once the controls are in place.

Stage 59: Transmission Tunnel



The front of the radio should look like this, with the knobs and display protruding through.

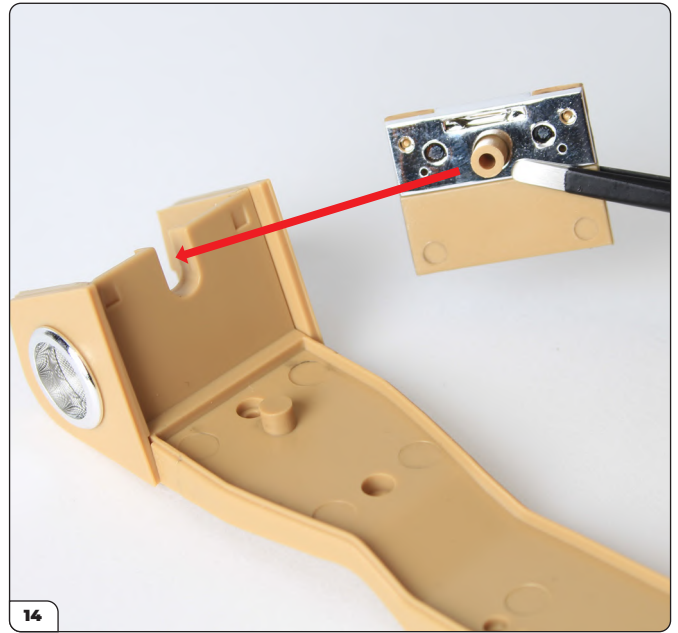

Align the radio assembly with the transmission tunnel assembly as shown. Slide the lug on the radio assembly into the U-shaped slot on the transmission tunnel.



The assembly should look like this when fitted.

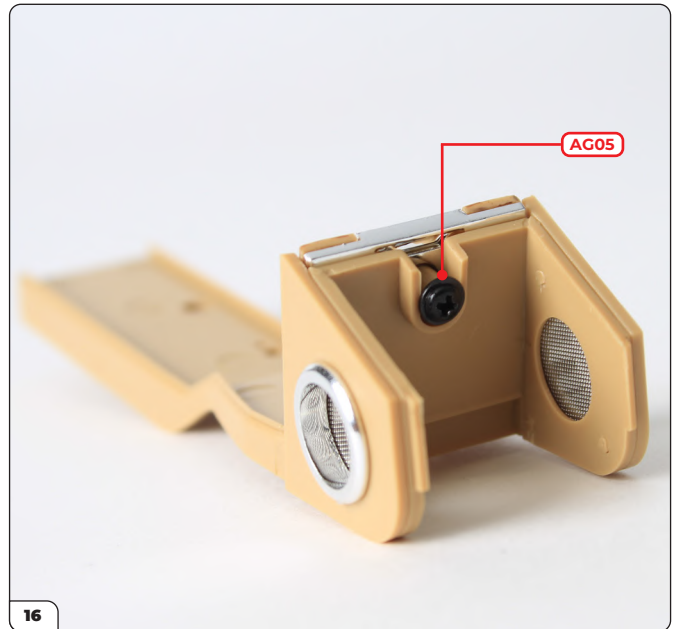

Turn the assembly around and secure the radio in place with 1 x AG05 screw.

Stage 59: Transmission Tunnel



Stage 60: Driver's Controls

Next, you'll add the driver's controls to the transmission tunnel before installing it onto the cockpit floor.



STAGE 60 PARTS LIST

Name
Centre console fascia
Gear lever shroud
Foot pedals
Gear lever
Handbrake lever
Screws type AG01 x2
Screws type AG04 x4
Screws type AG06 x5



Stage 60: Driver's Controls

STEP 1



Take the gear lever and gear lever shroud. Fit the shroud onto the gear lever, so that the lug protrudes through the hole and the pins face upwards (inset).

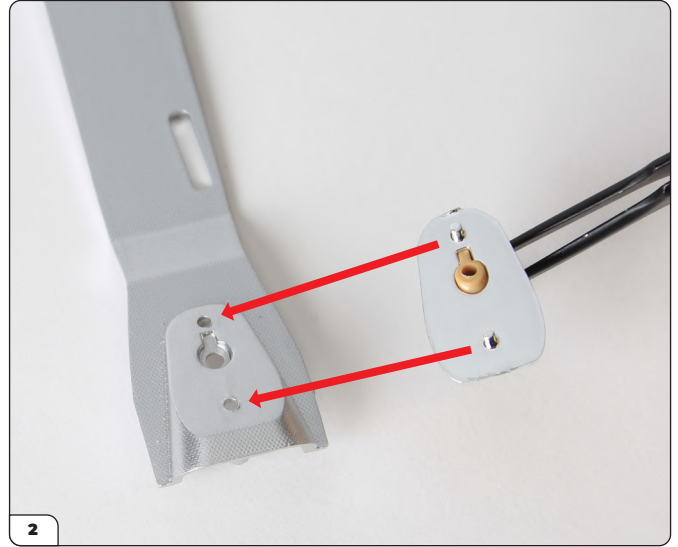

Keeping the shroud in place, align the gear lever with the centre console fascia as shown. Fit the pins on the shroud into the holes of the fascia (arrows), using the keyhole-shaped lug as a guide.



The gear lever should look like this once fitted.

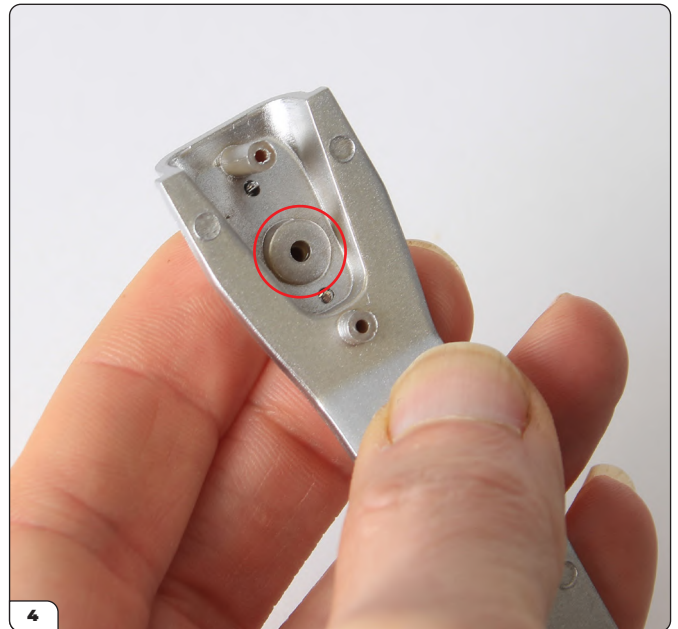

Holding the gear lever in place, turn the centre console fascia over and locate the screw hole (circled).

Stage 60: Driver's Controls

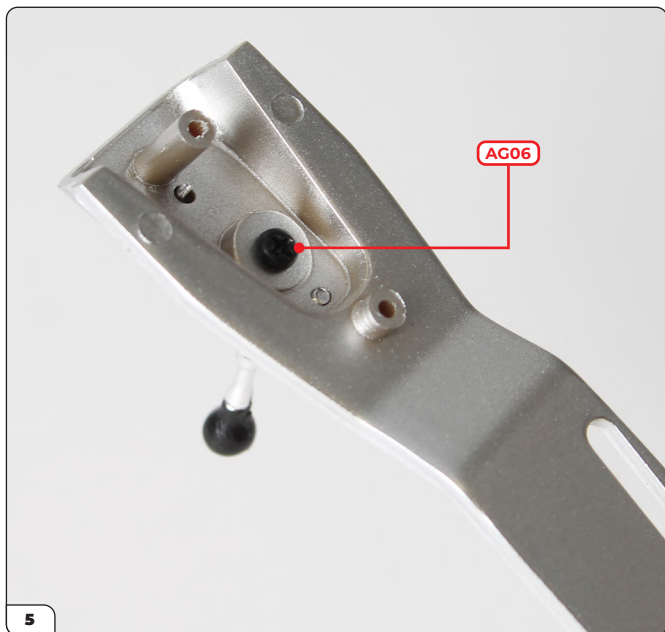

Fix the gear lever in place by driving 1 x AG06 screw into the centre screw hole.

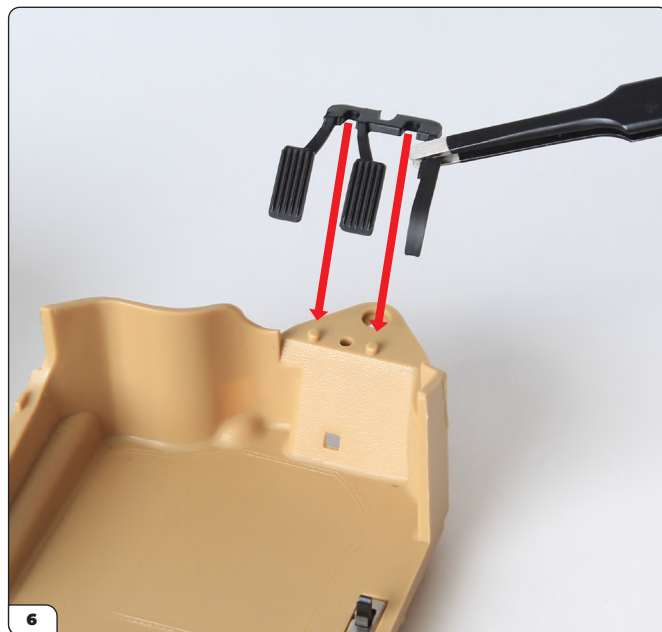

Take the cockpit floor assembly from Stage 58. Align the foot pedals with the cockpit floor as shown. Push the pedals onto the cockpit so that the notches fit over the matching lugs (arrows). Note: a pin on the bottom of the pedals goes into the hole between the two lugs of the cockpit.

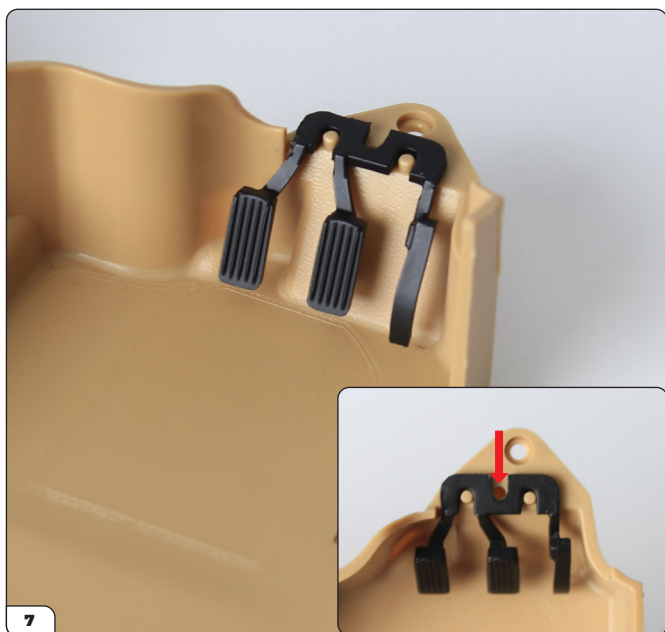

The pedals should look like this when in place. Note the screw hole in the cockpit floor (inset, arrow).

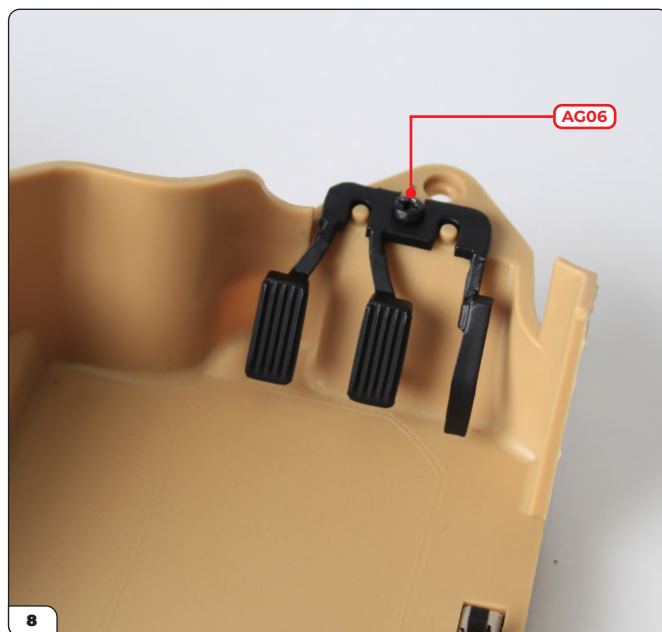

Secure the foot pedals to the cockpit floor using 1 x AG06 screw.

Stage 60: Driver's Controls

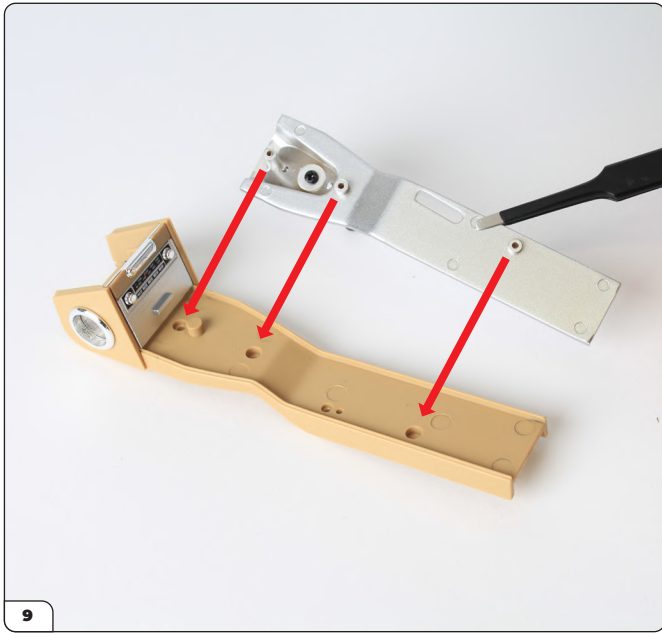

Take the transmission tunnel assembly from Stage 59. Align the centre console fascia with the transmission tunnel as shown. Locate the lugs on the fascia and the corresponding holes on the transmission tunnel (arrows).

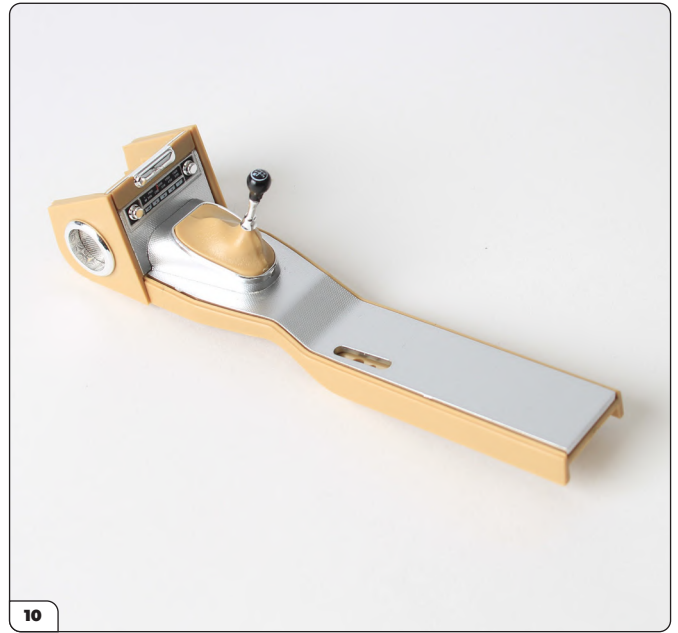

Press the centre console fascia into the transmission tunnel, ensuring that the fit is flush.

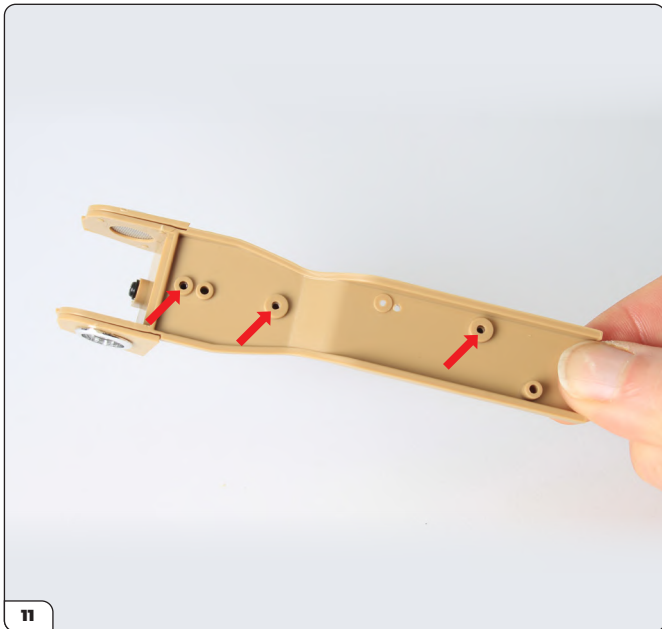

Turn the transmission tunnel over, and locate the three screw holes (arrows).

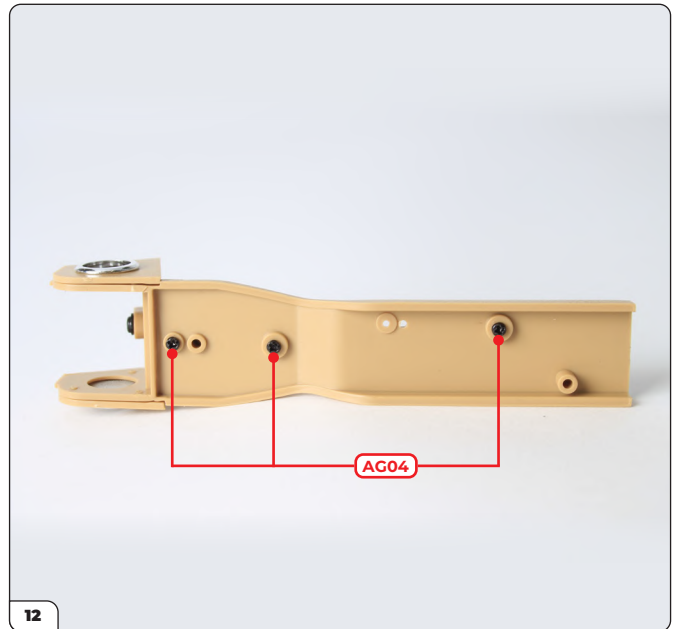

Secure the centre console fascia in place using 3 x AG04 screws.

Stage 60: Driver's Controls

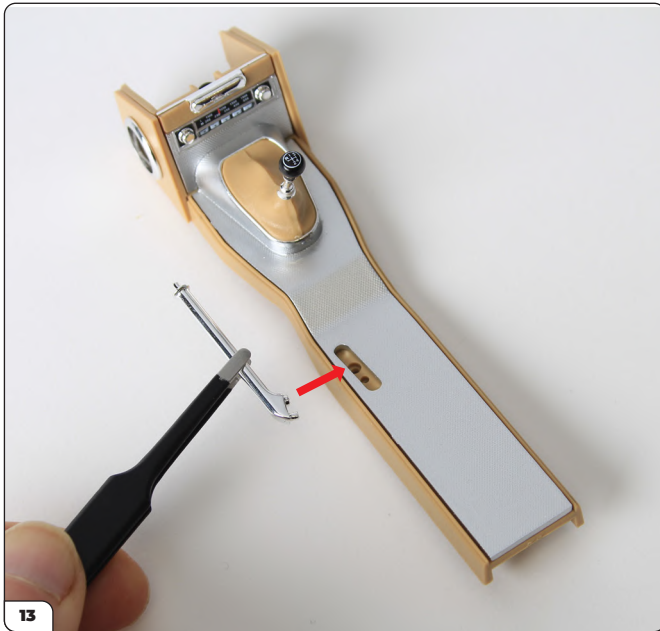

Take the handbrake lever and align it with the centre console assembly as shown. Note the larger lug on the handbrake lever and the corresponding larger hole in the centre console assembly (arrow).



Press the handbrake lever into the centre console assembly.



Holding the handbrake lever in place, turn the centre console over and locate the screw hole from the handbrake lever's lug (arrow).

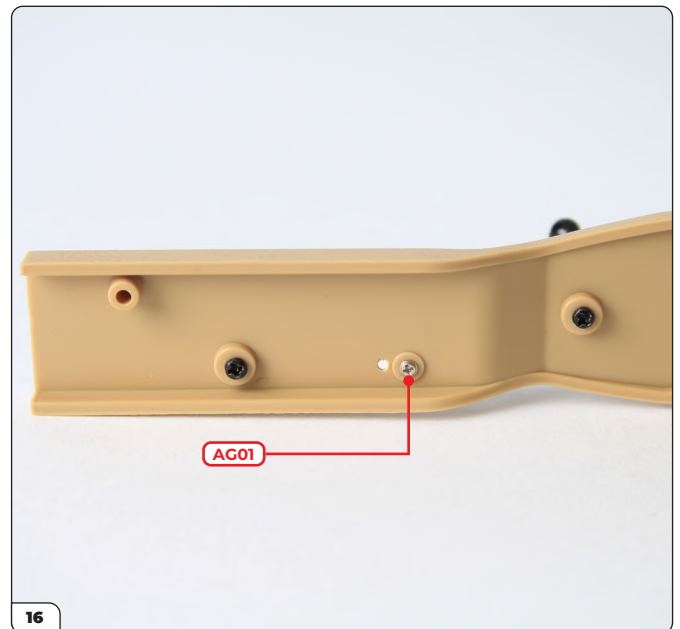

Secure the handbrake lever in place with 1 x AG01 screw.

Stage 60: Driver's Controls

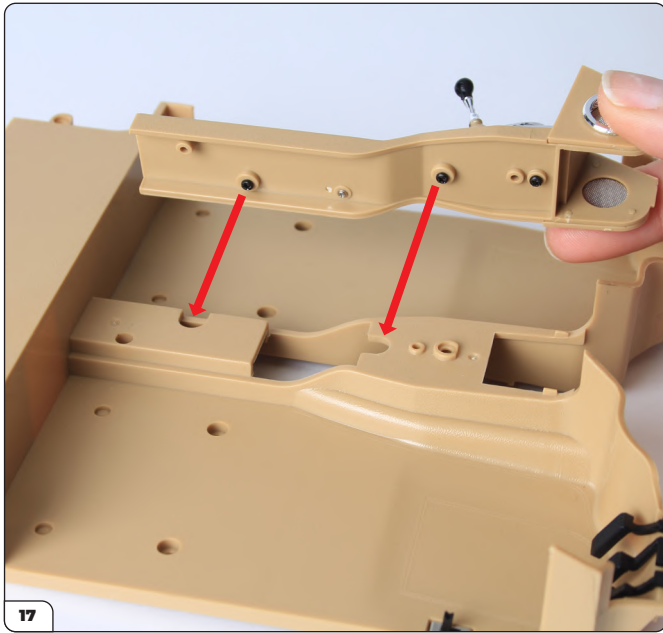

Align the centre console assembly with the cockpit floor as shown. Use the two screws in the centre console that fit into the two notches on the cockpit floor as a guide (arrows).

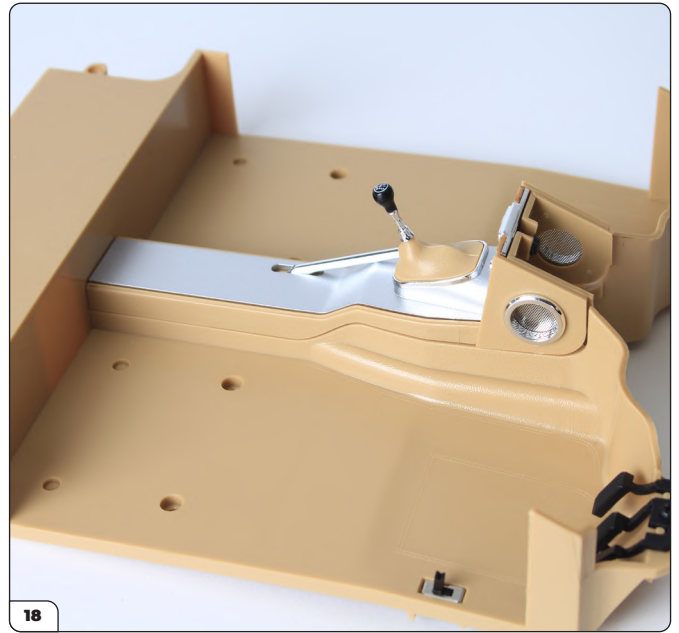

Press the centre console assembly into place as shown, ensuring it fits flush with the cockpit floor.

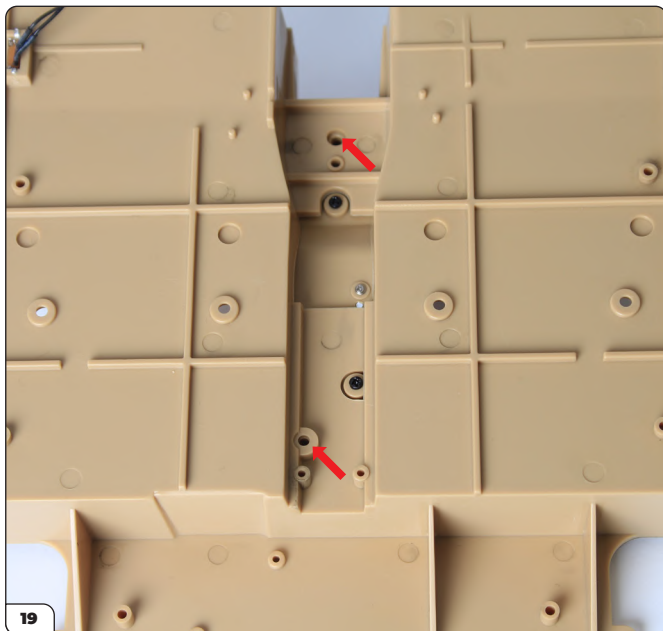

Holding the centre console assembly in place, turn the cockpit floor over and locate the two screw holes (arrows).

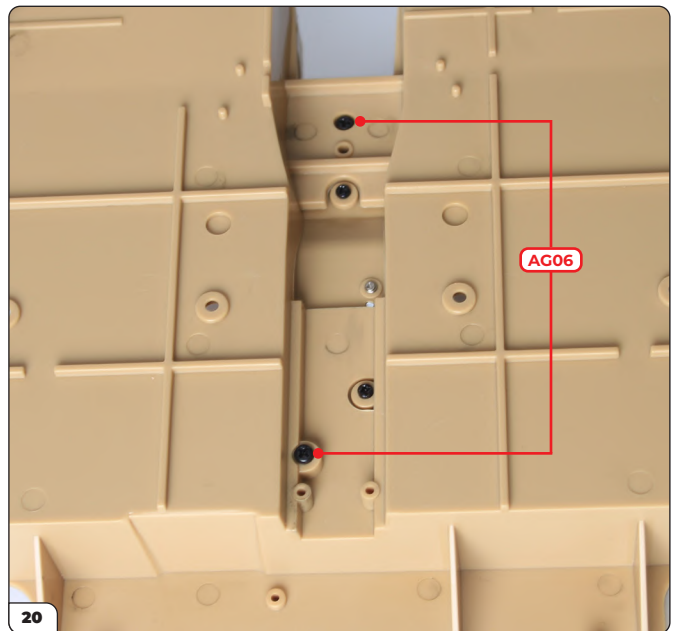

Secure the centre console to the cockpit floor using 2 x AG06 screws.

Stage 60: Driver's Controls

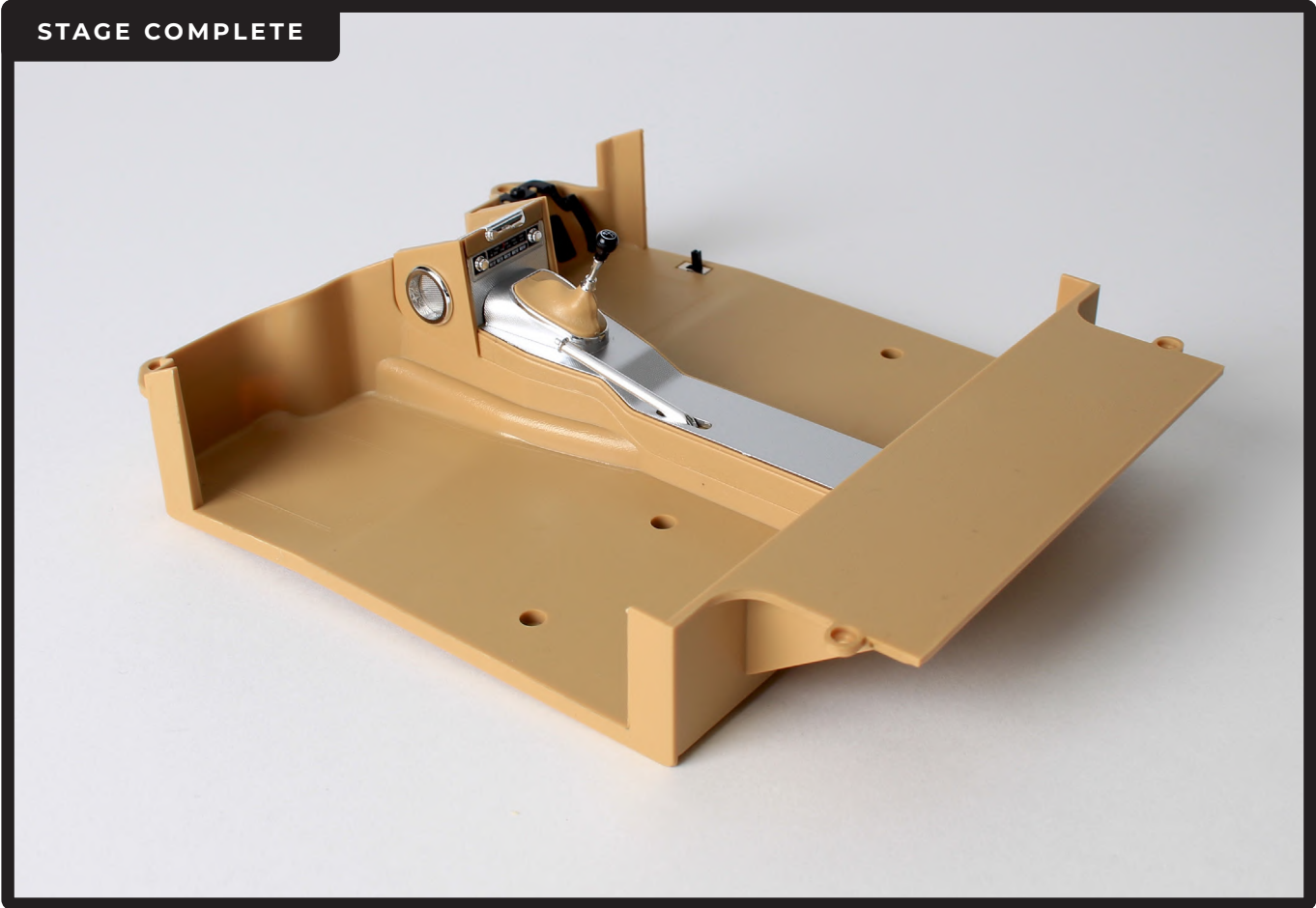

Stage 61: Brake Light Switch and Seat Cushion

In this next stage you'll begin to assemble the passenger seat, and add the switch for operating the brake lights to the cockpit floor.



STAGE 61 PARTS LIST

Name
Seat cushion cover
Seat foam
Seat cushion frame
Microswitch
Switch mount
Screws type AG05 x3



Stage 61: Brake Light Switch and Seat Cushion

STEP 1



Lay the seat cushion cover flat as shown. Take the seat foam and test fit with the seat cushion cover.



Press the seat foam into the seat cushion cover once you are happy with the fit.



Align the seat cushion frame with the cover as shown, using the triangular indentation as a guide (arrows).



Firmly press the seat cushion frame onto the cover, ensuring the fit is flush on the other side (inset).

Stage 61: Brake Light Switch and Seat Cushion



Next take the microswitch and align it with the switch mount as shown.

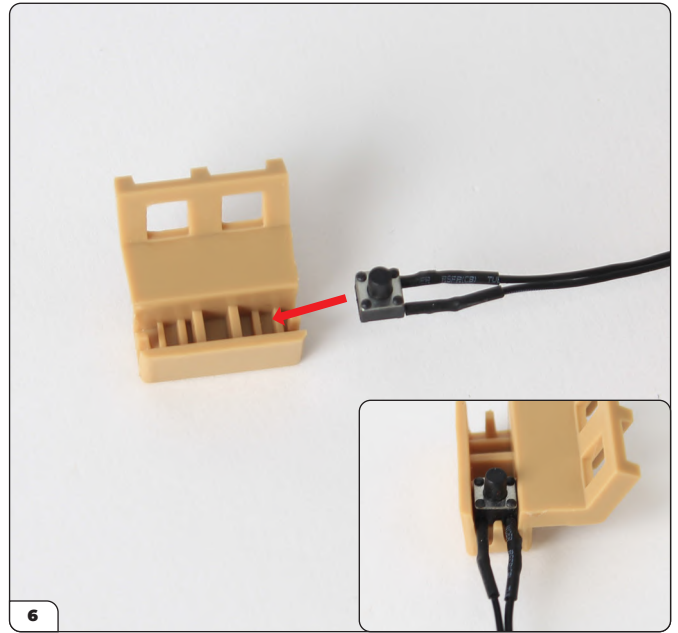

Fit the microswitch into the switch mount (arrow), with the button facing upwards. Make sure the two wires from the microswitch are in the recesses of the mount (inset).

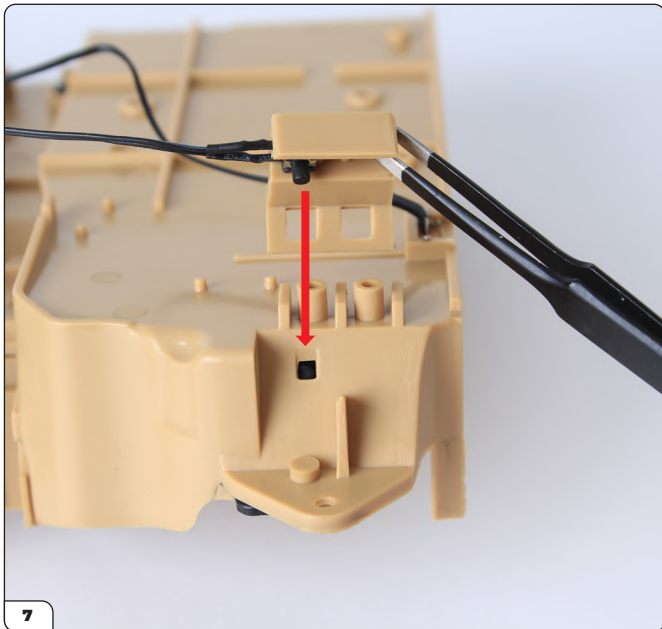

Lay the cockpit assembly from Stage 60 upside down and align the switch mount with it, as shown. Note the hole through which the button from the microswitch will protrude to make contact with the brake pedal (arrow).

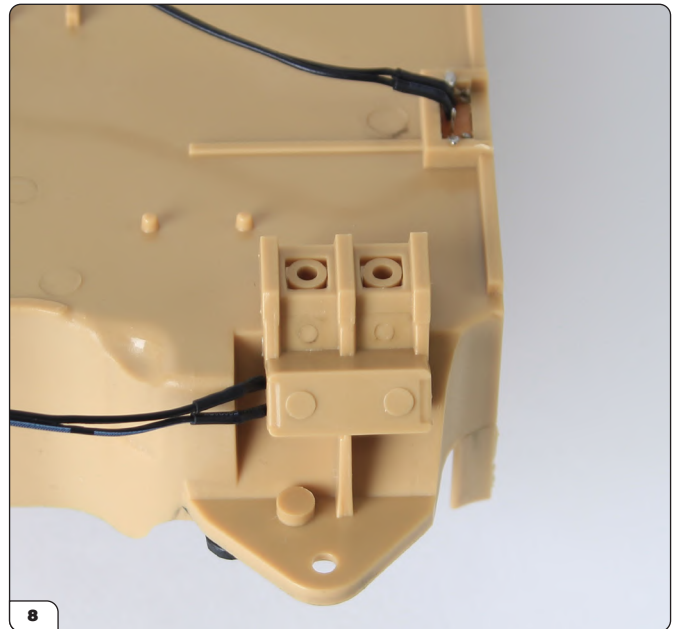

Fit the switch mount in place, so that the two square holes in the switch mount are over the two lugs from the cockpit floor assembly.

Stage 61: Brake Light Switch and Seat Cushion

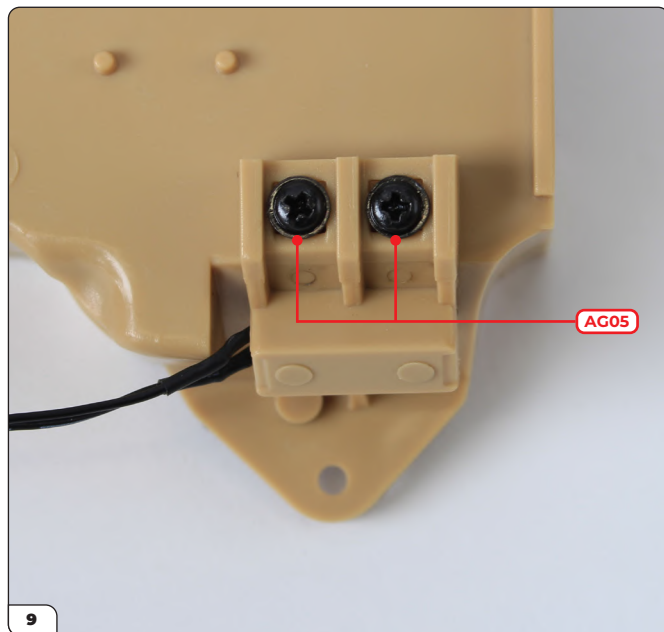

Secure the switch mount in place with 2 x AG05 screws.

Note: Check that the brake pedals operate the switch when pressed.
Adjust the fit of the parts if necessary.

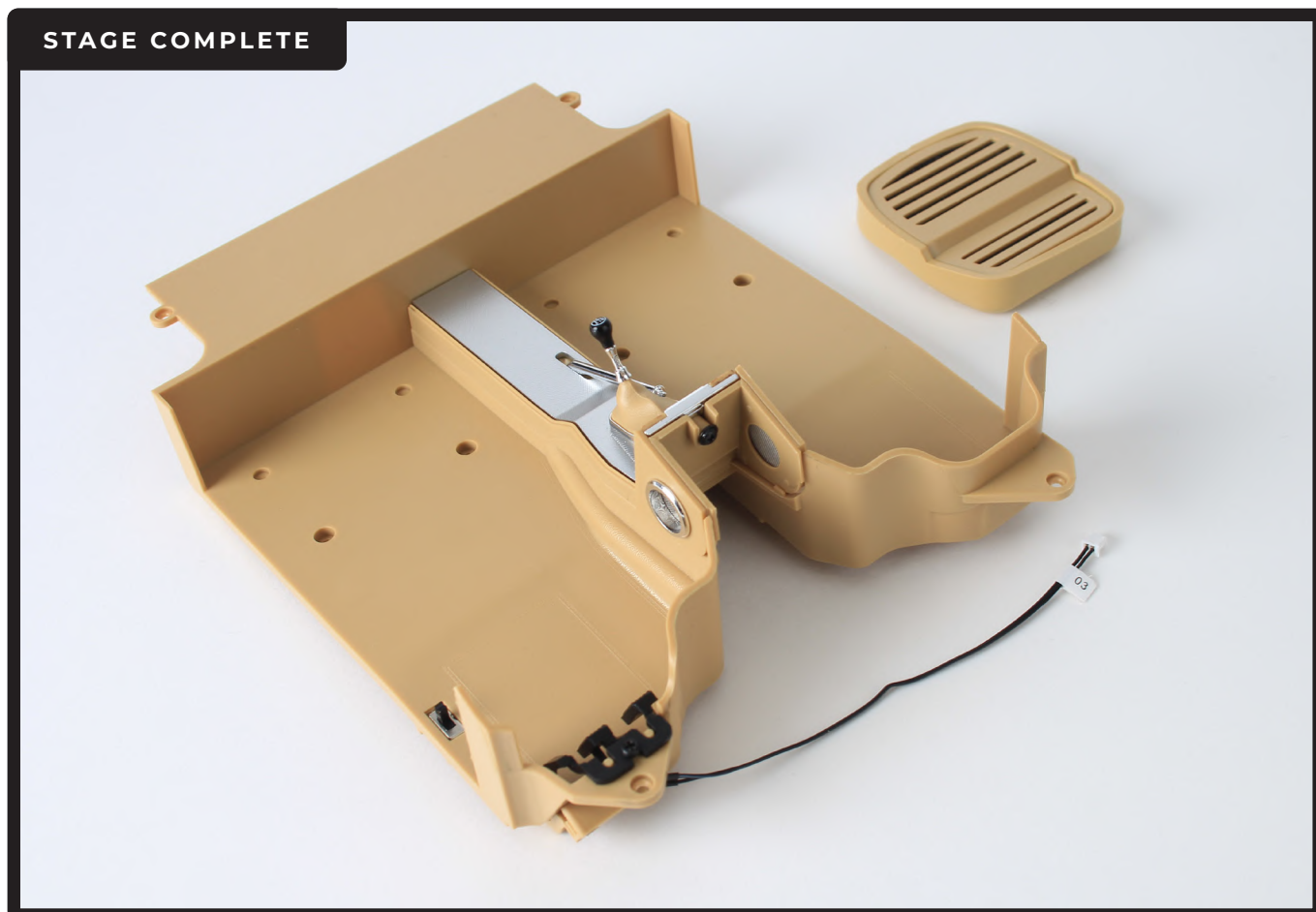

Stage 62: Installing the Seats

Now you'll finish assembling the passenger seat, ready to install both front seats onto the cockpit.



STAGE 62 PARTS LIST

Name
Seat backrest
Seat frame
Screws type AG06 x5



Stage 62: Installing the Seats

STEP 1

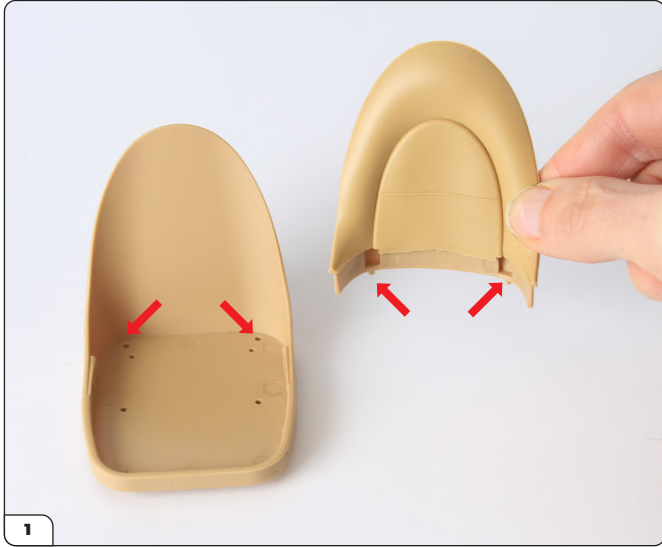

Take the seat backrest and the seat frame as shown. Note the pins and corresponding holes (arrows).



Slide the backrest into place in the seat frame, pushing the pins into the holes and ensuring that the bottom corners snap in behind the retaining clips on each side.



Take the seat cushion assembly from Stage 61.



Press the seat cushion assembly firmly into place on the seat frame.

Stage 62: Installing the Seats

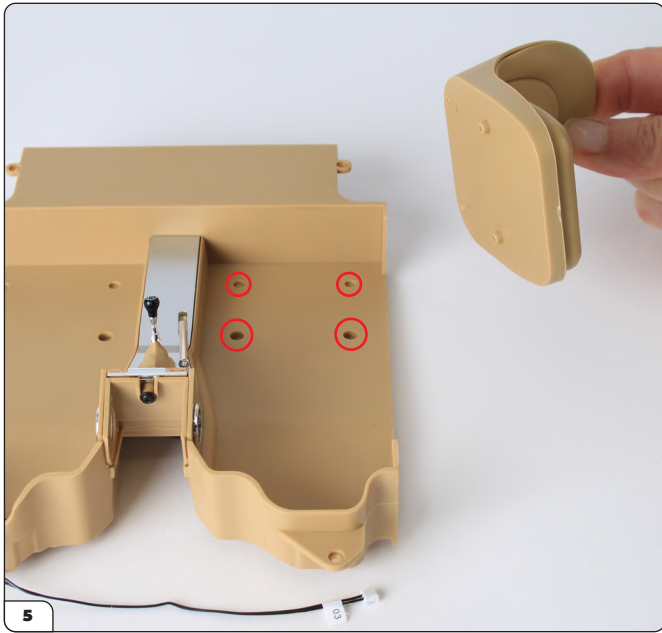

Align the seat with the cockpit floor assembly from Stage 61 as shown, taking note of the small and large holes (circled) on the cockpit floor that will accommodate the lugs on the underside of the seat.

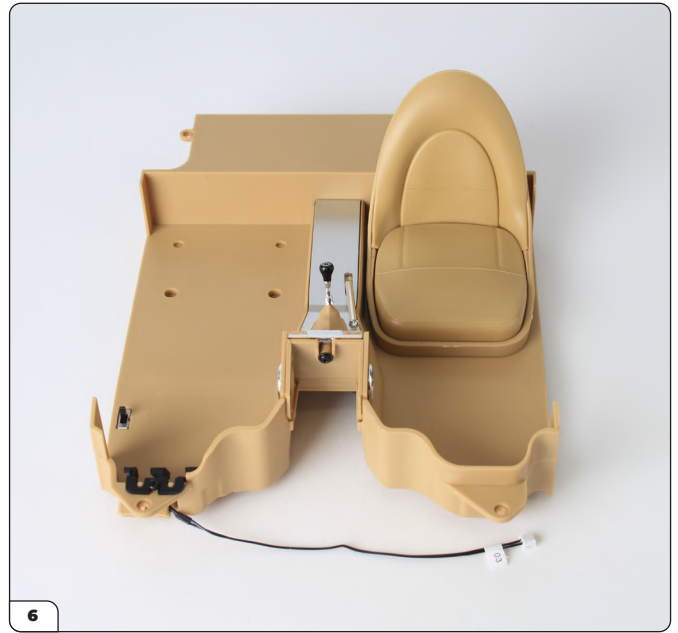

Place the seat onto the cockpit floor in the orientation shown.

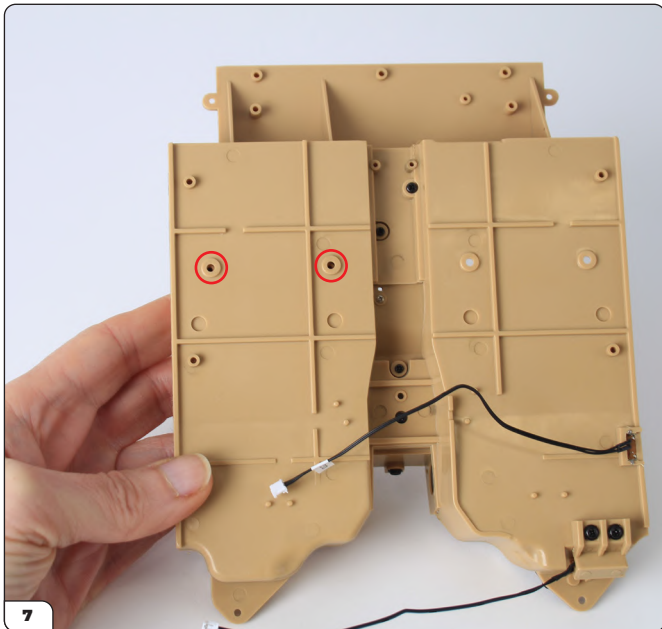

While holding the seat in place, turn the cockpit floor over and identify the screw holes on the underside (circled).

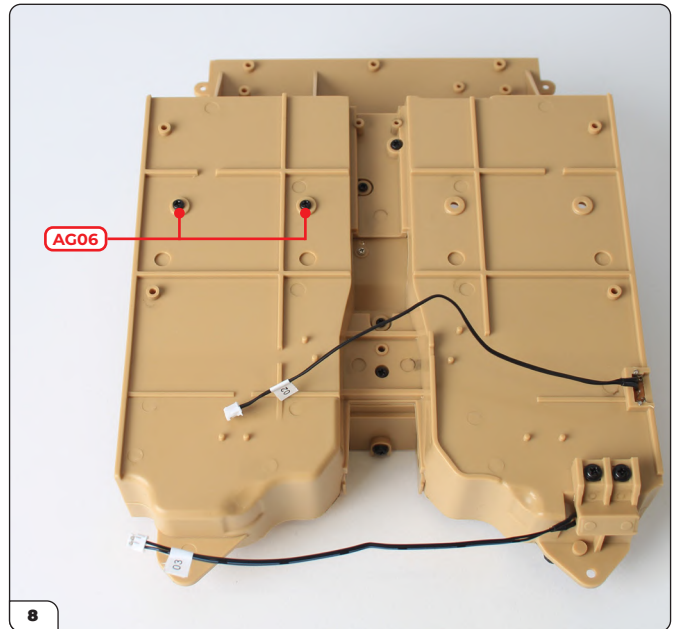

Secure the seat in place using 2 x AG06 screws.

Stage 62: Installing the Seats

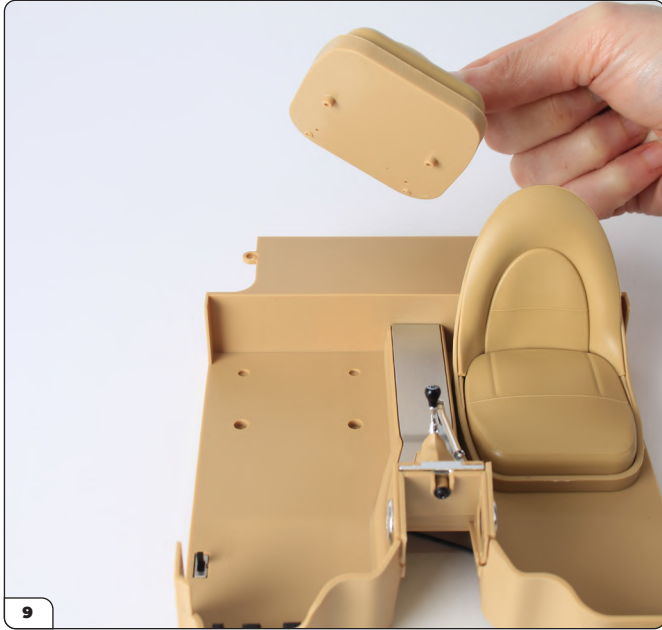

Take the driver's seat assembled in Stage 15 and align it with the cockpit floor as shown.



Fit the seat into the cockpit floor in the same manner as the passenger seat.

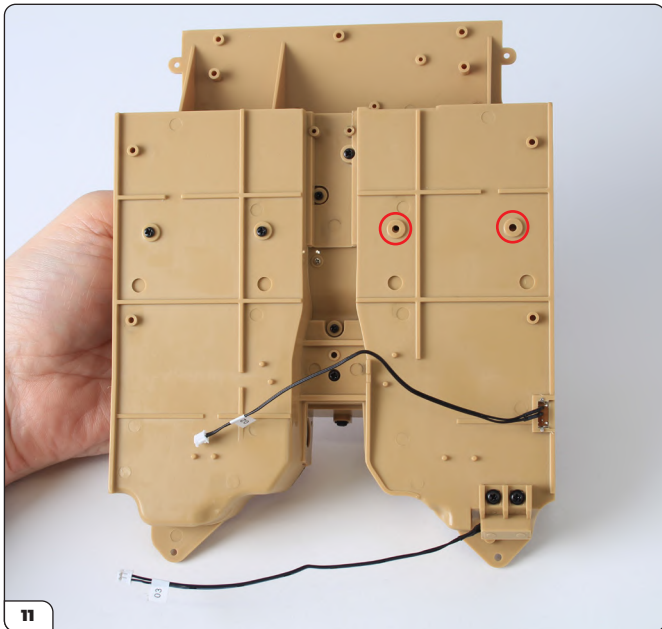

Holding the seat in place, turn the cockpit floor over and identify the two screw holes for fixing the seat in place (circled).

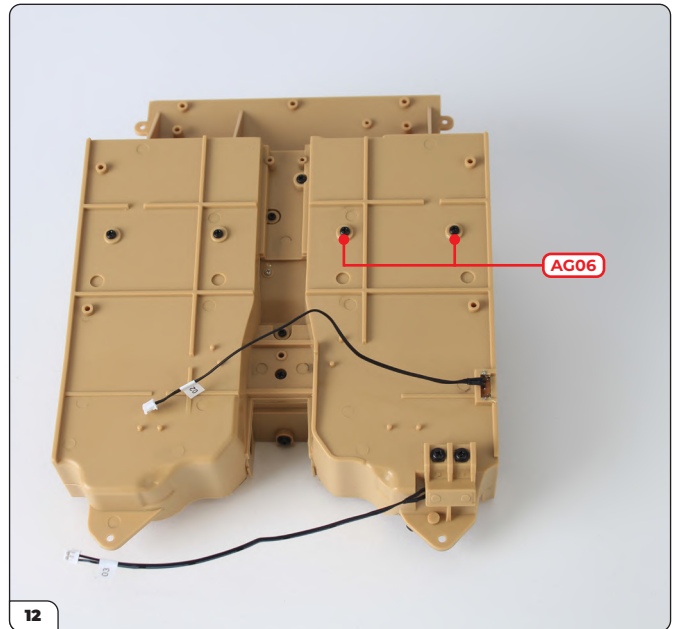

Use 2 x AG06 screws to secure the seat.

Stage 62: Installing the Seats

STAGE COMPLETE



Stage 63: Dashboard

The dashboard is supplied with this stage, but assembly begins by adding the components supplied in stage 64, so unpack the part and move straight on to the next stage.



STAGE 63 PARTS LIST

Name

Dashboard



Stage 64: Dashboard Instruments and Steering Wheel Column

Now you'll assemble the dashboard and its instruments before building and attaching the steering wheel column.



STAGE 64 PARTS LIST

Name
Microswitch
Minor instruments sticker
Instruments sticker
Instrument glass
Instrument mount
Dash panel
Steering column case (top)
Steering column case (bottom)
Control stalk
Steering column
Mixture control
Heater controls
Minor instrument glass
Screws type AG04 x12
Screws type AG06 x3



Stage 64: Dashboard Instruments and Steering Wheel Column

STEP 1



Take the heater controls and mixture control. Note that the heater controls (right) have two switches protruding from the part, while the mixture control (left) has one switch protruding.

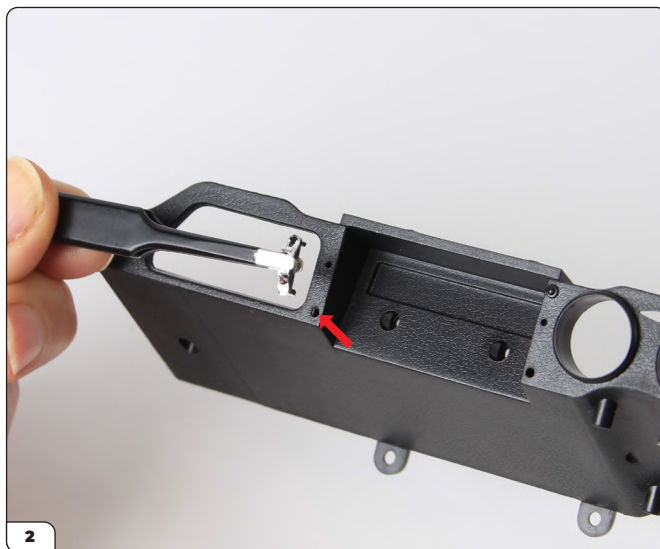

Align the heater controls (two switches) with the dashboard supplied in Stage 63 as shown. The larger D-shaped pin will be pressed into the larger D-shaped hole (arrow) at the bottom of the dashboard.



Press the heater controls into place on the dashboard.

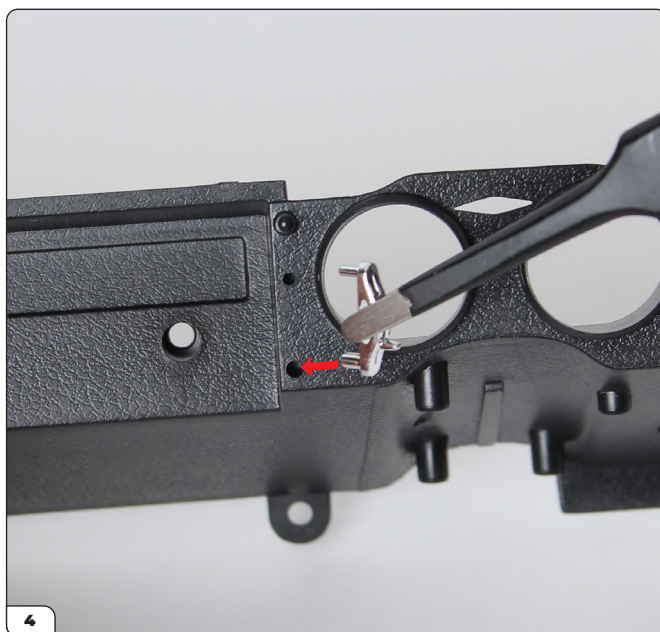

Align the mixture control (one switch) with the two holes on the opposite side of the dashboard as shown. The larger pin on the mixture controls fits into the larger hole in the dashboard (arrow).

Stage 64: Dashboard Instruments and Steering Wheel Column

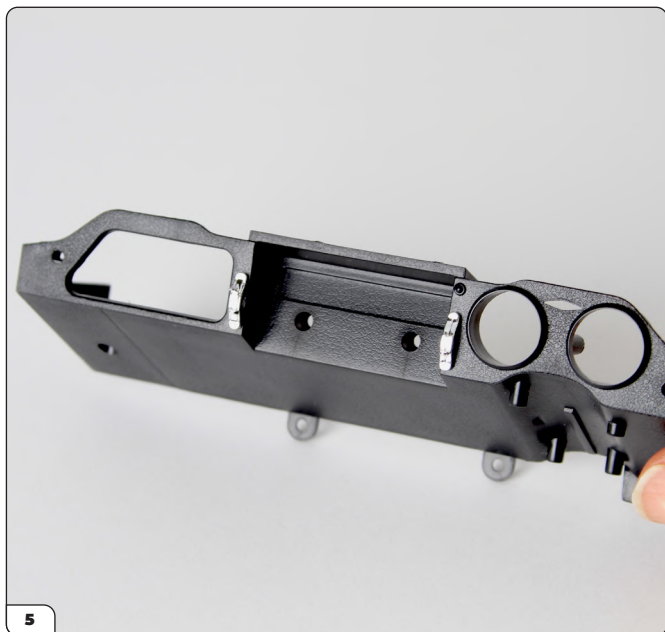

Both the heater controls and mixture control have been mounted onto the dashboard.



Align the minor instruments sticker with the dashboard as shown, checking that the numbers are along the bottom of the four dials (inset). Test the fit of the sticker into the recess (arrow) before removing the backing.

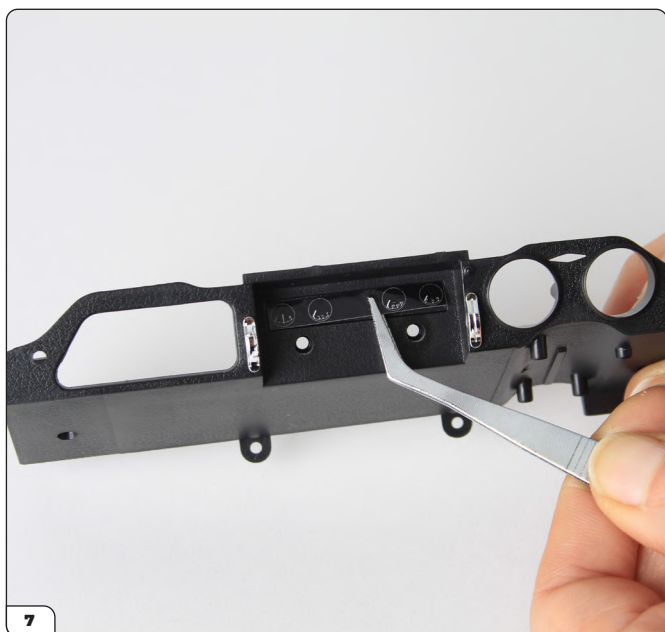

Remove the backing from the sticker and carefully place it into the recess in the dashboard. Place the sticker as centrally as possible while keeping it level.



The minor instruments should look like this once stuck in place.

Stage 64: Dashboard Instruments and Steering Wheel Column



Take the instrument mount and the instrument's sticker and align the two parts as shown. Check that the numbers on the dials are the correct way up (inset). As before, it is recommended you test fit the sticker before removing the backing at this point. Ensure the two holes at the centre of the parts align as you fit them (arrows).



Remove the backing and apply the sticker onto the instrument mount. Use the hole in the centre of the sticker as a guide to align as you stick it onto the mount.

Note: The edges of the sticker may overlap the mount slightly. Try to fit the sticker as centrally as possible.



The sticker has been applied to the instrument mount.



Take the instrument glass. Note the protruding indicators (arrow).

Stage 64: Dashboard Instruments and Steering Wheel Column

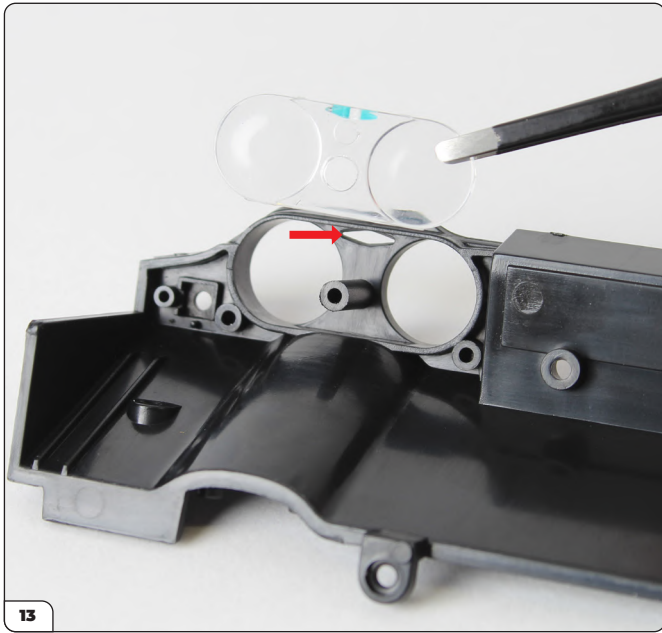

Align the instrument glass with the dashboard as shown. Check that the protruding indicators are facing towards the diamond shaped hole (arrow).



Slide the instrument glass into the dashboard so that the screw lug from the dashboard passes through the hole in the middle of the instrument glass. The protruding indicators should be visible from the front of the dashboard (see picture 20).

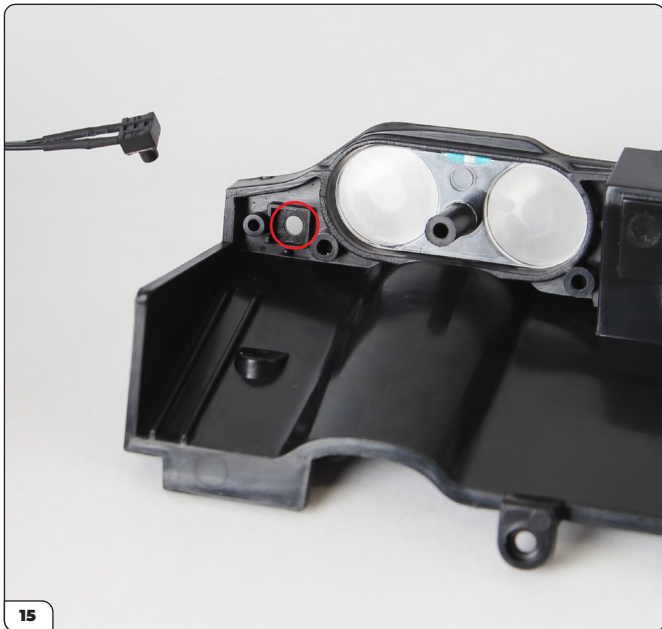

Take the microswitch and identify the hole in the dashboard through which the switch will be pressed (circled).

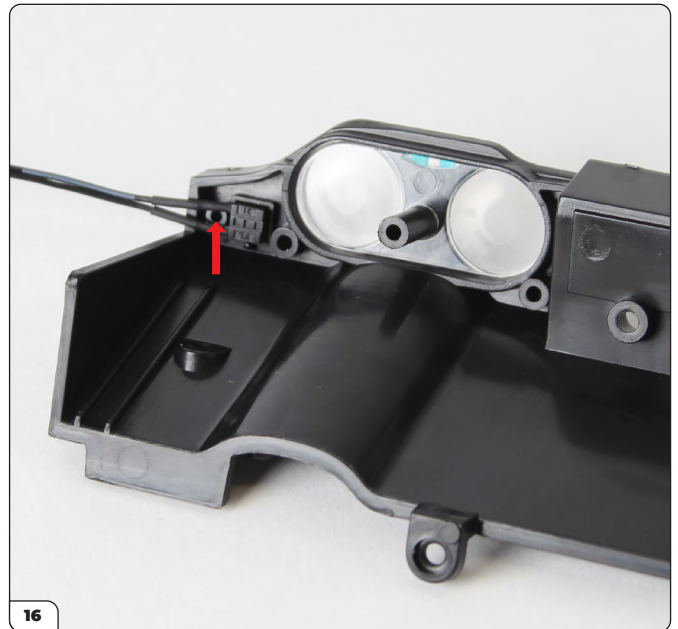

Press the switch in place, make sure that the wires leave a gap for the screw hole (arrow).

Stage 64: Dashboard Instruments and Steering Wheel Column

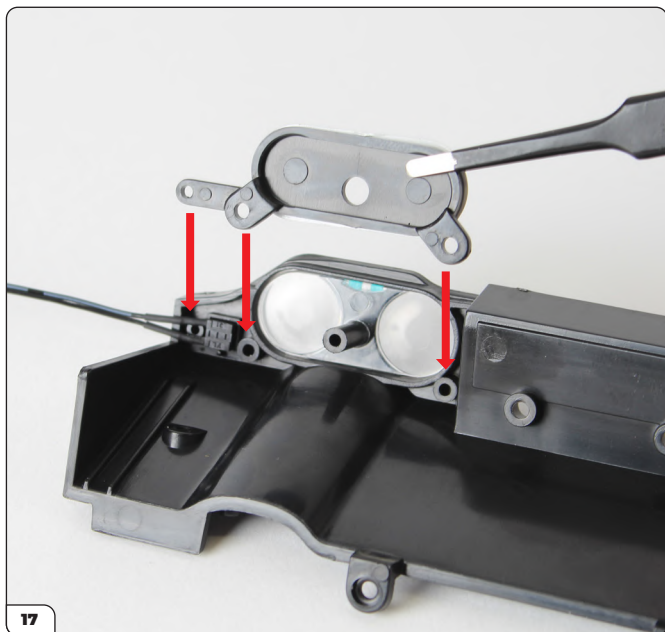

Take the the instrument mount and align it with the dashboard as shown. Note the three screw holes that will need to line up between the dashboard and the mount (arrows).

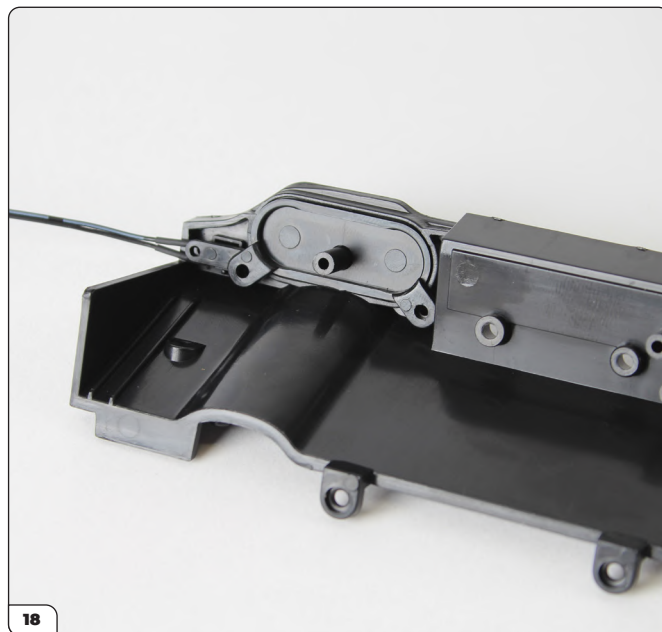

Press the instrument mount into the dashboard as shown, passing the screw lug of the dashboard through the hole of the instrument mount.

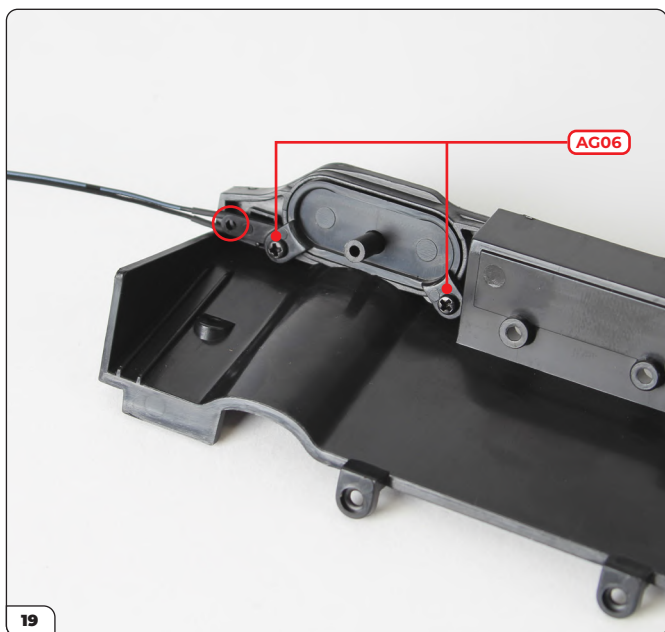

Secure the instrument mount in place using 2 x AG06 screws.

Note: the other screw hole (circled) will be driven in a later step, do not use an AG06 type screw for this hole!



The dashboard should now look like this from the front.

Stage 64: Dashboard Instruments and Steering Wheel Column

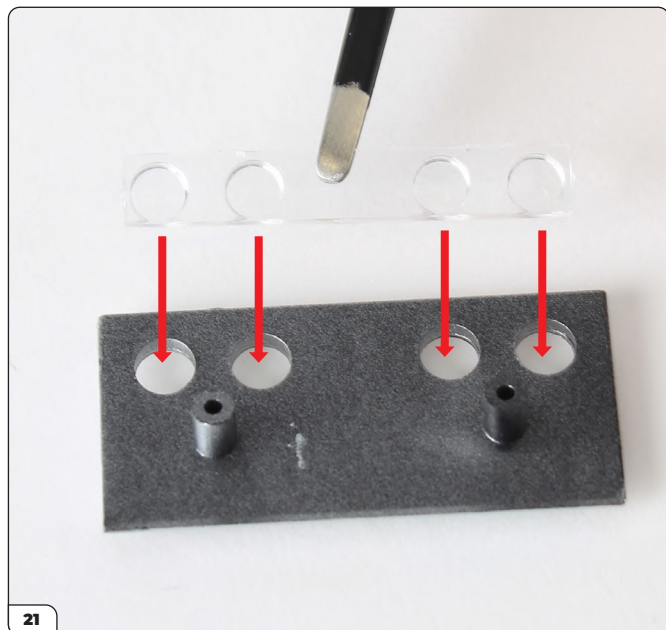

Take the minor instrument glass and align it with the back of the dash panel as shown. The protruding glass will fit into the holes in the dash panel (arrows).

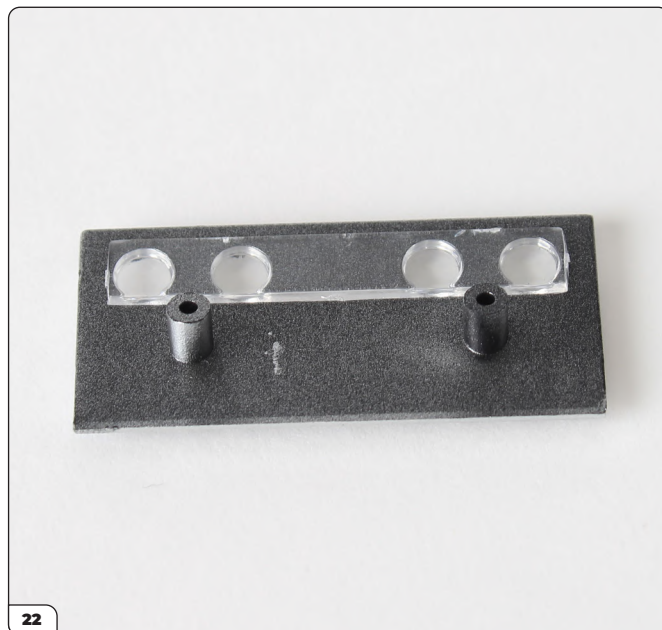

The glass has been fitted to the dash panel. The smooth side of the glass is facing upward in this photo.

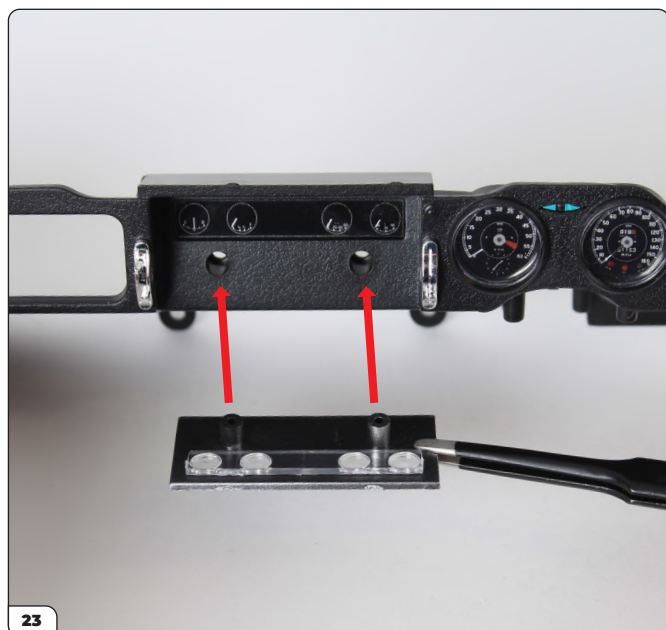

Carefully align the dash panel and glass with the front of the dashboard as shown. Keeping the glass in place, press the lugs on the dash panel into the holes of the dashboard (arrows).



The dash panel should look like this once fitted to the dashboard.

Stage 64: Dashboard Instruments and Steering Wheel Column

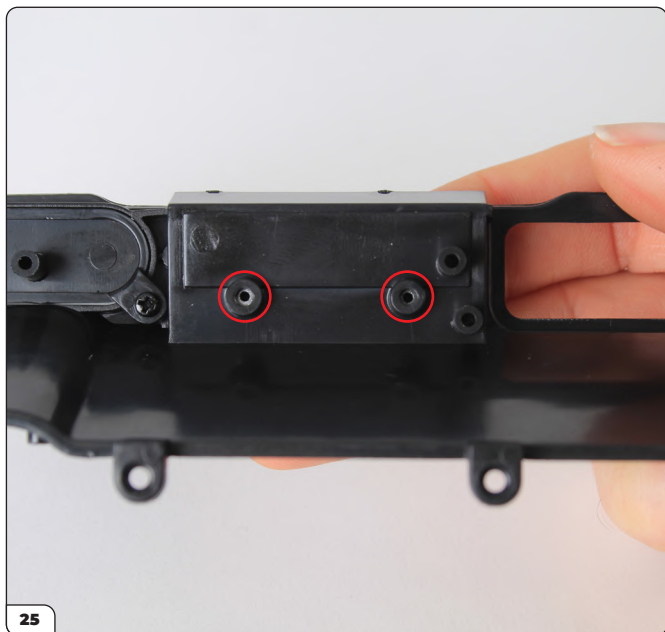

Holding the dash panel in place, turn the dashboard assembly around and identify the two screw holes on the back (circled).

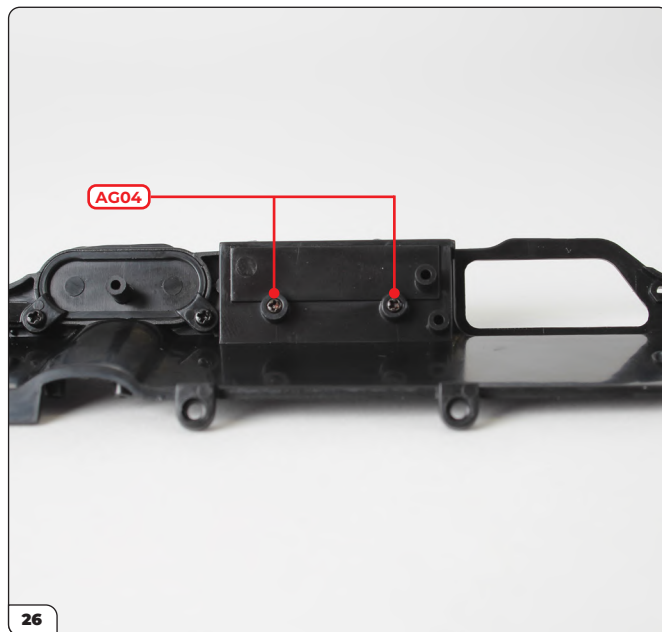

Secure the dash panel in place with 2 x AG04 screws.



Using 1 x AG04 screw, carefully drive into the last hole of the instrument mount. **Be careful not to overtighten this screw.** Check the connection by pressing the button once tightened. If you cannot feel a click, try loosening the screw slightly.

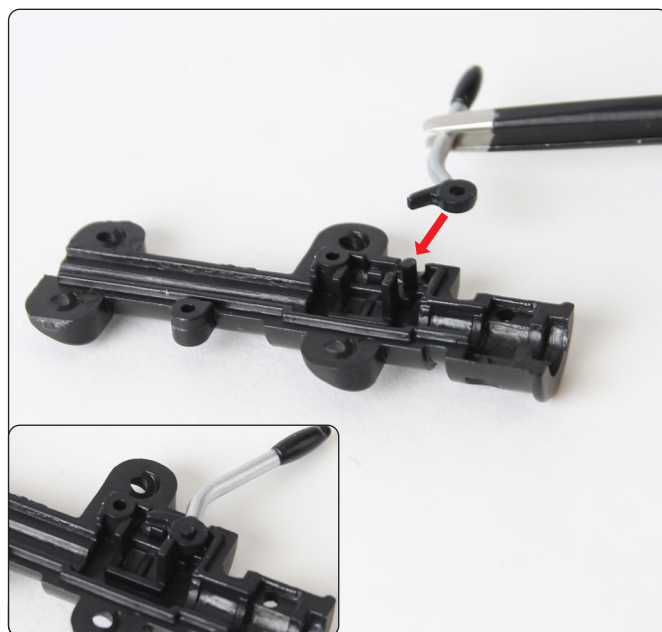

Now take the control stalk and the steering column case (bottom) and align the parts as shown. Fit the control stalk onto the pin protruding from the case (arrow).

Stage 64: Dashboard Instruments and Steering Wheel Column



Next, fit the steering column into its case, so the area between the two ridges fits inside the recesses (arrows). The inset photo shows the correct fit.



The steering column is now in place.

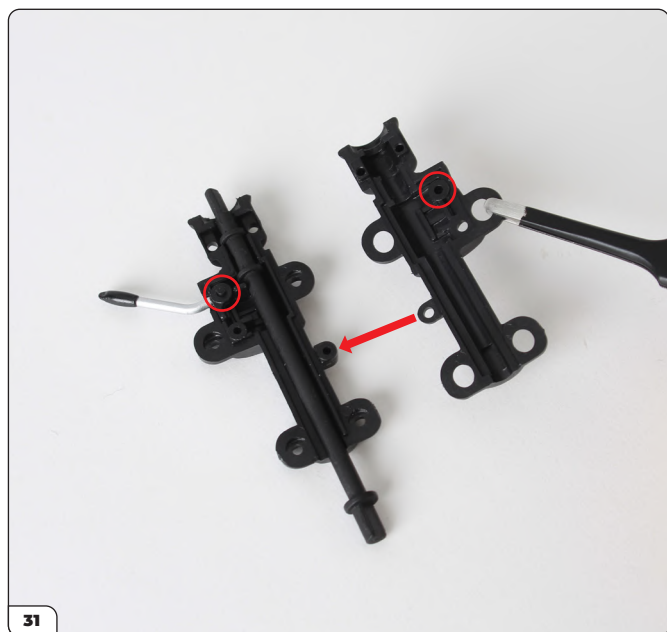

Take the steering column case top and fit it to the bottom part of the case, using the smaller screw holes (arrow) and the pin holding the control stalk as a guide (circled).



The steering column case should now look like this.

Stage 64: Dashboard Instruments and Steering Wheel Column

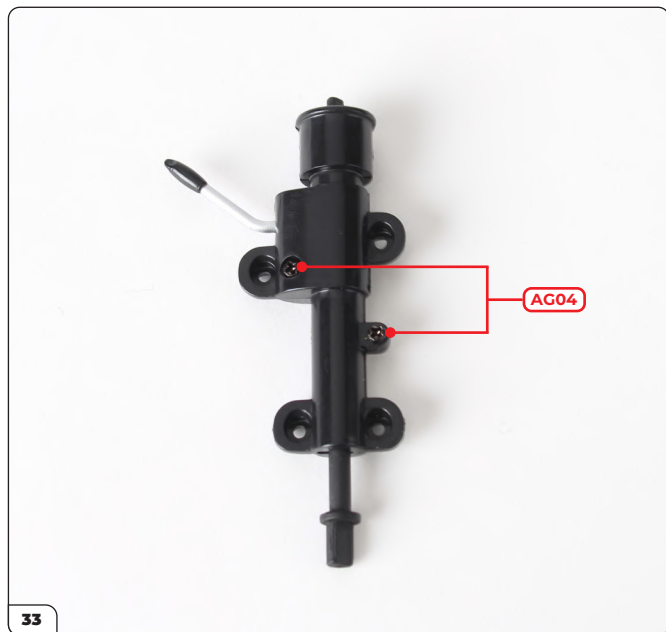

Drive 2 x AG04 screws into the holes indicated.



Turn the steering column case assembly over.



Using 2 x AG04 screws, secure the two halves of the case together.



Take the steering wheel from Stage 01 and align it with the steering column case. Check the orientation of the D-shaped hole and the D-shaped pin.

Stage 64: Dashboard Instruments and Steering Wheel Column



Press the steering wheel into the steering column.

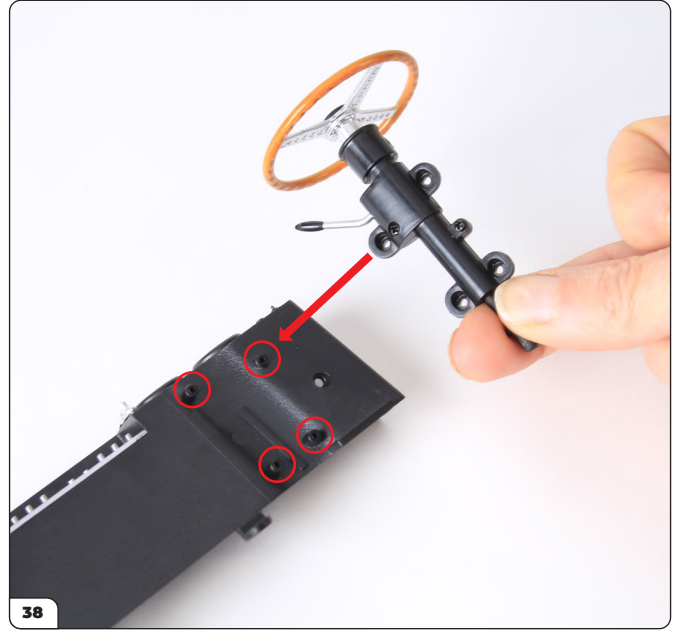

Take the steering wheel column and align it with the underside of the dashboard, noting the connection points (circled).

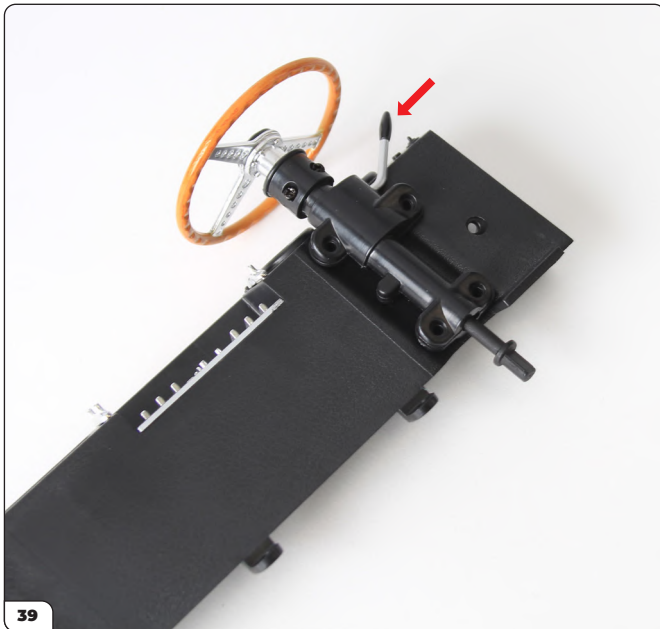

Place the steering wheel column onto the dashboard assembly so that the four screw holes line up. Note the control stalk should point outwards (arrow).

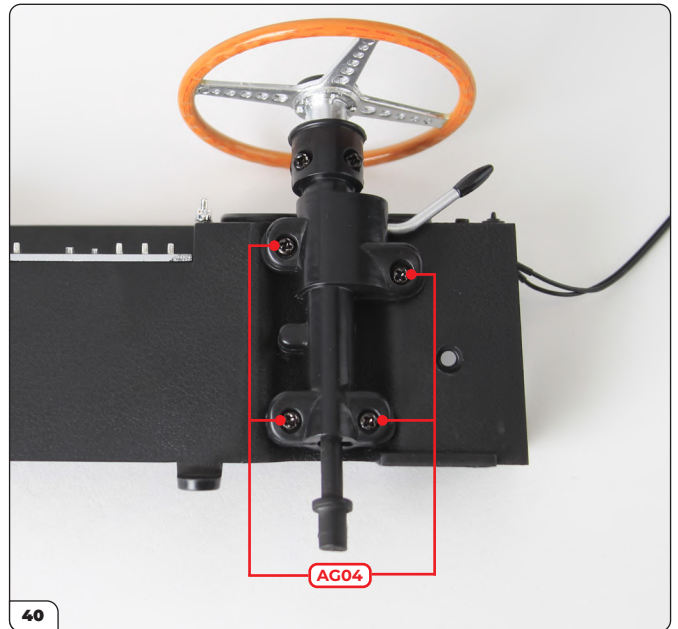

Secure the steering wheel column in place using 4 x AG04 screws.

Stage 64: Dashboard Instruments and Steering Wheel Column

STAGE COMPLETE

